



ENGLISH

DEUTSCH

FRANÇAIS

NEDERLANDS

SLOVENŠČINA

ITALIANO

ESPAÑOL

EMAHNIKA

PORTUGUÊS

# OWNER'S MANUAL

## Docking Speaker

Please read this manual carefully before operating your set and retain it for future reference.

PA36 (PA36)

P/NO : MFL67233873

## Safety Information



**CAUTION:** TO REDUCE THE RISK OF ELECTRIC SHOCK DO NOT REMOVE COVER (OR BACK) NO USER-SERVICEABLE PARTS INSIDE REFER SERVICING TO QUALIFIED SERVICE PERSONNEL.



This lightning flash with arrowhead symbol within an equilateral triangle is intended to alert the user to the presence of uninsulated dangerous voltage within the product's enclosure that may be of sufficient magnitude to constitute a risk of electric shock to persons.



The exclamation point within an equilateral triangle is intended to alert the user to the presence of important operating and maintenance (servicing) instructions in the literature accompanying the product.

**WARNING:** TO PREVENT FIRE OR ELECTRIC SHOCK HAZARD, DO NOT EXPOSE THIS PRODUCT TO RAIN OR MOISTURE.

**WARNING:** Do not install this equipment in a confined space such as a book case or similar unit.

The main label is attached on the exterior of the bottom of the apparatus.

### CAUTION concerning the Power Cord

Most appliances recommend they be placed upon a dedicated circuit;

That is, a single outlet circuit which powers only that appliance and has no additional outlets or branch circuits. Check the specification page of this owner's manual to be certain. Do not overload wall outlets. Overloaded wall outlets, loose or damaged wall outlets, extension cords, frayed power cords, or damaged or cracked wire insulation are dangerous. Any of these conditions could result in electric shock or fire. Periodically examine the cord of your appliance, and if its appearance indicates damage or deterioration, unplug it, discontinue use of the appliance, and have the cord replaced with an exact replacement part by an authorized service center. Protect the power cord from physical or mechanical abuse, such as being twisted, kinked, pinched, closed in a door, or walked upon. Pay particular attention to plugs, wall outlets, and the point where the cord exits the appliance. To disconnect power from the mains, pull out the mains cord plug. When installing the product, ensure that the plug is easily accessible.

This device is equipped with a portable battery or accumulator.

**Safety way to remove the battery or the battery from the equipment:** Remove the old battery or battery pack, follow the steps in reverse order than the assembly. To prevent contamination of the environment and bring on possible threat to human and animal health, the old battery or the battery put it in the appropriate container at designated collection points. Do not dispose of batteries or battery together with other waste. It is recommended that you use local, free reimbursement systems batteries and accumulators. The battery shall not be exposed to excessive heat such as sunshine, fire or the like.

**CAUTION:** The apparatus shall not be exposed to water (dripping or splashing) and no objects filled with liquids, such as vases, shall be placed on the apparatus.

### Disposal of your old appliance



1. When this crossed-out wheeled bin symbol is attached to a product it means the product is covered by the European Directive 2002/96/EC.
2. All electrical and electronic products should be disposed of separately from the municipal waste stream via designated collection facilities appointed by the government or the local authorities.
3. The correct disposal of your old appliance will help prevent potential negative consequences for the environment and human health.
4. For more detailed information about disposal of your old appliance, please contact your city office, waste disposal service or the shop where you purchased the product.



LG Electronics hereby declares that this/these product(s) is/are in compliance with the essential requirements and other relevant provisions of Directive 2004/108/EC, 2006/95/EC, and 2009/125/EC.

European representative :

LG Electronics Service Europe B.V.  
Veluwezoom 15, 1327 AE Almere, The Netherlands (Tel : +31-(0)36-547-8888)

# Table of Contents

## 1 Getting Started

---

- 2 Safety Information
- 5 Unique Features
  - 5 – Portable In
  - 5 – Alarm timer
  - 5 – Made for iPod/ iPhone
  - 5 – USB playback
  - 5 – Radio
- 5 Introduction
  - 5 – Symbol Used in this Manual
- 5 Playable file Requirement
  - 5 – Compatible USB Devices
  - 5 – USB device requirement
  - 6 – MP3/ WMA music file requirement
- 7 Top panel
- 8 Display Window

## 2 Operating

---

- 9 Basic Operations
  - 9 – iPod/ iPhone Operations
  - 9 – Compatible iPod/ iPhone
  - 10 – USB Operation
  - 11 – Programmed Playback
  - 11 – Resume playback
  - 11 – Selecting a folder
- 11 Sound adjustment
  - 11 – Setting the mode
- 12 Setting the Clock
  - 12 – Using your unit as an alarm clock
  - 13 – Activate and deactivate the alarm.  
(Display the alarm information)
  - 13 – Sleep Timer Setting
  - 13 – SNOOZE function
- 14 Radio Operations
  - 14 – Listening to the radio
  - 14 – Presetting the Radio Stations
  - 14 – Deleting all the saved stations
  - 14 – Improving poor FM reception
  - 14 – Seeing information about a Radio station
- 15 Advanced Operations

- 15 – Listening to music from your external device

## 3 Troubleshooting

---

- 16 Troubleshooting

## 4 Appendix

---

- 17 Specifications
- 18 Maintenance
  - 18 – Handling the Unit
- 18 Trademarks and Licenses

## Unique Features

### Portable In

Listens to music from your portable device.

### Alarm timer

Sets alarm which go off at desired time.

### Made for iPod/ iPhone

Enjoys music from iPod/ iPhone with simple connection.

### USB playback

Enjoys music from USB with simple connection.

### Radio

Listens to the radio

## Introduction

### Symbol Used in this Manual



#### Note

Indicates special notes and operating features.



#### Caution

Indicates cautions for preventing possible damages from abuse.

## Playable file Requirement

### Compatible USB Devices

- MP3 Player : Flash type MP3 player.
- USB Flash Drive : Devices that support USB2.0 or USB1.1.
- The USB function of this unit does not support all USB devices.

### USB device requirement

- Devices which require additional program installation connected to a computer, are not supported.
- Do not extract the USB device while in operation.
- For a large capacity USB, it may take longer than a few minute to be searched.
- To prevent data loss, back up all data.
- If you use a USB extension cable or USB hub, the USB device is not recognized.
- Using NTFS file system is not supported. (Only FAT(16/ 32) file system is supported.)
- This unit is not supported when the total number of files is 1 000 or more.
- External HDD, Card readers, Locked devices, or hard type usb devices are not supported.
- USB port of the unit cannot be connected to PC. The unit can not be used as a storage device.

## MP3/ WMA music file requirement

MP3/ WMA file compatibility with this unit is limited as follows :

- Sampling frequency : between 32 to 48 kHz (MP3), within 32 to 48 kHz (WMA)
- Bit rate : between 32 to 320 kbps (MP3), 40 to 320 kbps (WMA)
- Maximum files : Under 999
- File extensions : "mp3"/ "wma"

## Battery Installation

You can only use AC power as power supply. Battery is for backup purpose.

Turn the unit over. Pull the battery compartment, and Insert the battery with the (-) facing in the same direction as the (-) on the battery compartment. Push the battery compartment and turn the unit over again.

Replace the unit's battery with 3V micro lithium cells such as CR2032 or its equivalent.

Dispose of battery safely in accordance with local laws. Do not dispose of in fire.

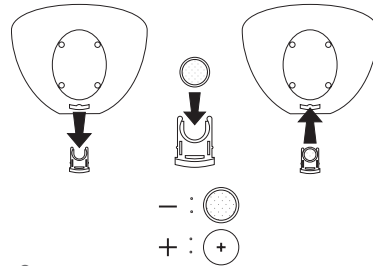

### Warning

The battery used in this device may present a fire or chemical burn hazard if mistreated. Do not recharge, disassemble, incinerate, or heat above 100 °C (212 °F). Replace the battery with Matsushita Elec. Ind. Co., Ltd. (Panasonic), part no. CR2032 only. Use of another battery may present a risk of fire or explosion. Dispose of used batteries. Keep batteries away from children. Do not disassemble or dispose of in fire.

### Note

If you insert the battery upside down, the clock won't switch on.

## Top panel

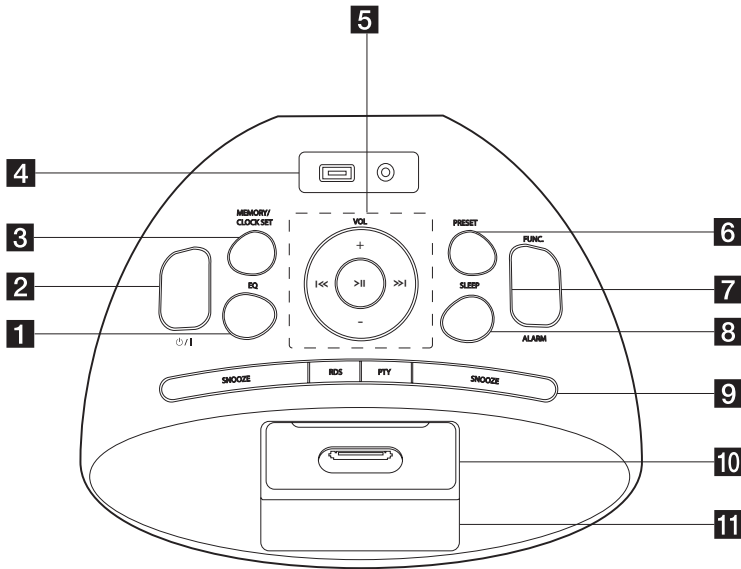

### 1 EQ

Chooses sound impressions.

### 2 ⏻/⏻ (POWER)

### 3 MEMORY/ CLOCK SET

MEMORY used for storing radio station and scrolling through saved station. On the USB mode, you can make your own playlist. Also used for setting the clock and checking the time.

### 4 USB Port / PORT. IN

You can play music files by connecting the USB device.

Listens to music from your portable device

### 5 VOL (+ / -)

Adjusts speaker volume

|<< / >>|

- Skip : Press |<< / >>|

- Search : Press and hold |<< / >>|

>||

- Starts playback and pauses : press >||

- Stops playback : press and hold >||

### 6 PRESET

Chooses a preset number for a radio station.

### 7 FUNC.

Selects the function or input source.

### ALARM

With the ALARM function you can turn IPOD/ IPHONE, USB, BUZZER and TUNER on or off at a desired time.

### 8 SLEEP

Sets the system to turn off automatically at a specified time.

### 9 RDS/ PTY

RDS (Radio Data System)/ Searches radio stations by radio type.

### SNOOZE

The SNOOZE function wakes you up every 5 minutes if you press **SNOOZE**.

### 10 iPod/ iPhone DOCKING

### 11 Display window

# Display Window

1

Getting Started

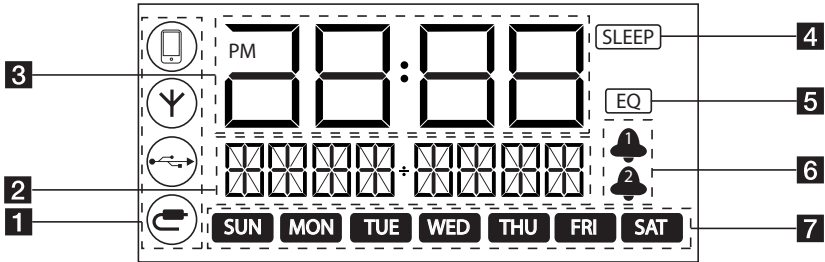

**1** FUNCTION indicators

- Ⓜ IPOD
- Ⓣ TUNER
- Ⓢ USB
- Ⓟ PORTABLE

**2** PROGRAM indicator

iPod/iPhone/Tuner/USB/Portable information

**CLOCK/ ALARM/ VOLUME information indicator**

**3** TIMER/ CLOCK indicator

**4** SLEEP indicator

**5** EQ

**6** ALARM indicator

**7** ALARM periods



# Basic Operations

## iPod/ iPhone Operations

You can enjoy the sound with your iPod/ iPhone. For details about iPod/ iPhone, refer to the iPod/ iPhone User Guide.

1. Connect the iPod/ iPhone firmly. If you turn this unit on, your iPod/ iPhone is automatically turned on and starts recharging .

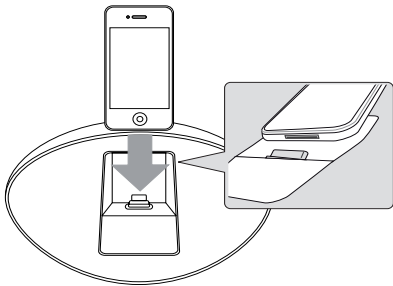

2. Press **FUNC.** on the unit to select iPod function.

To	Do this
Pause or restart	Press <b>&gt;  </b>
Skip	During playback, press <b> &lt;&lt; / &gt;&gt; </b> to go to the next file or to return to the beginning of the current file. Press <b> &lt;&lt;</b> twice briefly to step back to the previous file.
Search	Press and hold <b> &lt;&lt; / &gt;&gt; </b> during playback and release it at the point you want to listen to.

## Compatible iPod/ iPhone

- The unit supports the models as follows ;  
iPod nano 1 G, 2 G, 3 G, 4 G, 5 G, 6 G/  
iPod classic/  
iPod 5 G/  
iPod touch 1G, 2 G, 3 G, 4 G/  
iPod Mini  
iPhone 3 G, 3GS , 4.  
For some models, the unit may not operate depending on the firmware version.
- Depending on your iPod/ iPhone's software version, you may not control your iPod/ iPhone from the unit.

### ! Note

- If this unit displays an error message, follow the message. An error message "ERROR".
  - Your iPod/ iPhone is not connected firmly.
  - This unit recognizes your iPod/ iPhone as an unknown device.
  - Your iPod/ iPhone is exceptionally low in power.
    - ➔ The battery needs to be charged.
    - ➔ If you charge the battery while iPod/ iPhone is extremely low in power, it may take longer to be charged.
- iPod/ iPhone does not support recording function when connected.
- Depending on your iPod/ iPhone 's software version, it may not be possible to control your iPod/ iPhone from this unit. We recommend installing the latest software version.
- If you use an application, make a call, or send and receive SMS text message, etc. on iPod touch or iPhone, disconnect it from iPod dock of this unit and then use it.
- If you have a problem with your iPod/ iPhone, please visit [www.apple.com/support/ipod](http://www.apple.com/support/ipod).

## USB Operation

1. Connect the USB device to the USB port.
2. Select the **USB** function by pressing **FUNC.** on the unit.

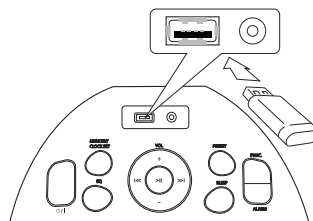

To	Do this
Stop	Press and hold <b>&gt;  </b> .
Play	Press <b>&gt;  </b> .
Pause	During playback, press <b>&gt;  </b> .
Skipping to the next/previous file	During playback, press <b> &lt;&lt;/&gt;&gt; </b> to go to the next file or to return to the beginning of the current file. Press <b> &lt;&lt;</b> twice briefly to step back to the previous file.
Searching for a section within a file	Press and hold <b> &lt;&lt;/&gt;&gt; </b> during playback and release it at the point you want to listen to.

## Programmed Playback

The program function enables you to store your favorite files from USB device.

A program can contain 20 files.

1. Insert a USB and wait for it to be order.
2. Press **MEMORY/ CLOCK SET** on the unit in stop status.
3. Press **I<</>>I** to select a file.
4. Press **MEMORY/ CLOCK SET** again to save and select a next file
5. Press **>II** to play the programmed music files.
6. To clear your selection, press and hold **MEMORY/ CLOCK SET** in stop statuae.

## Resume playback

The unit memorizes the point where you pressed the **>II**. Press **>II** to resume playback. If you press and hold **>II**, the unit will clear the stopped point.

## Selecting a folder

1. Press **PRESET** on the unit repeatedly until a desired folder appears.
2. Press **>II** to play it. The first file of folder will play. (USB only)

### Note

- During playback, if you turn the unit off and on, the last file you listened to plays normally
- During playback, if you change the function mode and return back to the previous function mode, the last file you listened to plays normally.

## Sound adjustment

### Setting the mode

This system has a number of pre-set sound fields. You can select a desired sound mode by using **EQ**.

The displayed items for the Equalizer may be different depending on sound sources and effects.

On Display	Description
POP CLASSIC ROCK JAZZ	This program lends an enthusiastic atmosphere to the sound, giving you the feeling you are at an actual pop, classic rock or jazz concert.
BASS	Reinforce the treble, bass and sound effect.
BYPASS	You can enjoy the sound without equalizer effect.

## Setting the Clock

1. Turn the unit off.
2. Press **MEMORY/ CLOCK SET** for at least 2 seconds.
3. Choose time mode by pressing **|<</>>|**.  
- 12:00 (for an AM and PM display) or 0:00 (for a 24 hour display)
4. Press **MEMORY/ CLOCK SET** to confirm your selection.
5. Select the hour and the minute by pressing **|<</>>|**.
6. Press **MEMORY/ CLOCK SET**.
7. Select the year, month and day by pressing **|<</>>|**.

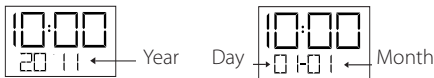

8. Press **MEMORY/ CLOCK SET**.
9. If you want to reset the clock, repeat steps 1-8.
10. If you want to stop while setting the clock, press and hold **MEMORY/ CLOCK SET**.

### ! Note

- If you want to set 12h, "PM" appears in the display window.
- If you want to set 24h, "PM" disappears in the display window.

## Using your unit as an alarm clock

1. Turn the unit on or off
2. Press and hold **ALARM** to set the alarm function.
3. Choose alarm mode by pressing **|<</>>|**.
4. Press **>||** to confirm your selection.
5. The hour setting blinks.  
Press **|<</>>|** to change the hour and press **ALARM** to save.
6. The minute setting blinks.  
Press **|<</>>|** to change the minute and press **ALARM** to save.
7. You can change in the following order, TUNER -> BUZZER -> USB -> IPOD by using **|<</>>|**.  
Press **ALARM** to save.
8. The alarm periods setting blinks.  
Press **|<</>>|** to change the alarm periods, and press **ALARM** to save.  
alarm periods : 7Days -> 5Days -> 2Days  
7Days : Everyday  
5Days : Weekday  
2Days : Weekend
9. The volume settings blinks.  
Press **|<</>>|** to change the volume and press **ALARM** to save.
10. The time when you want to stop ringing blinks.  
Press **|<</>>|** to change the hour and minute. Then press **ALARM** to save.
11. You can check the setting status.
12. If you want to reset the alarm, repeat steps 2-10.

### ! Note

When you set the alarm information (time, sound source, alarm periods, volume), the alarm icon  will blink in the display window.

### ! Note

- If you set ALARM1 and ALARM2 at the same time, the ALARM1 function only works.
- During the playback, if the time you set is up, the function is switched to the function you set for ALARM.
- If the function you set for alarm does not work, tuner function works automatically.
- If the alarm stops, the function you set works normally.
- If you don't set clock, the alarm function doesn't work.
- In the TUNER, BUZZER, USB, IPOD mode, the unit turns off at the preset time.
- If you don't connect the AC power cord to the wall outlet, the alarm function doesn't work.
- If you make a mistake while setting the alarm, press and hold **ALARM** to reset the alarm.
- If you set the clock time, you can check the time by pressing **ALARM**.
- If you set the clock time and alarm, you can check the alarm icon "🔔" and set information by pressing **ALARM** even when the unit is turned off. Then this function will work.
- Since the alarm goes off, if you don't press any button for 10 minute, the alarm will stop ringing automatically. (In only the BUZZER mode)
- When the alarm rings, you can deactivate the alarm by pressing all the buttons. (In only the BUZZER mode.)

## Activate and deactivate the alarm. (Display the alarm information)

1. Press **ALARM** to activate/deactivate the alarm. If you set the ALARM1 and ALARM2, select one by pressing **!<</>>!**.
2. Press **>||** to confirm your selection.

### ! Note

- If you activate the alarm, 🔔 or 🔔 will appear in the display window.
- If you activate the alarm, you can see the alarm information.
- If you deactivate the alarm, 🔔 or 🔔 will disappear in the display window.

## Sleep Timer Setting

Press **SLEEP** repeatedly to select delay time between 10 and 180 minutes. After the delay time, unit will turn off. (You can see in the following order, 180->150-> 120 -> 90 -> 80 -> 70 -> 60 -> 50 -> 40 -> 30 -> 20 -> 10)

To cancel the sleep function, press **SLEEP** repeatedly until "OFF" appears.

## SNOOZE function

This function wakes you up every 5 minutes if you press **SNOOZE**. If the time you set is up, the unit turns on automatically and the alarm rings. If you press **SNOOZE**, the alarm stops ringing and then the unit power off. The alarm rings again in 5 minutes.

### ! Note

- If you set the "OFF time" between SNOOZE time, SNOOZE time will be priority.
- If you press **ALARM**, SNOOZE function stop working.

## Radio Operations

### Listening to the radio

1. Press **FUNC.** until TUNER appears in the display window.  
The last received station is tuned in.
2. Auto tuning : Press and hold **I<</>>I** for about 2 seconds until the frequency indication starts to change, then release. Scanning stops when the unit tunes in a station.  
Manual tuning: Press **I<</>>I** repeatedly.
3. Adjust the volume by pressing **VOL (+/-)** on the top panel.

### Presetting the Radio Stations

You can preset 6 stations for FM.

Before tuning, make sure that you have turned down the volume.

1. Press **FUNC.** until TUNER appears in the display window.
2. Select the desired frequency by using **I<</ >>I**
3. Press **MEMORY/ CLOCK SET** until a preset number will blink in the display window.
4. Press **PRESET** to select the preset number you want.
5. Press **MEMORY/ CLOCK SET**. The station is stored.
6. Repeat the steps 2 to 5 to store other stations.
7. To listen a preset station, press **PRESET**.

### Deleting all the saved stations

Press **MEMORY/ CLOCK SET** for at least two seconds. "CLEAR" will flash up on the unit display.  
Press **MEMORY/ CLOCK SET** to erase all saved radio stations.

### Improving poor FM reception

Press **>||** on the unit. This will change the tuner from stereo to mono and usually improve the reception.

#### Note

Be sure to extend the antenna fully. And adjust it to get more clear reception.

### Seeing information about a Radio station

The FM tuner is supplied with the RDS (Radio Data System) facility. This shows information about the radio station being listened to. Press **RDS** repeatedly to cycle through the various data types.

PS (Programme Service Name)	The name of the channel will appear in the display.
PTY (Programme Type Recognition)	The programme type (e.g. Jazz or News) will appear in the display.
RT (Radio Text)	A text message contains special information from the broadcast station. This text may scroll across the display.
CT (Time controlled by the channel)	This shows the time and date as broadcast by the station.

You can search the radio stations by programme type by pressing **RDS**. The display will show the last PTY in use. Press **PTY** one or more times to select your preferred programme type. Press and hold **I<</>>I** The tuner will search automatically. When a station is found, the search will stop.

## Advanced Operations

### Listening to music from your external device

The unit can be used to play the music from many types of external device. (Portable cable is not supplied as an accessory with unit)

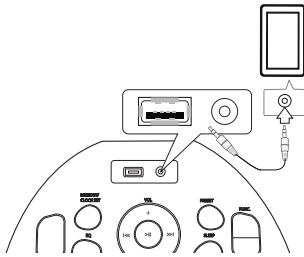

1. Connect the external device to the PORT. IN connector of the unit.
2. Turn the power on by pressing **POWER**.
3. Select the PORTABLE function by pressing **FUNC.**
4. Turn the external device on and start it playing.

## Troubleshooting

Problem	Correction
No Power.	Plug the power cord into the wall outlet securely.
There is little or no sound.	Select the correct input mode of the unit so you can hear the sound from the unit.
Radio stations cannot be tuned in properly.	<ul style="list-style-type: none"><li>• Adjust its position.</li><li>• Tune to the station manually.</li><li>• Preset some radio stations, see page 14 for details.</li></ul>
iPod / iPhone does not work.	Check whether the unit is connected to the unit correctly. Connect it to the unit correctly.

3

Troubleshooting



## Specifications

General	
Power supply	110-240 V, 50-60 Hz
Power consumption	15 W
Net Weight	0.65 kg
External dimensions (W x H x D)	200 x 112 x 176 mm
Operating conditions Temperature	5 °C to 35 °C (41 °F to 95 °F) Operation status: Horizontal
Operating humidity	5 % to 85 %

Tuner	
FM Tuning Range	87.5 to 108.0 MHz or 87.50 to 108.00 MHz

Amplifier	
Output Power	1.5 W + 1.5 W
T.H.D	less than 1 %

USB	
USB Version	USB 2.0 or USB 1.1
Bus Power Supply	USB : DC 5 V $\text{---}$ 500 mA, iPod/ iPhone : DC 5V $\text{---}$ 1A

Speakers	
Type	1 Way 2 Speaker
Impedance	4 $\Omega$
Rated Input Power	1.5 W
Max. Input Power	2 W

- Design and specifications are subject to change without notice.

## Maintenance

### Handling the Unit

#### When shipping the unit

Please save the original shipping carton and packing materials. If you need to ship the unit, for maximum protection, re-pack the unit as it was originally packed at the factory.

#### Keeping the exterior surfaces clean

Do not use volatile liquids such as insecticide spray near the unit.

Wiping with strong pressure may damage the surface.

Do not leave rubber or plastic products in contact with the unit for a long period of time.

#### Cleaning the unit

To clean the unit, use a soft, dry cloth. If the surfaces are extremely dirty, use a soft cloth lightly moistened with a mild detergent solution. Do not use strong solvents such as alcohol, benzine, or thinner, as these might damage the surface of the unit.

## Trademarks and Licenses



iPod is a trademark of Apple Inc., registered in the U.S. and other countries.

iPhone is a trademark of Apple Inc. "Made for iPod" and "Made for iPhone" mean that an electronic accessory has been designed to connect specifically to iPod or iPhone respectively, and has been certified by the developer to meet Apple performance standards. Apple is not responsible for the operation of this device or its compliance with safety and regulatory standards.

Please note that the use of this accessory with iPod, iPhone may affect wireless performance.

---



