



OWNER'S MANUAL SMART CAR AUDIO

Please read this manual carefully before operating your set and retain it for future reference.

LCS720BO / LCF820BO



MFL67409382

ENGLISH

DEUTSCH

FRANÇAIS

ESPAÑOL

ITALIANO

PORTUGUÊS

EMHNIKA

Safety Information



CAUTION: TO REDUCE THE RISK OF ELECTRIC SHOCK DO NOT REMOVE COVER (OR BACK) NO USER-SERVICEABLE PARTS INSIDE REFER SERVICING TO QUALIFIED SERVICE PERSONNEL.

 This lightning flash with arrowhead symbol within an equilateral triangle is intended to alert the user to the presence of uninsulated dangerous voltage within the product's enclosure that may be of sufficient magnitude to constitute a risk of electric shock to persons.

 The exclamation point within an equilateral triangle is intended to alert the user to the presence of important operating and maintenance (servicing) instructions in the literature accompanying the product.

WARNING: TO PREVENT FIRE OR ELECTRIC SHOCK HAZARD, DO NOT EXPOSE THIS PRODUCT TO RAIN OR MOISTURE.

WARNING: Do not install this equipment in a confined space such as a book case or similar unit.

 Always operate the vehicle in a safe manner. Do not become distracted by the vehicle while driving, and always be fully aware of all driving condition. Do not change settings,

or any functions. Pull over in a safe and legal manner before attempting such operations.

 Do not use for many hours at extremely low or high temperature. (-10 °C to 60 °C)

 To reduce the risk of electric shock, do not remove the cover or back of this product. There are no user-serviceable parts inside. Refer servicing to qualified service personnel.

 To reduce the risk of fire or electric shock, do not expose this product to dripping or splashing water, rain, or moisture.

 The temperature of unit's outside can be extremely high, please use the unit after proper installation in your vehicle.

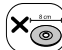
 This unit cannot play 8 cm disc (use 12 cm disc only).

 While driving, keep the sound volume at a proper level.

 Do not drop it and avoid heavy impacts at anytime.

 This unit is for vehicles with a 12-volt battery and negative grounding. Before installing it in a recreational vehicle, lorry or bus, check the battery voltage. To avoid shorts in the electrical system, be sure to disconnect the E battery cable before beginning the installation.



CAUTION: This product employs a Laser System. To ensure proper use of this product, please read this owner's manual carefully and retain it for future reference. Shall the unit require maintenance, contact an authorized service centre.

Use of controls, adjustments or the performance of procedures other than those specified herein may result in hazardous radiation exposure.

To prevent direct exposure to laser beam, do not try to open the enclosure.

This device is equipped with a portable battery or accumulator.

Safe way to remove the battery or the battery from the equipment:

Remove the old battery or battery pack, follow the steps in reverse order than the assembly. To prevent contamination of the environment and bring on possible threat to human and animal health, the old battery or the battery put it in the appropriate container at designated collection points. Do not dispose of batteries or battery together with other waste. It is recommended that you use local, free reimbursement systems batteries and accumulators.

The battery shall not be exposed to excessive heat such as sunshine, fire or the like.

Disposal of waste batteries/ accumulators

 1. When this crossed-out wheeled bin symbol is attached to batteries/accumulators of Your product it means they are covered by European Directive 2006/66/EC.

2. This symbol may be combined with chemical symbols for mercury(Hg), cadmium(Cd) or lead(Pb) if the battery Contains more than 0.0005% of mercury, 0.002% of cadmium or 0.004% of lead.

3. All batteries/accumulators should be disposed separately from the municipal waste stream via designated collection facilities appointed by the government or the local authorities.

4. The correct disposal of Your old batteries/accumulators will help to prevent potential negative consequences for the environment, animal and human health.

5. For more detailed information about disposal of Your old batteries/accumulators, please contact Your city office, waste disposal service or the shop where You purchased the product.

Disposal of your old appliance

1. When this crossed-out wheeled bin symbol is attached to a product it means the product is covered by the European Directive 2002/96/EC.

2. All electrical and electronic products shall be disposed of separately from the municipal waste stream via designated collection facilities appointed by the government or the local authorities.

3. The correct disposal of your old appliance will help prevent potential negative consequences for the environment and human health.

4. For more detailed information about disposal of your old appliance, please contact your city office, waste disposal service or the shop where you purchased the product.

CE LG Electronics hereby declares that this/these product(s) is/are in compliance with the essential requirements and other relevant provisions of Directive 2004/108/EC, 2006/95/EC and 2009/125/EC.

European Standards Centre:

Krijgsman 1, 1186 DM Amstelveen The Netherlands

- Please note that this is NOT a Customer Service contact point. For Customer Service Information, see Warranty Card or contact the dealer that you purchased this product.

Table of Contents**1 Getting Started**

- 2 Safety Information
- 4 Front panel
- 5 Remote control
- 5 – Battery Installation

2 Connecting

- 6 Installation
- 6 – Basic Installation
- 6 – Removing the existing receiver unit
- 6 – ISO-DIN Installation
- 7 About detachable control panel
- 8 Connection
- 8 – Connecting to a car

3 Operating

- 9 Operation
- 9 – Basic operations
- 9 – Turning off the sound temporarily
- 9 – Using EQ (Equalizer)
- 9 – Using 3D SOUND/ MIRROR CD
- 9 – Checking the clock
- 9 – Turning off the display light

- 9 – Resetting the unit
- 9 – Adjusting the general settings
- 11 Listening to a CD
- 11 – Pausing or restarting CD playback
- 11 – Searching for a section within a track / file
- 11 – Skipping to another track/ file
- 11 – Checking information about your music
- 11 – Playing back tracks / files in a way you want
- 12 Listening to music from an external device
- 12 – Preventing radical changes in volume as switching sources
- 12 Listening to the radio
- 12 – Storing desired frequencies manually
- 13 – Listening to a preset station
- 13 – Adjusting TUNER settings
- 14 Using an USB device/ SD card
- 14 – Moving to another drive
- 14 – Quick search of a desired file
- 14 – Deleting the desired file
- 14 – Playable USB device/ SD card Requirement
- 14 – Recording to USB device / SD card
- 15 Listening to music by connecting iPod/iPhone
- 15 – Pausing or restarting playback
- 15 – Searching for a section within a file
- 15 – Skipping to another file
- 15 – Checking information about your music
- 15 – Playing back files in a way you want
- 16 – Playing back files by music menus
- 16 – iPod / iPhone CONTROL MODE
- 16 – Compatible iPod / iPhone models
- 16 Connecting a Bluetooth wireless technology
- 17 – Using the buttons for Bluetooth wireless technology
- 17 – Using a Bluetooth wireless technology
- 18 – Adjusting the setting
- 19 – Using "LG CAR Remote" application
- 20 – Phone compatibility list

4 Troubleshooting

- 22 Troubleshooting

5 Appendix

- 23 Specifications

1

2

3

4

5

1

Getting Started

Front panel

[LCS720BO]

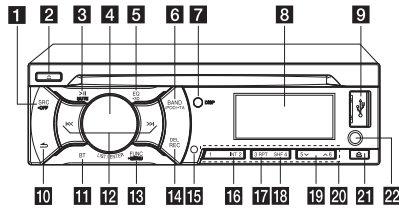

[LCF820BO]

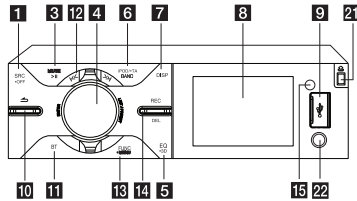

- 1 SRC**
When pressed, selects function sources.
• **OFF**
When pressed and held, powers unit off.
- 2** (LCS720BO only)
Ejects a disc.
- 3** **>||**
Plays and pauses playback.
MUTE
Temporarily stops the sound.

- 4 LIST / ENTER / PRESET (Volume knob)**
- Adjusts volume level.
- Confirms the settings.
- Checks tracks, files or preset stations.
- 5 EQ / • 3D**
Improves sound quality.
- When pressed, selects the EQ function.
- When pressed and held, selects the 3D SOUND/ MIRROR CD function.

- 6 BAND**
- Selects a band in Tuner mode.
- Moves to a next USB drive.
iPOD
Activates iPod / iPhone CONTROL MODE.
• **TA (Optional)**
Searches stations that have TA / TP information, when it is pressed and held.

- 7 DISP**
- Press it, you can check the clock time.
- Press and hold it, you can turn on/off the display window and the light of LED buttons.

- 8** Display window

- 9 USB port**

- 10** **⏮**
Returns to the previous step.

- 11 BT**
- Activates BT function.
- Answers a call.

- 12** **|<< / >>|**
Skip / Search / Seek / Tune

- 13 FUNC**
In each mode, sets playback items.
• **MENU**
Activates setting menu.

- 14 REC**
Recording to USB.
DEL
Deleting the desired file.

- 15** Remote Sensor

- 16 INT (LCS720BO only)**
Intro scan.

- 17 RPT (LCS720BO only)**
Repeats playback.

- 18 SHF (LCS720BO only)**
Shuffles playback.

- 19** **^ / v** (LCS720BO only)
- Moves 10 MP3 / WMA files backward or forward if there is no folder or one folder on a CD/ USB.
- Moves to the previous or next folder if there are more than 2 folders on a CD/ USB.

- 20 Numeric buttons (1 to 6)** (LCS720BO only)
Selects a numbered preset station in TUNER.

- 21** **🔒**
Opens the front panel.

- 22 AUX**
If connected to other portable player, you can enjoy music from it on the unit.

Remote control

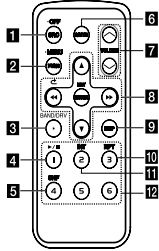

- 1 SRC**
When pressed, selects function sources.
• **OFF**
When pressed and held, powers unit off.
- 2 FUNC**
When pressed, sets playback items in each mode.
• **MENU**
When pressed and held, activates setting menu.
- 3 BAND**
Selects a band in Tuner mode.
DRV
Moves to a next USB drive.
- 4 ▶/⏸** Plays or pauses playback.
- 5 SHF** Shuffles playback.
- 6 MUTE** Temporarily stops the sound.
- 7 VOLUME ▲ / ▼**
Adjusts volume level.

- 8 ◀◀/▶▶**
Skip / Search / Seek / Tune
↶
Returns to the previous step.
▲ / ▼
- List up / down
- Adjusts settings.
- Moves 10 MP3 / WMA tracks backward or forward if there is no folder or one folder on a CD/ USB.
- Moves to the previous or next folder if there are more than 2 folders on a CD/ USB.
- ENTER / LIST**
- Confirms the settings.
- Checks tracks, files or preset stations.
- 9 DISP**
- Press it, you can check the clock time.
- Press and hold it, you can turn on/off the display window and the light of LED buttons.
- 10 RPT** Repeats playback.
- 11 INT** Intro scan.
- 12 Numeric buttons (1 to 6)**
Selects a numbered preset station in TUNER.

Battery Installation

Type 1

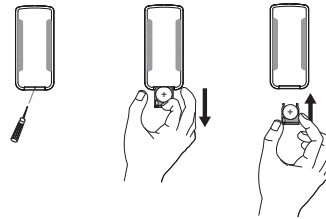

Type 2

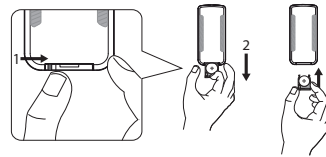

! Note

- Use only one CR2025 (3 V) lithium battery.
- Remove the battery if the remote control is not used for a long period of time.
- Do not leave the product in a hot or humid place.
- Do not handle the battery with metallic tools.
- Do not store the battery with metallic materials.

Installation

Basic Installation

Before installing, make sure that the ignition-switch is set to OFF and remove the terminal of the car battery to avoid short-circuiting.

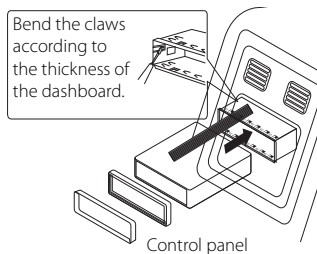

1. Remove the existing receiver unit.
2. Make the necessary connections.
3. Install the installation sleeve.
4. Install the unit into the installation sleeve.

Removing the existing receiver unit

If there is already an installation sleeve for the receiver unit in the dashboard, it must be removed.

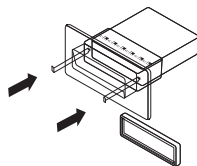

1. Remove the rear support from the unit.
2. Remove the control panel and trim ring from the unit.
3. Insert the lever into the hole on one side of the unit. Perform the same operation on the other side and pull the unit out from the mounting sleeve.

ISO-DIN Installation

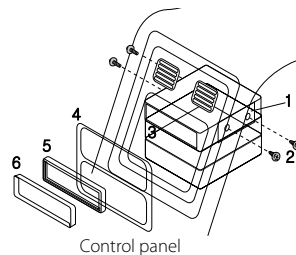

1. Slide the unit into the ISO-DIN frame.
2. Fit screws removed from the old unit.
3. Slide the unit and frame into the dash opening.
4. Install the dash panel or adapter plate. (According to models, this step may not be needed.)
5. Install the trim ring to the unit.
6. Install the control panel to the unit.

About detachable control panel

[LCS720BO]

Attaching the control panel

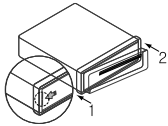

1. Align the left side of the panel with the stopper.
2. Push the right side of panel into the unit until it clicks.

Detaching the control panel

1. Press the to open the control panel.

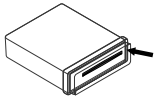

2. Lift the control panel slightly.
3. Push the control panel to right.

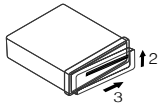

4. Pull the control panel out of the unit.
5. Put the detached control panel into the protective case.

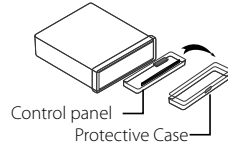

[LCF820BO]

Attaching the control panel

1. Attach part **A** of the control panel to part **B** of the unit.

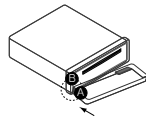

2. Attach part **C** of the control panel to part **D** of the unit while pushing the control panel to left.

3. Close the control panel.

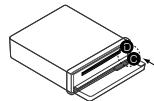

Detaching the control panel

1. Press the to open the control panel.

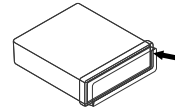

2. Push the control panel to left.

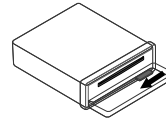

3. Pull the control panel out of the unit.
4. Put the detached control panel into the protective case.

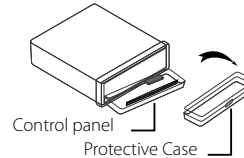

Caution

- The control buttons may not work properly if the control panel is not attached properly. If this occurs, gently press the display.
- Do not leave the control panel in any area exposed to high temperatures or direct sunlight.
- Do not drop the control panel or otherwise subject it to strong impact.
- Do not allow such volatile agents as benzene, thinner, or insecticides to come into contact with the surface of the control panel.

Note

Periodically wipe the contacts on the back of the control panel with a cotton swap moistened with alcohol. For safety, turn off the ignition before cleaning, and remove the key from the ignition switch.

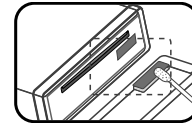

Connection

Connecting to a car

Before installing, make sure that the ignition-switch is set to OFF and remove the terminal of the car battery to avoid short-circuiting.

2

Connecting

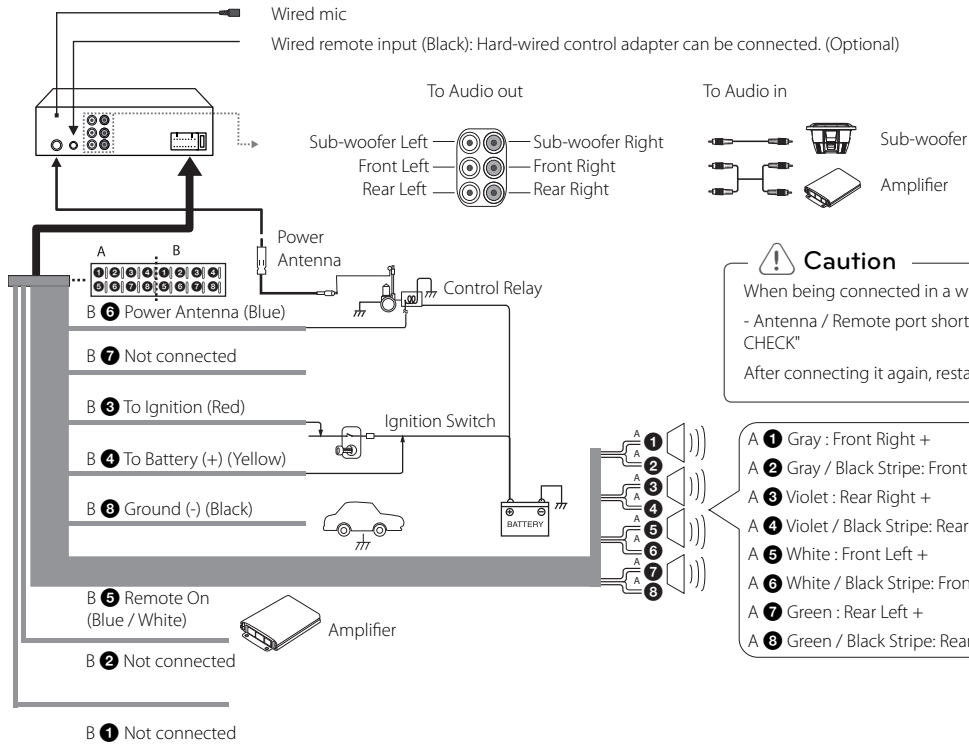

Caution

When being connected in a wrong way, the unit displays as follows.

- Antenna / Remote port short: "ANTENNA/ REMOTE ON PORT SHORT CIRCUIT CHECK"

After connecting it again, restart the unit.

- A 1 Gray : Front Right +
- A 2 Gray / Black Stripe: Front Right -
- A 3 Violet : Rear Right +
- A 4 Violet / Black Stripe: Rear Right -
- A 5 White : Front Left +
- A 6 White / Black Stripe: Front Left -
- A 7 Green : Rear Left +
- A 8 Green / Black Stripe: Rear Left -

Operation

Basic operations

1. Turn the unit on by pressing any key on the unit.
2. Select a source by pressing SRC.
3. Rotate the volume knob to adjust the volume on the unit.
Or press VOLUME ▲ / ▼ on the remote control.

Turning off the sound temporarily

1. Press MUTE to mute your unit. (When MP3/ WMA file is played, it will be paused.)
Or press MUTE on the remote control.
2. Press it again to cancel

Using EQ (Equalizer)

EQ is to increase or decrease the signal strength of audio frequencies. The function helps you to enjoy sound more plentifully.
Press EQ on the unit. And rotate the volume knob to select the item and press it. The indicator lights up in the following order.

FLAT → B-BOOST (BASS BOOSTER) → POP → CLASSIC → ROCK → JAZZ → VOCAL → SALSA → SAMBA → REGGAE → RUSSY → USER EQ1 → USER EQ2

Using 3D SOUND/ MIRROR CD

3D SOUND: This mode delivers outstanding surround sound.

MIRROR CD (MIRROR CD SOUND): This mode enhances the quality of compressed music file.

Press and hold EQ/ • 3D. And rotate the volume knob to select the item and press it. The indicator lights up in the following order.

OFF → 3D SOUND → MIRROR CD

! Note

- 3D SOUND/ MIRROR CD is only available when you use the CD/ USB/ SD card. (Except iPod/iPhone)
- When you are recording, 3D SOUND/ MIRROR CD will be turned off automatically.

Checking the clock

1. Press DISP.
2. Press it again to cancel.

Turning off the display light

1. Press and hold DISP.
2. Press and hold it again to turn it on.

! Note

Under the light-off condition, press any key, the light is turned on and then off automatically if you don't press it within a few seconds.

Resetting the unit

You can reset the unit when it does not operate properly.

1. Detach the control panel.
Refer to page 7 for detaching the control panel.
2. Press the RESET hole with a sharp object.

[LCS720BO]

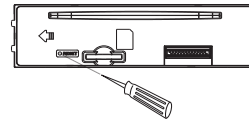

[LCF820BO]

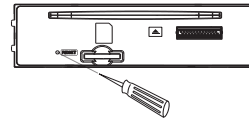

Adjusting the general settings

You can adjust [SOUND], [LIGHT] and [OTHER] settings.

On the unit

1. Press and hold • MENU.
2. Rotate the volume knob to select [SOUND], [LIGHT], or [OTHER] and press it.
3. Rotate the volume knob to select the item and press it.
4. Rotate the volume knob clockwise or counterclockwise to adjust the level.
5. Press the volume knob to confirm the setting.
If you want to return to the previous step, press ⏪.

On the Remote Control

1. Press and hold FUNC / • MENU.
2. Press ▲ / ▼ to select [SOUND], [LIGHT], or [OTHER] and press ENTER.
3. Press ▲ / ▼ to select the mode and press ENTER.
4. Press ▲ / ▼ to adjust the level.
5. Press ENTER to confirm the setting.
If you want to return to the previous step, press ⏪.

For [SOUND] setting

You can adjust sound quality by adjusting the level BALANCE (left/right speaker), FADER (front/rear speaker), SW (Subwoofer), SW-F (Subwoofer frequency), A-EQ (Auto EQ).

- When you set the EQ to USER EQ1/2 mode. : You can adjust the level of BAS (bass), MID (middle), TRB (treble).

- SW (Subwoofer)
You can adjust the volume of subwoofer.
- SW-F (Subwoofer frequency)
OFF/ SW 55 Hz/ SW 85 Hz/ SW 120 Hz
You can enable the subwoofer.
- A-EQ (Auto EQ) OFF/ ON
AUTO EQ operates only in the music file supported with genre in the device. When you set AUTO EQ to ON, POP, CLASSIC, ROCK, or JAZZ is automatically selected according to the music genre.

For [LIGHT] setting

[LCS720BO]

You can adjust the light effects by adjusting LED, DIM, or DIM LV.

- LED COL1 / COL2 / AUTO : You can change the LED window color.
- DIM (Dimmer) OFF / ON : You can change the brightness of the display window during the power-on status.

Settings	Description
DIM ON	The display window becomes dark.
DIM OFF	The display window becomes bright.

- DIM LV (Dimmer Level) : When you set DIM to ON, you can adjust the dimmer level. (-2, -1, 0, +1, +2)

[LCF820BO]

You can adjust the light effects by adjusting LED MODE, USER LED, DIM, or DIM LV.

- LED MODE : You can change the LED window color.
LED AUTO/ LED USER / LED 01 to 27
- USER LED
Making the desired LED color by adjusting the each level of RED, GREEN, and BLUE. (USER LED is only available when you set LED MODE to LED USER.)

- DIM (Dimmer) OFF / ON : You can change the brightness of the display window during the power-on status.

Settings	Description
DIM ON	The display window becomes dark.
DIM OFF	The display window becomes bright.

- DIM LV (Dimmer Level) : When you set DIM to ON, you can adjust the dimmer level. (-2, -1, 0, +1, +2)

For [OTHER] setting

- AUX (Auxiliary) ON / OFF
It is possible to use auxiliary equipment with this unit. Activate the auxiliary setting when using auxiliary equipment connected to this unit.
- DEMO OFF / ON
You can change the initial indication on the display to information name (function name, EQ name, etc...) while listening to a source.
- BEEP 2ND / ALL
BEEP 2ND : The beep is generated when a key is pressed for longer than 2 seconds.
BEEP ALL : The beep is generated when any key is pressed.
- CLK (Clock)
For the model RDS is not supported unit or even for a RDS supported unit.
 - When RDS CT information is not received and then you set CT to OFF, you can adjust the time by yourself. Set the clock as follows ;
 1. Select a source to TUNER.
 2. Press the FUNC to select the CT and then set CT to OFF. (Refer to the "Adjusting TUNER settings" on the page 13 for setting the CT (Clock Time) ON / OFF.)
 3. Press and hold • MENU on the unit to select [OTHER] and then select CLK by rotating the volume knob.
 4. Set the hour by rotating the volume knob.
 5. Press the volume knob to confirm the hour.
 6. Set the minute by rotating the volume knob.
 7. Press the volume knob to confirm the minute.
 - When RDS CT information is received; The clock is displayed according to the RDS CT information.
 - When RDS is not supported, set the clock according to 3 to 7 steps.

Listening to a CD

[LCS720BO]



1. Insert a CD.
2. Rotate the volume knob on the unit to adjust the volume.
Or press VOLUME ▲ / ▼ on the remote control.

[LCF820BO]

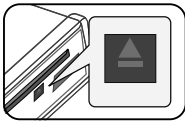
1. Press the  to open the control panel.
2. Insert a CD.
3. Close the control panel.



Note

Make sure to press  after pressing  to eject a disc. Refer to the picture above.

Pausing or restarting CD playback

1. Press >|| on the unit to pause playback.
Or press ►/|| on the remote control.
2. Press it to resume playback.

Searching for a section within a track / file

1. [LCS720BO]
Press and hold |◀◀/▶▶| on the unit for about 1 second during playback. [LCF820BO]
Push and hold |◀◀/▶▶| clockwise or counterclockwise on the unit for about 1 second during playback.
Or press and hold ◀◀ / ▶▶ on remote control.
2. Press >|| on the unit at the point you want.
Or press ►/|| on the remote control.

Skipping to another track/ file

- [LCS720BO]
Press |◀◀/▶▶| on the unit.
[LCF820BO]
Push |◀◀/▶▶| clockwise or counterclockwise on the unit.
Or press ◀◀ / ▶▶ on the remote control.

Or

1. Press the volume knob on the unit.
Or press ENTER on the remote control.
2. Rotate the volume knob on the unit to select a desired ROOT or folder and press it.
Or press ▲ / ▼ and press ENTER on the remote control.
3. Rotate the volume knob on the unit to select a desired track / file and press it.
Or press ▲ / ▼ and press ENTER on the remote control.

Note

- To skip to previous track, press briefly |◀◀ within 3 seconds of playing time (LCS720BO).
- To skip to previous track, push |◀◀ counterclockwise within 3 seconds of playing time (LCF820BO).

Checking information about your music

MP3 / WMA files often come with tags. The tag gives the Title, Artist or Album.

Press DISP repeatedly during MP3 / WMA / CD TEXT file playback. If there is no information, "NO TEXT" will be shown in the display window.

Playing back tracks / files in a way you want

For using applicable buttons

1. Press INT / RPT / SHF.
2. Press it again to cancel.
Or

Using the FUNC button

On the unit

1. Press FUNC.
2. Rotate the volume knob to select an item and press it.
3. Rotate the volume knob to select the option.
4. Press the volume knob to set the option.
If you want to return to the previous step, press .

On the Remote Control

1. Press FUNC / • MENU.
2. Press ▲ / ▼ to select an item and press it.
3. Press ▲ / ▼ to select the option.
4. Press ENTER to set the option.
If you want to return to the previous step, press .

- RPT (Repeat)
The current selected tracks / files (1 RPT) or folder (RPT) on the disc is played repeatedly.
- SHF (Shuffle)
Each files in the current selected folder (SHF) or all of the tracks / files (SHF) on the disc is played randomly. During random playback, even if you press **⏪**, you won't go back to the previous track/ file.
- INT (Intro Scan)
The first 10 seconds of all tracks / files (INT) or each files in the current selected folder (INT) on the disc are played.
- DEV (Device) USB / SD
You can change the recording device. USB <-> SD
- MODE
MODE REC / MODE COPY
MODE REC : The recording speed is normal. And during the recording, you can listen to the music being recorded.
MODE COPY : The recording speed is twice as fast. And during the recording, you can listen to the TUNER. But you cannot listen to the music being recorded.
(DEV and MODE are only available when the disc is activating.)

! Note

MP3 / WMA Disc compatibility with this unit is limited as follows:

1. Sampling Frequency / 8 kHz to 48 kHz (MP3) 22.05 kHz to 48 kHz (WMA).
2. Bit rate / within 8 kbps to 320 kbps (include VBR) (MP3) 32 kbps to 320 kbps (WMA).
3. CD-R / CD-RW file system should be "ISO 9660".
4. If you record MP3 / WMA files using software which cannot create a FILE SYSTEM, for example "Direct-CD" etc., it will not be possible to playback MP3 / WMA files. We recommend that you use "Easy-CD Creator" which creates an ISO 9660 file system.

You have to set the disc format option to [Mastered] in order to make the discs compatible with the LG players when formatting rewritable discs. When setting the option to Live File System, you cannot use it on LG players.

(Mastered / Live File System : Disc format system for Windows Vista)

Customers should also note that permission is required in order to download MP3 / WMA files and music from the Internet. Our company has no right to grant such permission. Permission should always be sought from the copyright owner.

Listening to music from an external device

1. Connect an external device to the AUX jack with line input cable.
2. Select a source to AUX.
3. Play the connected Auxiliary Equipment.

Preventing radical changes in volume as switching sources

Only when you set AUX to ON as switching sources, you can adjust the volume level of each source to prevent radical changes in volume by selecting GAIN 0/ +3/ +6.

1. Press FUNC on the unit.
Or press FUNC / • MENU on the remote control.
2. Rotate the volume knob on the unit.
Or press ▲ / ▼ on the remote control to set the option. (GAIN 0/ +3/ +6)
3. Press the volume knob on the unit.
Or press ENTER on the remote control to confirm the setting.
4. If you want to return to the previous step, press **↶**.
Or press **↶** on the remote control.

Listening to the radio

1. Press SRC repeatedly to select a source to TUNER.
2. Press BAND repeatedly to select a desired band.
3. [LCS720BO]
For manual search, press and hold **⏪ / ⏩** on the unit until "MANUAL" is displayed. Then press it repeatedly to select a desired frequency.
Or press and hold **⏪ / ⏩** on the remote control.
For auto search, press **⏪ / ⏩** on the unit. Then "SEARCH" is displayed. (Except MW)
Or press **⏪ / ⏩** on the remote control.
[LCF820BO]
For manual search, Push and hold **⏪ / ⏩** clockwise or counterclockwise on the unit until "MANUAL" is displayed. Then push it repeatedly to select a desired frequency.
Or press and hold **⏪ / ⏩** on the remote control.
For auto search, Push **⏪ / ⏩** clockwise or counterclockwise on the unit. Then "SEARCH" is displayed. (Except MW)
Or press **⏪ / ⏩** on the remote control.

Storing desired frequencies manually

1. Press BAND to select a desired band you want to store.
2. Select the desired frequency by using **⏪ / ⏩** on the unit.
Or use **⏪ / ⏩** on the remote control.

3. Press the volume knob and rotate the volume knob to select a preset station among 1 to 6 and then press and hold the volume knob until the beep sound is heard.
Or press and hold one of preset buttons among 1 to 6 on the remote control until the beep sound is heard.
4. Repeat steps 1 to 3 to preset other stations.

Note

When a station is stored on the preset numbers on which another station of the same band has already been preset, the previously preset station is automatically erased.

Listening to a preset station

1. Press BAND repeatedly to select a desired band.
2. Press the volume knob on the unit.
Or press ENTER on the remote control.
3. Rotate the volume knob to select a preset station.
Or press ▲ / ▼ on the remote control.
4. Press the volume knob.
Or press ENTER on the remote control.
Or

Press BAND and then press the desired preset button among 1 to 6 on the remote control.

Adjusting TUNER settings

On the unit

1. Press FUNC.
2. Rotate the volume knob to select an item and press it.
3. Rotate the volume knob to set the option and press it.
4. If you want to return to the previous step, press ↩.

On the Remote Control

1. Press FUNC / • MENU.
2. Press ▲ / ▼ to select an item and press ENTER.
3. Press ▲ / ▼ to set the option and press ENTER.
4. If you want to return to the previous step, press ↩.

- PTY (Program type, RDS (OPTIONAL))
It searches the radio stations by program type of FM tuner. The program types are displayed as follows.

NEWS	FINANCE	EASY M
AFFAIRS	CHILDREN	LIGHT M
INFO	SOCIAL	CLASSICS
SPORT	RELIGION	OTHER M
EDUCATE	PHONE IN	JAZZ
DRAMA	TRAVEL	COUNTRY
CULTURE	LEISURE	NATION M
SCIENCE	DOCUMENT	OLDIES
VARIED	POP M	FOLK M
WEATHER	ROCK M	

- A / S (Auto Store)
The six strongest broadcasting frequencies will be stored under preset button 1 to 6 in the order of their signal strength. To cancel, press the volume knob.
- P / S (Preset scan)
Each preset station appears. To cancel, press the volume knob.
- SENS (Tuner sensitivity) MID / HI / LOW
In an area in which signal reception is weak, it helps the tuner to search more stations. The weaker the reception is, the lower option you should set to.

RDS (OPTIONAL)

- AF (Alternative Frequency) ON / OFF
When the reception quality drops, the tuner automatically changes to another station in the network, broadcasting a better reception quality, using the PI and AF codes.
- REG (Region) ON / OFF
REG ON : The unit switches to another station, within the same network, broadcasting the same program when the receiving signals from the current station become weak.
REG OFF : The unit switches to another station, within the same network when the receiving signals from the current station become weak. (In this mode, the program may differ from the one currently received.)

- TA (Traffic Announcement) ALARM / SEEK
TA ALARM : When the tuned station has no TP information for 5 seconds, a double beep sound is output.
TA SEEK : When the tuned station does not receive TP information for 5 seconds, the receiver retunes to the next station that has the TP information.
- PI (Programme Identification) SOUND / MUTE
PI SOUND : When the frequency of a tuned station switches to an AF (Alternative frequency) with an unidentified PI, it keeps the sound.
PI MUTE : When the frequency of a tuned station switches to an AF with an unidentified PI, it mutes the sound until the PI is identified.
- CT (Clock Time) ON / OFF
You can use the RDS CT information to update the time. When RDS CT information is not received and then you set CT to OFF, you can adjust the time by yourself. Refer to the page 10 for setting the clock.

Using an USB device/ SD card

[USB]

1. Open the USB cover.
2. Connect the USB device.
3. Press SRC repeatedly to select a source to USB.

[SD]

1. Detach the control panel. (Refer to "About detachable control panel" on page 7.)
2. Insert the SD card.
3. Attach the control panel.
4. Press SRC repeatedly to select a source to SD.

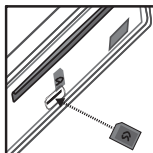

[LCS720BO]

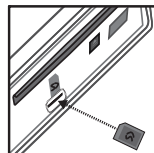

[LCF820BO]

Moving to another drive

When connecting this unit to multi reader, press BAND on the unit (or DRV on remote control) to go the next drive. Each time you press the button, the driver modes change.

Quick search of a desired file

1. Press the volume knob on the unit.
Or press ENTER on the remote control.
2. Rotate the volume knob on the unit to select a desired ROOT or folder and press it.
Or press ▲ / ▼ and press ENTER on the remote control.
3. Rotate the volume knob on the unit to select a desired file and press it.
Or press ▲ / ▼ and press ENTER on the remote control.

Deleting the desired file

You can select and delete a playable file you want.

1. Select the desired file in the same way as "Quick Search of a desired file"
2. Press DEL and then "DELETE?" displayed. Press it again to delete.

When the delete operation is started, playing is stopped. When the delete operation is ended, the list of files is displayed. If you do not select a file within few seconds, or press the , the first file is played.



Note

Other functions are same with "Listening to a CD". Refer to page 11.

Playable USB device/ SD card Requirement

- Do not extract the USB device/ SD card during operation (play, etc.).
- An USB device/ SD card which requires additional programme installation when you have connected it to a computer, is not supported.
- Regular back up is recommended to prevent data loss.
- If you use a USB extension cable, USB HUB, USB Multi-reader, or external HDD, the USB device may not be recognized.
- When you connect a partitioned USB device into the unit, only the first partition is recognized on it.
- Some USB device/ SD card may not work with this unit.
- Digital camera and mobile phone are not supported.
- USB Port of the unit cannot be connected to PC. The unit cannot be used as a storage device.
- Using FAT (16 / 32) file system is supported.
Using NTFS file system is supported to read only.

Recording to USB device / SD card

[USB]

1. Open the USB cover and connect it to the unit.
2. Select one of the following lists. (CD, FM tuner, Bluetooth Handsfree)
3. Press REC to start recording.
For one track/ file recording, press it once.
For all tracks or files in the current selected folder recording, press and hold it until the beep sound is heard.
4. Press it again to stop.

[SD]

1. Detach the control panel and connect it to the unit. Then attach the control panel.
(Refer to "About detachable control panel" on page 7.)
2. Select CD only.
3. Press REC to start recording.
For one track/ file recording, press it once.
For all tracks or files in the current selected folder recording, press and hold it until the beep sound is heard.
4. Press it again to stop.

Note

- [USB] Only in CD, FM tuner, and Bluetooth Handsfree, recording is available.
- [SD] Only in CD, recording is available.
- Do not remove the USB device / SD card during recording, or an incomplete file may be made and not deleted on PC.
- When USB device/ SD card memory is full, "MEMORY FULL" displays and stops recording.
- While FM tuner recording, the broadcastings are recorded as a file every 20 minutes.
- You can adjust the recording speed. (Refer to the page 12.)
- When you record all tracks on the audio CD, "REC" appears. When you record all MP3/WMA files in the folder, "REC ■" appears.

The making of unauthorized copies of copy-protected material, including computer programs, files, broadcasts and sound recordings, may be an infringement of copyrights and constitute a criminal offense. This equipment should not be used for such purposes.

Be responsible
Respect copyrights

Listening to music by connecting iPod/iPhone

You can enjoy iPod / iPhone-stored music on the unit by connecting it to the USB connector using the appropriate cable.

1. Open the USB cover.
2. Connect the iPod / iPhone.
3. Press SRC to select a source to USB.

Pausing or restarting playback

1. Press >|| on the unit to pause playback.
Or press ▶/|| on the remote control.
2. Press it to resume playback.

Searching for a section within a file

[LCS720BO]
During playback, press and hold |<</>>| and then release at a point you want.

[LCF820BO]
During playback, push and hold |<</>>| clockwise or counterclockwise on the unit and then release at a point you want.

Skipping to another file

[LCS720BO]
Press |<</>>| on the unit.

[LCF820BO]
Push |<</>>| clockwise or counterclockwise on the unit.

Or press <</>> on the remote control.

Or

1. Press the volume knob on the unit.
Or press ENTER on the remote control.
2. Rotate the volume knob on the unit to select a desired category and press it.
Or press ▲/▼ and press ENTER on the remote control.
3. Rotate the volume knob on the unit to select a desired file and press it.
Or press ▲/▼ and press ENTER on the remote control.

Checking information about your music

MP3 / WMA files often come with tags. The tag gives the Title, Artist or Album.

Press DISP repeatedly during MP3 / WMA file playback. If there is no information, "NO TEXT" will be shown in the display window.

Playing back files in a way you want**On the Unit**

1. Press FUNC.
2. Rotate the volume knob to select an item and press it.
3. Rotate the volume knob to select the option.
4. Press the volume knob to set the option.
If you want to return to the previous step, press ↶.

On the Remote Control

1. Press RPT / SHF.
2. Press it again to cancel.
Or
1. Press FUNC / • MENU.
2. Press ▲ / ▼ to select an item and press ENTER.
3. Press ▲ / ▼ to select the option.
4. Press ENTER to set the option.
If you want to return to the previous step, press ↶.



- RPT (Repeat)
The current selected file (1 RPT) or files on the iPod / iPhone is played repeatedly.
- SHF (Shuffle)
All of the files (SHF) on the iPod / iPhone are played randomly.
- SPD (BOOK SPEED)
You can adjust the audiobook speed of iPod / iPhone to NOR (Normal), SLOW or FAST.

Playing back files by music menus

You can check files by music menus and play it back.

The music menus are as follows.

PLAYLISTS → ARTISTS → ALBUMS →
GENRES → SONGS → COMPOSER →
AUDIO BOOK → PODCAST → ...

1. Press the volume knob on the unit.
Or press ENTER on the remote control.
2. Rotate the volume knob on the unit to select a music menu and press it.
Or press ▲ / ▼ on the remote control.
3. Rotate the volume knob on the unit to select a file.
Or press ▲ / ▼ on the remote control.
4. Press the volume knob on the unit to confirm the setting.
Or press ENTER on the remote control.
5. If you want to return to the previous step, press 
Or press  on the remote control.

iPod / iPhone CONTROL MODE

You can control on the unit and iPod / iPhone.

- Press iPOD on the unit. Then playback is paused. And you can control on the unit and iPod / iPhone.
- While using the iPod/iPhone CONTROL MODE, any functions are not available on the unit.
- Press iPOD again to cancel the iPod / iPhone CONTROL MODE.

Compatible iPod / iPhone models

- iPod classic
- iPod nano 6th generation
- iPod touch 4th generation
- iPhone 3G / 3GS / 4

We recommend that you use the OS Version 4.2.1 or more.



"Made for iPod" and "Made for iPhone" mean that an electronic accessory has been designed to connect specifically to iPod or iPhone respectively, and has been certified by the developer to meet Apple performance standards. Apple is not responsible for the operation of this device or its compliance with safety and regulatory standards. Please note that the use of this accessory with iPod, iPhone may affect wireless performance.

Connecting a Bluetooth wireless technology

Before you start the pairing procedure, make sure the Bluetooth wireless technology is turned on in your phone. Refer to your phone's user guide. Pairing links your unit and phone with Bluetooth wireless technology, and is required only once for the initial setup. If the connection is successful, the phone is registered (Device 1 to 10). The process of pairing may be different depend on the phones. The PIN CODE is 1234.

	ON PLAYER
1. Enter the menu.	BT
2. Find the "CONNECT" menu.	Rotate the volume knob
3. Enter the "CONNECT" menu.	Press the volume knob
4. Select the "SEARCH" menu.	Rotate the volume knob
5. Search the phones supported Bluetooth wireless technology.	Press the volume knob
6. Select a phone you want to connect.	Rotate the volume knob
7. Connect the phone.	Press the volume knob

Microphone

The microphone needs to be close to and pointed toward the person speaking. Install the microphone as shown below.

Microphone unit

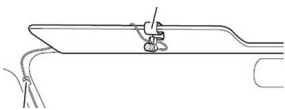

Note

If you power off the unit while talking on the phone through the unit by using the BT function, the function is deactivated and you can talk on the phone directly.

Using the buttons for Bluetooth wireless technology

[LCS720BO]

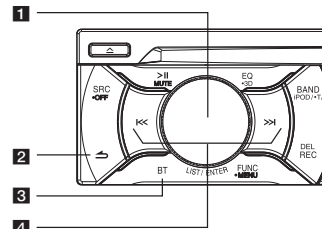

[LCF820BO]

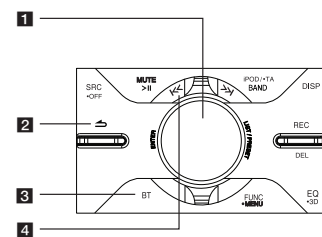

1 LIST / ENTER / PRESET (Volume knob)

- Press the volume knob : Go to the next contents of the setting.
- Rotate the volume knob : Move the contents vertically on the setting or choose a spell when you write the words on the unit.

2

- Returns to the previous step.
- Ends a call.

3 BT

- Press it to enter BT function.
- Answers a call.

4 I<< / >>I

Adjusts the mic volume while talking on the phone by BT function.

I<<

Deletes a spell or go back previous contents while writing some words on the unit.

>>I

Moves next space on display while writing some words on the unit.

Using a Bluetooth wireless technology

Disconnecting a phone

Press BT -> CONNECT -> LIST -> Connected device name -> DISCONN

Answering and Ending a call

To answer a call, press BT.

To end a call, press

Rejecting a call

To reject a call, press

Making a call saved as a preset number

Press BT and a preset number (1 to 6).

Checking missed calls

When the "✳?" appears, go to the menu (Press BT-> CALL -> LASTCALL). You can check the list of missed call.

Audio transfer

It is possible to switch the audio connection between your phone equipped with Bluetooth wireless technology and this unit.

1. Press BT to answer the call.
2. Press BT again. The "PRIVATE" is displayed.

If the private mode is selected on the unit, press BT to return to the call to handsfree mode.

! Note

- The lists of LASTCALL are sorted from newest to oldest entries.
- [LCS720BO]
When you want to make an international call, press **>>I** to add "+" and to delete it press again. [LCF820BO]
When you want to make an international call, push **>>I** clockwise to add "+" and to delete it push again.
- "+" can only be added when the detail list of LASTCALL is selected.
- You can record the Bluetooth Handsfree to USB. (Refer to the page 14.)
- The call waiting function is not supported. We do not guarantee any errors due to use of the call waiting function.

3

Operating

Listening to music of the Bluetooth device

When your unit and the Bluetooth device are pairing, Press SRC repeatedly to select "BT". And play the music stored on your Bluetooth device. Refer to the your Bluetooth device's user guide.

Bluetooth wireless technology profiles information

In order to use Bluetooth wireless technology, devices must be able to interpret certain profiles. This unit is compatible with following profiles.

GAP (Generic Access Profile)

HFP (Hands Free Profile)

GAVDP (Generic Audio / Video Distribution Profile)

A2DP (Advanced Audio Distribution Profile)

AVRCP (Audio / Video Distribution Remote Control Profile)

PBA / PBAP (Phone Book Access Profile)

Adjusting the setting

1. Press BT.
2. Rotate the volume knob to select an item and press it.
3. Rotate the volume knob to set the option and press it.
4. If you want to return to the previous step, press **↶**.

CALL

• LASTCALL

Phone number list (Received, Dialed, Missed). CALL -> LASTCALL -> Select the phone number -> Press the volume knob -> Display the information -> Press the volume knob -> DIAL, SAVE, DELETE menu will be displayed.

- To call the phone number, DIAL -> Press the volume knob.

- To save the phone number, SAVE -> Press the volume knob -> select the preset number (1 to 6) -> Press the volume knob.

- To delete the selected phone number, DELETE -> Press the volume knob -> NAME -> Press the volume knob.

- To delete all phone number, DELETE -> Press the volume knob -> ALL -> Press the volume knob.

• DIAL

Enters the number directly on the unit. To select the 0 to 9 rotate the volume. Press **>>I** to make the phone number. To call it, Press the volume knob.

• PRESET

Checks and deletes/dials the phone number saved preset number. CALL -> PRESET -> Select the preset number and press the volume knob -> Display the information -> Press the volume knob -> DIAL, DELETE menu will be displayed.

- To call the phone number, select DIAL and Press the volume knob.

- To delete the selected phone number, DELETE -> NAME -> Press the volume knob.

- To delete all phone number, DELETE -> ALL -> Press the volume knob.

P-BOOK

- **LIST**
Checks the list of the phone numbers saved by phonebook.
- **SEARCH**
Searches the phone number in the list.
- **GET**
Getting the phonebook from the phone automatically. This menu is only available on phones with PBA / PBAP (Phone Book Access Profile).

CONNECT

- **LIST**
Checks the list of the Connected Device Name.
- **SEARCH**
When unit is not connected with Bluetooth wireless technology, you can search the phones available to connect. When unit is connected with Bluetooth wireless technology, you can disconnect the phone.

SETUP

- **VISIBLE**
Makes it impossible to search this unit. (SHOWN <-> HIDDEN)
- **AUTO CON**
Adjusts connection with automatically or not. (ON <-> OFF)
- **AUTO ANS**
Adjusts answering automatically or not. (MANUAL <-> AUTO)
- **MIC VOL**
Adjusts microphone volume on the phone from 1 to 5. While you are on the phone with Bluetooth wireless technology, use **||<</>>|** to adjust the MIC volume.
- **REDIAL**
Adjusts the counts of redial. (1 TIME <-> 2 TIMES)

INFO

- **NAME**
Changes the name of this unit.
- **ADDRESS**
Checks the address.
- **PIN-CODE**
Changes the PIN code. Default is 1234.

Using "LG CAR Remote" application

You can control the unit by using the "LG CAR Remote" application.

1. Search the "LG CAR Remote" application and install it.



[Displays installed "LG CAR Remote" application]

2. Pairing links your unit and iPhone with Bluetooth wireless technology. (Refer to the page 16.)
3. When you run the "LG CAR Remote" application, activating source is displayed after initial screen.



[Initial screen]

[Tuner screen]

You can select a source by pressing "SOURCE".

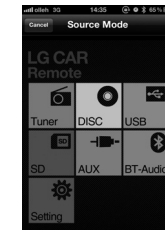

[Source Mode screen]

Phone compatibility list

Bluetooth list and manufacturing company applicable.
 H : Handsfree A : Audio Streaming P : Phonebook Sync

Company	List	H	A	P	Company	List	H	A	P	Company	List	H	A	P	Company	List	H	A	P		
Nokia	E61	0			Motorola	ROKR E6	0			SAMSUNG	S8003 JET(8GB)	0	0	0	SONY	G705	0	0	0		
	5200	0	0			Z8	0	0			S8300 Ultra Touch	0	0	0		ERICSSON	W595	0	0	0	
	N80	0				XT701	0	0	0		B5722	0					W705	0	0	0	
	N72	0				XT720	0	0	0		B7330 (Omnia Pro)	0	0	0			W980i	0	0	0	
	N91	0	0			(MOTOROI)					C3303K (Champ)	0		0			Xperia-X1	0	0	0	
	3250	0				Milestone	0	0			M5650U (Lindy)	0					Vizaz	0	0	0	
	6110	0	0			Droid					M8910 (Pixon12)	0	0	0			Xperia-X2	0	0	0	
	6288	0	0			SAMSUNG	D900	0	0			S7350	0	0			0	Xperia-X10	0	0	
	E90	0	0				SGH-U600	0	0		0	S8500 (Wave)	0	0			0				
	N73	0	0				SGH-Z240	0				i5503 (Galaxy S)	0	0			0	LG	KE850	0	
	N95	0	0		SGH-F300		0			i5700 (Galaxy Spica)	0	0	0	KU250	0						
	N77	0	0		SGH-E890		0			i7500 (Galaxy)	0			KS10	0						
	E71	0	0		SGH-E950		0	0	0	i9000 (Galaxy S(16G))	0	0	0	KC550	0	0					
	E75	0	0	0	SGH-F210		0			T959	0		0	KC780	0	0					
	N86	0	0	0	SGH-G600		0	0		Galaxy Tab	0	0	0	KC910(Renoir)	0	0	0				
	N97	0	0	0	i-900		0	0		W880	0		0	KF350(IceCream)	0	0					
	5800 (Xpress music)	0	0	0	F330		0	0		Z610	0	0	0	KF700	0						
	C6	0	0	0	G400	0	0		W300	0			KF750(Secret)	0	0						
	E5	0	0	0	L770	0	0		W800i	0	0	0	KM380	0	0	0					
	E52	0	0	0	L878	0	0	0	W910i	0	0	0	KM900(Arena)	0	0	0					
N97-1	0	0	0	U908	0	0		C702i	0	0	0	KP500(Cookie)	0	0	0						
N900	0	0		M8800 PIXON	0	0						KS500	0	0							
6710 (Navigator)	0	0	0	M7500 (Emporio Armani)	0	0	0					KT520	0	0							

Bluetooth list and manufacturing company applicable.
 H : Handsfree A : Audio Streaming P : Phonebook Sync

Company	List	H	A	P	Company	List	H	A	P		
LG	KT610	0			APPLE	iPhone	0		0		
	KU990	0	0			iPhone 3GS (16GB)	0	0	0		
	GD900	0	0	0		iPhone 3GS (32GB)	0	0	0		
	BL40 (New Chocolate)	0		0		iPhone 4 (16GB)	0	0	0		
	KM335	0	0			i-Pad		0			
	GD510 (POP)	0	0	0		ASUS	P750	0	0		
	GD880	0	0	0			HTC	Goole G1	0	0	
	GM730	0	0	0				Hero G3	0		
	GS500 (Cookie Plus)	0	0	0		Touch2		0	0	0	
	GT505	0	0	0		Legend		0	0	0	
	GT540	0	0	0		Nexus One	0	0	0		
	GW305	0	0			Rim	Desire	0	0	0	
	GX500	0	0	0							
Rim	Bold 9700	0	0	0							
	Storm2 9550	0	0	0							



"The Bluetooth word mark and logos are owned by the Bluetooth SIG, Inc. and any use of such marks by LG Electronics is under license. Other trademarks and trade names are those of their respective owners."

Bluetooth® wireless technology is a system which allows radio contact between electronic devices within a max range of 10 meters.

Connecting individual devices under Bluetooth® wireless technology does not incur any charges. A mobile phone with Bluetooth® wireless technology can be operated via the Cascade if the connection was made via Bluetooth® wireless technology.

Operating condition for using a Bluetooth wireless technology function

- Close windscreen.
- Turn off the air conditioner / heater.
- Stop the vehicle or drive at low speed.
- Make the call in a quiet location.
 - There may be differences in call quality depending on phone type, road conditions weather, etc.
 - Using the phone while driving may cause unexpected accidents.
 - The Bluetooth wireless technology function may not operate properly with certain types of phones equipped with Bluetooth wireless technology.

! Note

- When the phone features <Bluetooth Power Save> function, you should make the function turned on to maintain connection.
- When you switch the call mode from handsfree to phone, the connection may be disconnected.
- Some phones don't support Reject function.
- Low battery in phone may cause the problems.

Troubleshooting

Symptoms	Cause	Solution
Power doesn't turn on. The unit doesn't operate.	Leads and connectors are not properly.	Confirm once more that all connections are correct.
	The fuse is blown.	Rectify the problem that caused the fuse to blow, and then replace it. Be very sure to install the correct fuse with the same rate.
	Noise and other factors are causing the built in microprocessor to operate incorrectly.	Turn the unit off and then on again.
No sound is heard.	Cables are not connected correctly.	Connect the cables correctly.
There's audio skipping.	This unit is not firmly secured.	Secure this unit firmly.
The playback is not possible.	The disc is dirty.	Clean the disc.
	The disc of unplayable type is loaded.	Check what type the disc.
Radio stations cannot be tuned in.	The signal strength of the stations is too weak. (When tuning in with automatic tuning.)	Tuned in the stations manually.
	No station has been preset or preset stations have been cleared. (When tuning by scanning preset stations.)	Preset the stations.
iPod/ iPhone does not work.	Check whether iPod / iPhone is connected to the unit correctly.	Connect it to the unit correctly.
The unit does not operate correctly even when the appropriate remote control buttons are pressed.	Battery power is low.	Load a new battery.

Specifications

General

Output Power : 53 W x 4 CH (Max.)

Power Source : DC 12 V

Speaker impedance : 4 Ω

Ground System : Negative

Dimensions (W x H x D) : (178 x 50 x 168)
mm (without Control Panel)

Net Weight : 1.32 kg

TUNER

FM Tuning Range :

87.5 MHz to 108.0 MHz

S / N Ratio : 55 dB

Distortion : 0.7 %

Usable Sensitivity : 12 dB μ V

AM (MW) Tuning Range :

(520 to 1720) kHz or (522 to 1620) kHz

S / N Ratio : 50 dB

Distortion : 1.0 %

Usable Sensitivity : 28 dB μ V

CD

Frequency Response : 20 Hz to 20 kHz

S / N Ratio : 80 dB

Distortion : 0.12 %

Channel Separation (1 kHz) : 55 dB

AUX

Frequency Response : 20 Hz to 20 kHz

S / N Ratio : 80 dB

Distortion : 0.1 %

Channel Separation (1 kHz) : 45 dB

Max Input Level (1 kHz) : 1.1 V

USB

Version : USB 1.1 or USB 2.0 Full Speed

Bus Power Supply (USB) :

DC 5 V $\overline{\text{---}}$ 1.5 A

SD

Distortion : 0.1 %

Bluetooth

TX POWER 4 dBm

Version Bluetooth Specification 2.1 + EDR

Line OUT

Frequency Response : 20 Hz to 20 kHz

Output Voltage : 2 V (Max.)

Subwoofer

Frequency Response : 20 Hz to 120 Hz

Output Voltage : 2 V (Max.)

- Design and specifications are subject to change without notice.

