



# OWNER'S MANUAL

# VACUUM CLEANER

Please read carefully and thoroughly the operating instructions and safety precautions before installing and operating your vacuum cleaner.

V-C94\*\*\*\*



# IMPORTANT SAFETY INSTRUCTIONS

Read and follow all instructions before using your vacuum cleaner to prevent the risk of fire, electric shock, personal injury, or damage when using the vacuum cleaner. This guide does not cover all possible conditions that may occur. Always contact your service agent or manufacturer about problems that you do not understand. This appliance complies with the following EC Directives :-2006/95/EC Low Voltage Directive 2004/108/EC EMC Directive



This is the safety alert symbol.

This symbol alerts you to potential hazards that can kill or hurt you and others.

All safety messages will follow the safety alert symbol and either the word "WARNING" or "CAUTION." These words mean:



## WARNING

This symbol will alert you to hazards or unsafe practices which could cause serious bodily harm or death.



## CAUTION

This symbol will alert you to hazards or unsafe practices which could cause bodily injury or property damage.



## WARNING

- **Do not plug in if control knob is not in OFF position.**  
Personal injury or product damage could result.
- **Keep children away and beware of obstructions when rewinding the cord to prevent personal injury**  
The cord moves rapidly when rewinding.
- **Disconnect electrical supply before servicing or cleaning the unit or when cleaner is not in use.**  
Failure to do so could result in electrical shock or personal injury.
- **Do not use vacuum cleaner to pick up anything that is burning or smoking such as cigarettes, or hot ashes.**  
Doing so could result in death, fire or electrical shock.
- **Do not vacuum flammable or explosive substances such as gasoline, benzene, thinners, propane (liquids or gases).**  
The fumes from these substances can create a fire hazard or explosion. Doing so could result in death or personal injury.
- **Do not handle plug or vacuum cleaner with wet hands.**  
Doing so could result in death or electrical shock.
- **Do not unplug by pulling on cord.**  
Doing so could result in product damage or electrical shock. To unplug, grasp the plug, not the cord.
- **Keep hair, loose clothing, fingers, and all parts of the body away from openings and moving parts.**  
Failure to do so could result in electrical shock or personal injury.
- **Do not pull or carry by cord, use cord as a handle, close a door on cord, or pull cord around sharp edges or corners. Do not run vacuum cleaner over cord. Keep cord away from heated surfaces.**  
Failure to do so could result in electrical shock or personal injury or fire or product damage.
- **The hose contains electrical wires. Do not use it if it is damaged, cut or punctured.**  
Failure to do so could result in death, or electrical shock.
- **Do not allow to be used as toy. Close attention is necessary when used by or near children.**  
Personal injury or product damage could result.
- **Do not use the vacuum cleaner if the power cord or plug is damaged or faulty.**  
Personal injury or product damage could result. In these cases, contact LG Electronics Service Agent to avoid hazard.
- **Do not use vacuum cleaner if it has been under water.**  
Personal injury or product damage could result. In these cases, contact LG Electronics Service Agent to avoid hazard.
- **Do not continue to vacuum if any parts appear missing or damaged.**  
Personal injury or product damage could result. In these cases, contact LG Electronics Service Agent to avoid hazard.
- **Do not use an extension cord with this vacuum cleaner**  
Fire hazard or product damage could result.
- **Using proper voltage.**  
Using improper voltage may result in damage to the motor and possible injury to the user. Proper voltage is listed on the bottom of vacuum cleaner.
- **Turn off all controls before unplugging.**  
Failure to do so could result in electrical shock or personal injury.
- **Do not change the plug in any way.**  
Failure to do so could result in electrical shock or personal injury or product damage. Doing so result in death. If plug does not fit, contact a qualified electrician to install the proper outlet.
- **Repairs to electrical appliances may only be performed by qualified service engineers.**  
Improper repairs may lead to serious hazards for the user.

# IMPORTANT SAFETY INSTRUCTIONS



## CAUTION

- **Do not put any objects into openings.**  
Failure to do so could result in product damage.
- **Do not use with any opening blocked: keep free of dust, lint, hair, and anything that may reduce air flow.**  
Failure to do so could result in product damage.
- **Do not use vacuum cleaner without dust tank and/or filters in place.**  
Failure to do so could result in product damage.
- **Always clean the dust bin after vacuuming carpet cleaners or fresheners, powders and fine dust.**  
These products clog the filters, reduce airflow and can cause damage to the cleaner. Failure to clean the dust bin could cause permanent damage to the cleaner.
- **Do not use vacuum cleaner to pick up sharp hard objects, small toys, pins, paper clips, etc.**  
They may damage the cleaner or dust bin.
- **Store the vacuum cleaner indoors.**  
Put the vacuum cleaner away after use to prevent tripping over it.
- **The vacuum cleaner is not intended to be used by young children or infirm people without supervision.**  
Failure to do so could result in personal injury or product damage.
- **Only use parts produced or recommended by LG Electronics Service Agents.**  
Failure to do so could result in product damage.
- **Use only as described in this manual. Use only with LG recommended or approved attachments and accessories.**  
Failure to do so could result in personal injury or product damage.
- **To avoid personal injury and to prevent the machine from falling when cleaning stairs, always place it at the bottom of stairs.**  
Failure to do so could result in personal injury or product damage.
- **Use accessory nozzles in sofa mode.**  
Failure to do so could result in product damage.
- **Don't grasp the tank handle when you are moving the vacuum cleaner.**  
The vacuum cleaner's body may fall when separating tank and body. Personal injury or product damage could result. **You should grasp the carrier handle** when you are moving the vacuum cleaner.
- **If after emptying the dust tank the indicator light is on (red), clean the dust tank.**  
Failure to do so could result in product damage.
- **Make sure the filters (exhaust filter and motor safety filter) are completely dry before replacing in the machine.**  
Failure to do so could result in product damage.
- **Do not dry the filter in an oven or microwave.**  
Failure to do so could result in fire hazard.
- **Do not dry the filter in a clothes dryer.**  
Failure to do so could result in fire hazard.
- **Do not dry near an open flame.**  
Failure to do so could result in fire hazard.
- **Do not suck in the cement powder.**
- **If the power cord is damaged, it must be replaced by an approved LG Electronics Service Agent to avoid a hazard**
- **This appliance is not intended for use by persons (including children) with reduced physical, sensory or mental capabilities, or lack of experience and knowledge, unless they have been given supervision or instruction concerning use of the appliance by a person responsible for their safety.**  
Children should be supervised to ensure that they do not play with the appliance

### Thermal protector :

This vacuum cleaner has a special thermostat that protects the vacuum cleaner in case of motor overheating.

If the vacuum cleaner suddenly shuts off, turn off the switch and unplug the vacuum cleaner.

Check the vacuum cleaner for possible source of overheating such as a full dust tank, a blocked hose or clogged filter.

If these conditions are found, fix them and wait at least 30 minutes before attempting to use the vacuum cleaner.

After the 30 minute period, plug the vacuum cleaner back in and turn on the switch.

If the vacuum cleaner still does not run, contact a qualified electrician.

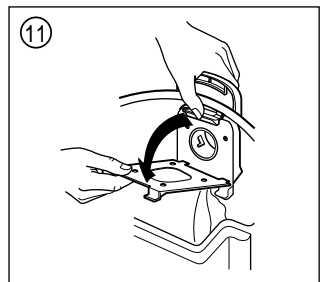
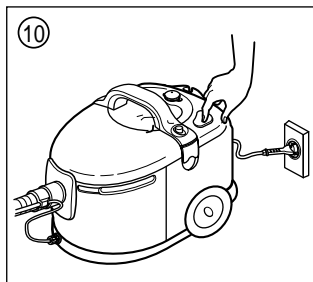
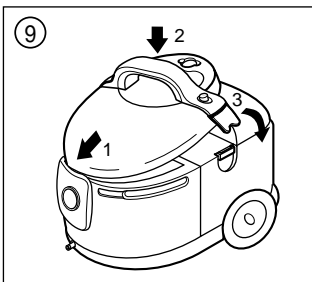
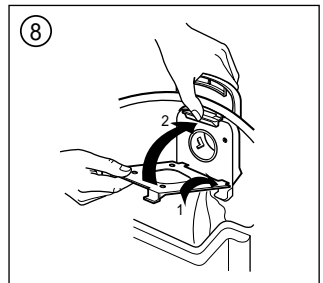
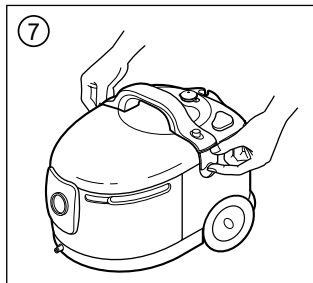
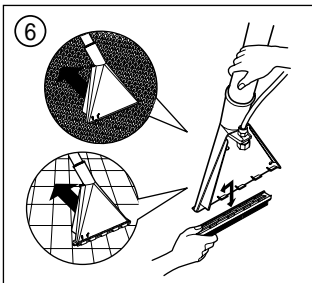
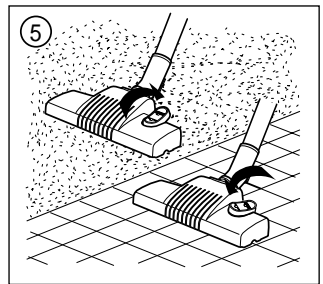
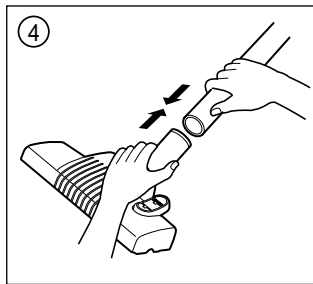
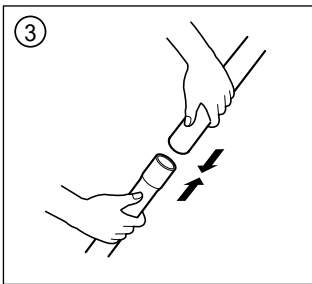
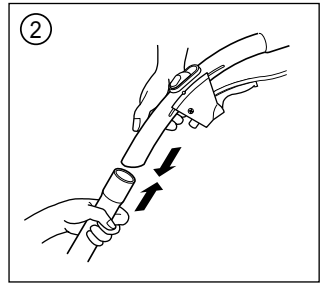
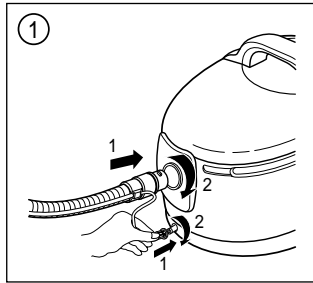
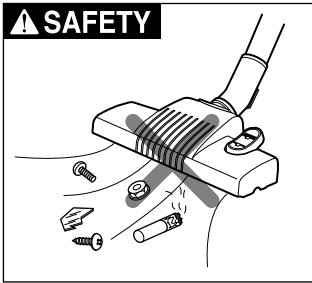
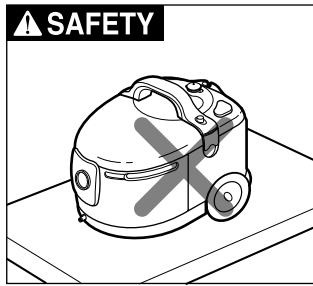

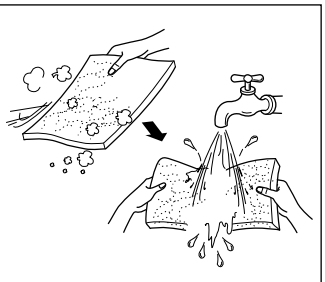
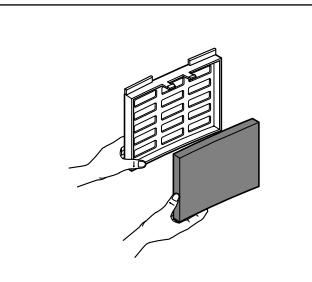
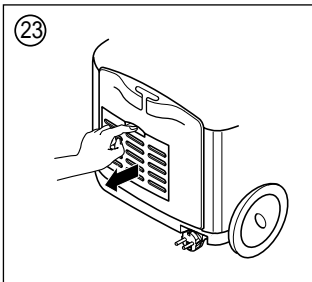
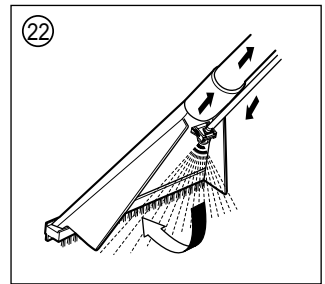
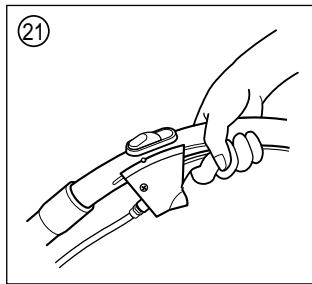
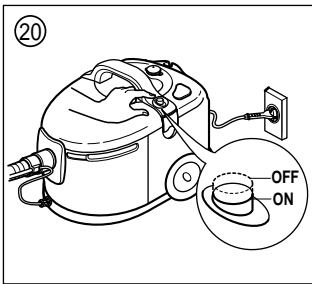
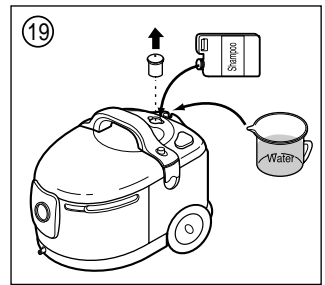
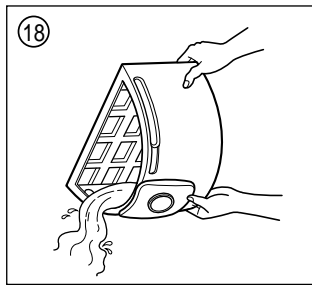
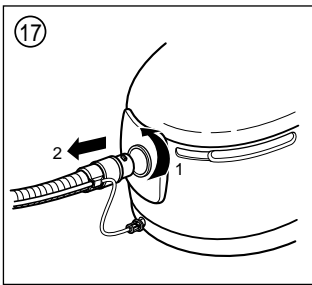
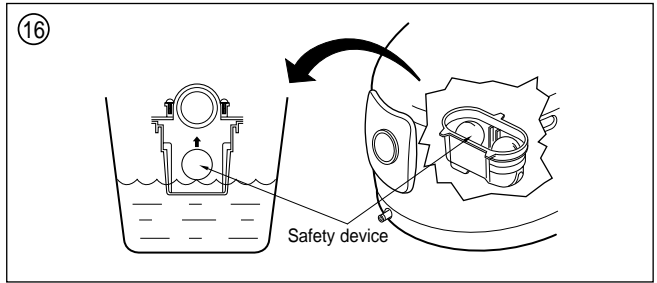
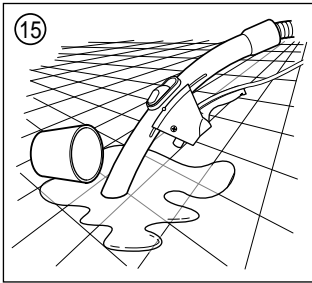
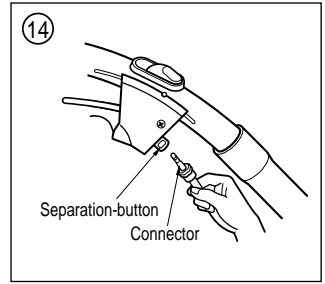
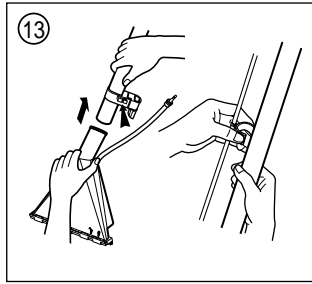
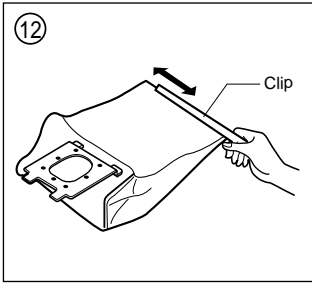

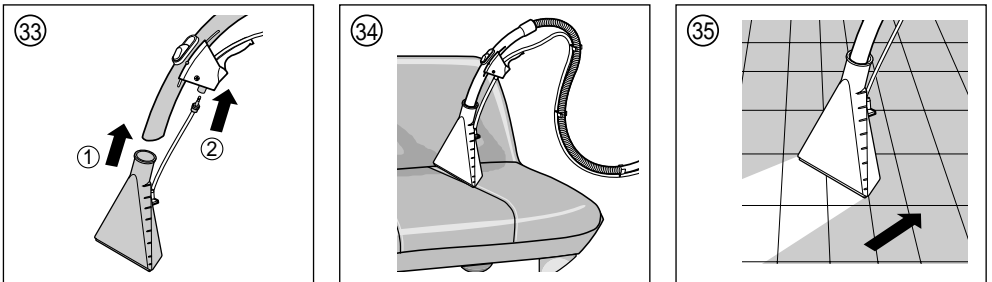
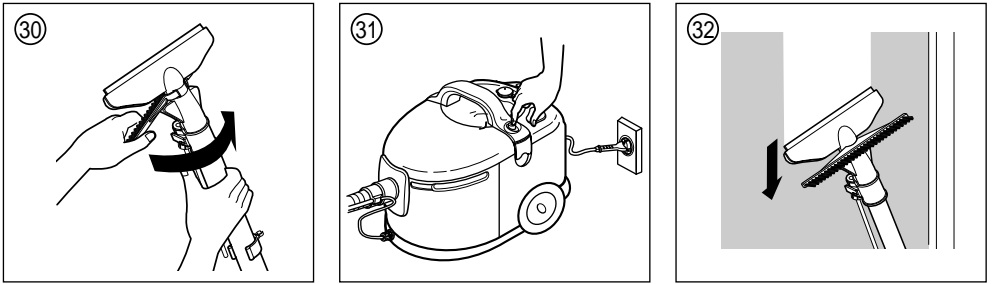
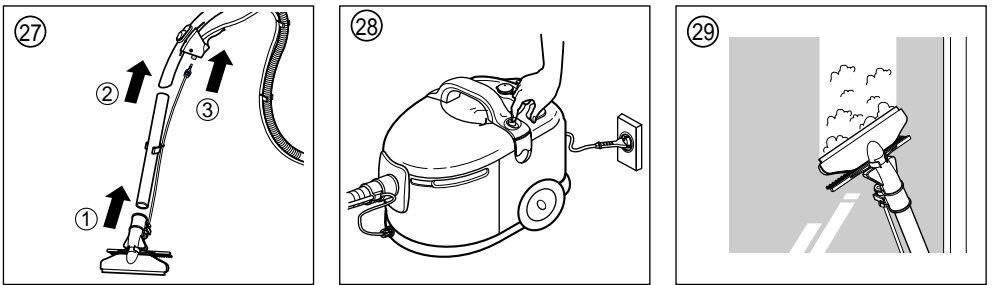
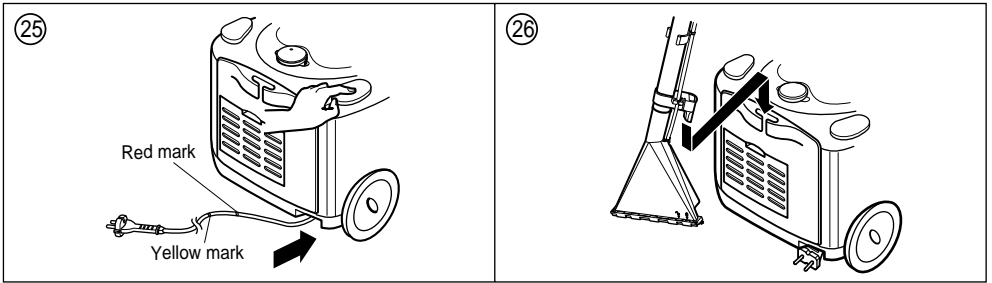
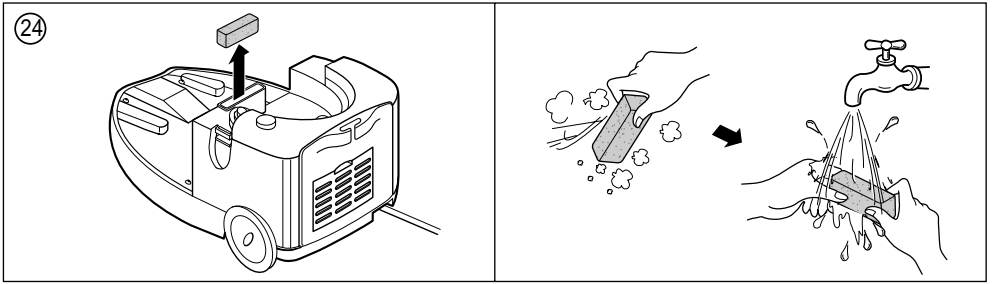

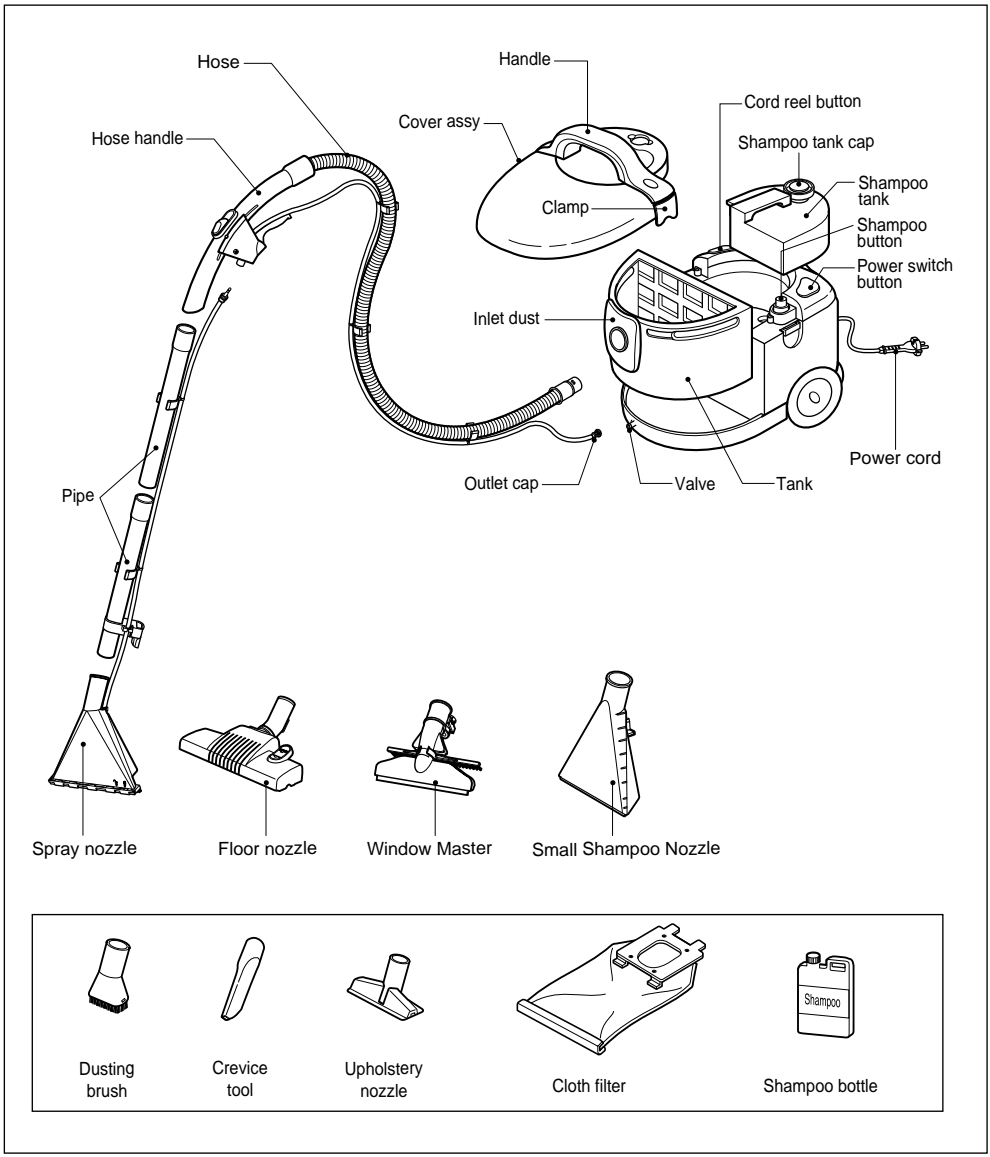

## OPERATING INSTRUCTION

### Preparation Before Using

- Connect the hose with the tank: Insert the end of the hose into the opening of the tank, and turn it right.(Fig. 1)
- Connect the outlet cap with the valve: Connect the outlet cap with the valve, and turn it right.(Fig. 1)
- Connect the pipe with the hose handle: There are two pipes. Connect the pipe which dose not have the pipe holder.(Fig. 2)
- Connect the other pipe.(Fig. 3)
- Connect the nozzle with the pipe: Connect the nozzle which you want to use with the pipe. (Fig. 4)

### NOZZLE

- Floor nozzle: Use it to clean the dry dust.  
You can use it to clean a carpet(without brush) and a tile(with brush).(Fig. 5)
- Spray nozzle: Use it to suck water or to do a shampoo cleaning.  
You can use it to clean a carpet(without brush) and a tile(with brush).(Fig. 6)

### ACCESSORY

You can use all of accessories with a pipe or directly with a hose handle.

- Upholstery nozzle: Use it to clean upholstery such as furniture, curtain, etc..
- Crevice tool: Use it to clean a crevice such as window frame, door crevice, etc.
- Dusting brush: Use it to clean some where difficult to reach such as inside of lampshade, shelf, etc.

### How to use

#### Cleaning a dry dust

- Open the cover, and check whether the inside of the tank is empty or dry.(Fig. 7)  
If not empty, make the tank completely empty and make it dry.
- Insert the cloth filter(Fig. 8), and closer the cover.(Fig. 9)
- Insert the floor nozzle.(Fig. 4)
- Connect the plug, and press power button.(Fig. 10)

#### Making the cloth filter empty

- ✓ When the filter becomes to be full, the suction power becomes to weak, and you can not do the cleaning any more.
- ✓ Then, clean the cloth filter.
- ✓ With the power off, open the cover and remove the filter.(Fig. 11)
- ✓ Slide out the clip of the filter(Fig. 12), clean the filter, and reinstall the clip again.

#### Sucking water

- Open the cover, and check whether the cloth filter is installed at the tank or not.  
If installed, remove the filter.
- Insert the spray nozzle.(Fig. 13)
- Insert the tube into the holder of the pipe, and insert the clip into the pipe.(Fig. 13)
- Insert the connector on the top of the tube into the trigger of the hose handle.(Fig. 14)
- When disconnecting the connector, press the remove button of the trigger.(Fig. 14)
- Connect the plug, and press the power button.
- You can suck water only with the hose handle after removing the pipe from the hose handle.(Fig. 15)



## Make the tank empty

- ✓ When the water in the tank goes to the specific level, the safety device works to prevent the water from sucking.(Fig. 16)
- ✓ Then, make the tank empty.
- ✓ With the power off, turn the hose connected with the tank to the left to be removed.(Fig. 17)
- ✓ Open the cover, and disconnect the tank from the main body.
- ✓ Make the tank empty (Fig. 18), and reassemble it.

## Shampoo cleaning

- Do the dry dust cleaning.
- Open the cover, and remove the filter from the tank.
- Remove the floor nozzle from the pipe, and insert the spray nozzle.
- Insert the tube into the holder of the pipe, and insert the clip into the pipe.
- Insert the connector on the top of the tube into the trigger of the hose handle.
- When you disconnect the connector, press the remove button of the trigger.
- Open the shampoo cap, and fill the shampoo tank with the appropriate ratio of water and shampoo.(Fig. 19)  
Read the appropriate ratio value on the shampoo.
- Connect the plug, and press the shampoo button.(Fig. 20)
- Pull the handle of the hose handle, then the shampoo is sprayed at the spray nozzle.(Fig. 21, 22)
- Spray the shampoo evenly over the area to be cleaned, and press the power button to suck the sprayed shampoo. At this time, you should pull to clean toward your body. If you push to clean, you can not suck the shampoo.(Fig. 6)
- When you hear the big noise from the main body during the shampoo cleaning, refill the shampoo tank, because it indicates that the shampoo tank is empty.

## Caution during the shampoo cleaning

- ✓ Use only the shampoo solution dedicated for LG.
- ✓ In order to remove the shampoo remaining inside the main body after the shampoo cleaning, make the tank empty, and operate about for 30 seconds at the state of the shampoo cleaning.
- ✓ Use the clean water only.
- ✓ When the shampoo tank is empty, do not operate for longer than one minute with the shampoo button pressed.

## Cleaning the exhaust filter and safety filter.(Fig. 23, 24)

- ✓ Separate exhaust cover and dust off.
- ✓ Then, wash filter in a soapy water.
- ✓ Do not clean in a dish-washer or washing machine.
- ✓ Remove the moisture and filter sufficiently in shade for about a day.

## Housekeeping

- Turn the cleaner off, and disconnect the plug.
- Press the cord reel button to reel the cord.(Fig. 25)
- Place the pipe holder into the hole at the rear side of the cleaner.(Fig. 26)
- Water may be remained inside the cleaner. In order to prevent the water remained inside it from freezing, keep it at 0°C or higher.

The working life of this set is 7 years since the date of delivery to to consumer.

Upon the expiry of the said period, it might be unsuitable for the use according to their destination.

The vacuum cleaner must be used for household only.

### Window cleaning

- Connecting the Window Master (Fig. 27)
- Shampoo Switch (Fig. 28)
- Cleaning the Window (Fig. 29)
- Rotating the Frame (Fig. 30)
- Turning off Shampoo Switch (Fig. 31)
- Cleaning Window (Fig. 32)

### Sofa Cleaning

- Connecting the Small Shompoo Nozzle (Fig. 33)
- Cleaning the Sofa (Fig. 34)
- Cleaning the Tile (Fig. 35)



### Disposal of your old appliance

1. When this crossed-out wheeled bin symbol is attached to a product it means the product is covered by the European Directive 2002/96/EC.
2. All electrical and electronic products should be disposed of separately from the municipal waste stream via designated collection facilities appointed by the government or the local authorities.
3. The correct disposal of your old appliance will help prevent potential negative consequences for the environment and human health.
4. For more detailed information about disposal of your old appliance, please contact your city office, waste disposal service or the shop where you purchased the product.