



ENGLISH

MAGYAR

ČEŠTINA

HRVATSKI

SRPSKI

SLOVENČINA

БЪЛГАРСКИ

МАКЕДОНСКИ

POLSKI

ROMÂNĂ

OWNER'S MANUAL

Sound Bar System

Please read this manual carefully before operating your set and retain it for future reference.

NB2020A



MFL67474465

Safety Information



CAUTION: TO REDUCE THE RISK OF ELECTRIC SHOCK DO NOT REMOVE COVER (OR BACK) NO USER-SERVICEABLE PARTS INSIDE REFER SERVICING TO QUALIFIED SERVICE PERSONNEL.



This lightning flash with arrowhead symbol within an equilateral triangle is intended to alert the user to the presence of uninsulated dangerous voltage within the product's enclosure that may be of sufficient magnitude to constitute a risk of electric shock to persons.



The exclamation point within an equilateral triangle is intended to alert the user to the presence of important operating and maintenance (servicing) instructions in the literature accompanying the product.

WARNING: TO PREVENT FIRE OR ELECTRIC SHOCK HAZARD, DO NOT EXPOSE THIS PRODUCT TO RAIN OR MOISTURE.

WARNING: Do not install this equipment in a confined space such as a book case or similar unit.

CAUTION: Do not block any ventilation openings. Install in accordance with the manufacturer's instructions.

Slots and openings in the cabinet are provided for ventilation and to ensure reliable operation of the product and to protect it from over heating. The openings shall be never be blocked by placing the product on a bed, sofa, rug or other similar surface. This product shall not be placed in a built-in installation such as a bookcase or rack unless proper ventilation is provided or the manufacturer's instruction has been adhered to.

Most appliances recommend they be placed upon a dedicated circuit;

That is, a single outlet circuit which powers only that appliance and has no additional outlets or branch circuits. Check the specification page of this owner's manual to be certain. Do not overload wall outlets. Overloaded wall outlets, loose or damaged wall outlets, extension cords, frayed power cords, or damaged or cracked wire insulation are dangerous. Any of these conditions could result in electric shock or fire. Periodically examine the cord of your appliance, and if its appearance indicates damage or deterioration, unplug it, discontinue use of the appliance, and have the cord replaced with an exact replacement part by an authorized service center. Protect the power cord from physical or mechanical abuse, such as being twisted, kinked, pinched, closed in a door, or walked upon. Pay particular attention to plugs, wall outlets, and the point where the cord exits the appliance. To disconnect power from the mains, pull out the mains cord plug. When installing the product, ensure that the plug is easily accessible.

This device is equipped with a portable battery or accumulator.

Safety way to remove the battery or the battery from the equipment: Remove the old battery or battery pack, follow the steps in reverse order than the assembly. To prevent contamination of the environment and bring on possible threat to human and animal health, the old battery or the battery put it in the appropriate container at designated collection points. Do not dispose of batteries or battery together with other waste. It is recommended that you use local, free reimbursement systems batteries and accumulators. The battery shall not be exposed to excessive heat such as sunshine, fire or the like.

Disposal of your old appliance



1. When this crossed-out wheeled bin symbol is attached to a product it means the product is covered by the European Directive 2002/96/EC.
2. All electrical and electronic products should be disposed of separately from the municipal waste stream via designated collection facilities appointed by the government or the local authorities.
3. The correct disposal of your old appliance will help prevent potential negative consequences for the environment and human health.
4. For more detailed information about disposal of your old appliance, please contact your city office, waste disposal service or the shop where you purchased the product.

Disposal of waste batteries/accumulators



1. When this crossed-out wheeled bin symbol is attached to batteries/accumulators of Your product it means they are covered by European Directive 2006/66/EC.
2. This symbol may be combined with chemical symbols for mercury(Hg), cadmium(Cd) or lead(Pb) if the battery Contains more that 0.0005% of mercury,0.002% of cadmium or 0.004% of lead.
3. All batteries/accumulators should be disposed separately from the municipal waste stream via designated collection facilities appointed by the government or the local authorities.
4. The correct disposal of Your old batteries/accumulators will help to prevent potential negative consequences for the environment, animal and human health.
5. For more detailed information about disposal of Your old batteries/accumulators, please contact Your city office, waste disposal service or the shop where You purchased the product.



LG Electronics hereby declares that this/ these product(s) is/are in compliance with the essential requirements and other relevant provisions of Directive 2004/108/EC, 2006/95/EC and 2009/125/EC.

European Standards Centre:

Krijgsman1, 1186 DM Amstelveen The Netherlands

- Please note that this is NOT a Customer Service contact point. For Customer Service Information, see Warranty Card or contact the dealer that you purchased this product.

Table of Contents

1 Getting Started

- 2 Safety Information
- 6 Accessories
- 6 Introduction
 - 6 – Symbols Used in this Manual
- 7 Remote control
- 8 Front panel
- 8 Rear panel
- 9 Installing the sound bar
- 9 Installing the cover foot

2 Connecting

- 10 Mounting the main unit on a wall
- 11 Optional Equipment Connection
 - 11 – OPTICAL In connection

3 Operating

- 12 Operations
 - 12 – DOLBY DRC (Dynamic Range Control)
 - 12 – AV Sync
 - 12 – AUTO POWER DOWN
 - 12 – AUTO POWER On/Off
 - 12 – Turn off the sound temporarily
- 13 Controlling a TV with the Supplied Remote Control

4 Troubleshooting

14 Troubleshooting

5 Appendix

15 Maintenance
15 - Handling the Unit
16 Trademarks and Licenses
17 Specifications



Accessories

Please check and identify the supplied accessories.

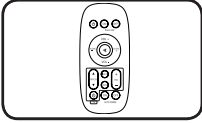

Remote control (1)

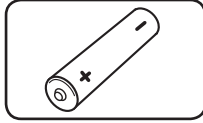

Batteries (1)

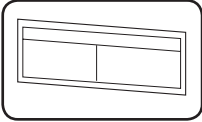

Wall Mount Bracket
Installation Template
(1)

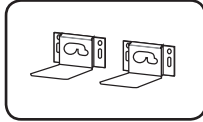

Wall bracket (2)

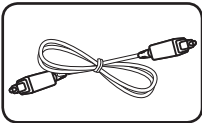

Optical cable (1)

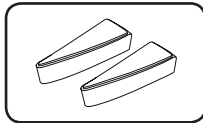

Cover foot (2)

Introduction

Symbols Used in this Manual

 **Note**

Indicates special notes and operating features.

 **Caution**

Indicates cautions for preventing possible damages from abuse.

Remote control

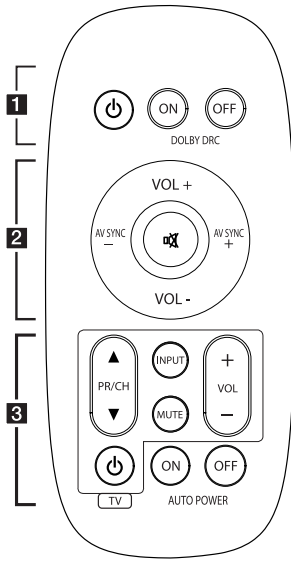

Battery Installation

Remove the battery cover on the rear of the Remote Control, and insert (size AAA) battery with \oplus and \ominus matched correctly.

..... **1**

Power (Power): Switches the unit ON or OFF.

DOLBY DRC (ON/OFF): Sets the Dobyly DRC.

..... **2**

MUTE: Mutes the sound.

VOL +/-: Adjusts speaker volume.

AV SYNC +/-: Synchronizes the audio and video.

Note

- When the volume reaches the highest/lowest level and you push **VOL +/-** on the remote control again, red LED on the unit turns on for 2 seconds to signal on what the volume level is.
- When the unit turns on, volume of the unit will rise gradually to the volume level set at the unit turned off.

..... **3**

TV Control buttons: See page 13.

AUTO POWER (ON/OFF): This function is automatically turned on the unit.

1

Getting Started

Front panel

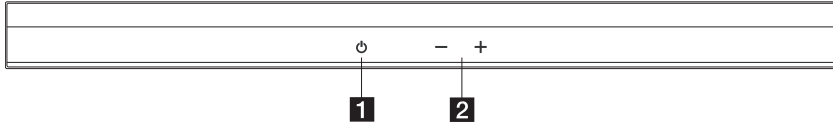

- 1** ⏻ (Standby/On)
- 2** -/+ (Volume)
Adjusts speaker volume.

Rear panel

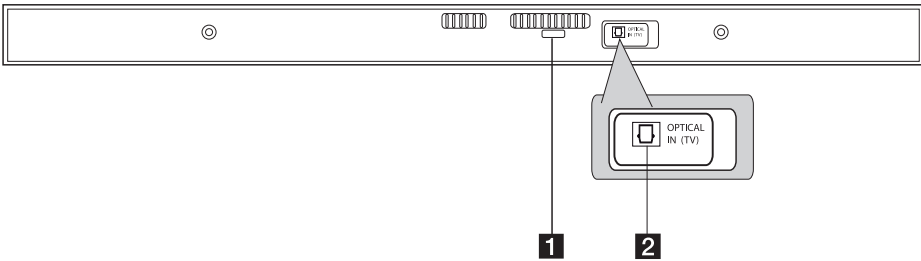

- 1** S/W Download Connector - Only for service.
- 2** OPTICAL IN

Installing the sound bar

You can hear the sound by connecting the unit to the other device : TV, Blu-ray disc player, DVD player, etc.

Place the unit in front of the TV and connect it to the device you want. (Refer to page11)

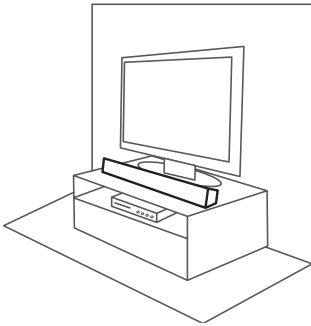

Installing the cover foot

You can extend the height of the unit.

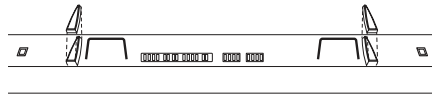

1. Turn the unit upside down.
2. After detaching a release layer on the cover foot, Put it on the foot of the unit.
3. Make the cover foot attached firmly to the unit by pushing it strongly.

1

Getting Started

Mounting the main unit on a wall

You can mount the main unit on a wall.
Prepare screws and brackets.

2
Connecting

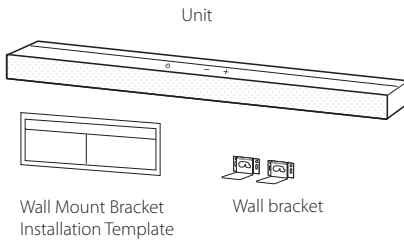

1. Match the TV's BOTTOM EDGE of Wall Mount Bracket Installation Template with the bottom of TV and attach to the position.

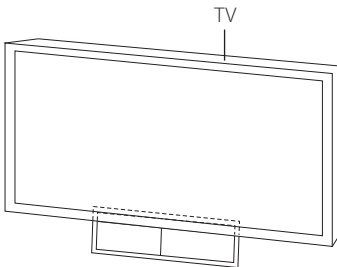

2. When you mount it on a wall (concrete), use the wall plugs (Not supplied). You should drill some holes. A guide sheet (Wall Mount Bracket Installation Template) is supplied to drill. Use the sheet to check the point to drill.

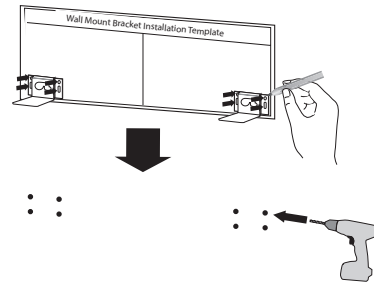

! Note

Screws and Wall Plugs are not supplied for mounting the unit. We recommend the Hilti (HUD-1 6 x 30) for the mounting. Please purchase it.

- Remove the Wall Mount Bracket Installation Template.
- Fix it with screws (not supplied) as shown in the illustration below.

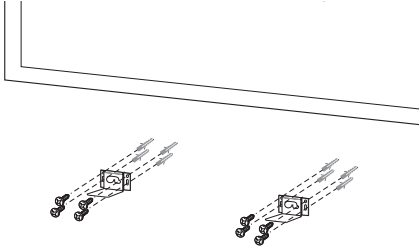

- Hang the main unit onto the bracket as shown below.

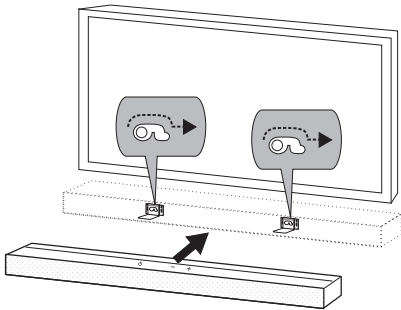

! Caution

- Do not hang onto the installed unit and avoid any impact to the unit.
- Secure the unit firmly to the wall so that it does not fall off. If the unit falls off, it may result in an injury or damage to the product.
- When the unit is installed on a wall, please make sure that a child does not pull any of connecting cables, as it may cause it to fall.

! Note

Detach the unit from the bracket as shown below.



Optional Equipment Connection

OPTICAL In connection

Connect an optical output of external devices to the OPTICAL IN connector.

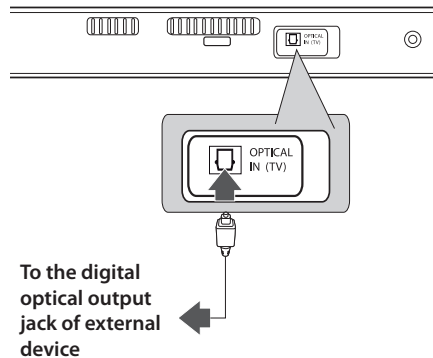

Operations

DOLBY DRC (Dynamic Range Control)

Make the sound clear when the volume is turned down (Dolby Digital only). Set to the DOLBY DRC by pressing **DOLBY DRC ON**.
To cancel the DOLBY DRC, press **DOLBY DRC OFF**.

AV Sync

When receiving audio signals from TV, sound and images may not be matched. In the case, this function can adjust the delay time.

Use **AV SYNC -/+** to scroll up and down through the delay amount, which you can set at anything between 0 and 300m/sec.

! Note

When the AV SYNC reaches the highest/lowest level and you push **AV SYNC -/+** on remote control again, red LED on the unit turns on for 2 seconds to signal on what the AV SYNC level is.

AUTO POWER DOWN

This unit turns off automatically to save power consumption if no signal is transmitted to the unit for about 25 minutes.

But the unit can turn on automatically based on the [AUTO POWER] function you've set.

AUTO POWER On/Off

This function is automatically turns on/off the unit when you turn on/off the external device (TV, DVD player, Blu-ray player etc.) connected to the unit by optical cable. Turn on this function by pressing **AUTO POWER ON**.

To cancel it, press **AUTO POWER OFF**.

! Note

If you don't connect external device to the unit by optical cable or there is no digital input, the unit is turned off after 15 minutes when you turn on this function.

Turn off the sound temporarily

Press **MUTE** to mute your unit.

You can mute your unit, for example, to answer the telephone.

! Note

Red LED on the unit blinks at intervals of 2 seconds to signal that the unit is in mute mode.

Controlling a TV with the Supplied Remote Control

You can control your TV using the buttons below.
(LG TV only.)

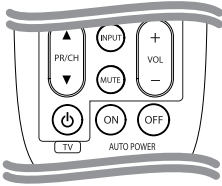

Button	Operation
MUTE	Turn the TV's volume on or off
INPUT	Switch the TV's input source between the TV and other input sources.
TV POWER	Turn the TV on or off.
VOL +/-	Adjust the volume of the TV.
PR/CH ▲/▼	Scan up or down through memorized channels.

! Note

- Depending on your TV being connected, you may not be able to control your TV using some of the buttons.
- The remote control of the unit performs basic operation of your TV. Please use the TV's remote control to enjoy advanced operation of your TV.

Troubleshooting

PROBLEM	CORRECTION
No Power	Plug in the power cord.
	Check the condition by operating other electronic devices.
No sound	Check the OPTICAL IN connection.
The remote control does not work properly.	The remote control is too far from the unit. Operate the remote control within about 23 ft (7m).
	There is an obstacle in the path of the remote control and the unit. Remove the obstacle.
	The battery in the remote control is exhausted. Replace the batteries with new one.
The AUTO POWER function does not work.	Depending on the connected device by the optical cable, this function may not operate.

4

Troubleshooting

Maintenance

Handling the Unit

When shipping the unit

Please save the original shipping carton and packing materials. If you need to ship the unit, for maximum protection, re-pack the unit as it was originally packed at the factory.

Keeping the exterior surfaces clean

- Do not use volatile liquids such as insecticide spray near the unit.
- Wiping with strong pressure may damage the surface.
- Do not leave rubber or plastic products in contact with the unit for a long period of time.

Cleaning the unit

To clean the player, use a soft, dry cloth. If the surfaces are extremely dirty, use a soft cloth lightly moistened with a mild detergent solution. Do not use strong solvents such as alcohol, benzine, or thinner, as these might damage the surface of the unit.

Trademarks and Licenses



Manufactured under license from Dolby Laboratories. Dolby and the double-D symbol are trademarks of Dolby Laboratories.



Manufactured under license under U.S. Patent Nos: 5,956,674; 5,974,380; 6,487,535 & other U.S. and worldwide patents issued & pending. DTS, the Symbol, & DTS and the Symbol together are registered trademarks & DTS 2.0 Channel is a trademark of DTS, Inc. Product includes software. © DTS, Inc. All Rights Reserved.



Specifications

General	
Power requirements	Refer to main label.
Power consumption	Refer to main label.
Dimensions (W x H x D)	(900 x 59 x 85) mm
Net Weight (Approx.)	2.6 kg
Operating temperature	41 °F to 95 °F (5 °C to 35 °C)
Operating humidity	5 % to 90 %

Inputs	
DIGITAL IN (OPTICAL IN)	3 V (p-p), Optical jack x 1

Amplifier	
Stereo mode	20 W + 20 W (6 Ω at 1 kHz)

Designs and specifications are subject to change without prior notice.

