



# QUICK REFERENCE GUIDE

# LED LCD TV / LCD TV

Please read this quick reference guide carefully before operating your set and retain it for future reference.

## LED LCD TV MODELS

22LQ630H  
26LQ630H  
32LQ630H

## LCD TV MODELS

42CQ610H

# LICENSES

Supported licenses may differ by model. For more information about licenses, visit [www.lg.com](http://www.lg.com).



HDMI™, the HDMI logo and High-Definition Multimedia Interface are trademarks or registered trademarks of HDMI Licensing LCC.



View videos and photos and listen to music on your TV through USB 2.0 ('videos' dependent on model).



Manufactured under license from Dolby Laboratories. "Dolby" and the double-D symbol are trademarks of Dolby Laboratories.



ABOUT DIVX VIDEO: DivX® is a digital video format created by DivX, LLC, a subsidiary of Rovi Corporation. This is an official DivX Certified® device that plays DivX video. Visit [divx.com](http://divx.com) for more information and software tools to convert your files into DivX video.

ABOUT DIVX VIDEO-ON-DEMAND: This DivX Certified® device must be registered in order to play purchased DivX Video-on-Demand (VOD) movies. To obtain your registration code, locate the DivX VOD section in your device setup menu. Go to [vod.divx.com](http://vod.divx.com) for more information on how to complete your registration.

"DivX Certified® to play DivX® video up to HD 1080p, including premium content."

"DivX®, DivX Certified® and associated logos are trademarks of Rovi Corporation or its subsidiaries and are used under license."

"Covered by one or more of the following U.S. patents:  
7,295,673; 7,460,668; 7,515,710; 7,519,274"

# IMPORTANT SAFETY INSTRUCTIONS

Always comply with the following precautions to avoid dangerous situations and ensure peak performance of your product.





**WARNING/CAUTION**

**RISK OF ELECTRIC SHOCK  
DO NOT OPEN**



TO REDUCE THE RISK OF ELECTRIC SHOCK DO NOT REMOVE COVER (OR BACK). NO USER SERVICEABLE PARTS INSIDE. REFER TO QUALIFIED SERVICE PERSONNEL.

 The lightning flash with arrowhead symbol, within an equilateral triangle, is intended to alert the user to the presence of uninsulated "dangerous voltage" within the product's enclosure that may be of sufficient magnitude to constitute a risk of electric shock to persons.

 The exclamation point within an equilateral triangle is intended to alert the user to the presence of important operating and maintenance (servicing) instructions in the literature accompanying the appliance.

**WARNING/CAUTION**  
- TO REDUCE THE RISK OF FIRE AND ELECTRIC SHOCK, DO NOT EXPOSE THIS PRODUCT TO RAIN OR MOISTURE.

Read these instructions.  
Keep these instructions.  
Heed all warnings.  
Follow all instructions.



- Do not use this apparatus near water.



- Clean only with a dry cloth.



- Do not block any ventilation openings. Install in accordance with the manufacturer's instructions.



- Do not install near any heat sources such as radiators, heat registers, stoves, or other apparatus (including amplifiers) that produce heat.



- Do not defeat the safety purpose of the polarized or grounding-type plug. A polarized plug has two blades with one wider than the other. A grounding type plug has two blades and a third grounding prong. The wide blade or the third prong are provided for your safety. If the provided plug does not fit into your outlet, consult an electrician for replacement of the obsolete outlet (Can differ by country).



- Protect the power cord from being walked on or pinched particularly at plugs, convenience receptacles, and the point where they exit from the apparatus.



- Only use attachments/accessories specified by the manufacturer.



- Use only with a cart, stand, tripod, bracket, or table specified by the manufacturer, or sold with the apparatus. When a cart is used, use caution when moving the cart/apparatus combination to avoid injury from tip-over.



- Unplug this apparatus during lightning storms or when unused for long periods of time.

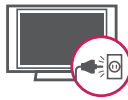

- Refer all servicing to qualified service personnel. Servicing is required when the apparatus has been damaged in any way, such as power-supply cord or plug is damaged, liquid has been spilled or objects have fallen into the apparatus, the apparatus has been exposed to rain or moisture, does not operate normally, or has been dropped.



- Do not stick metal objects or any other conductive material into the power cord. Do not touch the end of the power cord while it is plugged in.



- Keep the packing anti-moisture material or vinyl packing out of the reach of children. Anti-moisture material is harmful if swallowed. If swallowed by mistake, force the patient to vomit and visit the nearest hospital. Additionally, vinyl packing can cause suffocation. Keep it out of the reach of children.

- CAUTION concerning the Power Cord (Can differ by country):

It is recommended that appliances be placed upon a dedicated circuit; that is, a single outlet circuit which powers only that appliance and has no additional outlets or branch circuits. Check the specification page of this owner's manual to be certain. Do not connect too many appliances to the same AC power outlet as this could result in fire or electric shock. Do not overload wall outlets. Overloaded wall outlets, loose or damaged wall outlets, extension cords, frayed power cords, or damaged or cracked wire insulation are dangerous. Any of these conditions could result in electric shock or fire. Periodically examine the cord of your appliance, and if its appearance indicates damage or deterioration, unplug it, discontinue use of the appliance, and have the cord replaced with an exact replacement part by an authorized service. Protect the power cord from physical or mechanical abuse, such as being twisted, kinked, pinched, closed in a door, or walked upon. Pay particular attention to plugs, wall outlets, and the point where the cord exits the appliance. Do not move the TV with the power cord plugged in. Do not use a damaged or loose power cord. Be sure do grasp the plug when unplugging the power cord. Do not pull on the power cord to unplug the TV.

- **Warning** - To reduce the risk of fire or electrical shock, do not expose this product to rain, moisture or other liquids. Do not touch the TV with wet hands. Do not install this product near flammable objects such as gasoline or candles, or expose the TV to direct air conditioning.



- Do not expose to dripping or splashing and do not place objects filled with liquids, such as vases, cups, etc. on or over the apparatus (e.g. on shelves above the unit).



- **Grounding**  
(Except for devices which are not grounded.) Ensure that you connect the earth ground wire to prevent possible electric shock (i.e. a TV with a three-prong grounded AC plug must be connected to a three-prong grounded AC outlet). If grounding methods are not possible, have a qualified electrician install a separate circuit breaker. Do not try to ground the unit by connecting it to telephone wires, lightning rods, or gas pipes.

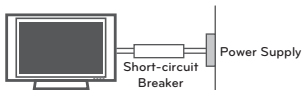

- **DISCONNECTING DEVICE FROM THE MAIN POWER**  
Mains plug is the disconnecting device. The plug must remain readily operable.
- As long as this unit is connected to the AC wall outlet, it is not disconnected from the AC power source even if the unit is turned off.
- Do not attempt to modify this product in any way without written authorization from LG Electronics. Unauthorized modification could void the user's authority to operate this product.

- **ANTENNAS Outdoor antenna grounding**  
(Can differ by country):  
If an outdoor antenna is installed, follow the precautions below. An outdoor antenna system should not be located in the vicinity of overhead power lines or other electric light or power circuits, or where it can come in contact with such power lines or circuits as death or serious injury can occur. Be sure the antenna system is grounded so as to provide some protection against voltage surges and built-up static charges. Section 810 of the National Electrical Code (NEC) in the U.S.A. provides information with respect to proper grounding of the mast and supporting structure, grounding of the lead-in wire to an antenna discharge unit, size of grounding conductors, location of antenna discharge unit, connection to grounding electrodes and requirements for the grounding electrode.  
**Antenna grounding according to the National Electrical Code, ANSI/NFPA 70**

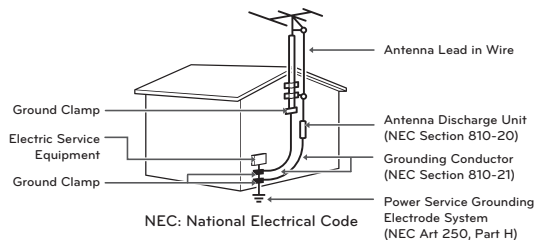

- **Cleaning**  
When cleaning, unplug the power cord and wipe gently with a soft cloth to prevent scratching. Do not spray water or other liquids directly on the TV as electric shock may occur. Do not clean with chemicals such as alcohol, thinners or benzene.
- **Moving**  
Make sure the product is turned off, unplugged and all cables have been removed. It may take 2 or more people to carry larger TVs. Do not press or put stress on the front panel of the TV.
- **Ventilation**  
Install your TV where there is proper ventilation. Do not install in a confined space such as a bookcase. Do not cover the product with cloth or other materials while plugged. Do not install in excessively dusty places.

ENGLISH

- If you smell smoke or other odors coming from the TV, unplug the power cord and contact an authorized service center.
- Do not press strongly upon the panel with a hand or a sharp object such as a nail, pencil or pen, or make a scratch on it.
- Keep the product away from direct sunlight.

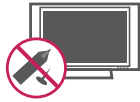

- Never touch this apparatus or antenna during a thunder or lightning storm.
- When mounting a TV on the wall, make sure not to install the TV by hanging the power and signal cables on the back of the TV.
- Do not allow an impact shock or any objects to fall into the product, and do not drop anything onto the screen.

#### • Dot Defect

The Plasma or LCD panel is a high technology product with resolution of two million to six million pixels. In a very few cases, you could see fine dots on the screen while you're viewing the TV. Those dots are deactivated pixels and do not affect the performance and reliability of the TV.

#### • Generated Sound

**"Cracking" noise:** A cracking noise that occurs when watching or turning off the TV is generated by plastic thermal contraction due to temperature and humidity. This noise is common for products where thermal deformation is required.

**Electrical circuit humming/panel buzzing:** A low level noise is generated from a high-speed switching circuit, which supplies a large amount of current to operate a product. It varies depending on the product.

This generated sound does not affect the performance and reliability of the product.

- Take care not to touch the ventilation openings. When watching the TV for a long period, the ventilation openings may become hot. This does not affect the performance of the product or cause defects in the product.

- If the TV feels cold to the touch, there may be a small "flicker" when it is turned on. This is normal, there is nothing wrong with TV. Some minute dot defects may be visible on the screen, appearing as tiny red, green, or blue spots. However, they have no adverse effect on the TV's performance. Avoid touching the LCD screen or holding your finger(s) against it for long periods of time. Doing so may produce some temporary distortion effects on the screen.

#### DISPOSAL (Hg lamp only used in LCD TVs)

The fluorescent lamp used in this product contains a small amount of mercury. Do not dispose of this product with general household waste. Disposal of this product must be carried out in accordance to the regulations of your local authority.

#### Preventing "Image burn" or "Burn-in" on your TV screen

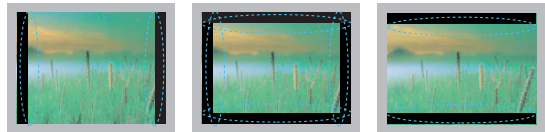

- If a fixed image displays on the TV screen for a long period of time, it will be imprinted and become a permanent disfigurement on the screen. This is "image burn" or "burn-in" and not covered by the warranty.
- If the aspect ratio of the TV is set to 4:3 for a long period of time, image burn may occur on the letterboxed area of the screen.
- Avoid displaying a fixed image on the TV screen for a long period of time (2 or more hours for LCD, 1 or more hours for the Plasma TV) to prevent image burn.

#### For USA and Canada

##### NOTE TO CABLE/TV INSTALLER

This reminder is provided to call the CATV system installer's attention to Article 820-40 of the National Electric Code (U.S.A.). The code provides guidelines for proper grounding and, in particular, specifies that the cable ground shall be connected to the grounding system of the building, as close to the point of the cable entry as practical.

# TABLE OF CONTENTS

<b>2</b>	<b>LICENSES</b>
<b>3</b>	<b>IMPORTANT SAFETY INSTRUCTIONS</b>
<b>7</b>	<b>TABLE OF CONTENTS</b>
7	Additional Information
<b>8</b>	<b>INSTALLATION PROCEDURE</b>
<b>8</b>	<b>ASSEMBLING AND PREPARING</b>
8	Accessories
9	Protection Cover
10	Rear Jack Panel
13	Wall Mount Installation
14	Setting Up the TV
14	- VESA Wall Mounting
<b>15</b>	<b>GENERAL TROUBLESHOOTING</b>
<b>17</b>	<b>OPEN SOURCE SOFTWARE NOTICE</b>

## Additional Information

The Owner's Manual and Commercial Mode Setup Guide contain detailed information on the advanced features of these TVs. To view the extended documentation, visit our website at: [www.lgsolutions.com/products](http://www.lgsolutions.com/products). From the Products page, select **TVs, Systems & Solutions**, then **LCD TVs**, then the applicable TV. Click the **Literature & Downloads** tab at the bottom of the TV page, and select the required document(s) from the Downloads list.

### FCC NOTICE

This equipment has been tested and found to comply with the limits for a Class B digital device, pursuant to Part 15 of the FCC Rules. These limits are designed to provide reasonable protection against harmful interference in a residential installation. This equipment generates, uses and can radiate radio frequency energy and, if not installed and used in accordance with the instructions, may cause harmful interference to radio communications. However, there is no guarantee that interference will not occur in a particular installation. If this equipment does cause harmful interference to radio or television reception, which can be determined by turning the equipment off and on, the user is encouraged to try to correct the interference by one or more of the following measures:

- Reorient or relocate the receiving antenna.
- Increase the separation between the equipment and the receiver.
- Connect the equipment to an outlet on a circuit different from that to which the receiver is connected.
- Consult the dealer or an experienced radio/TV technician for help.

This device complies with part 15 of the FCC Rules. Operation is subject to the following two conditions: (1) this device may not cause harmful interference and (2) this device must accept any interference received, including interference that may cause undesired operation of the device.

Any changes or modifications in construction of this device which are not expressly approved by the party responsible for compliance could void the user's authority to operate the equipment.

# INSTALLATION PROCEDURE

- 1 Open the package and make sure all the accessories are included.
- 2 Attach the stand to the TV set.

## ASSEMBLING AND PREPARING

### Accessories

Check your product box for the following items. If an accessory is missing, contact the dealer from whom you purchased the TV. Note: Accessories included may differ from the images below.

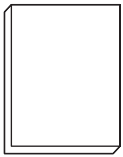

Quick Reference Guide

(For 22/26LQ630H)

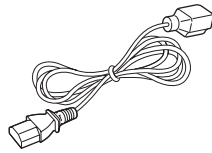

Power Cord

(For 32LQ630H)

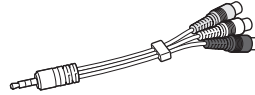

A/V adapter cable

(For 42CQ610H)

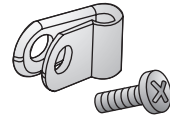

Protective bracket and screw for power cord

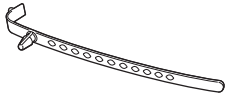

Cable holder

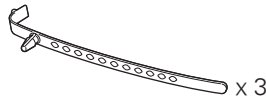

Cable holder

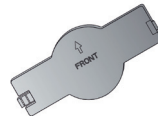

Protection cover  
(See p.9)



#### CAUTION

- To ensure safety and product life span, do not use any unapproved items.
- Any damages or injuries sustained due to use of unapproved items are not covered by the warranty.
- In the case of some models, the thin film on the screen is a part of TV and should not be removed.



#### NOTE

- The items supplied with your product will vary depending on the model.
- Gently wipe any spots on the cabinet with a polishing cloth (included with some models).
- When using a VGA (D-sub 15-pin signal cable) PC connection, use the shielded signal interface cable with a ferrite core to maintain standards compliance for the product.
- Product specifications and/or manual contents subject to change without prior notice due to upgrade of product functions.



## Protection Cover

Image shown may differ from your TV.

For 42CQ610H

Install the included **PROTECTION COVER** over the hole for the stand.

Press the **Protection cover** into the TV until you hear it click.

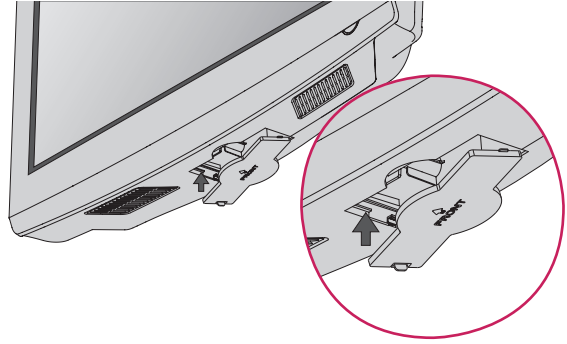

## Rear Jack Panel

Image shown may differ from your TV.

For 22LQ630H

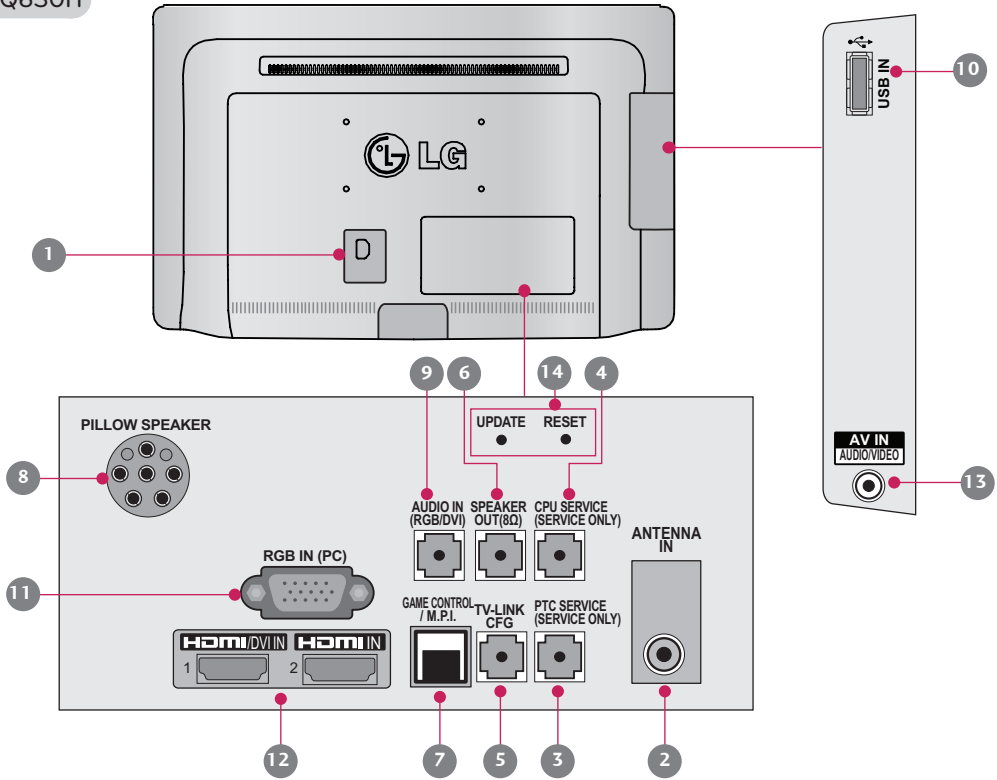

For 26/32LQ630H

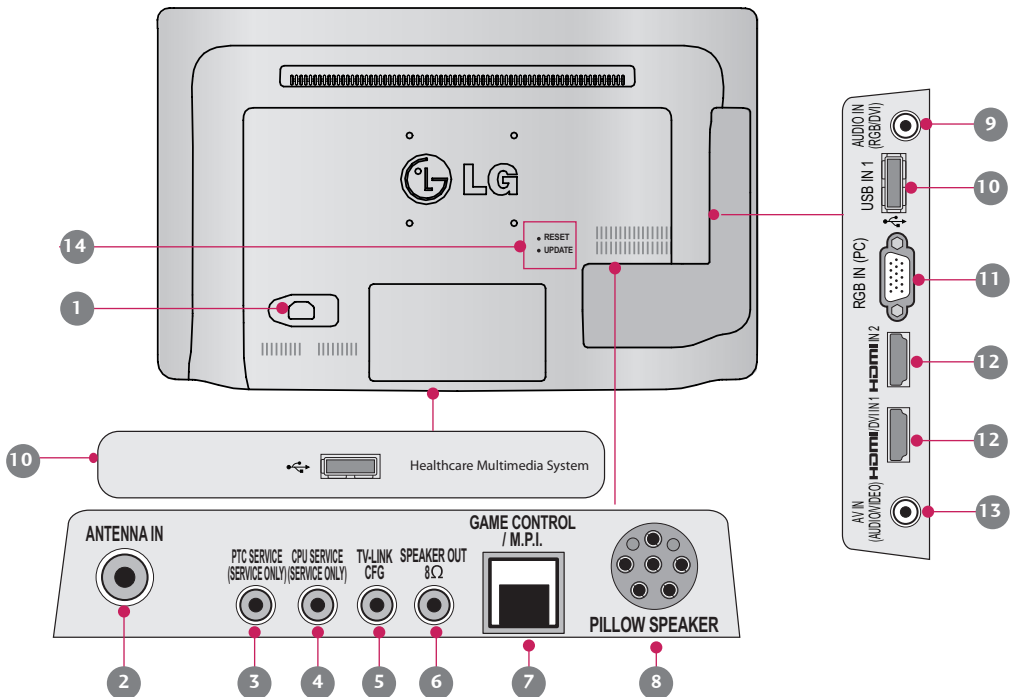

For 42CQ610H

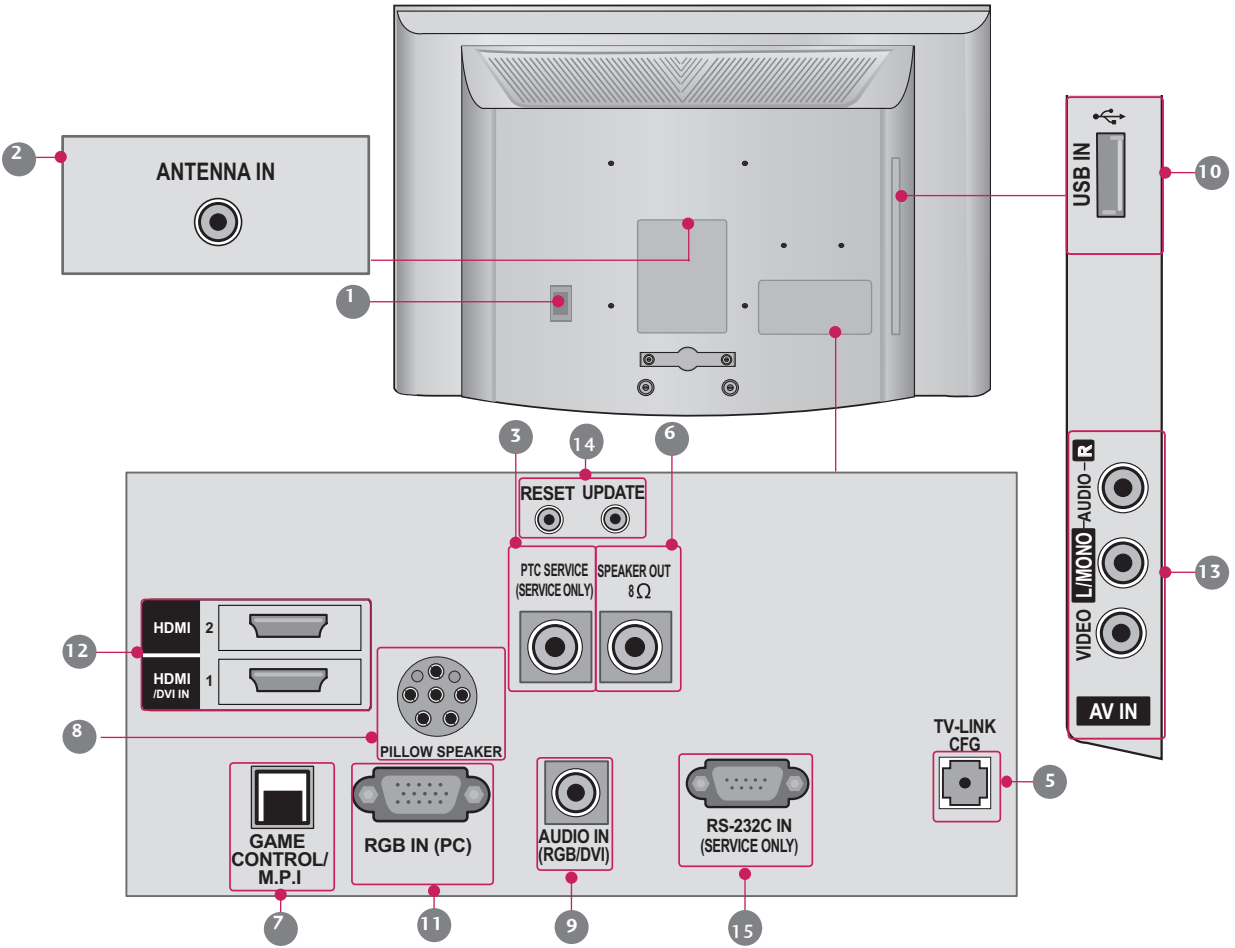

ENGLISH

Jack		Description
①	Power Cord Socket	For operation with AC power. Caution: Never attempt to operate the TV on DC power.
②	ANTENNA IN	Connect over-the air signals to this jack.
③	PTC SERVICE (SERVICE ONLY)	Used for PTC software updates.
④	CPU SERVICE (SERVICE ONLY)	Used for CPU software updates.
⑤	TV - LINK CFG	Computer input for programming Free To Guest services.
⑥	SPEAKER OUT 8Ω	For use with external speakers.
⑦	GAME CONTROL	Input port for third party game Controllers.
	M. P. I.	Allows VOD/PPV devices or set-top boxes to control the TV.
⑧	PILLOW SPEAKER	Used to connect to pillow speaker.
⑨	AUDIO IN (RGB/DVI)	1/8" headphone jack for analog PC audio input.
⑩	USB IN	Used for viewing multimedia files.
⑪	RGB IN (PC)	Analog PC Connection. Uses a D-sub 15-pin cable (VGA cable).
⑫	HDMI/DVI IN	Digital Connection. Supports HD video and Digital audio. Accepts DVI video using an adapter or HDMI to DVI cable (not included).
⑬	AV (Audio/Video) IN	Analog composite connection. Supports standard definition video only (480i). Used for PC/DTV audio input jack.
⑭	UPDATE	Software downloads and debug mode enable/ dis-able.
	RESET	Hardware reset to PTC microcontroller.
⑮	RS-232C IN (SERVICE ONLY)	Used for software updates.

## Wall Mount Installation

- Image shown may differ from your TV.

For proper ventilation, allow a clearance of 4 inches on all four sides.

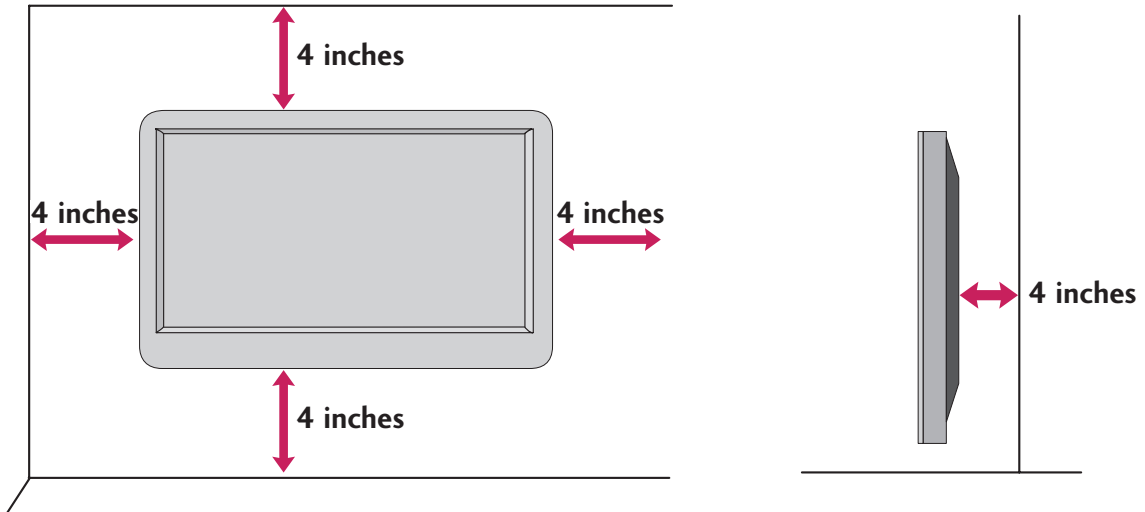

### CAUTION

- To ensure safety and product life span, do not use any unapproved items.
- Any damages or injuries sustained due to use of unapproved items are not covered by the warranty.
- In the case of some models, the thin film on the screen is a part of TV and should not be removed.

## Setting Up the TV

Refer to the appropriate section below to mount the TV on its stand or to a wall.

### VESA Wall Mounting

**NOTE**

- LG recommends that wall mounting be performed by a qualified professional installer.
- It is also recommended that you use an LG brand wall mount bracket when mounting the TV to a wall.

- 1 Install the protection cover provided with the TV to protect the area where the TV stand would otherwise be located. Press the protection cover into the TV until you hear it click.
- 2 (Optional) Carefully attach a wall mount bracket to the rear of the TV.
- 3 Install the wall mount bracket on a solid wall perpendicular to the floor. When you attach the TV to other building materials, please contact qualified personnel.

**CAUTION**

- If installed on a ceiling or slanted wall, the TV may fall, which could result in severe personal injury.
- Do not mount the TV to a wall while it is turned on. This may result in personal injury due to electric shock.

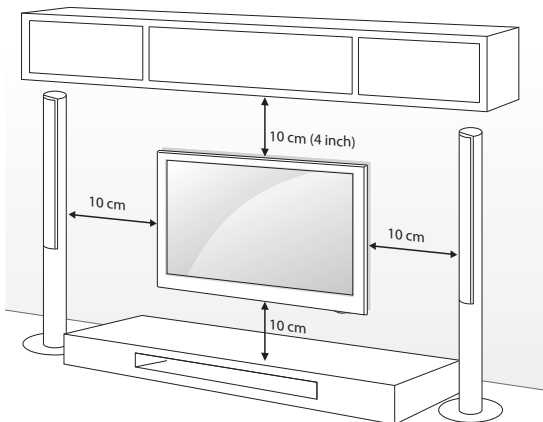

Make sure to use a wall mount bracket and screws that meet the VESA standard. Standard dimensions for wall mount kits are shown in the following table.

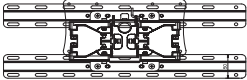
Model	22/26LQ630H	32LQ630H
VESA	100 x 100	200 x 100
Standard screw	M4	M4
Number of screws	4	4
Wall mount bracket (optional)	LSW100B(G) 	

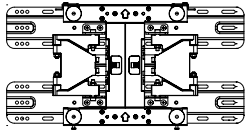
Model	42CQ610H
VESA	200 x 200
Standard screw	M6
Number of screws	4
Wall mount bracket (optional)	LSW200B(G) 

# GENERAL TROUBLESHOOTING

## Installation

Symptom	Possible Cause(s)	Possible Solution(s)
Cannot direct enter channel number.	<ul style="list-style-type: none"> <li>(TV in Pass-through Mode) Installer Menu item 028 CH. OVERRIDE is set to 0, i.e., disabled (recommended setting).</li> </ul>	<ul style="list-style-type: none"> <li>If the channel lineup is locked, only channels that are active in the TV's channel lineup can be selected. Set Installer Menu item 028 CH. OVERRIDE to 1 to allow access for direct keypad entry to all channels.</li> </ul>
	<ul style="list-style-type: none"> <li>(TV in FTG Mode) The channel entered is not part of the FTG Channel Map.</li> </ul>	<ul style="list-style-type: none"> <li>Channel access is restricted to channels included in the FTG Channel Map. If necessary, make changes to the FTG Channel Map using the FTG File Manager or the FTG Configuration Application, as appropriate.</li> </ul>
No channels present after setup.	<ul style="list-style-type: none"> <li>Auto Tuning (Channel Search) not run.</li> </ul>	<ul style="list-style-type: none"> <li>Refer to Express Script or Custom Master TV Setup procedure, as appropriate. Auto Tuning must be run in order for the channel lineup to be populated. Note for Express Script: You must select "Execute Auto Search" in the Auto Search screen to run the search. To re-activate the Express Script, set Installer Menu item 117 FACT DEFAULT to 001.</li> </ul>

## Picture Reception and Sound

Symptom	Possible Cause(s)	Possible Solution(s)
No picture.	<ul style="list-style-type: none"> <li>TV is turned OFF.</li> </ul>	<ul style="list-style-type: none"> <li>Turn TV ON.</li> <li>Power failure?</li> </ul>
	<ul style="list-style-type: none"> <li>Antenna/cable not connected.</li> </ul>	<ul style="list-style-type: none"> <li>Connect antenna/cable signal to TV.</li> </ul>
	<ul style="list-style-type: none"> <li>Connections incorrect.</li> </ul>	<ul style="list-style-type: none"> <li>Check connections on TV.</li> </ul>
	<ul style="list-style-type: none"> <li>MPI not connected</li> </ul>	<ul style="list-style-type: none"> <li>If applicable, connect MPI cable to MPI device.</li> </ul>
	<ul style="list-style-type: none"> <li>Encrypted program.</li> </ul>	<ul style="list-style-type: none"> <li>Try another channel.</li> </ul>
	<ul style="list-style-type: none"> <li>Wrong tuning band.</li> </ul>	<ul style="list-style-type: none"> <li>Adjust Installer Menu settings.</li> </ul>
Normal picture, poor or no sound.	<ul style="list-style-type: none"> <li>Broadcast problem.</li> </ul>	<ul style="list-style-type: none"> <li>Try a different channel.</li> </ul>
	<ul style="list-style-type: none"> <li>Audio muted</li> </ul>	<ul style="list-style-type: none"> <li>Press MUTE or use Volume Up key to increase sound level.</li> </ul>
	<ul style="list-style-type: none"> <li>Pillow/TV speaker not configured properly.</li> </ul>	<ul style="list-style-type: none"> <li>Check that Installer Menu items 020 FEATURE LEVEL and 027 HOSPITAL MODE are set as required. Also, if applicable, select TV Speaker in the Audio Menu.</li> </ul>

## Erratic Operation

Symptom	Possible Cause(s)	Possible Solution(s)
Installer Menu setup.	<ul style="list-style-type: none"> <li>Wrong Installer Menu settings.</li> </ul>	<ul style="list-style-type: none"> <li>Adjust Installer Menu settings as required.</li> </ul>

## Installer Remote

Symptom	Possible Cause(s)	Possible Solution(s)
Remote doesn't work.	<ul style="list-style-type: none"> <li>Remote not in TV Mode.</li> </ul>	<ul style="list-style-type: none"> <li>Use MODE key to select "TV"; puts remote into TV Mode.</li> </ul>
	<ul style="list-style-type: none"> <li>Not aimed at IR remote sensor.</li> </ul>	<ul style="list-style-type: none"> <li>Point remote at TV's IR receiver on TV.</li> </ul>
	<ul style="list-style-type: none"> <li>Remote too far from IR sensor.</li> </ul>	<ul style="list-style-type: none"> <li>Move remote closer to TV's IR receiver or darken room.</li> </ul>
	<ul style="list-style-type: none"> <li>MPI not connected.</li> </ul>	<ul style="list-style-type: none"> <li>If applicable, connect MPI cable to MPI device.</li> </ul>
	<ul style="list-style-type: none"> <li>IR path to TV's receiver obstructed.</li> </ul>	<ul style="list-style-type: none"> <li>Remove obstructions.</li> </ul>
	<ul style="list-style-type: none"> <li>Weak batteries.</li> </ul>	<ul style="list-style-type: none"> <li>Replace batteries.</li> </ul>
	<ul style="list-style-type: none"> <li>Wrong battery polarity.</li> </ul>	<ul style="list-style-type: none"> <li>Check that "+" and "-" match in battery compartment.</li> </ul>
	<ul style="list-style-type: none"> <li>Too much light in room.</li> </ul>	<ul style="list-style-type: none"> <li>Dim room light.</li> </ul>
	<ul style="list-style-type: none"> <li>Wrong Installer Remote.</li> </ul>	<ul style="list-style-type: none"> <li>Requires compatible Installer Remote. Contact your LG dealer.</li> </ul>
<ul style="list-style-type: none"> <li>Bed Switch set to wrong bed.</li> </ul>	<ul style="list-style-type: none"> <li>Set Bed Switch or update Installer Menu, as necessary.</li> </ul>	



# OPEN SOURCE SOFTWARE NOTICE

<b>Product Type</b>	Commercial TV
<b>Model Number/Range</b>	LQ630H-UA CQ610H-UA

Those products identified by the Product Type and Model Range above from LG Electronics, Inc. ("LGE") contain the open source software detailed below. Please refer to the indicated open source licences (as are included following this notice) for the terms and conditions of their use.

Component(s)	Licence
Linux kernel, busybox, e2fsprogs, gdbserver, jfsutils, mtd-utils, procps, u-boot, udhpc	GPL v2.0
DirectFB, gconv, glibc	LGPL v2.1
Nano-x	MPL v1.1

The source code for the above may be obtained free of charge from LGE at <http://opensource.lge.com>. LGE will also provide open source code to you on CD-ROM for a charge covering the cost of performing such distribution (such as the cost of media, shipping and handling) upon email request to [opensource@lge.com](mailto:opensource@lge.com). This offer is valid for three (3) years from the date on which you purchased the product.

Please be informed that LG Electronics products may contain open source software listed in the tables below.

Component(s)	Licence
Apache Jakarta Commons Net, Apache ORO	Apache license 1.1
ReportGUI	Apache license 2.0
strace	BSD license
freetype	Freetype license
libjpeg	JPEG license
Libcurl, ncurses	MIT license
The Legion of the Bouncy Castle	MIT/X11 style license
OpenSSL	OpenSSL license
Basic compression lib, libpng, tinymxml, zlib	zlib/libpng license







The model and serial numbers of the TV are located on the back and/or one side of the TV. Record them below should you ever need service.

MODEL \_\_\_\_\_

SERIAL \_\_\_\_\_

### LG Customer Information Center

For inquires or comments, visit [www.lg.com](http://www.lg.com) or call:

**1-888-865-3026** USA, Commercial User

**1-888-542-2623** CANADA

Register your product Online!

[www.lg.com](http://www.lg.com)

Pro:Centric is a trademark of LG Electronics U.S.A., Inc. Pro:Idiom is a registered trademark of Zenith Electronics LLC. b-LAN is a trademark of LodgeNet Interactive Corporation. All other trademarks or registered trademarks are the property of their respective owners.

(For LQ630H series)



This product qualifies for ENERGY STAR in the "factory default (Home Use)" setting.

Changing the factory default settings or enabling other features may increase power consumption that could exceed the limits necessary to qualify for ENERGY STAR.