

OWNER'S MANUAL

3D Glasses

Please read the safety information carefully before using the product.

AG-S360

ABOUT THE PRODUCT

The AG-S360 is a pair of 3D glasses that use radio frequency (RF) (2.4 GHz) wireless communication.

- Connect them to any TV compatible with RF glasses and enjoy vivid 3D images.
- Watch 3D movies and view 3D photos with 3D glasses.
- When using 3D glasses for the first time, make sure the coin cell battery is inserted correctly.

ACCESSORIES



3D Glasses
(Body, Leg)



Nose Pad
(for users wear-
ing regular
eyeglasses)



Coin Cell Battery
(CR2025)



Manual CD



Quick Guide



Cleaning Pad

! NOTE ► The accessories may look different from those shown here.

PART NAMES

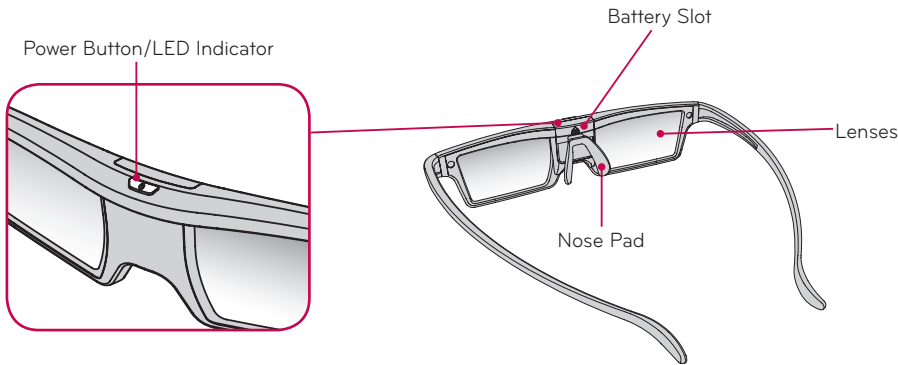

PAIRING 3D GLASSES WITH 3D TV *1

*1 Pairing means establishing a wireless connection between the 3D TV and 3D glasses.
The 3D glasses pair with the 3D TV that has the strongest wireless signal. If there is more than one TV, place the 3D glasses within 10 cm of the 3D TV you want to pair with.

Recommended Pairing Distance: 10 cm	Pairing the Glasses	Re-pairing the Glasses
	1. Turn the 3D TV on and activate 3D mode.	1. Press and hold the power button on the 3D glasses for at least eight seconds until the LED indicator turns green.
	2. Place your 3D glasses within the recommended pairing distance and turn them on.	2. After the green LED indicator flashes three times, the glasses are ready to pair.
	3. During pairing, the LED indicator flashes green and red alternately.	3. Turn the 3D TV on and activate 3D mode.
	4. When pairing is complete, the LED indicator goes off and the 3D glasses are ready to use.	4. Place your 3D glasses within the recommended pairing distance and turn them on.
	5. It is unnecessary to pair the 3D glasses with the same 3D TV again.	5. During pairing, the LED indicator flashes green and red alternately.
		6. When pairing is complete, the LED indicator goes off and pairing with the second 3D TV is complete.

! NOTE ► The 3D glasses detect the unique ID of the TV within the recommended pairing distance; a pair of 3D glasses cannot detect more than one TV.
► If you want to connect the glasses to another TV, see "Re-syncing the Glasses."

USING 3D GLASSES

	Button Operation	LED Indicator
Power On	Press and hold the power button for one to two seconds.	The red LED indicator flashes once.
Power Off	Press and hold the power button for one to two seconds until the LED indicator turns red.	The red LED indicator flashes three times.
Auto Off ^{*1}	The product is automatically turned off if there is no 3D signal for more than one minute.	The red LED flashes three times.
Battery discharge	-	The red LED flashes for one minute and turns off automatically.
Re-syncing the Glasses	Press the power button for at least eight seconds.	When the LED indicator turns green, release the power button. The green LED indicator flashes three times and turns off. If you turn the power on again, the 3D glasses detect the TV with the strongest signal.

^{*1} The Auto Off function automatically turns the power off when there is no signal between the TV and glasses for more than one minute. You cannot watch 3D images when the Auto Off function automatically turns the power off. This can happen when the distance or angle between the TV and glasses is out of range; when there is a barrier between the TV and glasses; or when the TV is switched from 3D to 2D mode.

NOTE ▶ Make sure to turn off the 3D glasses when they are not in use. Otherwise, the battery life shortens.

ASSEMBLING THE GLASSES

The temple arms of the glasses are provided in the package. Attach them to the frame according to the instructions below.

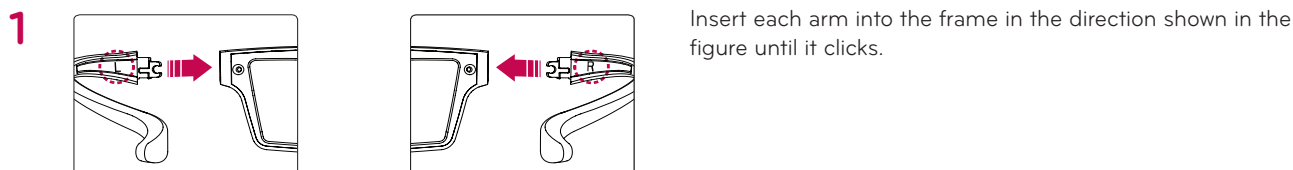

NOTE ▶ Make sure that the left and right arms are attached to the corresponding side of the frame.

REPLACING THE BATTERY

The coin cell battery is not rechargeable. Please replace it when the red LED indicator flashes continuously.

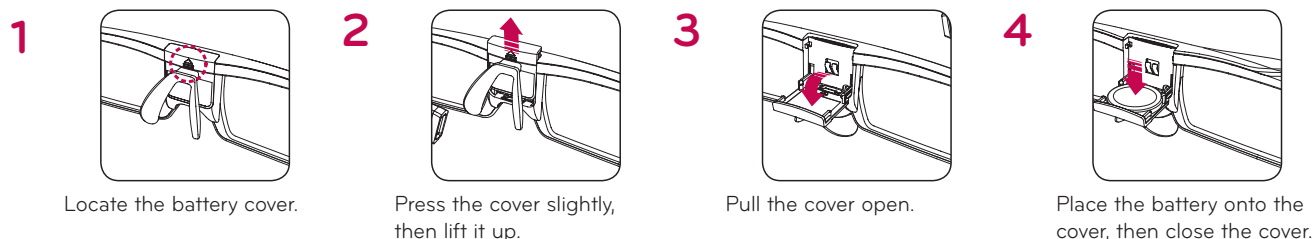

NOTE ▶ Make sure that the battery is inserted correctly with the plus sign facing towards the same sign marked on the cover.

CAUTION ▶ Risk of explosion if battery is replaced by an incorrect type.
▶ dispose of used batteries according to the instruction.

ATTACHING THE NOSE PAD

Using 3D glasses may not be comfortable for users wearing regular eyeglasses. Adjusting the nose pad can improve your viewing comfort.

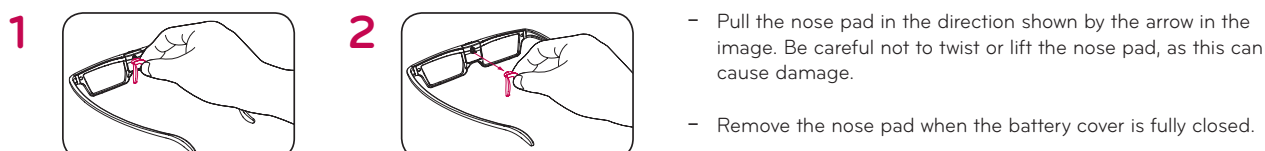

NOTE ▶ Follow the instructions in reverse order to reattach the nose pad.
▶ The nose pad can be adjusted even if you are not wearing glasses.

SAFETY PRECAUTIONS

Please read these safety precautions carefully to ensure your personal safety and prevent damage.

- 1** If you view 3D images too closely for a long period of time, you may experience blurred vision.
- 2** You may also develop headache or fatigue if you watch for a long period of time.
Stop watching and take a rest if you experience headache, fatigue or dizziness.
- 3** Do not drop anything onto the glasses or allow anything to strike them.
This may result in electric shock or fire.
- 4** Do not use your glasses near a humidifier or kitchen counter.
This may result in electric shock or fire.
- 5** Do not disassemble, repair or modify the glasses or its parts.
Failing to follow this precaution may result in damage or malfunction.
- 6** Some people may find that the glasses do not fit.
- 7** If you are pregnant, are a senior, have heart problems, or are prone to motion sickness, we recommend you do not view 3D images.
Because 3D images can appear to be reality and cause disorientation and confusion, some viewers may experience surprise or excitement.
- 8** Do not watch 3D images near fragile objects or objects that can be knocked over easily.
If you mistake 3D images for reality, you could knock over a nearby object or injure yourself when moving your body.
- 9** Only use this product for watching 3D images.
Do not use 3D glasses as sunglasses.
- 10** Do not spray cleaner directly onto the surface of the glasses.
This may result in discoloration and cracks and cause the coating on the lenses to peel off.
- 11** Do not let water come into contact with the product when cleaning it.
This may result in electric shock or fire.
- 12** The lenses of the glasses can be easily scratched.
Use a soft cloth when cleaning them.
Foreign particles on the cloth may cause scratches. Make sure to shake off any dust before using it.
- 13** Do not scratch the surface of the lenses with sharp objects or wipe them with chemicals.
- 14** Do not drop, bend, or allow the glasses to come into contact with other objects.
- 15** When watching 3D images, stay within the reception range. (For more information, refer to the owner's manual of the TV.)
If you are out of the reception range, images may not appear in 3D.
- 16** Flickering may occur when watching 3D images under a magnetic fluorescent light (50 Hz) due to interference between the 3D glasses (60 Hz) and the light.
If you encounter this issue, turn off the light and continue watching.
- 17** This product is a wireless communications device that uses the 2.4 GHz frequency. It may be affected by interference from another device, such as a microwave oven or wireless LAN.
Wireless performance may also be affected by a physical barrier between the TV and the glasses.
- 18** Children should be closely supervised when they use 3D glasses. They should stop using the glasses if they experience fatigue, twitching of the eye or face muscles or other involuntary movements.
- 19** Do not use the 3D glasses with the nose pad if you are not wearing regular eyeglasses. Otherwise, this may hurt your eyes.
- 20** Use a coin cell battery with the same specifications as the one provided. When replacing the battery, make sure to insert it with the polarity (+, -) in the right direction.
Otherwise, personal injury, fire or contamination (damage) due to battery leakage or rupture can occur.
- 21** Dispose the used batteries carefully to ensure that human and pets couldn't consume them.
Please seek Doctor- Medical Attention immediately if child consumes batteries.

TROUBLESHOOTING

Problem	Action
Q. The product does not work.	<p>A. The battery may be dead. Replace the battery with a new one.</p> <p>A. Check the 3D settings on the TV.</p>
Q. The red LED indicator keeps flashing.	<p>A. The coin cell battery is at the end of its life. Replace the battery with a new one.</p>

NOTE ► Make sure to use a coin cell battery with the same specifications (CR2025) as the one provided.

SPECIFICATIONS

	AG-S360
Frequency Range	2.400 GHz to 2.4835 GHz
Transmission Output	7 dBm
Reception Sensitivity	-86 dBm
Shutter	Liquid crystal
Contrast Ratio	Max. 500:1
Transmittance	34 % or more
Field Rate	120 fields/sec
Shutter Open Time	3.8 ms or less
Shutter Close Time	0.5 ms or less
Weight	26 g
Power Supply	Coin Cell Battery: 165 mA/h, 3.0 V (CR2025) Continuous Operating Time: 150 hours or less
Operating Temperature	0 °C to 40 °C
Storage Temperature	-20 °C to 45 °C

☞ The images used and specifications stated in this owner's manual are subject to change to improve the performance of the product.

☞ The continuous operating time may vary depending on the wireless environment and the operating conditions.

Warranty Period: 1 year (2 years for Europe)

If you find a technical defect or problem in the course of normal use during the warranty period, please contact your dealer.

This warranty applies only to the purchaser in the region where the product was purchased.

CE 0197

