

**3D Blu-ray™  
/ DVD Home  
Cinema System**

BH6240S, BH6340H,  
BH6440P, BH6540T

**PORTUGUÊS | MANUAL SIMPLES**

É fornecido em versão electrónica um manual de Utilizador com informação detalhada acerca das funções avançadas. Para ler estes ficheiros, irá de necessitar de um Computador Pessoal (PC) equipado com uma drive CD-ROM.

**NEDERLANDS | EENVOUDIGE HANDLEIDING**

Een uitgebreide Gebruikerhandleiding die informatie bevat over de geavanceerde eigenschappen, zit op de CD-ROM, die als elektronische versie is meegeleverd. Om die bestanden te lezen, zult u een computer (PC) moeten gebruiken die met een CD-ROM-drive is uitgerust.

**Ελληνικά | ΑΠΛΟ ΕΓΧΕΙΡΙΔΙΟ**

Στο CD-ROM που παρέχεται υπάρχει και ένα λεπτομερές Εγχειρίδιο χρήστη με πληροφορίες για επιπρόσθετα γνωρίσματα και παρέχεται σε ηλεκτρονική μορφή. Για την ανάγνωση των αρχείων, θα χρειαστεί να χρησιμοποιήσετε ένα PC το οποίο να είναι εξοπλισμένο με CD-ROM.

**SLOVENŠČINA | ENOSTAVNI PRIROČNIK**

Razširjeni Uporabniški priročnik, ki vsebuje informacije o naprednih funkcijah, se nahaja na CD-ROMu, ki ste ga prejeli v elektronski verziji. Za branje teh datotek boste potrebovali osebni PC računalnik, opremljen s CD-ROM pogonom.

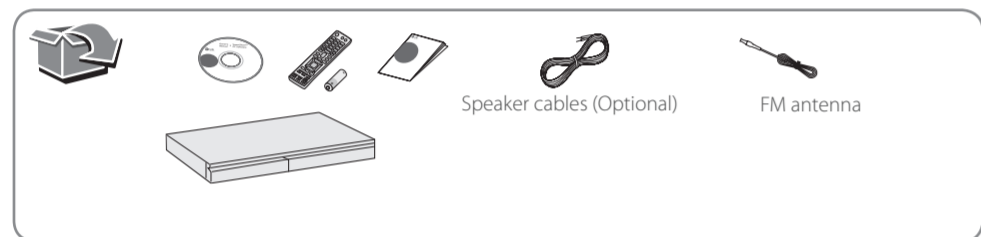

www.lg.com



**Ligação à TV (Saída HDMI)**  
TV-aansluiting (HDMI UIT) / Σύνδεση TV (Έξοδος HDMI) / TV-povezava (HDMI-izhod)

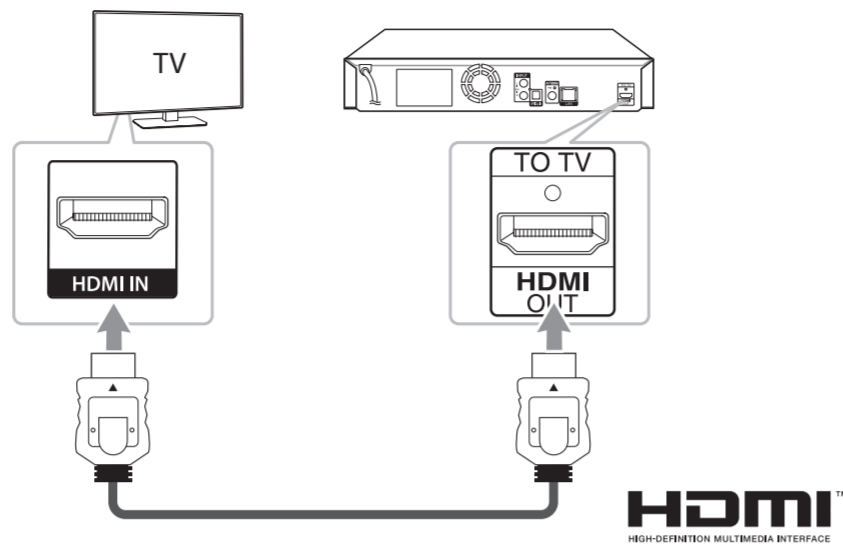

**Ligação OPTICAL IN**  
OPTICAL In-aansluiting / Σύνδεση OPTICAL IN (ΟΠΤΙΚΗΣ ΕΙΣΟΔΟΥ) / Povezava OPTICAL (Optični)

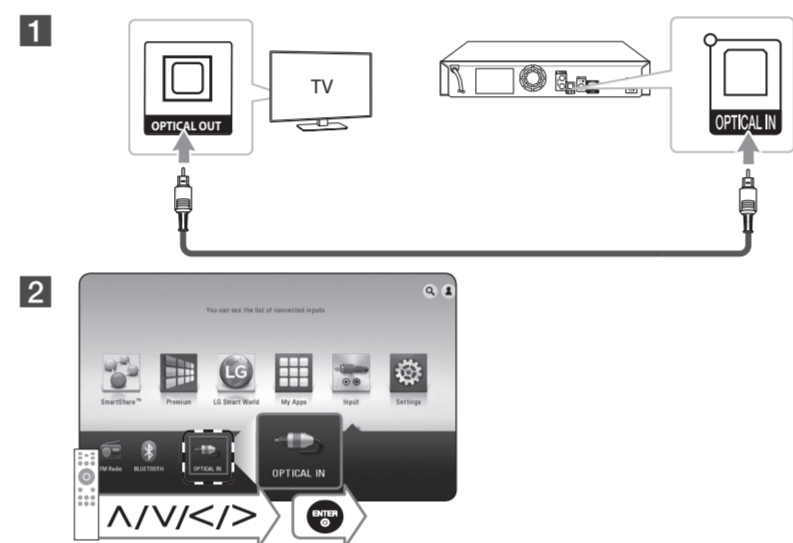

**Utilizar o menu de INÍCIO**  
HOME-menu gebruikt / Χρήση ΚΕΝΤΡΙΚΟΥ μενού / Uporaba menija DOMAČA STRAN

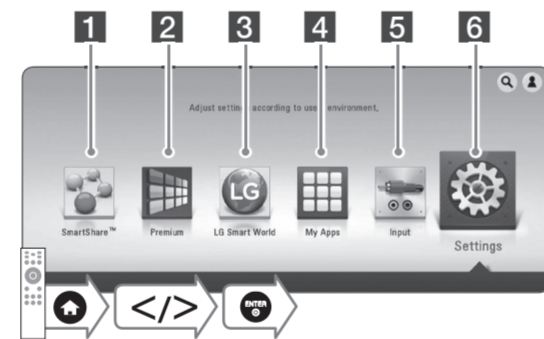

- 1 Exibe o menu SmartShare. / Toont het SmartShare menu. / Εμφάνιση μενού SmartShare. / Prikaže meni SmartShare.
- 2 Exibir o écran inicial do Premium. / Dit laat het Premium Home scherm zien. / Προβάλλει την αρχική οθόνη Premium. / Prikaže domači zaslon Premium.
- 3 Exibe os títulos LG Apps fornecidos à unidade. / Toont de aan het apparaat verstrekte titels van de LG Apps. / Εμφάνιση τίτλων συνοδευτικών εφαρμογών LG Apps. / Prikaže naslove LG Apps, ki so dostopni na tej enoti.
- 4 Exibe o ecrã as [As Minhas Aplicações]. / Toont het [Mijn Apps] scherm. / Εμφάνιση οθόνης [My Apps]. / Prikaže zaslon [My Apps].
- 5 Altera o modo de Entrada. / Hiermee wijzigt u de invoermodus. / Αλλάζει τον τρόπο εισόδου. / Spremeni vhodni način.
- 6 Ajusta as configurações do sistema. / De systeeminstellingen aanpassen. / Ορίζει τις ρυθμίσεις του συστήματος. / Nastavitev sistemskih nastavitev.



**Ligação à rede com fios**  
Bekabelde netwerkverbinding / Ενούρματη σύνδεση δικτύου / Žična omrežna povezava

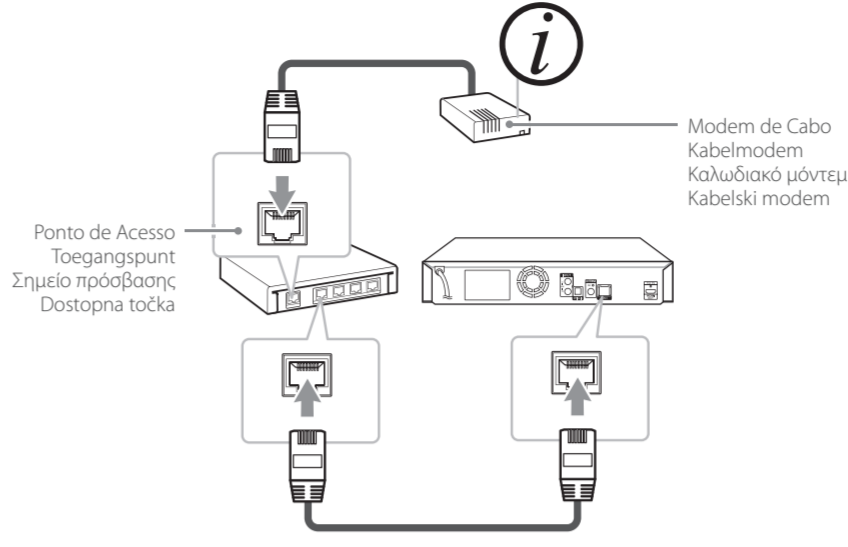

**Disco, Reprodução de Dados**  
Disk, gegevens afspelen / Δίσκος, Αναπαραγωγή περιεχομένου / Disk, Predvajanje podatkov

- 1 Dispositivo com suporte MTP / Apparaat dat MTP ondersteunt / Συσκευή που υποστηρίζει MTP / Naprava, ki podpira MTP
- 2 Seleciona vídeo, fotografia ou conteúdo de áudio. / Selecteert video-, foto- en audiocontent. / Επιλογή βίντεο, φωτογραφίας ή ηχητικού περιεχομένου. / Izbere video datoteke, fotografije ali avdio vsebino.
- 3 Exibe o ficheiro ou pasta no dispositivo conectado. / Toont het bestand of de map op het gekoppelde apparaat. / Εμφάνιση του αρχείου ή του φακέλου στη συνδεδεμένη συσκευή. / Prikaže datoteke ali mapo povezane naprave.

1 A reprodução da maioria dos CDs de Áudio, BD-ROM e DVD-ROM é iniciada automaticamente. / Bij de meeste audio-cd's, bd-rom- en dvd-romdisks start het afspelen automatisch. / Για τους περισσότερους δίσκους Audio CD, BD-ROM και DVD-ROM, η αναπαραγωγή ξεκινά αυτόματα. / Pri večini zvočnih CD-jev, diskov BD-ROM in diskov DVD-ROM se predvajanje začne samodejno.



**Ligação dos Altifalantes**  
Luidsprekers aansluiten / Σύνδεση ηχείων / Priključek za zvočnik

1 A estrutura dos altifalantes e o método de ligação podem variar dependendo do modelo. / Luidsprekerontwerp en de aansluitmethode kan verschillen naar gelang de modellen. / Ο σχεδιασμός των ηχείων και η μέθοδος σύνδεσης μπορεί να διαφέρουν ανάλογα με το μοντέλο. / Dizajn zvočnikov in metoda povezave se lahko razlikujeta, odvisno od modela.

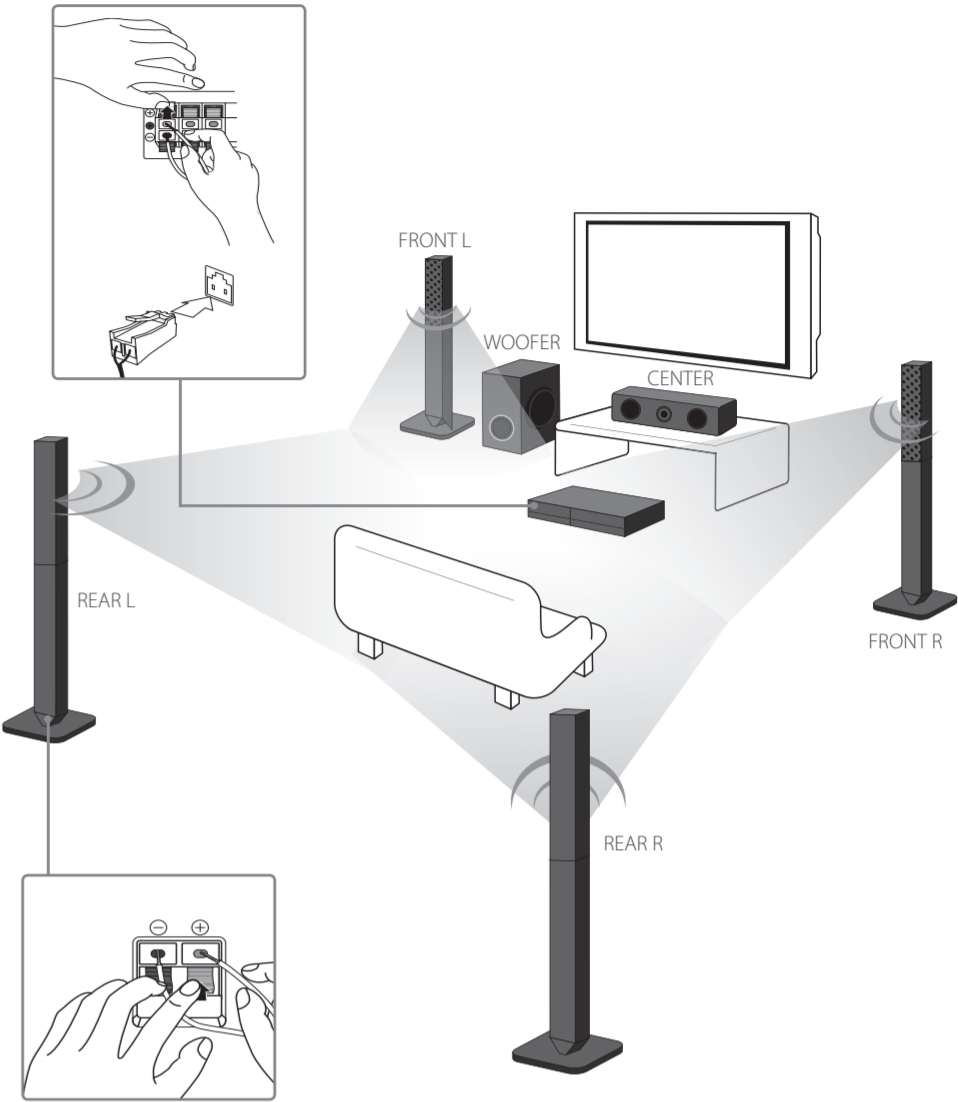

**Reprodução em Rede**  
Netwerk afspelen / Αναπαραγωγή δικτύου / Omrežno predvajanje

**Instalação do software SmartShare para PC**  
SmartShare PC Software installeren / Εγκατάσταση λογισμικού SmartShare PC / Namestitev SmartShare PC Software

- 1 Instalar o software SmartShare para PC. / Installeer SmartShare PC software. / Εγκατάσταση λογισμικού SmartShare PC. / Namestite računalniško programsko opremo SmartShare.
- 2 Execute o programa e defina a pasta de partilha que desejar. / Start het Programma en stel de gewenste gedeelde map in. / Τρέξτε το πρόγραμμα και ρυθμίστε τον φάκελο διαμοιρασμού που θέλετε. / Zaženi program in odpri poljubno mapo v skupni rabi.

**Reprodução em Rede SmartShare**  
Afspelel via Smart Share Network / Αναπαραγωγή δικτύου Smart Share / Omrežno predvajanje z uporabo funkcije SmartShare

- 1 Verifique as definições e a ligação de rede. / Controleer de netwerk aansluiting en de instellingen. / Ελέγξτε τη σύνδεση και τις ρυθμίσεις δικτύου. / Preverite omrežno povezavo in nastavitve.
- 2 Seleciona vídeo, fotografia ou conteúdo de áudio. / Selecteert video-, foto- en audiocontent. / Επιλογή βίντεο, φωτογραφίας ή ηχητικού περιεχομένου. / Izbere video datoteke, fotografije ali avdio vsebino.
- 3 Exibe o ficheiro ou pasta no dispositivo conectado. / Toont het bestand of de map op het gekoppelde apparaat. / Εμφάνιση του αρχείου ή του φακέλου στη συνδεδεμένη συσκευή. / Prikaže datoteke ali mapo povezane naprave.



## Desfrutar de Som Privado

Van Private Sound genieten / Απολαύστε τον ήχο στα μέτρα σας / Uživate v zasebnostnem zvoku

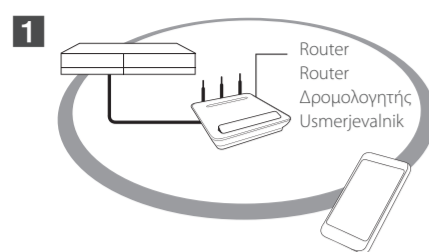

Certifique-se de que o dispositivo móvel está ligado à mesma rede Wi-Fi deste leitor. / Zorg ervoor dat uw mobiele apparaat verbonden is met hetzelfde Wi-Fi-netwerk als deze speler. / Βεβαιωθείτε ότι το smartphone σας είναι συνδεδεμένο στο ίδιο δίκτυο Wi-Fi με αυτή τη συσκευή αναπαραγωγής. / Prepríčajte se, da je pametni telefon povezan z istim omrežjem Wi-Fi kot ta predvajalnik.

2 Ative e execute a aplicação LG AV Remote instalada no dispositivo móvel. / Zet de app LG AV Remote aan. Deze wordt geïnstalleerd en voert dan de LG AV Remote uit. / Ενεργοποιήστε την εγκατεστημένη εφαρμογή απομακρυσμένου ελέγχου για κινητά LG και εκτελέστε την εφαρμογή LG AV Remote. / Vklopite mobilno napravo, na kateri je nameščena aplikacija LG AV Remote in zaženite aplikacijo LG AV Remote.



3 Nem todos os modelos suportam som privado e o emparelhamento de vários dispositivos não está disponível. / Niet alle modi ondersteunen privégeluid en koppelen van meerdere apparaten is niet beschikbaar. / Δεν υποστηρίζουν όλες οι λειτουργίες προσαρμογής ήχου και η ζεύξη πολλαπλών συσκευών δεν είναι διαθέσιμη. / Vse naprave ne podpirajo zasebnostnega zvoka, zato vzpostavitev povezave med napravami ne bo na voljo.



## Atualização de Software

Software-update / Ενημέρωση λογισμικού / Posodobitev programske opreme

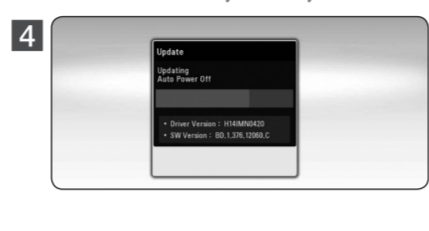

## Informação Adicional

Aanvullende informatie / Πρόσθετες πληροφορίες / Dodatne informacije

### Apoio ao Cliente

Pode atualizar o leitor utilizando o software mais recente para melhorar o funcionamento dos produtos e/ou adicionar novas funcionalidades. Para obter o software mais recente para este leitor (caso existam atualizações), siga as instruções para a atualização do software conforme descrito, visite <http://www.lg.com> ou contate o centro de apoio ao cliente da LG Electronics.

### Klantenondersteuning

Met behulp van de nieuwste software kunt u de speler bijwerken om de werking ervan te verbeteren en/of nieuwe functies toe te voegen. Om de laatste softwareversie voor deze speler te verkrijgen (wanneer er updates beschikbaar zijn), dient u de software-updates, zoals hierboven omschreven, voort te zetten. U kunt ook <http://www.lg.com> bezoeken of contact opnemen met het klantcontactcentrum van LG Electronics.

### Υποστήριξη πελατών

Μπορείτε να ενημερώσετε τη συσκευή με το τελευταίο λογισμικό, ώστε να βελτιώσετε τη λειτουργία του προϊόντος και/ή να προσθέσετε νέα χαρακτηριστικά. Για να αποκτήσετε την τελευταία έκδοση του λογισμικού για αυτή τη μονάδα αναπαραγωγής (στην περίπτωση που έχουν υπάρξει ενημερώσεις), εκτελέστε την ενημέρωση λογισμικού όπως αναφέρεται παραπάνω. Ή επισκεφθείτε τη διεύθυνση <http://www.lg.com> ή επικοινωνήστε με το κέντρο εξυπηρέτησης της LG Electronics.

### Podpora za stranko

Predvajalnik lahko posodobite z najnovejšo programsko opremo, ki lahko izboljša delovanje izdelka in/ali mu doda nove funkcije. Da pridobite najnovejšo programsko opremo za ta predvajalnik (če so bile narejene posodobitve), nadaljujte s posodobitvami programske opreme, kot je navedeno zgoraj, ali obiščite <http://www.lg.com> ali se obrnite na center za pomoč strankam LG Electronic

### Notas sobre software de código aberto

Para obter a fonte de código correspondente sob as licenças GPL, LGPL e outras, visite <http://opensource.lge.com>. Todos os termos de licença, garantias e avisos de direitos de autor estão disponíveis para descarregar com o código de fonte.

### Kennisgeving met betrekking tot open source-software

Als u de bijbehorende broncode onder GPL, LGPL en andere open source-licenties wilt downloaden, gaat u naar <http://opensource.lge.com>. Alle vermelde licentievooraarden, garanties en kennisgevingen met betrekking tot het auteursrecht, kunt u downloaden met de broncode.

### Ειδοποίηση λογισμικού ανοικτής πηγής

Για να αποκτήσετε τον αντίστοιχο κωδικό πηγής υπό GPL, LGPL και άλλες άδειες ανοικτού λογισμικού, παρακαλούμε επισκεφθείτε το <http://opensource.lge.com>. Όλοι οι αναφερόμενοι όροι αδειών, απαλλαγές εγγύησης και ειδοποιήσεις περί πνευματικών δικαιωμάτων, είναι διαθέσιμα για κατωφόρτωση με τον κωδικό πηγής.

### Oporozilo glede programske opreme z odprto kodo

Za pridobitev programske opreme z odprto kodo v okviru GPL, LGPL in drugih licenc z odprto kodo obiščite <http://opensource.lge.com>. Vsi licenčni pogoji, zavrnitve garancije in obvestila o avtorskih pravicah so na voljo za prenos skupaj z odprto kodo.



## Especificação

Specificatie / Προδιαγραφή / Specifikacije

### PORTUGUÊS

Table with 2 columns: Feature and Value. Includes Requisitos de alimentação, Consumo de energia, Dimensões, etc.

### NETERLANDS

Table with 2 columns: Feature and Value. Includes Stroomvereisten, Orgenomen vermogen, Afmetingen, etc.

### ΕΛΛΗΝΙΚΑ

Table with 2 columns: Feature and Value. Includes Απαιτήσεις τροφοδοσίας, Κατανάλωση ενέργειας, Διαστάσεις, etc.

### SLOVENŠČINA

Table with 2 columns: Feature and Value. Includes Zahteve za napajanje, Poraba moči, Dimenzije, etc.

### Substituição da bateria / Vervangen van de batterij / Αντικατάσταση μπαταρίας / Zamenjava baterije

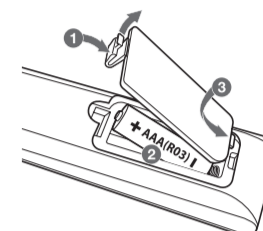

## Informação de Segurança

Veiligheidsinformatie / Στοιχεία σχετικά με την ασφάλεια / Varnostne informacije

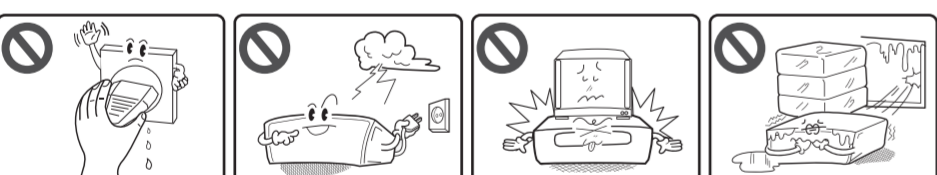
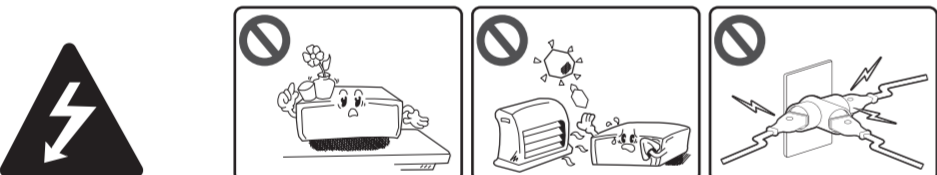

CAUTION: TO REDUCE THE RISK OF ELECTRIC SHOCK DO NOT REMOVE COVER (OR BACK) NO USER-SERVICEABLE PARTS INSIDE REFER SERVICING TO QUALIFIED SERVICE PERSONNEL.

This lightning flash with arrowhead symbol within an equilateral triangle is intended to alert the user to the presence of uninsulated dangerous voltage within the product's enclosure that may be of sufficient magnitude to constitute a risk of electric shock to persons.

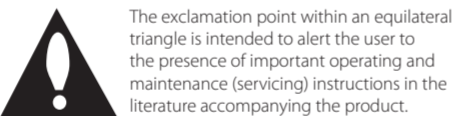

WARNING: TO PREVENT FIRE OR ELECTRIC SHOCK HAZARD, DO NOT EXPOSE THIS PRODUCT TO RAIN OR MOISTURE.

WARNING: Do not install this equipment in a confined space such as a book case or similar unit.

CAUTION: Do not block any ventilation openings. Install in accordance with the manufacturer's instructions. Slots and openings in the cabinet are provided for ventilation and to ensure reliable operation of the product and to protect it from over heating. The openings shall be never be blocked by placing the product on a bed, sofa, rug or other similar surface. This product shall not be placed in a built-in installation such as a bookcase or rack unless proper ventilation is provided or the manufacturer's instruction has been adhered to.



Use of controls, adjustments or the performance of procedures other than those specified herein may result in hazardous radiation exposure.

CAUTION concerning the Power Cord To disconnect power from the mains, pull out the mains cord plug. When installing the product, ensure that the plug is easily accessible.

CAUTION: The apparatus shall not be exposed to water (dripping or splashing) and no objects filled with liquids, such as vases, shall be placed on the apparatus.

This device is equipped with a portable battery or accumulator. Safety way to remove the battery or the battery from the equipment: Remove the old battery or battery pack, follow the steps in reverse order than the assembly. To prevent contamination of the environment and bring on possible threat to human and animal health, the old battery or the battery put it in the appropriate container at designated collection points. Do not dispose of batteries or battery together with other waste. It is recommended that you use local, free reimbursement systems, batteries and accumulators. The battery shall not be exposed to excessive heat such as sunshine, fire or the like.

### Disposal of your old appliance

- 1. All electrical and electronic products should be disposed of separately from the municipal waste stream via designated collection facilities appointed by the government or the local authorities.
2. The correct disposal of your old appliance will help prevent potential negative consequences for the environment and human health.
3. For more detailed information about disposal of your old appliance, please contact your city office, waste disposal service or the shop where you purchased the product.

### Disposal of waste batteries/accumulators

- 1. This symbol may be combined with chemical symbols for mercury(Hg), cadmium(Cd) or lead(Pb) if the battery Contains more than 0.0005% of mercury, 0.002% of cadmium or 0.004% of lead.
2. All batteries/accumulators should be disposed separately from the municipal waste stream via designated collection facilities appointed by the government or the local authorities.
3. The correct disposal of Your old batteries/accumulators will help to prevent potential negative consequences for the environment, animal and human health.
4. For more detailed information about disposal of Your old batteries/accumulators, please contact Your city office, waste disposal service or the shop where You purchased the product.

### For Wireless product European Union Notice



LG Electronics hereby declares that this/these product(s) is/are in compliance with the essential requirements and other relevant provisions of Directive 1999/5/EC, 2004/108/EC, 2006/95/EC, 2009/125/EC and 2011/65/EU.

Please contact to the following address for obtaining a copy of the DoC. (Declaration of Conformity).

### Contact office for compliance of this product:

LG Electronics Inc. EU Representative, Krijgsman 1, 1186 DM Amstelveen, The Netherlands

Please note that this is NOT a Customer Service contact point. For Customer Service Information, see Warranty Card or contact the dealer that you purchased this product.

Indoor use only.

### RF Radiation Exposure Statement

This equipment should be installed and operated with minimum distance 20 cm between the radiator and your body.



## Memo

Lined area for writing a memo.



## Memo

Lined area for writing a memo.