



**LG**

Life's Good

*MUSICflow* H7 / H5

**SMART Hi-Fi AUDIO**

Wireless Multi-room

Model : NP8740 / NP8540  
NP8740W / NP8540W  
NP8740B / NP8540B  
NP8740D / NP8540D



**ENGLISH | SIMPLE MANUAL**

The actual product may differ from the image.

# Safety Information

1

Getting Started



**CAUTION**  
**RISK OF ELECTRIC SHOCK**  
**DO NOT OPEN**



**CAUTION:** TO REDUCE THE RISK OF ELECTRIC SHOCK DO NOT REMOVE COVER (OR BACK) NO USER-SERVICEABLE PARTS INSIDE REFER SERVICING TO QUALIFIED SERVICE PERSONNEL.



This lightning flash with arrowhead symbol within an equilateral triangle is intended to alert the user to the presence of uninsulated dangerous voltage within the product's enclosure that may be of sufficient magnitude to constitute a risk of electric shock to persons.



The exclamation point within an equilateral triangle is intended to alert the user to the presence of important operating and maintenance (servicing) instructions in the literature accompanying the product.

**WARNING:** TO PREVENT FIRE OR ELECTRIC SHOCK HAZARD, DO NOT EXPOSE THIS PRODUCT TO RAIN OR MOISTURE.

**CAUTION:** The apparatus shall not be exposed to water (dripping or splashing) and no objects filled with liquids, such as vases, shall be placed on the apparatus.

**WARNING:** Do not install this equipment in a confined space such as a book case or similar unit.

**CAUTION:** Do not block any ventilation openings. Install in accordance with the manufacturer's instructions.

Slots and openings in the cabinet are provided for ventilation and to ensure reliable operation of the product and to protect it from over heating. The openings shall be never be blocked by placing the product on a bed, sofa, rug or other similar surface. This product shall not be placed in a built-in installation such as a bookcase or rack unless proper ventilation is provided or the manufacturer's instruction has been adhered to.

**NOTICE:** For safety marking information including product identification and supply ratings, please refer to the main label on the bottom or rear of the apparatus.

**CAUTION :** Do not use high voltage products around this product. (ex. Bug Zapper) This product may malfunction due to electrical shock.

**CAUTION :** Only use the AC adapter supplied with this device. Do not use a power supply from another device or another manufacturer. Using any other power cable or power supply may cause damage to the device and void your warranty.

#### **CAUTION concerning the Power Cord**

Check the specification page of this owner's manual to be certain of the current requirements of this device. Do not overload wall outlets. Overloaded wall outlets, loose or damaged wall outlets, extension cords, frayed power cords, or damaged or cracked wire insulation are dangerous. Any of these conditions could result in electric shock or fire. Periodically examine the cord of your appliance, and if its appearance indicates damage or deterioration, unplug it, discontinue use of the appliance, and have the cord replaced with an exact replacement part by an authorized service center. Protect the power cord from physical or mechanical abuse, such as being twisted, kinked, pinched, closed in a door, or walked upon. Pay particular attention to plugs, wall outlets, and the point where the cord exits the appliance. The Power Plug is the disconnecting device. In case of an emergency, the Power Plug must remain readily accessible.

## 4 Getting Started

---

1

Getting Started

**POWER:** This unit operates on a mains supply of 100 - 240 V ~, 50/60 Hz.

**Wiring:** This unit is supplied with a BS 1363 approved main plug. When replacing the fuse, always use of the same rating approved to BS 1362. Never use this plug with the fuse cover omitted. To obtain a replacement fuse cover contact your dealer. If the type of plug supplied is not suitable for the mains sockets in your home, then the plug should be removed and a suitable type fitted. Please refer to the wiring instructions below:

**Warning:** A mains plug removed from the mains lead of this unit must be destroyed. A mains plug with bared wires is hazardous if inserted in a mains socket. Do not connect either wire to the earth pin, marked with the letter E or with the earth symbol  $\perp$  or coloured green or green and yellow. If any other plug is fitted, use same rating of fuse in the plug.

**Important:** The wires in this mains lead are coloured in accordance with the following codes:

- **BLUE: NEUTRAL, BROWN: LIVE** - As the colours of the wires in the mains lead of this unit may not correspond with the coloured marking identifying the terminals in your plug, proceed as follows: The wire which is coloured blue must be connected to the terminal which is marked with the letter N or coloured black. The wire which is coloured brown must be connected to the terminal which is marked with the letter L or coloured red.

## Declaration of Conformity

# CE 01970

Hereby, LG Electronics European Shared Service Center B.V., declares that this Wireless Multi-room Audio is compliant with the essential requirements and other relevant provisions of Directive 1999/5/EC. The complete Declaration of Conformity may be requested through the following postal address:

LG Electronics European Shared Service Center B.V.  
European Standard Team  
Krijgsman 1  
1186 DM Amstelveen  
The Netherlands

or can be requested at our dedicated DoC website:  
<http://www.lg.com/global/support/cedoc/cedoc#>

This device is a 2.4 GHz and 5 GHz wideband transmission system, intended for use in all EU member states and EFTA countries, with indoor use restriction for 5 GHz band. (5150 – 5250 MHz)  
This device should be installed and operated with minimum distance 20 cm between the device and your body. And this phrase is for the general statement for consideration of user environment.

## Disposal of your old appliance



1. All electrical and electronic products should be disposed of separately from the municipal waste stream via designated collection facilities appointed by the government or the local authorities.
2. The correct disposal of your old appliance will help prevent potential negative consequences for the environment and human health.
3. For more detailed information about disposal of your old appliance, please contact your city office, waste disposal service or the shop where you purchased the product.

# Table of Contents

## 1 Getting Started

---

- 2 Safety Information
- 8 Unpacking
- 9 Top Panel
- 10 Rear Panel

## 2 Using Multi-Room

---

- 11 Multi-Room Network Setup
- 11 – Step 1. Home Network Requirement
- 12 – Step 2. Installing “Music Flow Player” App and Media Server
- 14 – Step 3. Initial Multi-Room Setup
- 19 – Step 4. Add Speakers (Optional)
- 21 – Using the Bridge
- 23 Enjoying Multiple MUSICflow Product
- 23 – 1. Home Cinema Mode (Surround Sound Mode)
- 24 – 2. Grouping Mode
- 24 – 3. L/R Stereo Mode

---

### 3 Using External device

---

- 25 Using External device
- 25 – 1. PORTABLE IN connection
- 26 – 2. BLUETOOTH® connection

### 4 Troubleshooting

---

- 27 Troubleshooting

### 5 Appendix

---

- 32 About Status LED's Condition
- 34 Specification
- 34 Open source software notice

1

2

3

4

5

- To view the instructions of advanced features, visit <http://www.lg.com> and then download Owner's Manual. Some of the content in this manual may differ from your unit.
- Some of the content in this manual may differ from Music Flow Player app depending on the application's version.

# Unpacking

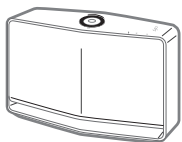

Unit



AC adapter



LAN cable



Simple Manual



Power cord

- Depending on the region, the supplied accessories may differ.



# Top Panel

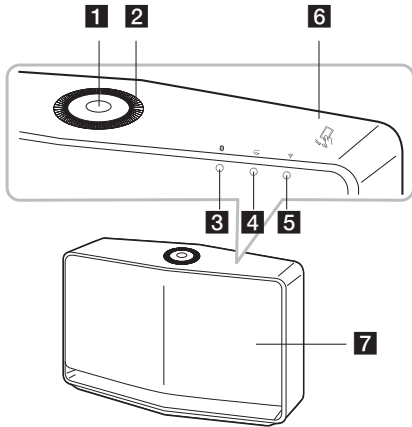

1

Getting Started

## 1 / F button

- Power On / Changing the mode
- Switching to the standby mode

## 2 Volume wheel

Turn the wheel clockwise to increase volume, or counterclockwise to decrease volume.

## 3 Bluetooth status

LED (page 32)

## 4 Portable In status

LED (page 32)

## 5 Network status

LED (page 33)

## 6 NFC Tag (page 26)

Tag On

## 7 Speaker

## Rear Panel

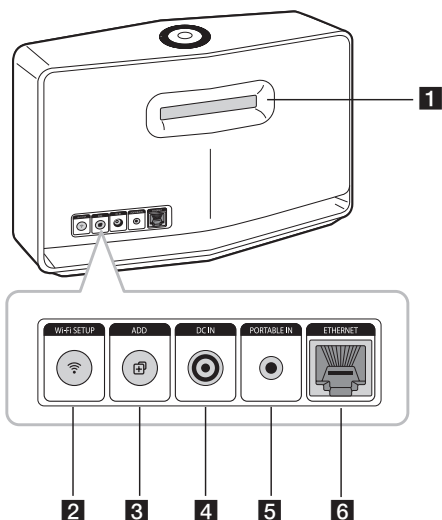
**1 Speaker duct**

A hole for plentiful bass sound on speaker cabinet.

**2 Wi-Fi SETUP button**

Connects initial MUSICflow product to your network wirelessly.

**3 ADD button**

Adds additional MUSICflow products to your network. (In case one or more MUSICflow products are connected)

**4 DC IN (AC adapter input)****5 PORTABLE IN connector****6 ETHERNET (LAN) port**

# Multi-Room Network Setup

## Step 1. Home Network Requirement



- 1 Make sure that a wireless network environment using a router is installed at your home. The home router should be connected to the internet.
- 2 Connect your smart device to your home network.
- 3 Connect the speaker to the power supply.
- 4 If you want to enjoy the music on media server (PC, Mac or Network Storage), connect the media server to your home network.

### ⚠ Caution for Home Network Requirement

- MUSICflow system communicates over both 2.4 GHz and 5 GHz home network supporting 802.11b/g/n wireless technology.
- Wireless signal interference may lead to disconnection of network or stopping playback.
- Depending on the speed of your network, playback of online contents may not work well.
- Network connection may not be made with some routers (or modem) from certain internet communication service providers. In such case, purchase a router from general market and use.
- Because of a firewall on your PC, Music Flow PC Software may not work well. In this case, disable all your firewalls and try to connect again. Refer to your firewall's instruction or website.

## Step 2. Installing “Music Flow Player” App and Media Server

### Installing “Music Flow Player” App

Download “Music Flow Player” on the App Store or Google Play Store.

2

Using Multi-Room

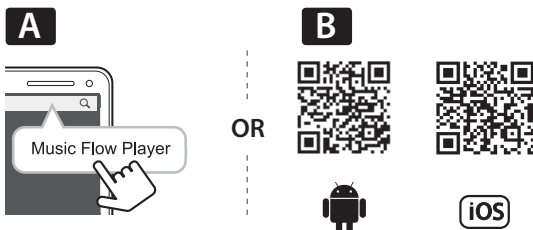

**A** Type “Music Flow Player” in the search bar and tap “Search”.

**B** Scan the QR code using the scanning application.

#### ! Note for “Music Flow Player” App

- Depending on the device, “Music Flow Player” app may not work.
- Music Flow Player app will be available in version of the software as follow;  
Android O/S : Ver 4.0 (or later)  
iOS O/S : Ver 6.0 (or later)

## Installing Media Server software on your PC or Mac

Media server software allows you to access audio files stored in media server (PC, Mac or Network storage) and enjoy them on your speaker via home networking. On [www.lg.com](http://www.lg.com) website, type model name in the search bar and find media server software on support tab.

- Windows : Music Flow PC Software
- Mac OS : Nero MediaHome 4 Essentials

### ⓘ Note for using Media Server

- On your PC or Mac, you must share the folder contained Audio content to play them on MUSICflow system.
- On your NAS device, you also must change the settings of your NAS device to ensure that DLNA server is enabled.
- On your Firewall software, you may also need to change the settings of your firewall software to ensure that Windows file sharing is not blocked.

## Step 3. Initial Multi-Room Setup

When installing the MUSICflow product for the first time, you can choose two types of connection as below.

2

Using Multi-Room

### Option 1. Wired connection (MUSICflow Mesh Network Connection)

Connect the one of MUSICflow products (sound bar, speaker or bridge) to the home router using LAN cable.

Then you can connect the additional MUSICflow products (Optional) to your home network wirelessly (MUSICflow Mesh Network). Refer to “Step 4. Add Speakers (Optional)” on page 19.

#### If you have a bridge

Bridge (Wired Connection) → One speaker (Add speakers)  
→ Other speakers (Add speakers)

#### If you do not have a bridge

Initial speaker (Wired Connection) → Other speakers (Add speaker)

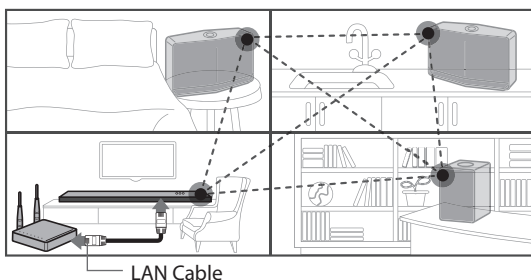

## Simple Setup Guide (Wired Connection)

1. Ensure that your smart device is connected to your Wi-Fi network.
2. Select the product you want to connect.
3. Launch Music Flow Player App and follow “Wired Connection” instructions on set-up wizard.
4. Connect LAN cable from router to any one of MUSICflow product (sound bar, speaker or bridge).
5. Power on the MUSICflow product and wait until you see a white LED become solid.
6. If you install successfully, update speaker software to the latest:  
[Home → Settings → Version Info.]

### Tip

Separated from the router's Wi-Fi environment, composes wireless network among MUSICflow products. Using MUSICflow mesh network, Wireless coverage is expanded, which offers stable music streaming service.

**In the below case, MUSICflow Mesh Network connection is recommended.**

1. When the Wi-Fi coverage cannot reach whole house because home router performance is unstable.  
(In case that your home router supports only 802.11 b/g 2.4 GHz.)
2. When you want to enjoy MUSICflow system in stable wireless network environment.
3. When you want to use in below mode.
  - 1) Multi-Room & Group-play Mode
  - 2) Home Cinema Mode
  - 3) Hi-Fi (24 bit/192 kHz) Mode : When you enjoying the high-quality audio source (ex: flac)

## Option 2. Wireless connection (Standard Wireless Connection)

When the wired connection is unavailable between MUSICflow products and home router, MUSICflow products offer music streaming service within home router's Wi-Fi coverage.

Connect one of the MUSICflow products (sound bar, speaker) to the home router wirelessly.

2

Using Multi-Room

### (Option)

Then you can connect the additional MUSICflow products to your home Wi-Fi network wirelessly.

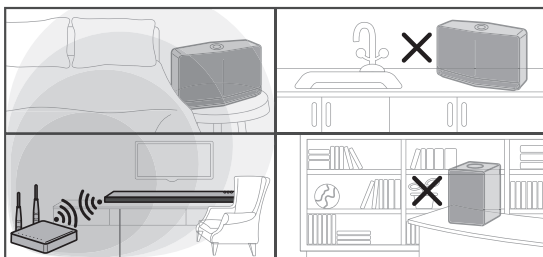

Refer to "Step 4. Add Speakers (Optional)" on page 19.



Wireless signal



## Simple Setup Guide (Wireless Connection)

1. Ensure your smart device is connected to your Wi-Fi network.
2. Select the product you want to connect.
3. Launch Music Flow Player App and follow “Wireless Connection” instructions on set-up wizard.
4. Press  (Wi-Fi Setup icon) button at the back or top of the MUSICflow product (sound bar, speaker or bridge).
5. Check if the  network indicator LED is blinking in a white and red color.
6. Please input the password of Home Router for connecting MUSICflow product to home router.

### If you have iOS device, you must take the three steps below (6-1~6-3)

- 6-1. Press home button of iOS device and go to [Settings].  
If you can select “MusicFlow\_Setup” in Wi-Fi settings. The App and MUSICflow product will be connected.
  - 6-2. Move to Music Flow Player App and input the password of home router for connecting MUSICflow product to home router.
  - 6-3. Press home button of iOS device and go to [Settings].  
Reconnect to your Home Wi-Fi network. And move to Music Flow Player App again.
7. If you install successfully, update speaker software to the latest:  
[Home → Settings → Version Info.]

### Note

- If you failed for “Wireless connection” configuration. It seems that location is too far from the router, it may not be connected. Place and use it at a location that is close enough to router.
- Music Flow PC Software installed on desktop is not supports wireless connection procedure. In this case, use the Music Flow Player on smart device.

## 18 Using Multi-Room

---

- If the router's performance is not good enough (ex. 802.11g 2.4 GHz), sound may be broken in group play or surround playback mode. In this case, connect the speaker in MUSICflow Mesh Network.

### Tip

Offers music streaming service in MUSICflow system within home router's Wi-Fi coverage.

2

**In the below case, Standard wireless connection is recommended.**

Using Multi-Room

1. When all speakers are within the home router's Wi-Fi coverage.  
(If case that your home router supports 802.11n 2.4/5 GHz)
2. When the wired connection is unavailable between MUSICflow products and home router.
3. When you want to use in below mode.
  - 1) When you use single speaker MUSICflow system.
  - 2) Group-play in the Wi-Fi coverage of the home router
  - 3) L/R stereo Mode

## Step 4. Add Speakers (Optional)

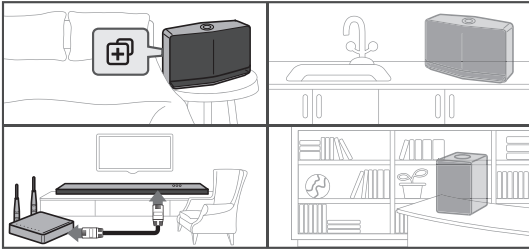

If you connect the initial MUSICflow product to your home network, you can connect the additional MUSICflow products (sound bar, speaker or bridge) to your home network.



2

Using Multi-Room

### Simple Setup Guide (Add Speakers)

1. If you have additional speakers, power on the speaker.
2. Launch smart device or PC application and follow instructions on set-up wizard.  
[Home → Add Speakers]
3. Press  (ADD icon) button at the back or at the top of the MUSICflow product (sound bar, speaker or bridge) which is you want to connect.
4. Check if  network indicator LED is blinking in a red color.
5. If you install successfully, update speaker software to the latest:  
[Home → Settings → Version Info]

#### Note

If you failed for “Add Speaker” configuration. It seems that location is too far from between speakers, it may not be connected. Place and use it at a location that is close enough to router and each speakers.

### ! Note for Multi-Room Setup

- You can make all wireless/wired connection according to the location of the router. But we recommend that you connect the first speaker or bridge to the router using LAN cable and connect additional speakers for network stability.
- When the "Firmware update" pop-up appears on Music Flow Player App, touch to start updating.
- If you connected a speaker with a LAN cable and installed additional speakers: If there is a speaker with frequent sound breaking it may not be close enough with the LAN cable connected speaker, install an additional Bridge or another speaker in a middle location between the LAN cable connected speaker and the speaker with sound breaking and try again.
- Even if you connected speakers with MUSICflow mesh network, music sound breaks by ambient signal interference causing Wi-Fi network defect. In this case, you can try to change Mesh network channel of MUSICflow system at the [Settings → Advanced settings → Mesh Network Channel]
- When making connection, "Mesh network composition" may appear and it takes about 30 seconds. This message appears once in first installation but may appear again when you change network environment.

## Using the Bridge

### 1. Use as a root device (wired to the home router)

When your home router is located too far from any speaker location that is to be connected via wired mode:

- 1 According to “Simple Setup Guide (Wired Connection)”, connect the Bridge to your home router with LAN cable.
- 2 According to “Simple Setup Guide (Add Speakers)”, add MUSICflow products to your home network.

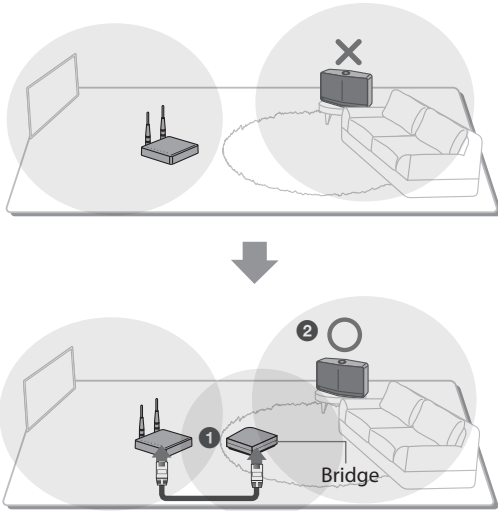

## 2. Use as a wireless extender

When you want to expand MUSICflow mesh network coverage:

**Preparation:** Initial MUSICflow product is connected to your home router with LAN cable.

- 1 According to "Simple Setup Guide (Add Speakers)", add the Bridge to your home network.
- 2 According to "Simple Setup Guide (Add Speakers)", add MUSICflow products to your home network.

2

Using Multi-Room

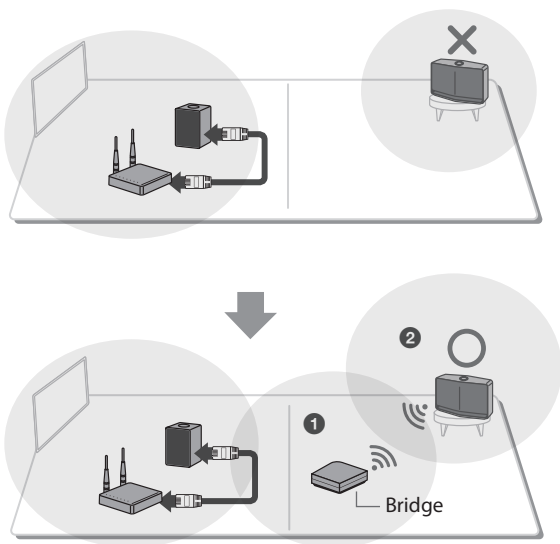

# Enjoying Multiple MUSICflow Product

## 1. Home Cinema Mode (Surround Sound Mode)

Simply add a LG MUSICflow sound bar to your network and synchronize it with your LG MUSICflow speakers to enjoy a home cinema system experience.

### If you have a bridge

Bridge (Wired Connection) → Sound bar (Add speaker) →  
Other speakers (Add speaker)

### If you do not have a bridge

Sound bar (Wired Connection) → Other speakers (Add speaker)

### ⓘ Note

If you connect the MUSICflow Speakers to your Home Cinema, those speakers must be same model.

## Requirement

- MUSICflow Sound Bar x 1
- MUSICflow Speaker x 2 (Same model)
- Network Bridge (optional)

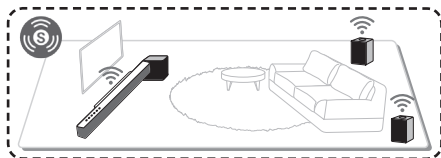

## 2. Grouping Mode

Speakers placed in separate rooms can play the same music or different music based on your needs.

Synchronize your multi-room speakers together to play the same song in every room.

2

Using Multi-Room

### Requirement

- More than 2 MUSICflow
- Network Bridge (optional)

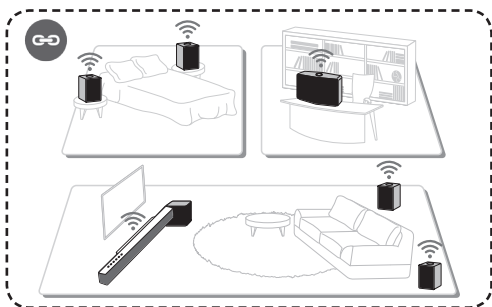

## 3. L/R Stereo Mode

Set your speakers to stereo sound with Music Flow Player Apps to enjoy movies and your favourite tracks.

### Requirement

- MUSICflow Speaker x 2
- Network Bridge (optional)

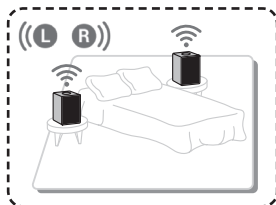



# Using External device

## 1. PORTABLE IN connection

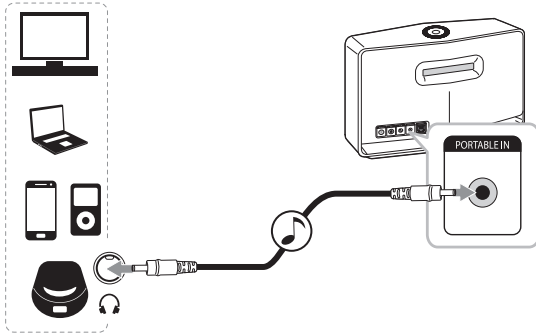

Connect any device which has portable out (🎧) to the PORTABLE IN connector of the unit by using a 3.5 mm stereo cable.

## 2. BLUETOOTH® connection

1. Select the Bluetooth mode with **⏻/I/F** button on the speaker.

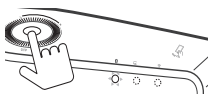

2. On your Bluetooth device, make sure that Bluetooth is on and select "Music Flow H5 (or H7) (XX.XX)".

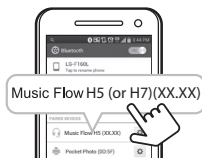

3. Play music on your Bluetooth device.

## NFC for Easy Pairing (Android Only)

You can pair simply and easily by tagging on the  mark.



### ⓘ Note

If you are listening to music using the Music Flow Player app, seamless playback is activated instead of Bluetooth pairing.

# Troubleshooting

## Software Update

When the MUSICflow device is connected to your home network, check whether the firmware version is the latest on all speakers and the Music Flow Player application.

Your MUSICflow device might require a more recent firmware to be installed for optimal operation.

[Settings → Version Info]: You can check if your speaker has the latest firmware.

## How can I initialize speaker?

If you press down “ (Add)” button until Beep sounds once, the network related settings are initialized. (For sound bar, “DISABLED” is displayed in the display window.)

If you press down “ (Add)” button until Beep sounds twice, factory initialization is performed. (For sound bar “RESET” is displayed in the display window.)

## Speaker is not connected.

1. For a speaker that is already connected, make sure the phone is connected to the same router as the speaker. If not, connect to the same router, also check the following.
  - 1-1. Set Power off / on, and check the connection.
  - 1-2. If it is not solved by 1-1, close the application and run again.
  - 1-3. If it is not solved by 1-2, reset the Speaker and reconnect. To reset, press and hold the “ADD” button for 8 seconds until you hear one beep.
  - 1-4. If it is not solved by 1-3, delete the App and reinstall, then try again.

## 28 Troubleshooting

---

2. If you change the location of the speaker that is in use,
  - 2-1. If the changed location is too far from the home router, it may not be connected. Place and use it at a location that is close enough to router.
  - 2-2. Connect the speaker with a LAN cable, and for additionally installed speakers, if they are not close enough to the speaker connected with a LAN cable, additionally install Bridge or another speaker in the middle location between the speaker connected with LAN cable and the speaker with sound being disconnected.

### **There are times that speaker disappears from the application**

4

Troubleshooting

1. If the speaker blinking lamp is not blinking, and stays as white: Even after the speaker power off and on, if the problem continues, in this case you have to reset the speaker (To reset, press and hold the "ADD" button for 8 seconds until you hear one beep.) then you need to register again. Carry out speaker installation or additional procedures.
2. If the speaker blinking lamp blinks white - network signal is unstable. Wait for a while, or move the speaker to another location closer to another speaker or router.
3. Press menu key or menu at the top right side of Home screen to end Music Flow Player app and run again.

### **Music sound breaks and unstable MUSICflow system**

1. If speaker with breaking sound is connected through wireless connection mode,
  - If the distance between the speaker and home router is not close enough, the corresponding condition may occur. Move the speaker closer to the home router and try again.

- If the device playing the source sound (Ex. phone or laptop) is at a place without fluent home router signal, move the corresponding device closer to the home router and try again.
2. If you connected a speaker with a LAN cable and installed additional speakers:  
If the speaker with frequent sound breaking is not close enough with the LAN cable connected speaker, install a Bridge or other another speaker in the middle location between the LAN cable connected speaker and the speaker with sound breaking, and try again.
  3. Even if you connected speakers with MUSICflow mesh network, music sound breaks by ambient signal interference causing Wi-Fi network defect. In this case, you can try to change Mesh network channel of MUSICflow system at the [Settings → Advanced settings → Mesh Network Channel].

### **How can I compose Music Library? / Song is not added even though library is updated.**

Just by adding a song to DLNA server, Music Library is not automatically updated. When you add a song to the server, in [Settings → Music Library → Synchronization], run Music Library synchronization again. Even after Music Library synchronization, if song is not added, check the followings.

1. Check if DLNA server or PC SW shared folder is designated.
2. Check if DLNA server contents list is renewed.
  - Even if you copy the file into the server, server contents list may not be immediately renewed, so check the server setting.
  - If you copy a song into the phone with a method other than MTP, it may not be reflected to the server contents list. In such case, rescan the contents in the phone, or turn off and start the phone again.

## 30 Troubleshooting

---

3. The sharing may be blocked, so check DLNA server program setting or firewall setting.
  - If you are using LG Musicflow PC software, when you designate shared folder, the corresponding folder will be automatically added to Music Library in a minute.

### **LG MUSICflow product is turned off automatically.**

There are some cases that power off will occur if not receiving sound signal:

- Optical, HDMI ARC, Bluetooth, Wi-Fi (DLNA) mode: if there is no sound signal during 20 minutes.
- Portable-In : no sound signal during 6 hours.
- In case of Network connected, it will go to Network standby mode (White LED).
- In case of Network disconnected, it will go to Standby mode (Red LED).

4

Troubleshooting

### **What is the type of music file that can be played?**

- You can play the files with extension mp3, wma, flac, m4a, aac, ogg, and wav.
- For mp3 and wma, sampling frequency is 32- 48 kHz, and for flac, it supports up to 192 kHz, 24 bit.
- Even if the above conditions are satisfied, it may not be played according to the characteristics of the file or media server.
- DRM applied file cannot be played.

## How can I use Spotify?

LG MUSICflow product supports Spotify connect method provided by Spotify. Through this, you can use the function supported by Spotify by connecting to the speaker through Spotify application. If Music Flow speaker is in the network composed of the same router, Spotify application Speaker shape Icon is changed, and when you press this Icon, you can check and select the speakers in the same network. (When the speaker is selected, the icon changes to green.)

## How can I use HomeChat?

After HomeChat device registration, you can use Home Chat.

Each of the family members can register and use one speaker in HomeChat, and one person can register several speakers.

For details, refer to <http://www.lghomechat.com>.





### Note

Depending on the region, some services (ex. Spotify, Homechat, etc.) are unavailable.

## About Status LED's Condition

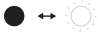
### Bluetooth









Color	Status
 (Off) (White)	The unit is waiting for Bluetooth pairing
 (White)	The unit is paired to Bluetooth

### Portable In

Color	Status
 (White)	Portable cable is connected.



## Network

Color	Status	
 (Off) (White)	The unit is waiting for network connection	Network Status
 (White) (Red)	The initial unit is being connected to the network (  button is pressed)	
 (White)	The unit is connected to the network	
 (Off) (Red)	The additional unit is being connected to the network (  button is pressed)	Standby Mode Status
 (Dimmed White)	Network standby mode	
 (Red)	Standby mode	

### ❗ Note for Status LED's Condition

- When you set the group at first, Network status LED turns green.
- The additional groups are set, the Network status LED color is changed in group order.  
[Green > Magenta > Cyan > Blue > Yellow]
- If the grouped speakers switch to the network standby mode, the brightness of Network status LED gets dark.

## Specification

### AC adapter:

Model: DA-48A18  
Manufacturer: Yang Ming Industrial  
Input: 100 - 240 V ~ 50/60 Hz  
Output: 18 V  2.67 A

### Power consumption:

NP8740: 12 W  
NP8540: 10 W  
Networked standby: 5.4 W  
(If all network ports are activated.)

**Bluetooth:** Codec SBC

### Dimensions (W x H x D):

NP8740:  
Approx. (370 x 232 x 110) mm without foot  
NP8540:  
Approx. (340 x 207 x 88) mm without foot

### Net Weight (Approx.):

NP8740: 4.1 kg  
NP8540: 3.25 kg

- Design and specifications are subject to change without notice.

## 5

### Appendix

## Open Source Software Notice Information

To obtain the source code under GPL, LGPL, MPL, and other open source licenses, that is contained in this product, please visit <http://opensource.lge.com>.

In addition to the source code, all referred license terms, warranty disclaimers and copyright notices are available for download.

LG Electronics will also provide open source code to you on CD-ROM for a charge covering the cost of performing such distribution (such as the cost of media, shipping, and handling) upon email request to [opensource@lge.com](mailto:opensource@lge.com). This offer is valid for three (3) years from the date on which you purchased the product.

## LG Customer Information Center

Country	Telephone
Austria / Österreich	0810-144131
Slovenia / Slovenija	080-543543
Benelux	0900 543 5454 (NL) 015 200 255 (BE)
Schweiz / Suisse / Svizzera / Switzerland	0848-543543
České republiky nebo Slovenské republiky / České republiky alebo Slovenskej republiky	CZ: 810 555 810 SK: 0850 111 154
Deutschland	01806 11 54 11
España	963 05 05 00
France	3220
Ελλάδα	801 11 200 900 210 4800 564
Italia	199600099
Polska	801 54 54 54
Portugal	808 785 454
România	031 228 3542
United Kingdom	UK : 0344 847 5454 IE : 01 686 9454

**For more product details check the following webpage**

United Kingdom      [www.lg.com/uk/musicflow](http://www.lg.com/uk/musicflow)



MFL69184903