



LG Pra.L DUAL BRUSH CLEANSER

Model Name
BCL1



MBM67236827

1910_Rev02



How to use Recommended to use once a day Recommended to use a rich foam cleansing product

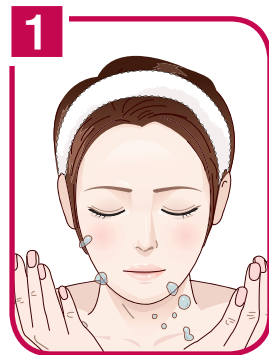

Wet your face and brush head of unit with warm water.



Put cleansing product for your skin type on your face.

❗ Making sufficient amount of bubble before cleansing is recommended.



Press the (POWER) button to turn this unit on.



Press the LEVEL button to select the cleansing level and intensity.

- Silicone brush (Daily gentle cleansing) : Vibration
- Micro-fine brush (Hypersensitive deep cleansing) : Rotation

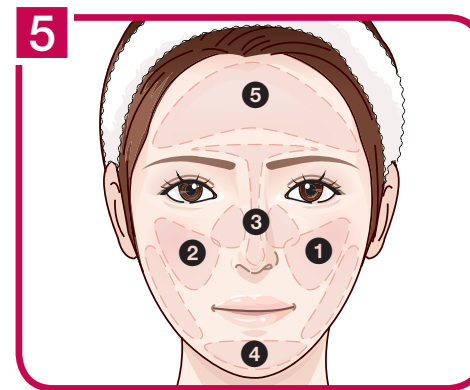

- Start cleansing in the following order.
(Default setting: 70's / Setting method: Refer to the back)
- **70 seconds** : ❶ Left cheek (10's) → ❷ Right cheek (10's) → ❸ Nose (20's) → ❹ Chin (10's) → ❺ Forehead (20's) → Power off
 - **120 seconds** : ❶ Left cheek (20's) → ❷ Right cheek (20's) → ❸ Nose (30's) → ❹ Chin (20's) → ❺ Forehead (30's) → Power off

❗ For Silicone brush head, cleansing the face by gently moving the brush in a small circle.

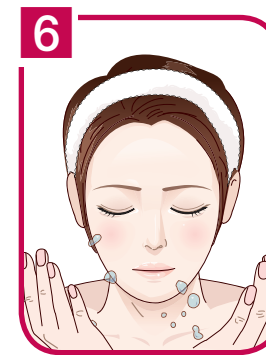

Rinse your face sufficiently with tepid water after cleansing.

How to hold the device

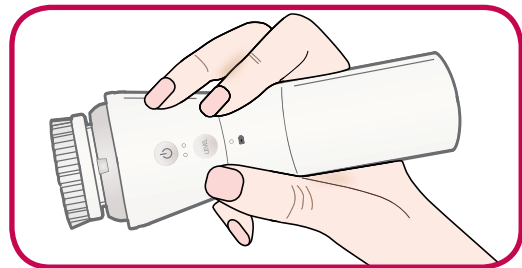

Hold the device naturally in a pencil grip when in use.

- ① Before use, make sure that the brush is correctly attached.

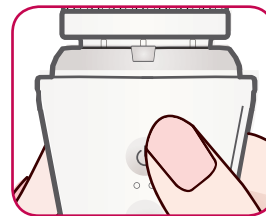

Change cleansing time

With power off, press and hold the  (POWER) button until you hear the voice assistance. (About 5 seconds) (70's ↔ 120's)

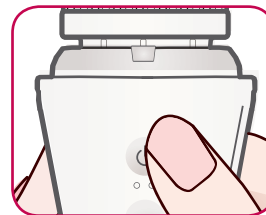

Voice Assistance Setting

With the power on, press and hold the  (POWER) button for about 5 seconds each time. (Voice assistance → Sound effect guide → Turn off guide (mute))

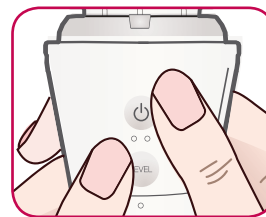

Language Setting

With power on, press and hold the  (POWER) button and the LEVEL button simultaneously for 3 seconds to cycle through each language: (Korean → English → Chinese)

Charge

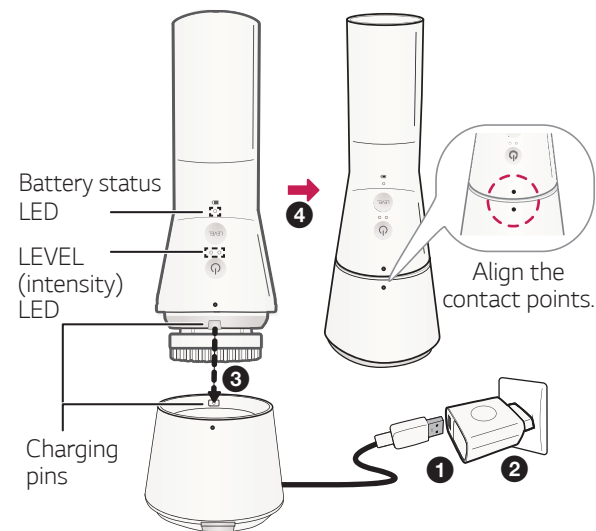

- ① When charging, place the device on the contact point of the charging stand. (Ensure that the contact point of the device and the charging cradle match). When correctly charging, the UV light on the bottom of the charging cradle will be lit.

Precautions for use

- Depending on individual skin condition, the device may cause a variety of skin irritations. If such irritation persists, please reduce the number of uses.
- In the following cases, it is recommended to use the device after consultation with a specialist.
 - Skin Allergies, acne, dermatitis, undergoing skin treatment or cosmetic surgery or hair loss surgery
 - Wearing a cardiac pacemaker, implant device or a metal prosthetic
- Device to be used as a facial treatments only, it is not recommended for use on body.
- If you are currently undergoing a dermatology-related treatment or have skin problems, consult your dermatologist before use.
- Recommend using the product once a day. Using more than twice a day may make skin more sensitive.
- Do not use the device for purposes other than those set out in this guide.