



INSTALLATION MANUAL

CLOUD GATEWAY

Please read this installation manual completely before installing the product.

Installation work must be performed in accordance with the national wiring standards by authorized personnel only. Please retain this installation manual for future reference after reading it thoroughly.

Cloud Gateway
PWFMDB200
Original instruction



MFL71720403
Rev.07_102025

www.lg.com

Copyright © 2021 - 2025 LG Electronics Inc. All Rights Reserved.

SLOVENČINA	PORTUGUÊS	ENGLISH
SLOVENŠČINA	MAGYAR	ITALIANO
LATVIŠU VALODA	БЪЛГАРСКИ	ESPAÑOL
LETUVU VALBA	СРПСКИ	FRANÇAIS
GAELI GE	HRVATSKI	DEUTSCH
МАКЕДОНСКИ	SVENSKA	EMAHNIKA
SHQIP	NORSK	ČEŠTINA
BOSANSKI	DANSK	NETERLANDS
		POLSKI
		LIEM ROMANI
		MALTI

Table of Contents

3	Safety Instructions
14	Product composition
14	Product specifications
15	Before installation (Mandatory)
16	Installation instruction
23	Search for the device
24	Install the ThinQ app and register the account
25	Controlling device via ThinQ
26	When interlocking BECON cloud
29	Open source software guide
30	Things to Check before Reporting Problems

Safety Instructions

The following safety guidelines are intended to prevent unforeseen risks or damage from unsafe or incorrect operation of the appliance.

The guidelines are separated into 'WARNING' and 'CAUTION' as described below.

 This symbol is displayed to indicate matters and operations that can cause risk. Read the part with this symbol carefully and follow the instructions in order to avoid risk.

WARNING

This indicates that the failure to follow the instructions can cause serious injury or death.

CAUTION

This indicates that the failure to follow the instructions can cause the minor injury or damage to the product.

⚠ WARNING

Installation

- When you re-install this product, please contact your Supplier or Installation Company to carry out the work.
 - If someone inexperienced installs the product, it may result in fire, electric shock, explosion, injury, or failure of the product.
- Ensure there is no damage the power cable.
 - It may cause fire or electric shock.
- When you perform any electrical work, please contact the Supplier or Installation Company.
 - If an inexperienced person performs the disassembly or repair, it may cause fire or electric shock.
- Install the product that can avoid rain water.
 - If water enters into the product, it may cause product failure.
- Do not install the product at a place with a lot of moisture.
 - If moisture enters the product, it may cause product failure.
- Make sure to contact the Supplier or Installation Company for the product installation.
 - If someone inexperienced installs the product, it may result in fire, electric shock, explosion, injury, or failure of the product.
- Please ensure an electrical engineer perform the electric work based on the installation manual and the designated circuit diagram.
 - If incorrect wiring is used, or inexperienced engineer performs the electric work, it may cause fire or electric shock.
- Do not place the product near an electric fire.
 - It may cause fire.
- Avoid installing this controller in an area with sensitive electronic equipment.
 - It may cause electrical interference with sensitive electronics.
- Install the product fixed firmly.
 - If the product is not securely fixed, it may fall and become damaged.
- Correctly install the product after fully studying the provided manual.
 - It may cause fire or electric shock.
- During the wiring, do not use non-standard cable and do not force or extend the cable.
 - It may cause fire or electric shock.

- During the wiring of the power cable and communication cable, firmly fix the cable.
 - If the cable is loose, it may cause fire or electric shock.
- Do not connect the power cable to a communication terminal.
 - It may cause fire or electric shock or it may cause the product failure.
- Do not install the product in a place where combustible gas may leak.
 - It may cause fire, electric shock, explosion, injury of the user, or product failure.
- Install the product without tension on the cable.
 - If the tension is applied on the cable, the cable may be broken, or it may cause fire by the heat generation.
- Do not use damaged plugs or connectors.
 - It may cause electric shock or product failure.
 - ✳ If it is a model using a plug
- Do not change or extend the power cable without authorization.
 - It may cause fire or electric shock.
- Use the cable exclusive for the product.
 - If an unauthorized or non-standard cable is used, it may cause fire or electric shock.
- Do not use a heating equipment near the power cable.
 - It may cause fire or electric shock.
- Do not let water enter inside the product.
 - It may cause electric shock of product failure.
- Do not place a container with liquid on the product.
 - It may cause product malfunction.
- Do not touch the product with wet hand.
 - It may cause fire or electric shock.
- Use standard parts.
 - If unauthorized parts are used, it may cause fire, electric shock, explosion, user injury, or product failure.
- When the product is flooded, do not use, power off and contact the Service Company.
 - It may cause fire or electric shock.

Use

- Do not place a heavy object on the power cable.
 - It may cause fire or electric shock.

- Do not impose shock to the product.
 - It may cause product failure.
- Do not store or use combustible gas or ignition material near the product.
 - It may cause fire or product failure.
- Do not disassemble, repair, or modify the product without authorization.
 - It may cause fire or electric shock.
- Provide adequate supervision for use of the product by children or elderly.
 - The negligence may cause safety accident or product failure.
- Safeguard the product from Children.
 - It may cause product damage to the product or injury of the child.
- Check the operation temperature boundary stated in the manual before using the product. If there is no usage boundary stated in the manual, use it in the boundary of 0 °C ~ 40 °C (32 °F ~ 104 °F).
 - If it is used in an environment exceeding the operation temperature boundary, it will seriously damage the product.
- Do not press the switch or button of the product with a sharp object.
 - It may cause electric shock of product failure.
- During the wiring, do not work while the power is applied to the product.
 - It may cause fire or electric shock.
- If there is an abnormal sound, smell, or smoke from the product, stop using the product.
 - It may cause fire or electric shock.
- Do not place a heavy object on the product.
 - It may cause product failure.
- Do not directly spray water on the product or wipe the product with wet towel, etc.
 - It may cause fire or electric shock.
- Do not use the product for special usage such as animal or plant, precision equipment, or preservation of art pieces, and do not use the product at a place unsuitable for the installation.
 - It may cause property damage.
- Safely dispose of the packaging material.
 - If it is not disposed, the remaining packaging material may cause injury to the user.

- When you pull out the power plug, hold the head of the plug, and do not touch the power plug with wet hand.
 - It may cause fire or injury.
- Make sure to cut off the power of the product during the cleaning or repair.
 - It may cause fire or product deformation.

⚠ CAUTION

Installation

- Install the product firmly on a place that can support the weight of the product.
 - The product may fall and be damaged.
- Do not use the product at a place with grease, steam, or sulphuric acid gas.
 - It may cause product performance degradation or product damage.
- Check the rated power.
 - It may cause fire or product failure.
- During the transportation of the product, be careful not to drop or damage the product.
 - It may cause product failure or injury of the transporting person.

- During the wiring, do not let dew, water, insect, etc. enter the connection part where the cable is extended.
 - If a foreign object enters, it may cause electric shock or product failure.
- Do not install the unit in potentially explosive atmospheres.

Use

- When cleaning the product, do not use strong detergent such as solvents, wipe with a soft cloth instead.
 - If strong detergent such as solvents are used, it may cause a fire or the product may be deformed.
- Do not press the touch panel with a pointed or sharp object.
 - It may cause electric shock or product failure.
- Do not let a metal material touch the product.
 - It may cause product failure.
- Before cleaning, power off the product.
 - It may cause malfunction of the product.
- Do not touch anything inside the product.
 - It may cause product failure.

- After a long period of product use, check it for any wear and tear or damage.
 - When the product is used for a long period of time, the product status may become worn or damaged, and it may cause user injury during the usage.
- Do not store the product near liquid such as a vase or water jar.
 - It may cause fire or electric shock.
- When the product is not used for a long period of time, turn off at the main power switch.
 - It may cause fire or product failure.
- This appliance is not intended for use by person (including children) with reduced physical, or mental capabilities, or lack of experience and knowledge, unless they have been given supervision or instruction concerning use of the appliance by a person responsible for their safety. Children should be supervised to ensure that they do not play with the appliance.
- This appliance can be used by children aged from 8 years and above and person with reduced physical, sensory or mental capabilities or lack of experience and knowledge if they have been given supervision or instruction concerning use of the appliance in a safe way and understand the hazards involved. Children shall not play with the appliance. Cleaning and user maintenance shall not be made by children without supervision

Product composition

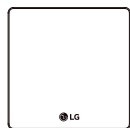

Cloud Gateway



Wall installation plate



Wall installation screw



Controlled fixing screw

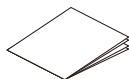

Installation / usage manual

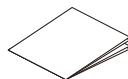

ThinQ connection manual

NOTE :

Components or separately sold product may differ from the actual product picture.

Product specifications

Product specifications are as follows.

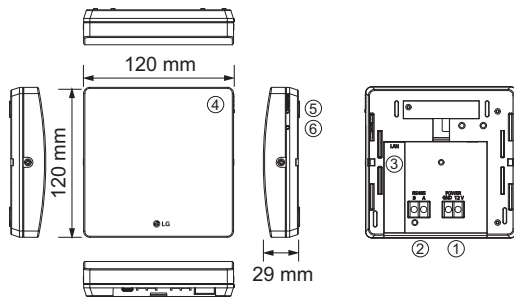

Number	Classification	Specifications	Other types
①	Power	12 V ---	Use of the output power of the outdoor unit.
②	Communication	RS485	Maximum 1 km
③		Ethernet	10/100 Mbps
		Wi-Fi	2.4 GHz
④	LED	2ea	Left (Product mode, red) / Right (Power, green)
⑤	Switch	Change product mode	Registration (LED dimming) \leftrightarrow Use (LED lighting)
⑥		Reset the power	-
	Temperature Spec.	0 °C ~ 40 °C	Use Temperature
	Storage Temperature	-20 °C ~ 60 °C	Storage Temperature

NOTE :

You can find this table on service manual.

USB port (C-Type) is a function not used in the corresponding product.

Before installation (Mandatory)

You should create an account on the partner portal to download PC setup program and installation guide for complete installation.

If you have trouble in logging in, please contact local LG support team in your country.



Installation instruction

Installation and setting

This page describes the installation and setting methods to set up Cloud Gateway.

To use Cloud Gateway, an environment must be established in which Cloud Gateway and the device (Air conditioner/ ventilation, etc.) can communicate with each other and the devices must be registered through Cloud Gateway.

You need to install in the following order.

STEP 1. Installation environment inspection and equipment address setting

Before installing Cloud Gateway, check the network configuration with the device interlocked to the power supply to Cloud Gateway, and assign the connected device a nonoverlapping address.

STEP 2. Product installation

Install Cloud Gateway and connect the power and communication lines.

STEP 3. Search the device

Search for the device you want to use and save it to the product.

STEP 4. Install ThinQ app or interlock BECON cloud

See attached form 'Connecting LG ThinQ and LG Electronics'.

STEP 5. Use ThinQ app or BECON cloud

Interlocking with ThinQ app or BECON cloud to control/monitor the searched device.

⚠ CAUTION

Installation work requires specialized skills.

Therefore, the installation contents mentioned in this page must be carried out by a qualified installation technician.

* Refer to the latest technical information for BECON cloud interlocking and install.

If you have questions or requests related to the installation, please contact service center or installation specialty store acknowledged by LG.

Installation environment inspection and equipment address setting

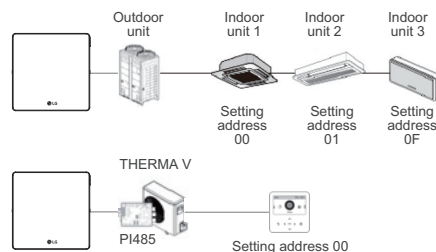

NOTE :

- The maximum allowable communication length guaranteed by LG Electronics is 1000m. In other words, Cloud Gateway and the farthest installed device must be installed within the distance of 1000m.
- It is recommended to use the communication cable which is more than 0.75 mm² (2 cores × 1.0 mm² shielded cable). The power cable must be used 0.5mm² or more. Alternatively, a shielded cable 4x 0.75 mm² or 4x 1.0 mm² can be used. 2 wires are then used for communication (BUS) and 2 wires for the power supply from the gateway via the PI485 interface.
- Set the address that does not overlap within the same device type.
- When multiple different wireless LAN equipment are connected to the router to which you are connecting Cloud Gateway, the wireless LAN malfunction may be caused (Such as delayed operation speed, disconnected, etc.) In this case, it is recommended to use a separate router to connect Cloud Gateway.

Connection of RS485 communication line

One unit of Cloud Gateway can connect up to 16 devices (indoor unit, ventilation, THERMA V).

When multiple devices are connected, they must be connected in a BUS format.

Otherwise, Cloud Gateway may cause malfunction.

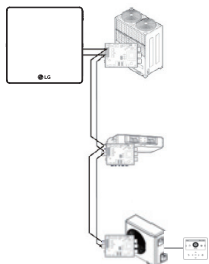

<Correct example : RS485 BUS format connection>

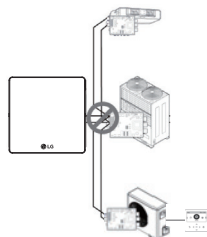

<Incorrect example : RS485 STAR format connection>

⚠ CAUTION

As Cloud Gateway is always **Master** controller, other master controller can't be installed in the same communication line.

Indoor unit central control address setting

First, you need to grant address that does not overlap to each equipment (indoor unit, ventilation, THERMA V equipment) considering the entire installation composition connected to one Cloud Gateway.

The address of the device must be set within the range of 00~0F.

The address of one THERMA V must be set as 00 in RS3 remote controller.

Note : Granting outdoor unit and indoor unit number

If the outdoor unit product is Multi V, it is recommended to set the first digit of the address as the outdoor unit number, and classify the second digit as the indoor unit number, so that the system composition and division can be easily identified during the address setting.

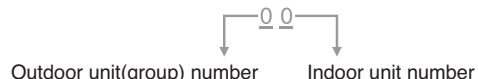

Note : Setting method of indoor unit central control address

The central control address setting method may be different according to the indoor unit product or remote controller type, so proceed the address setting by referring to the indoor unit product or wired remote controller manual.

Installation of the product and connection of RS485 communication line

Installing the product

Method for installing and cabling Cloud Gateway is as follows.

1. Decide where to install Cloud Gateway.
 - Before fixing it to the wall, check if it is a suitable location to connect it, RS485 cable, power cable, and ethernet cable.

NOTE :

When installing turn off the power of the product connecting with Cloud Gateway. Cloud Gateway failure may occur when installing it with the connected product powered on.

2. Fix the wall installation plate of Cloud Gateway on the wall.

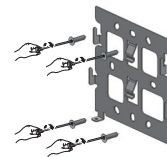

3. Connect RS485 cable located at the backside of Cloud Gateway main unit to RS485 terminal.

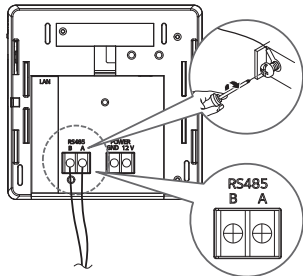

4. Connect the Ethernet cable to the LAN port on the back of Cloud Gateway's main unit.

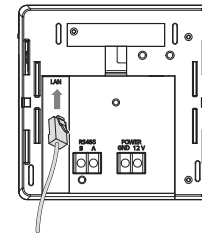

5. Connect the 12V power supplied through the outdoor unit to the power terminal located at the back of Cloud Gateway's main unit.

Remove the sheath using the guide as shown in the following figure during the T/B wiring, and then insert a short protecting sleeve into the O-ring or U-terminal to wiring.

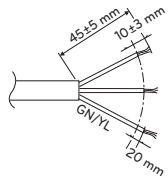

<Sheath removal guide>

Max 1,000m, 2 cores,
1.0 mm², shielded cable

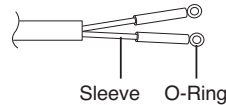

<Application appearance of O-Ring and sleeve>

⚠ CAUTION

Since RS485 communication cable connection has polarity, be careful not to reverse the connections of two lines.

When connecting the wire in reclamation structure, be careful of the bending of RS485 communication cable.

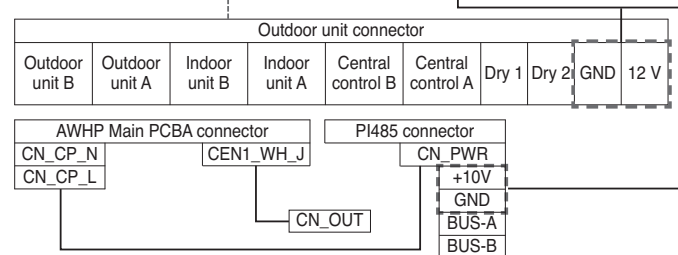
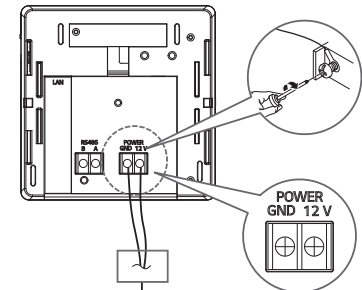

6. Match the groove of the product to the hook of the wall installation plate installed on the wall.

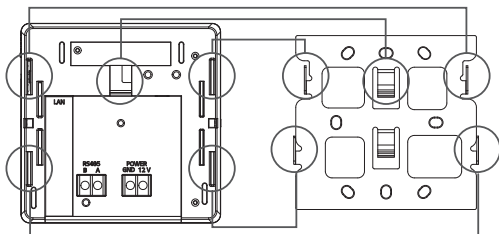

7. Lower the product to lock the hook. Fix the installation plate and product through Cloud Gateway fixing screws after locking.

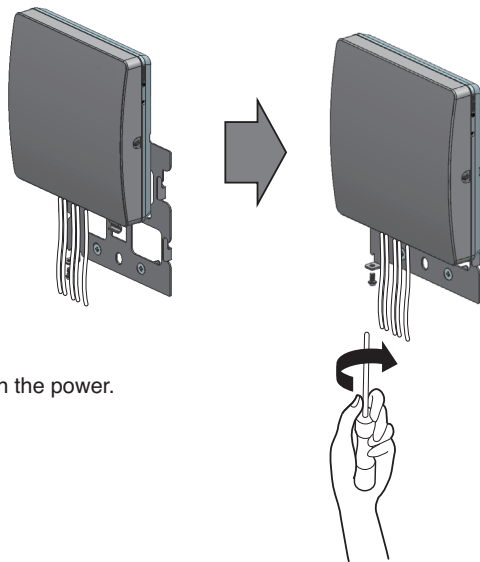

8. Turn on the power.

Search for the device

Search for the device

Search for the installed device (indoor unit, ventilation, THERMA V) and display the number of devices searched with LED.

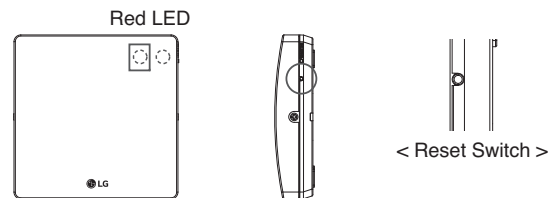

- 1) When Cloud Gateway is powered on, it automatically initiates the device search.
- 2) After 30 seconds, the device search is completed, and turns off after blinking LED as many as the number of devices found.
ex. 3 units of installation device → Turns off after blinking LED 3 times

NOTE :

Proceed with 'product registration' step after completing the search of the device.

When the device search step is not completed and the next step is carried out, it will cause malfunction.

When the LED does not blink as much as the number of device connections, check the installation status of the device.

The reset switch allows to restart searching of devices by resetting the power.

Install the ThinQ app and register the account

Refer to the 'Connecting LG ThinQ and LG Electronics' manual attached in the page for the account registration method and ThinQ app installation.

Registering the product

- Check the product registration method according to the smart phone OS. Some screens may be different from the actual application screen.
- App image may vary depending on the ThinQ app version,
- When log in, press the product registration menu (+) on the main screen and select Cloud Gateway.

Connect the products to the network (Use wired)

- Verify that the Cloud Gateway is wired to the router.
- Press the register button on the side of the cloud gateway for at least 3 seconds.
- Please select the network to which the cloud gateway is connected in the smartphone's Wi-Fi settings.
- Click start search to display the connecting cloud gateway and select it to complete the network connection.

Connect the products to the network (Use wireless)

- Verify that the cloud gateway is wired to the router.
- Press the register button on the side of the cloud gateway for at least 3 seconds. The product's front LED blinks to verify that Wi-Fi connection is ready.
- Select the network to connect the cloud gateway to from the list of networks displayed in the app.
- Enter the password for the selected network (Router) and click Connect to complete the network connection.

Synchronize product connection information

- It is able to check the number of device available to connect to the cloud gateway.
- By clicking next the app will send and receive information with the cloud gateway.
- The app sends and receives product information and registers product information on the server.
- Once the product information is registered on the server, you can check the registered cloud gateway and connected device information on the main page of the app.
- The status display LED (red) of the cloud gateway is lighted and remains lighted while the server is connected.

Add product and check setting

- Click on the cloud gateway on the main page to check the connected device information.
- Addition of device and cloud gateway settings can be checked/changed via the top right screen, addition of products and Cloud Gateway Settings menu.

Controlling device via ThinQ

Control/ monitoring functions

The device control and information can be monitored via ThinQ app. Click Cloud Gateway on the main page to check the connected device information.

The controllable items and condition information can be checked by selecting the device that you want to check the control and details. Refer to the [Instructions] of ThinQ app for device control/ monitoring functions and instructions via ThinQ app.

Depending on the model, some functions may not work, and depending on the version of the ThinQ app, the image may vary.

When interlocking BECON cloud

To interlock the BECON cloud, you need to set it up through a separate PC program.

Refer to the latest technical information for installation.

For the cloud gateway, address 00~0F is set as default setting.

When interlocking BECON cloud, you must delete the uninstalled device and install.

⚠ CAUTION

The address must be set via separate PC program in order to use an address outside the default setting.

The address 10~FF cannot be used as a device address of indoor unit, ventilation, THERMA V.

Wired LAN connection

PC program setting

- Check again connecting the PC to the same router (or hub) of Cloud gateway
- Install and run PC program. (Please ask LGE administrator to download it.)
- Press and hold the Register button for 3 seconds.
- Click “the magnifying glass” button to find Cloud gateway automatically.
- Click the “setup” button. The login screen address of indoor unit, ventilation, THERMA V.

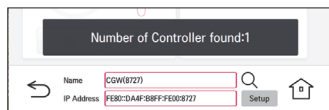

- There is no default password. Input the password and click apply. (Remember password)

Device setting

- Log in and click “Setting”.
- Click “Install”.
- Click “Device Management”.

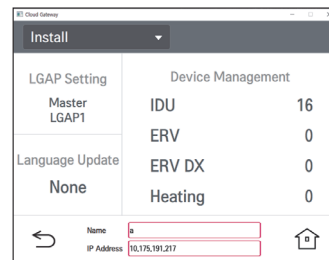

- Click “Edit”.
- Choose device to be deleted. Click “Del” button.
- Click “Complete” button.

TMS setting

- Go back to the “Setting” display. Click “System” button.
- Click “TMS” and go into “TMS” setting.
- Make “TMS configuration” to “ON”. Click “Site Information”.

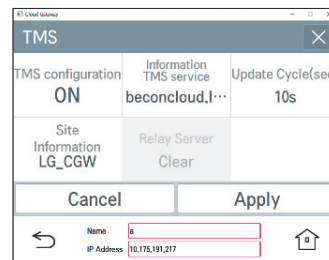

- Input "Site Address" and "Site Name". Click "Request Code" button. (Do not input "Site Code".)
- Then you can see "Site Code" is generated in the blank box.
- Click "Apply". And go back initial page and close PC program.
- Disconnect PC to Cloud Gateway
- Installer send "the site code" and "account of engineer" to be connected to Center Manager by phone, email, text message etc.
- After center manager's approval, installer can access to the new site.

NOTE :

- Site Code is generated automatically by TMS server if the connect is made correctly.
- Site Code is generated by the combination of "Site Address" and "Site Name"
- Site Address can be searchable in google map.
- General Site Name should be avoided such as "AWHP".
Unique site name is recommended.

Wireless LAN connection

- Connect the PC to Cloud gateway directly
- Execute above Device setting and TMS setting.
- Go back to the "Setting" display. Click "System" button.
- Click "Wi-Fi" and insert Wi-Fi information(whether to use, ssid, security, password)

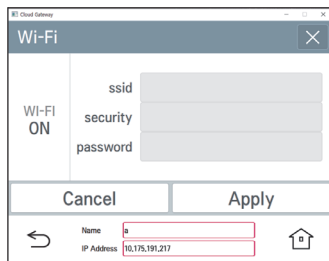

Open source software guide

To obtain a developer source code for this product with on-board GPL, LGPL, MPL or other open source license, visit <http://opensource.lge.com>.

You can download the source code, content of all relevant licenses, copyright notice, and a mark indicating that we bear no responsibility for the code.

If you request the open source codes for the software installed in this product by sending an e-mail to opensource@lge.com within 3 years after the purchase of the product, the code will be provided in CD-ROM for a minimum fee used to cover the costs of the media and shipping.

Wireless Product Specifications

Frequency range	2412 MHz - 2472 MHz
Output Power(Max)	18.12 dBm

Things to Check before Reporting Problems

When there is a problem with the product

When there is a problem with the product, please check the following cases before requesting to the service center.

Symptom	OK	Actions
“Product registration failed or product failed” message is displayed during product registration procedure in ThinQ app.	<ul style="list-style-type: none"> * Check the router setting 1) 5GHz setting 2) Signal strength (Less than -60db) 3) Security method (OPEN, WEP) 4) Incorrect password entry 	Setting the IP router 1) 2.4 GHz setting 2) Wireless signal strength is at least more than -60db 3) Security method change : WPA 4) Password check (English, number, some special characters)
Disconnection frequently occurs when using.	<ul style="list-style-type: none"> 1) Check whether the red LED of Cloud Gateway is lighted. 2) Check Wi-Fi signal strength 3) Internet communication inspection 	When Cloud Gateway LED is off, there may be a problem with internet connection. 1) Try resetting Cloud Gateway using the reset button. 2) Try resetting the power of the router. 3) When continuous connection is not available Check that the Smartphone has an internet connection through the router. When there is no connection, request a router and internet inspection.



Disposal of your old appliance

1. This crossed-out wheeled bin symbol indicates that waste electrical and electronic products (WEEE) should be disposed of separately from the municipal waste stream.
2. Old electrical products can contain hazardous substances so correct disposal of your old appliance will help prevent potential negative consequences for the environment and human health. Your old appliance may contain reusable parts that could be used to repair other products, and other valuable materials that can be recycled to conserve limited resources.
3. You can take your appliance either to the shop where you purchased the product, or contact your local government waste office for details of your nearest authorised WEEE collection point. For the most up to date information for your country please see www.lg.com/global/recycling



Disposal of waste batteries/accumulators

1. This symbol may be combined with chemical symbols for mercury (Hg), cadmium (Cd) or lead (Pb) if the battery contains more than 0.0005% of mercury, 0.002% of cadmium or 0.004% of lead.
2. All batteries/accumulators should be disposed separately from the municipal waste stream via designated collection facilities appointed by the government or the local authorities.
3. The correct disposal of your old batteries/accumulators will help to prevent potential negative consequences for the environment, animal and human health.
4. For more detailed information about disposal of your old batteries/ accumulators, please contact your city office, waste disposal service or the shop where you purchased the product.
(<http://www.lg.com/global/sustainability/environment/take-back-recycling/global-network-europe>)

Disposal of Waste Batteries

- All batteries should be disposed separately from the municipal waste stream via designated collection facilities appointed by the government or the local authorities.
- The correct disposal of your old batteries will help to prevent potential negative consequences for the environment, animal and human health.
- For more detail information about disposal of your old batteries, please contact your city office, waste disposal service or the shop where you purchased the product. Also You can contact our LG Support Representative Call center from below Link https://www.lg.com/sa_en/support/contact/telephone
- ✳ The above information applies only to Saudi Arabia.

التخلص من مخلفات البطاريات

- يجب التخلص من جميع البطاريات بشكل منفصل عن مجاري النفايات البلدية عن طريق مرافق الجمع المعينة التي تعينها الحكومة أو السلطات المحلية.
- يساعد التخلص الصحيح من البطاريات القديمة في منع الآثار السلبية المحتملة على البيئة وصحة الحيوان والبشر.
- لمزيد من المعلومات التفصيلية حول التخلص من البطاريات القديمة ، يرجى الاتصال بمكتب خدمة التخلص من النفايات في ميندنيك أو المتجر الذي اشتريته منه المنتج.
- كما يمكنك الاتصال بمركز اتصال ممثل دعم LG عن طريق الدخول على الرابط التالي https://www.lg.com/sa_en/support/contact/telephone
- تطبيق المعلومات الواردة أعلاه فقط على المملكة العربية السعودية.
- Safely dispose of all materials in accordance with federal/state/local laws or ordinances.
- التخلص الآمن من كافة المواد بما يتوافق مع القوانين والأوامر المحلية

Disposal of your old appliance (as per e-waste Rules)



1. When this crossed out wheeled bin symbol is depicted on the product and its operator's manual, it means the product is covered by the e-waste Management and Handling Rules , 2011 and are meant to be recycled, dismantled, refurbished or disposed off.
 2. **Do's**
 - a. The product is required to be handed over only to the authorized recycler for disposal.
 - b. Keep the product in isolated area, after it becomes non-functional/unreparable so as to prevent its accidental breakage.
 2. **Don't**
 - a. The product should not be opened by the user himself/herself, but only by authorized service personnel.
 - b. The product is not meant for re-sale to any unauthorized agencies/scrap dealer/kabariwalah.
 - c. The product is not meant for mixing into household waste stream.
 - d. Do not keep any replaced spare part(s) from the product in exposed area.
 3. Any disposal through unauthorized agencies/person will attract action under Environment (Protection) Act 1986.
 4. This product is complied with the requirement of Hazardous Substances as specified under Rule 13 (1) & (2) of the E-Waste (Management & Handling) Rules, 2011.
 5. To locate a nearest collection centre or call for pick-up (limited area only) for disposal of this appliance, please contact Toll Free No. **1800-180-9999** for details. All collection centre and pick up facilities are done by third parties with **LG Electronics India Ltd.** Merely as a facilitator. For more detailed information , please visit : <http://www.lge.com/in>.
- ✳ The above information applies only to India.

Recycling Info.
EPR registration number :
11595375254588000000



अपने पुराने नपिटान के उपकरण (ई-अपशष्टि नयिम के अनुसार)



1. जब इस काटे गए पहिये वाले बति का चन्हि कसि उपकरण और इसके ओपरेटर के साथ संलग्न होता है तो इसका मतलब है कि इसे 'ई-अपशष्टि' (एवरेधन और इथालन) नयिम २०११ के अंतर्गत सममलिति कथिा गया है , और इसे नवीनीकरणकलन ,वधेधन और नपिटान के लिये बनाया गया है ।
 2. **करे**
 - क . उपकरण को सरिफ अधकित पुन: नवीनीकरणकर्ता को ही नपिटारन करने हेतु हसुतानतर किये ।
 - ख . जब उपकरण करयतर न हो इसे अलग कषेत्र में रखे ताकि उपकरण से होने वाली दुरघटनाओ से बचा जा सके ।
 2. **न करे**
 - क . इस उपकरण को स्वयं/बुद नहीं खोलना चाहिये ! उपकरण को केवल अधकित अधकिकरी के द्वारा ही खोलना जाना चाहिये ।
 - ख . इस उपकरण को पुन: बकिकरी के लिये कसि भी कवाडीवालना / अंगार-वालना / अनाधकित संस्था को न दे ।
 - ग . इस उपकरण को कसि घरेलू अपशष्टि सामान के साथ मलिकर न रखे ।
 - घ . उपकरण के बदले हुए या आंतरकिये पुरजे को खुले कषेत्र में न रखे ।
 3. यदि कसि अनाधकित वधियग या वयकतके द्वारा नपिटारन कथिा जाता है तो यह पर्यावरण (सुरक्षा) धारा 1९८६ के अंतर्गत आता है ।
 4. यह जल्पाद ई-अपशष्टि (एवरेधन और इथालन) नयिम 2011 के अंतर्गत 13(1) एवं (2) के तहत नरिदधिये खतरनाक पदार्थो को आवरक्षकता का पालन करता है ।
 5. उपरोक्त पदार्थो के नपिटारन के लिये नजदीकी नपिटारन संस्थान (संकीरण कषेत्र) में कौल करे। अधकित जानकारी के लिये हमारे टोल फ्री नंबर **1800-180-9999** पर कौल करे. सभी संसंरक्षण केंटर व पकि-अप की सुवधिये कसि थर्ड- पार्टी जो "LG Electronics India Ltd." को अपनी सेवार पददान कर रही हों, से करवाए ।
ज्यादा जानकारी के लिये देखे वेब:साईट - <http://www.lge.com/in>
- ✳ अपर दी गई जानकारी केवल भारत पर लागू होती है।

Declaration of Conformity

EN



Hereby, LG Electronics declares that the radio equipment type Cloud Gateway is in compliance with Directive 2014/53/EU. The full text of the EU declaration of conformity is available at the following internet address: <http://www.lg.com/global/support/cedoc/cedoc#>

Declaración de conformidad

ES



Por la presente, LG Electronics declara que el equipo de radio tipo Cloud Gateway cumple las disposiciones de la Directiva 2014/53/UE. El texto completo de la declaración de conformidad de la UE está disponible en el siguiente sitio web: <http://www.lg.com/global/support/cedoc/cedoc#>

Декларация за съответствие

BG



С настоящото LG Electronics декларира, че радиооборудването от тип Cloud Gateway е в съответствие с Директива 2014/53/ЕС. Пълният текст на декларацията за ЕС съответствие е налична на следния интернет адрес: <http://www.lg.com/global/support/cedoc/cedoc#>

Vastusdeklaratsioon

ET



Käesolevaga deklareerib LG Electronics, et raadioseadmete tüüp Cloud Gateway vastab direktiivile 2014/53/EL. ELi vastusdeklaratsiooni täielik tekst on saadaval järgmisel Interneti-aadressil: <http://www.lg.com/global/support/cedoc/cedoc#>

Prohlášení o shodě

CZ



Tímto společnost LG Electronics prohlašuje, že rádiové zařízení typu Cloud Gateway je v souladu se směrnicí 2014/53/EU. Uplněné znění prohlášení o shodě je k dispozici na internetové adrese: <http://www.lg.com/global/support/cedoc/cedoc#>

Vaatumustenmukaisuusvakuutus

FI



LG Electronics täten ilmoittaa, että radiolaitteeksi luokiteltava Cloud Gateway on direktiivin 2014/53/EU mukainen. Täydellinen teksti EU:n vaatimustenmukaisuustodistuksesta löytyy seuraavasta internetosoitteesta: <http://www.lg.com/global/support/cedoc/cedoc#>

Overensstemmelseserklæring

DA



LG Electronics erklærer herved, at Cloud Gateway med indbygget radioudstyr er i overensstemmelse med direktivet 2014/53/EU. EU-overensstemmelseserklæringens fulde ordlyd kan findes på følgende internetadresse: <http://www.lg.com/global/support/cedoc/cedoc#>

Déclaration de conformité

FR



Par la présente, LG Electronics déclare que le type d'équipement radio Cloud Gateway est conforme à la directive 2014/53/UE. Le texte intégral de la déclaration de conformité UE est disponible à l'adresse Internet suivante : <http://www.lg.com/global/support/cedoc/cedoc#>

Konformitätserklärung

DE



Hiermit erklärt LG Electronics, dass das Funkgerät vom Typ Cloud Gateway der Richtlinie 2014/53/EU entspricht. Der vollständige Text der EU-Konformitätserklärung ist unter der folgenden Internetadresse verfügbar: <http://www.lg.com/global/support/cedoc/cedoc#>

Dearbhú Comhréireachta

GA



Leis seo, fógraíonn LG Electronics go bhfuil an trealamh raidió Cloud Gateway i gcomhréir le Treoir 2014/53/EU. Tá téacs iomlán an dhearbhairthe comhréireachta ar fáil ag an seoladh idirlín a leanas: <http://www.lg.com/global/support/cedoc/cedoc#>

Δήλωση συμμόρφωσης

EL



H LG Electronics δια της παρούσης δηλώνει ότι ο ραδιοεπιλασμός τύπου μοντέμ Cloud Gateway είναι σε συμμόρφωση με την Οδηγία 2014/53/ΕΕ. Το πλήρες κείμενο της δήλωσης συμμόρφωσης ΕΕ είναι διαθέσιμο στην ακόλουθη διαδικτυακή διεύθυνση: <http://www.lg.com/global/support/cedoc/cedoc#>

Izjava o sukladnosti

HR



Ovime LG Electronics izjavljuju da je radijska oprema tipa Cloud Gateway uskladená s direktivom 2014/53/EU. Puni tekst izjave o sukladnosti za EU dostupan je na sljedećoj internetskoj adresi: <http://www.lg.com/global/support/cedoc/cedoc#>

Megfelelőségi tanúsítvány



Ezennel az LG Electronics kijelenti, hogy a Cloud Gateway rádióberendezés megfelel az 2014/53/EU irányelv előírásainak. Az EU megfeleléségi nyilatkozat teljes szövege elérhető a következő internetes címen: <http://www.lg.com/global/support/cedoc/cedoc#>

HU

Conformiteitsverklaring



Hierbij verklaart LG Electronics dat de radioapparatuur van het type Cloud Gateway voldoet aan de richtlijn 2014/53/EU. De volledige tekst van de EU-conformiteitsverklaring is beschikbaar op het onderstaande internetadres: <http://www.lg.com/global/support/cedoc/cedoc#>

NL

Dichiarazione di conformità



Con la presente, LG Electronics dichiara che l'apparato radio di tipo Cloud Gateway è in regola con la Direttiva 2014/53/UE. Il testo completo della dichiarazione di conformità UE è disponibile al seguente indirizzo internet: <http://www.lg.com/global/support/cedoc/cedoc#>

IT

Samsvarserklæring



LG Electronics erklærer herved at radiostyret av typen Cloud Gateway overholder Direktiv 2014/53/EU. Den fulle teksten til erklæringen om EU-konformitet er tilgjengelig på den følgende adressen: <http://www.lg.com/global/support/cedoc/cedoc#>

NO

Atitikties deklaracija



Šiuo dokumentu „LG Electronics“ pareiškia, kad radijo įranga, tipas „Cloud Gateway“, atitinka Direktyvą 2014/53/ES. Visas ES atitikties deklaracijos tekstas pateikiamas toliau nurodytu interneto adresu: <http://www.lg.com/global/support/cedoc/cedoc#>

LT

Deklaracja zgodności



Niniejszym LG Electronics deklaruje, że typ modemu radiowego Cloud Gateway jest zgodny z Dyrektywą 2014/53/WE. Pełna treść deklaracji zgodności WE jest dostępna na stronie: <http://www.lg.com/global/support/cedoc/cedoc#>

PL

Atbilstības deklarācija



Ar šo LG Electronics paziņo, ka radioierīce Cloud Gateway atbilst Direktīvas 2014/53/ES prasībām. ES atbilstības deklarācijas pilns teksts ir pieejams interneta vietnē <http://www.lg.com/global/support/cedoc/cedoc#>

LV

Declaração de conformidade



Pelo presente, a LG Electronics declara que o tipo de equipamento rádio, Cloud Gateway, está em conformidade com a diretiva 2014/53/UE. O texto completo da declaração de conformidade da UE está disponível no seguinte endereço da internet: <http://www.lg.com/global/support/cedoc/cedoc#>

PT

Декларација за усогласеноста



Со ова, LG Electronics изјавува дека типот на радио опремата за Cloud Gateway е во согласност со Директивата 2014/53/EU. Целосниот текст на ЕУ декларацијата за сообразност е достапен на следната интернет адреса: <http://www.lg.com/global/support/cedoc/cedoc#>

MK

Declarație de conformitate



Prin prezentul document, LG Electronics declară că echipamentul radio de tip Cloud Gateway respectă Directiva 2014/53/UE. Întreaga declarație de conformitate este disponibilă la următoarea adresă de internet: <http://www.lg.com/global/support/cedoc/cedoc#>

RO

Dikjarazzjoni ta' Konformità



Hawnhekk, i-LG Electronics tidjikkjara li t-tagħmir tar-radju ta-t-tip Cloud Gateway huwa konformi mad-Direttiva 2014/53/UE. It-test sħih tad-dikjarazzjoni ta' konformità ta-UE huwa disponibbli fi-indirizz ta-internet li ġej: <http://www.lg.com/global/support/cedoc/cedoc#>

MT

Prehlásenie o zhode



Spoločnosť LG Electronics týmto vyhlasuje, že typ rádiového zariadenia Cloud Gateway je v súlade s požiadavkami Smernice č. 2014/53/EU. Úplné znenie Vyhĺásenia o zhode EÚ je k dispozícii na tejto internetovej adrese: <http://www.lg.com/global/support/cedoc/cedoc#>

SK

Izjava o skladnosti



S tem, LG Electronics izjavlja, da je radijska oprema vrste Cloud Gateway v skladu z direktivo 2014/53/EU. Celotno besedilo EU deklaracije o ustreznosti je na voljo na naslednjem internetnem naslovu: <http://www.lg.com/global/support/cedoc/cedoc#>

SL

Wireless function S/W version: V 1.0 / Безжична функција S/W верзија: V 1.0 / Verze softwaru bezdrátové funkce: V 1.0 / Softwareversion til trådløs funktion: V 1.0 / Drahtlosfunktion Software-Version: V 1.0 / Έκδοση λογισμικού ασύρματης λειτουργίας : V 1.0 / Version de software de la función inalámbrica: V 1.0 / Juhthmevaba funktsiooni S/W versioon: V 1.0 / Langattoman toiminnon S/W versio: V 1.0 / Version S/W de la fonction sans fil : V 1.0 / Feidhgh gan Sreang S/W leagan : V 1.0 / Verzija softvera bežične funkcije: V 1.0 / Vezeték nélküli funkció szoftver verzió: V 1.0 / Funzione Wireless S/W versione: V 1.0 / Belaidé funkcia S/W versija: V 1.0 / Bezvadu funkcijas programmas versija : V1.0 / Безжична функција S/W верзија: V 1.0/ Funzioni wireless verzijoni S/W : V 1.0 / Draadloze functie S/W-versie: V 1.0 / Trådløs funksjon S/W versjon : V 1.0 / Oprogramowanie funkcji bezprzewodowej wer.: V 1.0 / Versão S/W da função sem fios: V 1.0 / Functia wireless S/W versiunea : V 1.0 / Funkcia wireless S/W verzia: V 1.0 / Različica programske opreme za brezžično funkcijo: V1.0 / Funkzioni wireless (pa lidhje kablore) S/W version: V 1.0 / Verzija softvera bežične funkcije: V 1.0 / Trådløs funtion S/W version : V 1.0 / Verzija softvera bežične funkcije: V 1.0

Deklarata e pajtimt



Me anë të këtyh dokumente, LG Electronics deklarom se pajisja radiofonike e tipit Cloud Gateway është në përputhje me Direktivën 2014/53/BE. Teksti i plotë i deklaratës së konformitetit të BE-së gjendet në adresën e mëposhtme: <http://www.lg.com/global/support/cedoc/cedoc#>

SQ

For consideration of the user, this device should be installed and operated with a minimum distance of 20 cm between the device and the body. / C отпад безбедноста на потребителja, това устројство треба да биде инсталирано и оперирано от минимално растојание 20 cm между него и телото. / S ohledem na uživatele by se toto zařízení mělo instalovat a provozovat tak, aby byla minimální vzdálenost mezi zařízením a tělem alespoň 20 cm. / Af hensyn til brugerens sikkerhed skal dette apparat installeres og betjenes med en minimumsafstand på 20 cm mellem apparatet og kroppen. / Zur Rücksichtnahme auf den Nutzer, sollte dieses Gerät mit einem Abstand von mindestens 20 cm zwischen dem Gerät und dem Körper installiert und betrieben werden. / Πληροφορικά για το χρήστη, αυτή η συσκευή θα πρέπει να εγκαταστήσει να λειτουργήσει με μια ελάχιστη απόσταση 20 cm μεταξύ της συσκευής και του σώματος. / El usuario ha de tener en cuenta que el dispositivo deberá ser instalado y funcionar con una distancia mínima de 20 cm entre el mismo y el cuerpo. / Kasutaja peaks arvestama, et see seade tuleks paigaldada ja sellega töötada nii, et hoiakse minimaalne seadme ja keha vaheline vahemaad 20 cm juures. / Käytäjän huomioimiseksi, laite tulee asentaa ja sitä tulee käyttää 20 cm:n minimietäisyyden päässä varustalta. / À l'égard de l'utilisateur, cet appareil doit être installé et utilisé à une distance minimale de 20 cm entre l'appareil et le corps. / Ar mhaithe leis an úsáid, ba chóir an gléas seo a shuiteáil agus a oibriú ar a laghad 20 cm ó do chorp. / Za razmatranje korisnika, ovaj uređaj treba postaviti i njime upravljati s udaljenosti od najmanje 20 cm od tijela. / A felhasználónak vigyázni kell, hogy ezt a készüléket úgy kell telepíteni és üzemeltetni egy legalább 20 cm távolságot biztosítsanak a készülék és a test között. / Si consiglia agli utenti di installare questo dispositivo ad una distanza minima di 20 cm tra il dispositivo e il corpo. / Vartotojas turi sumontuoti ir eksploatuoti šį įrenginį mažiausiai 20 cm. Nuo įrenginio ir korpuso. / Lietotāja izvērtēšanai, šī ierīce jāuzstāda un jādarbina, ievērojot minimālo distanci 20 cm starp ierīci un ķermeni. / Заради грижата за корисничот, овој уред треба да се инсталира и да работи на минимална далечина од 20 cm меѓу уредот и телото на корисничот. / Ghall-konsiderazzjoni tal-utent, dan it-tagħmir għandu jigi installat u mħaddem b'distanza ta' mhux inqas minn 20 cm bejn l-apparat u l-persuna. / Het is in het belang van de gebruiker dat dit apparaat geïnstalleerd en gebruikt wordt met een minimale afstand van 20 cm tussen het apparaat en het lichaam. / For hensynet til brukeren, bør denne enheten bli installert og brukt med en avstand på minimum 20 cm mellom apparatet og kroppen. / Zaleca się montaż oraz obsługa urządzenia z odległości co najmniej 20 cm. / Para consideração do utilizador, este dispositivo deve ser instalado e operado com uma distância mínima de 20 cm entre o dispositivo e o corpo. / Utilizatorul trebuie să țină cont de faptul că acest dispozitiv trebuie instalat și utilizat cu o distanță minimă de 20 cm între dispozitiv și corp. / Poznámka pro používatele: toto zařízení by se malo montovat a využívat v minimální vzdálenosti 20 cm mezi zařízením a tělem. / Ob upoštovanju varnosti uporabnika je napravno treba namestiti in upravljati tako, da je med napravo ter telesom najmanj 20 cm. / Për konsideratën e përdoruesit, kjo pajisje duhet të instalohet dhe operohet nga një distancë minimale prej 20 cm mes pajisjes dhe trupit. / Korisnik treba da ima na umu da ovaj uređaj treba postaviti i njime upravljati sa udaljenosti od najmanje 20 cm od tela. / Med hänsyn till användaren, bör denna apparat installeras och drivas med en distans på åtminstone 20 cm mellan apparaten och kroppen. / Korisnik treba znati da ovaj uređaj treba postaviti i njime upravljati sa minimalne udaljenosti od 20 cm između uređaja i tijela.

Izjava o uskladenosti



Ovime LG Electronics izjavljuje da je radio oprema u vidu Cloud Gateway uskladena s direktivom 2014/53/EU. Celokupni tekst izjave o uskladenosti za EU nalazi se na sledećoj internet adresi: <http://www.lg.com/global/support/cedoc/cedoc#>

SR

For consideration of the user, this device should be installed and operated with a minimum distance of 20 cm between the device and the body. / C отпад безбедноста на потребителja, това устројство треба да биде инсталирано и оперирано от минимално растојание 20 cm между него и телото. / S ohledem na uživatele by se toto zařízení mělo instalovat a provozovat tak, aby byla minimální vzdálenost mezi zařízením a tělem alespoň 20 cm. / Af hensyn til brugerens sikkerhed skal dette apparat installeres og betjenes med en minimumsafstand på 20 cm mellem apparatet og kroppen. / Zur Rücksichtnahme auf den Nutzer, sollte dieses Gerät mit einem Abstand von mindestens 20 cm zwischen dem Gerät und dem Körper installiert und betrieben werden. / Πληροφορικά για το χρήστη, αυτή η συσκευή θα πρέπει να εγκαταστήσει να λειτουργήσει με μια ελάχιστη απόσταση 20 cm μεταξύ της συσκευής και του σώματος. / El usuario ha de tener en cuenta que el dispositivo deberá ser instalado y funcionar con una distancia mínima de 20 cm entre el mismo y el cuerpo. / Kasutaja peaks arvestama, et see seade tuleks paigaldada ja sellega töötada nii, et hoiakse minimaalne seadme ja keha vaheline vahemaad 20 cm juures. / Käytäjän huomioimiseksi, laite tulee asentaa ja sitä tulee käyttää 20 cm:n minimietäisyyden päässä varustalta. / À l'égard de l'utilisateur, cet appareil doit être installé et utilisé à une distance minimale de 20 cm entre l'appareil et le corps. / Ar mhaithe leis an úsáid, ba chóir an gléas seo a shuiteáil agus a oibriú ar a laghad 20 cm ó do chorp. / Za razmatranje korisnika, ovaj uređaj treba postaviti i njime upravljati s udaljenosti od najmanje 20 cm od tijela. / A felhasználónak vigyázni kell, hogy ezt a készüléket úgy kell telepíteni és üzemeltetni egy legalább 20 cm távolságot biztosítsanak a készülék és a test között. / Si consiglia agli utenti di installare questo dispositivo ad una distanza minima di 20 cm tra il dispositivo e il corpo. / Vartotojas turi sumontuoti ir eksploatuoti šį įrenginį mažiausiai 20 cm. Nuo įrenginio ir korpuso. / Lietotāja izvērtēšanai, šī ierīce jāuzstāda un jādarbina, ievērojot minimālo distanci 20 cm starp ierīci un ķermeni. / Заради грижата за корисничот, овој уред треба да се инсталира и да работи на минимална далечина од 20 cm меѓу уредот и телото на корисничот. / Ghall-konsiderazzjoni tal-utent, dan it-tagħmir għandu jigi installat u mħaddem b'distanza ta' mhux inqas minn 20 cm bejn l-apparat u l-persuna. / Het is in het belang van de gebruiker dat dit apparaat geïnstalleerd en gebruikt wordt met een minimale afstand van 20 cm tussen het apparaat en het lichaam. / For hensynet til brukeren, bør denne enheten bli installert og brukt med en avstand på minimum 20 cm mellom apparatet og kroppen. / Zaleca się montaż oraz obsługa urządzenia z odległości co najmniej 20 cm. / Para consideração do utilizador, este dispositivo deve ser instalado e operado com uma distância mínima de 20 cm entre o dispositivo e o corpo. / Utilizatorul trebuie să țină cont de faptul că acest dispozitiv trebuie instalat și utilizat cu o distanță minimă de 20 cm între dispozitiv și corp. / Poznámka pro používatele: toto zařízení by se malo montovat a využívat v minimální vzdálenosti 20 cm mezi zařízením a tělem. / Ob upoštovanju varnosti uporabnika je napravno treba namestiti in upravljati tako, da je med napravo ter telesom najmanj 20 cm. / Për konsideratën e përdoruesit, kjo pajisje duhet të instalohet dhe operohet nga një distancë minimale prej 20 cm mes pajisjes dhe trupit. / Korisnik treba da ima na umu da ovaj uređaj treba postaviti i njime upravljati sa udaljenosti od najmanje 20 cm od tela. / Med hänsyn till användaren, bör denna apparat installeras och drivas med en distans på åtminstone 20 cm mellan apparaten och kroppen. / Korisnik treba znati da ovaj uređaj treba postaviti i njime upravljati sa minimalne udaljenosti od 20 cm između uređaja i tijela.

Försäkran om överensstämmelse



LG Electronics informerar härmed att radio utrustningen, typ Cloud Gateway är i enlighet med Direktivet 2014/53/EU. Hela texten för EU-deklarationen gällande överensstämmelse, finns tillgänglig på följande internet adress: <http://www.lg.com/global/support/cedoc/cedoc#>

SV

Izjava o uskladenosti



Ovim, kompanija LG Electronics izjavljuje da je radio oprema tipa Cloud Gateway u skladu s Direktivom 2014/53/EU. Cijeli tekst EU izjave o uskladenosti dostupan je na sljedećoj internet adresi: <http://www.lg.com/global/support/cedoc/cedoc#>

BS

UK DECLARATION OF CONFORMITY



Hereby, LG Electronics declares that the radio equipment type Cloud Gateway is in compliance with the relevant statutory requirements. The full text of the UK declaration of conformity is available at the following internet address: <http://www.lg.com/global/support/cedoc/cedoc#>

LG Electronics EU Importer names and addresses / Имена и адреси на вносителите на LG Electronics в ЕС / Nazivi i adrese uvoznika LG Electronics u EU / Nazivi i adrese uvoznika LG Electronics u EU / Názvy a adresy dovozčů LG Electronics v EU / Navne og adresser på LG Electronics i EU / Namen und Adressen der LG Electronics EU-Importeure / Ονόματα και διευθύνσεις εισαγωγέων της LG Electronics EU / Nombres y direcciones de importadores para la UE de LG Electronics / LG Electronics EL maaletoajate nimed ja adressid / LG Electronics – EU-n maahantujien nimet ja osoitteet / Noms et adresses des importateurs pour LG Electronics EU / Ainmeacha agus seolairí Iompórtálaí AE LG Electronics / Nazivi i adrese uvoznika proizvođa tvrtke LG Electronics u Europskoj uniji / Az LG Electronics európai uniós importőreinek neve és címe / Nöfn og heimilisöfng LG Electronics innflytjenda innan ESB / Nomi e indirizzi degli importatori UE di LG Electronics / LG Electronics ES importuotojui pvadinimai ir adresai / LG Electronics ES importētāju nosaukumi un adreses / Имена и адреси на увозници на LG Electronics за ЕУ / LG Electronics: ismijiet u indirizzi tal-importatur tal-UE / Namen en adressen van importeurs voor LG Electronics EU / Navn og adresser for EU-importører for LG Electronics / Nazwy i adresy importerów produktów LG Electronics w Europie / Nomes e endereços dos importadores para LG Electronics EU / Numele și adresele importatorului UE al LG Electronics / Názvy a adresy dovozčů LG Electronics do EU / Imena in naslovi uvoznikov za LG Electronics EU / Emrat de adresat e importuesve të LG Electronics në BE / Nazivi i adrese EU uvoznika kompanije LG Electronics / Namn och adresser för LG Electronics EU-importörer

LG Electronics Benelux B.V.	Krijgsman 1, 1186 DM Amstelveen, The Netherlands
LG Electronics Deutschland GmbH	Alfred-Herrhausen-Allee 3-5, 65760, Eschborn, Germany
LG Electronics France, SAS	Immeuble Workstation, 25 quai du Président Paul Doumer, 92 400 Courbevoie, France
LG Electronics España S.A.U.	Calle Chile 1, 28290, Las Rozas, Madrid, Spain
LG Electronics Portugal S.A.	Taguspark, Av. Jacques Delors 3, Edifício Inovacao I, Corpo 1, 2740-122, Porto Salvo, Portugal
LG Electronics Hellas S.A.	Ethnarhou Makariou str. 1, 17501, Delta Paleo Faliro, Greece
LG Electronics Italia S.p.A.	Via Aldo Rossi 4, 20149, Milan, Italy
LG Electronics Latvia SIA	Gustava Zemgala gatve 74A, Rīga, LV-1039, Latvia
LG Electronics Magyar Kft.	Konyves K. krt.3/a., 1097, Budapest, Hungary
LG Electronics Polska Sp. z o.o.,	Wofoska 22, 02-675, Warszawa, Poland
LG Electronics Magyar Kereskedelmi Kft. Budapesta Sucursala București,	11-15, Tipografilor Street, S-Park Business Centre, Building B3, 5th Floor, District 1, 013714 Bucharest, Romania
LG Electronics Nordic AB	Esbogatan 18, 164 94, Kista, Sweden
LG Electronics Shared Services Center B.V.	Krijgsman 1, 1186 DM Amstelveen, The Netherlands

Depending on products or models, actual importers may be limited to some subsidiaries. For EU-produced units, there is no applicable EU importer. / В зависимости от продуктите или моделите действителните вносителите може да са ограничени до някои дъщерни дружества. За апарати, произведени в ЕС, няма приложим вносител в ЕС. / U zavisnosti od proizvoda ili modela, uvoznici mogu biti ograničeni na neka povezana društva. Za jedinice proizvedene u EU ne postoji važeći uvoznik iz EU. / U zavisnosti od proizvoda ili modela, uvoznici mogu biti ograničeni na određene podružnice. Za jedinice proizvedene u EU ne postoji EU uvoznik. / V závislosti na výrobchí nebo modelech mohou být aktuální dovozci omezeni na některé dceřiné společnosti. U výrobků vyráběných v EU není žádný relevantní dovozce do EU. / Afhangigt af produkt eller modeller kan de faktiske importører være begrænset til enkelte datterselskaber. For EU-fremstillede enheder er der ingen relevant EU-importør. / Je nach Produkt oder Modell können die tatsächlichen Importeure auf einige Tochtergesellschaften beschränkt sein. Für in der EU produzierte Geräte gibt es keinen anwendbaren EU-Importeur. / Ανάλογα με τα προϊόντα ή τα μοντέλα, οι πραγματικοί εισαγωγείς ενδέχεται να περιορίζονται σε ορισμένες θυγατρικές. Για μονάδες που παράγονται στην ΕΕ δεν υπάρχει ισχύων εισαγωγέας της ΕΕ. / Dependiendo de los productos o modelos, los importadores efectivos podrían quedar limitados a algunos subsidarios. Para las unidades producidas en la UE, no hay ningún importador para la UE aplicable. / Söltuvalt toodestes vii mudelitest võivad tegelikud maaletoojad olla piiratud mõnede tütarettevõtetega. EL-is toodetud seadmete puhul ei ole kohaldatavat EL maaletoojat. / Tuotteista tai malleista riippuen todelliset maahantuojaat voivat rajoittua muutamain tytäryhtiöihin. EU:ssa valmistetuilla laitteilla ei ole sovellettavaa EU:n maahantuoja. / Selon les produits ou les modèles, les importateurs effectifs peuvent être limités à certaines filiales. Pour les unités produites dans l'UE, il n'y a pas d'importateur applicable pour l'UE. / Ag brath ar thairgí nó múnlaí, d'headaí go mbeadh iompórtálaíthe iarmhír srianta go roinnt lochmhlachtaí. Maidir le aonaid déanta sa AE, níl iompórtálaí AE innfheidhme. / Ovisno o proizvodima ili modelima uvoznici mogu biti ograničeni na neke podružnice. Za uređaje proizvedene u Europskoj uniji nije predviđena tvrtka za uvoz iz EU. / A termékéktől vagy modellektől függően előfordulhat, hogy a tényleges importőrök egyes leányvállalatokra korlátozódnak. Az EU-ban gyártott készülékek esetében nincs vonatkozó európai uniós importőr. / Raunverulegjar framleiðendur geta verið takmarkaðir við tiltekin dótturfélög, en það fer eftir vörum eða vörumodelum. Engin ESB innflytjandi er fyrir hluti sem eru framleiðdir innan ESB. / A seconda dei prodotti o dei modelli, gli importatori effettivi potrebbero essere limitati ad alcune filiali. Per le unità prodotte nell'UE, non esiste un importatore UE applicabile. / Priklausomai nuo gaminių ar modelių, tikrieji importuotojai gali apsiriboti kai kuriomis dukterinėmis įmonėmis. ES pagamintiems vienetams nėra tinkamo ES importuotojo. / Atkarībā no produktiem vai modeļiem, faktiskie importētāji var būt dažādi meitasuzņēmumi. ES ražotām vienībām nav piemērojama ES importētāja. / Зависно од произвоците или моделите, актуелните увозници можеби се ограничени на некои подружници. За единиците произведени за ЕУ, нема применливи увозник за ЕУ. / Skont il-prodott jew il-modelli, l-importaturi attwali jistgħu jknu limitati għal ċerti sussidjarji. Għall-unitajiet prodotti fl-UE, m'hemm importatur applikabli tal-UE. /

Afhankelijk van de producten of modellen, kunnen de eigenlijke importeurs beperkt zijn tot enkele dochterondernemingen. Voor in de EU geproduceerde eenheden is er geen toepasselijke EU-importeur. / Afhangig af produkt eller modeller, kan faktiske importører være begrænset til enkelte datterselskaber. Det er ingen gjeldende EU-importør for EU-produserter enheter. / W zależności od produktów lub modeli, rzeczywiscy importeryz mogą polegac na swoich podmiotach zaleznych. W przypadku wyrobów produkowanych w UE nie ma odpowiedzialnego importera na region Unii. / Dependendo dos produtos ou modelos, os importadores existentes podem ser limitados a algumas filiais. Para as unidades produzidas na UE, não há nenhum importador da UE aplicável. / În funcție de produse sau modele, importatorii actuali ar putea fi limitați la anumite filiale. Pentru unitățile produse în UE, nu există niciun importator UE aplicabil. / V závislosti od výrobkov alebo modelov môžu byť skutoční dovozovia obmedzeni na niektoré dcérske spoločnosti. Pre zariadenia vyrobené v EU neexistuje žiadny príslušný dovozca do EÚ. / Ovisno od izdelkov ali modelov so lahko dejanski uvozniki omejeni na nekatere hčerinske družbe. Za enote, proizvedene v EU, ni ustreznega uvoznika iz EU. / Nė varėsi tė produktevo ose modelev, importuėstis aktual mud tė jėnė tė kufizuar vetėm nė disa degė. Pėr njsiėtic e produhuara nė BE, nuk ka importues tė zbatueshėm tė BE-sė. / U zavisnosti od proizvoda ili modela, stvarni uvoznici mogu biti ograničeni na neke podružnice. Za jedinice proizvedene u EU ne postoji merodavni EU uvoznik. / Berende på produkt eller modeller kan faktiska importörer vara begränsade till vissa dotterbolag. För EU-tillverkade enheter finns det ingen tillämplig EU-importör.

	①	②	③
ENGLISH	Single Contact Point	EU	Germany
ITALIANO	Punto di contatto unico	UE	Germania
ESPAÑOL	Punto de contacto único	UE	Alemania
FRANÇAIS	Point de contact unique	UE	Allemagne
DEUTSCH	Einheitliche Anlaufstelle	EU	Deutschland
ΕΛΛΗΝΙΚΑ	Ενιαίο σημείο επαφής	ΕΕ	Γερμανία
ČEŠTINA	Jednotné kontaktní místo	EU	Německo
NEDERLANDS	Eén enkel contactpunt	EU	Duitsland
POLSKI	Punkt kontaktowy	UE	Niemcy
LIMBA ROMÂNĂ	Punct unic de contact	UE	Germania
PORTUGUÊS	Ponto de contacto único	UE	Alemanha
MAGYAR	Egyetlen kapcsolattartó pont	EU	Németország
БЪЛГАРСКИ	Единна контактна точка	ЕС	Германия
SRPSKI	Jedinstvena kontaktna tačka	EU	Nemačka
HRVATSKI	Jedinstvena kontaktna točka	EU	Njemačka
SVENSKA	Enskild kontaktpunkt	EU	Tyskland
NORSK	Enkelt kontaktpunkt	EU	Tyskland
DANSK	Enkelt kontaktpunkt	EU	Tyskland
SLOVENČINA	Jednotné kontaktné miesto	EÚ	Nemecko
SLOVENŠČINA	Enotna kontaktna točka	EU	Nemčija
GAEILGE	Pointe Teagmhála Aonair	AE	an Ghearmáin
SHQIP	Pikë e vetme kontakti	BE	Gjermania
BOSANSKI	Jedinstvena kontaktna tačka	EU	Njemačka
EESTI KEEL	Üks kontaktpunkt	EL	Saksamaa
LATVIEŠU VALODA	Vienotais kontaktpunkts	ES	Vācija
LIETUVIŲ KALBA	Bendras kontaktas visiems	ES	Vokietija
MALTI	Punt ta' Kuntatt Uniku	UE	il-Ġermanja
МАКЕДОНСКИ	Единствена контакт точка	ЕУ	Германија

[For Equipment under battery regulation]



English

The battery is in compliance with the Regulation (EU) 2023/1542

Italiano

La batteria è conforme al Regolamento (UE) 2023/1542

Español

La pila cumple con el Reglamento (UE) 2023/1542

Français

La pile est conforme à la réglementation (UE) 2023/1542

Deutsch

Die Batterie entspricht der Verordnung (EU) 2023/1542

Ελληνικά

Η μπαταρία συμμορφώνεται με τον κανονισμό (ΕΕ) 2023/1542

Česky

Baterie odpovídá Nařízení (EU) 2023/1542

Nederlands

Deze accu voldoet aan de verordening (EU) 2023/1542

Polski

Bateria spełnia wymogi rozporządzenia (UE) 2023/1542

Română

Bateria este în conformitate cu Regulamentul (UE) 2023/1542

Português

A bateria está em conformidade com o Regulamento (EU) 2023/1542

Magyar

Az akkumulátor megfelel az (EU) 2023/1542 rendeletnek

Български

Батерията е в съответствие с Регламент (ЕС) 2023/1542

Srpski

Baterija je u skladu sa Uredbom (EU) 2023/1542.

Hrvatski

Baterija je u skladu s Uredbom (EU) 2023/1542.

Svenska

Batteriet överensstämmer med förordning (EU)

2023/1542

Norsk

Batteriet overholder forordningen (EU) 2023/1542

Dansk

Batteriet er i overensstemmelse med forordning (EU) 2023/1542

Eesti

Aku vastab määrusele (EL) 2023/1542

Malti

Il-batterija hija konformi mar-Regolament (UE) 2023/1542

Slovenčina

Batéria je v súlade s nariadením (EÚ) 2023/1542

Slovenščina

Baterija je v skladu z Uredbo (EU) 2023/1542.

Latviešu

Akkumulators ir atbilstīgs Regulai (ES) 2023/1542.

Lietuvių K.

Baterija atitinka Reglamentą (ES) 2023/1542

Gaeilge

Tá an cadhna i gcomhréir le Rialachán (AE)

2023/1542

Македонски

Батеријата е во согласност со Регулативата (ЕУ) 2023/1542.

Shqip

Bateria është në përputhje me Rregulloren (BE)

2023/1542

Bosanski

Baterija zadovoljava zahtjeve navedene u Propisu (EU) 2023/1542



Manufacturer :
LG Electronics Inc.
84, Wanam-ro, Seongsan-gu, Changwon-si, Gyeongsangnam-do, KOREA

UK Importer : LG Electronics U.K. Ltd
Velocity 2, Brooklands Drive, Weybridge, KT13 0SL