



LG Pra.L Derma LED Mask

Model name
BWL1



MBM67237037

1909_Rev03

Mask Band Wearing Guide (Optional)

If the Derma LED mask is not to fit into your face tightly, Wear the Derma LED mask by using a supplied mask band. Attach the band to the Derma LED mask as shown below.

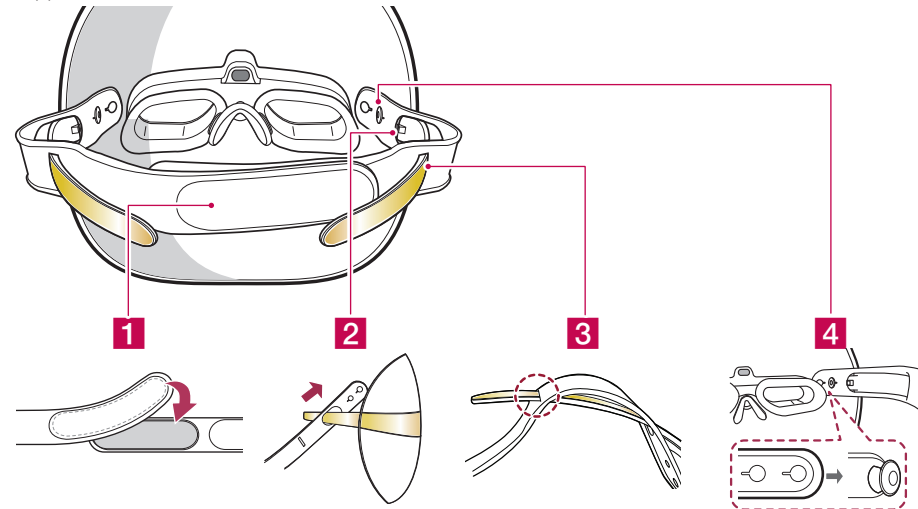

Put in the mask band in the same way on the other eye frame's leg.

- Adjust the hook to fit size of head and Insert the band as shown. If you feel pressure during band wear, loosen the band.
- When using the mask in a lying position, it is recommended that use the mask without wearing the mask band.

How to use



Use unit once per day



Use your previously used cosmetics or cosmetics for your skin type

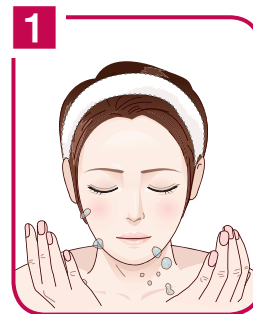

Wash the face.



Apply the appropriate
lotion to your skin.

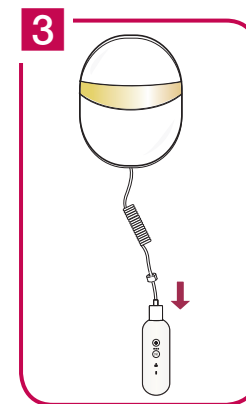

Connect the cable of
Derma LED Mask to
controller port.

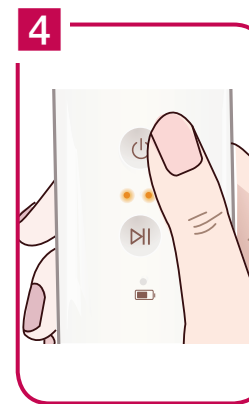

Turn on by pressing the
(power) button.



Wear the Derma LED Mask as if wearing eye
glasses. Press the **Start/Pause** button
to begin skincare routine.

- If device does not immediately begin after wearing the mask, adhere your skin as close as possible to the proximity sensor located in middle of the mask.

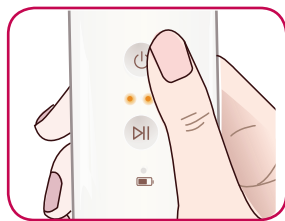

Power on / off

Press the  (power) button for a short while.



Start / Pause

Press the  (Start/Pause) button for a short while.



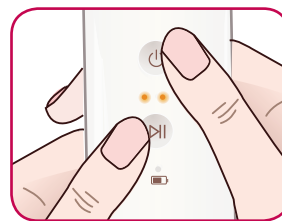

Voice Assistance Setting

With power on, press and hold the  (power) button for about 5 seconds to cycle through each mode:
(Voice Assistance → Sound effect guide → Turn off guide (mute))



Language Setting

With power on, press and hold both  (Power) button and the  (Play/Pause) button simultaneously for 3 seconds to cycle through each language:
(English → Chinese → Korean)

Charging

Charge in the cradle

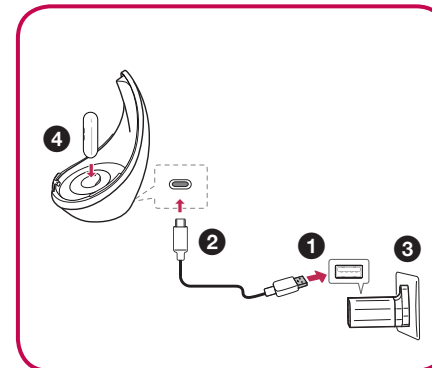

Charge directly to the controller

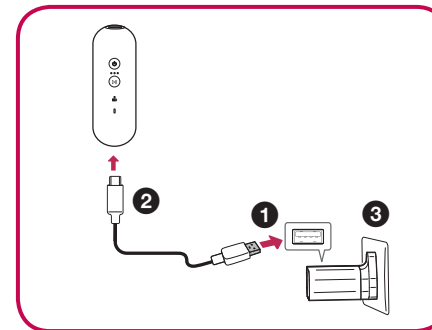

Precautions for use

- Depending on individual skin condition, the device may cause a variety of skin irritations. If such irritation occurs, please stop use.
- In the following cases, it is recommended to use the device after consultation with a specialist.
 - Skin Allergies, acne, dermatitis, undergoing skin treatment or cosmetic surgery or hair loss surgery
 - Wearing a cardiac pacemaker, implant device or a metal prosthetic
- Device to be used as a facial treatments only, it is not recommended for use on body.
- Do not make direct eye contact with LED light while device is in operation. Excessive exposure to LED light can cause eye damage.
- Recommend product use is once a day. Using more than twice a day may cause a burning sensation on skin.
- If you are currently undergoing a dermatology-related treatment or have skin problems, consult your dermatologist before use.
- Device use not recommended for pregnant, menstruating or lactating women. (Unstable hormonal balance may cause temporary skin issues.)
- Do not use the device for purposes other than those set out in this guide.
- Please pay attention to using cosmetics that contain the following ingredients as it may reduce the effect : denatured alcohol, sunscreen, retinol, oil