



OWNER'S MANUAL BOTTOM FREEZER FRIDGE

Please read this owner's manual thoroughly before operating and keep it handy for reference at all times.

GF-6D725BGL



MFL68507681

www.lg.com

TABLE OF CONTENTS

3 PRODUCT FEATURES ---

4 IMPORTANT SAFETY INSTRUCTIONS ---

7 COMPONENTS ---

7 Fridge Exterior

8 Fridge Interior

9 INSTALLATION ---

9 Installation Overview

10 Unpacking Your Fridge

10 Choosing the Proper Location

10 - Flooring

11 - Ambient Temperature

11 Turning On the Power

11 How to Remove the Fridge Door

12 How to Remove the Freezer Door

12 Height Adjustment

12 - Fridge Door Height Adjustment

13 - When the Freezer Door is Lower

14 HOW TO USE ---

14 Before Use

15 Control Panel

15 - Control Panel Features

16 Storing Food

16 - Food Storage Location

18 - Food Storage Tips

18 - Storing Frozen Food

19 Adjusting the Fridge Shelves

19 - Detaching the Shelf

19 - Refitting the Shelf

20 - Using the Folding Shelf

20 - When Closing the Door

21 Big Fresh Zone

21 - Removal of the Big Fresh Zone drawer

21 - Refitting the Big Fresh Zone drawer

22 How to disassemble and assemble the vegetable box

23 Extra Space

23 Tilting Fresh Basket

24 - Tilting Fresh Basket Disassembly

24 Dairy Corner

24 Door-In-Door

25 - Door-In-Door Shelf Disassembly

26 Adjustable Moving Basket

26 Ice Maker

27 Fresh Zone

27 Freezer Drawer

27 - Freezer Drawer Removal

28 - Refitting the Freezer Drawer

28 Freezer/Fridge Basket

29 MAINTENANCE ---

29 Cleaning

30 Replacing the Pure N Fresh filter

31 SMART DIAGNOSIS ---

31 Using Smart Diagnosis

32 TROUBLESHOOTING ---

PRODUCT FEATURES

* Depending on the model, some of the following functions may not be available.



DOOR ALARM

The Door Alarm function is designed to prevent fridge malfunctioning that could occur if a fridge door or freezer door remains open. If a fridge door or freezer door is left open for more than 60 seconds, a warning alarm sounds in 30 second intervals until it is closed.



AUTO CLOSING HINGE

The fridge doors close automatically with a slight push. (The door only closes automatically when it is open at an angle less than 30°.)

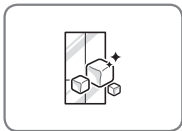

EXPRESS FREEZE

The freezer section is maintained at the coldest temperature for a 24-hour period before automatically resuming normal operation. The freezer display temperature will not change when Express Freeze is engaged. It will also enhance ice production whilst it is on.

IMPORTANT SAFETY INSTRUCTIONS

READ ALL INSTRUCTIONS BEFORE USING THE APPLIANCE.

This guide contains many important safety messages. Always **read and obey** all safety messages.



This is the safety alert symbol. It alerts you to safety messages that inform you of hazards that can kill or hurt you or others, or cause damage to the product.

All safety messages will be preceded by the safety alert symbol and the hazard signal word **WARNING** or **CAUTION**. These words mean:



WARNING You can be killed or seriously injured if you do not follow instructions.



CAUTION Indicates an imminently hazardous situation which, if not avoided, may result in minor or moderate injury, or product damage.



WARNING

To reduce the risk of fire, electric shock, or personal injury when using your product, basic safety precautions should be followed, including the following.

Power

- NEVER unplug your fridge by pulling on the power cord. Always grip the plug firmly and pull it straight out from the outlet.
- If the supply cord is damaged, it must be replaced by the manufacturer or its service agent or a similarly qualified person in order to avoid a hazard. Do not use a cord that shows cracks or abrasion damage along its length or at either the plug or connector end.
- Do not use an uncertified power outlet.
- Unplug the power plug immediately in the event of a blackout or thunderstorm.
- Plug in the power plug with the power cord facing downward.

Installation

- Contact an authorized service center when you install or relocate the fridge.
- When moving your fridge away from the wall, be careful not to roll over or damage the power cord.
- Connect this product to a dedicated grounded electric outlet conforming with the rating prior to use. It is the user's responsibility to replace a standard 2-prong wall outlet with a standard 3-prong wall outlet.
- Do not install the fridge where there may be a danger of it falling. Installation on a non sturdy timber floor may cause difficulty in door alignment and cause the cabinet to deform.

Use

- DO NOT allow children to climb, stand, or hang on the fridge doors or shelves in the fridge. They could damage the fridge and seriously injure themselves.
- Where fitted, do not place heavy objects on the dispenser of the fridge or hang onto it.
- Do not place heavy or dangerous objects (bottles or vases with liquid) on the fridge.
- Do not put live animals inside of the fridge.
- Do not allow children to climb into the product when it is in or out of use.
- In the event of a gas leak (propane/LPG), ventilate sufficiently and contact an authorized service center before use. Do not touch or disassemble the electric outlet of the fridge.
- In the event of a refrigerant leak, move flammable objects away from the fridge. Ventilate sufficiently and contact an authorized service center.
- Do not use or place flammable substances (chemicals, medicine, cosmetics, etc) near the fridge or store them inside the fridge. Do not place the fridge in the vicinity of flammable gas.
- The tempered glass on door can be broken by impact. Do not touch the broken parts. You may be injured.

READ ALL INSTRUCTIONS BEFORE USING THE APPLIANCE.

To reduce the risk of fire, electric shock, or personal injury when using your product, basic safety precautions should be followed, including the following.

- This appliance is intended to be used in household and similar applications such as
 - staff kitchen areas, offices and other working environments;
 - farm houses and by clients in hotels, motels and other residential type environments;
 - bed and breakfast type environments.
- Do not use this product for special purposes or mobile applications (storage of medicine or test materials or on ships, etc).
- Unplug the power plug before cleaning or repairing the fridge.
- If the fridge is fitted with light bulbs and require replacing, unplug the fridge or turn off the power before doing so.
- Do not modify or extend the power cord.
- Do not use a hair dryer to dry the interior. Do not light a candle to remove any interior odor.
- For your safety, this appliance must be properly grounded. Have the wall outlet and the circuit checked by a qualified electrician to make sure the outlet is properly grounded.
- Do not use an outlet that can be turned off via a remote switch. Do not use an extension cord. It is the user's responsibility to replace a standard 2-prong wall outlet with a standard 3-prong wall outlet.
- Do not, under any circumstances, cut or remove the third (ground) prong from the power cord.
- Do not use an adapter plug and plug the power plug into a multi-outlet extension cord.
- Disconnect the power cord immediately if you hear a noise, smell a strange odor or detect smoke.
- Turn the power off if dust or water from above or below penetrates into the fridge. Call a service agent.
- Do not disassemble or modify the fridge.
- Do not put hands, feet, or metal objects below or behind the fridge.
- Do not operate the fridge or touch the power cord with wet hands.
- In fridges with automatic icemakers, avoid contact with the moving parts of the ejector mechanism or with the heating element that releases the cubes. Do not place fingers or hands on the automatic ice-making mechanism while the fridge is plugged in.
- When dispensing ice from the dispenser, do not use crystal ceramics.
- Do not touch the cold surfaces in the freezer compartment with wet or damp hands, when your fridge is in operation.
- Do not put glass containers, glass bottles or beverage cans in the freezer.
- Do not store explosive substances such as aerosol cans with a flammable propellant in this appliance.
- This appliance is not intended for use by persons (including children) with reduced physical, sensory or mental capabilities, or lack of experience and knowledge, unless they have been given supervision or instruction concerning the use of the appliance by a person responsible for their safety.
- Do not refreeze frozen foods that have thawed completely. It may result in serious health issues.
- If you are throwing away your old fridge, make sure the CFC coolant is removed for proper disposal by a qualified servicer. If you release CFC coolant, you may be fined or imprisoned in accordance with the relevant environmental law.
- Disposed or abandoned fridges are dangerous, even if they are sitting for only a few days. When disposing the fridge, remove the packing materials from the door or take off the doors but leave the shelves in place so that children may not easily climb inside.
- If the refrigerant gas has leaked, do not touch the fridge or the power outlet and ventilate the room immediately. A spark could trigger an explosion causing a fire or burns. Because this fridge uses natural gas (isobutene, R600a) as the environment-friendly refrigerant, even a small amount (50~60g) is combustible. If gas leaks from severe damage during delivering, installing or using the fridge, any spark may cause fire or burns.

READ ALL INSTRUCTIONS BEFORE USING THE APPLIANCE.

To reduce the risk of fire, electric shock, or personal injury when using your product, basic safety precautions should be followed, including the following.

**CAUTION****Installation**

- The fridge must be properly installed in accordance with the Installer Instructions that were taped to the front of the fridge.
- Be careful when you unpack and install the fridge. Immediately dispose of packing materials (plastic) out of reach of children.

Use

- Close the doors carefully when children are around.
- Keep fingers out of pinch point areas; clearances between the doors and cabinets are necessarily small. Be careful closing doors when children are in the area.
- If food is stacked or stored poorly on the shelves, it may fall and cause injury when the door is opened.
- Do not move fridge while the fridge is operating. A Compressor rattling noise may occur as a result and will only stop when the compressor cycles off, or when the power to the unit is turned off and back on again. (This is normal and will not impact on the performance or the life of the compressor. The rattling will stop after the compressor comes to a rest.)

Maintenance

- Do not use strong detergents like wax or thinners for cleaning. Clean with a soft fabric.
- Wipe foreign objects (dust, water, etc) off the prongs of the power plug and contact areas before connecting.

**WARNING**

- Use drinkable water for ice making.

**WARNING**

- Keep ventilation openings, in the appliance enclosure or in the built-in structure, clear of obstruction.
- Do not use mechanical devices or other means to accelerate the defrosting process, other than those recommended by the manufacturer.
- Do not damage the refrigerant circuit.
- Do not use electrical appliances inside the food storage compartments of the appliance, unless they are of the type recommended by the manufacturer.
- The refrigerant and insulation blowing gas used in the appliance require special disposal procedures. When disposal, please consult with service agent or a similarly qualified person.



This appliance contains a small amount of isobutane refrigerant (R600a), natural gas with high environmental compatibility, but it is also combustible. When transporting and installing the appliance, care should be taken to ensure that no parts of the refrigerating circuit are damaged. Refrigerant squirting out of the pipes could ignite or cause an eye injury. If a leak is detected, avoid any naked flames or potential sources of ignition and air the room in which the appliance is standing for several minutes.

In order to avoid the creation of a flammable gas air mixture if a leak in the refrigerating circuit occurs, the size of the room in which the appliance may be sited depends on the amount of refrigerant used. The room must be 1m² in size for every 8g of R600a refrigerant inside the appliance. The amount of refrigerant in your particular appliance is shown on the identification plate inside the appliance. Never start up an appliance showing any signs of damage. If in doubt, consult your dealer.

SAVE THESE INSTRUCTIONS

COMPONENTS

Use this page to become more familiar with the parts and features of your fridge.
Page references are included for your convenience.

*The appearance and specifications of the actual product may differ depending on the model.

Fridge Exterior (Applicable to some models only)

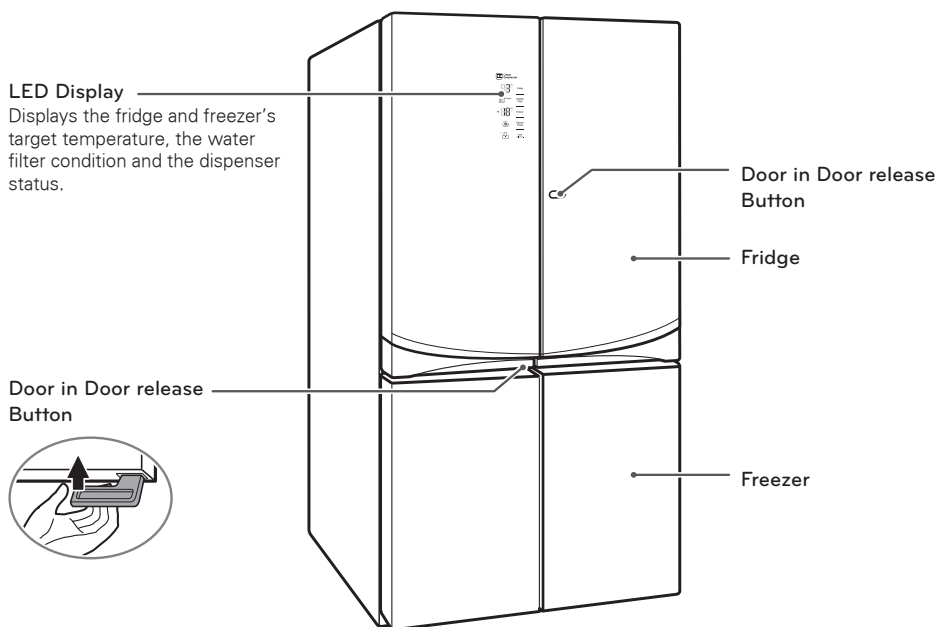

Fridge Interior (Applicable to some models only)

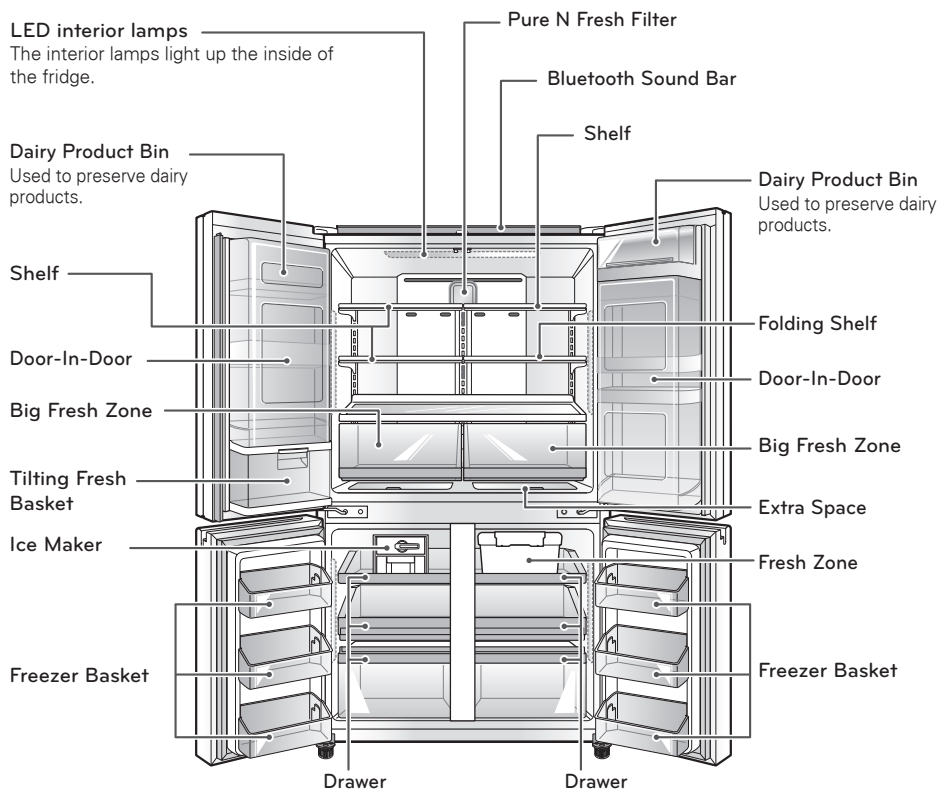

INSTALLATION

Installation Overview

Please read the following installation instructions first after purchasing this product or transporting it to another location.

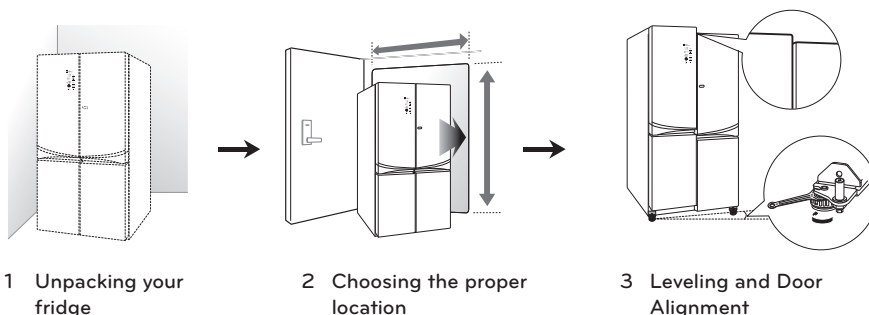

SUGGESTION FOR ENERGY SAVING

- Please do not keep the door open for a long time, close door in the shortest time.
- Too much food are not advised to be put in. Enough space should be kept for cool air circulating freely.
- Do not set the temperature of fridge lower than needed. Do not put the food near the temperature sensor.
- Allow hot food to cool prior to storing. Placing hot food in the fridge-freezer could spoil other food, and lead to higher electric bills.
- Do not block air vents with food. Smooth circulation of cold air keeps fridge-freezer temperature even.
- Do not open the door frequently. Opening the door lets warm air enter the fridge-freezer, and cause temperature to rise.

Unpacking Your Fridge

WARNING

- Use two or more people to move and install the fridge. Failure to do so can result in back or other injury.
- Your fridge is heavy. When moving the fridge for cleaning or service, be sure to protect the floor. Always pull the fridge straight out when moving it. Do not wiggle or walk the fridge when trying to move it, as floor damage could occur. Wind the leveling feet up first so that the unit is on its rollers.
- Keep flammable materials and vapors, such as gasoline, away from the fridge. Failure to do so can result in fire, explosion, or death.

Remove tape and any temporary labels from your fridge before using. Do not remove any warning-type labels, the model and serial number label, or the Tech Sheet that is located under the front of the fridge.

To remove any remaining tape or glue, rub the area briskly with your thumb. Tape or glue residue can also be easily removed by rubbing a small amount of liquid dish soap over the adhesive with your fingers. Wipe with warm water and dry.

Do not use sharp instruments, rubbing alcohol, flammable fluids, or abrasive cleaners to remove tape or glue. These products can damage the surface of your fridge.

Fridge shelves are installed in the shipping position. Please reinstall shelves according to your individual storage needs.

Choosing the Proper Location

- The fridge should always be plugged into its own individual properly grounded electrical outlet rated for 240 Volts, 50 Hz, AC only, and fused at 15 or 20 amperes. This provides the best performance and also prevents overloading house wiring circuits which could cause a fire hazard from overheated wires. It is recommended that a separate circuit serving only this appliance be provided.

WARNING

To reduce the risk of electric shock, do not install the fridge in a wet or damp area. do not install in any outdoor or sheltered outdoor location or direct sunlight.

Flooring

To avoid noise and vibration, the unit must be leveled and installed on a solidly constructed floor. If required, adjust the leveling legs to compensate for unevenness of the floor. The front should be slightly higher than the rear to aid in door closing. Leveling legs can be turned easily by tipping the cabinet slightly. Turn the leveling legs to the left to raise the unit or to the right to lower it. Poorly constructed timber flooring can cause a limit in door adjustment and the cabinet to become out of shape. (See Leveling and door Alignment.)

NOTE

Installing on carpeting, soft tile surfaces, a platform or weakly supported structure is not recommended.

Ambient Temperature

Install this appliance in an indoor area where the temperature is between 55°F (13°C) and 110°F (43°C). If the temperature around the appliance is too low or high, the cooling ability may be adversely affected.

- 1 Place your appliance where it is easy to use.
- 2 Avoid placing the unit near heat sources, direct sunlight or moisture.
- 3 To ensure proper air circulation around the fridge -freezer, please maintain sufficient space on both the sides as well as top and maintain at least 2 inches (5.08 cm) from the rear wall.
- 4 To avoid vibrations, the appliance must be leveled.
- 5 Don't install the appliance below 41°F (5°C). It may affect the performance.

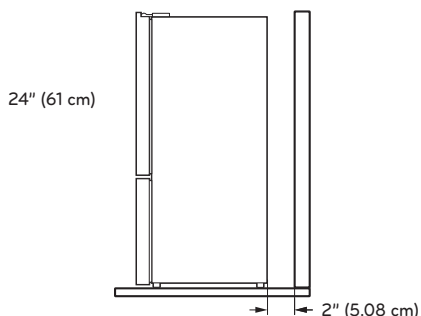

Turning On The Power

Plug in the fridge.



CAUTION

- Connect to a rated power outlet.
- Have a certified electrician check the wall outlet and wiring for proper grounding.
- Do not damage or cut off the ground terminal of the power plug.

How to Remove the Fridge Door (TURN OFF THE MAIN POWER. Same procedure for left and right doors)

- 1 Remove the fridge door hinge cover. (left side)

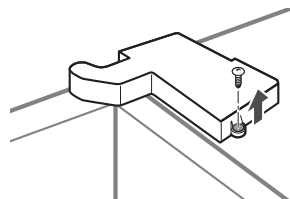

- 2 Disassemble connection plugs and ground wires.

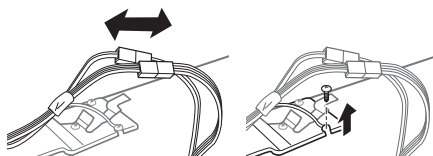

- 3 Turn ① around to release lock and raise hinge up.

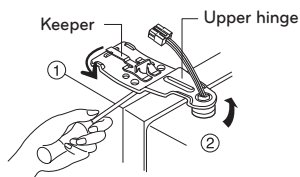

- 4 Disassemble Door, raising it from Hinge Center.

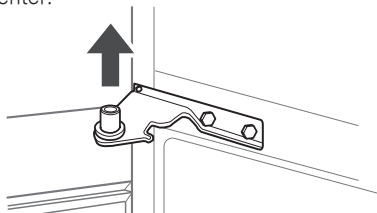

CAUTION

Remove it after you open Door to 90 degrees.

How to Remove the Freezer Door (TURN OFF THE MAIN POWER. Same procedure for left and right doors)

- 1 Remove the inner hinge bolt.

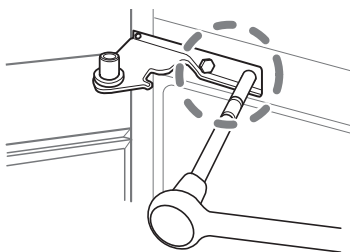

- 2 Twist the hinge to raise the pivoting end so that the door can be lifted off.

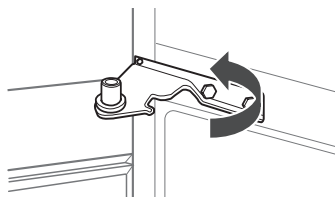

- 3 Remove the door by raising it from the lower hinge.

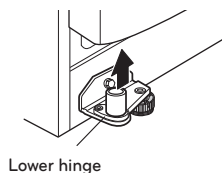

Height Adjustment

Leveling the doors may not be possible when the floor is not leveled, or is of weak or poor construction. The fridge is heavy and should be installed on a rigid and solid surface. Some Timber flooring may cause levelling difficulties if it flexes excessively.

Fridge Door Height Adjustment

- If the left door is lower, lift the door and screw a door hinge bolt using a spanner as illustrated in the figure.
- Use ① spanner in fridge.
- If the right door is lower, lift the right door and insert an additional ③ snap ring using a long nose plier until both doors are level.

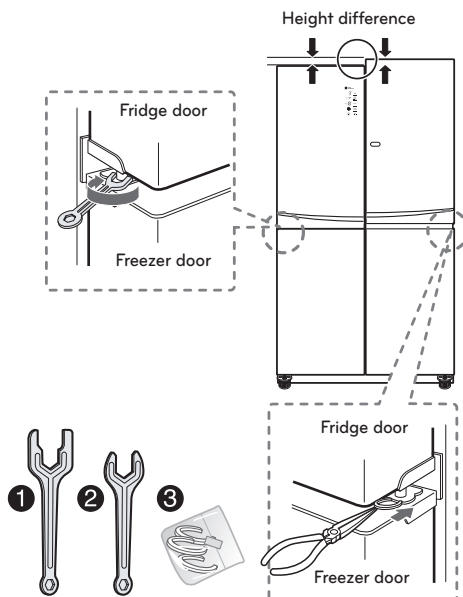

When the Freezer Door is Lower

- Method 1 is recommended.
- Use spanner ② for freezer door adjustment.

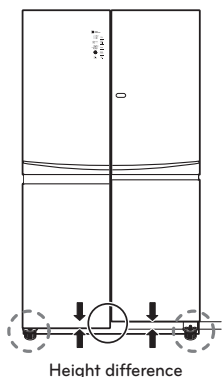

1 (Method 1 recommended.)

Open the door and adjust the level by using the nut on the adjustable round foot of the lower side first by using the supplied number ② spanner as per the below diagram.

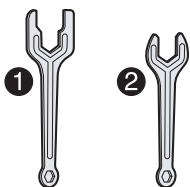
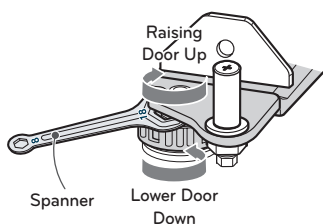

2 (Method 2)

- (1) Using the large side of the number ② spanner, rotate the locking nut (↻) clockwise to unlock it before adjusting the Adjust-Hinge pin.

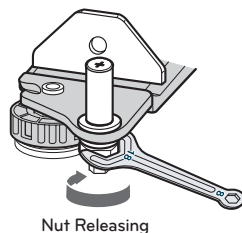

- (2) Rotate the Adjust-hinge pin either (↻) clockwise or (↺) counter-clockwise using the narrow side of the spanner spanner to adjust the level difference between the fridge door and freezer door (this method provides limited adjustment).

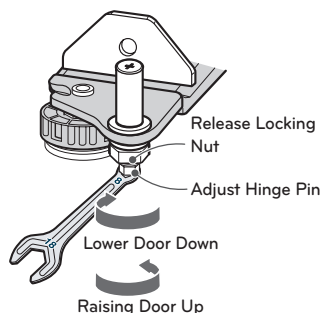

- (3) After adjusting door height, firmly tighten the Locking nut (↺) counter-clockwise until secured.

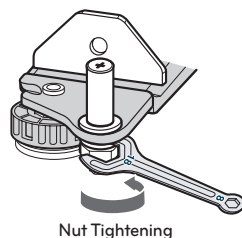

CAUTION

Do not adjust the hinge pin height level too much. The hinge pin can fall out.
(Range of height adjustment : Max. 3mm)

HOW TO USE

Before use



Clean the fridge.

Clean your fridge thoroughly and wipe off all dust that may have accumulated during shipping.



CAUTION

- Do not scratch the fridge with a sharp object or use a detergent that contains alcohol, a flammable liquid or an abrasive when removing any tape or adhesive from the fridge.
- Do not peel off the model or serial number label or the technical information on the rear surface of the fridge.



NOTE

Remove adhesive residue by wiping it off with your thumb or dishwashing detergent.

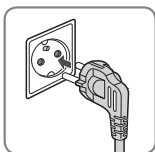

Connect the power supply.

Check if the power supply is connected before use.

Read the "Turning On The Power" section. (Your plug type might be different from the picture.)

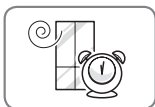

Wait for the fridge to cool.

Allow your fridge to run for at least three to four hours before putting food in it. Check the flow of cold air in the freezer compartment to ensure proper cooling.



CAUTION

Putting food in the fridge before it has cooled could cause the food to spoil, or a bad odor could remain inside the fridge.

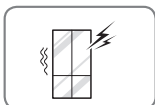

The fridge makes a loud noise after initial operation.

This is normal. The loudness will decrease as the temperature lowers.

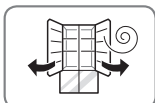

Before Plugging in, open the fridge doors to ventilate the interior.

The inside of the fridge may smell like plastic at first. Remove any adhesive tape from inside the fridge and open the fridge doors for ventilation until any odors have subsided.

Control Panel (Applicable to some models only)

Control Panel Features

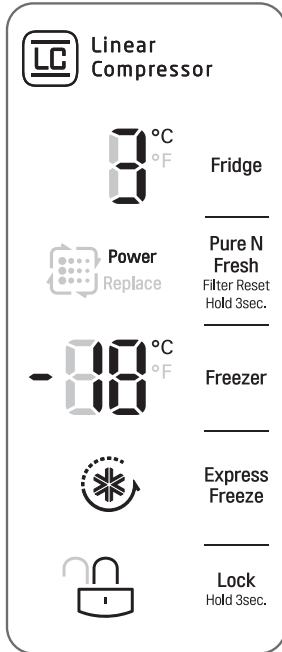

Fridge Temperature 8°C

Indicates the set target temperature of the refrigerator compartment in Celsius (°C).
The recommended Fridge set temperature in normal ambient conditions and loads is 3°C ~ 4°C.

Freezer Temperature -88°C

Indicates the set target temperature of the freezer compartment in Celsius (°C).
The recommended Freezer set temperature in normal ambient conditions and loads is -17°C ~ -19°C.



NOTE

The displayed temperature is the target temperature, and not the actual temperature of the refrigerator. The actual refrigerator temperature depends on the food inside the refrigerator as well as ambient temperatures and how often the doors are opened and closed.

Express Freeze

This function increases both ice making and freezing capabilities.

- When you touch the **Express Freeze** button, the graphic will illuminate in the display and will continue for 3 hours. The function will automatically disable itself after 3 hours.
- You can stop this function manually by touching the button one more time.

Pure N Fresh

When the Replace lamp is on, replace the Pure N Fresh filter.

- When the "Replace" lamp is turned on, replace the filter to maintain the performance of the Pure N Fresh Filter function.
- To replace the filter, press the **Pure N Fresh Filter Reset Hold 3sec.** button on the touch control panel to the OFF mode so that the filter icon is not illuminated and the blue Pure N Fresh LED inside the refrigerator remains off. The Pure N Fresh function has three modes, The Pure N Fresh function has three modes, Off(default mode when icon is not lit up), Auto(when icon is lit up) and Power(when icon and Power are lit up). Power mode can be engaged by pressing the Pure N Fresh touch control respectively. Off>Auto>Power>Off>Auto.... Power mode will resume back to Auto mode after 4 hours.

Control Lock

The Control Lock function disables the button functions only on the display.

- When power is initially connected to the refrigerator, the **Lock** function is off.
- If you want to activate the **Lock** function to lock other buttons, press and hold the **Lock** button for 3 seconds or more. The **Lock** icon will display and the **Lock** function is now enabled.
- To disable the **Lock** function, press and hold the **Lock** button for approximately 3 seconds.

Storing Food

Food Preservation Location (Applicable to some models only)

Each compartment inside the fridge is designed to store different types of food. Store your food in the optimal space to enjoy the freshest taste.

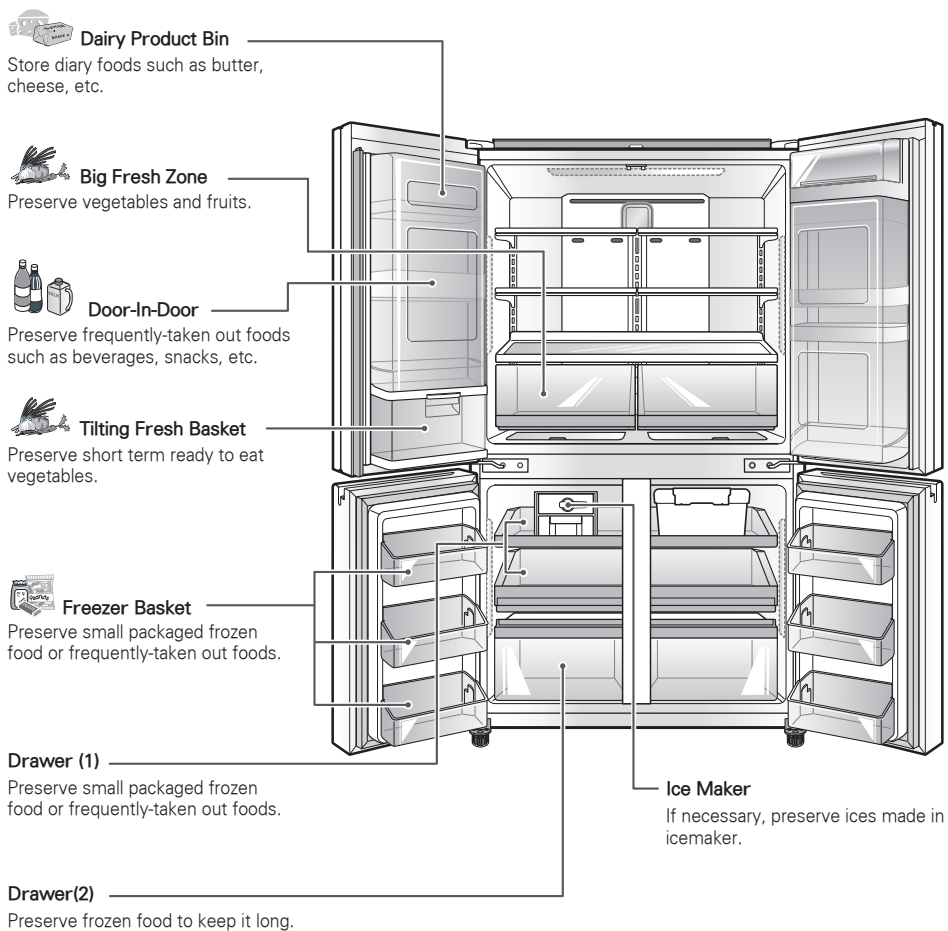

Food Preservation Location (Applicable to some models only) (continued)

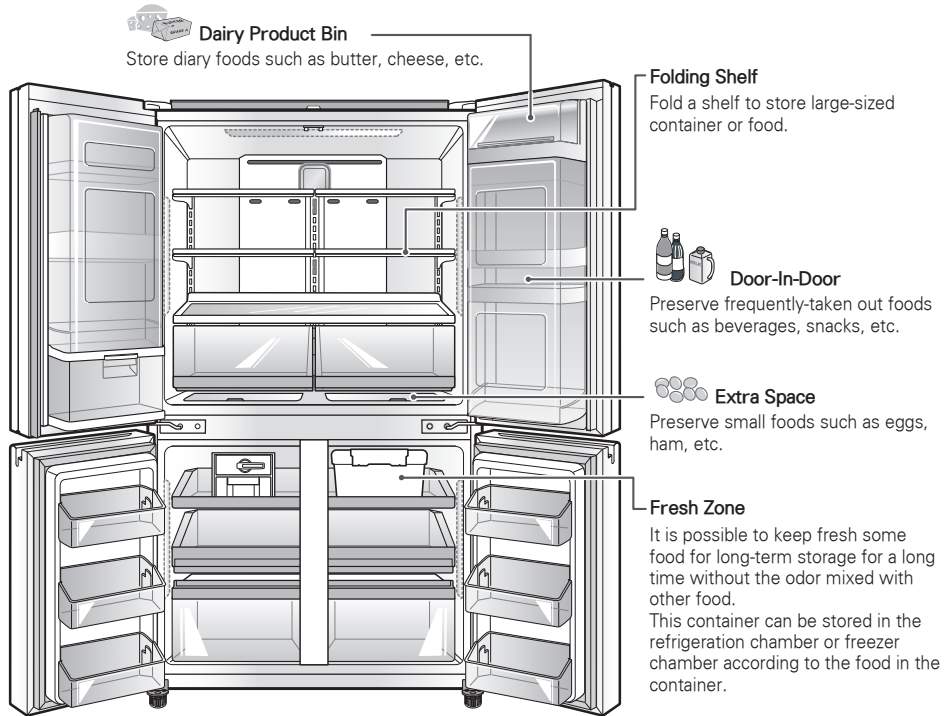

CAUTION

- Do not store food with high moisture content towards the top of the fridge. The moisture could come in direct contact with the cold air and freeze.
- Wash food before storing it in the fridge. Vegetables and fruit should be washed, and food packaging should be wiped down to prevent adjacent foods from being contaminated.
- If the fridge is kept in a hot and humid place, frequent opening of the door or storing a lot of vegetables in the fridge may cause condensation to form. Wipe off the condensation with a clean cloth or a paper towel.
- If the fridge doors are opened or closed too often, warm air may penetrate the fridge and raise its temperature. It can also increase the fridge's electricity usage.



NOTE

- If you are leaving home for a short period of time, like a short vacation, the fridge should be left on. Refrigerated foods that are able to be frozen will stay preserved longer if stored in the freezer.
- If you are leaving the fridge turned off for an extended period of time, remove all food and unplug the power cord. Clean the interior, and leave the doors slightly ajar to prevent mold from growing in the fridge.

Food Storage Tips

* The following tips may not be applicable depending on the model.

Wrap or store food in the fridge in airtight and moisture-proof material unless otherwise noted. This prevents food odor and taste transfer throughout the fridge. For dated products, check use by dates to ensure freshness.

Food	How to
Butter or Margarine	Keep opened butter in a covered dish or closed compartment. When storing an extra supply, wrap in freezer packaging and freeze.
Cheese	Store in the original wrapping until you are ready to use it. Once opened, rewrap tightly in plastic wrap or aluminum foil.
Milk	Wipe milk cartons. For best storage, place milk on interior shelf, not on door shelf.
Eggs	Store in original carton on interior shelf, not on door shelf.
Fruit	Do not wash or prepare fruit until it is ready to be used. Sort and keep fruit in its original container, in a crisper, or store in a completely closed paper bag on a fridge shelf.
Leafy Vegetables	Remove store wrapping and trim or tear off bruised and discolored areas. Wash in cold water and drain. Place in plastic bag or plastic container and store in crisper.
Vegetables with skins (carrots, peppers)	Place in plastic bags or plastic container and store in crisper.
Fish	Store fresh fish and shellfish in the freezer section if they are not being consumed the same day of purchase. It is recommended to consume fresh fish and shellfish the same day purchased.
Leftovers	Cover leftovers with plastic wrap, aluminum foil, or plastic containers with tight lids.

Storing Frozen Food



NOTE

Check a freezer food guide or a reliable cookbook for further information about preparing food for freezing or food storage times.

Freezing

Your freezer will not quick-freeze a large quantity of food. Do not put more unfrozen food into the freezer than will freeze within 24 hours (no more than 1 to 1.5kg. of food per cubic foot of freezer space). Leave enough space in the freezer for air to circulate around packages. Be careful to leave enough room at the front so the door can close tightly.

Storage times will vary according to the quality and type of food, the type of packaging or wrap used (how airtight and moisture-proof) and the storage temperature. Ice crystals inside a sealed package are normal. This simply means that moisture in the food and air inside the package have condensed, creating ice crystals.



NOTE

Allow hot foods to cool at room temperature for 30 minutes, then package and freeze. Cooling hot foods before freezing saves energy.



NOTE

Never freeze beverage cans or bottles of any kind as they can explode or shatter.

Storing Frozen Food (continued)

Packaging

Successful freezing depends on correct packaging. When you close and seal the package, it must not allow air or moisture in or out. If it does, you could have food odor and taste transfer throughout the fridge and could also dry out frozen food.

Packaging recommendations:

- Rigid plastic containers with tight-fitting lids
- Straight-sided canning/freezing jars
- Heavy-duty aluminum foil
- Plastic-coated paper
- Non-permeable plastic wraps
- Specified freezer-grade self-sealing plastic bags

Follow package or container instructions for proper freezing methods.

Do not use

- Bread wrappers
- Non-polyethylene plastic containers
- Containers without tight lids
- Wax paper or wax-coated freezer wrap
- Thin, semi-permeable wrap

Adjusting the Fridge Shelves

The shelves in your fridge are adjustable to meet your individual storage needs. Your model may have either glass or wire shelves.

Adjusting the shelves to fit different heights of items will make finding the exact item you want easier. Doing so will also reduce the amount of time the fridge door is open which will save energy.

Detaching the Shelf

Tilt up the front of the shelf and lift it straight up. Pull the shelf out.

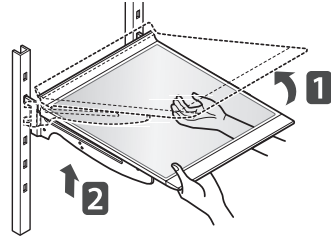

Refitting the Shelf

Tilt the front of the shelf up and guide the shelf hooks into the slots at the desired height. Then, lower the front of the shelf so that the hooks drop into the slots.

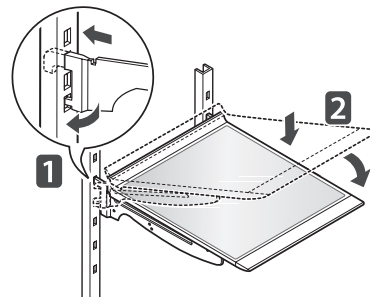

CAUTION

Make sure that shelves are level from one side to the other. Failure to do so may result in the shelf falling or spilling food.

Using the Folding Shelf

You can store taller items, such as containers or bottles, by simply pushing the front half of the shelf underneath the back half of the shelf. Pull the front of the shelf firmly toward you to return to a full shelf.

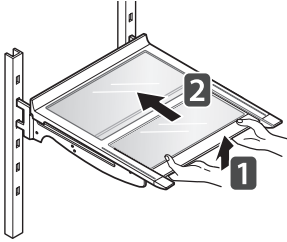

CAUTION

- Do not clean glass shelves with warm water while they are cold. Shelves may break if exposed to sudden temperature changes or impact.
- Glass shelves are heavy. Use special care when removing them.

When Closing the Door



CAUTION

- To reduce the risk of door scratches and breaking the door centre mullion, please make sure that the fridge door mullion is always folded in.
- The door Alarm will sound if the door remains open after 1 minute. Ensure that the folding mullion is folded in before closing the left hand door.

Big Fresh Zone

Removal of the Big Fresh Zone drawer.

- 1 Pull the drawer back to the end of its travel.

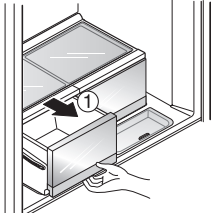

- 2 Lift the front of the draw up and remove it from its guide.

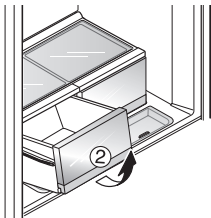

Refitting the Big Fresh Zone drawer

- 1 Insert the left and right roller of the drawer into the guides whilst the draw is slightly lifted at the front, and push it in gently while lowering it at the same time.

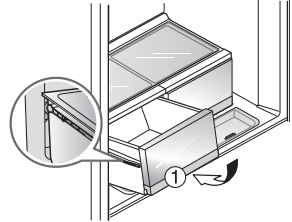

- 2 Push it in gently while lowering it at the same time.

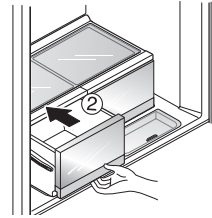

CAUTION

- Always empty the draws before removing them and use both hands when removing and refitting.
- Make sure that the fridge doors are fully open before removing and refitting the drawers.

How to disassemble and assemble the vegetable box

How to disassemble vegetable box

- 1 While the refrigeration chamber door is wide open, take out all the shelves from the refrigeration chamber.

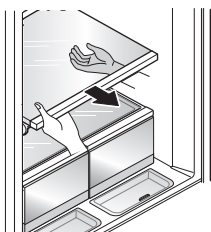

- 2 Lift the vegetable box with both hands and make space in the back by pulling it toward you.

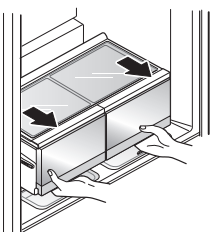

- 3 Grab the back side with one hand to lift the vegetable box, and at this time, take it out as tilted.

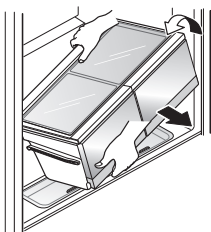

How to assemble vegetable box

- 1 Lift the vegetable box askew and push into the refrigeration chamber.

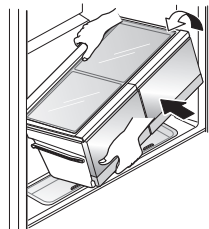

- 2 Lift the vegetable box horizontally with the height as high as the vegetable box in the refrigeration chamber and put it down on the floor. (It is to avoid contact with the side of the refrigeration chamber.)

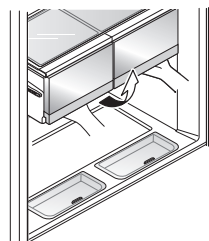

- 3 If there is a gap in the back side as in the drawing, slightly lift the vegetable box and push.

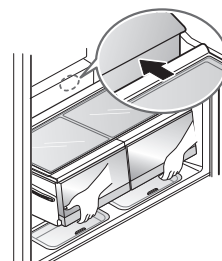

CAUTION

- Make sure to disassemble with both hands. Heavy food in storage may cause injury.
- When you disassemble or assemble the vegetable box, make sure to widely open the refrigeration chamber door.

Extra Space

Store small foods like eggs, ham, cheese, etc.

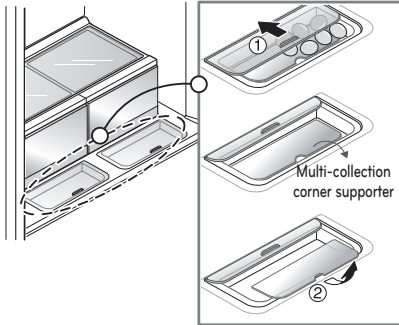

- Open and close pushing or pulling grips.



CAUTION

- Be careful when handling and storing larger eggs. They can be broken if the cover is not completely closed and the drawer is pushed in.
- Observe the above diagrams when removing and refitting the Multi-Collection corner after cleaning.
- Store all moist and easily-freezing foods like soy bean curd, sesame leaf, etc. on the front of the shelves.

Tilting Fresh Basket

Ideal for storing vegetables soon to be eaten.

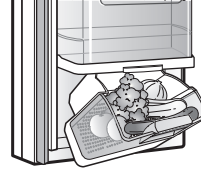

To open, lift the latch and gently pull the basket back.

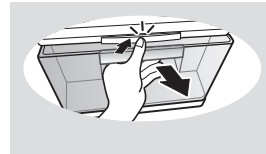

< OPEN >

To close, push the basket in until a "click" sound is heard.

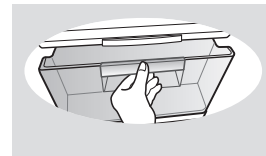

< CLOSE >

- To avoid damaging the drawer, do not overload it or apply excessive force when opening or closing.



CAUTION

- Do not allow children to hang from the basket when it is open or closed. This will damage the basket and could cause injury.

Tilting Fresh Basket Disassembly

- 1 Raise magicSpace cover up and take it out.

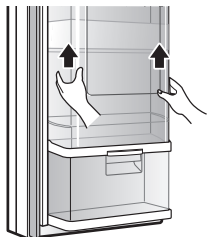

- 2 Hold both ends of the tilting fresh basket and lift up the front part of the tilting fresh basket.

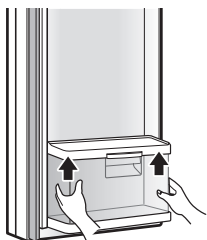

Dairy Corner

You can store dairy products such as butter, cheese etc.

If you close the fridge door with the dairy corner left open, the fridge door may not close properly. It could also result in damage to the lid.



Door-In-Door (Applicable to some models only)

The Door-In-Door compartment allows for easy access of commonly used food items.

The inner Door-In-Door includes two door bins, Cheese & Butter and Condiment bins, that are specially designed for food that can be stored at a warmer temperature. This makes spreading butter and slicing cheese easier.

NOTE

The Cheese & Butter and Condiment bins are not recommended for storing items that spoil easily such as milk and mayonnaise.

Press the the door button on the Home Bar until you hear a click sound.

- You can store more food in the larger Home Bar.
- With the larger storage room, you can organize your foods better.



Door-In-Door (Right)

When you turn the lever below the left door upward, the door opens along with 'click' sound.

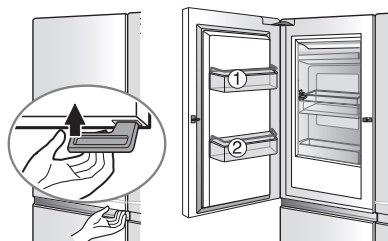

Door-In-Door (Left)

Door-In-Door Shelf Disassembly (Applicable to some models only)

- 1 Raise magic space cover up and take it out.

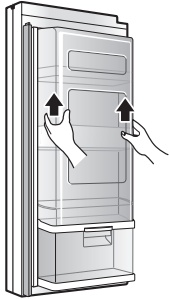

Left : two separate units type

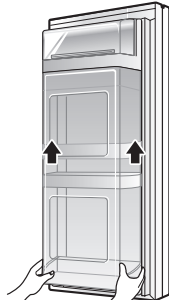

Right : single unit type

- 2 Hold the bottom of daily basket and raise it up to take it out.

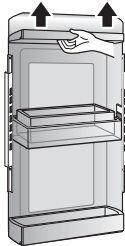

- 3 Move floating basket to the top compartment from magic space cover from which daily corner is removed.

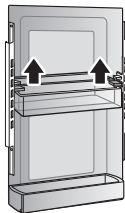

- 4 Remove screws on both sides of magic space cover.

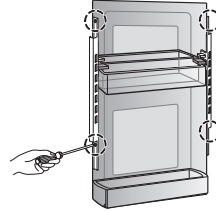

- 5 Hold the bottom of lower basket and raise it up to take it out.

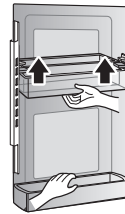

Hold both ends of the basket and lift up the front part of the basket.

- Assemble in the same method as disassembly.

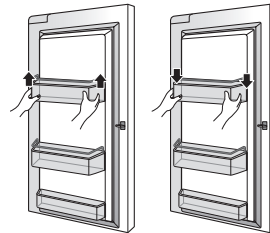

Adjustable Moving Basket

It can be moved up and down as necessary, and used conveniently.

- To move Adjustable Moving Basket up or down, remove all items from the basket first.
- Hold the center of basket gently with upward pressure
- Press the levers on both sides at the bottom of the lower section upward, and then move it up or down.
- Adjusting the Moving Door Basket allows taller food items to be stored more conveniently.

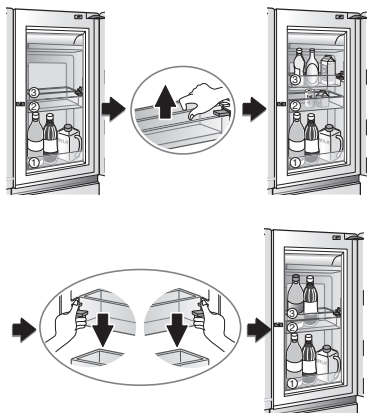

CAUTION

- Remove all food items from basket before moving it up or down. Not doing so could cause damage to the basket or food items.

Ice Maker

- To make ice cubes, fill the ice tray with water and insert in its position.

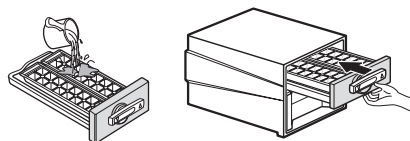
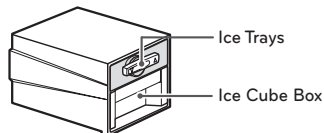

- To remove ice cubes, hold the lever of the tray and pull turn gently. Then, ice cubes drop in to the ice cube box.

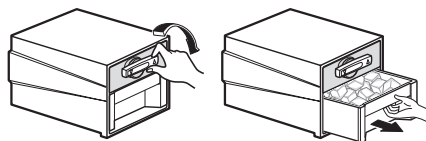

NOTE

You can disassemble the Ice Maker to secure space in the freezer.



WARNING

- Do not use anything other than water.
- Fill the water up to the marked line.

Fresh Zone

- Put food in the fresh zone and keep the cap tightly closed for storage.
- It is possible to keep fresh some food for long-term storage for a long time without the odor mixed with other food.
- This container can be stored in the refrigeration chamber or freezer chamber according to the food in the container.

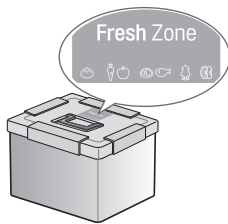

Freezer Drawer

Use the compartment for packed frozen foods and frequently-taken out foods.

You can have a wide space available by taking out the ice maker or fresh zone from the top compartment according to the purpose of use.

Use the bottom compartment for frozen foods. (Dried fish & condiments)

- The sliding freezer drawers allow easy access and convenience of use.

Freezer Drawer Removal

- 1 Pull out the Freezer drawer to the end of its travel (as per below fig) and remove all of the contents.

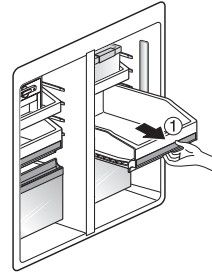

- 2 When the drawer is fully extended, lift up the front and continue to pull it out (as per below fig).

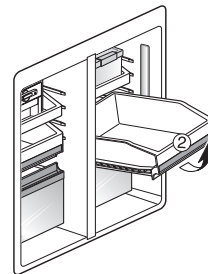

CAUTION

- Always remove drawers with both hands to avoid breakage or injury.
- Always open the freezer doors all the way before removing or refitting the drawers.

Refitting the Freezer Drawer

- 1 Insert both rollers into the guides with the front of the drawer slightly raised and gently push in. while lowering the drawer to the correct level.

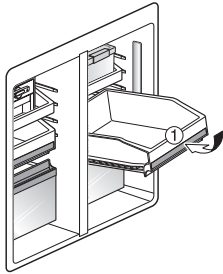

- 2 Continue to push in the drawer all the way while lowering the drawer to the correct level.

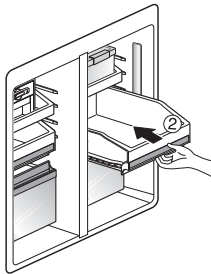

CAUTION

- Always remove drawers with both hands to avoid breakage or injury.
- Always open the freezer doors all the way before removing or refitting the drawers.

Freezer/Fridge basket

You can store small packaged frozen food (Freezer basket), small packaged refrigerated food or beverages (Fridge basket) such as milk, water, juice, beer etc.

Do Not store ice cream or foods intended for long term storage in the Freezer Basket.

To remove the basket, hold the basket with both hands and slightly lift up the front part to pull it out.

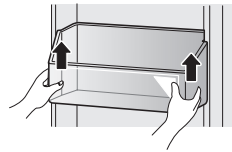

To refit the basket, align both sides of the basket with the guides and push it down until secure.

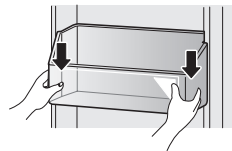

MAINTENANCE

Cleaning

- Both the fridge and freezer sections defrost automatically; however, clean both sections about once a month to prevent odors.
- Wipe up spills immediately.
- Always unplug the refrigeration before cleaning.

General Cleaning Tips

- Unplug fridge or disconnect power.
- Remove all removable parts, such as shelves, crispers, etc.
- Use a clean sponge or soft cloth and a mild detergent in only warm water. Do not use abrasive or harsh cleaners.
- Hand wash, rinse and dry all surfaces thoroughly.

Exterior

Waxing external painted metal surfaces helps provide rust protection. Do not wax plastic parts. Wax painted metal surfaces at least twice a year using appliance wax (or auto paste wax). Apply wax with a clean, soft cloth.

For products with a stainless steel exterior, use a clean sponge or soft cloth and a mild detergent in warm water. Do not use abrasive or harsh cleaners. Dry thoroughly with a soft cloth.



WARNING

Use non-flammable cleaner. Failure to do so can result in fire, explosion, or death. Always remove power cord from the wall outlet prior to cleaning in the vicinity of electrical parts (lamps, switches, covers, controls, etc.).

Wipe up excess moisture with a sponge or cloth to prevent water or Liquid from getting into any electrical part and causing an electric shock.

Never use metallic scouring pads, brushes, coarse abrasive cleaners, Strong alkaline solutions, industrial detergent (bleach containing detergent) Flammable or toxic cleaning liquids on any surface. Do not use Hot water to clean the interior or any interior parts of the unit when they are cold.



CAUTION

- Do not use a rough cloth or sponge when cleaning the interior and exterior of the fridge.
- Do not place your hand on the bottom surface of the fridge when opening and closing.

Inside Walls (allow freezer to warm up so the cloth will not stick)

To help remove odors, you can wash the inside of the fridge with a mixture of baking soda and warm water. Mix 2 tablespoons of baking soda to 1 litre of warm water. Be sure the baking soda is completely dissolved so it does not scratch the surfaces of the fridge.

Door Liners and Gaskets

Use a clean sponge or soft cloth and a mild detergent in warm water. Do not use cleaning waxes, concentrated detergents, bleaches, or cleaners containing petroleum on plastic fridge parts.

Plastic Parts (covers and panels)

Use a clean sponge or soft cloth and a mild detergent in warm water. Do not use window sprays, abrasive cleansers, or flammable fluids. These can scratch or damage the material.

Condenser Coil Cover

Use a vacuum cleaner with an attachment to clean the condenser cover and vents located at the rear of the appliance. Do not remove the panel covering the condenser coil area. Always disconnect the main power before cleaning.

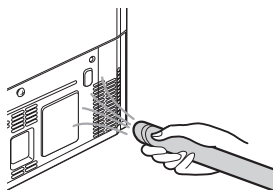

Replacing the Pure N Fresh filter

It is recommended that you replace the Pure N Fresh filter:

- Approximately every 1~2 years.
- When the Replace light turns on.

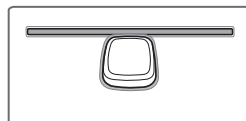

1 Remove the Old Filter

Turn the filter cover to the left to detach from the refrigerator wall. The filter is located on the inside of the filter cover. Remove the filter from the cover and replace it with a new filter.

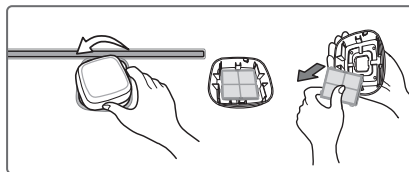

2 Installing a New Pure N Fresh filter.

Place the new filter inside of the cover with the side that says "Front" facing outward. Turn the filter cover to the right to reattach it to the refrigerator wall.

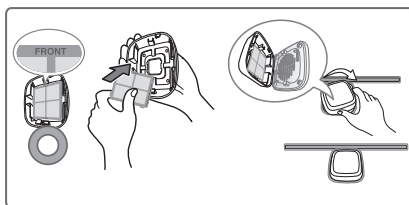

After changing the filter, touch and hold the Pure N Fresh filter button on the front display for three seconds to reset the filter sensor.

SMART DIAGNOSIS

Should you experience any problems with your fridge, it has the capability of transmitting data via your telephone to the LG service center. This gives you the capability of speaking directly to our trained specialists. The specialist records the data transmitted from your machine and uses it to analyze the issue, providing a fast and effective diagnosis.

If you experience problems with your fridge, call to the LG service center. Only use the Smart Diagnosis feature when instructed to do so by the LG call center agent. The transmission sounds that you will hear are normal and sound similar to a fax machine.

Smart Diagnosis cannot be activated unless your fridge is connected to power. If your fridge is unable to turn on, then troubleshooting must be done without using Smart Diagnosis.

Using Smart Diagnosis

First, call to the LG service center. Only use the Smart Diagnosis feature when instructed to do so by the LG call center agent.

- 1 Lock the display. To lock the display, press and hold the Lock button for three seconds. (If the display has been locked for over five minutes, you must deactivate the lock and then reactivate it.)

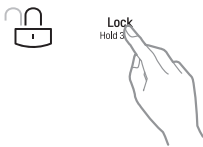

- 2 Open the right fridge door.

- 3 Hold the mouthpiece of your phone in front of the speaker that is located on the right hinge of the fridge door, when instructed to do so by the call center.

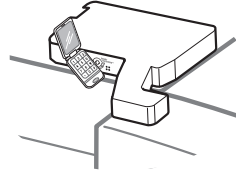

- 4 Press and hold the Freezer Temperature button for three seconds while continuing to hold your phone to the speaker.

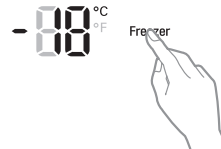

- 5 After you hear three beeps, release the Freezer Temperature button.
- 6 Keep the phone in place until the tone transmission has finished. This takes about 3 seconds, and the display will count down the time. Once the countdown is over and the tones have stopped, resume your conversation with the specialist, who will then be able to assist you in using the information transmitted for analysis.

! NOTE

- For best results, do not move the phone while the tones are being transmitted.
- If the call center agent is not able to get an accurate recording of the data, you may be asked to try again.

! NOTE

- Call quality differences by region may affect the function.
- Use the home telephone for better communication performance, resulting in better service.
- Bad call quality either from a mobile or home phone may result in poor data transmission from your phone to the diagnostics call centre, which could cause Smart Diagnosis to not work properly.

TROUBLESHOOTING

Review the Troubleshooting section before calling for service; doing so will save you both time and money.

Problem	Possible Causes	Solutions
Fridge and Freezer section are not cooling.	The fridge display control is set to OFF (some models).	Cancel the OFF mode so that the unit commences operation. Refer to the Setting the Controls section for proper temperature settings, or call Customer Service if OFF remains on the Display panel.
	Fridge is in the defrost cycle.	During the defrost cycle, the temperature of each compartment may raise slightly. Wait 40 minutes to confirm the proper temperature has been restored once the defrost cycle has completed.
	Fridge was recently installed.	It may take up to 24 hours for each compartment to reach the desired temperature.
	Fridge was recently relocated.	If the fridge was stored for a long period of time or moved on its side, it is necessary for the fridge to stand upright for 24 hours before connecting it to power.
Cooling System runs too much.	Fridge is replacing an older model.	Modern fridges require more operating time but use less energy due to more efficient technology.
	Fridge was recently plugged in or power restored.	The fridge will take up to 24 hours to cool completely.
	Door opened often or a large amount of food / hot food was added.	Adding food and opening the door warms the fridge, requiring the compressor to run longer in order to cool the fridge back down. In order to conserve energy, try to get everything you need out of the fridge at once, keep food organized so it is easy to find, and close the door as soon as the food is removed. (Refer to the Food Storage Guide.)
	Doors are not closed completely.	Firmly push the doors shut. If they will not shut all the way, see the Doors will not close completely or pop open section in Parts & Features Troubleshooting.
	Fridge is installed in a hot location.	The compressor will run longer under warm conditions. At normal room temperatures 70°F(21°C) expect your compressor to run about 40% to 80% of the time. Under warmer conditions, expect it to run even more often. The fridge should not be operated above 110°F(43°C).
	Condenser / back cover is clogged.	Use a vacuum cleaner with an attachment to clean the condenser cover and vents. Do not remove the panel covering the condenser coil area. Disconnect the mains before cleaning.

Problem	Possible Causes	Solutions
Fridge or Freezer section is too warm.	Fridge was recently installed.	It may take up to 24 hours for each compartment to reach the desired temperature.
	Air vents are blocked.	Rearrange items to allow air to flow throughout the compartment. Refer to the Airflow diagram in the Using Your Fridge section.
	Doors are opened often or for long periods of time.	When the doors are opened often or for long periods of time, warm, humid air enters the compartment. This raises the temperature and moisture level within the compartment. To lessen the effect, reduce the frequency and duration of door openings.
	Unit is installed in a hot location.	The fridge should not be operated in temperatures above 110°F(43°C).
	A large amount of food or hot food was added to either compartment.	Adding food warms the compartment requiring the cooling system to run. Allowing hot food to cool to room temperature before putting it in the fridge will reduce this effect.
	Doors not closed correctly.	See the Doors will not close correctly or pop open section in Parts & Features Troubleshooting.
	Temperature control is not set correctly.	If the temperature is too warm, adjust the control one increment at a time and wait for the temperature to stabilize. Refer to the Setting the Controls section for more information.
	Defrost cycle has recently completed.	During the defrost cycle, the temperature of each compartment may raise slightly and condensation may form on the back wall. Wait 40 minutes and confirm the proper temperature has been restored once the defrost cycle has completed.

Problem	Possible Causes	Solutions
Interior moisture buildup.	Doors are opened often or for long periods of time.	When the doors are opened often or for long periods of time, warm, humid air enters the compartment. This raises the temperature and moisture level within the compartment. To lessen the effect, reduce the frequency and duration of door openings.
	Doors not closed correctly.	See the Doors will not close correctly section in the Troubleshooting section.
	Weather is humid.	Humid weather allows additional moisture to enter the compartments when the doors are opened leading to condensation or frost. Maintaining a reasonable level of humidity in the home will help to control the amount of moisture that can enter the compartments.
	Defrost cycle recently completed.	During the defrost cycle, the temperature of each compartment may be raised slightly and condensation may form on the back wall. Wait 40 minutes and confirm that the proper temperature has been restored once the defrost cycle has completed.
	Food is not packaged correctly.	Food stored uncovered or unwrapped, and damp containers can lead to moisture accumulation within each compartment. Wipe all containers dry and store food in sealed packaging to prevent condensation and frost.
Food is freezing in the fridge compartment.	Food with high water content was placed near an air vent.	Rearrange items with high water content away from air vents.
	Fridge temperature control is set incorrectly.	If the temperature is too cold, adjust the control one increment at a time and wait for the temperature to stabilize. Refer to the Setting the Controls section for more information.
	Fridge is installed in a cold location.	When the fridge is operated in temperatures below 41°F (5°C), food can freeze in the fridge compartment. The fridge should not be operated in temperature below 55°F (13°C).
Frost or ice crystals form on frozen food (outside of package).	Door is opened frequently or for long periods of time.	When the doors are opened often or for long periods of time, warm, humid air enters the compartment. This raises the temperature and moisture level within the compartment. Increased moisture will lead to frost and condensation. To lessen the effect, reduce the frequency and duration of door openings.
	Door is not closing properly.	Refer to the Doors will not close correctly or pop open section in the Troubleshooting section.
Fridge or Freezer section is too cold.	Incorrect temperature control settings.	If the temperature is too cold, adjust the control one increment at a time and wait for the temperature to stabilize. Refer to the Setting the Controls section for more information.

Problem	Possible Causes	Solutions
Frost or ice crystals on frozen food (inside of sealed package).	Condensation from food with a high water content has frozen inside of the food package.	This is normal for food items with a high water content.
	Food has been left in the freezer for a long period of time.	Do not store food items with high water content in the freezer for a long period of time.
Clicking	The defrost control will click when the automatic defrost cycle begins and ends. The thermostat control (or fridge control on some models) will also click when cycling on and off.	Normal Operation
Rattling	Rattling noises may come from the flow of refrigerant, the water line on the back of the unit, or items stored on top of or around the fridge.	Normal Operation
	Fridge is not resting solidly on the floor.	Floor is weak or uneven or leveling legs need to be adjusted. See the Door Alignment section.
	Fridge with linear compressor was jarred while running.	Normal Operation
Whooshing	Evaporator fan motor is circulating air through the fridge and freezer compartments.	Normal Operation
	Air is being forced over the condenser by the condenser fan.	Normal Operation
Gurgling	Refrigerant flowing through the cooling system.	Normal Operation
Popping	Contraction and expansion of the inside walls due to changes in temperature.	Normal Operation
Sizzling	Water dripping on the defrost heater during a defrost cycle.	Normal Operation
Vibrating	If the side or back of the fridge is touching a cabinet or wall, some of the normal vibrations may make an audible sound.	To eliminate the noise, make sure that the sides and back cannot vibrate against any wall or cabinet.
Dripping	Water running into the drain pan during the defrost cycle.	Normal Operation

Problem	Possible Causes	Solutions
Pulsating or High-Pitched Sound	Your fridge is designed to run more efficiently to keep your food items at the desired temperature. The high efficiency compressor may cause your new fridge to run longer than your old one, but it is still more energy efficient than previous models. While the fridge is running, it is normal to hear a pulsating or high-pitched sound.	Normal Operation
Doors will not close correctly or pop open.	Food packages are blocking the door open.	Rearrange food containers to clear the door and door shelves.
	Ice bin, crisper cover, pans, shelves, door bins, or baskets are out of position.	Push bins all the way in and put crisper cover, pans, shelves and baskets into their correct positions. See the Using Your Fridge section for more information.
	The doors were removed during product installation and not properly replaced.	Remove and replace the doors according to the Removing and Replacing Fridge Handles and Doors section.
	Fridge is not leveled properly.	See Door Alignment in the Height adjustment section to level fridge.
Doors are difficult to open.	The gaskets are dirty or sticky.	Clean the gaskets and the surfaces that they touch. Rub a thin coat of appliance polish or kitchen wax on the gaskets after cleaning.
	Door was recently closed.	When you open the door, warmer air enters the fridge. As the warm air cools, it can create a vacuum. If the door is hard to open, wait one minute to allow the air pressure to equalize, then see if it opens more easily.
Fridge wobbles or seems unstable.	Leveling legs are not adjusted properly.	Refer to the Leveling and Door Alignment section.
	Floor is not level.	It may be necessary to add shims under the leveling legs or rollers to complete installation.
Lights do not work.	LED interior lighting failure.	The fridge compartment lamp is LED interior lighting, and service should be performed by a qualified technician.
Fridge has an unusual odor.	The Hygiene Fresh filter may need to be set to the POWER setting or replaced.	Set the Hygiene Fresh filter to the POWER setting. If the odor does not go away within 24 hours, the filter may need to be replaced. See the Replacing the Hygiene Fresh filter section for replacement instructions.
The interior of the fridge is covered with dust or soot.	The fridge is located near a fire source, such as a fireplace, chimney or candle.	Make sure that the fridge is not located near a fire source, such as a fireplace, chimney, heater or candle.



Bluetooth Sound Bar



Part Names and Functions

Front panel

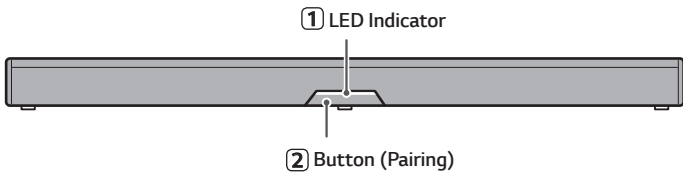

1 LED Indicator : Shows the status of the product.

2 Button (Pairing) : Press to connect or disconnect with a Bluetooth device.

LED status	Speaker status
LED turned off	Power off, disconnected
LED flashes slowly	Turning on the power
LED flashes quickly	Waiting for a Bluetooth connection (pairing)
LED turns on	Completed a Bluetooth connection (pairing)

Rear panel

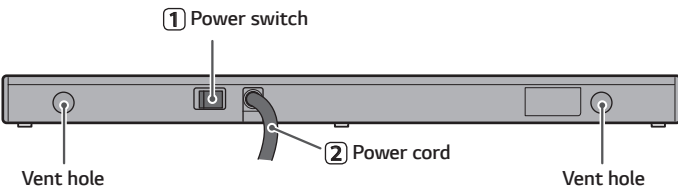

1 Power switch : Used to turn the power ON/OFF.

2 Power cord : Connect the power plug to an electrical outlet.

MODEL : GB-B1**

OWNER'S MANUAL

Please read this manual carefully before operating and retain it for future reference.



MFL69002203

<http://www.lg.com>



Specifications

General	
Dimensions (W x H x D)	Approx. 552 mm x 33 mm x 105 mm (21.7" x 1.3" x 4.1")
Net Weight	Approx. 1.1 kg (2.42 lb)
Power Consumption	4.8W
Voltage Rating	100-240 V-
Operating Temperature	5 °C to 35 °C (41 °F to 95 °F)
Operating Humidity	5 % to 90 %

Amplifier	
Total	5 W + 5 W(8 Ω at 1 kHz)
THD	1%

Speaker	
Type	Built-in
Impedance Rate	8 Ω
Rated Input Power	5 W
Max. Input Power	10 W

- Design and product specifications could change without any prior notice.
- Wireless communication devices cannot be used to provide services critical to personal safety because there is a possibility of electrical wave interference while they are in use.
- This device is suitable for home (B grade) electromagnetic wave and for home use, and it can be used in all regions.



Connecting and Disconnecting Devices

About Bluetooth.

Bluetooth is a wireless communication technology used for short distance transmissions. Bluetooth connections can be made within a 32-foot (10-meter) range. (Bluetooth connections can be interfered with by radio waves or other Bluetooth devices.)

There is no cost to connect Bluetooth devices.

Devices which support Bluetooth include mobile phones, MP3 players, notebook computers, PDAs, and PMPs.

Bluetooth Profile.

To use this Bluetooth wireless technology, the paired device should support the A2DP profile (Advanced Audio Distribution Profile).

- 1 Turn on the switch at the back of the product.

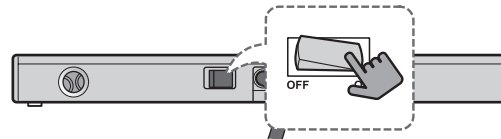

- 2 Enable Bluetooth on your device. When the LED indicator on the front of the sound bar begins to flash quickly, pair the sound bar and your Bluetooth device using Bluetooth tethering.

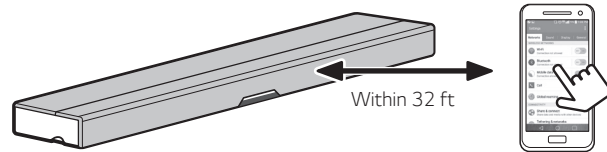

- 3 When the sound bar is successfully paired with the Bluetooth device, the LED indicator stays ON.

- 4 Play music on the Bluetooth device.

- 5 Pressing the pairing button on the front of the sound bar or disabling Bluetooth on your device causes Bluetooth to disconnect and the music to stop.

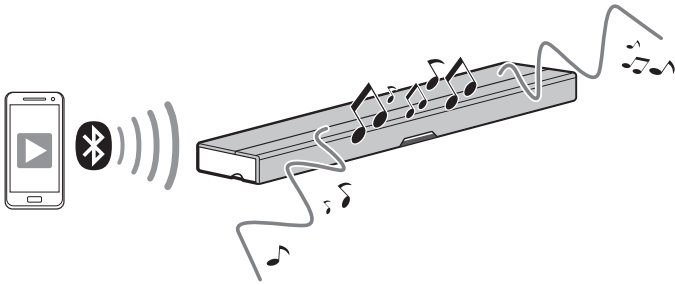

Caution

- Some Bluetooth devices may not function properly with this product.
- When there is an obstacle or a person between the product and a Bluetooth device, connection may not be made or may disengage even within 32 ft (10 m).
- As the distance between the product and a Bluetooth device becomes greater, the connection may not work properly.
- Other Bluetooth devices which use the same frequency, such as medical devices, microwave ovens, or wireless LANs, may interfere with the connection between the sound bar and a Bluetooth device.
- Be cautious that volume control cannot be made to some Bluetooth devices connected by a Bluetooth dongle.
- Maximum output could be a bit low with some Bluetooth devices.
- Cards with magnetic strips, or other objects which can be damaged by magnetic fields, should not be placed close to the sound bar.

Notice

- Select "LG_Refrigerator: XXXX" in the Bluetooth device. (XXXX stands for the last four digits of Bluetooth address.)
- Input four-digit PIN code(0000) when required by the Bluetooth device.
- Pairing method could differ by Bluetooth device. Try searching again if the address of the product is not found under the list of connectable devices.
- Refer to the manual of the Bluetooth device for the method of playing music.
- After the music begins to play, make any necessary adjustments to the volume on the Bluetooth device.
- If the product fails to pair with the Bluetooth device for more than 10 minutes, it goes into wait mode.
- Press the pairing button to enable pairing when the product is in wait mode.
- The Bluetooth device once paired with the product could be paired again without pressing the button.
- When the product is turned on again after turnoff, a Bluetooth device has to be reconnected.
- This product cannot operate a Bluetooth device, and multi-connection is not supported.
- The product doesn't support telephone function, and making or receiving a call while playing music stops the music.
- Playing at the maximum volume of a Bluetooth device could distort the sound.
- Accumulated dust or foreign substances could decrease sound quality. Refer to 'cleaning procedure' at the back of this manual.

Safety Information

READ ALL INSTRUCTIONS BEFORE USING THE APPLIANCE.

This guide contains many important safety messages. Always **read and obey** all safety messages.



This is the safety alert symbol. It alerts you to safety messages that inform you of hazards that can kill or hurt you or others, or cause damage to the product.

All safety messages will be preceded by the safety alert symbol and the hazard signal word WARNING or CAUTION. These words mean:



WARNING You can be killed or seriously injured if you do not follow instructions.



CAUTION Indicates an imminently hazardous situation which, if not avoided, may result in minor or moderate injury, or product damage.



WARNING

To reduce the risk of fire, electric shock, or personal injury when using this product, follow basic safety precautions, including the following:

Power

- When using a multi-electricity outlet, do not plug-in multiple products at the same time.
- Be cautious that power cord is not upturned or power plug is not pressed by the back of the product.
- Unplug while cleaning.
- Do not touch a power plug with wet hands.
- Remove moisture and dust from the power plug first and firmly plug in to an electrical outlet.
- When unplugging, do not pull the power cord but hold the power plug.
- When power cord or an power plug are damaged, or electricity outlet holes become loose, stop using and contact the LG Electronics service center.
- Unplug during lightning storms or when the product is not used for a long period of time.
- Do not force the power cord to be bent or damaged by placing a heavy object on it.
- Do not extend the length of the power cord or modify it.

Installation

- Do not place a heavy object on the product.

Use

- Only qualified LG Electronics service center personnel should disassemble, repair, or modify the product. Consult with LG Electronics service center for reinstallation.
- Do not use or stock fire devices or combustible materials (ether, benzene, alcohol, chemicals, LP gas, combustible spray, pesticide, air freshener, cosmetics, etc.) on or near the product.
- Do not place objects, or containers with liquids or flammable substances on the product.
- Do not insert or drop metals (coins, hairpins, needles) or inflammable substances (matches, paper) in the ventilation holes.

Disposal

- Dispose of all packing materials including vinyl and Styrofoam out of the reach of children.



WARNING

This product contains chemicals known to the State of California to cause cancer and birth defects or other reproductive harm. **Wash hands after handling.**



CAUTION

Installation

- Do not install in areas with high moisture or where it will be exposed to water or weather.
- Install by directly attaching on the surface of a refrigerator top.
- Do not install in a confined space such as in the drawer or kitchen sink.
- Do not install in a location which is unstable or has high vibration.
- Do not place near a magnetic field such as near a magnet.
- Do not install in direct sunlight.

Use

- Do not drop an object or inflict a shock on the product.
- Be careful when carrying the product.
- Do not use at excessive volume for a long period of time.
- Do not use the product on a blanket, an electric pad, or a carpet for a long period of time.
- Do not block the ventilation holes with tablecloths, curtains, or other obstructions.

Troubleshooting

No power.

- Insert the power plug into the electricity outlet correctly and firmly.
- Check if the power switch is on.

No sound or sound distortion

- The unit or your smart device's volume is set to minimum. Check and adjust the volume of the unit or bluetooth device's volume.
- When you use an external device at high volume, the sound quality may be deteriorated. Lower the volume of the devices.
- If you use the unit for purposes other than listening to music, the sound quality may be lowered or the unit may not work properly.

Bluetooth pairing does not work well.

- Switch bluetooth off and on again on your bluetooth device, then try pairing again.
- Remove the obstacle in the path of the bluetooth device and the unit.
- Depending on the type of the bluetooth device or surrounding environment, your device may not be paired with the unit.
- If your bluetooth device is connected to another unit, disable that bluetooth connection first.

The unit does not operate normally.

- When product doesn't operate normally, check the status after turning off and turning on the power switch.

Regulation Notice for Transmitter Module Contained in Refrigerator

FCC Statement:

This device complies with Part 15 of the FCC Rules. Operation is subject to the following two conditions:
(1) this device may not cause harmful interference, and
(2) this device must accept any interference received, including interference that may cause undesired operation.

Any changes or modifications not expressly approved by the party responsible for compliance could void the user's authority to operate this equipment.

This equipment has been tested and found to comply with the limits for a Class B digital device, pursuant to part 15 of the FCC Rules. These limits are designed to provide reasonable protection against harmful interference in a residential installation. This equipment generates, uses and can radiate radio frequency energy and, if not installed and used in accordance with the instructions, may cause harmful interference to radio communications. However, there is no guarantee that interference will not occur in a particular installation. If this equipment does cause harmful interference to radio or television reception, which can be determined by turning the equipment off and on, the user is encouraged to try to correct the interference by one or more of the following measures:
- Increase the separation between the equipment and receiver.
- Connect the equipment into an outlet on a circuit different from that to which the receiver is connected.
- Consult the dealer or an experienced radio/TV technician for help.
- Reorient or relocate the receiving antenna

FCC RF Radiation Exposure Statement:

This equipment complies with FCC radiation exposure limits set forth for an uncontrolled environment. This equipment should be installed and operated with minimum distance 20 cm between the radiator and your body. End users must follow the specific operating instructions for satisfying RF exposure compliance. This transmitter must not be co-located or operating in conjunction with any other antenna or transmitter.

Industry Canada Statement:

This device complies with RSS-210 of the Industry Canada Rules. Operation is subject to the following two conditions:

- 1) this device may not cause interference and
- 2) this device must accept any interference, including interference that may cause undesired operation of the device

Note: The manufacturer is not responsible for any radio or TV interference caused by unauthorized modifications to this equipment. Such modifications could void the user's authority to operate the equipment.

IC Radiation Exposure Statement:

This equipment complies with IC radiation exposure limits set forth for an uncontrolled environment. This equipment should be installed and operated with minimum distance 20 cm between the radiator and your body.

Operation of the equipment is subject to the following two conditions:

- (1) this equipment or device may not be used to cause harmful interference and
- (2) this equipment or device must accept any interference, including interference that may cause undesirable operation.