

### Front Panel

The buttons are located on the side.

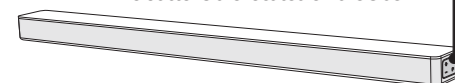

- (Standby) ..... Switches the unit ON or OFF
- F** (Function) ..... Selects Function
- +/-** (Volume) ..... Adjusts Volume

### Rear Panel

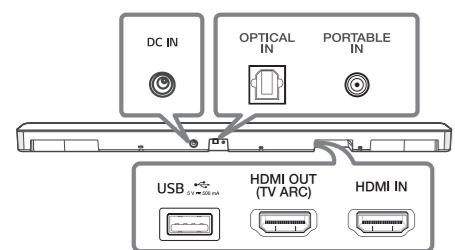

- DC IN ..... Connect to the AC adapter
- OPTICAL IN ..... Connect to an Optical device
- PORTABLE IN ..... Connect to a Portable device
- USB ..... Connect to a USB device
- HDMI OUT (TV ARC) ..... Connect to a TV
- HDMI IN ..... Connect to HDMI out on a device

## 1 Subwoofer Connection

Place the wireless subwoofer near the speaker and follow steps below.

- 1 Connect the power cord of wireless subwoofer and sound bar to the outlet.
- 2 Turn on the main unit :  
The sound bar and wireless subwoofer will be **automatically** connected. The subwoofer's green LED turns on.

### Subwoofer Connection Manually

If the subwoofer does not make sound, try to connect manually.

- 1 Press **Pairing** button on the rear of the wireless subwoofer.
  - The green LED on the rear of wireless subwoofer blinks quickly. (If the green LED does not blink, press and hold the Pairing button.)
- 2 Turn on the main unit.
- 3 Pairing is completed.
  - The green LED on the rear of wireless subwoofer turns on.

**!** Keep the sound bar and the subwoofer away from the device (ex. wireless router, microwave oven, etc.) over 1 m (3.3 ft) to prevent wireless interference.

## 2 TV Connection

Connect with the Sound Bar and TV using Optical (A) or HDMI ARC (B).

### A Optical Connection

- 1 Connect the sound bar to the TV using Optical cable.
- 2 Set up [External Speaker (Optical)] on your TV setting menu.

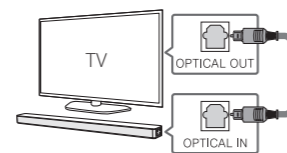

### B HDMI(ARC) Connection

- 1 Connect the sound bar to the TV using HDMI cable.
- 2 Set up [External Speaker (HDMI ARC)] on your TV setting menu.

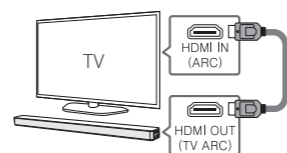

**!** HDMI connection is unavailable if your TV does not support HDMI ARC.

- If this unit is connected by OPTICAL and ARC at the same time, the ARC signal is a high priority.

### Additional Device Connection

- 1 Connect to the external device as follows.

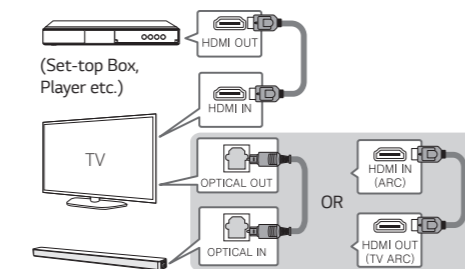

- 2 Set the input source by pressing **F** on the remote control or unit repeatedly.

## Remote control

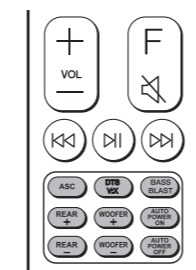

**ASC/DTS V:X/BASS BLAST:** Selects the sound effect.

**REAR +/-:** Adjusts the volume level of rear speakers. (For rear speakers)

**!** Adjustment of the Rear speakers volume levels and using Surround Sound are applied only when the rear speakers are connected.  
Rear speaker kit sold separately.

**WOOFER +/-:** Adjusts the volume level of subwoofer.

**AUTO POWER ON/OFF:** Automatically turns on by an input source.

### Replacement of battery

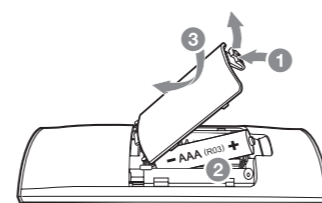

## Additional Information

### Specification

Power consumption	Refer to the main label.
AC adapter	<ul style="list-style-type: none"> <li>• Model : DA-38A2S</li> <li>• Manufacturer : Asian Power Devices Inc.</li> <li>• Input : 100 - 240 V ~ 50 - 60 Hz</li> <li>• Output : 25 V <math>\overline{\overline{=}}</math> 1.52 A</li> </ul>
Dimensions (W x H x D)	Approx. 891.0 mm X 57.5 mm X 87.8 mm With foot (35 inch x 2.2 inch x 3.4 inch)
Bus Power Supply (USB)	5 V $\overline{\overline{=}}$ 500 mA
Amplifier (Total RMS Output power)	360 W RMS

Design and specifications are subject to change without notice.

**!** **Rear Speakers Ready**  
Ready for surround sound with Rear Speakers Kit sold separately. (SPK8-S)

## OPEN SOURCE SOFTWARE NOTICE INFORMATION

To obtain the source code under GPL, LGPL, MPL, and other open source licenses, that is contained in this product, please visit <http://opensource.lge.com>.

In addition to the source code, all referred license terms, warranty disclaimers and copyright notices are available for download.

LG Electronics will also provide open source code to you on CD-ROM for a charge covering the cost of performing such distribution (such as the cost of media, shipping, and handling) upon email request to [opensource@lge.com](mailto:opensource@lge.com). This offer is valid for a period of three years after our last shipment of this product. This offer is valid to anyone in receipt of this information.

