

USER GUIDE

LG V20

LG-H990

Copyright ©2018 LG Electronics, Inc. All rights reserved.

MFL69728502 (1.0)

www.lg.com

About this user guide

Thank you for choosing this LG product. Please carefully read this user guide before using the device for the first time to ensure safe and proper use.

- Always use genuine LG accessories. The supplied items are designed only for this device and may not be compatible with other devices.
- This device is not suitable for people who have a visual impairment due to the touchscreen keyboard.
- Descriptions are based on the device default settings.
- Default apps on the device are subject to updates, and support for these apps may be withdrawn without prior notice. If you have any questions about an app provided with the device, please contact an LG Service Centre. For user-installed apps, please contact the relevant service provider.
- Modifying the device's operating system or installing software from unofficial sources may damage the device and lead to data corruption or data loss. Such actions will violate your LG licence agreement and void your warranty.
- Some content and illustrations may differ from your device, depending on the area, service provider, software version, or OS version, and are subject to change without prior notice.
- Software, audio, wallpaper, images, and other media supplied with your device are licenced for limited use. If you extract and use these materials for commercial or other purposes, you may be infringing copyright laws. As a user, you are fully responsible for the illegal use of media.
- Additional charges may incur for data services, such as messaging, uploading, downloading, auto-syncing and location services. To avoid additional charges, select a data plan suitable to your needs. Contact your service provider to obtain additional details.

Instructional notices



WARNING: Situations that could cause injury to the user and third parties.



CAUTION: Situations that may cause minor injury or damage to the device.



NOTE: Notices or additional information.

Table of contents

5 Guidelines for safe and efficient use

01

Custom-designed Features

- 13 Second screen
- 15 Video recording features
- 18 Audio recording features
- 21 Multi-tasking feature
- 22 Fingerprint recognition
- 26 quick share

02

Basic Functions

- 28 Product components and accessories
- 29 Parts overview
- 31 Turning the power on or off
- 32 Installing the SIM card
- 33 Inserting the memory card
- 34 Removing the memory card
- 34 Battery

- 38 Touch screen
- 41 Home screen
- 49 Screen lock
- 52 Memory card encryption
- 53 Taking screenshots
- 53 Entering text
- 59 Content sharing
- 62 Do not disturb

03

Useful Apps

- 64 Installing and uninstalling apps
- 65 App trash
- 66 App Shortcuts
- 67 Phone
- 71 Messaging
- 72 Camera
- 89 Gallery
- 93 Music
- 94 E-mail
- 95 Calendar
- 97 QuickMemo+
- 99 Calculator

100	Clock
101	Downloads
101	File Manager
101	FM Radio
102	Contacts
104	LG Health
105	QuickRemote
107	LG SmartWorld
107	Tasks
107	LG Friends Manager
108	LG Mobile Switch
108	RemoteCall Service
109	Smart Doctor
109	Evernote
109	Facebook
109	Instagram
110	Chrome
110	Google apps
111	In Apps

04

Phone Settings

113	Settings
113	Network
125	Sound
126	Display
127	General

05

Appendix

138	LG Language Settings
138	LG Bridge
139	Phone software update
141	FAQ
145	Anti-Theft Guide
146	More information

Guidelines for safe and efficient use

Please read these simple guidelines. Not following these guidelines may be dangerous or illegal.

Should a fault occur, a software tool is built into your device that will gather a fault log. This tool gathers only data specific to the fault, such as signal strength, cell ID position in sudden call drop and applications loaded. The log is used only to help determine the cause of the fault. These logs are encrypted and can only be accessed by an authorised LG Repair centre should you need to return your device for repair.

Exposure to radio frequency energy

Radio wave exposure and Specific Absorption Rate (SAR) information.

This device has been designed to comply with applicable safety requirements for exposure to radio waves. These requirements are based on scientific guidelines that include safety margins designed to assure the safety of all persons, regardless of age and health.

- The radio wave exposure guidelines employ a unit of measurement known as the Specific Absorption Rate, or SAR. Tests for SAR are conducted using standardised methods with the device transmitting at its highest certified power level in all used frequency bands.
- While there may be differences between the SAR levels of various LG device models, they are all designed to meet the relevant guidelines for exposure to radio waves.
- The SAR limit recommended by the International Commission on Non-Ionizing Radiation Protection (ICNIRP) is 2 W/kg averaged over 10 g of tissue.
- The highest SAR value for this model tested for use at the ear is 0.824 W/kg (10 g) and when worn on the body is 0.892 W/kg (10 g).

- This device meets RF exposure guidelines when used either in the normal use position against the ear or when positioned at least 5 mm away from the body. When a carry case, belt clip or holder is used for body-worn operation, it should not contain metal and should position the product at least 5 mm away from your body. In order to transmit data files or messages, this device requires a quality connection to the network. In some cases, transmission of data files or messages may be delayed until such a connection is available. Ensure the above separation distance instructions are followed until the transmission is completed.

Product care and maintenance

- Always use genuine LG batteries, chargers and accessories approved for use with this particular device model. The use of any other types may invalidate any approval or warranty applying to the device and may be dangerous.
- Some contents and illustrations may differ from your device without prior notice.
- Do not disassemble this unit. Take it to a qualified service technician when repair work is required.
- Repairs under warranty, at LG's discretion, may include replacement parts or boards that are either new or reconditioned, provided that they have functionality equal to that of the parts being replaced.
- Keep away from electrical appliances such as TVs, radios and personal computers.
- The unit should be kept away from heat sources such as radiators or cookers.
- Do not drop.
- Do not subject this unit to mechanical vibration or shock.
- Switch off the device in any area where you are required to by special regulations. For example, do not use your device in hospitals as it may affect sensitive medical equipment.
- Do not handle the device with wet hands while it is being charged. It may cause an electric shock and can seriously damage your device.
- Do not charge a handset near flammable material as the handset can become hot and create a fire hazard.

- Use a dry cloth to clean the exterior of the unit (do not use solvents such as benzene, thinner or alcohol).
- Do not charge the device when it is on soft furnishings.
- The device should be charged in a well ventilated area.
- Do not subject this unit to excessive smoke or dust.
- Do not keep the device next to credit cards or transport tickets; it can affect the information on the magnetic strips.
- Do not tap the screen with a sharp object as it may damage the device.
- Do not expose the device to liquid or moisture.
- Use accessories like earphones cautiously. Do not touch the antenna unnecessarily.
- Do not use, touch or attempt to remove or fix broken, chipped or cracked glass. Damage to the glass display due to abuse or misuse is not covered under the warranty.
- Your device is an electronic device that generates heat during normal operation. Extremely prolonged, direct skin contact in the absence of adequate ventilation may result in discomfort or minor burns. Therefore, use care when handling your device during or immediately after operation.
- If your device gets wet, immediately unplug it to dry off completely. Do not attempt to accelerate the drying process with an external heating source, such as an oven, microwave or hair dryer.
- The liquid in your wet device, changes the colour of the product label inside your device. Damage to your device as a result of exposure to liquid is not covered under your warranty.

Efficient device operation

Electronics devices

All devices may receive interference, which could affect performance.

- Do not use your device near medical equipment without requesting permission. Avoid placing the device over pacemakers, for example, in your breast pocket.
- Some hearing aids might be disturbed by devices.
- Minor interference may affect TVs, radios, PCs etc.
- Use your device in temperatures between 0 °C and 35 °C, if possible. Exposing your device to extremely low or high temperatures may result in damage, malfunction, or even explosion.

Road safety

Check the laws and regulations on the use of devices in the area when you drive.

- Do not use a hand-held device while driving.
- Give full attention to driving.
- Pull off the road and park before making or answering a call if driving conditions so require.
- RF energy may affect some electronic systems in your vehicle such as car stereos and safety equipment.
- When your vehicle is equipped with an air bag, do not obstruct with installed or portable wireless equipment. It can cause the air bag to fail or cause serious injury due to improper performance.
- If you are listening to music whilst out and about, please ensure that the volume is at a reasonable level so that you are aware of your surroundings. This is of particular importance when near roads.

Avoid damage to your hearing



To prevent possible hearing damage, do not listen at high volume levels for long periods.

Damage to your hearing can occur if you are exposed to loud sound for long periods of time. We therefore recommend that you do not turn on or off the handset close to your ear. We also recommend that music and call volumes are set to a reasonable level.

- When using headphones, turn the volume down if you cannot hear the people speaking near you, or if the person sitting next to you can hear what you are listening to.



- Excessive sound pressure from earphones and headphones can cause hearing loss.

Glass Parts

Some parts of your device are made of glass. This glass could break if your device is dropped on a hard surface or receives a substantial impact. If the glass breaks, do not touch or attempt to remove it. Stop using your device until the glass is replaced by an authorised service provider.

Blasting area

Do not use the device where blasting is in progress. Observe restrictions and follow any regulations or rules.

Potentially explosive atmospheres

- Do not use your device at a refueling point.
- Do not use near fuel or chemicals.
- Do not transport or store flammable gas, liquid or explosives in the same compartment of your vehicle as your device or accessories.

In aircraft

Wireless devices can cause interference in aircraft.

- Turn your device off before boarding any aircraft.
- Do not use it on the ground without permission from the crew.

Children

Keep the device in a safe place out of the reach of small children. It includes small parts which may cause a choking hazard if detached.

Emergency calls

Emergency calls may not be available on all mobile networks. Therefore you should never depend solely on your device for emergency calls. Check with your local service provider.

Battery information and care

- You do not need to completely discharge the battery before recharging. Unlike other battery systems, there is no memory effect that could compromise the battery's performance.
- Use only LG batteries and chargers. LG chargers are designed to maximise the battery life.
- Do not disassemble or short-circuit the battery.
- Keep the metal contacts of the battery clean.
- Replace the battery when it no longer provides acceptable performance. The battery pack may be recharged hundreds of times before it needs replacing.
- Recharge the battery if it has not been used for a long time to maximise usability.
- Do not expose the battery charger to direct sunlight or use it in high humidity, such as in the bathroom.
- Do not leave the battery in hot or cold places, as this may deteriorate battery performance.

- Risk of explosion if battery is replaced by an incorrect type. Dispose of used batteries according to the instructions.
- If you need to replace the battery, take it to the nearest authorised LG Electronics service point or dealer for assistance.
- Always unplug the charger from the wall socket after the device is fully charged to save unnecessary power consumption of the charger.
- Actual battery life will depend on network configuration, product settings, usage patterns, battery and environmental conditions.
- Make sure that no sharp-edged items such as animal's teeth or nails, come into contact with the battery. This could cause a fire.

Securing personal information

- Make sure to protect your personal information to prevent data leakage or misuse of sensitive information.
- Always back up important data while using the device. LG is not responsible for any data loss.
- Make sure to back up all data and reset the device when disposing of the device to prevent any misuse of sensitive information.
- Read the permission screen carefully while downloading applications.
- Be cautious using the applications that have access to multiple functions or to your personal information.
- Check your personal accounts regularly. If you find any sign of misuse of your personal information, ask your service provider to delete or change your account information.
- If your device is lost or stolen, change the password of your account to secure your personal information.
- Do not use applications from unknown sources.



01

Custom-designed Features

Second screen

Second screen overview

Second screen lets you open apps and see urgent info without searching for it on the main screen. Customise the screen with apps and info you need.

You can set it to be enabled when the screen is on and off.

Using the device with the main screen off

You can view the current time, date or notifications without turning on the device, and launch functions such as Quick Tools, music player and more.

- 1 Tap  > **Settings > Display > Second screen > Show when main screen off.**
- 2 Configure the options as desired.

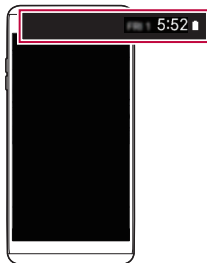

Display date and time

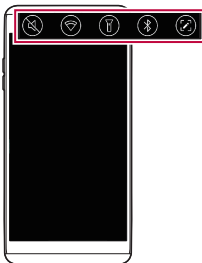

Start Quick tools

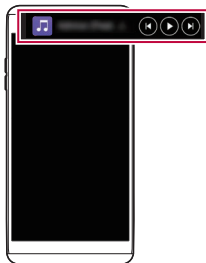

Start Music player

Expandable notifications

When a notification comes in, tap the expandable view icon to view the notification.

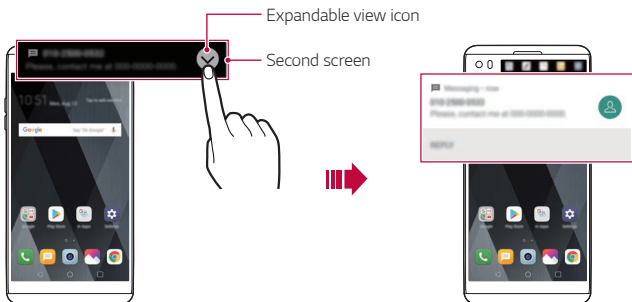

Direct reply

When you receive a notification, you can reply to the recipient from the Second screen without closing the current app.





When the notification comes in on the Second screen, tap the arrow icon, then reply to the recipient.



Video recording features

Wide-angle camera

You can take photos or record videos with a wider range than your actual field of vision by using the wide-angle on the front and rear camera.

Tap , then tap  /  or  /  to switch between the standard and wide-angle.

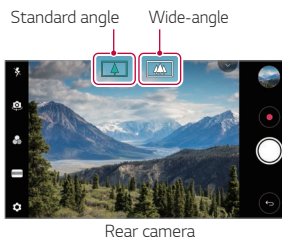
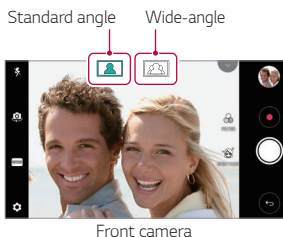

• See *Starting the camera* for details.

Steady recording

You can use the Steady recording feature to minimise motion blur while recording a video.

Launch the Camera app, then tap **AUTO** (📷) or **MANUAL** (📷) > ⚙️ > **Steady recording** ☐.



- See *Starting the camera* for details.
- This feature is unavailable in the following cases:
 - Video size limitation: Resolution is set as UHD 16:9.
 - FPS limitation: FPS is set as 1 FPS, 2 FPS, or 60 FPS.

Hi-Fi video recording

Record high quality videos by capturing higher quality sound with a wider dynamic frequency range using 3 sensitive AOP (Acoustic Overload Point) mics and incredible Hi-Fi Recording.

Launch the Camera app, then tap **MANUAL** (📷) > ⚙️ > **Hi-Fi** ☐.



- See *Starting the camera* for details.
- Hi-Fi videos can only be played in apps that support Hi-Fi.
- This feature is unavailable when you use the front camera.

Tracking focus while using the camera

You can track and maintain focus on an object while taking photos or recording videos.

- 1 Launch the Camera app, then tap  > **Tracking focus**.
- 2 Before recording a video or taking a photo, lightly tap the screen to select an object to focus on.

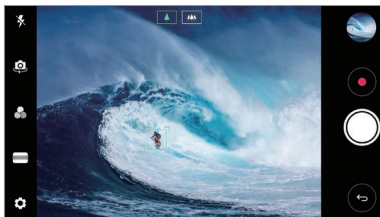

- 3 Take the photo or start recording your video.

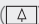

- See *Starting the camera* for details.
- To use this feature, select the standard camera () for taking photos or recording videos.
- This feature is unavailable when you use the front camera or the wide-angle camera for taking a photo or recording a video.
- This feature is unavailable in the following cases:
 - Video size limitation: Resolution is set as UHD 16:9.
 - FPS limitation: FPS is set as 60 FPS.

Audio recording features

HD Audio Recorder overview

You can configure the audio settings manually so that you can record audio based on the settings optimised for the selected mode.

Recording modes

You can record a highly defined audio file by selecting and configuring the audio mode to suit the recording environment.

Tap  > **HD Audio Recorder**.

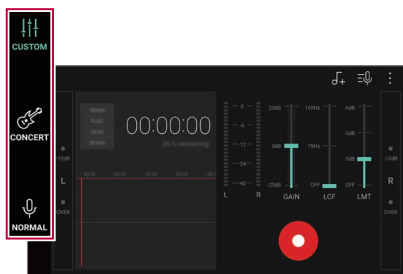

CUSTOM

You can configure the desired settings to record audio.

CONCERT

You can record audio in a concert or other music events.

NORMAL

You can record audio without extra settings.



Studio mode

You can play an audio file and record your voice at the same time.

You can record your voice along with the background music you selected.

You can also create a chord by recording your voice multiple times.

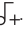
You can record your comments over the original audio file of the presenter or speaker.

- 1 Tap  > **HD Audio Recorder**.
- 2 On the Second screen, select **CUSTOM**.
- 3 Tap .
- 4 Select an audio file to use as background music.
- 5 Tap  to record voice.
- 6 Tap  to save the recorded file.



- Background music can only be played through earphones. Make sure to plug in earphones before using this feature.

Other useful features for use of the HD Audio Recorder app

GAIN

You can adjust the sensitivity of the sound recorded by the microphone. The higher the GAIN value is set, the more sensitively the sound is recorded.

LCF

You can filter any low-pitched noises such as the low hum of the air conditioner.

The higher the LCF (Low Cut Filter) value is set, the better high-frequency noises are filtered.

LMT

It can prevent clipping of the recorded sound. The higher the LMT (Limiter) value is set, the more low frequency sounds that will not get clipped.



- With one of the three recording modes selected, tap > **Settings**, then customise the file type, bit depth, sampling rate and other settings.
- When you connect the earpiece to the device, appears. Tap and then select the microphone to use.
- You can monitor sound quality with the connected earpiece while recording an audio. While recording an audio in Studio mode, the sound monitoring is not supported. You can hear only the background music.

Multi-tasking feature

Multi-Window

You can use two apps at the same time by separating the screen into the multiple windows.

While using an app, touch and hold  from the Home touch buttons, then select an app from the recently used apps list.

- You can use two apps displayed on the main screen at the same time.
- To stop the Multi-Window feature, touch and hold .

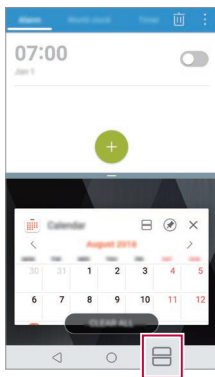
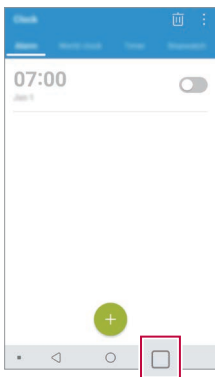

- You can use this feature in an app that supports the Multi-Window feature.
- The Multi-Window feature is not supported by some apps, including downloaded apps.

Overview screen

The Overview screen provides a preview of your recently used apps.

To view the list of recently used apps, tap  on the Home, then tap the displayed app.

- Touch and hold an app and drag it to the top of the screen to start the app with the Multi-Window. You can also tap  at the top of each app.

Fingerprint recognition

Fingerprint recognition overview

You must register your fingerprint on your device first before using the fingerprint recognition function.

You can use the fingerprint recognition function in the following cases:

- To unlock the screen
- To view the locked content in the **Gallery** or **QuickMemo+**.
- Confirm a purchase by signing in to an app or identifying yourself with your fingerprint.



- Your fingerprint can be used by the device for user identification. Very similar fingerprints from different users may be recognised by the fingerprint sensor as the same fingerprint. To enhance the device security, set the screen lock to a pattern, PIN or password.

Precautions for fingerprint recognition

Fingerprint recognition accuracy may decrease due to a number of reasons. To maximise the recognition accuracy, check the following before using the device.

- The device's Power/Lock key has a fingerprint sensor. Ensure that the Power/Lock key is not damaged by a metallic object, such as coin or key.
- When water, dust or other foreign substance is on the Power/Lock key or your finger, the fingerprint registration or recognition may not work. Clean and dry your finger before having the fingerprint recognised.
- A fingerprint may not be recognised properly if the surface of your finger has a scar or is not smooth due to being soaked in water.
- If you bend your finger or use the fingertip only, your fingerprint may not be recognised. Make sure that your finger covers the entire surface of the Power/Lock key.
- Scan only one finger for each registration. Scanning more than one finger may affect fingerprint registration and recognition.
- The device may generate static electricity if the surrounding air is dry. If the surrounding air is dry, avoid scanning fingerprints, or touch a metallic object such as coin or key before scanning fingerprints to remove static electricity.

Registering fingerprints

You can register and save your fingerprint on the device to use fingerprint identification.

1 Tap  > **Settings** > **General** > **Lock screen & security** > **Fingerprints**.



- This feature is available when the secured lock is activated.
 - Lock the device with Knock Code, Pattern, PIN, Password and more.
- If the screen lock is not active, configure the lock screen by following the on-screen instructions. See [Configuring screen lock settings](#) for details.

2 Locate the Power/Lock key on the back of the device and gently put your finger on it to register the fingerprint.



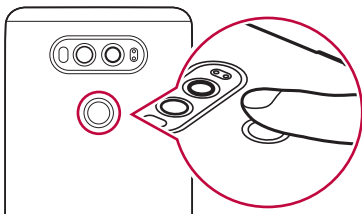

- Gently press the Power/Lock key so that the sensor can recognise your fingerprint. If you press the Power/Lock key with an excessive force, the screen lock function may start or the screen may be turned off.
- Ensure that your fingertip covers the entire surface of the sensor of the Power/Lock key.



- 3 Follow the on-screen instructions.
 - Repeat scanning the fingerprint by moving your finger little by little until the fingerprint registers.
- 4 When the fingerprint registration is done, tap **OK**.
 - Tap **Add fingerprint** to register another fingerprint. If you register only one fingerprint and the corresponding finger is not in a good condition, the fingerprint recognition may not work well. As the preventive measure against this kind of situation, register multiple fingerprints.

Managing fingerprints

You can edit or delete registered fingerprints.

- 1 Tap  > **Settings** > **General** > **Lock screen & security** > **Fingerprints**.
- 2 Unlock according to the specified lock method.
- 3 From the fingerprint list, tap a fingerprint to rename it. To delete it, tap .

Unlocking the screen with a fingerprint

You can unlock the screen or view the locked content by using your fingerprint. Activate the desired function:

- 1 Tap  > **Settings** > **General** > **Lock screen & security** > **Fingerprints**.
- 2 Unlock according to the specified lock method.
- 3 On the fingerprint settings screen, activate the desired function:
 - **Screen lock**: Unlock the screen with a fingerprint.
 - **Content lock**: Unlock content with a fingerprint. To do this, make sure that the content lock is set.

quick share

You can share a photo or video to the app you want immediately after taking it.

- 1 Tap  then take a photo or record a video.
- 2 Tap the app icon that appears on the screen to share it using that app. You can also swipe the icon towards the opposite direction to see what other apps you can use to share your photos and videos.

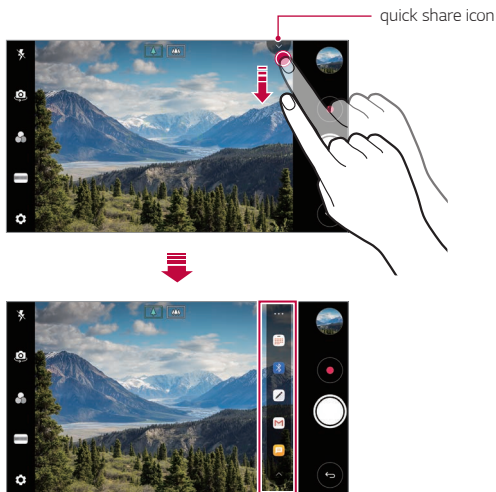

- The app displayed by the quick share icon may vary, depending on the type and frequency of access to the apps installed on the device.
- You can use this feature only when you take a photo or record a video in the AUTO mode. See [AUTO mode](#) for details.



02

Basic Functions

Product components and accessories

The following items are included with your device.

- Device
- Battery
- Stereo headset
- USB cable
- Charger
- Quick Start Guide



- The items described above may be optional.
- The items supplied with the device and any available accessories may vary depending on the area and service provider.
- Always use genuine LG Electronics accessories. Using accessories made by other manufacturers may affect your device's call performance or cause malfunctions. This may not be covered by LG's repair service.



- If any of these basic items are missing, contact the dealer from which you purchased your device.
- To purchase additional basic items, contact an LG Customer Service Centre.
- To purchase optional items, contact an LG Customer Service Centre for available dealers.
- Some items in the product box are subject to change without notice.
- The appearance and specifications of your device are subject to change without notice.
- Device specifications may vary depending on the area or service provider.
- Be sure to use authentic accessories provided by LG Electronics. Using third-party accessories may damage the device or cause malfunctions.
- Remove the protective film from the Fingerprint sensor before use of the fingerprint recognition feature.
- Remove the protective film on the camera lens if necessary.

Parts overview

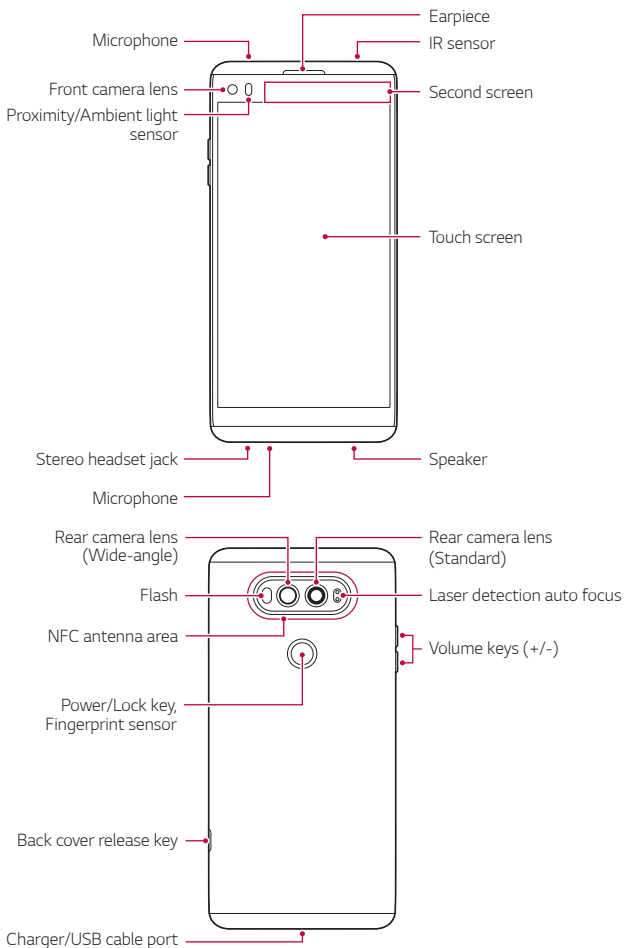

- Proximity/Ambient light sensor
 - Proximity sensor: During a call, the proximity sensor turns off the screen and disables touch functionality when the device is in close proximity to the human body. It turns the screen back on and enables touch functionality when the device is outside a specific range.
 - Ambient light sensor: The ambient light sensor analyses the ambient light intensity when the auto-brightness control mode is turned on.
- Laser detection auto focus
 - Detect the distance from the camera to your subject for automatic focusing.
 - Quickly focus on closer or farther objects when you use the rear camera to take photos.
- Volume keys
 - Adjust the volume for ringtones, calls or notifications.
 - While using the Camera, gently press a Volume key to take a photo. To take continuous shots of photos, press and hold the Volume key.
 - Press the Volume Down (-) key twice to launch the **Camera** app when the screen is locked or turned off. Press the Volume Up (+) key twice to launch **Capture+**.
- Power/Lock key (Fingerprint sensor)
 - Briefly press the key when you want to turn the screen on or off.
 - Press and hold the key when you want to select a power control option.
 - Turn on the fingerprint recognition feature to simplify the process of unlocking the screen. See *Fingerprint recognition overview* for details.



- Some functions may be restricted for access, depending on the device specifications.
- The back cover includes a built-in NFC antenna. Be cautious when handling the device to avoid damaging or covering the NFC antenna.



- Do not put heavy objects on the device or sit on it. Failure to do so may damage the touch screen.
- Screen-protective film or accessories may interfere with the proximity sensor.
- If your device is wet or is being used in a humid place, the touch screen or buttons may not function properly.

Turning the power on or off

Turning the power on

When the power is turned off, press and hold the Power/Lock key.



- When the device is turned on for the first time, initial configuration takes place. The first booting time for the smart phone may be longer than usual.

Turning the power off

Press and hold the Power/Lock key, then select **Power off**.

Power control options

Press and hold the Power/Lock key, then select an option.

- **Power off:** Turn off the device.
- **Power off and restart:** Restart the device.
- **Turn on Airplane mode:** Block telecommunication-related functions, including making phone calls, messaging and browsing the Internet. Other functions remain available.
- **Emergency:** Making a call to registered emergency number automatically.

Installing the SIM card

Insert the SIM (Subscriber Identity Module) card provided by your service provider to start using your device.

- 1 Press the back cover release key on the bottom side of the device.
- 2 Grab the back cover and remove it from the device.
- 3 Slide the SIM card into the SIM card slot with the gold-coloured contacts facing downwards.

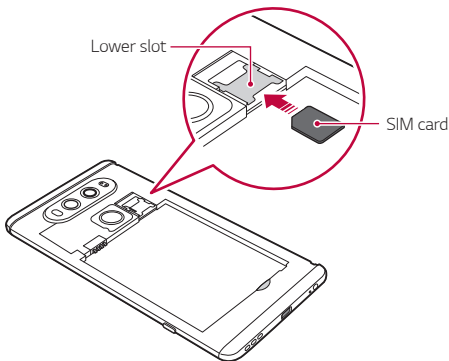

- This device supports only Nano SIM cards.
- For problem-free performance, it is recommended to use the phone with the correct type of SIM card. Always use a factory-made SIM card supplied by the operator.

Precautions when using the SIM card

- Do not lose your SIM card. LG is not responsible for damage and other issues caused by loss or transfer of a SIM card.
- Be careful not to damage the SIM card when you insert or remove it.

Inserting the memory card

Insert the memory card into your device.

The device can support up to a 2 TB microSD card. Depending on the memory card manufacturer and type, some memory card may not be compatible with your device.

- 1 Press the back cover release key on the bottom side of the device.
- 2 Grab the back cover and remove it from the device.
- 3 Insert the memory card into the memory card slot.

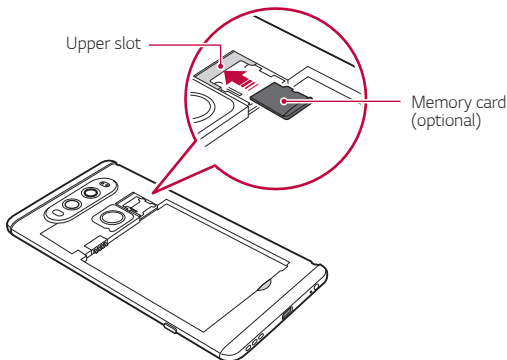



- Some memory cards may not be fully compatible with the device. If you use an incompatible card, it may damage the device or the memory card, or corrupt the data stored in it.



- Frequent writing and erasing of data may shorten the memory card lifespan.

Removing the memory card

Unmount the memory card before removing it for safety.

- 1 Tap  > **Settings** > **General** > **Storage** > .
- 2 Remove the back cover and pull out the memory card.



- Do not remove the memory card while the device is transferring or accessing information. This may cause data to be lost or corrupted, or may damage the memory card or the device. LG is not responsible for losses that result from the abuse or improper use of memory cards, including the loss of data.

Battery

Installing the battery

- 1 Press the back cover release key located at the bottom side of the device.

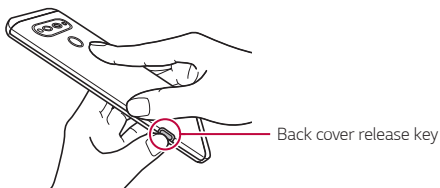

- 2 Grab the back cover and remove it from the device.

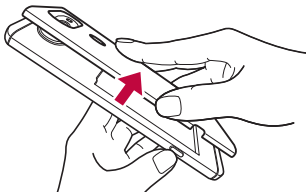

- 3 Align the battery with the battery contacts ① and insert it in place ②. Then put the back cover onto the device ③.

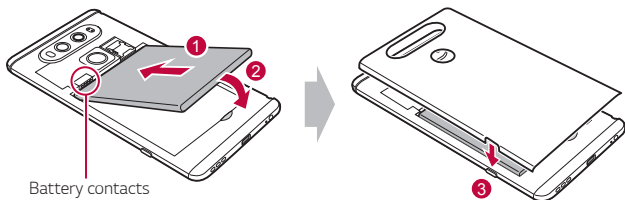

- 4 Press ① on the back cover; then press ② until the back cover is tightly fastened.

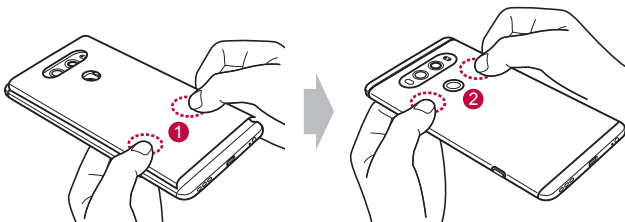

- Follow the instructions in this user guide cautiously when handling the device. Failure to do so may damage the device or cause injury to yourself or others.

Removing the battery

Open the back cover and pull out the battery.

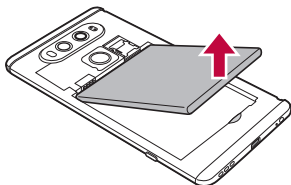

- Turn off the device before removing the battery. Failure to do so may damage the device.

Charging the battery

Before using the device, fully charge the battery.

Charge the device with the USB Type-C cable.

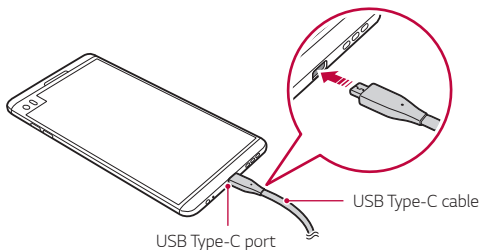



- Make sure to use the USB cable provided with your device.
- Make sure to use an LG-approved charger, battery and charging cable. Charging the battery with a third-party charger may cause the battery to explode or may damage the device.
- Using the device when it is charging may cause electric shock. To use the device, stop charging it.



- Remove the charger from the power socket after the device is fully charged. This prevents unnecessary power consumption.
- Another way to charge the battery is by connecting a USB cable between the device and a desktop or laptop computer. This may take a longer time than charging the battery in the common way.
- Do not charge the battery by using a USB hub that is unable to maintain the rated voltage. Charging may fail or unintentionally stop.

Precautions when using the device

- When replacing the battery, take extra care to ensure that no foreign substances or water enter the device.
- Ensure that the inside of the device does not make contact with a metallic object or water.
- Press the back cover release key to remove the back cover; do not use force to remove the back cover.
- Make sure to use the USB cable provided; do not use third party USB cables or chargers with your device. The LG limited warranty does not cover the use of third party accessories.
- Failure to follow the instructions in this guide and improper use may damage the device.

Using the battery efficiently

Battery lifespan may decrease if you keep many apps and functions running simultaneously and continuously.

Cancel background operations to increase battery life.

To minimise battery consumption, follow these tips:

- Turn off the **Bluetooth®** or Wi-Fi network function when not using them.
- Set the screen timeout to as short a time as possible.
- Minimise the screen brightness.
- Set a screen lock when the device is not used.
- Check the battery usage details and close any downloaded apps that are draining the battery.

Touch screen

You can familiarise yourself with how to control your device by using touch screen gestures.

Tapping

Lightly tap with your fingertip to select or run an app or option.

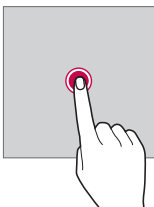

Touching and holding

Touch and hold for several seconds to display a menu with available options.

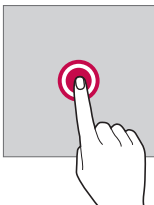

Double-tapping

Tap twice quickly to zoom in or out on a web page or map.

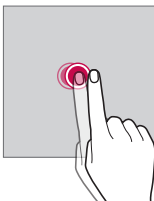

Dragging

Touch an item, such as an app or widget, then move your finger to another location in a controlled motion. You can use this gesture to move an item.

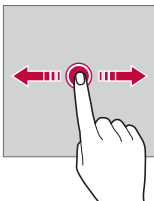

Swiping

Touch the screen with your finger and move it quickly without pausing. You can use this gesture to scroll through a list, a web page, photos, screens, and more.

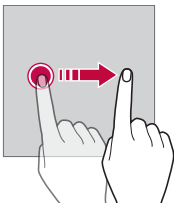

Pinching and spreading

Pinch two fingers to zoom out such as on a photo or map. To zoom in, spread your fingers apart.

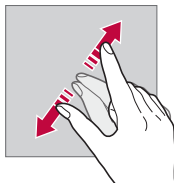
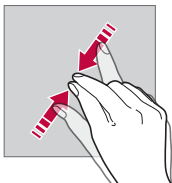



- Do not expose the touch screen to excessive physical shock. You might damage the touch sensor.



- A touch screen failure may occur if you use the device near a magnetic, metallic or conductive material.
- If you use the device under bright lights, such as direct sunlight, the screen may not be visible, depending on your position. Use the device in a shady location or a location with an ambient light that is not too bright and bright enough to read books.
- Do not press the screen with excessive force.
- Gently tap with your fingertip on the option you want.
- Touch control may not work properly if you tap while wearing a glove or by using the tip of your fingernail.
- Touch control may not work properly if the screen is moist or wet.
- The touch screen may not function properly if a screen-protective film or accessory purchased from a third party store is attached to the device.

Home screen

Home screen overview

The Home screen is the starting point for accessing various functions and apps on your device. Tap  on any screen to directly go to the Home screen.

You can manage all apps and widgets on the Home screen. Swipe the screen left or right to view all installed apps at a glance.

To search for apps installed on your device, use the **In Apps** function.

Home screen layout

You can view all apps and organise widgets and folders on the Home screen.

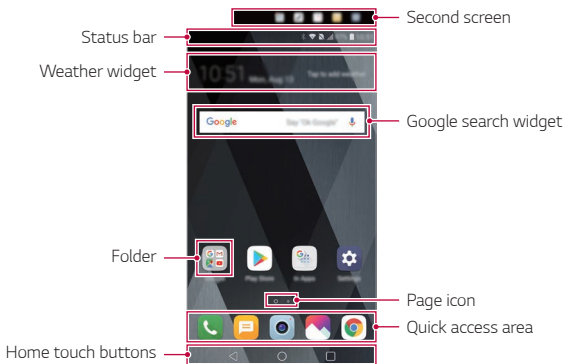

- The Home screen may vary, depending on the service provider or software version.

- **Second screen:** Launch apps and view urgent information without using the search on the main screen.
- **Status bar:** View status icons, the time and the battery level.
- **Weather widget:** View the information of weather and time for a specific area.
- **Google search widget:** Perform a Google search by inputting spoken or written keywords.
- **Folder:** Create folders to group apps by your preferences.
- **Page icon:** Display the total number of Home screen canvases. Tap the desired page icon to go to the page you selected. The icon reflecting the current canvas will be highlighted.

- **Quick access area:** Fix main apps at the bottom of the screen so that they can be accessed from any Home screen canvas.
- **Home touch buttons**
 - ◀: Return to the previous screen. Close the keypad or pop-up windows.
 - ○: Tap to go to the Home screen. To launch Google search, touch and hold.
 - □: Tap to view a list of recently used apps or run an app from the list. To delete all the recently used apps, tap **CLEAR ALL**. To use two apps at the same time with the Multi-Window feature, touch and hold the button while using an app.

Editing the Home touch buttons

You can rearrange the Home touch buttons or add frequently used functions to the Home touch buttons area.





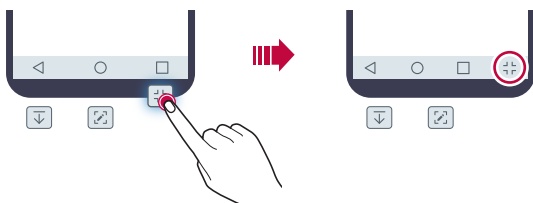









Tap ○ > **Settings** > **Display** > **Home touch buttons** > **Button combination** and customise the settings.

- Several functions, including QSlide, Notification panel and Capture+, are provided. A maximum of five items can be added.

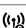

Status icons

When there is a notification for an unread message, calendar event or alarm, the status bar displays the corresponding notification icon. Check your device's status by viewing notification icons displayed on the status bar.

	No signal
	Data is being transmitted over the network
	Alarm is set
	Vibrate mode is on
	Bluetooth is on
	Connected to a computer via USB
	Battery level
	Airplane mode is on
	Missed calls
	Wi-Fi is connected
	Mute mode is on
	GPS is on
	Hotspot is on
	No SIM card
	NFC is on



- Some of these icons may appear differently or may not appear at all, depending on the device's status. Refer to the icons according to the actual environment in which you are using the device.
- Displayed icons may vary, depending on the area or service provider.

Notifications panel

You can open the notifications panel by dragging the status bar downward on the main screen.

- To open the quick access icons list, drag the notifications panel downwards or tap .
- To rearrange, add, or remove icons, tap **EDIT**.
- If you touch and hold the icon, the settings screen for the corresponding function appears.

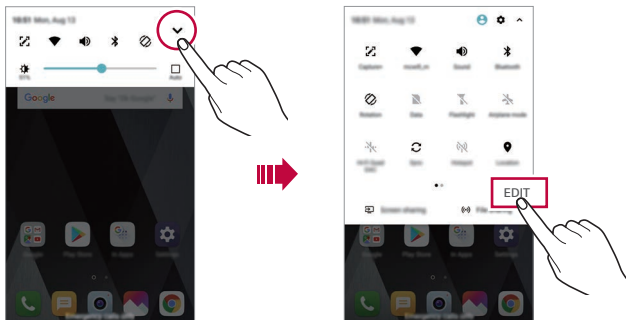

- You can use the notifications panel even on the lock screen. Drag the notifications panel while the screen is locked to quickly access the desired features.

Switching the screen orientation

You can set the screen orientation to automatically switch, according to the device's physical orientation.

On the notification panel, tap **Rotation** from the quick access icon list.

You can also tap ○ > **Settings** > **Display** and activate **Auto-rotate screen**.



Editing the Home screen

On the Home screen, touch and hold on an empty space, then select the desired action from below.

- To rearrange the Home screen canvases, touch and hold on a canvas, then drag it to another location.
- To add a widget to the Home screen, touch and hold on a blank area of the Home screen, then select **Widgets**.
- To change a theme, touch and hold on a blank area of the Home screen, then select **Theme**.

You can also tap ○ > **Settings** > **Display** > **Theme**, then select a theme to apply to the device.

- To configure the Home screen settings, touch and hold on a blank area of the Home screen, then select **Home screen settings**. See *Home screen settings* for details.

- To view or reinstall the uninstalled apps, touch and hold on a blank area of the Home screen, then select **App trash**. See *App trash* for details.
- To change the default screen, touch and hold on a blank area of the Home screen, move to desired screen, tap , then tap the screen once more.

Viewing the background theme

You can view only the background image by hiding the apps and widgets on the Home screen.

Spread two fingers apart on the Home screen.

- To return to the original screen, which displays apps and widgets, pinch your fingers on the Home screen or tap .

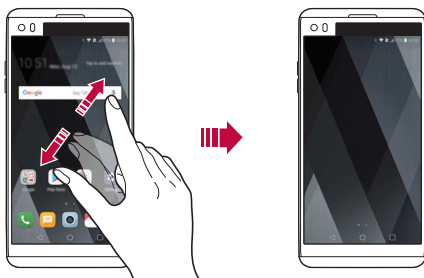

Moving apps on the Home screen

On the Home screen, touch and hold an app, then drag it to another location.

- To keep frequently used apps at the bottom of the Home screen, touch and hold an app, then drag it to the quick access area at the bottom.
- To remove an icon from the quick access area, drag the icon to the Home screen.

Using folders from the Home screen

Creating folders

On the Home screen, touch and hold an app, then drag it over another app.

- A new folder is created and the apps are added to the folder.

Editing folders

On the Home screen, tap a folder and do one of the following actions.

- To edit the folder name and colour, tap the folder name.
- To add apps, touch and hold an app, then drag it over the folder and release it.
- To remove an app from the folder, touch and hold the app and drag it to outside the folder. If the removed app is the only one app that existed in the folder, the folder is removed automatically.
- You can also add or remove apps after tapping **+** in the folder.

Home screen settings

You can customise Home screen settings.

- 1 Tap  > **Settings** > **Display** > **Home screen**.
- 2 Customise the following settings:
 - **Select Home:** Select a Home screen mode.
 - **Wallpaper:** Change the Home screen background wallpaper.
 - **Screen swipe effect:** Select an effect to apply when the Home screen canvas switches.
 - **Icon shape:** Choose if you want icons to have square or rounded corners.
 - **Sort apps by:** Set how apps are sorted on the Home screen.
 - **Grid:** Change the app arrangement mode for the Home screen.

- **Hide apps:** Select which apps you want to hide from the Home screen.
- **Loop Home screen:** Enable to allow continuous Home screen scrolling (loop back to first screen after the last screen).
- **Smart Bulletin:** Use the Home screen to view information customised to your needs.
- **Search:** Search by swiping down on the Home screen.

Screen lock

Screen lock overview

Your device's screen turns off and locks itself if you press the Power/Lock key. This also happens after the device is left idle for a specified period of time.

If you press the Power/Lock key when a screen lock is not set, the Home screen appears immediately.

To ensure security and prevent unwanted access to your device, set a screen lock.



- Screen lock prevents unnecessary touch input on the device screen and reduces battery consumption. We recommend that you activate the screen lock while not using the device.

Configuring screen lock settings

There are several options available for configuring the screen lock settings.

- 1 Tap  > **Settings** > **General** > **Lock screen & security** > **Select screen lock** and then select the method you prefer.

2 Customise the following settings:

- **None:** Deactivate the screen lock function.
- **Swipe:** Swipe on the screen to unlock the screen.
- **Knock Code:** Tap the spaces of the screen in accordance with a pattern to unlock the screen.
- **Pattern:** Draw a pattern to unlock the screen.
- **PIN:** Enter a numeric password to unlock the screen.
- **Password:** Enter an alphanumeric password to unlock the screen.
- **Fingerprints:** Unlock the screen by using your fingerprint.



- If you incorrectly attempt to unlock the device 5 times, the screen is blocked for 30 seconds.

Secure start-up settings

When you select Knock Code, Pattern, PIN or Password as a screen lock method, you can configure your device to be locked whenever turning on the device in order to secure your data.

- You cannot use all functions, except for emergency calls until you unlock the device.
- If you forget your decryption password, you cannot restore encrypted data and personal information.

KnockON

You can turn the screen on or off by double-tapping the screen.



- This option is available only on the Home screen provided by LG. It may not function properly on a custom launcher or on the Home screen installed by the user.
- When tapping the screen, use your fingertip. Do not use a fingernail.
- To use the KnockON feature, make sure that the proximity/light sensor is not blocked by a sticker or any other foreign substance.

Turning on the screen

Double-tap the middle of the screen.

- Tapping the top or bottom of the screen may decrease the recognition rate.

Turning off the screen

Double-tap on an empty space on the Home screen.

You can also double-tap an empty space on the status bar.

Knock Code

You can unlock the screen by creating your own Knock Code. When the screen is locked, you can directly access the Home screen by tapping the screen in a specified sequence.



- You can use your Knock Code together with the KnockOn feature.
- Make sure to use your fingertip when tapping the screen.

Creating a Knock Code

- 1 Tap  > **Settings** > **General** > **Lock screen & security** > **Select screen lock** > **Knock Code**.
- 2 Tap the squares in a pattern of your choice to create a Knock Code and tap **NEXT**.
- 3 Input the created Knock Code again for verification, then tap **CONFIRM**.

Unlocking the screen with a Knock Code

Unlock the screen by inputting the Knock Code you have created.

Input your Knock Code on the touch screen when the screen is turned off.

- It is also possible to enter a Knock Code when the lock screen is turned on.

Memory card encryption

You can encrypt and protect data saved on the memory card. The encrypted data in the memory card cannot be accessed from another device.

- 1 Tap  > **Settings** > **General** > **Lock screen & security** > **Encryption & credentials** > **Encrypt SD card**.
- 2 Read the on-screen overview of memory card encryption and then tap **CONTINUE** to continue.
- 3 Select an option and tap **ENCRYPT NOW**.
 - **New data encryption:** Encrypt only data that is saved on the memory card after encryption.
 - **Full encryption:** Encrypt all the data currently saved on the memory card.
 - **Exclude media files:** Encrypt all files, except for media files such as music, photos and videos.



- To encrypt the memory card, make sure that a screen lock is set using a PIN or password.
- Once memory card encryption starts, some functions are not available.
- If the device is turned off while encryption is underway, the encryption process will fail, and some data may be damaged. Therefore, be sure to check if the battery level is sufficient before starting encryption.
- Encrypted files are accessible only from the device where the files were encrypted.
- The encrypted memory card cannot be used on another LG device. To use the encrypted memory card on another mobile device, format the card.
- You can activate memory card encryption even when no memory card is installed into the device. Any memory card that is installed after encryption will automatically be encrypted.

Taking screenshots

You can take screenshots of the current screen you are viewing.

Via a shortcut

Press and hold the Power/Lock key and the Volume Down (-) key at the same time for at least two seconds.

- Screenshots can be viewed from the **Screenshots** folder in the **Gallery**.

Via Capture+

On the screen where you want to take a screenshot, drag the status bar downwards, then tap .



- When the screen is turned off or locked, you can access **Capture+** by pressing the Volume Up (+) key twice. To use this feature, tap  > **Settings** > **General** and turn on **Shortcut keys**.
- See *Writing notes on a screenshot* for details.

Entering text

Using the Smart keyboard

You can use the Smart keyboard to enter and edit text.

With the Smart keyboard, you can view text as you type without bothering to alternate between the screen and a conventional keyboard. This allows you to easily find and correct errors when typing.

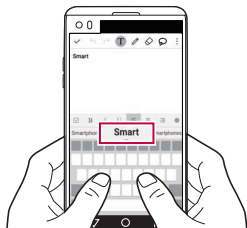

Moving the cursor

With the Smart keyboard, you can move the cursor to the exact position you want. When typing text, touch and hold on the space bar and then drag left or right.

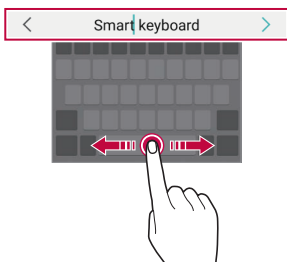

- This option is available only on the QWERTY keyboard.

Suggesting words

Smart keyboard automatically analyses your usage patterns to suggest frequently used words as you type. The longer you use your device, the more precise the suggestions are.

Enter text, then tap a suggested word or gently drag the left or right side of the space bar upwards.

- The selected word is automatically entered. You do not need to manually type every letter of the word.

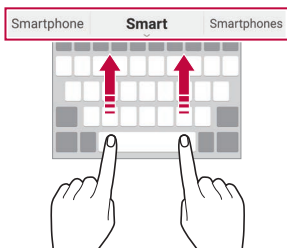

Changing the QWERTY keyboard layout

You can add, delete or rearrange keys on the bottom row of the keyboard.

- 1 Tap > **Settings** > **General** > **Language & input** > **On-screen keyboard** > **LG Keyboard** > **Keyboard height and layout** > **QWERTY keyboard layout**.

You can also tap on the keyboard and tap **Keyboard height and layout** > **QWERTY keyboard layout**.

- 2 Tap a key on the bottom row, then drag it to another position.

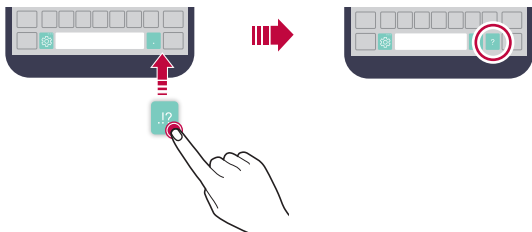

- This option is available on the QWERTY, QWERTZ and AZERTY keyboards.
- This function may not be supported for some languages.

Customising the keyboard height

You can customise the keyboard height to maximise hand comfort when typing.

- 1 Tap  > **Settings** > **General** > **Language & input** > **On-screen keyboard** > **LG Keyboard** > **Keyboard height and layout** > **Keyboard height**.

You can also tap  on the keyboard and tap **Keyboard height and layout** > **Keyboard height**.

- 2 Adjust the keyboard height.

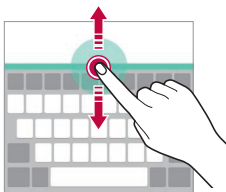

Selecting a landscape keyboard mode

You can select a landscape keyboard mode from several choices.

- 1 Tap  > **Settings** > **General** > **Language & input** > **On-screen keyboard** > **LG Keyboard** > **Keyboard height and layout** > **Keyboard type in landscape**.

You can also tap  on the keyboard and tap **Keyboard height and layout** > **Keyboard type in landscape**.

- 2 Select a keyboard mode.

Splitting the keyboard

You can split the keyboard in half and place each piece on either side of the screen when the screen is in landscape mode.

To split the keyboard, turn the device horizontally and spread it apart on both sides with holding the keyboard with two fingers. To attach the keyboard, close it with pressing with two fingers.

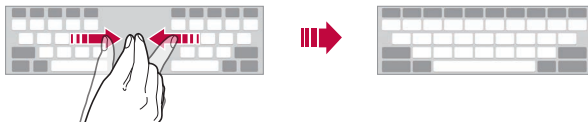

One-handed operation mode

You can move the keyboard to one side of the screen so that you can use the keyboard with one hand.



- 1 Tap  > **Settings** > **General** > **Language & input** > **On-screen keyboard** > **LG Keyboard** > **Keyboard height and layout** > **One-handed operation**.

You can also tap  on the keyboard and tap **Keyboard height and layout** > **One-handed operation**.

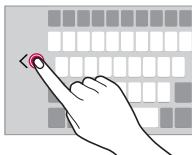
- 2 Press the arrow displayed next to the keyboard to move the keyboard in the direction you want.



Entering text by using voice

On the keyboard, touch and hold  and then select .



- To maximise the voice command recognition, speak clearly.
- To enter text with your voice, make sure that your device is connected to a network.
- To select the language for voice recognition, tap  > **Languages** on the voice recognition screen.
- This function may be not supported, or the supported languages may differ depending on the service area.



Adding languages to the keyboard

You can make additional languages available for keyboard input.

- 1 Tap  > **Settings** > **General** > **Language & input** > **On-screen keyboard** > **LG Keyboard** > **Select languages**.
- 2 Select the languages you want to make available.

Copy and Paste

You can cut or copy text from an app, and then paste the text into the same app. Or, you can run other apps and paste the text into them.





- 1 Touch and hold around the text you want to copy or cut.
- 2 Drag  /  to specify the area to copy or cut.
- 3 Select either **CUT** or **COPY**.
 - Cut or copied text is automatically added to the clipboard.
- 4 Touch and hold the text input window, then select **PASTE**.



- If there is no item that has been copied or cut, the **PASTE** option will not appear.

Clip Tray

If you copy or cut an image or text, it is automatically saved to the clip tray and can be pasted to any space at any time.

- 1 On the keyboard, touch and hold  and select .
You can also touch and hold the text input window, then select **CLIP TRAY**.
- 2 Select and paste an item from the clip tray.
 - A maximum of 20 items can be saved to the clip tray.
 - Tap  to lock saved items in order not to delete them, even when the maximum quantity is exceeded. A maximum of ten items can be locked. To delete locked items, unlock them first.
 - Tap  to delete the items saved to the clip tray.



- The clip tray may not be supported by some downloaded apps.

Content sharing

Playing content from another device

You can play photos, videos or songs saved on your device from a TV.

- 1 Connect the TV and your device to the same Wi-Fi network.
- 2 While viewing the items from the **Gallery** or **Music** app, tap  > **Play on other device**.
- 3 Select the TV you want to connect to.



- For use with Chromecast, Google Play services should be up to date.

Viewing content from nearby devices

You can view content from various devices, such as a computer, NAS or mobile device, by using the **Gallery** or **Music** apps.

Connecting the devices

Connect both your device and another device that support DLNA function to the same wireless network.



- Make sure that File sharing (DLNA) is activated on both the device and the connected device.

Searching for nearby devices

You can view a list of DLNA devices on the same network by selecting the **Nearby devices** menu in each app.

Use content from nearby devices as if you were using it on your device.

Sending or receiving files

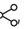

You can share files between your device and another LG device, or a tablet or computer.

Sending files

From the **Gallery**, **File Manager** or **Music** app, tap **:** > **Share** or  then select a device on the file sharing list.

Receiving files

Drag the status bar downward and tap , then tap **File sharing**.

If your device does not support the file sharing feature, tap  > **Settings** > **Network** > **File sharing** > **SmartShare Beam** .



- Make sure that your device is connected to the same wireless network as the file transfer target device.
- Make sure that File sharing is activated on both the device and the target device.

Sending files to a computer

You can quickly send large files to your computer.

- 1 Install LG Bridge on your computer.
- 2 Start LG Bridge on the computer, then sign in using your LG account.
- 3 Tap  > **Settings** > **Network** > **LG AirDrive**, then sign in using your LG account.
- 4 Select a computer on the sharing list from the **Gallery**, **File Manager** and **Music** apps.



- You can download LG Bridge from the LG Mobile website (www.lg.com).
- When you transfer files from the device to the computer while LG Bridge is not running, they are stored for 7 days in the temporary storage.

Temporarily stored files are automatically saved on the computer when you launch LG Bridge within 7 days.



Viewing content from your cloud

You can directly view the content saved on your cloud account, without downloading it to your device.

- 1 From the **Gallery**, **Music** or **File Manager** app, select  > **Cloud**.
- 2 Select a cloud account and sign in.
- 3 Save or play content in your cloud.

Do not disturb

You can limit or mute notifications to avoid disturbances for a specific period of time.

- 1 Tap  > **Settings** > **Sound** > **Do not disturb** and then drag  to activate it.
- 2 Tap **Mode** and select the mode you want:
 - **Priority only**: Receive sound or vibrate notifications for the selected apps. Even when **Priority only** is turned on, alarms still sound.
 - **Total silence**: Disable both the sound and vibration.



03

Useful Apps

Installing and uninstalling apps

Installing apps

Access an app store to search and download apps.

- You can use **SmartWorld**, **Play Store** or the app store provided by your service provider.



- Some app stores may require you to create an account and sign in.
- Some apps may charge fees.
- If you use mobile data, you may be charged for data usage, depending on your pricing plan.
- **SmartWorld** may not be supported depending on the area or service provider.

Uninstalling apps

Uninstall apps that you no longer use from your device.

Uninstalling with the touch and hold gesture

On the Home screen, touch and hold the app to uninstall, then drag it over **Delete** at the top of the screen.

- If apps were uninstalled within 24 hours from now, you can reinstall them. See *App trash* for details.

Uninstalling by using the settings menu

Tap  > **Settings** > **General** > **Apps & notifications**, select an app, then tap **Uninstall**.

Uninstalling apps from the app store

To uninstall an app, access the app store from which you download the app and uninstall it.



- Some apps cannot be uninstalled by users.

App trash

You can view the uninstalled apps on the Home screen. You can also reinstall apps which were uninstalled within 24 hours from now.

1 Tap > **App trash**.

You can also touch and hold an empty area of the Home screen, then tap **App trash**.

2 Activate the desired function:

- **Restore**: Reinstall the selected app.
-  : Remove the uninstalled apps permanently from the device.



- Uninstalled apps are automatically removed from the device 24 hours after they were uninstalled. If you want to reinstall the uninstalled apps, you must download them again from the app store.
- This feature is activated on the default Home screen only. If you uninstall apps while using the EasyHome screen or other launcher, they are immediately and permanently removed from the device.

App Shortcuts

On the Home screen, touch and hold an app icon such as Call, Message, Camera, Gallery and Settings to display a quick access menu. Use apps more easily through App Shortcuts.

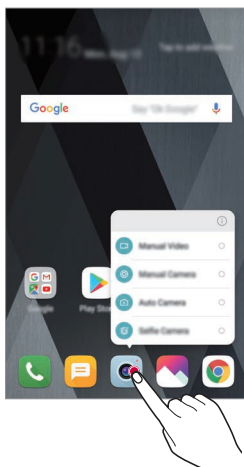





- This feature is available only on some apps.

Phone

Voice call

Make a phone call by using one of the available methods, such as manually entering a phone number and making a call from the contact list or the list of recent calls.



Making a call from the keypad

- 1 Tap  >  > **Dial**.
- 2 Make a call by using a method of your choice:
 - Enter a phone number and tap .
 - Touch and hold a speed dial number.
 - Search for a contact by tapping the initial letter of a contact name in the contact list, and then tap .





- To enter "+" when making an international call, touch and hold number 0.
- See *Adding contacts* for details on how to add phone numbers to the speed dial list.

Making a call from the contact list

- 1 Tap  >  > **Contacts**.
- 2 From the contact list, select a contact and tap .



Answering a call

To answer a call, drag  to the outside of the circle on the incoming call screen.

- When the stereo headset is connected, you can make calls by using the call/end button on the headset.
- To end a call simply by pressing the Power/Lock key, tap  > **Settings** > **Network** > **Call** > **Answer and end calls**, then turn on **End call with the Power key**.

Rejecting a call

To reject an incoming call, drag  across the incoming call screen.

- To send a rejection message, drag the rejection message option  across the screen.
- To add or edit a rejection message, tap  > **Settings** > **Network** > **Call** > **Call blocking & Decline with message** > **Decline with message**.
- When a call is coming in, press the Volume Up (+), Volume Down (-) or Power/Lock key to mute ringtone or vibration, or to hold the call.

Viewing missed calls

If there is a missed call, the status bar at the top of the screen displays .

To view missed call details, drag the status bar downwards. You can also tap  >  > **Call logs**.

Functions accessible during a call

During a call, you can access a variety of functions by tapping on-screen buttons:

- **Contacts:** View the contact list during a call.
- **End:** End a call.
- **Dialpad:** Display or hide the dial pad.
- **Speaker:** Turn on the speakerphone function.
- **Mute:** Mute your voice so that your voice cannot be heard by the other party.
- **Bluetooth:** Switch the call to a Bluetooth device that is paired and connected.
- **⋮** : Access additional call options.



- Available settings items may vary depending on the area or service provider.

Making a three-way calling

You can make a call to another contact during a call.



- 1 During a call, tap **⋮** > **Add call**.
- 2 Enter a phone number and tap .
 - The two calls are displayed on the screen at the same time, and the first call is put on hold.
- 3 To start a conference call, tap **Merge calls**.



- You may be charged a fee for each call. Consult with your service provider for more information.

Viewing call records

To view recent call records, tap  > **Call logs**. Then, you can use the following functions:



- To view detailed call records, select a contact. To make a call to the selected contact, tap .
- To delete call records, tap  > **Delete**.



- The displayed call duration may differ from the call charge. Consult with your service provider for more information.

Configuring call options

You can configure various call options.

- 1 Tap  >  > **Dial** or **Call logs**.
- 2 Tap  > **Call settings** and then configure the options to suit your preferences.

Messaging

Sending a message

You can create and send messages to your contacts using the Messaging app.



- Sending messages abroad may incur additional charges. Consult with your service provider for more information.

- 1 Tap > .
- 2 Tap .
- 3 Specify a recipient and create a message.
 - To attach files, tap .
 - To access optional menu items, tap .
- 4 Tap **Send** to send the message.

Reading a message

You can view exchanged messages organised by contact.

- 1 Tap > .
- 2 Select a contact from the message list.

Configuring messaging settings

You can change messaging settings to suit your preferences.

- 1 Tap > .
- 2 Tap > **Settings** from the message list.

Camera

Starting the camera

You can take a photo or record a video to cherish all of your memorable moments.

Tap .



- Before taking a photo or recording a video, wipe the camera lens with a soft cloth.
- Be careful not to stain the camera lens with your fingers or other foreign substance.
- If the battery level is lower than 5%, charge the battery before using the camera.
- Images included in this user guide may be different from the actual device.
- Photos and videos can be viewed or edited from the **Gallery**. See [Gallery overview](#) for details.

Changing the camera mode



You can select a camera mode that suits your environment to take a photo or record a video easily and conveniently.

Launch the Camera app, then select the desired camera mode from the Second screen.



AUTO mode

You can take photos or record videos by selecting a variety of camera modes and options.

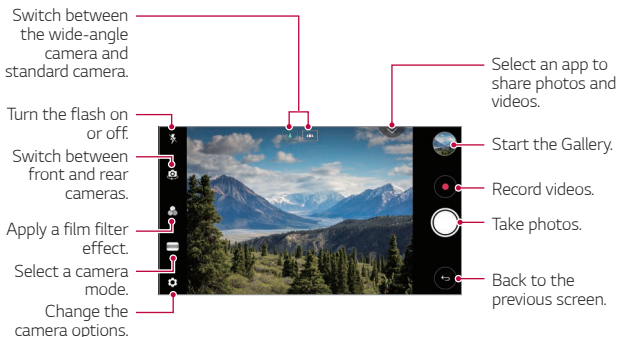

- 1 Launch the Camera app, then select the **AUTO** mode from the Second screen.
- 2 To take a photo, tap . To record a video, tap .





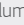

Taking a photo

- 1 Select a camera mode and tap the subject to focus the camera on.
- 2 Tap  to take a photo.
 - You can also press the Volume Down (-) or Volume Up (+) key to take a photo.



- When the screen is turned off or locked, start the camera by pressing the Volume Down (-) key twice. Tap  > **Settings** > **General** > **Shortcut keys** and then drag  to activate it.

Recording a video

- 1 Select a camera mode and tap the subject to focus the camera on.
- 2 Tap 
 - To take a photo while recording a video, tap .
 - To pause the video recording, tap . To resume the video recording, tap .
- 3 Tap  to end the video recording.

Customising the camera options

You can customise a variety of camera options to suit your preferences.

Tap  on the screen.



- Available options vary depending on the selected camera (front or rear camera) and the selected camera mode.

Photo size	Select values for aspect ratio and size for taking photos.
Video resolution	Select values for resolution and size for recording videos.
HDR	Obtain photos or videos in vivid colours, and get compensated effects even when they are taken against the light. These functions are provided by the high dynamic range (HDR) technology equipped in the camera of the device.
Timer	Set the timer to automatically take photos after a specified period of time.
Cheese shutter	Take photos with voice commands.

Tracking focus	When the subject is touched, the video is recorded tracking the focus even if the subject is moving. (Available when the standard camera is in use.)
Steady recording	Activate the Steady recording for a stable video image.
Tag locations	Save the image with GPS location data.
Grid	Display guide grids so that you can take photos or record videos based on the horizontal and vertical reference lines.
Storage	Select any of Internal storage and SD card. (Available when the memory card is inserted.)
Simple view	Hide all menus from the camera screen.
Help	Provide Help for each camera menu.





Additional options on the front camera

Selfie shot	Customise selfie shot settings. <ul style="list-style-type: none"> • Gesture shot: Shoot using the Gesture shot feature. • Auto shot: Shoot when the camera detects a face.
Gesture view	Choose whether to use Gesture view to view the taken photo immediately after taking a photo.
Save as flipped	Save as flipped images after taking selfies.

Various camera modes

Popout











You can take a photo or record a video by using both the standard and wide-angle of the dual camera at the back of the device to record the scenes as if they were put in the frame. The scenes shown in the small, front screen are shot by using the standard camera, and the scenes shown in the large, background screen are shot by using the wide-angle camera. Change the front screen to a different shape or apply various effects to take a sensuous photo or video.

- 1 In the AUTO mode, tap **MODE** > .
- 2 Tap  and select the desired layout.
- 3 Select the desired effect:
 - **Fisheye**: Apply a convex lens effect to the area captured by the wide-angle camera.
 - **B&W**: Apply grayscale to the area captured by the wide-angle camera.
 - **Vignette**: Darken the edges of the area captured by the wide-angle camera.
 - **Lens blur**: Blur the area captured by the wide-angle camera.
- 4 Tap  to take a photo. To record a video, tap .



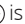

Multi-view

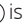
You can take multiple photos or videos in the form of a collage by using the front and rear cameras. Photos and videos can be saved with different layouts.

- 1 In the AUTO mode, tap **MODE** > .
- 2 Tap  and select a layout.
- 3 Tap  to take photos, according to the on-screen instructions. To record a video, tap .
 - To switch between front and rear (standard or wide-angle) cameras, drag up or down, or left or right.
 - Tap  /  to take photos or record videos simultaneously or sequentially depending on the displayed layout order.
 - When  is selected, you can take photos or record videos sequentially in the numerical order on the layout.
 - Tap  to take a photo. Tap  to record a short video clip.
 - To take continuous shots of photos or videos at specific intervals, touch and hold  or .
 - When  is selected, you can take photos or videos at the same time regardless the layout order.

Snap movie

You can record short videos clips and assemble them into a 60-second short film.

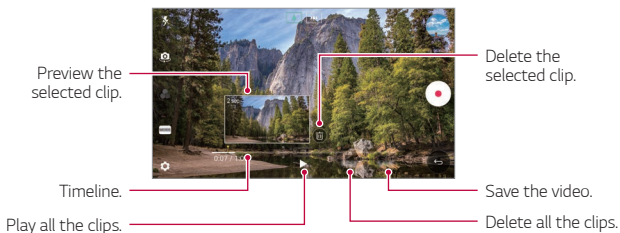

- 1 In the AUTO mode, tap **MODE** > .
- 2 Tap .
 - Tap the icon once to record a three-second video clip. Touch and hold the icon to create a longer video clip (maximum length: one minute).



3 Tap **SAVE**.

Panorama



You can create a panoramic photo by moving the camera in one direction to photograph and stitch continuous shots of a wide view.

- 1 In the AUTO mode, tap **MODE** > .
- 2 Tap  and then slowly move the camera in one direction.
 - Move the device by following the direction of the arrow in the guideline.
- 3 Tap  to stop capturing the panoramic.



Slo-mo



You can create an entertaining video by changing the moving speeds of subjects in your video. This feature allows you to record a video at a faster rate of speed and then play it at the standard speed so that the video appears to be slowed down.

- 1 In the AUTO mode, tap **MODE** > .
- 2 Tap  and record a video.
- 3 Tap  to end the video recording.



Time-lapse

You can take a sequence of frames at set intervals to record changes that take place slowly over time, such as cloud movements, celestial motions, traffic, and more.

- 1 In the AUTO mode, tap **MODE** > .
- 2 Tap  and record a video.
- 3 Tap  to end the video recording.



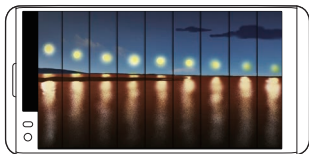

- While recording a Time-lapse video, voices are not recorded.



Burst shot

You can take continuous shots of photos to create moving pictures.



In the AUTO mode, touch and hold .

- Continuous shots are taken at a fast speed while  is held down.



- When the storage is set as Internal storage, you can take up to 100 photos. When the storage is set as External storage, you can take up to 30 photos in a row.

Simple view

In the AUTO mode, tap  > **Simple view** to hide menus on the camera screen. Tap  to display them.

MANUAL camera mode

You can create photos featuring professional touch by using a variety of advanced features. Adjust the white balance, focus, brightness, ISO, shutter speed and other options.

- 1 Launch the Camera app, then select **MANUAL** () on the Second screen.



2 Customise the following camera settings.

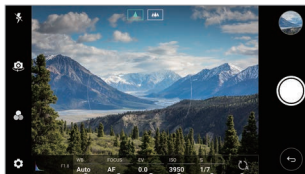

Adjust white balance.

Adjust focus.

Adjust brightness.

Adjust exposure level.

Adjust shutter speed.

Adjust ISO speed.

3 Tap to take the photo.

Customising the camera options

You can customise a variety of camera options to suit your preferences.

Tap  on the screen.

Photo size	Select values for aspect ratio and size for taking photos.
Timer	Set the timer to automatically take photos after a specified period of time.
Cheese shutter	Take photos with voice commands.
Tracking focus	When the subject is touched, the photo is taken tracking the focus even if the subject is moving. (Available when the standard camera is in use.)
Tag locations	Save the image with GPS location data.
Guide	Display guide grids to so that you can take photos based on the horizontal and vertical reference lines.

Save as RAW	The image is stored as a RAW file format so that you can modify it. The DNG file is created while taking a photo, then saved as a non compressed high resolution image.
Noise reduction	Reduce noise at high ISO settings.
Storage	Select any of Internal storage and SD card. (Available when the memory card is inserted.)
Help	Provide Help for each camera menu.

MANUAL video mode

You can record a video by manually customising various options. Adjust values for white balance, focus, brightness, ISO, shutter speed and more.

- 1 Launch the Camera app, then select **MANUAL** (📷) on the Second screen.



- 2 Customise the camera settings.
- 3 Tap  to record a video.

Customising the camera options

You can customise a variety of camera options to suit your preferences.

Tap  on the screen.

Video resolution	Select values for aspect ratio and size for videos.
Frame rate	Select the frames per second value.
Bit rate	Select the image quality for videos.
Hi-Fi	Record a video with Hi-Fi quality sound.
Timer	Set the timer to automatically take photos after a specified period of time.
Steady recording	Activate the Steady recording for a stable video image.
Tracking focus	When the subject is touched, the video is recorded tracking the focus even if the subject is moving. (Available when the standard camera is in use.)
Tag locations	Save the image with GPS location data.
Grid	Display guide grids so that you can record videos based on the horizontal and vertical reference lines.
Storage	Select any of Internal storage and SD card.
Help	Provide Help for each camera menu.

Other useful features in the Camera app

Zoom lever

You can control the zoom on the Second screen while recording a video.

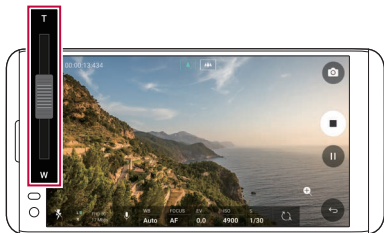

AE/AF lock

You can fix the current exposure level and focus position by touching and holding the screen in the AUTO mode. To turn off the feature, tap a blank area on the screen.

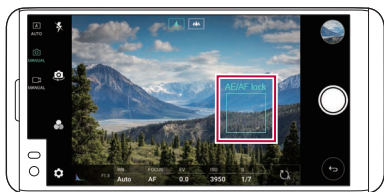

Focus peaking

- 1 In the MANUAL camera or MANUAL video mode, tap **FOCUS**.



- 2 Use the focus peaking control slide bar on the right of the screen to bring the subject into focus.

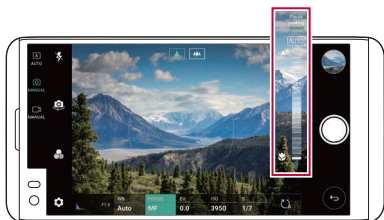

- To turn off the feature, tap **Focus peaking**.

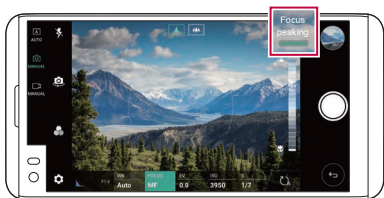

Switching between cameras

You can switch between the front and rear cameras to suit your environment.



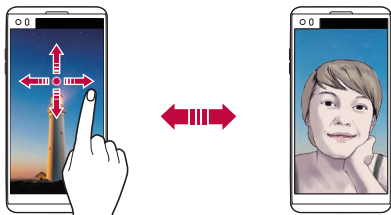

On the camera screen, tap  or drag the screen in any direction to switch between the front and rear cameras.



- Use the front camera to take selfies. See *Selfie shot* for details.

Switching to dual camera

Switch between the standard and wide-angle to take photos or record videos to suit your preferences.

- Tap  /  or  /  to switch between the standard and wide-angle camera.
- Another way to switch between the standard and wide-angle is to pinch or spread your fingers.

Zoom in or out

You can use zoom in or out on the camera screen while taking a photo or recording a video.

- On the camera screen, pinch or spread two fingers to zoom in or out, then use the displayed +/- slide bar.
- Then the wide-angle camera and general camera on the back of the device are automatically switched to take a photo or record a video.



- The zoom feature is not available when using the front camera in selfie mode.

Selfie shot

You can use the front camera to view your face on the screen and take selfies.

Gesture shot

You can take selfies by using gestures.

Show your palm to the front camera and then clench your fist.

You can also clench your fist and then open it towards the front camera.

- In three seconds, a photo is taken.

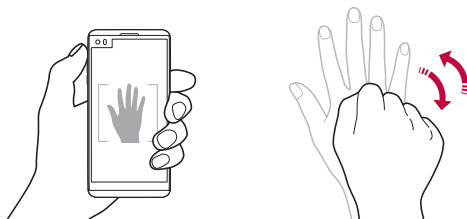

- To use this feature, switch to the front camera mode, then tap  > **Selfie shot > Gesture shot**.
- Make sure that your palm and fist are within the reference line so that the camera can detect them.
- This feature may not be available while using some of the camera features.

Auto shot

You can use the face detection feature to take selfies easily and conveniently. You can set the device so that, when you look at the screen, the front camera detects your face and takes a selfie automatically.

- The white coloured guide frame appears when the front camera detects your face. If the subject within the guide frame stops moving, the guide frame colour turns blue, then the camera takes a photo.



- Tap  > **Selfie shot** > **Auto shot** to enable the Auto shot feature.

Interval shot

You can take selfies at an interval.

While using the front camera, touch and hold . You can also show your palm to the camera, then clench your fist twice quickly.

- Four photos are taken at about two seconds interval after a timer delay of three seconds.

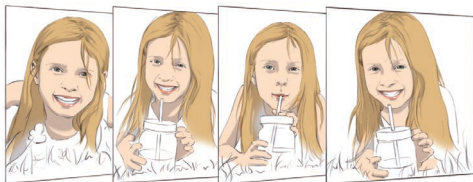

Gesture view

After taking a selfie with the front camera, you can preview the selfie immediately by placing the screen close to your face.

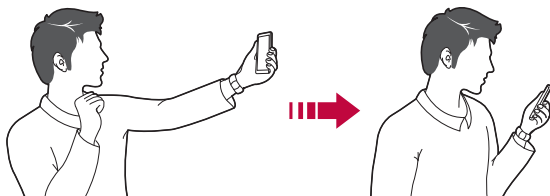

- Tap  > **Gesture view** to enable the Gesture view feature.
- Only one preview is available each time a photo is taken.
- If you rotate the device while in preview screen, the screen switches to camera mode.

Save as flipped

Before taking a photo with the front camera, tap  > **Save as flipped**. The image is flipped horizontally.



- When using the front camera, you can change how selfies are taken in the camera options. See *Customising the camera options* for details.

Gallery

Gallery overview

You can view and manage photos and videos saved on your device.

1 Tap  > .

- Saved photos and videos are displayed by folder.

2 Tap a folder and select a file.

- View the selected file in full-screen mode.
- While viewing a photo, swipe left or right to view the previous or next photo.
- While viewing a video, swipe left or right to rewind or fast-forward the video.



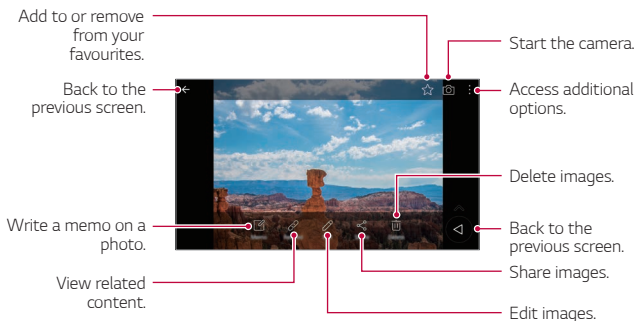

- Some file formats may not be supported, depending on the installed software.
- Some files may not be opened due to encoding.
- Files that exceed the size limit may cause an error.

Viewing photos



- To display the menu items, gently tap the screen. To hide the menu items, tap the screen again.

Editing photos

- 1 While viewing a photo, tap .
- 2 Use a variety of effects and tools to edit the photo.
- 3 Tap **SAVE** to save changes.
 - The changes are overwritten to the original file.
 - To save the edited photo as another file, tap  > **Save copy**.

Playing a video

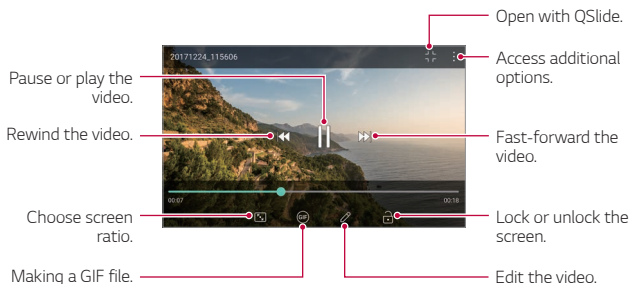

- To adjust the sound volume, drag the right side of the video screen up or down.
- To adjust the screen brightness, drag the left side of the video screen up or down.

Editing videos

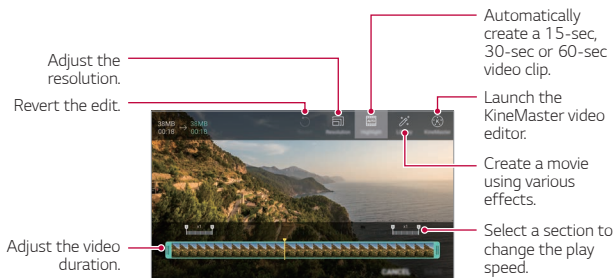

- 1 While viewing a video, tap .
- 2 Use a variety of effects and edit tools to edit the video.



3 Tap **SAVE** to save changes.



Deleting files

You can delete files by using one of the following options:

- Touch and hold a file from the file list, then tap **Delete**.
- Tap  from the file list and delete the desired files.
- Deleted files are automatically moved to **Trash** and they can be restored to the Gallery within 7 days.
- On the Gallery, tap  > **Trash**. Tap  to completely delete the files. In this case, the files cannot be restored.

Sharing files

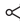
You can share files by using one of the following options:

- While viewing a photo, tap  to share the file by using the method you want.
- While viewing a video, tap  > **Share** to share the file by using the method you want.
- Tap  from the file list to select files and share them using the method you want.

Music

You can play and manage songs or music albums.

- 1 Tap  > **Music**.
- 2 Select a category.
- 3 Select a music file.

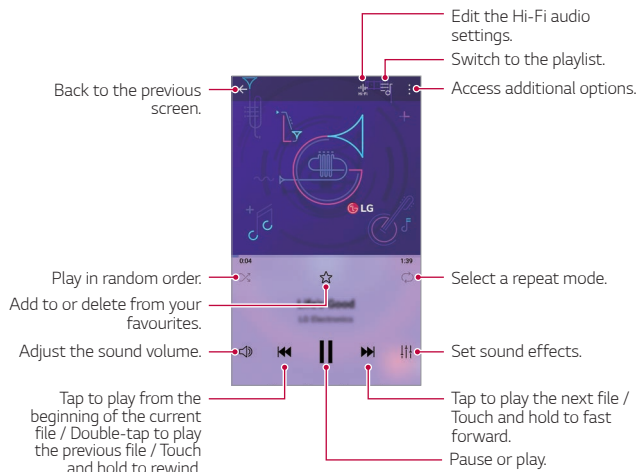

- Some file formats may not be supported, depending on the installed software.
- Files that exceed the size limit may cause an error.
- Music files may be protected by international copyright owners or copyright laws. You may have to obtain legal permission before copying a music file. To download or copy a music file, first check the copyright law for the relevant country.
- This model supports Hi-Fi audio playback. Hi-Fi audio files display the Hi-Fi icon.

E-mail

E-mail overview

You can register an email account to your device and then you can check and send emails from your device.



- If you use mobile data, you may be charged for data usage depending on your pricing plan. Consult with your service provider for more information.

Registering email accounts

When you use the email app for the first time, register your email account.

- 1 Tap  > **E-mail**.
- 2 Select an email service provider.
- 3 Enter your email address and password and then tap **NEXT** to register your account.
 - To manually register an email account or to register email accounts not found in the list, tap **MANUAL SETUP**.

Managing email accounts

To view or edit your email account settings, tap  > **Settings**.

- To add an account, tap **Add account**.
- To delete an account, tap  > **Remove account**.





Opening another email account

If several email accounts are registered and you want to view another account, tap  and select another one from the account list.

Checking email

- 1 Tap  and select a mail box.
- 2 Select an email from the email list.
 - The email message appears.

Sending email



- 1 Tap .
- 2 Enter the recipient's email address.
- 3 Enter a subject and message.
 - To attach files, tap .
 - To access optional menu items, tap .
- 4 Tap  to send the email.

Calendar

Calendar overview

You can use the calendar to manage events and tasks.

Adding events

- 1 Tap  > **Calendar**.
- 2 Select a date and then tap .
- 3 Enter event details and tap **SAVE**.
 - If you tap a date from the calendar and the date contains events, a pop-up window appears showing a list of the events. Tap an event from the pop-up window to view the event details.

Syncing events

Tap  > **Calendars to sync**, and select a calendar to sync.







- When your events are saved from the device to your Google account, they are automatically synced with the Google calendar, too. Then, you can sync other devices with the Google calendar in order to make those devices have the same events that your device has and to manage your events on those devices.

Event pocket

You can use the event pocket to create events.

Tap  to open the event pocket and then drag content to a date in the calendar.











-  : Manage images, text, memos and temporarily saved events. You can also share text, images and memos from another app and save them to the pocket. If you tap **POCKET** when creating an event, the event is temporarily saved to the pocket.
-  : Add a Facebook account to view information on Facebook events. Some devices may not support the Facebook event information function.
-  : View tourism information about the surrounding area, such as restaurants and convenient facilities, to plan an event.
-  : Manage tasks that have no deadline, such as events.

QuickMemo+





QuickMemo+ overview

You can make creative notes by using a variety of options on this advanced notepad feature, such as image management and screenshots, which are not supported by the conventional notepad.



Creating a note

- 1 Tap  > **QuickMemo+**.
- 2 Tap  to create a note.
 -  : Save a note.
 -  : Undo the last action.
 -  : Redo the last action you undid.
 -  : Enter a note by using the keypad.
 -  : Write notes by hand.
 -  : Erase handwritten notes.
 -  : Zoom in or out, rotate or erase the parts of a handwritten note.
 -  : Access additional options, including sharing and locking notes, changing the note pad style and inserting content.
- 3 Tap  to save the note.

Writing notes on a photo

- 1 Tap  > **QuickMemo+**.
- 2 Tap  to take a photo, then tap **OK**.
 - The photo is automatically attached into the notepad.
- 3 Tap **T** or  to write notes on the photo.
 - Write notes by hand on the photo.
 - Enter text below the photo.
- 4 Tap  to save the note.

Writing notes on a screenshot





- 1 While viewing the screen you want to capture, drag the status bar downwards and then tap .
 - The screenshot appears as the notepad background theme. Memo tools appear at the top of the screen.
- 2 Crop the image (if necessary) and take notes as desired.
 - Write notes by hand on the photo.
- 3 Tap  and save the notes to the location you want.
 - Saved notes can be viewed in either **QuickMemo+** or **Gallery**.
 - To save notes in the same location all the time, select the **Use as default app** checkbox and select an app.



- You can capture the entire screen by using the scroll capture feature.
- While using an app such as Message and Chrome, drag the notifications panel downwards and then tap **Capture+ > Extended** to capture the entire screen you are currently viewing as a single file.
- This feature is available only on some apps that support the scroll capture feature.

Managing folders

You can view notes grouped by the type of the notes.

- 1 Tap  > **QuickMemo+**.
- 2 At the top of the screen, tap  and select a menu item:
 - **All memos**: View all notes saved in **QuickMemo+**.
 - **My memos**: View notes created by **QuickMemo+**.
 - **Photo memos**: View notes created by .
 - **Capture+**: View notes created by **Capture+**.
 - **Trash**: View deleted notes.
 - **New category**: Add categories.
 -  : Rearrange, add or delete categories. To change the name of a category, tap the category.



- Some folders do not appear when launching QuickMemo+ for the first time. Disabled folders are enabled and appear when they contain at least one related note.

Calculator



You can use two types of calculators: the simple calculator and the scientific calculator.

- 1 Tap  > **Tools** > **Calculator**.
- 2 Use the keypad to make a calculation.
 - To use scientific calculator, drag the blue coloured slide bar located in the right side of the screen to the left.
 - To restart a calculation, touch and hold the **DEL** button.

Clock

Alarm

You can set an alarm to trigger it at a specified time.



- 1 Tap  > **Clock** > **Alarm**.
- 2 Tap  to add a new alarm.
- 3 Configure the alarm settings and tap **SAVE**.



- If you select a previously set alarm, you can edit the alarm.
- To delete an alarm, tap  at the top of the screen. You can also touch and hold the alarm.



World clock

You can view the current time in cities around the world.

- 1 Tap  > **Clock** > **World clock**.
- 2 Tap  and add a city.

Timer

You can set the timer to trigger an alarm after a specified period of time.

- 1 Tap  > **Clock** > **Timer**.
- 2 Set the time and tap **Start**.
 - To suspend the timer, tap **Pause**. To resume the timer, tap **Resume**.
- 3 Tap **Stop** to stop the timer alarm.
 - To reset the timer settings, tap .

Stopwatch

You can use the stopwatch to record a lap time.

- 1 Tap  > **Clock** > **Stopwatch**.
- 2 Tap **Start** to initiate the stopwatch.
 - To record a lap time, tap **Lap**.
- 3 Tap **Pause** to suspend the stopwatch.
 - To resume the stopwatch, tap **Resume**.
 - To clear all the records and newly start the stopwatch, tap **Reset**.

Downloads

You can view, delete or share files downloaded via the Internet or apps.

Tap  > **Tools** > **Downloads**.

File Manager

You can view and manage files saved on your device or cloud.

- 1 Tap  > **Tools** > **File Manager**.
- 2 Tap  and select the desired storage location.

FM Radio

You can listen to FM radio.

Tap  > **Tools** > **FM Radio**.



- To use this app, first connect earphones to the device. The earphones function as the radio antenna.
- This function may not be supported depending on the area.

Contacts

Contacts overview

You can save and manage contacts.

Tap  > **LG** > **Contacts**.

Adding contacts

Adding new contacts

- 1 On the contact list screen, tap .
- 2 Enter contact details and tap **SAVE**.

Importing contacts

You can import contacts from another storage device.

- 1 On the contact list screen, tap  > **Manage contacts** > **Import**.
- 2 Select the source and target locations of the contact you want to import, and then tap **OK**.
- 3 Select the contacts and tap **IMPORT**.

Adding contacts to the speed dial list

- 1 On the contact list screen, tap  > **Speed dial**.
- 2 Tap **Add contact** from a speed dial number.
- 3 Select a contact.

Searching for contacts

You can search for contacts by using one of the following options:

- On the contact list screen, enter a contact name in the search box.
- Scroll the contact list up or down.
- From the index of the contact list screen, tap the initial letter of a contact.

Contacts list

Editing contacts

- 1 On the contact list screen, select a contact.
- 2 On the contact detail screen, tap  and edit details.
- 3 Tap **SAVE** to save changes.

Deleting contacts

You can delete contacts by using one of the following options:

- On the contact list screen, touch and hold a contact you want to delete, then tap **Delete contact**.
- Tap  > **Delete** on the contact list screen.

Adding favourites

You can register frequently used contacts as favourites.

- 1 On the contact list screen, select a contact.
- 2 On the contact detail screen, tap .

Creating groups

- 1 On the contacts group list, tap .
- 2 Enter a new group name.
- 3 Tap **Add members**, select contacts, then tap **ADD**.
- 4 Tap **SAVE** to save the new group.

LG Health

LG Health overview

You can manage your health and maintain good exercise habits by keeping track of the exercises you do.

Getting started with LG Health

You can configure LG Health when launching the app for the first time or after resetting it.



- 1 Tap  > **LG** > **LG Health**.
- 2 Follow the on-screen instructions to complete configuration.

Using LG Health

You can view main information on LG Health and manage the amount of physical exercise and health information.

- 1 Tap  > **LG** > **LG Health**.
- 2 Do the following:

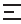

-  : View your exercise log on the day you want to check.
-  : Begin tracking an exercise. The route and amount of your physical exercise are recorded for each exercise type.
-  : Set your daily exercise goals including calories and steps, or set various LG Health settings.



- Health-related information provided by LG Health is designed for user convenience and cannot be used for purposes of disease prevention, treatment, diagnosis or other medical issues.
- LG Health may vary or may not be available, depending on the country and service provider. LG Health functions that are available and apps that can be added to LG Health may vary, depending on the country. This is due to differing laws and regulations.

QuickRemote

QuickRemote overview



You can control many electronic devices in different locations by using your device as a remote control.



- This feature uses infrared (IR) signals and operates very similar to a remote control. When using QuickRemote, keep the IR sensor at the top right of the device uncovered.
- This feature may vary or may not be supported, depending on the area, service provider, or device manufacturer.



Registering a device for remote control

You can register a device you want to control remotely with your device.

- 1 Tap  > **LG** > **QuickRemote**.
- 2 Tap  to specify locations where you want to use the remote control.
- 3 Tap  and select the type and manufacturer of the device you want to remotely control.
- 4 Follow the on-screen instructions to make sure that the QuickRemote feature works properly on the device.

Creating a universal remote control

When the device you want to control with your device does not exist in the list, you can create a customised universal remote control by arranging your frequently used buttons according to your preferences.

- 1 Tap  > **LG** > **QuickRemote**.
- 2 Tap  to specify locations where you want to use the remote control.
- 3 Tap  > **Universal remote**.
- 4 Enter a remote control name and tap **OK**.
- 5 Touch and hold the button you want, then drag it to the position you want.
- 6 Tap **NEXT**.
- 7 Follow the on-screen instructions to register the buttons, then tap **SAVE**.

LG SmartWorld

You can download a variety of games, audio content, apps and fonts provided by LG Electronics. Customise your device to suit your preferences by using Home themes and fonts.



- If you use mobile data, you may be charged for data usage depending on your pricing plan.
- This feature may not be supported depending on the area or service provider.

- 1 Tap > **LG** > **SmartWorld**.
- 2 Tap > **LG Account**, then sign in.
- 3 Select and download content items.

Downloading SmartWorld app

If **SmartWorld** app is not installed, follow these steps to download it.

- 1 Tap > **Settings** > **General** > **Update Centre** > **App Updates**.
- 2 From the list, select **SmartWorld** and tap **Download**.

Tasks

You can register tasks to your device to easily manage schedules.



- 1 Tap > **LG** > **Tasks**.
- 2 Tap to add a task.
- 3 Enter task details and then tap **SAVE**.

LG Friends Manager

You can connect to LG Friends devices and manage them with ease.

LG Mobile Switch

You can back up, restore and move the data saved on your device.

- 1 Tap  > **Management** > **LG Mobile Switch**.
You can also tap  > **Settings** > **General** > **Backup** > **LG Mobile Switch**.
- 2 Follow the on-screen instructions to select a desired method for transfer.



- Data in a Google account will not be backed up. When you synchronise your Google account, Google apps, Google contacts, Google calendar, Google memo app data and apps downloaded from Play store are stored on the Drive app automatically.
- Fully charge the battery before backing up or restoring data to avoid unintentional powering off during the process.

RemoteCall Service

Your device can be remotely diagnosed for resolving issues. First, make a phone call to an LG Customer Service Centre as follows:



- To use this function, first you must agree to usage of the function.
- If you use mobile data, you may be charged for data usage depending on your pricing plan.

- 1 Tap  > **Management** > **RemoteCall Service**.
- 2 Connect a call to an LG Customer Service Centre.
- 3 After the call connects, follow the service associate's instructions to enter a six-digit access number.
 - Your device is remotely connected and the remote support service starts.

Smart Doctor

You can use Smart Doctor to diagnose the device's condition and optimise it.

- 1 Tap  > **Smart Doctor**.
- 2 Use desired functions.
 - You can optimise the device, view the battery usage history, turn on or off the battery saving mode, or diagnose the device condition.

Evernote

You can write and collect important information and then share them with other devices that support **Evernote**.

Tap  > **Recommended** > **Evernote**.

Facebook

You can use a social networking service to update, view and share posts, photos and videos with your online contacts.

Tap  > **Recommended** > **Facebook**.

Instagram

Use a social networking service to capture and share your photos and videos. You can also apply filter effects to make your photos and videos more creative and interesting.

Tap  > **Recommended** > **Instagram**.

Chrome

Sign in to Chrome and import opened tabs, bookmarks and address bar data from a computer to your device.

Google apps

You can use Google apps by setting a Google account. The Google account registration window appears automatically when you use a Google app for the first time. If you do not have a Google account, create one from your device. For details on how to use an app, see the Help in the app.



- Some apps may not work depending on the area or service provider.

Docs

Create documents or edit documents created online or from another device. Share and edit documents together with others.

Drive

Upload, save, open, share and organise files from your device. Files accessible from apps can be accessed from anywhere, including online and offline environments.

Gmail

Register your Google email account to your device to check or send email.

Google

Use the Google to search for web pages, images, news and more by entering or speaking keywords.

Duo

Make simple, high quality video calls to your friends and family on Android phones and iPhones.

Maps

Find your location or the location of a place on the map. View geographical information.

Photos

View or share photos or albums saved on your device.

Play Movies & TV

Use your Google account to rent or purchase movies. Purchase content and play it anywhere.

Play Music

Purchase music files from the **Play Store**. Play music files saved on your device.

Sheets

Create spreadsheets or edit spreadsheets created online or from another device. Share and edit spreadsheets together with others.

Slides

Create presentation material or edit presentation material created online or from another device. Share and edit presentation material together with others.

YouTube

Search and play videos. Upload videos on YouTube to share them with people around the world.

In Apps

Use In Apps on your phone to find content: contacts, messages, videos, and more. It is also a quick way to find and start apps.



04

Phone Settings

Settings

You can customise the device settings in accordance with your preferences.

Tap  > **Settings**.

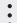

- Tap  and enter a keyword in the search box to access a setting item.
- Tap  to change the view mode. This user guide assumes that you are using the **Tab view**.

Network

Wi-Fi

You can connect to nearby devices over a Wi-Fi network.

Connecting to a Wi-Fi network

- 1 On the settings screen, tap **Network** > **Wi-Fi**.
- 2 Drag  to activate it.
 - Available Wi-Fi networks appear automatically.
- 3 Select a network.
 - You may need to enter the network's Wi-Fi password.
 - The device skips this process for previously accessed Wi-Fi networks. If you do not want to automatically connect to a certain Wi-Fi network, touch and hold the network and then tap **Forget network**.

Wi-Fi network settings

On the settings screen, tap **Network > Wi-Fi**.

- **Switch to mobile data:** If the mobile data connection function is activated but the device cannot connect to the Internet via Wi-Fi connection, the device automatically connects to the Internet via the mobile data connection.
-  : Customise Wi-Fi network settings.

Wi-Fi Direct

You can connect your device to other devices that support Wi-Fi Direct to share data directly with them. You do not need an access point. You can connect with more than two devices by using Wi-Fi Direct.

- 1 On the settings screen, tap **Network > Wi-Fi >  > Advanced Wi-Fi > Wi-Fi Direct**.
 - Nearby devices that support Wi-Fi Direct automatically appear.
- 2 Select a device.
 - Connection occurs when the device accepts the connection request.



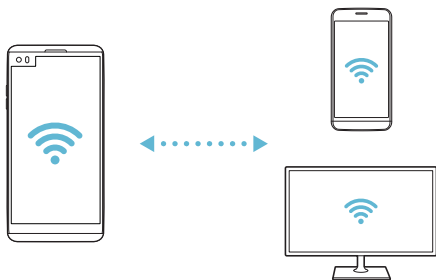

- The battery may drain faster when using Wi-Fi Direct.



Bluetooth

You can connect your device to nearby devices that support Bluetooth to exchange data with them. Connect your device to a Bluetooth headset and a keyboard. This makes it easier to control the device.

Pairing with another device

- 1 On the settings screen, tap **Network > Bluetooth**.
- 2 Drag  to activate it.
 - Available devices appear automatically.
 - To refresh the device list, tap .



• Only devices set as visible are displayed on the list.

- 3 Select a device from the list.
- 4 Follow the on-screen instructions to perform authentication.



• This step is skipped for previously accessed devices.

Sending data via Bluetooth

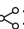
- 1 Select a file.
 - You can send multimedia files or contacts.
- 2 Tap  **Bluetooth**.
- 3 Select a target device for the file.
 - The file is sent as soon as the target device accepts it.



• File sharing processes may differ, depending on the file.

Mobile data

You can turn on or off mobile data. You can also manage mobile data usage.

Turning on mobile data

- 1 On the settings screen, tap **Network > Mobile data**.
- 2 Drag  to activate it.

Customising mobile data settings

- 1 On the settings screen, tap **Network > Mobile data**.
- 2 Customise the following settings:
 - **Mobile data:** Set to use data connections on mobile networks.
 -  : Customise mobile data settings.

Call

You can customise call settings, such as voice call and international call options.



- Some features may not be supported depending on the area or service provider.

- 1 On the settings screen, tap **Network > Call**.
- 2 Customise the settings.

Tethering

USB tethering

You can connect the device to another device via USB and share mobile data.

- 1 Connect your device and other devices via USB cable.
- 2 On the settings screen, tap **Network** > **Tethering** > **USB tethering** and then drag ☐ to activate it.



- This option uses mobile data and may incur data usage fees, depending on your pricing plan. Consult with your service provider for more information.
- When connecting to a computer, download the USB driver from www.lg.com and install it on the computer.
- You cannot send or receive files between your device and a computer while USB tethering is turned on. Turn off USB tethering to send or receive files.
- Operating systems that support tethering are Window XP or higher, or Linux.

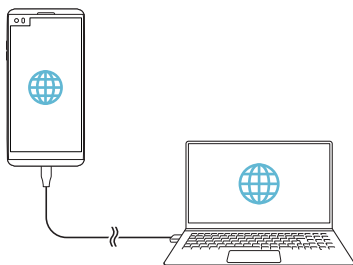

Wi-Fi hotspot

You can set the device as a wireless router so that other devices can connect to the Internet by using your device's mobile data.

- 1 On the settings screen, tap **Network > Tethering > Wi-Fi hotspot** and then drag  to activate it.
- 2 Tap **Set up Wi-Fi hotspot**, and enter the Wi-Fi name (SSID) and password.
- 3 Turn on Wi-Fi on the other device, and select the name of the device network on the Wi-Fi list.
- 4 Enter the network password.



- This option uses mobile data and may incur data usage fees, depending on your pricing plan. Consult with your service provider for more information.
- More information is available at this web site:
<http://www.android.com/tether#wifi>

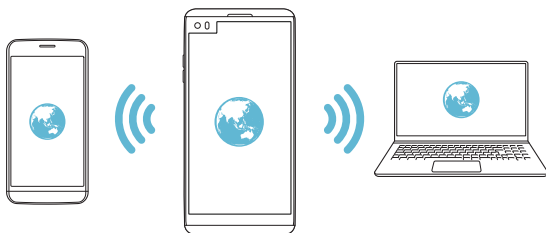

Bluetooth tethering

A Bluetooth-connected device can connect to the Internet by using your device's mobile data.

- 1 On the settings screen, tap **Network > Tethering > Bluetooth tethering** and then drag ☐ to activate it.
- 2 Turn on Bluetooth on both devices, and pair them.



- This option uses mobile data and may incur data usage fees, depending on your pricing plan. Consult with your service provider for more information.
- More information is available at this web site:
http://www.android.com/tether#Bluetooth_tethering

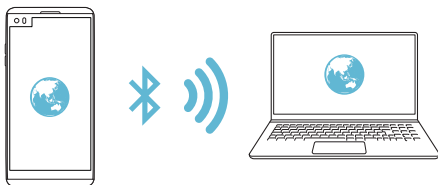

Help

You can view help on using tethering and hotspots.

On the settings screen, tap **Network > Tethering > Help**.

Screen sharing

You can play the screen and sound of the device on a different device, such as a TV, that supports the Miracast function.

- 1 On the settings screen, tap **Network > Screen sharing**.
- 2 Drag ☐ to activate it.

- 3 Select a device from the list of nearby devices.
 - If the desired device does not appear, tap **SEARCH** to refresh the list.
 - After connecting to the device, the device displays the screen of your device.



- Screen sharing turns off automatically if there is no sharing-compatible device in the vicinity.

NFC

You can use the device as a transportation card or credit card. You can also share data with the other device.

- 1 On the setting screen, tap **Network > NFC**.
- 2 Drag ☐ to activate it.
 - Touch your device with other device that supports NFC to allow sharing data.



- NFC antenna may be located differently depending on the device type. See [Parts overview](#) for details about the NFC antenna area.

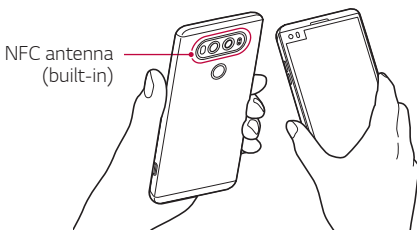

Android Beam

You can share files by touching the back of the device to other device. You can also share files including music, videos or contacts and open a web page or launch an app from the other device.

- 1 On the settings screen, tap **Network > Android Beam**.
- 2 Touch the back of the device with another device.



• NFC antenna may be located differently depending on the device type.

Sharing panel

You can share contents from Gallery, Music and File Manager with nearby devices. Also you can share content with specific people in apps that work with Google Direct Share.

- 1 On the settings screen, tap **Network > Sharing panel**.
- 2 Tap  to deactivate each option.

File sharing

You can send and receive files between your device and other LG devices or tablets.



• See *Sending or receiving files* for details.

- 1 On the settings screen, tap **Network > File sharing**.
- 2 Customise the following settings:
 - **V20**: Change the device name.
 - **Save to**: Set the destination folder to save files sent from other devices in.

- **File sharing:** Permit receipt of files sent from other devices.
- **SmartShare Beam:** Share files with other devices via SmartShare Beam.
- **Help:** You can view help on sharing files.

Media server

You can share media content on your device with nearby devices that support DLNA.

- 1 On the settings screen, tap **Network > Media server**.
- 2 Customise the following settings:
 - **Content sharing:** Share content on your device with nearby devices.
 - **V20:** Set your device's name.
 - **Content to share:** Select the type of media content to share with other devices.
 - **Allowed devices:** View a list of devices permitted to access content on your device.
 - **Not-allowed devices:** View a list of devices not permitted to access content on your device.

LG AirDrive

You can use your LG account to manage files saved on the device from a computer. You do not need a USB connection.

- 1 On the settings screen, tap **Network > LG AirDrive**.
- 2 Use a single LG account to sign in to LG Bridge on the computer and **LG AirDrive** on the device.
 - LG Bridge software can be downloaded from www.lg.com.
- 3 Manage files on the device from the computer.





Printing

You can connect your device to a Bluetooth printer and print photos or documents saved on the device.

- 1 On the settings screen, tap **Network > Printing**.



- If the desired printer is not in the list, install the printer driver from the app store.

- 2 Drag  to activate it.
- 3 Select a printer from the printer list screen.
 - To add a printer, tap  > **Add printer**.
 - To search for a printer name, tap  > **Search**.
 - Tap  > **Settings** from the printer list screen.
- 4 Select a file and tap  > **Print**.
 - The document prints.



- If you do not have a Google account, tap **ADD ACCOUNT** to create an account.

Airplane mode

You can turn off the call and mobile data functions. When this mode is on, functions that do not involve data, such as games and music playback, remain available.

- 1 On the settings screen, tap **Network > Airplane mode**.
- 2 Tap **TURN ON** in the confirmation screen.

Mobile networks

You can customise mobile data settings.

- 1 On the settings screen, tap **Network > Mobile networks**.
- 2 Customise the following settings:
 - **Mobile data:** Turn mobile data on or off.
 - **Data roaming:** Browse the web, use emails, multimedia messages and other data services overseas.
 - **Network mode:** Select a network type.
 - **Access Point Names:** View or change the access point for using mobile data services. To change the access point, select a choice from the access point list.
 - **Network operators:** Search for network operators and connect automatically to a network.

VPN

You can connect to a safe virtual network, such as an intranet. You can also manage connected virtual private networks.

Adding VPN

- 1 On the settings screen, tap **Network > VPN**.



- Be cautious that if the screen lock is unlocked, all VPN information saved on the device are erased.

- 2 Tap **+**.



- This feature is available only when the screen lock is activated. If the screen lock is deactivated, a notification screen appears. Tap **CHANGE** from the notification screen to activate the screen lock. See [Configuring screen lock settings](#) for details.

- 3 Enter VPN details and tap **SAVE**.

Configuring VPN settings

- 1 Tap a VPN from the **VPNS** list.
- 2 Enter the VPN user account details and tap **CONNECT**.
 - To save the account details, select the **Save account information** checkbox.

Sound

You can customise sound, vibrate and notification settings.

On the settings screen, tap **Sound** and customise the following settings:

- **Sound profile:** Change the sound mode to **Sound, Vibrate only**, or **Silent**.
- **Volume:** Adjust the sound volume for various items.
- **Ringtone:** Select a ringtone for incoming calls. Add or delete ringtones.
- **Ringtone ID:** Create a ringtone for an incoming call from a particular contact.
- **Ring with vibration:** Set the device to vibrate and play a ringtone simultaneously.
- **Notification sound:** Select a notification ringtone. Set music saved on the device as a notification ringtone.
- **Do not disturb:** Set the time, range and app type to receive notification messages. Receive notification messages only on particular days of the week.
- **Hi-Fi Quad DAC:** Connect to the earpiece, speaker or other external audio devices and use any of them as a Hi-Fi Quad DAC.
- **Vibration strength:** Adjust the vibration intensity.
- **Vibration type:** You can select a vibration type or make your own vibration pattern.

- **Vibrate on tap:** Set the device to vibrate when you tap certain items on the screen.
- **Dialing keypad sound:** Select the keypad sound effect.
- **LG Keyboard sound:** Select LG keyboard sound effect.
- **Touch sound:** Select a sound effect for tapping an item.
- **Screen lock sound:** Select a sound effect when the screen is locked or unlocked.

Display

You can customise detailed settings for each screen type.

On the settings screen, tap **Display** and customise the following settings:

- **Home screen:** Customise settings for the Home screen. See *Home screen settings* for details.
- **Theme:** Select a screen theme for your device.
- **Font:** Change the font size, bold text or type.
- **Home touch buttons:** Rearrange Home touch buttons or change their background colours. Hide Home touch buttons on the screen.
- **Second screen:** Customise the settings and options for the Second screen. See *Second screen* for details.
- **Display size:** Set the items on the screen to a size easy for you to see. Some items may change position.
- **Comfort view:** Set the device to reduce amount of blue light on screen to reduce eye strain.
- **Brightness:** Use the slide bar to change the device's screen brightness. To automatically adjust screen brightness according to ambient light intensity, tap the **Auto** switch.
- **Auto:** Set the device so that the screen brightness is automatically adjusted in accordance with the ambient light intensity.

- **Auto-rotate screen:** Automatically rotate the screen according to the device's orientation.
- **Screen timeout:** Automatically turn off the screen when the device is left idle for a specified period of time.
- **Screen saver:** Display a screen saver when the device is connected to the holder or charger. Select a screen saver type to display.
- **Mini view:** You can make the screen size smaller to conveniently use the device with one hand. Drag the Home touch button at the bottom of the screen to the left or right.

General

Lock screen & security

You can customise lock screen and security settings.

- **Google Play Protect:** Scan the device periodically for potentially harmful codes or apps.
- **Find My Device:** Remotely track the device location. You can also protect your data securely if you lost your device.
- **Security update:** Check for software update and configure automatic installation settings.
- **Select screen lock:** Select the desired screen lock method. See *Configuring screen lock settings* for details.
- **Customize Lock screen:** Change the information displayed on the locked screen.
- **Secure lock settings:** Change the secure lock settings.
- **Fingerprints:** Use your fingerprint to unlock the screen or content. See *Fingerprint recognition overview* for details.
- **Content lock:** Allows you to set a lock type (password or pattern) for your QuickMemo+ and Gallery files.
- **Location:** You can customise how your location information is used by particular apps.

- **Encryption & credentials:** Configure the settings for SD card encryption and credentials.
 - **Encrypt SD card:** Encrypt the memory card to prevent use on another device. See *Memory card encryption* for details.
 - **Secure start-up:** Protect your device with a lock when it powers on. See *Secure start-up settings* for details.
 - **Credential protection:** View the type of the storage where the security certificate will be saved.
 - **Trusted credentials:** View your system's root CA certificates and user-installed CA certificates.
 - **User credentials:** View and change secure certificate information stored on your device.
 - **Install from storage:** Install a secure certificate from a storage.
 - **Clear credentials:** Delete user-installed secure certificates and related credentials.
- **Set up SIM card lock:** Lock or unlock the USIM card, or change the password (PIN).
- **Make passwords visible:** Enable this option to briefly show each character of the password as you type it so you can see what you've entered.
- **Phone administrators:** Allows privileges to restrict the control or use of the device to particular apps.
- **Trust agents:** View and use trust agents installed on the device.
- **Screen pin:** Fix the app screen so that only the currently active app can be used.
- **Usage access:** View details on usage of apps on the device.

Apps & notifications

You can check a list of installed apps, and configure the settings for notifications, app permissions, and more.

- 1 On the settings screen, tap **General > Apps & notifications**.
- 2 Customise the settings.

Battery

You can view the current battery information or turn on power-saving mode.

- 1 On the settings screen, tap **General > Battery**.
- 2 Customise the following settings:
 - **Battery usage:** View the battery usage details. To view more details, select a specific item.
 - **Battery percentage on status bar:** Display the remaining battery level as a percentage on the status bar.
 - **Battery saver:** Reduce battery consumption by cutting down some device settings, such as the display brightness, speed and vibration intensity.
 - **Power saving exclusions:** Select apps to use without any functional limitation while in power saving or battery optimisation mode.

Storage

You can view and manage internal storage on the device or storage space of the memory card.

- 1 On the settings screen, tap **General > Storage**.
- 2 Customise the following settings:
 - **Internal storage:** View the total storage space and free space in the device's internal storage. View a list of apps in use and the storage capacity for each app.
 - **SD card:** View the total storage space and free space in the memory card. This option appears only when a memory card is inserted. To unmount the memory card, tap .

Users & accounts

You can add users to share your device and register a cloud account.

- 1 On the settings screen, tap **General > Users & accounts**.
- 2 Customise the settings.

Accessibility

You can manage accessibility plug-ins installed on your device.

- 1 On the settings screen, tap **General > Accessibility**.
- 2 Customise the following settings:
 - **Vision > TalkBack**: Set the device to notify screen status or actions via voice.
 - **Vision > Message/call voice notifications**: Set the device to read the caller information or message content via voice.
 - **Vision > Font**: Change the font size, bold text or type.
 - **Vision > Display size**: Set the items on the screen to a size easy for you to see. Some items may change position.
 - **Vision > Touch zoom**: Zoom in or out by tapping the screen three times.
 - **Vision > Window zoom**: Magnify or reverse a part of the screen.
 - **Vision > Large mouse pointer**: Magnify the mouse pointer.
 - **Vision > High contrast screen**: Turn the background colour into black for a high contrast screen.
 - **Vision > Screen colour inversion**: Increase the display colour contrast for people with low vision.
 - **Vision > Screen colour adjustment**: Adjust the display colour.
 - **Vision > Grayscale**: Switch the screen to grayscale mode.
 - **Vision > End call with the Power key**: End a call by pressing the Power/Lock key.

- **Hearing > Captions:** Turn on the subtitle service when playing videos for the hearing impaired.
- **Hearing > Flash alerts:** Set the device to notify you with a blinking light for incoming calls and alarms.
- **Hearing > Mute all sounds:** Mute all sounds and lower volume on the receiver.
- **Hearing > Audio channel:** Select the audio type.
- **Hearing > Sound balance:** Adjust the audio output balance. Use the slide bar to change the balance.
- **Motor & cognition > Touch assistant:** Turn on the touch board to make buttons and gestures easier to use.
- **Motor & cognition > Touch input:** Enter text by touching and holding the screen or modify it by simply touching the screen.
- **Motor & cognition > Physical keyboard:** Customise the keyboard settings.
- **Motor & cognition > Auto mouse click:** Automatically click the mouse pointer in case of no movement.
- **Motor & cognition > Touch and hold for calls:** Answer or decline calls by touching and holding the call button instead of dragging it.
- **Motor & cognition > Screen timeout:** Turn off the screen automatically when the device is left idle for a specified period of time.
- **Motor & cognition > Touch control areas:** Limit the touch area so that only a particular portion of the screen can be controlled by touch input.
- **Accessibility features shortcut:** Quickly access a frequently used function by tapping  three times.
- **Auto-rotate screen:** Automatically change the screen orientation according to the physical position of the device.
- **Select to Speak:** Allows you to tap items to hear spoken feedback.
- **Switch Access:** Create key combinations to control your device.

Google

You can use Google settings to manage your Google apps and account settings.

On the settings screen, tap **General > Google**.

Smart Doctor

You can use Smart Doctor to diagnose the device's condition and optimise it.

On the settings screen, tap **General > Smart Doctor**.



• See *Smart Doctor* for details.

Gaming

You can configure settings for game tools, graphics and battery saving feature.

- **Game tools:** Tap ☐ to activate this feature. You can launch this feature by tapping the game tool icon at the bottom of the screen while playing games.
- **Game graphics:** Adjust the game graphics.



• When you change the resolutions on some games, the screen display feature may not work properly.

- **Break time:** Reduce the screen brightness and performance whenever you leave the game running for more than 5 minutes.

Smart settings

You can automatically change your device settings according to the usage pattern and location.



- To use Smart settings, make sure to set the residential address.

- 1 On the settings screen, tap **General > Smart settings**.
- 2 Activate items you want to automatically change settings for.

Shortcut keys

You can use the volume keys to directly launch apps when the screen is turned off or locked.

- 1 On the settings screen, tap **General > Shortcut keys**.
- 2 Drag  to activate it.
 - Press the Volume Down (-) key twice to launch the **Camera** app when the screen is locked or turned off. Press the Volume Up (+) key twice to launch **Capture+**.

Quick Cover case

You can use Quick Cover case with your phone. You can answer calls, stop the alarm/timer, power off your phone, and see notifications via Second screen.

On the settings screen, tap **General > Quick Cover case**.

KnockON

Double-tap the screen to turn the screen on or off.

See *KnockON* for details.

Update centre

You can check and install the latest version of the app or software provided by LG.

- 1 On the settings screen, tap **General > Update centre**.
- 2 Customise the following settings:
 - **App Update:** Check if an app update is available. If available, you can install the update.
 - **Software Update:** Check if a software update is available. If available, you can install the update.

Language & input

You can customise language and keyboard settings for your device.

- 1 On the settings screen, tap **General > Language & input**.
- 2 Customise the following settings:
 - **Language:** Select a language to apply for the device.
 - **Current keyboard:** View the keyboard currently in use. Select a keyboard to use when entering text.
 - **On-screen keyboard:** Change the LG keyboard settings or voice recognition feature of Google Voice.
 - **Physical keyboard:** Select to use the physical keyboard, or check keyboard shortcut keys.
 - **Autofill service:** Enable this option to enter your information saved in your account such as password, address, or credit card number with a single tap. You can also disable this option, use Google Autocomplete, or add a new service account.
 - **Text-to-speech output:** Configure the settings for text-to-speech output.
 - **Pointer speed:** Adjust the pointer speed of a mouse or trackpad.
 - **Reverse mouse buttons:** Reverse the right mouse button to perform primary direct-manipulation actions.

Date & time

You can customise date and time settings for your device.

- 1 On the settings screen, tap **General > Date & time**.
- 2 Customise the settings.

Memory

You can view the average amount of memory usage over a certain period of time and the memory occupied by an app.

- 1 On the settings screen, tap **General > Memory**.
- 2 Tap ▼ to set a time slot to retrieve data.

Backup

You can back up data saved on your device to another device or account.

- 1 On the settings screen, tap **General > Backup**.
- 2 Customise the following settings:
 - **LG Mobile Switch:** Allows you to transfer data from an old LG device to your new LG device. See *LG Mobile Switch* for details.
 - **Backup & restore:** Back up your device data or restore data to your device from a backup.



Resetting your device may delete backup files saved in storage. Make sure to copy and store the important backup files to your PC.

- **Google backup:** Change Google drive backup settings. You can also check the backup account currently used, or add a new backup account.

Reset

You can reset the device including network and app settings.

- 1 On the settings screen, tap **General > Reset**.
- 2 Customise the following settings:
 - **Network settings reset:** Reset Wi-Fi, Bluetooth and other network settings.
 - **Reset app preferences:** Reset the settings for an app. The data saved in the app will not be deleted.
 - **Factory data reset:** Reset all settings for the device and delete data.



- Resetting your device deletes all data on it. Enter your device name, Google account and other initial information again.

About phone

You can view information about your device, such as the name, status, software details and legal information.

On the settings screen, tap **General > About phone** and view information.





05

Appendix

LG Language Settings

Select a language to use on your device.

- Tap  > **Settings** > **General** > **Language & input** > **Language** > **ADD LANGUAGE**, and select a language.
 - Touch and hold  and drag it to the top of the language list to set it as a default language.

LG Bridge

LG Bridge overview

LG Bridge is an app that helps you manage the photos, music, videos and documents saved on your LG smartphone from your computer conveniently. You can back up contacts, photos and more to the computer or update the device software.



- See LG Bridge help for details.
- The supported features may vary depending on the device.
- LG USB driver is a necessary program to connect your LG smartphone with the computer and is installed when you install LG Bridge.

LG Bridge functions

- Manage the files on the device from a computer via Wi-Fi connection or mobile data connection.
- Back up data from the device to a computer or restore data from a computer to the device via USB cable connection.
- Update the device software from a computer via USB cable connection.

Installing LG Bridge on a computer

- 1 Go to www.lg.com from your computer.
- 2 Select your region and click .
- 3 In the search bar, enter the name of your device.
- 4 Click **Support > Manuals & Downloads**.
- 5 In the Software & Firmware, Click **PC Sync** and download the setup file.
 - Click **Details** to view the minimum requirements for installing LG Bridge.

Phone software update

LG Mobile phone software update from the Internet

For more information about using this function, please visit <http://www.lg.com/common/index.jsp>, select your country and language.

This feature allows you to conveniently update the firmware on your phone to a newer version from the Internet without needing to visit a service centre. This feature will only be available if and when LG makes a newer firmware version available for your device.

Because the mobile phone firmware update requires the user's full attention for the duration of the update process, please make sure you check all instructions and notes that appear at each step before proceeding. Please note that removing the USB cable during the upgrade may seriously damage your mobile phone.



- LG reserves the right to make firmware updates available only for selected models at its own discretion and does not guarantee the availability of the newer version of the firmware for all handset models.

LG Mobile Phone software update via Over-the-Air (OTA)

This feature allows you to conveniently update your phone's software to a newer version via OTA, without connecting a USB cable. This feature will only be available if and when LG makes a newer firmware version available for your device.

First check the software version on your mobile phone:

Settings > General > Update centre > Software Update > Check now for update.



- Your personal data from internal phone storage—including information about your Google account and any other accounts, your system/application data and settings, any downloaded applications and your DRM licence—might be lost in the process of updating your phone's software. Therefore, LG recommends that you backup your personal data before updating your phone's software. LG does not take responsibility for any loss of personal data.
- This feature depends on the area or service provider.

FAQ

This chapter lists some problems you might encounter when using your device. Some problems require you to call your service provider, but most are easy to fix yourself.

SIM card error

Make sure the SIM card is correctly inserted.

No network connection or dropped network

Signal is weak. Move to a window or an open area.

You are outside the carrier network area. Move and check the network.

Calls are not available

New network not authorized.

Make sure you have not set call barring for the incoming number.

Make sure you have not set call barring for the number you are dialing.

Device cannot be turned on

When the battery is completely discharged, your device will not turn on.

Fully charge the battery before turning on the device.

Charging error

Make sure device is charging at a normal temperature.

Check the charger and its connection to the device.

Use only in-box accessories which are authorized by LG.

The battery depletes faster than when first purchased

When you expose the device or the battery to very cold or hot temperatures, the battery life may be reduced.

Battery consumption will increase when you use certain features or apps, such as GPS, games or the Internet.

The battery is consumable and the battery life will get shorter over time.

Error messages appear when launching the camera

Charge the battery.

Free some memory by transferring files to a computer or deleting files from your device.

Restart the device.

If you are still having trouble with the camera app after trying these tips, contact a LG Electronics Service Center.

The photo quality is poor

The quality of your photos may vary, depending on the surroundings and the photography techniques you use.

If you take photos and videos, standard angle quality is better than wide-angle.

If you take photos in dark areas, at night or indoors, image noise may occur or images may be out of focus.

If you have any problems, reset the options.

The touch screen responds slowly or incorrectly

If you attach a screen protector or optional accessories to the touch screen, the touch screen may not function properly.

If you are wearing gloves, if your hands are not clean while touching the touch screen or if you tap the screen with sharp objects or your fingertips, the touch screen may malfunction.

The touch screen may malfunction in humid conditions or when exposed to water.

Restart your device to clear any temporary software bugs.

If the touch screen is scratched or damaged, visit a LG Electronics Service Center.

Hangs or freezes

Restart the device

- If your device freezes or hangs, you may need to close apps or turn the device off and then on again.

Perform a boot-up

- A soft reset may be used to reset the device if the screen freezes, or the buttons, touch screen or device are no longer responding.
- To perform a soft reset of your device, simply press and hold the Volume Down and Power keys until the device restarts.

Reset the device

- If the methods above do not solve your problem, perform a factory data reset.
- On the settings screen, tap **General > Reset > Factory data reset**.
 - This method resets all settings for the device and deletes data. Before performing the factory data reset, remember to make back-up copies of all important data stored in the device.
 - If you registered a Google account to the device, you must sign in to the same Google account after resetting the device.

Bluetooth device is not located

Make sure the Bluetooth wireless feature is activated on your device.

Make sure the Bluetooth wireless feature is activated on the device you wish to connect to.

Make sure your device and the other Bluetooth device are within the maximum Bluetooth range (10 m).

If the tips above do not solve your problem, contact a LG Electronics Service Center.

A connection is not established when you connect the device to a computer

Make sure the USB cable you are using is compatible with your device.

Make sure you have the proper driver installed and updated on your computer.

Downloaded application causes a lot of errors

Application has problems.

Remove and reinstall the application.

Anti-Theft Guide

Set up your device to prevent other people from using it if it's been reset to factory settings without your permission. For example, if your device is lost, stolen, or wiped, only someone with your Google account or screen lock information can use the device.

All you need to make sure your device is protected is:

- Set a screen lock: If your device is lost or stolen but you have a screen lock set, the device can't be erased using the Settings menu unless your screen is unlocked.
- Add your Google account on your device: If your device is wiped but you have your Google account on it, the device can't finish the setup process until your Google account information is entered again.

After your device is protected, you'll need to either unlock your screen or enter your Google account password if you need to do a factory reset. This ensures that you or someone you trust is doing the reset.



- Do not forget your Google account and password you had added to your device prior to performing a factory reset. If you can't provide the account information during the setup process, you won't be able to use the device at all after performing the factory reset.

More information

Open Source Software Notice Information

To obtain the source code under GPL, LGPL, MPL, and other open source licenses, that is contained in this product, please visit <http://opensource.lge.com>.

In addition to the source code, all referred license terms, warranty disclaimers and copyright notices are available for download.

LG Electronics will also provide open source code to you on CD-ROM for a charge covering the cost of performing such distribution (such as the cost of media, shipping, and handling) upon email request to opensource@lge.com. This offer is valid for three (3) years from the date on which you purchased the product.

Trademarks

- Copyright ©2018 LG Electronics, Inc. All rights reserved. LG and the LG logo are registered trademarks of LG Group and its related entities.
- Google™, Google Maps™, Gmail™, YouTube™, Hangouts™ and Play Store™ are trademarks of Google, Inc.
- Bluetooth® is a registered trademark of Bluetooth SIG, Inc. worldwide.
- Wi-Fi® and the Wi-Fi logo are registered trademarks of the Wi-Fi Alliance.
- All other trademarks and copyrights are the property of their respective owners.

DOLBY AUDIO



Manufactured under license from Dolby Laboratories. Dolby, Dolby Audio, and the double-D symbol are trademarks of Dolby Laboratories.

TypeC-HDMI

- You may not need to connect the charger with TypeC-HDMI gender to output the screen. Connect the charger for reducing the battery consumption.
- When you connect the device with TypeC-HDMI gender or HDMI cable, you can view the UHD video on the TV, projector, or monitor. You need the UHD supporting gender and HDMI cable for UHD output.
- Copyright protected content (DRM/HDCP) may be limited depending on your output device. You can only view your own device screen.
- Some video files may not be played properly depending on the hardware performance or memory limit.
- Some videos may not be played properly depending on the screen resolution, frame per second, average bit transfer rate, or encoding settings.
- If the screen is cut or displayed abnormally, change the screen size into the original size on the TV or monitor.
- The devices can mutually connect with themselves by connecting them with TypeC-HDMI gender and HDMI cable even if the power is turned off.
- If the TV, projector, monitor do not output the screen, disconnect the HDMI cable with the gender for a moment. Some genders may not mutually connected with each other.

Laser safety statement

Caution!

This product employs a Laser system. To ensure proper use of this product, please read this owner's manual carefully and retain for future reference. Should the unit require maintenance, contact an authorised service centre.

Use of controls, adjustments, or the performance of procedures other than those specified herein may result in hazardous radiation exposure.

To prevent direct exposure to laser beam, do not try to open the enclosure or to make the direct contact with the laser.

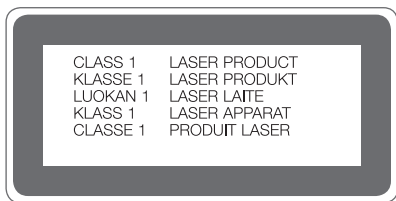

DECLARATION OF CONFORMITY

Hereby, **LG Electronics** declares that this **LG-H990** product is in compliance with the essential requirements and other relevant provisions of Directive **1999/5/EC**.

A copy of the Declaration of Conformity can be found at
<http://www.lg.com/global/declaration>



CE0168ⓘ