

Quick Start Guide

LED MONITOR
32MN49H

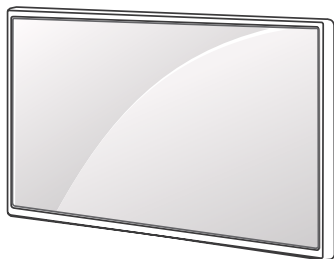

AAA

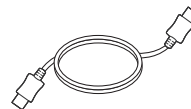

X 2
(M4 X L16)

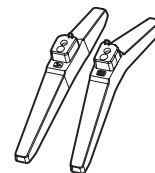
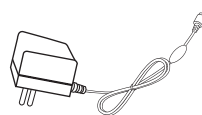
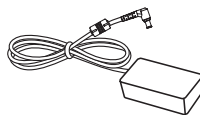

www.lg.com



Read Safety and Reference.

Unpacking

Check your product box for the following items. If there are any missing accessories, contact the local dealer where you purchased your product. The illustrations in this manual may differ from the actual product and item.

*Image may vary depending on models

 Depending on model



MFL69446193
(1712-REV00)



English

- Read **Safety and Reference**.
- For the power supply and power consumption, refer to the label attached to the product.



1

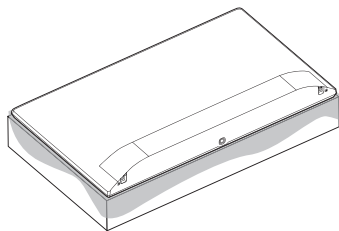

2

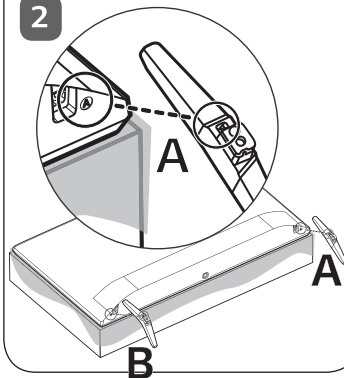

3

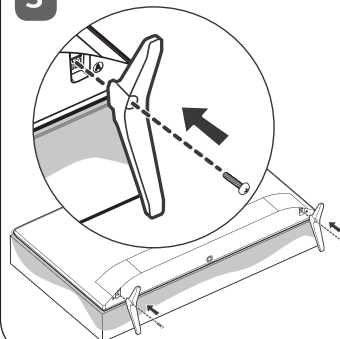

4

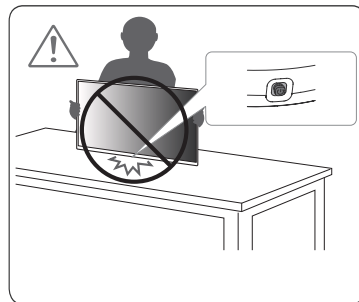
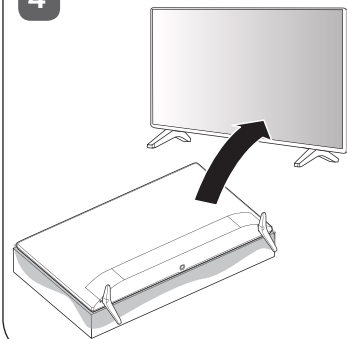

CAUTION

Image shown may differ from your TV.

When attaching the stand to the TV set, place the screen facing down on a cushioned table or flat surface to protect the screen from scratches.

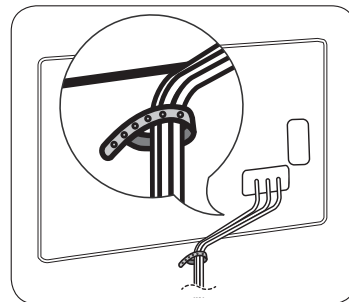

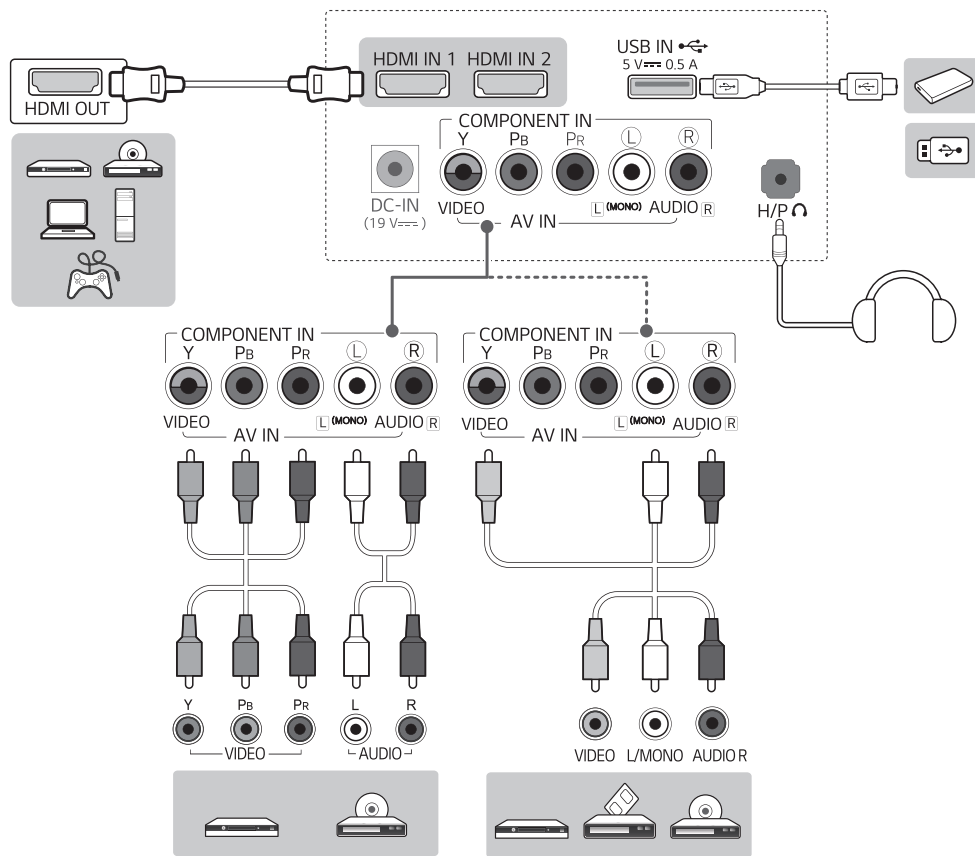
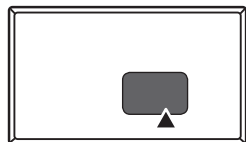

NOTE

Image shown may vary depending on model.
All connection cables & devices shown in the picture are not included along with the TV set.

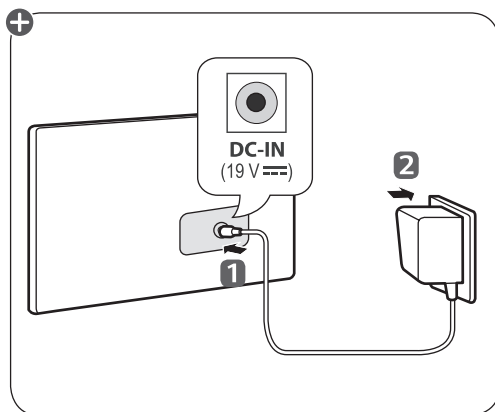
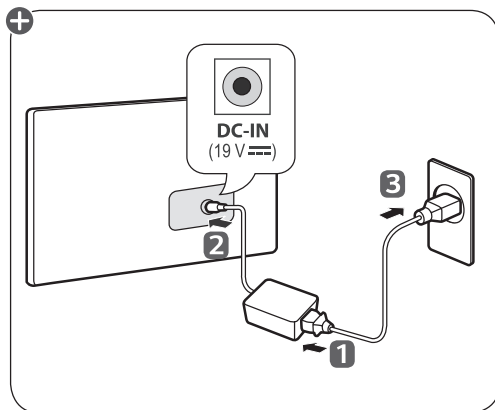

NOTE

Do not use sub standard batteries in monitor remote which may lead to leakage & damage the remote control unit permanently. For long unused applications of remote controller it is advisable to remove batteries from remote control unit.

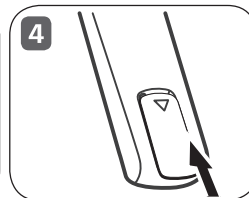
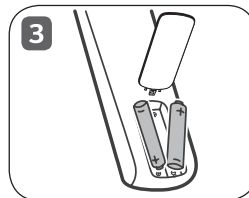
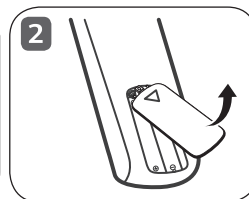
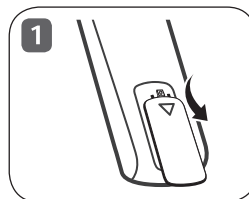
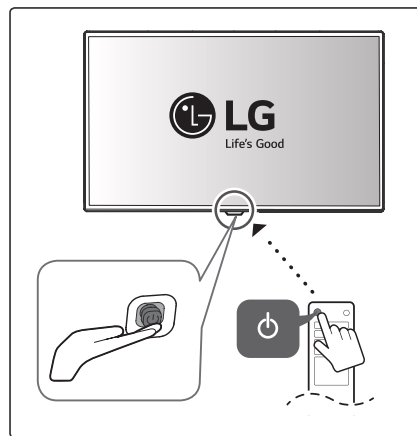

+ Depending on model