

OWNER'S MANUAL

WATER PURIFIER

Please read this manual carefully before operating
your set and retain it for future reference.



MFL66990819
Rev. 18_220221

www.lg.com

Copyright © 2020-2021 LG Electronics Inc. All Rights Reserved.

TABLE OF CONTENTS

This manual may contain images or content in addition to the model purchased.

This manual may be subjected to revision by the manufacturer.

- SAFETY INSTRUCTIONS 03
- INSTALLATION 06
 - Parts and Function 06
 - Notes for Installation 08
 - Installing water purifier 08
- OPERATION 09
 - Notes for Operation 09
 - Using Control Panel 09
 - Operation 10
- MANAGEMENT 11
 - Cleaning 11
 - Maintaining the filter 12
- TROUBLESHOOTING 14
- WATER PIPING DIAGRAM 15
- PRODUCT SPECIFICATION 18

SAFETY INSTRUCTIONS

Manufacturer is not responsible for accidents caused by the user as a result of not following the Instruction Manual.

The following safety guidelines are intended to prevent unforeseen risks or damage from unsafe or incorrect operation of the appliance.

The guidelines are separated into 'WARNING' and 'CAUTION' as described below.

 This symbol is displayed to indicate matters and operations that can cause risk. Read the part with this symbol carefully and follow the instruction in order to avoid risk.

 **WARNING** - This indicates that the failure to follow the instructions can cause serious injury or death.

 **CAUTION** - This indicates that the failure to follow the instructions can cause minor injury or damage the product.

WARNING

To reduce the risk of explosion, fire, death, electric shock, injury or scalding to persons when using this product, follow basic precautions, including the following:

TECHNICAL SAFETY

- Only an authorized person from LG Electronics service center should install the product. Contact LG Electronics service center if you move the product, improper installation/service may cause injury, electric shock or fire.

POWER

- Do not modify Power Cord length. Do not use any extension board or multiple socket outlet. Also, Do not share the same power socket outlet with other appliances. Otherwise it will cause electric shock or fire due to heat generation.
- Do not touch the power plug with wet hands, it may cause electric shock
- Plug the power plug in the outlet tightly after removing the moisture and dust completely. It will cause electric shock or fire due to heat generation.
- When pulling out the power plug from an outlet, hold the power plug, not the cable. it will cause electric shock or fire due to heat generation at damaged supply cord area. If the power cable or Power Plug is damaged, It must be replaced by a Original Spare part provided by the manufacturer or Contact LG Electronics Service.
- Power Supply cord should not be bend or pressed under heavy object. It may damage the power cord to cause Fire or Electric shock.
- Do not plug and unplug the power plug repeatedly It may loosen the holes of Outlet socket to cause Fire or Electric shock.

OPERATION

- In case of flood, stop using the product and contact LG Electronics service center.
- Do not place heavy or fragile objects, liquids, combustible substance, or flammable objects (such as lit candles and lamps) on or inside the product. It may cause fire, injury or damage.
- If moisture penetrates inside the product, unplug the power plug and contact LG Electronics service center. It may cause electric shock.
- Do not move the product while the product is plugged in. It may damage the power supply cord and Cause Electric shock or injury.
- Do not allow anyone to hang from or climb on the product. Be particularly cautious of children operating the product. It may cause injury.
- If water is leaking from the inside of the product or water has collected near the product, close the water supply valve, unplug the power plug, and contact LG Electronics service center. It may cause electric shock.
- When cleaning the product, unplug the power plug. It may cause electric shock.

CAUTION

To reduce the risk of minor injury to persons, malfunction, or damage to the product or property when using this product, follow basic precautions, including the following:

Installation

- Connect the input water pipe of the product to tap water only. Water other than tap water is not recommended. It may cause health issues.
- Never start up an appliance showing any signs of damage. If in doubt, consult your dealer. This may cause damage or injury.
- Do not clean the product with brushes, cloths or sponges with rough surfaces or which are made of metallic material. It may cause scratches and cracks on the product.
- There can be sharp edges in a disassembled set, special care to be taken while handling. It may cause electric shock.
- Do not spray/use or store flammable or combustible substance (ether, benzene, alcohol, chemical, LPG, combustible spray, insecticide, air freshener, cosmetics etc.) near/inside the product, it may cause health related issues.
- For counter-top installation, install the product on a solid and horizontally leveled surface. If the product is installed on a non-horizontally leveled surface, it can generate vibrations and noise or cause misalignment of the product.
- Keep ventilation openings, in the appliance enclosure or in the built-in structure, clear of obstruction. This may cause damage.
- Avoid installing the water purifier in outdoor place, damp area and keep away from direct sunlight, dust and direct water splashing. This could cause product malfunctioning.
- For optimum performance of product, installation condition should be followed as per page no. 18.

- Unplug the power plug during thunder or lightning or when not in use for more than 2 days. This could cause product malfunctioning.
- Immediately unplug the power plug and contact LG Electronics service center if you detect any abnormal noise, odour or smoke.

Operation

- Replace the filter with a LG standard filter periodically according to the replacement period. Older filters can multiply bacteria or change the taste of the water. The filter replacement period varies according to the usage, place of usage, season and water quality.

Remarks: Filter to be changed by authorized LG Service personnel only.

- Do not place any article on water tray assembly except water glass. It may fall and cause damage & injury
- Take care against the possibility of damaging the pipe (inlet, outlet) in order to prevent water leakage. It may cause injury or damage to the product and property.

INSTALLATION

Parts and Function (For WW182/172 Series)

Front & Rear

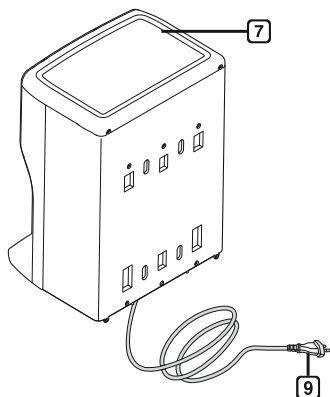
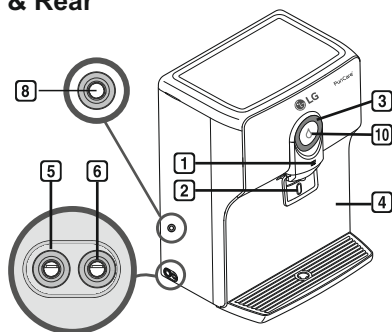

- | | | |
|----------------------------------|--|-----------------------------|
| 1 Purified water level indicator | 5 Water supply hose | 9 Power cord |
| 2 Touch Lever | 6 Drain hose | 10 Filter change indicator^ |
| 3 UV Sterilizing indicator* | 7 Top cover (Floral pattern*) | |
| 4 Filter cover (Floral pattern*) | 8 Cleaning water for fruits & veggies* | |

Accessories

Owner's Manual

Owner's Manual

Mounting Guide

Mounting Guide

Installation Guide

Installation Guide

QRG

Quick Reference Guide



6.35 mm Ø tube*



6.35 mm valve*

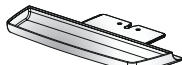

Water Tray



Water Tray Cover

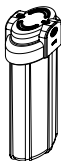

Out sediment filter with anti scalant module

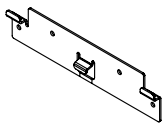

Mount plate (2 nos.)

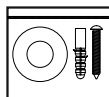

Screw kit : Screw (6 nos.)
Anchor (6 nos.) &
Teflon Tape (1 roll)

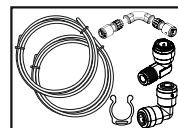

Hose assembly :
Hose (2 nos.)
Connectors (3 nos.)
lockers (2 nos.)
Connector Pipe (1 no.)

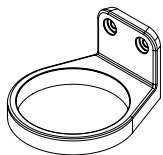

Mounting bracket

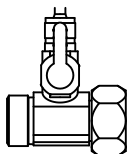

Adaptor

^ Applicable for Out-sediment filter
* For selected models only

INSTALLATION

Parts and Function (For WW151/140/130 Series)

Front & Rear

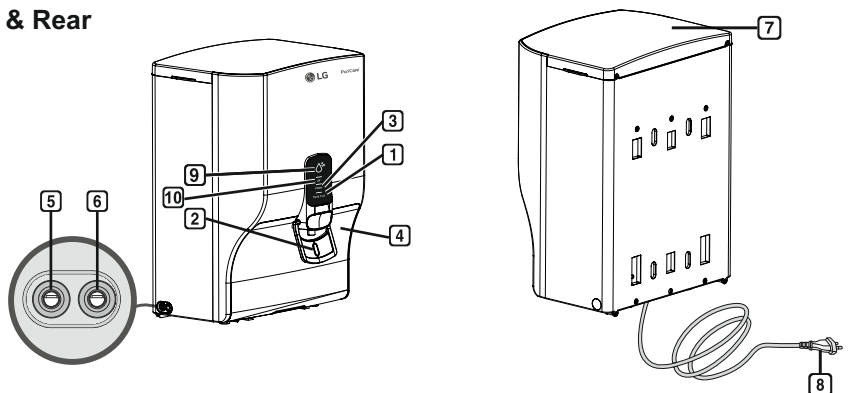

- | | | |
|-----------------------|---------------------|--|
| 1 Tank full indicator | 5 Water supply hose | 9 Filter change indicator [^] |
| 2 Touch Lever | 6 Drain hose | 10 UV Indicator* |
| 3 Power Indicator | 7 Top cover | |
| 4 Filter cover | 8 Power cord | |

Accessories

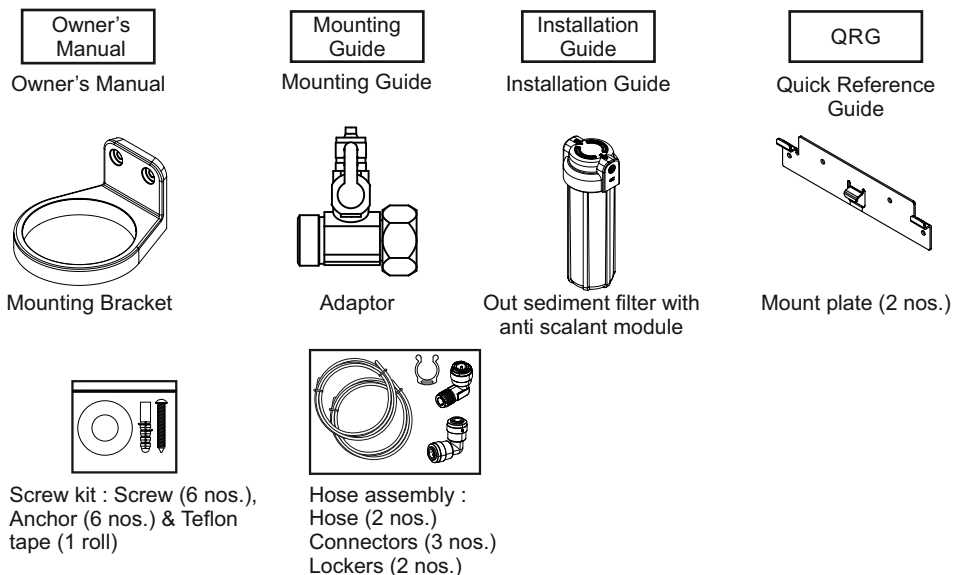

[^] Applicable for Out-sediment filter

* For selected models only

Notes for Installation

- Keep a distance of 10cm from all sides of the product.
- When connecting the water hose, do not connect it to the hot water pipe. Doing so may cause malfunctions.
- Check the pipe and hose connections for leaks. Water can leak and cause electric shock or injury.
- When transporting the product, do not tilt the product over 30 degrees. Doing so can cause malfunctions.
- For best usage of product, it is recommended to have surrounding temperature range of (4°C to 45°C). Not doing so can cause product malfunctioning.
- Avoid installing the water purifier in a place with a non-leveled horizontal surface, relative humidity of >85%, direct sunlight, dust and direct water splashing.
- Model no's WW151NP, WW140NP and WW130NP can only be wall mounted.
- Height between immediate Water reservoir tank to Water purifier inlet should be more than 1 meter for effective working of the product.



Important Note: All models can only be installed with water supply from overhead storage tank. No other water supply should be used for installation of these models.

Installing water purifier

- 1 Connect the product hoses as shown below.
 - Connect the white (water supply) hose to tap water.
 - Install the blue (drain) hose on the sink.

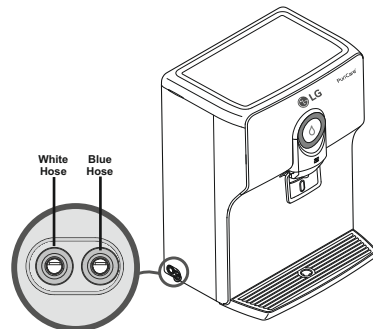

- 2 Connect the power cord to an appropriate socket.
- 3 Open the water supply valve.
- 4 After installation, discharge water for the first time when water tank is full. Same process is to be followed after every filter change or digital sterilization. Approximate time taken to fill the tank to the fullest is 1 hour, depending on water pressure, temperature etc.

⚠ CAUTION

Handle all packaging materials (such as plastic bags and thermocol) to keep away from children. The packaging materials can cause suffocation.

OPERATION

Notes for Operation

- Open the water supply valve. The water purifier operates normally only when water is supplied properly.
- It is very important to replace the filter periodically in order to drink clean water. When using an expired filter, the performance of water filtration system can deteriorate. Always abide by the filter replacement period.
- If product has not been used for 2 or more days, discharge the stored water from water purifier tank.
- Do not use purified water for replacing water in the humidifier or fishbowl.
- Use the product only after closing the product cover completely. Otherwise, insects or other foreign substance may get in.

Note

- The reverse osmosis contains a replaceable treatment component critical for the effective reduction of total dissolved solids and that product water shall be tested periodically (during service engineer visit) to verify that the system is performing properly.
- Do not use with water that is microbiologically unsafe or of unknown quality, without adequate disinfection before or after the system.

Suggestion for energy saving

- If the product will not be used for 2 or more days, unplug the power plug and drain the water inside of water filtration system completely.

* For selected models only

Using Control Panel

(For WW182/172 Series)

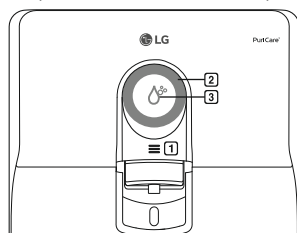

(For WW151/140/130 Series)

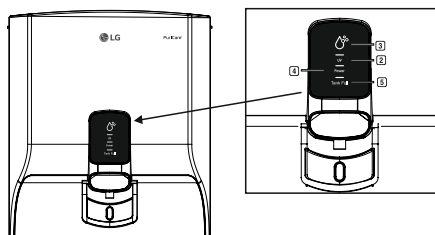

1 Water level indicator

The water level of the storage tank is displayed in 3 levels.

- The icon is divided into 3 levels according to the water level, and as more indication Light turn on, The water level becomes higher.

However, The water level cannot be adjusted discretionally.



2 UV Sterilizing indicator*

Purified water is sterilized by the UV LED. Blue color indicates that UV sterilization is ON & white color indicates that UV sterilization is OFF.

For WW151NP, UV indicator will glow. (When tank cover is open, UV LED will be automatically turned OFF for your safety.)

NOTE

The UV LED operates in any of the following 2 cases.

- It operates for 75 minutes in every 6 hours.
- It operates for 75 minutes after approximately 2 seconds when power is turned on following a power failure.

3 Filter Change indicator*^A



When the color of indicator changes from blue to amber, this indicates that it is time for preventive maintenance service. Please call LG customer care for service.

4 Power indicator*



The Power LED glows to indicate ON condition of Water Purifier.

5 Tank Full Indicator*



When the water storage tank gets filled up completely then Tank full indicator will turn ON.

Operation

Using purified water

When you press the touch lever, purified water will come out.

NOTE

If you wish to discharge continuously, lift the touch lever upward.

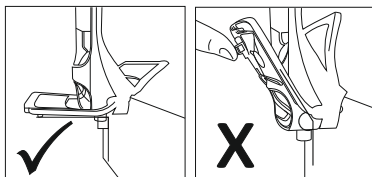
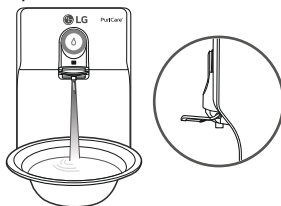

Caution : Open this lever to 90° only.*

*Opening more than 90° may cause it to malfunction/damage.

Using the fruit & vegetable cleaning water*

Open the valve. You can rinse fruits and vegetables, wash dishes.

The function discharges water while the valve is opened.

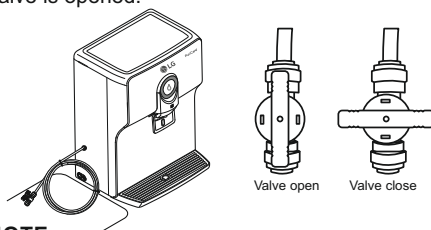

NOTE

Do not use this water for drinking and cooking.

Important note for all models:

All models of water purifier comes with a unique flow sensor (To protect the product from running without water supply) which turns on only if there is running water supply to water purifier. If no/lower water supply than specified limit is available, then water purifier will stop for 15 minutes and later, runs again for few seconds to check water supply.

If water supply is detected, then water purifier will work normally otherwise it will repeat to check cycle again. If water supply is available & you want to start water purifier immediately, just turn off the power supply and wait until the Display gets turned off, and turn on the power again.

^A Applicable for Out Sediment filter

* For selected models only

MANAGEMENT

Cleaning

How to clean the storage tank

- 1 Close the water supply valve.

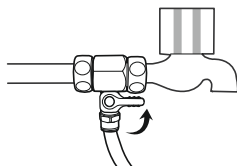

- 2 Drain water inside the storage tank completely using the drain hose and the water outlet.

(For WW182/172 Series)

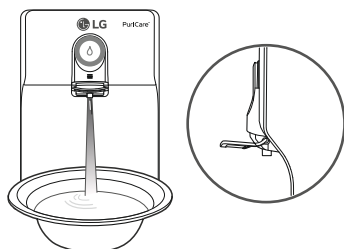

(For WW151/140/130 Series)

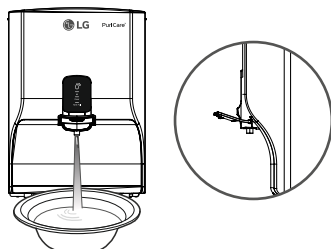

- 3 Unplug the power cord.
 - 4 Open the top cover by lifting it upward, and then unlock the storage tank cover.
- ⚠ CAUTION:** Handle with care, sharp edges may cause injury.

(For WW182/172 Series)

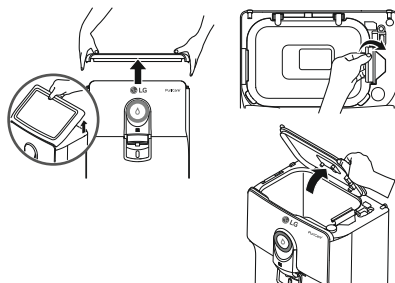

(For WW151/140/130 Series)

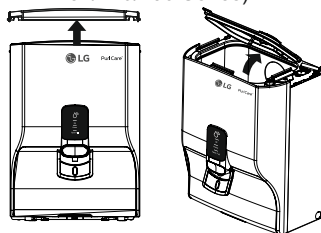

⚠ CAUTION : Do not put pressure or weight on tank cover, it may cause damage or injury.

- 5 Wipe the surface of the storage tank with soft clean cloth.

⚠ CAUTION : Avoid touching any interconnecting part inside water tank. it may cause damage to the product.

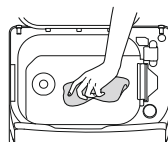

- 6 Rinse the storage tank with purified water and drain the water completely.

⚠ WARNING : Take care of water spattering, it may cause electric shock.

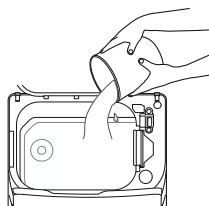

- 7 Insert and lock the storage tank cover.

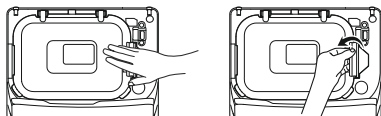

- 8 Close the top cover, plug in the power cord and open the water supply valve.

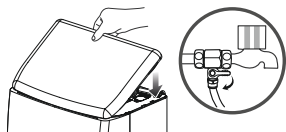

- 9 After installation, filter change or digital sterilization when tank is full, discharge water for the first time. (approximately time taken to fill the tank to fullest is 1 hour, depending on water pressure, temp etc)

NOTE

- **⚠ WARNING:** Unplug the power cord when cleaning the storage tank. It may cause electric shock.
- **⚠ CAUTION:** Clean the tank by only using purified water. Do not use chemical or detergent for cleaning the storage tank. Chemical or detergent will not be washed away completely, it can be harmful to the human body.

How to clean water outlet

- 1 Clean the water outlet periodically using a soft clean brush. Fur or foreign substances may accumulate in the water outlet.

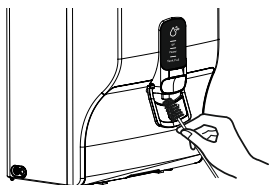

* For selected models only.

How to clean water tray assembly

- 1 Separate the Water tray cover by pulling it upwards.

⚠ CAUTION: Handle with care, sharp edges may cause injury.

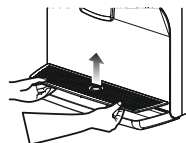

- 2 Separate the Water tray cover by pulling it forward.

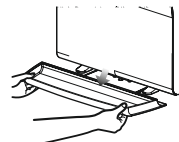

- 3 Clean it with water.

- 4 Wipe the surface of the water tray with a soft clean cloth.

- 5 Install the water tray on the product.

- 6 Place the Water tray cover on the water tray adhere it to the front side of the product closely, and gently push it to install.

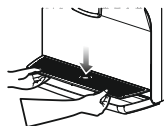

NOTE

- Caution should be taken. If a large amount of water is in the water tray, water can spill out when separating the water tray.
- Note-** Clean the water tray assembly periodically.

Maintaining the filter Process of Purification

Drinking Water

Step 1:

Out sediment filter with anti scalant module

- Removes big particles, rust stains, mud etc. and reduces input water hardness to enhance filter life.

Step 2:

Sedi + Carbon filter

- Removes unseen dregs and other contamination & removes invisible fine particles, residual chlorine, VOC (Volatile Organic Compounds) etc.

Step 3:

RO membrane filter* / RO recovery plus*

- Removes dissolved impurities and removes heavy metals, bacteria, viruses, VOC etc. from water.
- TDS Reduction upto 90% ppm of Source Water.

Step 4:

(For WW130 model)

Post-carbon filter

- Removes odour & improves taste of water.

(For WW140/151/182/172 models)

Mineral booster filter

- Removes odour, add minerals in the purified water without mixing impure water.

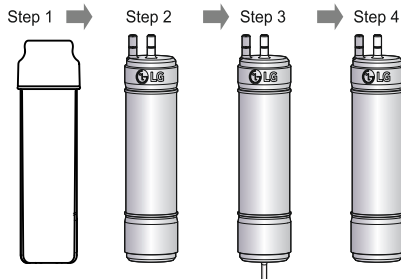

Cleaning water for fruits & veggies*

(Only with WW182EP)

Step 1:

Out sediment Filter with antiscalant module.

- Removes big particles, rust stains, mud etc. and reduces input water hardness to enhance filter life.

Step 2:

UF membrane filter*

- Removes only bacteria and fine particle substance.

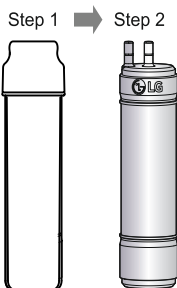

NOTE

- Do not use water drained from the product for drinking or cooking.
- Use the water instead for cleaning the bathroom and house, gardening or for other various purposes.
- Activated carbon inside the filter may sometimes flow in the storage tank. If so, a fine powder of activated carbon used in the post-carbon filter has come out, and it is harmless to the human body. If found, drain out the water from tank completely.

* For selected models only.

** As per LGEIL standard.

Anti-scalant module is applicable with out sediment filter only for WW130/140/151/182/172 models.

Filter replacement period

The filter replacement period refers to the period that the purification performance of the filter is maintained. And, the replacement period is lesser in the case of a place with poor water quality or a large purification amount.

Filter name	Recommended purification amount**(in litres)
Out sediment filter	3000
Anti scalant module#	6000 #
Sedi + Carbon filter*	6000
RO Membrane filter*	6000
RO Recovery Plus*	6000
Post-carbon filter*	6000
Mineral booster filter*	6000
UF membrane filter*	6000

NOTE

- If you wish to replace the filter, contact LG Electronics service centre.
- After replacing the filter, check if there is a leak from the product.
- After installation, discharge water for the first time when water tank is full. Same process is to be followed after every filter change or digital sterilization. Approximate time taken to fill the tank to the fullest is 1 hour, depending on water pressure, temperature etc.
- For RO Membrane Filter, around 25% of supplied water (based on the tap water pressure of 3.5 kgf/cm² at water temp. of 25°C) will be purified. While for RO Recovery Plus, around 50% of supplied water (based on the tap water pressure of 1.5kgf/cm², 750ppm TDS at water temp. of 25°C) will be purified and remainder will be drained.
- **▲ CAUTION** : Outsediment filter may get choked in abnormal turbidity (Sand & mud) condition, it is suggested to switch ON water purifier after 1-2 hour of overhead tank filling so that sand/mud will get settled. Outsediment filter should be cleaned regularly to prevent choking in above condition for better performance.

TROUBLESHOOTING

Symptoms	Reason	Solution
Water tastes strange	Have you left the water purifier for a period of 2 or more days without using it?	<ul style="list-style-type: none"> The taste of water may change as it ages. Contact LG Service. Use the water purifier after discharging the tank one time in case issue persists please contact LG service.
	Has it been a long time since you installed and replaced the filter?	<ul style="list-style-type: none"> If an expired filter is used, the purification performance may decline. It is recommended to replace the filter according to the filter replacement period.
The purification amount has reduced suddenly.	Is it time to replace the filter?	<ul style="list-style-type: none"> Request for filter replacement.
	Is the water supply valve closed?	<ul style="list-style-type: none"> Open the water supply valve.
Water does not come out.	Did you miss the filter replacement period?	<ul style="list-style-type: none"> Request filter replacement.
	Is the water supply valve closed?	<ul style="list-style-type: none"> Open the water supply valve.
	Is the power plug unplugged from the outlet?	<ul style="list-style-type: none"> Plug the power plug in the outlet correctly.
	Does water not come out when you press the discharge lever?	<ul style="list-style-type: none"> Contact LG Electronics service centre.
The product is noisy and generates abnormal sounds.	Is the product installed on a weak floor or not installed on a stable surface?	<ul style="list-style-type: none"> Install the product in a place with horizontally leveled surface.
	Is an article placed on top of the product?	<ul style="list-style-type: none"> Remove the article placed on top of the product.
Fine particles occur in the purified water.	Did water bubbles form?	<ul style="list-style-type: none"> Water bubbles may form in the draining process. It is safe for you to drink. If fine particles exist continuously after you receive water from the water purifier and several minutes have passed, cut off the tap water supply and power supply and contact LG Electronics service centre.

WATER PIPING DIAGRAM

WW182EP

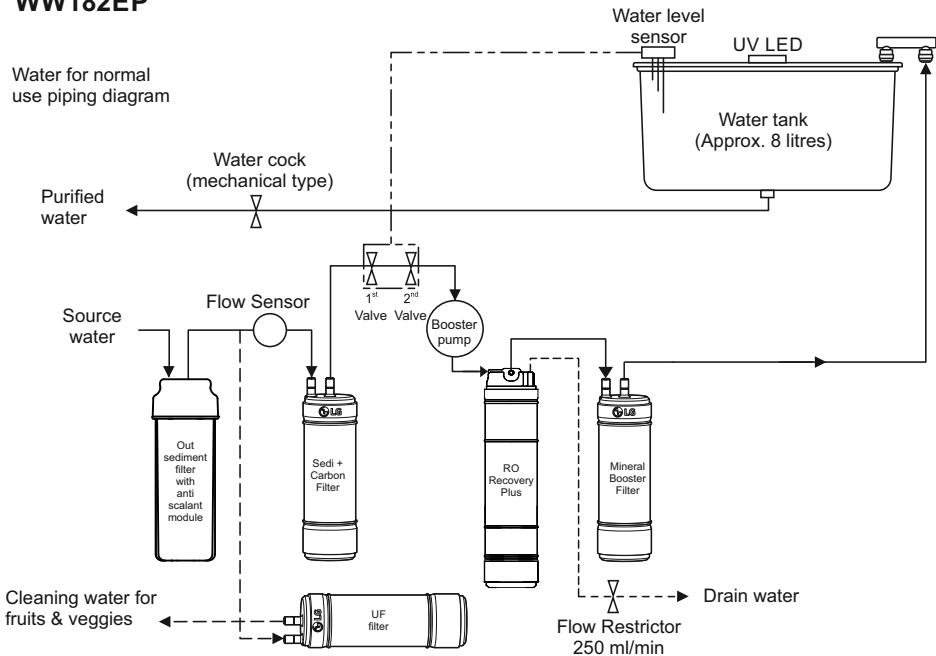

Electrolysis Sterilizing Care Water piping diagram

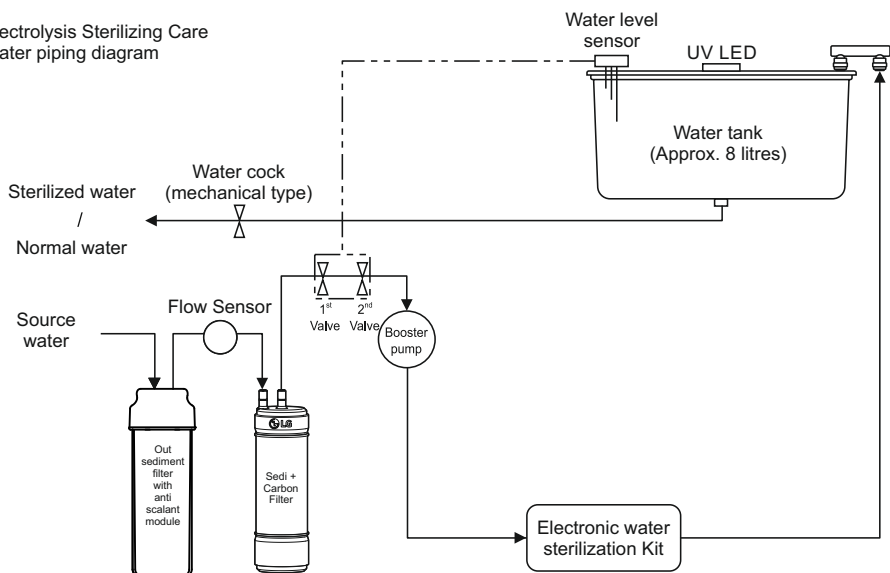

WW172EP

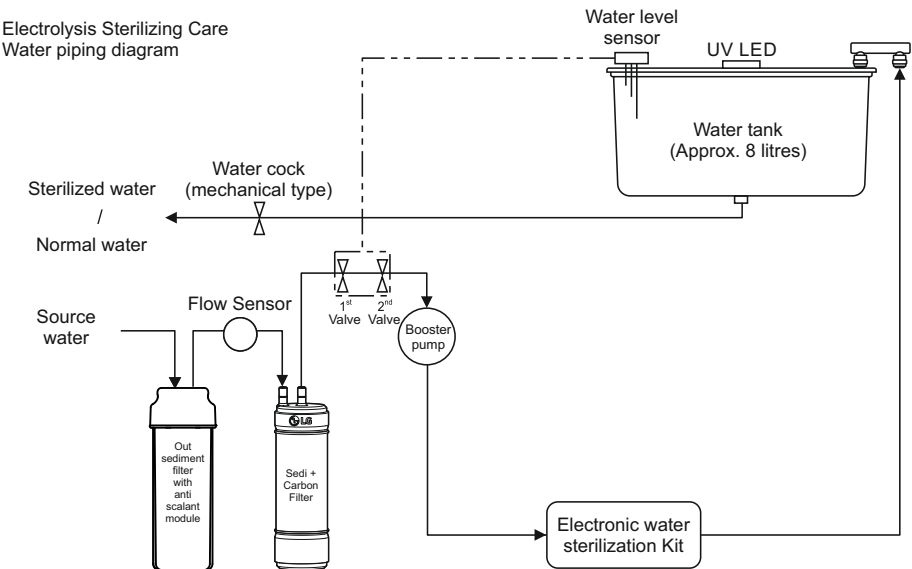
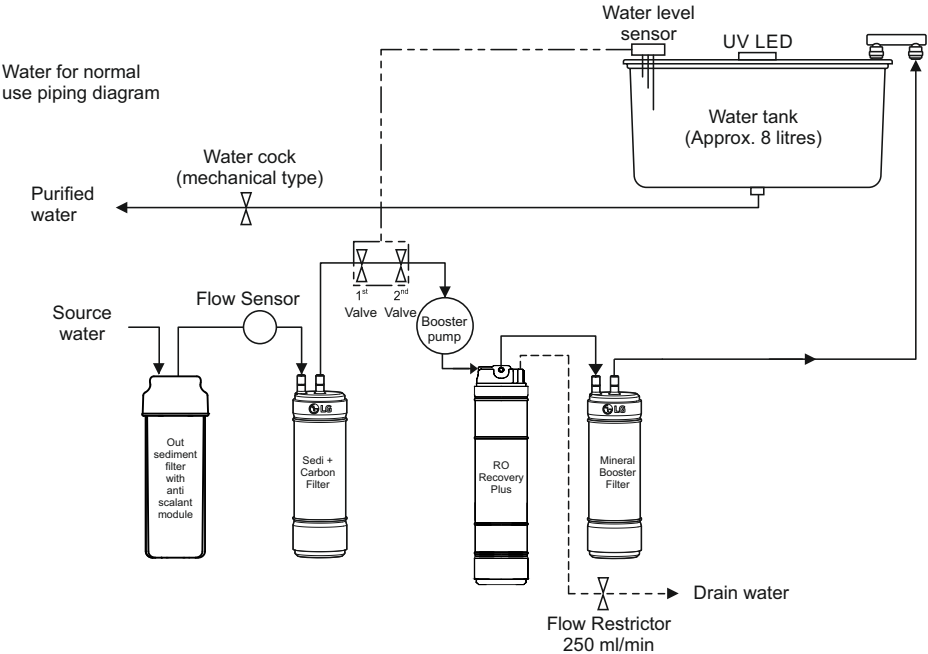

WW151NP/WW140NP/WW130NP

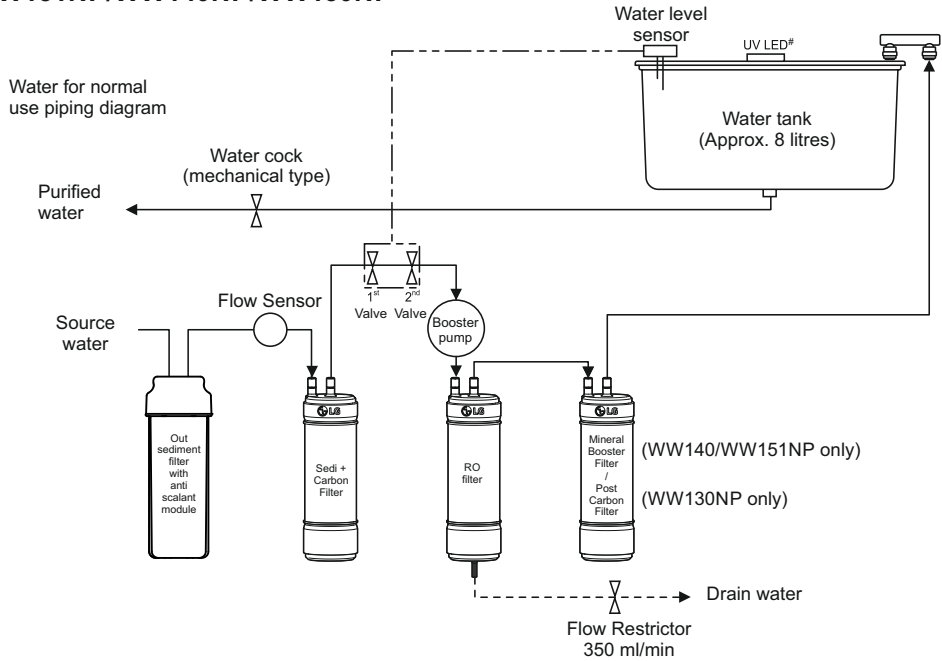

Electrolysis Sterilizing Care
Water piping diagram

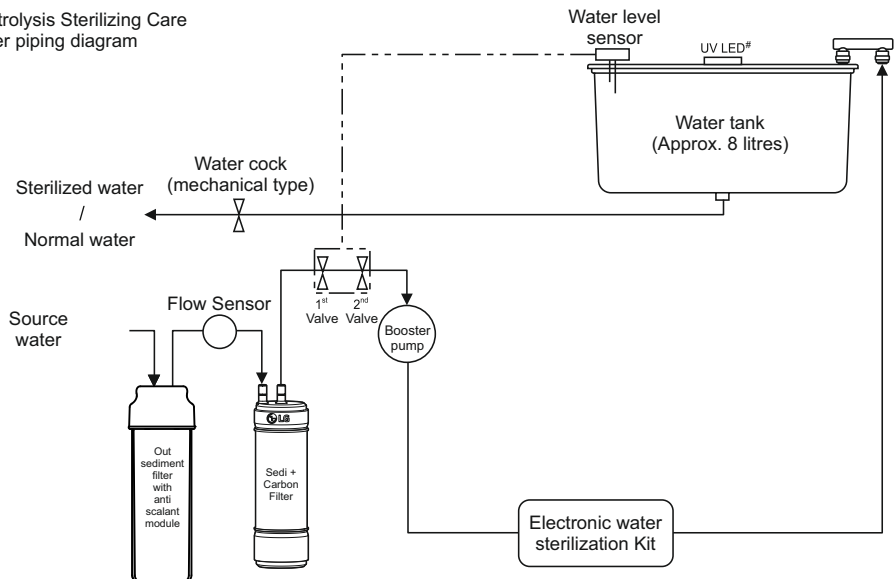

UV LED is only applicable for WW151NP

PRODUCT SPECIFICATION

Model name		WW182EP	WW172EP	WW151NP	WW140NP	WW130NP
Purification Method	Drinking Water	Reverse Osmosis	Reverse Osmosis	Reverse Osmosis	Reverse Osmosis	Reverse Osmosis
	Fruit & Vegetable cleaning water	Ultra-filtration	-	-	-	-
UV Sterilization		Yes	Yes	Yes	-	-
Rated Voltage		230 V - 50 Hz				
Power Rating		Water purifying : 40W				
Volume of Tank		Approx. 8 litres				
Filter Material	Out Sediment Filter* and Anti scalant module	Polypropylene Module Polyphosphate module				
	Sedi + Carbon Filter*	Polypropylene Module + Activated Carbon				
	RO Membrane Filter* RO Recovery Plus*	Polysulfone + Polyamide				
	Post Carbon Filter*	Activated Carbon				
	Mineral Booster Filter*	Activated Carbon + Mineral Booster				
	UF Membrane Filter*	Polysulfone				
Dimension		365mm (W) x 295mm (D) x 500mm (H) / without water tray : 365mm (W) x 275mm (D) x 500mm (H)		365mm (W) x 283mm (D) x 506mm (H)		
Net Weight		10.5 kg	10 kg	9.2 kg		
Installation water pressure limit		10-860kPa (0.1-8.8 kgf/cm²)				
Internal Operating Pressure		Min. 140kPa (Avg. 680kPa) (Before filtration)				
		Recommended input water quality				
Total Dissolved Solids (TDS)		≤2000 ppm				
Total Hardness		≤425 ppm				
Turbidity		≤5 NTU				

* For selected models only.

Customer Care : 09678-545454

