



OWNER'S MANUAL

AIR CONDITIONER



Read this owner's manual thoroughly before operating the appliance and keep it handy for reference at all times.

ENGLISH

Ventilator

TABLE OF CONTENTS

This manual may contain images or content that may be different from the model you purchased.
This manual is subject to revision by the manufacturer.

SAFETY INSTRUCTIONS

- READ ALL INSTRUCTIONS BEFORE USE 4**
 - Safety Messages.....4
- WARNING 4**
 - Installation4
 - Operation6
- CAUTION..... 7**
 - Installation7
 - Operation8

OPERATION

- Prior to Operation 10**
 - Preparing for Operation.....10
 - Usage10
 - Cleaning and Maintenance10
 - Service10
- Introduction..... 11**
 - Introduction11
- Characteristics..... 12**
 - Ventilation via Total Heat Exchanger.....12
 - Normal Ventilation.....13
 - Humidifier Process.....13
- Operating Instructions(Accessory) 14**
 - Name and fuction of remote controller14

Maintenance

- Maintenance and Service 16**
 - Method to disassemble each part.....16
 - Method to Clean and Replace Each Part17
 - Assembly and Check after Maintenance18
 - Replacement of the Humidifier19
- Humidifier Maintenance 22**
 - Inspection and Maintenance of the Humidifier22

Replacing the Humidifier element	22
Maintenance Cycle	22
Check Item Prior to notify a failure	23
Check Item Prior to notify a failure	23

SAFETY INSTRUCTIONS

READ ALL INSTRUCTIONS BEFORE USE

The following safety guidelines are intended to prevent unforeseen risks or damage from unsafe or incorrect operation of the appliance.

The guidelines are separated into 'WARNING' and 'CAUTION' as described below.

Safety Messages



This symbol is displayed to indicate matters and operations that can cause risk.
Read the part with this symbol carefully and follow the instructions in order to avoid risk.



WARNING

This indicates that the failure to follow the instructions can cause serious injury or death.



CAUTION

This indicates that the failure to follow the instructions can cause the minor injury or damage to the product.

WARNING

Installation

- Do not use a defective or underrated circuit breaker. Use this appliance on a dedicated circuit.
 - There is risk of fire or electric shock.
- For electrical work, contact the dealer, seller, a qualified electrician, or an Authorized Service Center.
 - Do not disassemble or repair the product. There is risk of fire or electric shock.
- Always ground the product.
 - There is risk of fire or electric shock.

- Install the panel and the cover of control box securely.
 - There is risk of fire or electric shock.
- Always install a dedicated circuit and breaker.
 - Improper wiring or installation may cause fire or electric shock.
- Use the correctly rated breaker or fuse.
 - There is risk of fire or electric shock.
- Do not modify or extend the power cable.
 - There is risk of fire or electric shock.
- Do not install, remove, or re-install the unit by yourself(customer).
 - There is risk of fire, electric shock, explosion, or injury.
- Be cautious when unpacking and installing the product.
 - Sharp edges could cause injury. Be especially careful of the case edges and the fins on the condenser and evaporator.
- For installation, always contact the dealer or an Authorized Service Center.
 - There is risk of fire, electric shock, explosion, or injury.
- Do not install the product on a defective installation stand.
 - It may cause injury, accident, or damage to the product.
- Do not let the ventilator run for a long time when the humidity is very high and a door or a window is left open.
 - Moisture may condense and wet or damage furniture.
- For re-installation of the installed product, always contact the dealer or an Authorized Service Center.
 - There is risk of fire, electric shock, explosion or injury.
- Do not open the maintenance cover of the main body during operation.
 - Otherwise, it may cause electrical shock.
- Use the outdoor air suction hole with the net installed to ensure that birds could not come in.
 - Remove estrange things like the bird's nest. Otherwise, it may cause scarcity of indoor oxygen.

- Install the air intake where polluted air can not be directly sucked in.
 - It may cause various accidents, including suffocation, due to the suction of harmful gasses(CO, etc.)
- Install the product a place that can support its weight.
 - Otherwise, it may cause accident due to falling of the product.
- An appliance is intended to be permanently connected to the water mains and not connected by a hose-set.
- The appliance shall be installed in accordance with the national wiring regulation.

Operation

- Take care to ensure that power cable could not be pulled out or damaged during operation.
 - There is risk of fire or electric shock.
- Do not place anything on the power cable.
 - There is risk of fire or electric shock.
- Do not touch(operate) the product with wet hands.
 - There is risk of fire or electrical shock.
- Do not place a heater or other appliances near the power cable.
 - There is risk of fire and electric shock.
- Do not allow water to run into electric parts.
 - It may cause There is risk of fire, failure of the product, or electric shock.
- Do not store or use flammable gas or combustibles near the product.
 - There is risk of fire or failure of product.
- When flammable gas leaks, turn off the gas and open a window for ventilation before turn the product on.
 - Do not use the telephone or turn switches on or off. There is risk of explosion or fire.
- If strange sounds, or smell or smoke comes from product. Turn the breaker off.

- There is risk of electric shock or fire.
- Stop operation and close the window in storm or hurricane. If possible, remove the product from the window before the hurricane arrives.
 - There is risk of property damage, failure of product, or electric shock.
- When the product is soaked (flooded or submerged), contact an Authorized Service Center.
 - There is risk of fire or electric shock.
- Be cautious that water could not enter the product.
 - There is risk of fire, electric shock, or product damage.
- Turn the breaker off when cleaning or maintaining the product.
 - There is risk of electric shock.
- Avoid fire equipment.
 - There is risk of fire.
- Don't touch a dedicated circuit or breaker with wet hands.
 - There is risk of electric shock.
- Use a firm stool or ladder when cleaning or maintaining the product.
 - Be careful and avoid personal injury.
- This appliance is not intended to be accessible to the general public.
- The appliance shall be disconnected from its power source during service and when replacing parts.
- If the supply cord is damaged, it must be replaced by the manufacturer, its service agent or similarly qualified persons in order to avoid a hazard.
- Ensure that the fan is switched off from the supply mains before removing the guard.

CAUTION

Installation

- Use two or more people to lift and transport the product.

- Avoid personal injury.
- Do not install the product where it will be exposed to sea wind (salt spray) directly.
 - It may cause corrosion on the product. Corrosion, particularly on the condenser and evaporator fins, could cause product malfunction or inefficient operation.
- Do not install the ventilation unit alone for controlling room temperature.
 - If this is needed, install with another Indoor unit (air conditioner).
- If anyone other than a licensed Professional installs, repairs, or alters LG Electronics Air Conditioning Products, the warranty is voided.
 - All costs associated with repair are then the full responsibility of the owner.
- Do not install the unit in potentially explosive atmospheres.

Operation

- Do not expose the skin directly to cool air for long periods of time.(Don't sit in the draft.)
 - This could harm to your health.
- Do not use the product for special purposes, such as preserving foods, works of art, etc. It is a consumer ventilator, not a precision refrigeration system.
 - There is risk of damage or loss of property.
- Use a soft cloth to clean. Do not use harsh detergents, solvents, etc.
 - There is risk of fire, electric shock, or damage to the plastic parts of the product.
- Do not step on or put anything on the product.(outdoor units)
 - There is risk of personal injury and failure of product.
- Use a firm stool or ladder when cleaning or maintaining the product.
 - Be careful and avoid personal injury.
- Wear adequate personal protection equipment (PPE) when installing, maintaining or servicing the product.

- This appliance can be used by children aged from 8 years and above and persons with reduced physical, sensory or mental capabilities or lack of experience and knowledge if they have been given supervision or instruction concerning use of the appliance in a safe way and understand the hazards involved. Children shall not play with the appliance. Cleaning and user maintenance shall not be made by children without supervision.
- This appliance is not intended for use by persons (including children) with reduced physical, sensory or mental capabilities or lack of experience and knowledge, unless they have been given supervision or instruction concerning use of the appliance by a person responsible for their safety. Children should be supervised to ensure that they do not play with the appliance.

OPERATION

Prior to Operation

Preparing for Operation

- Contact an installation specialist for installation.
- Use a dedicated circuit.
- Do not use an extension cord.
- If the cord/plug is damaged, replace it with only an authorized replacement part.

Usage

- Being exposed to direct airflow for an extended period of time could be hazardous to your health. Do not expose occupants, pets, or plants to direct airflow for extended periods of time.
- Due to the possibility of oxygen deficiency, ventilate the room when used together with stoves or other heating devices.
- Do not use this ventilator for non-specified special purposes (e.g. preserving precision devices, food, pets, plants, and art objects). Such usage could damage the items.
- This unit cannot control room temperature. If this is needed, do not install the ventilation unit alone, but rather install another indoor unit.

Cleaning and Maintenance

- Do not touch the metal parts of the unit when removing the filter. Injuries can occur when handling sharp metal edges.
- Do not use water to clean inside the ventilator. Exposure to water can destroy the insulation, leading to possible electric shock.
- When cleaning the unit, first make sure that the power and breaker are turned off. The fan rotates at a very high speed during operation. There is a possibility of injury if the unit's power is accidentally triggered on while cleaning inner parts of the unit.

Service

- For repair and maintenance, contact your authorized service dealer.

Introduction

Introduction

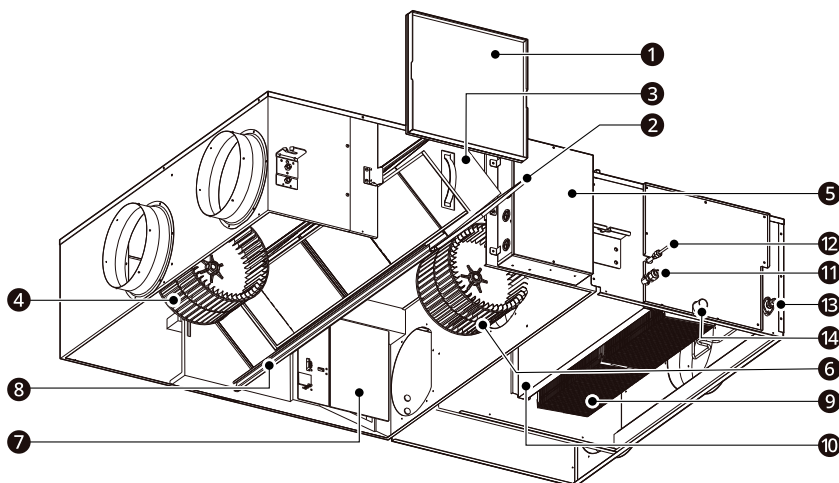

1 Maintenance cover

2 Air Filter

Prevents clogging of the Total heat exchanger due to dust.

3 Total Heat Exchanger

Exchanges temperature and moisture between supply air and exhaust air.

4 Blower for Exhaust Air

A blower for draining polluted air outside.

5 Electronic Parts Box (Control box)

6 Blower for Supply Air

A blower for induction outside air.

7 Bypass Damper

Converts the ventilation via Total heat exchange to the normal ventilation.

8 Holder for Total Heat Exchanger

Used for installation guide of the Total heat exchanger.

9 Humidifier Element

10 Direct expansion coil (DX Coil)

11 Gas pipe connection (Ø12.7)

12 Liquid pipe connection (Ø6.35)

13 Feed water connection port (Ø6.35)

14 Drain outlet (Ø25.4)

12 OPERATION

NOTE

- Optional filter(ISO ePM1 75 %) is available. It is sold separately.
-

Characteristics

Ventilation via Total Heat Exchanger

Exhausts indoor air via the Total Heat Exchanger outdoor.

- The outdoor air heat exchanged is supplied to indoor. Operate the ventilator in the **Ventilation via Total heat exchanger** in summer/winter when cool/heat operation is done.

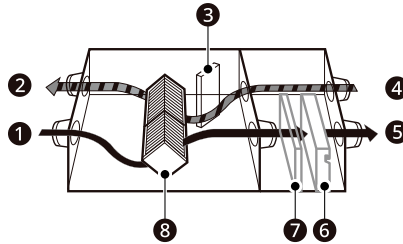

- ① Outdoor air
- ② Exhaust air
- ③ Damper
- ④ Return air
- ⑤ Supply air
- ⑥ Humidifier Element
- ⑦ DX Coil
- ⑧ Total Heat Exchanger

Normal Ventilation

Exhausts the polluted indoor-air directly without via the Total Heat Exchanger.

- Operate the ventilator in the **Normal Ventilation** in spring/autumn when the Total heat exchanger is not required.

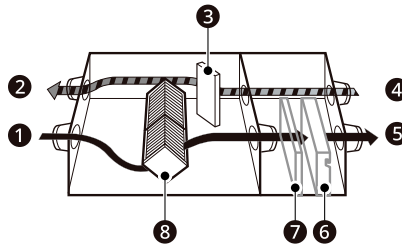

- ① Outdoor air
- ② Exhaust air
- ③ Damper
- ④ Return air
- ⑤ Supply air
- ⑥ Humidifier Element
- ⑦ DX Coil
- ⑧ Total Heat Exchanger

Humidifier Process

- Upon selection of heating mode, Humidifier Process is turned on automatically based on the humidification range set in the remote controller.
(Humidification range is the process to prevent excessive humidification, and when the humidity reaches maximum/minimum value set, humidification will be turned off/on.)
- When Manual Mode is selected, you can choose to turn on or off the Ventilation Only Mode and Heating Mode.
- Please refer to the remote controller manual for setting the humidification range and changing to Manual Mode.
- Such features are available only when the remote controller with humidity receiving function is used.
- The amount of humidification depend on the installation site, sealing, and other factors so it might not reach the maximum range.

⚠ CAUTION

- In case of high outdoor pollution degree like yellow sand please pause the ventilator.

Operating Instructions(Accessory)

Name and fuction of remote controller

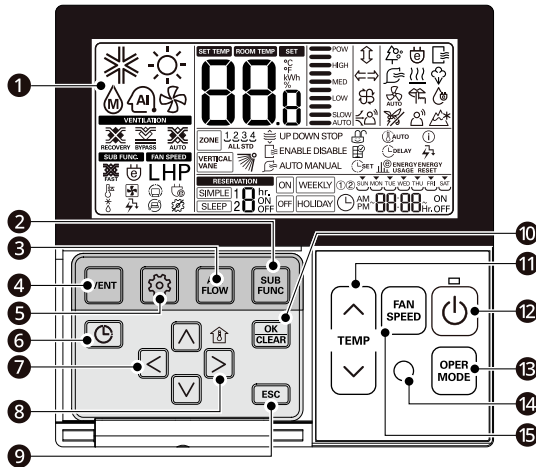

1 Operation Display Windows

Displays the status of operation and settings

2 Sub function Button

To select the additional operations function

3 Airflow Button

To select the airflows

4 Ventilation Button

For interlocking operations of air-conditioner and ventilator

5 Function Setting Button

To select the additional operations function

6 Reservation Button

To program the schedule

7 Up/Down/Left/Right Button

To change the settings in the menu

8 Room temperature Button

To check the indoor temperature

9 ESC Button

To exit from the menu

10 Set/Cancel Button

To save the settings in the menu

11 Temperature Control Button

To change the desired temperature

12 On/Off Button

To turn on/off with a remote controller

13 Operation Mode Selection Button

To select the operating mode

14 Wireless Remote Controller Receiver

15 Fan Speed Button

To select the fan speed

NOTE

- Some functions may not be operated and displayed depending on the product type.
- It will display strange value to the room temperature if wired remote controller is not connected.

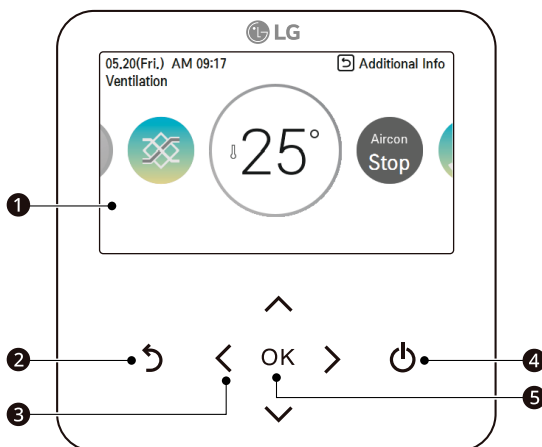

1 Operation display window

Operation and Settings status display

2 Back button

When you move to the previous stage from the menu's setting stage

3 Up/down/left/right button

When you change the menu's setting value

4 OK button

When you save the menu's setting value

5 On/Off button

When you turn ON/OFF the air conditioner

- Model: PREMTB100
- Some functions may not be operated and displayed depending on the product type. Refer to remote controller in order to know detail functions.

Maintenance

Maintenance and Service

Method to disassemble each part

To prevent function of the ventilator deteriorating, clean dust adhered to the air filter and total heat exchanger regularly.

Method to take each part out(Air filter, Total heat exchanger)

1 Remove the maintenance cover.

Loosen a screw on the maintenance cover. Put the hands inside of the ceiling from the maintenance cover, and pull the maintenance cover up.

(Looser the hinge and detach the maintenance cover.)

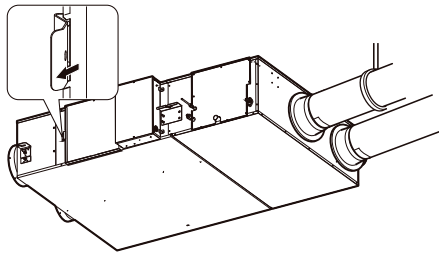

2 Take the air filter out.

Take the air filter with each contained to the left/right downside of the Total heat exchanger.

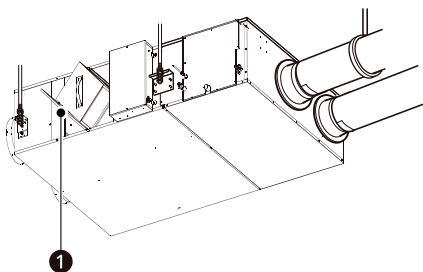

1 Air Filter

⚠ CAUTION

- Take care to ensure that you could not damage when taking the air filter out since there is a sharp part on it.
-

3 Take the Total heat exchanger out.

Catch the handle and then take the Total heat exchanger (2EA) out from the main body.(2 units)

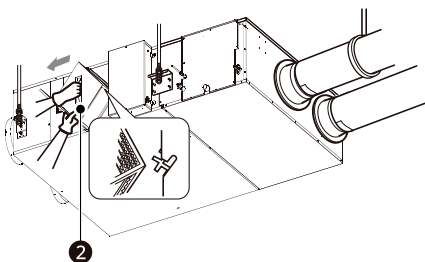

② Handle

⚠ WARNING

- Turn the breaker off when cleaning the product.

⚠ CAUTION

- Gloves should be worn when doing the maintenance work.

Method to Clean and Replace Each Part

1 Cleaning of Air Filter

- Clean dirt from the air filter using a vacuum cleaner or wash with water.
(if dirt is conspicuous, wash with a neutral detergent in lukewarm water)
- After washing with water, dry well in the shade.
(Do not expose the air filter to direct sunlight or heat from a fire when drying it)
- If the air filter is damaged, purchase it from the service center or professional agent.

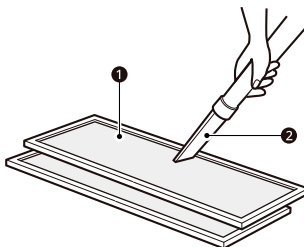

① Air Filter

② Cleaner

2 Cleaning of Total Heat Exchanger

Suck dusts adhered to the surface of the Total heat exchanger with a cleaner.

- Use the cleaner that attached to brush at its nozzle, and use a soft brush.
- Do not use a hard nozzle on the cleaner.
(Otherwise, surface of the Total heat exchanger may be damaged.)
- Never wash the Total heat exchanger with water.
- Replacement expenses are for a consideration after 2 years from the purchasing date.
- Expenses are for a consideration when you will contact the service center even within 2 years from the purchasing date.
- For service, always contact the dealer or an Authorized Service Center.

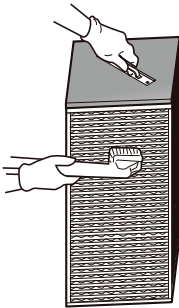

Air Filter



Total Heat Exchanger

Assembly and Check after Maintenance

1 Assembly of Total heat exchanger

Securely put the corner parts (4 parts) of the Total heat exchanger into the holder for assembly and slide them into the inside of the main body.

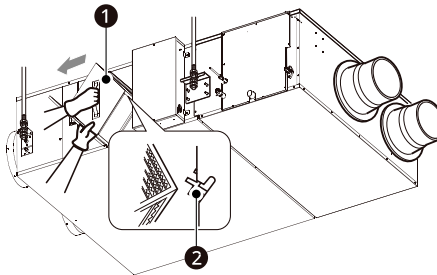

- 1 Total Heat Exchanger
- 2 Holder for Total Heat Exchanger

2 Assembly of air filter

Assemble the air filter into the holder structure of the Total heat exchanger.

- Take care to ensure that surface of the Total heat exchanger could not be damaged.
- Dusts adhered to the Total heat exchanger may cause deterioration of Air volume.

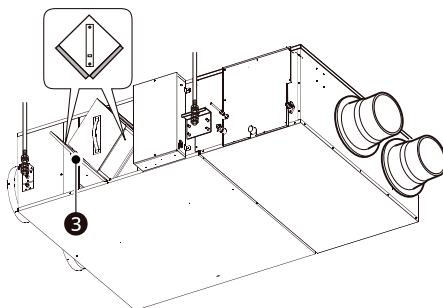

③ Air Filter

3 Assembly of maintenance cover

Fix the cover to the right hinge and fix it to the left side.(A nameplate is adhered toward the reading direction.)

Tighten a screw on the maintenance cover.

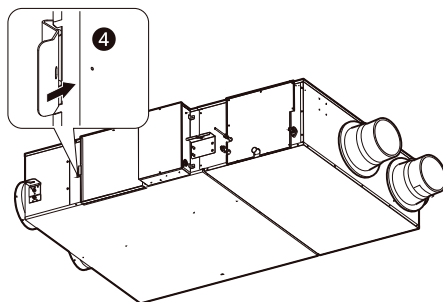

④ Hinge

⚠ WARNING

- Turn the breaker off when cleaning the product.

⚠ CAUTION

- Gloves should be worn when doing themaintenance work.

Replacement of the Humidifier

1 Remove the maintenance cover.

20 Maintenance

Loosen the screw (8EA) and detach the maintenance cover.

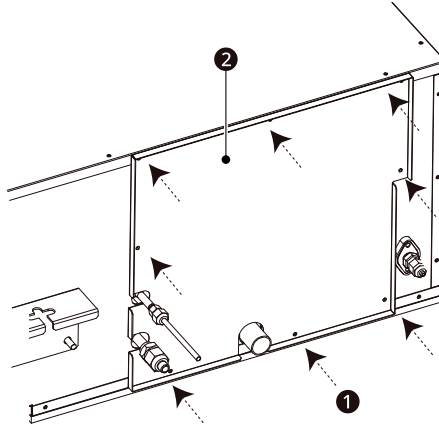

- ① Screw
- ② Maintenance Cover

2 Prepare to replace the Humidifier.

- Uncork the Drain Cap to drain the remaining water in the feed cistern.
- Loosen the screw (3EA) and detach the lid of feed cistern.
- Loosen the screw (1EA) and Detach the clamp.

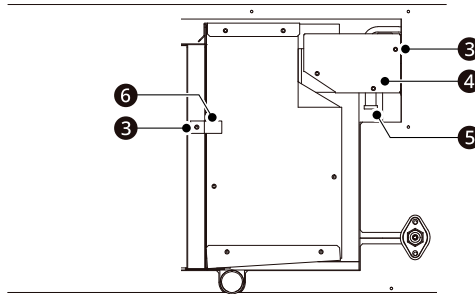

- ③ Screw
- ④ Lid of feed cistern
- ⑤ Drain Cap
- ⑥ Clamp

3 Pull out the Humidifier(2EA)

- Uncork the Drain Cap to drain the remaining water in the feed cistern.
- Loosen the screw (3EA) and detach the lid of feed cistern.

- Loosen the screw (1EA) and Detach the clamp.

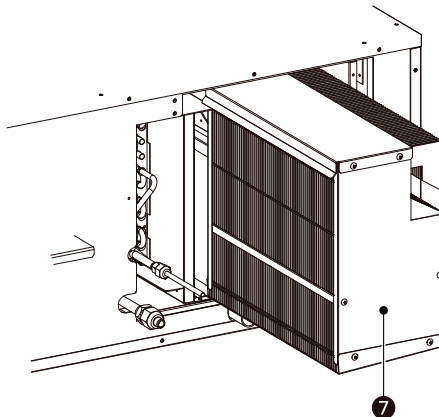

- 7 Humidifier

4 Insert the new Humidifier(2EA)

Confirm that the edge of top panel of humidifier element has been hooked securely on the rail. And assemble the lamp, rid of cistern and drain cap.

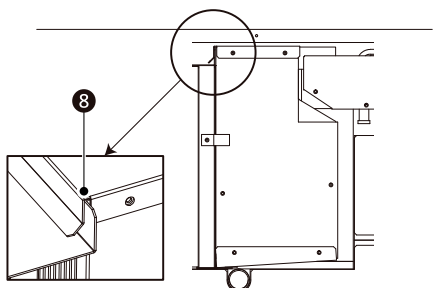

- 8 Rail

⚠ WARNING

- Turn the breaker off when cleaning the product.

⚠ CAUTION

- Gloves should be worn when doing the maintenance work.

Humidifier Maintenance

Inspection and Maintenance of the Humidifier

- Have your dealer do the following inspections in order to get the longest use.
- In order to prevent harmful bacteria from generating, ask your dealer to do maintenance on humidifying unit portion at the beginning or the end of the heating season.

Inspected Part	Content of Maintenance		Problems if maintenance is not carried out
	Items to be inspected	Solution	
Feed water tank	Check for operation of float switch	Clean if it does not work properly due to build-up.	Insufficient humidifying. Overflowed feed water tank.
	Check for dirt	Clean if very dirty.	Weak fan strength. Reduced humidifying capacity.
Solenoid valve	Check for shutting and opening. Check in a similar fashion when checking the float switch operation.	Replace if it doesn't work.	Insufficient humidifying. Overflowed feed water tank. (Increased tap water consumption.)

Replacing the Humidifier element

- 1) The humidifier element should in general be replaced once every three years when supply water is soft water, but outside factors (water quality, operating times) may shorten its productive life.
- 2) Contact your dealer if you have any questions.

NOTE

This note is only applied to model that there is humidity function.

When humidifying fails, the remote controller does not display any error code.

Just twinkle the icon of Humidification "💧" for 30 minutes and disappeared or display warning icon on the side of Humidification icon.

Usage under that status will lead to insufficient humidification and increased tap water consumption.

The solenoid valve and float switch should be checked at the beginning of heating season.

If the water purifier is not installed, foreign object may occur and can affect the lifespan of the humidifier and cause odor.

Maintenance Cycle

- **Recommended maintenance cycle of each part.**

Name of Part	Inspection cycle (Cleaning cycle)	Replacement Cycle
Air filter	0.5 year	3 years
Total Heat Exchanger	1 year	10 years
Humidifier Element	1 year	1~3 years

- This table indicates main parts.
- See the maintenance and inspection contract for details.
- This maintenance cycle indicates recommended lengths of time until the need arises for maintenance work, in order to ensure the product is operational as long as possible.
- Use for appropriate maintenance design.(budgeting maintenance and inspection fees, etc.)
- Life of humidifier element is about 3 years (4,000 hours), under the supply water conditions of hardness ; 150mg/l.
- Life of humidifier element is about 1 year (1,500 hours), under the supply water conditions of hardness ; 400mg/l.
- Annual operating hours : 10 hours/day x 26 days / month x 5 month = 1,300 hours.
- The cycle is not the same as the warranty period.

Check Item Prior to notify a failure

Check Item Prior to notify a failure

Symptom	Check Item	Counter-measure
The Product doesn't work	Is power not supplied?	Supply Power
The Product doesn't work through you press the 'ON' switch	Is the Indoor temperature less than 15 °C or more than 40 °C?	It's standby mode for protecting Total Heat Exchanger.
Even though you change the fan speed, the operation mode doesn't change and it changes to 'Auto or Low'	Is the Indoor temperature less than -10 °C or more than 45 °C?	It's operation mode to protect Total Heat Exchanger.
Even though you push the button of remote controller, any function doesn't work.	Is the icon "  " displaying on remote controller?	It's Child Lock mode. Refer to Remote controller.
	Is the icon displaying on remote controller? Does the message "HL" display on remote controller when you push the button.	It's centralized control mode. You can't control on remote controller.

Memo



Manufacturer :

LG Electronics Inc.

84, Wanam-ro, Seongsan-gu, Changwon-si, Gyeongsangnam-do, KOREA

UK Importer: LG Electronics U.K. Ltd

Velocity 2, Brooklands Drive, Weybridge, KT13 0SL

Eco design requirement

• The information for Eco design is available on the following free access website.

<https://www.lg.com/global/support/cedoc/cedoc>