



Scan the QR code to see the manual.



OWNER'S MANUAL

AIR PURIFIER



Before beginning installation, read these instructions carefully. This will simplify installation and ensure that the product is installed correctly and safely. Leave these instructions near the product after installation for future reference.

ENGLISH

AS35GGW10

TABLE OF CONTENTS

This manual may contain images or content that may be different from the model you purchased.
This manual is subject to revision by the manufacturer.

SAFETY INSTRUCTIONS

READ AND SAVE THESE INSTRUCTIONS 3
WARNING INSTRUCTIONS 3
CAUTION INSTRUCTIONS 7

OPERATION

Product Overviews 9
Preparation before Operation 11
Examining Features 14
Operating the Air Purifier 16
Using the Extra Functions 17
Overall Air Quality 18

SMART FUNCTIONS

LG ThinQ Application 19
Smart Diagnosis 20

MAINTENANCE

Maintaining the Product 21

TROUBLESHOOTING

Before Calling for Service 26

APPENDIX

Information 29

SAFETY INSTRUCTIONS

READ AND SAVE THESE INSTRUCTIONS

The following safety guidelines are intended to prevent unforeseen risks or damage from unsafe or incorrect operation of the appliance. The guidelines are separated into 'WARNING' and 'CAUTION' as described below.

Safety Messages



This symbol is displayed to indicate matters and operations that can cause risk.

Read the part with this symbol carefully and follow the instructions in order to avoid risk.



WARNING

This indicates that failure to follow the instructions can cause serious injury or death.



CAUTION

This indicates that failure to follow the instructions can cause minor injury or damage to the product.

WARNING INSTRUCTIONS

WARNING

- To reduce the risk of explosion, fire, death, electric shock, injury or scalding to persons when using this product, follow basic precautions, including the following:

Technical Safety

- This appliance is not intended for use by persons (including children) with reduced physical, sensory or mental capabilities or lack of experience and knowledge, unless they have been given supervision or instruction concerning use of the appliance by a person

responsible for their safety. Children should be supervised to ensure that they do not play with the appliance.

- The fan is not a toy. It should not be played with or placed where young children can reach it.
- If the supply cord is damaged, it must be replaced by the manufacturer, its service agent or similarly qualified person in order to avoid a hazard.
- Only an authorized repair person should disassemble, repair, or modify the appliance.
- Do not touch the power plug with wet hands.
- Do not place the power cord under rugs, carpeting or mats.
- Do not install and use broken parts.
- Do not continue to use the product if it is visibly damaged.
- The appliance is only to be used with the power supply unit provided with the appliance.
 - Failure to use the supplied power supply may result in reduced performance or failure of the product, and may result in safety hazards.
- The appliance must only be supplied at safety extra low voltage corresponding to the marking on the appliance.
- Be careful not to subject the power plug and adapter to shock.

Installation

- Do not install the appliance on an uneven or inclined surface.
- Do not install the appliance in an area exposed to direct sunlight or near heat-generating equipment.
- Do not install the product in a place where combustible gas may leak or industrial oil or metallic particulates are present.
- Do not allow the appliance to push against the power cord or plug.
- Do not bend the power cable excessively or place a heavy object on top of it.
- Do not extend the length of the power cable or alter it.

- Do not use several devices on a multi-socket extension outlet.
- Make the connection securely so that screw in terminals may not be loosened when the cable is pulled.
- Make sure that the power cable cannot be pulled out or damaged during operation.
- When unplugging the power cord, always pull it by the plug.
- Unplug the appliance during thunder or lightning storms or when not in use for a long time.

Operation

- If the appliance is immersed in water, stop using it and contact an LG Electronics Customer Information Center.
- If there is a gas leakage (isobutane, propane, LNG, etc.), do not touch the appliance or power plug and ventilate the area immediately.
- If you detect any abnormal noise, odor or smoke, unplug the appliance immediately and contact an LG Electronics Customer Information Center.
- Do not clean the appliance with brushes, cloths or sponges which are abrasive or made of metal.
- Do not use or store fire, combustibles (ether, benzene, alcohol, drugs, propane, butane, combustible spray, insecticide, air freshener, cosmetics, etc.) or flammable materials (candles, lamps, etc.) near the product.
- Do not allow animals or pets to chew on the power cord.
- Do not move the appliance when it is in operation.
- Do not hit the appliance.
- Do not insert hands or metal objects into the air inlet or outlet.
- Do not put flammables into the appliance.
- Do not move or operate the appliance while its cover is open.
- Do not allow children to climb on or play with the appliance.
- Do not place anything on top of the appliance.

Maintenance

- Dispose of the packing materials (vinyl, styrofoam, etc.) to keep them out of reach of children.
- Take care not to injure or pinch yourself when you detach and reattach parts of the appliance.
- Turn off and unplug the appliance before cleaning it or replacing the filter.

CAUTION INSTRUCTIONS

CAUTION

- To reduce the risk of minor injury to persons, malfunction, or damage to the product or property when using this product, follow basic precautions, including the following:

Installation

- Do not tilt the appliance to pull or push it when transporting.
- Do not install the appliance in a vehicle, RV, or marine vessel.
- Do not place the appliance near a TV or stereo equipment.
- Do not place the appliance under bright light.
- The appliance must be installed in accordance with national wiring regulations.
- When moving or storing the appliance, wrap the power cord around the base of the appliance to prevent personal injury, damage to the cord or damage to floors.
- Do not place the appliance near curtains.
- Insert the adapter all the way into the adapter connection terminal, and avoid moving it while connected.

Operation

- Do not use the product for removal of toxic gas such as carbon monoxide.
- Do not use the product for ventilation purposes.
- Do not use the appliance for a long time in a region with unstable voltage.
- Do not place obstacles around the air inlet or outlet.
- For safe use of the appliance, children or others with reduced mental capabilities need to be closely monitored by a person who is responsible for their safety.
- Do not use the product for special purposes such as preserving plants, precision instruments, artworks, etc.

- Do not operate the appliance with wet hands.
- Do not let the moisture from a humidifier directly touch the appliance.
- Do not use the appliance while it is not in an upright position.
- Do not use the appliance near objects vulnerable to heat.
- Do not use detergents, cosmetics, chemicals, air fresheners, or disinfectants in the appliance.
- Do not touch any internal parts while the unit is operating or immediately after operation.
- Use the filter only for its intended purpose.
- The Deodorization filter and Safe Plus filter are assembled together. Do not try to detach them from each other.
- Do not insert any objects in the air outlet.

Maintenance

- Do not use strong detergents or solvents to clean the appliance. Use a soft cloth to clean.
- Do not clean the appliance with an alkaline detergent.
- Do not wipe the appliance surface using sulfuric acid, hydrochloric acid or organic solvents (thinner, kerosene etc.) or attach a sticker on the appliance.
- Do not allow water inside the appliance.
- Do not wash the filter with water.
- Be careful not to damage the pre-filter when cleaning it with a vacuum cleaner.

OPERATION

- The exterior or components of the product may vary depending on the model.

Product Overviews

Air Purifier

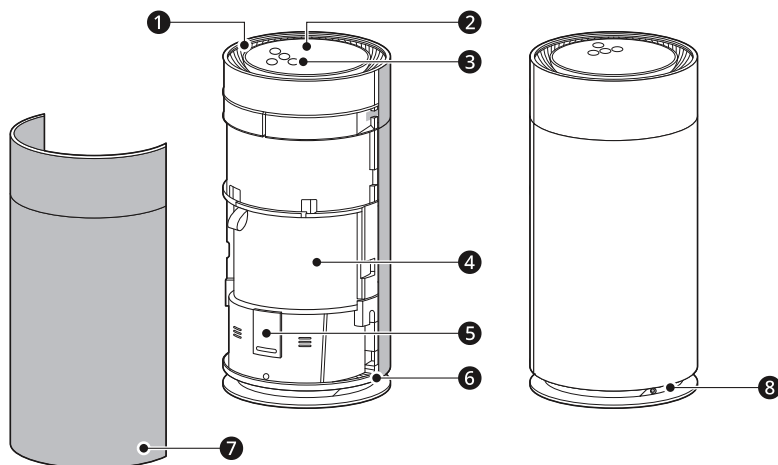

1 Air Outlet

- Purified air from the filter is emitted.

2 Status Panel

- Use it to check the settings of the appliance and the air quality.

3 Control Panel

- Use it to set the appliance functions.

4 Filter

- It eliminates fine particles, smog causing materials, sickening house syndrome materials, and domestic odor.

5 PM1.0 Sensor

- It detects the level of the concentration of particulate matter (PM).

6 Handle

- Use it to carry and move the product.

7 Air Inlet (Cover)

- Air is sucked into the air purifier through the air inlet.
- Allows you to disassemble the front and the rear covers separately.

8 Adapter Connection Terminal

- The adapter can be separated.

Filter

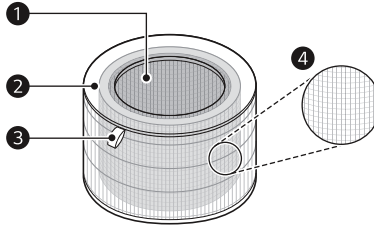

1 Deodorization Filter

- Minimizes smog causing materials (SO₂, NO₂), sickening house syndrome materials (toluene, formaldehyde), domestic odor, and sulphur compounds.

2 Safe Plus Filter

- Minimizes PM1.0, allergen materials, bacterial and viral from the air.

3 Filter Handle

- Allows you to separate the filter from the product.

4 Pre-Filter

- Minimizes large particles floating in the air.

⚠ CAUTION

- Do not forcefully separate the filters, as the filters are attached.
 - Do not throw the filters or use them for other purposes.
-

Components



1

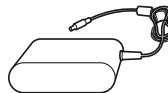

2

1 Quick Guide

2 Adapter

Preparation before Operation

Removing the Protective Vinyl from the Filter

Unpack the appliance and remove all packing tape and filter vinyl before using the appliance.

- 1 Take the product out of the box, and remove the vinyl or the fixing tape attached to the product.
- 2 Hold the top end of the front cover of the product with the **LG logo** and pull it slightly to achieve separation.

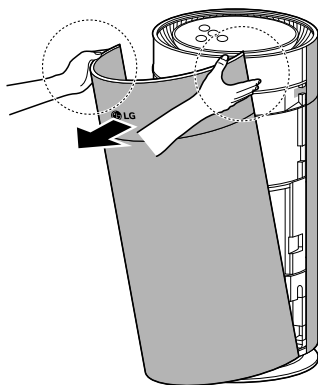

- 3 Remove the filter and detach the vinyl.

- When removing the packaged filter, separate it from the protective vinyl.

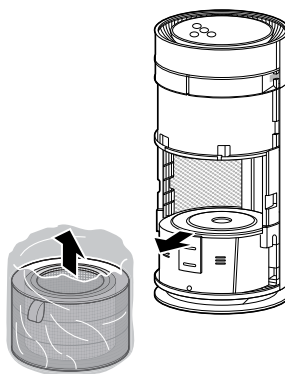

- 4 Install the filter into the product.

- Make sure that the side with the filter handle (1) is facing upward.

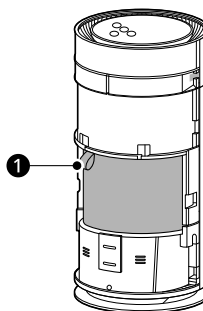

12 OPERATION

- 5** To install the cover again, insert the fixing part at the bottom of the cover into the fixed groove at the bottom of the product and then close it.

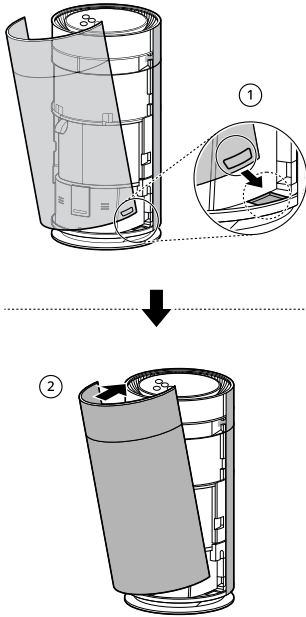

- If there is not enough room for air suction, the air purification performance may degrade.

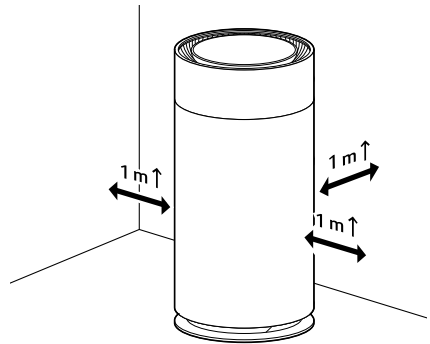

- The performance of the appliance may vary depending on the service environment (temperature, humidity, etc.).
 - The appliance can provide the guaranteed performance in an environment with humidity ranging between 40 % and 70 %.
- Do not install the product in a place exposed to direct sunlight or near lighting fixtures with strong light.
 - This may cause product discoloration.

⚠ CAUTION

- Be sure to remove the protective vinyl from the filter before using the product.
- Pay attention to filter direction when installing it. Failure to do so may cause product malfunction and failure.

Transportation Requirements

- When moving or storing the product, separate the plug from the outlet and then separate the adapter so that it will not drag across the floor.
 - Failure to do so may damage the adapter or scratch the floor.

Installation Location Requirements

Install the product at least 1 m from walls.

- Transport the product safely by holding the handle(❶) at the bottom of the product with both hands.

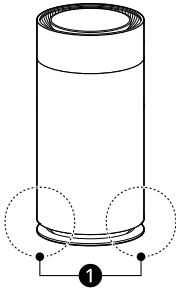

- 2 Plug the power plug of the adapter into the outlet.

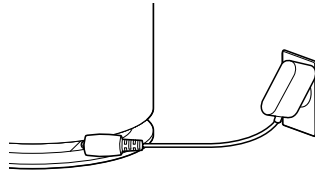

NOTE

- Hold the product and connect or disconnect the adapter horizontally.
- Connect the adapter to the end, and do not move it after it is connected. (Doing so may result in damage.)
- Be careful not to apply impact to the adapter. Failure to do so may result in damage.

⚠ CAUTION

- Do not carry the product by holding the external cover.
 - Doing so may allow the cover to open and the product to drop. Dropping the appliance may cause personal injury or product malfunction.

Connecting the Power

- 1 Connect the adapter to the adapter connection terminal on the back of the product.

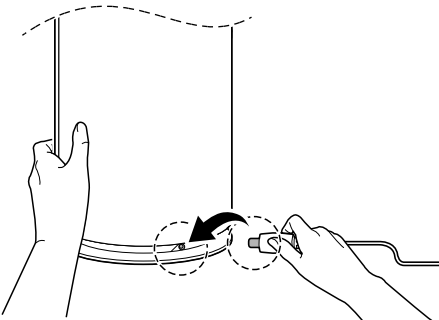

Examining Features

Controlling the Air Purifier

Control Panel

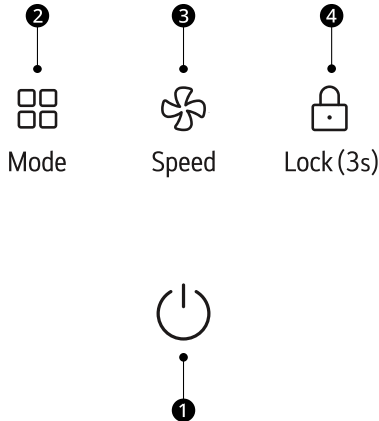

1 Start/Stop Button

Turns the product on and off.

- To prepare the product to connect to Wi-Fi through the **LG ThinQ** application, press and hold the button for 3 seconds or more.

2 Mode Button

Use it to set the mode.

3 Speed Button

Use it to adjust the fan speed of the air purifier.

4 Lock Button

You can lock or unlock the control panel by pressing and holding the button for 3 seconds.

NOTE

- You can use additional functions by pressing the buttons on the control panel for 3 seconds.

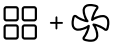
Long press (more than 3 seconds)	Extra Functions
	Filter Status Notification Reset

Status Panel

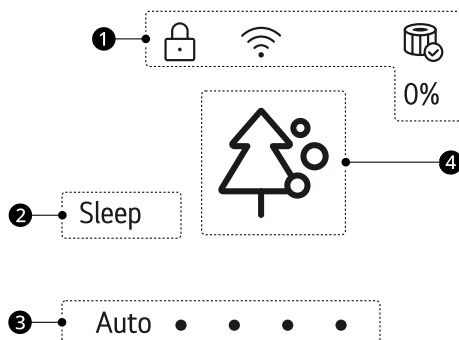

1 Add-on Display

Icon	Description
	Lights up when the lock function is set.
	Lights up when the Wi-Fi function is activated.
	The color indicates the life of the filter. For detailed information, refer to Replacing the Filters .

2 Display operating mode

It indicates the mode that is operating currently.

3 Display speed

Displays the air purifier's fan speed.

Speed	Display	Description
Auto	Auto ● ● ● ●	LED changes according to the overall air quality.
Low	●	1 LED ON
Middle	● ●	2 LED ON
High	● ● ●	3 LED ON
Turbo	● ● ● ●	4 LED ON

4 Overall Air Quality (Color)

The overall air quality is indicated by color. → See **Overall Air Quality** for detailed color information.

Operating the Air Purifier

Start/Stop

Press the **Start/Stop** button to turn on or off the air purifier.

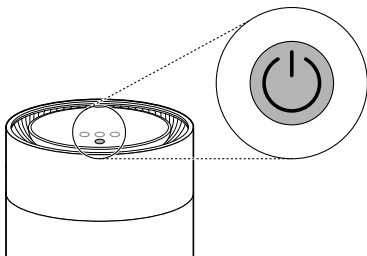

NOTE

- When the operation is started for the first time, the appliance operates in **Purify** mode.
- The most recently used mode is memorized if the power supply is cut off as a result of a power failure.
- When the operation begins, the Overall Air Quality will take around 30 seconds to display on Status Panel.

Operation Mode

Each time you press the **Mode** button, the mode changes in the following order

: **Purify** → **Sleep**.

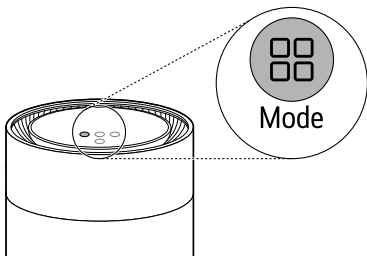

Using Purify Mode

The air purifier purifies indoor air.

Press the **Mode** button to choose the **Purify** mode.

- Each time you press the button, the operating mode changes in the following order: **Purify** → **Sleep**.

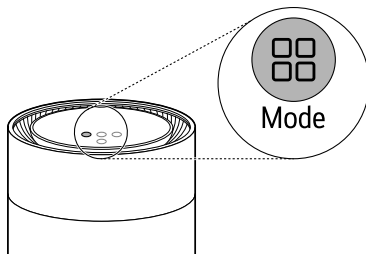

NOTE

- **Purify** mode is not displayed on the status panel.

Using Sleep Mode

You can use the air purifier in a quiet environment when you go to sleep.

Press the **Mode** button to choose **Sleep** mode.

- Each time you press the button, the operating mode changes in the following order: **Purify** → **Sleep**.

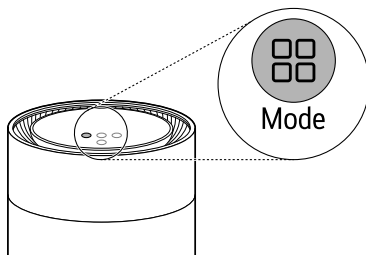

NOTE

- The whole display is turned off except for the display of **Sleep** mode.

- You cannot set the operation time in **Sleep** mode separately. To cancel the **Sleep** mode, press the **Mode** button in the same way as in setting it.

Adjusting the Fan Speed

You can adjust the fan speed from the air purifier.

- 1 Press the **Start/Stop** button to turn on the product.

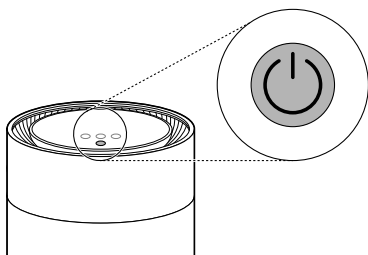

- 2 To adjust the fan speed, press the **Speed** button.
 - When you press the button during product operation, the fan speed changes in the order of **Auto** → **Low** → **Medium** → **High** → **Turbo**.

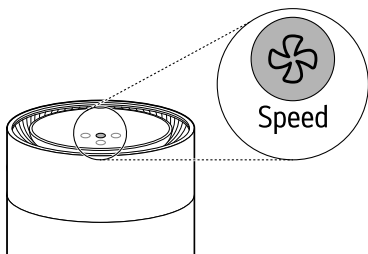

NOTE

- When the operation is started for the first time, it will operate with **Auto** as the fan speed. The **Auto** adjusts automatically the speed according to the air quality level of the indoor air.

Using the Extra Functions

Locking the Control Panel

You can lock the buttons on the control panel to prevent the appliance from operating due to unforeseen reasons, such as a child manipulating the buttons.

Press the **Lock** button for 3 seconds or longer during operation.

- The lock icon is displayed on the status panel when the lock function is set.

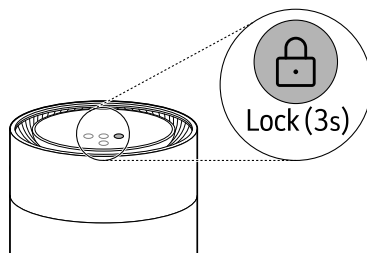

NOTE

- You can turn off the lock function in the same way as turning it on.
- You can also lock or unlock when the operation has stopped.

Overall Air Quality

Understanding Overall Air Quality

The overall air quality is calculated based on the concentration of particulates and is categorized in 4 levels based on the level of pollution in the air. (Green, Yellow, Orange, and Red)

Color	Overall air quality	Concentration of PM ($\mu\text{g}/\text{m}^3$)		
	State	PM10	PM2.5	PM1.0
Red	Poor	255 or more	56 or more	56 or more
Orange	Unhealthy	155 ~ 254	36 ~ 55	36 ~ 55
Yellow	Moderate	55 ~ 154	13 ~ 35	13 ~ 35
Green	Good	54 or less	12 or less	12 or less

NOTE

- Overall air quality can be seen by the color of the air quality indicator.
- The color of the overall air quality indicator is determined based on the concentration of particulate matter (PM).
- PM concentration values are based on the data sheet provided by the sensor manufacturer.
- The PM concentration measurement was tested using LG Electronics' standard test materials.

SMART FUNCTIONS

LG ThinQ Application

The **LG ThinQ** application allows you to communicate with the appliance using a smartphone.

LG ThinQ Application Features

Smart Diagnosis

If you experience a problem while using the appliance, this **Smart Diagnosis** feature will help you diagnose the problem.

Settings

Allows you to set various options on the appliance and in the application.

NOTE

- In the following cases, you must update the network information for each appliance in the **LG ThinQ** application under **Device Cards** → **Settings** → **Change Network**.
 - wireless router is changed
 - wireless router password is changed
 - Internet service provider is changed
- The application is subject to change for appliance improvement purposes without notice to users.
- Functions may vary by model.

Before Using LG ThinQ Application

This feature is only available on models with Wi-Fi function.

- 1 Check the distance between the appliance and the wireless router (Wi-Fi network).
 - If the distance between the appliance and the wireless router is too far, the signal strength becomes weak. It may take a long time to connect or installation may fail.

- 2 Turn off the Mobile data or Cellular Data on your smartphone.

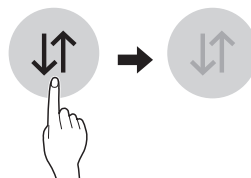

- 3 Connect your smartphone to the wireless router.

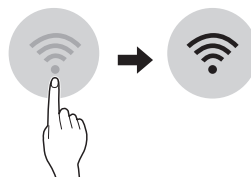

NOTE

- To verify the Wi-Fi connection, check that the Wi-Fi  icon on the status panel is lit.
- **The appliance supports 2.4 GHz Wi-Fi networks only.** To check your network frequency, contact your Internet service provider or refer to your wireless router manual.
- **LG ThinQ** is not responsible for any network connection problems or any faults, malfunctions, or errors caused by network connection.
- If the appliance is having trouble connecting to the Wi-Fi network, it may be too far from the router. Purchase a Wi-Fi repeater (range extender) to improve the Wi-Fi signal strength.
- The Wi-Fi connection may not connect or may be interrupted because of the home network environment.
- The network connection may not work properly depending on the Internet service provider.
- The surrounding wireless environment can make the wireless network service run slowly.

NOTE

- If the appliance cannot be connected due to problems with the wireless signal transmission, unplug the appliance and wait about a minute before trying it again.
 - If the firewall on your wireless router is enabled, disable the firewall or add an exception to it.
 - The wireless network name (SSID) should be a combination of English letters and numbers. (Do not use special characters.)
 - Smartphone user interface (UI) may vary depending on the mobile operating system (OS) and the manufacturer.
 - If the security protocol of the router is set to WEP, the network setup may fail. Change the security protocol (WPA2 is recommended) and connect the product again.
-

Installing the LG ThinQ Application

Search for the **LG ThinQ** application from the Google Play Store or Apple App Store on a smartphone. Follow instructions to download and install the application.

Open Source Software Notice Information

To obtain the source code that is contained in this product, under GPL, LGPL, MPL, and other open source licenses that have the obligation to disclose source code, and to access all referred license terms, copyright notices and other relevant documents, please visit <https://opensource.lge.com>.

LG Electronics will also provide open source code to you on CD-ROM for a charge covering the cost of performing such distribution (such as the cost of media, shipping, and handling) upon email request to opensource@lge.com.

This offer is valid to anyone in receipt of this information for a period of three years after our last shipment of this product.

Smart Diagnosis

Use this feature to help you diagnose and solve problems with your appliance.

NOTE

- For reasons not attributable to LGE's negligence, the service may not operate due to external factors such as, but not limited to, Wi-Fi unavailability, Wi-Fi disconnection, local app store policy, or app unavailability.
 - The feature may be subject to change without prior notice and may have a different form depending on where you are located.
-

Using LG ThinQ to Diagnose Issues

If you experience a problem with your Wi-Fi equipped appliance, it can transmit troubleshooting data to a smartphone using the **LG ThinQ** application.

- Launch the **LG ThinQ** application and select the **Smart Diagnosis** feature in the menu. Follow the instructions provided in the **LG ThinQ** application.

MAINTENANCE

Maintaining the Product

Scheduled Maintenance

⚠ WARNING

- Be sure to stop the appliance operation and remove the power plug from the outlet before cleaning and replacing the filter.
- Do not spray water directly on the appliance.

Component	Cleaning frequency	Replacement frequency
 Filter	Pre-Filter Clean filter as needed	1 year

NOTE

- The cleaning frequency may vary depending on the operating hours and environment of the appliance.
- If you do not clean the product according to the cleaning frequency, you may experience a bad odor and poor performance.
- The filter must be replaced at the end of its lifespan, and the cost of replacement filters is not covered under the warranty. To purchase new filters, contact an LG Electronics Customer Information Center or visit the website at www.lg.com
- If the overall air quality does not change on the display for a long time, clean the PM1.0 sensor even if it is not scheduled for a cleaning.

Cleaning the Exterior

- 1 Remove any dust from the air inlet and outlet using a vacuum cleaner.

- 2 Wipe the air outlet and the exterior of the product with a soft cloth.

⚠ CAUTION

- Do not wipe the appliance with an alkaline detergent.
- Never use sulphuric acid, hydrochloric acid or organic solvent (e.g., thinner, kerosene and acetone) to wipe the appliance exterior, or affix labels on the exterior. Doing so may damage the product surface.
- Care should be exercised to prevent flowing of water into the product.

NOTE

- If dust on the front and rear covers cannot be removed, disassemble the covers and clean them with water. After cleaning, dry the covers thoroughly in the shade.

Cleaning the Particles Sensor

The PM1.0 sensor is the device detecting fine dust and large dust contamination levels, so it is recommended to clean the lens periodically, at least once every 2 months.

- 1 Hold the top end of the front cover of the product with the **LG logo** and pull it slightly to achieve separation.

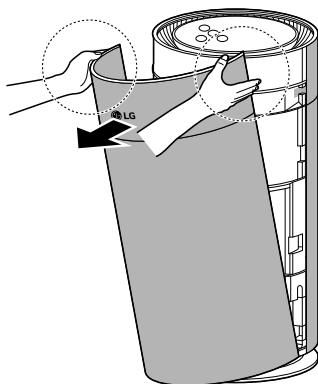

- 2 Push the sensor cover up.

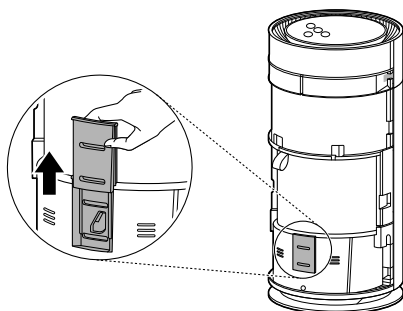

- 3 Clean the lens with a cotton swab soaked with water and clean it again with a dry cotton swab.

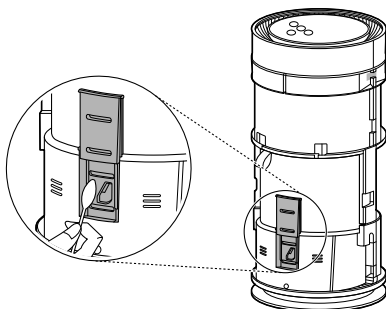

- 4 Close the sensor cover.

NOTE

- Do not wipe the sensor with any substances other than water. It may cause a appliance to malfunction.
- When opening or closing the sensor cover, a sound may be heard as a result of friction.

Cleaning the Filters

- 1 Separate the front and rear covers from the product.

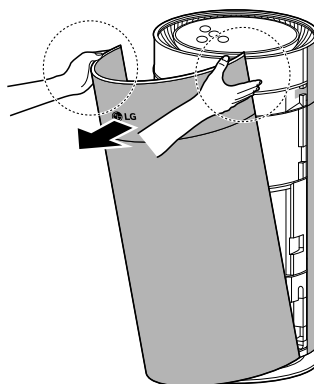

- 2 Using a vacuum cleaner or soft brush, remove any dust from the pre-filter surrounding the filter.

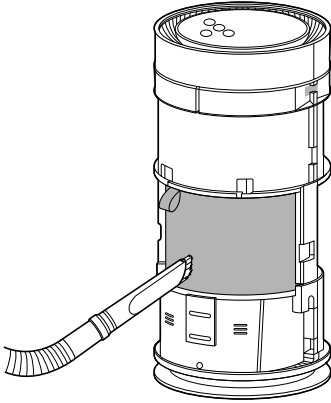

! CAUTION

- Do not clean the filter with water. The service life of the filter may be reduced.
- Be careful not to damage the pre-filter when using a vacuum cleaner.
- Take caution because there is a risk of tearing or loss when separating or assembling the pre-filter.
- Be careful as the filter may be damaged if it is covered with liquid.

Replacing the Filters

Checking Filter Status Notification

 Filter Status Notification

Color	Green	Orange	Red
Status	The filter has been installed.	Prepare for filter replacement.	Replace the filter.

NOTE

- Filter Status Notification appears based on the maximum usage time, taking into account the operating hours of the product. Replacement frequency is determined by the operating hours and the environment.
- Once you have replaced the filter, reset the Filter Status Notification.
 - The Filter Status Notification can be reset through the additional Filter Status Notification reset function.
- When the Filter Status Notification is displayed in red, a 0% icon is also displayed.

Replacing the Filters

- 1 Separate the cover from the product and replace the filter.
 - To avoid polluting the surroundings when replacing the filter, place a newspaper on the floor before you remove the filter.
- 2 Once you have replaced the filter, disable the Filter Status Notification.
 - When the Filter Status Notification is reset, the color of the Filter Status Notification changes to green.

Reset the Filter Status Notification

Press and hold the **Mode** and **Speed** buttons on the control panel for 3 seconds.

- Filter Status Notification on the status panel is reset and the time for Filter Status Notification is initialized.

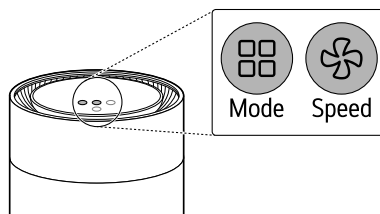

NOTE

- Use when replacing with a new filter.

Replacing the Pre-Filter

Check the Velcro of the pre-filter and replace the pre-filter by separating it slowly.

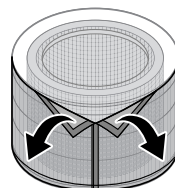

Storage

If the appliance is not used for a long period of time, store it at a shaded and dry place.

- 1 Operate the product for one hour or more on a fine day.
 - This removes moisture and prevents molds from building-up inside the product.
- 2 Turn off the product, separate the plug from the outlet, and then separate the adapter.
 - Separate the adapter from the product and store it.
- 3 Package the appliance to prevent the dust or foreign substance from entering the appliance.

Store the packaged appliance at a shaded place.

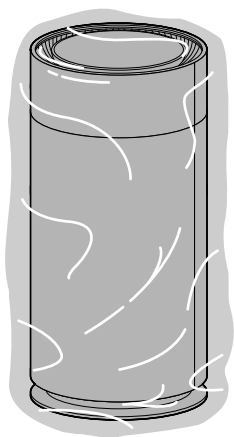

⚠ CAUTION

- Do not store the appliance at a humid place or at a place exposed to the direct sunlight.

Otherwise the appliance may be deformed, malfunction or generate odor.

TROUBLESHOOTING

Before Calling for Service

Please check the following before calling for service. If the problem persists, contact your local service center.

Operation

Symptoms	Possible Cause & Solution
The product does not power on.	Is the power plug disconnected? <ul style="list-style-type: none"> Connect it to an outlet correctly.
	Did the electricity get cut off? <ul style="list-style-type: none"> Check the power to other products in the house.
A noise occurs and the fan speed is low.	Has dust accumulated in the pre-filter? <ul style="list-style-type: none"> Clean the pre-filter.
	Has dust accumulated in the filter? <ul style="list-style-type: none"> Replace the filter.
Air purification is not done properly.	Is the indoor pollution severe? <ul style="list-style-type: none"> Ventilate indoors before using the product.
	Has dust accumulated in the pre-filter? <ul style="list-style-type: none"> Clean the pre-filter.
	Has dust accumulated in the filter? <ul style="list-style-type: none"> Replace the filter.
	Are you using it in a place that is too spacious or too open? <ul style="list-style-type: none"> Use a product that suits the size of the room. Avoid well-ventilated places such as doors, windows, etc.
	Is there an obstacle nearby? <ul style="list-style-type: none"> Remove any nearby obstacles before operating the product.
	Is the product installed in a corner? <ul style="list-style-type: none"> Move the product and reinstall it.
The overall air quality stays red.	Move the appliance to a different room and see if the color changes. <ul style="list-style-type: none"> Clean the PM1.0 sensor. Remove the power plug from the outlet and reconnect it one minute later.
	A substance was sprayed near the product. <ul style="list-style-type: none"> Do not use sprays near the product.

Symptoms	Possible Cause & Solution
The buttons on the control panel do not work.	<p>Is the lock icon displayed on the status panel?</p> <ul style="list-style-type: none"> Press and hold the Lock button for 3 seconds to disable the lock function.
The color of the filter status notification does not change to green.	<p>Is the color of the filter status notification orange or red?</p> <ul style="list-style-type: none"> The filter status notification can be reset through the additional filter status notification reset function. <ul style="list-style-type: none"> Press and hold the Mode and Speed buttons on the control panel for 3 seconds.

Odor

Symptoms	Possible Cause & Solution
A strange odor comes out from the air outlet as well as the filter.	<p>Appliance is new.</p> <ul style="list-style-type: none"> The odor of activated charcoal is not harmful. This is similar to the odor you may experience in a brand new car. The odor should dissipate after 1-2 weeks of use.
	<p>The appliance is located in an area with a lot of smoke or odors.</p> <ul style="list-style-type: none"> In areas with a lot of smoke or odors, the lifespan of the filters may be greatly decreased. For best results, ventilate the room first, then use the appliance.
	<p>The odor is coming from the filter.</p> <ul style="list-style-type: none"> Replace the filter. The filter replacement frequency may differ depending on the usage environment.
	<p>The appliance is located in an area with a lot of strong odors.</p> <ul style="list-style-type: none"> If the appliance is used near where you cook or broil fish or meat, the lifespan of the filters will be greatly decreased. For best results, ventilate the area first by opening a window or using a vent hood. Use the appliance only to minimize odors left after ventilating the area.

LG ThinQ

Symptoms	Possible Cause & Solution
The product and the smartphone cannot be connected through Wi-Fi.	<p>Is the Wi-Fi password used to connect to the smartphone correct?</p> <ul style="list-style-type: none"> Press the Settings button on your smartphone, and then find your Wi-Fi in the network list. Press and hold the button to select [Clear Network], and then proceed with product registration again from the beginning.

Symptoms	Possible Cause & Solution
The product and the smartphone cannot be connected through Wi-Fi.	Is your smartphone using mobile data rather than Wi-Fi? <ul style="list-style-type: none">• In the smartphone's settings, turn off Mobile Data, turn on Wi-Fi, and then register the product.
	Does the name (ID) of the wireless router contain special characters? <ul style="list-style-type: none">• Set the name (ID) of the wireless router as a combination of numbers and English letters. Wi-Fi connection may be difficult if you enter special characters.
	Is the frequency of the wireless router not 2,4 GHz? <ul style="list-style-type: none">• When connecting the product via Wi-Fi, only a 2,4 GHz network can be used. Set the wireless router to 2,4 GHz and then connect. To check the frequency of your wireless router, contact your Internet carrier or router manufacturer.
	Are the product and the wireless router too far apart? <ul style="list-style-type: none">• If the distance between the product and the wireless router is too great, the wireless signal may be weak, and the connection may not be smooth. Move the wireless router closer to the product.

APPENDIX

Information

APPLIANCE SPECIFICATIONS

- Appearance and specifications may vary without notice to improve the quality of the appliance.

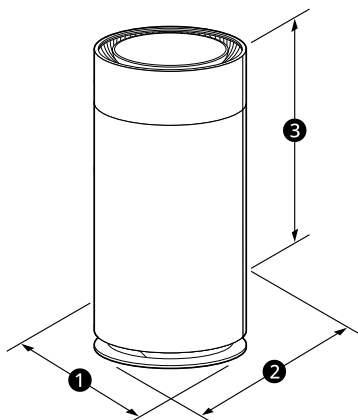

Name	AS35GGW10
Power	DC 24 V
Exterior Dimensions (1 x 2 x 3)	240 mm x 240 mm x 500 mm

AC/DC Adapter	
Manufacturer	FOSHAN SHUNDE GUANYUDA POWER SUPPLY CO.,LTD.
Model	GM51-240200-2A
Rated Input	AC 100 V - 240 V ~, 50/60 Hz
Rated Output	DC 24 V, 2.0 A, 48 W

