

# Accessing Installation Menu

- 1 Press and hold the **SETTINGS** button for more than 5 seconds.

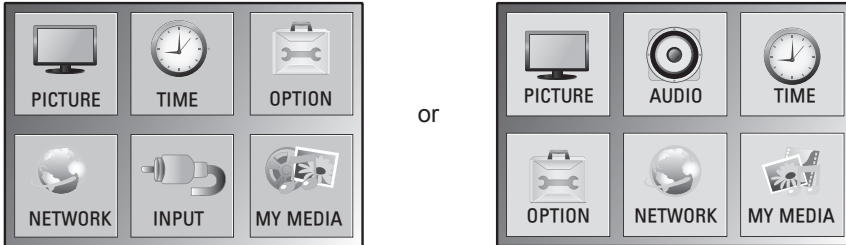

- 2 Press the **0** button four times. Press the **OK** button.

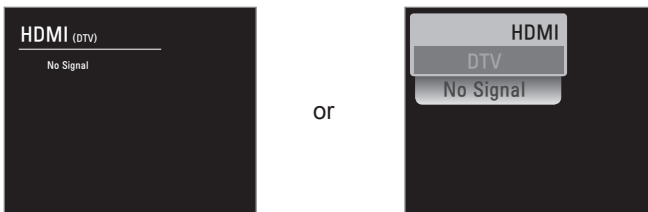

- 3 When the **Installation Menu** is displayed, select the item you want.



# Installation Menu



## NOTE

- Default values may differ by region.

## The LG Digital Signage Setup menu

This menu is used after installation to configure the Digital Signage.

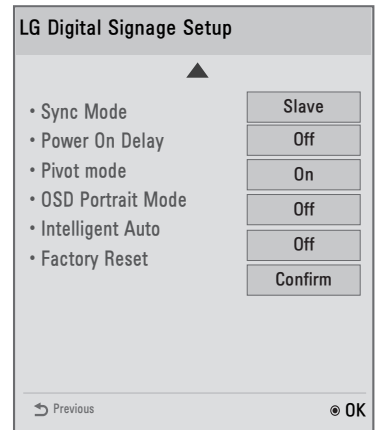
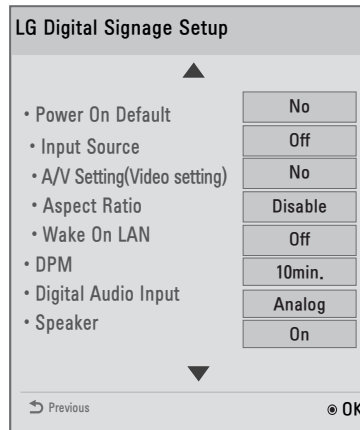
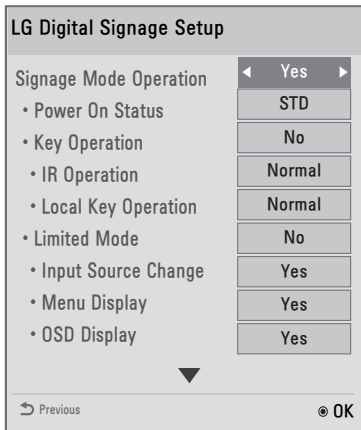

### Signage Mode Operation

- Decide to work all functions of **Signage Mode Operation** or not by setting **Signage Mode Operation** as Yes (Work) or No (Do Not Work)
- When **Signage Mode Operation** is set to Yes(Work), all functions of Signage Mode apply.
- When **Signage Mode Operation** is set to No(Do Not Work), all functions of Signage Mode Do Not apply and runs on initial value.  
(It may not work depending upon the model.)

### Power On Status

- Select the status of the monitor set when turning on the main power.
- You can set with PWR, STD, or LST.
- PWR always turns the monitor ON with the main power.
- STD turns the monitor on in the STAND-BY mode.
- LST turns the monitor to its previous status. If the main power were turned off in POWER ON status, the monitor would power up in POWER ON. If it were turned off in STAND-BY status, it would power up in STAND-BY.  
(This may not function, depending upon the model.)

## Key Operation

- This feature manages the usability of the local/front keys and your remote control with regard to their operations. This feature works according to the **IR Operation** and **Local Key Operation** settings. (It may not work depending upon the model.)

## IR Operation

- Set **LG IR Operation** to On (Work) or Off (Do Not Work) to enable or disable the remote control. (0 - Normal, 1 - Use PWR Only, 2 - Block All)
- Selecting **Block All** sets your monitor to block all key signals coming from general LG remote controls.
- Selecting **Use PWR Only** sets your monitor to block all key signals coming from general LG remote controls except for the Power key signal.
- Selecting **Normal** sets your monitor to receive all key signals coming from LG remote controls normally.
- There are keys that must be operated in Service mode when **Use PWR Only** or **Block All** is selected. (In-Start, In-Stop, Power-Only, ADJ, Installation Menu, P-Check, S-check)  
(It may not work depending upon the model.)

## ! NOTE

- When all IR key signals or all local key signals are blocked, the **Power On Status** value switches to **PWR**. Changing this value has been made impossible to ensure the operation of powering on. (To prevent mistakes by the user)

## Limited Mode

- This feature enables you to inhibit particular operations of the Signage functions. This feature works according to the **Input Source Change**, **Menu Display** or **OSD Display** settings. (It may not work depending upon the model.)

## Input Source Change

- Decide to change input source or not by setting **Input Source Change** as On(Change possible) or Off (Change impossible).
- When **Input Source Change** is set to Off (Change impossible) INPUT key doesn't work.
- When **Input Source Change** is set to On (Change possible), then changing input source is available. (It may not work depending upon the model.)

## Menu Display

- Set **On** (Work) or **Off** (Do Not Work).
- Even if it is set to **Off**, press the **Menu** button for five seconds or more to go back to the Installation Menu.  
(It may not work depending upon the model.)

## OSD Display

- Decide to display OSD or not by setting **OSD Display** as **On** (Mark) or **Off** (Off Mark).
- When **OSD Display** is set to **Off** (Off Mark), all OSD is not displayed except installaion menu. (It may not work depending upon the model.)

### Power On Default (Input Source, A/V Setting, Aspect Ratio)

- With the power turned on, you can set the **Input Source**, **A/V Setting** and **Aspect Ratio** options.
- Set to Yes (Work) or No (Do Not Work).
- If **Power On Default** is set to No, **Input Source** and **Volume** are deactivated.
- When **Power On Default** is set to Yes, it can set by entering the subordinate menu.  
(It may not work depending upon the model.)

### Input Source

- Set whether it is turned on by the set input source or by the last stored input source.
- It is turned on by the Last Memory Input if the **Input source** is turned off.
- All sources supported by the said model can be set as Input source.
- If both the **Input source** and the **ON TIME** are set, the **Input source** takes the priority.  
(It may not work depending upon the model.)

### A/V Setting(Video Setting)

- When your monitor is powered on, you can set certain options for A/V.
- If you set this feature to Yes, the A/V values you set before entering the Installation Menu are saved, and even if you have changed A/V values before powering off, the saved values are restored when you power on your monitor again.
- Saves video values: Picture Mode, DPM Select, Smart Energy Saving, Backlight, Contrast, Brightness, Sharpness, Color, Tint and Color Temp.
- Saves audio values: Sound Mode and Balance.  
(It may not work depending upon the model.)

### Aspect Ratio

- This feature enables you to set the screen size that will be applied to your monitor upon powering on.
- Selecting **Disable** sets the screen size of your monitor upon powering on to **Aspect Ratio**.
- Selecting **Set By Program** sets the screen size of your monitor upon powering on to **Set By Program**.
- Selecting **4:3** sets the screen size of your monitor upon powering on to **4:3**.
- Selecting **16:9** sets the screen size of your monitor upon powering on to **16:9**.  
(It may not work depending upon the model.)

### Wake On LAN

- Sets whether to use **Wake On LAN**.
- It can be set to On or Off.
- On: **Wake On LAN** is enabled, and you can turn on the product remotely via LAN.
- Off: **Wake On LAN** is disabled.  
(It may not work depending upon the model.)

### DPM

- Sets whether to use **DPM** (Display Power Management).
- It can be set to Off, 5 sec, 10 sec, etc.
- Others: If there is no input signal, the product enters into standby mode.
- Off: **DPM** is disabled.  
(It may not work depending upon the model.)

### Digital Audio Input

- You can set the audio for each input as **Analog** or **Digital**.
- In the case of RGB input, audio is fixed as **Analog**.
- In the case of Digital input, you can set the audio as **Analog** or **Digital**.  
(It may not work depending upon the model.)

## Speaker

- You can inhibit the audio settings by setting whether or not to use speakers.
- If you set this feature to Off, audio is not outputted and you cannot enter the **Audio** menu.
- If you set this feature to On, audio is outputted and you can enter the **Audio** menu.  
(It may not work depending upon the model.)

## Sync Mode

- With **Sync Mode** enabled, monitors connected with RS232C can start playing contents distributed by the Supersign Elite-w such as a video or an image simultaneously.
- If **Sync Mode** is set to Off, the function is disabled.
- If **Sync Mode** is set to Master for a monitor, it is set as the primary monitor.
- If **Sync Mode** is set to Slave for a monitor, it plays a content file at the same time as the master monitor.  
(It may not work depending upon the model.)

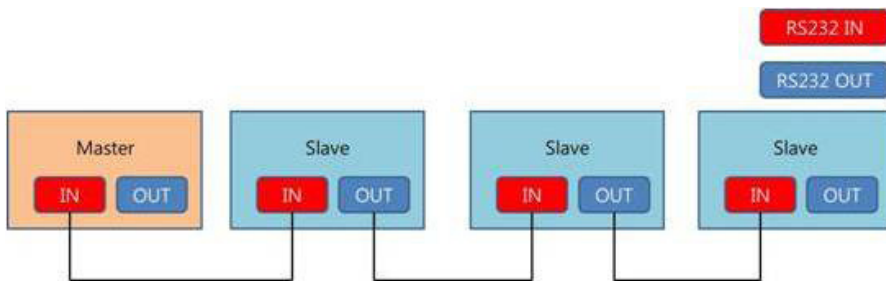

## Power on Delay

- This function delays the monitors' powering on to prevent overload when multiple connected monitors are turned on simultaneously. It can be set to **Off** or any value from 1 to 250 seconds.  
(It may not work depending upon the model.)

### Pivot Mode

- It Inverts the screen display 180 degrees.
- It inverts both Input video signal and OSD.
- The available options are **Off, On**.
- If it is set to Off, the function is disabled.
- If it is set to On, the screen display is inverted 180 degrees.
- Pivot Mode is applied after rebooting.  
(It may not work depending upon the model.)

### OSD Portrait Mode (Off, 90, 270)

- Rotate the OSD clockwise.
- The available options are Off, 90° or 270°.
- If set to **Off**, the function is deactivated.
- If set to **90**, the OSD rotates clockwise by 90 degrees.
- If set to **270**, the OSD rotates clockwise by 270 degrees.  
(It may not work depending upon the model.)

### Intelligent Auto

- Set to On (Work) or Off (Do Not Work).
- If the setting is On, Display is automatically arranged through resolution size when you change the resolution at the first.  
(It may not work depending upon the model.)

### Factory Reset

- This feature enables you to restore all set values to factory default values.
- If you set this feature to Yes, all Signage settings except for the UTT value (the Signage panel's operational hours) are restored to factory default settings.  
(It may not work depending upon the model.)

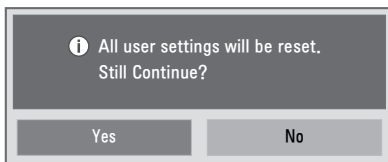

LG Digital Signage Setup		Initial setting/ Factory Reset	Signage Mode Operation	
Signage Mode Operation	Yes/ No	NO	Yes	NO
Power On Status	STD/ PWR/ LST	STD (Actual operations are performed in LST status)	User	STD (Actual operations are performed in LST status)
Key Operation	Yes/ No	No	User	No
IR Operation	Normal/ Use PWR Only/ Block All	Normal	User	Normal
Local key Operation	Normal/ Use PWR Only/ Block All	Normal	User	Normal
Limited Mode	Yes/ No	No	User	No
Input Source Change	Yes/ No	Yes	User	Yes
Menu Display	Yes/ No	Yes	User	Yes
OSD Display	Yes/ No	Yes	User	Yes
Power On Default	Yes/ No	No	User	No
Input Source	Off/ RGB/ HDMI	Off	User	Off
A/V Setting (Video Setting)	Yes/ No	No	User	No
Aspect Ratio	Disable/ Set By Program / 4:3/ 16:9	Disable	User	Disable
Wake On Lan	On/ Off	Off	User	Off
DPM	Off/ 5sec./ 10sec./ 15sec./ 1min./ 3min./ 5min./ 10min.	10min.	User	5sec.
Digital Audio Input	Digital/ Analog	RGB : Analog HDMI : Digital	User	RGB : Analog HDMI : Digital
Speaker	On/ Off	On	User	On
Sync mode	Off/ Master/ Slave	Off	User	Off
Power On Delay	Off, 1 sec ~ 250 sec	Off	User	Off
Pivot Mode	Off / Master / Slave	Off	User	Off
OSD Portrait Mode	On/ Off	Off	User	Off
Intelligent Auto	On/ Off	On	User	On
Factory Reset	Confirm			

\*\* User : Value set by the user

#### Factory Reset VS Initial Setting

Item	Factory Reset	Initial Setting
Set ID	User	1
IP	User	Reset to the default value 0

\*\* Values for other items are the same as each other

## USB Cloning

The administrator can configure a monitor more quickly through USB and configure multiple monitors simultaneously. All monitors that have been configured this way operate according to the settings of the same master monitor. This newer procedure significantly decreases the installation time that would be necessary if the standard RS-232C method were used instead.



### CAUTION

- To use the **USB Cloning** function, be sure to use a USB storage device formatted using the FAT32 file system. If the USB storage device has been formatted with another file system, it may not work correctly.

### Ez Download

Ez Download is a function that enables users to download the desired items all at once, such as EPK (software update file), TLL (see Send to USB descriptions for more information regarding file types), Splash Image, Micom, ect.

- Use the  $\wedge \vee$  button to select the Ez Download and press the **OK** button.

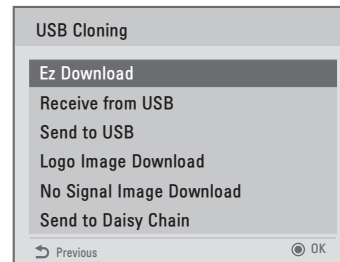
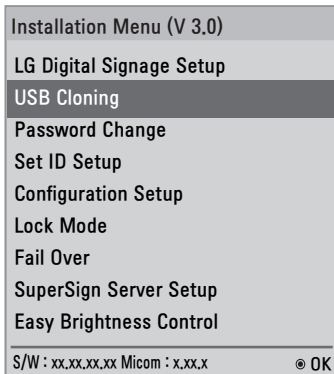

- Select a list to download and press the Apply button.
  - When EPK items are checked, EPK version information is displayed and SPI Boot and LG Boot Log items are enabled.
  - When both EPK and JPG are checked, the LG Boot Log option is disabled. When JPG is un-checked, the LG Boot Log option is enabled.
  - When Global TLL and Model TLL files are both present, only Global TLL file is displayed.
- Wait for the download to complete. When it is finished, your monitor will be turned off.



### NOTE

- The user interface for **No Signal Image Download** can be correctly displayed only in English.
- The name of the file to download can be correctly displayed only in English.

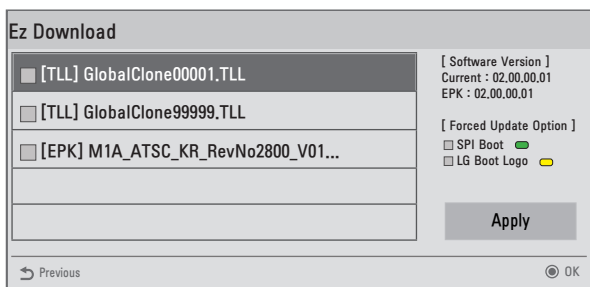

## Receive from USB

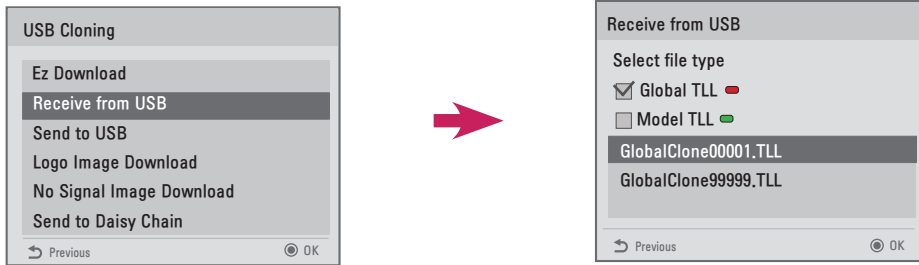

- 1 Use the  $\wedge \vee$  button to select the desired \*.TTL files name and press the OK button.
- 2 The monitor is changed to Standby mode after a successful download.  
If the download failed, the monitor will changed to the initial installation screen.

## Send to USB

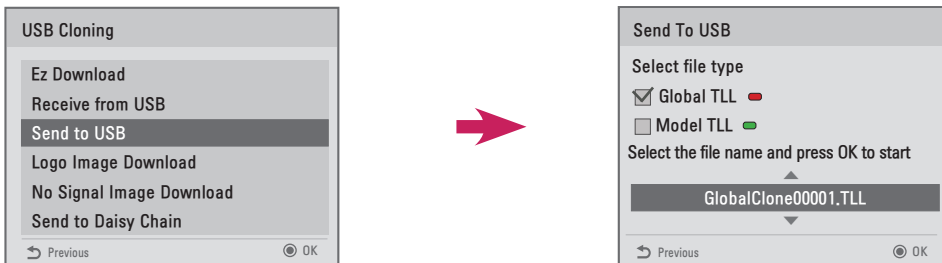

- 1 Use the  $\wedge \vee$  button to select the desired file name and press the OK button.
- 2 The monitor is changed to the initial installation screen after a successful download.

### ! NOTE

- **Model TLL** The top-level folder of USB xx (model) xxxxx. TLL (xxxxx is a number) in the form of, (model) must match the reception is possible.  
(ex) The name of Model TLL File is **xxLS33A-5DC00001.TLL ~ xxLS33A-5DC99999.TLL** for 42LS33A-5DC model.)  
Shown to be suitable for the same model, Global TLL and only appears as if the Model TLL.
- **Global TLL** The top-level folder of USB GlobalClonexxxxx.TLL (xxxxx is a number) in the form of, (model) is when the file does not match the Model TLL, Global TLL to be selected.  
(ex) The name of Global TLL File is **GlobalClone00001.TLL ~ GlobalClone99999.TLL** for 42LS33A-5DC model.)  
(\* Global TLL file exists in the same location in order to Cloning Model TLL file must be deleted or moved to other places.)
- When Global TLL and Model TLL files are both present in the top-level folder, press the red button to display the Global TLL file or the green button to display the Model TLL file.

### Logo Image Download

You can download a Splash Image file on your monitor.

Make a **LG\_DTV** folder on the USB flash drive and then copy the splash image file to that folder.

- 1 Use the  $\wedge \vee$  button to select the desired file name and press the **OK** button.

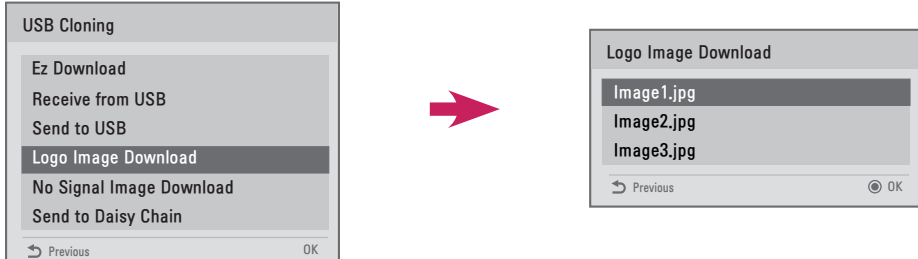

- 2 Wait till the download process is completed. After completion of download, monitor set will restart automatically.
- 3 You can see a new Splash Image on monitor which you downloaded while turning on monitor.

#### ! NOTE

- Splash Image upgrade function supports JPEG file of less than 1MB filesize.
- Except for JPEG images with progressive encoding.
- Monitor keep splash image until you change a new splash image.
- The resolution of Splash image should be 1920 x 1080 for full HD panel, 1360 x 768 for HD panel. The lowest resolution is 64 x 64.

### No signal Image Download

You can download a No Signal Image file on your monitor.

Make a **LG\_DTV** folder on the USB flash drive and then copy the No Signal Image file to that folder.

- 1 Use the  $\wedge \vee$  button to select the desired file name and press the **OK** button.

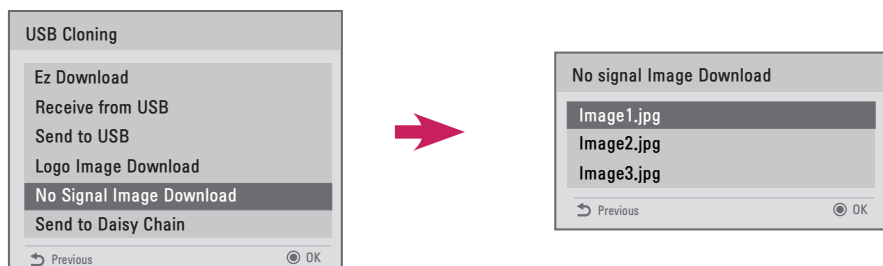

- 2 Wait till the download process is completed. After completion of download, monitor set will restart automatically.
- 3 You can see a new No Signal Image on monitor which you downloaded while turning on monitor.

#### ! NOTE

- No Signal Image upgrade function supports JPEG file of less than 1MB filesize.
- Except for JPEG images with progressive encoding.
- The resolution of No Signal Image should be 1920 x 1080 for full HD panel, 1360 x 768 for HD panel. The lowest resolution is 64 x 64.
- When the resolution for No Signal Image is set to Full HD > 1920 x 1080, then image sticking may occur.
- The file name for No Signal Image is correctly displayed only in English.

## Send to daisy chain

This function is provided to copy the product settings to other sets using RS232C.

- 1 You can send the settings for the current set to other sets using the RS232C output.
- 2 The settings of the first set, which is RS232C daisy chained, are copied.
- 3 After selecting **Send to Daisy Chain**, select **Yes** to send the data or **No** to return to the menu.
- 4 The function attempts to copy the settings until the sets connected to RS232C out port of the current set are powered off. The sets are then powered back on and the function checks that the settings have been copied.  
(It may not work depending upon the model.)

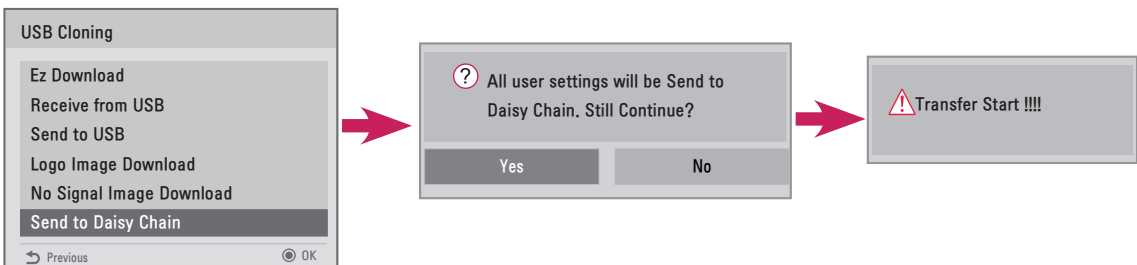

## Password Change

You can change the password for security.

Enter a new 4-digit number in **Change Password**.

Enter the same number again in **Confirm Password** to confirm the password.

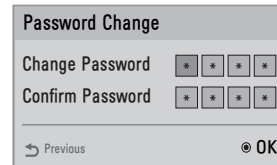
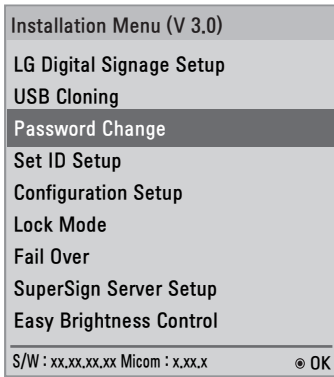

## Password Change

You can change the password for security.

Enter a new 4-digit number in **Change Password**.

Enter the same number again in **Confirm Password** to confirm the password.

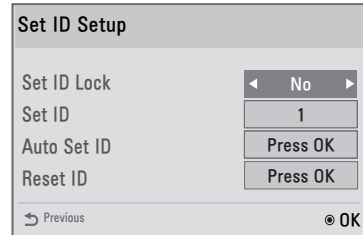
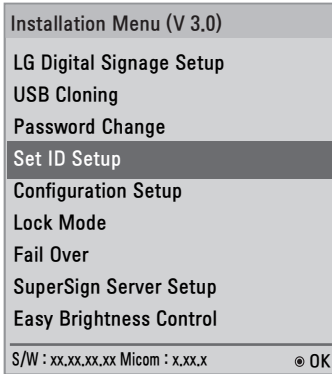

### Set ID Lock

- You can enable Set ID Lock by selecting **Yes** or cancel Set ID Lock by selecting **No**.

### Set ID

- Enter a number between 1 and 255 (or 1 and 1000) for Set ID.

### Auto Set ID

- The Set ID of a product is automatically configured.

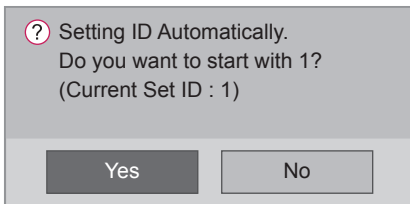

- If it is Yes, the Set ID of each set in a RS232C daisy chain is configured starting from 1.
- If it is No, the first set in the daisy chain is configured first and the rest of the sets are configured sequentially.
- Because Set ID cannot be decreased from the current value, it is recommended to execute Reset ID before using the function.
- The execution time may vary depending on the installation environment.
- If automatically setting the Set ID is not completed normally, turn the product off and on and then try again.
- Selecting Yes/No only works in the initial monitors in the daisy chain.  
(It may not work depending upon the model.)

### Reset ID

- Initialize the Set ID of a product.
- Then, the Set ID of all sets in a RS232C daisy chain is set to 1.  
(It may not work depending upon the model.)

## Configuration Setup

This feature enables the detailed configuration of the product.

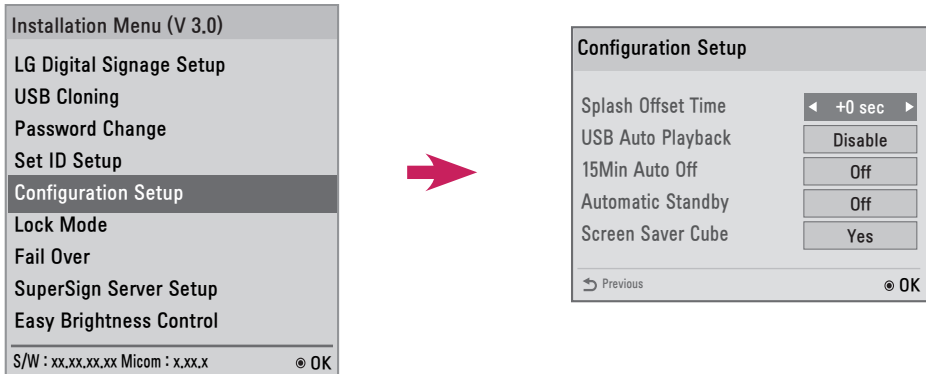

### Splash Offset Time

- This feature displays the duration of time a Splash Image is displayed.
- You can choose 0 to 10 seconds for the duration of time.

### USB Auto Playback

- This is a feature that automatically plays back video files from USB storage device.
- This feature is activated when you connect the USB device to your monitor or when you turn on your monitor with the USB device connected to it.
- Video files must be located under the root folder, in the first partition of your USB storage device.
- All video files located here will play back repeatedly.

### 15Min Auto Off

- Sets whether to use **15 Min Force Off**.
- It can be set to On or Off.
- **On** If there is No signal for 15 minutes, the product turns off.
- **Off** **15 Min Force Off** is disabled.
- Please set this option to Off when you use the product for a long period of time.

### Automatic Standby

- Sets whether to use **4 Hours Off**.
- It can be set to On or Off.
- **On** If you do not press any buttons on the remote control for 4 hours, the product turns off.
- **Off** **4 Hours Off** is disabled.
- Please set this option to Off when you use the product for a long period of time.

### Screen Saver Cube

- This Screen Saver-related feature enables you to enable/disable the 360-degree-rotating LG Cube to appear on the screen in case of no signal.

## Lock Mode

Lock Mode feature allows the user to establish whether any outside input limits, thus limiting each of the external input and automatically.



### USB

- You can enable/disable USB input. The following will happen when USB input is disabled.
- The pop-up window that appears when a USB disk is connected to your monitor is blocked.
- You cannot enter **My Media** in the menu.
- You cannot enter **USB Input** on the Input List.
- The set value for the **USB Auto Playback** function changes to No and no input is available.  
(\* As exceptions, you can download software updates and Welcome Screens.)

### Initial Setting

- You can enable/disable Initial Setting.
- If it is set to Disable, **Factory Reset** under OPTION is disabled.  
(It may not work depending upon the model.)



 **NOTE**

- The number of priorities may vary depending on the model.
- When the Mode is set to Off, all of the submenus are disabled.
- When the Mode is set to Auto, the submenus of Priority1, Priority2, and Priority3 are disabled.
- If you select Movie or Photo in the USB menu, the USB Auto Playback option in Configuration Setup is disabled and the function does not work.
- If you select Movie or Photo in the USB Auto Playback menu, the USB menu in the Fail Over menu is disabled and the function does not work.
- If the USB menu in the Lock Mode menu is disabled, the USB Auto Playback option and the Fail Over USB menu are disabled and the functions do not work.
- To enable the Fail Over USB function, a folder named **FAIL\_OVER** or **fail\_over** must exist in the USB along with any valid content (videos or images).
- If a folder named **FAIL\_OVER** or **fail\_over** or any valid content does not exist on the USB, the default USB pop-up menu is displayed when Fail Over USB function is activated.
- Be sure to turn off the USB Fail Over function after the content distribution. However, if a Fail Over event (e.g., input signal connection, Fail Over USB menu option change or USB re-connection) occurs, the Fail Over USB function will work.
- The USB Fail Over function does not work while software update (including EZ Download) is in progress.
- Fail Over for the LS33A/LS35A model may not work properly under the following conditions:
  - RGB will still be recognized as connected even when the RGB cable is connected to the equipment and monitor with no signal.  
(e.g., if the HDMI input had lost its signal and the RGB cable was connected, the input would switch to RGB even though there was no signal.)
  - HDMI will still be recognized as connected even when the equipment has no signal but is powered.  
(e.g., if a powered laptop was connected to the monitor and only the laptop was set to be displayed, HDMI would still be recognized as connected even though there was no signal from the monitor.)



## Easy Brightness Control

This feature is for a linkage with SuperSign Manager.

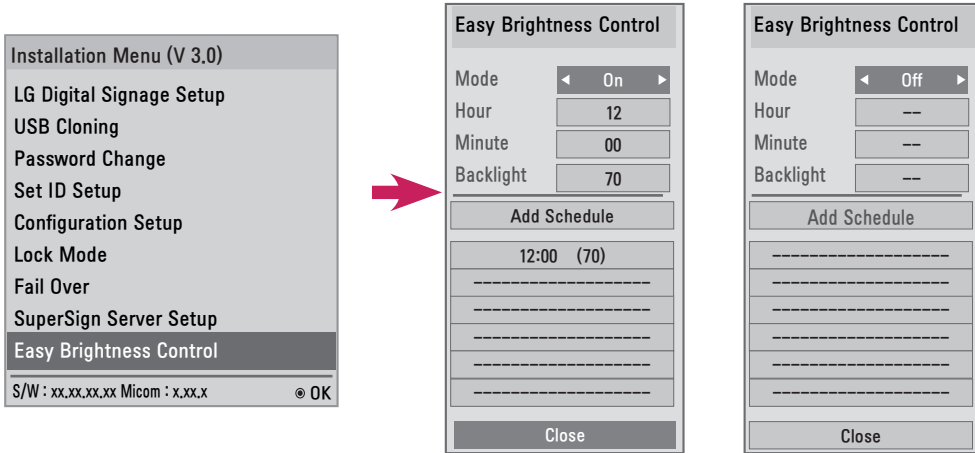

- Adjusts the backlight according to the schedule you set.
- Set to On (Work) or Off (Do Not Work).
- Easy Brightness Control is disabled if the current time is not set.
- If Energy Saving is set to Maximum, Easy Brightness Control is disabled.
- You can set up to six schedules and they will be sorted in time ascending order.
- If more than six schedules are added, the latest schedule will be automatically deleted.
- You can delete a schedule by pressing the OK button.
- Duplicate schedules are not added, but the backlight value changes. (It may not work depending upon the model.)
- Return to default settings by clicking **General** → **Reset to Initial Settings**.

# CONTROLLING THE MULTIPLE PRODUCT

- Use this method to connect several products to a single PC. You can control several products at one time by connecting them to a single PC.
- In the Option menu, Set ID must be between 1 and 255 (or from 1 to 1,000) without being duplicated.

## Connecting the cable

Connect the RS-232C cable as shown in the picture.

- The RS-232C protocol is used for communication between the PC and product. You can turn the product on/off, select an input source or adjust the OSD menu from your PC.

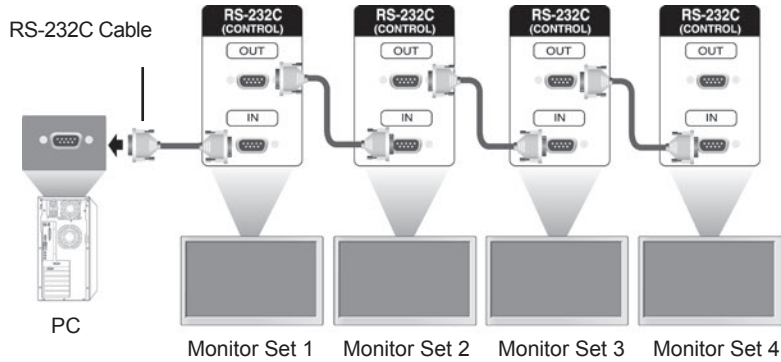

## RS-232C Configurations

### 8-Wire Configurations (Cross-over RS-232C cable)

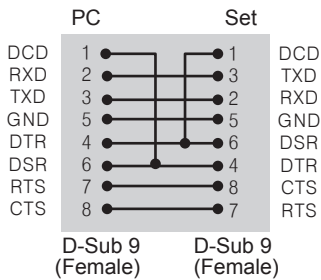

**NOTE**

- When using 3-wire connections (non-standard), an IR daisy chain cannot be used.