



49UH5B
55UH5B
65UH5B

LG Digital Signage
(MONITOR SIGNAGE)

Affichage dynamique numérique LG
(MONITEUR DE SIGNALISATION)

Señalización digital LG
(MONITOR DE SEÑALIZACIÓN)

ENGLISH Easy Setup Guide

Please read this manual carefully before operating your set and retain it for future reference.

FRANÇAIS Guide de configuration rapide

Veillez lire ce manuel attentivement avant d'utiliser l'appareil et le conserver pour pouvoir vous y reporter ultérieurement.

ESPAÑOL Guía Rápida

Lea atentamente este manual antes de poner en marcha el equipo y consérvelo para futuras consultas.

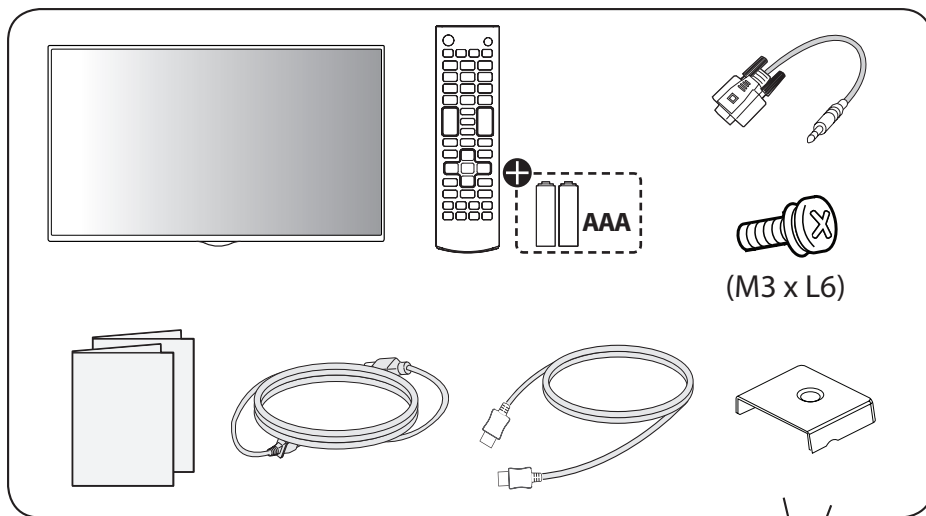

⊕ Depending upon country / Selon le pays / Según del país

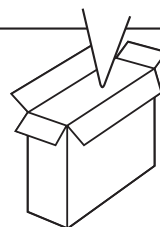

* M F L 6 9 3 2 5 8 0 4 *

P/No: MFL69325804 (1806-REV02)

ENGLISH	You can download the owner's manual for this product at the following websites. (Keyword : UH5B)
FRANÇAIS	Vous pouvez télécharger le guide de l'utilisateur pour ce produit sur les sites suivants. (Mot-clé : UH5B)
ESPAÑOL	Puede descargar el manual de usuario de este producto en los siguientes sitios web. (Palabra clave : UH5B)
www.lg.com/b2b	



* SuperSign : <http://partner.lge.com>

ENGLISH

Dimensions (Width x Height x Depth) / Weight	49UH5B		
	49UH5B	Head	1103.2 mm x 648 mm x 38.6 mm / 13.3 kg (43.4 inches x 25.5 inches x 1.5 inches / 29.3 lbs)
		Head + Stand	1103.2 mm x 714.1 mm x 298.3 mm / 14.8 kg (43.4 inches x 28.1 inches x 11.7 inches / 32.6 lbs)
		Head + Speaker	1103.2 mm x 648 mm x 86.6 mm / 14 kg (43.4 inches x 25.5 inches x 3.4 inches / 30.8 lbs)
		Head + Speaker + Stand	1103.2 mm x 714.1 mm x 298.3 mm / 15.5 kg (43.4 inches x 28.1 inches x 11.7 inches / 34.1 lbs)
	55UH5B	Head	1239.8 mm x 725.2 mm x 38.6 mm / 16.6 kg (48.8 inches x 28.5 inches x 1.5 inches / 36.5 lbs)
		Head + Stand	1239.8 mm x 788.8 mm x 298.3 mm / 18.1 kg (48.8 inches x 31.0 inches x 11.7 inches / 39.9 lbs)
		Head + Speaker	1239.8 mm x 725.2 mm x 86.6 mm / 17.3 kg (48.8 inches x 28.5 inches x 3.4 inches / 38.1 lbs)
		Head + Speaker + Stand	1239.8 mm x 788.8 mm x 298.3 mm / 18.8 kg (48.8 inches x 31.0 inches x 11.7 inches / 41.4 lbs)
	65UH5B	Head	1458.6 mm x 848.9 mm x 40.1 mm / 26 kg (57.4 inches x 33.4 inches x 1.5 inches / 57.3 lbs)
		Head + Stand	1458.6 mm x 915.8 mm x 313.9 mm / 27.4 kg (57.4 inches x 36.0 inches x 12.3 inches / 60.4 lbs)
		Head + Speaker	1458.6 mm x 848.9 mm x 87.1 mm / 26.7 kg (57.4 inches x 33.4 inches x 3.4 inches / 58.8 lbs)
		Head + Speaker + Stand	1458.6 mm x 915.8 mm x 313.9 mm / 28.1 kg (57.4 inches x 36.0 inches x 12.3 inches / 61.9 lbs)

FRANÇAIS

Dimensions (largeur x hauteur x profondeur) / Poids	49UH5B	Ecran	1 103,2 mm x 648 mm x 38,6 mm / 13,3 kg (43,4 po x 25,5 po x 1,5 po / 29,3 lb)
		Ecran + socle	1 103,2 mm x 714,1 mm x 298,3 mm / 14,8 kg (43,4 po x 28,1 po x 11,7 po / 32,6 lb)
		Ecran + enceintes	1 103,2 mm x 648 mm x 86,6 mm / 14 kg (43,4 po x 25,5 po x 3,4 po / 30,8 lb)
		Ecran + enceintes + socle	1 103,2 mm x 714,1 mm x 298,3 mm / 15,5 kg (43,4 po x 28,1 po x 11,7 po / 34,1 lb)
	55UH5B	Ecran	1 239,8 mm x 725,2 mm x 38,6 mm / 16,6 kg (48,8 po x 28,5 po x 1,5 po / 36,5 lb)
		Ecran + socle	1 239,8 mm x 788,8 mm x 298,3 mm / 18,1 kg (48,8 po x 31,0 po x 11,7 po / 39,9 lb)
		Ecran + enceintes	1 239,8 mm x 725,2 mm x 86,6 mm / 17,3 kg (48,8 po x 28,5 po x 3,4 po / 38,1 lb)
		Ecran + enceintes + socle	1 239,8 mm x 788,8 mm x 298,3 mm / 18,8 kg (48,8 po x 31,0 po x 11,7 po / 41,4 lb)
	65UH5B	Ecran	1 458,6 mm x 848,9 mm x 40,1 mm / 26 kg (57,4 po x 33,4 po x 1,5 po / 57,3 lb)
		Ecran + socle	1 458,6 mm x 915,8 mm x 313,9 mm / 27,4 kg (57,4 po x 36,0 po x 12,3 po / 60,4 lb)
		Ecran + enceintes	1 458,6 mm x 848,9 mm x 87,1 mm / 26,7 kg (57,4 po x 33,4 po x 3,4 po / 58,8 lb)
		Ecran + enceintes + socle	1 458,6 mm x 915,8 mm x 313,9 mm / 28,1 kg (57,4 po x 36,0 po x 12,3 po / 61,9 lb)

ESPAÑOL

Dimensiones (ancho x alto x profundidad) / Peso	49UH5B	Cabecal	1 103,2 mm x 648 mm x 38,6 mm / 13,3 kg
		Cabecal + Soporte	1 103,2 mm x 714,1 mm x 298,3 mm / 14,8 kg
		Cabecal + Altavoz	1 103,2 mm x 648 mm x 86,6 mm / 14 kg
		Cabecal + Altavoz + Soporte	1 103,2 mm x 714,1 mm x 298,3 mm / 15,5 kg
	55UH5B	Cabecal	1 239,8 mm x 725,2 mm x 38,6 mm / 16,6 kg
		Cabecal + Soporte	1 239,8 mm x 788,8 mm x 298,3 mm / 18,1 kg
		Cabecal + Altavoz	1 239,8 mm x 725,2 mm x 86,6 mm / 17,3 kg
		Cabecal + Altavoz + Soporte	1 239,8 mm x 788,8 mm x 298,3 mm / 18,8 kg
	65UH5B	Cabecal	1 458,6 mm x 848,9 mm x 40,1 mm / 26 kg
		Cabecal + Soporte	1 458,6 mm x 915,8 mm x 313,9 mm / 27,4 kg
		Cabecal + Altavoz	1 458,6 mm x 848,9 mm x 87,1 mm / 26,7 kg
		Cabecal + Altavoz + Soporte	1 458,6 mm x 915,8 mm x 313,9 mm / 28,1 kg
Alimentación	49UH5B	AC 100-240 V ~ 50/60 Hz 1,2 A	
	55UH5B	AC 100-240 V ~ 50/60 Hz 1,4 A	
	65UH5B	AC 100-240 V ~ 50/60 Hz 1,5 A	

1

49UH5B

55UH5B

65UH5B

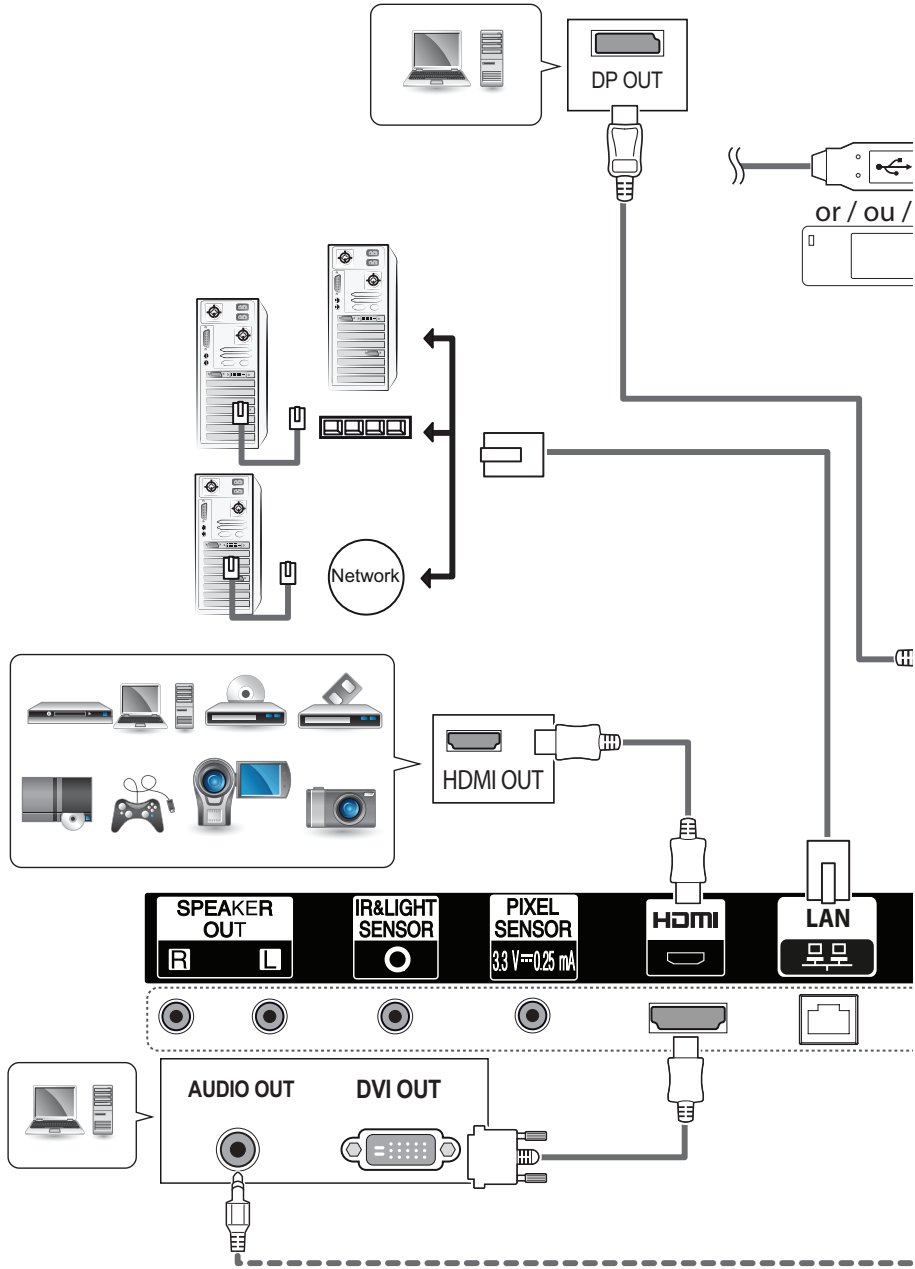

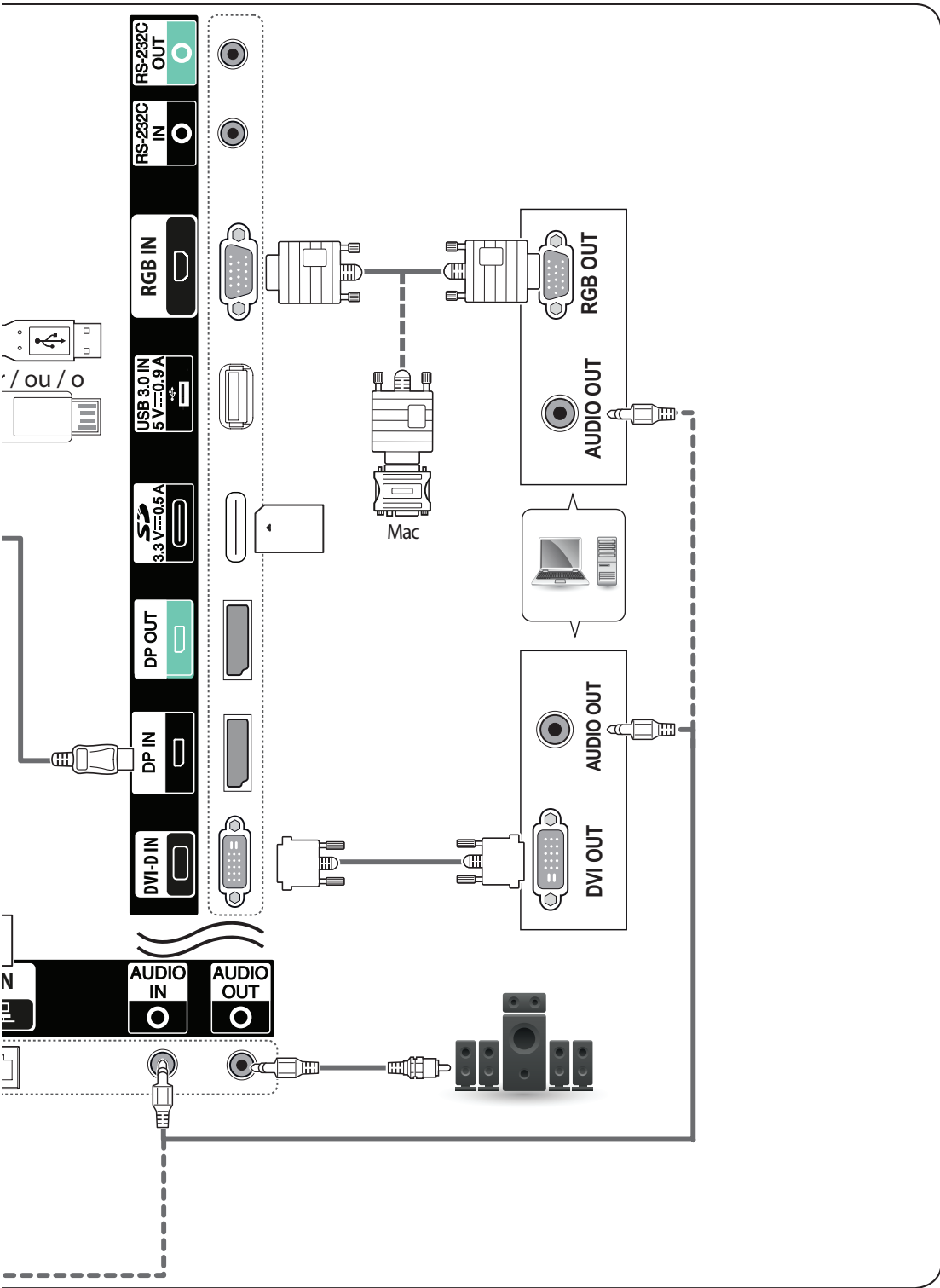

2

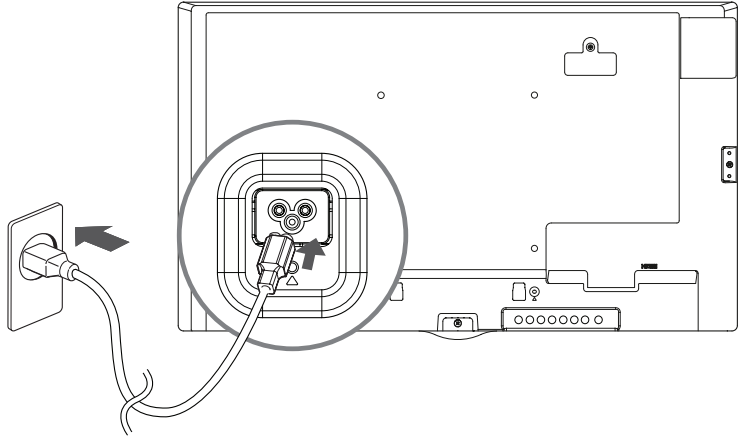

3

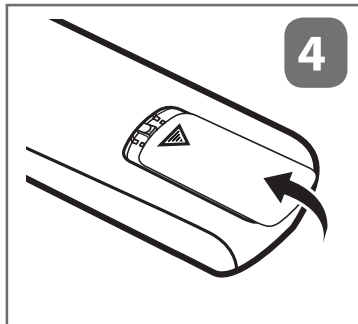
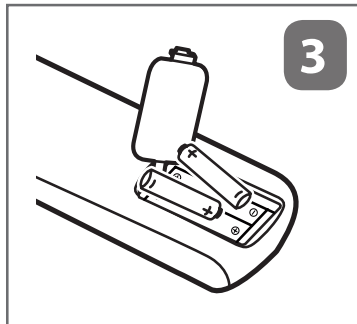
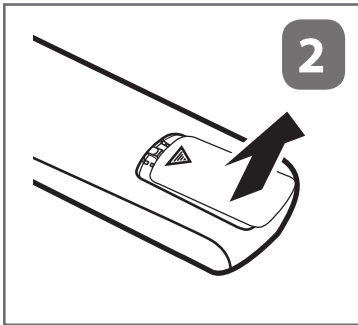
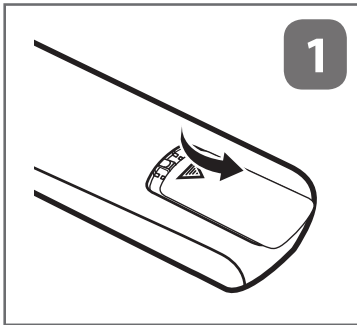
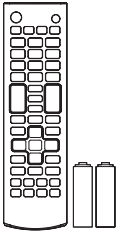

4

