



SIMPLE MANUAL

*MUSICflow* SH7B

SMART Hi-Fi

AUDIO

Wireless Multi-room Sound Bar

To view the instructions of advanced features, visit <http://www.lg.com> and then download Owner's Manual. Some of the content in this manual may differ from your unit.

MODEL

SH7B



## Safety Information



**CAUTION:** TO REDUCE THE RISK OF ELECTRIC SHOCK DO NOT REMOVE COVER (OR BACK) NO USER-SERVICEABLE PARTS INSIDE REFER SERVICING TO QUALIFIED SERVICE PERSONNEL



This lightning flash with arrowhead symbol within an equilateral triangle is intended to alert the user to the presence of uninsulated dangerous voltage within the product's enclosure that may be of sufficient magnitude to constitute a risk of electric shock to persons.



The exclamation point within an equilateral triangle is intended to alert the user to the presence of important operating and maintenance (servicing) instructions in the literature accompanying the product.

**WARNING:** TO PREVENT FIRE OR ELECTRIC SHOCK HAZARD, DO NOT EXPOSE THIS PRODUCT TO RAIN OR MOISTURE.

**WARNING:** Do not install this equipment in a confined space such as a book case or similar unit.

**CAUTION:** Do not use high voltage products around this product. (ex. Electrical swatter) This product may malfunction due to electrical shock.

**CAUTION:** The apparatus shall not be exposed to water (dripping or splashing) and no objects filled with liquids, such as vases, shall be placed on the apparatus.

**CAUTION:** Do not block any ventilation openings. Install in accordance with the manufacturer's instructions.

Slots and openings in the cabinet are provided for ventilation and to ensure reliable operation of the product and to protect it from over heating. The openings shall be never be blocked by placing the product on a bed, sofa, rug or other similar surface. This product shall not be placed in a built-in installation such as a bookcase or rack unless proper ventilation is provided or the manufacturer's instruction has been adhered to.

**CAUTION:** No naked flame sources, such as lighted candles, should be placed on the apparatus.

**NOTICE:** For safety marking information including product identification and supply ratings, please refer to the main label on the bottom or the other surface of the product.

### CAUTION

Only use the AC adapter supplied with this device. Do not use a power supply from another device or another manufacturer. Using any other power cable or power supply may cause damage to the device and void your warranty.

### CAUTION concerning the Power Cord

Most appliances recommend they be placed upon a dedicated circuit;

That is, a single outlet circuit which powers only that appliance and has no additional outlets or branch circuits. Check the specification page of this owner's manual to be certain. Do not overload wall outlets. Overloaded wall outlets, loose or damaged wall outlets, extension cords, frayed power cords, or damaged or cracked wire insulation are dangerous. Any of these conditions could result in electric shock or fire. Periodically examine the cord of your appliance, and if its appearance indicates damage or deterioration, unplug it, discontinue use of the appliance, and have the cord replaced with an exact replacement part by an authorized service center. Protect the power cord from physical or mechanical abuse, such as being twisted, kinked, pinched, closed in a door, or walked upon. Pay particular attention to plugs, wall outlets, and the point where the cord exits the appliance. The Power Plug is the disconnecting device. In case of an emergency, the Power Plug must remain readily accessible.

This device is equipped with a portable battery or accumulator.

**Safety way to remove the battery from the equipment:** Remove the old battery or battery pack, follow the steps in reverse order than the assembly. To prevent contamination of the environment and bring on possible threat to human and animal health, the old battery or the battery put it in the appropriate container at designated collection points. Do not dispose of batteries or battery together with other waste. It is recommended that you use local, free reimbursement systems batteries and accumulators. The battery should not be exposed to excessive heat such as sunshine, fire or the like.

### Industry Canada Statement

This device complies with Industry Canada's licence-exempt RSSs. Operation is subject to the following two conditions:

- (1) This device may not cause interference; and
- (2) This device must accept any interference, including interference that may cause undesired operation of the device.

### CAN ICES-3 (B)/NMB-3 (B)

#### IC Radiation Exposure Statement

This equipment complies with IC radiation exposure limits set forth for an uncontrolled environment.

This equipment should be installed and operated with minimum distance 20 cm (7.8 inches) between the antenna & your body.

NOTE: THE MANUFACTURER IS NOT RESPONSIBLE FOR ANY RADIO OR TV INTERFERENCE CAUSED BY UNAUTHORIZED MODIFICATIONS TO THIS EQUIPMENT. SUCH MODIFICATIONS COULD VOID THE USER'S AUTHORITY TO OPERATE THE EQUIPMENT.

#### WARNING

[For product having the wireless function using 5 GHz frequency bands]

- (i) the device for operation in the band 5150–5250 MHz is only for indoor use to reduce the potential for harmful interference to co-channel mobile satellite systems;
- (ii) for devices with detachable antenna(s), the maximum antenna gain permitted for devices in the bands 5250-5350 MHz and 5470-5725 MHz shall be such that the equipment still complies with the e.i.r.p. limit;
- (iii) for devices with detachable antenna(s), the maximum antenna gain permitted for devices in the band 5725-5850 MHz shall be such that the equipment still complies with the e.i.r.p. limits specified for point-to-point and non-point-to-point operation as appropriate; and
- (iv) the worst-case tilt angle(s) necessary to remain compliant with the e.i.r.p. elevation mask requirement set forth in Section 6.2.2(3) shall be clearly indicated (devices operating in the band 5250-5350 MHz with a maximum e.i.r.p. greater than 200 mW)
- (v) High-power radars are allocated as primary users (i.e. priority users) of the bands 5250–5350 MHz and 5650–5850 MHz and that these radars could cause interference and/or damage to LE-LAN devices.

## IMPORTANT SAFETY INSTRUCTIONS

1. Read these instructions.
2. Keep these instructions.
3. Heed all warnings.
4. Follow all instructions.
5. Do not use this apparatus near water.
6. Clean only with dry cloth.
7. Do not block any ventilation openings. Install in accordance with the manufacturer's instructions.
8. Do not install near any heat sources such as radiators, heat registers, stoves, or other apparatus (including amplifiers) that produce heat.
9. Do not defeat the safety purpose of the polarized or grounding-type plug. A polarized plug has two blades with one wider than the other. A grounding type plug has two blades and a third grounding prong. The wide blade or the third prong are provided for your safety. If the provided plug does not fit into your outlet, consult an electrician for replacement of the obsolete outlet.
10. Protect the power cord from being walked on or pinched particularly at plugs, convenience receptacles, and the point where they exit from the apparatus.
11. Only use attachments/accessories specified by the manufacturer.
12. Use only with the cart, stand, tripod, bracket, or table specified by the manufacturer, or sold with the apparatus. When a cart is used, use caution when moving the cart/apparatus combination to avoid injury from tip-over.



13. Unplug this apparatus during lightning storms or when unused for long periods of time.
14. Refer all servicing to qualified service personnel. Servicing is required when the apparatus has been damaged in any way, such as power-supply cord or plug is damaged, liquid has been spilled or objects have fallen into the apparatus, the apparatus has been exposed to rain or moisture, does not operate normally, or has been dropped.

# Table of Contents

## 1 Getting Started

- 2 Safety Information
  - 4 – IMPORTANT SAFETY INSTRUCTIONS
- 6 Unpacking
  - 6 – Wireless subwoofer connection
- 7 Front panel
- 7 Rear panel
- 8 Remote control

## 2 Connecting to your TV

- 9 Connecting to your TV
  - 9 – 1. Optical connection
  - 9 – 2. HDMI (ARC) connection
  - 9 – 3. Wireless LG Sound Sync connection

## 3 Using Multi-Room

- 10 Multi-Room Network Setup
  - 10 – Step 1. Home Network Requirement
  - 11 – Step 2. Installing “Music Flow Player” App and Media Server
  - 12 – Step 3. Initial Multi-Room Setup
  - 14 – Step 4. Add Speakers (Optional)
  - 15 – Using the Bridge
- 16 Enjoying Multiple MUSIC flow Product
  - 16 – 1. Home Cinema Mode (Surround Sound Mode)
  - 16 – 2. Grouping Mode
  - 16 – 3. L/R Stereo Mode

## 4 Using External device

- 17 Using External device
  - 17 – 1. HDMI Input connection
  - 17 – 2. PORTABLE IN connection
  - 17 – 3. BLUETOOTH® connection

## 5 Troubleshooting

- 18 Troubleshooting

## 6 Appendix

- 22 Mounting the main unit on a wall
- 23 About Status LED's Condition
- 23 Specification
- 23 OPEN SOURCE SOFTWARE NOTICE INFORMATION

1

2

3

4

5

6

Some of the content in this manual may differ from Music Flow Player app depending on the application's version.

# Unpacking

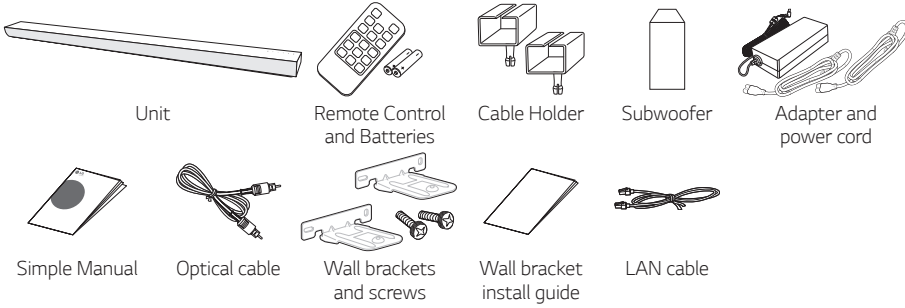

- When mounting this unit on a wall, refer to page 22.
- Depending on the region, the supplied accessories may differ.

## Wireless subwoofer connection

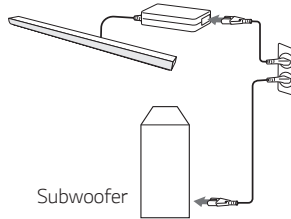

1. Connect the power cord of the main unit and the wireless subwoofer to the outlet.
2. Turn them on and the wireless subwoofer will be automatically connected. When the connection is completed, you can see the green LED on the subwoofer.

If you have trouble to connect the wireless subwoofer, refer to page 18.

## Front panel

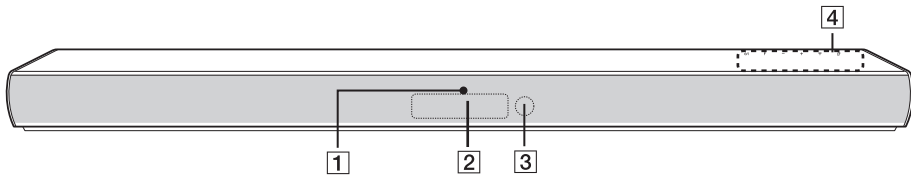



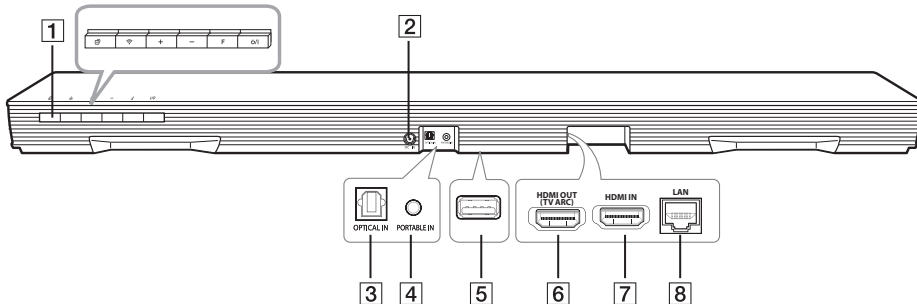

- 1 LED indicator:** Shows connection status. (Page 23)
- White (blinking): waiting for network connection
  - White (staying on): network connection is completed.
  - White (Dimmed): standby mode with network connection.
  - Green (staying on): the first group was set.
  - Red (staying on): standby mode without network connection

- 2 Display window**
- 3 Remote sensor**
- 4 The buttons are located on the rear.**

## Rear panel



- 1**  /  (Standby/On)  
**F (Function):** Selects the function and input source. (OPTICAL / HDMI IN / WI-FI / BT READY / LG TV / PORTABLE)
- / + (Volume)**
-  **(Wi-Fi):** Connects initial MUSICflow product to your network wirelessly.
-  **(Add):** Adds the additional MUSICflow product to your network. (In case that one or more MUSICflow product is connected.)

- 2 DC IN** (AC adapter input)
- 3 OPTICAL IN** connectors
- 4 PORTABLE IN** connector
- 5 USB (Service only)** : S/W download connector
- 6 HDMI OUT (TV ARC)** : Connect to HDMI IN (ARC) on TV.
- 7 HDMI IN**
- 8 LAN** port

## Remote control

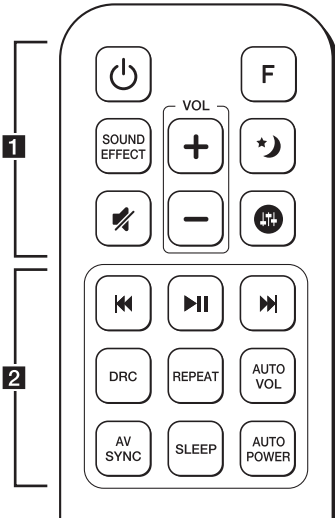

### Battery Installation

Remove the battery cover on the rear of the remote control, and insert the battery with **+** and **-** matched correctly.

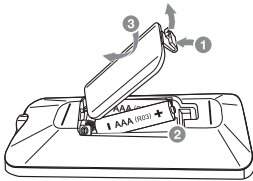

### 1

**⏻ (Power)** : Switches the unit ON or OFF (standby mode).

**F (Function)**: Selects the function and the input source. (OPTICAL / HDMI IN / WI-FI / BT READY / LG TV / PORTABLE)

**SOUND EFFECT** : Selects a sound effect mode.

**🔇 (Mute)** : Mutes the sound.

**🌙 (Night mode)** : Set Night mode to On to reduce the sound intensity and improve fineness and softness.

**🔊** : Adjusts sound level of Treble, Bass and Sub-woofer.

**+/- (VOL)**: Adjusts speaker volume.

### 2

**⏮/⏭ (Skip)** : Skips Fast backward or Forward.

**⏸ (Play/Pause)** : Starts playback or pauses playback.

### ! Note

You can use these playback buttons after play music by "Music Flow Player" App or PC software.

**DRC** : Turns on or off DRC function.

- DRC (Dynamic Range Control) : Make the sound clear when the volume is turned down (Dolby Digital only).

**REPEAT** : Listen to your music repeatedly.

- Press and hold **REPEAT** on the remote control for about 3 seconds, you can see the connected bluetooth device name on the bluetooth function.

**AUTO VOL** : Turns on or off the AUTO VOLUME mode.

- When the output sound is too loud or too low, press this button on the remote control. So you can enjoy the sound with appropriate levels.

**AV SYNC** : Synchronizes the audio and video.

- When receiving audio signals from TV, sound and images may not be matched. In the case, this function can adjust the delay time.
- Press AV SYNC then use **⏮/⏭** to control the time which you can set at between 0 and 300 ms.
- To control the TV remote control function, press and hold **AV SYNC** on the remote control for about 3 seconds.

**SLEEP** : Sets the system to turn off automatically at a specified time.

**AUTO POWER** : Turns on or off AUTO POWER function.

- If your TV or an external device is connected to Optical Input connector(s) on the unit and when you turn on your TV or an external device, this unit recognizes the input signal and selects the optical function. You can hear the sound from your device.
- To use the Auto display off function, press and hold **AUTO POWER** on the remote control for about 3 seconds.

# Connecting to your TV

Make one of the following connections, depending on the capabilities of your TV among Optical, HDMI or Wireless connection.

## 1. Optical connection

1. Connect the OPTICAL IN jack on the unit to OPTICAL OUT jack on the TV using an OPTICAL cable.

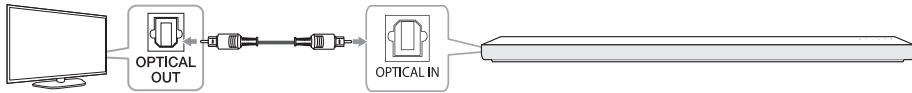

2. Set up the sound output of TV to OPTICAL output. (For details, reference your TV user manual.)  
**Note:** If your LG TV is supported LG Sound Sync (LG TV with the Sound Sync logo). Set up the sound output of TV to LG Sound Sync (Optical). (For details, reference your TV user manual.)
3. Set the input source of this unit to OPTICAL using OPTICAL or FUNC button.

## 2. HDMI (ARC) connection **HDMI™**

If you connect this unit to a TV that supports HDMI CEC and ARC (Audio Return Channel), you can enjoy the TV audio through the speakers of this unit without connecting the optical cable.

1. Connect the **HDMI OUT (TV ARC)** jack on the unit to **HDMI IN (ARC)** jack on the TV using an HDMI cable (Type A, High speed HDMI™ Cable with Ethernet).

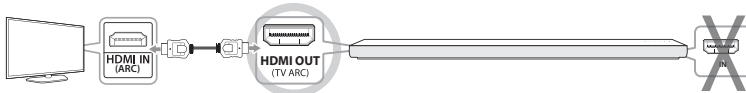

TV : HDMI IN (ARC)

Sound Bar : HDMI OUT (TV ARC)

2. Set up the sound output of TV to HDMI (ARC). (For details, reference your TV user manual.)
3. ARC function is automatically selected when ARC signal comes in from TV, no matter what kind of the function you are using.

## 3. Wireless LG Sound Sync connection

If you connect this unit to a TV that supports LG Sound Sync (LG TV with the Sound Sync logo), you can enjoy the TV sound with wireless connection.

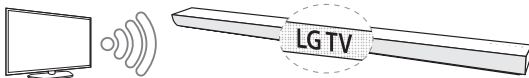

1. Turn on the unit and set the input source of this unit to LG TV function using FUNC button.
2. Set up the sound output of TV to LG Sound Sync (Wireless). (For details, reference your LG TV user manual.)  
 "PAIRED" appears on the display window for about 3 seconds and then you can see "LG TV" on the display window if connecting normally between this unit and your TV.

### About Sound Sync

You can control some functions of this unit by your TV's remote control with LG Sound Sync. It is compatible with the LG TV that is supported LG Sound Sync. Make sure of the LG Sound Sync logo on your TV.

# Multi-Room Network Setup

## Step 1. Home Network Requirement

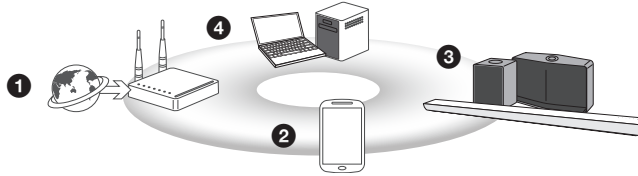

- ❶ Make sure that a wireless network environment using a router is installed at your home. The home router should be connected to the internet.
- ❷ Connect your smart device to your home network.
- ❸ Connect the speaker to the power supply.
- ❹ If you want to enjoy music on a media server (PC, Mac or Network Storage), connect the media server to your home network.

### ⚠ Caution for Home Network Requirement

- MUSIC flow system communicates over both 2.4 GHz and 5 GHz home network supporting 802.11b/g/n wireless technology.
- Wireless signal interference may lead to disconnection of network or stopping playback.
- Depending on the speed of your network, playback of online contents may not work well.
- Network connection may not be made with some routers (or modem) from certain internet communication service providers. In such case, use a router purchased from the general market.
- Because of a firewall on your PC, Music Flow PC Software may not work well. In this case, disable all your firewalls and try to connect again. Refer to your firewall's instruction or website.
- The network drive cannot configure the shared folder setting.

## Step 2. Installing “Music Flow Player” App and Media Server

### Installing “Music Flow Player” App

Download “Music Flow Player” on the Apps Store or Google Play Store.

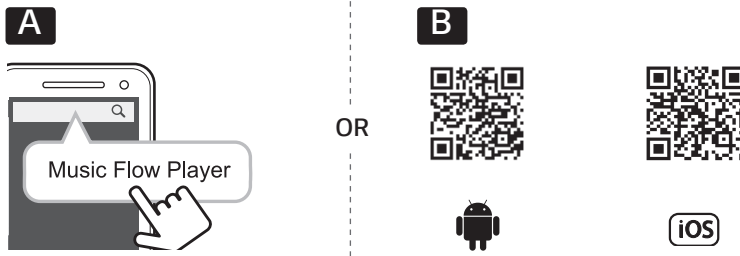

- A** Type “Music Flow Player” in the search bar and tap “Search”.
- B** Scan the QR code using the scanning application.

#### ⓘ Note for “Music Flow Player” App

- Depending on the device, “Music Flow Player” app may not work.
- Music Flow Player app will be available in version of the software as follow;  
Android O/S : Ver 4.0 (ICS) (or later)  
iOS O/S : Ver 6.0 (or later)

### Installing Media Server software on your PC or Mac

Media server software allows you to access audio files stored in media server (PC, Mac or Network storage) and enjoy them on your speaker via home networking. On [www.lq.com](http://www.lq.com) website, type model name in the search bar and find media server software on support tab.

- Windows : Music Flow PC Software
- Mac OS : Nero MediaHome 4 Essentials

#### ⓘ Note for using Media Server

- On your PC or Mac, you must share the folder contained Audio content to play them on MUSIC flow system.
- On your NAS device, you also must change the settings of your NAS device to ensure that DLNA server is enabled.
- On your Firewall software, you may also need to change the settings of your firewall software to ensure that Windows file sharing is not blocked.

### Simple Connection (EZ Setup)

#### Preparation

- For Simple Connection, Wi-Fi network condition is needed.
- Make sure that the Bluetooth setting on your smart device is on.
- Simple Connection is supported by Bluetooth Ver 4.0 (or higher).

For Simple Connection, follow the direction on the screen of “Music Flow Player” app.

## Step 3. Initial Multi-Room Setup

When installing the MUSIC flow product for the first time, you can choose two types of connection as below.

### Option 1. Wired connection (MUSIC flow Mesh Network Connection)

Connect one of MUSIC flow products (sound bar, speaker or bridge) to the home router using LAN cable. Then you can connect the additional MUSIC flow products (Optional) to your home network wirelessly (MUSIC flow Mesh Network). Refer to "Step 4. Add Speakers (Optional)" on page 14.

#### If you have a bridge

Bridge (Wired Connection) → Sound bar (Add speaker) → Other speakers (Add speaker)

#### If you do not have a bridge

Sound bar (Wired Connection) → Other speakers (Add speaker)

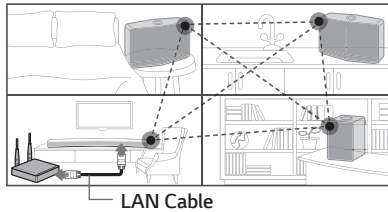

### Simple Setup Guide (Wired Connection)

1. Ensure that your smart device is connected to your Wi-Fi network.
2. Select the product you want to connect.
3. Launch Music Flow Player App and follow "Wired Connection" instructions on set-up wizard.
4. Connect LAN cable from router to any one of the MUSIC flow products (sound bar, speaker or bridge).
5. Power on the MUSIC flow product and wait until you see a white LED become solid.
6. If you install successfully, update speaker software to the latest:  
[Home → Settings → Version Info.]

#### Tip

Separated from the router's Wi-Fi environment, composes wireless network among MUSIC flow products. Using MUSIC flow mesh network, Wireless coverage is expanded, which offers stable music streaming service.

#### In the below case, MUSIC flow Mesh Network connection is recommended.

1. When the Wi-Fi coverage cannot reach whole house because home router performance is unstable.  
(In case that your home router supports only 802.11 b/g 2.4 GHz.)
2. When you want to enjoy MUSIC flow system in stable wireless network environment.
3. When you want to use in below mode.
  - 1) Multi-Room & Group-play Mode
  - 2) Home Cinema Mode

## Option 2. Wireless connection (Standard Wireless Connection)

MUSIC flow products offer music streaming service within the home router's Wi-Fi coverage.



Connect one of the MUSIC flow products, (sound bar or speaker) to the home router wirelessly.

### (Option)

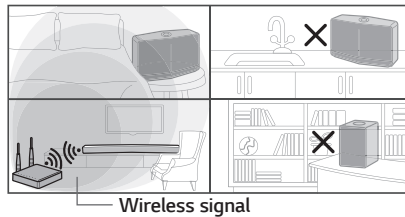
Then you can connect any additional MUSIC flow products to your home Wi-Fi network wirelessly. Refer to "Step 4. Add Speakers (Optional)" on page 14.



### Simple Setup Guide (Wireless Connection)

1. Ensure your smart device is connected to your Wi-Fi network.
2. Select the product you want to connect.
3. Launch Music Flow Player App and follow "Wireless Connection" instructions on set-up wizard.
4. Press  (Wi-Fi Setup icon) button at the back or top of the MUSIC flow product (sound bar, speaker or bridge).
5. Check if the  network indicator LED is blinking in a white and red color.
6. Please input the password of Home Router for connecting the MUSIC flow product to home router.

#### If you have an iOS device, you must take the three steps below

- 6-1. Press home button of the iOS device and go to [Settings].  
If you can select "MUSIC flow\_Setup" in Wi-Fi settings. The App and MUSIC flow product will be connected.
- 6-2. Move to the Music Flow Player App and input the password of the home router for connecting the MUSIC flow product to home router.
- 6-3. Press the home button of the iOS device and go to [Settings].  
Reconnect to your Home Wi-Fi network. And move to the Music Flow Player App again.
7. If the installation was successful, update speaker software to the latest:  
[Home → Settings → Version Info.]

#### Note

- If the "Wireless connection" configuration failed, your location may be too far from the router, it may not connect. Place and use it at a location that is closer to router.
- Music Flow PC Software installed on a desktop does not support wireless connection. In this case, use the Music Flow Player on a smart device.
- If the router's performance is not good enough (ex. 802.11g 2.4GHz), sound may be broken in group play or surround playback mode. In this case, connect the speaker in MUSIC flow Mesh Network.

**Tip**

Offers music streaming service in MUSIC flow system within home router's Wi-Fi coverage.  
In the below case, Standard wireless connection is recommended.

1. When all speakers are within the home router's Wi-Fi coverage.  
(If case that your home router supports 802.11n 2.4/5 GHz )
2. When the wired connection is unavailable between MUSIC flow products and home router.
3. When you want to use in below mode.
  - 1) When you use single speaker MUSIC flow system.
  - 2) Group-play in the Wi-Fi coverage of the home router
  - 3) L/R stereo Mode in the Wi-Fi coverage of the home router

## Step 4. Add Speakers (Optional)

If you connect the initial MUSIC flow product to your home network, you can connect additional MUSIC flow products (sound bar, speaker or bridge) to your home network.

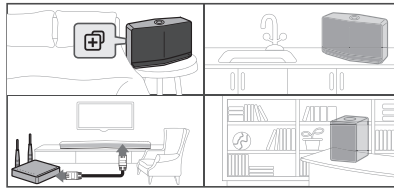

### Simple Setup Guide (Add Speakers)

1. If you have additional speakers, power on the speaker.
2. Launch smart device or PC application and follow instructions on set-up wizard.  
[Home → Add Speakers]
3. Press **+** (ADD icon) button at the back or at the top of the MUSIC flow product (sound bar, speaker or bridge) which you want to connect.
4. Check if network indicator LED is blinking in a red color.
5. If you install successfully, update speaker software to the latest:  
[Home → Settings → Version Info.]

**Note**

If the "Add Speaker" configuration failed, your location may be too far from the router; it may not connect. Place and use it at a location that is closer to router and each speaker.

**1 Note for Multi-Room Setup**

- You can make all wireless/wired connection according to the location of the router. But we recommend that you connect the first speaker/wired connection to the router using LAN cable and connect additional speakers for network stability.
- When the “Firmware update” pop-up appears on Music Flow Player App, touch to start updating.
- If you connected a speaker with a LAN cable and installed additional speakers: If the speaker with frequent sound breaking is not close enough with the cable connected speaker, install a Bridge or another speaker in the middle location between the speaker connected with LAN cable and the speaker with sound breaking, and try again.
- Even if you connected speakers with MUSIC flow mesh network, music sound breaks by ambient signal interference causing Wi-Fi network defect. In this case, you can try to change Mesh network channel of MUSIC flow system at the [Settings → Advanced settings → Mesh Network Channel]
- When making connection, “Mesh network composition” may appear and it takes about 30 seconds. This message appears once in first installation but may appear again when you change network environment.

**Using the Bridge****1. Use as a root device (wired to the home router)**

When your home router is located too far from any speaker location that is to be connected via wired mode:

- 1 According to “Simple Setup Guide (Wired Connection)”, connect the Bridge to your home router with LAN cable.
- 2 According to “Simple Setup Guide (Add Speakers)”, add MUSIC flow products to your home network.

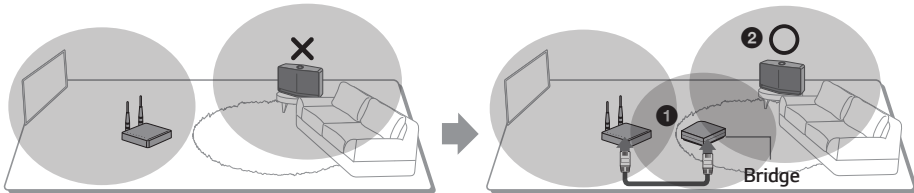
**2. Use as a wireless extender**

When you want to expand MUSIC flow mesh network coverage:

**Preparation:** Initial MUSIC flow product is connected to your home router with LAN cable.

- 1 According to “Simple Setup Guide (Add Speakers)”, add the Bridge to your home network.
- 2 According to “Simple Setup Guide (Add Speakers)”, add MUSIC flow products to your home network.

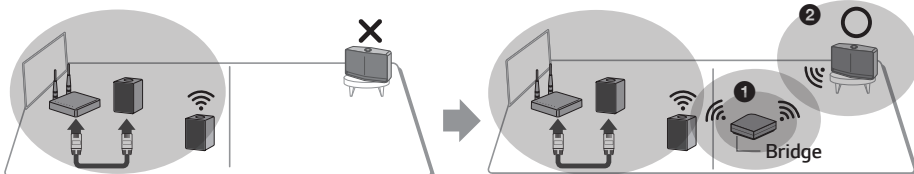

# Enjoying Multiple MUSIC flow Product

## 1. Home Cinema Mode (Surround Sound Mode)

Simply add a LG MUSIC flow sound bar to your network and synchronize it with your LG MUSIC flow speakers to enjoy a home cinema system experience.

### If you have a bridge

Bridge (Wired Connection) → Sound bar (Add speaker) → Other speakers (Add speaker)

### If you do not have a bridge

Sound bar (Wired Connection) → Other speakers (Add speaker)

#### Note

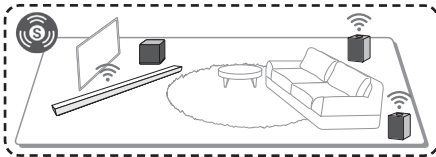

#### Requirement

- MUSICflow Sound Bar x 1
- MUSICflow Speaker x 2
- Network Bridge (optional)

## 2. Grouping Mode

Speakers placed in separate rooms can play the same music or different music based on your needs. Synchronize your multi-room speakers together to play the same song in every room.

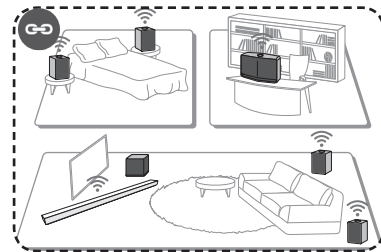

#### Requirement

- More than 2 MUSICflow
- Network Bridge (optional)

## 3. L/R Stereo Mode

Set your speakers to stereo sound with Music Flow Player Apps to enjoy movies and your favourite tracks.

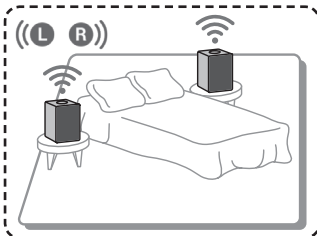

#### Requirement

- MUSICflow Speaker x 2
- Network Bridge (optional)

# Using External device

## 1. HDMI Input connection

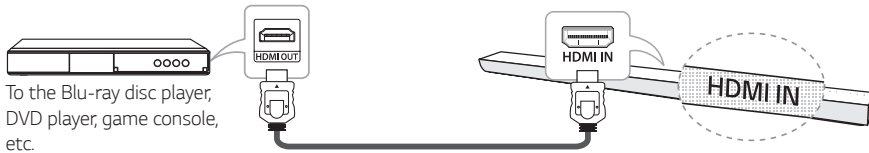

1. Connect HDMI IN jack on the unit to HDMI OUT jack on the audio & video device such as Blu-ray disc player, DVD player, game console, etc.
2. Select the input source of this unit to HDMI IN using FUNC button.

## 2. PORTABLE IN connection

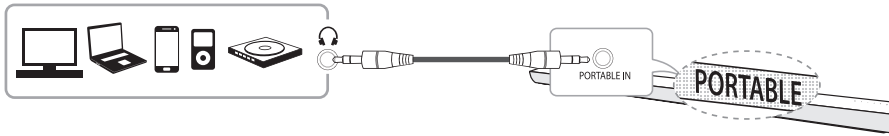

1. Connect any device which has portable out (🎧) to the PORTABLE IN connector of the unit by using a 3.5 mm stereo cable.
2. Select the input source of this unit to PORTABLE using FUNC button.

## 3. BLUETOOTH® connection



1. Select the input source of this unit to **Bluetooth** function using FUNC button. "BT READY" appears on the display window.
2. Select "LG SH7B(XX:XX)" on your **Bluetooth** device for pairing.
3. When this unit is successfully connected with your **Bluetooth** device, "PAIRED" will appear on the display window and will soon change to the **Bluetooth** device name. If it is unavailable to display device name on the unit, "\_ \_" will be display.
4. Play music on your **Bluetooth** device.

## Troubleshooting

### No woofer sound

You can set up wireless connection manually, when your connection is not completed.

- Adjust volume level of the main unit to minimum.
  - "VOL MIN" appears on the display window.

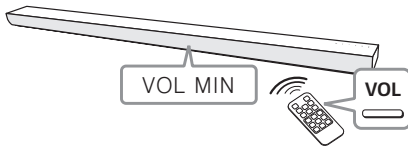

- Press and hold **MUTE** on the remote control for about 3 seconds.
  - "SUB-WF RESET" appears on the display window briefly.

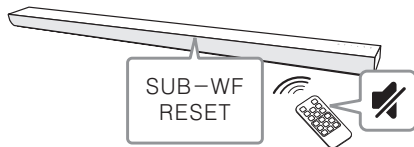

- If the LED of the wireless subwoofer already blinks in green continually, you can skip this step. Press and hold **PAIRING** on the back of the wireless subwoofer for more than 5 seconds.
  - The LED of the wireless subwoofer lights up alternately in red and green.

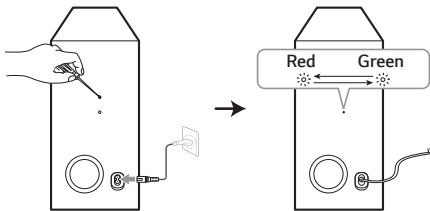

- Disconnect the power cord of the main unit and the wireless subwoofer.

- Connect them again after the LED of the main unit and the wireless subwoofer is fully turned off. The main unit and the wireless subwoofer will be paired automatically when you turn on the main unit.
  - When the connection is completed, you can see the green LED on the subwoofer.

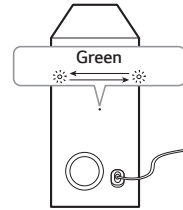

### In case that sounds are cut off during playback

- For best performance of wireless connection such as Bluetooth or wireless subwoofer, do not install the unit on Metallic furniture and raises the height by attaching accessory foot because wireless connection communicates through a module positioned on the bottom of the unit.
- Be careful not to make scratches on the surface of the Unit /Sub-Woofer when installing or moving them.
- It takes a few seconds (and may take longer) for the main unit and the subwoofer to communicate with each other and make sounds.
- The closer the main unit and the subwoofer, the better sound quality. It is recommended to install the main unit and the subwoofer as close as possible and avoid the cases below.
  - There is an obstacle between the main unit and the subwoofer.
  - There is a device using same frequency with this wireless connection such as a medical equipment, a microwave or a wireless LAN device.

## Software Update

When the MUSICflow product is connected to your home network, first of all, check whether the firmware version is the latest on all speakers and the Music Flow Player application.

Your MUSICflow device might require a more recent firmware to be installed for optimal operation.

[Settings → Version Info.]: you can check if your speaker has the latest firmware.

## How can I initialize speaker?

If you press down "⊕ (Add)" button until Beep sounds once, the network related settings are initialized. (For sound bar, "DISABLED" is displayed in the display window.)

If you press down "⊕ (Add)" button until Beep sounds twice, factory initialization is performed. (For sound bar "RESET" is displayed in the display window.)

## Speaker is not connected.

1. For a speaker that is already connected, make sure the phone is connected to the same router as the speaker. If not, connect to the same router, also check the following.
  - 1-1. Set Power off / on, and check the connection.
  - 1-2. If it is not solved by 1-1, close the application and run again.
  - 1-3. If it is not solved by 1-2, reset the Speaker and reconnect. Press and hold the "⊕ (Add)" button until you hear the beep sound twice.
  - 1-4. If it is not solved by 1-3, delete the App and reinstall, then try again.
2. If you change the location of the speaker that is in use,
  - 2-1. If the changed location is too far from the home router, it may not be connected. Place and use it at a location that is closer to router.
  - 2-2. Connect the speaker with a LAN cable, and for additional installed speakers, if they are not close enough to the speaker connected with a LAN cable, install a Bridge or another speaker in the middle location between the speaker connected with LAN cable and the speaker with sound being disconnected.

## There are times that speaker disappears from the application

1. If the speaker blinking lamp is not blinking, and stays as white: Even after the speaker power off and on, if the problem continues, in this case you have to reset the speaker (Press and hold the "⊕ (Add)" button until you hear the beep sound twice.) then you need to register again. Carry out speaker installation or additional procedures.
2. If the speaker blinking lamp blinks white - network signal is unstable. Wait for a while, or move the speaker to another location closer to another speaker or router.
3. Press menu key or menu at the top right side of Home screen to end Music Flow Player app and run again.

## NOTES to use wireless

### This device may have wireless interference.

- Wireless may not operate normally in weak signal area.
- Please install the device close enough to wireless subwoofer.
- Do not install the device on metal furniture for optimum performance.

### Bluetooth device may malfunction or make noise in the following cases.

- When any part of your body contact the transceiver of the Bluetooth device or sound bar.
- When there is an obstacle or wall or the device is installed in a secluded spot.
- When there is a device(a wireless LAN, a medical equipment or a microwave) using same frequency, make the distance between the products as far away as possible each other.
- When connecting the device to the Bluetooth device, make the distance between the products as close as possible each other.
- When the device gets too far from the Bluetooth device, the connection is disconnected and also malfunction may occur.

## Music sound breaks and unstable MUSICflow system

1. If speaker with breaking sound is connected through wireless connection mode,
  - If the distance between the speaker and home router is not close enough, the corresponding condition may occur. Move the speaker closer to the home router and try again.
  - If the device playing the source sound (Ex. phone or laptop) is at a place without fluent home router signal, move the corresponding device closer to the home router and try again.
2. If you connected a speaker with a LAN cable and installed additional speakers:  
If the speaker with frequent sound breaking is not close enough with the LAN cable connected speaker, install a Bridge or another speaker in the middle location between the LAN cable connected speaker and the speaker with sound breaking, and try again.
3. Even if you connected speakers with MUSICflow mesh network, music sound breaks by ambient signal interference causing Wi-Fi network defect. In this case, you can try to change Mesh network channel of MUSICflow system at the [Settings → Advanced settings → Mesh Network Channel].

## How can I compose Music Library? / Song is not added even though library is updated.

Just by adding a song to DLNA server, Music Library is not automatically updated. When you add a song to the server, in [Settings → Music Library → Sync], run Music Library synchronization again. Even after Music Library synchronization, if song is not added, check the followings.

1. Check if DLNA server or PC SW shared folder is designated.
2. Check if DLNA server contents list is renewed.
  - Even if you copy the file into the server, server contents list may not be immediately renewed, so check the server setting.
  - If you copy a song into the phone with a method other than MTP, it may not be reflected to the server contents list. In such case, rescan the contents in the phone, or turn off and start the phone again.
3. The sharing may be blocked, so check DLNA server program setting or firewall setting.
  - If you are using LG Musicflow PC software, when you designate shared folder, the corresponding folder will be automatically added to Music Library in a minute.

### No TV sound in HDMI (ARC) connection

The ARC function enables an HDMI capable TV to send the audio streaming to HDMI OUT of the unit.

**To use this function :**

- Your TV must support the HDMI-CEC and ARC function and the HDMI-CEC and ARC must be set to On.
- The setting method of HDMI-CEC and ARC may differ depending on the TV. For details about ARC function, refer to your TV manual.
- You must use the HDMI cable (Type A, High Speed HDMI™ cable with Ethernet).
- You must connect the HDMI OUT (TV ARC) on the unit with HDMI IN of the TV that supports ARC function using an HDMI cable.
- You can connect only one Sound bar to TV compatible with ARC.

### LG MUSICflow product is turned off automatically.

There are some cases that power off will occur if not receiving sound signal:

- Optical, HDMI ARC, Bluetooth, LG TV, Wi-Fi (DLNA) mode: if there is no sound signal during 20 minutes.
- Portable-In : no sound signal during 6 hours.
- In case of Network connected, it will go to Network standby mode (Dimmed in white LED).
- In case of Network disconnected, it will go to Standby mode (Red LED).

### What is the type of music file that can be played?

- You can play the files with extension mp3, wma, flac, m4a, aac, ogg, and wav.
- For mp3 and wma, sampling frequency is 32- 48 kHz, and for flac, it supports up to 192 kHz, 24 bit.
- Even if the above conditions are satisfied, it may not be played according to the characteristics of the file or media server.
- DRM applied file cannot be played.

### How can I use Spotify?

LG MUSICflow product supports Spotify connect method provided by Spotify. Through this, you can use the function supported by Spotify by connecting to the speaker through Spotify application. If Music Flow speaker is in the network composed of the same router, Spotify application Speaker shape Icon is changed, and when you press this Icon, you can check and select the speakers in the same network. (When the speaker is selected, the icon changes to green.)

### How can I use HomeChat?

After HomeChat device registration, you can use Home Chat.

Each of the family members can register and use one speaker in HomeChat. One person can register several speakers.

For details, refer to <http://www.lghomechat.com>.

**! Note**

Depending on the region, some services (ex. Spotify, Homechat, etc.) are unavailable.

# Mounting the main unit on a wall

## Preparation materials

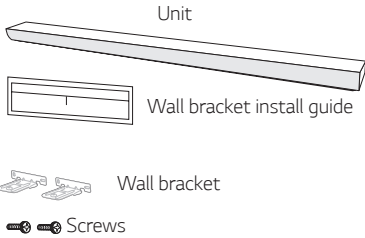

Screws (A)

Wall plug

Screws (A) and Wall Plugs are not supplied for mounting the unit. We recommend the Hilti (HUD-1 6 x 30) for the mounting.

1. Match the TV's BOTTOM EDGE of Wall bracket install guide with the bottom of TV and attach to the position.

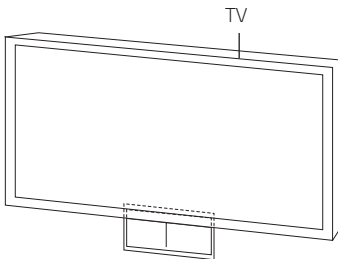

2. When you mount it on a wall (concrete), use the wall plugs. You should drill some holes. A guide sheet (Wall bracket install guide) is supplied to drill. Use the sheet to check the point to drill.

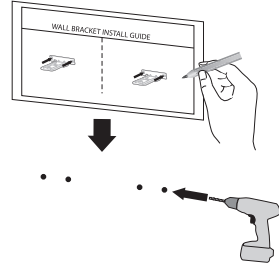

3. Remove the Wall bracket install guide.
4. Fix the brackets with screws (A) as shown in the illustration below.

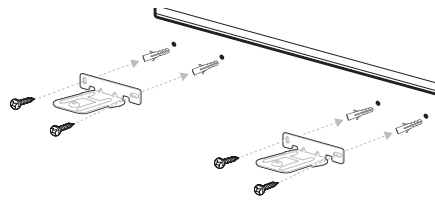



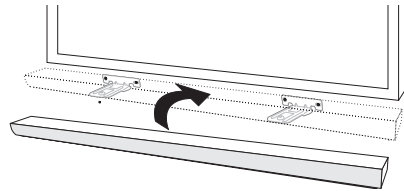

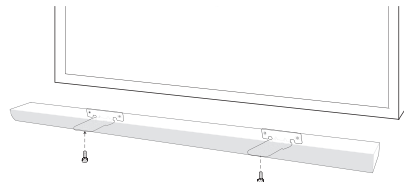

5. Put the unit on the brackets to match screw holes on the bottom of the unit.



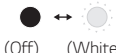

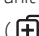

6. Fix the unit with the screws firmly.



## About Status LED's Condition

| Color   | Status  |                     |
|---|---|---------------------|
| <br>(Off) (White)  | The unit is waiting for network connection  | Network Status      |
| <br>(White) (Red)  | The initial unit is being connected to the network<br>(  button is pressed)    |                     |
| <br>(White)        | The unit is connected to the network  |                     |
| <br>(Off) (Red)    | The additional unit is being connected to the network<br>(  button is pressed) | Standby Mode Status |
| <br>(Dimmed White) | Network standby mode  |                     |
| <br>(Red)          | Standby mode  |                     |

### Note for Status LED's Condition

- When you set the group at first, Network status LED turns green.
- The additional groups are set, the Network status LED color is changed in group order.  
( (Green) >  (Magenta) >  (Cyan) >  (Blue) >  (Yellow))
- If the grouped speakers switch to the network standby mode, the brightness of Network status LED gets dark.

## Specification

### AC adapter

- Model : DA-38A25
- Manufacturer: Asian Power Devices Inc.
- Input: 100 - 240 V ~ 50/60 Hz
- Output: 25 V  1.52 A

### Power consumption: Refer to main label.

- Networked standby : 5.8 W  
(If all network ports are activated.)

### How to disconnect the wireless network connection or the wireless device

Press and hold the " (Add)" button until you hear the beep sound twice.

**Dimensions (W x H x D):** Approx. 1060 mm x 53 mm x 85 mm (41.7 inch x 2 inch x 3.3 inch)

**Net Weight:** Approx. 2.8 kg (6.2 lb)

**Amplifier (Total RMS Output power):** 360 W

- Design and specifications are subject to change without notice.

## OPEN SOURCE SOFTWARE NOTICE INFORMATION

To obtain the source code under GPL, LGPL, MPL, and other open source licenses, that is contained in this product, please visit <http://opensource.lge.com>.

In addition to the source code, all referred license terms, warranty disclaimers and copyright notices are available for download.

LG Electronics will also provide open source code to you on CD-ROM for a charge covering the cost of performing such distribution (such as the cost of media, shipping and handling) upon email request to [opensource@lge.com](mailto:opensource@lge.com). This offer is valid for three (3) years from the date on which you purchased the product.



LG Customer Information Center

1-888-542-2623

CANADA

Register your product Online!

[www.lg.com](http://www.lg.com)