

Additional Information

Specifications

Power Requirements	Refer to the main label on the unit.
Power Consumption	Refer to the main label on the unit.
Dimensions (W x H x D)	Approx. 300 mm x 163 mm x 241 mm
Bus Power Supply (USB)	5 V  500 mA
Amplifier (Total RMS output power)	300 W RMS

Design and specifications are subject to change without notice.

Replacement of battery

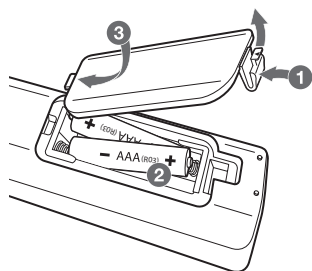

POWER: This unit operates on a mains supply of 200 - 240 V ~, 50 / 60 Hz.

Wiring: This unit is supplied with a BS 1363 approved main plug. When replacing the fuse, always use of the same rating approved to BS 1362. Never use this plug with the fuse cover omitted. To obtain a replacement fuse cover contact your dealer. If the type of plug supplied is not suitable for the mains sockets in your home, then the plug should be removed and a suitable type fitted. Please refer to the wiring instructions below:

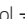
Warning: A mains plug removed from the mains lead of this unit must be destroyed. A mains plug with bared wires is hazardous if inserted in a mains socket. Do not connect either wire to the earth pin, marked with the letter E or with the earth symbol  or coloured green or green and yellow. If any other plug is fitted, use same rating of fuse in the plug.

Important: The wires in this mains lead are coloured in accordance with the following codes:

- **BLUE: NEUTRAL, BROWN: LIVE** - As the colours of the wires in the mains lead of this unit may not correspond with the coloured marking identifying the terminals in your plug, proceed as follows: The wire which is coloured blue must be connected to the terminal which is marked with the letter N or coloured black. The wire which is coloured brown must be connected to the terminal which is marked with the letter L or coloured red.



SIMPLE MANUAL Mini Hi-Fi System

Please read this manual carefully before operating your set and retain it for future reference. To view the instructions of advanced features, visit <http://www.lg.com> and then download Owner's Manual. Some of the content in this manual may differ from your unit.

MODEL
CK43



www.lg.com

Copyright © 2018 LG Electronics Inc. All Rights Reserved.

1807_Rev02

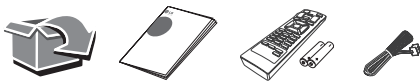

Front Panel

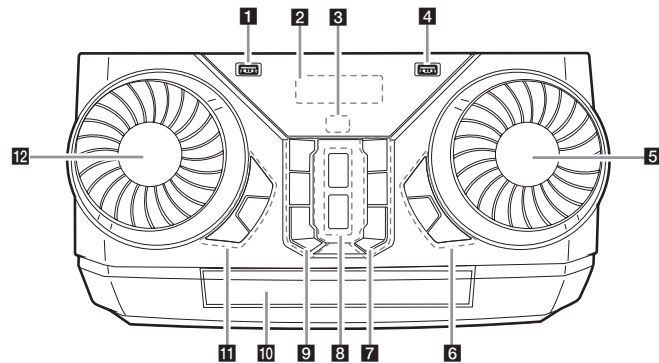

- 1** USB 1 Port
You can play sound files by connecting the USB device.
- 2** Display window
- 3** (Remote sensor)
- 4** USB 2 Port
You can play sound files by connecting the USB device.
- 5** MASTER VOL. (Volume)
Adjust speaker volume.
- 6** BASS BLAST (or BASS BLAST+)
Press to select BASS (or BASS+) effect directly.
USB REC / DEMO
- Records to USB.
- To stop Recording, press and hold for 3 seconds.
- In power off status, if you press **USB REC / DEMO**, show DEMO mode.
- 7** (Function)
Selects the function and input source.
⏮ (Skip/Search)
- Skips forward.
- Searches for a section within a track/file.
- Selects the radio stations.
⏸ (Open/Close)
Opens and closes the disc tray.
- 8** AUTO DJ
Selects the AUTO DJ mode.
⏮ (Play/Pause)
- Starts or pauses playback.
- Selects stereo/mono.
- 9** (Standby)
Turns the power on or off.
⏮ (Skip/Search)
- Skips backward.
- Searches for a section within a track/file.
- Selects the radio stations.
⏹ (Stop)
Stops playback or cancels DELETE function.
- 10** Disc tray
- 11** SPECIAL EQ
Chooses special equalizer.
SEARCH
Moves to folder or file in selection mode.
OK
Selects a folder when searching a file.
- 12** EQUALIZER / SEARCH
- Chooses sound impressions.
- Searches a folder or a file.

Rear Panel

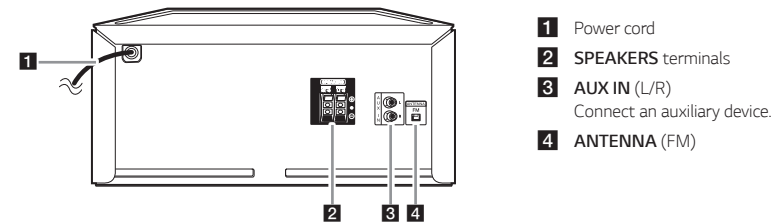

- 1** Power cord
- 2** SPEAKERS terminals
- 3** AUX IN (L/R)
Connect an auxiliary device.
- 4** ANTENNA (FM)

Speaker Connection

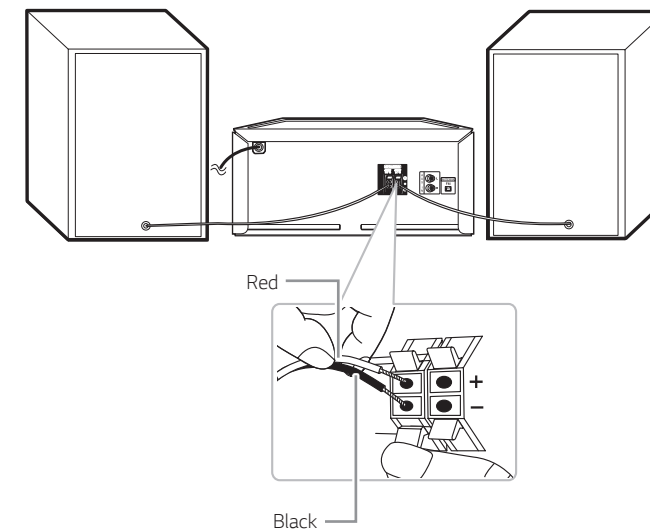

Controller App



Download the **Music Flow Bluetooth** App to your device. (Android only)

LG Sound Sync (Wireless)



For more information, download the online owner's manual. <http://www.lg.com>