

23	22	21	20	19	18	17	16	15	14	13	12	11	10	9	8	7	6	5	4	3	2	1	A0
This drawing is the property of LG and it is protected by the copyright laws and regulations.																							
CTQ Table																							
No.	CTQ Item	Unit	Target	USL	USL	Zst	Ztk																
1																							
2																							
3																							
4																							

WORK	BRAND	PRODUCT	BUYER	LANGUAGE	TOTAL PAGE	PRINTING ON LAST PAGE	WARRANTY CARD	COLOR FRONT PAGE	APPLICABLE MODEL	Cover Page Front	Cover Page Back	Dimn. 'L' (mm)	Dimn. 'W' (mm)	REMARK
06	LG	DIRECT COOL	EXPORT	ENGLISH	28	AS PER ART WORK	NO	BLACK & WHITE	ORION5 CK NEPAL EXPORT	FIG.1	FIG.1	210 ± 2	142 ± 2	ORION5 CK NEPAL

Mark	Classification	Length (mm)											
		0.5-3	3-6	6-30	30-120	120-400	400-1000	1000-2000	2000-4000				
F	Fine (S-Grade)	0.05	0.05	0.1	0.15	0.2	0.3	0.5	0.5	-	-	-	-
M	Medium (N-Grade)	0.1	0.1	0.2	0.3	0.5	0.8	1.2	2.0	3.0	4.0	-	-
C	Coarse (L-Grade)	0.2	0.3	0.5	0.8	1.2	2.0	3.0	4.0	-	-	-	-
V	Very Coarse (M-Grade)	-	0.5	1.0	1.5	2.5	4.0	6.0	8.0	-	-	-	-
Tolerance Grade		Round/Chamfer (mm)					Angle (±Degree° Minute' Second")						
Mark	Classification	0.5-3	3-6	6-	10-50	50-120	120-400	400-					
F	Fine (S-Grade)	0.2	0.5	1.0	1°	30'	20"	10'	5'				
M	Medium (N-Grade)	0.2	0.5	1.0	1°	30'	20"	10'	5'				
C	Coarse (L-Grade)	0.4	1.0	2.0	1°30'	1°	30'	15'	10'				
V	Very Coarse (M-Grade)	0.4	1.0	2.0	3°	2°	1°	30'	20'				

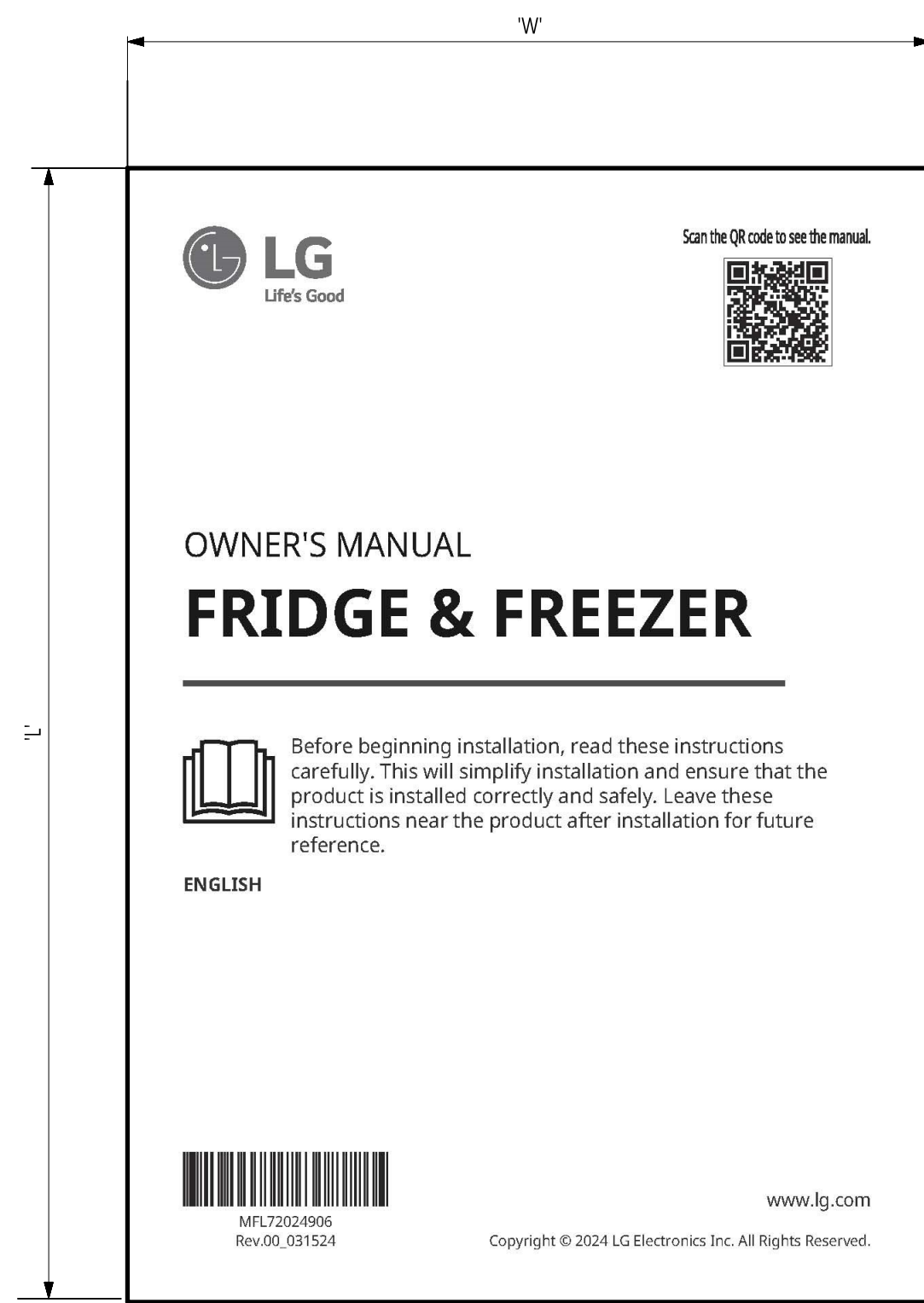

FIG.1  
FRONT PAGE

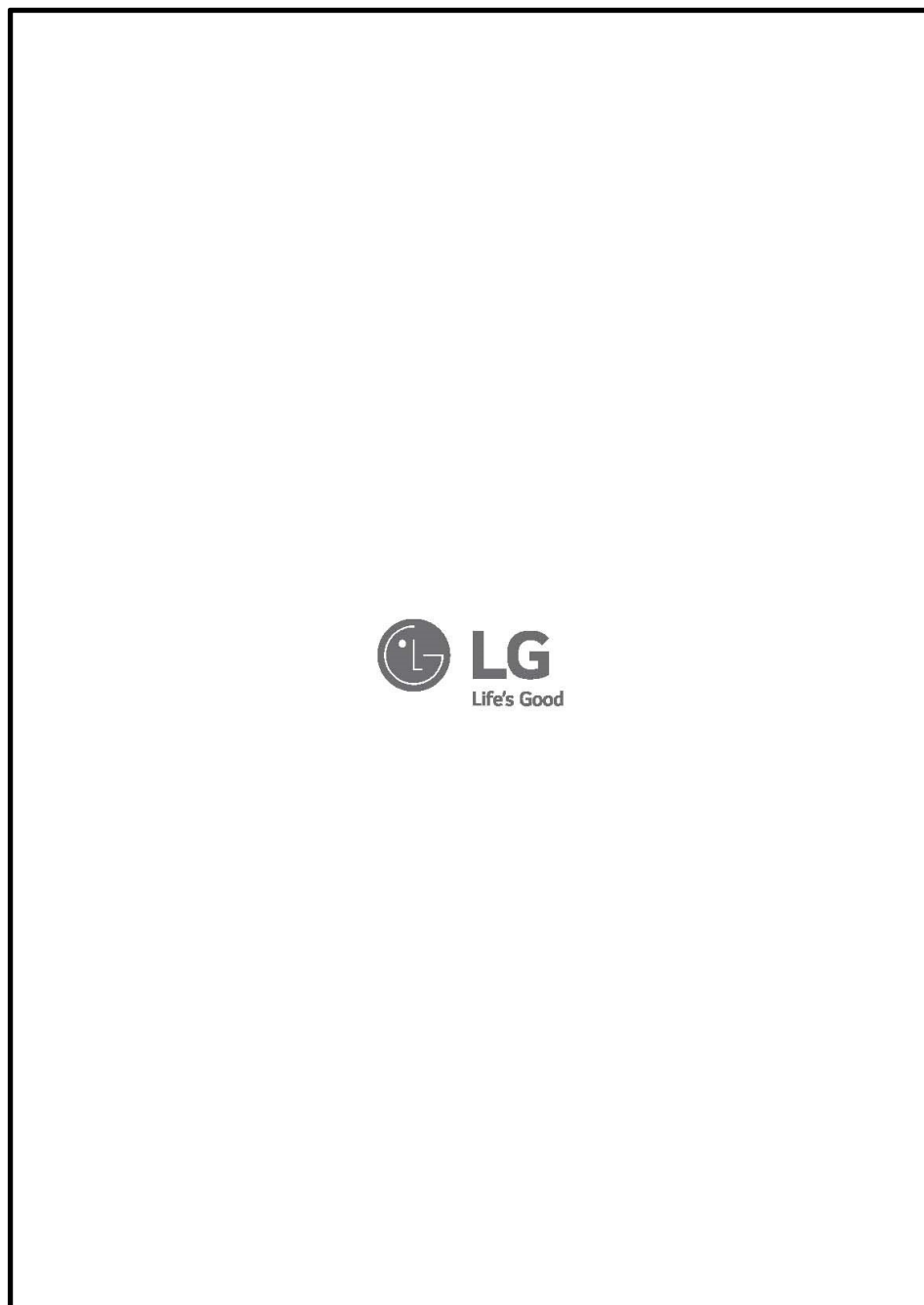

FIG.1  
BACK PAGE

- NOTES :
1. MATERIAL : SNOW WHITE PAPER 80 g/m2 ± 5%
  2. ALL PRINTING TO BE DONE IN BLACK & LG GREY COLOR AS PER R&D CONTROL COPY.
  3. INSPECTION CRITERIA AS PER CONTROLLED COPY GIVEN BY R&D
  4. (IF APPLICABLE) ANY TYPE OF PLASTIC/FOAM USED FOR PACKING SHOULD BE ABOVE 50MICRON WITH RECYCLE SYMBOL/PRINTING NOTE AS PER PWM RULE
  5. REV.NO.,REV.DATE & COPYRIGHT YEAR AS PER RESPECTIVE REV.
  6. THIS PART SHOULD COMPLY WITH THE CRITERIA OF LEVEL A-I, A-II RESTRICTED HAZARDOUS SUBSTANCES WHICH REFERS TO LGE STANDARD LG(10)-A-9023 AND THE HAZARDOUS SUBSTANCE MANAGEMENT MANUAL FOR THE SUPPLIERS.

**PWM Note**  
 "The compliance related to plastic sheet or like used for packaging should be as per the "The Plastic Waste Management Rules , 2016 as amended from time to time" and as per LG standard LG(ILN)-B-3073 as shared."

REV	REVISION	ECO NO.	DATE	SIGNED	CHK	REV	REVISION	ECO NO.	DATE	SIGNED	CHK	REV	REVISION	ECO NO.	DATE	SIGNED	CHK	CONSENT	REVISION CHECKED	UNIT	DATE	SCALE	N/S	TITLE
																				DESIGNED	REVISED	CHECKED	APPROVED	OWNER'S MANUAL
																				DRAWN	DATE	SCALE	N/S	Orion5 CK Export
																				DATE	DATE	DATE	DATE	MFL72049
																				DATE	DATE	DATE	DATE	



Scan the QR code to see the manual.



## OWNER'S MANUAL

# FRIDGE & FREEZER

---



Before beginning installation, read these instructions carefully. This will simplify installation and ensure that the product is installed correctly and safely. Leave these instructions near the product after installation for future reference.

**ENGLISH**



MFL72024906  
Rev.00\_031524

[www.lg.com](http://www.lg.com)

Copyright © 2024 LG Electronics Inc. All Rights Reserved.

# TABLE OF CONTENTS

This manual may contain images or content that may be different from the model you purchased.  
This manual is subject to revision by the manufacturer.

## SAFETY INSTRUCTIONS

READ ALL INSTRUCTIONS BEFORE USE..... 3  
WARNING ..... 3  
CAUTION ..... 9

## INSTALLATION

Before Installation ..... 11  
Levelling the Appliance ..... 12  
Turning on the Power ..... 12  
Moving the Appliance for Relocation ..... 13

## OPERATION

Before Use ..... 14  
Product Features ..... 16  
Control Panel ..... 19  
Door Basket ..... 21  
Shelf ..... 21

## MAINTENANCE

Cleaning ..... 22

## TROUBLESHOOTING

Before Calling for Service..... 23

# SAFETY INSTRUCTIONS

## READ ALL INSTRUCTIONS BEFORE USE

The following safety guidelines are intended to prevent unforeseen risks or damage from unsafe or incorrect operation of the appliance. The guidelines are separated into 'WARNING' and 'CAUTION' as described below.

### Safety Messages



This symbol is displayed to indicate matters and operations that can cause risk. Read the part with this symbol carefully and follow the instructions in order to avoid risk.



#### **WARNING**

This indicates that the failure to follow the instructions can cause serious injury or death.



#### **CAUTION**

This indicates that the failure to follow the instructions can cause the minor injury or damage to the product.

## WARNING

### **WARNING**

- To reduce the risk of explosion, fire, death, electric shock, injury or scalding to persons when using this product, follow basic precautions, including the following:

### Technical Safety

- This appliance is not intended for use by persons (including children) with reduced physical, sensory or mental capabilities, or lack of experience and knowledge, unless they have been given supervision or instruction concerning use of the appliance by a person

responsible for their safety. Children should be supervised to ensure that they do not play with the appliance.

- This appliance is intended to be used in household and similar applications such as:
  - staff kitchen areas in shops, offices and other working environments;
  - farm houses and by clients in hotels, motels and other residential type environments;
  - bed and breakfast type environments;
  - catering and similar non-retail applications.
- This appliance is not for use in portable or mobile installations, such as marine or RV uses, where it will be in motion while operating.



This symbol alerts you to flammable materials that can ignite and cause a fire if you do not take care.

- This appliance contains a small amount of isobutane refrigerant (R600a), but it is also combustible. When transporting and installing the appliance, care should be taken to ensure that no parts of the refrigerating circuit are damaged.
- The refrigerant and insulation blowing gas used in the appliance require special disposal procedures. Consult with service agent or a similarly qualified person before disposing of them.
- Do not damage the refrigerant circuit.
- If the power cord is damaged or the hole of the outlet socket is loose, it must be replaced. Do not use the power cord and contact an authorized service centre in order to avoid a hazard.
- Do not locate multiple portable socket-outlets or portable power supplies at the rear of the appliance.
- Securely plug the power plug in the outlet socket after completely removing any moisture and dust.
- Never unplug the appliance from the power supply by pulling on the power cable. Always grip the power plug firmly and pull straight out from the outlet socket.

- Keep ventilation openings, in the appliance enclosure or in the built-in structure, clear of obstruction.
- Do not store explosive substances such as aerosol cans with a flammable propellant in this appliance.
- Do not tilt the appliance to pull or push it when transporting.
- When positioning the appliance, ensure the supply cord is not trapped or damaged.
- Do not use mechanical devices or other means to accelerate the defrosting process.
- Do not use a hair drier to dry the inside of the appliance or place a candle inside to remove the odours.
- Do not use electrical appliances inside the food storage compartments of the appliance, unless they are of the type recommended by the manufacturer.
- Make sure not to get a body part such as a hand or foot stuck while moving the appliance.
- Disconnect the power cord before cleaning the appliance interior or exterior.
- Do not spray water or inflammable substances (toothpaste, alcohol, thinner, benzene, flammable liquid, abrasive, etc.) over the interior or exterior of the appliance to clean it.
- Do not clean the appliance with brushes, cloths or sponges with rough surfaces or which are made of metallic material.
- Only qualified service personnel from LG Electronics service centre should disassemble or repair the appliance.

### **Risk of Fire and Flammable Materials**

- If a leak is detected, avoid any naked flames or potential sources of ignition and air the room in which the appliance is standing for several minutes. In order to avoid the creation of a flammable gas air mixture if a leak in the refrigerating circuit occurs, the size of the room in which the appliance is used should correspond to the amount of refrigerant used. The room must be 1 m<sup>2</sup> in size for every 8 g of R600a refrigerant inside the appliance.

- Refrigerant leaking out of the pipes could ignite or cause an explosion.
- The amount of refrigerant in your particular appliance is shown on the identification plate inside the appliance.

### **Installation**

- This appliance should only be transported by two or more people holding the appliance securely.
- Install the appliance on a firm and level floor.
- Do not install the appliance in a damp and dusty place. Do not install or store the appliance in any outdoor area, or any area that is subject to weathering conditions such as direct sunlight, wind, rain, or temperatures below freezing.
- Do not place the appliance in direct sunlight or expose it to the heat from heating appliances such as stoves or heaters.
- Be careful not to expose the rear of the appliance when installing.
- Install the appliance in a place where it is easy to unplug the power plug of the appliance.
- Be careful not to let the appliance door fall during assembly or disassembly.
- Be careful not to pinch, crush, or damage the power cable during assembly or disassembly of the appliance door.
- Be careful not to point the power plug up or let the appliance lean against the power plug.
- Do not modify or extend the power cable.
- Ensure that the outlet socket is properly grounded, and that the earth pin on the power cord is not damaged or removed from the power plug. For more details on grounding, inquire at an LG Electronics customer information centre.
- This appliance is equipped with a power cord having an equipment-grounding conductor and a grounding power plug. The power plug must be plugged into an appropriate outlet socket that is installed and grounded in accordance with all local codes and ordinances.

- Never start up an appliance showing any signs of damage. If in doubt, consult your dealer.
- Dispose of all packaging materials (such as plastic bags and styrofoam) away from children. The packaging materials can cause suffocation.
- Do not plug the appliance into a multi socket adapter which does not have a power cable (mounted).
- The appliance should be connected to a dedicated power line which is separately fused.
- Do not use a multi-socket outlet which is not properly grounded (portable). It must comply with the technical specifications of the appliance and may only be used for the appliance.

## Operation

- Do not use the appliance for any purpose (storage of medical or experimental materials or shipping) other than any domestic household food storage use.
- If water penetrates electrical parts of the appliance, disconnect power plug and contact an LG Electronics customer information centre.
- Unplug the power plug during a severe thunderstorm or lightening or when not in use for a long period of time.
- Do not touch the power plug or the appliance controls with wet hands.
- Do not bend the power cable excessively or place a heavy object on it.
- Immediately unplug the power plug and contact an LG Electronics customer information centre if you detect a strange sound, odour, or smoke coming from the appliance.
- Do not place hands or metallic objects inside the area emitting the cold air, cover or heat releasing grille on the back.
- Do not apply excessive force or impact to the back cover of the appliance.
- Be careful of nearby children when you open or close the appliance door. The door may bump the child and cause injury.

- Avoid the danger of children getting trapped inside the appliance. A child trapped inside the appliance can cause suffocation.
- Do not put animals, such as pets into the appliance.
- Do not place heavy or fragile objects, containers filled with liquid, combustible substances, flammable objects (such as candles, lamps, etc.), or heating devices (such as stoves, heaters, etc.) on the appliance.
- Do not place any electronic appliance (such as heater and mobile phone) inside the appliance.
- If there is a gas leakage (isobutane, propane, natural gas, etc.), do not touch the appliance or power plug and ventilate the area immediately. This appliance uses a refrigerant gas (isobutane, R600a). Although it uses a small amount of the gas, it is still combustible gas. Gas leakage during appliance transport, installation or operation can cause fire, explosion or injury if sparks are caused.
- Do not use or store flammable or combustible substances (ether, benzene, alcohol, chemical, LPG, combustible spray, insecticide, air freshener, cosmetics, etc.) near the appliance.
- This appliance incorporates an earth connection for functional purposes.
- Connect to potable water supply only.
  - If connected to a water supply, connect to a potable water supply only.
- Fill with potable water only.
  - If using an icemaker or dispenser water tank, make sure to fill it with potable water only.

### **Disposal**

- When discarding the appliance, remove the door gasket while leaving the shelves and baskets in place and keep children away from the appliance.

## CAUTION

### CAUTION

- To reduce the risk of minor injury to persons, malfunction, or damage to the product or property when using this product, follow basic precautions, including the following:

## Installation

- After unpacking, check the appliance for any damage that may have occurred during transit.
- Wait for at least 3 to 4 hours in order to ensure the refrigerant circuit is fully efficient.
- Move the appliance carefully on sensitive floors to avoid damage to the floor.

## Operation

- Do not touch frozen food or the metal parts in the freezer compartment with wet or damp hands. It may cause frostbite.
- Do not place glass containers, bottles or cans (especially those containing carbonated drinks) in the freezer compartment, shelves or ice bucket that will be exposed to temperatures below freezing. Contents may expand when frozen, break the container and cause injury.
- The tempered glass on the front side of the appliance door or the shelves can be damaged by an impact. If it is broken, do not touch it with hands.
- Do not hang from the appliance doors, storage room, shelf or climb up into it.
- Do not store an excessive amount of water bottles or containers for side dishes on the door baskets.
- Do not open or close the appliance door with excessive force.
- If the hinge of the appliance door is damaged or operates improperly, stop using the appliance and contact an authorized service centre.

- Prevent animals from nibbling on the power cable or water hose.
- Never eat frozen foods immediately after they have been taken out in the freezer compartment. There is a risk of freezing or the formation of frost blisters. FIRST AID: Immediately hold it under cold running water. Do not pull it away.
- Make sure not to get a hand or foot stuck upon opening or closing the appliance door or door in door.

### **Maintenance**

- This appliance is equipped with maintenance-free LED interior light. Do not remove cover or LED lamp in any attempt to repair or change it. Contact an LG Electronics customer information centre.
- Do not clean glass shelves or covers with warm water when they are cold. They may shatter if exposed to sudden temperature changes.
- Do not insert the shelves upside down. The shelves may fall.
- If ice forms in the freezer compartment, please contact LG Electronics customer service. Do not use sharp-edged objects to remove any frost or ice build-up. Do not use sprays, electric heating devices such as fan heaters, hair dryers, steam cleaners or other heat sources for defrosting. Plastic parts could deform.
- Dispose of the ice inside the ice bucket in the freezer compartment during an extended power outage.

# INSTALLATION

## Before Installation

### Dimensions and Clearances

Too small of a distance from adjacent items may result in the degradation of freezing capability and increased electricity costs. Allow over 50 mm of clearance between the back of the appliance and the wall when installing the appliance.

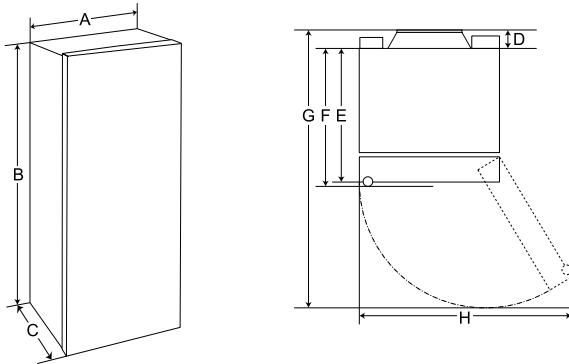

-	Remark	Size (mm)				
		a	b	c	d	e
A		537	537	534	534	565
B	w/o Base Stand	1142	1142	1172	1172	1217
	w Base Stand	1247	1247	1277	1277	1322
C	w/o Handle	598	616	603	621	668
	w Handle	638	656	632	650	700
D		20	38	20	38	38
E		578	578	583	583	630
F		618	618	612	612	662
G		1059	1077	1049	1067	1145
H	w/o Handle	913	913	891	891	943

## 12 INSTALLATION

### NOTE

- You can determine what type of appliance it is by looking at the label inside the appliance.

## Ambient Temperature

- The appliance is designed to operate within a limited range of ambient temperatures, depending on the climate zone.
- The internal temperatures could be affected by the location of the appliance, the ambient temperature, the frequency of door opening and so on.
- The climate class can be found on the rating label.

Climate Class	Ambient Temperature Range °C
SN (Extended Temperate)	+10 - +32
N (Temperate)	+16 - +32
ST (Subtropical)	+16 - +38 / +18 - +38**
T (Tropical)	+10 - +43* / +16 - +43 / +18 - +43**

\* Australia, India, Kenya

\*\* Argentina

### NOTE

- The appliances rated from SN to T are intended to be used at an ambient temperature between 10 °C and 43 °C.

## Levelling the Appliance

### Adjusting the Levelling Leg

If the appliance seems unsteady, or the doors do not close easily, adjust the appliance's tilt using the instructions below.

- Turn the levelling leg clockwise to raise that side of the appliance or counterclockwise to lower it.

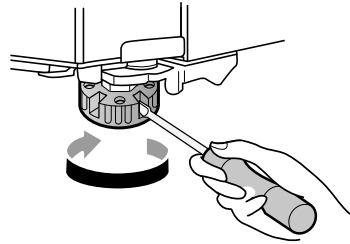

- Open the doors and check to make sure that they close easily.

### NOTE

- In case of Base stand models, levelling of the fridge should be done with front legs of Base stand.
- Levelling the doors may not be possible when the floor is not leveled, or is of weak or poor construction.
- The refrigerator is heavy and should be installed on a rigid and solid surface.
- Some timber flooring may cause levelling difficulties if it flexes excessively.

## Turning on the Power

### Connecting the Appliance

To turn on the appliance, connect the power plug into the outlet socket. Do not double up with other appliances on the same outlet.

### NOTE

- After connecting the power supply cord (or plug) to the outlet, wait 3 or 4 hours before you put

food into the appliance. If you add food before the appliance has cooled completely, your food may spoil.

- To turn off the appliance, disconnect the power plug from the outlet socket.

## Moving the Appliance for Relocation

### Moving the Appliance

- 1 Remove all food from inside the appliance.
- 2 Fix the power plug.
  - Models with a power plug hook:  
Pull the power plug out, insert and fix it into the power plug hook at the rear or on top of the appliance.
  - Models without a power plug hook:  
Pull the power plug out and fix the power supply cable with a tape to the side of the appliance where the power socket is located at the installation site.
- 3 Tape parts such as shelves and the door handle to prevent from falling off while moving the appliance.
- 4 Move the appliance with more than two people carefully. When transporting the appliance over a long distance, keep the appliance upright.

- Do not move the appliance in zigzags.

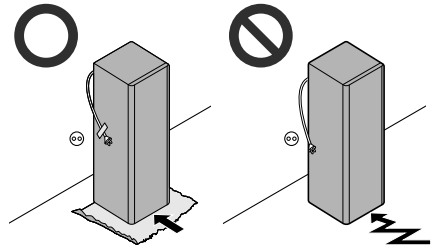

- 5 After installing the appliance, connect the power plug into a mains outlet socket and switch it on.

### **⚠ CAUTION**

- Move the appliance carefully on sensitive floors to avoid damage to the floor.
- Use cardboard, floor mat or carpet to prevent scratches on the floor when installing or moving the appliance.

# OPERATION

## Before Use

### Notes for Operation

- Before placing food in the appliance, clean the inside and outside of the appliance with warm water and a mild washing-up liquid to remove manufacturing residues.
- Users should keep in mind that frost can form if the door is not closed completely or if the humidity is high during the summer.
- Ensure there is sufficient space between food stored on the shelf or door basket to allow the door to close completely.
- Opening the door for long periods can cause a significant increase of the temperature in the compartments of the appliance.
- If the refrigerating appliance is left empty for long periods, switch off, defrost, clean, dry, and leave the door open to prevent mould developing within the appliance.
- Note that a temperature rise after defrosting has a permissible range in the appliance specifications. If you wish to minimise the impact on the food storage due to a temperature rise, seal or wrap the stored food in several layers.

## Door Open Alarm

This feature is only available on some models. The alarm sounds if the door is left open or not completely closed.

---

### NOTE

- Contact the LG Electronics customer information centre if the alarm sound continues even after closing all doors.
- 

## Failure Detection

This feature is only available on some models. The appliance can automatically detect problems during the operation.

---

### NOTE

- If a problem is detected, the appliance may not operate and an error code is displayed even when any button is pressed.
  - If an error code is indicated on the display, do not turn off the power. Immediately contact the LG Electronics customer information centre and report the error code. If you turn off the power, the repair technician from the our information centre may have difficulty finding the problem.
- 

## Suggestion for Energy Saving

- For the most efficient use of energy, keep all inner parts (e.g. door bins, drawers and shelves) on their original location.
- Ensure there is sufficient space between stored foods. This allows cold air to be circulated evenly and lowers electricity bills.
- Store hot food only after it has cooled in order to prevent dew or frost.
- When storing food in the freezer compartment, set the freezer temperature lower than the temperature indicated on the food.
- Do not set the temperature of the appliance lower than needed.
- Do not put food near the temperature sensor of the fridge compartment. Keep a distance of at least 3 cm from the sensor.

## Storing Foods Effectively

- Food may freeze or spoil if stored at the wrong temperature. Set the refrigerator to the correct temperature for the food being stored.
- Store frozen food or refrigerated food inside sealed containers.
- Check the expiration date and label (storage instructions) before storing food in the appliance.

- Do not store food for a long period of time if it spoils easily at a low temperature.
- Do not place unfrozen food in direct contact with food that is already frozen. Do not store excessive amounts of fresh food.
  - If you want to freeze food over several days, only store up to about 2/3 of the maximum freezing capacity.
- Freeze food in portion-sized quantities for faster freezing, easier thawing and processing.
- Place the refrigerated food or frozen food in each fridge or freezer compartment immediately after purchasing.
- Store raw meat and fish in suitable containers in the refrigerator, so that it is not in contact with or drip onto other food.
- Refrigerated foods and other food items can be stored on top of the vegetable drawer.
- Avoid refreezing any food which has been completely thawed. Freezing any food which has been completely thawed again will lower its taste and nutrition.
  - Only take out the amount of food that you need. Consume thawed food quickly. It can only be refrozen after being cooked.
- Cool hot food before storing. If too much hot food is placed inside, the internal temperature of the appliance can increase and negatively affect other foods stored in the appliance.
- Do not overfill the appliance. Cold air can not circulate properly if the appliance is overfilled.
- If you set an excessively low temperature for food, it may become frozen. Do not set a temperature lower than the required temperature for the food to be stored correctly.
- If there are chill compartments in the appliance, do not store vegetables and fruits with higher moisture content in the chill compartments as they may freeze due to the lower temperature.
- Always follow the food manufacturer's instructions on the permissible storage duration of frozen food. Do not exceed the recommended storage time of food.
  - Mark the storage date, permissible storage duration, and the food name on the packaging to prevent it from exceeding the storage time limit.
- In the event of a blackout, call the electricity company and ask how long it is going to last.
  - You should avoid door openings while the power is off.
  - When the power supply gets back to normal, check the condition of the food.
  - If the power outage lasts longer, especially during the summer months, please follow these guidelines:
    - Do not place additional food into the appliance during the power outage.
    - If the power outage is announced and is expected to last for more than 10 hours, prepare some ice and put it in a container on the top shelf of the fridge.
    - Due to the temperature increase in the appliance during a power outage or other malfunction, the shelf life of the food will be reduced and its quality will decrease. If necessary, process thawed food and freeze it again in the cooked state.

## Product Features

The appearance or components of the appliance may differ from model to model.

### Interior

\*1 This feature is only available on some models.

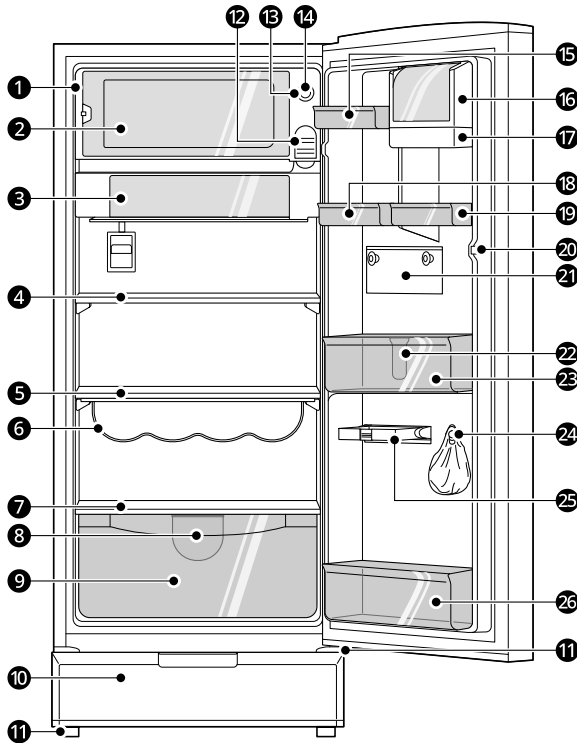

**1** Evaporator Frame

**2** Evaporator Door

**3** Chiller Tray

**4** Upper Shelf

**5** Lower Shelf

**6** Bottle Holder\*<sup>1</sup>

Pull down the bottle holder to store up to four numbers of one liter water bottles. Fold it when not in use.

**7** Cell Fresh Crisper\*<sup>1</sup>

Holds moisture, helps to keep vegetables fresh, and prevents them from getting rotten.

**8 Soft Tray Veg.\*<sup>1</sup>**

Stores small vegetables such as lemon, chilly, coriander etc.  
This is placed in the Vegetable Tray.

**9 Vegetable Tray**

Used to store food and vegetables. (Storage capacity varies with model)

**10 Base Stand with drawer \*<sup>1</sup>**

Max. storage space is 5 kg in the base stand drawer.  
Store dry vegetables only such as potato, onion, etc.

**11 Adjustable Leg****12 Lamp 10 watt / LED****13 Temperature Control Knob**

Specially designed knob gives you the facility to control temperature inside the fridge.

**14 Defrost Button**

Defrost button can be used for removing the excess frost and ice from freezer components. For better Efficiency of refrigerator, push the defrost knob after every 3 days/ ice level reaches defrost indicator.

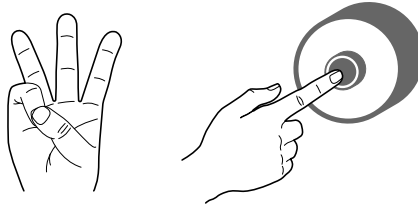
**15 Small Basket\*<sup>1</sup>****16 Cosmetics Box\*<sup>1</sup>**

Specified storage location for cosmetics and medicines.  
Store only medicines which can be placed in the fridge.

**17 Small Basket\*<sup>1</sup>****18 Small Basket****19 Small Basket\*<sup>1</sup>****20 Lock\*<sup>1</sup>****21 Zip Pouch\*<sup>1</sup>**

Pouch is a Nylon bag with a zip that helps to store small items like lemon, ginger, coriander etc.  
Unzip to keep items and zip after keeping items.

**22 Bottle Guide\*<sup>1</sup>****23 Large Basket****24 Bag Holder\*<sup>1</sup>**

Helps for hanging the items with a polythene bag.

### 25 Flip Basket\*<sup>1</sup>

Flip down the basket to keep small items less than 0.5 kg only.

Flip up the basket to store 2 liter bottles in the lower basket.

### 26 Large Basket

#### Additional Features

- Egg Cum Ice Tray\*<sup>1</sup>: Specified storage location for eggs. It can also be used to make the ice in the freezer.
- Door Lock: Serviceable type lock, press the key inside for 'Lock and unlock'.
- Anti-Bacterial Gasket: An effective Anti Bacterial Gasket that prevents bacterial growth within the fridge.
- Handle type : Strong elegant handles with better grip with good locks and sturdiness.

## Control Panel

The actual control panel may differ from model to model.

### Control Panel and Functions

\*1 This control panel is only available on some models.

#### Type A: For Knob Control Model\*1

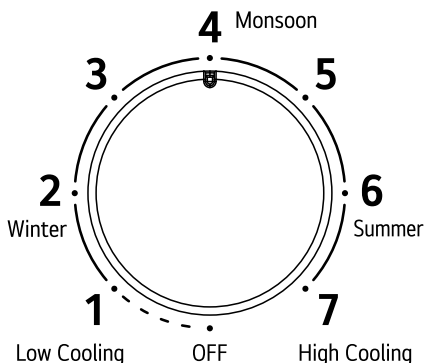

#### Knob dial Setting

Specially designed knob gives you the facility to control the temperature inside the fridge.

- Turn the dial to select a desired temperature between 1 (Cold) and 7 (Coldest).
- Before loading, let refrigerator run for 12 hrs. in No. 4 position.

12+  
Hours

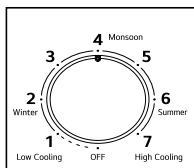

- Winter Season

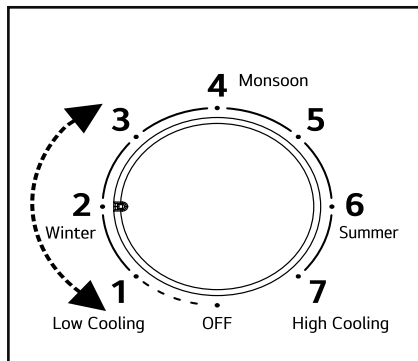

- Monsoon Season

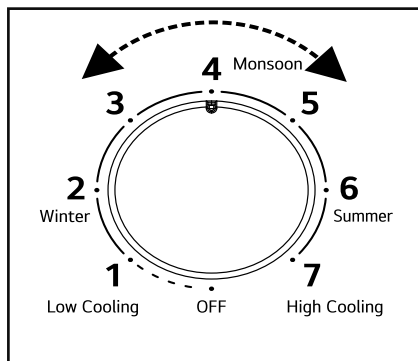

- Temperature setting as per shown picture.

- Summer Season

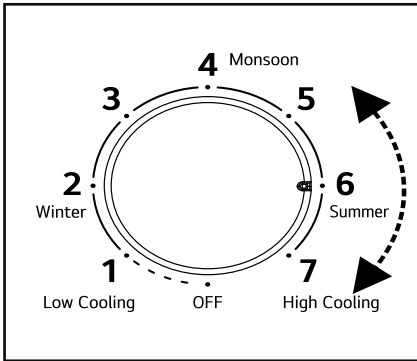

off automatically once optimum temperature is achieved.

### NOTE

- In case of power cut, the refrigerator will come out of 'Express Cool' mode.

### ③ Defrost

Press and hold the button for 3 seconds in case of excess ice. For best performance of the fridge, press the button every three days.

### ④ Lock

Lock feature is provided to lock the display controls.

Hold the button for 3 seconds to activate the function. To deactivate, press the button again for 3 seconds.

### ⑤ Smart Connect

Auto Smart feature implies that the appliance is capable of automatically switching to backup power sources in absence of regular power source. LED light on means Backup Power source in use.

### NOTE

- Minimum Requirement for smart Connect: UPS / Inverter should be in ON condition having minimum 600VA capacity along with minimum 120Ah capacity battery connected with the fridge's power supply socket.
- While using this feature, the fridge will work on basic energy requirement as required by the product.
- The results of the smart Connect feature may vary depending on the number of appliances that are running on inverter.
- For optimum running of fridge during Smart Connect Mode, it is recommended to switch off the other appliances which are not in use.
- It is recommended to confirm the quality of food items before consumption.

### Type B: For Display Model\*1

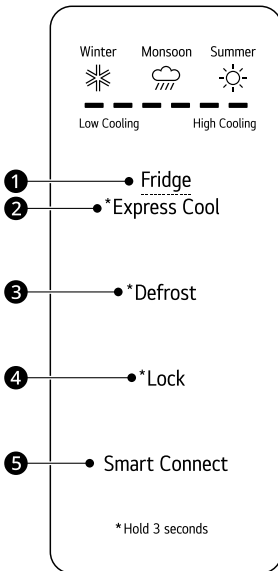

### ① Fridge

Press **Fridge** button to control the fridge temperature.

### ② Express Cool

Express Cool is provided for fast cooling and quick ice making. Press and hold **Express Cool** for 3 seconds. In this mode, the compressor operates at maximum cooling capacity to quickly lower the fridge temperature. It shuts

## Door Basket

### Removing/Refitting the Door Basket

- 1 Hold both edges of the basket and remove it by lifting it upward.

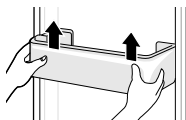

- 2 Refit the door basket in the reverse order of the removal process.

## Shelf

### Removing/Refitting the Shelf

- 1 Hold the both side of the shelf. Lift the shelf up and remove it by pulling it out.

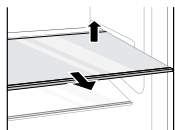

- 2 Refit the shelf by sliding it inward until the shelf snaps into the frame.

# MAINTENANCE

## Cleaning

### General Cleaning Tips

- Performing manual defrosting, maintenance or cleaning of the appliance while food is stored in the freezer can raise the temperature of the food and reduce its storage life.
- Regularly clean any surfaces that can come in contact with food.
- When cleaning the inside or outside of the appliance, do not wipe it with a rough brush, toothpaste, or flammable materials. Do not use cleaning agents containing flammable substances. This may cause discolouration or damage to the appliance.
  - Flammable substances: alcohol (ethanol, methanol, isopropyl alcohol, isobutyl alcohol, etc.), thinner, bleach, benzene, flammable liquid, abrasive, etc.
- After cleaning, check if the power cable is damaged.

### Cleaning the Exterior

- When cleaning the outside air vents of the appliance by means of vacuuming, then the power cord should be unplugged from the outlet to avoid any static discharge that can damage the electronics or cause an electric shock. Regular cleaning of the rear and side ventilation covers is recommended to maintain reliable and economical operation of the unit.
- Keep the air vents on the exterior of the appliance clean. Blocked air vents can cause fire or appliance damage.
- For the appliance exterior, use a clean sponge or soft cloth and a mild detergent in warm water. Do not use abrasive or harsh cleaners. Dry thoroughly with a soft cloth. Do not use contaminated cloths when cleaning the stainless steel doors. Always use a dedicated cloth and wipe in the same direction as the grain. This helps reduce surface staining and tarnishing.

## Cleaning the Interior

- Before removing a shelf or drawer from inside the appliance, remove all stored foods from the shelf or drawer to prevent injury or damage to the appliance. Otherwise, injury may occur due to the weight of stored foods.
- Detach the shelves and drawers and clean them with water and a mild detergent, and then dry them sufficiently, before replacing them.
- Regularly wipe the door gaskets with a wet soft towel.
- Door basket spills and stains should be cleaned as they can compromise storage ability of the basket and could even be damaged.
- Never clean the shelves or containers in the dishwasher. The parts may become deformed due to the heat.
- The automatic defrosting system in the appliance ensures that the compartment remains free of ice buildup under normal operating conditions. Users do not need to defrost it manually.

# TROUBLESHOOTING

## Before Calling for Service

### Cooling

Symptoms	Possible Cause & Solution
There is no refrigeration or freezing.	<b>Is there a power interruption?</b> <ul style="list-style-type: none"> <li>Check the power of other appliances.</li> </ul>
	<b>Appliance is unplugged.</b> <ul style="list-style-type: none"> <li>Plug the power plug in the outlet properly.</li> </ul>
	<b>A fuse in your home may be blown or the circuit breaker tripped. Or the appliance is connected to a GFCI (Ground Fault Circuit Interrupter) outlet, and the outlet's circuit breaker has tripped.</b> <ul style="list-style-type: none"> <li>Check the main electrical box and replace the fuse or reset the circuit breaker. Do not increase fuse capacity. If the problem is a circuit overload, have it corrected by a qualified electrician.</li> <li>Reset the circuit breaker on the GFCI. If the problem persists, contact an electrician.</li> </ul>
There is poor refrigeration or freezing.	<b>Is the fridge or freezer temperature set to its warmest setting?</b> <ul style="list-style-type: none"> <li>Set the fridge or freezer temperature to a colder setting.</li> </ul>
	<b>Is the appliance in direct sunlight, or is it near a heat generating object such as cooking oven or heater?</b> <ul style="list-style-type: none"> <li>Check the installation area and reinstall it away from heat generating objects.</li> </ul>
	<b>Did you store hot food without cooling it first?</b> <ul style="list-style-type: none"> <li>Cool the hot food first before putting it in the fridge or freezer compartment.</li> </ul>
	<b>Did you put in too much food and restrict air circulation?</b> <ul style="list-style-type: none"> <li>Maintain an appropriate space between food.</li> <li>Provide space in between the dishes. If the shelves are covered with cloth or polythene, remove it.</li> </ul>
	<b>Are the appliance doors completely closed?</b> <ul style="list-style-type: none"> <li>Completely close the door and make sure that stored food is not obstructing in the door.</li> </ul>
	<b>Is there enough space around the appliance?</b> <ul style="list-style-type: none"> <li>Adjust the installation position to make enough space around the appliance.</li> </ul>

Symptoms	Possible Cause & Solution
<b>The appliance contains a bad smell.</b>	<b>Is the fridge or freezer temperature set to 'Warm'?</b> <ul style="list-style-type: none"> <li>Set the fridge or freezer temperature to a colder setting.</li> </ul>
	<b>Did you put in food with a strong smell?</b> <ul style="list-style-type: none"> <li>Store foods with strong smells in sealed containers.</li> </ul>
	<b>Vegetables or fruit may have spoiled in the drawer.</b> <ul style="list-style-type: none"> <li>Throw away rotten vegetables and clean the vegetable drawer. Do not store vegetables too long in the vegetable drawer.</li> </ul>
	<b>Improper covering and wrapping of food</b> <ul style="list-style-type: none"> <li>Wrap and cover food items properly. Place caps on bottles and other liquids stores. If the smell persists, defrost the refrigerator, remove all food items, clean the refrigerator thoroughly and wipe it dry before restarting.</li> </ul>
<b>Refrigerator does not work.</b>	<b>Thermostat switch in 'OFF' position</b> <ul style="list-style-type: none"> <li>Check that the thermostat knob is on 'Normal' (No.4) position and not in OFF position.</li> </ul>

## Water

Symptoms	Possible Cause & Solution
<b>Water does not come out.</b>	<b>The water dispenser tank may be empty. (Non plumbed models only)</b> <ul style="list-style-type: none"> <li>Fill the water dispenser tank.</li> </ul>

## Condensation & Frost

Symptoms	Possible Cause & Solution
<b>There is condensation inside the appliance or on the bottom of the vegetable drawer cover.</b>	<b>Did you store hot food without cooling it first?</b> <ul style="list-style-type: none"> <li>Cool the hot food first before putting it inside the fridge or freezer.</li> </ul>
	<b>Did you leave the appliance door open?</b> <ul style="list-style-type: none"> <li>Although the condensation will disappear soon after you close the appliance door, you can wipe it with a dry cloth.</li> </ul>
	<b>Do you open and close the appliance door too frequently?</b> <ul style="list-style-type: none"> <li>Condensation can form due to the temperature difference from the outside. Wipe out the dampness with a dry cloth.</li> </ul>

Symptoms	Possible Cause & Solution
There is condensation inside the appliance or on the bottom of the vegetable drawer cover.	<p><b>Did you put warm or moist food inside without sealing it in a container?</b></p> <ul style="list-style-type: none"> <li>Store food in a covered or sealed container.</li> </ul>
Frost or condensation has formed inside or outside the appliance.	<p><b>Did you open and close the appliance door frequently or is the appliance door improperly closed?</b></p> <ul style="list-style-type: none"> <li>Frosts or condensation can form if the outside air penetrates inside the appliance.</li> </ul>
	<p><b>Is the installation environment humid?</b></p> <ul style="list-style-type: none"> <li>Condensation can appear on the exterior of the appliance if the installation area is too humid or on a humid day such as a rainy day. Wipe off any moisture with a dry cloth.</li> </ul>
	<p><b>Hot and humid climate</b></p> <ul style="list-style-type: none"> <li>In hot and humid weather the moist air rushes inside whenever the refrigerator door is opened. This results in excess frosting on the evaporator and condensation on the chiller tray bottom. Avoid too frequent door openings.</li> </ul>
The side or front of the appliance is warm.	<p><b>There are anti condensation pipes fitted to these areas of the appliance to reduce condensation forming from around the door area.</b></p> <ul style="list-style-type: none"> <li>The heat releasing pipe to prevent condensation is installed on the front and side of the appliance. You may feel it particularly hot right after the appliance is installed or during the summer. You can be assured that this is not a problem and is quite normal.</li> </ul>
There is water inside or outside of the appliance.	<p><b>Is there water leakage around the appliance?</b></p> <ul style="list-style-type: none"> <li>Check if the water has leaked from a sink or another place.</li> </ul>
	<p><b>Is there water on the bottom of the appliance?</b></p> <ul style="list-style-type: none"> <li>Check if the water is from the thawed frozen food or a broken or dropped container.</li> </ul>
	<p><b>High Humidity during monsoon season</b></p> <ul style="list-style-type: none"> <li>During the monsoon, when the humidity in the atmosphere reaches around 90%, water droplets may form around the sides of the refrigerator cabinet, especially the top portion. This moisture should be wiped off periodically. Contact our serviceman to check the door seal or proper and uniform contact with the cabinet.</li> </ul>

## Parts & Features

Symptoms	Possible Cause & Solution
The appliance door is not closed tightly.	<p><b>Is the appliance leaning forward?</b></p> <ul style="list-style-type: none"> <li>Adjust the front feet to raise the front side slightly.</li> </ul>

Symptoms	Possible Cause & Solution
The appliance door is not closed tightly.	<b>Were the shelves properly assembled?</b> <ul style="list-style-type: none"> <li>Refit the shelves if needed.</li> </ul>
	<b>Did you close the door with excessive force?</b> <ul style="list-style-type: none"> <li>If you apply too much force or speed when closing the door, it may remain briefly open before closing. Make sure that you do not slam the door closed. Close without force.</li> </ul>
It is difficult to open the appliance door.	<b>Did you open the door right after you closed it?</b> <ul style="list-style-type: none"> <li>If you try to open the appliance door within one minute after you closed it, you may have difficulties because of the pressure inside the appliance. Try to open the appliance door again in a few minutes so that the internal pressure stabilizes.</li> </ul>
The inside lamp in the appliance does not turn on.	<b>Lamp failure</b> <ul style="list-style-type: none"> <li>Close the door and re-open. If the lamp does not turn on, please contact the LG Electronics customer information centre. Do not attempt removal of the lamp.</li> </ul>

## Noises

Symptoms	Possible Cause & Solution
The appliance is noisy and generates abnormal sounds.	<b>Is the appliance installed on a weak floor or improperly levelled?</b> <ul style="list-style-type: none"> <li>Install the appliance on a solid and flat area.</li> </ul>
	<b>Does the rear of the appliance touch the wall?</b> <ul style="list-style-type: none"> <li>Adjust the installation position to allow enough clearance around the appliance.</li> </ul>
	<b>Are objects scattered behind the appliance?</b> <ul style="list-style-type: none"> <li>Remove the scattered objects from behind the appliance.</li> </ul>
	<b>Normal Cut-off/cut-in noise</b> <ul style="list-style-type: none"> <li>Whenever the refrigerator starts and stops there is a noise of thermostat cut-off/cut-in and Compressor start/stop. This is a normal phenomenon.</li> </ul>
	<b>Is there an object on top of the appliance?</b> <ul style="list-style-type: none"> <li>Remove the object on top of the appliance.</li> </ul>
Clicking noises	<b>The defrost control will click when the automatic defrost cycle begins and ends. The thermostat control (or appliance control on some models) will also click when cycling on and off.</b> <ul style="list-style-type: none"> <li>Normal Operation</li> </ul>
Rattling noises	<b>Appliance is not resting evenly on the floor.</b> <ul style="list-style-type: none"> <li>Floor is weak or uneven or levelling legs need to be adjusted.</li> </ul>

Symptoms	Possible Cause & Solution
<b>Rattling noises</b>	<b>Appliance with a compressor was moved while operating.</b> <ul style="list-style-type: none"><li>• Normal operation. If the compressor does not stop rattling after three minutes, turn the power to the appliance off and then on again.</li></ul>
<b>Gurgling noises</b>	<b>Appliance flowing through the cooling system.</b> <ul style="list-style-type: none"><li>• Normal Operation</li></ul>
<b>Popping noises</b>	<b>Contraction and expansion of the inside walls due to changes in temperature.</b> <ul style="list-style-type: none"><li>• Normal Operation</li></ul>
<b>Vibrating</b>	<b>If the side or back of the appliance is touching a cabinet or wall, some of the normal vibrations may make an audible sound.</b> <ul style="list-style-type: none"><li>• To eliminate the noise, make sure that the sides and back do not make any contact with any wall or cabinet.</li></ul>
<b>Noise from freezer</b>	<b>Hissing noise from Freezer</b> <ul style="list-style-type: none"><li>• This is normal gas expansion noise.</li></ul>

