

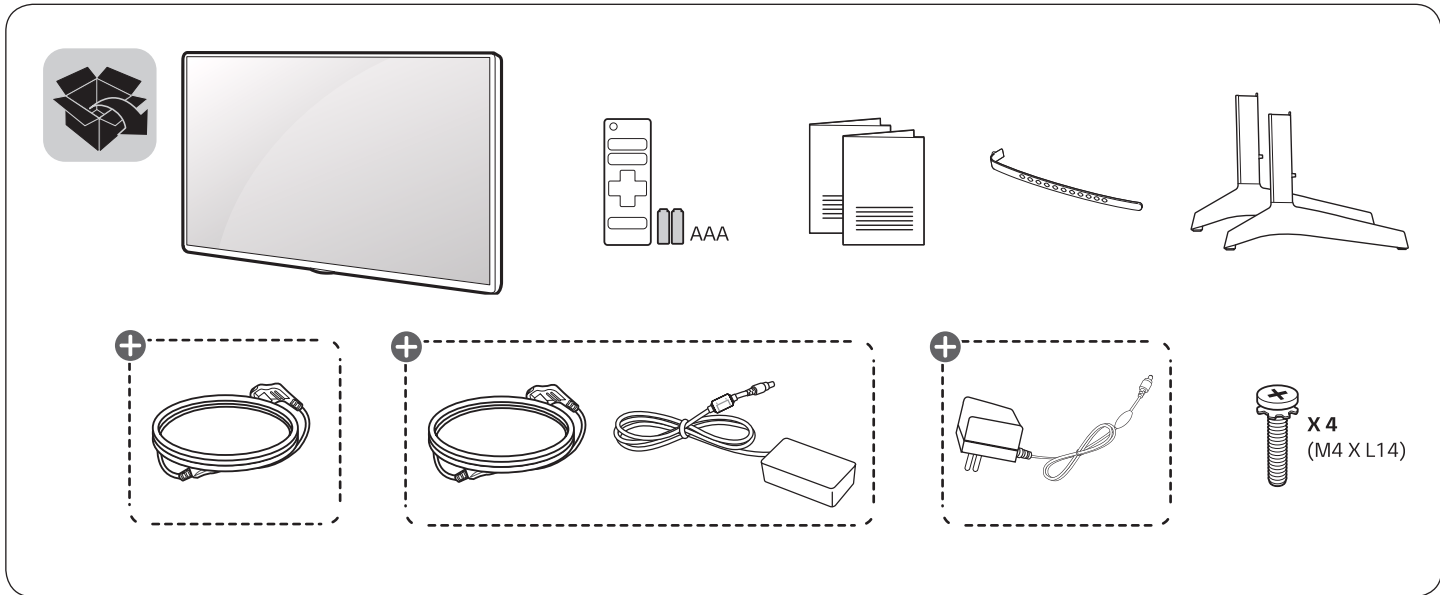

# Quick Start Guide

LED TV  
LH57\*\*  
LH59\*\*



⊕ : Depending on model.



[www.lg.com](http://www.lg.com)

## Unpacking

Check your product box for the following items. If there are any missing accessories, contact the local dealer where you purchased your product. The illustrations in this manual may differ from the actual product and item.

\*Images may vary depending on models.

P/NO : MFL69446123(1603-REV01)



English

- Read **Safety and Reference**.
- For the power supply and power consumption, refer to the label attached to the product.

## USING THE USER GUIDE

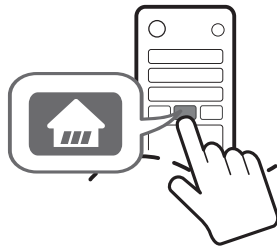

Press the  button  
To access home button.



Navigate & Select  
User Guide.



Refer User Guide for  
Detail information

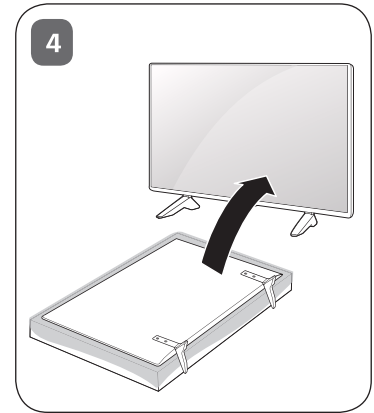
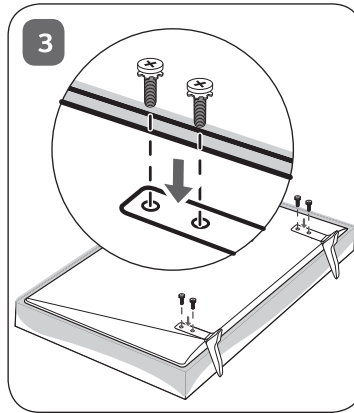
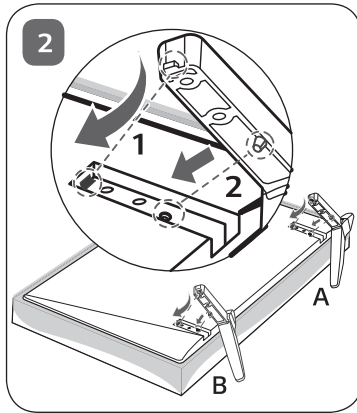
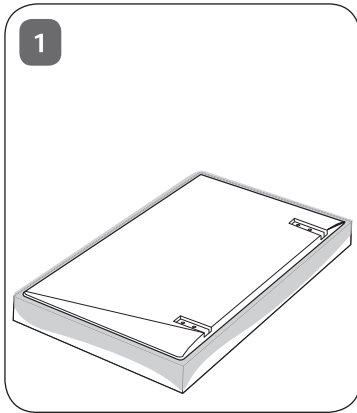

 **CAUTION**

Image shown may differ from your TV.

When attaching the stand to the TV set, place the screen facing down on a cushioned table or flat surface to protect the screen from scratches.



ANTENNA/  
CABLE IN

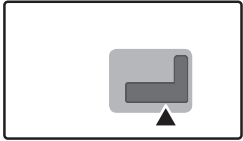
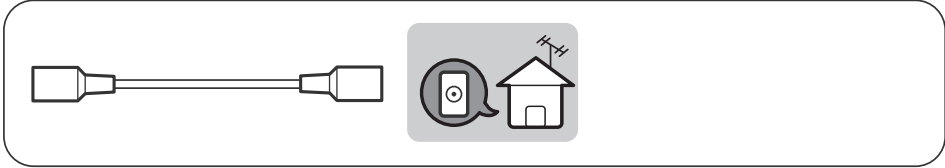

HDMI IN

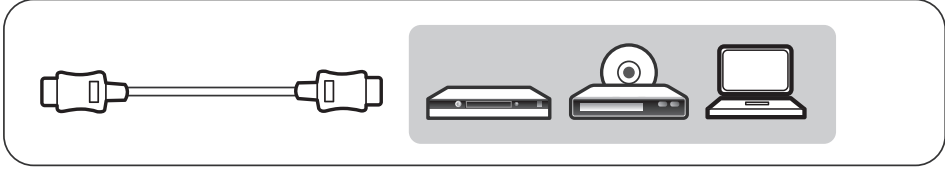

+  
HDMI IN/ARC

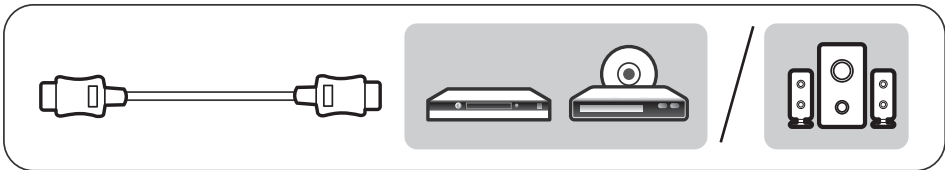

USB IN

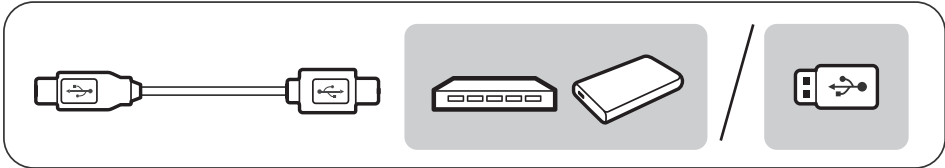

LAN

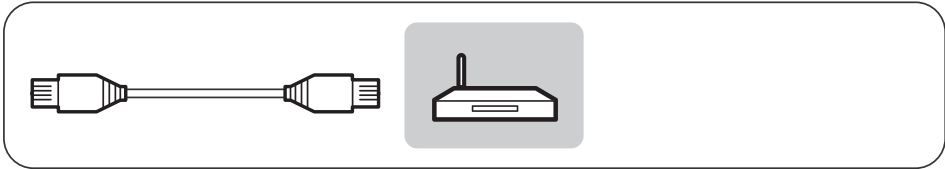

**NOTE**  
Image shown may vary depending on model.  
All connection cables & devices shown in the picture are not included along with the TV set.

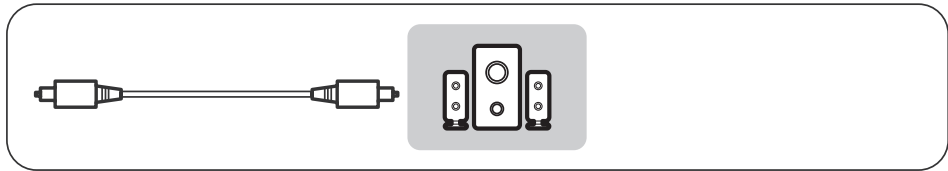
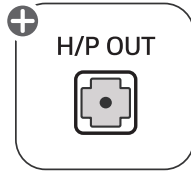
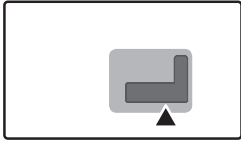

(\*Features may vary depending on models)

⊕ : Depending on model.

#### ARC (Audio Return Channel)

- An external audio device that supports SIMPLINK and ARC must be connected using HDMI IN 2 (ARC) port.
- When connected with a high-speed HDMI cable, the external audio device that supports ARC outputs SPDIF audio without additional audio cable and supports the SIMPLINK function.

#### ! NOTE

Image shown may vary depending on model.  
All connection cables & devices shown in the picture are not included along with the TV set.

#### ! NOTE

Some USB Hubs may not work. If a USB device connected using a USB Hub is not detected, connect it to the USB port on the TV directly.  
Connect the external power source if your USB is needed.

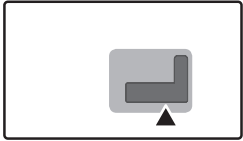

### COMPONENT IN

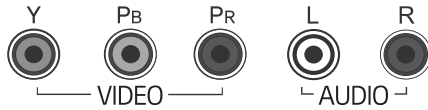
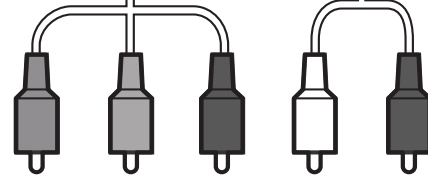
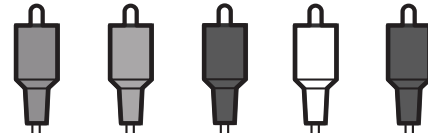
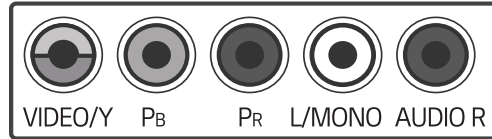

### AV IN

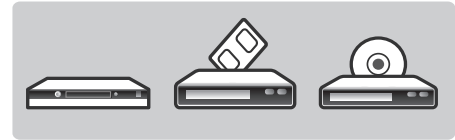
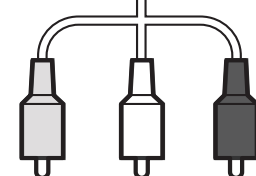
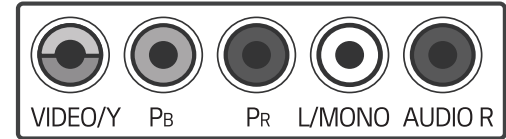

**NOTE**

Image shown may vary depending on model.  
All connection cables & devices shown in the picture are not included along with the TV set.

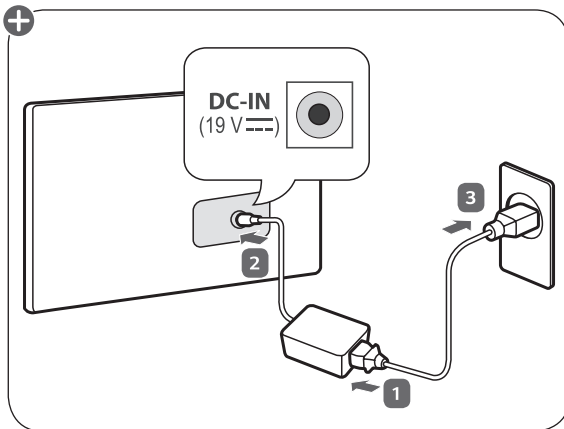
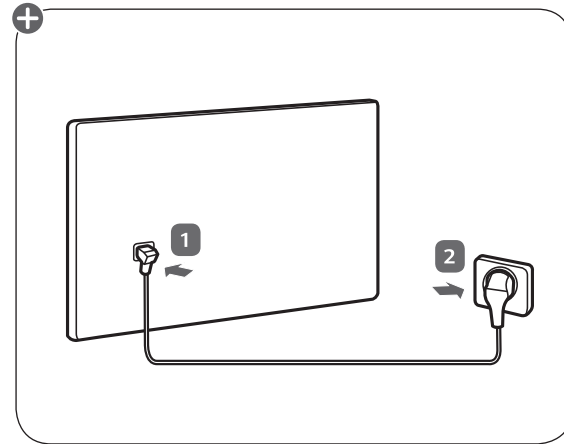
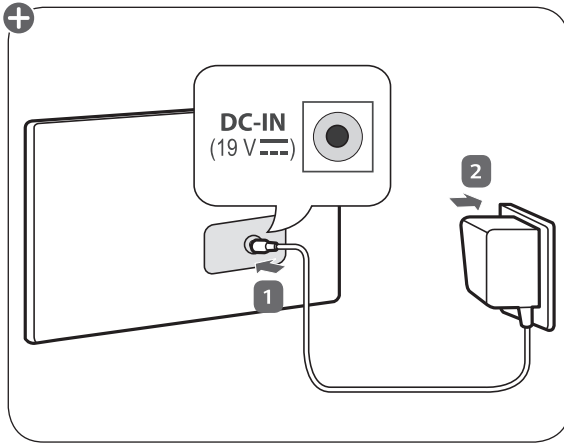

+: Depending on model.

**NOTE**

Image shown may vary depending on model.

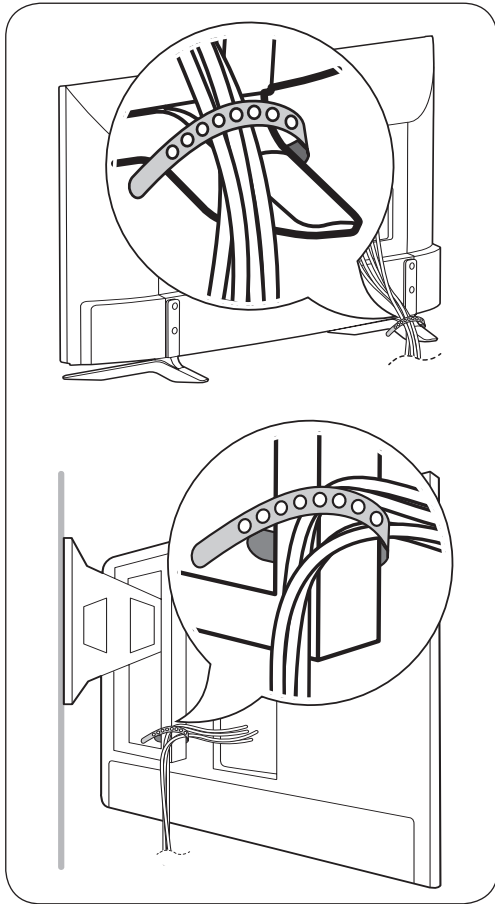

**NOTE**  
Image shown may vary depending on model.

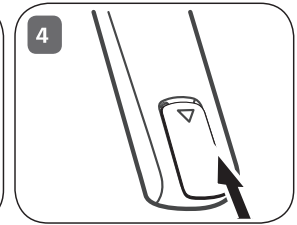
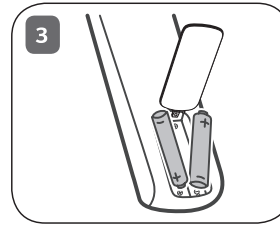
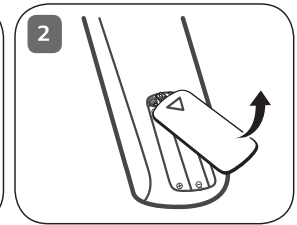
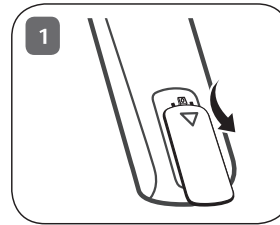

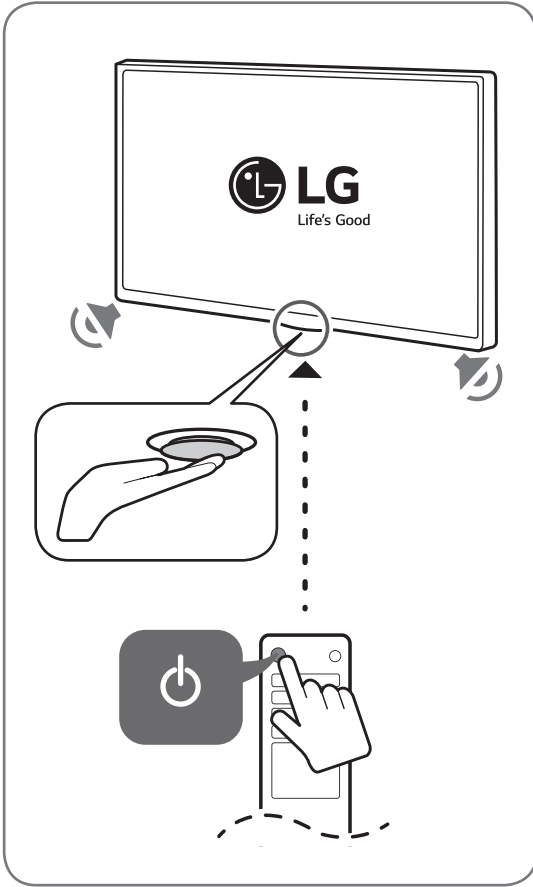

**NOTE**

Image shown may vary depending on model.

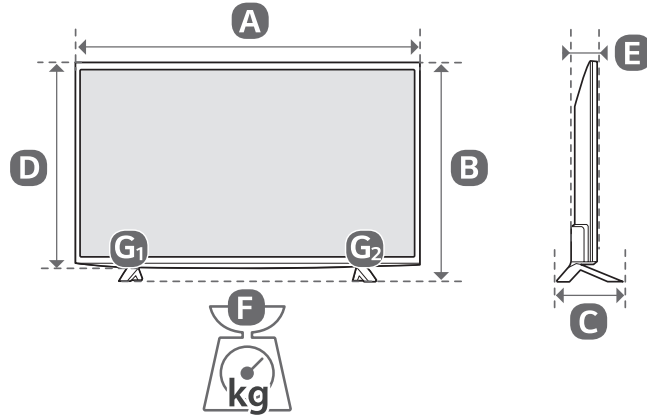

	<b>A</b> (mm)	<b>B</b> (mm)	<b>C</b> (mm)	<b>D</b> (mm)	<b>E</b> (mm)	<b>F</b> (kg)	<b>F</b> - ( <b>G</b> <sub>1</sub> + <b>G</b> <sub>2</sub> ) (kg)
32LH570D-TA	734	474	172	438	71	4.7	4.5
32LH571D-TB							
32LH572D-TC							
32LH572U-TC							
32LH576D-TA							
32LH577D-TB							
32LH578D-TC							
32LH590D-TA							
32LH591D-TH							
32LH592U-TC							
32LH592Z-TC							

Power requirement

19 V  $\overline{\overline{\text{---}}}$  1.8 A

(\*Images may vary depending on model)



	<b>A</b> (mm)	<b>B</b> (mm)	<b>C</b> (mm)	<b>D</b> (mm)	<b>E</b> (mm)	<b>F</b> (kg)	<b>F</b> - ( <b>G</b> <sub>1</sub> + <b>G</b> <sub>2</sub> ) (kg)
43LH571V-TE 43LH571T-TE 43LH571Y-TE	976	621	208.7	583	81.5	8.4	8.1
43LH570T-TD 43LH570Y-TD 43LH590V-TD 43LH590T-TD 43LH590Y-TD	976	633	217.9	583	81.5	8.4	8.1
43LH576T-TD	976	633	217.9	583	81.5	8.7	8.4
49LH571V-TE 49LH571T-TE 49LH571Y-TE	1108	696	208.7	657	81.5	11.3	11
49LH570T-TD 49LH570Y-TD 49LH590V-TD 49LH590T-TD 49LH590Y-TD	1108	707	217.9	657	81.5	11.3	11
49LH576T-TD	1108	707	217.9	657	81.5	11.6	11.3

Power requirement

AC 100-240 V - 50 / 60 Hz

IN020222



ML6946123