



# Washing Machine

## OWNER'S MANUAL

MODELS : WF-551S(C/F)PC  
WF-551S(C/F)PP  
WF-551S(C/F)PH



Please read this manual carefully before operating your set.  
Retain it for future reference.  
Record model number and serial number of the set.  
See the label attached on the back cover and quote this  
information to your dealer when you require service.

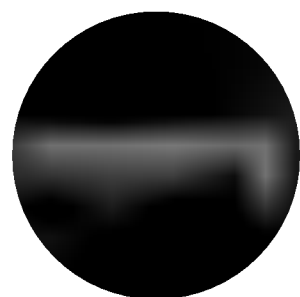

FEATURES .....	3
PARTS IDENTIFICATION.....	4
NAMES OF THE FUNCTION SELECTORS .....	5
INSTALLATION.....	6~7
PREPARATION BEFORE WASH .....	8
NORMAL WASH PROGRAM.....	9
OTHER WASHING PROGRAMS .....	10~11
DELAY START.....	12~13
SELECTABLE WASHING METHODS .....	14
MAINTENANCE .....	15~16
TROUBLE-SHOOTING GUIDE .....	17~18
SPECIFICATION.....	19

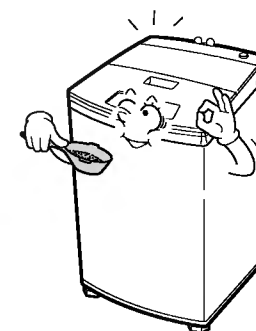

**ALL YOU JUST HOW MUCH  
DETERGENT IS NECESSARY**

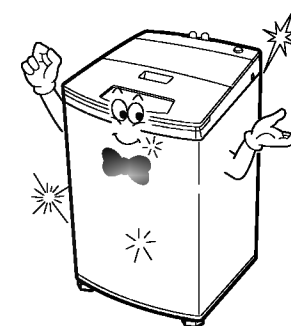

**WATER LEVEL IS AUTOMATI-  
CALLY SET**

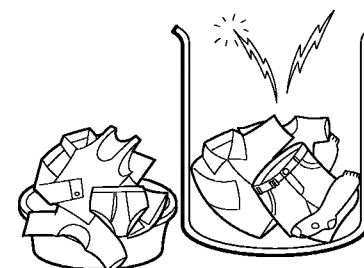

**LEGANTLY ROUNDED DESIGN**

Adds more sophisticated touch to comfortable uses.

**WASHING ADJUSTED TO LOAD  
VOLUME**

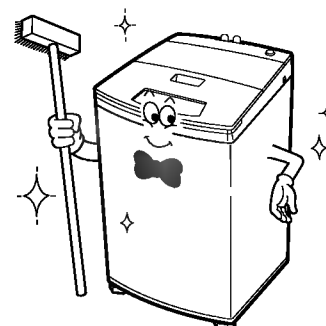

**UNITARY WASH**

Antimicrobial additive which restrains mold or mildew from growing around the tub is applied to the washing tub for cleaner wash.

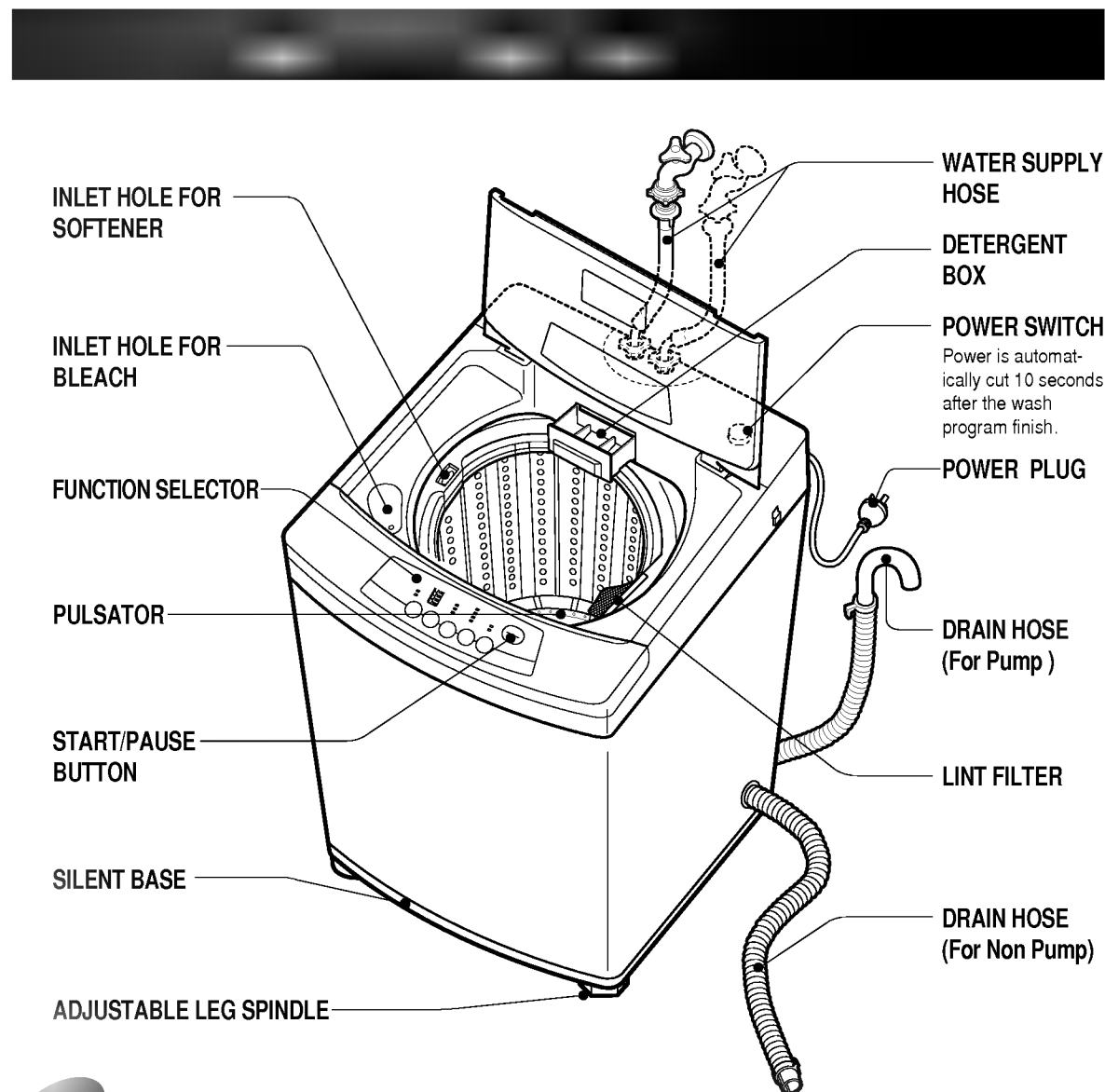

## ACCESSORIES

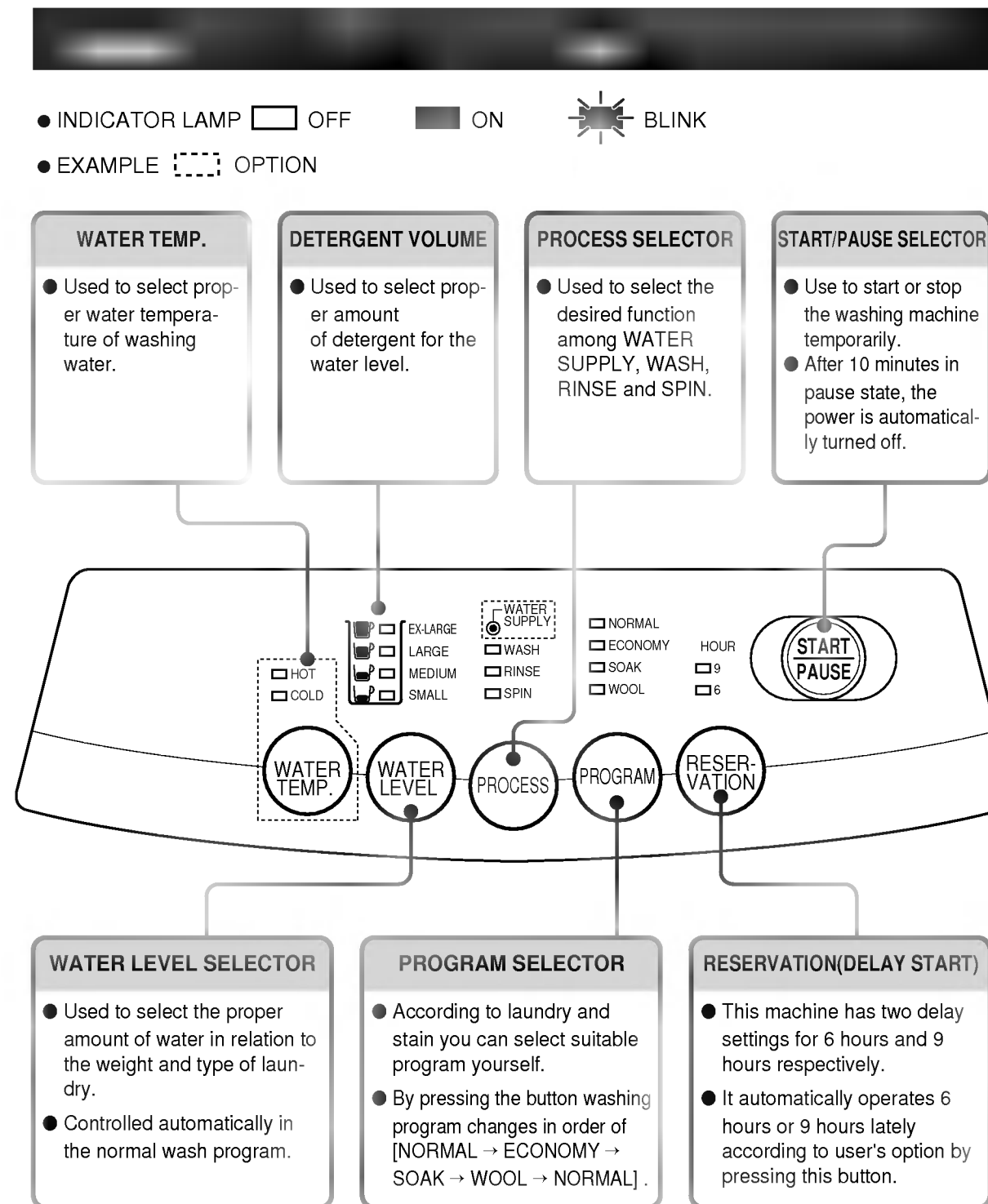
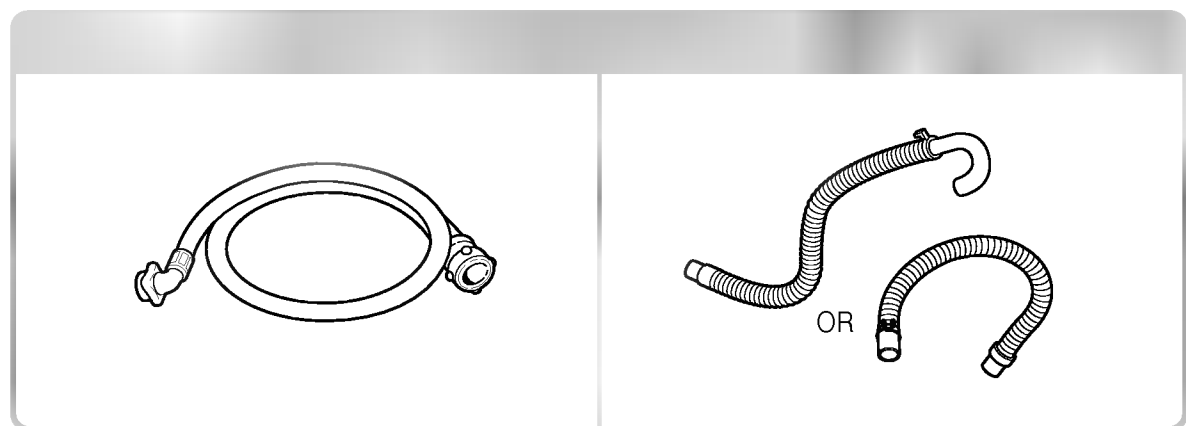

## INSTALL THE WASHING MACHINE ON FIRM AND EVEN PLACE

- Install the washing machine on a flat and firm surface.
- Keep the washing machine over 10cm away from the wall to prevent a noisy sound while spinning.

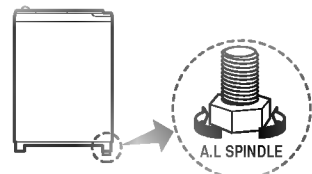

- When washing machine does sit level A.L spindle.
- Turn the A.L spindle CCW or CW and adjust level.

## CONNECT THE DRAIN HOSE

### ■ PUMP MODEL

- Connect the drain hose to the outlet of the drain pump located at the back of the washing machine.

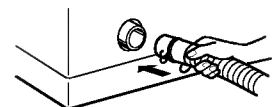

- Fix the drain hose with the clip. And then push it toward the body as in the figure.

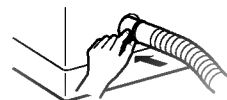

- Check if the drain hose is hung up to proper location for drainage.
- Do not use an extension hose.
- The discharge height is approximately 0.9~1.3m from the floor.

### ■ NON-PUMP MODEL

- Connect the drain hose to the outlet of the drain hose located at the right hand side of the washing machine.

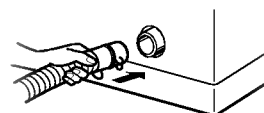

- \* Keep downward while the washing machine is working. (Non pump)
- \* Ensure the hose is free from kinking.

## CHANGE THE DIRECTION OF THE DRAIN HOSE FOR NON-PUMP MODEL

- 1 Unfasten the set screw which secures the drain hose joint, and then push the inside drain hose into the body.

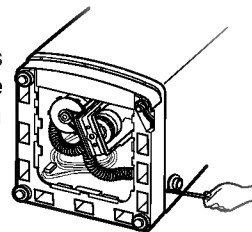

- 2 Change the direction of the drain hose to the hole of the opposite side.

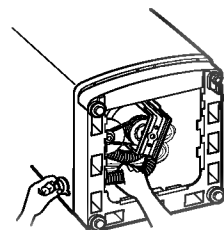

- 3 Fasten the set screw to secure the drain hose joint.

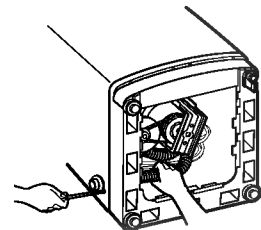

## CONNECT THE INLET HOSE (FILL HOSE)

- Connect the inlet hose to inlet valve of the washing machine, and then lock it by turning the hose connecting part. Check to see if there is a rubber seal inside the connector.

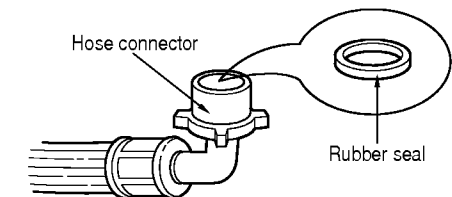
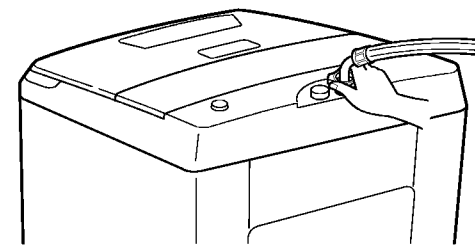

### □ How to connect the hose of Nut type

- Turn the inlet Nut to the right hand direction as shown in the below figure. Tighten it firmly to prevent water leakage.
- Connect the other end of the hose to the water valve on washer securely.
- Make sure that the rubber packing is inside the union nut.

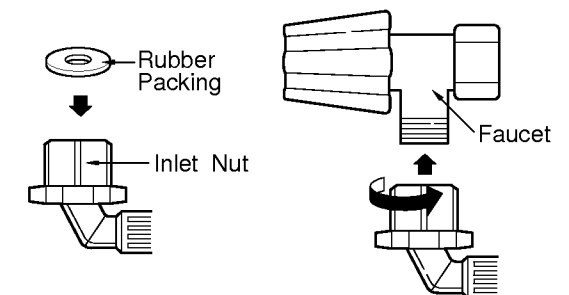

## EARTH WIRE CONNECTION

### \* WARNING - THIS APPLIANCE MUST BE EARTHED.

- When an earth wire is in the power cord assembly, an additional earth wire does not need.
- Earth wire is installed to prevent electric shock caused by the current leakage.
- Earth wire is secured on the back side of the washing machine. Connect the earth wire to a metal faucet. In case the earth wire is connected to a plastic faucet, no effect is expected.

### CAUTION

- If the power supply cord is damaged, it must be replaced by a special cord or assembly available from the manufacturer or its service agent. All material used for enclosing the power supply cord connection have to be retained as origin after any services.
- The base openings must not be obstructed by carpeting, when the washing machine is installed on a carpet floor.

## PREPARATION BEFORE WASH



- Check if laundry is washable in water.

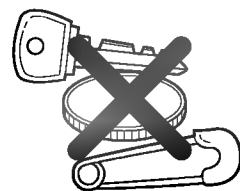

- Be sure to remove things such as keys, pins and coins from the laundry.



- Wash oily or dyed laundry separately.



- Shake loose dirt off before washing.



- Wash fluffy laundry by turning it inside out.

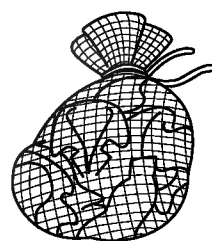

- Wash delicate clothes, wrapping them in a nylon net.

### READY?

- Plug the power plug into the outlet.
- Let water flow into the tub after connecting the inlet hose to the tap.

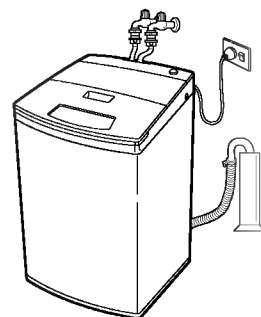

## NORMAL WASH PROGRAM

### NORMAL WASH (FUZZY)



- Wash normal clothes except for blankets, woolen clothes or lingerie.
- Operate WASH, RINSE, SPIN and WATER SUPPLY by pressing the process button.

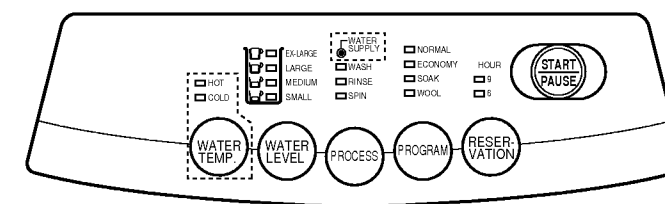

### WASHING PROCEDURE

- 1 Press the power switch.

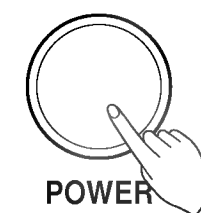

- Normal wash indicator lamp illuminates when the power is on.
- All selection changes are possible.

- 2 Put laundry and detergent in the tub.

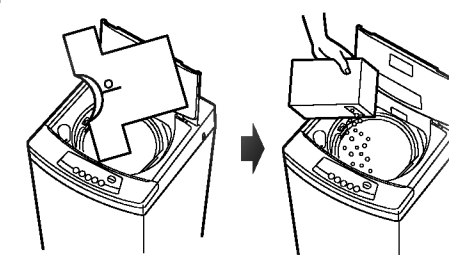

- 3 Begin.

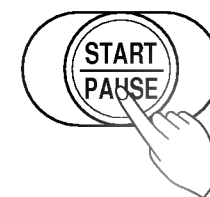

- Press the START/PAUSE button.
- Press the START/PAUSE button again to stop operation temporarily (Washing operation resumes by pressing the START/PAUSE button again.)
- Select WATER SUPPLY, WASH, RINSE or SPIN convertible.

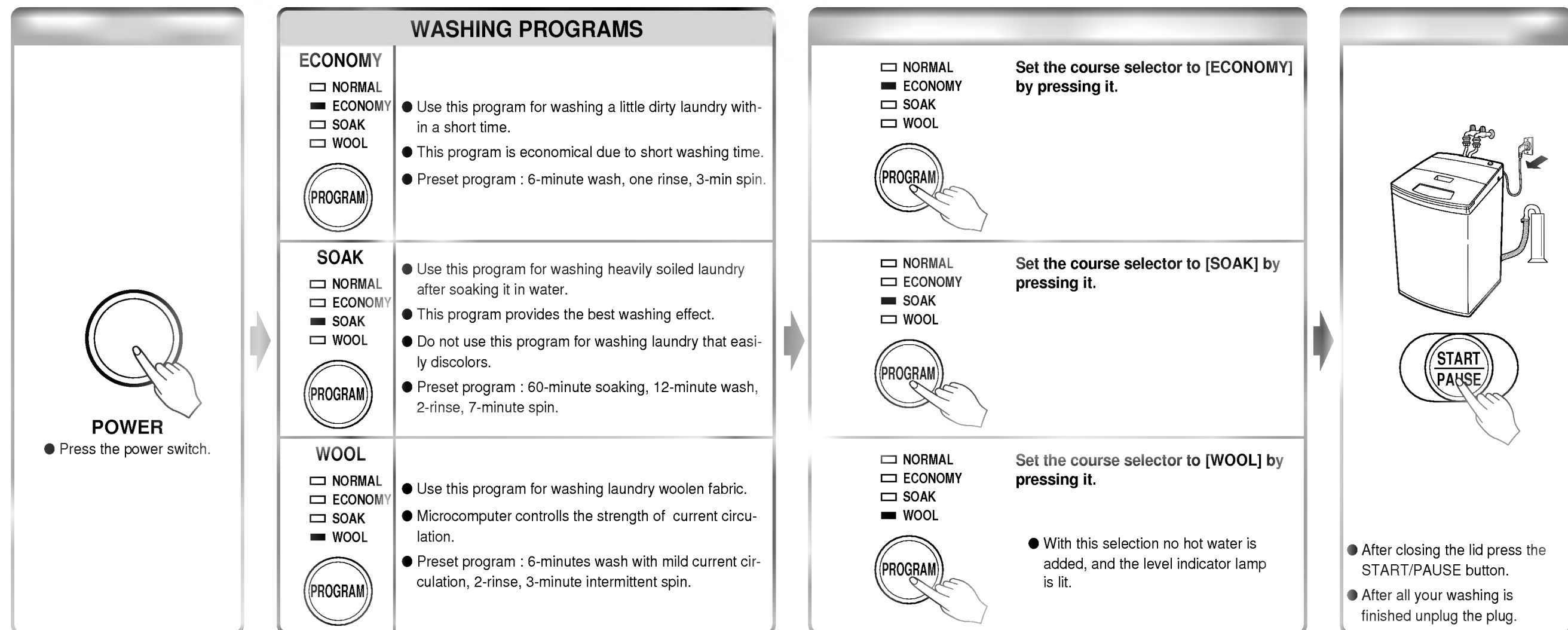

- ✳ When you would like to change washing conditions, select them manually.
- ✳ Preset programs mentioned above can be changed at any time.

- Take out laundry.
- Dry woolens in shade.
- Unplug the power plug.
- Switch off the tap, and separate the connecting hose.
- Clean the washing machine.

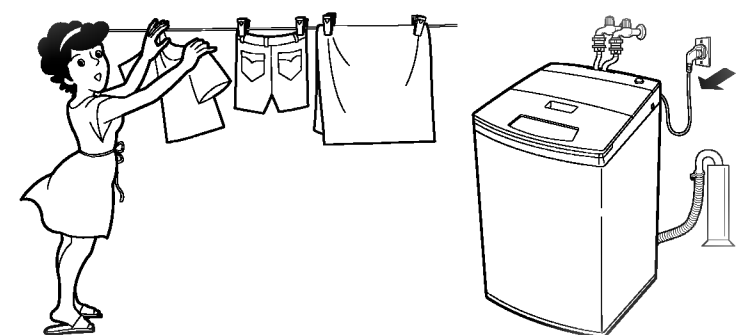

# DELAY START

**1** Press the power switch ON.

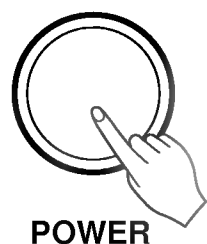

POWER

**2** Select program.

- NORMAL
- ECONOMY
- SOAK
- WOOL



- Select a desired program.
- If a specific program is not selected, the NORMAL program will run.

**3** Set the time.

- HOUR
- 9
- 6



- This machine has two delay settings for 6 hours and 9 hours respectively.
- It automatically operates 6 hours or 9 hours later according to user's option by pressing this button.

**4** Insert laundry and press the START/PAUSE button.



- Insert laundry and press the START/PAUSE button. The washer senses the amount of laundry and displays recommended amount of detergent.
- The washer does not sense the amount of laundry for the BLANKET or WOOL program.

**5** Deposit detergent.

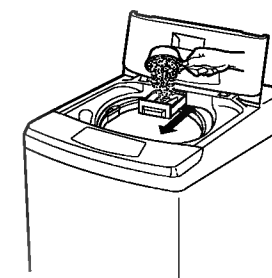

- Pull powder detergent dispenser forward and deposit displayed amount of detergent, then push the dispenser back.
- Concentrated detergent is not suitable for RESERVATION WASHING(Delay Start).

**6** Close the lid.

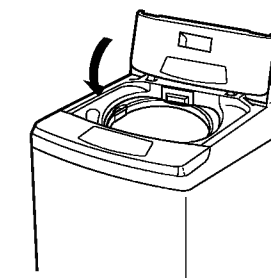

- If the lid is not completely closed, the alarm will sound.
- If the lid is opened RESERVATION WASHING(Delay Start) can not proceed.

## CAUTION

- A wet dispenser drawer may cause the detergent to clump together.
- Do not use powdered hand soap.  
If the lid is open, the machine will not operate and an error warning will occur.
- When you would like to cancel this program press the POWER switch OFF.

## SELECTABLE WASHING METHODS

### ONLY WASHING

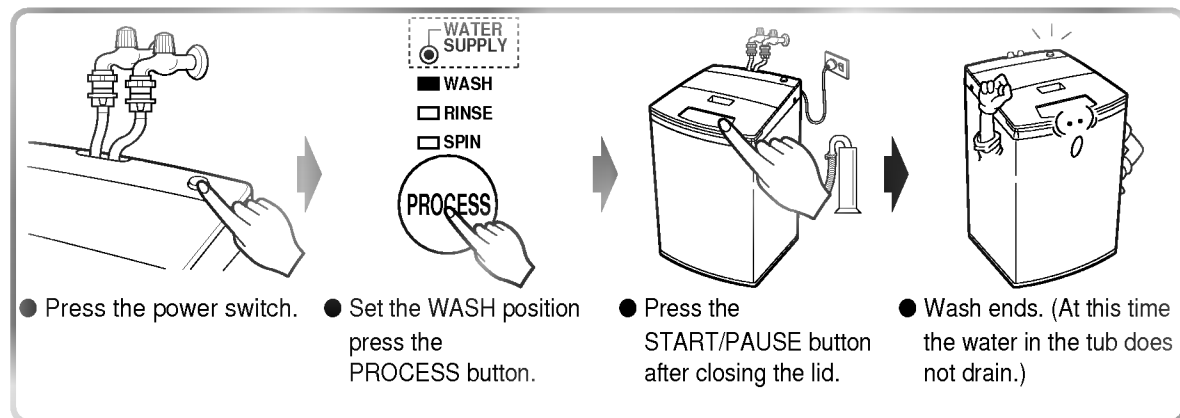

### ONLY RINSE

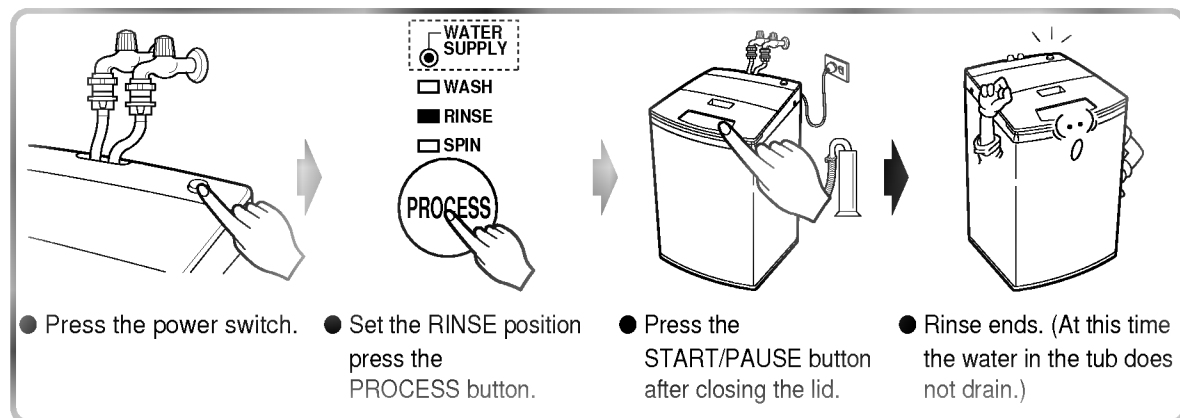

### ONLY SPIN

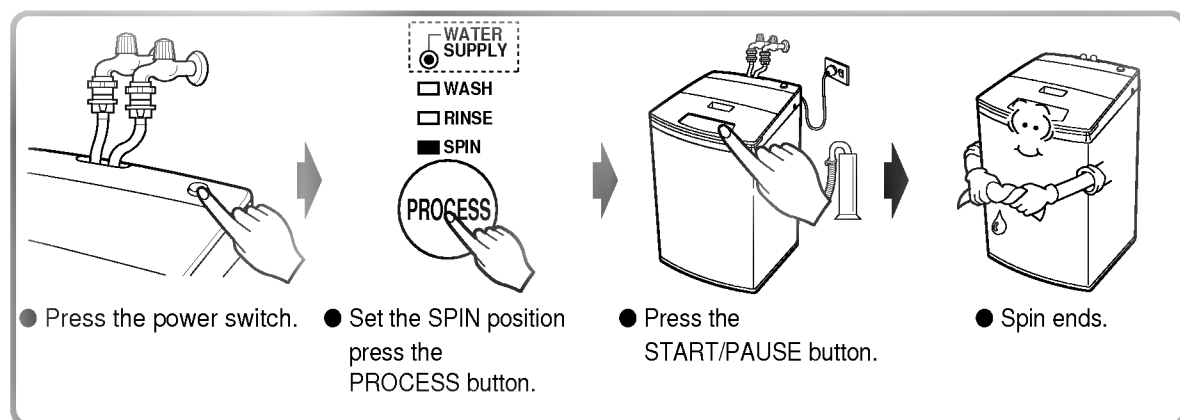

## MAINTENANCE

□ Clean the filter at the inlet valve. When water supply into the tub is bad or the inlet valve is clogged with impurity.

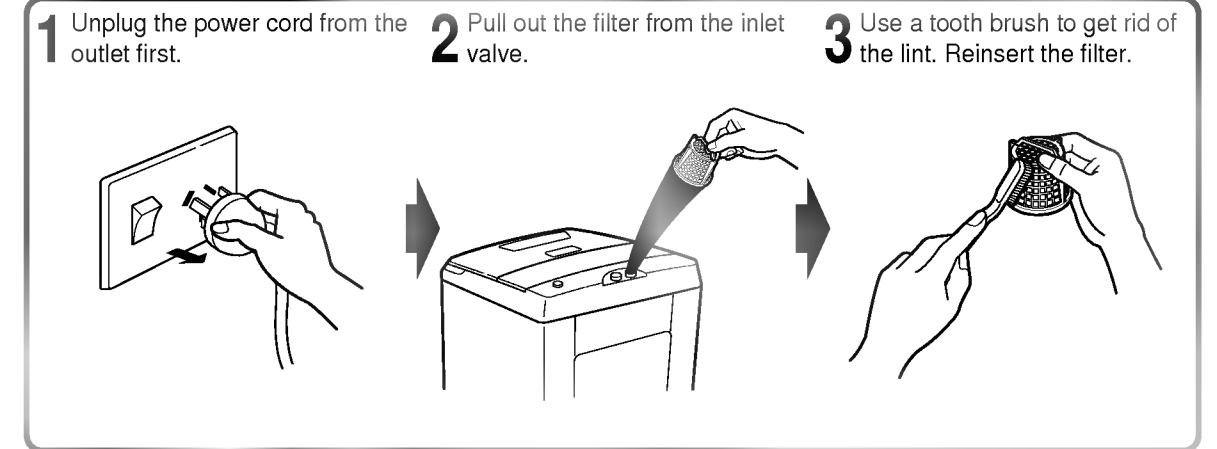

□ Clean the lint filter

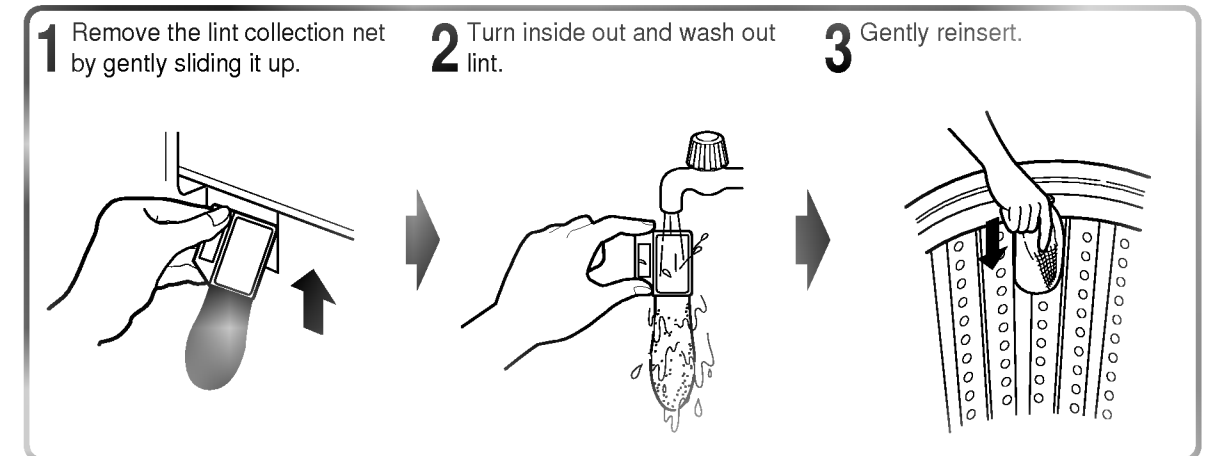



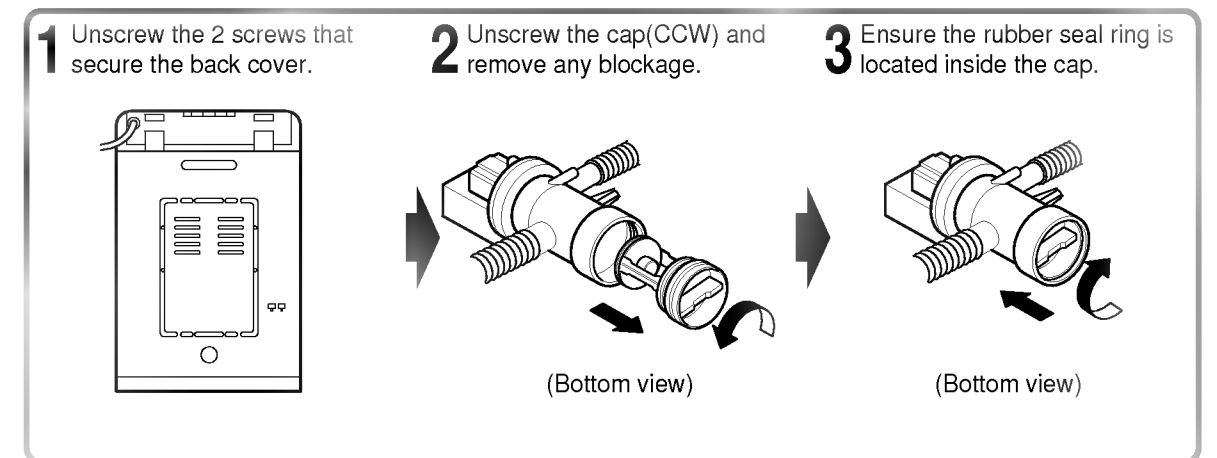





□ Cleaning the pump.



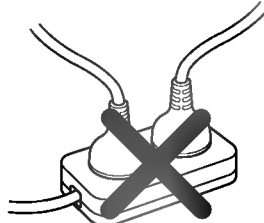

## MAINTENANCE

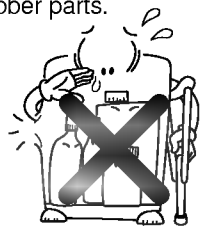
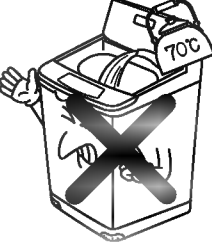
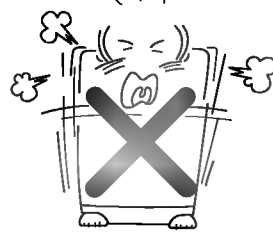
□ Observe the following to ensure the durability of the washing machine and your safety.

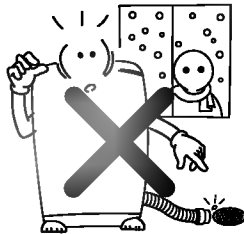
<p>● Do not expose the washing machine to direct sunlight or rain.</p> 	<p>● Do not install the washing machine in a wet area.</p> 	<p>● Do not sprinkle water control switches.</p> 
<p>● Do not over load plug points.</p> 	<p>● When removing the plug, do not use the power cord to pull it out.</p> 	<p>● Keep children away from the washing machine.</p> 
<p>● Keep the washing machine away from fire or heat sources.</p> 	<p>● Do not pour caustic soda and bleach over the washing machine. It causes damage to rubber parts.</p> 	<p>● Do not pour water that is over 70°C water into the tub.</p> 
<p>● Ensure the lid is closed, especially when spinning.</p> 	<p>● Do not put your hands into the rotating tub.</p> 	<p>● Ensure water is thoroughly drained.</p> 

## TROUBLE-SHOOTING GUIDE

### No water supply.



Process indicator lamp flickers (Wash, Rinse) when water does not flow into the tub.

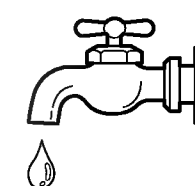

Is tap open?

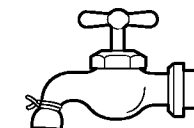

Is the water supply cut off?



Are the pipes frozen?

### Not draining.

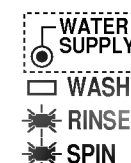

Process indicator lamp flickers (Rinse, Spin) when draining does not take place.

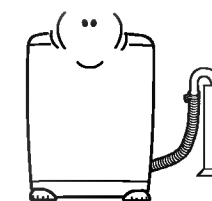

Is the power connected of switched on?

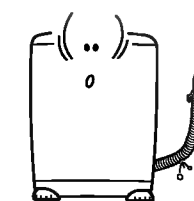

Is the drain hose frozen?

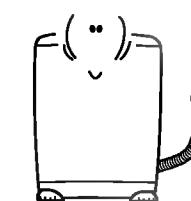

Is the drain hose hung up properly? The proper height of stand pipes is 0.9~1.3m (For pump)

### Not spinning.

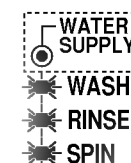

Process indicator lamp flickers (Wash, Rinse, Spin) when tub does not spin.

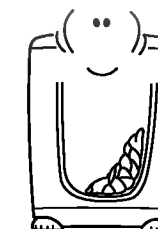

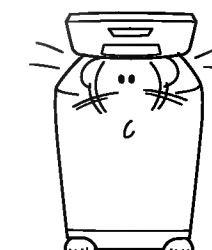

Is the laundry unevenly balanced?

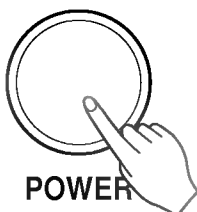
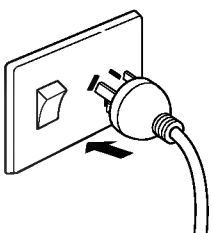
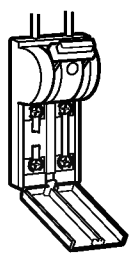
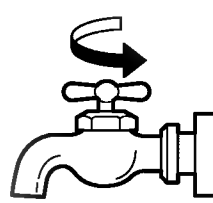
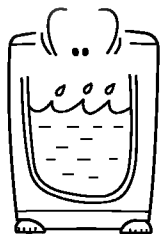

Is the lid closed?

# TROUBLE-SHOOTING GUIDE

No power.	<div>    </div> <div> Is the power switch pressed?  Is the power cord unplugged?  Power failure?  Fuse blown? </div>
Not working.	<div>    </div> <div> Is the tap closed?  Is the water level normal?  Has the START/PAUSE button been pressed? </div>
A high level of vibration and noise during spinning.	<div>  </div> <div> Is the washing machine installed on a level place? </div>

# SPECIFICATION

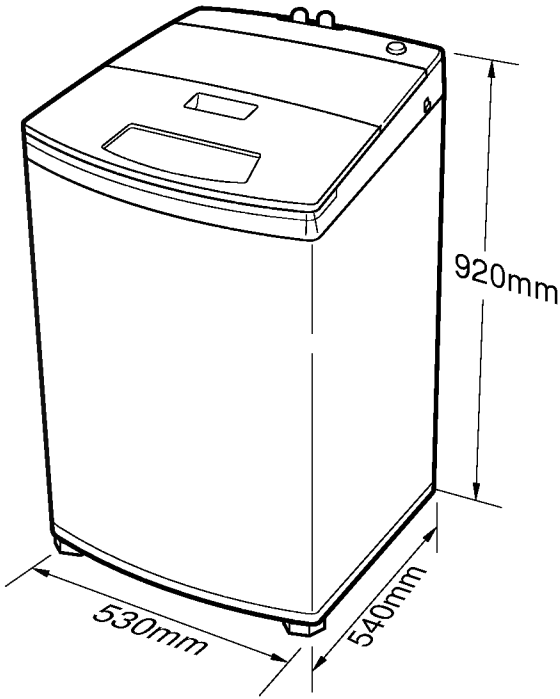

❑ ELECTRICITY SOURCE	: 220V~,50Hz
❑ THE USE RANGE OF WATER PRESSURE	: 0.3–10kgf/cm²(30–1000kPa)
❑ MOTOR OUTPUT	: 90W
❑ WEIGHT	: 32 kg
❑ SIZE	: 530(W) × 540(D) × 920(H)
❑ STANDARD WATER LEVEL	: EX-LARGE : 47 ℓ
	: LARGE : 39 ℓ
	: MEDIUM : 29 ℓ
	: SMALL : 21 ℓ