

Table of Contents

Installation and Connection

Safety Precautions	A1
Accessories	A4
Before connecting to the PC	A5
Name and Function of the Parts	A7
Connecting to External Devices	A11
When Connecting to your PC	A11
When Watching VCR/DVD	A13
When watching DVD/SET-TOP BOX with a D-Sub cable	A15
When Watching TV	A16
To arrange cables in order	A17

Input Selection and Tracking

Selecting and Adjusting the Screen	A18
Name of the Buttons in the screen Adjustment Unit	A18
OSD (On Screen Display) Menu	A20
OSD (On Screen Display) Screen Tracking Order	A21
Set/Select the channel when using the TV	A22
Adjusting the picture function (TV/Video)	A23
Adjusting the picture function (RGB-DTV, RGB-PC)	A24
Adjusting the sound function	A25
Adjusting the time function	A26
Selecting the setup function	A27
Adjusting the screen function (RGB-PC, RGB-DTV only)	A33

Miscellaneous

Troubleshooting	A34
Specifications	A37

ENGLISH

Safety Precautions

Please read these safety precautions carefully before using the product.

 **Warning** If you ignore the warning message, you may be seriously injured or there is a possibility of accident or death.

 **Caution** If you ignore the caution message, you may be slightly injured or the product may be damaged

Precautions in installing the Product

Warning

- **Keep away from heat sources like electrical heaters.**
 - Electrical shock, fire, malfunction or deformation may occur.
- **Keep the packing anti-moisture material or vinyl packing out of the reach of children.**
 - Anti-moisture material is harmful if swallowed. If swallowed by mistake, force the patient to vomit and visit the nearest hospital. Additionally, vinyl packing can cause suffocation. Keep it out of the reach of children.
- **Do not put heavy objects on the product or sit upon it.**
 - If the product collapses or is dropped, you may be injured. Children must pay particular attention.
- **Do not leave the power or signal cable unattended on the pathway.**
 - The passerby can falter, which can cause electrical shock, fire, product breakdown or injury.
- **Install the product in a neat and dry place.**
 - Dust or moisture can cause electrical shock, fire or product damage.
- **If you can smell smoke or other odors or hear a strange sound unplug the power cord and contact the service center.**
 - If you continue to use without taking proper measures, electrical shock or fire can occur.
- **If you dropped the product or the case is broken, turn off the product and unplug the power cord.**
 - If you continue to use without taking proper measures, electrical shock or fire can occur. Contact the service center.
- **Do not drop metallic objects such as coins, hair pins, chopsticks or wire into the product, or inflammable objects such as paper and matches. Children must pay particular attention.**
 - Electrical shock, fire or injury can occur. If a foreign object is dropped into the product, unplug the power cord and contact the service center.

Caution

- **Make sure the product ventilation hole is not blocked. Install the product in a suitably wide place (more than 10cm from the wall)**
 - If you install the product too close to the wall, it may be deformed or fire can break out due to internal heat.
- **Do not block the ventilation hole of the product by a tablecloth or curtain.**
 - The product can be deformed or fire can break out due to overheating inside the product.
- **Install the product on a flat and stable place that has no risk of dropping the product.**
 - If the product is dropped, you may be injured or the product may be broken.
- **Install the product where no EMI occurs.**
- **Keep the product away from direct sunlight.**
 - The product can be damaged.

Electrical Power Related Precautions

Warning

- **Make sure to connect the power cable to the grounded current.**
 - You may be electrocuted or injured.
- **Use the rated voltage only.**
 - The product can be damaged, or you may be electrocuted.
- **During a thunder or lightning storm, unplug the power cable or signal cable.**
 - You may be electrocuted or a fire can break out.
- **Do not connect several extension cords, electrical appliances or electrical heaters to a single outlet. Use a power bar with a grounding terminal designed for exclusive use with the computer.**
 - A fire can break out due to overheating.
- **Do not touch the power plug with wet hands. Additionally, if the cord pin is wet or covered with dust, dry the power plug completely or wipe dust off.**
 - You may be electrocuted due to excess moisture.
- **If you don't intend to use the product for a long time, unplug the power cable from the product.**
 - Covering dust can cause a fire, or insulation deterioration can cause electric leakage, electric shock or fire.
- **Fix the power cable completely.**
 - If the power cable is not fixed completely, a fire can break out.
- **Hold the plug when pulling out the power cable. Do not bend the power cord with excessive force or put heavy objects on the power cord.**
 - The power line can be damaged, which may cause electric shock or fire.
- **Do not insert a conductor (like a metal chopstick) into one end of the power cable while the other end is connected to the input terminal on the wall. Additionally, do not touch the power cable right after plugging into the wall input terminal.**
 - You may be electrocuted.
- **The power supply cord is used as the main disconnection device. Ensure that the socket-outlet is easily accessible after installation.**

Caution

- **Do not unplug the power cord while the product is in use.**
 - Electrical shock can damage the product.

Precautions in Moving the Product

Warning

- **Make sure to turn off the product.**
 - You may be electrocuted or the product can be damaged.
- **Make sure to remove all cables before moving the product.**
 - You may be electrocuted or the product can be damaged.

Safety Precautions

Caution

- Do not shock the product when moving it.
 - You may be electrocuted or the product can be damaged.
- Do not dispose the product-packing box. Use it when you move.
- Make the panel face forward and hold it with both hands to move.
 - If you drop the product, the damaged product can cause electric shock or fire. Contact with the service center for repair.

Precautions in Using the Product

Warning

- Do not disassemble, repair or modify the product at your own discretion.
 - Fire or electric shock accident can occur.
 - Contact the service center for check, calibration or repair.
- When cleaning the brown tube surface, unplug the power cord and scrub with soft cloth to prevent scratching. Do not clean with a wet cloth.
- Keep the product away from water.
 - Fire or electric shock accident can occur.

Caution

- Do not put or store inflammable substances near the product.
 - There is a danger of explosion or fire due to careless handling of the inflammable substances.
- When cleaning the brown tube surface, unplug the power cord and scrub with soft cloth to prevent scratching. Do not clean with a wet cloth.
 - The water can sink into the product, which can cause electric shock or serious malfunction.
- Take a rest from time to time to protect your vision.
- Keep the product clean at all times.
- Take a comfortable and natural position when working with a product to relax the muscles.
- Take a regular break when working with a product for a long time.
- Do not press strongly upon the panel with a hand or sharp object such as nail, pencil or pen, or make a scratch on it.
- Keep the proper distance from the product.
 - Your vision may be impaired if you look at the product too closely.
- Set the appropriate resolution and clock by referring to the User's Guide.
 - Your vision can be impaired.
- Use authorized detergent only when cleaning the product. (Do not use benzene, thinner or alcohol.)
 - Product can be deformed.

On Disposal

- The fluorescent lamp used in this product contains a small amount of mercury.
- Do not dispose of this product with general household waste.
 - Disposal of this product must be carried out in accordance to the regulations of your local authority.

Accessories

ENGLISH

Please check the accessories in the product package.

* The product and the accessories can be different from the figures shown here.

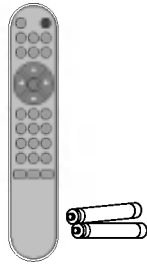

Remote Control/Batteries



User's Guide/
Driver CD/Cards



D-Sub Signal Cable



Power Cable



Audio Cable (PC)



Stand base

Inserting batteries into remote control.

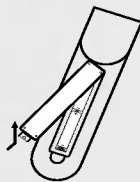

1. Take out the battery cap.
2. Insert the batteries with correct polarity (+/-).
3. Close the battery cap.
 - You can use a remote control 7 meter distance and 30 degree (left/right) within the receiving unit scope.
 - Dispose of used batteries in the recycle bin to prevent environmental pollution.

Before Connecting to the PC

- Before setting up the product, ensure that the power to the product, the computer system, and other attached devices is turned off.

Connecting the stand base

1. Place the product with its front facing downward on a soft cloth.
2. Align the hooks on the stand base with the matching slots in the base of the product.
3. Insert the hooks into slots.

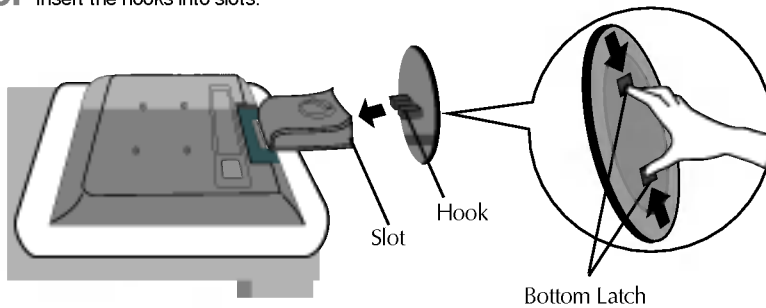

Removing the stand base

1. Place the product with its front facing downward on a soft cloth.
2. To remove the stand base, hold the bottom of the stand with one hand and pull the base bottom latch with the other hand, as shown in the figure.

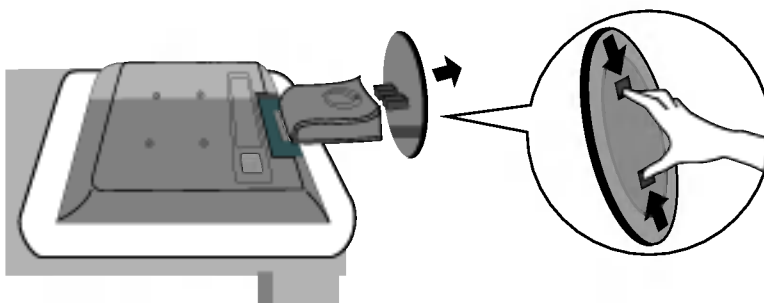

Important

- Once you connect the stand base, try not to disconnect it.
- Do not carry the product upside down holding only the stand base. The product may fall and get damaged or injure your foot.

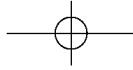

ENGLISH

- Before setting up the product, ensure that the power to the product, the computer system, and other attached devices is turned off.

Positioning your display

1. Adjust the position of the panel in various ways for maximum comfort.

- Tilt Range $-3^{\circ} \sim 25^{\circ}$

- Swivel : 345°

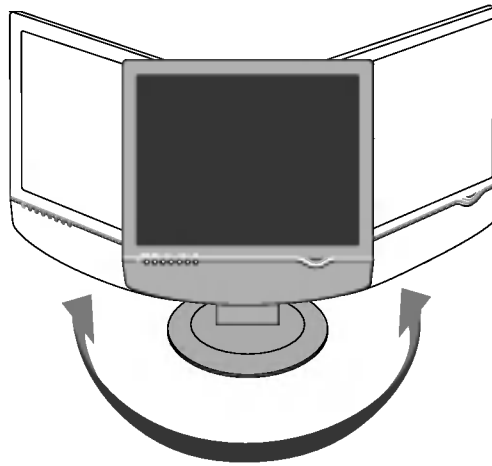
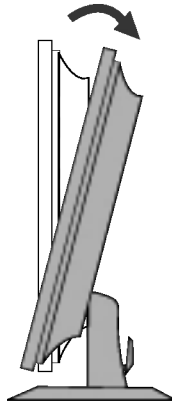

Name and Function of the Parts

● Name of the Remote Control Buttons

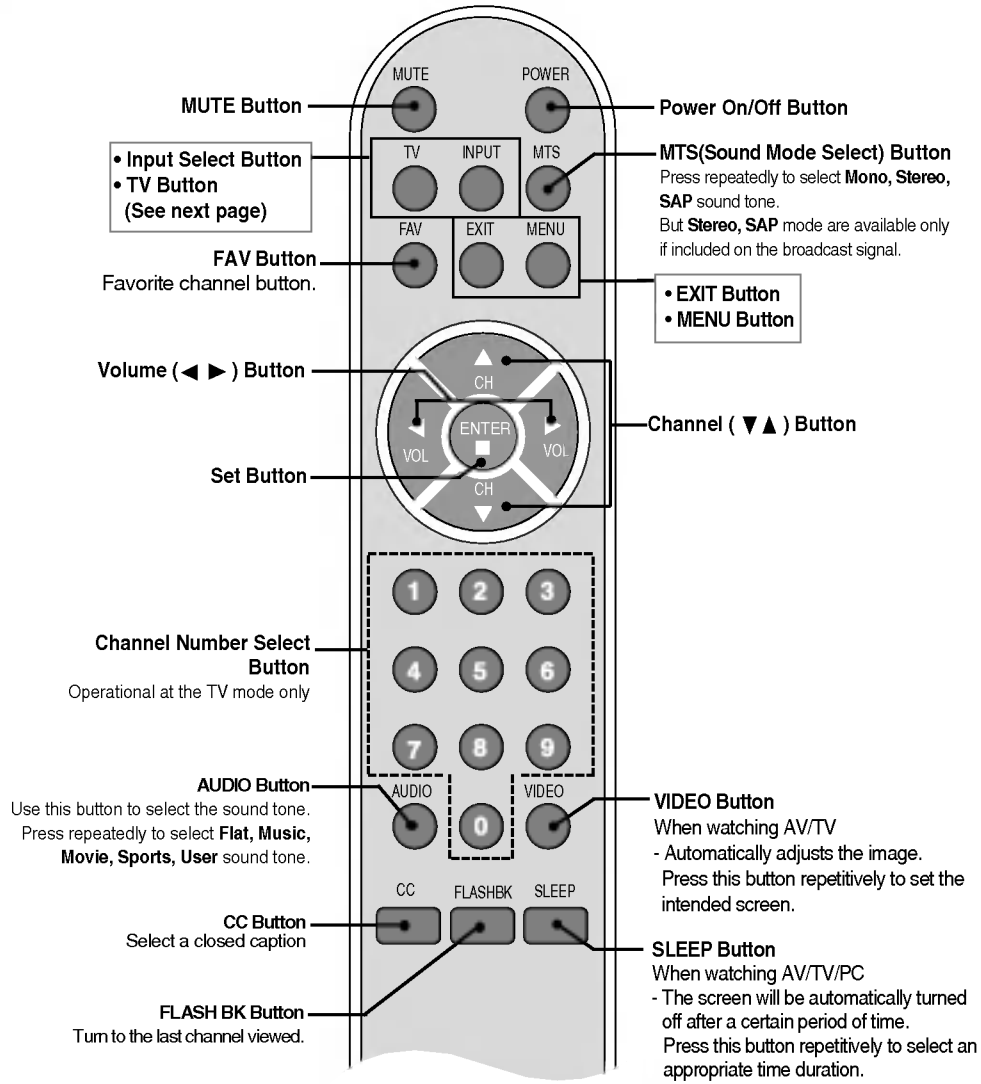

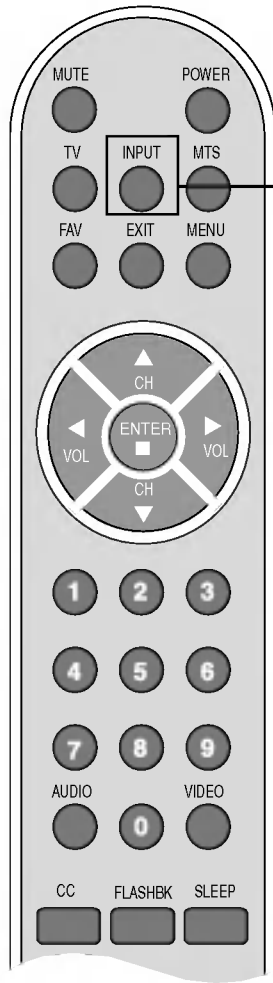

• Input Select Button

Each time you press the Input button it will change to TV → Video → RGB-DTV → RGB-PC. If nothing is inputted for several seconds the screen will automatically move to the selected menu.



Name and Function of the Parts

● Rear View

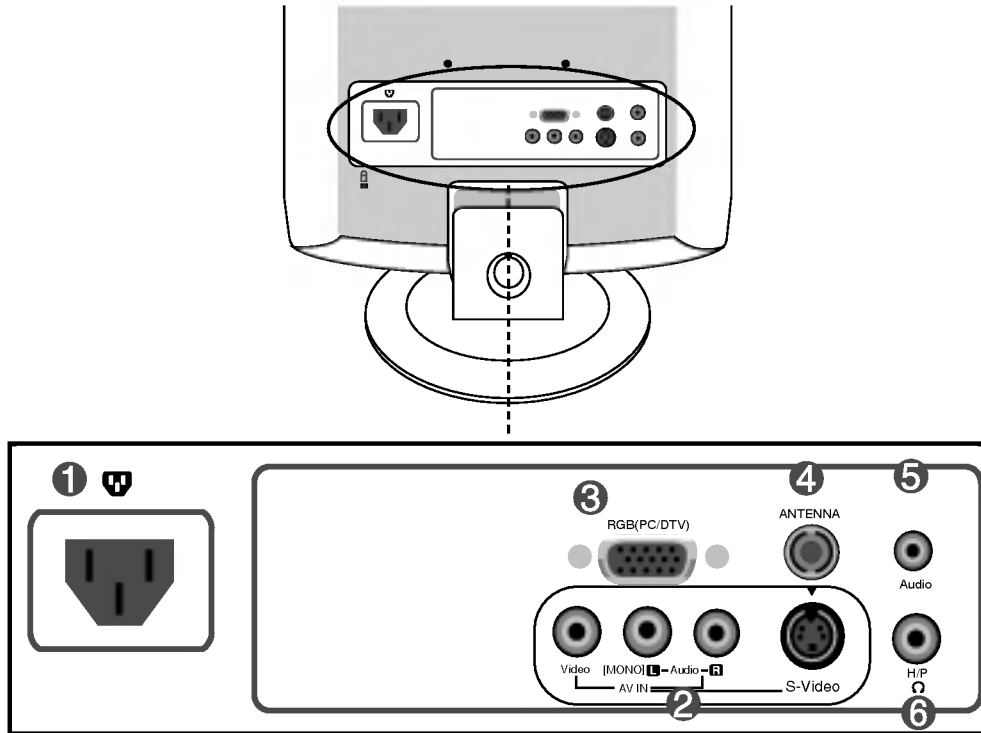

- ❶ Power Connector : Connect the power cord.
- ❷ AV Input Terminal
- ❸ D-Sub Analog Signal Connector
- ❹ TV Tuner Jack : Connect the antenna.
- ❺ PC Sound Jack : Connect to the jack in the PC sound card.
- ❻ Headphone/Earphone Connection Terminal

● AV Input Terminal

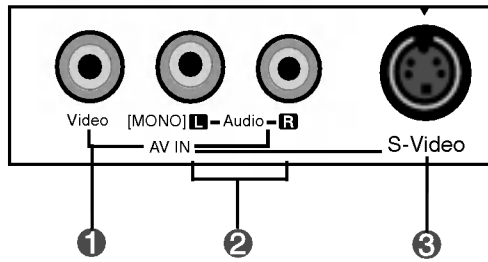

- ① **Video Input Terminal**
- ② **Audio Input Terminal**
- ③ **S-Video Input Terminal**

● Connecting the sound card output terminal

- Make sure to check the sound card connection terminal in the PC before connecting to the product.
If the PC sound card supports both Speaker Out and Line Out, change it to Line Out by setting the jumper or the PC application. (For more details, refer to the sound card user's guide.)
 - **Speaker Out** : The terminal connected to the speaker that is not equipped with an amplifier.
 - ***Line Out** : The terminal connected to the speaker equipped with an amplifier.
- If Audio Out in the PC sound card has only Speaker Out, reduce the PC volume. This product is integrated with an amplifier.

Connecting to External Devices

■ ■ When Connecting to your PC

1. First of all, see if the computer, product and the peripherals are turned off. Then, connect the signal input cable.

- (A) When connecting with the D-Sub signal input cable.
- (B) When connecting with the D-Sub signal input cable.

Rear side of the product.

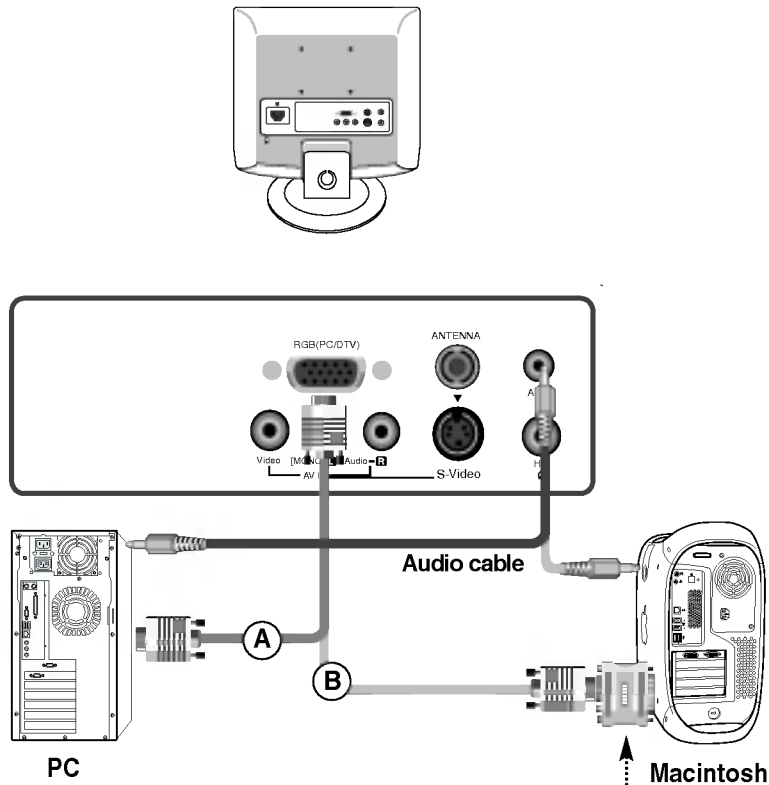

Macintosh Adapter

Use the standard Macintosh adapter since an incompatible adapter is available in the market. (Different signaling system)

2. Connect the power cord.

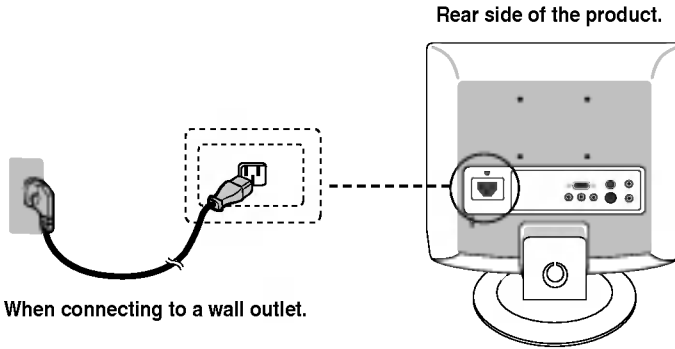

* When connecting to a wall outlet.

3. ① Turn on power by pressing the power button on the product.

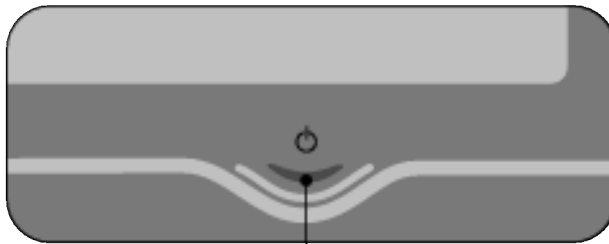

Power button

② Turn on the PC.

4. Select an input signal.
Press the INPUT button on the remote control to select the input signal.

INPUT → OK

Or, press the INPUT button at the front side of the product.

INPUT → OK

• Select RBG-PC

Each time you press the Input button it will change to
TV → Video → RGB-DTV → RGB-PC.
If nothing is inputted for several seconds the screen will automatically move to the selected menu.

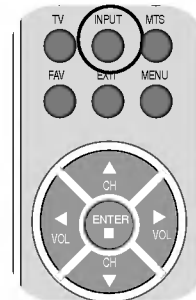

Note

• Directly connect to a grounded power outlet on the wall or a power bar with a ground wire.

Connecting to External Devices

When watching VCR/DVD

1 Connect the video/audio cable as shown in the below figure and then connect the power cord. (See page A12)

- A** When connecting with an RCA cable.
- Connect the input terminal with a proper color match.
(Video – Yellow, Sound (left) – White, Sound (right) – Red)

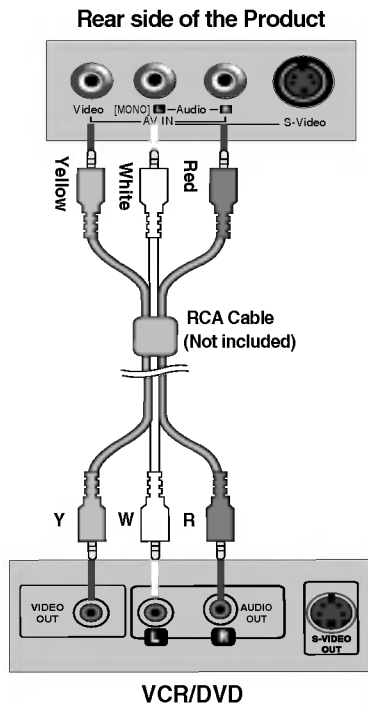

- B** When connecting with an S-Video cable.
- Connect to the S-Video input terminal to watch high image quality movies.

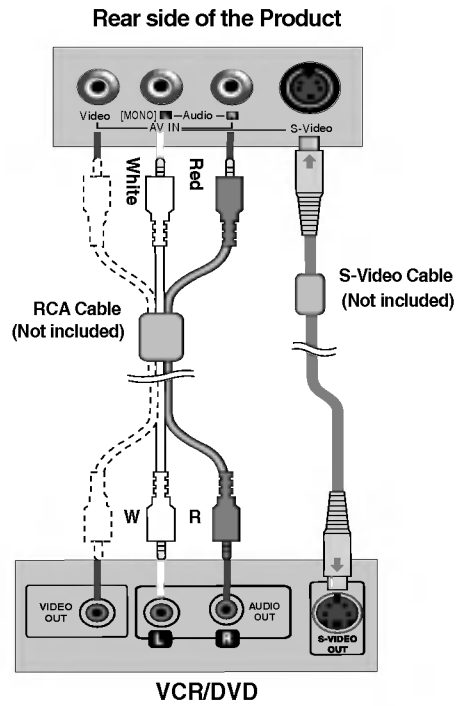

Note • In case the RCA cable is connected simultaneously as S-Video cable is connected, S-Video cable is first.

2. Select an input signal.
Press the **INPUT** button on the remote control to select the input signal.

INPUT → OK

Or, press the **INPUT** button at the front side of the product.

INPUT → OK

- A** When connecting with a RCA cable.
 - Select **AV**
- B** When connecting with a S-Video cable.
 - Select **AV**

Each time you press the Input button it will change to
TV → Video → RGB-DTV → RGB-PC.
If nothing is inputted for several seconds the screen will automatically move to the selected menu.

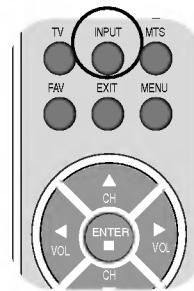

Connecting to External Devices

■ ■ ■ When watching DVD/SET-TOP BOX with a D-Sub cable

1. Connect the RGB output of the digital set-top box/DVD to the RGB(PC/DTV) jack on the set.
Connect the audio outputs of the set-top box/DVD to the Audio jack on the set.
And then connect the power cord. (see page A12)

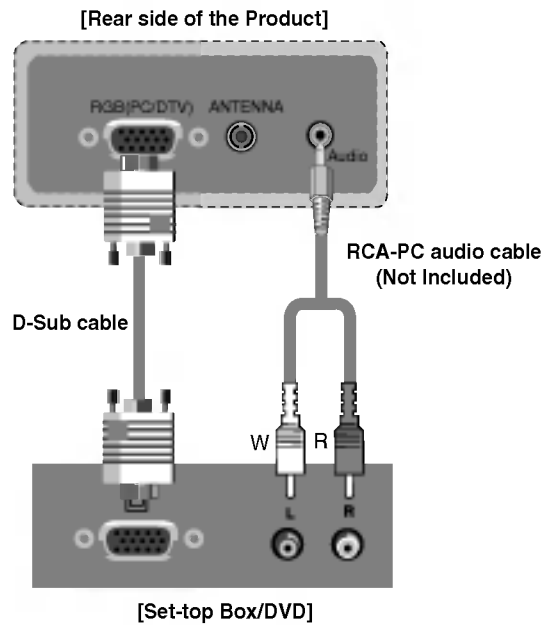

2. Select an input signal.
Press the INPUT button on the remote control to select the input signal.

INPUT → OK

Or, press the INPUT button at the front side of the product.

INPUT → OK

- Select RGB-DTV

Each time you press the Input button it will change to
TV → Video → RGB-DTV → RGB-PC.
If nothing is inputted for several seconds the screen will automatically move to the selected menu.

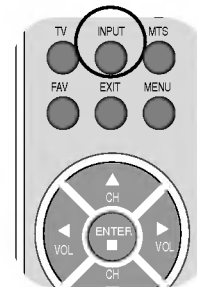

■ ■ When watching TV

1. See if the antenna cable is connected at the rear side of the product and then, connect the power cord.

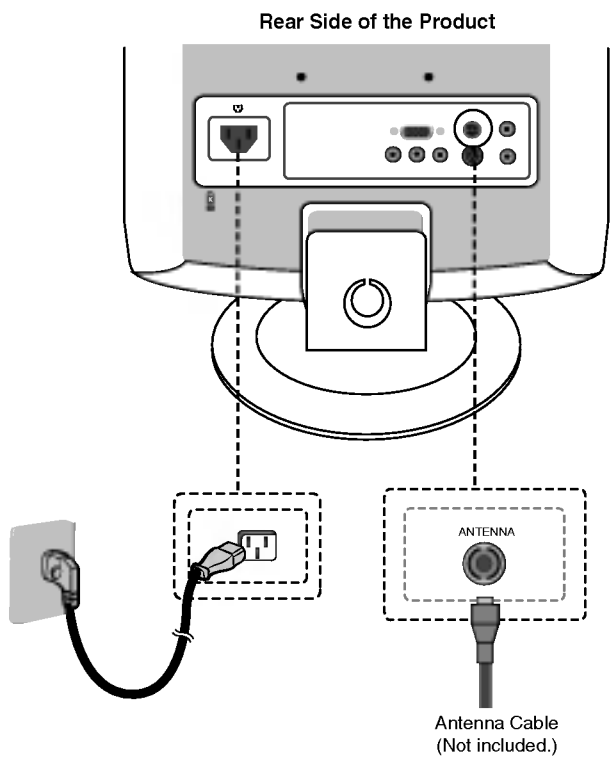

2. Select an input signal.
Press the INPUT button on the remote control to select the input signal.

INPUT → OK

Or, press the INPUT button at the front side of the product.

INPUT → OK

• Select TV

Each time you press the Input button it will change to
 TV → Video → RGB-DTV → RGB-PC.
 If nothing is inputted for several seconds the screen will automatically move to the selected menu.

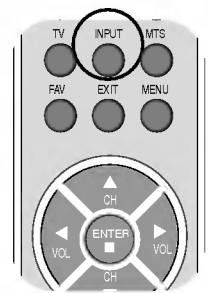

To arrange cables in order

Connect the signal cable, power cord and the audio cable to use in order to arrange in the cable holder as shown in the following figure.

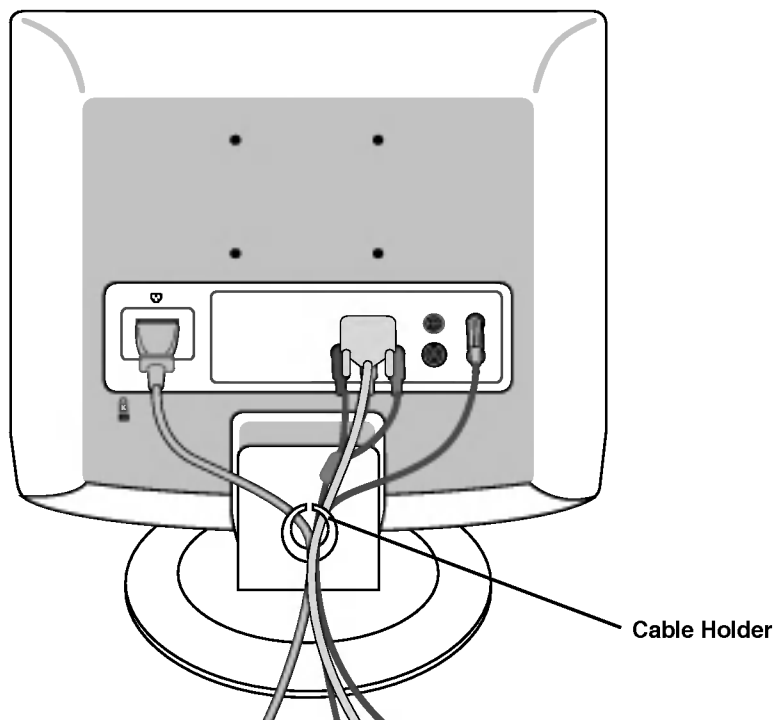

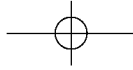

Selecting and Adjusting the Screen

ENGLISH

● Name of the Buttons in the Screen Adjustment Unit

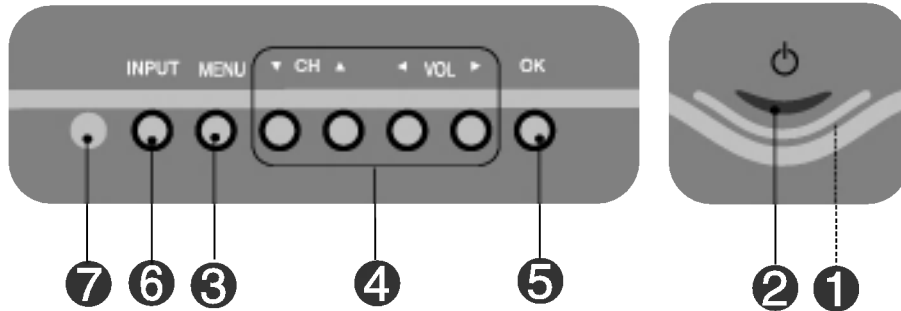

- 1** **Power Indicator** • This Indicator lights up blue when the display operates normally (On Mode). If the display is in Sleep (Energy Saving) Mode, this indicator color changes to amber.
- 2** **Power Button** • Press the button to turn on the power. Press the button again to turn it off.
- 3** **MENU Button** • Use this button to show/hide the OSD (On Screen Display) menu screen.
- 4** **OSD Select/Adjust Button** • Use this button to select an icon or adjust the setting in the OSD screen.

 - ▼▲ • Use this button to control the channel for the TV signal.
 - ◀▶ • Adjust the volume.

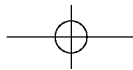

Selecting and Adjusting the Screen

● Name of the Buttons in the Screen Adjustment Unit

- 5** **OK Button** • Select the icon to adjust on the OSD screen.
 [For PC Analog signal]









- 6** **INPUT Button**
- | | |
|---------|---------------------|
| TV | Television |
| AV | CVBS, S-Video |
| RGB-DTV | DTV |
| RGB-PC | D-Sub analog signal |



Each time you press the Input button it will change to
 TV → Video → RGB-DTV → RGB-PC.
 If nothing is inputted for several seconds the screen will automatically move to the selected menu.

- 7** **IR Receiver** • The unit that receives the signal from the remote control.

● OSD (On Screen Display) Menu

Icon	Function Description
 CHANNEL	Set/Select the channel when using the TV
 PICTURE	Adjusting the picture function.
 SOUND	Adjusting the sound function.
 TIMER	Adjusting the time function.
 SPECIAL	Selecting the setup function.
 SCREEN	Adjusting the screen function. (RGB-PC, RGB-DTV only)

ENGLISH



Note OSD(On Screen Display)

The OSD function enables you to adjust the screen status conveniently since it provides graphical presentation.

Selecting and Adjusting the Screen

OSD (On Screen Display) Screen Tracking Order

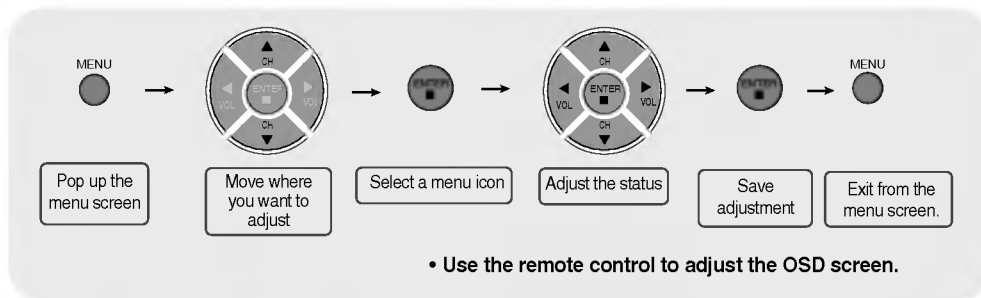

- 1 Press the **MENU** Button, then the main menu of the OSD appears.
- 2 To access a control, use the **▼▲** Buttons.
- 3 When the icon you want becomes highlighted, press the **ENTER** Button.
- 4 Use the **▼▲◀▶** Buttons to adjust the item to the desired level.
- 5 Accept the changes by pressing the **ENTER** Button.
- 6 Exit the OSD by pressing the **MENU** Button.

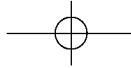

Set/Select the channel when using the TV

ENGLISH

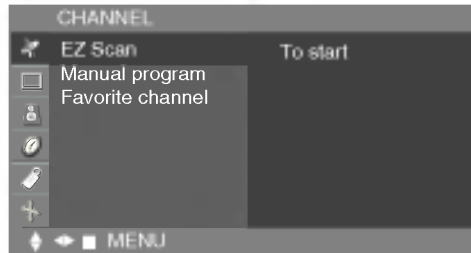

EZ Scan

Press ► button to start automatic programming. All available TV channels are searched and stored automatically.

To stop auto CH progress, press the **MENU** or **ENTER** button.

- Wait for auto CH progress to complete the channel search cycle before choosing a channel. The TV scans for over-the-air channels and then channels are provided by a cable service.

Manual program

User can do manual channel selection and store or erase individual channels.

Press ► button and then use ◀▶ button to select a channel you want to add to memory or erase. Press the ▼ button and then use ◀▶ button to select **Memory**(add) or **Erase**(delete).

Favorite channel

This function lets you select your favourite channels directly. Press the ▼▲◀▶ buttons to select a channel number.

* **FAV Button (remote control)** : Rotate Favourite channel.



Selecting and Adjusting the Screen

Adjusting the picture function (TV/Video)

EZ Video



The **EZ Video** function automatically adjusts the screen image quality. (It is not adjust to the RGB-PC.)

- **Clear**
Select this option to display with a sharp image.
- **Optimum**
The most general and natural screen display status.
- **Soft**
Select this option to display with a mild image.
- **User**
Select this option to use the user-defined settings.

ACC



Selecting a factory setting color set.

- **Cool**
Slightly purplish white.
- **Normal**
Slightly bluish white.
- **Warm**
Slightly reddish white.
- **User**
Select this option to use the user-defined settings.
Red / Green / Blue
Set your own color levels.

Contrast : To adjust the contrast of the screen.

Brightness : To adjust the brightness of the screen.

Color : To adjust the colour to desired level.

Sharpness : To adjust the clearness of the screen.

Tint : To adjust the tint to desired level. (only 60Hz signal)

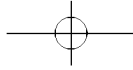

Adjusting the picture function (RGB-DTV, RGB-PC)

ENGLISH

ACC



Selecting a factory setting color set.

- **Cool**
Slightly purplish white.
- **Normal**
Slightly bluish white.
- **Warm**
Slightly reddish white.
- **User**
Select this option to use the user-defined settings.
Red / Green / Blue
Set your own color levels.

Contrast : To adjust the contrast of the screen.

Brightness : To adjust the brightness of the screen.

Selecting and Adjusting the Screen

Adjusting the sound function



- EZ Audio** The best sound tone quality will be selected automatically depending on the video type that you're currently watching.
- **Flat** : The most commanding and natural audio.
 - **Music** : Select this option to enjoy the original sound when listening to the music.
 - **Movie** : Select this option to enjoy sublime sound.
 - **Sports** : Select this option to watch sports broadcasting.
 - **User** : Select this option to use the user-defined audio settings.
- AVL** To adjust uneven sound volumes across all channels or signals automatically to the most appropriate level. To use this feature, select **On**.
- Balance** Use this function to balance sound from the left and right speakers.

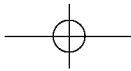

Adjusting the time function

ENGLISH

Clock

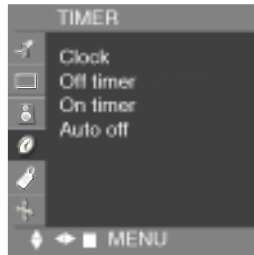

Auto Clock Setup

This function is used to set up of current time.

You must set the time correctly before using **On/Off timer** function.

- 1) Press the **menu** button and then use **▼▲** button to select the **TIMER** menu.
- 2) Press the **▶** button and then use **▼▲** button to select the **Clock** menu.
- 3) Press **▶** button and then use **▼▲** button to select **Auto**.
- 4) Press **▶** button and then use **▼▲** button to select the time zone for your viewing area. Your choices are : AUTO, E.S.T(Eastern Standard Time), C.S.T(Central Standard Time), M.S.T(Mountain Standard Time), P.S.T (Pacific Standard Time), Alaska and Hawaii.
- 5) Press **▶** button and then use **▼▲** button to set PBS channel.
- 6) Press **▶** button and then use **▼▲** button to set D.S.T (Daylight Savings Time) **Auto**, **Off** or **On**, depending in whether or not your viewing area observes Daylight Savings Time.
- 7) Press **enter** button to save.

Manual Clock Setup

You must set the time correctly before using **On/Off timer** function.

- 1) Press the **menu** button and then use **▼▲** button to select the **TIMER** menu.
- 2) Press the **▶** button and then use **▼▲** button to select the **Clock** menu.
- 3) Press **▶** button and then use **▼▲** button to select **Manual**.
- 4) Press **▶** button and then use **▼▲** button to set the hour(01~12).
- 5) Press **▶** button and then use **▼▲** button to set the minutes(00~59).
- 6) The default value is -- : -- AM(PM).

Off / On timer

The **Off timer** automatically switches the set to off mode at the pre-set time.

- 1) Press the **menu** button and then use **▼▲** button to select the **TIMER** menu.
- 2) Press the **▶** button and then use **▼▲** button to select **Off timer** or **On timer**.
- 3) Press the **▶** button and then use **▼▲** button to set the hour(01~12).
- 4) Press the **▶** button and then use **▼▲** button to set the minutes(00~59).
- 5) Press the **▶** button and then use **▼▲** button to select **Run** or **Hold**.
- 6) Only **On timer** function; Press the **▶** button and then **▼▲** button to adjust volume level and channel number.
- 7) Press the **enter/menu** button to save.

Auto off

If **Auto off** is active and there is no input signal, the TV switches to off mode automatically after 10 minutes.

- 1) Press the **menu** button and then use **▼▲** button to select the **Auto off** menu.
- 2) Press the **▶** button and then use **▼▲** button to select **On** or **Off**.
- 3) Press the **enter/menu** button to save .



Note

- In the event of power interruption (disconnection or power failure), the **Clock** must be reset.
- Two hours after the set is switched on by the **On timer** function it will automatically switch back to off mode unless a button has been pressed.
- Once the **On** or **Off timer** is set, these functions operate daily at the preset time.
- **Off timer** function overrides **On timer** function if they are set to the same time.
- The set must be in off mode for the **On timer** to work.
- **On timer** will move on to auto off if no activity is received in 2hours after setting the **On time**.

Selecting and Adjusting the Screen



Selecting the setup function

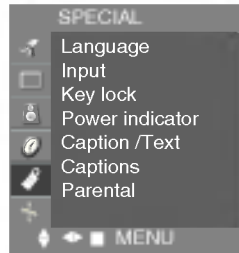

- Language** To choose the language in which the control names are displayed.
- Input** If you press the button once, the following Input Signal Window will appear. Select the signal type you want using the ▼▲ button.
- Key lock** Use the ▼▲ buttons to select **On** or **Off**. It can be set up so that it can only be used with the remote control. This feature can prevent unauthorized viewing.
In order to lock the OSD screen adjustment, set the **Key lock** tab to the 'On' position.
In order to unlock it, do the following :
Push the menu button on the remote control and set **Key lock** to the 'Off' position.
- Power indicator** Use this function to set the power indicator on the front side of the product to **On** or **Off**. If you set **On** at any time, the power indicator will automatically be turned on.



Selecting the setup function (To adjust the CAPTION & VCHIP function - US Only)

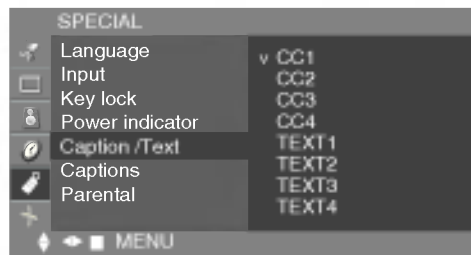

- Caption / Text (TV input only)** Use the ▼▲ buttons to select caption mode.
Text services give a wide variety of information on all kind of subjects(ex. captioned program lists, weather forecasts, stock exchange topics, news for hearing-impaired....) on up to half of the TV screen. But not all stations offer text services, even though they might offer captioning.
In the event you are receiving a poor signal, an empty black box may appear and disappear, even when the text mode is selected. This is a normal when receiving a poor signal.
This TV is programmed to remember the **Caption/Text** mode it was last set to, when you turn the power off.



Selecting the setup function (To adjust the CAPTION & VCHIP function - US Only)

Captions (TV input only)

Use the ▼▲ buttons to select captions.

[Remote Control]

- Press the **CC** button repeatedly to display the caption option as shown below. Press the **ENTER** button to select the caption option.

*If sound is on, the caption will be off. On the contrary, if sound is off, the caption will be on.

Parental (TV input only)

This function is used to block program viewing based on the ratings sent by the broadcast station. The default setting is to allow all programs to be viewed. Viewing can be blocked by the type of program and by the categories chosen to be blocked. It is also possible to block all program viewing for a time period.

Select the **Parental** menu and click ► button. The **'Enter code'** window will appear. Once the correct four-digit password is entered, sub-menu that allows a user to control various blocks will be enabled. The initial password is set for **'0000'** and it can be changed through **'Set password'** menu.

PAGE A29

Selecting and Adjusting the Screen



Selecting the setup function (To adjust the CAPTION & VCHIP function - US Only)

■ V-CHIP rating and categories

- Rating guidelines are provided by broadcast station. Most television programs and television movies can be blocked by TV rating and/or individual categories. Movies that have been shown at the theaters or direct-to-video movies use the Movies Rating System(MPAA) only.

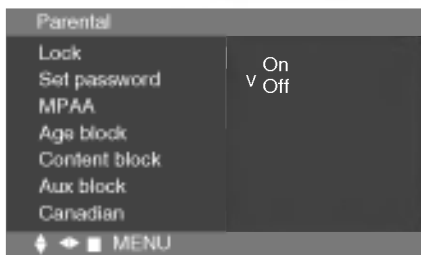

Lock On/Off

To select the VCHIP function On/Off.

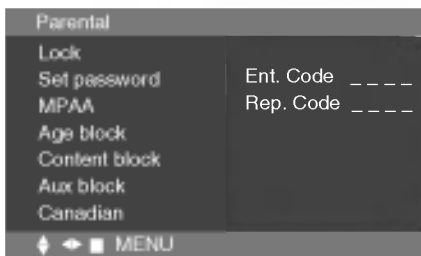

Set password

This menu is to be used to change password. Once the correct current password is entered using the number panel in a remote control, the window for new password will appear. Enter your choice of new four-digit password.

Setting a password

You control access to the parental controls with a password. The default password is '0000'. You can change the password to any four-digit number.

1. Open the OSD. -> Press the ▼▲ buttons to select the **SPECIAL** menu, then press the ► button to open the menu. -> Press the ▼▲ buttons to select the **Parental** sub-menu, then press the ► button to open the sub-menu.
2. Use the number pad to enter your password when prompted.
If you have not set a password, enter **0000**.
If you are unable to correct the problem yourself, contact the service center.
3. Press the ▼▲ buttons to select the **Set password** sub-menu, then press the ► button to change the setting. Use the number button pad to enter a new four-digit password when prompted.
4. Re-enter the new four-digit password when prompted.

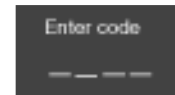



Selecting the setup function (To adjust the CAPTION & VCHIP function - US Only)

■ For movies previously shown in theaters.

Parental	
Lock	G & Above
Set password	PG & Above
MPAA	PG-13 & Above
Age block	R & Above
Content block	NC-17 & Above
Aux block	X
Canadian	v Unblocked
⬇ ⬅ ➡ MENU	

MPAA

■ MOVIE Ratings :

- G&Above : General audience
- PG&Above : Parental guidance suggested
- PG-13&Above : 13 years and up
- R&Above : Restricted
- NC-17&Above : 17 years and up
- X : Adult
- Unblocked

If you set PG-13&Above, G and PG movies will be available : PG-13, R, NC-17, and X will be blocked.

ENGLISH

Parental	
Lock	
Set password	
MPAA	
Age block	To set
Content block	
Aux block	
Canadian	
⬇ ⬅ ➡ MENU	

Age block

■ GENERAL TV Rating :

- TV-G&above : General audience / Individual categories do not apply.
- TV-PG&Above : Parental guidance suggested
- TV-14&Above : 14 years and up
- TV-MA : Mature audience
- Unblocked

■ CHILDREN TV Rating :

- TV-Y&Above : Youth / Individual content categories do not apply.
- TV-Y7 : Youth, 7 years and up.
- Unblocked

Parental	
Lock	
Set password	
MPAA	
Age block	
Content block	To set
Aux block	
Canadian	
⬇ ⬅ ➡ MENU	

Content block

■ CONTENT Categories :

- Dialogue(sexual dialogue)
: Applies to TV-PG&Above, TV-14.
- Language(adult language)
: Applies to TV-PG&Above, TV-14&Above, TV-MA.
- Sex Scene(sexual situations)
: Applies to TV-PG&Above, TV-14&Above, TV-MA.
- Violence
: Applies to TV-PG&Above, TV-14&Above, TV-MA.
- F Violence(fantasy violence)
: Applies only to TV-Y7.

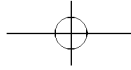

Selecting and Adjusting the Screen



Selecting the setup function (To adjust the CAPTION & VCHIP function - US Only)



Aux block

Enables you to select a source to block from the external source devices you have hooked up.



Selecting the setup function (To adjust the CAPTION & VCHIP function - Canadian Only)

■ V-CHIP rating and categories - Canadian Rating System

- Rating guidelines are provided by broadcast station. Most television programs and television movies can be blocked by TV rating and/or individual categories.

Canadian

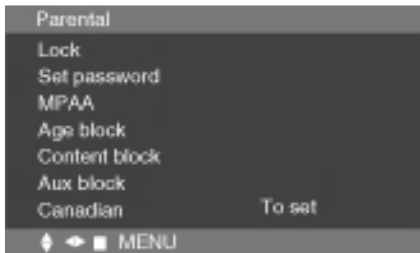

English

■ MOVIE Ratings :

- C&Above : Under 8 years
- C8+ : 8 years and up
- G&Above : General audience
- PG&Above : Parental guidance suggested
- 14+ : 14 years and up
- 18+ : Adult
- Unblocked

Français

■ MOVIE Ratings :

- G&Above : General audience
- 8 ans + : 8 years and up
- 13 ans + : 13 years and up
- 16 ans + : 16 years and up
- 18 ans + : 18 years and up
- Unblocked

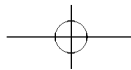

Closed Captions - Not all TV broadcasts include closed caption signals.

Closed captioning is a process which converts the audio portion of a television program into written words which then appear as subtitles on the television screen. Closed captions allow viewers to read the dialogue and narration of television programs.

Using Closed Captions

Captions are the subtitles of the dialogue and narration of television programs. For prerecorded programs, program dialogue can be arranged into captions in advance. It is possible to caption a live program by using a process called real-time captioning, which creates captions instantly. Real-time captioning is normally done by professional reporters using a machine shorthand system and computer for translation into English.

Captioning is an effective system for the hearing-impaired, and it can also aid in teaching language skills.

Caption Tips

1. Not all TV broadcasts include closed caption signals.
2. Sometimes TV stations broadcasts four different caption signals on the same channel. By selecting **From CC1 ~ CC4, TEXT1 ~ TEXT4** you can choose which signal you view **CC1** is usually the signal with the captions, while **Another mode** might show demonstration or programming information.
3. Your TV might not receive caption signals normally in the following situations.
 - Poor reception conditions are encountered :
 - **IGNITION** :
Picture may flutter, drift, suffer from black spots, or horizontal streaking. Usually caused by interference from automobile ignition systems, neon lamps, electrical drills, and other electrical appliances.
 - **GHOSTS** :
Ghosts are caused when the TV signal splits and follows two paths. One is the direct path and the other is reflected off tall buildings, hills or other objects. Changing the direction or position of the antenna may improve reception.
 - **SNOW** :
If your receiver is located at the weak, fringe area of a TV signal, your picture may be marred by small dots. It may be necessary to install a special antenna to improve the picture.
 - An old, bad or illegally recorded tape is playing.
 - Strong, random signals from a car or airplane interfere with the TV signal.
 - The signal from the antenna is weak.
 - The program wasn't captioned when it was produced, transmitted, or taped.

Selecting and Adjusting the Screen

Adjusting the screen function (RGB-PC, RGB-DTV only)

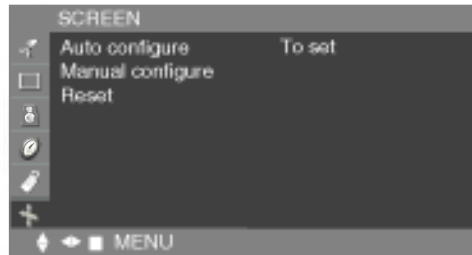

Auto configure

This button is for the automatic adjustment of the screen **Position**, **Clock** and **Phase**.

Manual configure

This button is for the manual adjustment of the screen **Position**, **Clock** and **Phase**.

- **H-Position**
To move image left or right.
- **V-Position**
To move image up or down.
- **Clock**
To minimize any vertical bars or stripes visible on the screen background.
The horizontal screen size will also change.
- **Phase**
To adjust the focus of the display. This item allows you to remove any horizontal noise and clear or sharpen the image of characters.

Reset

Use this function to reset the product to the factory default. However, language selection will not be initialized.

Troubleshooting

ENGLISH

No image is displayed

- Is the product power cord connected?
 - Does the power indicator is turned on?
 - Power is on, power indicator is blue but the screen appears extremely dark.
 - Does the power indicator look amber?
 - Does the 'Out of range' message appear?
 - Does the 'Check signal cable' message appear?
- See if the power cord is properly connected to the outlet.
 - See if the power switch is turned on.
 - Adjust brightness and contrast again.
 - If the product is in power saving mode, move the mouse or press any key.
 - The signal from the PC (video card) is out of the vertical or horizontal frequency range of the product. Adjust the frequency range by referring to the Specifications in this user's guide.
 - * **Maximum resolution**
 - 17 inch : 1280 x 1024 @60Hz
 - 19 inch : 1280 x 1024 @60Hz
 - The signal cable between PC and product is not connected. Check the signal cable.
 - Press the 'INPUT' button in the remote control to check the input signal.

'Unknown Product' message appears when the product is connected.

- Did you install the driver?
- Install the product driver, which is provided with the product, or download it from the web site. (<http://www.lge.com>)
 - See if the plug&play function is supported by referring to the video card user's guide.



Note

* **Vertical frequency:** To enable the user to watch the product display, screen image should be changed tens of times every second like a fluorescent lamp. The vertical frequency or refresh rate is the times of image display per second. The unit is Hz.

* **Horizontal frequency:** The horizontal interval is the time to display one vertical line. When the 1 is divided by horizontal interval, the number of horizontal lines displayed every second can be tabulated as the horizontal frequency. The unit is kHz.

Troubleshooting

The screen image looks abnormal.

- Is the screen position wrong?

If adjustment is not satisfactory, use the Position menu in OSD.

- See if the video card resolution and frequency are supported by the product. If the frequency is out of range, set to the recommended resolution in the Control Panel – Display – Setting menu.

- Do thin lines appear on the background screen?

If adjustment is not satisfactory, use the Clock menu in OSD.

- Horizontal noise appears or the characters look blurred.

If adjustment is not satisfactory, use the Phase menu in OSD.

After-image appears on the product.

- After-image appears when the product is turned off.

- If you use a fixed image for a long time, the pixels may be damaged quickly. Use the screensaver function.

The audio function does not work.

- | | |
|---|---|
| <ul style="list-style-type: none"> ● No sound?

 ● Sound is too low. | <ul style="list-style-type: none"> • See if the audio cable is connected properly. • Adjust the volume. • See if the sound is set properly.

 • Adjust the volume. |
|---|---|

The TV function does not work.

- | | |
|--|--|
| <ul style="list-style-type: none"> ● The TV signal is not being received. | <ul style="list-style-type: none"> • See if you have selected the proper channel mode. • Use the automatic channel setup function. • See if the TV antenna is properly connected. |
|--|--|

Screen color is abnormal.

- | | |
|--|--|
| <ul style="list-style-type: none"> ● Screen has poor color resolution (16 colours).

 ● Screen color is unstable or mono-coloured.

 ● Do black spots appear on the screen? | <ul style="list-style-type: none"> • Set the number of colours to more than 24 bits (true colour)
Select Control Panel – Display – Settings – color Table menu in Windows.
 • Check the connection status of the signal cable.
Or, re-insert the PC video card.
 • Several pixels (red, green, white or black colour) may appear on the screen, which can be attributable to the unique characteristics of the LCD panel. It is not a malfunction of the LCD. |
|--|--|

Specifications

The product specifications can change without prior notice for product improvement.

[17 inch]

LCD Panel	Screen Type	17 inches (43.27 cm) TFT (Thin Film Transistor) LCD (Liquid Crystal Display) Panel Visible diagonal size: 43.27 cm
	Pixel Pitch	0.264 mm
Video Signal	Max. Resolution	1280 X 1024 @ 60 Hz
	Recommended Resolution	1280 X 1024 @ 60 Hz
	Horizontal Frequency	30 - 70 kHz
	Vertical Frequency	56 - 75 Hz
	Synchronization Type	Separate
Input Connector		S-Video, Composite video, TV, D-Sub Analog, Headphone, PC Audio In
Power	Rated Voltage	AC 100-240V~ 50/60Hz 1.0A
	Power Consumption	On Mode : 40 W Sleep Mode ≤ 1 W Off Mode ≤ 1 W
Tilt	Tilt Range	-3° ~ 25°
	Swivel	345°
Dimension/Weight	Size (WxLxH)	389.5 mm x 232 mm x 437.9 mm
	Weight (excl. package)	5.28 kg (12.9 lbs)
Environmental Conditions	Operational Condition	Temperature: 10°C ~ 35°C , Humidity: 10% ~ 80%
	Storage Condition	Temperature: -20°C ~ 60°C , Humidity: 5% ~ 95%

The product specifications can change without prior notice for product improvement.

[19 inch]

LCD Panel	Screen Type	19 inches (48.19 cm) TFT (Thin Film Transistor) LCD (Liquid Crystal Display) Panel Visible diagonal size: 48.19 cm
	Pixel Pitch	0.294 mm
Video Signal	Max. Resolution	1280 X 1024 @60 Hz
	Recommended Resolution	1280 X 1024 @60 Hz
	Horizontal Frequency	30 - 70 kHz
	Vertical Frequency	56 - 75 Hz
	Synchronization Type	Separate
Input Connector		S-Video, Composite video, TV, D-Sub Analog Headphone, PC Audio In
Power	Rated Voltage	AC 100-240V~ 50/60Hz 1.0A
	Power Consumption	On Mode : 45 W Sleep Mode ≤ 1 W Off Mode ≤ 1 W
Tilt	Tilt Range	-3° ~ 25°
	Swivel	345°
Dimension/Weight	Size (WxLxH)	443.6 mm x 232.0 mm x 475.6 mm
	Weight (excl. package)	6.0 kg (13.23 lbs)
Environmental Conditions	Operational Condition	Temperature: 10°C ~ 35°C , Humidity: 20% ~ 80%
	Storage Condition	Temperature: -10°C ~ 60°C , Humidity: 5% ~ 95%

Specifications

● PC Mode – Preset Mode

[17 inch] [19 inch]

Preset mode			Horizontal Frequency (kHz)	Vertical Frequency (Hz)	Preset mode			Horizontal Frequency (kHz)	Vertical Frequency (Hz)
1	VGA	640 x 350	31.469	70	8	VESA	1024 x 768	48.363	60
2	VGA	720 x 400	31.468	70	9	VESA	1024 x 768	60.123	75
3	VGA	640 x 480	31.469	59	10	MAC	1152 x 870	68.681	75
4	VESA	640 x 480	37.500	75	11	VESA	1152 x 900	61.805	65
5	VESA	800 x 600	37.879	60	12	VESA	1280 x 1024	63.981	60
6	VESA	800 x 600	46.875	75					
7	MAC	832 x 624	49.725	74					

● Power Indicator

Mode	Product
On Mode	Blue
Sleep Mode	Amber
Off Mode	Off

● Theft prevention locking device

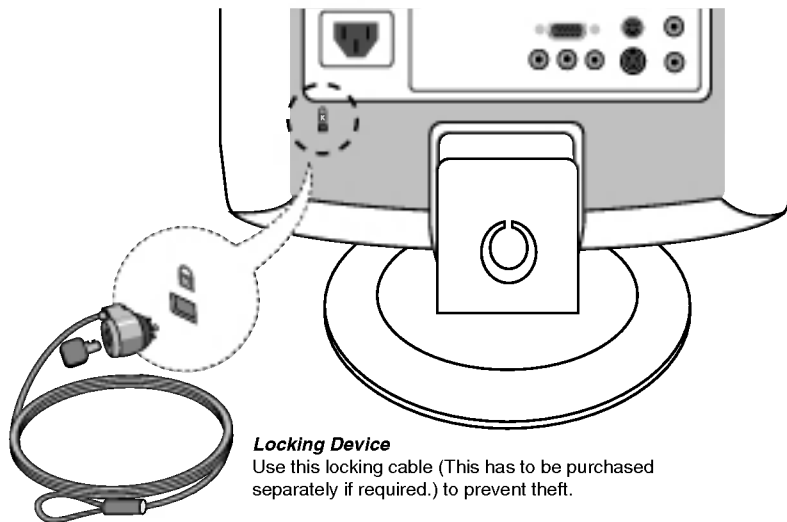

● VESA wall mounting

This product meets VESA-compliant mounting interface pad specifications.

1. Separate the Hinge Cover using a screwdriver as shown in the picture.

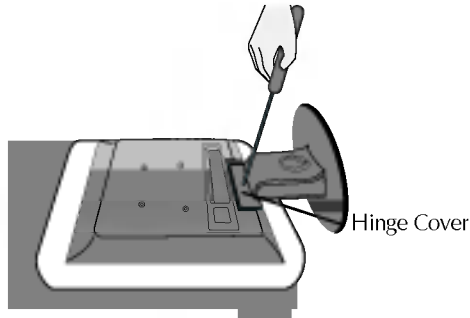

2. Please the product on a piece of cloth or other soft surface with the front side facing downward.
3. Separate the stand base using a screwdriver as shown in the picture.

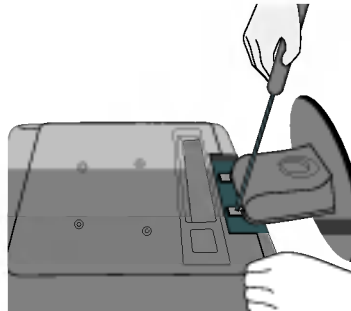

4. Install the VESA standrad wall mounting.

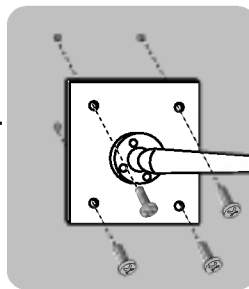
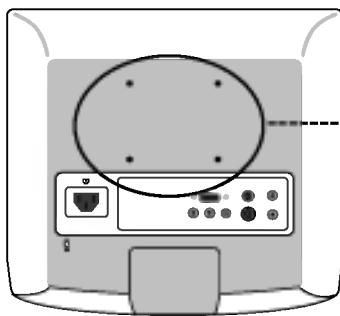

VESA wall mounting

Connected to another object (stand type and wall-mounted type). This product accepts a VESA-compliant mounting interfacepad. (This has to be purchased separately if required.) For further information, refer to the VESA Wall Mounting Instruction Guide.