

1 Remove Packaging

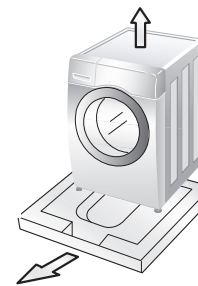

- The appliance is fitted with transit bolts to prevent internal damage during transport. **Be careful, heavy load!**
- Packing and all transit bolts must be removed before using the washing machine.

Store original packing for future move.
Dispose of packing material according to local regulations.

2 Transit bolts

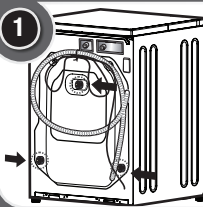

To prevent internal damage during transport, the special 3 bolts are locked. If they are not removed, it may cause heavy vibration, noise and machine to malfunction.



Remove the 3 bolts along with the rubber bungs by slightly twisting the bung.

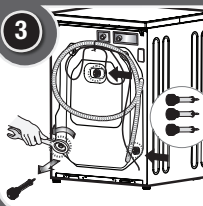

Unscrew the 3 bolts using the spanner supplied.

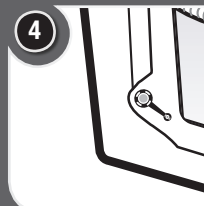

Close the holes with the caps supplied.

Keep the 3 bolts and the spanner for the future use. Refit transit bolts before transporting the appliance.

3 Requirements for installation site

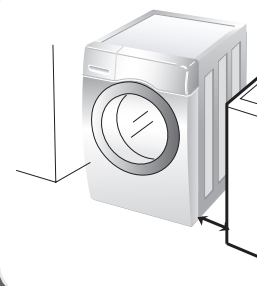

Level floor: Permissible floor gradient under entire washing machine is 1°.

Power socket: Must be within 100 cm of either side of location of washing machine. Do not overload the socket with more than one appliance.

Additional Clearance: For wall, floor and door space is needed. (10cm: rear / 2cm:right & left side). Do not place or store laundry products on top of the washing machine at any times. They can damage the finish or controls of the machine.

4 Electrical connection

- Do not use an extension cord or double adapter.
- Have damaged supply cords replaced by the manufacturer or its service agents or a similarly qualified person to prevent danger.
- Always unplug the machine and turn off the water supply after use.
- Connect the machine to an earthed socket in accordance with current wiring regulations.
- The appliance must be positioned so that the plug is easily accessible.
- Repairs to the washing machine must only be carried out by qualified personnel. Repairs carried out by inexperienced persons may cause injury or serious malfunctioning. Contact your local service centre.
- Do not install your washing machine in rooms where temperature below freezing may occur. Frozen hoses may burst under pressure. The electronic control unit may become unreliable at temperatures below freezing point.
- If the appliance is delivered in the winter months and temperatures are below freezing: Leave the washing machine standing at room temperature for a few hours before putting it into operation.

5 Connecting water supply hose

The hose supplied with the machine must be used. Old hoses may not be reused

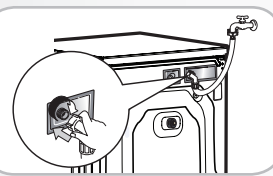

Water supply pressure must be between 100kPa~1000kPa (1.0-10 bar).

Don't strip or crossthread when connecting inlet hose to the valve.

If the water supply pressure is more than 1000kPa, a decompression device should be installed.

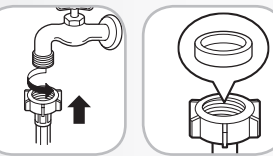

Two rubber seals are supplied with the water inlet hoses. They are used for preventing water leaks.

Make sure the connection to taps is tight enough.

Periodically check the condition of the hose and replace the hose if necessary.

Make sure that there is no kink on the hose and that it is not crushed.

If after completing connection water leaks from the hose, repeat the same steps. Use the most conventional type of tap for water supply. In case the faucet is square or too big, remove the spacing ring before inserting the tap into the adaptor.

6 Installation of drain hose

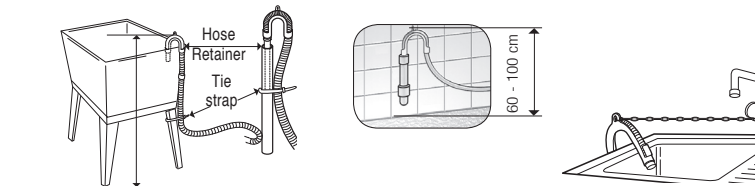
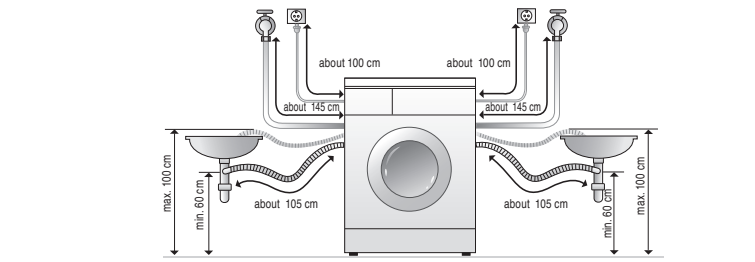

- The drain hose should not be placed higher than 100 cm above the floor.
- Proper securing of the drain hose will protect the floor from damage due to any water leakage.
- If the drain hose is too long do not force back into the washing machine. This will cause abnormal noise and cause the machine to malfunction and leak.

CAUTION

- The hose supplied with the machine must be used. Old hoses may not be reused.
- The appliance is not intended for use by young children or infirm persons without supervision.
- Young Children should be supervised to ensure that they do not play with appliance.

Level adjustment

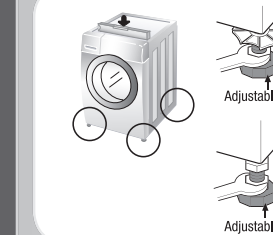

Proper level-adjustment of the washing machine prevents excessive noise and vibration. Install the appliance on a solid and level floor surface, preferably in a corner of the room.

If the floor is uneven, adjust feet as required. (Do not insert pieces of wood etc. under the feet). Make sure that all four feet are stable and resting on the floor. Then check that the appliance is perfectly level. (Use a spirit level).

Wooden floors (Suspended floors)

- Wooden floors are particularly susceptible to vibration.
 - To prevent vibration we recommend you place rubber cups under each foot, at least 15mm thick under the washer, secured to at least 2 floor beams with screws.
 - If possible install the washer in one of the corners of the room, where the floor is more stable.
- Insert the rubber cups to reduce vibration.
- You can obtain the rubber cups (p.no.4620ER4002B) from the LG spares dept.



Safety instructions for the installation

Install or store appliance where it will not be exposed to sub-zero temperatures or exposed to the weather. Fit ground of the washing machine correctly to conform with all statutory regulations and ordinances. Ensure that the base opening is free from obstruction by carpeting if the washing machine is installed on a carpeted floor. In countries where there is a risk of cockroach infestation or other vermin, pay particular attention to keep the appliance and its surroundings in a clean condition at all times. Any damage which may be caused by cockroaches or other vermin is not covered by the appliance guarantee.

CAUTION about positioning the appliance

Install the washing machine on a flat hard floor. Make sure that air circulation around the washing machine is not impeded by carpets, rug etc.

- Never try to correct any unevenness in the floor using pieces of wood, cardboard or similar materials under the washing machine.
- If it is not possible to position the washing machine away from a gas cooker or coal burning stove, an insulation panel (85x60cm) covered with aluminum foil on the side facing the cooker or stove, must be inserted between the two appliances.
- The washing machine must not be installed in rooms where the temperature may drop below 0°C.
- Please ensure that when the washing machine is installed an engineer can gain easy access in the event of a breakdown.
- Adjust all four feet using the transit bolt spanner provided to ensure that the appliance is stable, with 20mm clearance between the top of the washing machine and underside of the worktop.

CAUTION about the power cord

We recommend connecting most appliances to a dedicated circuit. That is, a single outlet supplying power only to the appliance concerned, without any additional outlets or branch circuits. Check the specifications of this owner's manual. Do not overload wall sockets. Overloaded wall sockets, loose or damaged wall sockets or extension cords, frayed power cords, damaged or cracked wire insulation are dangerous. Any of these conditions could result in electric shock or fire. Periodically examine the cord of your appliance, and if its appearance indicates damage or deterioration, unplug it, discontinue use of the appliance, and have the cord replaced with an exact replacement part by an authorized service. Protect the power cord from physical or mechanical abuse, such as being twisted, kinked, pinched, squashed in a jamb of a door, or walked upon. Pay particular attention to plugs, wall outlets, and the point where the cord exits the appliance. We recommend to use a residual current operated device in the mains supply.

CAUTION about location and moving

This equipment is not designed for maritime use or for use mobile installations such as caravans, aircraft etc. Turn off the stop-cock if the machine is to be left for any length of time (e.g. if you are going on holiday), especially if there is no floor drain (gully) in the immediate vicinity. If relocating the appliance use the original packing material. Disable the door lock to prevent young children becoming trapped inside. Packaging material (e.g. plastic film, Styrofoam) can be dangerous for children. There is a risk of suffocation! Keep all packaging well away from children.

CAUTION about the floor surface

- The installation surface must be clean, dry and level.
- Install washing machine on a flat hard floor.
- Proper placement and levelling of the washing machine ensure long, regular and reliable operation.
- The washing machine must be perfectly level and firmly in position.
- It must not "see-saw" across corners under load.
- The installation surface must be clean, free from floor wax and other lubricant coatings.
- Do not allow the feet of the washing machine to get wet. If feet of the washing machine get wet, slipping may occur.

Technical Specification

Name of product	Front loading washing machine	Max. Watt	2200 W
Power supply	220-240 V~, 50 Hz	Wash capacity	11 kg
Size WxDxH mm:	600 x 640 x 850	Water consumption	77 ℓ (7 ℓ / kg)
Weight	70 kg	Permissible water pressure	100-1000 kPa (1.0-10 bar)

Safety instructions for use

Read all instructions and explanations of the installation before use. Follow the instructions carefully. Keep the operating instructions handy for later use. If the appliance is sold or passed on then ensure that the new owner always receives these operating instructions. The following warnings must be strictly observed for safety reasons. They must be read before installing the appliance and putting it into operation.

- Intended use: This appliance has been designed exclusively for use in dry-interior households. Use the appliance only with cold drinking water and only for washing textiles with washing detergents designed for washing machines. Every other use is improper and may lead to injuries, whereby the liability of the manufacturer will cease.
- This appliance may only be used by adults. Do not allow children to touch the controls or to play with the product.
- Never modify the appliance on your own, as this is dangerous.
- This appliance is heavy. Transporting with care.
- Remove all packaging and transport bolts before using the appliance. Otherwise serious damage may result.
- All installation work must be carried out by a qualified fitter or technician.
- Have electrical connections done by a qualified electrician.
- Never place the appliance on the power cord.
- If the appliance is placed on a carpet then place the feet so that air can circulate underneath the appliance.
- Always unplug the machine and turn off the water supply after use. Disconnect appliance by pulling only the plug - never disconnect by pulling the power cord. Never touch the plug with wet fingers or hands.
- Do not overload the appliance.
- Wash only machine-washable textiles. If you have doubts regarding this, then observe the markings on the label.
- Never place electrical heaters, candles etc. in the vicinity of the appliance. They could cause the appliance to ignite or parts to warp.
- Protect the appliance from wet and damp. Otherwise, there is danger of electric shock and fire.
- Connect the appliance to a suitable wall socket for 220-240V. Never use an extension cord or double adapter.
- Empty all pockets. Hard or sharp objects such as coins, needles, nails, screws or stones may cause serious damage. Unbalanced mass may create heavy vibrations. If heavy vibrations remain also without load, call for an authorized customer service.
- Do not wash or dry articles that have been cleaned in, washed in, soaked in, or dabbed with combustible or explosive substances (such as wax, oil, paint, gasoline, degreasers, dry-cleaning solvents, kerosene, etc.). This may result in fire or explosion.
- Never insert products coated with mineral oils (e.g. nylon coating, plastic belts, etc.) into the machine. If a stain remover has been used then make sure that the solvent has been carefully washed out before inserting the clothes into the appliance. Oil may remain in the tub after a whole cycle resulting in fire during drying. So, do not load oily clothes.
- Do not operate the appliance at locations where flammable substances are present such as oil, benzene or highly inflammable gas. Such materials may cause fire or explosion. Never use combustible detergents.
- Only add the prescribed amount of softener. Excessive amounts may damage the clothes.
- After washing, keep the drum door open to protect the door seal.
- Make sure that all water has run off before opening the door. Never open the door if water still remains. Danger of scalding.
- Animals and children may get into the washing machine. So always check the appliance before using it.
- During washing, the glass door becomes very hot. Keep children away from the appliance when in operation.
- Never try to repair the machine yourself. Incorrect repairs may result in injuries and/or serious defects to the machine.
- The product should be serviced and repaired only by the authorised customer service using original replacement parts.
- When disposing of your old machine, the power cable must be capped and the door lock must be made unusable in order to protect children.
- When placing on a carpeted floor, make sure that the opening in the socket is not blocked.
- If the appliance has been under water then contact the customer service. There is danger of electric shock and fire.
- The cover cup of the filter as well as the dispenser drawer may not be opened during the operation.
- Keep all washing powder and detergents away from children. Danger of poisoning

Troubleshooting

	Water supply is not adequate in area Water supply taps are not completely open. Water inlet hose(s) are kinked. The filter of the inlet hose(s) are clogged.	Check another tap in the house. Fully open tap. Straighten hose(s). Check the filter of the inlet hose(s).
	Drain hose is kinked or clogged. The drain filter is clogged.	Clean and straighten the drain hose. Clean the drain filter. For more detailed information, please refer to "Cleaning the drain pump filter"
	Load is too small. Load is out of balance. The appliance has an unbalance detection and correction system. If individual heavy articles are loaded (ex. bath mat, both robe, etc.), this system may stop spinning or even interrupt the spin cycle altogether. If the laundry is still too wet at the end of the cycle, add smaller articles of laundry to balance the load and repeat the spin cycle.	Add 1 or 2 similar items to help balance the load. Rearrange load to allow proper spinning
	Is the door opened or not completely closed?	Close the door completely. * If "dE" is not released, call for service.
		Unplug the power plug and call for service.
	Water overfills due to the faulty water valve.	Close the water tap. Unplug the power plug. Call for service.
	Water level sensor has malfunctioned.	
	Over load in motor.	
	Water leaks	Call for service.
	The washer experienced a power failure.	Restart the cycle.

Rattling and clanking noise	Extraneous objects such as coins or safety pins maybe in drum or pump.
Thumping sound	Heavy wash loads may produce a thumping sound. This is usually normal.
Vibrating noise	Have all transit bolts and packing been removed?
Water leaks.	Check and tighten hose connections. Unclog drain pipe. Contact plumber if necessary.
Excessive suds	Too much detergent or unsuitable detergent.
Washing machine does not start	Power cord may not be plugged in or connection may be loose.
Washing machine won't spin	Check that the door is firmly shut.
Door does not open	Once started, the door can not be opened for safety reasons. Wait one or two minutes before opening the door to allow the electric locking mechanism time to release.



Owner's Manual

WF-7111TFD

WF-7111WFD



Before use please read carefully the safety instructions!

Thank you for buying an LG fully automatic washing machine. Please read this owner's manual carefully, it provides instructions on safe installation, use and maintenance. Keep it handy for future reference of this machine. Make a note of the model and serial numbers of your washing machine.

P/No.: MFL63288753

Preparation



CHECKING THE MACHINE

Never use a defective machine! In case of any failure, first unplug the machine and turn off the water tap.



WATER CONNECTION

Turn on the water tap



HANG UP WASTE WATER HOSE

Hose elbow connection e.g. attach to water tap



INSERT PLUG INTO THE MAINS SOCKET

Never touch the plug with wet hands! Never remove the plug from the socket by pulling on the cord.



DOING LAUNDRY AND USING MACHINE WITH CARE

- empty all pockets
- remove all metal parts
- place the delicate textiles into the laundry net
- close zippers



LAUNDRY WITH DIFFERENT AMOUNTS OF SOILING

- wash new textiles separately
- do not prewash
- pretreat dirty spots
- pre wash



WATER TREATMENT

- with hardness III water
- use water softening agent (please dispensing into main wash compartment after use detergent.)



DRUM CARE

- remove extraneous objects
- leave door open to dry the drum
- check the rubber seals regularly



ECOLOGICAL WASHING

- make use of the max. washing quantity
- do not "pre wash" if possible
- use short program if possible

Washing symbols



Washing temperature



Luke warm ironing



Hot ironing



Do not tumble dry



Drip dry



Do not bleach



Do not wash



Medium hot ironing



Do not iron



Hang to dry



Dry flat



Handy to bleach

Dispenser drawer

A Pre Wash

For very dirty clothes fill 1/4 of the portion of detergent in here and select a prewashing program

B Main Wash

For normal dirty clothes use a small amount of detergent. Don't pre wash. Mount the level plate to use fluid detergents

C Softener

Do not exceed the MAX-Level. Highly densified softeners are to be diluted with some water.

Washing program table

Program	Description	Fabric Type	Water Temp. (Selection)	Spin Speed (Selection)	Option	Maximum Load
Cotton	Provide better performance by combining various drum motions	Color fast garments (shirts, nightdresses, pajamas...) and lightly soiled white cotton (underwear)	40°C (Cold to 95°C)	1400 ("No Spin" to 1400)		Rating
Cotton Eco	Provide optimized washing performance with less energy consumption		60°C (Cold to 60°C)			
Easy Care	This cycle is suitable for casual shirt which doesn't need to iron after washing.	Polyamide, Acrylic, Polyester	40°C (Cold to 60°C)	1000 ("No Spin" to 1000)	- Time Delay - Crease Care - Favorite - Pre Wash - Medic Rinse - Rinse+Spin - Time Save - Intensive	5.5 kg
Silent Wash	Provide less noise and vibration and save money by using overnight electricity.	Color fast garments (shirts, nightdresses, pajamas...) and lightly soiled white cotton (underwear)	40°C (Cold to 40°C)	800 ("No Spin" to 1000)		6.5 kg
Mix	Enable to wash various fabrics at once.	Various kind of fabrics except special garments. (silk/delicate/sports wear, dark clothes, wool, Duvet/Curtains)	40°C (Cold to 40°C)	1000 ("No Spin" to 1400)		5.5 kg
Skin Care	Remove efficiently detergent residue in clothes	Fabrics which will be in direct contact with the skin, e.g. underwear, nappies, towelling, bed linen, pillow and mattress covers	40°C (Cold to 60°C)	1400 ("No Spin" to 1400)		Rating
Baby care	Remove solid and protein stain and provide better rinse performance	Lightly soiled baby wear	60°C (95°C)	1000 ("No Spin" to 1000)	- Time Delay - Crease Care - Favorite - Pre Wash - Medic Rinse - Rinse+Spin - Intensive	5.5 kg
Duvet	This cycle is for big clothes such as bed cover, pillow, sofa cover and etc.	Cotton bedding with filling duvet, pillow, blanket, sofa cover with light filling	40°C (Cold to 40°C)	800 ("No Spin" to 800)	- Time Delay - Favorite - Crease Care - Rinse+Spin - Time Save - Intensive	1 single size
Sports Wear	This cycle is suitable for sports wear such as jogging clothes, and running wear and Sympatex	Coolmax, gore tex, fleece and Sympatex	30°C (Cold to 40°C)	800 ("No Spin" to 1400)		3.0 kg
Dark Wash	If the clothes are possibility to decolorize, please use this cycle. The cycle prevent decolorization. (Please use detergent for coloured fabrics.)	Dark garments made from cotton or mixed fabrics.	30°C (Cold to 40°C)	800 ("No Spin" to 800)		
Delicate	This cycle is for delicate clothes such as underwear, blouse and etc.	Delicate laundry easily damaged	40°C (Cold to 40°C)	800 ("No Spin" to 800)	- Time Delay - Crease Care - Favorite - Rinse+Spin - Intensive	
Wool	Enable to wash wool fabrics. (Please use detergent for machine-washable woollens)	Machine washable woollens with pure new wool only	40°C (Cold to 40°C)	800 ("No Spin" to 800)		
Quick 30	This cycle provide fast washing time for small load and light soiled clothes.	Colored laundry which is lightly soiled fast	30°C (Cold to 40°C)	800 ("No Spin" to 1400)		
Intensive 60 (suitable as short program)	Within 60mins provide better washing performance and energy efficiency.	Cotton and mix fabrics (Special PROGRAM within 60mins for normally soiled laundry)	60°C (Cold to 60°C)	1000 ("No Spin" to 1400)		5.5 kg

Water Temperature: Select water temperature to suit wash cycles. Always follow garment manufacture's care label or instructions when washing. Set program at "Cotton Eco 60°C + Intensive + Maximum spin speed" option for test in accordance with EN60456 and IEC60456.

Notes on comparative tests :

When you select Cotton, Easy care, Intensive 60, select additional option: Intensive and Maximum spin speed. The test results are depended on water pressure, water hardness, water inlet temperature, room temperature, type and amount of load, degree of soiling utilized detergent, fluctuations in the maintain electricity supply and chosen additional options.



The wool wash cycle of this machine has been approved by Woolmark for the washing of machine washable Woolmark products provided that the products are washed according to the instructions on the garment label and those issued by the manufacturer of this washing machine M0912.

Notes: Neutral detergent is recommended. The wool cycle features gentle tumbling and low-speed spin for garment care.

Warning: Keep all washing powder and detergents away from children. Danger of poisoning

Sort the laundry

note washing instruction symbols - Degree of soiling - Type of textile / colour



Fill the drum

Check the folds of the flexible gasket (grey) - and remove any small articles, if any. Check inside of the drum and remove - any left in items for next wash cycle. Remove any clothing or items on the flexible gasket - to prevent clothing and the gasket damages



Fill detergent

Refer to the written information on the detergent's packaging

※ Using the Tablets

1) Open the door and Tablets into the drum.

2) Load the laundry into the drum.



Turn the machine ON

by pressing the Power button

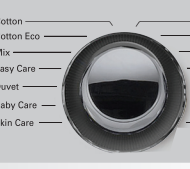

Select a Program

Select the **Spinning speed** - Spin only: Press the Power button, setting a spin speed at "No spin" - Drain only: Press the Power button, setting a spin speed at "No spin" - Note: Hands off the program dial when select the Spin or Drain only.



Medic Rinse

For best results or for cleaner rinsing, you can choose Medic Rinse option. Rinse+Spin : This can be helpful in preventing fresh stains from setting in fabrics.

Time Save : This option can be used to reduce the time of a wash program. To use this option press option button before wash program is started

Intensive : If the laundry is normally and heavily soiled, "Intensive" option is effective.

Select Rinse mode and Washing temperature

Rinse+ + Hold : Add rinse once then after rinsing process, the course is paused until consumers press start button again when rinse is finished.

Normal+Hold : The course is paused until consumers press start button again when rinse is finished.

Rinse++ : Add rinse twice

Rinse+ : Add rinse once

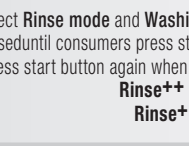

Control panel

Dispenser drawer

Drum

Cover cap

Spin

Wait until washing is finished

Press Start / Pause to start the washing process

4 additional programs

Time Delay / Crease Care / Favorite / Pre Wash

Additional programs

Display

Spinning cycle

Power button

Program Cycle

Start / Pause

Options

Rinse

Temperature

Turn off tap

Additional Steps

Remove laundry

Child Lock

Tub Clean

Changing the language

Beep on / off

Cleaning and Maintenance

Cleaning the water inlet filter

Cleaning the drain pump filter

Cleaning the dispenser drawer

Cleaning in general

Exterior

Interior

Warning

Notes

Additional programs

Time Delay

Crease Care

Favorite

Pre Wash

Child Lock

Tub Clean

Changing the language

Beep on / off

Cleaning and Maintenance

Cleaning the water inlet filter

Cleaning the drain pump filter

Cleaning the dispenser drawer

Cleaning in general

Exterior

Interior

Warning

Notes

Additional programs

Time Delay

Crease Care

Favorite

Pre Wash

Child Lock

Tub Clean

Changing the language

Beep on / off

Cleaning and Maintenance

Cleaning the water inlet filter

Cleaning the drain pump filter

Cleaning the dispenser drawer

Cleaning in general

Exterior

Interior

Warning

Notes

Additional programs

Time Delay

Crease Care

Favorite

Pre Wash

Child Lock

Tub Clean

Changing the language

Beep on / off

Cleaning and Maintenance

Cleaning the water inlet filter

Cleaning the drain pump filter

Cleaning the dispenser drawer

Cleaning in general

Exterior

Interior

Warning

Notes

Additional programs

Time Delay

Crease Care

Favorite

Pre Wash

Child Lock

Tub Clean

Changing the language

Beep on / off

Cleaning and Maintenance

Cleaning the water inlet filter

Cleaning the drain pump filter

Cleaning the dispenser drawer

Cleaning in general

Exterior

Interior

Warning

Notes

Additional programs

Time Delay

Crease Care

Favorite

Pre Wash

Child Lock

Tub Clean

Changing the language

Beep on / off

Cleaning and Maintenance

Cleaning the water inlet filter

Cleaning the drain pump filter

Cleaning the dispenser drawer

Cleaning in general

Exterior

Interior

Warning

Notes

Additional programs

Time Delay

Crease Care

Favorite

Pre Wash

Child Lock

Tub Clean

Changing the language

Beep on / off

Cleaning and Maintenance

Cleaning the water inlet filter

Cleaning the drain pump filter

Cleaning the dispenser drawer

Cleaning in general

Exterior

Interior

Warning

Notes

Additional programs

Time Delay

Crease Care

Favorite

Pre Wash

Child Lock

Tub Clean

Changing the language

Beep on / off

Cleaning and Maintenance

Cleaning the water inlet filter

Cleaning the drain pump filter

Cleaning the dispenser drawer

Cleaning in general

Exterior

Interior

Warning

Notes

Additional programs