



ENGLISH

OWNER'S MANUAL

Portable DVD Player

Please read this manual carefully before operating your set and retain it for future reference.

MODEL

DP650
DP650B

P/NO : MFL67007226

1 Safety Information

Cautions and Warnings

WARNING: TO PREVENT FIRE OR ELECTRIC SHOCK HAZARD, DO NOT EXPOSE THIS PRODUCT TO RAIN OR MOISTURE.

WARNING: Do not install this equipment in a confined space such as a book case or similar unit.

CAUTION: Do not block any ventilation openings. Install in accordance with the manufacturer's instructions.

Slots and openings in the cabinet are provided for ventilation and to ensure reliable operation of the product and to protect it from over heating. The openings should never be blocked by placing the product on a bed, sofa, rug or other similar surface. This product shall not be placed in a built-in installation such as a bookcase or rack unless proper ventilation is provided or the manufacturer's instruction have been adhered to.

CAUTION concerning the Power Cord

Most appliances recommend they be placed upon a dedicated circuit;

That is, a single outlet circuit which powers only that appliance and has no additional outlets or branch circuits. Check the specification page of this owner's manual to be certain. Do not overload wall outlets. Overloaded wall outlets, loose or damaged wall outlets, extension cords, frayed power cords, or damaged or cracked wire insulation are dangerous. Any of these conditions could result in electric shock or fire. Periodically examine the cord of your appliance, and if its appearance indicates damage or deterioration, unplug it, discontinue use of the appliance, and have the cord replaced with an exact replacement part by an authorized service centre. Protect the power cord from physical or mechanical abuse, such as being twisted, kinked, pinched, closed in a door, or walked upon. Pay particular attention to plugs, wall outlets, and the point where the cord exits the appliance. To disconnect power from the mains, pull out the mains cord plug. When installing the product, ensure that the plug is easily accessible.

This device is equipped with a portable battery or accumulator.

Safe way to remove the battery or the battery from the equipment: To remove the old battery or battery pack, follow the installation steps in reverse order than the assembly. To prevent contamination of the environment and bring on possible threat to human and animal health, the old battery or the battery put it in the appropriate container at designated collection points. Do not dispose of batteries or battery together with other waste. It is recommended that you use local, free reimbursement systems batteries and accumulators. The battery should not be exposed to excessive heat such as direct sunlight, fire or the like.



CAUTION: This product employs a Laser System. To ensure proper use of this product, please read this owner's manual carefully and retain it for future reference. Should the unit require maintenance, contact an authorized service center. Use of controls, adjustments or the performance of procedures other than those specified herein may result in hazardous radiation exposure. To prevent direct exposure to laser beam, do not try to open the enclosure. Visible laser radiation when open. **DO NOT STARE INTO BEAM.**

CAUTION:

- The apparatus should not be exposed to water (dripping or splashing) and no objects filled with liquids, such as vases, should be placed on the apparatus.
- Minimum distances around the apparatus for sufficient ventilation, no less than 5 cm.
- The ventilation should not be impeded by covering the ventilation openings with items, such as newspapers, table-cloth, curtains etc.
- No naked flame sources, such as lighted candles,

should be placed on the apparatus.

- Internal lithium battery in the DVD should not be replaced by user because of danger of explosion if battery is incorrectly replaced, and must be replaced with the same type battery by expert.
- Use the apparatus in tropical and moderate climates only.

Notes on Copyrights

- This product incorporates copyright protection technology that is protected by U.S. patents and other intellectual property rights. Use of this copyright protection technology must be authorized by Rovi Corporation, and is intended for home and other limited viewing uses only unless otherwise authorized by Rovi Corporation. Reverse engineering or disassembly is prohibited.
- Under the U.S. Copyright laws and Copyright laws of other countries, unauthorized recording, use, display, distribution, or revision of television programs, videotapes, DVDs, CDs and other materials may subject you to civil and/or criminal liability.

Caution of usage in the car

- To prevent electrical shock and possible damage to your unit or vehicle, always unplug the automotive adapter from the cigarette lighter socket before you remove the plug from your unit.
- A 3 amp, 250 V fuse for protection is installed in the automotive adapter.
- While the engine is being started, disconnect the automotive adapter from the car's cigarette lighter socket.
- Do not operate your unit when the car battery is discharged. Peak current from the car generator may cause the DC fuse to blow.
- If the vehicle's supply voltage drops below approximately 10 volts, your unit may not work properly.
- Do not leave your unit in a place where the temperature exceeds 45 °C (113 °F), or the pick-up device may be damaged.

Caution of Unit handling

- **Shipping the unit**
Save the original packing materials and re-pack the unit with them to maximize protection.
- **Cleaning the unit**
Clean the unit using a soft and dry cloth with a mild detergent solution, not strong solvents occurred the damage of surface.
Do not leave the unit with rubber or plastic materials for a long period.
- **Maintaining performance of the unit**
Maintain the cleaning status of optical pick-up lens and disc drive parts clean. If they are dirty or worn, the displayed quality could be diminished. For details, please contact your nearest authorized service center.

Contents

1

Safety Information

- 3 Cautions and Warnings

2

Preparation

- 6 Introduction
 - 6 Symbols Used in this Manual
 - 6 About the "Ⓢ" Symbol Display
 - 6 Playable Discs
 - 6 Regional Code
 - 7 File compatibility
 - 7 Rechargeable battery

Main Unit

- 8 Supplied Accessories

3

Installation

- 9 Connecting the AC Adaptor
- 9 Connecting the Automotive Adaptor
- 9 Connecting Audio and Video cable
- 9 Setup
 - 9 Adjust the settings
 - 10 [LANGUAGE] Menu
 - 10 [DISPLAY] Menu
 - 10 [AUDIO] Menu

- 10 [LOCK] Menu
- 10 [OTHERS] Menu

4

Operation

- 11 On-Screen display
- 11 General Playback
- 12 General operation
- 12 Advanced Playback
- 12 Movie
- 13 Music
- 13 Photo

5

Troubleshooting

- 14 Troubleshooting

6

Appendix

- 15 Area Code List
- 16 Language code List
- 17 Specifications
- 17 Trademarks and Licenses

1

2

3

4

5

6

2 Preparation





2

Preparation

Introduction

Symbols Used in this Manual

A section whose title has one of the following symbols are applicable only to the disc represented by the symbol.

	DVD-Video, DVD±R/RW
	Audio CDs
	Movie files contained in the USB/Disc
	Music files contained in the USB/Disc
	Photo files

About the “” Symbol Display

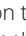
“” may appear on the screen during operation and indicates that the function explained in this owner’s manual is not available on that specific media.

Playable Discs



DVD-VIDEO (8 cm / 12 cm disc)
Discs such as movies that can be purchased or rented.



DVD±R (8 cm / 12 cm disc)
- Video mode and finalized only
- Supports the dual layer disc also
- DVD±R discs that contain Movie, Music or Photo files.



DVD-RW (8 cm / 12 cm disc)
- VR mode, Video mode and finalized only
- DVD-RW discs that contain Movie, Music or Photo files.



DVD+RW (8 cm / 12 cm disc)
- Video mode and finalized only
- DVD+RW discs that contain Movie, Music or Photo files.



Audio CD (8 cm / 12 cm disc)



CD-R/RW (8 cm / 12 cm disc)
CD-R/RW discs that contain audio titles, Movie, Music or Photo files.

Regional Code

This unit has a regional code printed on the rear of the unit. This unit can play only DVD disc labeled same as the rear of the unit or “ALL”.

File compatibility

Overall

Available File extensions: ".jpg", ".avi", ".divx", ".mpg", ".mpeg", ".mp3", ".wma"

- Some wav files are not supported on this player.
- The file name is limited to 45 characters.
- Depending on the size and number of the files, it may take several minutes to read the contents on the media.

Maximum Files/Folder: Less than 600 (total number of files and folders)

CD-R/RW, DVD±R/RW Format:
ISO 9660+JOLIET

MOVIE

Available resolution size:

720 x 576 (W x H) pixels

Playable subtitle: SubRip (.srt / .txt), SAMI (.smi), SubStation Alpha (.ssa/.txt), MicroDVD (.sub/.txt), SubViewer 2.0 (.sub/.txt), TMPlayer (.txt), DVD Subtitle System (.txt)

Playable Codec format: "DIVX3.xx", "DIVX4.xx", "DIVX5.xx", "DIVX6.xx" (Standard playback only), "MP43", "3IVX"

- This player does not support the file that are recorded with GMC*1 or Qpel*2. Those are video encoding techniques in MPEG4 standard, like DivX or XVID have.

*1 GMC – Global Motion Compensation

*2 Qpel – Quarter pixel

Playable Audio format: "Dolby Digital", "PCM", "MP3", "WMA"

Sampling frequency: within 32 - 48 kHz (WMA), within 8 - 48 kHz (MP3)

Bit rate: within 32 - 192 kbps (WMA), within 8 - 320 kbps (MP3)

MUSIC

Sampling frequency: within 32 - 48 kHz (WMA), within 8 - 48 kHz (MP3)

Bit rate: within 8 - 320 kbps (MP3), within 32 - 192 kbps (WMA)

PHOTO

Recommended size:

more than 32 x 32 x 32 bit/pixel

less than 5760 x 4608 x 32 bit/pixel

Rechargeable battery

- The internal rechargeable battery provides you with the freedom to pass it around and play the files without the power cord.
- The internal rechargeable battery will start charging only when the unit is turned off and the AC adaptor is connected to a power outlet.
- The charging stops if you turn on the unit.
- The charging will take approximately 2 hours and 30 minutes.
- Operating time on battery: approximately 2 hours and 30 minutes. The operating time on battery may vary depending on the battery status, operational status and environment conditions, and the maximum playing time is possible up to 3 hours.
- When the remaining time of the battery power is under a few minutes, "▲ Check Battery" will blink on the screen.

Main Unit

2 Preparation

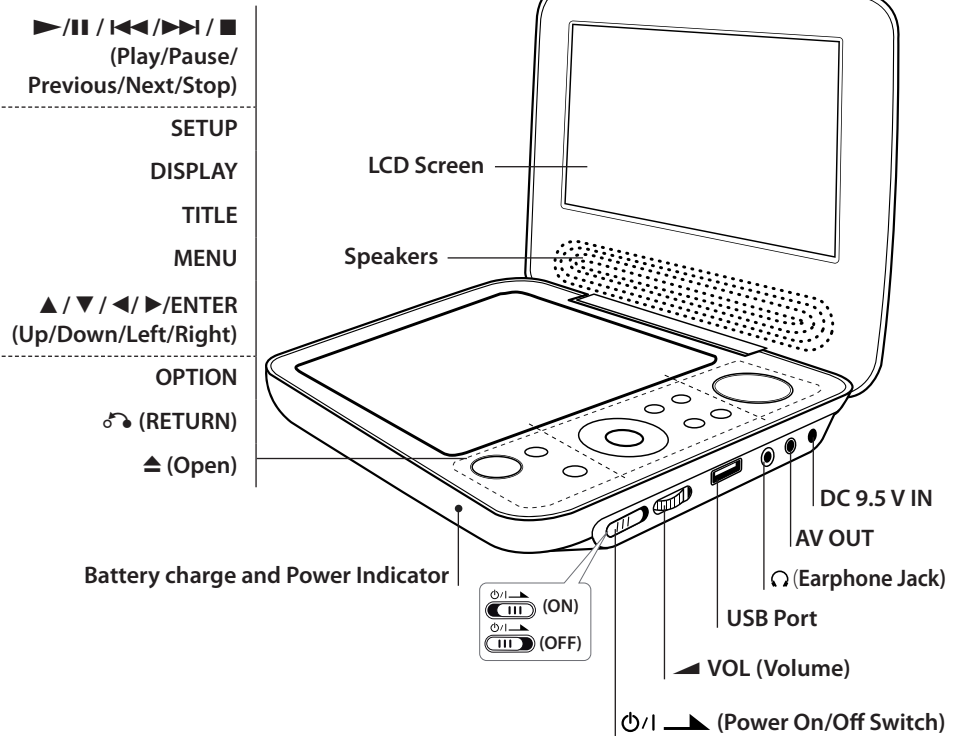

Supplied Accessories

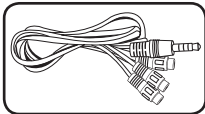

RCA Video/Audio Adaptor (1)

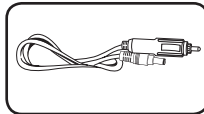

Automotive Adaptor (1)

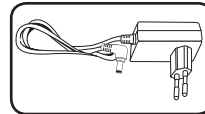

AC Adaptor (MPA-20P) (1)

- The actual AC Adaptor may differ from the drawing.

3 Installation

Connecting the AC Adaptor

Connect the unit to the power supply with the supplied AC Adaptor.

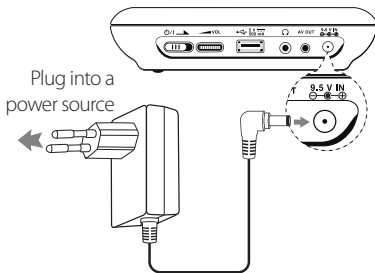

- Contact an electrical parts distributor for assistance in selecting a suitable AC plug adaptor or AC cord set.
- This AC adaptor is manufactured by NANJING WANLIDA TECHNOLOGY CO., LTD.

Connecting the Automotive Adaptor

Connect the unit to the Cigarette lighter socket with the supplied Automotive Adaptor.

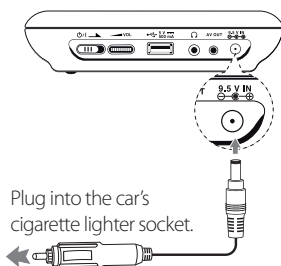

- Contact an electrical parts distributor for assistance in selecting a suitable Automotive Adaptor.

- This Automotive Adaptor is manufactured by NANJING WANLIDA TECHNOLOGY CO., LTD.

Connecting Audio and Video cable

Connect the AV OUT on the unit to AV cable connected from TV with the supplied AV Adaptor.

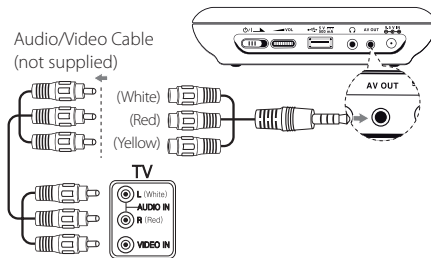

Setup

When the unit is turned-on for the first time, you have to select the desired language.

Adjust the settings

1. Press **SETUP**.
2. Use **▲▼** to select the first setup option, and press **▶** to move to the second level.
3. Use **▲▼** to select a second setup option, and press **▶** to move to the third level.
4. Press **▲▼** to move the desired option and press **ENTER**.

[LANGUAGE] Menu

Menu Language/Disc Audio/Disc Subtitle/Disc Menu

Select and set the language you prefer or appropriate.

[DISPLAY] Menu

TV Aspect

Select and set TV aspect ratio according to your TV type and preference.

[4:3]: Standard TV type

[16:9]: Wide TV type

Display Mode

Select and set Display Mode according to your preference. Display Mode works only when the TV Aspect mode is 4:3.

[Letterbox]: Display wide screen with black stripe at top and bottom on TV

[Panscan]: Display full screen with cut non-main scene on TV

[AUDIO] Menu

Set the player's Audio options according to various disc output type you use.

DRC (Dynamic Range Control)

To adjust the volume level automatically when the Audio level reaches to more than the predetermined level (Dolby Digital only).

Vocal

To mix or not the vocal with music using the multi-channel karaoke DVD.

[LOCK] Menu

First, you have to create a 4-digit password on Area Code to use the LOCK menu. You can create or change the password using ▲▼◀▶

and ENTER.

Rating

To rate level from 1 (Kids) to 8 (Adult).

Password

To create or change the password.

If you forget the password

Remove the disc, press SETUP and OPTION buttons, and then press ENTER after input "2104" The password will be cleared.

Area Code

To input the standardized area code refer to the Area Code List on page 15.

[OTHERS] Menu

REC Bitrate

To select bitrate when you record from Audio CD to USB directly. Higher bitrate gives better sound quality. For detailed recording method, see page 13.

DivX VOD

ABOUT DIVX VIDEO: DivX® is a digital video format created by DivX, Inc. This is an official DivX Certified® device that plays DivX video. Visit www.divx.com for more information and software tools to convert your files into DivX video.

ABOUT DIVX VIDEO-ON-DEMAND: This DivX Certified® device must be registered in order to play purchased DivX Video-on-Demand (VOD) movies. To obtain your registration code, locate the DivX VOD section in your device setup menu. Go to vod.divx.com for more information on how to complete your registration.

[Register]: Displays the registration code of your unit.

[Deregister]: Deactivate your unit and display the deactivation code.







4 Operation

On-Screen display

You can display and adjust various information on-screen about the loaded disc and USB Flash Drive.

Displaying content information on-screen **DVD** **MOVIE**

You can see the various playback information using DISPLAY and ▲▼◀▶.

Title  1/5	current title number/ total number of titles
Chapter  03/24	current chapter number/total number of chapters
Time  C 0:17:20 T 2:52:18	elapsed playing time/ total playback time
Audio  1. ENG D D 2/0 CH	selected audio language or channel
Subtitle  2. ENG	selected subtitle
Code Page  CP1252	selected proper subtitle code (MOVIE file only)
Angle  1/1	selected angle/total number of angles

General Playback

Playing Disc

1. Turn on the Power Switch.
2. Open the disc lid by pressing ▲ and insert a disc.
3. Close the disc lid.
4. Press ▶/|| to play.
DVD disc will be automatically loaded.

Playing USB Flash Drive

1. Turn on the Power Switch.
2. Insert the USB Flash Drive to unit.
3. Press ⏪ (RETURN) to use USB Flash Drive.
4. Select the desired file.
5. Press ▶/|| to play the file.

Music **ACD** **MUSIC**

To	Do this
Search for the file Number	Press OPTION and select Number Search, and then press ENTER. Select the desired Number using ▲▼ and select OK using ►, and then press ENTER.
Play repeatedly	Press OPTION during playback and select Repeat. And then, press OPTION or RETURN after selecting a repeat mode using ◀▶. (Track/All/Off)
Play randomly	Press OPTION and select Random, and then select ON or OFF using ◀▶. Press OPTION or RETURN.
Create or delete your own program	Select the desired file and press ► to move to "▶", and then press ENTER to create the music lists. Select the undesired file and press ► to move to "✕", and then press ENTER to delete programmed music lists. But, if you want to delete all from programmed lists, press ▼ to move to [Clear All] and then press ENTER.
Display the file information	Press DISPLAY repeatedly to see the contained information in MP3 file, [TITLE/ARTIST/ALBUM/YEAR/COMMENT].
Last Scene Memory	This unit can memorize and play the last viewed scene even if disc is inserted again after removal or unit is turned on after off with same disc. (ACD only)

Record the Audio CD to USB Flash Drive	Insert a USB flash drive and Audio CD in the unit. Press OPTION and select [CD Recording] menu. Select a desired track using ▲▼ and press ENTER. <ul style="list-style-type: none"> • [X1] or [X4] option Press OPTION on recording - X1: Recording to 1X speed listening to music - X4: Recording to 4X speed non-listening to music
---	--

The making of unauthorized copies of copy-protected material, including computer programs, files, broadcasts and sound recordings, may be an infringement of copyrights and constitute a criminal offense. This equipment should not be used for such purposes.

**Be responsible
Respect copyrights**

Photo **PHOTO**

To	Do this
Search for the file Number	Press OPTION and select Number Search, and then press ENTER. Select the desired Number using ▲▼ and select OK using ►, and then press ENTER.
View the slide show	Press ▲▼◀▶ to move to "☰" and press ENTER to view the slide show.
Adjust the slide show speed	Press ▲▼◀▶ to move to "☰" and press ◀▶ repeatedly to adjust the slide show speed.
Listen to music during slide show	Press ▲▼◀▶ to move to "☰" and press ENTER to listen to music during slide show.

5

Troubleshooting

Troubleshooting

Symptom	Cause	Solution
No power.	<ul style="list-style-type: none"> The power cord is disconnected. 	<ul style="list-style-type: none"> Plug the power cord into the wall outlet securely.
The power is on, but the unit does not work.	<ul style="list-style-type: none"> Disc is not inserted. 	<ul style="list-style-type: none"> Insert a disc.
No picture on other connected display devices, TV etc.	<ul style="list-style-type: none"> The TV is not set to receive the signal from the unit. 	<ul style="list-style-type: none"> Select the appropriate video input mode on the TV.
	<ul style="list-style-type: none"> The video cable is not connected securely. 	<ul style="list-style-type: none"> Connect the video cable securely.
No sound.	<ul style="list-style-type: none"> The volume is set to minimum. 	<ul style="list-style-type: none"> Use the volume controller to adjust the volume.
	<ul style="list-style-type: none"> The equipment connected with the audio cable is not set to receive the signal from the unit. 	<ul style="list-style-type: none"> Select the correct input mode of the audio amplifier.
	<ul style="list-style-type: none"> The AUDIO options are set to the wrong position. 	<ul style="list-style-type: none"> Set the AUDIO settings to the correct position.
	<ul style="list-style-type: none"> The earphone jack is connected to the unit. 	<ul style="list-style-type: none"> Separate the earphone jack from the unit.
The unit does not start playback.	<ul style="list-style-type: none"> The disc is inserted upside down. 	<ul style="list-style-type: none"> Ensure the disc label is upwards.
	<ul style="list-style-type: none"> The disc surface is dirty by Fingerprints and dust on the disc. 	<ul style="list-style-type: none"> Clean the disc with a clean, soft, lint-free cloth, wipe the disc outwards from the center. (Do not use strong solvents such as alcohol, benzine, thinner, etc)
	<ul style="list-style-type: none"> An unplayable disc is inserted. 	<ul style="list-style-type: none"> Insert a playable disc. (Check the disc type and regional code.)
	<ul style="list-style-type: none"> The rating level is set. 	<ul style="list-style-type: none"> Change the rating level.

6 Appendix

Area Code List

Choose an area code from this list.

Area	Code	Area	Code	Area	Code	Area	Code
Afghanistan	AF	Fiji	FJ	Monaco	MC	Singapore	SG
Argentina	AR	Finland	FI	Mongolia	MN	Slovak Republic	SK
Australia	AU	France	FR	Morocco	MA	Slovenia	SI
Austria	AT	Germany	DE	Nepal	NP	South Africa	ZA
Belgium	BE	Great Britain	GB	Netherlands	NL	South Korea	KR
Bhutan	BT	Greece	GR	Antilles	AN	Spain	ES
Bolivia	BO	Greenland	GL	New Zealand	NZ	Sri Lanka	LK
Brazil	BR	Hong Kong	HK	Nigeria	NG	Sweden	SE
Cambodia	KH	Hungary	HU	Norway	NO	Switzerland	CH
Canada	CA	India	IN	Oman	OM	Taiwan	TW
Chile	CL	Indonesia	ID	Pakistan	PK	Thailand	TH
China	CN	Israel	IL	Panama	PA	Turkey	TR
Colombia	CO	Italy	IT	Paraguay	PY	Uganda	UG
Congo	CG	Jamaica	JM	Philippines	PH	Ukraine	UA
Costa Rica	CR	Japan	JP	Poland	PL	United States	US
Croatia	HR	Kenya	KE	Portugal	PT	Uruguay	UY
Czech Republic	CZ	Kuwait	KW	Romania	RO	Uzbekistan	UZ
Denmark	DK	Libya	LY	Russian Federation	RU	Vietnam	VN
Ecuador	EC	Luxembourg	LU	Saudi Arabia	SA	Zimbabwe	ZW
Egypt	EG	Malaysia	MY	Senegal	SN		
El Salvador	SV	Maldives	MV				
Ethiopia	ET	Mexico	MX				

Language code List

Use this list to input your desired language for the following initial settings: [Disc Audio], [Disc Subtitle] and [Disc Menu].

Language	Code	Language	Code	Language	Code	Language	Code
Afar	6565	French	7082	Lithuanian	7684	Sindhi	8368
Afrikaans	6570	Frisian	7089	Macedonian	7775	Singhalese	8373
Albanian	8381	Galician	7176	Malagasy	7771	Slovak	8375
Ameharic	6577	Georgian	7565	Malay	7783	Slovenian	8376
Arabic	6582	German	6869	Malayalam	7776	Spanish	6983
Armenian	7289	Greek	6976	Maori	7773	Sudanese	8385
Assamese	6583	Greenlandic	7576	Marathi	7782	Swahili	8387
Aymara	6588	Guarani	7178	Moldavian	7779	Swedish	8386
Azerbaijani	6590	Gujarati	7185	Mongolian	7778	Tagalog	8476
Bashkir	6665	Hausa	7265	Nauru	7865	Tajik	8471
Basque	6985	Hebrew	7387	Nepali	7869	Tamil	8465
Bengali; Bangla	6678	Hindi	7273	Norwegian	7879	Telugu	8469
Bhutani	6890	Hungarian	7285	Oriya	7982	Thai	8472
Bihari	6672	Icelandic	7383	Panjabi	8065	Tonga	8479
Breton	6682	Indonesian	7378	Pashto, Pushto	8083	Turkish	8482
Bulgarian	6671	Interlingua	7365	Persian	7065	Turkmen	8475
Burmese	7789	Irish	7165	Polish	8076	Twi	8487
Byelorussian	6669	Italian	7384	Portuguese	8084	Ukrainian	8575
Chinese	9072	Japanese	7465	Quechua	8185	Urdu	8582
Croatian	7282	Kannada	7578	Rhaeto-Romance		Uzbek	8590
Czech	6783	Kashmiri	7583		8277	Vietnamese	8673
Danish	6865	Kazakh	7575	Rumanian	8279	Volapük	8679
Dutch	7876	Kirghiz	7589	Russian	8285	Welsh	6789
English	6978	Korean	7579	Samoan	8377	Wolof	8779
Esperanto	6979	Kurdish	7585	Sanskrit	8365	Xhosa	8872
Estonian	6984	Laothian	7679	Scots Gaelic	7168	Yiddish	7473
Faroese	7079	Latin	7665	Serbian	8382	Yoruba	8979
Fiji	7074	Latvian, Lettish	7686	Serbo-Croatian	8372	Zulu	9085
Finnish	7073	Lingala	7678	Shona	8378		

Specifications

Power consumption	12 W
Power requirements	9.5 V \pm 2 A
AC adaptor requirements	100 - 240 V \sim 1 A, 50/60 Hz
Automotive Adaptor requirements	8.5 V -16 V DC
Dimensions (W x H x D)	Approx. (200 x 16.5 x 38.5) mm
Net Weight (Approx.)	0.73 kg
Operating temperature	0 °C to 40 °C
Operating humidity	5 % to 90 %
Laser	Semiconductor laser
Signal system	PAL
Bus Power Supply (USB)	5 V \pm 500 mA
Video/Audio Out	\varnothing 3.5 mm mini jack x 1
Video Out	1.0 V (p-p), 75 Ω , sync negative
Audio Out	1.5 Vrms (1 kHz, 0 dB)
Earphone terminal	\varnothing 3.5 mm stereo mini jack x 1

Liquid Crystal Display

Panel size	17.8 cm (diagonal)
Projection system	R.G.B. stripe
Driving system	TFT active matrix
Resolution	480 x 234 (WQVGA)

Trademarks and Licenses



Manufactured under license from Dolby Laboratories. Dolby and the double-D symbol are trademarks of Dolby Laboratories.



DivX®, DivX Certified® and associated logos are trademarks of DivX, Inc. and are used under license.



"DVD Logo" is a trademark of DVD Format/Logo Licensing Corporation.

- Design and specifications are subject to change without notice.

