

OWNER'S MANUAL MONITOR TV

Please read this manual carefully before operating your set and retain it for future reference.

MONITOR TV MODELS

M197WAP	M2062A
M227WAP	M2262A
M237WAP	M2362A
	M2762A

CONTENTS

PREPARATION

SIDE PANEL CONTROLS	
<M197WAP/M227WAP/M237WAP>	4
FRONT PANEL CONTROLS	
<M2062A/M2262A/M2362A/M2762A>	5
BACK PANEL INFORMATION	
<M197WAP/M227WAP/M237WAP>	6
<M2062A/M2262A/M2362A/M2762A>	7
STAND INSTALLATION	
<M197WAP/M227WAP>	8
<M237WAP>	9
<M2062A/M2262A/M2362A>	10
<M2762A>	11
DETACHING STAND	
<M197WAP/M227WAP>	12
<M237WAP>	13
<M2062A/M2262A/M2362A>	14
<M2762A>	15
DETACHING STAND BODY	
(M2062A/M2262A/M2362A/M2762A)	16
WALL MOUNT: HORIZONTAL INSTALLATION ..	17
DESKTOP PEDESTAL INSTALLATION	18
SWIVEL STAND(Only M2762A)	19
POSITIONING YOUR DISPLAY	19
LOCATION	20
SECURING THE SET TO THE WALL TO	
PREVENT FALLING WHEN THE SET IS USED	
ON A STAND (Only M2762A)	21
ATTACHING THE TV TO A DESK	
(Only M2762A)	22
KENSINGTON SECURITY SYSTEM	23

EXTERNAL EQUIPMENT SETUP

ANTENNA CONNECTION	24
HD RECEIVER SETUP	
When connecting with a component cable ...	25
Connecting a set-top box with a HDMI cable ..	26
DVD SETUP	
Connecting with a component cable	27
Connecting with a HDMI cable	28

VCR SETUP

Connecting with a RF cable	29
Connecting with a RCA cable	29
OTHER A/V SOURCE SETUP	30
PC SETUP	
When connecting with a D-sub 15 pin cable ...	31
BACK COVER FOR WIRE ARRANGEMENT ..	32
SUPPORTED DISPLAY RESOLUTION	33

WATCHING TV / PROGRAMME CONTROL

REMOTE CONTROL KEY FUNCTIONS	34
TURNING ON THE SET	36
INSTALLATION GUIDE	36
PROGRAMME SELECTION	36
VOLUME ADJUSTMENT	36
ON SCREEN MENUS SELECTION AND	
ADJUSTMENT	37
AUTO PROGRAMME TUNING	38
MANUAL PROGRAMME TUNING	39
FINE TUNING	40
ASSIGNING A STATION NAME	41
PROGRAMME EDIT	42
FAVOURITE PROGRAMME	43
SELECTING THE PROGRAMME LIST	44

PICTURE CONTROL

PICTURE SIZE (ASPECT RATIO) CONTROL ...	45
PRESET PICTURE SETTINGS	46
MANUAL PICTURE ADJUSTMENT	47
PICTURE IMPROVEMENT TECHNOLOGY ...	48
PICTURE RESET	50
SCREEN SETUP	
AUTO CONFIGURE	
(RGB [PC] mode only)	51
MANUAL CONFIGURE	
(Adjustment for screen Position)	52

INITIALIZING (Reset to original factory settings).....	53
SELECTING RESOLUTION.....	54

SOUND CONTROL

PRESET SOUND SETTINGS	
- SOUND MODE	55
SOUND SETTING ADJUSTMENT	
- USER MODE	56
AUTO VOLUME LEVELER.....	57
BALANCE.....	58
AUDIO RESET	59
I/II	
STEREO / DUAL RECEPTION	60
NICAM RECEPTION	61
SPEAKER SOUND OUTPUT SELECTION	61

TIME SETTING

CLOCK SETUP	62
AUTO ON/OFF TIMER SETTING	63
SLEEP TIMER SETTING.....	64
AUTO SLEEP	65

OPTION SETTING

ON-SCREEN MENU LANGUAGE SELECTION...	66
KEY LOCK	67
DDC-CI(Only RGB).....	68
POWER INDICATOR	69
MODE SETTING.....	70
FACTORY RESET	71

TELETEXT

SWITCH ON/OFF	72
SIMPLE TEXT	72
SWITCH ON/OFF	73
FASTEXT	73
SPECIAL TELETEXT FUNCTIONS.....	74

APPENDIX

TROUBLESHOOTING	75
MAINTENANCE	77
PRODUCT SPECIFICATIONS	
M197WAP	78
M227WAP	79
M237WAP	80
M2062A.....	81
M2262A.....	82
M2362A.....	83
M2762A.....	84

PREPARATION

<M197WAP/M227WAP/M237WAP>

SIDE PANEL CONTROLS

- This is a simplified representation of the side panel. The image shown may be somewhat different from your set.

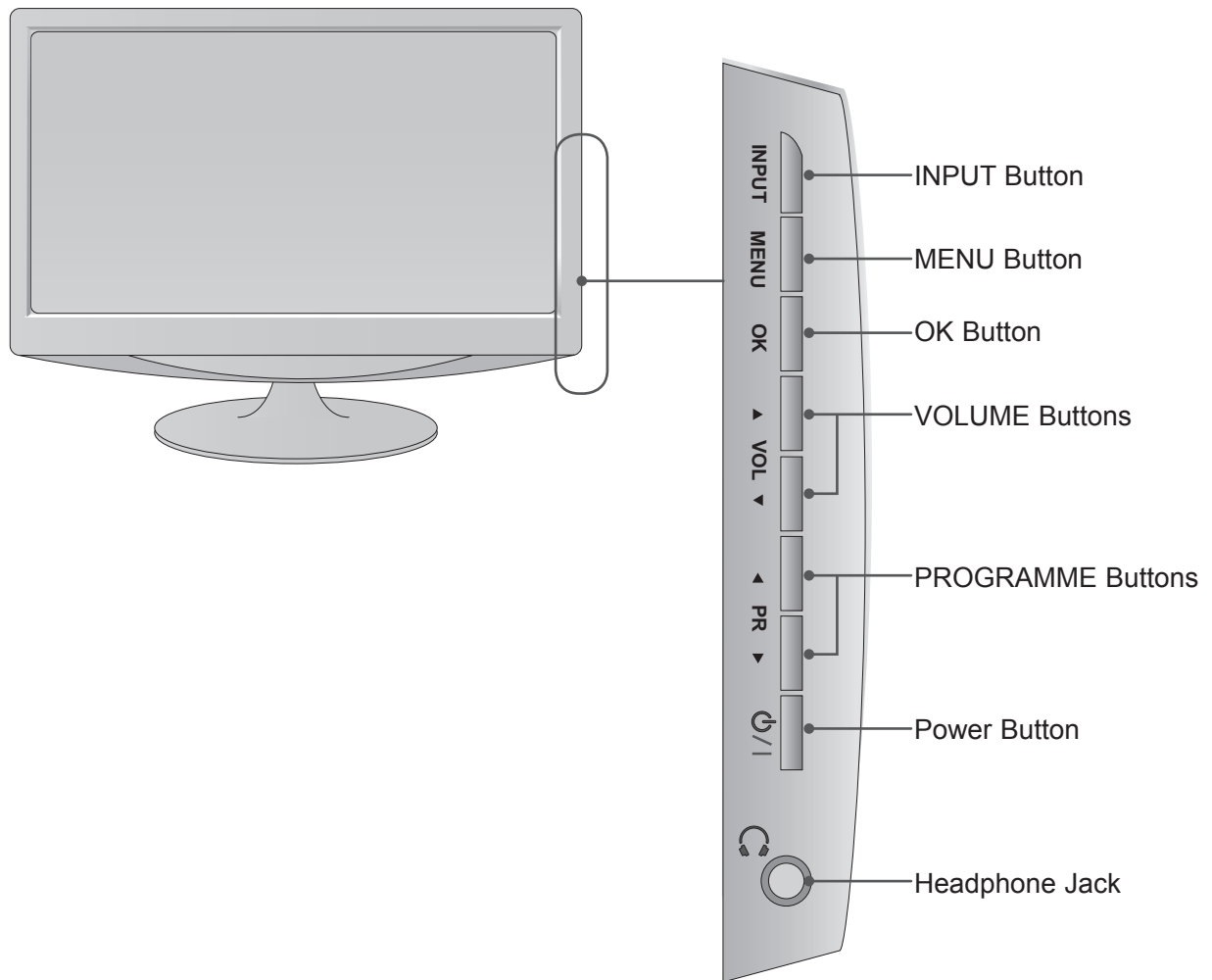

<M2062A/M2262A/M2362A/M2762A>

FRONT PANEL CONTROLS

- This is a simplified representation of the front panel. The image shown may be somewhat different from your set.

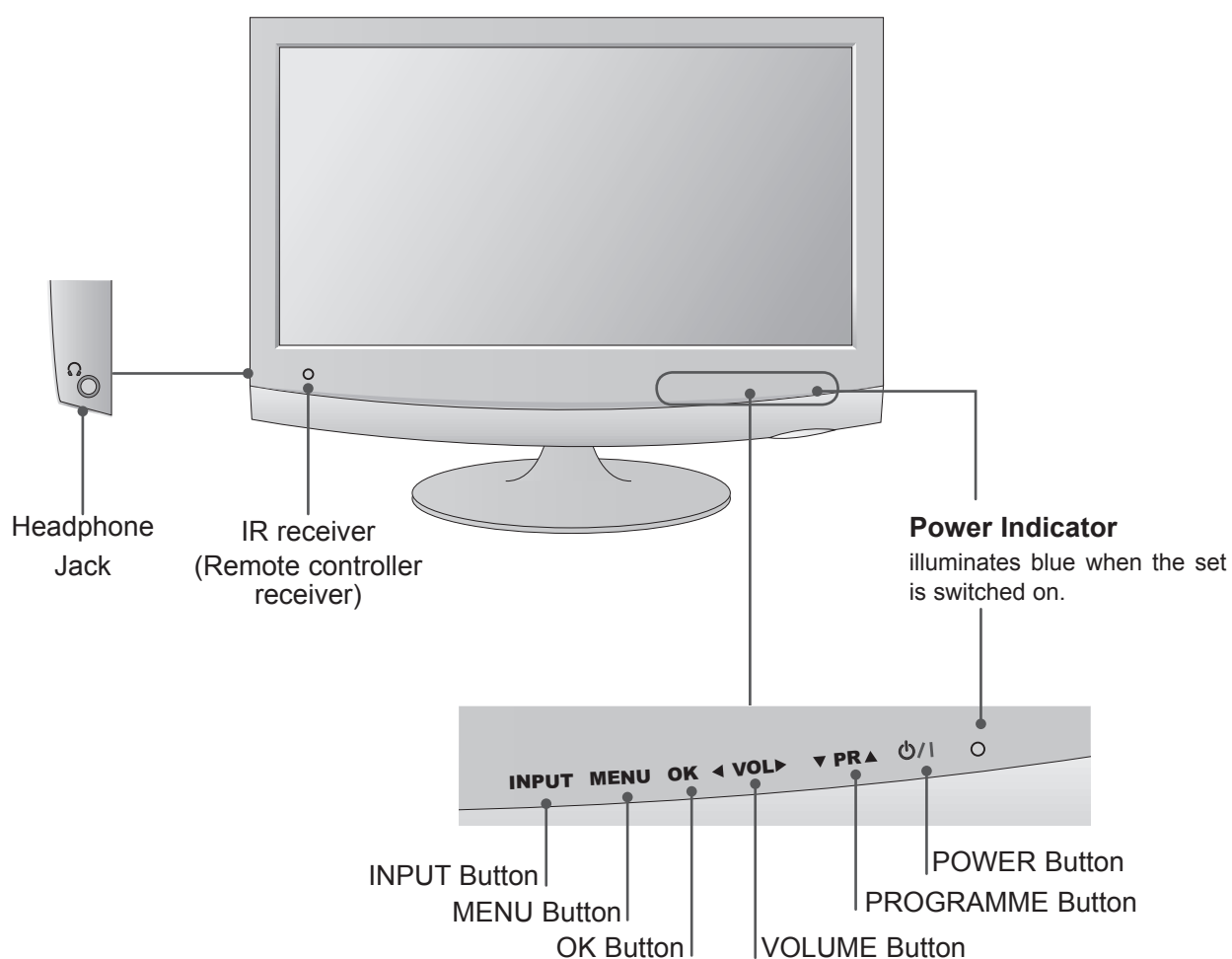

PREPARATION

<M197WAP/M227WAP/M237WAP>

BACK PANEL INFORMATION

- This is a simplified representation of the back panel. The image shown may be somewhat different from your set.

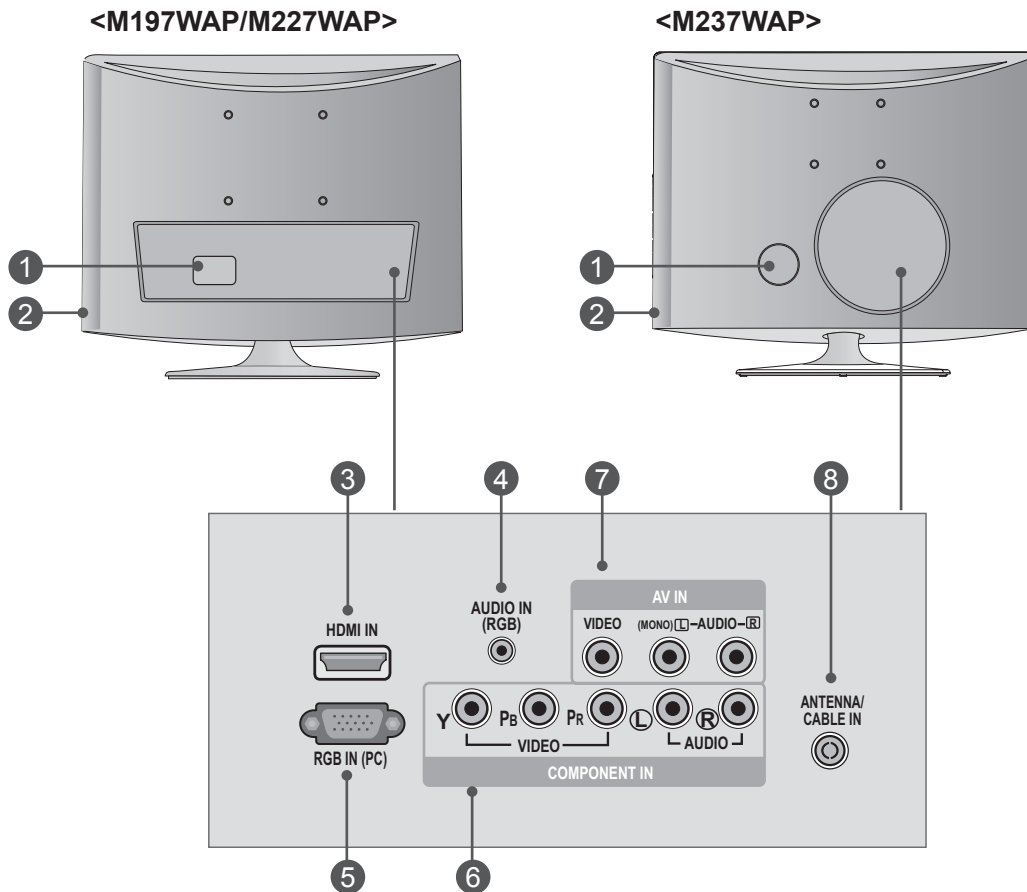

1 POWER CORD SOCKET

This set operates on AC power. The voltage is indicated on the Specifications page. Never attempt to operate the set on DC power.

2 HEADPHONE AUDIO OUTPUT

Connect the audio from a Headphone Jack.

3 HDMI INPUT

Connect a HDMI signal to HDMI IN.
Or DVI (VIDEO) signal to HDMI IN with DVI to HDMI cable.

4 RGB AUDIO INPUT

Connect the audio from a PC.

5 RGB INPUT (PC)

Connect the output from a PC.

6 COMPONENT INPUT

Connect a component video/audio device to these jacks.

7 AV(AUDIO/VIDEO) INPUT

Connect audio/video output from an external device to these jacks.

8 ANTENNA / CABLE INPUT

Connect over-the-air signals to this jack.

<M2062A/M2262A/M2362A/M2762A>

BACK PANEL INFORMATION

- This is a simplified representation of the back panel. The image shown may be somewhat different from your set.

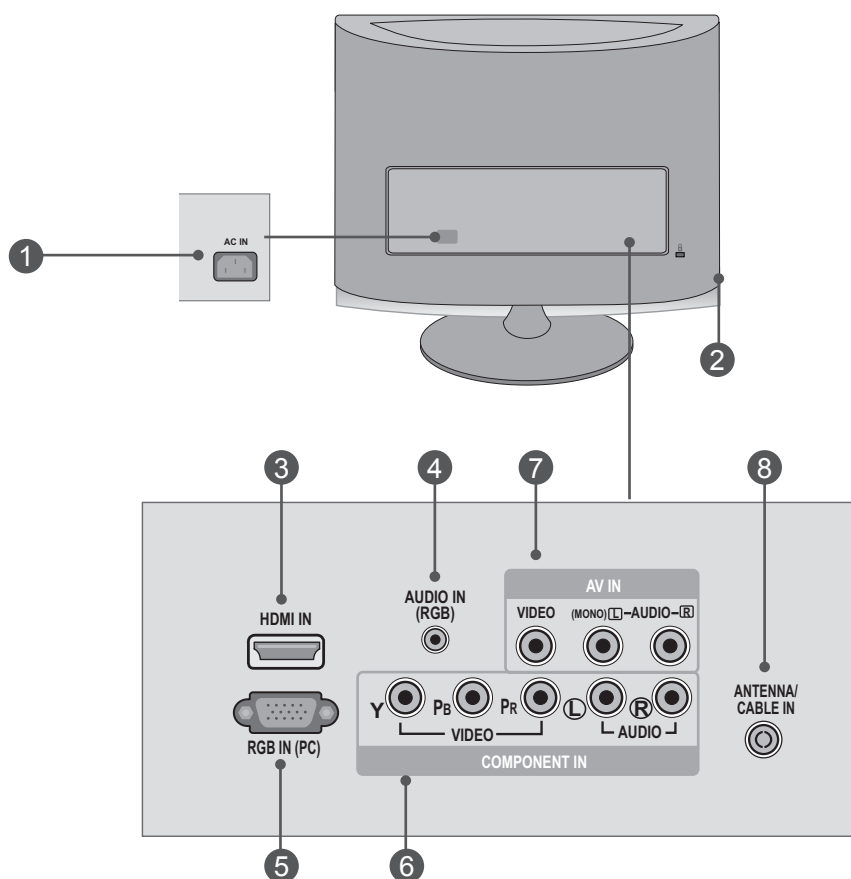

1 POWER CORD SOCKET

This set operates on AC power. The voltage is indicated on the Specifications page. Never attempt to operate the set on DC power.

2 HEADPHONE AUDIO OUTPUT

Connect the audio from a Headphone Jack.

3 HDMI INPUT

Connect a HDMI signal to HDMI IN.
Or DVI (VIDEO) signal to HDMI IN with DVI to HDMI cable.

4 RGB AUDIO INPUT

Connect the audio from a PC.

5 RGB INPUT (PC)

Connect the output from a PC.

6 COMPONENT INPUT

Connect a component video/audio device to these jacks.

7 AV(AUDIO/VIDEO) INPUT

Connect audio/video output from an external device to these jacks.

8 ANTENNA / CABLE INPUT

Connect over-the-air signals to this jack.

PREPARATION

<M197WAP/M227WAP>

STAND INSTALLATION

- The image shown may be somewhat different from your set.

- 1 Carefully place the product screen side down on a cushioned surface that will protect product and screen from damage.

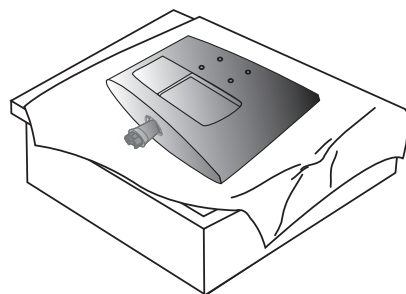

- 2 Insert the **Stand Base** into the product.

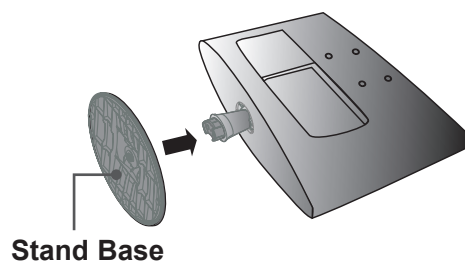

- 3 Use a **Coin** on the bottom of the stand base and turn the screw clockwise to tighten.

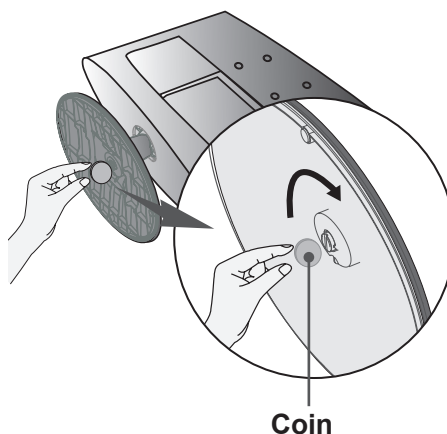
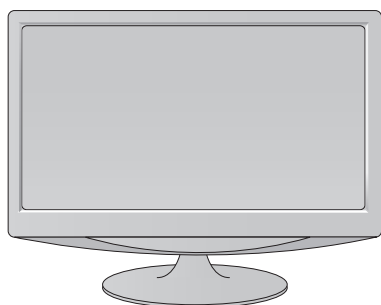

STAND INSTALLATION

■ The image shown may be somewhat different from your set.

- 1 Carefully place the product screen side down on a cushioned surface that will protect product and screen from damage.

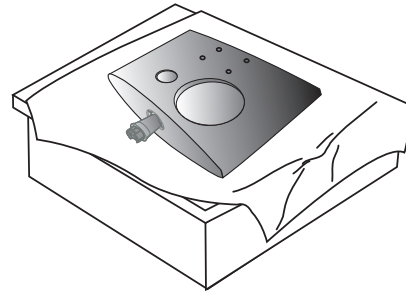

- 2 Insert the **Stand Base** into the product.

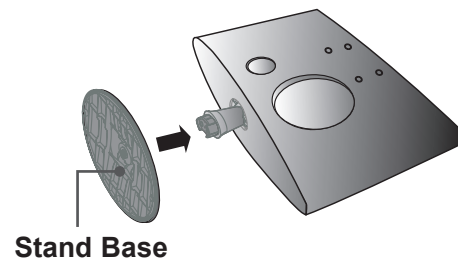

- 3 Use a **Coin** on the bottom of the stand base and turn the screw clockwise to tighten.

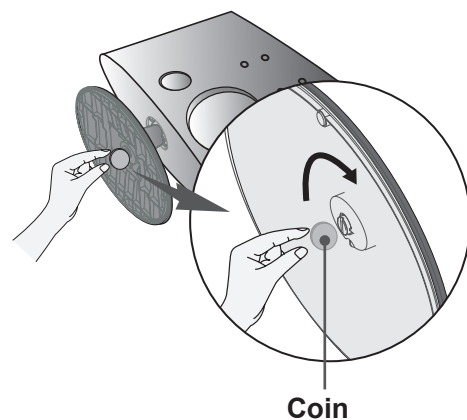
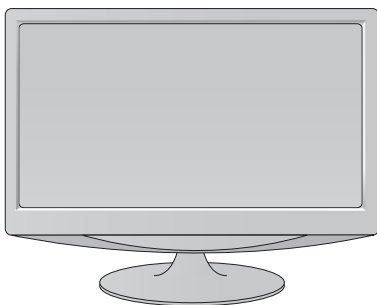

PREPARATION

<M2062A/M2262A/M2362A>

STAND INSTALLATION

- The image shown may be somewhat different from your set.

- 1 Carefully place the product screen side down on a cushioned surface that will protect product and screen from damage.

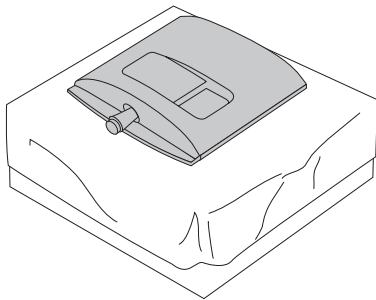

- 2 Insert the **Stand Base** into the product.

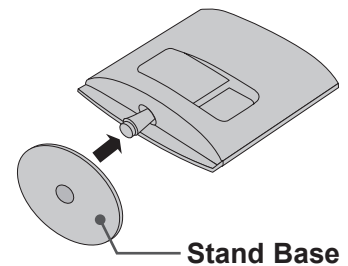

- 3 Turn the **Stand Base Lock** through 90° to fix the stand base to the stand body.

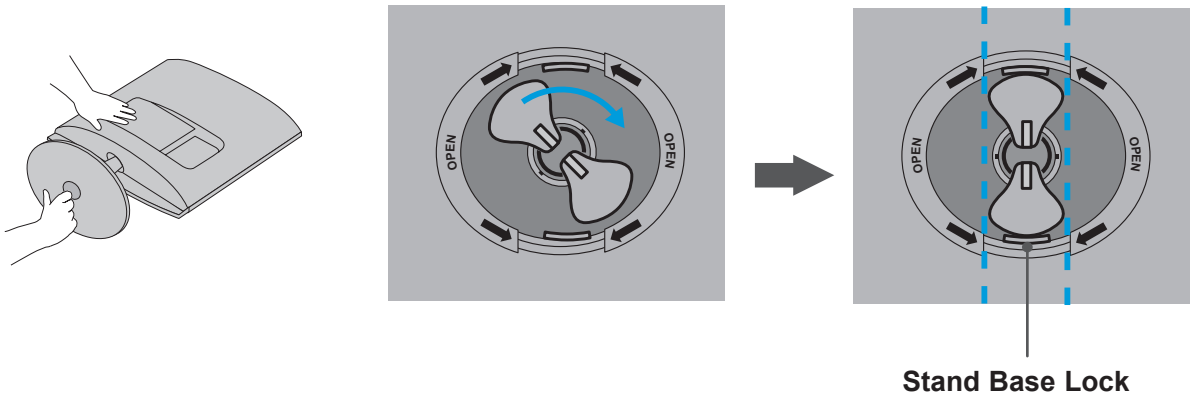

4

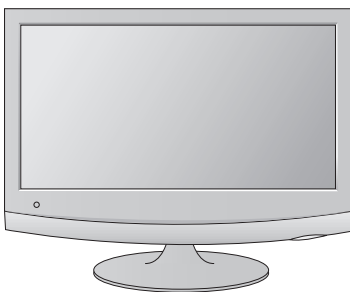

STAND INSTALLATION

■ The image shown may be somewhat different from your set.

- 1 Carefully place the product screen side down on a cushioned surface that will protect product and screen from damage.

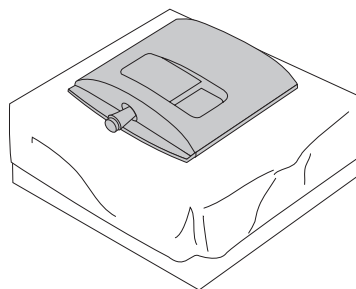

- 2 Insert the **Stand Base** into the product.

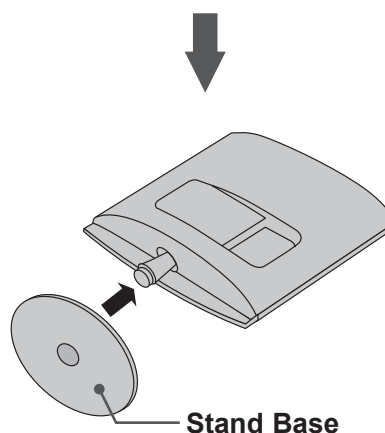

- 3 Use a **Coin** on the bottom of the stand base and turn the screw clockwise to tighten.

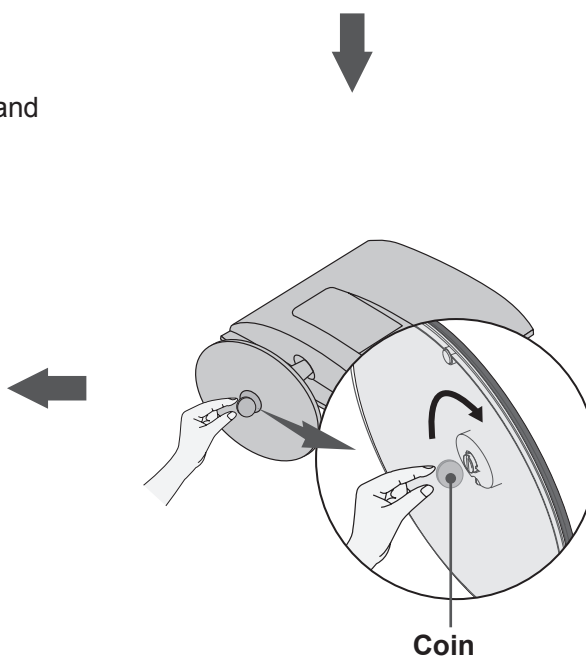
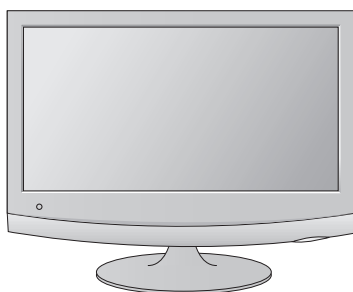

PREPARATION

<M197WAP/M227WAP>

DETACHING STAND

- The image shown may be somewhat different from your set.

- 1 Place the set screen side down on a cushion or soft cloth.

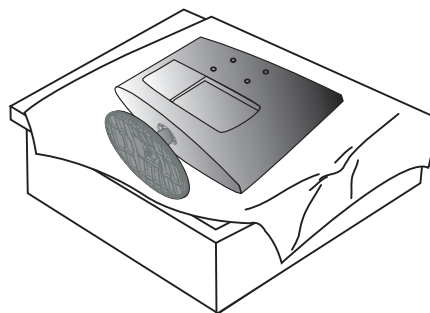

- 2 Detach the stand base from the set by turning the screw to the left with a **Coin**.

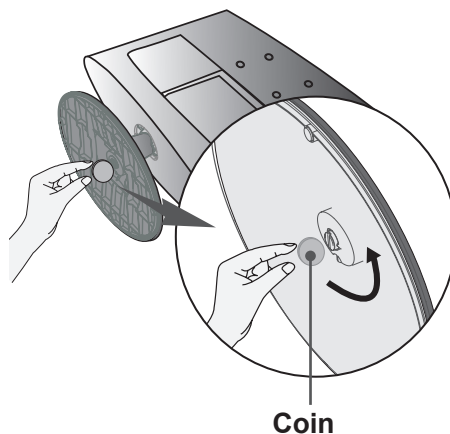

- 3 Pull the **Stand base**.

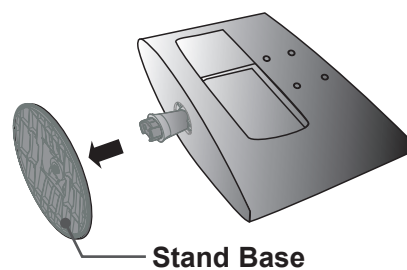

DETACHING STAND

■ The image shown may be somewhat different from your set.

- 1 Place the set screen side down on a cushion or soft cloth.

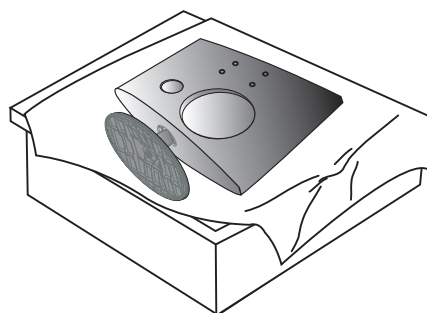

- 2 Detach the stand base from the set by turning the screw to the left with a **Coin**.

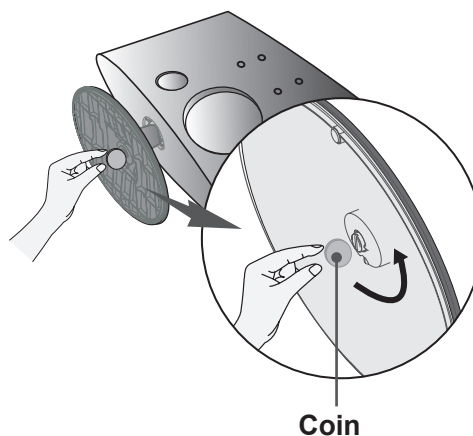

- 3 Pull the **Stand base**.

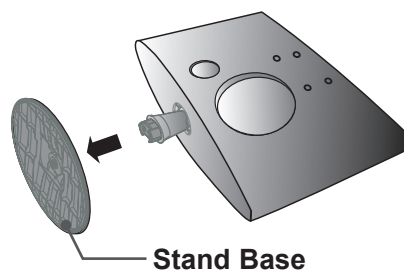

PREPARATION

<M2062A/M2262A/M2362A>

DETACHING STAND

- The image shown may be somewhat different from your set.

1 Place the set screen side down on a cushion or soft cloth.

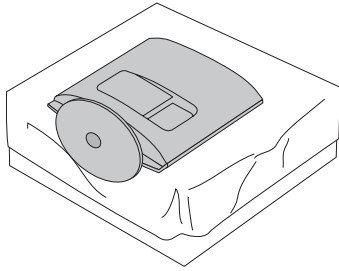

2 Detach the monitor to the **Stand Base** by turning the screw to the left.

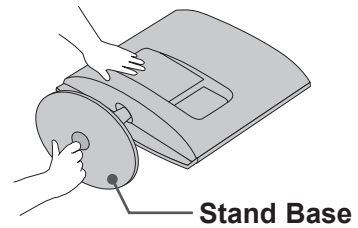

3 Turn the stand base lock through 90° to separate the stand base from the stand body.

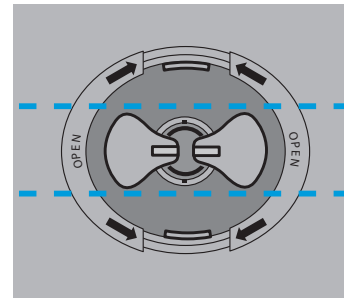
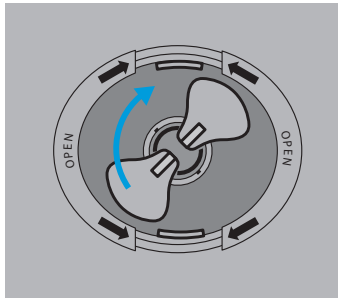

4 Pushing **Latch** inside, Take the stand base from stand body.

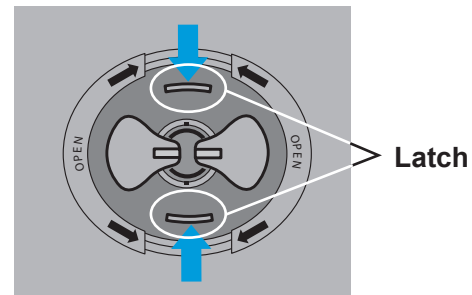
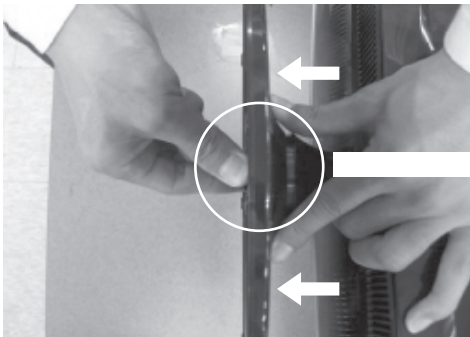

DETACHING STAND

■ The image shown may be somewhat different from your set.

- 1 Place the set screen side down on a cushion or soft cloth.

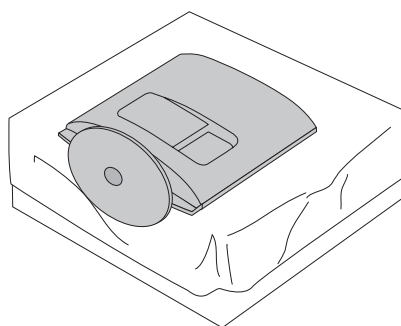

- 2 Detach the stand base from the set by turning the screw to the left with a **Coin**.

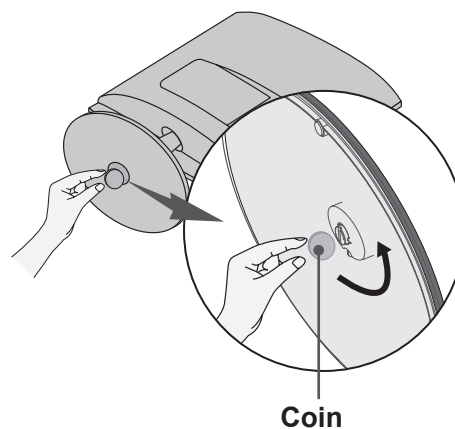

- 3 Pull the **Stand base**.

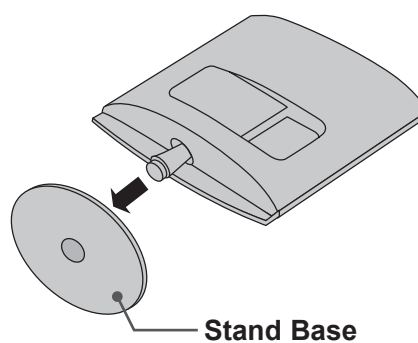

PREPARATION

DETACHING STAND BODY (M2062A/M2262A/M2362A/M2762A)

- The image shown may be somewhat different from your set.
- Remove the Stand Body in the same way as the following when using it as a Wall Hook.

<M2062A/M2262A/M2362A>

1. Remove the screw 2 point.
2. Pull the stand body.

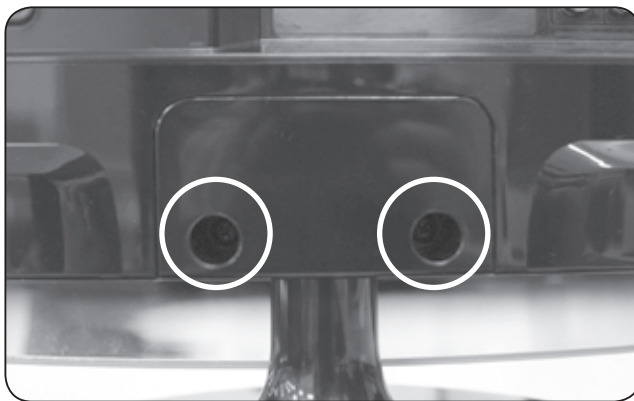

<M2762A>

1. Remove the screw 4 point.
2. Pull the stand body.

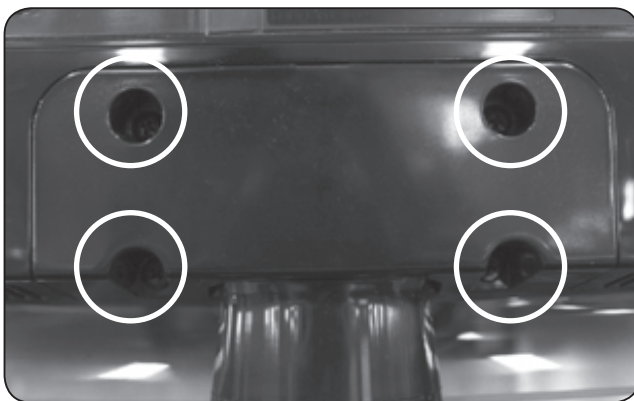

WALL MOUNT: HORIZONTAL INSTALLATION

■ The image shown may be somewhat different from your set.

For proper ventilation, allow a clearance of 10 cm on each side and from the wall. Detailed installation instructions are available from your dealer, see the optional Tilt Wall Mounting Bracket Installation and Setup Guide.

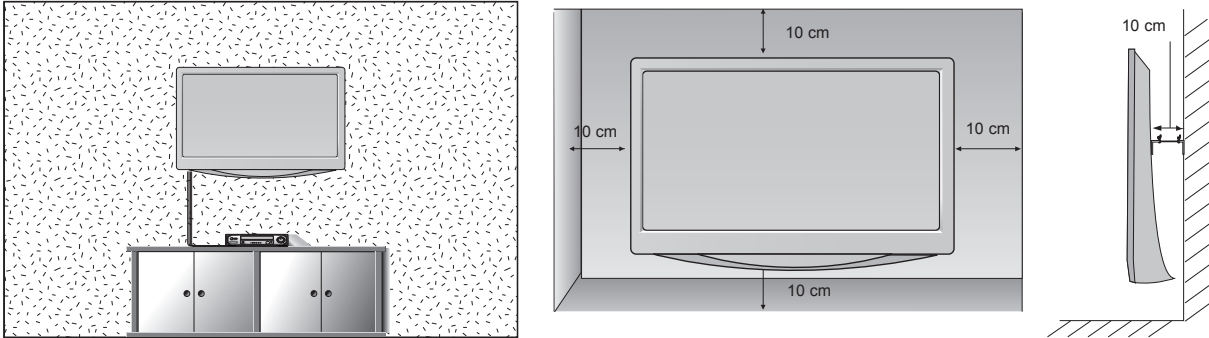

If you intend to mount the set to a wall, attach Wall mounting interface (optional parts) to the back of the set. When you install the set using the wall mounting interface (optional parts), attach it carefully so it will not drop.

1. Be sure to use screws and a wall mount that meet VESA standards.
2. Using screws longer than those recommended might damage the product.
3. Using screws that do not meet VESA standards might either damage the product or result in it coming away from the wall. We will not be held responsible for any damage resulting from failure to follow these instructions.
4. VESA compatible only with respect to screw mounting interface dimensions and mounting screw specifications
5. Please use VESA standard as below.
 - 5-1) 784.8 mm (30.9 inch) and under
 - * Wall Mount Pad Thickness : 2.6 mm
 - * Screw : Φ 4.0 mm x Pitch 0.7 mm x Length 10 mm
 - 5-2) 787.4 mm (31.0 inch) and above
 - * Please use VESA standard wall mount pad and screws.

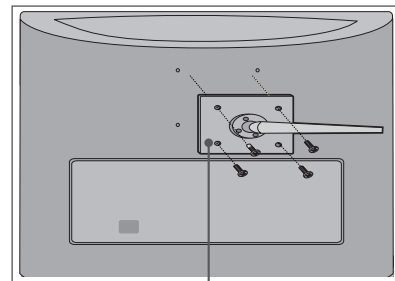

Wall Mount Pad

< Screw Mounting Interface Dimension >

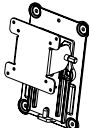
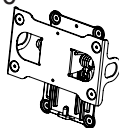
Model	M237WAP	M197WAP M227WAP M2062A M2262A M2362A	M2762A
VESA (A x B)	75 x 75	100 x 100	200 x 100
Wall mount bracket(optional)	RW120 		RW240 

PREPARATION

DESKTOP PEDESTAL INSTALLATION

- The image shown may be somewhat different from your set.

For proper ventilation, allow a clearance of 10 cm on each side and from the wall.

<M197WAP/M227WAP/M237WAP>

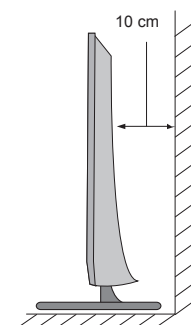
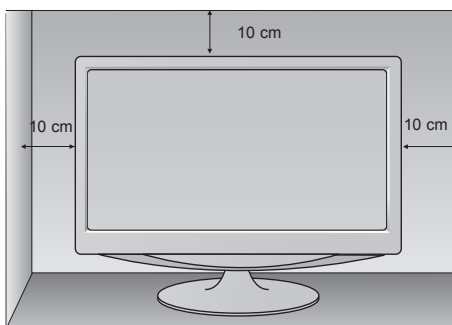
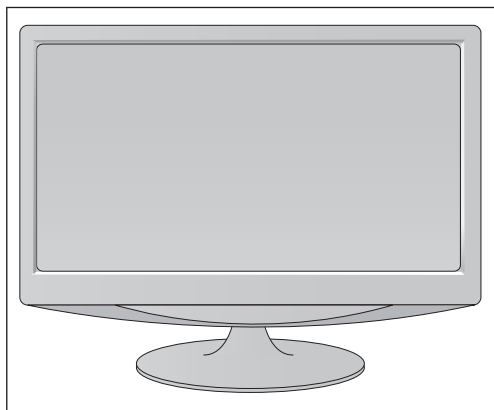

<M2062A/M2262A/M2362A/M2762A>

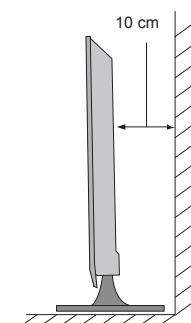
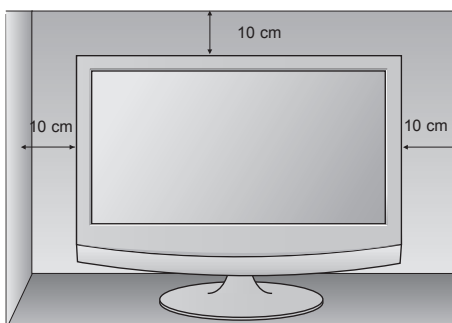
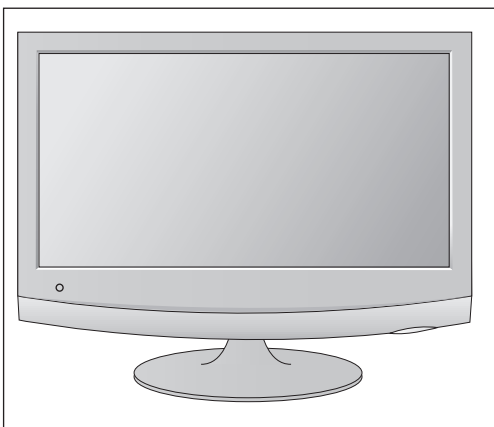

SWIVEL STAND(Only M2762A)

■ The image shown may be somewhat different from your set.

After installing the set, you can adjust the set manually to the left or right direction by 179 degrees to suit your viewing position.

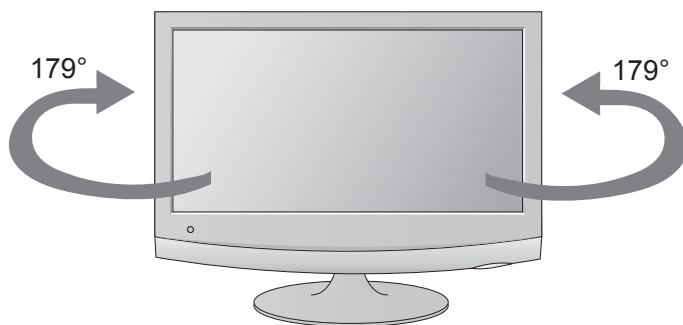

POSITIONING YOUR DISPLAY

■ The image shown may be somewhat different from your set.

Adjust the position of the panel in various ways for maximum comfort.

* Tilt range

<M197WAP/M227WAP/M237WAP>

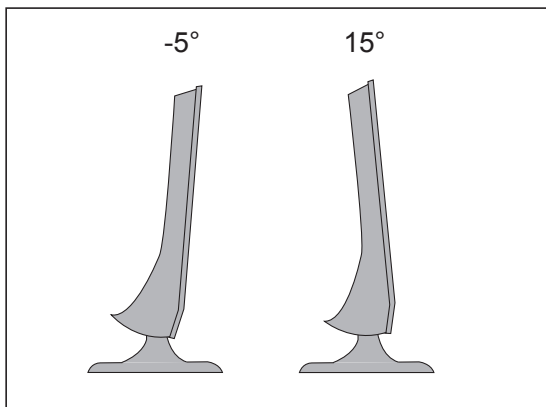

<M2062A/M2262A/M2362A/M2762A>

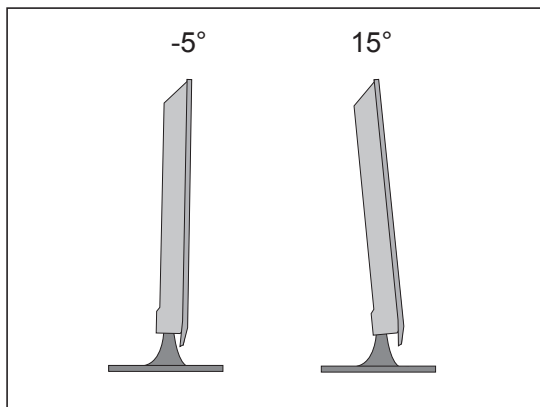

PREPARATION

LOCATION

Position your set so that no bright light or sunlight falls directly onto the screen. Care should be taken not to expose the set to any unnecessary vibration, moisture, dust or heat. Also, ensure that the set is placed in a position to allow a free flow of air. Do not cover the ventilation openings on the back cover.

WARNING

When adjusting the angle of the screen, do not put your finger(s) in between the head of the monitor and the stand body.

You can hurt your finger(s).

<M197WAP/M227WAP/M237WAP>

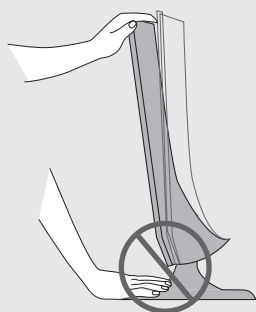

<M2062A/M2262A/M2362A/M2762A>

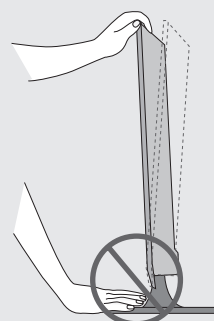

SECURING THE SET TO THE WALL TO PREVENT FALLING WHEN THE SET IS USED ON A STAND (Only M2762A)

■ Image shown may differ from your set.

We recommend that you set up the set close to a wall so it cannot fall over if pushed backwards. Additionally, we recommend that the set be attached to a wall so it cannot be pulled in a forward direction, potentially causing injury or damaging the product.

Caution: Please make sure that children don't climb on or hang from the set.

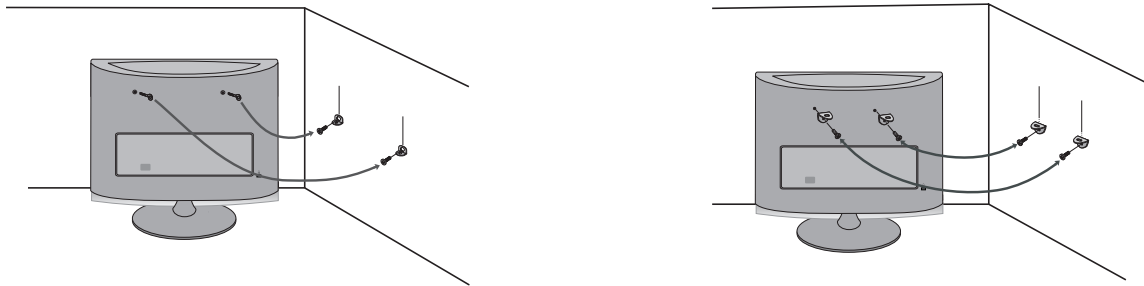

■ Insert the eye-bolts (or set brackets and bolts) to tighten the product to the wall as shown in the picture.

* If your product has the bolts in the eye-bolts position before inserting the eye-bolts, loosen the bolts.

* Insert the eye-bolts or set brackets/bolts and tighten them securely in the upper holes.

Secure the wall brackets with the bolts (sold separately) to the wall. Match the height of the bracket that is mounted on the wall to the holes in the product.

Ensure the eye-bolts or brackets are tightened securely.

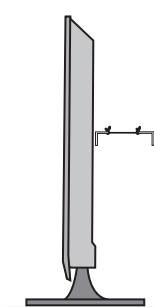

■ Use a sturdy rope or cord (sold separately) to tie the product. It is safer to tie the rope so it becomes horizontal between the wall and the product.

! NOTE

- ▶ When moving the set, undo the cords first.
- ▶ Use a platform or cabinet strong enough and large enough to support the size and weight of the set.
- ▶ To use the set safely make sure that the height of the bracket on the wall and the one on the set are the same.

PREPARATION

ATTACHING THE TV TO A DESK (Only M2762A)

- Image shown may differ from your set.

The TV must be attached to desk so it cannot be pulled in a forward/backward direction, potentially causing injury or damaging the product. Use only an attached screw.

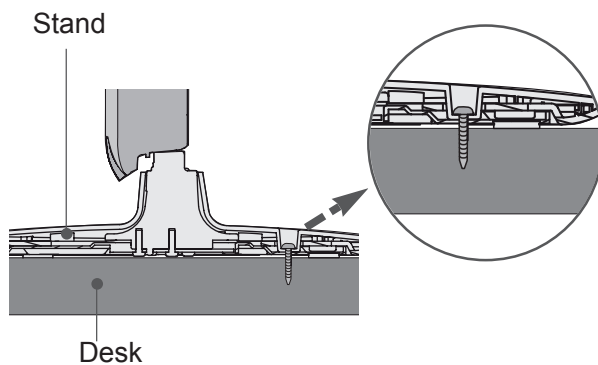
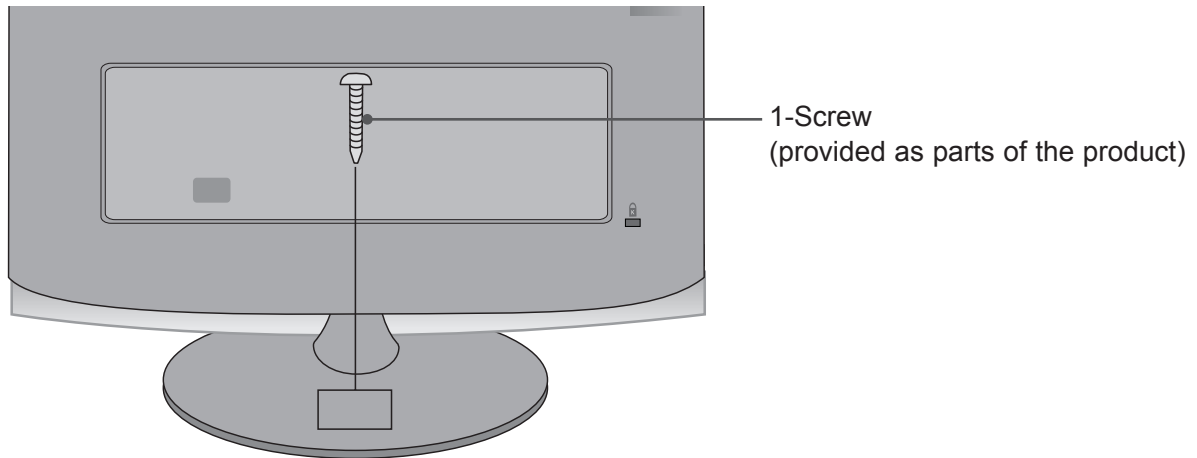

! WARNING

- To prevent TV from falling over, the TV should be securely attached to the floor/wall per installation instructions. Tipping, shaking, or rocking the machine may cause injury.

KENSINGTON SECURITY SYSTEM

- The product is equipped with a Kensington Security System connector on the back panel. Connect the Kensington Security System cable as shown below.
 - For detailed installation and use of the Kensington Security System, refer to the user's guide provided with the Kensington Security System.
- For further information, contact <http://www.kensington.com>, the internet homepage of the Kensington company. Kensington sells security systems for expensive electronic equipment such as notebook PCs and LCD projectors.

NOTE

- The Kensington Security System is an optional accessory.

NOTES

- If the product feels cold to the touch, there may be a small "flicker" when it is turned on.
This is normal, there is nothing wrong with product.
- Some minute dot defects may be visible on the screen, appearing as tiny red, green, or blue spots.
However, they have no adverse effect on the monitor's performance.
- Avoid touching the LCD screen or holding your finger(s) against it for long periods of time.
Doing so may produce some temporary distortion effects on the screen.

<M197WAP/ M227WAP >

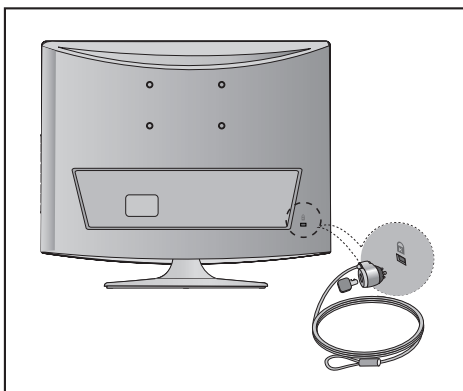

<M237WAP>

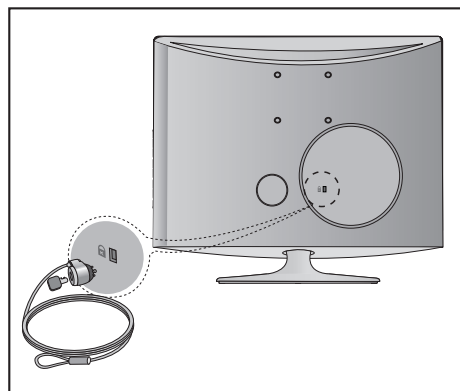

<M2062A/M2262A/M2362A/M2762A>

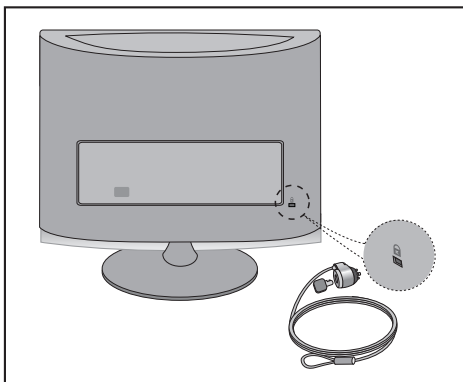

EXTERNAL EQUIPMENT SETUP

- To prevent damage do not connect to the mains outlet until all connections are made between the devices.

ANTENNA CONNECTION

- For optimum picture quality, adjust antenna direction.
- An antenna cable and converter are not supplied.

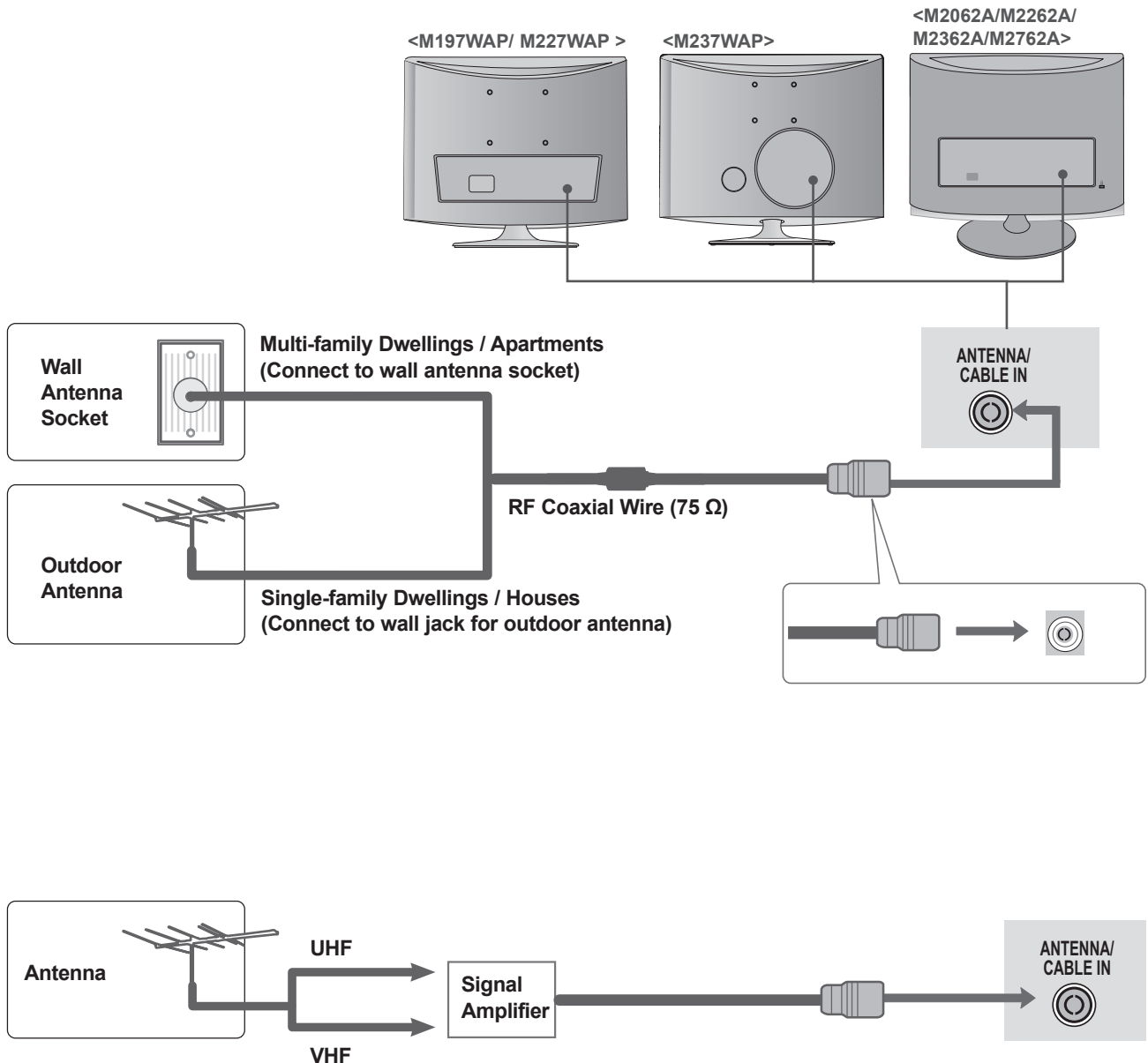

- In poor signal areas, to get better picture quality, install a signal amplifier to the antenna as shown above.
- If signal needs to be split for two sets, use an antenna signal splitter for connection.

EXTERNAL EQUIPMENT SETUP

- To avoid damaging any equipment, never plug in any power cords until you have finished connecting all equipment.
- The image shown may be somewhat different from your set.

HD RECEIVER SETUP

When connecting with a component cable

- 1 Connect the video outputs (Y, PB, PR) of the digital set-top box to the **COMPONENT IN VIDEO** jacks on the SET.
- 2 Connect the audio output of the digital set-top box to the **COMPONENT IN AUDIO** jacks on the SET.
- 3 Turn on the digital set-top box. (Refer to the owner's manual for the digital set-top box.)
- 4 Select **COMPONENT** input source using the **INPUT** button on the remote control.

Signal	Component
480i / 576i	O
480p / 576p	O
720p	O
1080i / 1080p	O

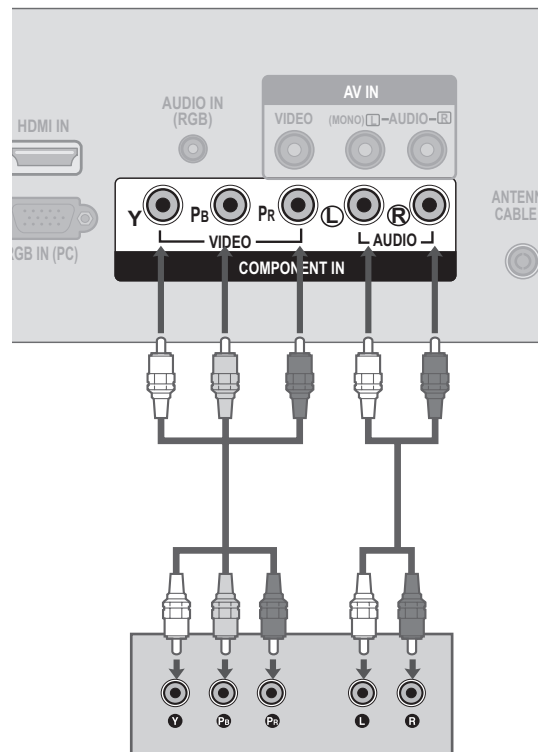

EXTERNAL EQUIPMENT SETUP

Connecting a set-top box with a HDMI cable

- 1 Connect the **HDMI** output of the digital set-top box to the **HDMI IN** jack on the SET.
- 2 Select **HDMI** input source using the **INPUT** button on the remote control.
- 3 Turn on the digital set-top box. (Refer to the owner's manual for the digital set-top box.)

! NOTE

- ▶ SET can receive the video and audio signal simultaneously with using a HDMI cable.
- ▶ If the digital set-top box supports Auto HDMI function, the output resolution of the source device will be automatically SET to 1920 x 1080p.
- ▶ If the digital set-top box player does not support Auto HDMI, you need to SET the output resolution appropriately.
To get the best picture quality, adjust the output resolution of the source device to 1920 x 1080p .
- ▶ We recommend less than 10 m for HDMI cable.

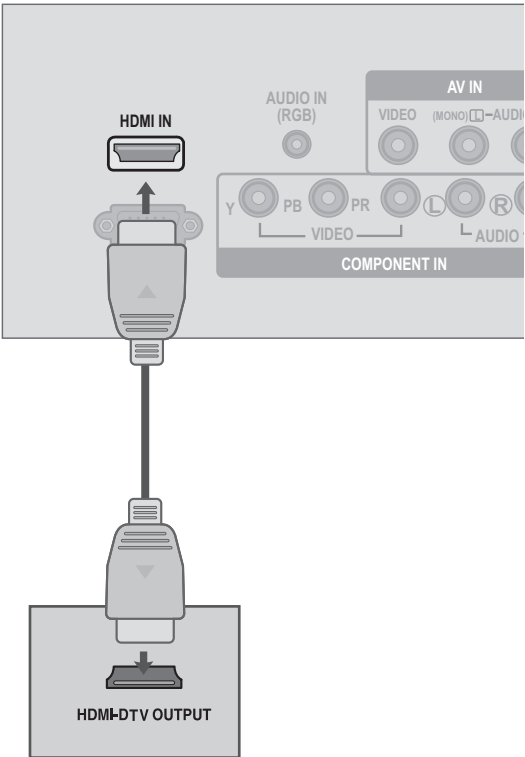

Signal	HDMI
480p / 576p	O
720p	O
1080i / 1080p	O

DVD SETUP

Connecting with a component cable

- 1

Connect the video outputs (Y, PB, PR) of the **DVD** to the **COMPONENT IN VIDEO** jacks on the SET.
- 2

Connect the audio outputs of the **DVD** to the **COMPONENT IN AUDIO** jacks on the SET.
- 3

Turn on the **DVD player**, insert a **DVD**.
- 4

Select **COMPONENT** input source using the **INPUT** button on the remote control.
- 5

Refer to the **DVD** player's manual for operating instructions.

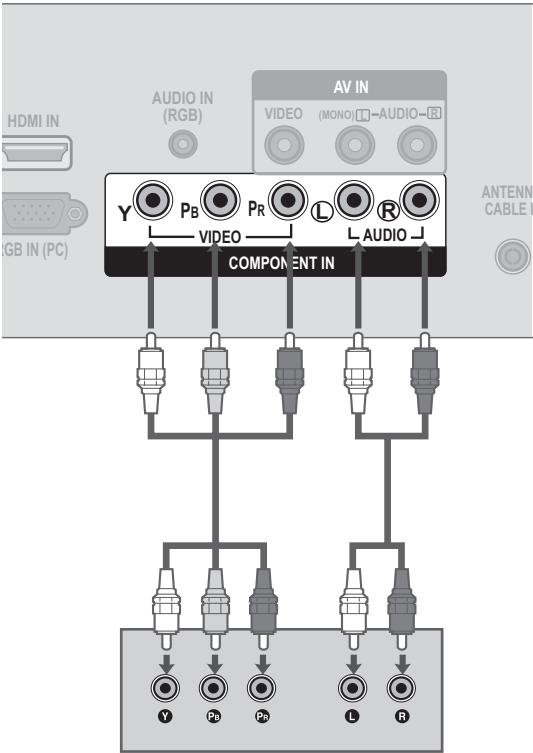

EXTERNAL EQUIPMENT SETUP

Component Input ports

To achieve better picture quality, connect a DVD player to the component input ports as shown below.

Component ports on the SET	Y	P _B	P _R
Video output ports on DVD player	Y	P _B	P _R
	Y	B-Y	R-Y
	Y	Cb	Cr
	Y	Pb	Pr

EXTERNAL EQUIPMENT SETUP

Connecting with a HDMI cable

- 1 Connect the **HDMI** output of the **DVD** to the **HDMI IN** jack on the SET.
- 2 Select **HDMI** input source using the **INPUT** button on the remote control.
- 3 Refer to the **DVD** player's manual for operating instructions.

! NOTE

- ▶ SET can receive the video and audio signal simultaneously with using a HDMI cable.
- ▶ If the digital set-top box supports Auto HDMI function, the output resolution of the source device will be automatically SET to 1920 x 1080p.
- ▶ If the digital set-top box player does not support Auto HDMI, you need to SET the output resolution appropriately.
- ▶ To get the best picture quality, adjust the output resolution of the source device to 1920 x 1080p.
- ▶ We recommend less than 10 m for HDMI cable.

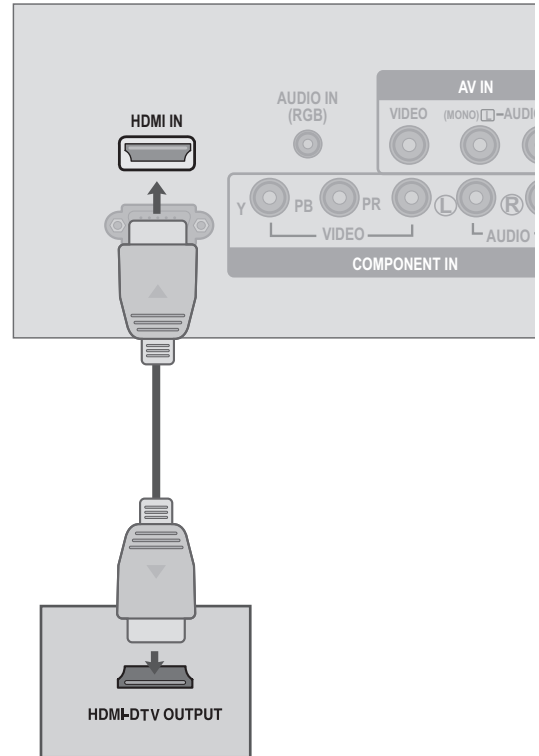

VCR SETUP

- To avoid picture noise (interference), allow adequate distance between the VCR and SET.

Connecting with a RF cable

- 1 Connect the **ANT OUT** socket of the **VCR** to the **ANTENNA IN** socket on the SET.
- 2 Connect the antenna cable to the **ANT IN** socket of the **VCR**.
- 3 Press the **PLAY** button on the **VCR** and match the appropriate programme between the SET and **VCR** for viewing.

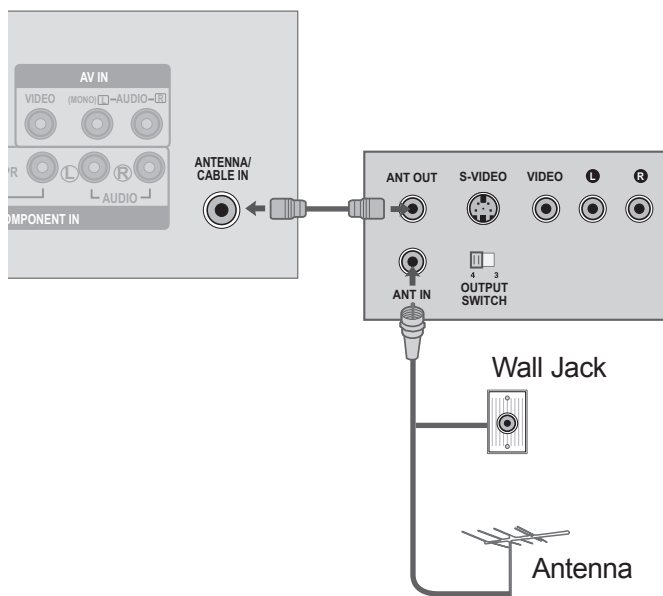

Connecting with a RCA cable

- 1 Connect the **AUDIO / VIDEO** jacks between **SET** and **VCR**. Match the jack colours (Video = yellow, Audio Left = white, and Audio Right = red)
- 2 Insert a video tape into the **VCR** and press **PLAY** on the **VCR**. (Refer to the VCR owner's manual.)
- 3 Select **AV** input source using the **INPUT** button on the remote control.

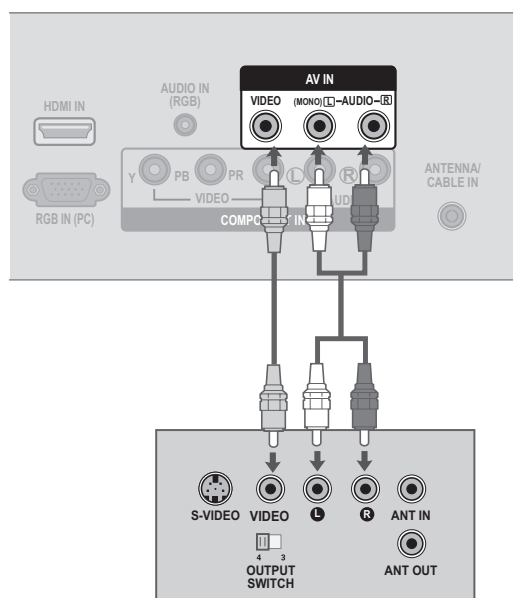

EXTERNAL EQUIPMENT SETUP

OTHER A/V SOURCE SETUP

- 1 Connect the **AUDIO / VIDEO** jacks between **SET** and external equipment. Match the jack colours. (Video = yellow, Audio Left = white, and Audio Right = red)
- 2 Select AV input source using the **INPUT** button on the remote control. If connected to **AV IN**, select **AV** input source.
- 3 Operate the corresponding external equipment. Refer to external equipment operating guide.

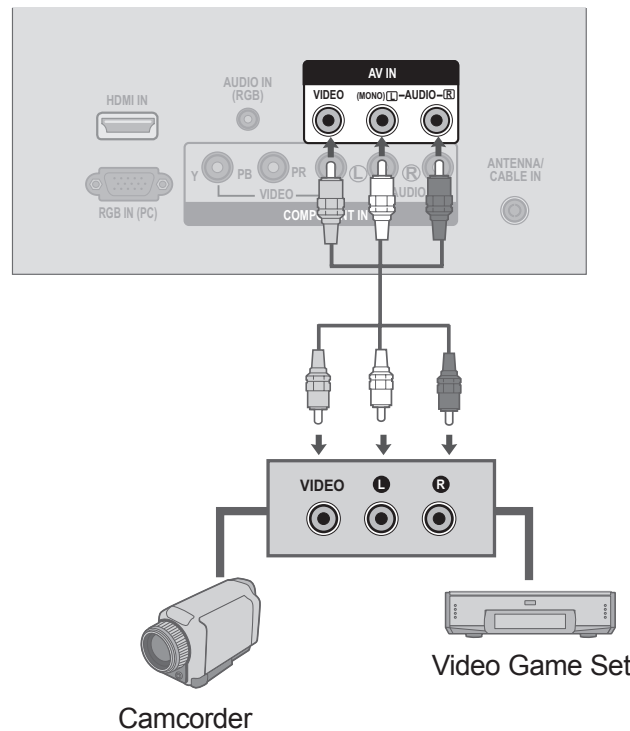

PC SETUP

When using the remote control, aim it at the remote control sensor on the SET.

When connecting with a D-sub 15 pin cable

- 1 Connect the signal cable from the monitor output socket of the PERSONAL COMPUTER to the PC input socket of the set.
- 2 Connect the audio cable from the PC to the **AUDIO IN** (RGB) sockets of the set.
- 3 Press the **INPUT** button to select **RGB PC**.
- 4 Switch on the **PC**, and the **PC** screen appears on the set. The set can be operated as a PC monitor.

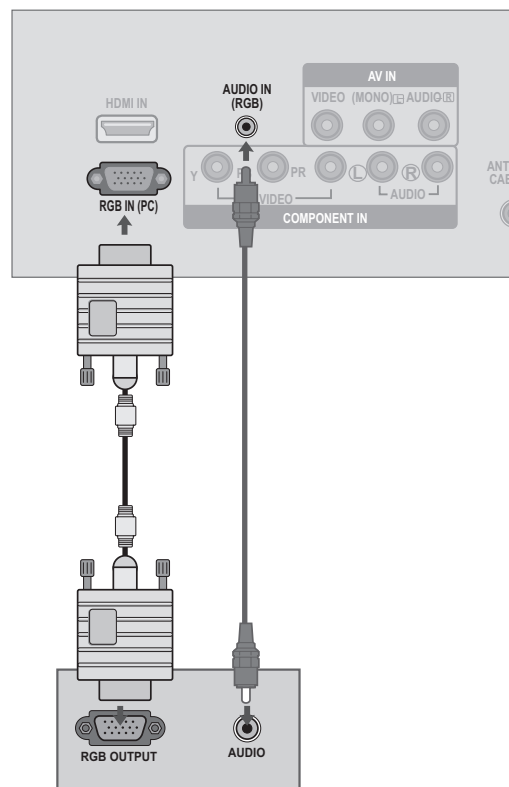

! NOTE

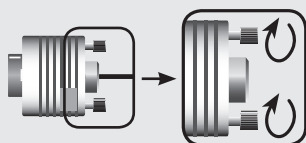

► Connect the signal input cable and tighten the screws by turning them clockwise.

► User must use shielded signal interface cables (D-sub 15 pin cable) with ferrite cores to maintain standard compliance for the product.

EXTERNAL EQUIPMENT SETUP

BACK COVER FOR WIRE ARRANGEMENT

Tie cables together with a cable management as shown in the illustration.

<M197WAP/ M227WAP >

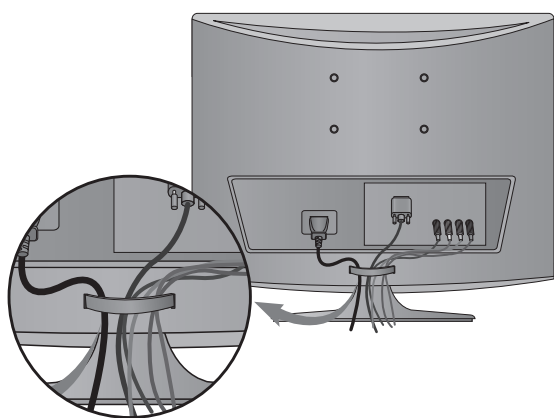

<M237WAP>

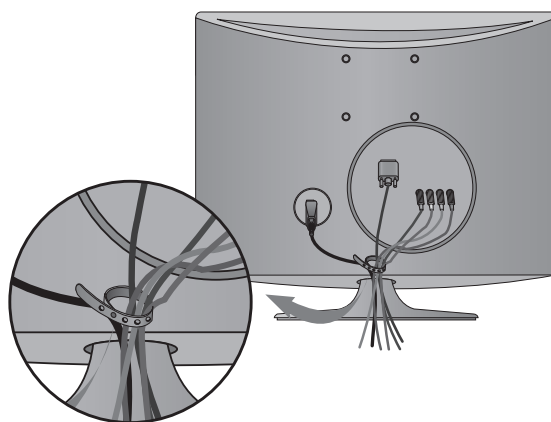

<M2062A/M2262A/M2362A/M2762A>

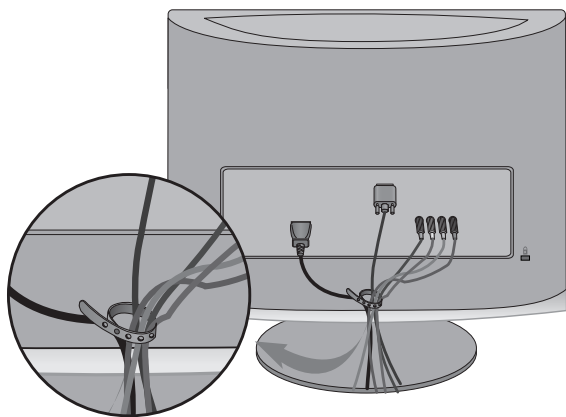

SUPPORTED DISPLAY RESOLUTION

RGB[PC] mode

M197WAP

Resolution	Horizontal Frequency(kHz)	Vertical Frequency(Hz)
640 x 480	31.469	59.94
800 x 600	37.879	60.317
1024 x 768	48.363	60.0
1280 x 720	47.77	59.85
1360 x 768	47.71	60.02

M2062A

Resolution	Horizontal Frequency(kHz)	Vertical Frequency(Hz)
640 x 480	31.469	59.94
800 x 600	37.879	60.317
1024 x 768	48.363	60.0
1280 x 720	47.77	59.85
1280 x 1024	63.981	60.02
1600 x 900	60	60

M227WAP / M237WAP /

M2262A / M2362A / M2762A

Resolution	Horizontal Frequency(kHz)	Vertical Frequency(Hz)
640 x 480	31.469	59.94
800 x 600	37.879	60.317
1024 x 768	48.363	60.0
1152 x 864	54.34	60.05
1280 x 960	60	60
1280 x 1024	63.981	60.02
1680 x 1050	64.674	59.883
1680 x 1050	65.290	59.954
1920 x 1080	67.5	60

HDMI[DTV] mode

Resolution	Horizontal Frequency(kHz)	Vertical Frequency(Hz)
720 x 480	31.47	59.94
720 x 480	31.50	60.00
720 x 576	31.25	50.00
1280 x 720	44.96	59.94
1280 x 720	45.00	60.00
1280 x 720	37.50	50.00
1920 x 1080	33.72	59.94
1920 x 1080	33.75	60.00
1920 x 1080	28.125	50.00
1920 x 1080	67.432	59.94
1920 x 1080	67.5	60
1920 x 1080	56.250	50

WATCHING TV / PROGRAMME CONTROL

REMOTE CONTROL KEY FUNCTIONS

When using the remote control, aim it at the remote control sensor on the SET.

A TYPE

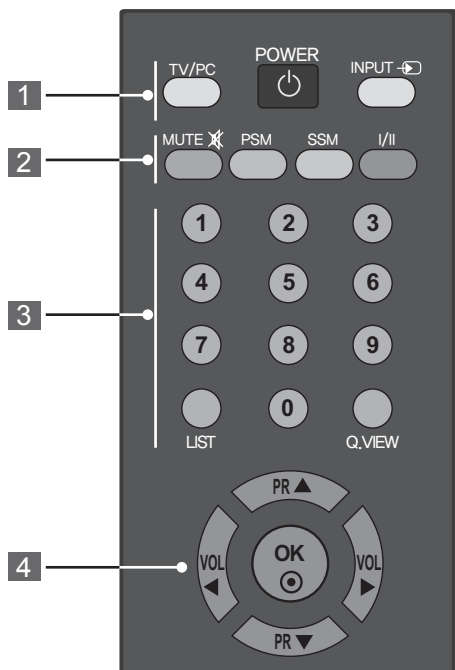

1 POWER Switches the set on from standby or off to standby.

TV/PC Selects TV or PC mode.

INPUT If you press the button once, the input source OSD will appear on screen as shown. Press the **▲/▼** button and then OK button to select the desired input source.

2 MUTE Switches the sound on or off.

PSM Recalls your preferred picture setting.

SSM Recalls your preferred sound setting.

I/II Selects the sound output. (►p.60)

B TYPE

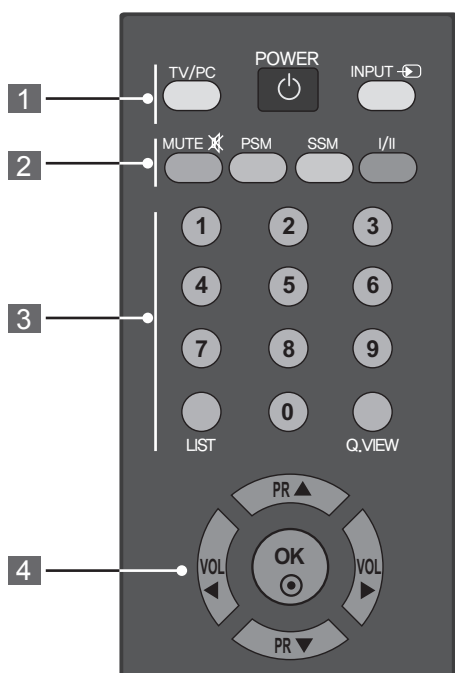

3 0~9 Selects a programme.
number button Selects numbered items in a menu.

LIST Displays the programme table.

Q.VIEW Returns to the previously viewed programme.

4 THUMBSTICK Allows you to navigate the on-screen menus and adjust the system settings to your preference.
(Up/Down/Left/Right)
-Up/Down Selects a programme.
-Left/Right Adjusts the volume.

OK Accepts your selection or displays the current mode.

REMOTE CONTROL KEY FUNCTIONS

A TYPE

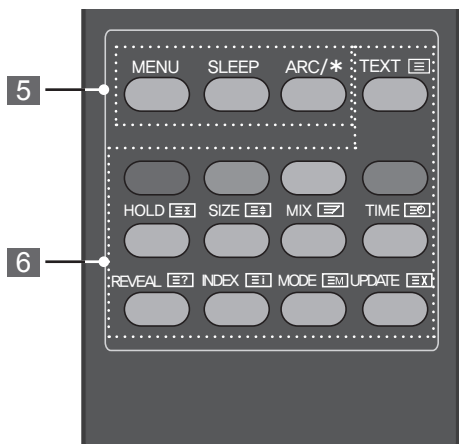

5 MENU Selects a menu.(► p.37)

SLEEP Sets the sleep timer.

ARC/* Selects your desired picture format.(► p.45)

6 Coloured buttons These buttons are used for teletext (on **TELETEXT** models only) or **Programme edit**.

TELETEXT BUTTONS These buttons are used for teletext. For further details, see the 'Teletext' section. (► p.72)

B TYPE

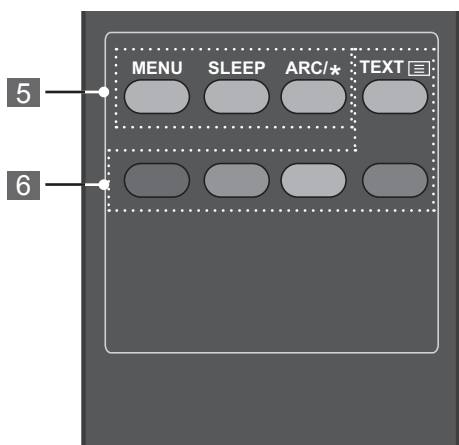

Installing Batteries

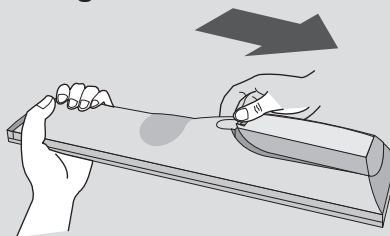

- Open the battery compartment cover on the back side and install the batteries matching correct polarity (+with +,-with -)
- Install two 1.5 V AAA batteries. Don't mix old or used batteries with new ones.
- Close cover.
- To remove the batteries, perform the installation actions in reverse.

WATCHING TV / PROGRAMME CONTROL

TURNING ON THE SET

When using the remote control, aim it at the remote control sensor on the SET.

- 1 Firstly, connect the power cord correctly.
At this stage, the SET switches to standby mode.
 - In standby mode to turn SET on, press the button ϕ/I on the SET or press the POWER buttons on the remote control and the SET will switch on.

INSTALLATION GUIDE

- 1 If the OSD (On Screen Display) is displayed on the screen after turning on the SET, you can adjust the **Language, Auto Tuning**.

Note:

- a. It will automatically disappear after approx. 40 seconds unless a button is pressed.
- b. If you close without completing the initial setting, the Instal lation Guide menu can be displayed again.

PROGRAMME SELECTION

- 1 Press the $\blacktriangle/\blacktriangledown$ or NUMBER buttons to select a programme number.

VOLUME ADJUSTMENT

- 1 Press the $\blacktriangleleft/\blacktriangleright$ button to adjust the volume.
- 2 If you wish to switch the sound off, press the MUTE button.
- 3 You can cancel the Mute function by pressing the MUTE, $\blacktriangleleft/\blacktriangleright$, SSM or I/II button.

ON SCREEN MENUS SELECTION AND ADJUSTMENT

Your TV's OSD (On Screen Display) may differ slightly from that shown in this manual.

- 1 Press the **MENU** button and then **▲/▼** button to display each menu.
- 2 Press the **▶** button and then **▲/▼** button to select a menu item.
- 3 Change the setting of an item in the sub or pull-down menu with **◀ / ▶** button.
You can move to a higher level menu by pressing the **OK** button.

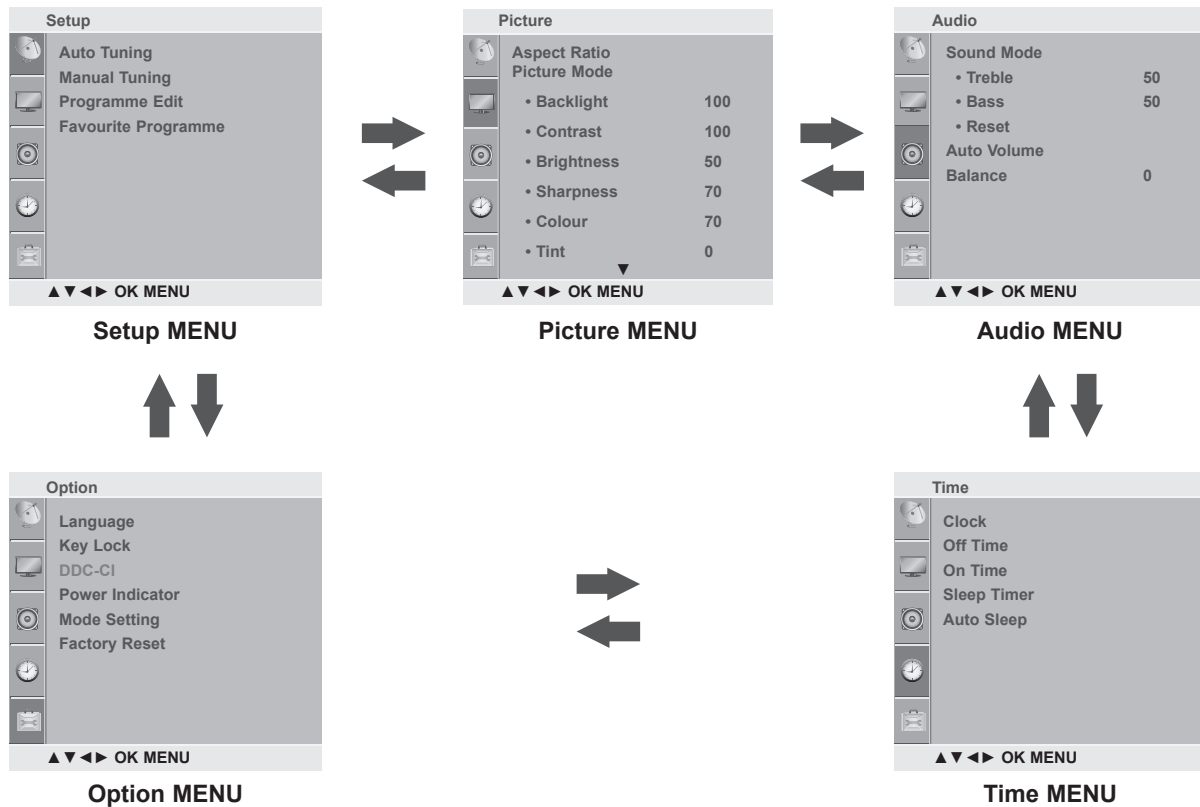

! NOTE

- ▶ The OSD (On Screen Display) function enables you to adjust the screen status conveniently since it provides graphical presentation.
- ▶ In this manual, the OSD (On Screen Display) may be different from your TV's because it is just example to help the TV operation.
- ▶ In the teletext mode, menus are not displayed.

WATCHING TV / PROGRAMME CONTROL

AUTO PROGRAMME TUNING

Up to 200 TV stations can be stored by programme numbers (0 to 199). Once you have preset the stations, you will be able to use the ▲ / ▼ or NUMBER buttons to scan the stations you have programmed. Stations can be tuned using automatic or manual modes.

All stations which can be received are stored by this method. It is recommended that you use Auto tuning during installation of this SET.

1 Press the **MENU** button and then ▲ / ▼ button to select the **Setup** menu.

2 Press the ► button and then ▲ / ▼ button to select **Auto Tuning**.

3 Press the ► button and then ▲ / ▼ button to select **System**

4 Press the ► button and then ▲ / ▼ button to select a TV system menu;
BG: PAL B / G, SECAM B / G (Asia / NewZealand / M.East / Africa)
I: PAL I (South Africa / Hong Kong)
DK: PAL D / K, SECAM D / K (China / Africa / CIS)
M: (Philippines)

5 Press the ▲ / ▼ button to select **Storage From**.

6 Press the ◀ / ▶ button or NUMBER buttons to select the initial programme number.

7 Press the ▲ / ▼ button to select **Search**.

8 Press the ► button to begin auto tuning.
All receivable stations are stored.

To stop auto tuning, press the **MENU** button.

When auto tuning is complete, the **Programme Edit** menu appears on the screen. See the **Programme Edit** section to edit the stored programme.

9 Press the **MENU** button to move to the previous menu screen.

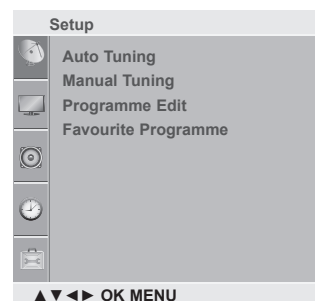

1

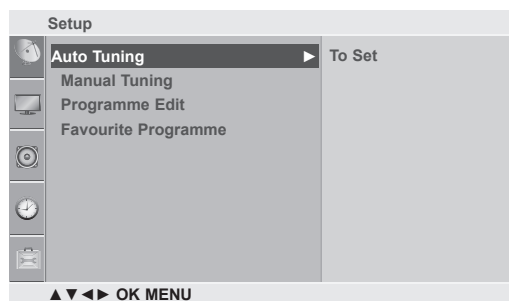

2

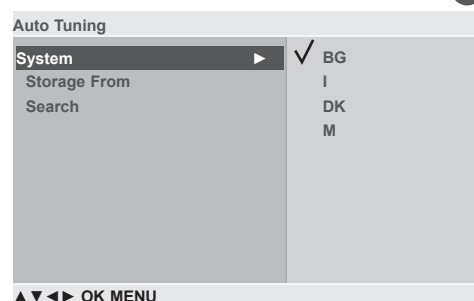

3 4 5 6 7

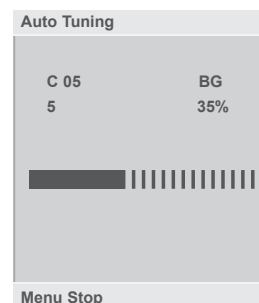

8

MANUAL PROGRAMME TUNING

Manual Turning lets you manually tune and arrange the stations in whatever order you desire.

- 1 Press the **MENU** button and then ▲ / ▼ button to select the **Setup** menu.
- 2 Press the ► button and then ▲ / ▼ button to select **Manual Tuning**.
- 3 Press the ► button and then ▲ / ▼ button to select **Storage**.
- 4 Press the ◀ / ▶ button or NUMBER buttons to select the desired programme number (0 to 199).
- 5 Press the ▲ / ▼ button to select **System**.
- 6 Press the ► button and then ▲ / ▼ button to select a TV system menu;
BG: PAL B / G, SECAM B / G (Asia / NewZealand / M.East / Africa)
I: PAL I (South Africa / Hong Kong)
DK: PAL D / K, SECAM D / K (China / Africa / CIS) M: (Philippines)
- 7 Press the ▲ / ▼ button to select **Band**.
- 8 Press the ► button and then ▲ / ▼ button to select **V/ UHF or Cable**.
- 9 Press the ▲ / ▼ button to select **Channel**.
- 10 Press the ► button and then You can select the desired programme number with the ◀ / ▶ button or NUMBER buttons.If possible, select the programme number directly with the number buttons.
- 11 Press the ▲ / ▼ button to select **Search**.
- 12 Press the ◀ / ▶ button to commence searching. If a station is found the search will stop.
- 13 Press the **OK** button to store it.
- 14 To store another station, repeat steps 3 to 13.
- 15 Press the **MENU** button to move to the previous menu screen.

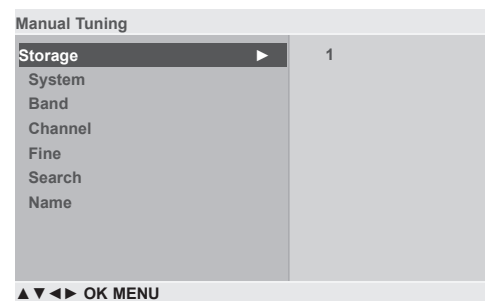
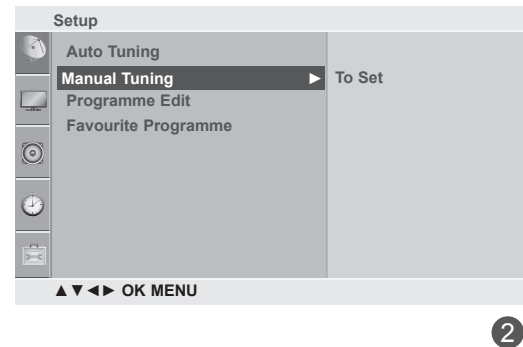
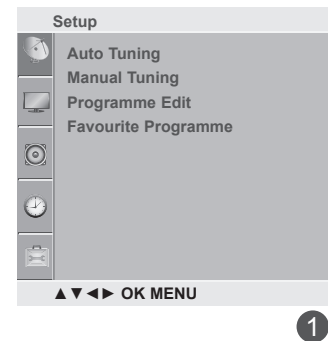

3 4 5 6 7
8 9 10 11 12

WATCHING TV / PROGRAMME CONTROL

FINE TUNING

Normally fine tuning is only necessary if reception is poor.

- 1 Press the **MENU** button and then ▲ / ▼ button to select the **Setup** menu.
.....
- 2 Press the ► button and then ▲ / ▼ button to select **Manual Tuning**.
.....
- 3 Press the ► button and then ▲ / ▼ button to select **Fine**.
.....
- 4 Press the ► button and then ◀ / ▶ button to fine tune for the best picture and sound.
.....
- 5 Press the **OK** button to store it.
.....
- 6 Press the **MENU** button to move to the previous menu screen.

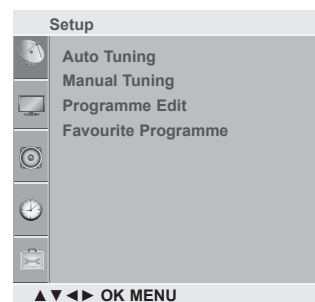

1



2



3 4 5

ASSIGNING A STATION NAME

You can assign a station name up to five characters to each programme number.

- 1 Press the **MENU** button and then ▲ / ▼ button to select the **Setup** menu.
- 2 Press the ► button and then ▲ / ▼ button to select **Manual Tuning**.
- 3 Press the ► button and then ▲ / ▼ button to select **Name**.
- 4 Press the ► button and then ▲ / ▼ button. You can use a blank, +, -, the number 0 to 9 and the alphabet A to Z.
- 5 Press the ◀ / ▶ button to select the position and make your choice of the second character, and so on.
- 6 Press the **OK** button to store it.
- 7 Press the **MENU** button to move to the previous menu screen.

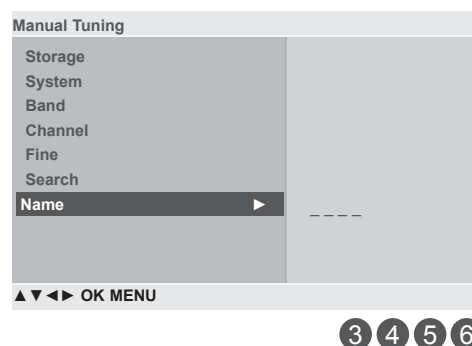
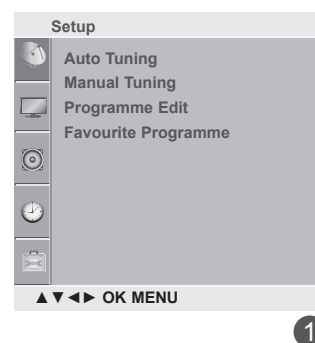

3 4 5 6

WATCHING TV / PROGRAMME CONTROL

PROGRAMME EDIT

This function enables you to delete or skip stored programmes. Also you can move some stations to other programme numbers.

- 1 Press the **MENU** button and then ▲ / ▼ button to select the **Setup** menu.

- 2 Press the ► button and then ▲ / ▼ button to select **Programme Edit**.

- 3 Press the ► button to display the **Programme Edit** menu.

■ Deleting a programme

1. Select a programme to be deleted with the ▲ / ▼ / ◀ / ▶ button.

2. Press the RED button twice.

The selected programme is deleted, all the following programmes are shifted up one position.

■ Moving a programme

1. Select a programme to be moved with the ▲ / ▼ / ◀ / ▶ button.

2. Press the Green button.

3. Move the programme to the desired programme number with the ▲ / ▼ / ◀ / ▶ button.

4. Press the Green button again to release this function.

■ Skipping a programme number

1. Select a programme number to be skipped with the ▲ / ▼ / ◀ / ▶ button.

2. Press the BLUE button. The skipped programme turns to blue.

3. Press the BLUE button again to release the skipped programme.

When a programme number is skipped it means that you will be unable to select it using the ▲ / ▼ button during normal TV viewing. If you wish to select the skipped programme, directly enter the programme number with the **NUMBER** buttons or select it in the **Programme Edit** or table menu.

- 4 Press the **MENU** button to move to the previous menu screen.

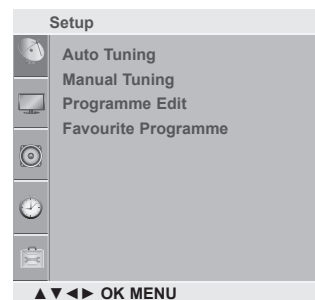

1



2

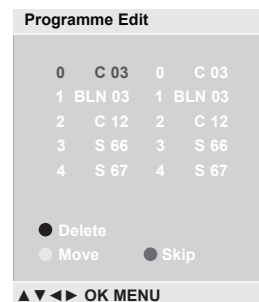

3

FAVOURITE PROGRAMME

This function lets you select your favourite programmes directly.

Repeatedly press the YELLOW button to select stored favourite programmes.

- 1 Press the **MENU** button and then ▲ / ▼ button to select the **Setup** menu.
- 2 Press the ► button and then ▲ / ▼ button to select **Favourite Programme**.
- 3 Press the ► button.
- 4 Press the ▲ / ▼ button to select -----.
- 5 Select a desired programme with the ◀ / ▶ button or **NUMBER** buttons.
- 6 To store another programme, repeat steps 4 to 5.
You can store up to 8 programmes.
- 7 Press the **MENU** button to move to the previous menu screen.

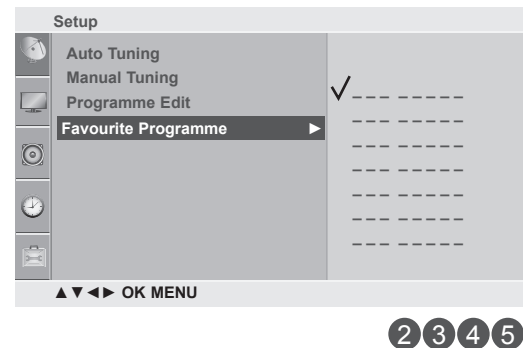
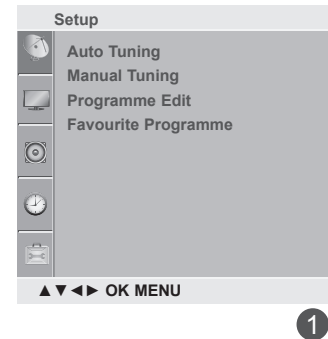

WATCHING TV / PROGRAMME CONTROL

SELECTING THE PROGRAMME LIST

You can check which programmes are stored in the memory by displaying the programme list.

■ Displaying programme list

Press the **LIST** button to display the **Programme List** menu.

The programme list appears on the screen.

One programme list contains ten programmes as shown.

! NOTE

- You may find some blue programmes. They have been set up to be skipped by auto programming or in the programme edit mode.
- Some programmes with the channel number shown in the programme list indicate there is no station name assigned.

■ Selecting a programme in the Programme List

Select a programme with the ▲ / ▼ / ◀ / ▶ button.

Then press the **OK** button. The TV switches to the chosen programme number.

■ Paging through a Programme List

There are 20 programme table pages in which contain 200 programmes. Pressing the ▲ / ▼ / ◀ / ▶ button repeatedly turns the pages.

Press the **LIST** button to return to normal TV viewing.

Programme List			
0	C 03	0	C 03
1	BLN 03	1	BLN 03
2	C 12	2	C 12
3	S 66	3	S 66
4	S 67	4	S 67
▲ ▼ ◀ ▶ OK MENU			

PICTURE CONTROL

PICTURE SIZE (ASPECT RATIO) CONTROL

You can watch the screen in various picture formats; **16:9**, **Original**, **4:3**, **14:9**, **Zoom1**, **Zoom2** and **Just Scan**.

If a fixed image is displayed on the screen for a long time, that fixed image may become imprinted on the screen and remain visible.

You can adjust the enlarge proportion using ▲ / ▼ button.

This function works in the following signal.

- 1 You can adjust **Aspect Ratio** in the **Picture** menu.

• 16:9

The following selection will allow you to adjust the picture horizontally, in linear proportion, to fill the entire screen (useful for viewing 4:3 formatted DVDs).



• Original

When your TV receives a wide screen signal it will automatically change to the picture format to be broadcast.



• 4:3

The following selection will allow you to view a picture with an original 4:3 aspect ratio, black bars will appear on both the left and right of the screen.



• 14:9

You can view a picture format of 14:9 or a general TV programme in the 14:9 mode. The 14:9 screen is viewed in the same way as in 4:3, but is magnified to the left and right.



• Zoom 1

The following selection will allow you to view the picture without any alteration, while filling the entire screen. However, the top and bottom of the picture will be cropped.



• Zoom 2

Choose Zoom 2 when you wish the picture to be altered, both horizontally extended and vertically cropped. The picture adopting a compromise between alteration and screen coverage.



• Just Scan

Following Selection will lead you view the picture of best quality without loss of original picture in high resolution image.



! NOTE

- ▶ You can only select 4:3, 16:9 (Wide) in Component, RGB-PC, HDMI mode.
- ▶ In HDMI/Component (over 720p) mode, Just Scan is available.

PICTURE CONTROL

PRESET PICTURE SETTINGS

Picture Mode-Preset

Picture Mode adjusts the SET for the best picture appearance. Select the preset value in the **Picture Mode** menu based on the programme category.

Vivid, Standard, Cinema and **sRGB** are programmed for optimum picture reproduction at the factory.

- 1

Press the **MENU** button and then ▲ / ▼ button to select the **Picture** menu.
- 2

Press the ► button and then ▲ / ▼ button to select **Picture Mode**.
- 3

Press the ► button and then ▲ / ▼ button to select **Vivid, Standard, Cinema** or **sRGB**.
- 4

Press the **MENU** button to move to the previous menu screen.

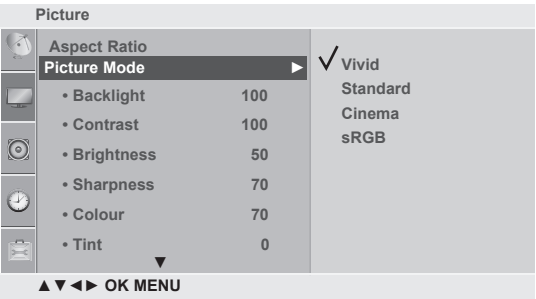
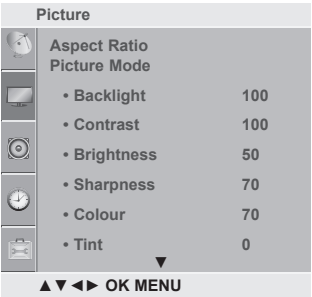

! NOTE

- In RGB PC mode, sRGB is available.

MANUAL PICTURE ADJUSTMENT

Picture Mode-User Option

Backlight	To control the brightness of the screen, adjust the brightness of LCD panel.
Contrast	Adjusts the difference between light and dark levels in the picture.
Brightness	Increases or decreases the amount of white in the picture.
Sharpness	Adjusts the level of crispness in the edges between the light and dark areas of the picture. The lower the level, the softer the image.
Colour	Adjusts intensity of all colours.
Tint	Adjusts the balance between red and green levels.

- 1 Press the **MENU** button and then **▲ / ▼** button to select the **Picture** menu.
- 2 Press the **▶** button and then **▲ / ▼** button to select **Picture Mode**.
- 3 Press the **▶** button and then **▲ / ▼** button to select **Vivid, Standard, Cinema** or **sRGB**.
- 4 Press the **OK** button and then **▲ / ▼** button to select the desired picture option (**Backlight, Contrast, Brightness, Sharpness, Colour** and **Tint**).
- 5 Press the **◀ / ▶** button to make appropriate adjustments.
- 6 Press the **MENU** button to move to the previous menu screen.

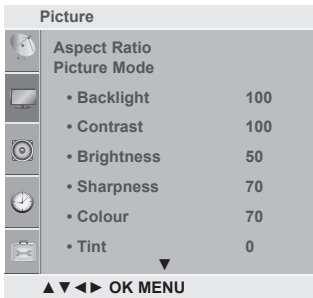

1

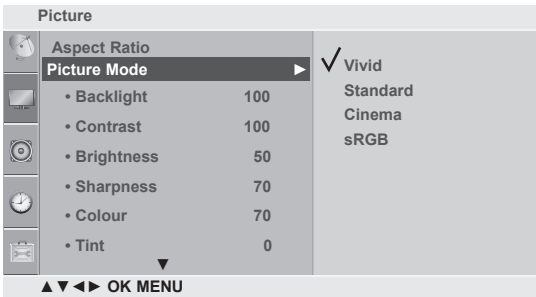

2 3

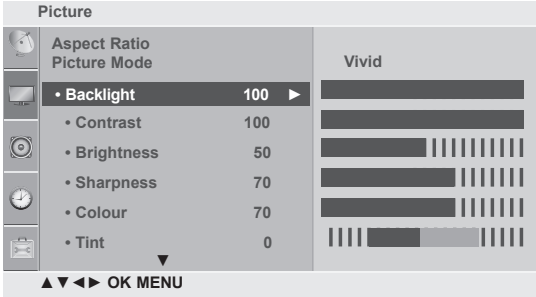

4 5



! NOTE

- In RGB PC mode, sRGB is available.

PICTURE CONTROL

PICTURE IMPROVEMENT TECHNOLOGY

You can calibrate the screen for each Picture Mode or set the video value according to the special video screen.

You can set the video value differently for each input.

To reset to the factory default screen after making adjustments to each video mode, execute the “Picture Reset” function for each Picture Mode.

- 1

Press the **MENU** button and then ▲ / ▼ button to select the **Picture** menu.
- 2

Press the ► button and then ▲ / ▼ button to select **Advanced**.
- 3

Press the ► button and then ▲ / ▼ button to select **Dynamic Contrast, Dynamic Colour, Noise Reduction, Black Level, Film Mode or Colour Temperature**.
- 4

Press the **MENU** button to move to the previous menu screen.

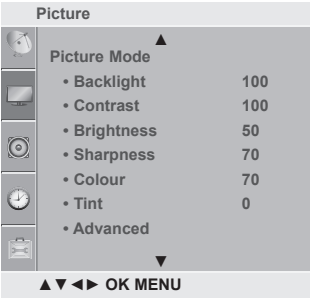

1



2

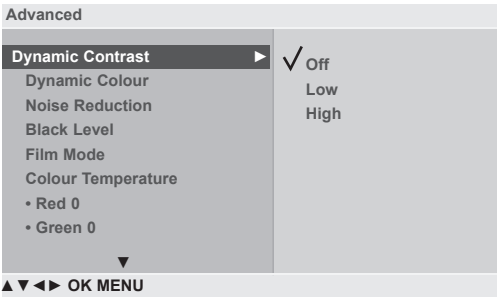

3

! NOTE

- At 1080i / p **Dynamic Contrast, Dynamic Colour, Noise Reduction** is not enable.

PICTURE IMPROVEMENT TECHNOLOGY

Dynamic Contrast (Off/Low/High)	<ul style="list-style-type: none"> ■ Adjusts the contrast to keep it at the best level according to the brightness of the screen. The picture is improved by making bright parts brighter and dark parts darker. ■ This feature is not working in RGB 1080p/i mode.
Dynamic Colour (Off/Low/High)	<ul style="list-style-type: none"> ■ Adjusts screen colours so that they look livelier, richer and clearer. This feature enhances hue, saturation and luminance so that red, blue, green and white look more vivid. ■ This feature is not working in RGB 1080p/i mode.
Noise Reduction (Off/Low/High)	<ul style="list-style-type: none"> ■ Reduces screen noise without compromising video quality.
Black Level (Low/High)	<ul style="list-style-type: none"> • Low :The reflection of the screen gets darker. • High : The reflection of the screen gets brighter. ■ Set black level of the screen to proper level. ■ This function enables to select 'Low' or 'High' in the following mode: RF, AV, Component or HDMI.
Film Mode (On/Off)	<ul style="list-style-type: none"> ■ Makes video clips recorded in film look more natural. ■ This feature operates only in SET, AV, RF and Component 480i/576i mode.
Colour Temperature (Cool/Medium/Warm)	<ul style="list-style-type: none"> ■ Choose one of three automatic colour adjustments. Set to warm to enhance hotter colours such as red, or set to cool to see less intense colours with more blue. ■ You can control red, green, blue to adjust colour details.

PICTURE CONTROL

PICTURE RESET

Settings of the selected picture modes return to the default factory settings.

- 1

Press the **MENU** button and then ▲/▼ button to select the **Picture** menu.
- 2

Press the ► button and then ▲/▼ button to select **Picture Reset**.
- 3

Press the ► button to initialize the adjusted value.
- 4

Press the **MENU** button to move to the previous menu screen.

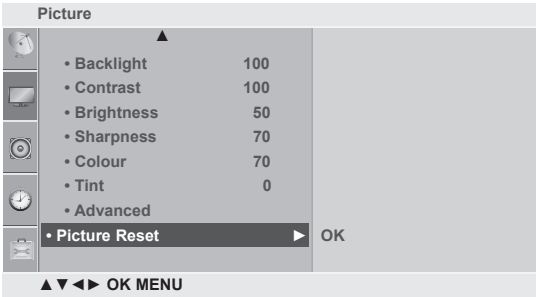
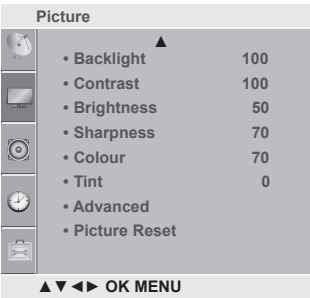

SCREEN SETUP

AUTO CONFIGURE (RGB [PC] mode only)

Automatically adjusts picture position and minimizes image instability. After adjustment, if the image is still not correct, your set is functioning properly but needs further adjustment.

Auto configure

This function is for automatic adjustment of the screen position, clock, and phase The displayed image will be unstable for a few seconds while the auto configuration is in progress.

- 1

Press the **MENU** button and then use ▲/▼ button to select the **Picture** menu.
- 2

Press the ► button and then use ▲/▼ button to select **Screen**.
- 3

Press the ► button and then use ▲/▼ button to select **Auto Config.**
- 4

Press the **OK** button
- 5

Press the **MENU** button to move to the previous menu screen

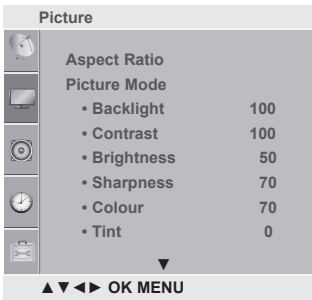

1

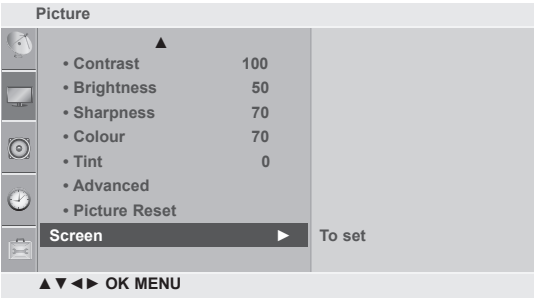

2

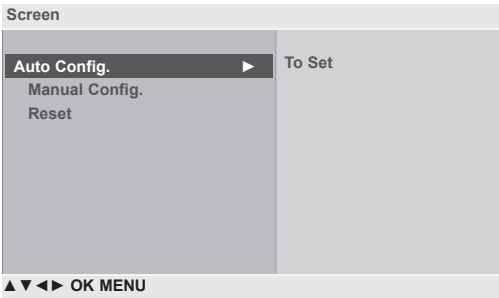

3 4

PICTURE CONTROL

MANUAL CONFIGURE(Adjustment for screen Position)

If the picture is not clear and especially if characters are still trembling, adjust the picture phase manually.

This function works in the following mode when the signal exist : **RGB PC**

- 1

Press the **MENU** button and then use ▲/▼ button to select the **Picture** menu.
- 2

Press the ► button and then use ▲/▼ button to select **Screen**.
- 3

Press the ► button and then use ▲/▼ button to select **Manual Config.**
- 4

Press the ► button and then use ▲/▼ button to select **Phase, Clock, H-Position** or **V-Position**.
(When the H-Position and V-Position be changed, Value may differ from the aspect ratio.)
- 5

Press the ◀ / ▶ button to make appropriate adjustments.
- 6

Press the **MENU** button to move to the previous menu screen.

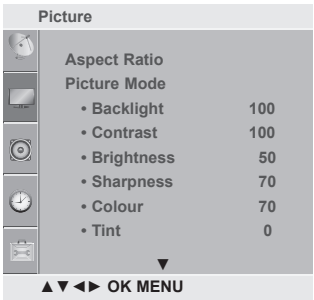

1

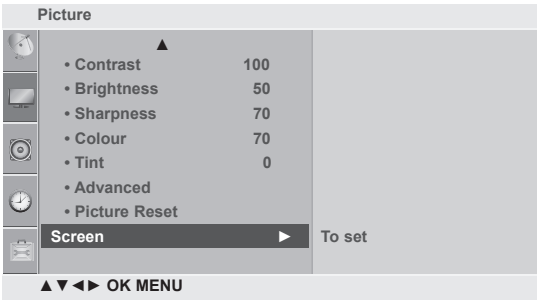

2

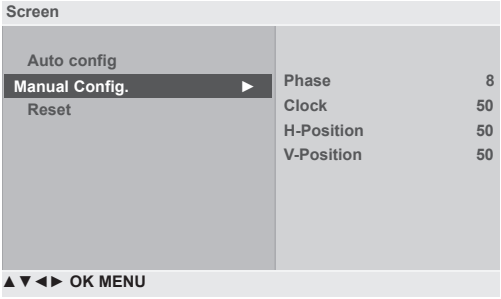

3 4 5

INITIALIZING (Reset to original factory settings)

This function operates in current mode.
 To initialize the adjusted value
 This function works in the following mode when the signal exist : **RGB PC**

- 1 Press the **MENU** button and then use ▲/▼ button to select the **Picture** menu.
- 2 Press the ► button and then use ▲/▼ button to select **Screen**.
- 3 Press the ► button and then use ▲/▼ button to select **Reset**.
- 4 Press the ► button.
- 5 Press the **MENU** button to move to the previous menu screen.

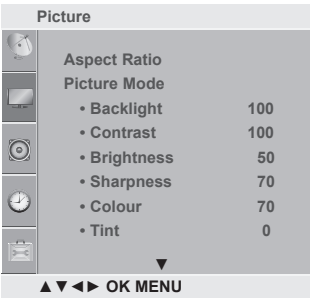

1

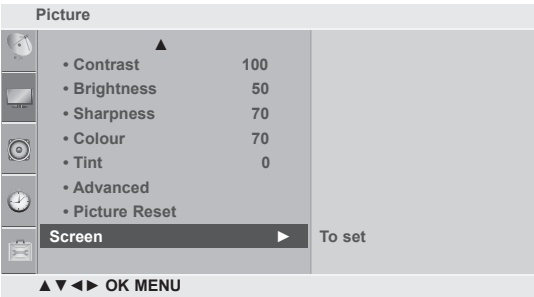

2

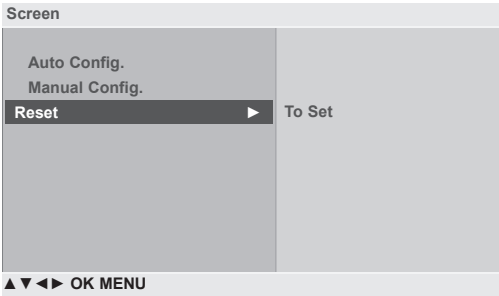

3 4

PICTURE CONTROL

SELECTING RESOLUTION

To view a normal picture, match the resolution of RGB mode and selection of PC mode.

This function works in the following mode: **RGB[PC] mode.**

- 1

Press the **MENU** button and then use ▲/▼ button to select the **Picture** menu.
- 2

Press the ► button and then use ▲/▼ button to select **Screen**.
- 3

Press the ► button and then use ▲/▼ button to select **Resolution**.
- 4

Press the **MENU** button to move to the previous menu screen.

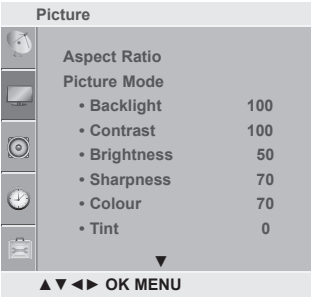

1

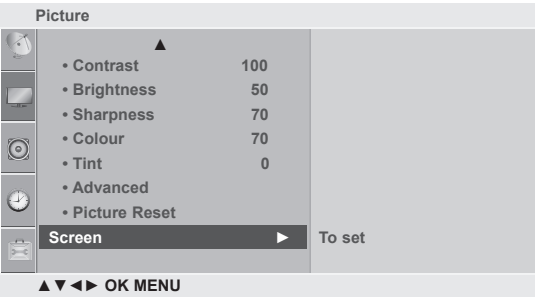

2

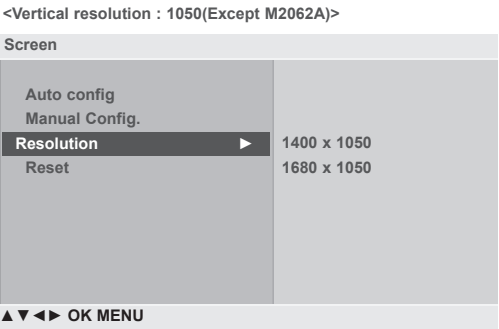
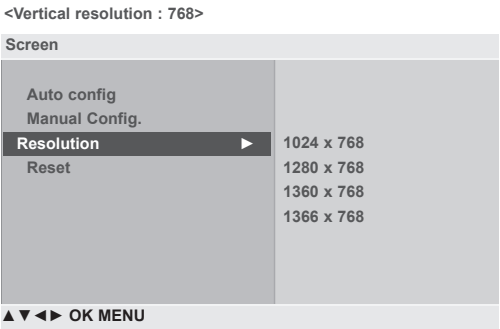

3

SOUND CONTROL

PRESET SOUND SETTINGS - SOUND MODE

You can select your preferred sound setting; **Standard**, **Music** or **Cinema**.

Sound Mode lets you enjoy the best sound without any Special adjustment as the TV sets the appropriate sound options based on the programme content.

Standard, **Music** and **Cinema** are preset for optimum sound quality at the factory.

- 1

Press the **MENU** button and then ▲/▼ button to select the **Audio** menu.
- 2

Press the ► button and then ▲/▼ button to select **Sound Mode**.
- 3

Press the ► button and then ▲/▼ button to select **Standard**, **Music** or **Cinema**.
- 4

Press the **MENU** button to move to the previous menu screen.

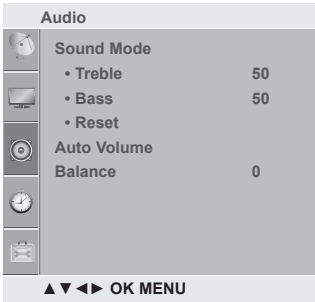

1

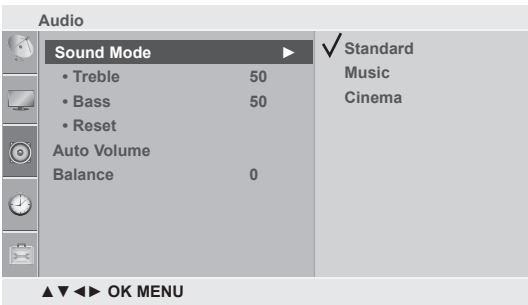

2 3

SOUND CONTROL

SOUND SETTING ADJUSTMENT - USER MODE

- 1 Press the **MENU** button and then ▲/▼ button to select the **Audio** menu.
- 2 Press the ► button and then ▲/▼ button to select **Sound Mode**.
- 3 Press the ► button and then ▲/▼ button to select **Standard, Music or Cinema**.
- 4 Press the **OK** button and then ▲/▼ button to select **Treble** or **Bass**.
- 5 Press the ◀/▶ button to make appropriate adjustments.
- 6 Press the **MENU** button to move to the previous menu screen.

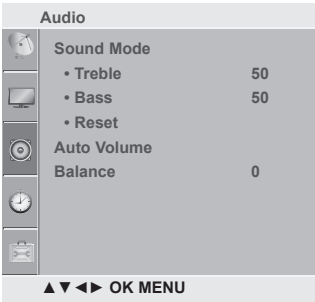

1

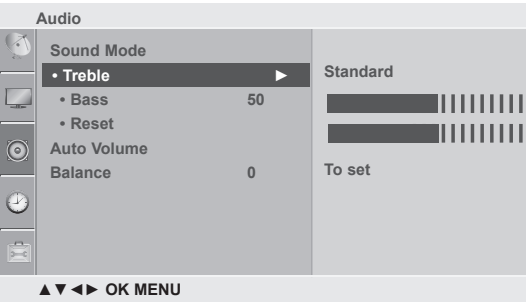

2 3 4 5

AUTO VOLUME LEVELER

Auto Volume automatically remains on the same level of volume if you change programmes.

- 1

Press the **MENU** button and then ▲/▼ button to select the **Audio** menu.
- 2

Press the ► button and then ▲/▼ button to select **Auto Volume**.
- 3

Press the ► button and then ▲/▼ button to select **On** or **Off**.
- 4

Press the **MENU** button to move to the previous menu screen.

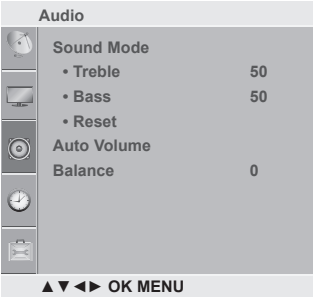

1

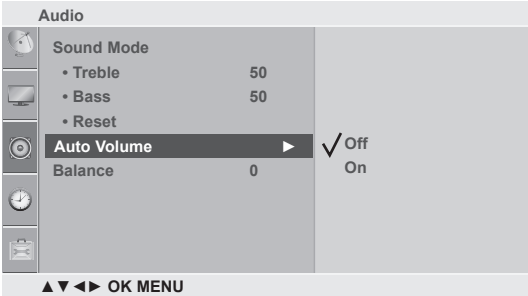

2 3

SOUND CONTROL

BALANCE

You can adjust the sound balance of the speakers to the preferred levels.

- 1

Press the **MENU** button and then ▲/▼ button to select the **Audio** menu.
- 2

Press the ► button and then ▲/▼ button to select **Auto Balance**.
- 3

Press the ► button and then ◀/▶ button to make desired adjustment.
- 4

Press the **MENU** button to move to the previous menu screen.

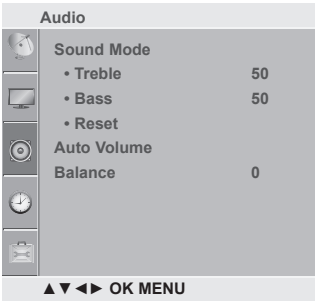

1

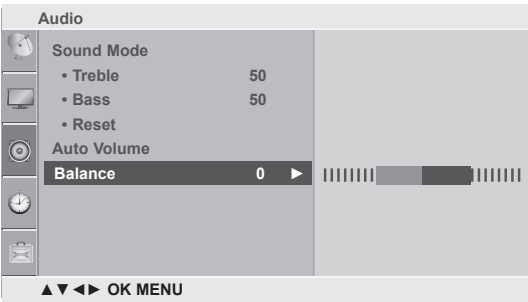

2 3

AUDIO RESET

Settings of the selected **Sound Mode** return to the default factory settings.

- 1

Press the **MENU** button and then ▲/▼ button to select the **Audio** menu.
- 2

Press the ► button and then ▲/▼ button to select **Reset**.
- 3

Press the ► button or **OK** button.
- 4

Press the **MENU** button to move to the previous menu screen.

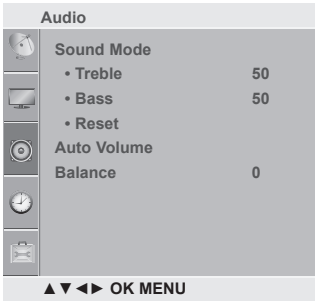

1

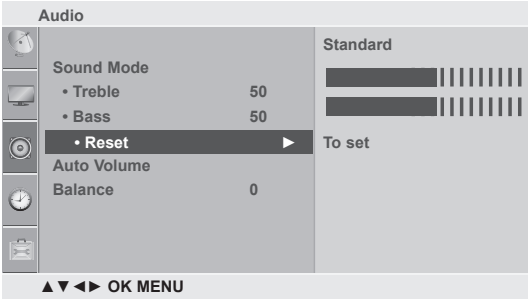

2 3

SOUND CONTROL



STEREO / DUAL RECEPTION

When a programme is selected, the sound information for the station appears with the programme number and station name.

-
- 1** Press the **I/II** button to select the **Multi Audio** menu.
-

Broadcast	On Screen Display
Mono	MONO
Stereo	STEREO
Dual	DUAL I , DUAL I I , DUAL I+I I

■ **Mono sound selection**

If the stereo signal is weak in stereo reception, you can switch to mono. In mono reception, the clarity of sound is improved. To switch back to stereo.

■ **Language selection for dual language broadcast**

If a programme can be received in two languages (dual language), you can switch to DUAL I, DUAL II or DUAL I+II.

- DUAL I** Sends the primary broadcast language to the loudspeakers.
DUAL II Sends the secondary broadcast language to the loudspeakers.
DUAL I+II Sends a separate language to each loudspeaker.

NICAM RECEPTION

If the SET is equipped with a receiver for **NICAM** reception, high quality **NICAM** (Near Instantaneous Companding Audio Multiplex) digital sound can be received.

Sound output can be selected according to the type of broadcast received.

-
- 1 When **NICAM MONO** is received, you can select **NICAM MONO** or **MONO**.
.....
 - 2 When **NICAM STEREO** is received, you can select **NICAM STEREO** or **MONO**.
If the stereo signal is weak, switch to **MONO**.
.....
 - 3 When **NICAM DUAL** is received, you can select **NICAM DUAL I**, **NICAM DUAL II** or **NICAM DUAL I+II** or **MONO**.
.....
-

SPEAKER SOUND OUTPUT SELECTION

In **AV**, **Component**, **RGB PC** and **HDMI** mode, you can select output sound for the left and right loudspeakers.

Select the sound output.

L+R : Audio signal from audio L input is sent to the left loudspeaker and audio signal from audio R input is sent to the right loudspeaker.

L+L : Audio signal from audio L input is sent to left and right loudspeakers.

R+R : Audio signal from audio R input is sent to left and right loudspeakers.

TIME SETTING

CLOCK SETUP

You must set the time correctly before using on/off time function.

If current time setting is erased by a power failure or the SET is unplugged, reset the clock.

- 1 Press the **MENU** button and then ▲/▼ button to select the **Time** menu.

- 2 Press the ► button and then ▲/▼ button to select **Clock**.

- 3 Press the ► button and then ▲/▼ button to set the hour.

- 4 Press the ► button and then ▲/▼ button to set the minute.

- 5 Press the **MENU** button to move to the previous menu screen.

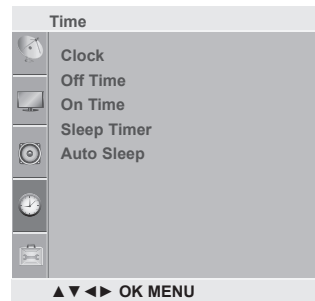

1



2 3 4

AUTO ON/OFF TIMER SETTING

The Off time function automatically switches the SET to standby at a preset time.

The SET is switched on by the on time function it will automatically switch back to standby mode unless a button has been pressed for Two hours after.

Once the on time/off time is set, these functions operate daily at the preset time.

The Off time function overrides the On time function if both are set to the same time.

The SET must be in standby mode for the On time to work.

- 1 Press the **MENU** button and then ▲ / ▼ button to select the **Time** menu.

- 2 Press the ► button and then ▲ / ▼ button to select **On/Off Time**.

- To cancel **On / Off Time** function, select **Off**.

- 3 Press the ► button and then ▲ / ▼ button to set the hour.

- 4 Press the ► button and then ▲ / ▼ button to set the minutes.

- 5 **For On Time function only**

- **PR** : Press the ► button and then ▲ / ▼ button to select the programme.
- **Vol** : Press the ► button and then ▲ / ▼ button to adjust volume level at switch-on.

- 6 Press the **MENU** button to move to the previous menu screen.

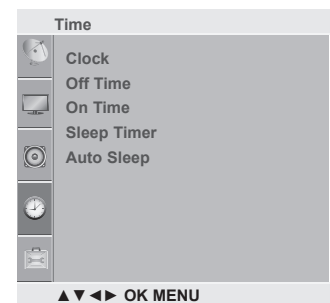

1



2 3 4



2 3 4 5

TIME SETTING

SLEEP TIMER SETTING

You do not have to remember to switch the SET off before you go to sleep. The sleep timer automatically switches the SET to standby after the preset time has elapsed.

- 1

Press the **MENU** button and then ▲ / ▼ but ton to select the **Time** menu.
- 2

Press the ► button and then ▲ / ▼ button to select **Sleep Timer**.
- 3

Press the ► button and then ▲ / ▼ button to set the minute (**Off, 10, 20, 30, 60, 90, 120, 180 or 240**).
- 4

Press the **MENU** button to move to the previous menu screen.



1

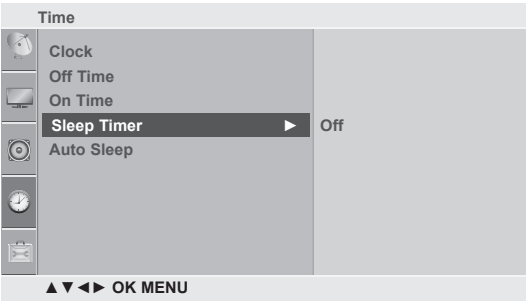

2 3 4

AUTO SLEEP

If the set is switched on and there is no input signal, it will switch off automatically after 15 minutes.

- 1 Press the **MENU** button and then ▲ / ▼ button to select the **Time** menu.
- 2 Press the ► button and then ▲ / ▼ button to select **Auto Sleep**.
- 3 Press the ► button and then ▲ / ▼ button to select **On** or **Off**.

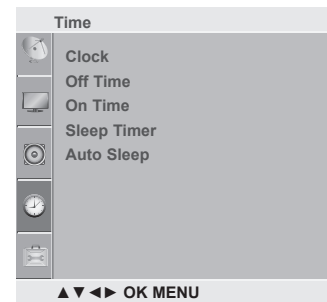

1



2 3

OPTION SETTING

ON-SCREEN MENU LANGUAGE SELECTION

The menus can be shown on the screen in the selected language.

1 Press the **MENU** button and then use ▲ / ▼ button to select the **Option** menu.

2 Press the ► button and then use ▲ / ▼ button to select **Language**.

3 Press the ► button and then use ▲ / ▼ / ◀ / ▶ button to select your desired language.

4 Press the **OK** button

5 Press the **MENU** button to move to the previous menu screen.



1

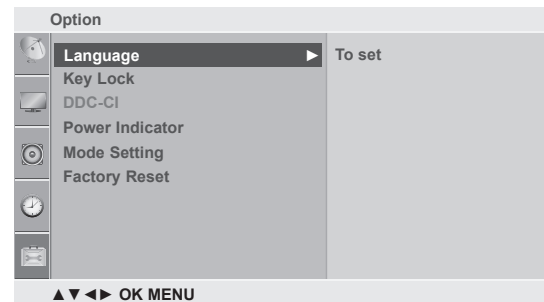

2

KEY LOCK

The SET can be set so that the remote control is needed to control it. This feature can be used to prevent unauthorized viewing.

This SET is programmed to remember which option it was last set to even if you turn the SET off.

- 1 Press the **MENU** button and then ▲ / ▼ button to select the **Option** menu.
- 2 Press the ► button and then ▲ / ▼ button to select **Key Lock**.
- 3 Press the ► button and then ▲ / ▼ button to select **On** or **Off**.
- 4 Press the **MENU** button to move to the previous menu screen.



1

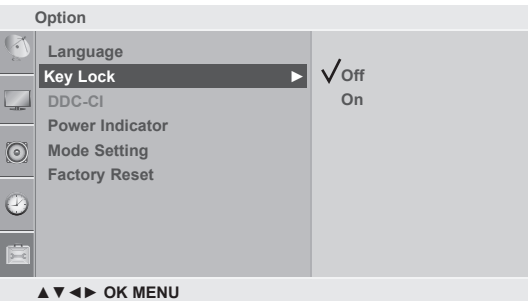

2 3

! NOTE

- In **Key Lock 'On'**, if the TV is turned off, press the ⏻ / I button on the SET or **POWER** buttons on the remote control.
- With the Key Lock On, the display 'Key Lock On' appears on the screen if any button on the side panel is pressed while viewing the SET.

OPTION SETTING

DDC-CI(Only RGB)

DDC-CI (Display Data Channel Command Interface) is a communication protocol for communications between PC and set.

DDC-CI makes it possible to adjust and setup detailed functions on PC instead of the set OSD.

Set can be adjusted with PC by connecting communication between PC and set when DDC-CI is ON, and when DDC-CI is OFF set cannot be adjusted with PC because communication between PC and set is disconnected.

- 1 Press the **MENU** button and then ▲ / ▼ button to select the **Option** menu.

- 2 Press the ► button and then ▲ / ▼ button to select **DDC-CI**.

- 3 Press the ► button and then ▲ / ▼ button to select **On** or **Off**.

- 4 Press the **MENU** button to move to the previous menu screen.

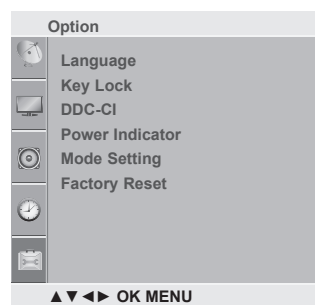

1

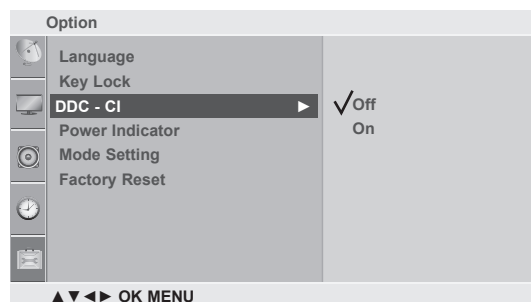

2 3

POWER INDICATOR

It is function to control of LED(turn on/off).

- 1 Press the **MENU** button and then ▲/▼ button to select the **Option** menu.
- 2 Press the ► button and then ▲/▼ button to select **Power Indicator**.
- 3 Press the ► button and then ▲/▼ button to select **On** or **Off**.
- 4 Press the **MENU** button to move to the previous menu screen.



1

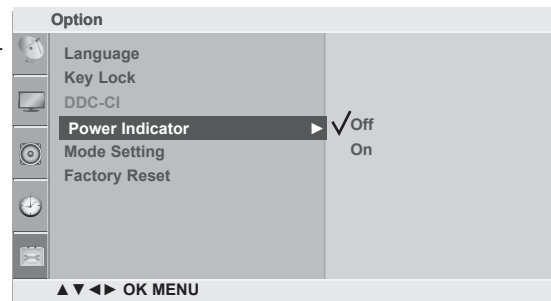

2

OPTION SETTING

MODE SETTING

We recommend setting the set to “Home Use” mode for the best picture in your home environment. “Store Demo” mode is an optimal setting for displaying at stores.

- 1 Press the **MENU** button and then ▲ / ▼ button to select the **Option** menu.

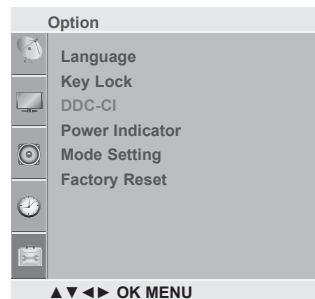

1

- 2 Press the ► button and then ▲ / ▼ button to select **Mode Setting**.

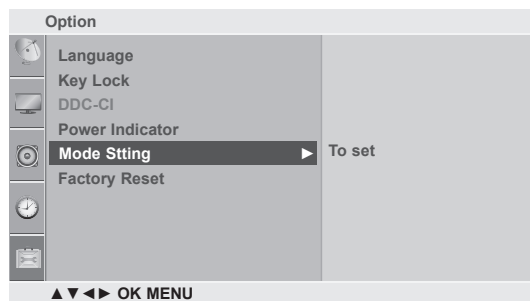

2

- 3 Press the ► button and then ◀ / ▶ button to select **Store Demo or Home Use**.

- 4 Press the **MENU** button to move to the previous menu screen.

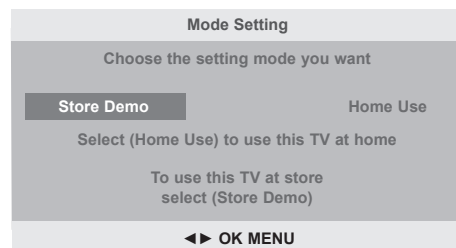

3

FACTORY RESET

Use to quickly reset all the menu options to their original factory preset values.

This function deletes all SET programmes.

When the **Factory Reset** is completed, you must restart the **Installation Guide**.

-
- 1 Press the **MENU** button and then ▲ / ▼ button to select the **Option** menu.
-

- 2 Press the ► button and then ▲ / ▼ button to select **Factory Reset**.
-

- 3 Press the ► button and then ▲ / ▼ button to select **Yes** or **No**.
-

- 4 Press the **MENU** button to move to the previous menu screen.
-

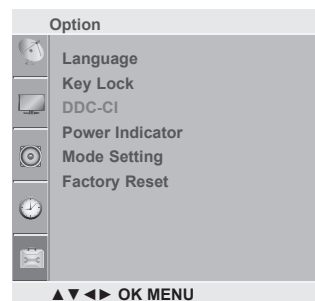

1

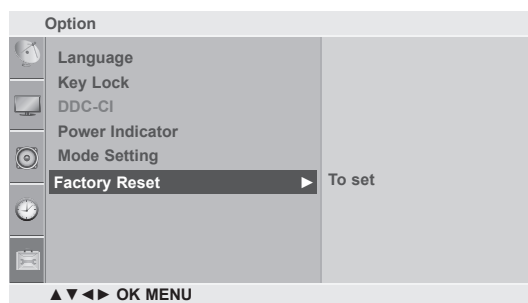

2

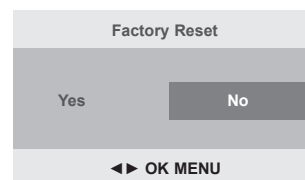

3

TELETEXT

This feature is not available in all countries.

Teletext is a free service broadcast by most SET stations which gives up-to-the-minute information on news, weather, television programmes, share prices and many other topics.

The teletext decoder of this SET can support the SIMPLE, TOP and FASTEXT systems. SIMPLE (standard teletext) consists of a number of pages which are selected by directly entering the corresponding page number. TOP and FASTEXT are more modern methods allowing quick and easy selection of teletext information.

SWITCH ON/OFF

Press the **TEXT** button to switch to teletext. The initial page or last page viewed appears on the screen.

Two page numbers, SET station name, date and time are displayed on the screen headline. The first page number indicates your selection, while the second shows the current page displayed.

Press the **TEXT** button to switch off teletext. The previous mode reappears.



SIMPLE TEXT

Page selection

- 1 Enter the desired page number as a three digit number with the NUMBER buttons. If during selection you press a wrong number, you must complete the three digit number and then re-enter the correct page number.
- 2 The ▲ / ▼ button can be used to select the preceding or following page.

Programming a colour button in LIST mode

If the SET is in SIMPLE text, TOP text or FASTEXT mode, press the **≡M** button to switch to LIST mode.

Four teletext page numbers of your choice can be colour coded and easily selected by pressing the corresponding coloured button on the remote control handset.

- 1 Press a coloured button.
- 2 Using the NUMBER buttons, select the page you wish to programme.
- 3 Press the OK button. The selected page is stored as the selected page number, blinking once to confirm this. From now on, you can select this page with the same coloured button.
- 4 The three other coloured buttons are programmed in this way.

SWITCH ON/OFF

The user guide displays four fields-red, green, yellow and blue at the bottom of the screen. The yellow field denotes the next group and the blue field indicates the next block.

■ Block / group / page selection

- ① With the blue button you can progress from block to block.
- ② Use the yellow button to proceed to the next group with automatic overflow to the next block.
- ③ With the green button you can proceed to the next existing page with automatic overflow to the next group.
Alternatively the ▲ button can be used.
- ④ The red button return to the previous selection. Alternatively the ▼ button can be used.

■ Direct page selection

As with SIMPLE teletext mode, you can select a page by entering it as a three digit number using the NUMBER buttons in TOP mode.

FASTEXT

The teletext pages are colour coded along the bottom of the screen and are selected by pressing the corresponding coloured button.

■ Page selection

- ① Press the  button to select the index page.
- ② You can select the pages which are colour coded along the bottom line with corresponding coloured buttons.
- ③ As with SIMPLE teletext mode, you can select a page by entering its three digit page number with the NUMBER buttons in FASTEXT mode.
- ④ The ▲ / ▼ button can be used to select the preceding or following page.

TELETEXT

SPECIAL TELETEXT FUNCTIONS

TIME

When viewing a SET programme, press this button to display the time at the topright hand corner of the screen. Press this button again to remove the display.

In the teletext mode, press this button to select a sub page number. The sub page number is displayed at the bottom of the screen. To hold or change the sub page, press the RED / GREEN, ▲ / ▼ or NUMBER buttons.

Press again to exit this function.

SIZE

Selects double height text.

Press this button to enlarge the top half of the page.

Press this button again to enlarge the bottom half of the page.

Press this button again to return to the normal display.

UPDATE

Displays the SET picture on the screen while waiting for a new teletext page. The display will appear at the top left hand corner of the screen. When the updated page is available then display will change to the page number. Press this button again to view the updated teletext page.

REVEAL

Press this button to display concealed information, such as solutions to riddles or puzzles.

Press this button again to remove the information from the display.

INDEX

Select the each index page.

HOLD

Stops the automatic page change which will occur if a teletext page consists of 2 or more sub pages. The number of sub pages and the sub page displayed is, usually, shown on the screen below the time. When this button is pressed the stop symbol is displayed at the top left-hand corner of the screen and the automatic page change is inactive. To continue press this button again.

MIX

Displays the teletext pages superimposed on the SET picture.

To switch the SET picture off press this button again.

APPENDIX

TROUBLESHOOTING

The SET does not operate properly

The remote control does not work	<ul style="list-style-type: none">■ Check to see if there is any object between the SET and the remote control causing an obstruction.■ Are batteries installed with correct polarity (+ to +, - to -)?■ Install new batteries.
Power is suddenly turned Off	<ul style="list-style-type: none">■ Is the sleep timer set?■ Check the power control settings. Has the Power supply been interrupted.■ The SET goes into Standby mode automatically if no signal is received and no operation is performed for 15 minutes.

The Video function is not working

No picture & No sound	<ul style="list-style-type: none">■ Check whether the SET is switched on.■ Try another channel. The problem may be with the broadcast.■ Is the power cord inserted correctly into the mains?■ Check your antenna direction and/or location.■ Test the mains outlet by plugging another SET into the same outlet.
Picture appears slowly after switching on	<ul style="list-style-type: none">■ This is normal, the image is muted during the SET startup process. Please contact your service center, if the picture has not appeared after five minutes.
No or poor colour or poor picture	<ul style="list-style-type: none">■ Adjust Colour in menu option.■ Allow a sufficient distance between the SET and the VCR.■ Try another channel. The problem may be with the broadcast.■ Are the video cables installed properly?■ Activate any function to restore the brightness of the picture.
Horizontal/vertical bars or picture shaking	<ul style="list-style-type: none">■ Check for local interference such as an electrical appliance or power tool.
Poor reception on some channels	<ul style="list-style-type: none">■ Station or cable channel experiencing problems, tune to another station.■ Station signal is weak, reposition the antenna to receive weaker stations.■ Check for sources of possible interference.
Lines or streaks in pictures	<ul style="list-style-type: none">■ Check antenna (Change the position of the antenna).

APPENDIX

TROUBLESHOOTING

The Audio function is not working

Picture OK & No sound	<ul style="list-style-type: none">■ Press the VOL ◀ or ▶ (or - ▲ +) button.■ Sound muted? Press MUTE button.■ Try another channel. The problem may be with the broadcast.■ Are the audio cables installed properly?
No output from one of the speakers	<ul style="list-style-type: none">■ Adjust Balance in menu option.
Unusual sound from inside the TV	<ul style="list-style-type: none">■ A change in ambient humidity or temperature may result in an unusual noise when the TV is switched on or off and does not indicate a fault with the TV.
Picture ok & No sound	<ul style="list-style-type: none">■ Check whether volume is "0".■ Check sound muted.■ HDMI cable installed properly.■ Head phone cable installed properly.■ Check sound format. Not supply to bitstream and compressed sound format.

NO image appear.

Do you see an "OUT OF RANGE" message on the screen?	<ul style="list-style-type: none">■ This message appears when the signal from the PC(video card) is out off horizontal or vertical frequency range of the display. See the 'Product Specifications' section of this manual and configure you display again.
--	---

MAINTENANCE

Early malfunctions can be prevented. Careful and regular cleaning can prolong the life of your new SET.

Caution : Be sure to switch the power off and unplug the power cord before you begin any cleaning.

Cleaning the Screen

- ① A good way to keep the dust off your screen for a while is to wet a soft cloth in a mixture of lukewarm water and a little fabric softener or dish washing detergent. Wring the cloth until it's almost dry, and then use it to wipe the screen.
- ② Ensure there is no excess water on the screen. Allow any water or dampness to evaporate before switching on.

Cleaning the Cabinet

- To remove dirt or dust, wipe the cabinet with a soft, dry, lint-free cloth.
- Do not use a wet cloth.

Extended Absence

CAUTION

- If you expect to leave your SET dormant for prolonged periods (such as a holiday), unplug the power cord to protect against possible damage from lightning or power surges.

APPENDIX

PRODUCT SPECIFICATIONS

M197WAP

LCD Panel	Screen Type	470.1 mm Wide (18.51 inch) TFT (Thin Film Transistor) LCD (Liquid Crystal Display) Panel Visible diagonal size: 470.1 mm
	Pixel Pitch	0.30 mm (H) x 0.30 mm (V)
Video Signal	Max. Resolution	1360 x 768 @ 60 Hz
	Recommended Resolution	1360 x 768 @ 60 Hz
	Horizontal Frequency	30 kHz to 61 kHz
	Vertical Frequency	56 Hz to 61 Hz
	Synchronization Type	Separate Sync
Input Connector		CVBS, TV, D-Sub Analog, HDMI, PC Audio In, component
Power	Rated Voltage	AC 100-240 V~ 50 / 60 Hz 0.6 A
	Power Consumption	On Mode : 25 W (typ.) Sleep Mode 1 W (RGB) Off Mode 0.5 W
Tilt	Tilt Range	-5° to 15°
Dimensions (Width x Height x Depth) Weight		454.7 mm x 362.8 mm x 193.2 mm (17.90 inch x 14.28 inch x 7.61 inch) 3.5 kg (7.72 lb)
Environmental conditions	Operating Temperature	10 °C to 35 °C
	Operating Humidity	20 % to 80 %
	Storage Temperature	-10 °C to 60 °C
	Storage Humidity	5 % to 90 %

- The specifications shown above may be changed without prior notice for quality improvement.

PRODUCT SPECIFICATIONS

M227WAP

LCD Panel	Screen Type	546.86 mm Wide (21.53 inch) TFT (Thin Film Transistor) LCD (Liquid Crystal Display) Panel Visible diagonal size: 546.86 mm
	Pixel Pitch	0.248 mm (H) x 0.248 mm (V)
Video Signal	Max. Resolution	1920 x 1080 @ 60 Hz
	Recommended Resolution	1920 x 1080 @ 60 Hz
	Horizontal Frequency	30 kHz to 69 kHz
	Vertical Frequency	56 Hz to 61 Hz
	Synchronization Type	Separate Sync
Input Connector		CVBS, TV, D-Sub Analog, HDMI, PC Audio In, component
Power	Rated Voltage	AC 100-240 V~ 50 / 60 Hz 0.9 A
	Power Consumption	On Mode : 45 W (typ.) Sleep Mode 1 W (RGB) Off Mode 0.5 W
Tilt	Tilt Range	-5° to 15°
Dimensions (Width x Height x Depth) Weight		519.8 mm x 400.5 mm x 193.2 mm (20.46 inch x 15.77 inch x 7.61 inch) 4.5 kg (9.92 lb)
Environmental conditions	Operating Temperature	10 °C to 35 °C
	Operating Humidity	20 % to 80 %
	Storage Temperature	-10 °C to 60 °C
	Storage Humidity	5 % to 90 %

- The specifications shown above may be changed without prior notice for quality improvement.

APPENDIX

PRODUCT SPECIFICATIONS

M237WAP

LCD Panel	Screen Type	584.2 mm Wide (23 inch) TFT (Thin Film Transistor) LCD (Liquid Crystal Display) Panel Visible diagonal size: 584.2 mm
	Pixel Pitch	0.265 mm (H) x 0.265 mm (V)
Video Signal	Max. Resolution	1920 x 1080 @ 60 Hz
	Recommended Resolution	1920 x 1080 @ 60 Hz
	Horizontal Frequency	30 kHz to 69 kHz
	Vertical Frequency	56 Hz to 61 Hz
	Synchronization Type	Separate Sync
Input Connector		CVBS, TV, D-Sub Analog, HDMI, PC Audio In, component
Power	Rated Voltage	AC 100-240 V~ 50 / 60 Hz 1.0 A
	Power Consumption	On Mode : 50 W (typ.) Sleep Mode 1 W (RGB) Off Mode 0.5 W
Tilt	Tilt Range	-5° to 15°
Dimensions (Width x Height x Depth) Weight		560.8 mm x 427 mm x 193.2 mm (20.08 inch x 16.81 inch x 7.61 inch) 5.6 kg (12.35 lb)
Environmental conditions	Operating Temperature	10 °C to 35 °C
	Operating Humidity	20 % to 80 %
	Storage Temperature	-10 °C to 60 °C
	Storage Humidity	5 % to 90 %

- The specifications shown above may be changed without prior notice for quality improvement.

PRODUCT SPECIFICATIONS

M2062A

LCD Panel	Screen Type	508.05 mm Wide (20 inch) TFT (Thin Film Transistor) LCD (Liquid Crystal Display) Panel Visible diagonal size: 508.05 mm
	Pixel Pitch	0.2766 mm (H) x 0.2766 mm (V)
Video Signal	Max. Resolution	1600 x 900 @ 60 Hz
	Recommended Resolution	1600 x 900 @ 60 Hz
	Horizontal Frequency	30 kHz to 69 kHz
	Vertical Frequency	56 Hz to 61 Hz
	Synchronization Type	Separate Sync
Input Connector		CVBS, TV, D-Sub Analog, HDMI, PC Audio In, component
Power	Rated Voltage	AC 100-240 V~ 50 / 60 Hz 0.9 A
	Power Consumption	On Mode : 42W (typ.) Sleep Mode 1 W (RGB) Off Mode 0.5 W
Tilt	Tilt Range	-5° to 15°
Dimensions (Width x Height x Depth) Weight		482.3 mm x 384.2 mm x 221.6 mm (18.98 inch x 15.12 inch x 8.72 inch) 4.6 kg (10.14 lb)
Environmental conditions	Operating Temperature	10 °C to 35 °C
	Operating Humidity	20 % to 80 %
	Storage Temperature	-10 °C to 60 °C
	Storage Humidity	5 % to 90 %

- The specifications shown above may be changed without prior notice for quality improvement.

APPENDIX

PRODUCT SPECIFICATIONS

M2262A

LCD Panel	Screen Type	546.86 mm Wide (21.53 inch) TFT (Thin Film Transistor) LCD (Liquid Crystal Display) Panel Visible diagonal size: 546.86 mm
	Pixel Pitch	0.248 mm (H) x 0.248 mm (V)
Video Signal	Max. Resolution	1920 x 1080 @ 60 Hz
	Recommended Resolution	1920 x 1080 @ 60 Hz
	Horizontal Frequency	30 kHz to 69 kHz
	Vertical Frequency	56 Hz to 61 Hz
	Synchronization Type	Separate Sync
Input Connector		CVBS, TV, D-Sub Analog, HDMI, PC Audio In, component
Power	Rated Voltage	AC 100-240 V~ 50 / 60 Hz 1.2 A
	Power Consumption	On Mode : 45 W (typ.) Sleep Mode 1 W (RGB) Off Mode 0.5 W
Tilt	Tilt Range	-5° to 15°
Dimensions (Width x Height x Depth) Weight		517.2 mm x 399.8 mm x 221.6 mm (20.36 inch x 15.74 inch x 8.72 inch) 4.7 kg (10.36 lb)
Environmental conditions	Operating Temperature Operating Humidity	10 °C to 35 °C 20 % to 80 %
	Storage Temperature Storage Humidity	-10 °C to 60 °C 5 % to 90 %

- The specifications shown above may be changed without prior notice for quality improvement.

PRODUCT SPECIFICATIONS

M2362A

LCD Panel	Screen Type	584.2 mm Wide (23 inch) TFT (Thin Film Transistor) LCD (Liquid Crystal Display) Panel Visible diagonal size: 584.2 mm
	Pixel Pitch	0.265 mm (H) x 0.265 mm (V)
Video Signal	Max. Resolution	1920 x 1080 @ 60 Hz
	Recommended Resolution	1920 x 1080 @ 60 Hz
	Horizontal Frequency	30 kHz to 69 kHz
	Vertical Frequency	56 Hz to 61 Hz
	Synchronization Type	Separate Sync
Input Connector		CVBS, TV, D-Sub Analog, HDMI, PC Audio In, component
Power	Rated Voltage	AC 100-240 V~ 50 / 60 Hz 1.2 A
	Power Consumption	On Mode : 50 W (typ.) Sleep Mode 1 W (RGB) Off Mode 0.5 W
Tilt	Tilt Range	-5° to 15°
Dimensions (Width x Height x Depth) Weight		551.8 mm x 419.5 mm x 221.6 mm (21.72 inch x 16.51 inch x 8.72 inch) 5.2 kg (11.46 lb)
Environmental conditions	Operating Temperature Operating Humidity	10 °C to 35 °C 20 % to 80 %
	Storage Temperature Storage Humidity	-10 °C to 60 °C 5 % to 90 %

- The specifications shown above may be changed without prior notice for quality improvement.

APPENDIX

PRODUCT SPECIFICATIONS

M2762A

LCD Panel	Screen Type	686 mm Wide (27 inch) TFT (Thin Film Transistor) LCD (Liquid Crystal Display) Panel Visible diagonal size: 686 mm
	Pixel Pitch	0.3114 mm (H) x 0.3114 mm (V)
Video Signal	Max. Resolution	1920 x 1080 @ 60 Hz
	Recommended Resolution	1920 x 1080 @ 60 Hz
	Horizontal Frequency	30 kHz to 69 kHz
	Vertical Frequency	56 Hz to 61 Hz
	Synchronization Type	Separate Sync
Input Connector		CVBS, TV, D-Sub Analog, HDMI, PC Audio In, component
Power	Rated Voltage	AC 100-240 V~ 50 / 60 Hz 1.2 A
	Power Consumption	On Mode : 60 W (typ.) Sleep Mode 1 W (RGB) Off Mode 0.5 W
Tilt	Tilt Range	-5° to 15°
Swivel	Swivel Range	358°
Dimensions (Width x Height x Depth) Weight		649.1 mm x 485 mm x 210 mm (25.56 inch x 19.09 inch x 8.27 inch) 7.2 kg (15.87 lb)
Environmental conditions	Operating Temperature	10 °C to 35 °C
	Operating Humidity	20 % to 80 %
	Storage Temperature	-10 °C to 60 °C
	Storage Humidity	5 % to 90 %

- The specifications shown above may be changed without prior notice for quality improvement.



Make sure to read the Safety Precautions before using the product.
Keep the Owner's Manual (CD) in an accessible place for future reference.
The model and serial number of the SET is located on the back and one side of the SET.
Record it below should you ever need service.

MODEL _____

SERIAL _____