



ENGLISH

# OWNER'S MANUAL

## Portable DVD Player

Please read this manual carefully before operating your set and retain it for future reference.

DP670D  
DP671D

P/NO : MFL67007231

## Safety Information



**CAUTION:** TO REDUCE THE RISK OF ELECTRIC SHOCK DO NOT REMOVE COVER (OR BACK) NO USER-SERVICEABLE PARTS INSIDE REFER SERVICING TO QUALIFIED SERVICE PERSONNEL.



This lightning flash with arrowhead symbol within an equilateral triangle is intended to alert the user to the presence of uninsulated dangerous voltage within the product's enclosure that may be of sufficient magnitude to constitute a risk of electric shock to persons.



The exclamation point within an equilateral triangle is intended to alert the user to the presence of important operating and maintenance (servicing) instructions in the literature accompanying the product.

**WARNING:** TO PREVENT FIRE OR ELECTRIC SHOCK HAZARD, DO NOT EXPOSE THIS PRODUCT TO RAIN OR MOISTURE.

**WARNING:** Do not install this equipment in a confined space such as a book case or similar unit.

**CAUTION:** Do not block any ventilation openings. Install in accordance with the manufacturer's instructions.

Slots and openings in the cabinet are provided for ventilation and to ensure reliable operation of the product and to protect it from over heating. The openings shall be never be blocked by placing the product on a bed, sofa, rug or other similar surface. This product shall not be placed in a built-in installation such as a bookcase or rack unless proper ventilation is provided or the manufacturer's instruction has been adhered to.

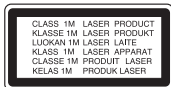

**CAUTION:** This product employs a Laser System. To ensure proper use of this product, please read this owner's manual carefully and retain it for future reference. Shall the unit require maintenance, contact an authorized service center.

Use of controls, adjustments or the performance of procedures other than those specified herein may result in hazardous radiation exposure.

To prevent direct exposure to laser beam, do not try to open the enclosure. Visible laser radiation when open. DO NOT STARE INTO BEAM.

### CAUTION concerning the Power Cord

Most appliances recommend they be placed upon a dedicated circuit;

That is, a single outlet circuit which powers only that appliance and has no additional outlets or branch circuits. Check the specification page of this owner's manual to be certain. Do not overload wall outlets. Overloaded wall outlets, loose or damaged wall outlets, extension cords, frayed power cords, or damaged or cracked wire insulation are dangerous. Any of these conditions could result in electric shock or fire. Periodically examine the cord of your appliance, and if its appearance indicates damage or deterioration, unplug it, discontinue use of the appliance, and have the cord replaced with an exact replacement part by an authorized service center. Protect the power cord from physical or mechanical abuse, such as being twisted, kinked, pinched, closed in a door, or walked upon. Pay particular attention to plugs, wall outlets, and the point where the cord exits the appliance. To disconnect power from the mains, pull out the mains cord plug. When installing the product, ensure that the plug is easily accessible.

This device is equipped with a portable battery or accumulator.

### Safety way to remove the battery or the battery from the equipment:

Remove the old battery or battery pack, follow the steps in reverse order than the assembly. To prevent contamination of the environment and bring on possible threat to human and animal health, the old battery or the battery put it in the appropriate container at designated collection points. Do not dispose of batteries or battery together with other waste. It is recommended that you use local, free reimbursement systems batteries and accumulators. The battery shall not be exposed to excessive heat such as sunshine, fire or the like.

**CAUTION:**

- The apparatus should not be exposed to water (dripping or splashing) and no objects filled with liquids, such as vases, should be placed on the apparatus.
- Minimum distances around the apparatus for sufficient ventilation, no less than 5 cm.
- The ventilation should not be impeded by covering the ventilation openings with items, such as newspapers, table-cloth, curtains etc.
- No naked flame sources, such as lighted candles, should be placed on the apparatus.
- Internal lithium battery in the unit should not be replaced by user because of danger of explosion if battery is incorrectly replaced, and must be replaced with the same type battery by expert.
- Use the apparatus in tropical and moderate climates only.
- The excessive sound pressure from earphones and headphones can cause hearing loss.

**Caution of usage in the car**

- To prevent electrical shock and possible damage to your unit or vehicle, always unplug the automotive adapter from the cigarette lighter socket before you remove the plug from your unit.
- A 3 amp. 250 V fuse for protection is installed in the automotive adapter.
- While the engine is being started, disconnect the automotive adapter from the car's cigarette lighter socket.
- Do not operate your unit when the car battery is discharged. Peak current from the car generator may cause the DC fuse to blow.
- If the vehicle's supply voltage drops below approximately 10 volts, your unit may not work properly.
- Do not leave your unit in a place where the temperature exceeds 45 °C (113 °F), or the pick-up device may be damaged.

**Disposal of your old appliance**

1. When this crossed-out wheeled bin symbol is attached to a product it means the product is covered by the European Directive 2002/96/EC.
2. All electrical and electronic products should be disposed of separately from the municipal waste stream via designated collection facilities appointed by the government or the local authorities.
3. The correct disposal of your old appliance will help prevent potential negative consequences for the environment and human health.
4. For more detailed information about disposal of your old appliance, please contact your city office, waste disposal service or the shop where you purchased the product.

**CE** LG Electronics hereby declares that this/ these product(s) is/are in compliance with the essential requirements and other relevant provisions of Directive 2004/108/EC, 2006/95/EC, and 2009/125/EC.

European representative: LG Electronics Service Europe B.V. Veluwezoom 15, 1327 AE Almere. The Netherlands (Tel : +31-(0)36-547-8888)

### Notes on Copyrights

- This product incorporates copyright protection technology that is protected by U.S. patents and other intellectual property rights. Use of this copyright protection technology must be authorized by Rovi Corporation, and is intended for home and other limited viewing uses only unless otherwise authorized by Rovi Corporation. Reverse engineering or disassembly is prohibited.
- Under the U.S. Copyright laws and Copyright laws of other countries, unauthorized recording, use, display, distribution, or revision of television programs, videotapes, DVDs, CDs and other materials may subject you to civil and/or criminal liability.

### Notes on Discs

- Do not touch the playback side of the disc. Hold the disc by the edges so that fingerprints do not get on the surface. Never stick paper or tape on the disc.
- After playing, store the disc in its case. Do not expose the disc to direct sunlight or sources of heat and never leave it in a parked car exposed to direct sunlight.

### Notes on the Unit

- Please save the original shipping carton and packing materials. If you need to ship the unit, for maximum protection, re-pack the unit as it was originally packed at the factory.
- To clean the unit, use a soft, dry cloth. If the surfaces are extremely dirty, use a soft cloth lightly moistened with a mild detergent solution. Do not use strong solvents such as alcohol, benzene, or thinner, as these might damage the surface of the unit.
- The unit is a high-tech, precision device. If the optical pick-up lens and disc drive parts are dirty or worn, the picture quality could be diminished. For details, please contact your nearest authorized service center.

# Table of Contents

## 1 Getting Started

- 2 Safety Information
- 6 Introduction
  - 6 – About the “Q” Symbol Display
  - 6 – Symbols Used in this Manual
  - 6 – Regional Code
  - 6 – Playable Discs
  - 7 – File compatibility
- 8 Main Unit
- 9 Remote control
  - 9 – Battery Installation
- 10 Supplied Accessories
- 10 Unfolding the LCD panel
- 10 Rechargeable battery

## 2 Connecting

- 11 Connecting the AC Adaptor
- 11 Connecting the Automotive Adaptor
- 11 Connecting Audio and Video cable
- 11 Connecting the TV Antenna

## 3 System Setting

- 12 Settings
  - 12 – Adjust the Setup Settings
  - 12 – [LANGUAGE] Menu
  - 12 – [DISPLAY] Menu
  - 13 – [AUDIO] Menu
  - 13 – [LOCK] Menu
  - 13 – [OTHERS] Menu

## 4 Operating

- 14 Viewing a TV Channel
- 15 General Playback
  - 15 – Selecting an operating mode
  - 15 – Playing a Disc
  - 15 – Playing a file
  - 15 – On-Screen display
- 16 – General operation
- 16 Advanced Playback
  - 16 – Movie
  - 17 – Music
  - 18 – Photo

## 5 Troubleshooting

- 19 Troubleshooting

## 6 Appendix

- 20 Area Code List
- 21 Language Code List
- 22 Specifications
- 22 Trademarks and Licenses

1

2

3

4

5

6





## Introduction

### About the “⊘” Symbol Display

“⊘” may appear on the screen during operation and indicates that the function explained in this owner's manual is not available on that specific media.

### Symbols Used in this Manual







A section whose title has one of the following symbols are applicable only to the disc or file represented by the symbol.

	DVD-Video, DVD±R/RW
	Audio CDs
	Video files contained in the USB/Disc
	Audio files contained in the USB/Disc
	Photo files contained in the USB/Disc

### Regional Code

This unit has a regional code printed on the rear of the unit. This unit can play only DVD disc labelled same as the rear of the unit or “ALL”.

### Playable Discs

	DVD-VIDEO (8 cm / 12 cm disc) Discs such as movies that can be purchased or rented.
	DVD±R (8 cm / 12 cm disc) - Video mode and finalized only - Supports the dual layer disc also
	- DVD±R discs that contain Video, Audio or Photo files.
	DVD-RW (8 cm / 12 cm disc) - VR mode, Video mode and finalized only - DVD-RW discs that contain Video, Audio or Photo files.
	DVD+RW (8 cm / 12 cm disc) - Video mode and finalized only - DVD+RW discs that contain Video, Audio or Photo files.
	Audio CD (8 cm / 12 cm disc)
	CD-R/RW (8 cm / 12 cm disc) - CD-R/RW discs that contain audio titles, Video, Audio or Photo files.



#### Note

You have to set the disc format option to [Mastered] in order to make the discs compatible with the players when formatting rewritable discs. When setting the option to Live System, you cannot use it on player. (Mastered/Live File System: Disc format system for windows Vista)

## File compatibility

### Overall

**Available File extensions:** ".avi", ".mpg", ".mpeg", ".mp3", ".wma", ".jpg"

- The file name is limited to 20 characters.
- Depending on the size and number of the files, it may take several minutes to read the contents on the media.

**Maximum Files/Folder:** Less than 600 (total number of files and folders)

**CD-R/RW, DVD±R/RW Format:** ISO 9660

### Video Files

**Available resolution size:** 720 x 576 (W x H) pixels

**Playable subtitle:** SubRip (.srt/.txt), SAMI (.smi), SubStation Alpha (.ssa/.txt), MicroDVD (.sub/.txt), VobSub (.Sub), SubViewer 2.0 (.sub/.txt), TMPlayer (.txt), DVD Subtitle System (.txt)

**Playable Codec format:** "DIVX3.xx", "DIVX4.xx", "DIVX5.xx", "MP43", "3IVX", "DIVX6.xx (playback only)"

**Playable Audio format:** "Dolby Digital", "PCM", "MP3", "WMA"

**Sampling frequency:** within 8 to 48 kHz (MP3), within 32 to 48 kHz (WMA)

**Bit rate:** within 8 to 320 kbps (MP3), within 32 to 192 kbps (WMA), less than 4 Mbps (DivX file)

### ! Note

This unit does not support files that are recorded with GMC<sup>\*1</sup> or Qpel<sup>\*2</sup>. Those are video encoding techniques in MPEG4 standard, like DivX have.

\*1 GMC – Global Motion Compensation

\*2 Qpel – Quarter pixel

### Audio Files

**Sampling frequency:** within 8 to 48KHz (MP3), within 32 to 48KHz (WMA)

**Bit rate:** within 8 to 320 kbps (MP3), within 32 to 192 kbps (WMA)

## Photo Files

**Photo size:** Less than 2M recommended.

- Progressive and lossless compression photo image files are not supported.

### ! Note of USB Device

- Do not extract the USB device during operation (play, etc.).
- A USB device which requires additional program installation when you have connected it to a computer, is not supported.
- USB device: USB device that supports USB1.1 and USB2.0.
- Movie, music and photo files can be played. For details of operations on each file, refer to relevant pages.
- Regular back up is recommended to prevent data loss.
- If you use a USB extension cable, USB HUB or USB Multi-reader, the USB device may not be recognized.
- Some USB device may not work with this unit.
- Digital camera and mobile phone are not supported.
- USB Port of the unit cannot be connected to PC. The unit cannot be used as a storage device.

## Main Unit

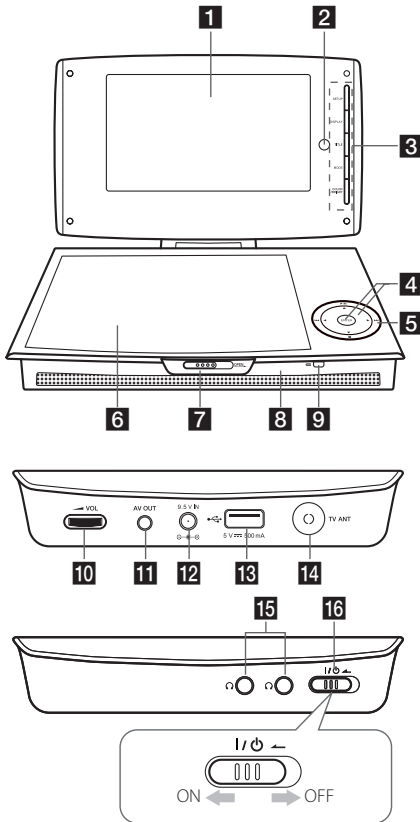

### 1 LCD screen

- 2 Remote sensor:** Point the remote control here. To control the unit using the remote control, do not fold the LCD panel down.

### 3 Function buttons

- **SETUP:** Accesses or exits the setup menu.
- **DISPLAY:** Accesses On-Screen Display.
- **TITLE:** Displays the DVD title menu, if available.
- **MODE:** Selects a operation mode among [DISC], [USB] and [TV].

- **COLOR/BRIGHT:** Press to display the Brightness or Color menu for LCD display. To adjust the color or brightness of the LCD display, press COLOR/ BRIGHT repeatedly on the main unit to display the Brightness or Color menu then use ◀/▶ to adjust the value. Press ENTER to confirm the adjustment.

### 4 Menu control buttons

- **▲/▼/◀/▶:** Use to select an item in the menu.
- **ENTER:** Press to confirm menu selection.

### 5 Playback control buttons

- **▶|| (Play/Pause):** Press to start playback and pause playback temporarily, press again to exit pause mode.
- **■ (Stop):** Press to stop playback.
- **◀◀ / ▶▶ (Skip):** Goes to the next or previous chapter / track / file.

### 6 Disc lid

- 7 CD OPEN:** Use the slide open key to open the disc lid.

### 8 Speakers

### 9 Battery charge and power indicator

- The indicator turns red in charging and it will be turned into green when the charging is complete. (Refer to page 10 for details.)
- The indicator turns green for a moment when the unit is turned on.

- 10 VOL (Volume):** Adjusts the volume level of the built-in speaker and earphones.

- 11 AV OUT:** Connect to a TV with video and audio input.

- 12 DC 9.5V IN:** Connect the AC adapter or automotive adapter.

- 13 USB Port:** Connect a USB Flash Drive.

- 14 TV Antenna connector**

- 15 (Earphones):** Connect earphones here.

- 16 I/⏻ (Power):** Switches the unit ON or OFF.



# Remote control

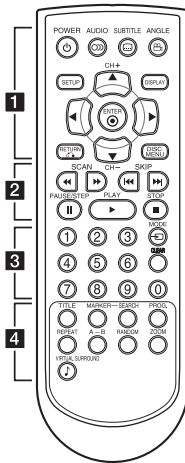

## 1

**POWER** (⏻): Switches the unit ON or OFF.

**AUDIO** (🔊): Selects an audio language or audio channel.

**SUBTITLE** (📄): Selects a subtitle language.

**ANGLE** (📷): Selects a DVD camera angle, if available.

**SETUP**: Accesses or exits the setup menu.

**DISPLAY**: Displays or exits On-Screen Display.

**▲/▼/◀/▶**: Navigates the menus.

**ENTER** (⊙): Confirms menu selection.

**CH (+/-)**: Scans up or down through memorized channels in TV mode.

**RETURN** (↩): Moves backward or exits the menu.

**DISC MENU**: Accesses or exits the DVD menu.

## 2

**SCAN** (◀◀/▶▶): Searches backward or forward.

**SKIP** (◀◀◀/▶▶▶): Goes to the next or previous chapter / track / file.

**PAUSE/STEP** (⏸): Pauses playback.

**PLAY** (▶): Starts playback.

**STOP** (■): Stops playback.

## 3

**Numerical buttons (0-9)**: Selects numbered items in a menu.

**MODE**: Switches a operation mode (DISC, TV or USB).

**CLEAR**: Removes a track number on the Program List.

## 4

**TITLE**: Accesses the disc's title menu in disc mode, if available.

**MARKER**: Marks any point during playback.

**SEARCH**: Displays or exits the search menu.

**PROG.:** Enters the program edit mode.

**REPEAT**: Repeats a chapter, track, title or all.

**A-B**: Repeats a section.

**RANDOM**: Plays tracks in random order.

**ZOOM**: Enlarges video image.

**VIRTUAL SURROUND** (🔊): Applies the various sound effects.

## Battery Installation

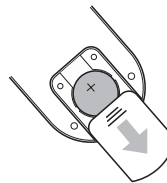

Remove the battery cover on the rear of the Remote Control, and insert the battery with the + facing in the same direction as the + on the battery compartment.

- Replace Remote Control's battery with 3 V micro lithium cells such as CR-2025 or its equivalent.
- Dispose of battery safely in accordance with local laws. Do not dispose of in fire.

### Warning

The battery used in this device may present a fire or chemical burn hazard if mistreated. Do not recharge, disassemble, incinerate, or heat above 100 °C (212 °F).

Replace the battery with Matsushita Elec. Ind. Co., Ltd. (Panasonic), part no. CR-2025 only. Use of another battery may present a risk of fire or explosion. Dispose of used batteries. Keep batteries away from children. Do not disassemble or dispose of in fire.

## Supplied Accessories

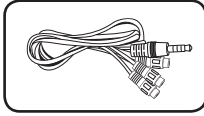

RCA Video/Audio  
Adaptor (1)

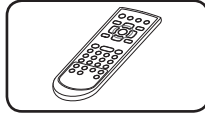

Remote control (1)

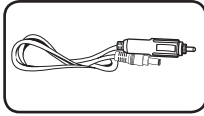

Automotive Adaptor (1)

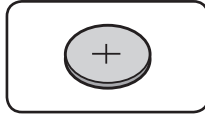

Battery for Remote  
Control (Lithium  
Battery) (1)

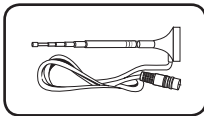

Antenna (1)

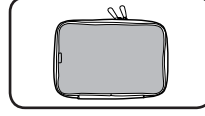

Carrying Bag (1)

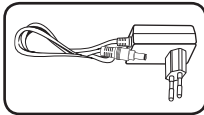

AC Adaptor (MPA-20P)  
(1)

- The actual AC Adaptor may differ from the drawing.

## Rechargeable battery

- The internal rechargeable battery provides you with the freedom to pass it around and play the files without the power cord.
- The internal rechargeable battery will start charging only when the unit is turned off and the AC adaptor is connected to a power outlet.
- The charging stops if you turn on the unit.
- The charging will take approximately 2 hours and 30 minutes.
- Operating time on battery: approximately 4 hours and 30 minutes. The operating time on battery may vary depending on the battery status, operational status and environment conditions, and the maximum playing time is possible up to 5 hours.
- When the remaining time of the battery power is under a few minutes, "⚠ Check Battery" will blink on the screen.

## Unfolding the LCD panel

To unfold the LCD panel, place the unit on a stable and even surface such as on a table.

- When finished using the unit, return the LCD panel to its original position.
- Do not leave the LCD panel in the face-up position, or sudden shocks may damage it.

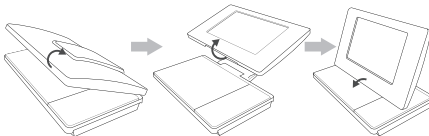

## Connecting the AC Adaptor

Connect the unit to the power supply with the supplied AC Adaptor.

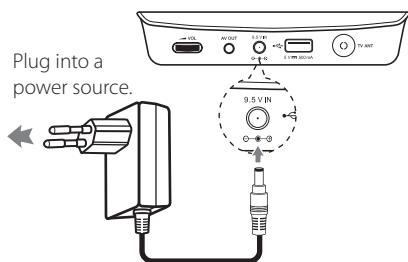

- Contact an electrical parts distributor for assistance in selecting a suitable AC plug adaptor or AC cord set.
- This AC adaptor is manufactured by NANJING WANLIDA TECHNOLOGY CO., LTD.

## Connecting the Automotive Adaptor

Connect the unit to the Cigarette lighter socket with the supplied Automotive Adaptor.

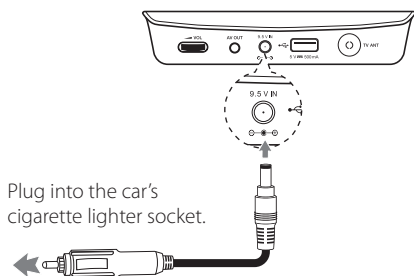

- Contact an electrical parts distributor for assistance in selecting a suitable Automotive Adaptor.
- This Automotive Adaptor is manufactured by NANJING WANLIDA TECHNOLOGY CO., LTD.

## Connecting Audio and Video cable

Connect the AV OUT on the unit to AV cable connected from TV with the supplied AV Adaptor.

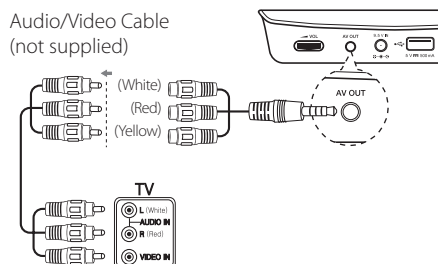

### ! Note

The signal does not come out from AV OUT jack when the unit is set to [TV] mode.

## Connecting the TV Antenna

For TV viewing, connect the TV antenna to the TV ANT jack on the unit as shown below.

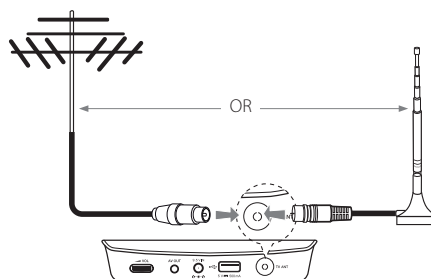

# Settings

When the unit is turned-on at the first time, you have to select the desired language. (optional)

## Adjust the Setup Settings

You can change the settings of the unit in the [Setup] menu.

1. Press SETUP.
2. Use ▲/▼ to select the first setup option, and press ► to move to the second level.
3. Use ▲/▼ to select a second setup option, and press ► to move to the third level.
4. Use ▲/▼ to select a desired setting, and press ENTER (⊙) to confirm your selection.

## [LANGUAGE] Menu

### Menu Language

Select a language for the Setup menu and on-screen display.

### Disc Audio/Subtitle/Menu

Select a language for the Disc Audio/Subtitle/Menu.

**[Original]:** Refers to the original language in which the disc was recorded.

**[Other]:** To select another language, press number buttons then ENTER (⊙) to enter the corresponding 4-digit number according to the language code list. (See page 21) If you make a mistake while entering number, press CLEAR to delete numbers then correct it.

**[Off]**(for Disc Subtitle): Turn off Subtitle.

## [DISPLAY] Menu

### TV Aspect

Select which screen aspect to use based on the shape of your TV screen.

**[4:3]:** Select when a standard 4:3 TV is connected.

**[16:9]:** Select when a 16:9 wide TV is connected.

### Display Mode

If you selected 4:3, you'll need to define how you would like widescreen programs and films to be displayed on your TV screen.

**[Letterbox]:** This displays a widescreen picture with black bands at the top and bottom of the screen.

**[Panscan]:** This fills the entire 4:3 screen, cropping the picture as necessary.

## [AUDIO] Menu

### DRC (Dynamic Range Control)

Make the sound clear when the volume is turned down (Dolby Digital only). Set to [On] for this effect.

### Vocal

Set to [On] only when a multi-channel karaoke DVD is playing. The karaoke channels on the disc mix into normal stereo sound.

## [LOCK] Menu

Firstly, you have to create the 4-digit password on [Area Code] to use the LOCK menu.



### Note

If you forget your password you can reset it. First, remove the disc in the unit. Display setup menu then input the 6-digit number "210499". The password is deleted.

### Rating

Select a rating level. The lower the level, the stricter the rating. Select [Unlock] to deactivate the rating.

### Password

Sets or changes the password for lock settings.

### Area Code

To input the standardized area code referring the Area Code List on page 20.

## [OTHERS] Menu

### REC Bitrate

You can choose a bit rate for USB Direct Recording. Higher bit rate gives the better sound quality but uses more space on the USB Flash Drive. For USB Direct Recording, see page 17.

### DivX(R) VOD

ABOUT DIVX VIDEO: DivX® is a digital video format created by DivX, Inc. This is an official DivX Certified® device that plays DivX video. Visit [www.divx.com](http://www.divx.com) for more information and software tools to convert your files into DivX video.

ABOUT DIVX VIDEO-ON-DEMAND: This DivX Certified® device must be registered in order to play purchased DivX Video-on-Demand (VOD) movies. To obtain your registration code, locate the DivX VOD section in your device setup menu. Go to vod.  
[divx.com](http://divx.com) for more information on how to complete your registration.

#### [Register]

Displays the registration code of your player.

#### [Deregister]

Deactivate your player and display the deactivation code.

## Viewing a TV Channel

### Auto Tuning

Automatically finds all channels available through the 'Antenna In' source and stores all the active channels found.

Select "Auto Tuning" option then press ENTER (Ⓢ) to start auto tuning.

1. Select [TV] mode using MODE button.
2. Press SETUP to display [TV SETUP] menu.
3. Select [CH. SYSTEM], and press ►.
4. Select a TV System (PAL B/G, PAL/I, PAL D/K or SECAM B/G, SECAM D/K)
5. Select [AUTO SCAN], and press ►.
6. When [START] is highlighted, press ENTER (Ⓢ) to start auto tuning.

### Manual Tuning

You can edit a channel using [Manual Tuning] option in the [TV SETUP] menu.

1. Select [TV] mode using MODE button.
2. Press SETUP to display [TV SETUP] menu.
3. Select [CHANNELS], and press ►.
5. When [START] is highlighted, press ENTER (Ⓢ) to display [Manual Tuning] menu.
4. Use ▲/▼ to select a menu and use ◀/▶ to select a value of the item to be set.
  - [CH. No]: Selects a channel number.
  - [Fine]: Selects a frequency to obtain a clear picture.
  - [Band]: Selects a channel band. (VHF H, VHF L or UHF)
  - [Skip]: Sets the channel to the skipped channel. The channel cannot be selected using the CH +/- button during TV viewing.
  - [Manual]: Searches for a channel automatically. Searching stops when the unit tunes in a channel.

### Channel Selection

You can select channels as described below.

If the TV channel is not set, use [AUTO SCAN] option in [TV SETUP] menu.

- Use CH +/- to select a channel through the channels in memory.
- Use number (0-9) buttons to select a channel directly.
- Press RETURN (↵) to return to the previous channel you viewed.

### Note

#### Notes on the TV receiving signal

If the TV receiving signal is poor, it may appear following symptoms.

- Screen is shaken.
- Faded in double or triple.
- Field gets bad gradually.
- Color appears or disappears.
- Screen is spotted.
- Stripes appear.
- Sound of noise is occurred.

It may not receive TV receiving signals as following.

- Between Buildings
- At an airplane or a train passing nearby
- A power cable nearby
- In the mountain or forest
- A automobile, A motorcycle
- A high tension wire

# General Playback

## Selecting an operating mode

You must select one of the operating modes before operating.

1. Press MODE.
2. Use ◀/▶ to select a option then press ENTER

**DISC:** You should select the Disc mode before using playback functions or disc setup setting.

**TV:** You should select the TV mode before watching TV channel or using TV setup setting.

**USB:** You should select the [USB] mode before using the USB device.

## Playing a Disc

### DVD ACD

1. Turn on the Power Switch.
2. Open the disc lid and insert a disc.
3. Close the disc lid.

For the most DVD-ROM discs, playback starts automatically.

For the Audio CD, select a track using ▲/▼/◀/▶, and press PLAY (▶) or ENTER (⊙) to play the Track.

## Playing a file

### MOVIE MUSIC PHOTO



1. Turn on the Power Switch.
2. Insert a disc, or connect the USB Flash Drive.
3. Select a file using ▲/▼/◀/▶, and press PLAY (▶) or ENTER (⊙) to play the file.

MODE	Changes among DISC, TV and USB.
TITLE	Changes the mode. (Music → Photo → Movie)

## On-Screen display DVD MOVIE

You can display and adjust various information and settings about the content.

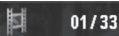
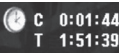
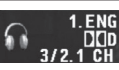
1. While playback, press DISPLAY to show various playback information.
2. Select an option using ▲/▼.
3. Use ◀/▶ and numerical button to adjust the selected option value.
4. Press RETURN (↵) to exit the On-Screen display.

	Current title number/total number of titles
	Current chapter number/total number of chapters
	Elapsed playing time Selected total time of current title/file
	Selected audio language or channel
	Selected subtitle
	Selected angle/total number of angles

## General operation

To	Do this
<b>Playback</b>	Press PLAY (▶)
<b>Pause</b>	Press PAUSE/STEP (⏸)
<b>Stop</b>	Press STOP (■)
<b>Skip to the next or previous</b>	Press ◀◀ or ▶▶ during playback
<b>Fast forward or fast reverse</b>	Press ◀◀ or ▶▶ during playback.
<b>Resume playback</b>	Press STOP (■) during playback to save the stopped point. <ul style="list-style-type: none"> <li>• Press STOP (■) once: Displayed ⏸ on the screen (Resume Stop)</li> <li>• Press STOP (■) twice: Displayed ■ on the screen (Complete Stop)</li> </ul>
<b>Playback disc or USB device with several kinds of files</b>	Select the proper menu by continuously pressing TITLE as [MUSIC], [PHOTO], and [MOVIE].
<b>Screen Saver</b>	Leave the unit in Stop mode for about five minutes, then the screen saver appears. If the Screen Saver is displayed for five minutes, the unit automatically turns itself off.
<b>Last Scene Memory</b>	Turn off the unit, then the unit memorize the lastly viewed scene even if disc is inserted again after removal or unit is turned on after off with same disc. (DVD/ Audio CD only)
<b>Virtual Surround</b>	You can enjoy the surround sound simply by selecting one of the pre-programmed sound field according to the program you want to listen to. Each time you press VIRTUAL SURROUND, the sound mode is changed as follows: (CONCERT → HALL → ARENA → Normal (default))

## Advanced Playback

### Movie DVD MOVIE

To	Do this
<b>Display disc menu</b>	Press DISC MENU. (DVD Only)
<b>Play repeatedly</b>	Press REPEAT during playback. To select an option to be repeated, Press REPEAT repeatedly. <ul style="list-style-type: none"> <li>• DVD: Chapter/ Title/ Off</li> <li>• MOVIE: Track/ All/ Off</li> </ul>
<b>Play frame-by-frame</b>	Press PAUSE/STEP (⏸) while Video file playback and press PAUSE/STEP (⏸) repeatedly to play Frame-by-Frame playback.
<b>Repeat a specific portion</b>	Press A-B at the beginning of the portion you wish to repeat and again at the end of the portion. To return to normal playback, press A-B to select [Off].
<b>Set the desired starting time of playback</b>	Searches for the starting point of entered time code. Press DISPLAY then select clock icon. Enter a time then press ENTER (⏻). For example, to find a scene at 1 hour, 10 minutes, and 20 seconds, enter "1 1020" and press ENTER (⏻). If you enter the wrong number, press CLEAR to enter again.
<b>Change the subtitle code page (Video file only)</b>	Press and hold SUBTITLE for 3 seconds during playback. The language code will appear. Press ◀/▶ to select another language code until the subtitle is displayed properly and then press ENTER (⏻).
<b>Slow down the playing speed (Forward only)</b>	While the playback is paused, press ▶▶ repeatedly to play various speeds of slow motion. Press PLAY (▶) to continue play at normal speed.



<b>Watch an enlarged video (Zoom)</b>	During playback or pause mode, press ZOOM repeatedly to select zoom mode.  ZOOM: 100% → 200% → 300% → 400% → 100% ▲/▼/◀/▶: Move through the zoomed picture.
---------------------------------------	--

Music **ACD MUSIC**

To	Do this
<b>Play repeatedly</b>	Press REPEAT during playback. To select an item to be repeated, Press REPEAT repeatedly. • TRACK / ALL
<b>Playing in random order</b>	Press RANDOM during playback. Press RANDOM again to return to normal playback.
<b>Create or delete your own program</b>	Press the PROG. to select desired file and then, <b>E</b> mark appears on screen.  Using ▲/▼ and ENTER (⊙) to add a music file(s) on the program list,  If you add desired music file(s), press PROG. to end edit program list.  To clear a music file(s) from the program list, select the music file you want to clear then press CLEAR in program edit mode.  To clear all music file(s) from the program list, select [Clear All] then press ENTER (⊙) in program edit mode.
<b>Display file information (ID3 TAG).</b>	While playing a MP3 file containing file information, you can display the information by pressing DISPLAY repeatedly.  • Depending on the MP3 files, information may not be displayed on the screen.

<b>Record the Audio CD to USB device</b>	Connect USB Flash Drive to the unit before recording.  Insert an Audio CD, and then select a track using ▲/▼, DISC MENU, or numerical buttons. <ul style="list-style-type: none"><li>• For track recording: Press AUDIO(⊞) in play, pause or resume stop mode.</li><li>• For all track recording: Press AUDIO(⊞) in complete stop mode.</li><li>• For program list recording: In stop mode, press AUDIO(⊞) after selecting a track on the program list.</li></ul>
--	---

**! Note**

- If you use this function, the "CD\_REC" folder will be created automatically in the USB Flash Driver then the music file(s) is saved in it.
- If you remove USB Flash Drive, turn off or open the unit while recording, it can make a malfunction.
- If the remaining space on the USB Flash Drive is insufficient, the recording is not available. To increase the free space, delete files in it using your PC.
- CD-G disc and Audio CDs encoded in DTS cannot be recorded.
- External HDD, Multi Card reader, Multi Partition USB, Locked device and MP3 player are not supported.
- The recording speed is fixed to X2.
- Recording format: MP3 file
- Encoding Bit rate: 96 Kbps / 128 Kbps

The making of unauthorized copies of copy-protected material, including computer programs, files, broadcasts and sound recordings, may be an infringement of copyrights and constitute a criminal offense. This equipment should not be used for such purposes.

**Be responsible  
Respect copyrights**

**Photo****PHOTO**

To	Do this
<b>View photo files as a slide show</b>	Use ▲/▼/◀/▶ to highlight (🖼️) icon then press ENTER (⏵) to start slide show.
<b>Adjust slide show speed</b>	You can change slide show speed using ◀/▶ when (🖼️) icon is highlighted.
<b>Rotate a photo</b>	Use ▲/▼ to rotate the photo in full screen counterclockwise or clockwise while viewing a photo in full screen.
<b>Watch an enlarged Photo</b>	While viewing a photo in full screen, press ZOOM repeatedly to select zoom mode.  ZOOM: 100% → 200% → 300% → 400% → 100% ▲/▼/◀/▶: Move through the zoomed photo.
<b>Listen to music during slide show</b>	You can listen to music during slide show, if the disc contain music and photo files together. Use ▲/▼/◀/▶ to highlight (🎵) icon then press ENTER (⏵) to start slide show.

# Troubleshooting

Symptom	Cause	Solution
No power	The power cord is disconnected.	Plug the power cord into the wall outlet securely.
	The battery is discharged.	Recharge the battery.
The power is on, but the unit does not work.	No disc is inserted.	Insert a disc.
The unit does not start playback.	An unplayable disc is inserted.	Insert a playable disc. (Check the disc type and regional code.)
	The rating level is set.	Change the rating level.
The remote control does not work properly.	The remote control is not pointed at the remote sensor on the unit.	Point the remote control at the remote sensor of the unit.
	The remote control is too far from the unit.	Operate the remote control closer to the unit.
Poor picture quality and sound distortion	Fingerprints and dust are stained on the disc.	Wipe the disc from the center to out with a clean cloth. Do not use strong solvents. (alcohol, benzene, thinner, commercially available cleaners)
No picture	The TV is not set to receive the signal from the unit.	Select the appropriate video input mode on the TV.
	The video cable is not connected securely.	Connect the video cable securely.
	The rating level is set.	Change the rating level.
No sound	The volume is set to minimum.	Use the volume controller to adjust the volume.
	The earphone jack is connected to the unit.	Separate the earphone jack from the unit.
	The equipment connected with the audio cable is not set to receive the signal from the unit.	Select the correct input mode of the audio amplifier.
	The AUDIO options are set to the wrong position.	Set the AUDIO settings to the correct position.

# Area Code List

Choose an area code from this list.



Area	Code	Area	Code	Area	Code	Area	Code
Afghanistan	AF	Fiji	FJ	Monaco	MC	Singapore	SG
Argentina	AR	Finland	FI	Mongolia	MN	Slovak Republic	SK
Australia	AU	France	FR	Morocco	MA	Slovenia	SI
Austria	AT	Germany	DE	Nepal	NP	South Africa	ZA
Belgium	BE	Great Britain	GB	Netherlands	NL	South Korea	KR
Bhutan	BT	Greece	GR	Antilles	AN	Spain	ES
Bolivia	BO	Greenland	GL	New Zealand	NZ	Sri Lanka	LK
Brazil	BR	Hong Kong	HK	Nigeria	NG	Sweden	SE
Cambodia	KH	Hungary	HU	Norway	NO	Switzerland	CH
Canada	CA	India	IN	Oman	OM	Taiwan	TW
Chile	CL	Indonesia	ID	Pakistan	PK	Thailand	TH
China	CN	Israel	IL	Panama	PA	Turkey	TR
Colombia	CO	Italy	IT	Paraguay	PY	Uganda	UG
Congo	CG	Jamaica	JM	Philippines	PH	Ukraine	UA
Costa Rica	CR	Japan	JP	Poland	PL	United States	US
Croatia	HR	Kenya	KE	Portugal	PT	Uruguay	UY
Czech Republic	CZ	Kuwait	KW	Romania	RO	Uzbekistan	UZ
Denmark	DK	Libya	LY	Russian Federation	RU	Vietnam	VN
Ecuador	EC	Luxembourg	LU	Saudi Arabia	SA	Zimbabwe	ZW
Egypt	EG	Malaysia	MY	Senegal	SN		
El Salvador	SV	Maldives	MV				
Ethiopia	ET	Mexico	MX				

## Language Code List

Use this list to input your desired language for the following initial settings: [Disc Audio], [Disc Subtitle] and [Disc Menu].

Language	Code	Language	Code	Language	Code	Language	Code
Afar	6565	French	7082	Lithuanian	7684	Sindhi	8368
Afrikaans	6570	Frisian	7089	Macedonian	7775	Singhalese	8373
Albanian	8381	Galician	7176	Malagasy	7771	Slovak	8375
Amharic	6577	Georgian	7565	Malay	7783	Slovenian	8376
Arabic	6582	German	6869	Malayalam	7776	Spanish	6983
Armenian	7289	Greek	6976	Maori	7773	Sudanese	8385
Assamese	6583	Greenlandic	7576	Marathi	7782	Swahili	8387
Aymara	6588	Guarani	7178	Moldavian	7779	Swedish	8386
Azerbaijani	6590	Gujarati	7185	Mongolian	7778	Tagalog	8476
Bashkir	6665	Hausa	7265	Nauru	7865	Tajik	8471
Basque	6985	Hebrew	7387	Nepali	7869	Tamil	8465
Bengali; Bangla	6678	Hindi	7273	Norwegian	7879	Telugu	8469
Bhutani	6890	Hungarian	7285	Oriya	7982	Thai	8472
Bihari	6672	Icelandic	7383	Panjabi	8065	Tonga	8479
Breton	6682	Indonesian	7378	Pashto, Pushto	8083	Turkish	8482
Bulgarian	6671	Interlingua	7365	Persian	7065	Turkmen	8475
Burmese	7789	Irish	7165	Polish	8076	Twì	8487
Byelorussian	6669	Italian	7384	Portuguese	8084	Ukrainian	8575
Chinese	9072	Japanese	7465	Quechua	8185	Urdu	8582
Croatian	7282	Kannada	7578	Rhaeto-Romance	8277	Uzbek	8590
Czech	6783	Kashmiri	7583	Rumanian	8279	Vietnamese	8673
Danish	6865	Kazakh	7575	Russian	8285	Volapük	8679
Dutch	7876	Kirghiz	7589	Samoan	8377	Welsh	6789
English	6978	Korean	7579	Sanskrit	8365	Wolof	8779
Esperanto	6979	Kurdish	7585	Scots Gaelic	7168	Xhosa	8872
Estonian	6984	Laotian	7679	Serbian	8382	Yiddish	7473
Faroese	7079	Latin	7665	Serbo-Croatian	8372	Yoruba	8979
Fiji	7074	Latvian, Lettish	7686	Shona	8378	Zulu	9085
Finnish	7073	Lingala	7678				

## Specifications

<b>Power requirements</b>	9.5 V  2 A
<b>AC adaptor requirements</b>	100 - 240 V ~ 1 A, 50/60 Hz
<b>Automotive Adaptor requirements</b>	8.5 V -16 V DC
<b>Power consumption</b>	10 W
<b>Dimensions (W x H x D)</b>	Approx. (240 x 157,7 x 44,4) mm
<b>Net Weight (Approx.)</b>	0.87 kg
<b>Operating temperature</b>	0 °C to 40 °C
<b>Operating humidity</b>	5 % to 90 %
<b>Laser</b>	Semiconductor laser
<b>Signal system</b>	PAL
<b>Bus Power Supply (USB)</b>	DC 5V  500 mA
<b>Video/Audio Out</b>	ø 3.5 mm mini jack x 1
<b>Video Out</b>	1.0 V (p-p), 75 Ω, sync negative
<b>Audio Out</b>	1.5 Vrms (1 kHz, 0 dB)
<b>Earphone terminal</b>	ø 3.5 mm stereo mini jack x 2
<b>Antenna input</b>	75 Ω (VHF/UHF)
<b>Channel coverage</b>	Analog (VHF / UHF): 1 - 125

### Liquid Crystal Display

<b>Panel size</b>	17.8 cm (diagonal)
<b>Projection system</b>	R.G.B. stripe
<b>Driving system</b>	TFT active matrix
<b>Resolution</b>	480 x 234 (WQVGA)

Design and specifications are subject to change without prior notice.

## Trademarks and Licenses



Manufactured under license from Dolby Laboratories. Dolby and the double-D symbol are trademarks of Dolby Laboratories.



"DVD Logo" is a trademark of DVD Format/Logo Licensing Corporation.



DivX®, DivX Certified® and associated logos are trademarks of DivX, Inc. and are used under license.







	Телефон	Режим работы	Интернет
Россия	8-800-200-7676	Круглосуточно	<a href="http://www.lg.com">http://www.lg.com</a>
Беларусь	8-820-0071-1111		
Латвия	8-0003-271		
Литва	8-800-30-800		
Эстония	800-9990		
Украина	0-800-303-000	8:00 - 21:00 (Пн.-Пят.) 9:00 - 18:00 (Суб., Вс.)	
Казахстан	8-8000-805-805	9:00 - 18:00 (Пн.-Пят.) 9:00 - 18:00 (Суб.)	
	2255 (для мобильных телефонов)		
Кыргызстан	8-0000-710-005	Круглосуточно	
Узбекистан			

Импортер LG Electronics RUS

Адрес импортера 143160 Российская Федерация, Московская область,  
Рузский район, сельское поселение Дороховское, 86 км. Минского шоссе, д.9

Адрес производителя : Нанджинг Ванлида Текнолоджи Ко, Лтд  
Китайская Народная республика, Фуджиан, Зангзоу,  
Нанджинг, Ванлида Индастри Зон



Сделано в Китае