



KC550 User Guide

**CE 0168**

[www.lgmobile.com](http://www.lgmobile.com)

MMBB0287923 (1.0) G

LG ELECTRONICS INC.

**KC550**

ENGLISH

Bluetooth QD ID B013915



Some of the contents in this manual may differ from your phone depending on the software of the phone or your service provider.

## KC550 User Guide

Congratulations on your purchase of the advanced and compact KC550 phone by LG, designed to operate with the latest digital mobile communication technology.

SET UP **01**

YOUR STANDBY SCREEN **02**

THE BASICS **03**

GET CREATIVE **04**

GET ORGANISED **05**

BROWSER **06**

SETTINGS **07**

ACCESSORIES **08**

# Contents

<b>01 SET UP</b>	
Getting to know your phone .....	8
Open view .....	9
Installing the SIM and battery .....	10
<b>Memory card</b> .....	<b>13</b>
Installing a memory card .....	13
Removing the memory card .....	13
Formatting the memory card .....	13
<b>Menu map</b> .....	<b>14</b>
<b>02 YOUR STANDBY SCREEN</b>	
Your standby screen .....	15
The quick keys .....	15
The main menu .....	15
The status bar .....	16
<b>03 THE BASICS</b>	
<b>Calls</b> .....	<b>17</b>
Making a call .....	17
Making a call from your contacts .....	17
Answering and rejecting a call .....	17
Adjusting the call volume .....	18
Speed dialling .....	18
Viewing your call logs .....	18
Using call divert .....	19
Using call barring .....	19
Changing the call settings .....	20
<b>Contacts</b> .....	<b>21</b>
Searching for a contact .....	21
Adding a new contact .....	21
Contact options .....	21
Adding a contact to a group .....	22
Renaming a group .....	22
Adding a picture to a contact .....	22
Copying your contacts to your SIM .....	23
Deleting all your contacts .....	23
Viewing information .....	23
<b>Messaging</b> .....	<b>24</b>
Messaging .....	24
Sending a message .....	24
Entering text .....	25
Setting up your email .....	26
Sending an email using your new account .....	27
Message folders .....	27
Managing your messages .....	28
Using templates .....	28
Changing your text message settings .....	29
Changing your multimedia message settings .....	29
Changing your email settings .....	30
Changing your other settings .....	30

04 GET CREATIVE	FM radio	41
Camera	Using the FM radio	41
Taking a quick photo	Searching for stations	41
After you've taken your photo	Resetting channels	41
Getting to know the viewfinder	Listening to the radio	41
Using the quick settings	Voice recorder	42
Using the flash	Using the voice recorder	42
Changing the image size	Recording your voice memo	42
Viewing your saved photos	Sending a voice recording	42
Setting a photo as Wallpaper	Using the muvee studio	42
or Picture ID	My stuff	43
Video camera	Images	43
Shooting a quick video	Images options menu	43
After you've shot your video	Sending a photo	44
Getting to know the viewfinder	Organising your images	44
Using the quick settings	Deleting an image	44
Watching your saved videos	Deleting multiple images	44
Adjusting the volume when	Creating a slide show	45
viewing a video	Sounds	45
MP3 player	Using a sound	45
MP3 player	Videos	45
Transferring music onto your phone	Watching a video	45
Playing a song	Using options while video is paused	46
Using options while playing music	Sending a video clip	46
Creating a playlist	Video options menu	46
Playing a playlist	Documents	47
Editing a playlist	Viewing a document	47
Deleting a playlist	Others	47

# Contents

External memory .....	47	<b>06 BROWSER</b>	
Using your phone as a mass storage device.....	47	<b>Browser</b> .....	55
Transferring a file to your phone .....	48	Accessing the web.....	55
Sending and receiving your files using Bluetooth .....	49	Adding and accessing your bookmarks.....	55
<b>Games and Apps</b> .....	50	Saving a page .....	56
Games and Apps .....	50	Accessing a saved page.....	56
Playing a game.....	50	Viewing your browser history .....	56
Viewing applications .....	50	Changing the web browser settings .....	56
Changing the network profile.....	50	<b>07 SETTINGS</b>	
M-Toy .....	50	<b>Settings</b> .....	57
<b>05 GET ORGANISED</b>		Changing your profiles .....	57
<b>Organiser</b> .....	51	Personalising your profiles.....	57
Adding an event to your calendar .....	51	Changing your date & time.....	57
Editing a calendar event.....	51	Changing the language .....	57
Sharing a calendar event.....	52	Changing your display settings .....	57
Adding a memo .....	52	Changing your security settings .....	58
<b>Tools</b> .....	53	Using flight mode.....	58
Setting your alarm .....	53	Resetting your phone .....	59
Using your calculator .....	53	Viewing memory status.....	59
Using the stopwatch .....	53	Changing your Bluetooth settings.....	59
Converting a unit .....	54	Changing your connectivity settings .....	59
Adding a city to your world clock .....	54	Pairing with another Bluetooth device .....	60
SIM services.....	54	Using a Bluetooth headset.....	60

## 08 ACCESSORIES

Accessories ..... 61

Network service..... 62

Technical data ..... 62

    General ..... 62

    Ambient Temperatures ..... 62

Guidelines for safe and efficient use ..... 64

# Getting to know your phone

**Main screen**

**Clear key** 

Deletes a character with each press. Use this key to go back to the previous screen.

**Call key** 

Dials a phone number and answers incoming calls.



**Charger, cable, handsfree connector**

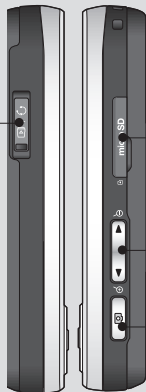

**Memory card slot**

**Volume key**

**Camera**

**End/Power key** 

Ends or rejects a call.  
Turns the phone on/off.  
Returns to the standby screen when you use the menu.

## Open view

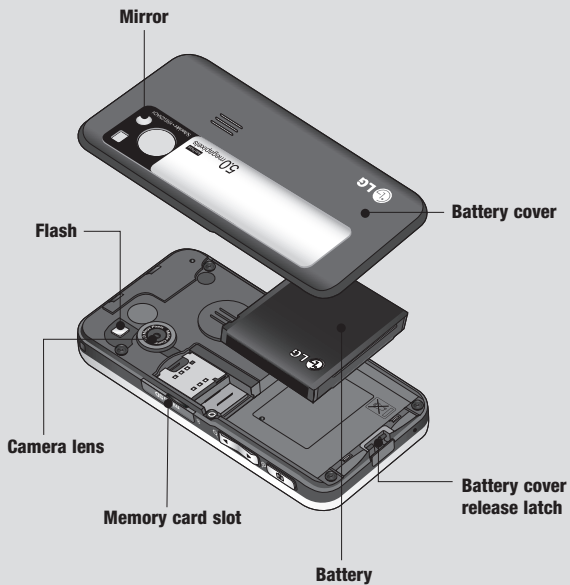

01

02

03

04

05

06

07

08

# Installing the SIM and battery

## 1 Remove the battery cover

Press the battery cover release latch. The battery cover should lift off easily.



## 2 Remove the battery

Lever the bottom edge of the battery and remove it carefully from the battery compartment.

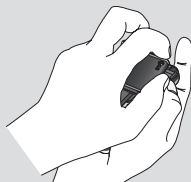

**⚠ WARNING:** Do not remove the battery when the phone is switched on, as this may damage the phone.

## 3 Install the SIM card

Slide the SIM card into the SIM card holder. Make sure that the gold contact area on the card is facing downward. To remove the SIM card, slide it gently in the opposite direction.

**⚠ WARNING:** Do not insert the SIM card when the slide is open, as this may damage your phone and SIM card.

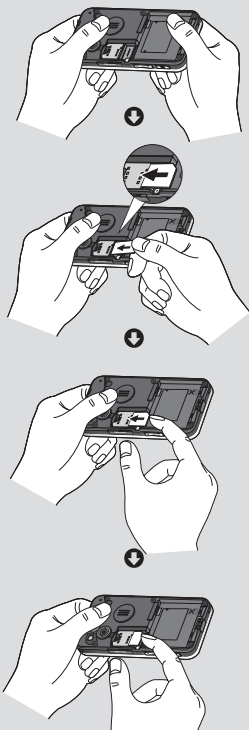

#### 4 Install the battery

Insert the top of the battery first into the top edge of the battery compartment. Ensure the battery contacts align with the terminals on the phone. Press the bottom of the battery down until it clips into place.

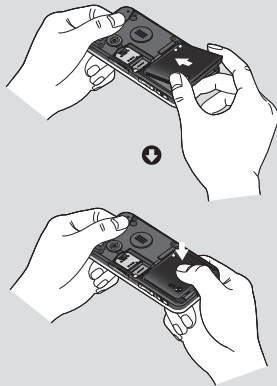

01

02

03

04

05

06

07

08

## Installing the SIM and battery

### 5 Replace the battery cover

Slide the battery cover towards the top of the phone until it clicks into place.

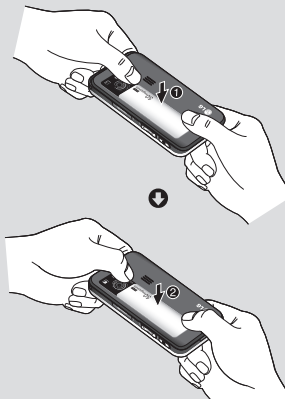

### 6 Charging your phone

Slide the cover of the charger socket on the side of your KC550. Insert the charger and plug into a mains electricity socket. Your KC550 will need to be charged until a message reading Fully Charged appears on screen.

**⚠ WARNING:** Do not charge the phone when it is on soft furnishings. The phone should be charged in a well ventilated area.

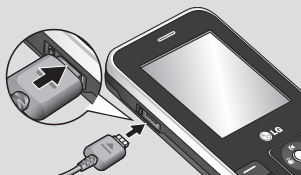

# Memory card

## Installing a memory card

You can expand the memory space available on your phone using a memory card. The KC550 will support a memory card of up to 2 GB.

**TIP!** A memory card is an optional accessory.

Open the slide covering the memory card slot. Slide the memory card into the slot, until it clicks into place. Make sure that the gold contact area is facing downwards.

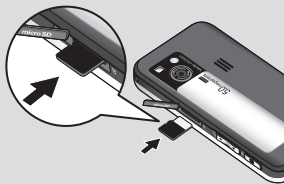

## Removing the memory card

Open the slide and carefully remove the memory card by gently pushing it as shown in the following diagram:

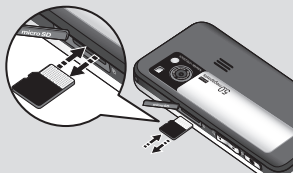

## Formatting the memory card

If your memory card is not already formatted, you will need to do so before you can begin using it.

- 1 From the standby screen press **Menu** and select **Settings**.
- 2 Choose **Memory status** and select **External memory**.
- 3 Press **Format** and enter the password, which is set to 0000 as default. Your card will be formatted and ready to use.
- 4 To view the new formatted folders on your KC550 press **Menu** and select **My stuff**. Choose **External memory**.

**⚠ WARNING:** When you format your memory card, all the content will be wiped. If you do not want to lose the data on your memory card, back it up first.

01

02

03

04

05

06

07

08

# Menu map



## Games & Apps

- 1 M-toy
- 2 Games
- 3 Applications
- 4 Network profile



## Call history

- 1 All calls
- 2 Missed calls
- 3 Dialed calls
- 4 Received calls
- 5 Call duration
- 6 Call costs
- 7 Data information



## Organiser

- 1 Calendar
- 2 Memo



## Multimedia

- 1 MP3 player
- 2 Camera
- 3 Video camera
- 4 FM radio
- 5 Voice recorder
- 6 Muvee studio



## Messaging

- 1 New message
- 2 Inbox
- 3 Email box
- 4 Drafts
- 5 Outbox
- 6 Sent
- 7 Listen to voicemail
- 8 Info message
- 9 Templates
- 0 Settings



## My stuff

- 1 Images
- 2 Sounds
- 3 Videos
- 4 Documents
- 5 Others
- 6 External memory



## Profiles

- 1 General
- 2 Silent
- 3 Vibrate only
- 4 Outdoor
- 5 Headset



## Contacts

- 1 Search
- 2 New contact
- 3 Speed dials
- 4 Groups
- 5 Copy all
- 6 Delete all
- 7 Settings
- 8 Information



## Tools

- 1 Alarm clock
- 2 Calculator
- 3 Stopwatch
- 4 Unit converter
- 5 World clock
- 6 SIM services



## Browser

- 1 Home
- 2 Bookmarks
- 3 Enter address
- 4 History
- 5 Saved pages
- 6 Settings
- 7 Information



## Connectivity

- 1 Bluetooth
- 2 Network
- 3 USB connection
- 4 TV out





## Settings

- 1 Date & Time
- 2 Languages
- 3 Display
- 4 Call
- 5 Security
- 6 Flight mode
- 7 Reset
- 8 Memory status

## Your standby screen

### The quick keys

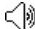
The quick keys provide easy, one-press access to your most used functions.

-  Select to open your message editor.
-  Select to choose a sound profile for your phone.
-  Select to open the favourites menu.
-  Select to play MP3 file.

### The main menu

The main menu provides twelve menu options. To open the main menu:

- 1 Select **Menu**.
- 2 The main menu will appear on the screen.
- 3 When the option you require is highlighted, select **OK** to open.

01

02

03

04

05

06

07

08

#### Advice to the customer

In order to allow better antenna sensitivity LG suggest that you hold the handset as shown in the figure below.

O



X













Please do not cover the antenna area with your hand during a call or when using a Bluetooth connection. It may interfere and degrade signal quality.







# Your standby screen

## The status bar

The status bar uses various icons to indicate things like signal strength, new messages and battery life, as well as telling you whether your Bluetooth is active.

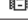
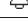
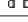

Below is a table explaining the meaning of icons you're likely to see in the status bar.

Icon	Description
	Network signal strength (number of bars will vary)
	No network signal
	GPRS available
	EDGE available
	Flight mode is activated
	Calls are diverted
	Roaming service
	Bluetooth® is activated
	WAP service is connected
	An alarm is set
	Schedule

Icon	Description
	New message
	New voice message
	General profile in use
	Silent profile in use
	Vibrate profile in use
	Outdoor profile in use
	Headset profile in use
	Remaining battery life
	Battery empty

# Calls

## Making a call

- 1 Key in the number using the keypad. To delete a digit press .
- 2 Press  to initiate the call.
- 3 To end the call, press .

**TIP!** To enter + when making an international call, press and hold **0**.

## Making a call from your contacts

- 1 Select **Contacts** from the Standby screen.
- 2 Using the keypad, enter the first letter of the contact you want to call. For example, for Office, press **6** three times.
- 3 Select **Call** or press  to initiate the call.

## Answering and rejecting a call

When your phone rings, press **Accept** or press  to answer the call.

While your phone is ringing, press the camera key, then select **Silent** to mute the ringing. This is great if you have forgotten to change your profile to **Silent** for a meeting.

Press  or select **Reject** to reject the incoming call.

**TIP!** You can change the settings on your phone to answer your calls in different ways. Press **Menu**, select **Settings** and choose **Call**. Select **Answer mode** and choose from **Slide open**, **Any key** or **Send key only**.

01

02

03

04

05

06

07

08

# Calls

## Adjusting the call volume

To adjust the volume during a call, press the volume key on the right hand side of your phone.

## Speed dialling

You can assign a speed dial number to a contact you call frequently.

- 1 Press **Contacts**, then select **Speed dials**.
- 2 Your voicemail is set to speed dial 1 and you cannot change this. Select any other number either by using the navigation key arrows and selecting **Assign** or by pressing the hard key number.
- 3 Your address book will open. Select the contact you'd like to assign to that number using the navigation arrows, then select **OK**.

To call a speed dial number, press and hold the assigned number until the contact appears on screen. The call will initiate automatically; there's no need to press .

## Viewing your call logs

Press **Menu**, select **Call history**. Choose to view:

**All calls** - View a complete list of all your dialled, received and missed calls.

**Missed calls** - View a list of any calls you have missed.

**Dialled calls** - View a list of all the numbers you have called.

**Received calls** - View a list of all the numbers that have called you.

**Call duration** - View details of how long you have spent on your calls; received and dialled.

**Call costs** - View the charges applied to your Last call or All calls. This service is network dependent, some operators are unable to support this.

**Data information** - View the amount of all your received and sent data in kilobytes.

**TIP!** From any call log select **Options** and choose **Delete** to delete selected or all of the recorded items.

**TIP!** Using the navigation key arrows, highlight any single call entry to view the date and time of the call. To view the call duration select **View**.

## Using call divert

- 1 Select **Menu**, select **Settings** and choose **Call**.
- 2 Select **Call divert**.
- 3 Choose whether to divert all calls, when the line is busy, when there is no reply, when you are out of reach, all data calls or all fax calls.
- 4 Choose **Activate** and select whether to divert to voicemail, another number or your favourite number.
- 5 Enter your divert number or select **Search** to browse **Contacts** for your divert number.

**Note:** Charges are incurred for diverting calls. Please contact your network provider for details.

**TIP!** To turn off all call diverts, choose **Cancel all** from the **Call divert** menu.

## Using call barring

- 1 Select **Menu**, select **Settings** and choose **Call**.
- 2 Select **Call barring**.
- 3 Choose any or all of the seven options:
  - All outgoing**
  - Outgoing international**
  - Outgoing international except home country**
  - All incoming**
  - Incoming when abroad**
  - Cancel all barrings**
  - Change password**
- 4 Select **Activate** and enter the call barring password. Please check with your network operator for this service.

**TIP!** Select **Fixed dial number** from the **Call** menu to turn on and compile a list of numbers which can be called from your phone. You'll need your PIN2 code from your operator. When activated, only numbers included in the fixed dial list can be called from your phone.

01

02

03

04

05

06

07

08

# Calls

## Changing the call settings

1 Select **Menu**, select **Settings** and choose **Call**.

2 From here you can amend the settings for:

**Call divert** - Choose whether to divert your calls.

**Call barring** - Select which calls you would like to be barred.

**Fixed dial number** - Choose a list of numbers that can be called from your phone.

**Answer mode** - Choose whether to answer the phone using the send key, any key or by sliding your handset open.

**Send my number** - Choose whether your number will be displayed when you call someone.

**Call waiting** - Be alerted when you have a call waiting.

**Minute minder** - Select **On** to hear a tone every minute during a call.

**Auto redial** - Choose **On** or **Off**.

**Send DTMF tones** - Choose **On** or **Off**.

# Contacts

## Searching for a contact

- 1 Select **Contacts** from the standby screen, and choose **Search**.
- 2 Using the keypad enter the first letter of the contact you want to call. For example, for Office, press **6** three times.
- 3 To scroll through the contacts and their different numbers use the navigation arrows.

## Adding a new contact

- 1 Select **Contacts** and choose **New contact**.
- 2 Choose whether to store your new contact on your **Phone** or **SIM** card.
- 3 Enter all the information you have in the fields provided and select **Save**.

Or, using the slightly quicker method...

- 1 Enter the number you wish to store on the standby screen and select **Options**.
- 2 Choose **Save** or **Add to existing contact**.
- 3 Enter the relevant information as above and select **Save**.

**Note:** When you are storing a contact's email address, press **\*..\*** to enter a symbol and scroll with the navigation arrows until you see **@**.

## Contact options

There are many things you can do when viewing a contact. Here's how to access and use the Options menu:

- 1 Open the contact you'd like to use. See **Searching for a contact** above.
- 2 Select **Options** to open the list of options.

From here you can:

**Edit** - Change any of the contact's details.

**New message** - Send a message to the contact. If the contact has an email address, select whether you'd like to send a **Message** or **Email**.

**Send via** - Send the contact's details to another person as a business card. Choose to send as a **Text message**, **Multimedia message**, via **Bluetooth** or by **Email**.

**Delete** - Delete the contact. Select **Yes** if you are sure.

**New contact** - Add a new contact.

**Multi delete** - Mark multiple contacts to delete.

01

02

03

04

05

06

07

08

# Contacts

**Copy to SIM/phone** - Choose to move or copy to the SIM card or phone (depending on where you originally saved the contact).

## Adding a contact to a group

You can save your contacts into groups, for example, keeping your work colleagues and family separate. There are a number of groups including **Family**, **Friends**, **Colleague**, **VIP**, **Group1** and **Group2** already set up on the phone.

- 1 Select **Contacts** and choose **Groups**.
- 2 Scroll to the group you wish to add a contact to and select **View** then select **Add**.
- 3 Your contacts will open. Scroll to any contacts you would like to add to the group and press  , then select **Done**.
- 4 Select **Yes** if you are sure.

**TIP!** You can assign a ringtone or icon to a group. Select the group you wish to assign the ringtone or icon to and select **Options** and choose an item you want.

## Renaming a group

You can rename any of the groups to fit your lifestyle.

- 1 Select **Contacts** and choose **Groups**.
- 2 Select a group you want to rename.
- 3 Choose **Options**, select **Rename** and enter your new group name.
- 4 Select **Save**.

**Note:** You can only assign a contact to a group or add a picture to a contact that is saved in your phone (not SIM) memory.

## Adding a picture to a contact

You can change the appearance of your contacts in your address book to include a picture.

- 1 Select **Contacts** and choose **Settings**.
- 2 Select **View options** and choose **With picture**.
- 3 Then return to the address book and select the contact you want to add a picture to.
- 4 Choose **Options** and select **Edit**.

- 5 Scroll down to the **Photo** section and select **Edit**. Choose **Options** and select **Images** or **New image**. If you select **Images**, you can choose an image that is saved in your phone memory. If you select **New image**, your camera viewfinder will open, so you can take a picture of your contact.
- 6 Select **Save**.

### Copying your contacts to your SIM

You can also choose to copy your contacts from your SIM to your handset or from your handset to your SIM.

- 1 Select **Contacts** and choose **Copy All**.
- 2 Select to copy the contacts from **SIM to phone** or **Phone to SIM**.
- 3 Choose whether to **Keep original** or **Delete original**.
- 4 Select **Yes** if you are sure.

### Deleting all your contacts

- 1 Select **Contacts** and choose **Delete all**.
- 2 Select to delete contacts from **SIM** or **Phone**.
- 3 Select **Yes** if you are sure.

- 4 Enter the password, which is set to 0000 as default, and select **OK**.

### Viewing information

Select **Contacts** and choose **Information**. From here you can view your **Service dial numbers**, your **Own numbers** and your **Business card**.

**TIP!** If you haven't yet created a business card, the **Business card** screen will give you the option to create one. Select **New** and enter your details as you would for any contact. Choose **Save**.

01

02

03

04

05

06

07

08

# Messaging

## Messaging

Your KC550 includes functions related to SMS (Short Message Service), MMS (Multimedia Message Service) and email, as well as the network's service messages. Simply press

**Menu** and select **Messaging**.

## Sending a message

- 1 Press **Menu**, select **Messaging** and choose **New message**.
- 2 Choose **Message** to send an SMS or MMS. (If you want to send an **Email** see page 26-27 or if you want to send something using **Bluetooth**, see page 49.)
- 3 A new message editor will open. Message editor combines SMS and MMS into one intuitive and easy to switch between mode. The default setting of the message editor is SMS mode.
- 4 Enter your message using either the T9 predictive mode or Abc manual mode. See **Entering text** on page 25 to see how to switch between the different text entry modes.

- 5 Select **Options** and choose **Insert** to add an **Image, Sound, Video, Symbol, Text template, Emoticon, Name & Number, New slide, Subject** or **More (Contact/My business card/Schedule)**.
- 6 Press the centre key **Send to**.
- 7 Enter the phone number or press **Options** and select **Contacts** or **Recent list** to open your contacts list. You can add multiple contacts.
- 8 Select **Send**.



**WARNING:** If an **Image, Sound, Video, New slide** or **Subject** is added to the message editor, it will be automatically converted to MMS mode and you will be charged accordingly.

## Entering text

You can enter alphanumeric characters using the phone's keypad. For example, storing names in Contacts, writing a message and creating scheduling events in the calendar all require entering text. The following text input methods are available in the phone: T9 predictive mode, ABC manual mode and 123 mode.

**Note:** Some fields may allow only one text input mode (e.g. telephone number in address book fields).

To turn on T9 mode in the text entry field, choose **Options**, select **Set T9** and choose **On**. With T9 on, you can switch text input mode by pressing **# \* 0**. You will notice the text input mode indicator in the upper right corner of the display.

To input a symbol in the text entry field, press the **\* 0** key and select a symbol, then select **OK**.

Complete each word with a space by pressing **0**.

To delete a character, press **C** key.

## T9 predictive mode

T9 predictive mode uses a built-in dictionary to recognise words you're writing based on the key sequences you press. Simply press the number key associated with the letter you want to enter, and the dictionary will recognise the word once all the letters are entered. For example, press **8, 3, 5, 3, 7, 4, 6, 6, 3** to write 'telephone'.

If the word you want doesn't appear, select **Options** and select **New T9 word**, then you can enter the word using ABC manual mode. Your word will be added to the dictionary.

**Note:** You can select a different T9 language by pressing **Options** and select **Writing language**.

## ABC manual mode

In ABC manual mode you may need to press the key repeatedly to enter a letter. For example, to write 'hello', press **4** twice, **3** twice, **5** three times, **5** three times again, then **6** three times.

## 123 mode

Type numbers using one keystroke per number. You can also add numbers whilst in letter modes by pressing and holding the desired key.

01

02

03

04

05

06

07

08

# Messaging

## Setting up your email

You can stay in press on the move using email on your KC550. It's quick and simple to set up a POP3 or IMAP4 email account.

- 1 Press **Menu**, select **Messaging** and choose **Settings**.
- 2 Select **Email** then **Email account**.
- 3 Select **New**.
- 4 You can now choose how your account works:
  - Email name** - Enter a name for this account.
  - Email address** - Enter the account email address.
  - My name** - Enter your name.
  - Incoming mail server** - Enter the account details.
  - User name** - Enter the account user name.
  - Password** - Enter the account password.
  - Outgoing mail server** - Enter the account details.
  - Outgoing mail authentication** - Select on or off.
  - Outgoing server ID** - Enter the account details.
  - Outgoing server password** - Enter the account details.

To enter the following information, choose **Options** and select **Advanced settings**.

**Protocol type** - Select the mailbox type, POP3 or IMAP4.

**Maximum receive size** - Choose the size limit of your emails, the maximum is 300KB.

**Save to server** - Choose whether to save your emails to the server. For IMAP4 accounts copies are always saved.

**APOP secure login** - Choose whether to save your emails to the server of the phone (only for IMAP4).

**Insert signature** - Choose whether to automatically insert a signature in your emails.

**Reply email address** - Enter the "reply to" email address.

**Incoming port number** - Normally, this is 110 for POP3 and 143 for IMAP4 accounts.

**Outgoing port number** - Normally this is 25.

**Auto retrieving** - Select to automatically retrieve your emails.

**Retrieve download** - Select **Headers only**, **Headers + body** (only for IMAP4) or **All**.

Now your account is set up, it will appear in the list of accounts in your Email folder.

## Sending an email using your new account

To send/receive an email, you should set up an email account (see page 26).

- 1 Select **Menu**, select **Messaging** and choose **New message**.
- 2 Choose **Email** and a new email will open.
- 3 Write a subject then press OK.
- 4 Enter your message using T9 predictive mode or ABC manual mode. See **Entering text** on page 25 to see how to switch between the different text entry modes.
- 5 Select **Options** and choose an attachment to add: **Image, Sound, Video, Document, Contact, My business card** or **Schedule**.
- 6 Press **Send** and enter the recipient's address or press **Options** and select **Contacts** to open your contacts list.
- 7 Press **Send** and your email will be sent.

## Message folders

Press **Menu**, select **Messaging**. The folder structure used on your KC550 is fairly self-explanatory.

**Inbox** - All the messages you receive are placed into your Inbox. From here you can reply, forward and more, see below for details.

**Email box** - Contains all your email messages. Select the account you want to use then select **Retrieve**. Your KC550 will connect to your email account and retrieve your new messages.

**Drafts** - If you don't have time to finish writing a message, you can save what you have done so far here.

**Outbox** - This is a temporary storage folder while messages are being sent.

**Sent** - All the messages you send are placed into your Sent folder.

**Listen to voicemail** - You can access your voicemail box (if provided by your network). When a new voice message is received, the symbol will be displayed on the standby screen.

**Info message** - All info messages and updates received from your operator.

**Templates** - A list of useful messages, already written for a quick reply.

01

02

03

04

05

06

07

08

# Messaging

## Managing your messages

You can use your **Inbox** to manage your messages.

- 1 Press **Menu**, select **Messaging** and choose **Inbox**. Or, a quicker way is to select  on the stand by screen to edit a new message.

- 2 Select **Options** and then choose to:

**Delete** - Delete the selected message.

**Reply** - Send a reply to the selected message.

**Forward** - Send the selected message on to another person.

**Return call** - Call the person who sent you the message.

**Information** - View the details of a message, for example, the time it was sent.

**Copy/Move** - Choose to copy or move the selected message to the SIM card or phone.

**Multi delete** - Delete selected messages.

**Delete all read** - All opened messages will be deleted.

**Delete all** - Delete text messages, multimedia messages or all messages.

If you see the message **No space for SIM message**, you should delete some messages from your inbox.

If you see the message **No space for messages**, you can delete either messages or saved files to create space.

## Using templates

You can create templates for the **Text** and **Multimedia** messages you send most frequently. There are some templates already on your phone, which can be edited if you wish.

- 1 Press **Menu**, select **Messaging** and choose **Templates**.
- 2 Choose **Text** or **Multimedia**. You can then select **Options** and choose **Edit** to change existing templates, to add **New template** or to **Delete** templates.
- 3 To send a template, select the one you want to send, choose **Options** and select **Send via**.
- 4 Choose how you would like to send the template; as a **Message**, **Bluetooth message** or **Email**.
- 5 Select a contact and select **Send**.

## Changing your text message settings

Your KC550 message settings are pre-defined so that you can send messages immediately.

If you would like to change the settings, you can do this using the **Settings** options.

Press **Menu**, select **Messaging**, then choose **Settings** and **Text message**. You can make changes to:

**Message types** - Convert your text into Voice, Fax, Paging, X.400, Email or ERMES.

**Validity period** - Choose how long your message is stored at the message centre.

**Delivery report** - Choose to receive confirmation that your message was delivered.

**Reply charging** - Choose to be billed for your message recipient's reply.

**Message centre number** - Enter the details for your message centre.

**Character encoding** - Choose how your characters are encoded. This impacts the size of your message and therefore data charges.

**Send long text as** - Choose whether to send your message as SMS or MMS when you enter a text longer than 2 pages in the message field.

**Bearer setting** - Choose whether to send your messages via GSM or GPRS.

## Changing your multimedia message settings

Your KC550 message settings are pre-defined so that you can send messages immediately.

If you would like to change the settings, you can do so using the **Settings** options.

Press **Menu**, select **Messaging**, then choose **Settings** and **Multimedia message**.

You can make changes to:

**Slide duration** - Choose how long your slides appear on screen.

**Priority** - Choose the priority level of your multimedia message.

**Validity period** - Choose how long your message is stored at the message centre.

**Delivery report** - Choose to allow and/or request a delivery report.

01

02

03

04

05

06

07

08

# Messaging

**Read report** - Choose to allow and/or send a read report.

**Auto download** - Choose to automatically or manually download multimedia messages depending on whether you are at home or roaming.

**Network profile** - Select an operator specific network profile for sending multimedia messages.

**Permitted message type** - Select which type of multimedia messages to allow.

## Changing your email settings

You can adapt your email settings to your own preferences.

- 1 Press **Menu**, select **Messaging** and choose **Settings**.
- 2 Select **Email** then you can adapt the following settings:

**Email account** - You can set up an email account.

**Access point** - You can set the email access point.

**Retrieve interval** - Choose how often your KC550 checks for new email messages.

**Signature** - Create an email signature and switch this feature on.

## Changing your other settings

Press **Menu**, select **Messaging**, choose **Settings** then:

**Voicemail number** - Your voicemail number is stored here. Contact your network operator for more information on the service they provide.

**Service message** - Here you can switch off service message, which means your messages will no longer be pushed directly to your device as they are received, only when you check for new messages.

**Info message** - Choose the reception status, alerts and language of your info messages.

**Save text message** - Choose whether to save your text messages to the phone memory or to the external memory.

# Camera

## Taking a quick photo

- 1 Open the lens cover and hold the camera key down on the right side of the handset. The camera's viewfinder will appear on screen.
- 2 Holding the phone horizontally, point the lens towards the subject of the photo.
- 3 Press the camera key halfway. A focus box will appear in the centre of the viewfinder screen. Position the phone so you can see the subject of your photo in the focus box. When the focus box turns green, the camera has focused on your subject.
- 4 Press the centre soft key or press the camera key all the way down to take a photo.

**Note:** You can also access the camera menu from the standby screen. Select **Menu** and select **Multimedia**, scroll down to and select **Camera** to open the viewfinder.

## After you've taken your photo

Your captured photo will appear on the screen. The name of the image runs along the bottom of the screen and you will see six options displayed on the right side of the screen.

**Delete** - Delete the photo you have just taken and confirm by selecting **Yes**. The viewfinder will reappear.



**New image** - Take another photo straightaway. Your current photo will be saved.



**Set as** - Select to open a sub menu to set your image as **Wallpaper** or **Picture ID**.



**Send via** - Select to send the photo as a **Multimedia message** or **Email**. See page 24 for **Sending a message**.



**Album** - Select to look at the other photos in your album. Your current photo will be saved. See page 34 for **Viewing your saved photos**.

**OK** - Select to take another photo straightaway. Your current photo will be saved.

01

02

03

04

05

06

07

08

# Camera

## Getting to know the viewfinder

**Note:** You can adjust the zoom using the volume key on the left side of the phone. The zoom function is only available when the resolution is set to 640 x 480 or below. See **Changing the image size** on page 33 for details.

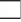
**TIP!** When using the camera, power consumption increases. If  icon appears indicating low battery, recharge the battery before use.

## Using the quick settings

Select **Options** to access the quick settings options. These include various options for taking photos.

**Self timer** - The self-timer allows you to set a delay after the capture button is pressed. Choose from 3 seconds, 5 seconds or 10 seconds. Great for that group photo you want to be part of.

**Shot mode** - This enables you to take up to 9 shots automatically in very quick succession, great for taking photos of moving objects or at sporting events.

**White balance** - The white balance ensures that any white in your photo is realistic. In order for your camera to correctly adjust the white balance you may need to determine the light conditions. Choose from **Auto**, **Daylight**, **Incandescent**, **Cloudy** or **Fluorescent**.

**Colour effect** - Choose from four colour tone options: Off (normal/colour), Sepia, Mono (black and white) or Negative.

**EV** - Turn macro mode on if you are taking a picture very close to the image subject.

**Resolution** - See **Changing the image size** on page 33.

**Quality** - Choose between **Normal**, **Fine** and **Super fine**. The finer the quality the sharper a photo will be but the file size will increase as a result, which means you will be able to store fewer photos in your memory.

**Auto focus** - Turn Auto focus On or Off. Your camera can automatically adjust the focus for a clear, sharp image with a single press of the camera button.

**Shutter tone** - Select one of the three shutter sounds.

**ISO** - Set the ISO to Auto, ISO 800, ISO 400, ISO200, ISO 100 or ISO 80.

**Save to** - Choose whether to save your photos to the phone memory or to the external memory.

**Reset settings** - Choose **Yes** to reset your phone to its original camera settings.

## Using the flash

The flash is set to **Off** as default, but there are other options.

- 1 Select  on the navigation key.
- 2 There are four flash options:

**Off** - The camera will not flash. This is useful if you want to save battery power.

**Auto** - Your camera will assess the lighting needed to take a good picture and use the flash as necessary.

**Always on** - Set the flash to on when you are taking a photo in a dark place.

**When taking** - Set the flash so that it will only flash when you take the photo.

- 3 Select the flash option you'd like to use.
- 4 When you have made your selection the flash menu will automatically close, ready for you to take your picture.
- 5 The flash icon in the viewfinder will change according to your new flash mode.

**Note:** When you exit the camera, the flash setting will revert to the default **Auto** mode.

## Changing the image size

You can change the size of the photo to save memory space. The more pixels, the larger the file size, which in turn means they take up more of your memory. If you want to fit more pictures on to your phone you can alter the pixel number to make the file size smaller.

- 1 Press **Options** and select **Resolution** from the toolbar.
- 2 Select a pixel value from the six numerical options (320X240, 640X480, 1280X960, 1600X1200, 2048X1536, 2560X1920).
- 3 Press **OK** to implement your changes.

**Note:** The zoom function varies depending on the resolution the camera is set to. The zoom function is only available when the resolution is set to 640 x 480 or below.

01

02

03

04

05

06

07

08

# Camera

## Viewing your saved photos

- 1 You can access your saved photos from within the camera mode and from the standby screen. From the viewfinder, simply select  on the navigation key. From the standby screen you should select **Menu**, then select **My stuff** and **Images**.
- 2 Your gallery will appear on screen.
- 3 Use the navigation keys to select the photo you want to view and select **View** to enlarge it.

## Setting a photo as Wallpaper or Picture ID

From your image gallery, use the navigation keys to select an image and choose **Options** and **Set as** to use the selected image as **Wallpaper** or **Picture ID** for one of your contacts.

**Note:** Picture ID can only be added to contacts saved to your phone, not your SIM.

# Video camera

## Shooting a quick video

- 1 Open the lens cover and hold the camera key down on the right side of the handset. The camera's viewfinder will appear on screen.
- 2 Choose **Video** on the top right corner of the screen. The video camera's viewfinder will appear on screen.
- 3 Point the camera lens towards the subject of the video.
- 4 Press the camera key on the right side of the handset to start recording.
- 5 **REC** will appear in the bottom left corner of the viewfinder and a timer will show the length of your video.
- 6 To pause the video select **Pause** and resume by selecting **Resume**.
- 7 Select **Stop** to stop recording.

**Note:** You can also access the **Video camera** from the standby screen. Select **Menu** and select **Multimedia**, scroll down and select **Video camera** to open the viewfinder.

## After you've shot your video

The name of the video runs along the bottom of the screen and six options will be displayed on the right side of the screen.

**Delete** - Delete the video you have just recorded and confirm by selecting Yes. The viewfinder will reappear.

 **New video** - Select to shoot another video straight away. Your current video will be saved.

 **Play** - Select to play the video you have just recorded.

 **Send via** - Select to send the video as a **Multimedia message** or **Email**. See page 24 for **Sending a message**.

 **Album** - Select to look at the other video clips in your album. Your current video clip will be saved. See page 37 for **Watching your saved videos**.

**OK** - Select to record another video straight away. Your current video will be saved.

01

02

03

04

05

06

07

08

## Video camera

### Getting to know the viewfinder

**Note:** You can adjust the zoom using the volume key on the left side of the phone.

### Using the quick settings

Select **Options** to access the quick settings options. These include various options for recording videos.

**Mode** - To record a video you want to send in a multimedia message, select **MMS**.

**Colour effect** - Choose from four colour tone options: **Off** (normal/colour), **Sepia**, **Mono** (black and white) or **Negative**.

**Brightness** - Contrast defines the difference between light and dark in an image. A low contrast image will appear foggy, whereas a high contrast image will appear much sharper. Use the navigation keys to slide the contrast indicator along the bar, towards - for a lower contrast, hazier image or towards + for a higher contrast, sharper image.

**Resolution** - If you want to fit more videos onto your phone you can alter the pixel number to make the file size smaller. Choose between four options for your video, 176X144, 320X240, 640X480, 720X480.

**Quality** - Super fine/ Fine/ Normal.

**Save to** - Choose whether to save your video clip to the phone memory or to the external memory.

**Flash** - Turn the flash **On** or **Off**. The flash is set to **Off** as default, saving battery power. Whenever you exit the camera it will return to the default **Off** setting.

**White balance** - The white balance ensures that any white in your video is realistic. In order for your camera to correctly adjust the white balance, you may need to determine the light conditions. Choose from **Auto**, **Daylight**, **Incandescent**, **Cloudy**, **Fluorescent** or **Night mode**.

**Album** - View all of your images.

**Reset settings** - Choose **Yes** to reset your phone to it's original video camera settings.

## Watching your saved videos

- 1 You can access your saved videos either from within video camera mode or from the standby screen. From the Options menu select **Album**. From the standby screen you should select **Menu**, then select **My stuff** and **Videos**.
- 2 Your gallery will appear on screen.
- 3 Use the navigation keys to select the video you want to view and press the centre soft key to watch it.

## Adjusting the volume when viewing a video

To adjust the volume of the audio on a video whilst it is playing, use the volume keys on the right side of the handset.

01

02

03

04

05

06

07

08

# MP3 player

## MP3 player

Your LG KC550 has a built-in MP3 player so you can play all your favourite music.

To access the MP3 player, press  from the standby screen, or select **Menu** and select **Multimedia** then **MP3 player**. From here you have access to:

**All songs** - Contains all of the songs you have on your phone.

**My playlist** - Contains any playlists you have created as well as **On the go**, **Recent songs** and **Favourite songs**.

**Artists** - Browse through your music collection by artist.

**Albums** - Browse through your music collection by album.

**Genres** - Browse through your music collection by genre.

**Settings** - Adjust your music settings.







## Transferring music onto your phone

The easiest way to transfer music onto your phone is via Bluetooth or your sync cable. To transfer using Bluetooth:

- 1 Make sure both devices have Bluetooth switched on and are visible to one another.

- 2 Select the music file on the other device and choose to send it via Bluetooth.
- 3 When the file is sent you will have to accept it on your phone by selecting **Yes**.
- 4 The file should appear in **All songs**.

## Playing a song

- 1 Press **Menu** and select **Multimedia**, then choose **MP3 player**, or press  from the standby screen.
- 2 Choose **All songs** then select the song you want to play. Select .
- 3 Select  to pause the song.
- 4 Select  to skip to the next song.
- 5 Select  to skip to the previous song.
- 6 Select  to stop the music and return to the MP3 player menu.

**TIP!** To change the volume while listening to music, use the volume keys on the side of your phone.

## Using options while playing music

Select **Options** and choose from:

**Minimise** - Hide the music player screen so that you can continue using your phone as normal while music is playing.

**View playlist** - Look at the playlist you are currently listening to.

**Add to playlist** - Adds the current track to a playlist.

**Set as** - Set the current track as your **Ringtone** or **Message tone**.

**Information** - You can view information about the MP3 file you are listening to.

**Settings** - Change the Shuffle, Repeat, or Equalizer settings.

## Creating a playlist

You can create your own playlists by choosing a selection of songs from the **All songs** folder.

- 1 Press **Menu** and select **Multimedia**.
- 2 Choose **MP3 player**, then select **My playlist**.
- 3 Press **Options** and select **New playlist**, enter the playlist name and press **Save**.
- 4 The **New playlist** folder will show. Select all of the songs that you would like to include in your playlist by scrolling to them and selecting .
- 5 Select **Save** to store the playlist.

## Playing a playlist

- 1 Press **Menu** and select **Multimedia**.
- 2 Choose **MP3 player**, then select **My playlist**.
- 3 Select the playlist you would like to play and select **View**, then select **▶**.

## Editing a playlist

From time to time, you may want to add new songs or delete songs from a playlist.

If you want to organise your playlists, you can edit them using the **Options** menu.

- 1 Press **Menu** and select **Multimedia**.
- 2 Choose **MP3 player**, then select **My playlist**.
- 3 Scroll to the playlist you want to edit and select **View**, then select **Options**. Choose from:

**Add** - You can add songs to the playlist using this option.

**Remove** - Remove a song from the playlist. Select **Yes** to confirm.

**Multi remove** - Delete selected songs from the playlist.

01

02

03

04

05

06

07

08

## MP3 player

**Remove all** - Remove all of the songs from the playlist.

**Information** - View the playlist information.

### Deleting a playlist

- 1 Press **Menu** and select **Multimedia**.
- 2 Choose **MP3 player**, then select **My playlist**.
- 3 Scroll to the playlist you want to delete and select **Options**.
- 4 Select **Delete all** and select **Yes** to confirm.

### Note:

As a result of the Digital Rights Management (DRM) system, some of the media items you download from the Internet or receive by MMS may have a "Purchase right" menu to access them. You can acquire the key to purchase the right from the website which owns the rights to the contents.

Music is copyright protected in international treaties and national copyright laws. It may be necessary to obtain permission or a licence to reproduce or copy music. In some countries national law prohibits private copying of copyrighted material. Please check the national legislation of the applicable country concerning the use of such material.

# FM radio

## Using the FM radio

Your LG KC550 has an FM radio feature so you can tune into your favourite stations to listen on the move.

**Note:** You will need to insert your headset in order to listen to the radio. Insert the plug into the headset socket (this is the same socket that you plug your charger into).

## Searching for stations

You can tune radio stations into your phone by searching for them either manually or automatically. They will then be saved to specific channel numbers so you don't have to keep re-tuning. You can save up to 12 channels in your phone.

To auto tune:

- 1 Press **Menu** and select **Multimedia**, then choose **FM radio**.
- 2 Select **Options** and choose **Auto scan** then select **Yes**.
- 3 Each time a station is found, your KC550 will ask if you want to save it. Select **Yes** if you want to store the channel and **No** if you don't. Any stations you choose to save will automatically be allocated to a channel number in your phone.

To manually tune:

- 1 Press **Menu** and select **Multimedia**, then choose **FM radio**.
- 2 Select a channel number that you want to save a station to and choose **Edit**.
- 3 To enter your station, use the navigation keys to search or enter the frequency using the keypad, then select **Save**.

**Note:** You can also edit the stations you have saved in a channel number.

**TIP!** To improve the reception extend the headset cord, which functions as the radio antenna.

## Resetting channels

- 1 Press **Menu** and select **Multimedia**, then choose **FM radio**.
- 2 Select **Options** and select **Reset channels**. Choose **Yes** to confirm the reset. Each channel will return to the starting 87.5Mhz frequency.

## Listening to the radio

- 1 Press **Menu** and select **Multimedia**, then choose **FM radio**.
- 2 Select the channel number of the station you would like to listen to.

**Note:** You can listen to the radio via a built-in speaker. Press **Options**, select **Listen via** and choose **Speaker**.

01

02

03

04

05

06

07



08

# Voice recorder

## Using the voice recorder

Use your **Voice recorder** to record voice memos or other sounds.

## Recording your voice memo

- 1 Press **Menu** and select **Multimedia**, then choose **Voice recorder**.
- 2 Press  to begin recording.
- 3 Select **Pause** to pause the recording.
- 4 Choose **Stop** to end the recording.
- 5 Select  to listen to the recording.

**Note:** You can listen to all of the voice recordings you have saved by selecting **Album**.

## Sending a voice recording

- 1 Once you have finished recording, select **Options**.
- 2 Select **Send via** and choose from **Multimedia message**, **Bluetooth** or **Email**. If you choose **Message** or **Email**, the recording will be added to the message and you can write and send it as normal. If you choose **Bluetooth**, you will be prompted to turn Bluetooth on.

**TIP!** If you plan to send your recording as a message, before you start recording, select **Options**, select **Recording mode** and choose **MMS**. This will ensure that the recording fits into a message.

## Using the muvee studio

The Muvee studio allows you to create an image slide show combined with music.

- 1 Press **Menu** and select **Multimedia**, then choose **Muvee studio**.
- 2 Choose the music track that you would like to use.
- 3 Mark the images that you would like to use in your slide show, and choose **Done**.
- 4 The new muvee will begin to play. To save your slide show press **Save**.

**Note:** You can use the Options menu to choose where to save your slide show (Phone or External memory), the duration mode (General or MMS) and the play order (Random or Sequential).

## My stuff

You can store any multimedia files into your phone's memory so that you have easy access to all of your pictures, sounds, videos and games. You can also save your files to a memory card. The advantage of using a memory card is that you can free up space on your phone's memory.

All your multimedia files will be saved in **My stuff**. Select **Menu** then select **My stuff** to open a list of folders.

### Images

**Images** contains a folder of default images and default flash files pre-loaded onto your phone, images downloaded by you and images taken on your phone's camera.

### Images options menu

The options which are available to you in **Images** depend on what type of image you have selected. All of the options will be available for pictures you have taken on the phone's camera. Only the **View**, **Set as wallpaper**, **File info**, **Slide show**, **Sort by** and **List view / Thumbnail view** options are available for default images.

In the **Images** folder, select **Options** to bring up your list of options.

**Delete** - Delete the selected image.

**Set as** - Set the selected image as your **Wallpaper** or as a **Picture ID**.

**Send via** - Send the selected image to a friend via **Multimedia message**, **Bluetooth** or **Email**.

**Note:** The image may need to be resized before it can be sent by MMS.

**Edit Image** - Change any of the image's details.

**File** - Rename, make animation or view the information (Name, Size, Date, Time, Resolution, Type and Copyright) of the selected image. If you have an external memory card inserted two additional options will show: **Move to external memory** and **Copy to external memory**.

**Print via** - Print an image file via **Bluetooth** or **Pictbridge**.

**Slide show** - See **Creating a slide show** on page 45.

**New folder** - Create a new folder within the main Images folder.

**Mark/Unmark** - Select more than one image to delete.

**Delete all** - Delete all the photos in your Images folder.

01

02

03

04

05

06

07

08

# My stuff

**Sort by** - Arrange your images by **Date**, **Type** or **Name**.

**List view / Thumbnail view** - Change the way you view your photos.

## Sending a photo

- 1 Press **Menu** then select **My stuff**.
- 2 Select **Images**.
- 3 Select a photo and choose **Options**.
- 4 Select **Send via** and choose from **Multimedia message**, **Bluetooth** or **Email**.
- 5 If you choose **Multimedia message** or **Email**, your photo will be attached to the message and you can write and send the message as normal. If you choose **Bluetooth**, you will be prompted to turn Bluetooth on and your phone will search for a device to send the picture to.

## Organising your images

- 1 Press **Menu** then select **My stuff**.
- 2 Select **Images**.
- 3 Choose **Options** then select **Sort by**.
- 4 Choose from **Date**, **Type** or **Name**.

## Deleting an image

- 1 Press **Menu** then select **My stuff**.
- 2 Select **Images**.
- 3 Select an image and press **Options**.
- 4 Select **Delete**.

## Deleting multiple images

- 1 Press **Menu** then select **My stuff**.
- 2 Select **Images**.
- 3 Choose **Options** and select **Mark/Unmark** and **Delete**.
- 4 A box will appear next to each image. Select each image and select  to mark it. To unmark an image, select  again so that the tick disappears from the box. Or, you can select **Options** then choose **Mark all** or **Unmark all**.
- 5 Once you have marked all of the appropriate boxes, select **Delete** and confirm you want to delete all of the marked images.

## Creating a slide show

If you want to look at all of the images on your phone or scan through what you've got, you can create a slide show to save you from having to open and close each individual image.

- 1 Press **Menu** then select **My stuff**.
- 2 Select **Images**.
- 3 Select the photo you would like to begin the slide show and select **Options**.
- 4 Choose **Slide show** and it will begin.
- 5 Press **Pause** to pause the slide show and **Quit** to end the slide show and return to the **Images** folder.

Selecting **Options** during the slide show presents further options:

**View** - Choose between **Full image** and **Full screen**. Select **Landscape** to change the orientation of the image.

**Repeat on / off** - Decide whether you want the slide show on repeat or not.

## Sounds

The **Sounds** folder contains the **Default sounds**, your voice recordings and sound files downloaded by you. From here you can manage, send or set sounds as ringtones.

### Using a sound

- 1 Press **Menu** then select **My stuff**.
- 2 Scroll to and select **Sounds**.
- 3 Select **Default sounds** or choose from the list of voice recording files.
- 4 Select a sound and press ► to listen to it.
- 5 Select **Options**, select **Set as** and choose from **Ringtone**, **Ringtone ID** and **Message tone**.

## Videos

The **Videos** folder shows the list of downloaded videos and videos you have recorded on your phone.

### Watching a video

- 1 Press **Menu** then select **My stuff**.
- 2 Scroll to and select **Videos**.
- 3 Select a video and press ►.

01

02

03

04

05

06

07

08

## My stuff

### Using options while video is paused

By selecting **Options**, the video you are playing will be in pause mode and you can choose from:

**Delete** - Delete the video.

**Send via** - Send the video to a friend via **Multimedia message, Bluetooth** or **Email**.

**Information** - View the Name, Size, Date, Time, Type and Copyright details of the selected file.

### Sending a video clip

- 1 Press **Menu** then select **My stuff**.
- 2 Scroll to and select **Videos**.
- 3 Select the video clip you want and press **Options**.
- 4 Press **Send via** and choose from **Multimedia message, Bluetooth** or **Email**.
- 5 If you choose **Message** or **Email**, your video clip will be attached to the message and you can write and send the message as normal. If you choose **Bluetooth**, you will be prompted to turn Bluetooth on and your phone will search for a device to send the video to.

**Note:** The video may need to be resized before it can be sent by MMS. Some videos may be too large to send by MMS at all.

### Video options menu

In the **Videos** folder, press **Options** to bring up the following list of options.

**Delete** - Delete the selected video.

**Send via** - Send the selected video to a friend via **Multimedia message, Email** or **Bluetooth**.

**File** - Rename the video or view the information (Name, Size, Date, Time, Type and Copyright). If you have an external memory card inserted two additional options will show:

**Move to external memory** and **Copy to external memory**.

**New folder** - Create a new folder within the main Videos folder.

**Mark/Unmark** - Select more than one video clip before selecting **Delete**.

**Delete all** - Delete all the clips in your Videos folder.

**Sort by** - Arrange your videos by **Date, Type** or **Name**.

**Auto next play** - Allows to set the play mode: **Off**, **Repeat once** and **Repeat all**.

- **Off**: Plays the selected file.
- **Repeat once**: Plays all files in a list once.
- **Repeat all**: Continues to play all files in a list repeatedly.

**List view / Thumbnail view** - Change the way you view your videos.

## Documents

From the **Documents** menu, you can view Excel, PowerPoint, Word, Text and PDF files.

### Viewing a document

- 1 Press **Menu** then select **My stuff**.
- 2 Select **Documents**.
- 3 Select a document and press **View**.

## Others

From the **Others** menu, you can view the files which are not saved in the Images, Sounds, Videos or Documents folders.

You may find that when you transfer files from your computer to your phone, they appear in the **Others** folder rather than the **Documents** folder. If this happens you can move them.

To move a file from **Others** to **Documents**:

- 1 Press **Menu**, then select **My stuff** followed by **Others**.
- 2 Select a file and select **Options**.
- 3 Press **Move**, then select **Move** again.

## External memory

If you've inserted a memory card it will be displayed as a folder within **My stuff**. Your external memory folder will be divided into five further folders: **Images**, **Sounds**, **Videos**, **Documents** and **Others**. Each folder will contain all the files of that type which are saved to your memory card rather than your handset.

## Using your phone as a mass storage device

Your KC550 can be used as a mass storage device, just like a USB stick. This is a great way of moving your files from your computer to your phone. If you've inserted a memory card, when connecting as **Mass storage**, the phone will be displayed as two drives on your computer: the handset memory and external memory.

01

02

03

04

05

06

07

08

## My stuff

- 1 Press **Menu**, select **Connectivity**.
- 2 Select **USB Connection**.
- 3 Scroll to **Mass storage** and select **OK**.
- 4 Insert the smaller end of the USB cable into the USB cable connector on the edge of the KC550. Plug the larger end into the USB port of your computer.
- 5 A removable disk folder will open automatically on your computer, two if you have a memory card inserted, showing all the folders on your phone or memory card.
- 6 Drag and drop your images, videos, music or documents into the correct folders.
- 7 Safely remove your phone by clicking on the **Safely remove hardware** icon in your desktop toolbar.
- 8 When you want to then access a file, for example an image, press **Menu**, then select **My stuff** followed by **External memory** then **Images**. All the images you transfer will be contained in this file.

### Transferring a file to your phone

You can also transfer files from your computer to your phone using Bluetooth.

- 1 Make sure your phone and computer have Bluetooth switched on and are visible to one another.
- 2 Use your computer to send the file via Bluetooth.
- 3 When the file is sent you will have to accept it on your phone by selecting **Yes**.
- 4 The file will be saved within the appropriate folder depending on its type. So for example, photographs will be saved in the **Images** folder and music in the **Sounds** folder. If your phone cannot identify the file type, the file will be saved in the **Others** folder.

**Note:** Files sent using Bluetooth will be saved to the phone memory.

## Sending and receiving your files using Bluetooth

Bluetooth is a great way to send and receive files as no wires are needed and connection is quick and easy. You can also connect to a Bluetooth headset to make and receive calls.

Before you can start sharing files using Bluetooth, you will need to pair your phone with another Bluetooth device. For information on pairing devices, see **Pairing with another Bluetooth device** on page 60.

### To switch Bluetooth on:

- 1 Press **Menu** and select **Connectivity**, then choose **Bluetooth**.
- 2 Select **Bluetooth on/off** and choose **On**.
- 3 Select **Off** to switch Bluetooth off.

### To send a file:

- 1 Open the file you want to send, typically this will be a photo, video or music file.
- 2 Select **Options** and choose **Send via**, then **Bluetooth**.
- 3 Select **Yes** to turn Bluetooth on if it is not already activated.

- 4 Your KC550 will automatically search for other Bluetooth enabled devices within range.
- 5 Choose the device you want to send the file to and select **Send**.

### To receive a file:

- 1 To receive files, your Bluetooth must be both **On** and **Visible**. See **Changing your Bluetooth settings** on page 59 for more information.
- 2 A message will prompt you to accept the file from the sender, select **Yes** to receive the file.

**TIP!** Keep an eye on the progress bar to make sure your file is sent.

**Note** The Bluetooth® word mark and logos are owned by the Bluetooth SIG, Inc. and any use of such marks by LG Electronics is under licence. Other trademarks and trade names are those of their respective owners.

01

02

03

04

05

06

07

08

# Games and Apps

## Games and Apps

Your KC550 comes with preloaded games to keep you amused when you have time to spare. If you choose to download any additional games or applications they will be saved into this folder.

### Playing a game

- 1 Press **Menu** and select **Games & Apps**.
- 2 Select **Games**.
- 3 Choose the game you want to play and select **Play**.

### Viewing applications

You can manage the Java applications installed in your phone by using the **Applications** menu. You can also delete downloaded applications.

- 1 Press **Menu** and select **Games & Apps**.
- 2 Select **Applications**.
- 3 View and manage any applications you have.

## Changing the network profile

To download a game, you can set the value to connect to the network using **Network profile**.

- 1 Press **Menu** and select **Games & Apps**.
- 2 Select **Network profile**.
- 3 You can add and edit a new network profile.

## M-Toy

You can enjoy six default games including: **Dart, Homerun Derby, Magic Ball, Hammer, Maze, Fishing**.

**About** - View the information for a game.

**Setting** - Set the sound and vibration when activating a game.

**Reset data** - Reset all settings.

**Exit** - End a game.

# Organiser

## Adding an event to your calendar

- 1 From the standby screen press **Menu**, and select **Organiser**, then **Calendar**.
- 2 Select the date you would like to add an event to. You can choose a date either by scrolling to it using the navigation keys or by selecting **Options** and **Go to date** in order to enter a date.
- 3 Select **New** and scroll down to enter the time you would like your event to begin. Scroll down and enter the end time of your event.
- 4 Scroll down again and choose whether you would like to set an **Alarm** for the event. Scroll left or right to see the available options. You can set the alarm to go off at the starting time of the event or at a set period of time before the event starts to remind you the event is coming up.
- 5 Scroll down and enter a **Subject** for the event. Use the keypad to type letters and numbers.
- 6 Scroll down once more to select whether the event is occurring **Once** or repeated at **Daily**, **Weekly**, **Monthly** or **Yearly** intervals. If the event is repeated, you can

also scroll down to enter an **Expiration date** for when the events will stop completely.

- 7 Select **Save** and your event will be saved in the calendar. A square cursor will mark the days that any events have been saved to.

## Editing a calendar event

- 1 From the standby screen press **Menu**, and select **Organiser**, then **Calendar**.
- 2 Choose **Options** and select **All schedules** to see a list of all your events. Scroll to the event you would like to edit and select **View**. Alternatively select the day of the event in the calendar and select **View**.
- 3 Select **Edit** and scroll to the event detail you want to change. Make your modifications and select **Save** to store the edited event.

**Note:** You can delete an event from your calendar by selecting to view the event and then pressing **Options** and **Delete**.

01

02

03

04

05

06

07

08

# Organiser

## Sharing a calendar event

- 1 From the standby screen press **Menu**, and select **Organiser**, then **Calendar**.
- 2 Select the event you would like to share and choose **Options**.
- 3 Choose **Send via** and select from **Text message**, **Multimedia message**, **Bluetooth** or **Email**.

## Adding a memo

- 1 From the standby screen press **Menu**, and select **Organiser**, then **Memo**.
- 2 Select **New** and type your memo.
- 3 Select **Save**.
- 4 Your memo will appear on screen the next time you open the memo application.

**TIP!** You can edit an existing memo. Select the one you want to edit, press **Options** and select **Edit**.

# Tools

## Setting your alarm

- 1 From the standby screen press **Menu**, and select **Tools**, then **Alarm clock**.
- 2 Select **New**.
- 3 Scroll down and enter the time you would like the alarm to sound at.
- 4 Choose the repeat type to indicate whether you would like your alarm to sound **Once**, **Daily**, **Mon - Fri**, **Mon - Sat**, **Sat - Sun**, or **Choose weekday**.
- 5 Scroll down and choose whether you would like the alarm to **Always sound**, **Always vibrate** or **Follow profile**.
- 6 Scroll down to choose the alarm tone. Choose **Sounds** to select a new sound.
- 7 Scroll down and enter a name for the alarm or keep the suggested name.
- 8 Select **Save**.

**Note:** You can set up to 5 alarms.

## Using your calculator

- 1 From the standby screen press **Menu**, and select **Tools**, then **Calculator**.
- 2 Press the numeric keys to input numbers.

- 3 For simple calculations, select the function you require (+, -, ×, ÷), followed by =.
- 4 For more complex calculations, select **Function** to select a command.
- 5 Select **Clear** to clear the screen and start a new calculation.

## Using the stopwatch

- 1 From the standby screen press **Menu**, and select **Tools**, then **Stopwatch**.
- 2 Select **Start** to begin the timer.
- 3 Choose **Lap** if want to record a lap time. The duration of an individual lap time (up to 20 times) can be saved.
- 4 Select **Stop** to end the timer.
- 5 Choose **Resume** to restart the stopwatch at the time you stopped it at or select **Reset** to return to zero.

01

02

03

04

05

06

07

08

## Tools

### Converting a unit

- 1 From the standby screen press **Menu**, and select **Tools**, then **Unit converter**.
- 2 Choose whether you would like to convert **Currency, Area, Length, Weight, Temperature, Volume** or **Velocity**.
- 3 Scroll up to choose from the unit of measurement you want to enter. Scroll left and right to select a unit, then scroll down and enter the unit quantity.
- 4 Scroll down to the unit conversion box and choose the unit measurement you want to convert into. The conversion will show automatically in the line below.

### Adding a city to your world clock

- 1 From the standby screen press **Menu**, and select **Tools**, then **World clock**.
- 2 Scroll up, down, left or right to navigate the globe and choose a continent.
- 3 Select **Zoom in** to zoom into an area and choose from the cities in that area.
- 4 Press **OK**.

### SIM services

This feature depends on SIM and the network services.

In case the SIM card supports SAT (i.e. SIM Application Toolkit) services, this menu will be the operator specific service name stored on the SIM card.

# Browser

With a browser at the tip of your fingers, you can get up to date news and weather forecasts as well as information on sports or traffic whenever you need it. In addition, the browser allows you to download the latest music, ringtones, wallpapers and games.

## Accessing the web

- 1 Press **Menu** and select **Browser**.
- 2 To access the browser homepage directly, select **Home**. Alternately, select **Enter address** and type in your desired URL, followed by **Connect**.

**Note:** An additional cost is incurred when connecting to this service and downloading content. Check your data charges with your network provider.

## Adding and accessing your bookmarks

For easy and fast access to your favourite websites, you can add bookmarks and save web pages.

- 1 Press **Menu** and select **Browser**.
- 2 Select **Bookmarks**. A list of your bookmarks will appear on the screen.
- 3 To add a new bookmark, select **Options** and choose **New bookmark**. Enter a name for your bookmark followed by the URL.
- 4 Press **Save**. Your bookmark will now appear in the list of bookmarks.
- 5 To access the bookmark simply scroll to the required bookmark and select **Connect**. You will be connected to your bookmarked page.

01

02

03

04

05

06

07

08

# Browser

## Saving a page

- 1 Access your required web page as described on page 55.
- 2 Choose **Options** and scroll to **Save**, select **This page**.
- 3 Select **OK**.

## Accessing a saved page

- 1 Press **Menu** and select **Browser**.
- 2 Select **Saved pages**.
- 3 Select the required page and press **Open**.

**TIP!** This menu will also allow you to delete saved pages.

## Viewing your browser history

- 1 Press **Menu** and select **Browser**.
- 2 Select **History** and select **OK**.
- 3 A list of web page titles you have accessed recently will be displayed. To access one of these pages, scroll to the required page and select **Connect**.

## Changing the web browser settings

- 1 Press **Menu** and select **Browser**.
- 2 Select **Settings**.
- 3 You can choose the way your mobile handles, displays and uses information when browsing the internet. You can amend settings within **Network profiles**, **Rendering mode**, **Cache**, **Cookies**, **Security certificates**, **Show image**, **JavaScript** and **Storage location**.
- 4 Once you have changed your settings, select **OK**.

# Settings

Within this folder you can adapt your settings to make your KC550 personal to you.

**Note:** For information on call settings see page 20.

## Changing your profiles

You can quickly change your profile from the standby screen. Simply press  then the profile you would like to activate. Choose from **General**, **Silent**, **Vibrate only**, and **Outdoor**.

## Personalising your profiles

You can personalise each profile setting.

- 1 Press **Menu** and select **Profiles**.
- 2 Choose the profile you want and select **Personalise**.
- 3 For the **Silent** and **Vibrate only** profiles, you can adapt the vibration. For the other profiles, you can change all of the sounds and alert options available in the list. (Please refer to your handset for details.)

## Changing your date & time

You can set functions relating to the date and time.

- 1 Press **Menu** and select **Settings**.
- 2 Select **Date & Time** and choose from the list below:

**Set date** - You can enter the current date.

**Date format** - You can set the date format. (YYYY/MM/DD, DD/MM/YYYY, MM/DD/YYYY)

**Set time** - You can enter the current time.

**Time format** - You can set the time format to either 24 hours or 12 hours.

**Auto update** - Select **On**, the phone will automatically update the date and time.

## Changing the language

Go to **Settings** and **Languages** to change the language for any text in your phone. Any change will also alter the language input mode.

## Changing your display settings

- 1 Press **Menu** and select **Settings**.
- 2 Select **Display** and choose from:

**Wallpaper** - Choose a wallpaper to appear on your screen display.

**Clocks** - Choose to have the time and date visible on your standby screen. Choose from No date & time or Normal.

**Backlight timer** - Choose how long the backlight remains on for.

01

02

03

04

05

06

07

08

# Settings

**TIP!** The longer the backlight is on for, the more battery power is used and you may need to charge your phone more often.

**Brightness** - Use the navigation keys to adjust the brightness. Choose from 40%, 60%, 80% or 100%, then select OK to save your change.

**Home screen shortcut** - Select **On** to display the shortcuts of 4 menus as pictures on the middle of the standby screen.

**Font size** - Change the font size of the following : **Menu, Dialling** and **Messaging**.

**Theme** - Quickly change the whole look of your screen.

**Menu style** - Change the menu view from **Grid view** to **List view**.

**Main font style** - Adjust the font type.

**Dialling font style** - Adjust the font style for when you are dialling a phone number.

**Standby text** - Choose to add a message to your standby screen.

**Network name** - Choose to show or hide the network name.

## Changing your security settings

Change your security settings to keep your KC550 and the important information it holds protected.

- 1 Press **Menu** and select **Settings**.
- 2 Select **Security** and choose from the list below:

**PIN code request** - Choose a PIN code to be requested when you turn your phone on.

**Phone lock** - Choose a security code to lock your phone **When power on, When SIM changed** or **Immediately**.

**Change codes** - Change your **Security code, PIN1 code** or **PIN2 code**.

## Using flight mode

Use this function to switch the flight mode **On** or **Off**. You will not be able to make calls, connect to the internet, send messages when **Flight mode** is switched **On**.

## Resetting your phone

Use **Reset** to reset all the settings to their factory definitions. You need the security code to activate this function.

## Viewing memory status

Your KC550 has three memories available: the phone, the SIM card and an external memory card (you may need to purchase the memory card separately).

You can use the memory manager to determine how each memory is used and see how much space is available.

Press **Menu** and select **Settings**. Choose **Memory status** and you will then see the current status of the memories (Common, Reserved, SIM card and External memory) in your KC550.

**TIP!** See page 13 for information on **inserting a memory card**.

## Changing your Bluetooth settings

- 1 Press **Menu** and select **Connectivity**, then choose **Bluetooth**.
- 2 Choose **Bluetooth settings**. Make your changes to:

**My visibility** - Choose whether to **Show** or **Hide** your device to others.

**My name** - Enter a name for your KC550.

**My address** - View your Bluetooth address.

## Changing your connectivity settings

Your connectivity settings have already been set up by your network operator, so you can enjoy your new phone from the off. If you want to change any settings, use this menu.

Press **Menu** and select **Connectivity**. Your options are:

**Bluetooth** - Set up your KC550 for Bluetooth use. You can adapt your visibility to other devices or search through devices your phone is paired with.

**Network** - Your KC550 connects automatically to your preferred network. To change these settings use this menu. You can also add new access points using this menu.

01

02

03

04

05

06

07

08

# Settings

**USB connection** - Choose **Data service** and synchronise your KC550 using the LG PC Suite software to copy files from your phone.

If you have a memory card inserted, select **Mass storage** to use your phone in the same way as you would use a USB stick. Connect to your computer and drag and drop files to the KC550 removable device folder. See pages 47~49 for further details.

## Pairing with another Bluetooth device

By pairing your KC550 and another device, you can set up a passcode protected connection. This means your pairing is more secure.

- 1 Check your Bluetooth is **On** and **Visible**.  
You can change your visibility in the **Bluetooth settings** menu, by selecting **My visibility**, then **Show**.
- 2 Select **Device list** from the Bluetooth menu and choose **New**.
- 3 Your KC550 will search for devices. When the search is completed **Pair** and **Refresh** will appear on screen.
- 4 Choose the device you want to pair with, select **Pair** and enter a passcode then choose **OK**.

- 5 Your phone will then connect to the other device, on which you should enter the same passcode.
- 6 Your passcode protected Bluetooth connection is now ready.

## Using a Bluetooth headset

- 1 Check your Bluetooth is **On** and **Visible**.
- 2 Follow the instructions that came with your headset to place it in pairing mode and pair your devices.
- 3 Your KC550 will then automatically connect to your Bluetooth headset and switch to headset profile.

# Accessories

These accessories were supplied with your KC550.

## Charger



## Data cable and CD

Connect and synchronise your KC550 and PC.



## Battery



## User Guide

Learn more about your KC550.

## Stereo headset



### Note

- Always use genuine LG accessories. Failure to do this may invalidate your warranty.
- Accessories may be different in different regions; please check with our regional service company or agent for further inquiries.

01

02

03

04

05

06

07

08

## Network service

The wireless phone described in this guide is approved for use on the GSM 900, DCS 1800 and PCS1900 networks.

A number of features included in this guide are called Network Services. These are special services that you arrange through your wireless service provider. Before you can take advantage of any of these Network Services, you must subscribe to them through your service provider and obtain instructions for their use from your service provider.

## Technical data

### General

Product name : KC550

System : GSM 900 / DCS 1800 / PCS 1900

### Ambient Temperatures

Max : +55°C (discharging)

+45°C (charging)

Min : -10°C

# Declaration of Conformity



## Suppliers Details

Name

LG Electronics Inc

Address

LG Twin Tower 20, Yeouido-dong, Yeongdeungpo-gu Seoul, Korea 150-721

## Product Details

Product Name

E-GSM 900 / DCS 1800 / PCS 1900 Tri Band Terminal Equipment

Model Name

KC550

Trade Name

LG

# CE 0168

## Applicable Standards Details

R&TTE Directive 1999/5/EC

EN 301 489-01 v1.6.1 / EN 301 489-07 v1.3.1 / EN 301 489-17 v.1.2.1  
EN 60950-1 : 2001  
EN 50360/EN 60361 : 2001  
EN 301 511 V9.0.2  
EN 300 328 V 1.6.1

## Supplementary Information

The conformity to above standards is verified by BABT.

## Declaration

I hereby declare under our sole responsibility that the product mentioned above to which this declaration relates complies with the above mentioned standards and Directives

European Standard Center  
LG Electronics Logistics and Services B.V.  
Veluwezoom 15, 1327 AE Almere, The Netherlands  
Tel : +31 - 36- 547 - 8940, Fax : +31 - 36 - 547 - 8794  
e-mail : jacob @ lge.com

Name

Issued Date

Seung Hyoun, Ji / Director

18. March. 2008

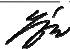
  
Signature of representative

## Guidelines for safe and efficient use

Please read these simple guidelines. Not following these guidelines may be dangerous or illegal.

### Exposure to radio frequency energy

#### Radio wave exposure and Specific Absorption Rate (SAR) information

This mobile phone model KC550 has been designed to comply with applicable safety requirements for exposure to radio waves. These requirements are based on scientific guidelines that include safety margins designed to assure the safety of all persons, regardless of age and health.

- The radio wave exposure guidelines employ a unit of measurement known as the Specific Absorption Rate, or SAR. Tests for SAR are conducted using standardized method with the phone transmitting at its highest certified power level in all used frequency bands.
- While there may be differences between the SAR levels of various LG phone models, they are all designed to meet the relevant guidelines for exposure to radio waves.

- The SAR limit recommended by the International Commission on Non-Ionizing Radiation Protection (ICNIRP) is 2W/kg averaged over 10g of tissue.
- The highest SAR value for this model phone tested by DASY4 for use at the ear is 0.348 W/kg (10g) and when worn on the body is 0.665 W/kg (10g).
- SAR data information for residents in countries/regions that have adopted the SAR limit recommended by the Institute of Electrical and Electronics Engineers (IEEE), which is 1.6 W/kg averaged over 1g of tissue.

### Product care and maintenance

#### WARNING

- Only use batteries, chargers and accessories approved for use with this particular phone model. The use of any other types may invalidate any approval or warranty applying to the phone, and may be dangerous.
- Do not disassemble this unit. Take it to a qualified service technician when repair work is required.
  - Keep away from electrical appliances such as TVs, radios, and personal computers.

- The unit should be kept away from heat sources such as radiators or cookers.
- Do not drop.
- Do not subject this unit to mechanical vibration or shock.
- Switch off the phone in any area where you are required by special regulations. For example, do not use your phone in hospitals as it may affect sensitive medical equipment.
- Do not handle the phone with wet hands while it is being charged. It may cause an electric shock and can seriously damage your phone.
- Do not charge a handset near flammable material as the handset can become hot and create a fire hazard.
- Use a dry cloth to clean the exterior of the unit (do not use solvents such as benzene, thinner or alcohol).
- Do not charge the phone when it is on soft furnishings.
- The phone should be charged in a well ventilated area.
- Do not subject this unit to excessive smoke or dust.

- Do not keep the phone next to credit cards or transport tickets; it can affect the information on the magnetic strips.
- Do not tap the screen with a sharp object as it may damage the phone.
- Do not expose the phone to liquid or moisture.
- Use the accessories like earphones cautiously. Do not press the antenna unnecessarily.

## **Efficient phone operation**

### **Electronics devices**

All mobile phones may get interference, which could affect performance.

- Do not use your mobile phone near medical equipment without requesting permission. Avoid placing the phone over pacemakers, for example in your breast pocket.
- Some hearing aids might be disturbed by mobile phones.
- Minor interference may affect TVs, radios, PCs, etc.

# Guidelines for safe and efficient Use

## Road safety

Check the laws and regulations on the use of mobile phones in the areas when you drive.

- Do not use a hand-held phone while driving.
- Give full attention to driving.
- Use a hands-free kit, if available.
- Pull off the road and park before making or answering a call if driving conditions so require.
- RF energy may affect some electronic systems in your vehicle such as car stereos and safety equipment.
- When your vehicle is equipped with an air bag, do not obstruct with installed or portable wireless equipment. It can cause the airbag to fail or cause serious injury due to improper performance.
- If you are listening to music whilst out and about, please ensure that the volume is at a reasonable level so that you are aware of your surroundings. This is particularly imperative when near roads.

## Avoid damage to your hearing

Damage to your hearing can occur if you are exposed to loud sound for long periods of time. We therefore recommend that you do not turn on or off the handset close to your ear. We also recommend that music and call volumes are set to a reasonable level.

## Blasting area

Do not use the phone where blasting is in progress. Observe restrictions, and follow any regulations or rules.

## Potentially explosive atmospheres

- Do not use the phone at a refueling point.
- Do not use near fuel or chemicals.
- Do not transport or store flammable gas, liquid, or explosives in the same compartment of your vehicle as your mobile phone and accessories.

## In aircraft

Wireless devices can cause interference in aircraft.

- Turn your mobile phone off before boarding any aircraft.
- Do not use it on the ground without permission from the crew.

## Children

Keep the phone in a safe place out of the reach of small children. It includes small parts which may cause a choking hazard if detached.

## Emergency calls

Emergency calls may not be available under all mobile networks. Therefore, you should never depend solely on the phone for emergency calls. Check with your local service provider.

## Battery information and care

- You do not need to completely discharge the battery before recharging. Unlike other battery systems, there is no memory effect that could compromise the battery's performance.
- Use only LG batteries and chargers. LG chargers are designed to maximize the battery life.
- Do not disassemble or short-circuit the battery pack.
- Keep the metal contacts of the battery pack clean.
- Replace the battery when it no longer provides acceptable performance. The battery pack maybe recharged hundreds of times until it needs replacing.
- Recharge the battery if it has not been used for a long time to maximize usability.
- Do not expose the battery charger to direct sunlight or use it in high humidity, such as the bathroom.
- Do not leave the battery in hot or cold places, this may deteriorate the battery performance.
- There is risk of explosion if the battery is replaced by an incorrect type.
- Dispose of used batteries according to the manufacturer's instructions. Please recycle when possible. Do not dispose as household waste.
- If you need to replace the battery, take it to the nearest authorized LG Electronics service point or dealer for assistance.
- Always unplug the charger from the wall socket after the phone is fully charged to save unnecessary power consumption of the charger.





# LG Electronics Warranty Card

Name \_\_\_\_\_  
 Address \_\_\_\_\_  
 \_\_\_\_\_  
 Tel. No. \_\_\_\_\_ Mobile No. \_\_\_\_\_  
 E-mail Address \_\_\_\_\_  
 Product \_\_\_\_\_ Purchase date \_\_\_\_\_  
 Model No. \_\_\_\_\_ Sales Invoice No. \_\_\_\_\_  
 Serial No. \_\_\_\_\_ Store Name \_\_\_\_\_

### Warranty Period

#### Products

Mobile Phone	Transceiver	One (1) year warranty on parts and labor
CTV	Conventional, Flat, Projection, DLP, LCD, Plasma (PDP)	

**This warranty does not cover the following conditions:**

#### Monitor

CRT: 15"	One (1) year warranty on parts and labor
CRT: 17" & above/FLAT CRT/LCD	
Flat/LCD	

- Damage due to fire, water, improper use, accident, force majeure (lightning, earth quake, etc.)

- Tampering or removal of serial number

- Unit has been serviced by anyone other than a duly authorized service center

#### Specific Parts

Conventional/Flat TV	CRT	Five (5) years warranty on parts only
Microwave Oven	Magnetron	
Refrigerator	Compressor	Five (5) years warranty on parts only
Air Conditioner	Compressor, Evaporator, Condenser, Adjoining Tubes & Connectors	
Mobile Phone	Battery and accessories	

- Damaged accessories like remote control, antenna, glass tray, plastic shelves, microphone, promo disc, etc.

Customer's Copy

## Customer Information Center

# 15 Francisco Legaspi Street,  
Maybunga, Pasig City

Hotline:

Manila: **640-2525**

Provincial: 1-800-10-640-2525

Mobile: 0917-824-2525 / 0920-900-2525

Customer's Copy



# LG Electronics Warranty Card

Name \_\_\_\_\_  
 Address \_\_\_\_\_  
 \_\_\_\_\_  
 Tel. No. \_\_\_\_\_ Mobile No. \_\_\_\_\_  
 E-mail Address \_\_\_\_\_  
 \_\_\_\_\_  
 Product \_\_\_\_\_ Purchase date \_\_\_\_\_  
 Model No. \_\_\_\_\_ Sales Invoice No. \_\_\_\_\_  
 Serial No. \_\_\_\_\_ Store Name \_\_\_\_\_

## Warranty Period

### Products

Mobile Phone	Transceiver	One (1) year warranty on parts and labor
CTV	Conventional, Flat, Projection, DLP, LCD, Plasma (PDP)	

### Monitor

CRT 15"	One (1) year warranty on parts and labor
CRT 17" & above/FLAT CRT/LCD	Three (3) years warranty on parts and labor
Flat/LCD	

### Specific Parts

Conventional/Flat TV	CRT	Five (5) years warranty on parts only
Microwave Oven	Magnetron	
Refrigerator	Compressor	
Air Conditioner	Compressor, Evaporator, Condenser, Adjoining Tubes & Connectors	
Mobile Phone	Battery and accessories	Six (6) months warranty on parts only

**This warranty does not cover the following conditions:**

- Damage due to fire, water, improper use, accident, force majeure (lightning, earthquake, etc.)
- Tampering or removal of serial number
- Unit has been serviced by anyone other than a duly authorized service center
- Damaged accessories like remote control, antenna, glass tray, plastic shelves, microphone, promo disc, etc.

www.lge.com

MarCom Copy

 **LG Electronics** Warranty Card

**Mode of payment**

Cash

Card

\_\_\_\_\_ months 0% Interest

**FPS Name** \_\_\_\_\_

**Remarks** (Marketing initiated program/promo/premium/w/product)

\_\_\_\_\_  
\_\_\_\_\_  
\_\_\_\_\_  
\_\_\_\_\_

www.lge.com

MarCom Copy



# LG Electronics Warranty Card

Name \_\_\_\_\_  
 Address \_\_\_\_\_  
 \_\_\_\_\_  
 Tel. No. \_\_\_\_\_ Mobile No. \_\_\_\_\_  
 E-mail Address \_\_\_\_\_  
 \_\_\_\_\_  
 Product \_\_\_\_\_ Purchase date \_\_\_\_\_  
 Model No. \_\_\_\_\_ Sales Invoice No. \_\_\_\_\_  
 Serial No. \_\_\_\_\_ Store Name \_\_\_\_\_

### Warranty Period

#### Products

Mobile Phone	Transceiver	One (1) year warranty on parts and labor
CTV	Conventional, Flat, Projection, DLP, LCD, Plasma (PDP)	

#### Monitor

CRT, 15"	One (1) year warranty on parts and labor
CRT, 17" & above/FLAT CRT,LCD	
FlatLCD	

#### Specific Parts

Conventional/Flat TV	CRT	Five (5) years warranty on parts only
Microwave Oven	Magnetron	
Refrigerator	Compressor	
Air Conditioner	Compressor, Evaporator, Condenser, Adjoining Tubes & Connectors	
Mobile Phone	Battery and accessories	

### This warranty does not cover the following conditions:

- Damage due to fire, water, improper use accident, force majeure (lightning, ear quake, etc.)
- Tampering or removal of serial number
- Unit has been serviced by anyone other than a duly authorized service center
- Damaged accessories like remote control, antenna, glass tray, plastic shelves, microphone, promo disc, etc.

Service Copy

www.lge.com

BUSINESS REPLY ENVELOPE

Business Reply  
permit number SB83 NCR  
No stamp Needed

Postage will be paid by:

**LG Electronics Philippines, Inc.**

# 15 Francisco Legaspi Street  
Maybunga, Pasig City  
1600 Philippines

ATTN: Customer Information Center











