

GB106 USER GUIDE

This manual may differ from the phone depending on the phone software version and service provider used.



P/N: MMBB0332301 (1.1)

Installing the SIM Card and Charging the Battery

Installing the SIM Card

When you subscribe to a cellular network, you are provided with a plug-in SIM card loaded with your subscription details, such as your PIN, any optional services available and many others.

Important!

- > The plug-in SIM card and its contacts can be easily damaged by scratches or bending, so be careful when handling, inserting or removing the card. Keep all SIM cards out of the reach of small children.
- > USIM is not supported in this phone.
- > If the battery is removed for about 1 minute, the clock returns to its default setting. You will then need to reset the time.

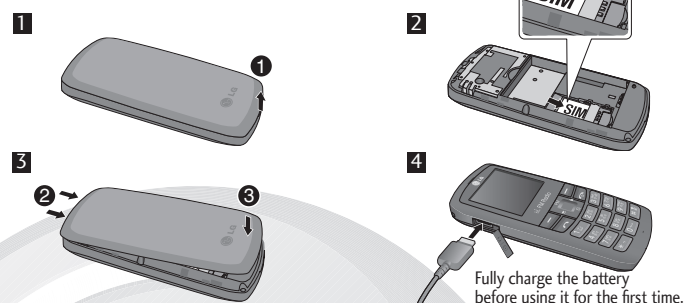

Illustrations

- 1 Open battery cover
- 2 Insert your SIM
- 3 Close battery cover
- 4 Charge your battery

Turning Your Phone On and Off

1. Hold down the [END] key until the phone switches on.
2. To switch the phone off, hold down the [END] key until the power-off image displays.

Making a call

1. Enter a phone number including the area code.
2. Press the [SEND] key to call the number.
3. When finished, press the [END] key.

Answering a call

1. When the phone rings and the phone icon flashes on the screen, press the [SEND] key or the left soft key to answer.
2. If the Any Key menu option (Menu 5.5.2.1), has been set, any key press will answer a call except for the [END] key or the right soft key.
3. End the call by pressing the [END] key.

Note: After the call ends, the phone will go back to standby mode.

Making an international call

1. Press and hold the [0+] key for the international prefix. The '+' character automatically selects the international access code.
2. Enter the country code, area code, and the phone number.
3. Press [SEND] key to call the number.

How to set the tone

Ringtone

1. Press the left soft key [Menu] and select [Settings - Profiles] using the up/down navigation keys.
2. Select [General - Personalise] and choose Ringtones menu.
3. Press the left soft key [OK] and then you can set the desired ringtone.

Tip

> If you want to change your ringer to vibrate, select Vibrate mode or press and hold the [M3] key.

Call alert type, Ring tones, Ring volume, Message alert type, Message tones, Message volume, Keypad tones, Keypad volume, Effect sound volume, Power on/off volume

You can select Call alert type, Ring tones, Ring volume, Message alert type, Message tones, Message volume, Keypad tones, Keypad volume, Effect sound volume, Power on/off volume.

You can change the sound that will occur when a key is pressed, or volume level. [Menu - Settings - Profiles - General - Personalise]

Entering Text

You can enter alphanumeric characters by using the phone's keypad. To change modes, press the [M3] key.

T9 Mode

This mode allows you to enter words with only one keystroke per letter. Each key on the keypad has more than one letter. The T9 mode automatically compares your keystrokes with an internal linguistic dictionary to determine the correct word, thus requiring far fewer keystrokes than the traditional ABC mode.

ABC Mode

This mode allows you to enter letters by pressing the key labeled with the required letter once, twice, three or four times until the letter is displayed.

123 Mode (Numbers Mode)

Type numbers using one keystroke per number.

Symbol Mode

This mode allows you to enter special characters by short pressing [M3] key.

Menu tree

- | | | |
|--|--|--|
| 1. Contacts
1.1 Search
1.2 New contact
1.3 Speed dials
1.4 Copy all
1.5 Delete all
1.6 Memory status
1.7 Information | 3. Call history
3.1 All calls
3.2 Missed calls
3.3 Dialed calls
3.4 Received calls
3.5 Call duration | 5. Settings
5.1 Profiles
5.2 Date & Time
5.3 Language
5.4 Display
5.5 Call
5.6 Auto keylock
5.7 Security
5.8 Power save
5.9 Network selection
5.0 Reset settings
5.* Memory status |
| 2. Messaging
2.1 New message
2.2 Inbox
2.3 Drafts
2.4 Outbox
2.5 Sent
2.6 Listen voice mail
2.7 Info messages
2.8 Templates
2.9 Settings | 4. Tools
4.1 Games
4.2 FM radio*
4.3 Calculator
4.4 Stopwatch
4.5 Unit Converter
4.6 World clock | 6. Organizer (SIM Services)**
6.1 Alarm
6.2 Calendar
6.3 Memo |

** In case SIM Services are also provided by the service provider then Menu 6 will be SIM Services and Organizer will be under Menu 4. Tools.

Phone Components



FM Radio

(This function may be different in different regions.)

1. Press the corresponding number key of a channel to store the selected radio station.
2. After presetting radio channels, you can listen to another channel by pressing the corresponding number key.
3. You can access the following option menus by pressing the left soft key [Options].
 - > **Edit channel:** You can adjust frequency and channel 0.1 MHz at a time using the Left/Right navigation keys and number keys.
 - > **Auto scan:** If you turn "Auto Scan Now?" on, this automatically sets the radio channel. When "Save this Station?" message pops up and you select Yes, the selected frequency will be stored.
 - > **Reset channels:** You can delete all channels you saved.
 - > **Listen via speaker:** You can listen to the FM radio via built-in speaker. When you select [Options - Listen via wired headset] and connect the ear-mic then you can listen via headset.

Note

> Intenna FM (Wireless FM antenna): In weak FM radio signal area the sensitivity can degrade with wireless antenna mode. So it is advisable to insert the ear-mic for better & enhanced FM quality.

Display Information

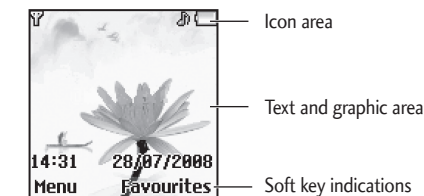

On-Screen Icons

The table below describes various display indicators or icons that appear on the phone's display screen.

[Signal strength icon]	Tells you the strength of the network signal.
[Call icon]	Call is connected.
[Roaming icon]	Shows that you are using a roaming service.
[Alarm icon]	The alarm has been set and is on.
[Battery icon]	Tells you the status of the battery.
[Text message icon]	You have received a text message.
[Voice message icon]	You have received a voice message.
[Vibrate icon]	Vibrate only menu in profile.
[General menu icon]	General menu in profile.
[Outdoor menu icon]	Outdoor menu in profile.
[Silent menu icon]	Silent menu in profile.
[Headset menu icon]	Headset menu in profile.
[Schedule icon]	You can view your schedule.

Anti-theft Mobile Tracker (ATMT)

1. The ATMT feature of this phone provides you with the ability to have a tracking system in place for your Mobile in case you lose or misplace it.
2. The moment an un-authorized user uses your phone, a SMS is triggered from your phone and the Message is sent to your pre-defined number.
3. Setting the ATMT ON [Menu - Settings - Security]
 - > Select Anti-theft Mobile Tracker
 - > Set ATMT and Select ON
 - > Press OK and enter default ATMT code

Note

- > In case you want to use your phone with some other SIM card, make sure to set the ATMT OFF.
- > It is recommended to enter the Number for ATMT with the country code (e.g. for INDIA +91 followed by mobile number)
- > Default ATMT code is "0000".

Quick feature reference

This section provides brief explanations of features on your phone.

Contacts Menu 1

- Search** You can Search for contacts in Phonebook.
 Note: Instant searching is available by inputting the initial letter of the name you want to search.
- New contact** You can add phonebook entries by using this menu.
- Speed dials** Assign contacts to any of keys between [2-9] and [9-9].
- Copy all** You can copy all entries from SIM card memory to Phone memory and also from Phone memory to SIM card memory.
- Delete all** You can delete all entries from SIM card memory or Phone memory.
- Memory status** You can check free space and memory usage.
- Information**
 - > **Service dial numbers:** Access the list of service numbers assigned by service provider safely.
 - > **Own numbers:** You can save and check your own numbers in SIM card.
 - > **Business card:** This option allows you to create your own business card featuring your name, mobile phone number and so on.

Messaging Menu 2

This menu includes functions related to SMS (Short Message Services).

- New message** This menu allows you to type a new message.
- Inbox** You will be alerted when you have received a message.
- Drafts** This menu shows the saved message.
- Outbox** This menu allows to view the message which is about to be sent or has failed to be sent.
- Sent** This menu allows you to view the messages which have already been sent, including time and content.
- Listen voice mail** This menu provides you with a quick way of accessing your voice mailbox (if provided by your network).
- Info message** Info service messages are text messages delivered by the network to your handset.
- Templates** There are pre-defined messages in the list. You can view and edit the template messages or create new messages.
- Settings** This menu allows you to set features of your network service provider.

Call history Menu 3

You can check the record of missed, received, and dialed calls only if the network supports the Calling Line Identification (CLI) within the service area. The number and name (if available) are displayed together with the date and time at which the call was made. You can also view call durations.

All calls	Displays all the lists of three types (Received/Dialed/Missed calls) by time.
Missed calls	This option lets you view the last 20 unanswered calls.
Dialed calls	This option lets you view the last 20 outgoing calls (called or attempted).
Received calls	This option lets you view the last 20 incoming calls.
Call duration	Allows you to view the duration of your incoming and outgoing calls.

Tools Menu 4

Games	Has List of default games available in the phone.
FM Radio	You can search radio stations and enjoy listening to the radio.
Calculator	This contains the standard functions such as +, -, x, ÷: Addition, Subtraction, Multiplication and Division.
Stopwatch	Stopwatch is available just as common stopwatches we see and use in daily life.
Unit Converter	This converts any measurement into a unit you want.
World clock	Allows you to determine the current time in another time zone or country.

Guidelines for safe and efficient use (Continued)

Electronic devices

All mobile phones may get interference, which could affect performance.

- Do not use your mobile phone near medical equipment without requesting permission. Avoid placing the phone over a pacemaker, i.e. in your breast pocket.

Road safety

Check the laws and regulations on the use of mobile phones in the areas when you drive.

- Do not use a hand-held phone while driving.
- Use a hands-free kit, if available.
- Pull off the road and park before making or answering a call if driving conditions so require.

Blasting area

Do not use the phone where blasting is in progress. Observe restrictions, and follow any regulations or rules.

Potentially explosive atmospheres

Do not use the phone at a refueling point. Do not use near fuel or chemicals.

In aircraft

Wireless devices can cause interference in aircraft.

- Turn off your mobile phone before boarding any aircraft.

Settings Menu 5

You can set the following menus for your convenience and preferences.

Profiles	You can adjust and customize the phone tones.
Date & Time	You can set functions relating to the date and time.
Language	You can change the language for the display texts in your phone. This change will also affect the Language Input mode.
Display	You can change settings for the phone display.
Call	You can set the menu relevant to a call.
Auto keypad	When this feature is enabled, the phone keypad is locked.
Security	This menu allows you to set the phone safely.

- PIN code request:** You can set the phone to ask for the PIN code of your SIM card when the phone is switched on.
- Phone lock:** You can use a security code to avoid unauthorized use of the phone.
- Call barring:** The Call barring service prevents your phone from making or receiving a certain category of calls. This function requires the call barring password.
- Fixed dial number (SIM dependent):** You can restrict your outgoing calls to selected phone numbers. The numbers are protected by your PIN2 code. The numbers you wish to allow access to once this service has been enabled, must be added to the contacts after enabling Fixed dial number.

Guidelines for safe and efficient use (Continued)

Children

Keep the phone in a safe place out of children's reach. It includes small parts which if detached may cause a choking hazard.

Emergency calls

Emergency calls may not be available under all cellular networks. Therefore, you should never depend solely on the phone for emergency calls. Check with your local service provider.

Battery information and care.

- You do not need to completely discharge the battery before recharging. Unlike other battery systems, there is no memory effect that could compromise the battery's performance.
- Use only LG batteries and chargers. LG chargers are designed to maximize the battery life.
- Do not disassemble or short-circuit the battery pack.
- Replace the battery when it no longer provides acceptable performance. The battery pack may be recharged hundreds of times before it needs to be replaced.
- Do not expose the battery charger to direct sunlight or use it in high humidity, such as the bathroom.
- Risk of explosion if battery is replaced by an incorrect type.
- Dispose off used batteries according to the manufacturer's instructions.

Settings Menu 5 (Continued)

Security (Continued)	<ul style="list-style-type: none"> Anti-theft Mobile Tracker: The ATMT feature of this phone provides you with the ability to have a tracking system in place for your mobile in case you lose or misplace it. Change codes: PIN is an abbreviation of Personal Identification Number to prevent use by unauthorized persons. You can change the access codes: Security code, PIN code, PIN2 code, ATMT code.
-----------------------------	---

Power save	If you set this to On, you can save the power when you are not using the phone.
-------------------	---

Network selection	You can select a network that will be registered either automatically or manually. Usually, the network selection is set to Automatic.
--------------------------	--

Reset settings	You can initialize all setting values as defaults. You need a Security code to activate this function.
-----------------------	--

Memory status	You can check free space and memory usage of each repository.
----------------------	---

Organizer Menu 6

Alarm	Allows you to set one of three alarms. The current time is displayed at the top of the screen when you select an alarm to set. At the alarm time, the Alarm icon will be displayed on the LCD screen and the alarm will sound.
Calendar	You can check track of daily or monthly schedules.
Memo	You can create a list of tasks.

Guidelines for safe and efficient use (Continued)

Exposure to radio frequency energy

Radio wave exposure and Specific Absorption Rate (SAR) information

This mobile phone model has been designed to comply with applicable safety requirement for exposure to radio waves. This requirement is based on scientific guidelines that include safety margins designed to ensure safety of all persons, regardless of age and health.

- The radio wave exposure guidelines employ a unit of measurement known as the Specific Absorption Rate, or SAR. Tests for SAR are conducted using standardized methods with the phone transmitting at its highest certified power level in all used frequency bands.
- While there may be differences between the SAR levels of various LG phone models, they are all designed to meet the relevant guidelines for exposure to radio waves.
- The SAR limit recommended by the international Commission on Non-Ionizing Radiation Protection (ICNIRP) is 2W/kg averaged over ten (10) gram of tissue.
- The highest SAR value for this model phone tested by DASY4 for use at the ear/body is [0.686/482] W/kg (10g).
- SAR data information for residents in countries/regions that have adopted the SAR limit recommended by the Institute of Electrical and Electronics Engineers (IEEE) is 1.6 W/kg averaged over one (1) gram of tissue.

Guidelines for safe and efficient use

Please read these simple guidelines. Ignoring them may be dangerous or illegal. Further detailed information is given in this manual.

Warning

- For your safety, use ONLY specified ORIGINAL batteries and chargers.
- Switch off the phone in any area where required by special regulations, e.g. in a hospital where it may affect medical equipment.
- Batteries should be disposed off in accordance with relevant legislation.

Product care and maintenance

WARNING! Only use batteries, chargers and accessories approved for use with this particular phone model. The use of any other types may invalidate any approval or warranty applying to the phone, and may be dangerous.

- Do not disassemble this unit. Take it to a qualified service technician when repair work is required.
- The unit should be kept away from heat sources such as radiators or cookers.
- Use a dry cloth to clean the exterior of the unit. (Do not use any solvents.)
- Do not keep the phone next to credit cards or transport tickets; it can affect the information on the magnetic strips.

Technical Data

General

- Product name :** GB106
- System :** GSM 900 / DCS 1800
- Max. :** +55°C, Charging (+45°C)
- Min. :** -10°C

Battery Specification

- Type :** 950 mAh, LI-Ion
- Talk Time* :** Up to 10hrs

Note!

- Variation in operation time may occur depending on SIM card, network condition, usage style, usage setting and environment.*

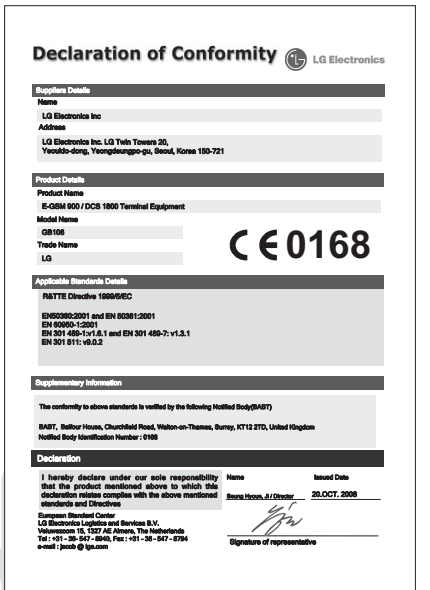

सिम कार्ड स्थापित करना और बैटरी को चार्ज करना

सिम कार्ड स्थापित करना

जब आप किसी सेल्युलर नेटवर्क की सेवाएं लेते हैं, तो आपको एक सिम कार्ड दिया जाता है जिसमें आपकी ग्राहकी के ब्योरे, जैसे आपका पिन, उपलब्ध वैकल्पिक सेवाएं और कई अन्य ब्योरे लोड होते हैं। सिम कार्ड को छोटे बच्चों की पहुंच से दूर रखें।

इस फोन में USIM समर्थित नहीं है।

अगर बैटरी को लगभग 1 मिनट के लिए निकाल दिया जाता है, तब घड़ी अपनी डिफॉल्ट सेटिंग पर आ जाती है। फिर आपको पुनः समय सेट करने की आवश्यकता होगी।

चित्र

- 1 बैटरी कवर खोलें
- 2 सिम कार्ड डालें
- 3 बैटरी कवर को बंद करें
- 4 बैटरी को चार्ज करें

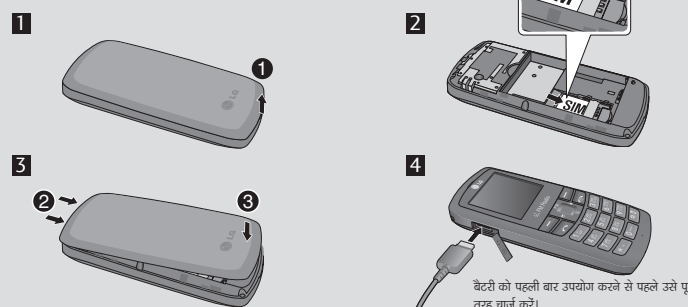

फोन के अवयव

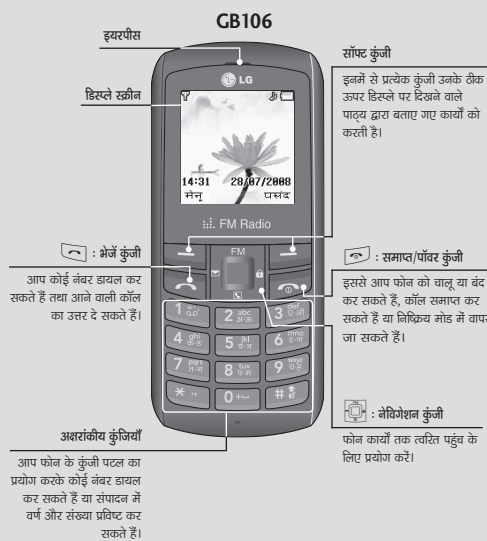

अक्षर व अंक प्रविष्ट करने की तालिका

कुंजी	1 बार	2 बार	3 बार	4 बार	5 बार	6 बार	7 बार	8 बार	9 बार	10 बार	11 बार	12 बार	13 बार	14 बार
1	ॐ	ं	ः	ॠ	ॡ	1								
2	ा	ि	ी	ु	ू	ॡ	अ	आ	इ	ई	उ	ऊ	ॠ	ॡ
3	े	ै	ॐ	ो	ौ	ॠ	ए	ऐ	ॠ	ऑ	औ	ऑ	ॠ	ॡ
4	क	ख	ग	घ	ङ	च	छ	ज	झ	ञ				
5	ट	ठ	ड	ढ	ण	त	थ	द	ध	न				
6	प	फ	ब	भ	म	य	र	ल	व	श	ष	स	ह	ॠ
7	०	१	२	३	४	५	६	७	८	९				
8	०	१	२	३	४	५	६	७	८	९				
9	०	१	२	३	४	५	६	७	८	९				
0	०	१	२	३	४	५	६	७	८	९				

हिन्दी शब्द लिखने के उदाहरण

- कितাব**
क :- कुंजी 4 को 1 बार दबाएं।
ि :- कुंजी 2 को 2 बार दबाएं।
त :- कुंजी 7 को 1 बार दबाएं।
त :- कुंजी 2 को 1 बार दबाएं।
ब :- कुंजी 8 को 3 बार दबाएं।
- क्षत्रिय**
क :- कुंजी 4 को 1 बार दबाएं।
ि :- कुंजी 1 को 4 बार दबाएं।
ष :- कुंजी 9 को 6 बार दबाएं।
त :- कुंजी 7 को 1 बार दबाएं।
ि :- कुंजी 1 को 4 बार दबाएं।
र :- कुंजी 9 को 2 बार दबाएं।
ि :- कुंजी 2 को 2 बार दबाएं।
य :- कुंजी 9 को 1 बार दबाएं।
- ज्ञानी**
ज :- कुंजी 5 को 3 बार दबाएं।
ि :- कुंजी 1 को 4 बार दबाएं।
ज :- कुंजी 5 को 5 बार दबाएं।
त :- कुंजी 2 को 1 बार दबाएं।
न :- कुंजी 7 को 5 बार दबाएं।
ी :- कुंजी 2 को 3 बार दबाएं।

एफ एम रेडियो (यह फंक्शन अलग-अलग क्षेत्रों में भिन्न-भिन्न हो सकता है।)

- रेडियो चैनलों को सेट करने के लिए अनुकूल नंबर कुंजी को दबाएं।
- रेडियो चैनलों को पहले से सेट करने के बाद, आप संबंधित नंबर कुंजी को दबाकर दूसरा चैनल सुन सकते हैं।
- आप बाई सोफ्ट कुंजी [सॉफ्ट] [विकल्प] को दबाकर निम्नलिखित विकल्प मेनू में जा सकते हैं।
 - चैनल संपादित करें आप बाई/दाई नेविगेशन कुंजियों और नंबर कुंजियों का प्रयोग करके बारी-बारी से फ्रीक्वेंसी और चैनल 0.1 MHz से आगे-पीछे कर सकते हैं।
 - स्वतः स्कैन यदि आप "अभी स्वतः स्कैन करें?" को चालू करेंगे, तो इससे रेडियो चैनल स्वतः सेट हो जाएंगे। जब "यह स्कैन को रोकें?" संदेश उभरता है और आप "हां" चुनते हैं, तो चयनित फ्रीक्वेंसी संवित हो जाएगी।
 - चैनल रीसेट करें आप रोकित किए गए सभी चैनलों को मिटा सकते हैं।
 - स्पीकर से सुनना आप एफएम रेडियो को फोन में निर्मित स्पीकर द्वारा सुन सकते हैं। जब आप [विकल्प-वायर्ड हेडसेट] द्वारा सुनें। चुनें और हेडसेट लगाएँ, तब आप हेडसेट द्वारा सुन सकते हैं।

नोट:

- इन्टेना एफएम (वायरलेस एफएम ऐन्टेना) कमज़ोर रेडियो संकेत क्षेत्र में, वायरलेस ऐन्टेना मोड में संवेदनशीलता कम हो सकती है। इसलिए, ये सलाह दी जाती है कि वेक्टर और बंदिया एफएम गुणवत्ता के लिए हेडसेट लगाएँ।