



CE 0168 P/N: MMB0366380 (1.0)

GS106 User Guide - English

This guide will help you understand your new mobile phone. It will provide you with useful explanations of features on your phone. Some of the contents in this manual may differ from your phone depending on the software of the phone or your service provider.



Getting to know your phone



Menu map

Messaging 1 New message 2 Inbox 3 Drafts 4 Outbox 5 Sent 6 Listen voice mail 7 Info messages 8 Templates 9 Settings	Contacts 1 Search 2 New contact 3 Speed dials 4 Copy all 5 Delete all 6 Memory status 7 Information	Call history 1 All calls 2 Missed calls 3 Dialed calls 4 Received calls 5 Call duration	Games 1 Space ball	FM radio
Profiles 1 General 2 Silent 3 Vibrate only 4 Outdoor 5 Flight mode 6 Headset	Tools 1 Fake call 2 Calculator 3 Stopwatch 4 Unit converter 5 World clock	Organiser 1 Alarm 2 Calendar 3 Memo	Settings 1 Date & Time 2 Language 3 Display 4 Call 5 Auto keylock 6 Security 7 Power save 8 Network selection 9 Reset settings 0 Memory status	

Contacts

Searching for a contact

You can search for a contact in your contacts.

- 1 Press **Contacts** and choose **Search**, select **Contacts** from the **Menu** screen or press from the standby screen.
- 2 Using the keypad enter the first letter of the contact you want to call.
- 3 To scroll through the contacts use up and down navigation key and to scroll through their different numbers use left and right navigation keys.

Messaging

Sending a message

- 1 Press **Menu**, select **Messaging** and choose **New message**.
- 2 A new message editor will open. The default setting of the message editor is SMS mode.
- 3 Enter your message using either the T9 predictive mode or Abc manual mode. You can switch text input mode by pressing .
- 4 Press **Options** and choose **Insert** to add an **Symbol**, **Template**, **Contact**, **Business card**.
- 5 Press **Options** and **Send to**.
- 6 Enter the phone number or press **Options** and select **Contacts** or **Recent list** to open your contacts list.
- 7 Press **Options** and **Send**.

Profiles

Changing your profiles

You change your profile by pressing **Menu**>**Profiles**, then choose from General, Silent, Vibrate only, Outdoor, Flight mode and Headset.

Using flight mode (Menu > Profiles > Flight mode)

Use this function to switch the flight mode On or Off You will not be able to make calls, Connect to the internet, Send messages when Flight mode is switched On.

Tools / Organiser

Using your calculator (Menu > Tools > Calculator)

The calculator provides the basic arithmetic functions: addition, subtraction, multiplication and division.

Using the stopwatch (Menu > Tools > Stopwatch)

This option allows you to use the function of a stopwatch.

Converting a unit (Menu > Tools > Unit converter)

This converts many measurements into a unit you want.

Adding a city to your world clock (Menu > Tools > World clock)

You can check the current time of Greenwich Mean Time (GMT) and major cities around the world.

Calls

Making a call

- 1 Key in the number using the keypad.
 - 2 Press to initiate the call.
 - 3 To end the call, press .
- TIP!** To enter + when making an international call, press and hold 0.

Making a call from your contacts

- 1 Press to open the address book.
- 2 Using the keypad, enter the first letter of the contact you want to call.
- 3 To scroll through the contacts and their different numbers use and .
- 4 Press to initiate the call.

Entering text

You can enter alphanumeric characters using the phone's keypad. For example, storing names in Contacts, writing a message and creating scheduling events in the calendar all require entering text. The following text input methods are available in the phone: T9 predictive mode, ABC manual mode and 123 mode.

Note: Some fields may allow only one text input mode (e.g. telephone number in address book fields).

T9 predictive mode

T9 predictive mode uses a built-in dictionary to recognise words you're writing based on the key sequences you press. Simply press the number key associated with the letter you want to enter, and the dictionary will recognise the word once all the letters are entered.

ABC manual mode

This mode allows you to enter letters by pressing the key labeled with the required letter once, twice, three or four times until the letter is displayed.

123 mode

Type numbers using one keystroke per number. You can also add numbers while remaining in letter modes by pressing and holding the desired key.

Setting your alarm (Menu > Organiser > Alarm)

You can set up to 3 alarm clocks to go off at a specified time.

Using the calendar (Menu > Organiser > Calendar)

When you enter this menu, a calendar appears. A square cursor is located on the current date. You can move the cursor to another date using the navigation keys.

Adding a memo (Menu > Organiser > Memo)

You can register your own memos here.

Settings

Changing your date & time (Menu > Settings > Date & Time)

You can set functions relating to the date and time.

Changing the language (Menu > Settings > Language)

You can change the language for the display texts in your phone. This change will also affect the language input mode.

Changing your display settings (Menu > Settings > Display)

You can change the settings for the phone display.

Installing the SIM Card and Charging the Battery

Installing the SIM Card

When you subscribe to a cellular network, you are provided with a plug-in SIM card loaded with your subscription details, such as your PIN, any optional services available and many others.

Important! The plug-in SIM card and its contacts can be easily damaged by scratches or bending, so be careful when handling, inserting or removing the card. Keep all SIM cards out of the reach of small children.
> only 2G/2.5G SIM supported

Illustrations

- 1 Open battery cover
- 2 Remove the battery
- 3 Insert your SIM
- 4 Close the battery cover
- 5 Charge your battery

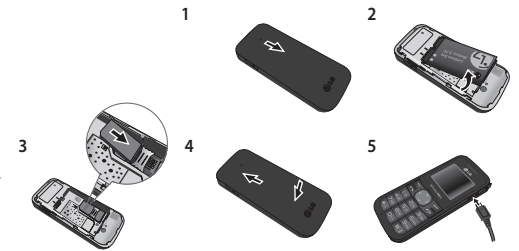

WARNING: Do not remove the battery when the phone is switched on, as this may damage the phone.

Answering and rejecting a call

When your phone rings, press **Accept** or press to answer the call. While your phone is ringing, select **Silent** to mute the ringing. This is great if you have forgotten to change your profile to **Silent** for a meeting.

Press or **Reject** to reject the incoming call.

TIP! You can change the settings on your phone to answer your calls in different ways. Press **Menu**, select **Settings** and choose **Call**. Select **Answer mode** and choose from **Any key** or **send key only**.

Changing the call settings

You can set the menu relevant to a call. Press **Menu**, select **Settings** and choose **Call**.

- **Call divert** – Select methods of call divert.
- **Call waiting** – Select activate or cancel call waiting.

FM radio (Wireless FM)

With embedded FM antenna, you can receive FM radio without an external earphone. You can listen to your favor radio station anytime.

Note: In weak FM radio signal area the sensitivity can degrade with wireless and antenna mode. So it is advisable to insert the ear-mic for better and enhanced FM quality.

Listening to the radio

- 1 Press **Menu** and select **FM radio**.
- 2 Select the channel number of the station you would like to listen to.

Note: You can listen to the radio via built-in speaker. Press **Options**, select **Listen via Speaker**.

Games

Your GS106 comes with preloaded games to keep you amused when you have time to spare. If you choose to download any additional games or applications they will be saved into this folder. Press **Menu** and select **Games**.

Changing your security settings (Menu > Settings > Security)

Change your security settings to keep your GS106 and the important information it holds protected.

- **PIN code request** - Choose a PIN code to be requested when you turn your phone on.
- **Phone lock** - Choose a security code to lock your phone, **When power on**, **When SIM changed** or **Immediately**.
- **Anti Theft Mobile Tracker** - When the handset is stolen, handset sends the SMS to the numbers configured by real owner. User has to configure the ATMT settings with name, primary phone number, secondary number. User has to Set ATMT ON to activate the ATMT feature. Default ATMT code is "0000". ATMT SMS will contain information about the stolen phone IMEI, current location & number of the person who is using that handset.
- **Change codes** - Change your **Security code**, **PIN code**, **PIN2 code** or **ATMT code**.

Power save (Menu > Settings > Power save)

If you set **Always on**, you can save the battery power when you don't use the phone. Choose to switch the power save settings **Always on**, **Night only** or **Off**.

Resetting your phone (Menu > Settings > Reset settings)

Use **Reset** to reset all the settings to their factory definitions. You need the security code to activate this function. The default number is "0000".

