



# LG-A190 User Guide - English

This guide will help you to understand your new mobile phone. It will provide you with useful explanations of the features on your phone.

Some of the contents of this manual may differ from your phone depending on the phone software or your service provider.

## Product Authentication program

Dear Customers,  
To protect all LG customers from counterfeit and grey market products and make sure that you receive off cial warranty service, LG is now running a product authentication program. To make sure your handset is a genuine product of LG, ONLY one SMS containing the IMEI No. of your purchased handset will be automatically sent to LG on the date of purchase. Once your phone is authenticated, you will receive the message 'Your handset is a genuine LG product.' The customer shall bear the cost of one SMS for the product authentication program. In return, you will receive one additional month of warranty for free. One additional month of warranty covers only mobile phone, not batteries and accessories. The IMEI No. sent to LG guarantees your handset to be free from manufacturing defects during the warranty period from the date of purchase without proof of purchase or warranty card.

P/N: MFL67217604 (1.0)



www.lg.com

## Getting to know your phone

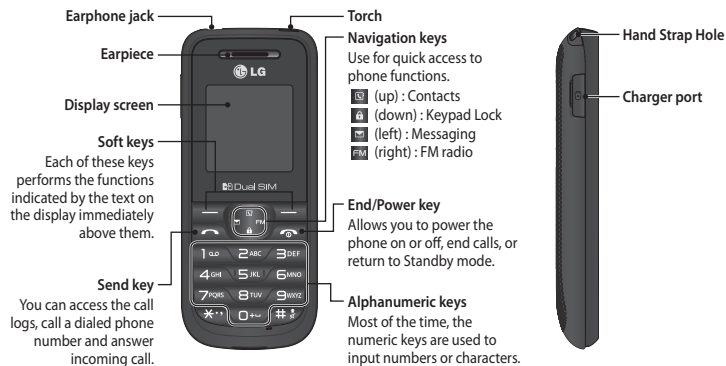

## Installing the SIM Card and Charging the Battery

### Installing the SIM Card

**Important!** The SIM Card and its contacts can easily be damaged by scratches or bending, so be careful when handling, inserting or removing the card. Keep all SIM cards out of reach of small children.

### Illustrations

- 1 Open battery cover
- 2 Remove the battery
- 3 Insert your SIM
- 4 Insert the battery
- 5 Close the battery cover
- 6 Charge your battery

**WARNING:** Do not remove the battery while the phone is switched on, as this may damage the phone.

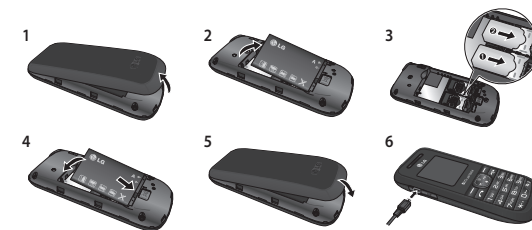

## Display Information

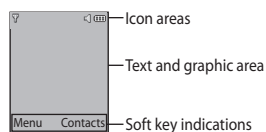

## On-Screen Icons

	Tells you the strength of the network signal.
	Indicates the battery charge level.
	Indicates new text message(s).
	Indicates new voice message(s).
	Indicates that the alarm clock is set.
	Indicates that your phone is using the general settings.
	Indicates that your phone is using the silent settings.
	Indicates that your phone is using the outdoor settings.
	Indicates that your phone is using the headset setting.
	Indicates that all calls are being diverted to another number.
	Indicates that your phone is in Flight mode.
	Indicates new schedule(s).

## Menu and Options

Your phone offers a set of functions that allow you to customise it. These functions are arranged in menus and sub-menus, which are accessed via the left and right soft keys. The label at the bottom of the display screen, above the soft keys indicates their current function.

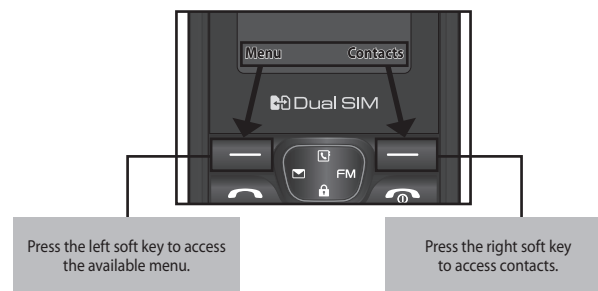

## Making a call from your contacts

- 1 Press (up) to open the contacts.
- 2 On the keypad, enter the first few letters of the contact you want to call.
- 3 To scroll through your contacts, use the up and down navigation keys. And to scroll through their different numbers, use the left and right navigation keys.
- 4 Press to initiate the call.

## Answering and rejecting a call

When your phone rings, press **Accept** or press to answer the call. While your phone is ringing, select **Silent** to mute the ringing. This is used if you have forgotten to change your profile to Silent for a meeting.

Press or **Reject** to reject the incoming call.

**TIP!** You can change the settings on your phone to answer your calls in different ways. Press **Menu**, select **Settings** and press **Call** choose **Common settings**. Select **Answer mode** and choose **Any key** or **Send key only**.

- **Any key** – You can answer a call by pressing any key.

- **Send key only** – You can answer a call only by pressing the Send key.

## Changing your call settings

You can set the menu depending on the call. Press **Menu**, select **Settings** and press **Call** then choose **SIM1** or **SIM2**.

- **Call divert** – Select methods for diverting calls.
- **Call waiting** – Select Active or cancel call waiting.
- **Fixed dial number** – Entering a PIN2 code to enable fixed dial number lets you restrict calls to only those in Contacts.

## Checking your call history

You can check the record of all, missed, dialled, received calls and call durations. The number and name (if available) are displayed together with the date and time at which the call was made. You can also view the number of times you have called. Press **Menu**, select **Call history**.

## Information

- **Service dial numbers** – Access the list of service numbers assigned by your service provider securely.
- **Own number** – You can save and check your own numbers on the SIM card.
- **Business card** – You can save and check your business card containing information including your name, mobile, home, office and email, and send it in a message.

## Call history

You can check the record of all, missed, dialled, received calls and call durations. The number and name (if available) are displayed together with the date and time at which the call was made. You can also view the number of times you have called.

- **All calls** – Displays the lists of all three types (Received/Dialled/Missed calls) by time.
- **Missed calls** – This option lets you view the last 20 unanswered calls.
- **Dialled calls** – This option lets you view the last 20 outgoing calls (called or attempted).
- **Received calls** – This option lets you view the last 20 received calls.
- **Call duration** – Allows you to view the duration of your incoming and outgoing calls.

## Quick feature reference

### Messaging

#### Sending a message

- 1 Press **Menu**, select **Messaging** and choose **New message**.
  - 2 A new message editor will open. The default setting of the message editor is SMS mode.
  - 3 Enter your message using either the T9 predictive mode or Abc manual mode or 123 mode. You can switch text input modes by pressing .
  - 4 Press **Options** and choose **Insert** to add **Symbol**, **Template**, **Contact**, **Business card**.
  - 5 Press **Send to**.
  - 6 Enter the phone number or press **Options** and select **Contacts** or **Recent list** to open your contacts list.
  - 7 Press **Options** and choose **Send**.
- **Inbox** – You will be alerted when you have received a message. It will also be saved here.
  - **Drafts** – This menu shows the message you have saved.
  - **Outbox** – This menu allows you to view the message which is about to be send or that have failed to send.
  - **Sent** – This menu allows you to view the messages which have already been sent, including time and content.

## Games

Your LG-A190 comes with preloaded games to keep you amused when you have time to spare. Press **Menu** and select **Games**.

## FM radio (Wireless FM)

With embedded FM antenna, you can receive FM radio without an external earphone. You can listen to your favourite radio station anytime.

**Note:** In weak FM radio signal area the sensitivity can degrade with wireless and antenna mode. So it is advisable to insert the ear-mic for better and enhanced FM quality.

### Listening to the radio

- 1 Press **Menu** and select **FM radio**.
  - 2 Select the channel number of the station you would like to listen to.
- Note:** You can listen to the radio via built-in speaker. Press **Options**, select **Listen via Speaker** when ear-mic is inserted.

You can enter alphanumeric characters via the phone's keypad. For example, storing names in **Contacts**, writing a message and scheduling events in the calendar all require entering text. To change modes, press the key. The input method is displayed in the upper right corner of your phone.

Indicator	Function (English Smart mode)
	Numeric
	Multitap Abc
	Multitap abc
	Multitap ABC

## T9 Mode

In Editor, Press **Options** Choose "Set T9" Select On. This mode allows you to enter words with only one keystroke per letter. Each key on the keypad is associated with more than one letter. T9 mode automatically compares your keystrokes with an internal linguistic dictionary to determine the correct word, thus requiring far fewer keystrokes than the traditional ABC mode.

## Turning Your Phone On and Off

You can power the phone on and off by pressing or holding the power key.

## Making a Call

- 1 Key in the number on the keypad.
- 2 Press to initiate the call.
- 3 To end the call, press .

**TIP!** To enter + when making an international call, press and hold 0.

- **Listen voicemail** – This menu provides you with a quick way to access your voice mailbox.
- **Info messages** – Info service messages are text messages that are delivered by the network to your handset.
- **Templates** – There are pre-defined messages in the list. You can view and edit the template messages or create new messages.
- **Settings** – This menu allows you to set the features of your network service provider.

## Contacts

You can search for a contact in your Contacts.

- 1 Press **Contacts**(Up navigation key) and choose **Search** or press (right soft key) from the standby screen or select **Contacts** from the Menu screen.
  - 2 On the keypad, enter the first few letters of the contact you want to call.
  - 3 To scroll through the contacts, use the up and down navigation keys. To scroll through their different numbers use the left and right navigation keys.
- **New contact** – You can add phonebook entries by using this menu.
  - **Speed dials** – Assign contacts to any keys between 2 and 8.
  - **Copy all** – You can copy all entries from the SIM card memory to the Phone memory or from the Phone memory to the SIM card memory.
  - **Delete all** – You can delete all entries from the SIM card memory or Phone memory.
  - **Memory status** – You can check the memory status of your SIM and phone.

## Profiles

You change your profile, then choose from General, Silent, Outdoor, Flight mode and Headset.

- **General** – After setting up this profile, the indicator will be displayed on the standby screen.
- **Silent** – Ring tone is disabled and Vibrate is activated. When you set up this profile, the indicator will be displayed on the standby screen.
- **Outdoor** – This is the default profile. Ring tone and key tone volume are set to maximum. When you set up this profile, the indicator will be displayed on the standby screen.
- **Flight mode** – Use this function to switch the Flight mode On or Off. You will not be able to make calls or send messages also cannot play FM radio when **Flight mode** is switched On.
- **Headset** – When the headset is connected to the phone, the indicator will be displayed on the standby screen. You can personalise your call alert type, ring tones, ring volume, message alert type, message tones, message volume, keypad tones, keypad volume, effect sound volume and power on/off volume.

## Tools

- Torch** – You can turn the torch ON/OFF here. Also Turn on/off the torch directly by holding the up navigation key for 3 seconds in the idle screen.
- Self call** – This is a useful function for avoiding awkward situation politely. You can call yourself by setting the time in self call menu.
- Calculator** – This contains the standard functions such as Addition, Subtraction, Multiplication and Division.
- Stopwatch** – This option allows you to use the function of a stopwatch.
- Unit converter** – This converts many measurement into a unit you want.
- World clock** – Allows you to determine the current time in another time zone or country.

## Organiser

- Alarms** – You can set up to 3 alarm clocks to go on at a specified time.
- Calendar** – When you enter this menu, a calendar appears. A square cursor is placed on the current date. You can move the cursor to another date using the navigation keys, also you can set scheduler for desired date and time.
- Memo** – You can register your own memos here.

LG Optimus V battery pack

LG Optimus V battery pack

LG Optimus V battery pack

LG Optimus V battery pack

LG Optimus V battery pack

### Guidelines for safe and efficient use

Please read these simple guidelines. Failure to follow these guidelines may be dangerous or illegal. More detailed information is given in this manual.

**⚠ WARNING**

- Mobile phones must be switched off at all times in an aircraft.
- Do not hold the phone in your hand while driving.
- Do not use your phone near petrol stations, fuel depots, chemical plants or blasting operations.
- For your safety, use ONLY specified ORIGINAL batteries and chargers.
- Do not handle the phone with wet hands while it is being charged. It may cause an electric shock or seriously damage your phone.
- Keep the phone in a safe place out of reach of small children. It includes small parts which if detached may present a choking hazard.
- Do not charge the phone when it is on soft furnishings.
- The phone should be charged in a well ventilated area.

#### CAUTION

- Switch the phone off in any area where required by special regulations. For example, do not use your phone in hospitals or it may affect sensitive medical equipment.
- Emergency calls may not be available on all mobile networks. Therefore, you should never depend solely on the phone for emergency calls.

LG Optimus V battery pack

LG Optimus V battery pack

LG Optimus V battery pack

LG Optimus V battery pack

LG Optimus V battery pack

LG Optimus V battery pack

LG Optimus V battery pack

LG Optimus V battery pack

LG Optimus V battery pack

LG Optimus V battery pack

LG Optimus V battery pack

LG Optimus V battery pack

LG Optimus V battery pack

LG Optimus V battery pack

LG Optimus V battery pack

LG Optimus V battery pack

LG Optimus V battery pack

LG Optimus V battery pack

LG Optimus V battery pack

LG Optimus V battery pack

LG Optimus V battery pack

LG Optimus V battery pack

LG Optimus V battery pack

LG Optimus V battery pack

LG Optimus V battery pack

LG Optimus V battery pack

LG Optimus V battery pack

LG Optimus V battery pack

LG Optimus V battery pack

LG Optimus V battery pack

LG Optimus V battery pack

LG Optimus V battery pack

LG Optimus V battery pack

LG Optimus V battery pack

LG Optimus V battery pack

LG Optimus V battery pack

LG Optimus V battery pack

LG Optimus V battery pack

LG Optimus V battery pack

LG Optimus V battery pack

LG Optimus V battery pack

LG Optimus V battery pack

LG Optimus V battery pack

## Settings

- Dual SIM** – You can see two Network Signal icons on the left-top of the screen when you insert two SIM-Card.
- Date & Time** – You can set functions relating to the date and time.
- Language** – You can change the language for the display texts in your phone. This change will also affect the Language Input mode.
- Display** – You can adjust settings for the phone display.
- Call** – You can set the menu depending on the call.
- Auto key lock** – Lock the keypad automatically in standby screen.
- Security** – This menu allows you to set the phone security.
  - PIN code request** – Choose a PIN code to be requested when you turn your phone on.
  - Phone lock** – Choose a security code to lock your phone, When power on, When SIM changed or Immediately.
  - Anti-theft mobile tracker (ATMT)** – Anti-theft mobile tracker (ATMT) allows you to track your lost phone. When someone uses your phone without your permission, the tracking service will be activated. You are reminded by a text message sent to the default phone number you have set, without the unauthorized user’s knowledge. You can always activate the ATMT and configure your personal settings.

LG Optimus V battery pack

LG Optimus V battery pack

LG Optimus V battery pack

LG Optimus V battery pack

LG Optimus V battery pack

LG Optimus V battery pack

LG Optimus V battery pack

LG Optimus V battery pack

LG Optimus V battery pack

LG Optimus V battery pack

LG Optimus V battery pack

LG Optimus V battery pack

LG Optimus V battery pack

LG Optimus V battery pack

LG Optimus V battery pack

LG Optimus V battery pack

LG Optimus V battery pack

LG Optimus V battery pack

LG Optimus V battery pack

LG Optimus V battery pack

LG Optimus V battery pack

LG Optimus V battery pack

LG Optimus V battery pack

LG Optimus V battery pack

LG Optimus V battery pack

LG Optimus V battery pack

LG Optimus V battery pack

LG Optimus V battery pack

LG Optimus V battery pack

LG Optimus V battery pack

LG Optimus V battery pack

LG Optimus V battery pack

LG Optimus V battery pack

LG Optimus V battery pack

LG Optimus V battery pack

LG Optimus V battery pack

LG Optimus V battery pack

LG Optimus V battery pack

LG Optimus V battery pack

LG Optimus V battery pack

LG Optimus V battery pack

LG Optimus V battery pack

LG Optimus V battery pack

LG Optimus V battery pack

LG Optimus V battery pack

LG Optimus V battery pack

LG Optimus V battery pack

LG Optimus V battery pack

LG Optimus V battery pack

LG Optimus V battery pack

LG Optimus V battery pack

LG Optimus V battery pack

LG Optimus V battery pack

LG Optimus V battery pack

LG Optimus V battery pack

LG Optimus V battery pack

LG Optimus V battery pack

LG Optimus V battery pack

LG Optimus V battery pack

LG Optimus V battery pack

LG Optimus V battery pack

LG Optimus V battery pack

LG Optimus V battery pack

LG Optimus V battery pack

LG Optimus V battery pack

LG Optimus V battery pack

LG Optimus V battery pack

› **Change codes** – Change your Security code, PIN code, PIN2 code or ATMT code.

- Power save** – If you set Always on, you can save the battery power when you are not using the phone. Choose to switch between power save settings **Always on**, **Night only** or **Off**.
- Network selection** – You can select a network that will be registered either automatically or manually.
- SOS service** - This allows you to send SOS message to your friends automatically by long press No. 9 key on your keypad when you are in emergency.
- Reset settings** – Use **Reset settings** to restore the factory settings. You need the security code to activate this function. The default number is “0000”.
- Memory status** – You can check the free space and memory usage of each repository.

LG Optimus V battery pack

LG Optimus V battery pack

LG Optimus V battery pack

LG Optimus V battery pack

LG Optimus V battery pack

LG Optimus V battery pack

LG Optimus V battery pack

LG Optimus V battery pack

LG Optimus V battery pack

LG Optimus V battery pack

LG Optimus V battery pack

LG Optimus V battery pack

LG Optimus V battery pack

LG Optimus V battery pack

LG Optimus V battery pack

LG Optimus V battery pack

LG Optimus V battery pack

LG Optimus V battery pack

LG Optimus V battery pack

LG Optimus V battery pack

LG Optimus V battery pack

LG Optimus V battery pack

LG Optimus V battery pack

LG Optimus V battery pack

LG Optimus V battery pack

LG Optimus V battery pack

LG Optimus V battery pack

LG Optimus V battery pack

LG Optimus V battery pack

LG Optimus V battery pack

LG Optimus V battery pack

LG Optimus V battery pack

LG Optimus V battery pack

LG Optimus V battery pack

LG Optimus V battery pack

LG Optimus V battery pack

LG Optimus V battery pack

LG Optimus V battery pack

LG Optimus V battery pack

LG Optimus V battery pack

LG Optimus V battery pack

LG Optimus V battery pack

LG Optimus V battery pack

LG Optimus V battery pack

LG Optimus V battery pack

LG Optimus V battery pack

LG Optimus V battery pack

LG Optimus V battery pack

LG Optimus V battery pack

LG Optimus V battery pack

LG Optimus V battery pack

LG Optimus V battery pack

LG Optimus V battery pack

LG Optimus V battery pack

LG Optimus V battery pack

LG Optimus V battery pack

LG Optimus V battery pack

LG Optimus V battery pack

LG Optimus V battery pack

LG Optimus V battery pack

LG Optimus V battery pack

LG Optimus V battery pack

LG Optimus V battery pack

LG Optimus V battery pack

LG Optimus V battery pack

LG Optimus V battery pack

LG Optimus V battery pack

LG Optimus V battery pack

LG Optimus V battery pack

LG Optimus V battery pack

LG Optimus V battery pack

LG Optimus V battery pack

LG Optimus V battery pack

LG Optimus V battery pack

### Guidelines for safe and efficient use (Continued)

- If your vehicle is equipped with an air bag, do not obstruct with installed or portable wireless equipment. It can fail or cause serious injury due to improper performance.

If you are listening to music whilst out and about, please ensure that the volume is at a reasonable level so that you are aware of your surroundings. This is particularly imperative when near roads.

#### Avoid damage to your hearing

Your hearing may be damaged if you are exposed to loud sounds for long periods of time. We therefore recommend that you do not turn the handset on or off close to your ear. We also recommend that music and call volumes are set to a reasonable level.

**Note:** Excessive sound pressure from earphones can cause hearing loss.

#### Blasting area

Do not use the phone where blasting is in progress. Observe restrictions, and follow any regulations or rules.

#### Potentially explosive atmospheres

- Do not use the phone at a refuelling point. Do not use near fuel or chemicals.
- Do not transport or store flammable gas, liquid, or explosives in the compartment of your vehicle which contains your mobile phone and accessories.

LG Optimus V battery pack

LG Optimus V battery pack

LG Optimus V battery pack

LG Optimus V battery pack

LG Optimus V battery pack

LG Optimus V battery pack

LG Optimus V battery pack

LG Optimus V battery pack

LG Optimus V battery pack

LG Optimus V battery pack

LG Optimus V battery pack

LG Optimus V battery pack

LG Optimus V battery pack

LG Optimus V battery pack

LG Optimus V battery pack

LG Optimus V battery pack

LG Optimus V battery pack

LG Optimus V battery pack

LG Optimus V battery pack

LG Optimus V battery pack

LG Optimus V battery pack

LG Optimus V battery pack

LG Optimus V battery pack

LG Optimus V battery pack

LG Optimus V battery pack

LG Optimus V battery pack

LG Optimus V battery pack

LG Optimus V battery pack

LG Optimus V battery pack

LG Optimus V battery pack

LG Optimus V battery pack

LG Optimus V battery pack

LG Optimus V battery pack

LG Optimus V battery pack

LG Optimus V battery pack

### Guidelines for safe and efficient use (Continued)

- The highest SAR value for this model phone tested by DASY4 for use at the ear is 0.936 W/Kg (10g) and when worn on the body is 0.856 W/Kg (10g).
- SAR data information for residents of countries/regions that have adopted the SAR limit recommended by the Institute of Electrical and Electronics Engineers (IEEE), which is 1.6 W/Kg averaged over one (1) gram of tissue.

#### Product care and maintenance

**⚠ WARNING**

- Only use batteries, chargers and accessories that have been approved for use with this phone model. The use of any other types may invalidate any approval or warranty applying to the phone, and may be dangerous.
- Do not disassemble this unit. Take it to a qualified service technician when repair work is required.
- Keep away from electrical appliances such as TVs, radios, and personal computers.
- The unit should be kept away from heat sources such as radiators or cookers.
- Do not drop.
- Do not subject this unit to mechanical vibration or shock.
- The coating of the phone may be damaged if it is covered with wrapping or vinyl wrapper.
- Use a dry cloth to clean the exterior of the unit. (Do not use solvents such as benzene, thinner or alcohol.)
- Do not expose this unit to excessive smoke or dust.
- Do not keep the phone next to credit cards or transport tickets; it can affect the information on the magnetic strips.

LG Optimus V battery pack

LG Optimus V battery pack

LG Optimus V battery pack

LG Optimus V battery pack

LG Optimus V battery pack

LG Optimus V battery pack

LG Optimus V battery pack

LG Optimus V battery pack

LG Optimus V battery pack

LG Optimus V battery pack

LG Optimus V battery pack

LG Optimus V battery pack

LG Optimus V battery pack

LG Optimus V battery pack

LG Optimus V battery pack

LG Optimus V battery pack

LG Optimus V battery pack

LG Optimus V battery pack

LG Optimus V battery pack

LG Optimus V battery pack

LG Optimus V battery pack

LG Optimus V battery pack

LG Optimus V battery pack

LG Optimus V battery pack

LG Optimus V battery pack

LG Optimus V battery pack

LG Optimus V battery pack

LG Optimus V battery pack