



LG-T310 User Guide - English

Some of the contents in this manual may differ from your phone depending on the software of the phone or your service provider.



CE0168

Bluetooth QD ID B016850



Disposal of your old appliance

- 1 When this crossed-out wheeled bin symbol is attached to a product it means the product is covered by the European Directive 2002/96/EC.
- 2 All electrical and electronic products should be disposed of separately from the municipal waste stream via designated collection facilities appointed by the government or the local authorities.
- 3 The correct disposal of your old appliance will help prevent potential negative consequences for the environment and human health.
- 4 For more detailed information about disposal of your old appliance, please contact your city office, waste disposal service or the shop where you purchased the product.



P/N: MMBB0390425 (1.0)

Installing the SIM card and the handset battery

Installing the SIM Card

When you subscribe to a cellular network, you are provided with a plug-in SIM card loaded with your subscription details, such as your PIN, any optional services available and many others.

Important!

The plug-in SIM card and its contacts can be easily damaged by scratches or bending, so be careful when handling, inserting or removing the card. Keep all SIM cards out of the reach of small children.

Illustrations

Always switch the device off and disconnect the charger before removing the battery.

- 1 Remove the back cover.
- 2 Lift battery away.
- 3 Insert the SIM card.
- 4 Insert the battery pack.
- 5 Attach the back cover.
- 6 Charge the battery.

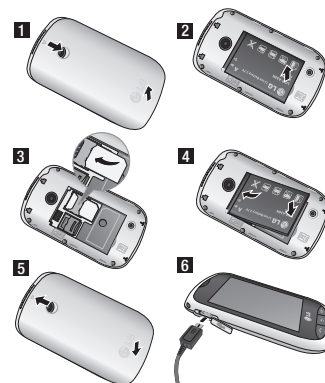

Phone Components

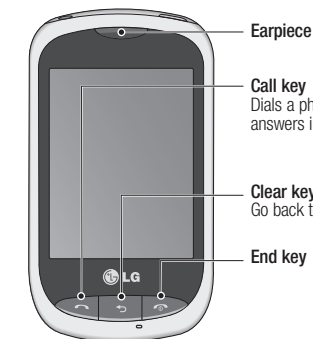

- Earpiece**
- Call key**
Dials a phone number and answers incoming calls.
- Clear key**
Go back to a previous screen.
- End key**

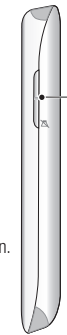

- Volume keys**
- When the screen is at the Home screen: Ring tone and touch tone volume.
- During a call: Earpiece volume.
- Down volume key: Press and hold to activate/deactivate Silent mode.

- Power/Lock key**
- Short press to turn on/off the screen.
- Long press for power on/off.

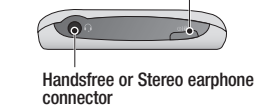

Using your touch screen

Touch screen tips

- To select an item, touch the centre of the icon.
- Do not press too hard. The touchscreen is sensitive enough to pick up a light, firm touch.
- Use the tip of your finger to touch the option you require. Be careful not to touch any other keys.
- Whenever your LG-T310 is not in use, it will return to the lock screen.

Control the touch screen

The controls on the LG-T310 touch screen change dynamically depending on the task you are carrying out.

Calls

Making a Call

- 1 Touch to open the keypad.
- 2 Key in the number using the keypad.
- 3 Touch to initiate the call.

TIP! To enter + for making an international call, press and hold .

Press the power key to lock the touchscreen to prevent calls being made by mistake.

Making a call from your contacts

- 1 From the home screen touch to open the Contacts.
- 2 Tap the Name field box on the top of the screen and enter the first few letters of the contact you would like to call using the keypad.

Messaging

Your LG-T310 combines SMS and MMS into one intuitive and easy-to-use menu.

Sending a message

- 1 Touch **Messages** in menu and touch **Write message** to begin composing a new message.
- 2 Touch **Insert** to add an image, video, sound, template and so on.
- 3 Touch **To** at the top of the screen to enter the recipients. Then enter the number or touch to select a contact. You can even add multiple contacts.
- 4 Touch **Send** when ready.

WARNING: If an image, video or sound is added to an SMS it will be automatically converted to an MMS and you will be charged accordingly.

Entering Text

You can choose your input method by tapping and **Input method**.

Touch to turn on T9 mode. This icon is only shown when you choose **Keypad** as the input method.

Touch to change between numbers, symbols and text input.

Use **Shift** key to change between capital or lowercase input.

Handwriting recognition

In Handwriting mode you simply write on the screen and your LG-T310 will convert your handwriting into your message.

Setting up your email

Touch **E-mail** in **Application** screen.

If the email account is not set up, start the email set up wizard and finish it.

You can check and edit settings also you can check the additional settings that were filled in automatically when you created the account.

Touch to view a gallery of your saved photos.

Using the advanced settings

From the viewfinder, touch to open all advanced settings options.

After selecting the option, touch the **OK** button.

Size - Change the size of the photo to save memory

White balance - Choose between **Auto**, **Incandescent**, **Sunny**, **Fluorescent**, and **Cloudy**.

Colour effect - Choose a colour tone for your new photo.

Continuous shot - Position the subject in the viewfinder, then press the capture button as if taking a normal photo. The camera will take shots in quick succession.

Self-timer - The self-timer allows you to set a delay after the shutter is pressed. Select **Off**, **3 seconds**, **5 seconds**, or **10 seconds**. This is ideal if you want to be included in a photo.

Night mode - Useful to user in dark places.

Changing your text message settings

Touch **Messages** and touch **Settings**. Select **Text message**.

Text message centre - Enter the details of your message centre.

Delivery report - Slide the switch left to receive confirmation that your messages have been delivered.

Validity period - Choose how long your messages are stored at the message centre.

Message types - Convert your text into **Text**, **Voice**, **Fax**, **X.400** or **E-mail**.

Character encoding - Choose how your characters are encoded. This impacts the size of your messages and therefore data charges.

Send long text as - Choose to send long messages as **Multiple SMS** or as an **MMS**.

Image quality - Choose between **Super fine**, **Fine**, and **Normal**. The finer the quality, the sharper the photo. However, the file size will increase as a result, which means you'll be able to store fewer photos in the memory.

Select storage - Choose whether to save your photos to the Handset memory or to the External memory.

Hide icons - Choose the camera setting icons to hide manually or automatically.

Show captured image - Choose On to check the picture you took right away.

Shutter sound - Select one of the three shutter sounds.

Grid screen - Choose between **Off**, **Simple cross**, or **Trisection**.

Reset settings - Restore all camera default settings.

- 3 From the filtered list, touch the Call icon next to the contact you want to call. The call will use the default number if there is more than one for that contact.
- 4 Or, you can touch the contact name and select the number to use if there is more than one for that contact to use. You can also touch to initiate the call to the default number.

Answering and rejecting a call

When your phone rings, press key to answer the call.

To mute the ringing, touch on Silent tab in alerting screen. This is useful if you forgot to change your profile to Silent for a meeting. Touch on Reject tab to reject an incoming call in alerting screen.

Changing the common call setting

- 1 Touch **Call settings** in the **Settings** menu.
- 2 Scroll and touch **Common settings**.

- **Call reject** - Slide the switch left for ON. You can touch the Reject list to choose All calls, Contacts, Groups, All unknown callers and All unknown numbers.
- **Send my number** - Choose whether to display your number on an outgoing call.
- **Auto-redial** - Slide the switch left for ON or right for OFF.
- **Answer mode**
Press send key: Allows you to only answer an incoming call by pressing the key.
Press any key: Allows you to answer an incoming call by pressing any key, except the key.
- **Minute minder** - Slide the switch left to ON to hear a tone every minute during a call.
- **BT answer mode** - Select Handsfree to be able to answer a call using a Bluetooth headset, or select Handset to press a handset key to answer a call.
- **Save new number** - Select ON or OFF to save a new number.

Changing your multimedia message settings

Touch **Messages** and, touch **Settings** and **Multimedia message**.

Retrieval mode - Choose between **Home network** or **Roaming network**. If you then choose **Manual** you will receive only notifications of MMS and you can then decide whether to download them in full.

Delivery report - Choose to request and/or allow a delivery report.

Read receipt - Choose to request and/or allow a reply.

Priority - Choose the priority level of your MMS.

Validity period - Choose how long your message is stored at the message centre.

Slide duration - Choose how long your slides appear on the screen.

Video camera

Making a quick video

To switch to the camera mode or video mode, slide up/down the camera or video icon on the right centre of the viewfinder.

1 Holding the phone horizontally, point the lens towards the subject of the video.

2 Press the red dot .

3 **Rec** will appear at the bottom of the viewfinder with a timer at the bottom showing the length of the video.

4 To pause the video, touch and resume by selecting .

5 Touch on screen to stop video recording.

Contacts

Searching for a contact

- 1 Touch **Contacts**.
- 2 You see a list of contacts. Typing in the first letter of a contact's name in the Name field will jump the menu to that alphabetical area of the list.

Adding a new contact

- 1 Touch **Contacts** and touch **Add**.
- 2 Choose whether to save the contact to your **Internal memory** or **SIM**.
- 3 Enter your first and last name.
- 4 You can enter up to five different numbers per contact.
- 5 Add an email addresses. You can enter up to two different email addresses per contact.
- 6 Assign the contact to one or more groups.
- 7 Touch **Save** to save the contact.

Unsupported attachment - Choose whether the unsupported attachment is restricted or not.

Delivery time - Choose how long to wait before a message is delivered.

MMS centre - Choose one from the list or add a new message centre.

Social network services (SNS)

Your LG-T310 has SNS that lets you enjoy and manage your social network.

NOTE: SNS feature is a data intensive application. An additional costs may be incurred when connecting and using online services. Check your data charges with your network provider.

Changing your contact settings

You can adapt your contact settings so that your **Contacts** suits your own preferences.

Touch **Options key** and touch **Settings**.

- **Display name** - Choose whether to display the first or last name of a contact first.
- **Copy** - Copy your contacts from your SIM to Internal memory, or vice versa.
- **Move** - This works in the same way as Copy, but the contact is stored at the new location only. Therefore, once a contact is moved from the SIM to the Internal memory it will be deleted from the SIM memory.
- **Send all contacts via Bluetooth** - Sends all contacts to other handset via Bluetooth.
- **Back up contacts/ Restore contacts** - Save or restore the contacts data to the other storage.
- **Delete all contacts** - Delete all your contacts. Touch Yes if you are sure you want to delete all your contacts.

Facebook (Continued SNS)

Home: Log in and you will see your friend's updated status. Input your comment about new status or check others.

Profile: You can select the **Wall > Status updates** and write the current status. See your info detail and upload the photo by touching **Album > Upload Photo**.

Friends: Search your friends in facebook by selecting Search tap.

Message: You can see the Inbox/Sent folder, and write a SN message.

Camera

Taking a quick photo

- 1 Touch **Camera** menu.
- 2 When the camera has focused on your subject, touch the on the right-center of the screen to take a photo.

Using the advanced settings

From the viewfinder, touch to open all advanced settings options. You can change the video camera setting after selecting the option, touch the **OK** button.

Colour Effect - Choose a colour tone to use for your new view.

White balance - The white balance ensures any the white areas in your video are realistic. To enable your camera to adjust the white balance correctly, you may need to determine the light conditions. Choose between **Auto**, **Incandescent**, **Sunny**, **Fluorescent**, and **Cloudy**.

Quality - Choose between **Super fine**, **Fine** and **Normal**. The finer the quality, the sharper a video will be, but the file size will increase. As a result, you will be able to store fewer videos in the phone's memory.

Duration - Set a duration limit for your video. Choose between Normal and MMS to limit the maximum size to send as an MMS message.

Select storage - Choose whether to save your videos to the Handset memory or to the External memory.

