

OWNER'S MANUAL TOP FREEZER REFRIGERATOR

Please read this manual carefully before operating your set and retain it for future reference.

MANUAL DE USUARIO REFRIGERADOR CON CONGELADOR SUPERIOR

Lea detenidamente este manual antes de empezar a utilizar el refrigerador y guárdelo como referencia para el futuro.

TABLE OF CONTENTS

English Version	1
Spanish Version	19
Safety Measures	2
Identification of Parts	4
Installation of the Refrigerator	6
Unpacking	6
Install it away from heat sources and humid areas	6
Though and even floor	6
Ambient Temperature	6
A proper distance from adjacent items	6
Waiting Period	6
Connection	6
Before Storing Food	7
In case of Uninstalling	7
Installation of Base Grille	7
Operations and Functions	7
Connection	7
Ice Maker Operation	7
Thawing	8
Meat Tray	8
Humidity Control	8
Vegetable Drawer	8
Temperature Control Functions	9
Auto Checking	11
Using your Refrigerator	12
Storing Food Suggestions	13
Cleaning	14
What to do when	15
What you have to know about your refrigerator	16
Warranties	35

SAFETY MEASURES

This manual contains several important safety notices. Always read and obey all of the following safety messages.



THIS IS THE SAFETY ALERT SYMBOL. IT WILL INDICATE WHEN CERTAIN ACTIONS MUST NOT BE DONE.

DANGER

If you fail to follow these instructions you will be killed or seriously injured.

WARNING

Misuses of the product will cause you physical damage or personal wounds.

CAUTION

Inadequate use and installation will cause damage to your property.

All safety labels will inform you of potential danger, ways to reduce chance of injury and what can happen if instructions are not followed.

Warnings and Important Safety Measures

Read all instructions before using the product

CAUTION

This appliance is not intended for use by children, persons with physical or mental disabilities, persons with reduced sensory or mental capacity, or persons with lack of experience or know-how, unless they have supervision or instruction in relation to the use of the appliance by the person responsible for their safety. Children should be supervised to assure that they do not play with the appliance.

NEVER USE EXTENSION CORDS

Never connect multiple machines to same socket; this can cause wiring to overcharge, warming, cause voltage vibrations and bad functioning.

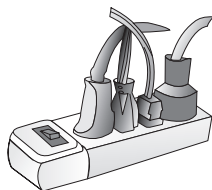

ELECTRICAL CORD REPLACEMENT

If feed cable gets damaged it must be replaced by the manufacturer, our service center or qualified LG Electronics personnel to minimize risks.

GROUND CONNECTION

In case of electrical surge, connection to ground will reduce risks of electric shock hazard. This unit must be grounded/landed. Consult a qualified electrician. When moving your refrigerator, be careful not to step on the feed cable with the machine's keepers.

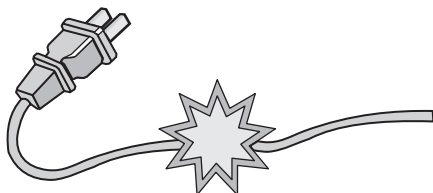

WHAT TO DO WITH YOUR OLD REFRIGERATOR

Your refrigerator contains liquids (refrigerant, lubricant) made of recyclable materials. All these materials must be sent to a recycling waste disposal site as they can be reused after a specific recycling process. Contact local authorities.

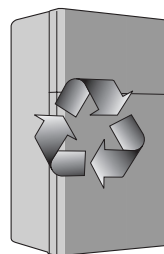

NEVER USE MECHANICAL DEVICES

Never use mechanical devices or any other means to accelerate the thawing process, use only those which are approved by the manufacturer.

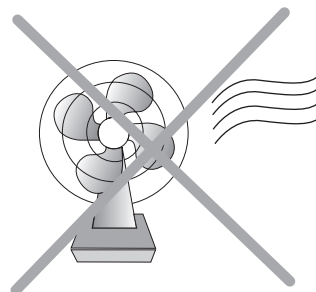

SAFETY MEASURES

Warnings and Important Safety Measures

Read all instructions before using the product

DANGEROUS FUN

An empty refrigerator can be very dangerous for children. Remove doors or magnetic packaging when not in use or secure it in a way to make it impossible to open and allow a child to go in as this can lead to suffocation.

Never allow a child to climb, hang or play with the refrigerator racks. They can get hurt and damage the refrigerator.

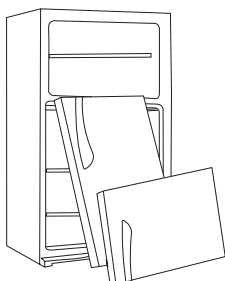

PLUG ACCESS

The refrigerator-freezer must be placed in a way that the Power cord can be pulled easily in case of emergency.

SUPERVISION IN RELATION TO THE USE

This appliance is not intended for use by children, persons with physical or mental disabilities, persons with reduced sensory or mental capacity, or persons that lack experience or know-how, unless they have supervision or instruction in relation to the use of the appliance by the person responsible for their safety. Children should be supervised to assure that they do not play with the appliance.

NEVER KEEP EXPLOSIVES INSIDE

Never store explosive substances or chemicals in your refrigerator such as benzene, alcohol etc. It is **DANGEROUS!**



NEVER STORE ELECTRONIC DEVICES

Never use electronic equipment to store food unless they are specific models approved by the manufacturer.

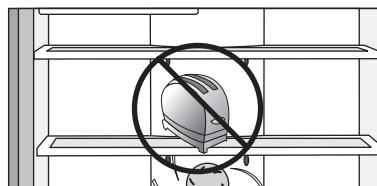

WHEN CLOSING REFRIGERATOR DOOR

Never place your thumb or fingers on the superior part of the handle, as it can be pressed against the lower part of the freezer handle. Keep away all fingers from injury prone areas such as where doors close cabinets and hinges, etc. Be careful when closing doors if children are nearby.

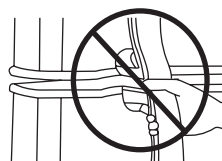

IDENTIFICATION OF PARTS

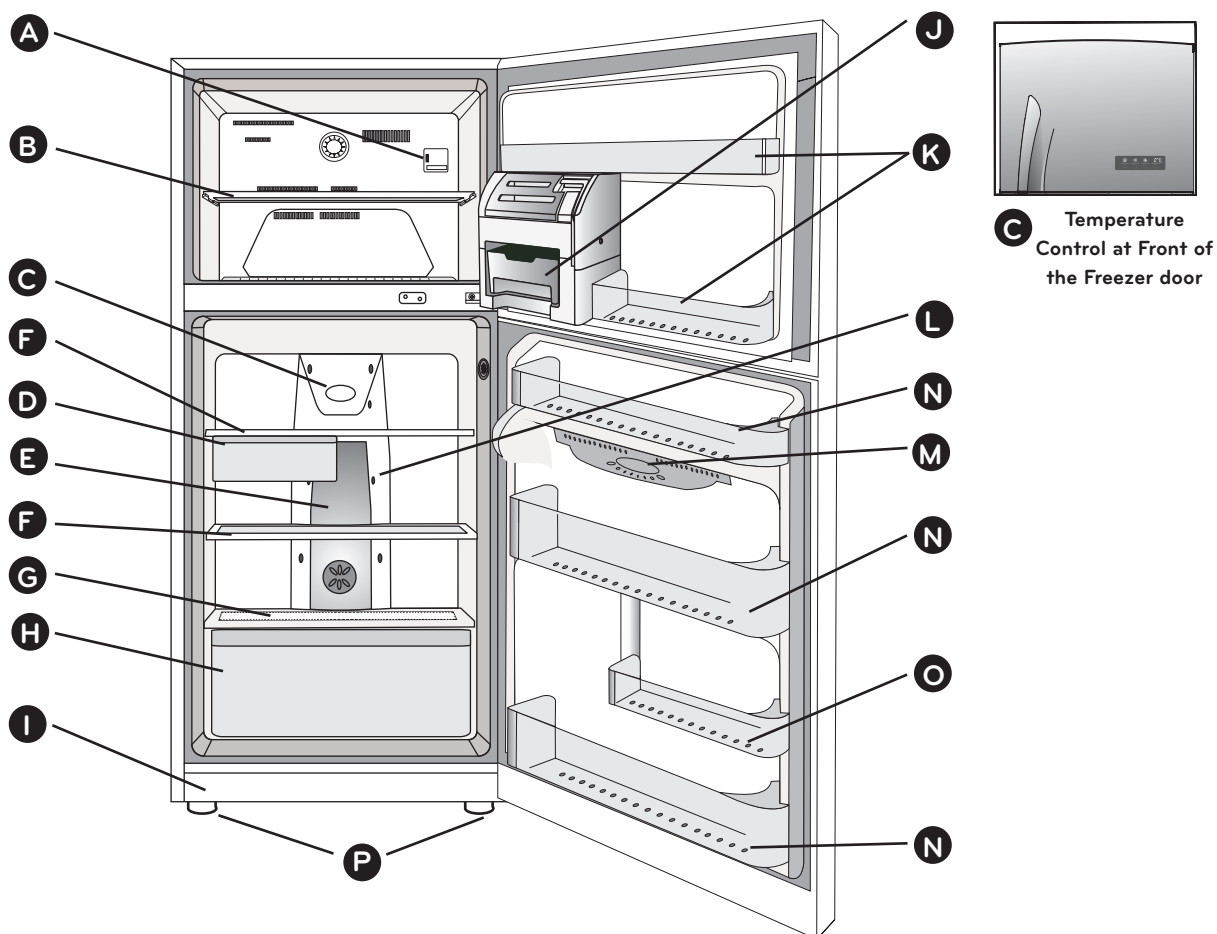

NOTE: Certain components featured in the diagram may not be included in your refrigerator, as these vary depending on your model characteristics.

- | | |
|--|--|
| A Temperature Control (Freezer) | I Base Grille * |
| B Freezer Shelf (Rack) | J Ice Drawer |
| C Temperature Control (Refrigerator) * | K Freezer Door Racks |
| D Fresh Meat Tray | L Multi Flow Air Duct
Distributes air to all refrigerator compartments |
| E Lamp | M Door Cooling
Cold air flow form door |
| F Refrigerator Shelves
(Glass, plastic or steel) | N Large Refrigerator Door Rack |
| G Magic Crisper
Cover for vegetable shelf it controls humidity | O Small Refrigerator Door Rack |
| H Vegetable Drawer
Keeps fruits and vegetables fresh | P Leveling Screws |

* Certain models

IDENTIFICATION OF PARTS

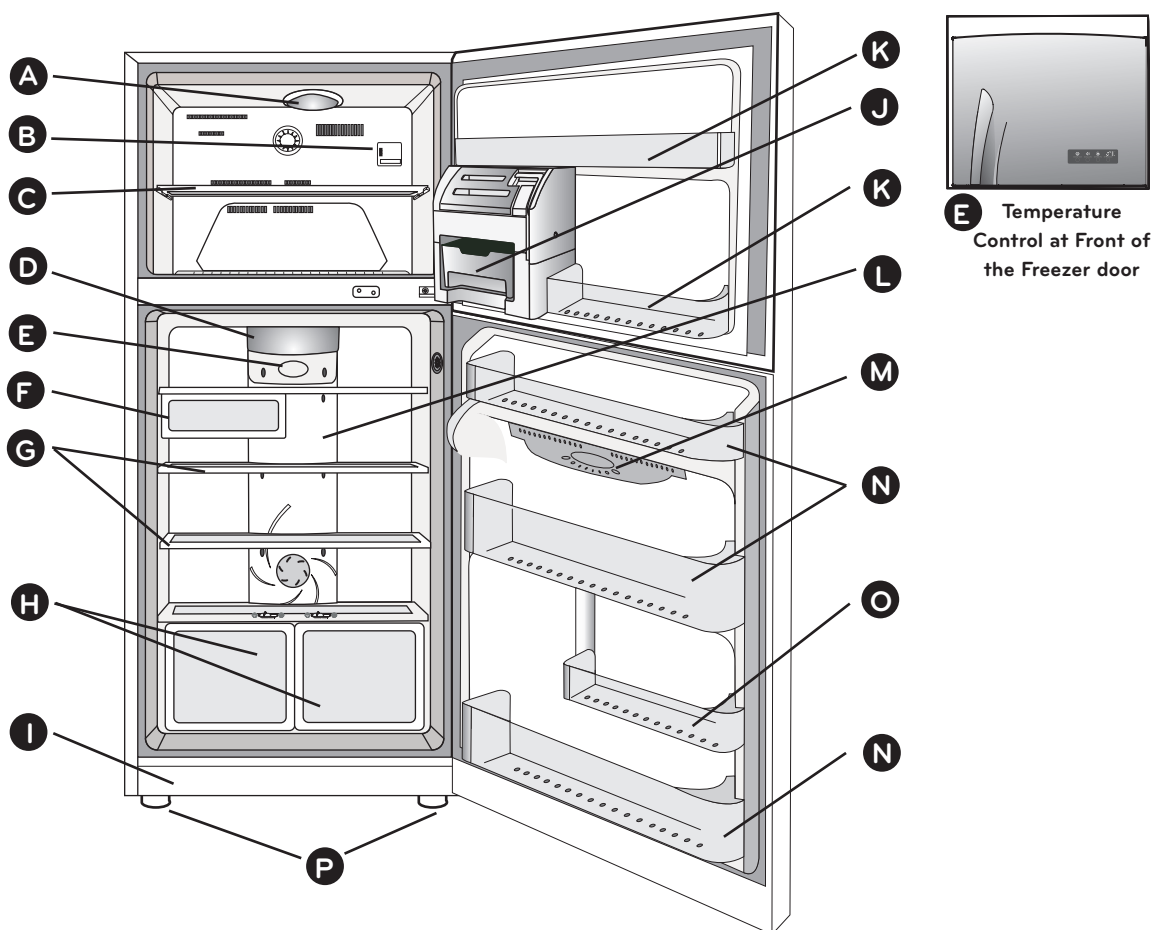

NOTE: Certain components featured in the diagram may not be included in your refrigerator, as these vary depending on your model characteristics.

- | | |
|---|---|
| A Freezer Lamp | I Base Grille * |
| B Temperature Control (Freezer) | J Ice Drawer |
| C Freezer Shelf | K Freezer Door Racks |
| D Refrigerator Lamp | L Multi- Flow Air Duct
Distributes air to all refrigerator compartments |
| E Temperature Control (Refrigerator) * | M Door Cooling
Cold air flow form door |
| F Fresh Meat Tray | N Large Refrigerator Door Rack |
| G Refrigerator Shelves
(Glass, plastic or steel) | O Small Refrigerator Door Rack |
| H Vegetable Drawers
Keeps fruits and vegetables fresh | P Leveling Screws |

* Certain models

INSTALLATION OF THE REFRIGERATOR

1. UNPACKING

Before installing your refrigerator, remove any tape or temporary stickers. Do not remove any stickers that feature warnings, the model serial number or the technical label of the product located on the back of the refrigerator. To remove adhesive tape residue, rub it well with your fingers and a little liquid detergent. Clean with warm water and let dry.

Do not use sharp instruments, rubbing alcohol, flammable liquids or abrasive cleaning products to remove the adhesive tape or glue. These products can damage the surface of your refrigerator. The shelves come already installed in their factory position. Remove the shelves and replace them according to your spacing needs.

2. INSTALL IT AWAY FROM HEAT SOURCES AND HUMID AREAS

In places with high temperatures, freezing capacity can be affected and cause high consumption of electrical energy.

Never install in places with high humidity as this can cause oxidation and electric shock hazard.

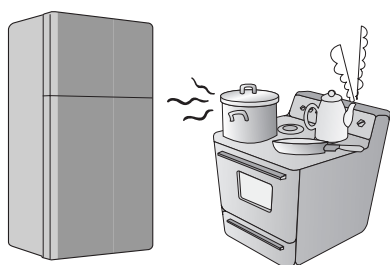

3. THOUGH AND EVEN FLOOR

Your refrigerator must be leveled and placed on a strong floor. An unstable installation can produce noise and vibrations. If the floor is uneven, level the unit by twisting the height adjusting screw, this will eliminate unwanted sounds and vibrations.

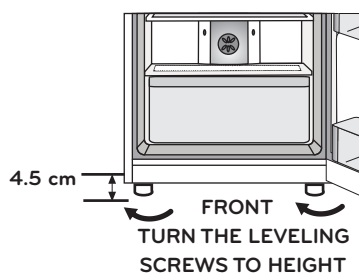

4. AMBIENT TEMPERATURE

The refrigerator will work efficiently if room temperature is between 10 °C and 43 °C (50 °F and 109,4 °F).

5. A PROPER DISTANCE FROM ADJACENT ITEMS

Adequate air flow is needed for an efficient operation. Keep your refrigerator at a relative distance from other objects. Reduces distance between the unit and other nearby objects can diminish freezing capacity and rise consumption of electrical energy.

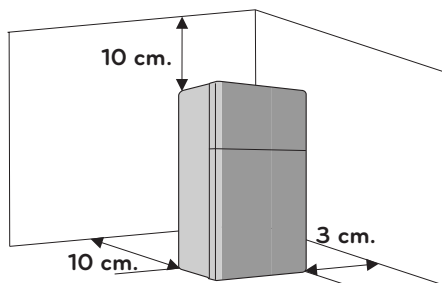

⚠ WARNING

EXCESSIVE WEIGHT HAZARD. Use the assistance of two or more persons to move or install the refrigerator. Not following these instructions may cause injury to the back and other parts of the body.

6. WAITING PERIOD

Wait at least an hour before connecting, after installation was completed.

7. CONNECTION

⚠ DANGER

FOR YOUR PERSONAL SAFETY, this device must be properly landed. Connect to a single undamaged socket. Not having proper installation will require you to call qualified personnel to achieve it.

Do not, under any circumstance, cut or extract the third prong from the plug.

It is your responsibility and obligation to replace two-prong outlets with that of an adequately grounded three-prong outlet.

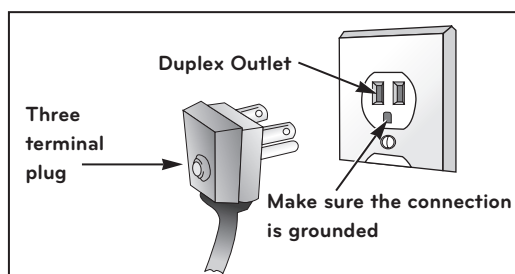

INSTALLATION OF THE REFRIGERATOR

⚠ WARNING

REPLACING ELECTRICAL CABLE; if the power cord is damaged, it must be replaced by our service center or qualified LG technician to avoid any risk. NEVER disconnect the refrigerator by pulling the power cord, always grip the plug firmly and disconnect it directly from the outlet.

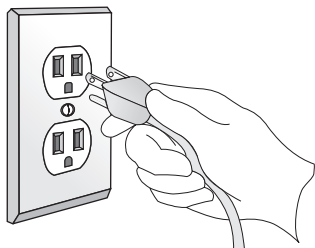

8. BEFORE STORING FOOD

Leave it working from 2 h to 3 h before storing food. If operation were to be interrupted wait 5 min before trying again.

9. IN CASE OF UNINSTALLING

If you wish to dispose of your refrigerator, keep in mind the following **Warning**.

⚠ WARNING

If the use of this unit is no longer needed, please contact local authorities to dispose of this product in a safely manner; as is Pentane-cycle or pentane like gas for insulation. Insulation gases require a special elimination process. This product contains flammable insulation.

10. INSTALLATION OF BASE GRILLE (in some models) Installing or Replacing the Base Grille:

1. Remove the 2 screws from the bottom front part of your refrigerator (in front).
2. Place base grille into position and insert and tighten screws.

To remove the Base Grille:

1. Open the refrigerator's door.
2. Once the door is open, remove screws from base grille and remove.
3. Remove the base grille.
4. Reattach screws to the base of refrigerator.

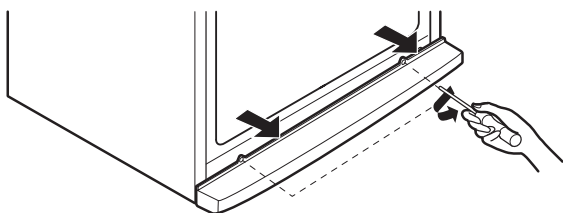

OPERATIONS AND FUNCTIONS

1. CONNECTION

Remember that your refrigerator must be landed.

⚠ CAUTION

If operation were to be interrupted, wait 5 min before restarting it.

2. ICE MAKER OPERATION

"Ice @ Door"

- To make ice cubes, pull out the ice drawer and pour water on the shelves (Fig. 1.) Then place in their original position until you hear a "click" sound.

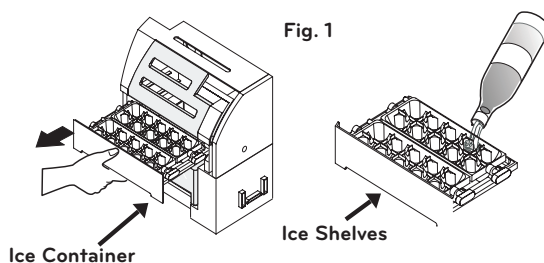

⚠ WARNING

Fill only with potable water.

⚠ WARNING

Make sure the level of water in the shelf is even on the entire surface, guiding yourself with pointing arrows on Fig. 2. Water must not surpass this level as it can get spilled when opening or closing door.

Water Level Indicators

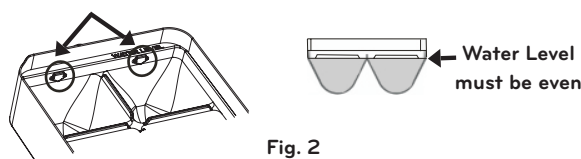

- The Ice maker takes around 4 hours to produce ice cubes. Check the ice status through the transparent panel.
- To remove ice cubes, carefully pull the drawer lever (Fig. 3). The ice cubes will fall into the ice container (Fig. 4).

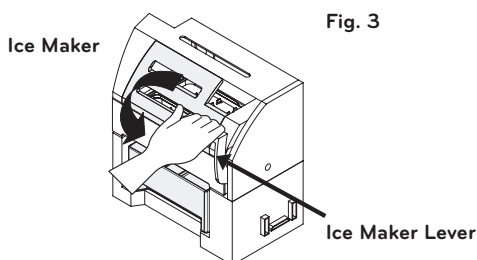

OPERATIONS AND FUNCTIONS

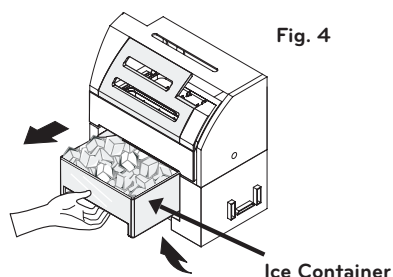

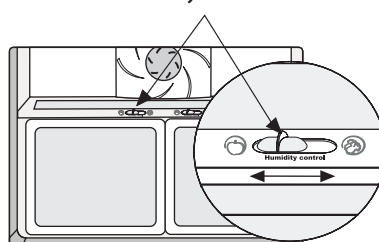

Fig. 4

5. HUMIDITY CONTROLS (in some models)

- If you slide the humidity control to the left, you will keep the fruits crispy. 
- If you slide the humidity control to the right, you will keep the vegetables crispy. 

Humidity Controls



6. VEGETABLE DRAWER (in some models)

Magic Crisper

- The magic crisper allows a better preservation of your fruits and vegetables allowing to easily control the level of humidity inside.

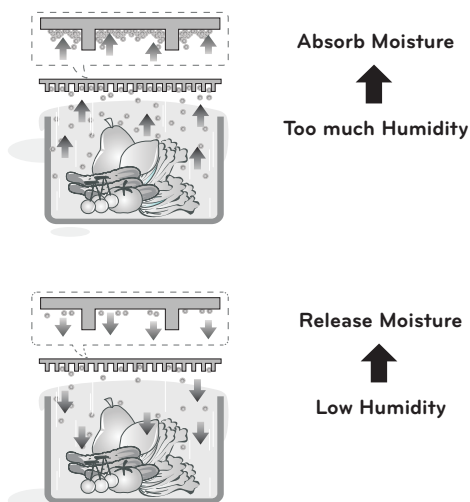

⚠ WARNING

Refrain from pulling the lever before ice cubes have been completely made, as this can cause water to spill, freeze, and cause the container to stick to the ice maker Fig. 5. If water spills, immediately wipe it off with a cloth. Avoid heavy ice accumulation in the container as this can cause problems to move the lever and/or container.

Fig. 5

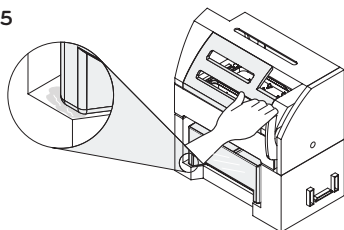

3. THAWING

- Thawing occurs automatically, you do not need to worry about this. Thawed water will flow into the evaporation shelf at the back of the refrigerator.

4. MEAT TRAY

- The air which comes in when the door is opened, will not affect your meat due to the position of the shelf. It is important not to switch places so this function persists.

NOTE: Door should not be kept open for long periods of time.

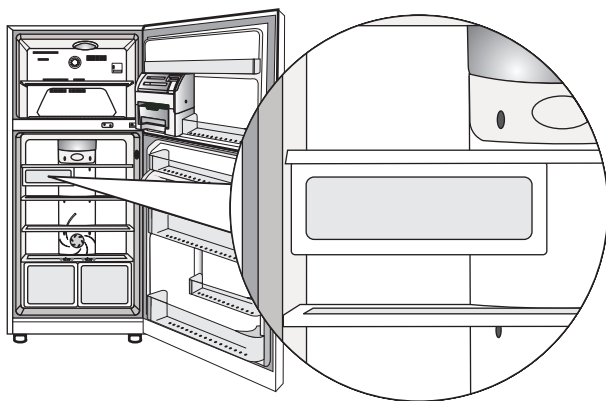

- It has a vent located in the inner wall of the lid to let humidity in or out.

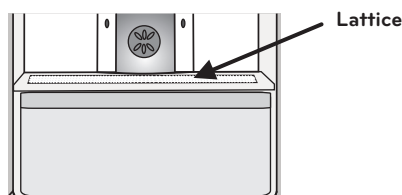

OPERATIONS AND FUNCTIONS

7. TEMPERATURE CONTROL SETTINGS

- Refrigerator temperature will always be the same, despite ambient temperature changes.
- We recommend not to change the temperature adjustments after they have been set unless it is necessary.
- This refrigerator contains a button which controls the refrigerator's temperature and a knob to control the freezer's temperature.
- The correct temperature configuration for the refrigerator compartment should be 37,4 °F (3 °C).
- The correct temperature configuration for the freezer compartment should be -2,2 °F (-19 °C).
- The refrigerator compartment contains a temperature sensor which will automatically start and stop the compressor functions as needed.

7.1 External Temperature Control

- **Refrigerator:** Monitors the refrigerator temperature. External temperature control, Fig. 6, (certain models).

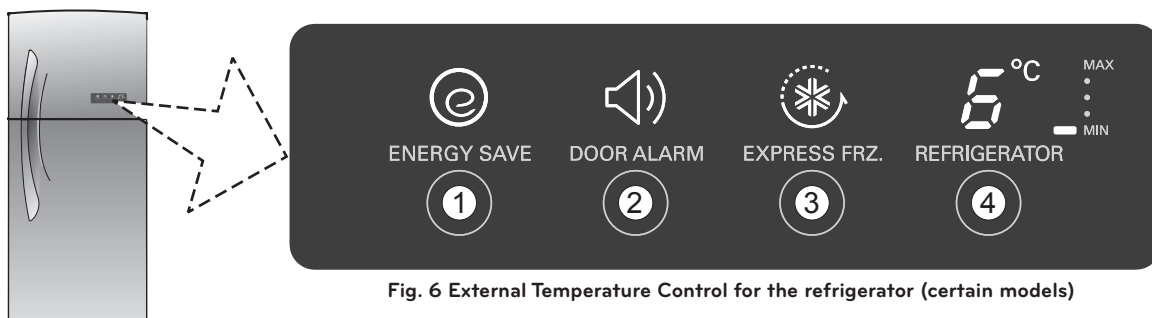

Fig. 6 External Temperature Control for the refrigerator (certain models)

- ENERGY SAVE:** By pressing this button the refrigerator will work with minimal power, reducing the time it is spent used and energy consumption. This feature will not activate if "EXPRESS FREEZING" is on.
- DOOR ALARM:** You will hear an alarm when the refrigerator or freezer door stays open for over a minute. The alarm will continue to sound every 30 seconds. Alarm will stop once both doors have been shut. By pressing the button, the alarm can be deactivated.
- EXPRESS FRZ:** Once this button is pressed, the refrigerator will begin to cool at full power to a maximum of two 2 hours. Pressing the button a second time will deactivate the mechanism. This feature will not be available if "ENERGY SAVE" is on.
- REFRIGERATOR:** This feature allows you to adjust the refrigerator temperature. The number appearing on the screen will match the degrees of the inside of the refrigerator. You can choose from 5 different settings, from 0 °C to 6 °C (32 °F to 42,8 °F).

Temperature Configuration

HOW TO ADJUST		
COLDER	RECOMMENDED	LESS COLD
Press the "REFRIGERATOR" button until the bars reach the maximum limit and the temperature indicator reads 32 °F (0 °C).	Press the "REFRIGERATOR" button until the indicator reads 37,4 °F (3 °C). This is the desired temperature for best performance of this unit (Up to the third bar will be lighted).	Press the "REFRIGERATOR" button until the bars reach the minimum level. The indicator will reads 42,8 °F (6 °C).

- **Freezer:** Controls the flow of cold air that goes from the freezer into the refrigerator.

NOTE: To check functions of the freezer temperature control, please look for Internal Temperature Control Function.

OPERATIONS AND FUNCTIONS

7.2 Internal Temperature Control

- **Freezer:** Controls the air flow from the freezer to the refrigerator, Fig 7.

HOW TO ADJUST	COLDER	RECOMMENDED	LESS COLD
To adjust the position knob turn to either side to make it turn. The arrow will set the temperature in your freezer.	<p>FREEZER / CONGELADOR TEMP. CONTROL</p> <p>1 LESS COLD/MENOS FRIO 5 NORMAL 9 COLDER/MAS FRIO</p> <p>9 8 7</p>	<p>FREEZER / CONGELADOR TEMP. CONTROL</p> <p>1 LESS COLD/MENOS FRIO 5 NORMAL 9 COLDER/MAS FRIO</p> <p>7 6 5 4 3</p>	<p>FREEZER / CONGELADOR TEMP. CONTROL</p> <p>1 LESS COLD/MENOS FRIO 5 NORMAL 9 COLDER/MAS FRIO</p> <p>3 2 1</p>

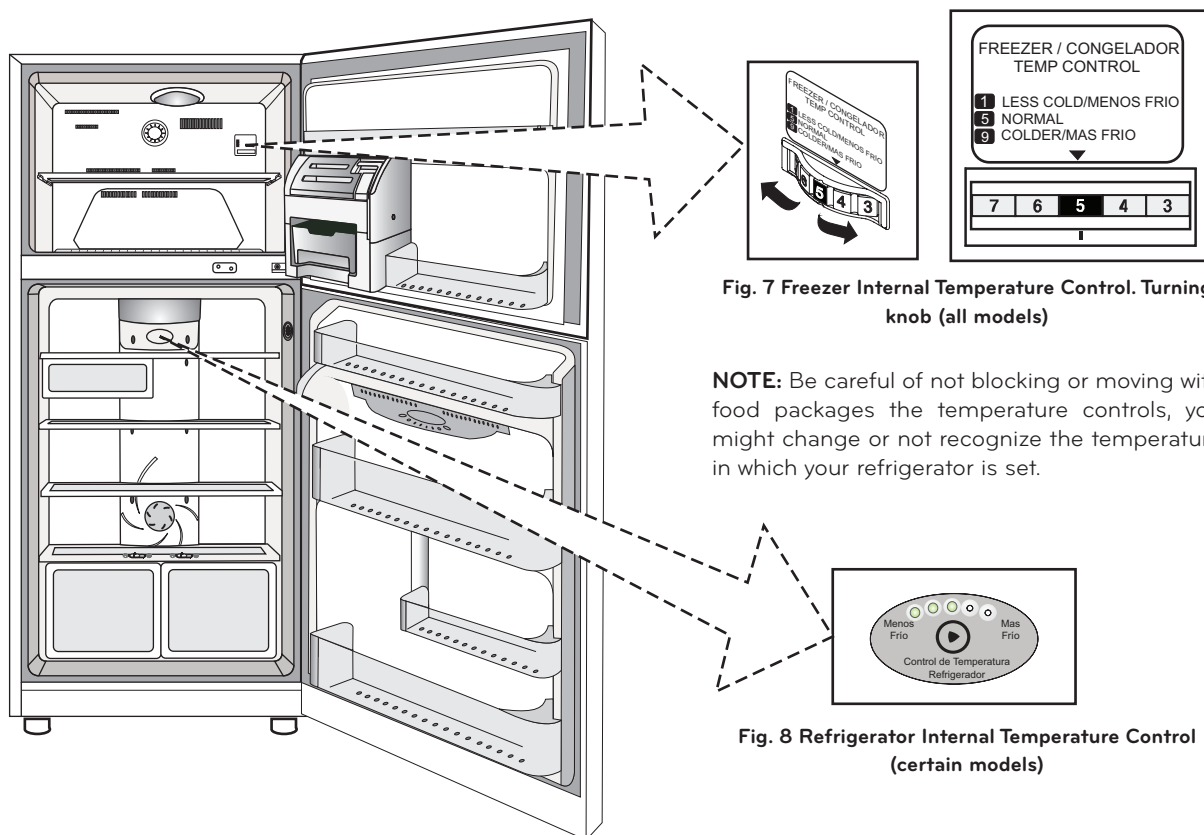

- **Refrigerator:** Controls the temperature of the refrigerator Control the internal temperature, Fig. 8 (according to every model).

HOW TO ADJUST		
COLDER	RECOMMENDED	LESS COLD
<p>Menos Frio Mas Frio</p> <p>Control de Temperatura Refrigerador</p>	<p>Menos Frio Mas Frio</p> <p>Control de Temperatura Refrigerador</p>	<p>Menos Frio Mas Frio</p> <p>Control de Temperatura Refrigerador</p>
Press the button until the maximum level lights are on.	Press the button until the third light is on. This temperature is the recommended one for the optimum refrigerator performance.	Press the button until the first light in on. The temperature is the minimum.

OPERATIONS AND FUNCTIONS

8. AUTO CHECKING

Your refrigerator has the capacity of auto checking. If any failure comes to happen a code will be displayed to help the technician for it repairing. While this code is on display, the rest of the functions of control a visualizing will not be functioning.

NOTE: In the temperature controls, the code is represented with a no consecutive blinking of the LED (left to right/down to up) as would be in the normal mode.

Example:

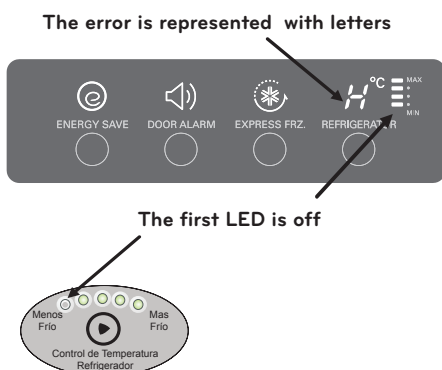

USING YOUR REFRIGERATOR

1. SHELVES

The shelves of your refrigerator can be adjusted to comply with your storage necessities; depending on the model you have it can include glass shelves or wired shelves. Storing your foods together and adjusting the shelves to different heights will ease to help you locate what you need. This also helps your refrigerator to stay shut longer which will save you energy.

IMPORTANT: While your refrigerator glass shelves are cold do not clean with hot or warm water. The glass shelves may break if exposed to rapid temperature changes or hard impacts. For your safety the glass shelves are made out of tempered glass so when at breaking they will fracture into tiny fragments.

NOTE: Be careful while moving or relocating the shelves, they are heavy. If moving the shelves is required keep in mind to locate them in a safe environment to prevent them from breaking.

Shelf (Refrigerator and Freezer)

To remove the shelves of your refrigerator as of the freezer, follow these instructions.

1. Pull the shelf from the front Fig 9.

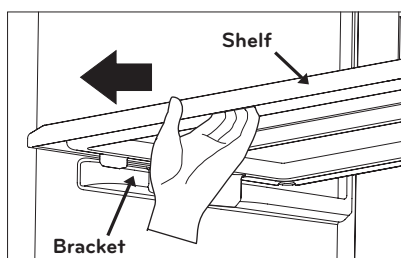

Fig. 9

2. Pull the shelf outside raising it until the lock Fig. 10.

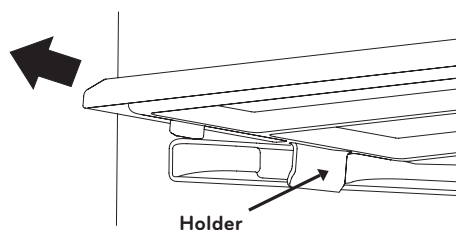
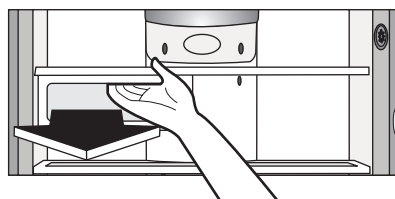

Fig. 10

Frozen Meat Compartment

Pull the frozen meat compartment forward while holding it with your other hand, slightly lift and pull.



NOTE: DO NOT store lettuce or other leafy produce in this drawer.

Removing the Vegetable Drawer

To remove the vegetable drawer, follow the next instructions:

1. Slip out the drawer towards the outside until it stops.
2. Slightly lift the front part and pull the rest, in order to completely remove the drawer.
3. To relocate the drawer slip out towards the front until it stops.

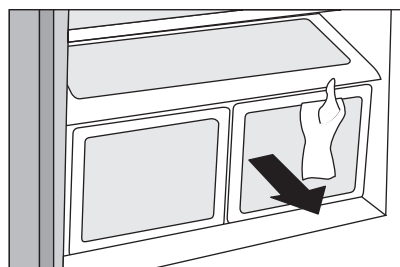

Door Racks

Door racks can be taken off in order to clean them better.

1. To remove the rack, raise it and pull it.
2. To replace the rack again slide it on the desirable guide and push it down until it is tighten (you will listen a "tick").

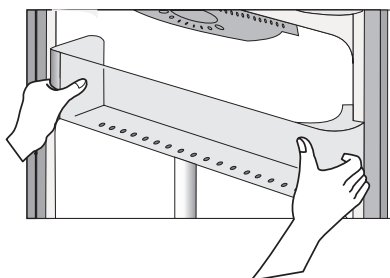

⚠ WARNING

Someone could get hurt if the racks are not well assembled.

NOTE: Empty the food charge before you move the containers.

⚠ CAUTION

DO NOT allow children play with baskets. Sharp corners on basket could cause in

STORING FOOD SUGGESTIONS

- Keep fresh food in the refrigerator.
- Freeze only small amounts of food.

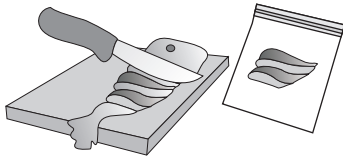

- After you freeze some food, once you thaw it do not freeze them again, they lose their taste and nutritional value; after thawing them, you might keep them in the refrigerator up to 48 hours.
- Do not store food that might get decomposed under low temperatures (like pineapple, bananas and cantaloupe).

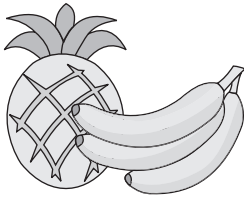

- Do not store garlic in the refrigerator.
- When storing food in the refrigerator use closed containers to avoid odor mixing and loss of humidity.

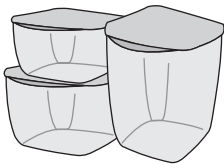

- Always clean the food before placing them in the refrigerator. Wash and dry the fruits and vegetables.

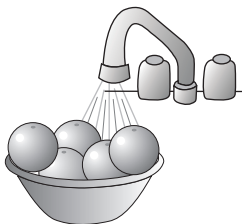

- It is recommendable to store onion in plastic bags to avoid other food odor to get mixed with its odor.

- If you are going to store ice cream for a long period of time, place it on the freezer grid and not on the freezer door.
- When storing eggs always place them in the highest shelf or in the first grid in order to keep them fresh for a longer period of time.
- Throw away any food that is being decomposed; it may contaminate other foods.



- Store cold cuts, cheese and sausages in bags or plastic sealed containers.

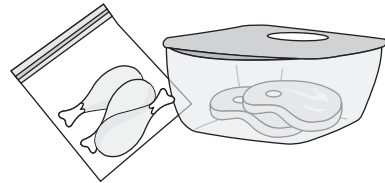

- Do not store glass bottles in the freezer because they can break when they freeze.
- Do not store hot food inside the refrigerator they might decrease the refrigerator's efficiency.



- In the models with water dispenser it is recommended that you change the water at least every 7 days.

CLEANING

In order to avoid bad or unwanted odors, is important to keep the refrigerator clean. Any spilled food must be cleaned immediately; they can stain and/or acidify the plastic parts of the refrigerator if they are let to get dry.

⚠ WARNING

Unplug the power plug always before cleaning around the electrical parts (lamps, switches, etc.) Clean any humidity to avoid any liquid might get into any electrical part. Do not touch the frozen part with wet hands, humid or wet object stick to frozen surfaces.

Exterior

Use a warm mixture of mild detergent or soap to clean the refrigerator's surface. Clean with a damp cloth and dry immediately.

Interior

It is recommended to clean the interior often. Wash all the bins and drawers with a mixture of bicarbonate or mild detergent with water. Clean and dry. Using other kinds of products might damage your refrigerator.

After Cleaning

Check that the plug is not damaged or overheated and it is properly plugged.

Ice Tray Kit

Indoor Ice Maker

- Remove the ice tray from the kit. Fig. 11.
- Clean the inside and the outside of the tray with a mild soap, rinse with tap water. Fig. 12.
- Pass a damp piece of cloth, dry Fig. 13.

Fig. 11

Ice Maker

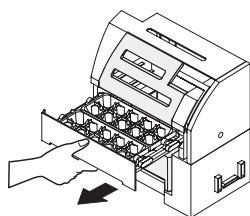

Fig. 12

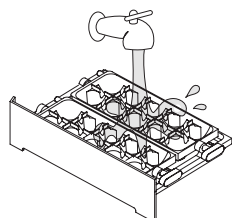
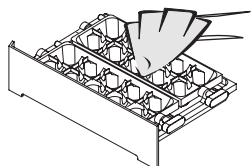

Fig. 13

Ice Tray



⚠ CAUTION

Do not immerse the ice tray in water. If done, completely dry the tray.

Door lining and gaskets

Use only a mild detergent (such as dish soap).

Plastic Parts

Do not use abrasive, paper or rough products. These could damage the product.

Back Cover

In order to get an efficient performance of your refrigerator, clean the rear part of it at least twice a year.

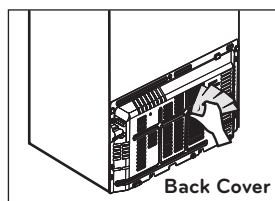

WHAT TO DO WHEN...

The refrigerator does not work

- Check if any fuse is broken in the electric facility.
- Check if the power cord is correctly plugged.
- Check if the power outlet is not damaged.
- Identify if there are any high consume electrical appliances working at the same time, unplug the one that are not necessary.

The temperature of the refrigerator or the freezer is too warm or hot

- Check that the temperature control is in the right position.
- Place the refrigerator away from any heat sources or direct sunlight.
- Open the doors only when necessary.
- There are too many food that block the air vents.
- Don't let the doors open for too long.

I can hear some weird or abnormal sounds

- Check that the refrigerator is placed over an even leveled surface, if not, adjust the refrigerator using the leveling height adjusting screws.
- Remove the unnecessary object from the back or top of the refrigerator.
- Check that the voltage is the correct one, if not call your electric company.

There are some odors in the refrigerator

- Store all food in sealed containers.
- Frequently clean the refrigerator inside.

Some humidity is formed in the cabinet's surface

- When the weather is humid is normal.
- The door might be opened, check that is properly closed.

The front part of the refrigerator is getting warm

- Do not worry, is part of the normal functioning of the refrigerator, and this happens in order to avoid condensation or "sweat".
- If this comes to happen, just clean with a dry piece of cloth.

The compressor works too frequently and for extended periods of time

- Check if the temperature controls are place in the maximum, if so, place then in the middle.
- Check that the doors are properly closed.
- Do not store over heated products.
- Do not let the doors open for too long. Move away from any heat sources the refrigerator.

There is a power interruption

- Check that no fuse is burned.
- Check if the power cord is plugged.
- Check that the outlet is not damaged.
- Identify weather you have different high consumption equipment plugged at the same time, unplug the one you do not use.

In case of a black out, call your electric company and ask how long it will last.

- In case of a 24 hour or less black out, do not open the refrigerator; this will keep the food fresh.
- In case of a longer black out, do one of the following options:
 1. Pull out all of the frozen food and keep them in an ice chest.
 2. Put 2 lbs (0, 907 Kg) of frozen ice (make sure you use gloves) for each square foot (28 L) inside the freezer. This task will preserve the food for 2 to 4 days. While handling dry ice (CO₂), wear gloves to protect your hands from frostbite.
 3. In case you do not possess neither ice chest or dry ice (CO₂), consume your food as soon as possible.

REMEMBER: In a power failure, a full freezer stays cold longer than a partially filled one. A freezer full of meat stays cold longer than a freezer full of baked goods. If you see that food contains ice crystals, it may be safely refrozen, although the quality and flavor may be affected. If the condition of the food is poor or if you feel it unsafe, dispose of it.

WHAT YOU HAVE TO KNOW ABOUT YOUR REFRIGERATOR

1. THE OVERALL PERFORMANCE OR EFFICIENCY OF YOUR REFRIGERATOR MIGHT BE AFFECTED IF:

- It is placed near a heat source or humid area.
- You open the door frequently.
- If you introduce water or any object in the cold air vents.
- You block the air vents with food.
- You store hot food.

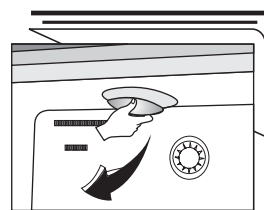

2. DURING VACATIONS WE RECOMMENDED YOU THE FOLLOWING:

- If the vacations are for a short period of time place the freezable food in the refrigerator.
- If you are going to be outside or away for a longer period of time, do the following:
 - ⇒ Take out all food.
 - ⇒ Unplug the power cord.
 - ⇒ Leave the doors open to avoid bad odors.
 - ⇒ Thoroughly clean the refrigerator.
 - ⇒ Empty and clean the water bin not forgetting to purge the system (turning on the switch).

3. IF YOU ARE PLANNING TO MOVE OR TO CHANGE YOUR REFRIGERATOR FROM ITS CURRENT POSITION:

- Remove and secure all attachments inside the refrigerator.
- To avoid any damage to the leveling height adjusting screws, turn them completely until the base.
- Place the power cord in the hook located in the upper left side.
- Clean and empty the water container and do not forget to purge the system (turning on the switch).
- After these procedures, you will be able to move your refrigerator.

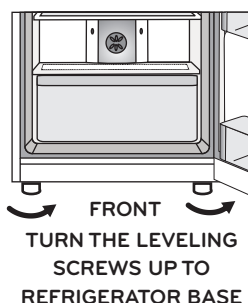
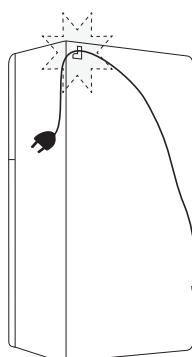

4. LAMP REPLACEMENT

4.1 Freezer Lamp

- Unplug the power cord from the outlet.
- Remove the lamp lid, pulling it from behind down and to the front.
- Screw out the lamp clockwise, remove it and replace.
- Assembly in the inverse order.

4.2 Refrigerator Lamp (Identify your type)

Type 1

- Unplug the power cord from the outlet.
- Remove the shelves and the lid of the vegetable container.
- To remove the lamp cover, pull with your hand or with a tool from the bottom.
- Turn the lamps clockwise, remove (⚠).
- Assembly in the inverse order.

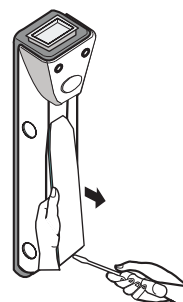

Type 2

- Unplug the refrigerator from the power outlet.
- Remove the shelves.
- Remove the lamp lid by pushing in the center and removing it carefully.
- Turn the lamp clockwise and remove it.
- Assembly in the inverse order.

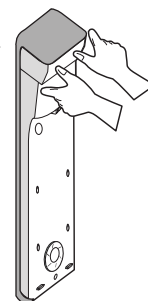

⚠ WARNING

The replacing lamp must be the same specification as the original.

5. THE FRONT AREA WARMS UP

The front wall of the cabinet of the refrigerator might warm up sometimes specially during installation. DO NOT ALARM! It's normal due to avoid humidity or "sweat".

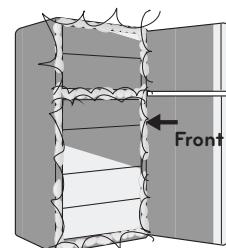

6. THE BACK OF THE REFRIGERATOR WARMS UP (some models)

The warming up is normal because from behind passes the cooling coil.

