



ENGLISH

DEUTSCH

FRANÇAIS

ITALIANO

SLOVENŠČINA

NEDERLANDS

# OWNER'S MANUAL

# Wireless Speaker with Lightning Dock

## MUSIC IN STYLE

Please read this manual carefully before operating your set and retain it for future reference.

ND1530



MFL68020431

## Safety Information

1

Getting Started



**CAUTION:** TO REDUCE THE RISK OF ELECTRIC SHOCK DO NOT REMOVE COVER (OR BACK) NO USER-SERVICEABLE PARTS INSIDE REFER SERVICING TO QUALIFIED SERVICE PERSONNEL.



This lightning flash with arrowhead symbol within an equilateral triangle is intended to alert the user to the presence of uninsulated dangerous voltage within the product's enclosure that may be of sufficient magnitude to constitute a risk of electric shock to persons.



The exclamation point within an equilateral triangle is intended to alert the user to the presence of important operating and maintenance (servicing) instructions in the literature accompanying the product.

**WARNING:** TO PREVENT FIRE OR ELECTRIC SHOCK HAZARD, DO NOT EXPOSE THIS PRODUCT TO RAIN OR MOISTURE.

**WARNING:** Do not install this equipment in a confined space such as a book case or similar unit.

**NOTICE :** For safety marking information including product identification and supply ratings, please refer to the main label on the bottom of the apparatus.

### CAUTION concerning the Power Cord

Most appliances recommend they be placed upon a dedicated circuit;

That is, a single outlet circuit which powers only that appliance and has no additional outlets or branch circuits. Check the specification page of this owner's manual to be certain. Do not overload wall outlets. Overloaded wall outlets, loose or damaged wall outlets, extension cords, frayed power cords, or damaged or cracked wire insulation are dangerous. Any of these conditions could result in electric shock or fire. Periodically examine the cord of your appliance, and if its appearance indicates damage or deterioration, unplug it, discontinue use of the appliance, and have the cord replaced with an exact replacement part by an authorized service centre. Protect the power cord from physical or mechanical abuse, such as being twisted, kinked, pinched, closed in a door, or walked upon. Pay particular attention to plugs, wall outlets, and the point where the cord exits the appliance. To disconnect power from the mains, pull out the mains cord plug. When installing the product, ensure that the plug is easily accessible.

**CAUTION:** The apparatus shall not be exposed to water (dripping or splashing) and no objects filled with liquids, such as vases, shall be placed on the apparatus.

**Disposal of your old appliance**

1. When this crossed-out wheeled bin symbol is attached to a product it means the product is covered by the European Directive 2002/96/EC.
2. All electrical and electronic products should be disposed of separately from the municipal waste stream via designated collection facilities appointed by the government or the local authorities.
3. The correct disposal of your old appliance will help prevent potential negative consequences for the environment and human health.
4. For more detailed information about disposal of your old appliance, please contact your city office, waste disposal service or the shop where you purchased the product.

**Disposal of waste batteries/accumulators**

1. When this crossed-out wheeled bin symbol is attached to batteries/accumulators of Your product it means they are covered by European Directive 2006/66/EC.
2. This symbol may be combined with chemical symbols for mercury(Hg), cadmium(Cd) or lead(Pb) if the battery Contains more that 0.0005% of mercury,0.002% of cadmium or 0.004% of lead.
3. All batteries/accumulators should be disposed separately from the municipal waste stream via designated collection facilities appointed by the government or the local authorities.
4. The correct disposal of Your old batteries/accumulators will help to prevent potential negative consequences for the environment, animal and human health.
5. For more detailed information about disposal of Your old batteries/accumulators, please contact Your city office, waste disposal service or the shop where You purchased the product.

# CE1588

LG Electronics hereby declares that this/these product(s) is/are in compliance with the essential requirements and other relevant provisions of Directive 1999/5/EC, 2004/108/EC, 2006/95/EC, 2009/125/EC and 2011/65/EU.

Please contact to the following address for obtaining a copy of the DoC (Declaration of Conformity).

Contact office for compliance of this product:

LG Electronics Inc.  
EU Representative, Krijgsman 1,  
1186 DM Amstelveen, The Netherlands

- Please note that this is NOT a Customer Service contact point. For Customer Service Information, see Warranty Card or contact the dealer that you purchased this product.

In door use only.

## RF Radiation Exposure Statement

This equipment should be installed and operated with minimum distance 20 cm between the radiator and your body.

# Table of Contents

## 1 Getting Started

---

- 2 Safety Information
- 6 Main Features
- 6 Accessories
- 6 Introduction
- 7 Front Panel
- 8 Rear Panel
- 8 Connecting the AC Adapter
- 10 How to Attach the Ferrite Core (For EMI Only)

## 2 Operating

---

- 11 Basic Operations
  - 11 – Switch to Power On
  - 11 – Switch to Standby mode
  - 11 – iPhone/iPod Operations
  - 11 – Enjoying Music by Docking Your iPhone/iPod (Lightning Connector) to the Unit
- 12 – Compatible iPhone/iPod
- 14 – Listening to Music from Your Portable Device
- 14 – Auto Power Down
- 15 Using a Bluetooth Wireless Technology
  - 15 – Listening to Music of a Bluetooth Device

## 3 Troubleshooting

---

- 17 Troubleshooting

## 4 Appendix

---

- 18 Trademarks and Licenses
- 18 Handling the Unit
- 19 Specifications

1

2

3

4

## Main Features

### Made for iPhone/iPod

Enjoys music from iPhone/iPod with simple connection.

### Portable In

Listens to music from your portable device.

### Bluetooth®

Enjoys music from Bluetooth device with simple connection.

## Accessories

Please check and identify the supplied accessories.

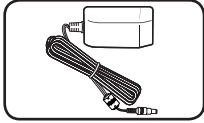

AC adapter(1)

## Introduction

### Symbol Used in This Manual

#### ! Note

Indicates special notes and operating features.

#### ! Caution

Indicates cautions for preventing possible damages from abuse.

## Front Panel

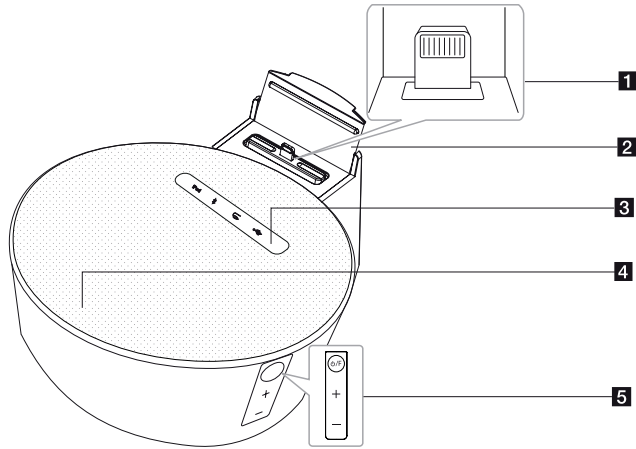

- 1** iPhone/iPod Dock (Lightning Connector)
- 2** Support for iPhone/iPod
- 3** Indicator  
Displays each of functions.
- 4** Speaker

- 5** **⏻/F** (Power/Function)
  - Power on : Press **⏻/F** to turn the unit on when the power is turned off.
  - Power off : Press and hold **⏻/F** for about 3 seconds to turn the unit off
  - Selects the function and input source when the power is turned on.
- +/-** (Volume)  
Adjusts volume of speaker.

## Rear Panel

1

Getting Started

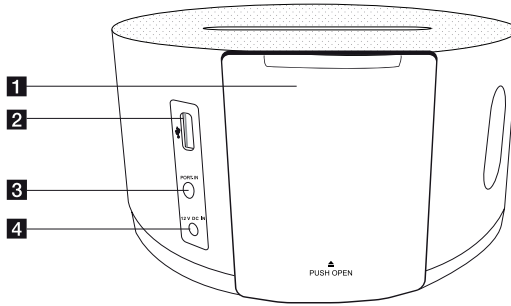

**1 DOCK**

Press the PUSH OPEN button appears iPod DOCK.

**2**  (USB)

Plays the audio files using your USB cable for iPhone/iPod

**3 PORT.IN**

Listens to music from your portable device.

**4 12 V DC IN (AC adapter input)**

Connects the supplied AC adapter.

### ! Note

How to open the dock station

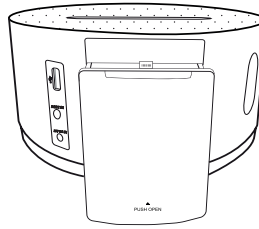
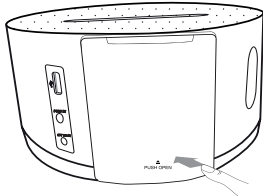

**Notice:** To open or close docking tray, please push center of "B PUSH OPEN".

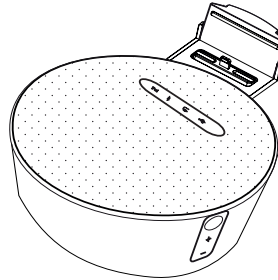
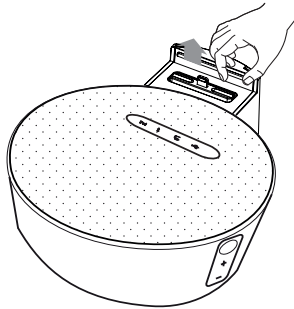

### ! Caution

Precautions in using the touch buttons

- Use the touch buttons with clean and dry hands. - In a humid environment, wipe out any moisture on the touch buttons before using.
- Do not press the touch buttons hard to make it work. - If you apply too much strength, it can damage the sensor of the touch buttons.
- Touch the button that you want to work in order to operate the function correctly.
- Be careful not to have any conductive material such as metallic object on the touch buttons. It can cause malfunctions.

## Connecting the AC Adapter

Plug the AC adapter into an AC outlet.

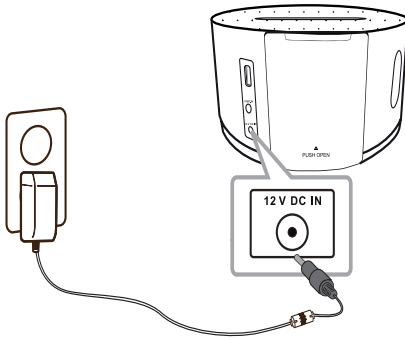

### ! Caution

- Only use the AC adapter supplied with this device. Do not use a power supply from another device or manufacturer. Using any other power cable or power supply may cause damage to the device and void your warranty.
- Right after change function or volume, if you plug out adapter without power off operation, it might be not memory its latest status.

## How to Attach the Ferrite Core (For EMI Only)

You must affix the cores (supplied with the model you purchased) in order to reduce or eliminate electrical interference.

1. Pull the stopper [a] of the ferrite core to open.
2. Wind the portable cable and USB cable on the ferrite core.
3. Close the ferrite core until it clicks.

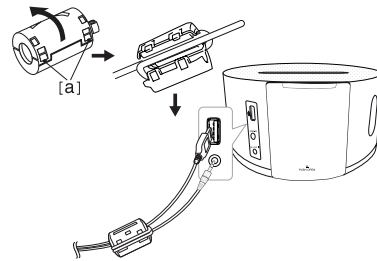

## Basic Operations

### Switch to Power On

Press **⏻/F**. The LED indicators light up and the last function you selected blinks, then the unit switches to Power on.

### Switch to Standby mode

Press and hold **⏻/F**. The LED indicators light on and then off, and the unit switches to Stand by.

### iPhone/iPod Operations

You can enjoy the sound from your iPhone/iPod through this unit. For details about iPhone/iPod refer to the iPhone/iPod User Guide.

### Enjoying Music by Docking Your iPhone/iPod (Lightning Connector) to the Unit

1. Connect your iPhone /iPod(Lightning connector) to Dock firmly.
2. Dock the iPhone/iPod (Lightning Connector) firmly. If you turn this unit on, your iPhone/iPod is automatically turned on and starts recharging
3. Press **⏻/F** to select iPod function.
4. Start playing it.

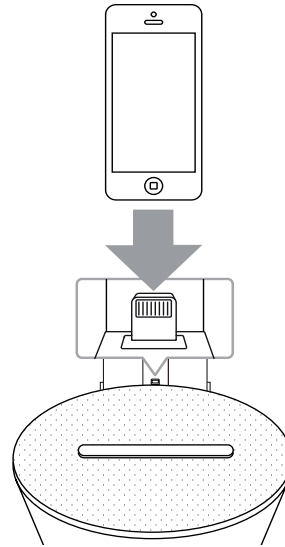
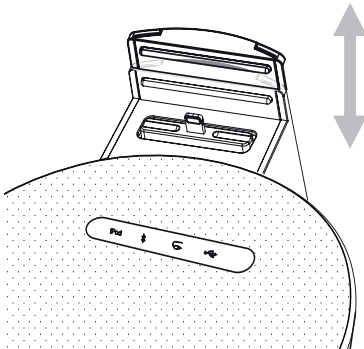

## Enjoying Music by Connecting Your iPhone/iPod (30 Pin/Lightning Connector) to the Unit

2  
Operating

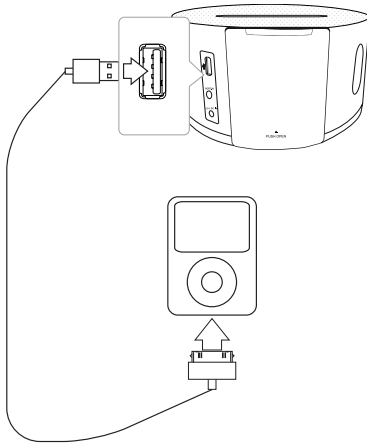

1. Connect iPhone/iPod (30 Pin/Lightning Connector) to the USB port on the unit by using the iPhone/iPod cable. If you turn this unit on, your iPhone/iPod (30 Pin/Lightning Connector) will be automatically turned on and start recharging.
2. Press **⏻/F** to select **🔌(USB)** function. You can operate your iPhone/iPod (30 Pin/Lightning Connector) through an iPhone/iPod (30 Pin/Lightning Connector)'s display by controlling your iPhone/iPod (30 Pin/Lightning Connector).

## Compatible iPhone/iPod

The unit supports the models as follows:

iPhone 5, iPhone 4S, iPhone 4, iPhone 3GS  
iPod touch (3rd through 5th generation),  
iPod nano (4th through 7th generation)

Depending on your iPhone/ iPod's software version, you may not control your iPhone/iPod from the unit.

iPhone, iPod nano, and iPod touch are trademarks of Apple Inc., registered in the U.S.

and other countries. Lightning is a trademark of Apple Inc.

### ! Note

- Made for iPhone5, iPod touch(5th generation) and iPod nano(7th generation) with lightning connector.
- Made for Compatible iPhone/iPod with USB.

 **Note**

- An Error can occur as per below conditions.
  - Your iPhone/iPod is not connected firmly.
  - This unit recognizes your iPhone/iPod as an unknown device.
  - Your iPhone/iPod is exceptionally low in power.
    - ▶ The battery needs to be charged.
    - ▶ If you charge the battery while iPhone/iPod is extremely low in power, it may take longer to be charged.
- Depending on your iPhone/iPod 's software version, it may not be possible to control your iPhone/iPod from this unit. We recommend installing the latest software version.
- If you use an application, make a call, or send and receive SMS text message, etc. on iPhone/iPod touch, disconnect it from this unit and then use it.
- If you have a problem with your iPhone/iPod, please visit [www.apple.com/support](http://www.apple.com/support).
- In standby mode, you can charge your iPhone/iPod.
- You may need additional operation for iPhone/iPod touch, for example "unlock" before you use.

## Listening to Music from Your Portable Device

The unit can be used to play the music from many types of portable device. (Portable cable is not supplied as an accessory with this unit.)

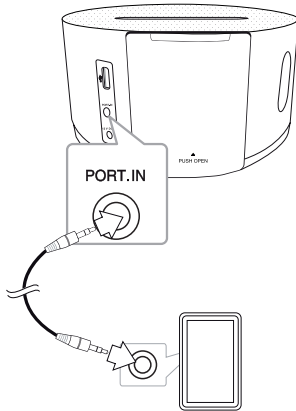

1. Connect the portable device to the **PORT.IN** connector of the unit.
2. Turn the power on by using **⏻/F**.
3. Select the **📶** (PORTABLE) function by pressing **⏻/F**.
4. Turn the portable device on and start playing it.

## Auto Power Down

This unit will be off itself to save electronic consumption in the case main unit is not connected to external device and is not used for 25 minutes.

So does this unit after six hours since Main unit has been connected to other device using analog input.

# Using a Bluetooth Wireless Technology

## About Bluetooth

**Bluetooth®** is wireless communication technology for short range connection.

The available range is within 10 meters.

(The sound may be interrupted when the connection interfered by the other electronic wave or you connect the bluetooth in the other rooms.) Connecting individual devices under **Bluetooth®** wireless technology does not incur any charges. A mobile phone with **Bluetooth®** wireless technology can be operated via the Cascade if the connection was made via **Bluetooth®** wireless technology.  
Available Devices : Mobile phone, MP3, Laptop, PDA.



## Bluetooth Profiles

In order to use Bluetooth wireless technology, devices must be able to interpret certain profiles. This unit is compatible with following profile.

A2DP (Advanced Audio Distribution Profile)

## Listening to Music of a Bluetooth Device

Before you start the pairing procedure, make sure the Bluetooth feature is turned on in to your Bluetooth device. Refer to your Bluetooth device's user guide. Once a pairing operation is performed, it does not need to be performed again.

1. Select the Bluetooth function by using the  /F. Bluetooth LED "  "blinks in the display window.
2. Operate the Bluetooth device and perform the pairing operation. When searching for this unit with the Bluetooth device, a list of the devices found may appear in the Bluetooth device display depending on the type of Bluetooth device. Your unit appears as "ND1530".
3. Enter the PIN code.  
PIN code : 0000
4. When this unit successfully is connected with your Bluetooth device, Bluetooth LED "  "stop blinking.

### ! Note

- Depending on the Bluetooth device type, some device have a different pairing way.
- Try pairing procedure if your device name is not in the device list.

5. Listen to music.  
To play a music stored on your Bluetooth device, refer to your Bluetooth device's user guide. According to your Bluetooth device's volume level, the volume level of Bluetooth will be adjusted.

### ! Note

- Sound from the main set can be distorted if you raise the volume of Bluetooth device up to two-thirds or more.
- When you use the Bluetooth function, adjust the volume of a Bluetooth device to a proper level to listen to.

**Note**

- After searching for this unit on your Bluetooth device, connect the Bluetooth device to this unit. Then play music you want.
- The sound may be interrupted when the connection interfered by the other electronic wave.
- You cannot control the Bluetooth device with this unit.
- Pairing is limited one Bluetooth device per one unit and multi-pairing is not supported.
- Although the distance between your Bluetooth and the set is less than 10 m, there are obstacles between both, your Bluetooth device cannot be connected.
- Depending on the type of the device, you may not be able to use the Bluetooth function.
- You can enjoy wireless system using phone, MP3, Notebook, etc..
- When not connected the Bluetooth LED "  " blinks in the display window.
- The Electrical malfunction due to devices using same frequency such as Medical equipment, Microwaves or wireless LAN devices, the connection will be disconnected.
- When someone stands and interrupts communication between Bluetooth device and the player, the connection will be disconnected.
- If the gotten away of the distance between Bluetooth and the unit, the sound quality is lower and lower. The connection will be disconnected when the space between the Bluetooth and the unit gets out of the operating range of Bluetooth.
- The device with Bluetooth wireless technology is disconnected, if you turn off the main unit or put the device away from the main unit more than 10 m.
- If the Bluetooth device is disconnected, you should connect the Bluetooth device to your unit.

**Note**

- In some of mobile phone, if you don't disconnect bluetooth pairing status by phone forcedly when you power off the device, bluetooth can be connected automatically after device is powered on.
- In some of mobile phone, there are two ways to turn off the Bluetooth on the phone. Just disconnect and another one pairing off. Just disconnect the device and try to connect again. So If you want to terminate the connection quite do the pairing off.

# Troubleshooting

Problem	Correction
No Power.	<ul style="list-style-type: none"> <li>• Plug in the power cord.</li> <li>• Check the condition by operating other electronic devices.</li> </ul>
No sound.	<ul style="list-style-type: none"> <li>• Press <b>⏻/F</b> and then check the selected function.</li> <li>• Adjust volume of your portable device.</li> </ul>
iPhone/iPod does not work.	Connect iPhone/iPod to the unit correctly.

## Trademarks and Licenses



*Bluetooth*® wireless technology is a system which allows radio contact between electronic devices within a max. range of 10 meters.

Connecting individual devices under *Bluetooth*® wireless technology does not incur any charges. A mobile phone with *Bluetooth*® wireless technology can be operated via the Cascade if the connection was made via *Bluetooth*® wireless technology.

The *Bluetooth*® word mark and logos are owned by the *Bluetooth*® SIG, Inc. and any use of such marks by LG Electronics is under license.

Other trademarks and trade names are those of their respective owners.

## Handling the Unit

### When Shipping the Unit

Please save the original shipping carton and packing materials. If you need to ship the unit, for maximum protection, re-pack the unit as it was originally packed at the factory.

### Keeping the Exterior Surfaces Clean

Do not use volatile liquids such as insecticide spray near the unit.

Wiping with strong pressure may damage the surface.

Do not leave rubber or plastic products in contact with the unit for a long period of time.

### Cleaning the Unit

To clean the player, use a soft, dry cloth. If the surfaces are extremely dirty, use a soft cloth lightly moistened with a mild detergent solution. Do not use strong solvents such as alcohol, benzine, or thinner, as these might damage the surface of the unit.

## Specifications

General	
AC adapter requirements	DC 12 V $\text{---}$ 2 A, 100 -240 V, 50/ 60 Hz
Power consumption	18 W
Dimensions (W x H x D)	174 mm X 174 mm X 90.5 mm
Net Weight (Approx.)	0.8 kg
Operating temperature	5 °C to 35 °C (41 °F to 95 °F)
Operating humidity	5 % to 90 %

Inputs	
PORT. IN	500 mV (3.5 mm stereo jack)

USB	
USB Version	USB 2.0
Bus Power Supply	USB : DC 5 V $\text{---}$ 1 A, DOCK : DC 5 V $\text{---}$ 1 A

Amplifier	
Output Power	5 W (8 $\Omega$ at 1 kHz)
T.H.D	10 %

Speakers	
Type	built-in
Impedance Rated	8 $\Omega$
Rated Input Power	5 W
Max. Input Power	10 W

- Design and specifications are subject to change without notice.

