

LG-A390 User Guide

This guide will help you understand your new mobile phone. It will provide you with useful explanations of features on your phone. Some of the contents in this manual may differ from your phone depending on the software of the phone or your service provider.



MFL67787710 (1.0)

www.lg.com

Getting to know your phone

LED Blinker

LED indicator blink with respective color on pressing of Sim Switching Key(SSK) in the idle screen,notification popup(Message and missed call) and glow continuously while charging.

Main screen

Each of these keys performs the functions indicated by the text on the display immediately above them.

Soft keys

Selects menu options and confirms actions.

OK key

Dials a phone number and answers incoming calls.

Call key

Making a call
 1. Enter the number using the keypad. To delete a digit press **Clear**.
 2. Press **Call** to initiate the call.
 3. To end the call, press **End**.
TIP! To enter + when making an international call, press and hold **0**.

Answering and rejecting a call

When your phone rings, press **Call** to answer the call. While your phone is ringing, select **Silent** to mute the ringing. This is useful if you have forgotten to change your profile to **Silent** for a meeting. Press **Call** or select **Silent** then **Reject** to reject the incoming call.

Applications

Your LG-A390 comes with preloaded games to keep you amused when you have time to spare. If you choose to download any additional games or applications they will be saved into this folder. Press **Menu** and select **Applications**. Choose **My games & apps**.
• Steps to be followed to set the required language in Facebook Application:
After login: **Menu > Settings > Language**, user can select the language.
Before Login: In login screen , the last option "Language" , user can select the language.

Changing your phone settings (Menu > Settings > Phone)

Enjoy the freedom of adapting how your LG-A390 works for your own style.
• UART settings - User will be able to perform the operation from PC using modem for selected SIM card in UART settings (like AT command using HyperTerminal, PC dialup). User will be able to make the GPRS dialup on PC using the SIM which is selected in UART setting for e.g. if SIM1 is selected then user will be able to make the connection using selected SIM card.
• Misc. settings - You can set the brightness and time of the display screen.

Resetting your phone (Menu > Settings > Restore factory settings)

You can initialize all factory defaults. You need Security code to activate this function.

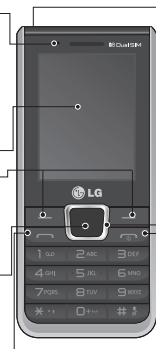

Headset jack

Navigation keys

Use for quick access to phone functions
• In standby mode:
 Press Up Navigation Key: MP3 player
 Press Down Navigation Key: Messaging
 Press Right Navigation Key: FM Radio
 Press Left Navigation Key: Camera
• In menu: Scroll up, down, Right & left.

End/Power key

• Ends or rejects a call.
• Returns to the home screen when you use the menu.
• Long Press to Turn On/Off.



Charger / USB Cable connector

SIM Switch Key
 SIM Switch Key is used to switch between 2 SIM cards. You can switch to another SIM card by pressing the **SIM Switch Key** more than 0.5 seconds.



Note: Memory card is an optional accessory.

Formatting the memory card

From your home screen, Press **Menu** and select **Gallery**, Select **External memory** and From **Options** choose **Format** and enter Phone Password to format the Memory card.

WARNING: When you format your Memory card, all the content will be Erased. If you do not want to lose the data on your Memory card, take a backup first.

3. Press Up/Down navigation key to scroll through the contacts.

Adding a new contact

1. Select **Contacts** from the home screen. Select **Add new contact**.
 2. Choose the contact storage location.
 3. Then enter the Name, Number & details of your new contact, select **Options** then choose **Save**.

TIP! **Assign SIM** field is used to assign the Contact to **Default SIM/SIM1/SIM2**. Call will be originated via assigned SIM for the Contact when **Cost Save mode** is **ON**.

Messaging

Sending a message

1. Press **Menu**, select **Messaging**, and choose **Write message** to send an SMS or MMS.

Adding a city to your world time (Menu > Organizer > World time)

You can check the current time of major cities around the world.

Using your calculator (Menu > Organizer > Calculator)

The calculator provides the basic arithmetic functions: addition, subtraction, multiplication and division .

Converting a unit (Menu > Organizer > Converter)

This converts any measurements into a unit you want.

Using the stopwatch (Menu > Organizer > Stopwatch)

This option allows you to use the function of a stopwatch.

Installing LG PC Suite on your computer

1. Go to www.lg.com and choose your country.
 2. Select **Support** and Go to **Mobile Support**.
 3. Follow the instructions on screen to complete the LG PC Suite Installation on your PC.

Phone Software update

LG Mobile Phone Software update from internet

For more information on using this function, please visit the <http://www.lg.com/common/index.jsp> ----> select country.
 This Feature allows you to update the firmware of your phone to the latest version conveniently from the internet without the need to visit a service centre. As the mobile phone firmware update requires the user's full attention for the duration of the update process, please make sure to check all instructions and notes that appear at each step before

2. If you want to add some images or videos etc, select **Options** and choose **Add Picture, Add sound, Add video, Add subject**.
 3. From **Options** choose **Send** to then Select **Enter recipient, Add from Phonebook or Recent input**. You can even add multiple contacts by marking the contacts.
 4. Press **Send** icon to send the message.
WARNING: Image, Video clip, Sound clip or Subject is added to the message editor, it will be automatically converted to MMS mode and you will be charged accordingly.

E-mail

Sending an e-mail using your new account

To send/receive an e-mail, you should set up an e-mail account.

1. From **Menu** Select **Messaging** and choose **E-mail**.

Shortcuts (Menu > Organizer > Shortcuts)

It helps you to go to the menu you search for. You can set the item as Shortcuts.

Internet

Accessing the internet browser

You can launch the wap browser and access the homepage of the activated profile on Internet Profiles. You can also manually enter a URL address and access the associated wap page. Press **Menu** and select **Internet**.

Note: An additional cost is incurred when connecting to this service and downloading content. Check your data charges with your network provider.

proceeding. Please note that removing the USB data cable or battery during the upgrade may seriously damage your mobile phone.

Guidelines for safe and efficient use
 Please read these simple guidelines. Not following these guidelines may be dangerous or illegal.

Exposure to radio frequency energy
 Radio wave exposure and Specific Absorption Rate (SAR) information. This mobile phone model LG-A390 has been designed to comply with applicable safety requirements for exposure to radio waves. These requirements are based on scientific guidelines that include safety margins designed to assure the safety of all persons, regardless of age and health.

Installing the SIM Card and Charging the Battery

Installing the SIM Card

When you subscribe to a cellular network, you are provided with a SIM card loaded with your subscription details, such as your PIN, any optional services available and many others.

Important! > The SIM card can be easily damaged by scratches or bending, so be careful when handling, inserting or removing the card. Keep all SIM cards out of the reach of small children.
 > Only 2G/2.5G SIM cards are supported.

Illustrations

1. Open back cover.
2. Remove the battery.
3. Insert your SIM Cards.
4. Insert your battery.
5. Close the back cover.
6. Charge your battery.

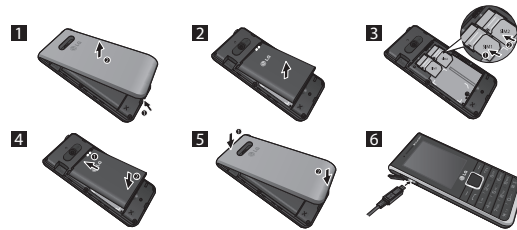

WARNING: Do not remove the battery when the phone is switched on, as this may damage the phone.

2. From **Options** Choose **Write e-mail** and a new e-mail editor screen will open.
3. Enter the recipient's address and write a subject.
4. Enter your message.
5. Press **Options**, select **Add attachments** to add a file.
6. From **Options** Choose **Send** to sent your e-mail.

Camera

You can take photos with the built in camera and adjust its settings to suit your needs.

Video camera

You can record a video clip through the built-in camera.

Settings

Switching your SIM cards (Menu > Settings > Dual SIM > Dual SIM switch)

You can choose which SIM card you're going to use between manually or automatically.

Activating SIM cards (Menu > Settings > Dual SIM > Dual SIM Settings)

You can choose one or all of SIM cards you would like to activate.

Setting Phone Profile (Menu > Settings > Profiles)

You can adjust and customize the phone tones for different events, or environments.

Changing your display settings (Menu > Settings > Display)

You can change the settings for the phone display.

Media Player

Your LG-A390 has a built-in Media player so you can play all your favourite music.

FM radio

Your LG-A390 has an FM radio feature so you can tune into your favourite stations and listen on the move.

Note: You will need to insert your headset in order to listen to the radio. Insert the plug into the headset connector in order to listen to the radio and keep the good radio reception.

Voice recorder

Use your Voice recorder to record voice memos or other sounds.

Changing your connectivity settings (Menu > Settings > Connectivity > Data account)

Your connectivity settings have already been set up by your network operator, so you can enjoy your new phone from switch on. If you want to change any settings, use this menu. You can configure the Data account in this menu.

Changing your Bluetooth settings (Menu > Settings > Connectivity > Bluetooth)

• Power - Select **Power** as **On/Off**.
• Visibility - Choose whether to **Permanent visible, Temporary visible** or **Off** your device to others.
• My name - Enter a name for your LG-A390.
• Advanced - Set your **Bluetooth settings** for **Audio path, Storage, Sharing permission** and View your Bluetooth address by choosing **My address**.

