



ENGLISH

# WIRELESS SPEAKER

NP1540B / NP1540BP  
NP1540W / NP1540WP

## OWNER'S MANUAL

Please read this manual carefully before operating your set and retain it for future reference.

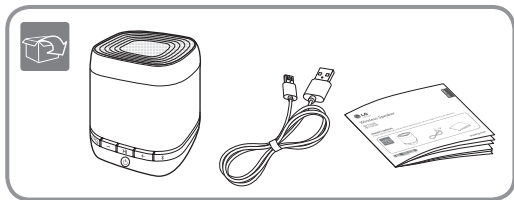

MFL68607315

[www.lg.com](http://www.lg.com)

**CAUTION:** TO REDUCE THE RISK OF ELECTRIC SHOCK DO NOT REMOVE COVER (OR BACK) NO USER-SERVICEABLE PARTS INSIDE REFER SERVICING TO QUALIFIED SERVICE PERSONNEL.



This lightning flash with arrowhead symbol within an equilateral triangle is intended to alert the user to the presence of uninsulated dangerous voltage within the product's enclosure that may be of sufficient magnitude to constitute a risk of electric shock to persons.



The exclamation point within an equilateral triangle is intended to alert the user to the presence of important operating and maintenance (servicing) instructions in the literature accompanying the product.

**WARNING:**

- To prevent fire or electric shock hazard, do not expose this product to rain or moisture.
- Do not install this equipment in a confined space such as a book case or similar unit.

**CAUTION:**

- The apparatus should not be exposed to water (dripping or splashing) and no objects filled with liquids, such as vases, should be placed on the apparatus.
- No naked flame sources, such as lighted candles, should be placed on the apparatus.
- Internal lithium battery in the unit should not be replaced by user because of danger of explosion if battery is incorrectly replaced, and must be replaced with the same type battery by expert.



- To avoid fire or electric shock, do not open the unit. Contact with qualified personnel only.
  - Do not leave the unit in a place near the heating appliances or subject to direct sunlight, moisture, or mechanical shock.
  - To clean the unit, use a soft, dry cloth. If the surfaces are extremely dirty, use a soft cloth lightly moistened with a mild detergent solution. Do not use strong solvents such as alcohol, benzene, or thinner, as these might damage the surface of the unit.
  - Do not use volatile liquids such as insecticide spray near the unit. Wiping with strong pressure may damage the surface. Do not leave rubber or plastic products in contact with the unit for a long period of time.
  - Do not place the unit over the vehicle's air bag. When the air bag deploys, it may result in injury. Before using in the car, fix the unit.
  - Do not leave the unit on an unstable place such as high shelves. It may fall down because of the vibration of the sound.
- CAUTION:** Do not remove the battery incorporated with the product for your safety. If you need to replace the battery, take it to the nearest authorized LG Electronics service point or dealer for assistance.
- CAUTION when using this product in environments of low humidity.**
- It may cause static electricity in environments of low humidity.
  - It is recommended to use this product after touching any metal object which conducts electricity.
- NOTICE:** For safety making information including product identification and supply ratings, please refer to the main label on the bottom of the apparatus.

# Important Safety Instructions

1. Read these instructions.
2. Keep these instructions.
3. Heed all warnings.
4. Follow all instructions.
5. Do not use this apparatus near water.
6. Clean only with dry cloth.
7. Do not block any ventilation openings. Install in accordance with the manufacturer's instructions.
8. Do not install near any heat sources such as radiators, heat registers, stoves, or other apparatus (including amplifiers) that produce heat.
9. Do not defeat the safety purpose of the polarized or grounding-type plug. A polarized plug has two blades with one wider than the other. A grounding type plug has two blades and a third grounding prong. The wide blade or the third prong are provided for your safety. If the provided plug does not fit into your outlet, consult an electrician for replacement of the obsolete outlet.
10. Protect the power cord from being walked on or pinched particularly at plugs, convenience receptacles, and the point where they exit from the apparatus.
11. Only use attachments/accessories specified by the manufacturer.

12. Use only the cart, stand, tripod, bracket, or table specified by the manufacturer, or sold with apparatus. When a cart is used, use caution when moving the cart/apparatus combination to avoid injury from tip-over.



13. Unplug this apparatus during lightning storms or when unused for long periods of time.

14. Refer all servicing to qualified service personnel. Servicing is required when the apparatus has been damaged in any way, such as power-supply cord or plug is damaged, liquid has been spilled or objects have fallen into the apparatus, the apparatus has been exposed to rain or moisture, does not operate normally, or has been dropped.



## Overview

[Front]

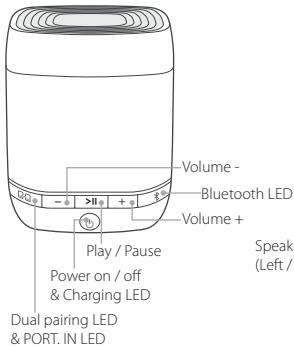

[Rear]

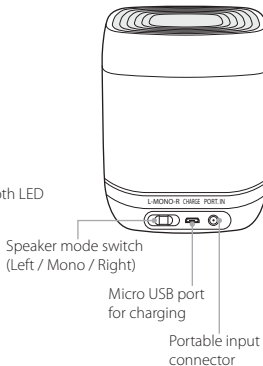



## LED Indicator

Status	LED
Battery low	⏻ / Red / Blinking
Charging	⏻ / Red / Staying
Charged	⏻ / Off
Turn on	🔌 or 🔌 / Red / Staying
Turn off	🔌 / Off
Ready for single pairing	🔌 / Red / Blinking
Single paired & Ready to play	🔌 / Red / Staying
Ready to detect each other	🔌 / Red / Blinking 🔌 / Red / Blinking
Paired each other & Ready for dual pairing	🔌 / Red / Blinking (L speaker only) 🔌 / Red / Staying
Dual paired & Ready to play	🔌 / Red / Staying 🔌 / Red / Staying



## Charging

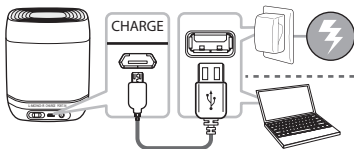

- Charging LED  
for battery status
- Charging : Red
  - Charged : Off
- Charging time
- About 3 hours

- [Note]**
- The battery can last up to 5 hours. (Based on 30 % volume, 1 kHz signal, 600 mV portable input and fully charged status)
  - When the battery is low, the beep sound is heard in Bluetooth mode.
  - Charging the unit using the PC takes longer time.
  - To prevent electric shock, handle with care during charging.
  - Avoid high or low temperature or humidity.
  - AC adaptor is not supplied.
  - This unit must always be operated with DC 5 V. certified/listed adaptor which complies with LPS.
  - Do not use the adaptor higher than DC 5 V.



## Bluetooth Connection

1



Before turning on the unit, move the mode switch to MONO.

2



Press and hold to turn on. The unit goes into the pairing mode.



## Bluetooth Connection

3



Select "LG BT Box (XX:XX)" on your Bluetooth device. (XX:XX means the last four digits of BT address.)

4



After pairing, the voice notification is heard and Bluetooth LED stays turned on. If the unit fails to pair, go to step 1 and try again.



## Bluetooth Connection

5



Play the desired music on the Bluetooth device. After pairing, you can control playback using the buttons on the front of the unit.

-----  
**[Note]**

- Once pairing is performed, it does not need to be done again even if you turn off this unit.
- To unpair the Bluetooth device, press and hold **>||** on the front of the unit for 3 seconds. The unit is unpaired.



## Dual Speaker Connection

\* Two speakers are needed to enjoy in stereo.

1

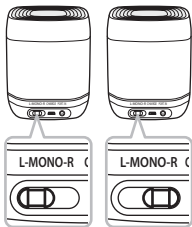

Before turning on the unit, move the each speaker's mode switch to L and R.

2

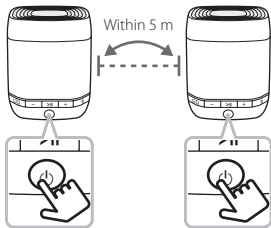

Press and hold to turn on. The two speakers begin to detect each other automatically. It takes about 45 seconds but can be longer depending on use environment.



## Dual Speaker Connection

3



After detecting, beep sound is heard and dual pairing LED stays turned on. the unit goes into the pairing mode. If the units fail to detect, go to step 1 and try again.

4



Select "LG BT Box 2 (XX:XX)" on your Bluetooth device.



## Dual Speaker Connection

5



After pairing, the voice notification is heard and the Bluetooth LED stay turned on. If the unit fails to pair, go to step 1 and try again.

6



Play the desired music on the Bluetooth device. After pairing, you can control playback using the buttons on the front of the unit.



## Portable Input Connection

1

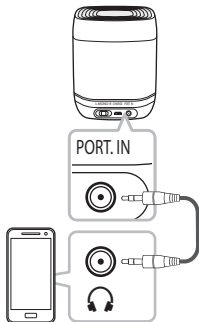

Connect the unit to the external device using PORT. IN cable.

2



Press and hold to turn on.  
PORT. IN LED stays turned on.



## Portable Input Connection

3

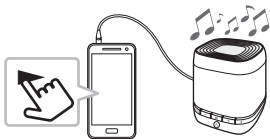

Play the desired music on the device connected to the unit. While the unit is connected with PORT. IN cable, >|| in the front of the unit does not work.



## Additional Information

- The operating time on battery is subject to battery status, operational status and environment conditions.
- The Bluetooth connection can be disconnected in case that the distance between the unit and your Bluetooth device is more than the Bluetooth range limitation.
- This unit is turned off automatically in case that any button is not pressed or any input source is not connected for 20 minutes in Bluetooth mode.
- PORT. IN cable (ø 3.5 mm mini stereo cable) is not supplied.
- While using PORT. IN connection, Bluetooth connection is unavailable.
- While using PORT. IN connection, stereo mode using extra speaker is unavailable.
- When you disconnect PORT. IN connection, previous Bluetooth connection is repaired to the unit automatically.
- Depending on the type of the Bluetooth device, some devices have a different way of pairing.
- The sound may be interrupted when the connection is interfered by the other electronic wave.



## Additional Information

- In case that there are obstacles between your Bluetooth device and the unit, the device cannot be connected even though the distance between both is less than the Bluetooth range limitation.
- When you use dual speaker connection, keep the distance between the units closer than Bluetooth range limitation. If the distance between the units is more than the Bluetooth range limitation, the units can be turned off automatically.
- The electrical malfunction due to the devices using same frequency such as medical equipment, microwaves or wireless LAN devices, may make the unit disconnected.
- The sound notification function is available in Bluetooth mode only.
- Bluetooth connection using the PC or dongle is not supported.



## Specification

<b>Power Supply</b>	<ul style="list-style-type: none"><li>• 5 V  2 A</li><li>• Built-in rechargeable battery</li></ul>
<b>Power Consumption</b>	<ul style="list-style-type: none"><li>• 2.5 W</li></ul>
<b>Dimensions (W x H x D)</b>	<ul style="list-style-type: none"><li>• Approx. 83 mm x 95 mm x 83 mm</li></ul>
<b>Net Weight</b>	<ul style="list-style-type: none"><li>• Approx. 370 g</li></ul>
<b>Operating Temperature</b>	<ul style="list-style-type: none"><li>• 0 °C to 35 °C</li></ul>
<b>Operating Humidity</b>	<ul style="list-style-type: none"><li>• 5 % to 60 %</li></ul>
<b>External Connector</b>	<ul style="list-style-type: none"><li>• ø 3.5 mm mini jack</li><li>• Micro USB port for charging battery</li></ul>
<b>Communication</b>	<ul style="list-style-type: none"><li>• Bluetooth 3.0</li></ul>
<b>Speaker</b>	<ul style="list-style-type: none"><li>• Type : Built-in</li><li>• Impedance Rate : 4 Ω</li><li>• Max. Output Power : 2.8 W</li><li>• THD: 10%</li></ul>

- Design and specifications are subject to change without notice.



## Troubleshooting

### No power

- The battery is discharged. Recharge the battery.
- Connect the unit to the power supply with the AC adapter.

### No sound or sound distortion

- The unit or your Bluetooth device's volume is set to minimum. Check and adjust the volume of the unit or Bluetooth device's volume.
- When you use an external device at high volume, the sound quality may be deteriorated. Lower the volume of the devices.
- If you use the unit for purposes other than listening to music, the sound quality may be lowered or the unit may not work properly.

- If the unit does not work well in Bluetooth mode, switch Bluetooth off and on again on your Bluetooth device.

### Bluetooth pairing does not work well.

- Switch Bluetooth off and on again on your Bluetooth device, then try pairing again.
- Be sure that your Bluetooth device is on.
- Remove the obstacle in the path of the Bluetooth device and the unit.
- Depending on the type of the Bluetooth device or surrounding environment, your device may not be paired with the unit.



## Troubleshooting

### **The unit does not operate normally.**

- Press the reset hole on the bottom of the unit using an object like a thin pin. The unit is reset (Refer to below).

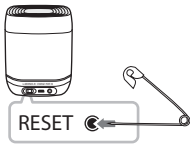

- In case of malfunction, use the unit in proper place where the temperature or humidity is not too high or low.

### **The unit is turned off without voice notification.**

- In PORT. IN mode, voice notification on the battery status is unavailable. When the unit is turned off suddenly in PORT. IN mode, recharge the battery.

### **The charging LED blinks rapidly when the unit is being charged.**

- Turn down the volume of the unit. The LED stops blinking.

