



**LG**

Life's Good

ENGLISH

USER GUIDE

**LG G** *flex 2*  
LG-H955



# User Guide

ENGLISH

- Some content and illustrations may differ from your device depending on the region, service provider, software version, or OS version, and are subject to change without prior notice.
- Always use genuine LG accessories. The supplied items are designed only for this device and may not be compatible with other devices.
- Available accessories may vary depending on your region, country or service provider.
- This handset is not suitable for people who have a visual impairment due to the touchscreen keyboard.
- Copyright ©2015 LG Electronics, Inc. All rights reserved. LG and the LG logo are registered trademarks of LG Group and its related entities. All other trademarks are the property of their respective owners.
- Google™, Google Maps™, Gmail™, YouTube™, Hangouts™ and Play Store™ are trademarks of Google, Inc.

# Table of contents

<b>Guidelines for safe and efficient use</b> .....	<b>4</b>	<b>Google account setup</b> .....	<b>40</b>
<b>Important notice</b> .....	<b>15</b>	<b>Connecting to Networks and Devices</b> ....	<b>41</b>
<b>Getting to know your phone</b> .....	<b>19</b>	Wi-Fi .....	41
Phone layout.....	19	Bluetooth.....	42
Installing the SIM or USIM card .....	21	Wi-Fi Direct .....	43
Charging the phone .....	22	SmartShare .....	44
Inserting a memory card.....	23	Transferring data between a PC and your device.....	45
Unlocking the screen.....	24	<b>Calls</b> .....	<b>46</b>
<b>Your Home screen</b> .....	<b>25</b>	Making a call.....	46
Touch screen tips .....	25	Calling your contacts .....	46
Home screen .....	26	Answering and rejecting a call .....	46
Customizing the Home screen .....	27	Making a second call.....	47
Returning to recently-used applications .....	28	Viewing your call logs .....	47
Notifications panel.....	29	Call settings.....	47
On-screen keyboard .....	32	<b>Contacts</b> .....	<b>48</b>
<b>Special Features</b> .....	<b>33</b>	Searching for a contact.....	48
Gesture shot.....	33	Adding a new contact .....	48
Glance View.....	33	Favorites contacts.....	48
Gesture View .....	34	Creating a group.....	49
KnockON .....	35	<b>Messaging</b> .....	<b>50</b>
Knock Code .....	35	Sending a message .....	50
Dual window.....	36	Conversation view .....	51
QuickMemo+.....	37	Changing message settings.....	51
QSlide.....	38		
QuickRemote.....	39		

<b>E-mail</b> .....	<b>52</b>	<b>Settings</b> .....	<b>74</b>
Managing email accounts.....	52	Networks.....	74
Working with account folders.....	52	Sound.....	77
Composing and sending email.....	53	Display.....	78
		General.....	81
<b>Camera and Video</b> .....	<b>54</b>	<b>PC software (LG PC Suite)</b> .....	<b>87</b>
Camera options on the viewfinder.....	54	For Windows OS.....	87
Using the advanced settings.....	55	For Mac OS.....	88
Taking a photo.....	55	<b>Phone software update</b> .....	<b>90</b>
Once you have taken a photo.....	56	Phone software update.....	90
Recording a video.....	56	<b>About this user guide</b> .....	<b>92</b>
After recording a video.....	57	About this user guide.....	92
Gallery.....	60	Trademarks.....	93
		DivX HD.....	93
<b>Multimedia</b> .....	<b>63</b>	Dolby Digital Plus.....	93
Music.....	63	<b>Accessories</b> .....	<b>94</b>
		<b>Troubleshooting</b> .....	<b>95</b>
<b>Utilities</b> .....	<b>65</b>	<b>FAQ</b> .....	<b>99</b>
Clock.....	65		
Calculator.....	66		
Calendar.....	66		
Voice Recorder.....	67		
Tasks.....	67		
Voice Search.....	68		
Downloads.....	68		
FM radio.....	68		
LG SmartWorld.....	69		
Voice Mate.....	70		
<b>Web Browser</b> .....	<b>71</b>		
Internet.....	71		
Chrome.....	73		

## Guidelines for safe and efficient use

Please read these simple guidelines. Not following these guidelines may be dangerous or illegal.

Should a fault occur, a software tool is built into your device that will gather a fault log. This tool gathers only data specific to the fault, such as signal strength, cell ID position in sudden call drop and applications loaded. The log is used only to help determine the cause of the fault. These logs are encrypted and can only be accessed by an authorized LG Repair centre should you need to return your device for repair.

### Exposure to radio frequency energy

Radio wave exposure and Specific Absorption Rate (SAR) information.

This mobile phone model LG-H955 has been designed to comply with applicable safety requirements for exposure to radio waves. These requirements are based on scientific guidelines that include safety margins designed to assure the safety of all persons, regardless of age and health.

- The radio wave exposure guidelines employ a unit of measurement known as the Specific Absorption Rate (SAR). Tests for SAR are conducted using standardised methods with the phone transmitting at its highest certified power level in all used frequency bands.
- While there may be differences between the SAR levels of various LG phone models, they are all designed to meet the relevant guidelines for exposure to radio waves.
- The SAR limit recommended by the International Commission on Non-Ionizing Radiation Protection (ICNIRP) is 2 W/kg averaged over 10g of tissue.
- The highest SAR value for this model phone tested for use at the ear is 0.471 W/kg (10 g) and when worn on the body is 0.418 W/Kg (10 g).

- This device meets RF exposure guidelines when used either in the normal use position against the ear or when positioned at least 1.5 cm away from the body. When a carry case, belt clip or holder is used for body-worn operation, it should not contain metal and should position the product at least 1.5 cm away from your body. In order to transmit data files or messages, this device requires a quality connection to the network. In some cases, transmission of data files or messages may be delayed until such a connection is available. Ensure the above separation distance instructions are followed until the transmission is completed.

## Product care and maintenance

### **WARNING**

Only use batteries, chargers and accessories approved for use with this particular phone model. The use of any other types may invalidate any approval or warranty applying to the phone and may be dangerous.

- The flexibility of this product is limited to withstand ordinary and normal use. This phone may be bent flat up to 180 degrees for a limited period of time but should not be bent inward. Damages caused by misuse, including but not limited to intentionally bending or continually exerting force on the product, may lead to permanent damage to the display and/or other parts and functions of the phone.
- Do not disassemble this unit. Take it to a qualified service technician when repair work is required.
- Repairs under warranty, at LG's discretion, may include replacement parts or boards that are either new or reconditioned, provided that they have functionality equal to that of the parts being replaced.
- Keep away from electrical appliances such as TVs, radios and personal computers.
- The unit should be kept away from heat sources such as radiators or cookers.
- Do not drop.

- Do not subject this unit to mechanical vibration or shock.
- Switch off the phone in any area where you are required to by special regulations. For example, do not use your phone in hospitals as it may affect sensitive medical equipment.
- Do not handle the phone with wet hands while it is being charged. It may cause an electric shock and can seriously damage your phone.
- Do not charge a handset near flammable material as the handset can become hot and create a fire hazard.
- Use a dry cloth to clean the exterior of the unit (do not use solvents such as benzene, thinner or alcohol).
- Do not charge the phone when it is on soft furnishings.
- The phone should be charged in a well ventilated area.
- Do not subject this unit to excessive smoke or dust.
- Do not keep the phone next to credit cards or transport tickets; it can affect the information on the magnetic strips.
- Do not tap the screen with a sharp object as it may damage the phone.
- Do not expose the phone to liquid or moisture.
- Use accessories like earphones cautiously. Do not touch the antenna unnecessarily.
- Do not use, touch or attempt to remove or fix broken, chipped or cracked glass. Damage to the glass display due to abuse or misuse is not covered under the warranty.
- Your phone is an electronic device that generates heat during normal operation. Extremely prolonged, direct skin contact in the absence of adequate ventilation may result in discomfort or minor burns. Therefore, use care when handling your phone and charger (fast charger) during or immediately after operation.
- If your phone gets wet, immediately unplug it to dry off completely. Do not attempt to accelerate the drying process with an external heating source, such as an oven, microwave or hair dryer.

- The liquid in your wet phone, changes the colour of the product label inside your phone. Damage to your device as a result of exposure to liquid is not covered under your warranty.

## Efficient phone operation

### Electronics devices

All mobile phones may receive interference, which could affect performance.

- Do not use your mobile phone near medical equipment without requesting permission. Avoid placing the phone over pacemakers, for example, in your breast pocket.
- Some hearing aids might be disturbed by mobile phones.
- Minor interference may affect TVs, radios, PCs etc.
- Use your phone in temperatures between 0°C and 40°C, if possible. Exposing your phone to extremely low or high temperatures may result in damage, malfunction, or even explosion.

## Road safety

Check the laws and regulations on the use of mobile phones in the area when you drive.

- Do not use a hand-held phone while driving.
- Give full attention to driving.
- Pull off the road and park before making or answering a call if driving conditions so require.
- RF energy may affect some electronic systems in your vehicle such as car stereos and safety equipment.

- When your vehicle is equipped with an air bag, do not obstruct with installed or portable wireless equipment. It can cause the air bag to fail or cause serious injury due to improper performance.
- If you are listening to music whilst out and about, please ensure that the volume is at a reasonable level so that you are aware of your surroundings. This is of particular importance when near roads.

## Avoid damage to your hearing



To prevent possible hearing damage, do not listen at high volume levels for long periods.

Damage to your hearing can occur if you are exposed to loud sound for long periods of time. We therefore recommend that you do not turn on or off the handset close to your ear. We also recommend that music and call volumes are set to a reasonable level.

- When using headphones, turn the volume down if you cannot hear the people speaking near you, or if the person sitting next to you can hear what you are listening to.

**NOTE:** Excessive sound pressure from earphones and headphones can cause hearing loss.

## Glass Parts

Some parts of your mobile device are made of glass. This glass could break if your mobile device is dropped on a hard surface or receives a substantial impact. If the glass breaks, do not touch or attempt to remove it. Stop using your mobile device until the glass is replaced by an authorised service provider.

## Blasting area

Do not use the phone where blasting is in progress. Observe restrictions and follow any regulations or rules.

## Potentially explosive atmospheres

- Do not use your phone at a refueling point.
- Do not use near fuel or chemicals.
- Do not transport or store flammable gas, liquid or explosives in the same compartment of your vehicle as your mobile phone or accessories.

## In aircraft

Wireless devices can cause interference in aircraft.

- Turn your mobile phone off before boarding any aircraft.
- Do not use it on the ground without permission from the crew.

## Children

Keep the phone in a safe place out of the reach of small children. It includes small parts which may cause a choking hazard if detached.

## Emergency calls

Emergency calls may not be available on all mobile networks. Therefore you should never depend solely on your phone for emergency calls. Check with your local service provider.

## Battery information and care

- You do not need to completely discharge the battery before recharging. Unlike other battery systems, there is no memory effect that could compromise the battery's performance.
- Use only LG batteries and chargers. LG chargers are designed to maximise the battery life.
- Do not disassemble or short-circuit the battery.
- Replace the battery when it no longer provides acceptable performance. The battery pack may be recharged hundreds of times before it needs replacing.
- Recharge the battery if it has not been used for a long time to maximise usability.
- Do not expose the battery charger to direct sunlight or use it in high humidity, such as in the bathroom.
- Dispose of used batteries according to the manufacturer's instructions. Please recycle when possible. Do not dispose as household waste.
- Always unplug the charger from the wall socket after the phone is fully charged to save unnecessary power consumption of the charger.
- Actual battery life will depend on network configuration, product settings, usage patterns, battery and environmental conditions.
- Make sure that no sharp-edged items such as animal's teeth or nails, come into contact with the battery. This could cause a fire.
- Do not leave the phone in hot or cold places, as this may deteriorate phone performance.
- Power Consumption (Networked Standby Mode) : 0.46 W

## **WARNING**

### **Notice for Battery replacement**

- Li-Ion Battery is a hazardous component which can cause injury.
- Battery replacement by non-qualified professional can cause damage to your device.
- Do not replace the battery by yourself. The battery can be damaged, which can cause overheat and injury. The battery must be replaced by the authorized service provider. The battery should be recycled or disposed separately from household waste.
- In case this product contains a battery incorporated within the product which cannot be readily removed by end-users, LG recommends that only qualified professionals remove the battery, either for replacement or for recycling at the end of this product's working life. To prevent damage to the product, and for their own safety, users should not attempt to remove the battery and should contact LG Service Helpline, or other independent service providers for advice.
- Removal of the battery will involve dismantling of the product case, disconnection of the electrical cables/contacts, and careful extraction of the battery cell using specialized tools. If you need the instructions for qualified professionals on how to remove the battery safely, please visit <http://www.lge.com/global/sustainability/environment/take-back-recycling>.

## Laser safety statement

### Caution!

This product employs a laser system. To ensure proper use of this product, please read this owner's manual carefully and retain for future reference. Should the unit require maintenance, contact an authorized service center.

Use of controls, adjustments, or the performance of procedures other than those specified herein may result in hazardous radiation exposure.

To prevent direct exposure to laser beam, do not try to open the enclosure or make direct contact with the laser.

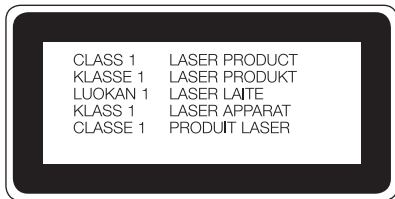

## Open Source Software Notice Information

To obtain the source code under GPL, LGPL, MPL, and other open source licenses, that is contained in this product, please visit <http://opensource.lge.com>. In addition to the source code, all referred license terms, warranty disclaimers and copyright notices are available for download.

LG Electronics will also provide open source code to you on CD-ROM for a charge covering the cost of performing such distribution (such as the cost of media, shipping, and handling) upon email request to [opensource@lge.com](mailto:opensource@lge.com). This offer is valid for three (3) years from the date on which you purchased the product.

## HOW TO UPDATE YOUR DEVICE

Access to latest firmware releases, new software functions and improvements.

- **Select the software update in settings menu on your device.**
- **Update your device by connecting it to your PC.** For more information about using this function, please visit <http://www.lg.com/common/index.jsp> select country and language.

## DECLARATION OF CONFORMITY

Hereby, **LG Electronics** declares that this **LG-H955** product is in compliance with the essential requirements and other relevant provisions of Directive **1999/5/EC**. A copy of the Declaration of Conformity can be found at <http://www.lg.com/global/declaration>

## Contact office for compliance of this product :

LG Electronics Inc.

EU Representative, Krijgsman 1,  
1186 DM Amstelveen, The Netherlands



### Disposal of your old appliance

- 1 All electrical and electronic products should be disposed of separately from the municipal waste stream via designated collection facilities appointed by the government or the local authorities.
- 2 The correct disposal of your old appliance will help prevent potential negative consequences for the environment and human health.
- 3 For more detailed information about disposal of your old appliance, please contact your city office, waste disposal service or the shop where you purchased the product.



### Disposal of waste batteries/accumulators

- 1 This symbol may be combined with chemical symbols for mercury (Hg), cadmium (Cd) or lead (Pb) if the battery contains more than 0.0005% of mercury, 0.002% of cadmium or 0.004% of lead.
- 2 All batteries/accumulators should be disposed separately from the municipal waste stream via designated collection facilities appointed by the government or the local authorities.
- 3 The correct disposal of your old batteries/accumulators will help to prevent potential negative consequences for the environment, animal and human health.
- 4 For more detailed information about disposal of your old batteries/accumulators, please contact your city office, waste disposal service or the shop where you purchased the product.

## Important notice



### Please read this before you start using your phone!

Please check to see whether any problems you encountered with your phone are described in this section before taking the phone in for service or calling a service representative.

## 1. Phone memory

When there is less than 10MB of space available in your phone memory, your phone cannot receive new messages. You must check your phone memory and delete some data, such as applications or messages, to make more memory available.

To uninstall applications:

- 1 Tap  >  > **Apps** tab (if necessary) >  > **General** tab > **Apps**.
- 2 Once all applications appear, scroll to and select the application you want to uninstall.
- 3 Tap **Uninstall**.

## 2. Optimizing battery life

Extend your battery's power by turning off features that you do not need to run constantly in the background. You can monitor how applications and system resources consume battery power.

Extending your phone's battery life:

- Turn off radio communications when you are not using. If you are not using Wi-Fi, Bluetooth or Location services (including GPS), turn them off.

- Reduce screen brightness and set a shorter screen timeout.
- Turn off automatic syncing for Gmail, Calendar, Contacts and other applications.

**NOTE:**

- Some applications you download may consume battery power.
- While using downloaded applications, check the battery charge level.

**NOTE:** If you accidentally press the **Power/Lock Button** while the device is in your pocket, the screen will turn off automatically in order to save battery power.

### 3. Before installing an open source application and OS



**WARNING**

If you install and use an OS other than the one provided by the manufacturer it may cause your phone to malfunction. In addition, your phone will no longer be covered by the warranty.



**WARNING**

To protect your phone and personal data, only download applications from trusted sources, such as Play Store™. If there are improperly installed applications on your phone, the phone may not work normally or a serious error may occur. You must uninstall those applications and all associated data and settings from the phone.

## 4. Using the Hard Reset (Factory Reset)

If your phone needs to be restored to its original settings and condition, use a Hard Reset (Factory Reset).

- 1 Turn the power off.
- 2 Press and hold the **Power/Lock Button + Volume Down Button** on the back of the phone.
- 3 Release the **Power/Lock Button** only when the boot logo is displayed, then immediately press and hold the **Power/Lock Button** again.
- 4 Release all Buttons when the Factory hard reset screen is displayed.
- 5 Press the **Volume Buttons** to select **Yes**, and then press the **Power/Lock Button** to perform a Hard Reset.
- 6 Press the **Volume Buttons** to highlight **YES** once more, then press the **Power/Lock Button** to confirm.



### WARNING

If you perform a Hard Reset, all user applications, user data and DRM licenses will be deleted. Please remember to backup any important data before performing a Hard Reset.

## 5. Opening and switching applications

Multitasking is easy with Android; you can keep more than one application running at the same time. There is no need to quit an application before opening another. Use and switch between several open applications. Android manages each application, stopping and starting them as needed to make sure that idle applications don't consume resources unnecessarily.

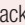
- 1 Tap . App previews of recently used applications will be displayed.
- 2 Tap the application you want to access. This does not stop the previous app from running in the background. Make sure to tap  to back out of a window after using it.
  - To close an app from the recent apps list, swipe the app preview to the left or right. To clear all apps, tap **Clear all**.

## 6. If the screen freezes

**If the screen freezes or the phone does not respond when you try to operate it:**

Press and hold the **Power/Lock Button** and **Volume Down Button** for about 10 seconds to reset your phone. To turn your phone off, press and hold the **Power/Lock Button** and the **Volume Down Button** for about 20 seconds. If it still does not work, please contact the service center.

# Getting to know your phone

## Phone layout

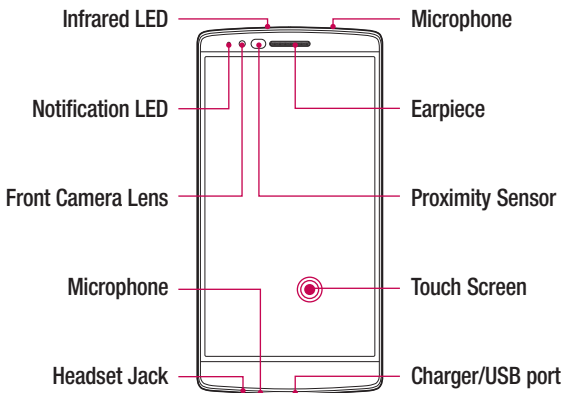

### NOTE: Proximity sensor

When receiving and making calls, the proximity sensor automatically turns the backlight off and locks the touch screen by sensing when the phone is near your ear. This extends battery life and prevents you from unintentionally activating the touch screen during calls.



### WARNING

Placing a heavy object on the phone or sitting on it can damage the display and touch screen functions. Do not cover the proximity sensor with screen protectors or any other type of protective film. This could cause the sensor to malfunction.

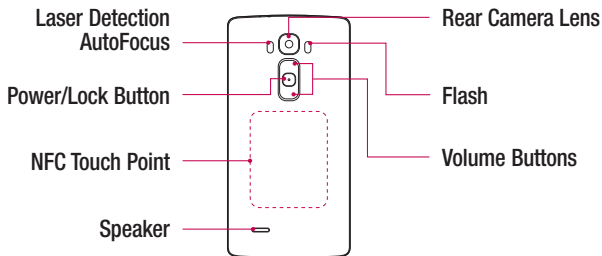

- |                          |   |
|--------------------------|---|
| <b>Power/Lock Button</b> | <ul style="list-style-type: none"> <li>• Turn your phone on/off by pressing and holding this button</li> <li>• Short press to lock/unlock the screen</li> </ul> |
|--------------------------|---|

- |                       |  |
|-----------------------|--|
| <b>Volume Buttons</b> | <p><b>(While screen is off)</b></p> <ul style="list-style-type: none"> <li>• Long press the Up key to launch QuickMemo+</li> <li>• Long press the Down key to launch Camera</li> </ul> |
|-----------------------|--|

### **WARNING**

Be careful not to damage the NFC touch point on the phone, as this is part of the NFC antenna.

**NOTE:** The back cover of this product applies a “self-healing” technology, which self-repairs minor scratches in just a few minutes. Minor scratches are those caused by ordinary and normal use of the phone. Scratches caused by abrasive surface, misuse, including but not limited to intentional scratches, and damages caused by a fall or dropping the product, may not disappear. The “self-healing” results may vary depending on the extent of the damage as well as other conditions. Any warranty on the “self-healing” is hereby expressly excluded.

### **NOTE: LDAF Sensor (Laser Detection AutoFocus Sensor)**

By detecting the distance with laser, when you recording with the rear camera lens, LDAF Sensor enables you to focus the long or close range more fast and accurately.

## Installing the SIM or USIM card

Before you can start exploring your new phone, you need to set it up.

- 1 To remove the back cover, hold the phone firmly in one hand. With your other hand, lift off the back cover with your thumbnail as shown in the figure below.

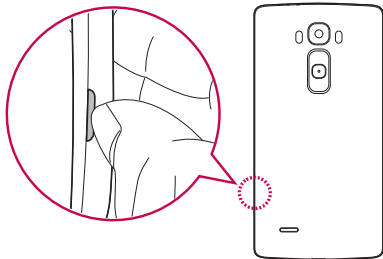

- 2 Slide the SIM card into the lower slot for the SIM card as shown in the figure. Make sure the gold contact area on the card is facing downward.

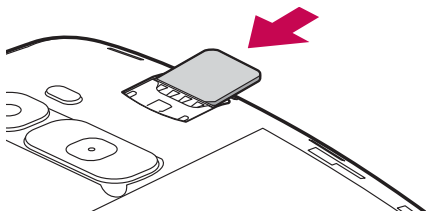

**NOTE:** Only the microSIM cards work with the device.

- 3 To replace the cover onto the device, align the back cover over the battery compartment (1) and press it down until it clicks into place (2).

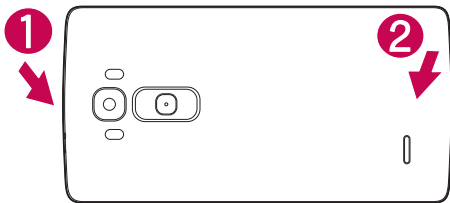

## Charging the phone

Charge the battery before using it for first time. Use the charger to charge the battery.

### WARNING

Use only LG-approved chargers, batteries and cables. If you use unapproved chargers, batteries or cables, it may cause battery charging delay or pop up message regarding slow charging, Or this can cause the battery to explode or damage the device, which are not covered by the warranty.

The charger connector is at the bottom of the phone. Insert the charger and plug it into a power outlet.

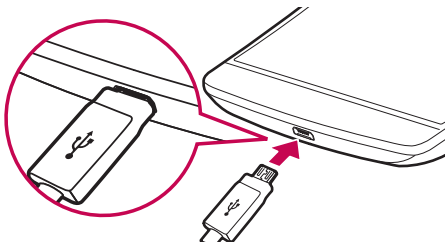

**NOTE:** Do not open the back cover while your phone is charging.

## Inserting a memory card

Your device supports up to a 32 GB microSD card. Depending on the memory card manufacturer and type, some memory cards may not be compatible with your device.

### **WARNING**

Some memory cards may not be fully compatible with the device. Using an incompatible card may damage the device or the memory card, or corrupt the data stored in it.

### **NOTE:**

- The device supports the FAT and the exFAT file systems for memory cards. When inserting a card formatted in a different file system, the device asks to reformat the memory card.
- Frequent writing and erasing of data shortens the lifespan of memory cards.

- 1 Remove the back cover.
- 2 Insert a memory card with the gold-coloured contacts facing downwards.

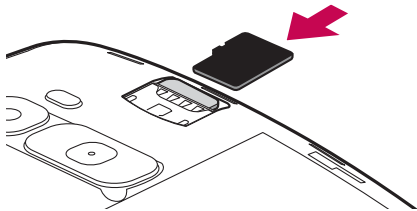

- 3 Replace the back cover.

Getting to know your phone

## Unlocking the screen

By default, your screen will lock after a period of inactivity, then turn off.



### Unlocking the screen

- 1 Press the **Power/Lock Button** or double-tap on the screen.
- 2 Swipe the screen in any direction to unlock it.

#### **TIP! Smart Lock**

You can use **Smart Lock** to make unlocking your phone easier. You can set it to keep your phone unlocked when you have a trusted Bluetooth device connected to it, when it's in a familiar location like your home or work, or when it recognises your face.

#### **Setting up Smart Lock**

- 1 Tap  >  > **Apps** tab > .
- 2 Tap **Display** tab > **Lock screen** > **Smart Lock**.
- 3 Before you add any trusted devices, trusted places, or trusted face, you need to set up a screen lock (pattern, PIN, or password).

## Touch screen tips

Here are some tips on how to navigate on your phone.

- **Tap or touch** – A single finger tap selects items, links, shortcuts and letters on the on-screen keyboard.
- **Touch and hold** – Touch and hold an item on the screen by tapping it and not lifting your finger until an action occurs.
- **Drag** – Touch and hold an item for a moment and then, without lifting your finger, move your finger on the screen until you reach the target position. You can drag items on the Home screen to reposition them.
- **Swipe or slide** – To swipe or slide, quickly move your finger across the surface of the screen, without pausing when you first tap it (so you don't drag an item instead).
- **Double-tap** – Double-tap to zoom on a webpage or a map (if the feature is supported by the application).
- **Pinch-to-Zoom** – Use your index finger and thumb in a pinching or spreading motion to zoom in or out when using the browser or Maps, or when browsing pictures (if the feature is supported by the application).
- **Rotate the screen** – From many applications and menus, the physical orientation of the screen adjusts to the device's physical orientation.

### NOTE:

- Do not press too hard; the tap screen is sensitive enough to pick up a light, yet firm tap.
- Use the tip of your finger to tap the option you want. Be careful not to tap any other keys.

## Home screen

The Home screen is the starting point for many applications and functions. It allows you to add items like app shortcuts and Google widgets to give you instant access to information and applications. This is the default canvas and accessible from any menu by tapping .



- 1** Shows phone's status information, including the time, signal strength, battery status and notification icons.
- 2** Widgets are self-contained applications that can be accessed through the Apps drawer or on the Home screen. Unlike a shortcut, a Widget can function as an on-screen application.
- 3** Tap an icon (application, folder, etc.) to open and use it.
- 4** Indicates which Home screen canvas you are currently viewing.
- 5** Provides one-touch access to the function in any Home screen canvas.

<b>6</b> ◀ <b>Back Key</b>	Returns to the previous screen. Also closes pop-up items, such as menus, dialog boxes and the on-screen keyboard. Touch and hold it to access the Dual window.
○ <b>Home Key</b>	Return to the Home screen from any screen.
□ <b>Recent Key</b>	Displays recently used applications. If you touch and hold this key, it opens a menu of available options.

## Extended Home screen

The operating system provides multiple Home screen canvases to provide more space for adding icons, widgets and more.

- Slide your finger left or right across the Home screen to access additional canvases.

## Customizing the Home screen

You can customize your Home screen by adding apps and widgets and changing wallpapers.

### Adding items on your Home screen

- 1 Touch and hold the empty part of the Home screen.
- 2 In the Add Mode menu, select the item you want to add. You then see this added item onto the Home screen canvas.
- 3 Drag it to the desired location and lift your finger.

**TIP!** To add an application icon to the Home screen from the Apps menu, touch and hold the application you want to add.

## Removing an item from the Home screen

- **Home screen** > Touch and hold the icon you want to remove > drag it to .

## Adding an app as a Quick key

- From the Apps menu or on the Home screen, touch and hold an application icon and drag it to the Quick key area. Up to 7 apps can be added.

## Removing an app from the Quick key area



- Touch and hold the desired quick key and drag it to .

**NOTE:**  **Apps Key** cannot be removed.

## Customizing app icons on the Home screen

- 1 Touch and hold an application icon already on the Home screen canvas. The editing icon  appears in the upper-right corner of the application.
- 2 Tap the application icon again and select the desired icon design and size.
- 3 Tap **OK** to save the change.

## Returning to recently-used applications

- 1 Tap . A list of recently used applications will be displayed.
- 2 Tap an icon to open the application. Or tap  to return to your previous screen.

## Notifications panel

Notifications alert you to the arrival of new messages, calendar events and alarms, as well as ongoing events, such as when you are using turn-by-turn navigation.

When a notification arrives, its icon appears at the top of the screen. Icons for pending notifications appear on the left, and system icons, such as Wi-Fi and battery strength shown on the right.

**NOTE:** The available options may vary depending on the region or service provider.

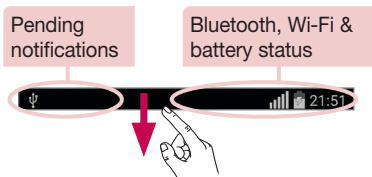

## Opening the Notifications panel

Swipe down from the Status bar to open the Notifications panel. To close the Notifications panel, touch and drag the screen toward the top of the screen.

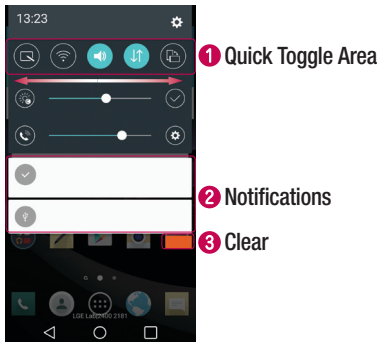











- 1** Tap each quick toggle key to turn it on/off. Touch and hold the key to access the settings menu for the function. To see more toggle keys, swipe left or right. Tap  to remove, add or rearrange toggle keys.
- 2** Current notifications are listed, each with a brief description. Tap a notification to open the corresponding application that manages it.
- 3** Tap to clear all the notifications.









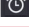

## Indicator icons on the Status Bar

Indicator icons appear on the Status bar at the top of the screen to report missed calls, new messages, calendar events, device status and more.



The icons displayed at the top of the screen provide information about the status of the device. The icons listed in the table below are some of the most common ones.

Icon	Description
	No SIM card inserted
	No network signal available
	Airplane mode is on
	Connected to a Wi-Fi network
	Wired headset connected
	Call in progress
	Missed call
	Bluetooth is on
	System warning
	An alarm is set
	New voicemail available

Icon	Description
	A media file is currently playing
	Silent mode is enabled
	Vibrate mode is on
	Battery fully charged
	Battery is charging
	Phone is connected to PC via USB cable
	Downloading data
	Uploading data
	GPS is on
	Data is synchronizing
	Choose input method

	New text or multimedia message		Media server content sharing is on
	NFC is on		Wi-Fi hotspot is active

**NOTE:** The icon's location in the Status bar may differ according to the function or service.

## On-screen keyboard

You can enter text using the on-screen keyboard. The on-screen keyboard appears on the screen when you tap an available text entry field.

### Using the keypad and entering text

 Tap once to capitalize the next letter you type. Tap twice for all caps.

 Tap to access the keyboard's Settings menu.

 Tap to enter a space.

 Tap to create a new line.

 Tap to delete the previous character.

### Entering accented letters

When you select French or Spanish as the text entry language, you can enter special French or Spanish characters (e.g. "á").

For example, to input "á", touch and hold the "a" key until the pop-up appears and displays related special characters. Without lifting the finger, drag your finger to the desired special character.

# Special Features

## Gesture shot

Take a picture with a hand gesture. To take a photo, raise your hand until the front camera detects it and a box appears on the screen.

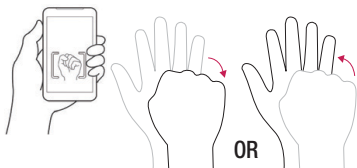

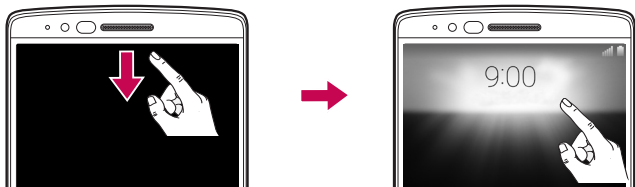

## Glance View

When the phone screen is off, you can see the Status bar, time and date by dragging your finger down on the screen.



## Gesture View

After taking a photo with the front camera lens, you can automatically check the captured photo with this gesture.

- 1 Tap  >  > **Apps** tab (if necessary) > .
- 2 Take a picture with the front camera.
- 3 After taking the picture, bring the phone close to your face. The captured photo will be displayed.

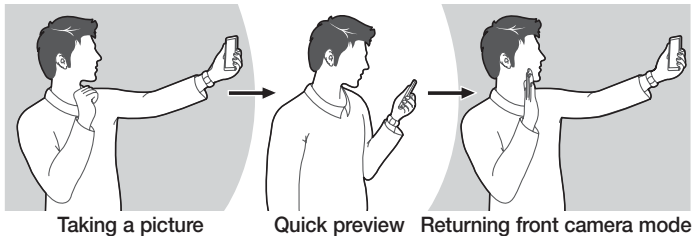

### NOTE:

- Depends on the speed and angle of the gesture, this feature may not work properly.
- When the angle is changed after Quick preview, it will go back to the camera mode. You should go to Gallery to view the picture again.

## KnockON

You can wake up, or turn off, the screen as easily as double-tapping the screen. While the screen is off, and idle, double-tap the center screen quickly to wake the screen. To turn the screen off, double-tap the Status bar in any screen (except on the camera viewfinder) or empty area on the Home screen.



**NOTE:** When using KnockOn to wake the screen, make sure you do not cover the proximity sensor. Doing so will prevent the screen from turning on. This feature is designed to prevent the device turning on inadvertently in your pocket or storage location.

## Knock Code

The Knock Code feature allows you to wake and unlock the screen with your own Knock Code pattern. When enabled, Knock Code divides the screen into 4 parts and uses your unique combination of taps to secure your device. You can disable this feature in the Lock screen settings.

### NOTE:

- If you enter an incorrect Knock Code combination 6 times, it will be necessary to use your Google account log in or backup PIN.
- Use the fingertip instead of finger nail to tap the screen for turning it on or off.
- When the Knock Code is not in enabled, you can use Knock On function by tapping the screen.

- 1 Tap  >  > **Apps** tab (if necessary) >  > **Display** tab > **Lock screen** > **Select screen lock** > **Knock Code**.
- 2 Follow the on-screen steps to set your Knock Code.
- 3 Tap Done when you have finished.

## Unlocking the screen using the Knock Code

You can wake up and unlock the screen by tapping the Knock Code, set up in the previous section, when the screen is off.

## Dual window

This feature allows you to multi-task by splitting up the screen into two, allowing you to use two compatible applications at the same time.

- 1 Touch and hold the ◀ to split the screen.
- 2 Tap or drag the app icon for the corresponding application you wish to use.

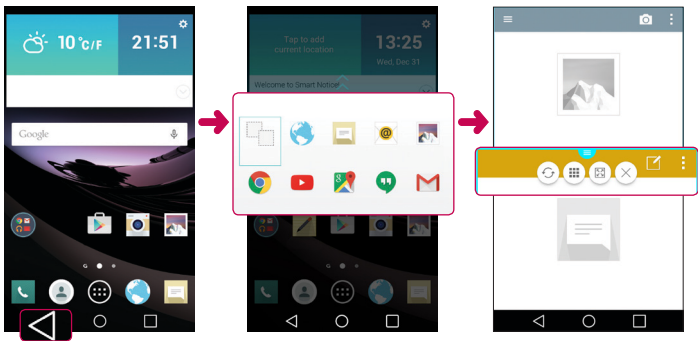

 : Tap to view the Dual window menu options, or drag to resize the split screens.



 : Switch two screens.

 : View the app list.

 : Change the selected window to full screen.

 : Close the currently selected app window.

**NOTE:** You can enable or disable Dual window through the Settings menu.

- 1 Tap  >  > **Apps** tab (if necessary) >  > **General** tab > **Dual window**.
- 2 Slide the toggle key to **On** or **Off**.

## QuickMemo+

The **QuickMemo+** feature allows you to create memos and capture screen shots. Capture screens, draw on them and share them with family and friends with QuickMemo+.



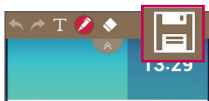

OR



- 1 (While screen is off) Press and hold the Volume Up button.

OR

(While the screen is on) Touch and slide the Status bar downward and tap .

- 2 Use the menu to select from the available options **Pen type**, **Color**, **Eraser** and create a memo.
- 3 Tap  to save the memo. To exit QuickMemo+ at any time, tap .

## QSlide

From any screen, use the Notification panel to easily access and use the Notepad, Calendar, Calculator, and more with QSlide.

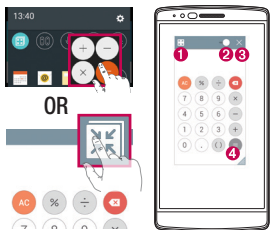

1		Tap to expand the window to full window size.
2		Tap to adjust the window's transparency.
3		Tap to close the QSlide window.
4		Drag to adjust the size.

- 1 Touch and slide the status bar downward > tap **QSlide** to view the available QSlide apps. Also, while using applications that support QSlide, tap . The function is displayed as a small window on your screen.
- 2 You can use and tap the screen under the **QSlide** windows when the transparency bar is not full .

**NOTE:** QSlide can support up to one window at the same time.

## QuickRemote

QuickRemote turns your phone into a Universal Remote for your home TV, set-top box and audio system, and more.

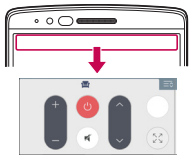
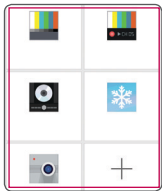
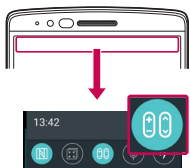

### Set up

- 1 Touch and slide the Status bar downward and tap  > **ADD REMOTE**.

OR

Tap  >  > **Apps** tab (if necessary) >  > tap .

- 2 Select the type and brand of the device, then follow the on-screen instructions to configure the device.

### Access your QuickRemote

- 3 Once you have completed the initial set up, you can easily access the QuickRemote from the Notification panel. Open the Notification panel and use the QuickRemote functions.

**NOTE:** The QuickRemote operates the same way as an ordinary remote control infrared (IR) signals. Be careful not to cover the infrared sensor at the top of the phone when you use the QuickRemote function. This function may not be supported depending on the model, the manufacturer or service company.

# Google account setup

When you first turn on your phone, you have the opportunity to sign into your Google Account and select how you want to use certain Google services.

## Setting up your Google account

- During the initial boot up of your device, ensure your device is connected to the Web. Then, sign into a Google Account from the prompted set-up screen.

**OR**

- After having exited the Startup Wizard, tap  >  >  > **General** tab > **Accounts & sync** > **Add Account** > **Google**.

If you already have a Google account, enter your email address and tap **NEXT**.

Once you have set up your Google account on your phone, your phone will automatically synchronize with your Google account on the Web (if data connection is available).

Depending on your synchronization settings, your contacts, Gmail messages, Calendar events and other information from these applications and services on the Web are synchronized with your phone.



After signing in, you can use Gmail™ and take advantage of Google services on your phone.

# Connecting to Networks and Devices

## Wi-Fi

You can use high-speed Internet access while within the coverage of the wireless access point (AP).





### Connecting to Wi-Fi networks

- 1 Tap  >  > **Apps** tab (if necessary) >  > **Networks** tab > **Wi-Fi**.
- 2 Set **Wi-Fi** to **ON** to turn Wi-Fi on and start scanning for available Wi-Fi networks.
- 3 Tap a network to connect to it.
  - If the network is secured with a lock icon, you will need to enter a security key or password.

**NOTE:** The Status bar displays icons that indicate Wi-Fi status.

**NOTE:** If you are out of the Wi-Fi zone or have set Wi-Fi to **OFF**, the device may automatically connect to the Web using mobile data, which may incur data charges.

### TIP! How to obtain the phone's MAC address

Tap  >  > **Apps** tab (if necessary) >  > **Networks** tab > **Wi-Fi** >  > **Advanced Wi-Fi** > **MAC address**.



## Bluetooth

You can use Bluetooth to connect with headsets, sound systems, or even to exchange data between near devices.

### NOTE:

- LG is not responsible for the loss, interception or misuse of data sent or received via the Bluetooth feature.
- Always ensure that you share and receive data with devices that are trusted and properly secured.
- If there are obstacles between the devices, the operating distance may be reduced.
- Some devices, especially those that are not tested or approved by Bluetooth SIG, may be incompatible with your device.

### Pairing your phone with another Bluetooth device

- 1 Tap  >  > **Apps** tab (if necessary) >  > **Networks** tab > **Bluetooth**.
- 2 Set **Bluetooth** to **ON**.
- 3 Tap **Search for devices** to view the devices in the Bluetooth Range.
- 4 Choose the device you want to pair with from the list and follow any subsequent instructions to complete pairing. Once the pairing is successful, your phone connects to the other device.



**NOTE:** Some devices, especially headsets or hands-free car kits, may have a default Bluetooth PIN, such as 0000.

## Sending data via Bluetooth

- 1 Using an application that supports sharing, locate the data, or file, that you want to share.
- 2 Select the **Share** option.
- 3 Select **Bluetooth**.
- 4 Select the paired Bluetooth device (or pair with a new device).

**NOTE:** The method for selecting an option may vary by data type.

## Receiving data via Bluetooth

- 1 Tap  >  > **Apps** tab (if necessary) >  > **Networks** tab > **Bluetooth**.
- 2 Set **Bluetooth** to **ON** to turn it on.
- 3 You will receive a request to accept a pairing attempt from the sending device. Be sure to select **Accept**.

## Wi-Fi Direct

Wi-Fi Direct provides a direct connection between Wi-Fi enabled devices without requiring an access point.

### Turning on Wi-Fi Direct

- 1 Tap  >  > **Apps** tab (if necessary) >  > **Networks** tab > **Wi-Fi**.
- 2 Tap  > **Advanced Wi-Fi** > **Wi-Fi Direct**.

**NOTE:** When in this menu, your device is visible to other visible Wi-Fi Direct devices nearby.

## SmartShare

SmartShare allows you to receive multimedia content via LG phone and tablets.

- 1 While viewing the content you want to share, tap  or  > **SmartShare**.
- 2 Tap **Play** or **Beam** in the pop-up that is displayed.
  - **Play:** You can stream your content via a TV, Bluetooth speaker, etc.
  - **Beam:** You can send your content to Bluetooth devices or via SmartShare Beam\* to supported LG phones or tablets.  
\*SmartShare Beam quickly transfers multimedia contents through Wi-Fi Direct.
- 3 Tap the device you want to share from the list.
  - If the device is not displayed on the list, make sure that Wi-Fi, Wi-Fi Direct, or Bluetooth is turned on. Then tap **Rescan**.

### Enjoying content from nearby devices on your phone

- 1 To connect nearby devices to your phone, tap the **Nearby devices** option on the **Gallery** and **Music** apps.
  - Make sure that your phone and nearby devices are connected to the same Wi-Fi network and that the DLNA service on the nearby device is turned on.
- 2 Tap the device you wish to connect to.  
If the device is not listed, tap **Search nearby devices**.
- 3 After a connection is established, you can enjoy the content on your phone.

## Transferring data between a PC and your device

You can copy or move data between a PC and the device.

### Transferring data





- 1 Connect your device to a PC using the USB cable that came with your phone.
- 2 Open the Notifications panel and select **Media device (MTP)**.
- 3 A window will pop-up on your PC, allowing you to transfer the desired data.

#### NOTE:

- The LG Android Platform Driver is required to be installed on your PC to be able to detect the phone.
- Check the requirements for using **Media device (MTP)**.



Items	Requirement
OS	Microsoft Windows XP SP3, Vista or higher
Window Media Player version	Windows Media Player 10 or higher

## Making a call

- 1 Tap  to open the dialer.
- 2 Enter the number using the dialer. To delete a digit, tap .
- 3 After entering the desired number, tap  to place the call.
- 4 To end the call, tap .

**TIP!** To enter "+" to make international calls, touch and hold .

## Calling your contacts



- 1 Tap  to open your contacts.
- 2 Scroll through the contact list. You can also enter the contact's name in the Search field or scroll along the alphabet letters on the right edge of the screen.
- 3 To place the call, tap  next to the contact you want to call.

## Answering and rejecting a call

When you receive a call, swipe  in any direction to answer the call.

Swipe  in any direction to decline the call.

## Making a second call

- 1 During your first call, tap  > **Add call**.
- 2 Enter the number and tap  to place the call.
- 3 Both calls are displayed on the call screen. Your initial call is locked and put on hold.
- 4 To toggle between numbers, tap the number displayed on the screen. You can also tap  to start a conference call.
- 5 To end all calls, tap **End**.

**NOTE:** You are charged for each call you make.

## Viewing your call logs

On the Home screen, tap  and select **Call logs** tab.

A list of all dialed, received and missed calls is displayed.

### TIP!

- Tap any call log entry to view the date, time and duration of the call.
- Tap , then tap **Delete all** to delete all of the recorded items.

## Call settings

You can configure phone call settings, such as call forwarding, as well as other special features offered by your carrier.

- 1 On the Home screen, tap  to open the dialer.
- 2 Tap  to display the available options.
- 3 Tap **Call settings** and configure the desired options.



# Contacts

Add contacts to your phone and synchronize them with the contacts in your Google account or other accounts that support contact syncing.

## Searching for a contact

- 1 Tap  to open your contacts.
- 2 Tap **Search contacts** and enter the contact name using the keyboard. You can also scroll along the alphabet letters on the right edge of the screen.

## Adding a new contact

- 1 Tap  and enter the new contact's number.
- 2 Tap  > **Add to Contacts** > **New contact**.
- 3 If you want to add a picture to the new contact, tap the image icon.  
Choose **Take photo** or **Select from Gallery**.
- 4 Enter the desired information for the contact.
- 5 Tap **Save**.

## Favorites contacts

You can classify frequently called contacts as favorites.



### Adding a contact to your favorites

- 1 Tap  to open your contacts.
- 2 Tap a contact to view its details.
- 3 Tap the star at the top right corner of the screen. The star turns yellow.

## Removing a contact from your favorites list

- 1 Tap  to open your contacts.
- 2 Tap the **Favorites** tab and choose a contact to view its details.
- 3 Tap the yellow star at the top right corner of the screen. The star turns grey color and the contact is removed from your favorites.

## Creating a group



- 1 Tap  to open your contacts.
- 2 Tap **Groups** >  > **New group**.
- 3 Enter a name for the new group. You can also set a distinct ringtone for the group.
- 4 Tap **Save** to save the group.

**NOTE:** If you delete a group, the contacts assigned to that group are not lost. They remain in your contact list.

# Messaging

Your phone combines text and multimedia messages into one intuitive, easy-to-use menu.

## Sending a message

- 1 Tap  on the Home screen and tap  to create a new message.
- 2 Enter a contact name or contact number into the **To** field. As you enter the contact name, matching contacts appear. You can tap a suggested recipient and add more than one contact.

**NOTE:** You may be charged for each text message you send. Please consult with your service provider.

- 3 Tap the **Enter message** field and begin composing your message.
- 4 Tap  to open the messaging options.

**TIP!** You can tap  to attach a file that you want to share.

- 5 Tap **Send** to send your message.

### **TIP!**

- The 160-character limit may vary from country to country, depending on the language and how the text message is coded.
- If an image, video or audio file is added to a text message, it is automatically converted into a multimedia message and you may be charged accordingly.

## Conversation view

Text and multimedia messages exchanged with another party are displayed in chronological order so that you can conveniently see and find your conversations.

## Changing message settings

Your phone's messaging settings are predefined to allow you to send messages immediately. You can change the settings based on your preferences.

- Open the **Messaging** app and tap  > **Settings**.





You can use the E-mail application to read emails from services like Gmail. The E-mail application supports the following account types: POP3, IMAP and Exchange. Your service provider or system administrator can provide you with the account settings you need.

## Managing email accounts



The first time you open the **E-mail** application, a setup wizard opens to help you set up an email account.

After the initial setup, the Email app displays the contents of your inbox.





### Adding another email account:

- Tap  >  > **Apps** tab (if necessary) > **E-mail** >  > **Settings** >  **Add account.**

### Changing an email general settings:

- Tap  >  > **Apps** tab (if necessary) > **E-mail** >  > **Settings** > **General settings.**

### Deleting an email account:





- Tap  >  > **Apps** tab (if necessary) > **E-mail** >  > **Settings** >  > **Remove account** > Select the account you want to delete > **Remove** > **Yes.**

## Working with account folders

To access your email account's folders, open the **Email** app and tap  > **Folders**. Each account has Inbox, Outbox, Sent and Drafts folders. Depending on the features supported by your account's service provider, you may have additional folders.

# Composing and sending email

## Composing and sending messages



- 1 While in the **E-mail** application, tap  to create a new email.
- 2 Enter an address for the email's intended recipient. As you enter text, matching addresses are proposed from your Contacts. Separate multiple addresses using semicolons.
- 3 Tap  to add a Cc/Bcc and tap  to attach files, if required.
- 4 Enter the email's text.
- 5 Tap  to send the email.

# Camera and Video

To open the Camera application, tap  >  > **Apps** tab (if necessary) > .







## Camera options on the viewfinder



- 1 Hide/Display Options** – Tap to hide/display the camera options on the viewfinder.
- 2 Flash** – Allows you to manage the camera's flash. Choose from **Off** , **On** , **Auto** .
- 3 Swap camera** – Tap to swap between the rear camera and the front camera.
- 4 Shot mode** – Allows you to select the shot mode for the picture. Choose from **Auto**, **Panorama** or **Dual**.
- 5 Settings** – Tap to adjust the camera and video settings.
- 6 Gallery** – Tap to access your Gallery.
- 7 Record** – Tap to start recording a video.
- 8 Capture** – Tap to take a photo.
- 9 Back key** – Tap to close the selected menu or exit the Camera app.

## Using the advanced settings

In the camera viewfinder, tap  to access the camera settings below.





	Combines photos taken at multiple exposures into one optimal photo to get a better photo in difficult lighting situations.
	Selects the photo resolution.
	Allows you to say a voice command to take pictures. You can say LG, Cheese, Smile, etc.
	Sets a delay after the capture key is pressed. This is ideal if you want to be in the photo or video.
	Displays grid lines to help you align your pictures and videos.
	Opens the Help guide to show how to use a function.

## Taking a photo

- 1 Open the **Camera** application and point the lens toward the subject you want to photograph.
- 2 Focus indicators will appear in the center of the viewfinder screen. You can also tap anywhere on the screen to focus on that spot.
- 3 When the focus indicators turn blue, the camera has focused on your subject.
- 4 Tap  to capture the photo.

## Once you have taken a photo

Tap the image thumbnail at the bottom of the Camera screen to view the last photo you took. The following options are available.

	Tap to edit the photo.
	Tap to take another photo immediately.
	Tap to send your photo to others or share it in via any available social network services.
	Tap to delete the photo.
	Tap to access additional options.
	Tap to add the photo to your favorites.



## Recording a video

- 1 Open the **Camera** application and point the lens toward the subject you want to capture in your video.
- 2 Tap  once to start recording.

**NOTE:** The timer will be displayed on the screen.





- 3 A red light appears in the upper-right corner of the viewfinder with a timer showing the length of the video.
- 4 Tap  to stop recording.

### TIP!

-  – Tap to capture a screen shot while recording a video.
-  – Tap to pause the recording.

## After recording a video

In the viewfinder, tap the video thumbnail at the top of the screen to view the last video you recorded. The following options are available.

	Tap to record another video immediately.
	Tap to open the available sharing options (such as Messaging or Bluetooth) to share.
	Tap to delete the video.
	Tap to access additional options.
	Tap to add the video to <b>Favourites</b> .

**NOTE:** Additional charges may apply when MMS messages are downloaded while roaming.

## Multi-point Auto Focus







When you take a picture, the Multi-point Auto Focus (AF) function operates automatically and allows you to see a clear image.

## Burst shot

Allows you to take multiple shots quickly. Touch and hold .

## Panorama mode

Allows you to take a panoramic picture.

- 1 Tap  >  > **Apps** tab (if necessary) > .
- 2 Tap  > .
- 3 Tap  to start taking the panoramic picture.
- 4 Pan your phone slowly in one direction.

- 5 Make sure that the focus area aligns with the blue guideline while taking the photo.
- 6 Tap  to stop taking the panoramic picture.

## Dual

The Dual feature allows you to take a picture or record video with the front and rear cameras at the same time.

- 1 Tap  >  > **Apps** tab (if necessary) > .
- 2 Tap  > .



**NOTE:** Drag the small screen to move it to your desired location. Touch and hold the small screen to resize it. Tap on the small screen to alternate between the two cameras.

- 3 Tap  to stop dual recording.

## Super Zooming

When using the rear camera lens, you can zoom in or out to 8x.

**NOTE:** Use a steady hand. This feature does not work with some functions. Objects may be overlapped when taking a picture of fast-moving subjects.

## Live Zoom

Live Zoom allows you to zoom in or out on a portion of a video that is being played to make the desired section appear larger or smaller.

When viewing a video, use your index finger and thumb in a pinching or spreading motion to zoom in or out.



**NOTE:** Do not press too hard; the touch screen is sensitive enough to pick up a light, but firm touch.

## Dual Play

Dual Play (wired or wireless connection to two displays) can be run on a different screen.

**NOTE:** Connect two devices using a wired (Slimport-HDMI) cable or wirelessly (Miracast). The connectable device can be a TV or a monitor supported by an HDMI cable or Miracast. The Gallery and Video apps are supported on Dual Play. Tap  once when two displays are a different status (i.e. the monitor is playing a video and your phone's video app is displaying an empty screen), then Dual Play will start. Not all videos are supported by Dual Play. Dual Play operates at 1280X720 or higher display resolution.

## Gallery

The **Gallery** allows you to view and manage all of your pictures and videos.

- Tap  >  > **Apps** tab (if necessary) > .

### **NOTE:**

- Depending on the software installed, some file formats may not be supported.
- Some files may not play properly due to their encoding.

## Viewing pictures

The Gallery displays your pictures in folders. When an application, such as E-mail, saves a picture, the download folder is automatically created to contain the picture. Likewise, capturing a screenshot automatically creates the Screenshots folder.



Pictures are displayed in a folder by creation date. Select a picture to view it full screen. Scroll left or right to view the next or previous image.

## Zooming in and out







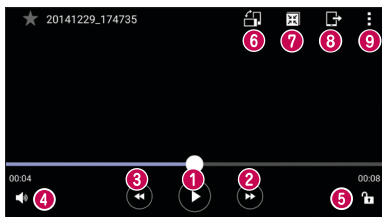

Use one of the following methods to zoom in on an image:

- Double-tap anywhere to zoom in.
- Spread two fingers apart on any place in the picture zoom in. Pinch in or double-tap the image to zoom out.

## Playing videos

- 1 Touch  > **Apps** tab (if necessary) > .
- 2 Select the video you want to watch.  
The following options are available.



	Touch to pause/resume video playback.
	Touch to fast-forward 10 seconds.
	Touch to rewind 10 seconds.
	Touch to adjust the video volume.
	Touch to lock/unlock the screen.
	Touch to rotate the screen.
	Touch to use QSlide for the Videos app.
	Tap to share your video using the SmartShare function.
	Tap to access additional options.



To change the volume while watching a video, press the Up and Down Volume buttons on the back of the phone.

## Editing photos

While viewing a photo, tap .

## Deleting photos/videos

Use one of the following methods:

- While in a folder, tap , select the photos/videos and then tap **Delete**.
- While viewing a photo, tap .



## Setting wallpaper

While viewing a photo, tap  > **Set image as** to set the image as wallpaper or assign it to a contact.



### NOTE:

- Depending on the software installed, some file formats may not be supported.
- If the file size exceeds the available memory, an error can occur when you open files.



## Music





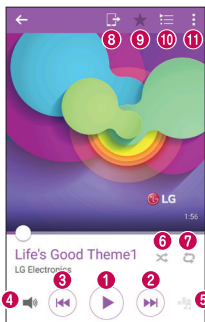



Your phone has a music player that lets you play all your favorite tracks. To access the music player, tap  >  > **Apps** tab (if necessary) > .

### Playing a song

- 1 Tap  >  > **Apps** tab (if necessary) > .
- 2 Tap the **Songs** tab.
- 3 Select the song you want to play.
- 4 The following options are available.



1		Tap to pause playback.
		Tap to resume playback.
2		Tap to skip to the next track in the album, playlist or shuffle list. Touch and hold to fast-forward.

3		Tap to restart the current track or skip to the previous track in the album, playlist or shuffle list. Touch and hold to rewind.
4		Tap to adjust the volume.
5		Tap to set audio effects.
6		Tap to play the current playlist in shuffle mode (tracks are played in random order).
7		Tap to toggle through repeat all songs, repeat current song and repeat off.
8		Tap to share your music using the SmartShare function.
9		Tap to add the song to your favorites.
10		Tap to open the current playlist.
11		Tap to access additional options.

To change the volume while listening to music, press the Up and Down Volume buttons on the back side of the phone.

**NOTE:**

- Depending on the software installed, some file formats may not be supported.
- If the file size exceeds the available memory, an error can occur when you open files.

**NOTE:** Music file copyrights may be protected by international treaties and national copyright laws.

Therefore, it may be necessary to obtain permission or a license to reproduce or copy music.

In some countries, national laws prohibit private copying of copyrighted material. Before downloading or copying the file, check the national laws of the relevant country concerning the use of such material.

## Clock

Use the Clock app gives you access to the Alarms, Timer, World clock and Stopwatch functions. Access these functions by tapping the tabs across the top of the screen or swiping horizontally across the screen.

Tap  >  > **Apps** tab (if necessary) > .

### Alarm

The Alarms tab allows you to set alarms.

- 1 Open the **Clock** app, then select the **Alarm** tab.
- 2 Tap the **New alarm** icon to add an alarm.
- 3 Adjust the settings as necessary and tap **Save**.

**NOTE:** You can also tap an existing alarm to edit it.

### Timer

The Timer can alert you with an audible signal when a set amount of time has passed.

- 1 Open the **Clock** app, then select the **Timer** tab.
- 2 Set the desired time on the timer.

### World clock

The World clock allows you to easily check the current time in other cities around the world.

- 1 Open the **Clock** app, then select the **World clock** tab.
- 2 Tap the **New city** icon and select the desired city.

## Stopwatch

The Stopwatch tab allows you to use your phone as a stopwatch.

- 1 Open the **Clock** app, then select the **Stopwatch** tab.
- 2 Tap the **Start** key to initiate the stopwatch.





**NOTE:** Tap the Lap key to record lap times.

- 3 Tap the **Stop** button to stop stopwatch.

**NOTE:** To reset the stopwatch, tap the Reset button. You can also tap the Resume button to resume the stopwatch.

## Calculator





The Calculator app allows you to perform mathematical calculations using a standard or scientific calculator.

- 1 Tap  >  > **Apps** tab (if necessary) >  .
- 2 Tap the number keys to enter numbers.
- 3 For simple calculations, tap the function you want to perform (+, -, x or ÷) followed by =.
- 4 For more complex calculations, tap  > **Scientific calculator**.

**NOTE:** To check the history, tap  > **Calculation history**.

## Calendar







The Calendar app allows you to track your schedule of events.

- 1 Tap  >  > **Apps** tab (if necessary) >  .
- 2 Tap the date you want to add an event to. Then tap  .

## Voice Recorder

The Voice Recorder app records audible files for you to use in a variety of ways.

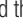
### Recording a sound or voice



- 1 Tap  >  > .
- 2 Tap  to begin recording.
- 3 Tap  to end the recording.
- 4 Tap  to listen to the recording.

**NOTE:** Tap  to access your recordings. You can listen to the saved recording. The available recording time may differ from actual recording time.

## Tasks

You can add your tasks in the Tasks app and synchronize with your MS Exchange account (if supported by your MS Exchange account).



### Synchronizing MS Exchange

- 1 Tap  >  > **Apps** tab (if necessary) > .
- 2 Tap **General** tab > **Accounts & sync** > **Add account**.
- 3 Tap **Microsoft Exchange** and sign in to your account.
- 4 Make sure to place a checkmark in the **Tasks** option when prompted.

**NOTE:** MS Exchange may not be supported depending on email server.

## Voice Search

Use this application to search the web using your voice.

- 1 Tap  >  > **Apps** tab (if necessary) > **Google** folder > .
- 2 Say a keyword or phrase when **Speak now** appears on the screen. Select one of the suggested keywords that appear.

**NOTE:** This application may not be available depending on the region or service provider.

## Downloads

Use this application to see what files have been downloaded through your applications.

- Tap  >  > **Apps** tab (if necessary) > .

**NOTE:** This application may not be available depending on the region or service provider.

## FM radio

Your phone has a built-in FM radio so you can tune in to your favorite stations and listen on the go.

- Tap  >  > **Apps** tab (if necessary) > .



**NOTE:** You need to use your headphones to listen to the radio. Insert it into the headphone jack.

**NOTE:** This application may not be available depending on the region or service provider.

## LG SmartWorld

LG SmartWorld offers an assortment of exciting content – fonts, themes, games, applications.

### How to Get to LG SmartWorld from Your Phone

- 1 Tap  >  > **Apps** tab (if necessary) > **LG SmartWorld**.
- 2 Tap **Sign in** and enter your user name and password. If you have not signed up yet, tap **Register** to create an account.
- 3 Browse and download the content you want.

#### NOTE:

- You may incur data fee charges when using your mobile network to access LG SmartWorld.
- LG SmartWorld may not be available for all carriers or in all countries.

#### NOTE: What if there is no LG SmartWorld icon?





- 1 Using a mobile Web browser on your device, access LG SmartWorld ([www.lgworld.com](http://www.lgworld.com)) and select your country.
- 2 Download the LG SmartWorld App.
- 3 Run and install the downloaded file.
- 4 Access LG SmartWorld by tapping the  icon.

#### Special benefits available for LG SmartWorld

- Personalize your device with home themes, keyboard themes, and fonts.
- Enjoy special promotions only offered on LG SmartWorld.
- Note that LG SmartWorld is only available for certain devices. Please check the [www.lgworld.com](http://www.lgworld.com) for more information.

## Voice Mate

You can ask Voice Mate to perform phone functions using your voice, such as calling a contact, setting alarms, or searching the web. You can say “help” to help you get started.

- 1 Tap  >  > **Apps** tab (if necessary) > .
- 2 The Speak icon  (at the bottom of the screen) illuminates. Say what you want it to do for you.

**NOTE:** Voice Mate confirms found match requests before executing it. To skip confirmation for exact matches (name or number), access the Voice Mate settings and checkmark Skip confirmation.

# Web Browser

## Internet





Use this application to browse the Internet. Browser gives you a fast, full-color world of games, music, news, sports, entertainment and much more, right on your mobile phone.

**NOTE:** Additional charges apply when connecting to these services and downloading content. Check data charges with your network provider.

- Tap  >  > **Apps** tab (if necessary) >  .

### Using the Browser toolbar

Scroll towards the top of the webpage to access the browser toolbar.

	Tap to go back one page.
	Tap to go forward one page.
	Tap to go to the Home page.
	Tap to open a new window.
	Tap to access your bookmarks.

### Viewing webpages

Tap the address field, enter the web address and tap **Go** on the keyboard.

## Opening a page

To go to a new page, tap  > .

To go to another webpage, tap , scroll up or down, and tap the page to select it.

## Searching the web by voice

In the browser, tap the address field and then tap . When prompted, say a keyword and select one of the suggested keywords that appear.



**NOTE:** This feature may not be available depending on the region or service provider.

## Bookmarks

To bookmark the current webpage, tap  > **Add to bookmarks** > **OK**.

To open a bookmarked webpage, tap  and select the desired one.

## History

Tap  > **History** to open a list of recently visited webpages. To clear all of your history, tap  > **Yes**.

## Using QSlide with the Browser

Use this feature to multi-task while browsing the internet.

While viewing content, such as contacts or notes that include web addresses, select a web address and then tap **Popup Browser** to open the pop-up browser. Touch and drag the QSlide window to move it to another location.

To view the browser in full screen, tap .

To close the browser, tap .

## Chrome

Use Chrome to search for information and browse webpages.

- Tap  >  > **Apps** tab (if necessary) >  .

**NOTE:** This application may not be available, depending on your region and service provider.

### Viewing webpages

In the Chrome browser, tap the address field, and then enter a web address or search criteria.

### Opening a page

To open a new page, tap  > **New tab**.

To go to another webpage, tap , and tap the page to select it.

# Settings

This section provides an overview of items you can change using your phone's System Settings menus.

## Accessing the Settings menu:

- Tap  > touch and hold  > **System settings**.
- or -
- Tap  >  > **Apps** tab (if necessary) > .

## Networks

### < WIRELESS NETWORKS >

#### Wi-Fi

Allows you to manage your Wi-Fi connections and connect to available Wi-Fi networks.

#### Bluetooth

Allows you to manage your the Bluetooth wireless feature.

#### Mobile data

Displays the data usage and allows you to set a personalized mobile data usage limit.

#### Call

This menu allows you to configure various call settings.

- **Voicemail** – Allows you to select your carrier's voicemail service.
- **Fixed dialing numbers** – Allows you to manage and compile a list of numbers that can be called from your phone. You need your PIN2, which is available from your operator. If activated, only numbers in the fixed dial list can be called from your phone.

- **Incoming voice call pop-up** – Displays a pop-up for an incoming call when an app is in use.
- **Call reject** – Allows you to set the call decline function.
- **Decline with message** – When you want to decline a call, you can send a quick message using this function. This is useful if you need to decline a call during a meeting.
- **Call forwarding** – Allows you to choose when to forward calls.
- **Auto answer** – Sets the time before a connected hands-free device automatically answers an incoming call.
- **Connection vibration** – Vibrates your phone when the other party answers the call.
- **Noise suppression** – Suppresses background noise on your device during a call.
- **Voice clarity** – Enhances voice quality in noisy environments so you can hear more clearly.
- **Save unknown numbers** – Allows you to add unknown numbers to contacts after a call.
- **Power key ends call** – Allows you to use the Power key to end calls.
- **Call barring** – Locks incoming, outgoing or international calls.
- **Call duration** – Allows you to view the call duration for various types of calls.
- **Additional settings** – Allows you to change the following settings.

## < CONNECTIVITY >

### Share & connect

- **NFC** – Your phone is an NFC-enabled cell mobile phone. NFC (Near Field Communication) is a wireless connectivity technology that enables two-way communication between electronic devices. It operates over a distance of a few centimeters. You can share your content with an NFC tag or another NFC support device by simply tapping it with your device. If you tap an NFC tag with your device, it displays the tag content on your device.

- **Android Beam** – When this feature is turned on, you can transfer app content to another NFC-capable device by holding the devices close together. Just bring the device together (typically back to back) and then tap your screen. The app determines what gets beamed.
- **SmartShare Beam** – Allows you to receive multimedia content via LG phones and tablets.
- **Media server** – Share media content with nearby devices via DLNA.
- **Miracast** – Allows you to wirelessly mirror the phone screen and sound onto a Miracast dongle or TV.
- **LG PC Suite** – Connect LG PC Suite with your phone to easily manage multimedia content and apps.

## Tethering & networks

- **USB tethering** – Allows you to share the internet connection with your computer via a USB cable.
- **Wi-Fi hotspot** – Allows you to create a hotspot and share your connection. Please consult "**Sharing your phone's data connection**" for more information.
- **Bluetooth tethering** – Allows you to connect to other devices via Bluetooth.
- **Help** – Displays Help information about USB tethering, Wi-Fi hotspot, and Bluetooth tethering.
- **Airplane mode** – Airplane Mode (flight mode) allows you to use many of your phone's features, such as games, and music, when you are in an area where making or receiving calls or data use is prohibited. When you set your phone to Airplane Mode, it cannot send or receive any calls or access online data.
- **Mobile networks** – This menu allows you to configure various mobile network settings.
- **VPN** – From your phone, you can add, set up, and manage virtual private networks (VPNs) that allow you to connect and access resources inside a secured local network, such as your corporate network.

# Sound

## < BASIC >

### Sound profile

Allows you to set your phone's sound profile. Choose from **Sound**, **Vibrate only** or **Do not disturb**.

### Volume

Adjust the phone's volume settings to suit your needs and environment.

### Vibration strength

Allows you to set the vibration strength for calls, notifications and touch feedback.

## < RINGTONES & VIBRATIONS >

### Ringtone

Allows you to set the ringtones for calls. You can also add a ringtone by tapping  in the upper-right corner of the screen.

### Notification sound

Allows you to set the notification sound. You can also add a notification sound by tapping  in the upper-right corner of the screen.

### Sound with vibration

Checkmark to set the phone to vibrate in addition to the ringtone when you receive calls.

### Vibration type

Allows you to choose the type of vibration.

## < NOTIFICATIONS >

### Do not disturb

Allows you to set a schedule when to prevent interruptions from notifications. You can set to allow certain features to interrupt when Priority only is set.

## Lock screen

Allows you to choose if you want to show or hide notifications on the lock screen.

## Apps

Allows you to prevent apps from displaying notifications or set apps to show notifications with priority when Do not disturb is set to Priority only.

## < ADVANCED SETTINGS >

### Vibrate on tap

Checkmark to vibrate when tapping the Home touch buttons and during other UI interactions.

### Sound effects

Tap to set the dial pad touch tones, touch sounds and screen lock sound.

- **Dialpad touch sounds** – Checkmark to play tones while using the dial pad.
- **Touch sounds** – Checkmark to play a sound when making a screen selections.
- **Screen lock sound** – Checkmark to play a sound when locking and unlocking the screen.

### Message/call voice notifications

Tap the **Message/call voice notifications** switch to toggle it On or Off. On allows your device to read out incoming calls and message events automatically.

## Display

### < HOME & LOCK >

#### Home screen

- **Select Home** – Set **Home** or **EasyHome** as the default home.
- **Smart Bulletin** – Tap the **Smart Bulletin** switch to toggle it On or Off. Activating this feature adds an additional Home screen showing customized information. Checkmark **LG Health**, or **Smart Tips**.

- **Theme** – Sets the screen theme for your device. You can download new themes from **LG SmartWorld**.
- **Wallpaper** – Sets the wallpaper to use on your Home screen.
- **Screen swipe effect** – Choose the desired type of effect to display when you swipe from one Home screen canvas to the next.
- **Allow Home screen looping** – Displays the first screen after the last screen when scrolling the Home screen.
- **Home backup & restore** – You can backup and restore app/widget layouts and the Home screen wallpaper.
- **Help** – Displays help information for the Home screen.

## Lock screen

- **Select screen lock** – Set a screen lock type to secure your phone. Opens a set of screens that guide you through drawing a screen unlock pattern.  
If you enabled a Pattern lock type when you turn on your phone or wake up the screen, you are asked to draw your unlock pattern to unlock the screen.
- **Smart Lock** – Sets to keep your phone unlocked when you have a trusted Bluetooth device connected to it, when it's in a familiar location like your home or work, or when it recognizes your face.
- **Screen swipe effect** – Sets the screen swipe effect options.

**NOTE:** This setting name may be Pattern effect if the Screen lock is set to Pattern.

- **Wallpaper** – Allows you to set your Lock screen wallpaper.
- **Shortcuts** – Allows you to choose the shortcuts available on the lock screen.
- **Weather animation** – Checkmark to show weather animation on the lock screen for the current location.
- **Contact info for lost phone** – Allows you to display the owner information on the lock screen in case the phone is lost.

- **Lock timer** – Sets the amount of time before the screen automatically locks after the screen has timed out.
- **Power button instantly locks** – Checkmark to instantly lock the screen when the Power/Lock Button is pressed. This setting overrides the Security lock timer setting.

## Home touch buttons

Set the Home touch buttons displayed at the bottom of all screens. Set which keys are displayed, their position on the bar and what they look like.

## < FONT >

### Font type

Sets the type of font used for the phone and menus.

### Font size

Sets the size of the font displayed in the phone and menus.

## < OTHER SCREEN SETTINGS >

### Brightness

Adjusts the brightness of the screen. For best battery performance, use the dimmest comfortable brightness.

### Notification LED

Tap the switch to toggle it On or Off. On activates the LED light for the notifications you select, in the color you set for each.

### Auto-rotate screen

Checkmark to set the phone to automatically rotate the screen based on the phone orientation (portrait or landscape).

### Screen timeout

Sets the amount of time before the screen times out.

### Screen mode

Sets the screen mode. Choose from **Standard**, **Vivid** and **Natural**.

## < ADVANCED SETTINGS >

### Screen-off effect

Select the screen-off effect when locking and turning off the screen. Choose from **Black hole**, **Retro TV** and **Fade out**.

### Daydream

Tap the Daydream switch to toggle it On or Off. On allows to set a screensaver to be displayed when the phone is sleeping while docked and/or charging.

### Auto-adjust screen tone

Checkmark to adjust the screen brightness automatically with an analysis of image color.

## General

## < PERSONAL >

### Language & input

Use the Language & input settings to select the language for the text on your phone and to configure the on-screen keyboard, including words you added to its dictionary.

- **Language** – Sets the language to use on your phone.
- **Default** – Allows you to set the default keyboard to use when entering text.
- **LG Keyboard** – Checkmark to select the LG Keyboard to enter text. Tap the Settings icon to change the following settings.
- **Google voice typing** – Checkmark to select Google voice typing to enter text. Tap the Settings icon to change the Google voice settings.
- **Voice Search** – Sets voice search options.
- **Text-to-speech output** – Sets the preferred speech engine and speech rate (very slow to very fast). Also plays a short demonstration of speech synthesis.
- **Pointer speed** – Allows you to set the pointer speed using a slide bar.

## Location

Allows you to manage location services to determine your approximate location using GPS, Wi-Fi and mobile networks.

- **Mode** – Allows you to choose a location mode from **High accuracy (GPS and networks)**, **Battery saving (Networks only)** and **Device sensors only (GPS only)**.
- **Camera** – Checkmark to tag photos or videos with the location they were taken at.
- **Google Location Reporting** – Allows you to view and manage your Google location settings.

## Accounts & sync

Permits applications to synchronize data in the background, whether or not you are actively working in them. Deactivating the **Auto-sync data** option can save battery power and lower (but not eliminate) data usage.

## Cloud

Allows you to add a cloud account to quickly and easily use a cloud service.

## Accessibility

Use the **Accessibility** settings to configure accessibility plug-ins you installed on your phone.

**NOTE:** Requires additional plug-ins to become selectable.

## One-handed operation

- **Dial keypad** – Checkmark to enable you to move the dial keypad to the right or left side of the device. Simply tap the arrow to move it to one side or the other.
- **LG keyboard** – Checkmark to enable you to move the keyboard to the right or left side of the device. Simply tap the arrow to move it to one side or the other.

- **Lock screen** – Checkmark to enable you move the PIN Lock screen keypad to the right or left side of the phone. Simply tap the arrow to move it to one side or the other.
- **Help** – Displays information regarding one-handed operation.

## Shortcut key

Get quick access to apps by pressing and holding the Volume button when the screen is off or locked. Tap the Shortcut key switch (Shortcut key switch image) in the upper-right corner of the screen to toggle it **On** or **Off**.

## < PRIVACY >

### Security

- **Content lock** – Select lock types to lock files in Gallery. Choose from **Password** or **Pattern**.
- **Encrypt phone** – Allows you to encrypt data on the phone for security. You will be required to enter a PIN or password to decrypt your phone each time you power it on.
- **Encrypt SD card storage** – Allows you to encrypt the SD card and make data unavailable to other devices.
- **Password typing visible** – Checkmark to briefly show each character of passwords as you enter them so that you can see what you enter.
- **Phone administrators** – Allows you to view or deactivate phone administrators.
- **Unknown sources** – Allows you to install non-Play store applications.
- **Verify apps** – Disallow or warn before installation of apps that may cause harm.
- **Storage type** – Displays the storage type for credentials.
- **Trusted credentials** – Displays trusted CA certificates.
- **Install from storage** – Allows you to install encrypted certificates.
- **Clear credentials** – Deletes all secure certificates and related credentials and erases the secure storage's own password.
- **Trust agents** – View or deactivate Trust agents.

- **Screen pin** – This feature allows you to lock your device so that the current user can only access the pinned app. This is useful for users with children.

## < SMART FUNCTIONS >

### Gestures

- **Answer an incoming call** – Checkmark to enable you to bring the phone to your ear to automatically answer the incoming call.
- **Fade out ringtone** – Checkmark to allow you to pick up the phone from the flat surface to fade out the incoming call ringtone.
- **Silence incoming calls** – Checkmark to allow you to flip the phone to silence incoming calls.
- **Snooze or stop alarm** – Checkmark to allow you to simply flip the device to snooze or stop the alarm.
- **Pause video** – Checkmark to allow you to simply flip the device to pause the currently playing video.
- **Help** – Displays a Help guide on how to use the Gestures features of your device.
- **Motion sensor calibration** – Allows you to improve the accuracy of the tilt and speed of the sensor.

### QuickCircle case

This menu allows you to select apps to be used directly on the cover in small view using QuickCircle.

### Dual window

Allows you to configure the Dual Window feature.

- **Split view** – Checkmark to allow you to tap a link on the full screen or attachments from emails to open Dual window.
- **Help** – Display tips for using Dual window.

## < PHONE MANAGEMENT >

### Date & time

Use the **Date & time** settings to set how dates will be displayed. You can also use these settings to set your own time and time zone rather than obtaining the current time from the mobile network.

### Storage

- **INTERNAL STORAGE** – View internal storage usage.

### Battery

- **BATTERY INFORMATION** – The Battery charge information is displayed on a battery graphic along with the percentage of the remaining charge and its status. Touch the Battery charge icon to display the Battery use screen to see battery level and use details. The phone also displays which components and applications are using the most battery power. Tap one of the items to see more detailed information.
- **Battery usage** – Displays battery usage.
- **Battery percentage on status bar** – Checkmark to display the battery level percentage on the Status Bar next to the Battery icon.
- **BATTERY SAVER** – Tap the Battery Saver switch to toggle it On or Off. Tap Battery Saver to access the following settings:
  - **TURN BATTERY SAVER ON** – Sets the battery charge percent level that automatically turns on Battery Saver. Choose from Immediately, 5% battery and 15% battery.
  - **Help** – Displays help information for the Battery saver feature.

### Smart cleaning

Allows you to manage unused apps and data.

### Apps

View and manage your applications.

## Default message app

This menu allows you to set your default messaging app as desired.

## Backup & reset

This menu allows you to back-up your data, automatically restore data, and erase all the data on your phone.

- **Backup my data** – Allows you to back up your settings and application data to the Google server.
- **Backup account** – Allows you to back up your account.
- **Automatic restore** – Allows you to restore your settings and application data when the applications are reinstalled onto your device.
- **LG Backup service** – Backs up all information on the device and restores it in the event of data loss or replacement.
- **Factory data reset** – Reset your settings to the factory default values and delete all your data, including user data such as pictures and videos.

## Printing

Allows you to print the content of certain screens (such as web pages displayed in Chrome) to a printer connected to the same Wi-Fi network as your Android device.

## About phone

Display information about the network, phone identity, battery, hardware, software, and legal.

# PC software (LG PC Suite)

## For Windows OS

LG PC Suite helps you manage media contents and applications in your phone by allowing you to connect to your phone with your PC.

With the LG PC Suite software, you can...

- Manage and play your media contents (music, movie, pictures) on your PC.
- Send multimedia contents to your device.
- Synchronizes data (schedules, contacts, bookmarks) in your device and PC.
- Backup the applications in your device.
- Update the software in your device.
- Play multimedia contents of your PC from other device

**NOTE:** Some functions may not be available, depending on the model.

**NOTE:** You can use the Help menu from the application to find out how to use the LG PC Suite software.

## Installing the LG PC Suite Software

To download the LG PC Suite software, please do the following:

- 1 Go to [www.lg.com](http://www.lg.com).
- 2 Go to **SUPPORT > MOBILE SUPPORT > PC Sync**.
- 3 Select the model information and click **GO**.
- 4 Scroll down, select the **PC SYNC** tab > **Windows > DOWNLOAD** to download LG PC Suite.

## System Requirements for LG PC Suite software

- OS: Windows XP (Service pack 3) 32bit, Windows Vista, Windows 7, Windows 8
- CPU: 1 GHz or higher processors
- Memory: 512 MB or higher RAMs
- Graphic card: 1024 x 768 resolution, 32 bit color or higher
- HDD: 500 MB or more free hard disk space (More free hard disk space may be needed depending on the volume of data stored.)
- Required software: LG United drivers, Windows Media Player 10 or later.

### **NOTE: LG United USB Driver**

The LG United USB driver is required to connect an LG device and PC. It is installed automatically when you install the LG PC Suite software application.

## For Mac OS

### With the LG PC Suite software, you can...

- Manage and play your media contents (music, movie, pictures) on your PC.
- Send multimedia contents to your device.
- Synchronizes data (schedules, contacts, bookmarks) in your device and PC.

**NOTE:** Some functions may not be available, depending on the model.

**NOTE:** You can use the Help menu from the application to find out how to use the LG PC Suite software.

## Installing the LG PC Suite Software

To download the LG PC Suite software, please do the following:

- 1 Go to [www.lg.com](http://www.lg.com).
- 2 Go to **SUPPORT > MOBILE SUPPORT > PC Sync**.
- 3 Select the model information and click **GO**.
- 4 Scroll down, select the **PC SYNC** tab > **Mac OS > DOWNLOAD** to download LG PC Suite.

## System Requirements for LG PC Suite software

- OS: Mac OS X (10.6.8) or higher
- Memory : 2GB RAM or higher
- Graphics card: 1024 x 768 screen resolution or higher and 32-bit color
- Hard disc: Storage of 500 MB or higher (Additional space may be required for data)
- Required software: LG United Mobile driver

### **NOTE: LG Integrated USB Driver**

The LG integrated USB driver is required to connect an LG device and PC. It is installed automatically when you install the LG PC Suite software application.

## Phone software update

### Software updates from the Internet for your LG phone

For more information about software updates, please visit <http://www.lg.com/common/index.jsp>.

This feature allows you to conveniently update the firmware on your phone to a newer version from the Internet without needing to visit a service center. This feature will only be available if and when LG makes a newer firmware version available for your device. Because the mobile phone firmware update requires the user's full attention for the duration of the update process, please make sure you check all instructions and notes that appear at each step before proceeding. Please note that removing the USB cable during the upgrade may seriously damage your mobile phone.

**NOTE:** LG reserves the right to make firmware updates available only for selected models at its own discretion and does not guarantee the availability of the newer version of the firmware for all phone models.

### Software updates via Over-the-Air (OTA) for your LG phone

This feature allows you to conveniently update your phone's software to a newer version via OTA, without connecting using a USB cable. This feature will only be available if and when LG makes a newer firmware version available for your device.

You should first check the software version on your mobile phone: **Settings > General tab > About phone > Update Center > Software Update > Check now for update.**

**NOTE:** Your personal data saved to the internal phone memory—including information about your Google account and any other accounts, your system/application data and settings, any downloaded applications and your DRM licence—may be lost in the process of updating your phone's software. Therefore, LG recommends that you backup your personal data before updating your phone's software. LG does not take responsibility for any loss of personal data.

**NOTE:** This feature depends on your network service provider, region and country.

## About this user guide

- Before using your device, please carefully read this guide. This ensures that you use your phone safely and correctly.
- Some of the images and screenshots provided in this guide may appear differently on your phone.
- Your content may differ from the final product or from software supplied by service providers or carriers. This content is subject to change without prior notice. For the latest version of this guide, please visit the LG website at [www.lg.com](http://www.lg.com).
- Your phone's applications and their functions may vary by country, region or hardware specifications. LG cannot be held liable for any performance issues resulting from the use of applications developed by providers other than LG.
- LG cannot be held liable for performance or incompatibility issues resulting from edited registry settings or modified operating system software. Any attempt to customize your operating system may cause the device or its applications to work incorrectly.
- Software, audio, wallpaper, images, and other media supplied with your device are licensed for limited use. If you extract and use these materials for commercial or other purposes, you may be infringing copyright laws. As a user, you are fully and entirely responsible for the illegal use of media.
- Additional charges may apply for data services, such as messaging, uploading, downloading, auto-syncing and location services. To avoid additional charges, select a data plan suitable to your needs. Contact your service provider to obtain additional details.

## Trademarks

- LG and the LG logo are registered trademarks of LG Electronics.
- All other trademarks and copyrights are the property of their respective owners.

### DivX HD

This DivX Certified® device has passed rigorous testing to ensure it plays DivX® video. To play purchased DivX movies, first register your device at [vod.divx.com](http://vod.divx.com). Find your registration code in the DivX VOD section of your device setup menu.

**DivX Certified® to play DivX® video up to HD 720p, including premium content. DivX®, DivX Certified® and associated logos are trademarks of DivX, LLC and are used under license.**

### Dolby Digital Plus DOLBY DIGITAL PLUS

Manufactured under license from Dolby Laboratories. Dolby, Dolby Digital Plus, and the double-D symbol are trademarks of Dolby Laboratories.

## Accessories

These accessories are available for use with the your phone. **(Items described below may be optional.)**

- Travel adaptor
- Quick Start Guide
- Stereo headset
- USB cable

### **NOTE:**

- Always use genuine LG accessories. The supplied items are designed only for this device and may not be compatible with other devices.
- The items supplied with the device and any available accessories may vary depending on the region or service provider.

# Troubleshooting

This chapter lists some problems you might encounter when using your phone. Some problems require you to call your service provider, but most are easy to fix yourself.



Message	Possible causes	Possible corrective measures
SIM or USIM card error	There is no SIM or USIM card in the phone or it is inserted incorrectly.	Make sure that the SIM card is correctly inserted.
No network connection/ Dropped network	Signal is weak or you are outside the carrier network.	Move toward a window or into an open area. Check the network operator coverage map.
	Operator applied new services.	Check whether the SIM card is more than 6~12 months old. If so, change your SIM card at your network provider's nearest branch. Contact your service provider.
Codes do not match	To change a security code, must confirm the new code by re-entering it.	If you forget the code, contact your service provider.
	The two codes you entered do not match.	

<b>Message</b>	<b>Possible causes</b>	<b>Possible corrective measures</b>
No applications can be set	Not supported by service provider or registration required.	Contact your service provider.
Calls not available	Dialing error	New network not authorized.
	New SIM or USIM card inserted.	Check for new restrictions.
	Pre-paid charge limit reached.	Contact service provider or reset limit with PIN2.
Phone cannot be turned on	On/Off key pressed too briefly.	Press the On/Off key for at least two seconds.
	Battery is not charged.	Charge battery. Check the charging indicator on the display.

Message	Possible causes	Possible corrective measures
Charging error	Battery is not charged.	Charge battery.
	Outside temperature is too hot or cold.	Make sure phone is charging at a normal temperature.
	Contact problem	Check the charger and its connection to the phone.
	No voltage	Plug the charger into a different outlet.
	Charger defective	Replace the charger.
	Wrong charger	Use only original LG accessories.
Number not allowed.	The Fixed dialing number function is on.	Check the Settings menu and turn the function off.
Impossible to receive/send text messages & photos	Memory full	Delete some messages from your phone.
Files do not open	Unsupported file format	Check the supported file formats.



Message	Possible causes	Possible corrective measures
The screen does not turn on when I receive a call.	Proximity sensor problem	If you use a protection tape or case, make sure it has not covered the area around the proximity sensor. Make sure that the area around the proximity sensor is clean.
No sound	Vibration mode	Check the settings status in the sound menu to make sure you are not in vibration or silent mode.
Hangs up or freezes	Intermittent software problem	Try to perform a software update through the website.

Category	Question	Answer
Bluetooth Devices	What are the functions available via Bluetooth?	You can connect a Bluetooth audio device, such as a Stereo/Mono headset or car kit.
Contacts Backup	How can I back up Contacts?	Contacts data can be synchronized between your phone and Gmail™.
Synchronization	Is it possible to set up one-way sync with Gmail?	Only two-way synchronization is available.
Synchronization	Is it possible to synchronize all email folders?	The Inbox is automatically synchronized. You can view other folders by tapping the  icon and selecting <b>Folders</b> to choose a folder.
Gmail Log-In	Do I have to log into Gmail whenever I want to access Gmail?	Once you have logged into Gmail, there is no need to log into Gmail again.
Google Account	Is it possible to filter emails?	No, the phone does not support email filtering.
Email	What happens when I execute another application while writing an email?	Your email is automatically saved as a draft.
Ringtone	Is there a file size limit for using MP3 files as ringtones?	There is no file size limit.

Category	Question	Answer
Message Time	My phone does not display the time of receipt for messages older than 24 hrs. How can I view the time?	Open the conversation and touch and hold the desired message. Then tap <b>Details</b> .
Navigation	Is it possible to install another navigation application on my phone?	Any application that is available at Play Store™ and is compatible with the hardware can be installed and used.
Synchronization	Is it possible to synchronize my contacts from all my email accounts?	Only Gmail and MS Exchange server (company email server) contacts can be synchronized.
Wait and Pause	Is it possible to save a contact with Wait and Pause in the numbers?	<p>If you transferred a contact using the Wait &amp; Pause functions saved into the number, you cannot use those features. You must save each number again.</p> <p>How to save with Wait and Pause:</p> <ol style="list-style-type: none"> <li>1. From the Home screen, tap .</li> <li>2. Dial the number, then tap .</li> <li>3. Tap <b>Add 2-sec pause</b> or <b>Add wait</b>.</li> </ol>
Security	What are the phone's security functions?	You can set the phone to require an Unlock Pattern to be entered before the phone can be accessed or used.

Category	Question	Answer
Unlock Pattern	How do I create the Unlock Pattern?	<ol style="list-style-type: none"> <li>1. From the Home screen, tap and hold .</li> <li>2. Tap <b>System settings</b> &gt; <b>Display</b> tab &gt; <b>Lock screen</b>.</li> <li>3. Tap <b>Select screen lock</b> &gt; <b>Pattern</b>. The first time you do this, a short tutorial about creating an Unlock Pattern appears.</li> <li>4. Set up your pattern by drawing it then drawing it a second time for confirmation.</li> </ol> <p>Precautions to take when using the pattern lock.</p> <p>It is very important to remember the unlock pattern you set. You can no longer access your phone if you use an incorrect pattern five times. You have five chances to enter your unlock pattern, PIN or password. If you have used all 5 opportunities, you can try again after 30 seconds. (Or, if you preset the backup PIN, you can use the backup PIN code to unlock the pattern.)</p>

Category	Question	Answer
Unlock Pattern	What should I do if I forget the unlock pattern and I did not create my Google account on the phone?	<p>If you forgot your pattern: If you logged into your Google account on the phone but failed to enter the correct pattern 5 times, tap the Forgot pattern button. You are then required to log in with your Google account to unlock your phone. If you have not created a Google account on the phone or you have forgotten it, you must perform a hard reset.</p> <p>Caution: If you perform a factory reset, all user applications and user data are deleted. Please remember to back up any important data before performing a factory reset.</p>
Memory	Will I know when my memory is full?	Yes, you will receive a notification.
Language Support	Is it possible to change my phone's language?	<p>The phone has multilingual capabilities. To change the language:</p> <ol style="list-style-type: none"> <li>1. From the Home screen, tap and hold  and tap <b>System settings</b>.</li> <li>2. Tap <b>General</b> tab &gt; <b>Language &amp; input</b> &gt; <b>Language</b>.</li> <li>3. Tap the desired language.</li> </ol>
VPN	How do I set up a VPN?	VPN access configuration is different for each company. To configure VPN access on your phone, you must obtain the details from your company's network administrator.

Category	Question	Answer
Screen time out	My screen turns off after only 15 seconds. How can I change the amount of time for the backlight to turn off?	<ol style="list-style-type: none"> <li>1. From the Home screen, tap and hold .</li> <li>2. Tap <b>System settings</b> &gt; <b>Display</b> tab.</li> <li>3. Tap <b>Screen timeout</b>.</li> <li>4. Tap the preferred screen backlight timeout time.</li> </ol>
Wi-Fi & mobile network	When the Wi-Fi and mobile networks are both available, which service does my phone use?	<p>When using data, your phone may default to the Wi-Fi connection (if Wi-Fi connectivity on your phone is set to On). However, there is no notification when your phone switches from one to the other.</p> <p>To know which data connection is being used, view the mobile network or Wi-Fi icon at the top of your screen.</p>
Home screen	Is it possible to remove an application from the Home screen?	Yes. Just touch and hold the icon until the trash can icon appears at the top and center of the screen. Then, without lifting your finger, drag the icon to the trash can.
Application	I downloaded an application and it causes a lot of errors. How do I remove it?	<ol style="list-style-type: none"> <li>1. From the Home screen, tap and hold .</li> <li>2. Tap <b>System settings</b> &gt; <b>General</b> tab &gt; <b>Apps</b> tab (if necessary) &gt; <b>DOWNLOADED</b>.</li> <li>3. Tap the application, then tap <b>Uninstall</b>.</li> </ol>

Category	Question	Answer
Charger	Is it possible to charge my phone using a USB cable without installing the necessary USB driver?	Yes, the phone is charged through the USB cable regardless of whether the necessary drivers are installed.
Alarm	Can I use music files for my alarm?	Yes. After saving a music file as a ringtone, you can use it as an alarm. <ol style="list-style-type: none"> <li>1. Touch and hold a song in a library list. In the menu that opens, tap <b>Set as ringtone</b> &gt; <b>Phone ringtone</b> or <b>Contact ringtone</b>.</li> <li>2. On the Alarm Clock Setting screen, select the song as a ringtone.</li> </ol>
Alarm	Will my alarm be audible or will it go off if the phone is turned off?	No, this is not supported.
Alarm	If my ringer volume is set to Vibrate, will I hear my alarm?	Your alarm is programmed to be audible even in these scenarios.
Display	I tried to set the screen brightness to maximum but it still appears dark. How can I make the screen brighter?	<ol style="list-style-type: none"> <li>1. From the Home screen, tap and hold <input type="checkbox"/>.</li> <li>2. Tap <b>System settings</b> &gt; <b>Display</b> tab &gt; <b>Auto-adjust screen tone</b>.</li> <li>3. Tap the checkbox to cancel the function.</li> </ol>
Hard Reset (Factory Reset)	How can I perform a factory reset if I cannot access the phone's Settings menu?	If your phone does not restore to its original condition, use a hard reset (factory reset) to initialize it.

### **Wi-Fi (WLAN)**

This equipment may be operated in all European countries.  
The 5150 - 5350 MHz band is restricted to indoor use only.

AT	BE	BG	CH	HR	CY	CZ	DK	EE	FI	FR	DE	GR	HU	IE	IT	LI	LV
LT	LU	MT	NO	NL	PL	PT	RO	SK	SI	ES	SE	GB	IS	ME	RS	TR	MK



**General Inquiries**

< LG Customer Information Centre >

**UK: 0344-847-5454 or +44-344-847-5454**

**IE: 01-686-9454 or +353-1-686-9454**

\* Make sure the number is correct before making a call.



CE0168!