

Multimedia Speaker System

LH70B

ENGLISH OWNER'S MANUAL

Please read this manual carefully before operating your set and retain it for future reference.

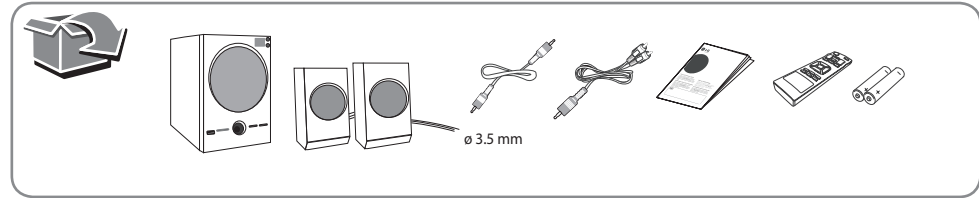

www.lg.com

Product Overview

Front of the unit

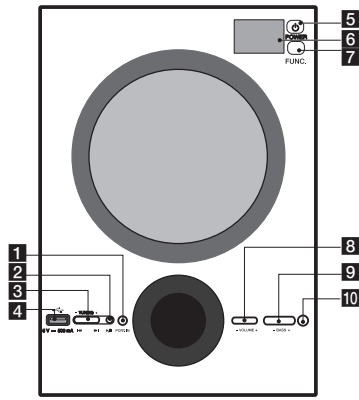

1 **PORT. IN** (ø 3.5mm) : Listens to music from your portable device.

2 **▶/II** : Playback / Pause

3 **◀◀/▶▶** : (Skip/Search)

- Skips Fast backward or Forward.
- Searches for a section within a file.

- TUNING + : Scans the radio station.

4 **USB Port** (5 V \equiv 500 mA)

5 **POWER** Power (ON/OFF) button

6 **Display window** : Shows the current status of the unit.

7 **FUNC.** : (Function: Selects a function among the USB, AUX, **PORT.IN**, **Bluetooth** or FM.)

8 **VOLUME(+/-)** : Adjusts speaker volume.

9 **BASS (-/+)** : Adjusts Subwoofer volume

Back of the unit

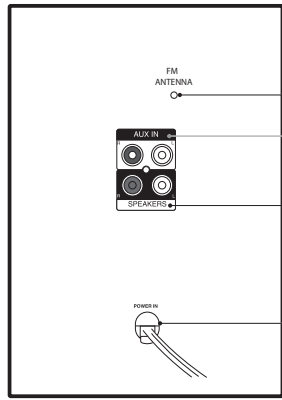

10 Remote Sensor

11 **FM ANTENNA**

12 **AUX IN** connectors(L/R)

13 **SPEAKERS** connectors(L/R)

14 **POWER IN** cable

! USB Port is not available for charging battery.

Remote Controller

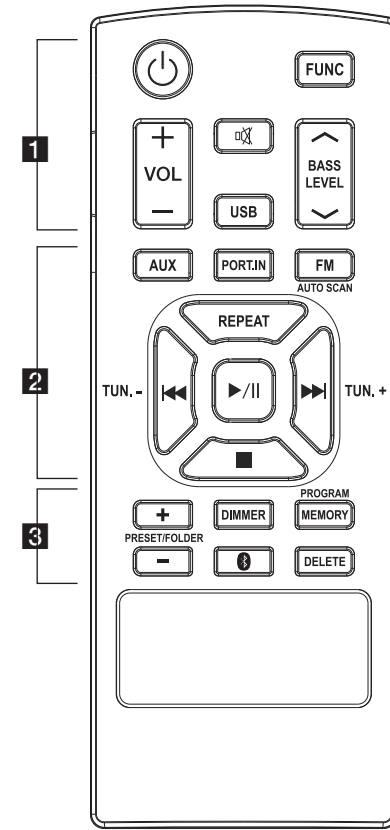

1 : Switches the unit ON or OFF.

FUNC. : Selects the function and input source on the display window.

(USB → AUX → PORT.IN → Bluetooth → FM → USB...)

VOL +/- : Adjusts speaker volume.

MUTE : Mutes the sound.

USB : Changes to USB function.

BASS LEVEL : Adjusts Subwoofer volume.

2 : Changes to AUX function.

PORT.IN : Changes to **PORT.IN** function.

FM/AUTO SCAN:

- Changes to FM radio function.
- Presets the radio station automatically.

REPEAT : Plays to your files repeatedly or randomly.

◀◀/▶▶ : (Skip/Search)

- Skips Fast backward or Forward.
- Searches for a section within a file.

TUN. (- / +) : Scans the radio stations.

▶/II : (Play/Pause)

- Starts or pauses playback.

- Selects STEREO/MONO.

■ : Stops playback

3 **PRESET/FOLDER (+/-)** :

- Searches for a folder of MP3 files.

- Chooses a preset number for a radio station.

DIMMER : Press [DIMMER] once. The display window will be darkened by half. (To cancel it, press [DIMMER] again.)

PROGRAM/MEMORY : Presets radio stations and stores.

Bluetooth : Changes input source to Bluetooth.

DELETE : Deletes saved radio stations.

Battery Installation

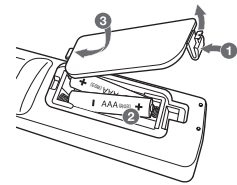

Remove the battery cover on the rear of the Remote Control, and insert two (size AAA) batteries with **+** and **-** matched correctly.

Safety Information

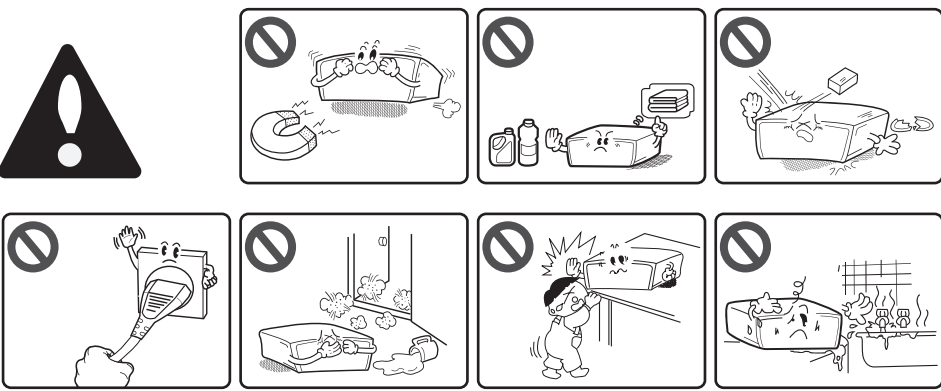
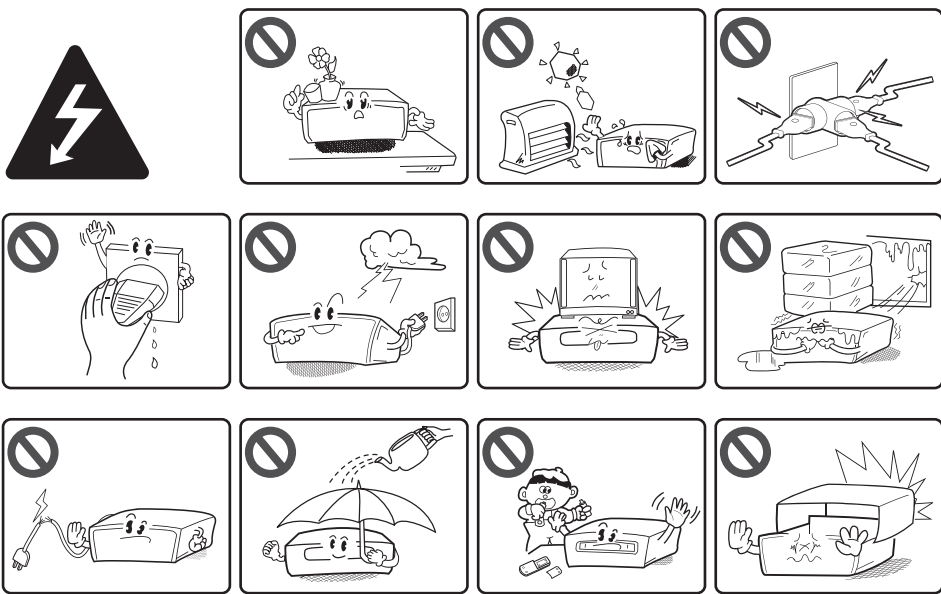

External Device Connection (AUX)

OPTION 1

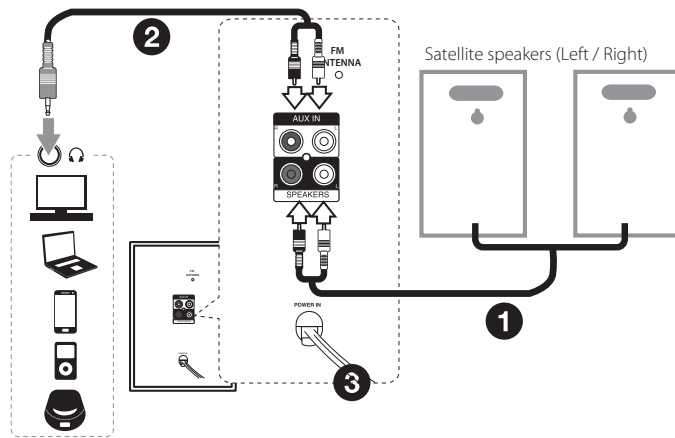

1. Connect the satellite speaker cable to **SPEAKERS** (L/R) of the unit, matching respective colour connector.
2. Connect the [AUX IN] of the unit to output port of an external device or portable player using supplied (RCA) cable.
3. Plug the power cable into wall outlet.
4. Turn the Power on by pressing [POWER] on the front of the unit or remote control.
5. Select [AUX] function by pressing [FUNC.] on the front of the unit or [FUNC] on the remote control.
6. Turn on the external device and start playing music.

OPTION 2

If you want to connect an external device with AUX OUT(L/R) connector, connect it using Audio cable (L/R).

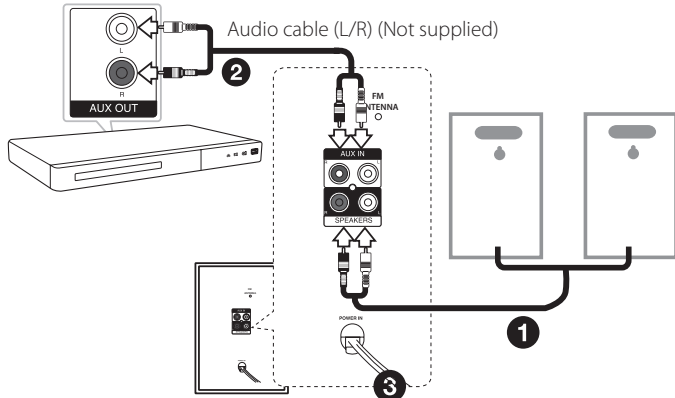

- !**
- To prevent hearing damage when turning on the unit, always turn down the VOLUME and BASS before turning off the unit.
 - If you do not intend to use the speakers for a long time, turn off the power.
 - If your external player has only one output for audio(mono), connect it to the left (white) audio connector on the unit.

USB Data Playback

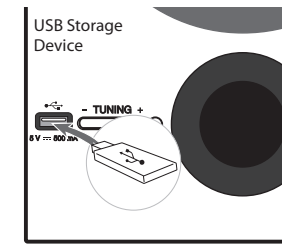

1. Insert the USB storage device (or MP3 player, etc.) to the USB port on the front of the unit.
2. Select the USB function by pressing [FUNC.] on the front of the unit or [FUNC] on the remote control. When you select USB function, the USB storage device will be played automatically.
3. Select a file you want to play by pressing **◀◀/▶▶** on the front of the unit or remote control.

- !** **MP3 Playback Requirement**
- Bitrate : 32 kbps - 448 kbps
 - Sampling Frequency : 8 KHz - 48 KHz

Removing the USB Device from the unit :

1. Choose a different function or press **■** on the remote control.
2. Remove the USB device from the unit.

To	Do this
Stop	Press ■ on the remote control.
Playback	Press ▶/II on the front of the unit or remote control.
Skipping to the next/previous file	Press ◀◀/▶▶ on the unit or to skip the file in stop state. During playback, press ▶▶ on the unit or remote control or to go to the next file. Playing less than 3 seconds, press ◀◀ on the unit or remote control to go to the previous file. Playing after 3 seconds, press ◀◀ on the unit or remote control to go to the beginning of the file.
Pause	During playback, press ▶/II on the unit or remote control.
Searching for a section within a file	During playback, Press and hold ◀◀/▶▶ on the unit or remote control and release it at the point you want to listen to.
Playing repeatedly or randomly	Press [REPEAT] on the remote control repeatedly, the display changes in the following order. 1 REPEAT → ALL REPEAT → ALL RANDOM → OFF

- !**
- If you use an USB extension cable or USB hub, the USB device is not recognized.
 - Some USB device may not work with this unit.
 - During random playback, a same file that was being played may be played again.
 - For a large capacity USB, it may take a few minute to be searched.



Selecting a folder

When a USB containing MP3 files in several folders is being played,

1. Press [PRESET/FOLDER +/-] on the remote control repeatedly. Index of the first played file in the folder is displayed.
2. Press ►/II on the unit or remote control to play it. The first file of the folder will play.

- USB Folders/Files are recognized as below.

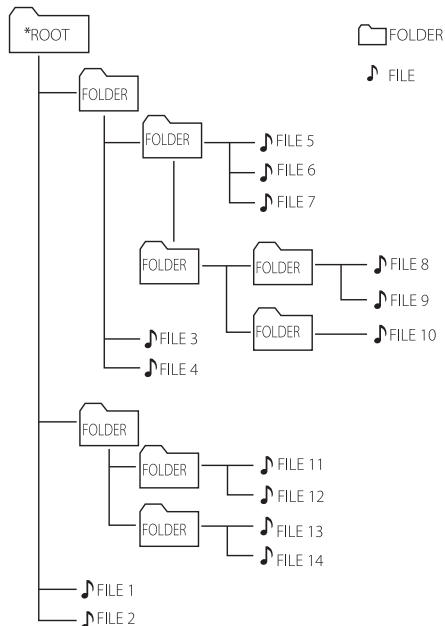

- File will be played from ♪ file No.1 to ♪ file No.14 one by one.
- The Index number of folder will be presented in order recorded and may be presented differently according to the recording circumstances.
- *ROOT : The first screen you can see when a computer recognizes the USB is "ROOT".



Radio Operation

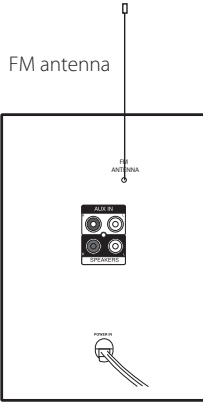

Listening to the radio

1. Press [FM/AUTO SCAN] on the remote control or [FUNC.] on the unit until FM appears in the display window.
The last received station is tuned in.
2. - **Auto tuning:** Press [TUN.-/+] on the remote control or [TUNING -/+] on the unit for about 1 second until the frequency indication starts changing, then release. scanning stops when the unit tunes in a station.
- **Manual tuning:** Press [TUN.-/+] on the remote control or [TUNING -/+] on the unit repeatedly.
3. Adjust the volume by using [VOL +/-] on the remote control or the unit.

- Be sure to fully extend the FM wire antenna before using the radio function.
- Before tuning, make sure to turn down the volume.
- Press ►/II on the remote control. This will change the tuner from stereo to mono. Then the FM reception will be better than before.



Presetting Radio Station

Presetting the Radio Stations

1. Press [FUNC] on the remote control or [FUNC.] on the unit until FM appears in the display window.
2. Select the desired frequency by pressing [TUN.-/+] on the remote control or [TUNING -/+] on the unit.
3. Press [PROGRAM/MEMORY]. A preset number will blink in the display window.
4. Press [PROGRAM/MEMORY]. The station is saved.
5. Repeat steps 2 to 4 to store other stations. You can preset up to 50 stations for FM.
6. To listen a preset station, press [PRESET/FOLDER +/-].

Using AUTO SCAN

1. Press [FM/AUTO SCAN] on the remote control for longer than 2 seconds, all of the FM bands are scanned.
2. Radio frequencies are saved automatically by preset number while FM bands are scanned.
3. To cancel the scanning, press ■ or convert to other function. It will be cancelled.

Deleting a saved Preset station

1. Select a desired Preset by pressing [PRESET/FOLDER +/-] and press [DELETE] on the remote control.
2. The selected Preset number will be blinked.
3. Press [DELETE] on the remote control to erase the saved preset number.

- Press and hold [DELETE] to erase all saved radio stations.



Using BLUETOOTH®

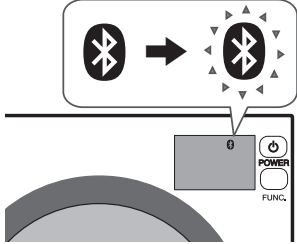

Before you start the pairing procedure, make sure that the Bluetooth feature is turned on in your Bluetooth device.

1. Press [POWER] to turn on the unit or remote control.
2. Select the (Bluetooth) * function by pressing [FUNC.] on the front of the unit or * button on the remote control.
3. * * will blink to find a Bluetooth device on the display window.

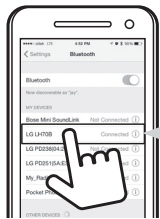

- Select "LG LH70B (XX)" on your Bluetooth device. (XX) means the last two digits of BT address.)
- Depending on the Bluetooth device, you need to enter the PIN code (0000).

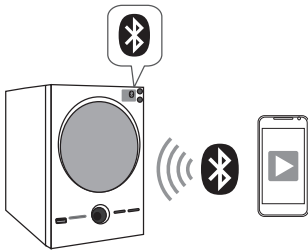

4. When this unit successfully paired with your Bluetooth device, * * will stop blinking.
5. Play music on your Bluetooth device.

- Sound from the main set can be distorted if you raise the volume of Bluetooth device up to two-thirds or more.
- When you use the Bluetooth function, adjust the volume of a Bluetooth device to a proper level to listen to.
- When using Bluetooth® technology, you have to make a connection between the unit and the Bluetooth device as close as possible and keep the distance. However it may not work well in the case below :
 - There is a obstacle between the unit and the Bluetooth device.-
 - There is a device using same frequency with Bluetooth® technology such as a medical equipment, a microwave or a wireless LAN device.
- You should connect your Bluetooth device to this unit again when you restart it.
- Pairing is limited one Bluetooth device per one unit and multi-pairing is not supported.
- When you select Bluetooth function again after changing to other functions, the last connected Bluetooth device is connected automatically.
- Depending on the type of the device, you may not be able to use the Bluetooth function.
- Bluetooth connection will be disconnected when the unit is turned off or the Bluetooth device gets too far from the unit.



Troubleshooting

No Power

- The power cord is not plugged in. Plug in the power cord.
- Check whether electricity failed. Check the condition by operating other electronic devices.

No sound and sound distortion

- The unit or your external device's volume is set to minimum. Check and adjust the volume of the unit.
- When you use external device at high volume, the sound quality may be deteriorated. Lower the volume of device.
- If you use the unit for purposes other than listening to music, the sound quality may be lowered or the unit may not work properly.

The USB device does not start playback

- An unplayable USB device is inserted. Check the USB device.
- Check whether you selected right function. Pressing [FUNC.] button and check the selected function.

Radio stations cannot be tuned in properly.

- The antenna is positioned poorly. Adjust its position.
- The signal strength of the radio station is too weak. Tune to the station manually.
- No stations have been preset or preset stations have been cleared (when being tuned by scanning preset channels). Refer to Presetting Radio Station.

The remote control does not work properly.

- The remote control is not pointed at the remote sensor of the unit. Point the remote control at the remote sensor of the unit.
- The remote control is too far from the unit. Operate the remote control within about 23 ft (7 m).
- There is an obstacle in the path of the remote control and the unit. Remove the obstacle.
- The battery in the remote control is exhausted. Replace the battery with new one.

Bluetooth pairing does not work well.

- Switch Bluetooth off and on again on your Bluetooth device, then try pairing again.
- Be sure your Bluetooth device is on.
- Remove the obstacle in the path of the Bluetooth device and the unit.
- Depending on the type of the Bluetooth device or surrounding environment, your device may not be paired with the unit.
- When your Bluetooth device have been already connected with other unit, disconnect the Bluetooth connection first.

Cleaning the unit

- To clean the player, use a soft, dry cloth. If the surfaces are extremely dirty, use a soft cloth lightly moistened with a mild detergent solution. Do not use strong solvents such as alcohol, benzine, or thinner, as these might damage the surface of the unit.



Specification

Auto power down

This unit will turn itself off to save electricity in the case were the main unit is not connected to an external device and is not used for 20 minutes.

The unit will also turn itself off after six hours if the Main unit has been connected to another device using the analog inputs.

How to disconnect the wireless network connection or the wireless device.

Turn off the unit.

Product type:

- 2.1 speaker system

Power Supply

- Refer to the main label.

Power Consumption

- 20 W

Dimensions (W x H x D):

- Satellite: Approx. 110 (W) mm x 201 (H) mm x 115 (D) mm
- Subwoofer: 264 (W) mm x 370 (H) mm x 323 (D) mm

Net Weight:

- Main Set : Approx. 5.44 kg
- Speaker (1EA) : Approx. 0.64 kg

Operating Temperature:

- 0 °C to 35 °C

Connectivity:

- 3.5mm stereo jack-male input jack

Tuner:

- FM Tuning Range : 87.5 to 108.0 MHz or 87.50 to 108.00 MHz

Impedance:

- Subwoofer: 6 (Ω)
- Satellite: 8 (Ω)

Frequency response

- Subwoofer: 55 Hz~ 104 Hz
- Satellite: 40 Hz ≤ 20 kHz

Total Max. power

- 70 W (THD : 10 %)

Signal to noise ratio

- 75 dB

- Design and specifications are subject to change without notice.



CAUTION: TO REDUCE THE RISK OF ELECTRIC SHOCK DO NOT REMOVE COVER (OR BACK) NO USER-SERVICEABLE PARTS INSIDE. REFER SERVICING TO QUALIFIED SERVICE PERSONNEL.



This lightning flash with arrowhead symbol within an equilateral triangle is intended to alert the user to the presence of uninsulated dangerous voltage within the product's enclosure that may be of sufficient magnitude to constitute a risk of electric shock to persons.



The exclamation point within an equilateral triangle is intended to alert the user to the presence of important operating and maintenance (servicing) instructions in the literature accompanying the product.

WARNING: TO PREVENT FIRE OR ELECTRIC SHOCK HAZARD, DO NOT EXPOSE THIS PRODUCT TO RAIN OR MOISTURE.

CAUTION: The apparatus shall not be exposed to water (dripping or splashing) and no objects filled with liquids, such as vases, shall be placed on the apparatus.

WARNING: Do not install this equipment in a confined space such as a book case or similar unit.

CAUTION: Do not use high voltage products around this product. (ex. Electrical swatter) This product may malfunction due to electrical shock.

CAUTION: Do not block any ventilation openings. Install in accordance with the manufacturer's instructions. Slots and openings in the cabinet are provided for ventilation and to ensure reliable operation of the product and to protect it from over heating. The openings shall be never be blocked by placing the product on a bed, sofa, rug or other similar surface. This product shall not be placed in a built-in installation such as a bookcase or rack unless proper ventilation is provided or the manufacturer's instruction has been adhered to.

CAUTION concerning the Power Cord

Most appliances recommend they be placed upon a dedicated circuit;

That is, a single outlet circuit which powers only that appliance and has no additional outlets or branch circuits. Check the specification page of this owner's manual to be certain. Do not overload wall outlets. Overloaded wall outlets, loose or damaged wall outlets, extension cords, frayed power cords, or damaged or cracked wire insulation are dangerous. Any of these conditions could result in electric shock or fire. Periodically examine the cord of your appliance, and if its appearance indicates damage or deterioration, unplug it, discontinue use of the appliance, and have the cord replaced with an exact replacement part by an authorized service center. Protect the power cord from physical or mechanical abuse, such as being twisted, kinked, pinched, closed in a door, or walked upon. Pay particular attention to plugs, wall outlets, and the point where the cord exits the appliance.

The Power Plug is the disconnecting device. In case of an emergency, the Power Plug must remain readily accessible.

NOTICE: For safety marking information including product identification and supply ratings, please refer to the main label on the bottom or rear of the apparatus.

This device is equipped with a portable battery or accumulator.

Safety way to remove the battery or the battery from the equipment: Remove the old battery or battery pack, follow the steps in reverse order than the assembly. To prevent contamination of the environment and bring on possible threat to human and animal health, the old battery or the battery put it in the appropriate container at designated collection points. Do not dispose of batteries or battery together with other waste. It is recommended that you use local, free reimbursement systems batteries and accumulators. The battery shall not be exposed to excessive heat such as sunshine, fire or the like.