

3D Blu-ray™ / DVD Home Theater System

BH6240S, BH6340H,
BH6440P, BH6540T

ENGLISH | SIMPLE MANUAL

An extended Owner's Manual that contains information on the advanced features is located on the CD-ROM provided in an electronic version. To read these files, you will need to use a Personal Computer (PC) equipped with a CD-ROM drive.

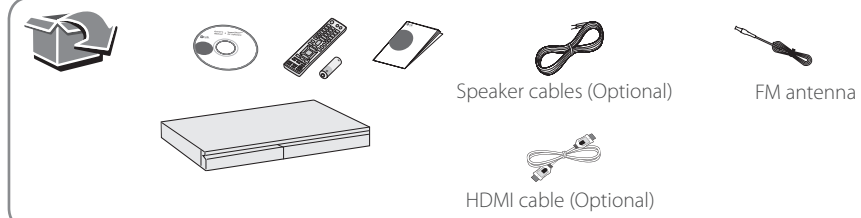

www.lg.com



TV Connection (HDMI OUT)

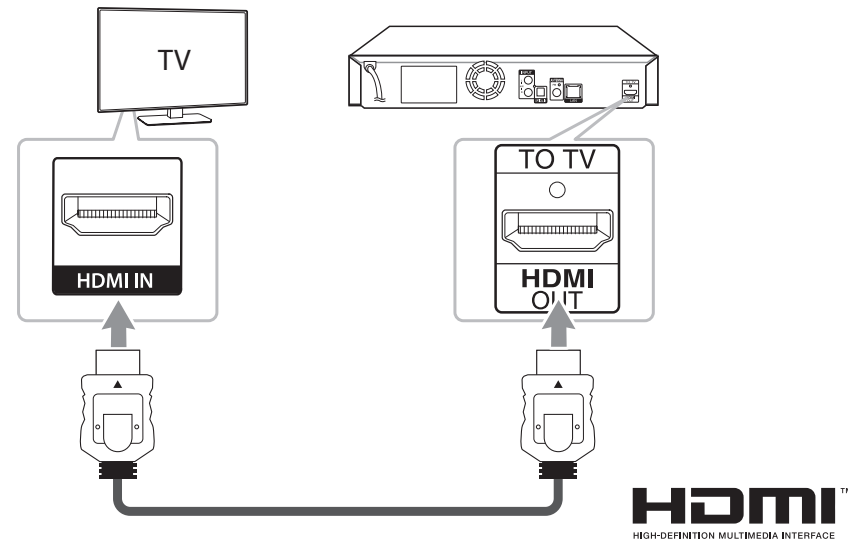

OPTICAL IN Connection

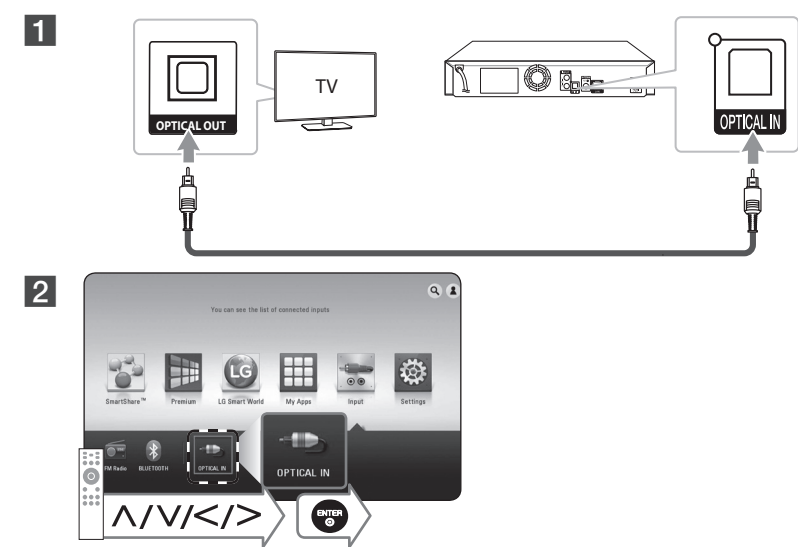

Wired Network Connection

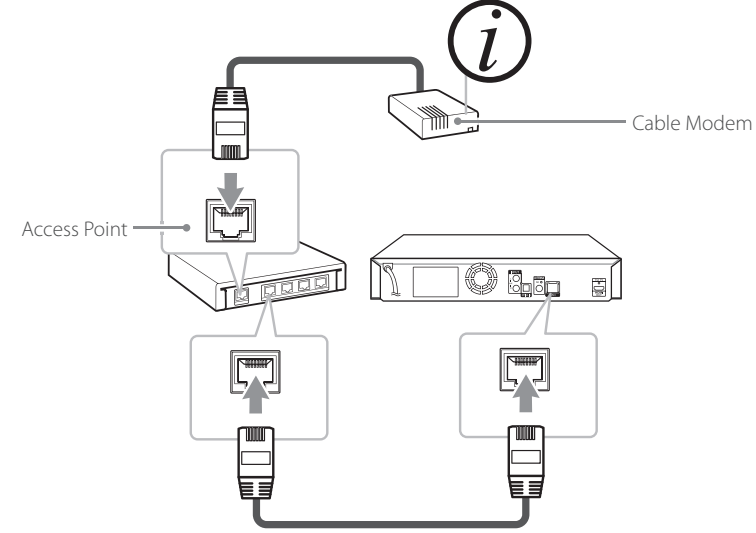

Speaker Connection

! Speaker design and connection method may be different according to models.

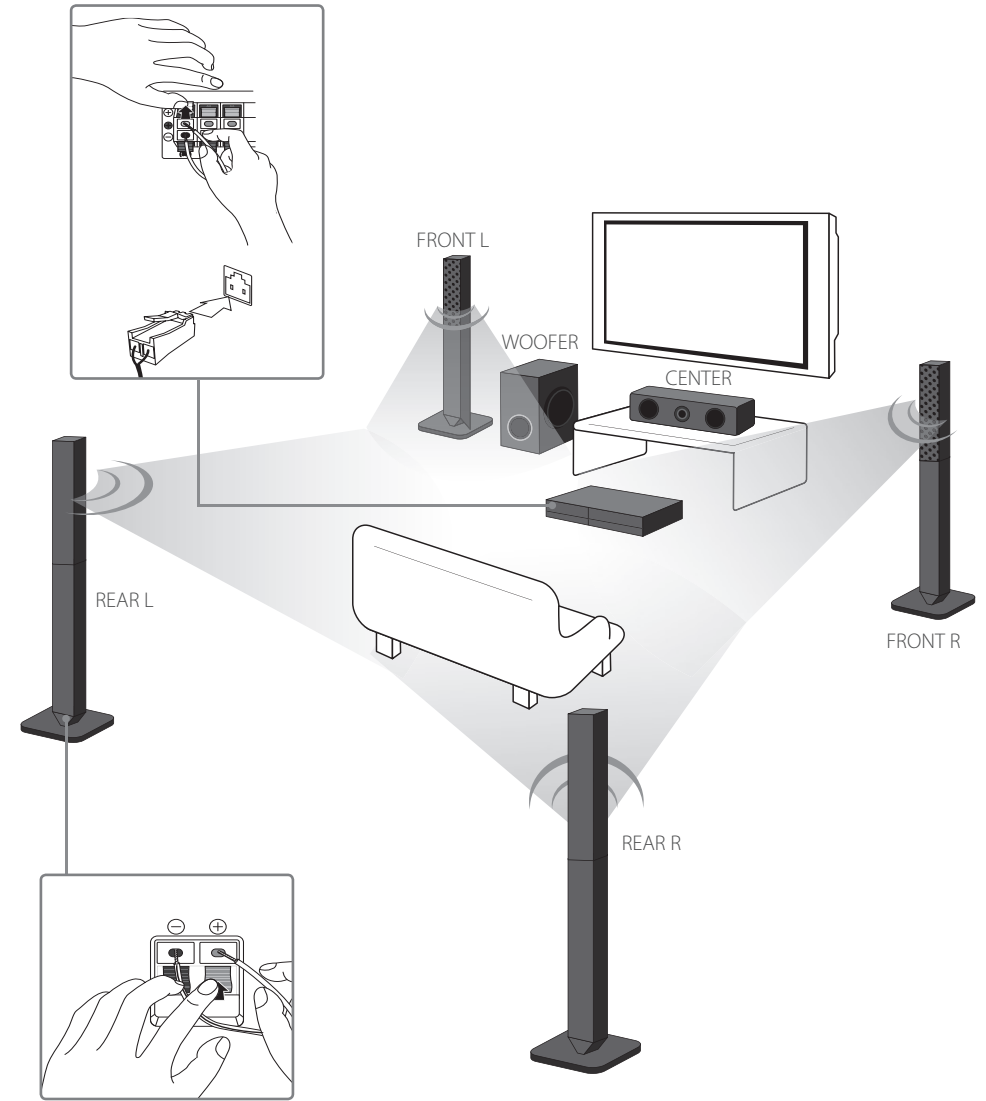

Initial Setup

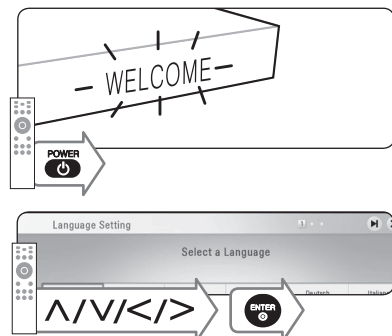

Follow the directions for the initial setup displayed on the screen.



⋮
Start the speaker test.

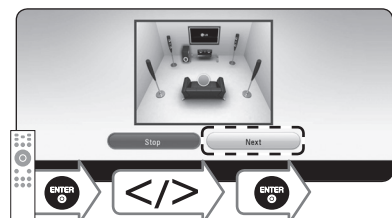

Stop the speaker test and select [Next].

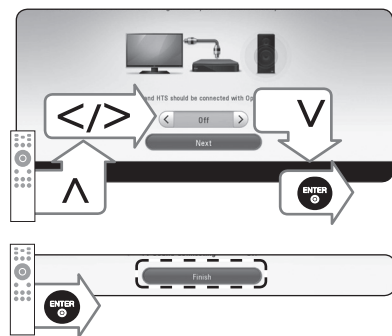

Setup [TV Sound Connecting] and select [Next].



Using HOME menu

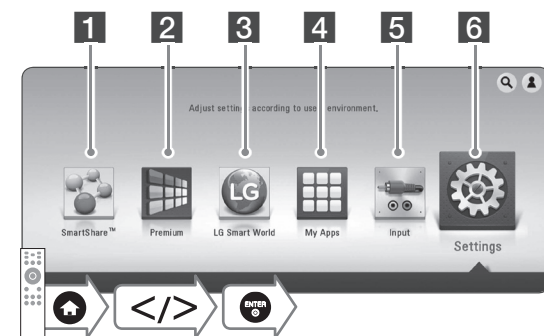

- 1 Displays SmartShare menu.
- 2 Displays LG Apps titles provided to the unit.
- 3 Displays the [My Apps] screen.
- 4 Displays the [My Apps] screen.
- 5 Changes input mode.
- 6 Adjusts the system settings.



Disc, Data Playback

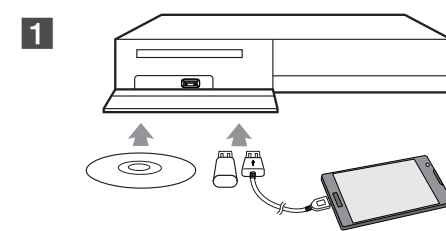

! Devices that support MTP.

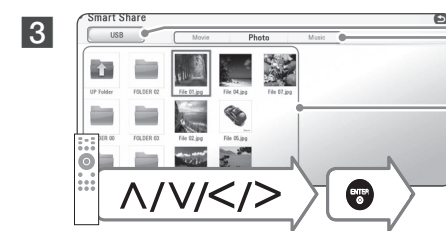
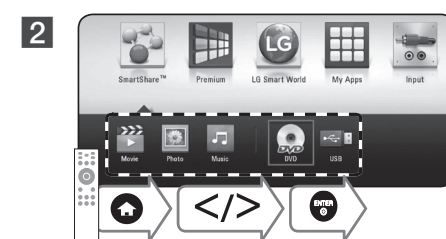

Displays all linked devices.

Selects video, photo or audio content.

Displays the file or folder on linked device.

! For the most Audio CD, BD-ROM and DVD-ROM discs, playback starts automatically.



Network Playback

SmartShare PC software Installation

- 1 Install SmartShare PC Software.

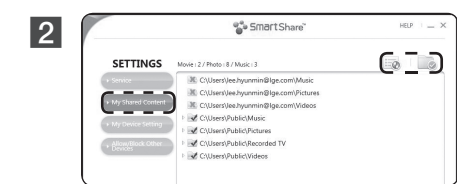

Run the program, and set the share folder you want.

SmartShare Network Playback

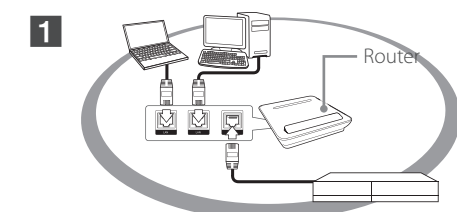

Check the network connection and settings.

