



ENGLISH

FRANÇAIS

PORTUGUÊS

SIMPLE MANUAL

Wireless Sound Bar

Please read this manual carefully before operating your set and retain it for future reference.

To view the instructions of advanced features, visit <http://www.lg.com> and then download Owner's Manual. Some of the content in this manual may differ from your unit.

MODEL
SJ3



www.lg.com
Copyright © 2017 LG Electronics. All Rights Reserved



Front Panel

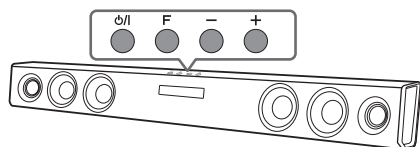

ϕ/I Standby/ON

F Selects Function

- / + Adjusts Volume

Rear Panel

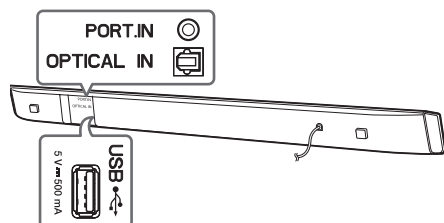

PORT.IN Connect to a Portable device

OPTICAL IN Connect to an Optical device

USB Connect to a USB device

1

Subwoofer Connection

Place the wireless subwoofer near the sound bar and follow steps below.

- 1 Connect the power cord of wireless subwoofer and sound bar to the outlet.
- 2 Turn on the main unit :
The sound bar and wireless subwoofer will be **automatically** connected. The subwoofer's green LED turns on.

Subwoofer Connection Manually

- 1 Press **Pairing** button on the rear of the wireless subwoofer.
 - The green LED on the rear of wireless subwoofer blinks quickly.
- 2 Turn on the main unit.
- 3 Pairing is completed.
 - The green LED on the rear of wireless subwoofer turns on.



Keep the sound bar and the subwoofer away from the device (ex. wireless router, microwave oven, etc.) over 1m to prevent wireless interference.

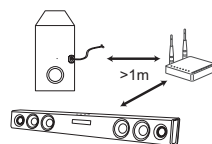

2 TV Connection

- 1 Connect the sound bar to the TV using Optical cable.
- 2 Set up [External Speaker (Optical)] on your TV setting menu.

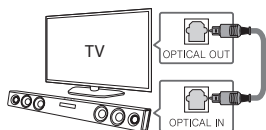

Additional Device Connection

- 1 Connect to the external device as follows.

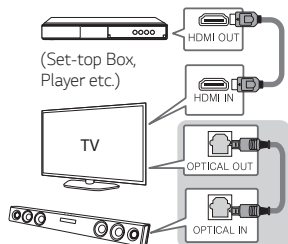

- 2 Set the input source by pressing **F** on the remote control or unit repeatedly.

Remote control

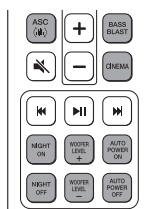

ASC/BASS BLAST/CINEMA: Selects the sound effect.

NIGHT ON/OFF: Turns down the volume at night.

WOOFER LEVEL +/-: Adjusts the volume level of subwoofer.

AUTO POWER ON/OFF: Automatically turns on by an input source.

Replacement of battery

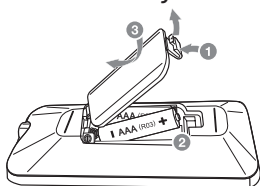

Additional Information

Specification

Power requirements	Refer to the main label.
Power consumption	Refer to the main label.
Dimensions (W x H x D)	Approx. 950 mm x 71 mm x 47 mm
Bus Power Supply (USB)	5 V  500 mA
Amplifier (Total RMS Output power)	300 W RMS

Design and specifications are subject to change without notice.

