

## INSTALLATION MANUAL

# AIR CONDITIONER

Please read this installation manual completely before installing the product.  
Installation work must be performed in accordance with the national wiring standards  
by authorized personnel only.  
Please retain this installation manual for future reference after reading it thoroughly.

Ceiling Concealed Duct  
Original instruction

[Representative] LG Electronics Inc. EU Representative : LG Electronics European Shared  
Service Center B.V. Krijgsman 1, 1186 DM Amstelveen, The Netherlands  
[Manufacturer] LG Electronics Inc. Changwon 2nd factory 84, Wanam-ro, Seongsan-  
gu, Changwon-si, Gyeongsangnam-do, KOREA

For more information, Refer to the CD or LG Web site ([www.lg.com](http://www.lg.com)).



P/NO : MFL67855520

[www.lg.com](http://www.lg.com)

# CONTENTS

<b>Safety Precautions .....</b>	<b>3</b>
<b>Installation Places .....</b>	<b>7</b>
<b>The indoor unit installation.....</b>	<b>8</b>
<b>Installation instruction .....</b>	<b>14</b>
<b>Self-diagnosis Function .....</b>	<b>27</b>
<b>Dip Switch Setting .....</b>	<b>27</b>

# Safety Precautions



To prevent the injury of the user or other people and property damage, the following instructions must be followed.

- Be sure to read before installing the air conditioner.
- Be sure to observe the cautions specified here as they include important items related to safety.
- Incorrect operation due to ignoring instruction will cause harm or damage. The seriousness is classified by the following indications.

**⚠ WARNING** This symbol indicates the possibility of death or serious injury.

**⚠ CAUTION** This symbol indicates the possibility of injury or damage to properties only.

- The meanings of the symbols used in this manual are as shown below.

	<b>Be sure not to do.</b>
	<b>Be sure to follow the instruction.</b>

## ⚠ WARNING

### ■ Installation

#### Always perform grounding.

- Otherwise, it may cause electrical shock.

#### Don't use a power cord, a plug or a loose socket which is damaged.

- Otherwise, it may cause a fire or electrical shock.

#### For installation of the product, always contact the service center or a professional installation agency.

- Otherwise, it may cause a fire, electrical shock, explosion or injury.

#### Securely attach the electrical part cover to the indoor unit and the service panel to the outdoor unit.

- If the electrical part cover of the indoor unit and the service panel of the outdoor unit are not attached securely, it could result in a fire or electric shock due to dust, water, etc.

#### Always install an air leakage breaker and a dedicated switching board.

- No installation may cause a fire and electrical shock.

#### Do not keep or use flammable gases or combustibles near the air conditioner.

- Otherwise, it may cause a fire or the failure of product.

**Ensure that an installation frame of the outdoor unit is not damaged due to use for a long time.**

- It may cause injury or an accident.

**Do not disassemble or repair the product randomly.**

- It will cause a fire or electrical shock.

**Do not install the product at a place that there is concern of falling down.**

- Otherwise, it may result in personal injury.

**Use caution when unpacking and installing.**

- Sharp edges may cause injury.

## ■ Operation

---

**Do not share the outlet with other appliances.**

- It will cause an electric shock or a fire due to heat generation.

**Do not use the damaged power cord.**

- Otherwise, it may cause a fire or electrical shock.

**Do not modify or extend the power cord randomly.**

- Otherwise, it may cause a fire or electrical shock.

**Take care so that the power cord may not be pulled during operation.**

- Otherwise, it may cause a fire or electrical shock.

**Unplug the unit if strange sounds, smell, or smoke comes from it.**

- Otherwise, it may cause electrical shock or a fire.

**Keep the flames away.**

- Otherwise, it may cause a fire.

**Take the power plug out if necessary, holding the head of the plug and do not touch it with wet hands.**

- Otherwise, it may cause a fire or electrical shock.

**Do not use the power cord near the heating tools.**

- Otherwise, it may cause a fire and electrical shock.

**Do not open the suction inlet of the indoor/outdoor unit during operation.**

- Otherwise, it may cause electrical shock and failure.

**Do not allow water to run into electrical parts.**

- Otherwise, it may cause the failure of machine or electrical shock.

**Hold the plug by the head when taking it out.**

- It may cause electric shock and damage.

**Never touch the metal parts of the unit when removing the filter.**

- They are sharp and may cause injury.

**Do not step on the indoor/outdoor unit and do not put anything on it.**

- It may cause an injury through dropping of the unit or falling down.

**Do not place a heavy object on the power cord.**

- Otherwise, it may cause a fire or electrical shock.

**When the product is submerged into water, always contact the service center.**

- Otherwise, it may cause a fire or electrical shock.

**Take care so that children may not step on the outdoor unit.**

- Otherwise, children may be seriously injured due to falling down.

---

---

**⚠ CAUTION**

---

---

■ **Installation**

---

**Install the drain hose to ensure that drain can be securely done.**

- Otherwise, it may cause water leakage.

**Install the product so that the noise or hot wind from the outdoor unit may not cause any damage to the neighbors.**

- Otherwise, it may cause dispute with the neighbors.

**Always inspect gas leakage after the installation and repair of product.**

- Otherwise, it may cause the failure of product.

**Keep level parallel in installing the product.**

- Otherwise, it may cause vibration or water leakage.

■ **Operation**

---

**Avoid excessive cooling and perform ventilation sometimes.**

- Otherwise, it may do harm to your health.

**Use a soft cloth to clean. Do not use wax, thinner, or a strong detergent.**

- The appearance of the air conditioner may deteriorate, change color, or develop surface flaws.

**Do not use an appliance for special purposes such as preserving animals vegetables, precision machine, or art articles.**

- Otherwise, it may damage your properties.

**Do not place obstacles around the flow inlet or outlet.**

- Otherwise, it may cause the failure of appliance or an accident.

# Installation Places

## Indoor unit

- The place shall easily bear a load exceeding four times the indoor unit's weight.
- The place shall be able to inspect the unit as the figure.
- The place where the unit shall be leveled.
- The place where the unit shall be leveled.
- The place shall allow easy water drainage. (Suitable dimension "H" is necessary to get a slope to drain as figure.)
- The place shall easily connect with the outdoor unit.
- The place where the unit is not affected by an electrical noise.
- The place where air circulation in the room will be good .
- There should not be any heat source or steam near the unit

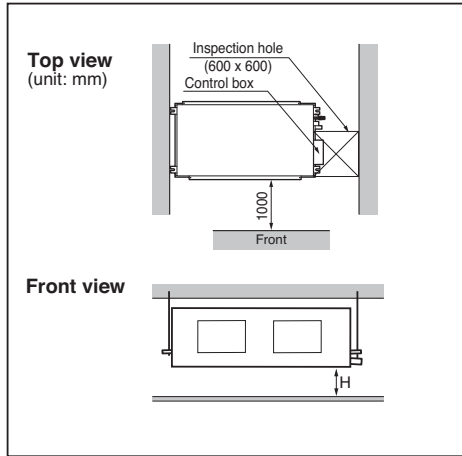

# The indoor unit installation

## Installation of Unit

Install the unit above the ceiling correctly.

### CASE 1

#### POSITION OF SUSPENSION BOLT

- Apply a joint-canvas between the unit and duct to absorb unnecessary vibration.
- Apply a filter Accessory at air return hole.

(Unit:mm)

Dimension Capacity	A	B	C	D	E	F	(G)	H	I	J
18/24 K	932	882	355	46	450	30	87	750	163	260

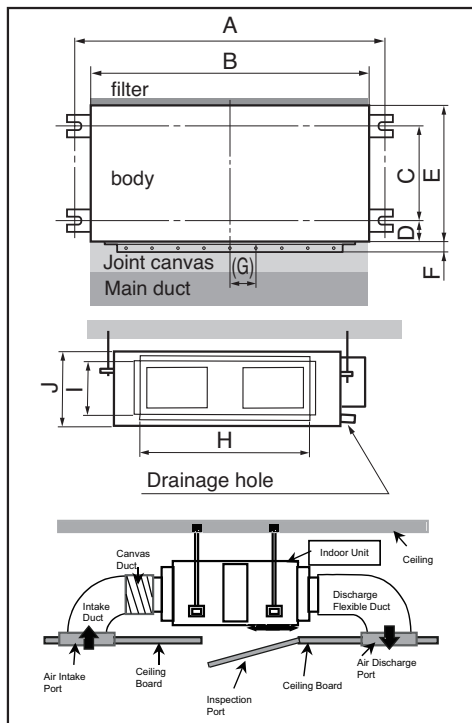

### CASE 2

- Install the unit leaning to a drainage hole side as a figure for easy water drainage.

#### POSITION OF CONSOLE BOLT

- A place where the unit will be leveled and that can support the weight of the unit.
- A place where the unit can withstand its vibration.
- A place where service can be easily performed.

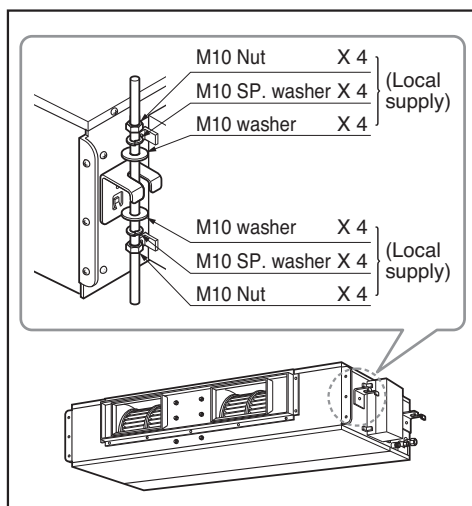

- Select and mark the position for fixing bolts.
- Drill the hole for set anchor on the face of ceiling.

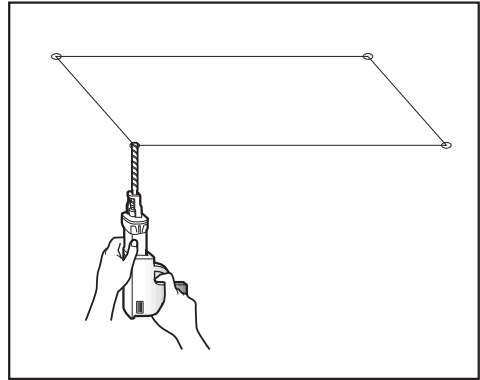

- Insert the set anchor and washer onto the suspension bolts for locking the suspension bolts on the ceiling.
- Mount the suspension bolts to the set anchor firmly.
- Secure the installation plates onto the suspension bolts (adjust level roughly) using nuts, washers and spring washers.



**CAUTION:** Tighten the nut and bolt top prevent unit falling.

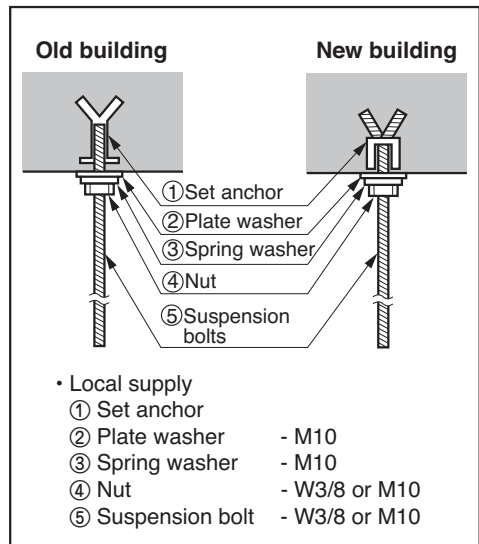

**CAUTION**

1. **Install declination** of the indoor unit is very **important for the drain** of the duct type air conditioner.
2. Minimum thickness of the insulation for the connecting pipe shall be 5mm.

**Front of view**

- The unit must be declined to the drain hose connected when finished installation.

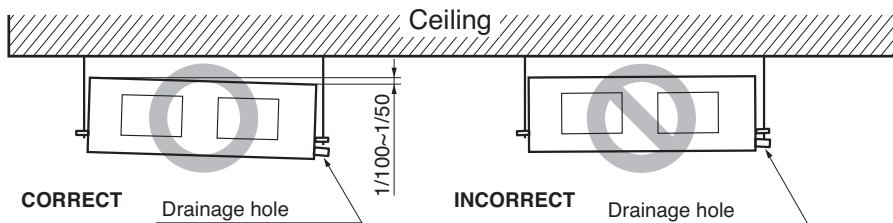

**CAUTION FOR GRADIENT OF UNIT AND DRAIN PIPING**

Lay the drain hose with a downward inclination so water will drain out.

- Always lay the drain with downward inclination (1/100 to 1/50). Prevent any upward flow or reverse flow in any part.
- 10mm or thicker formed thermal insulator shall always be provided for the drain pipe.

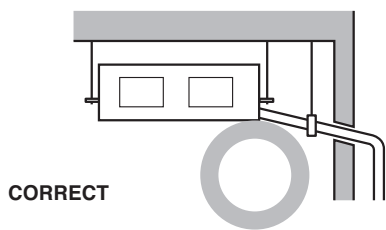
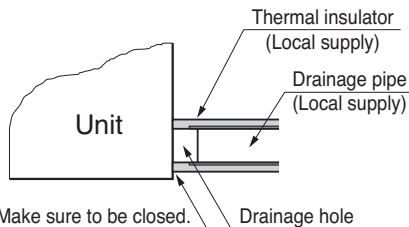

- Upward routing not allowed

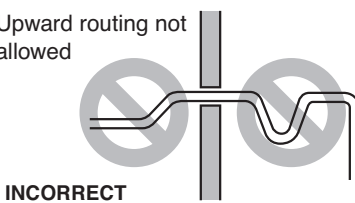

**Applied U-Trap Dimension**

- A ≥ 70mm
- B ≥ 2C
- C ≥ 2 x SP
- SP = External Pressure (mmAq)
- Ex) External Pressure = 10mmAq
- A ≥ 70mm
- B ≥ 40mm
- C ≥ 20mm

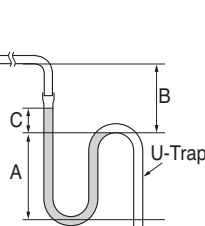

- Install the P-Trap (or U-Trap) to prevent a water leakage caused by the blocking of intake air filter.

## Indoor Unit Drain Piping

- Drain piping must have down-slope (1/50 to 1/100): be sure not to provide up-and-down slope to prevent reversal flow.
- During drain piping connection, be careful not to exert extra force on the drain port on the indoor unit.
- The outside diameter of the drain connection on the indoor unit is 32mm.

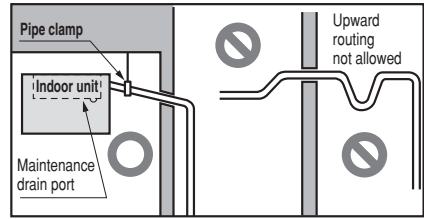

Piping material: Polyvinyl chloride pipe VP-25 and pipe fittings

- Be sure to execute heat insulation on the drain piping.
- Install the drain raising pipes at a right angle to the indoor unit and no more than 300mm from the unit.

Heat insulation material: Polyethylene foam with thickness more than 8 mm.

## Drain test

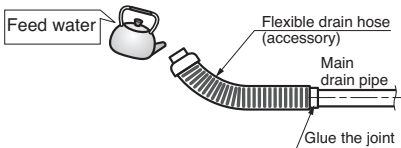

- Connect the main drain pipe to the exterior and leave it provisionally until the test comes to an end.
- Feed water to the flexible drain hose and check the piping for leakage.
- When the test is complete, connect the flexible drain hose to the drain port on the indoor unit.

1) Remove the Air Filter.

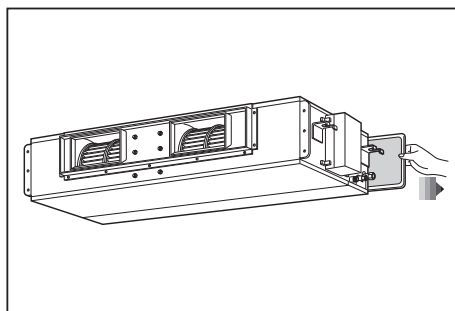

2) Check the drainage.

- Spray one or two glasses of water upon the evaporator.
- Ensure that water flows drain hose of indoor unit without any leakage.

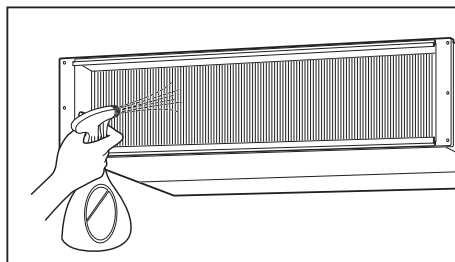

## Heat insulation

1. Use the heat insulation material for the refrigerant piping which has an excellent heat-resistance (over 120°C).

2. Precautions in high humidity circumstance:

This air conditioner has been tested according to the "KS Standard Conditions with Mist" and confirmed that there is not any default. However, if it is operated for a long time in high humid atmosphere (dew point temperature: more than 23°C), water drops are liable to fall. In this case, add heat insulation material according to the following procedure:

- Heat insulation material to be prepared...  
Adiabatic glass wool with thickness 10 to 20mm.
- Stick glass wool on all air conditioners that are located in ceiling atmosphere.

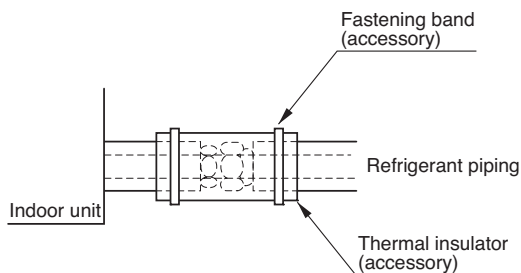

## Wiring Connection

- Open the control box cover and connect the Remote controller cord and Indoor power wires.
- Remove the control box cover for electrical connection between the indoor and outdoor unit.  
(Remove screws ①.)
- Use the cord clumper to fix the cord.

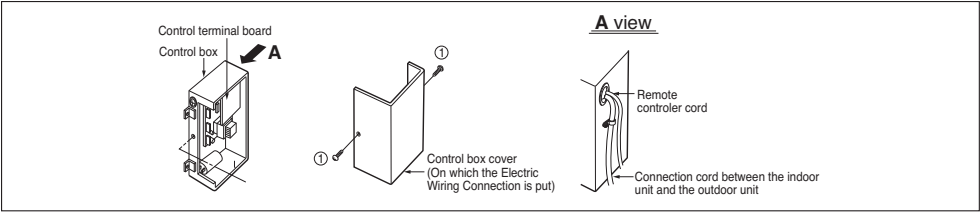

### CAUTION

The connecting cable connected to the indoor and outdoor unit should be complied with the following specifications (Rubber insulation, type H05RN-F approved by HAR or SAA).

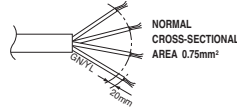

If the supply cord is damaged, it must be replaced by a special cord or assembly available from the manufacturer of its service agent. When the connection line between the indoor unit and outdoor unit and outdoor unit is over 40m, connect the telecommunication line and power line separately.

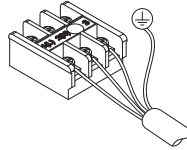

### ◆ Precautions when laying power wiring

Use round pressure terminals for connections to the power terminal block.

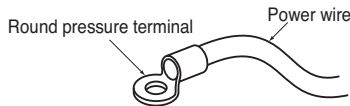

When none are available, follow the instructions below.

- Do not connect wiring of different thicknesses to the power terminal block. (Slack in the power wiring may cause abnormal heat.)
- When connecting wiring which is the same thickness, do as shown in the figure below.

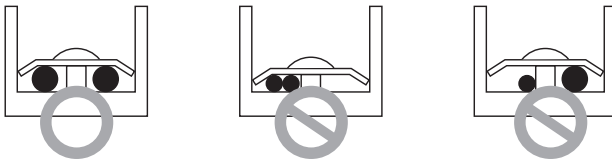

- For wiring, use the designated power wire and connect firmly, then secure to prevent outside pressure being exerted on the terminal block.
- Use an appropriate screwdriver for tightening the terminal screws. A screwdriver with a small head will strip the head and make proper tightening impossible.
- Over-tightening the terminal screws may break them.

# Installation instruction

**1. Please fix tightly using provided screw after placing remote controller setup board on the place where you like to setup.**

- Please set it up not to bend because poor setup could take place if setup board bends.  
Please set up remote controller board fit to the reclamation box if there is a reclamation box.

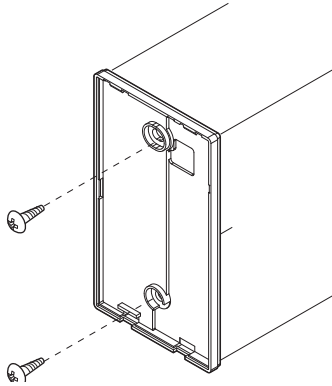

**2. Can set up Wired remote controller cable into three directions.**

- Setup direction: the surface of wall reclamation, upper, right
- If setting up remote controller cable into upper and right side, please set up after removing remote controller cable guide groove.

\* Remove guide groove with long nose.

- ① Reclamation to the surface of the wall
- ② Upper part guide groove
- ③ Right part guide groove

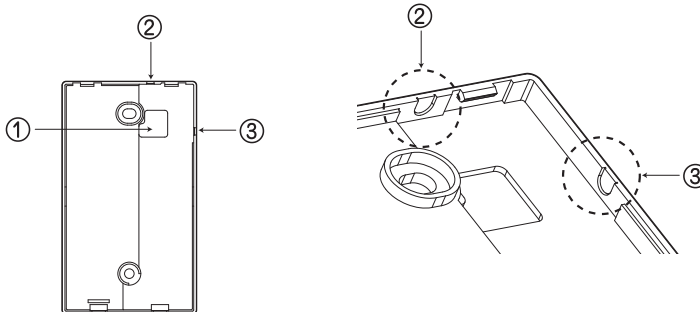

<Wire guide grooves>

**3. Please fix remote controller upper part into the backplate attached to the surface of the wall, as the picture below, and then, connect with backplate by pressing lower part.**

- Please make sure to leave no gaps on the top, bottom, left or right sides between the remote controller and backplate.
- Before assembly with the backplate, arrange the Cable not to interfere with circuit parts.

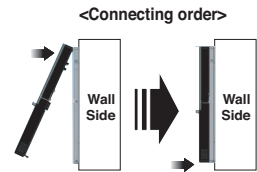

**Remove remote controller by inserting a screwdriver into the lower separating holes and twisting to release the controller from backplate.**

- There are two separating holes. Please individually separate one at a time.
- Please be careful not to damage the inside components when separating.

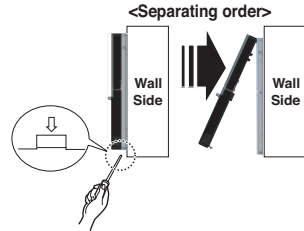

**4. Please refer to the following directions when connecting the indoor unit and the wired remote controller together.**

- 1) Please connect the cables as shown in the figure below when connecting the plug type cable from the indoor unit's C/BOX and the housing type of the extension cable.

Signal	Yellow
12V	Red
GND	Black

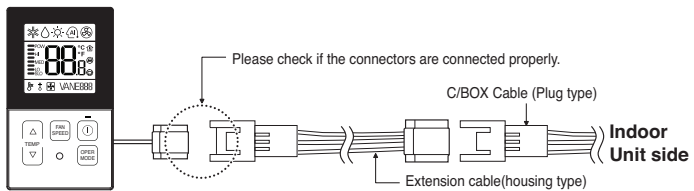

**CAUTION**

- Specification of LG supplied extension cable: AWG#22, 3 core shielded. (Model : PZCWRC1)
- \* Apply enclosed noncombustible conduit(metal raceway) totally or use FT-6 rated cable or above level in case of local electric & building code that requires plenum (CMP) cable usage.

- 2) When connecting Terminal Blocks of the indoor C/BOX and the wired remote controller with the extension cable, refer to the steps below.

- ① Remove the screw on the cable which is fastened to the wired remote controller's Terminal Block by loosening with a screw driver.
- ② Remove the housing of the provided 32ft extension cable with a cutting nipper and peel it as shown in the figure below. (when purchasing the extension cable at the site directly, please peel it as shown in the figure below.)

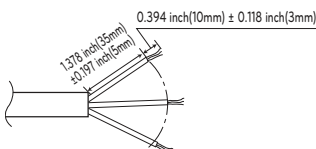

- ③ Make sure each wire is securely fastened under each screw terminal and the wires are not in contact with each other.
- ④ Please connect the Terminal blocks of indoor unit's C/BOX and wired remote controller by referring to the images and contents shown below.  
 Connect the yellow(signal) part of the wired remote controller's terminal block and the 'YL' part of the indoor unit's terminal block.  
 Connect the red(12V) part of the wired remote controller's terminal block and the 'RD' part of the indoor unit's terminal block.  
 Connect the black(GND) part of the wired remote controller's terminal block and the 'BK' part of the indoor unit's terminal block.

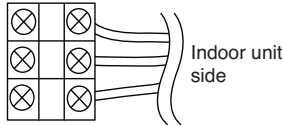
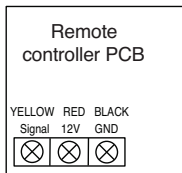

Remote controller PCB Terminal block Remark	Indoor Terminal block	Function
YELLOW	YL	Signal
RED	RD	12V
BLACK	BK	GND

<Remote controller>    <Indoor Terminal Block>

- \* In case of loosened screws or insufficient contact between the terminal and the wire, remote controller may not function properly.
- \* When the power is off on the remote controller, check the connection between the remote controller and Terminal Block.
- \* Use an appropriate screwdriver for tightening the terminal screws. A screwdriver with a small head will strip the head and make proper tightening impossible.
- \* Over-tightening the terminal screws may break wires and terminal block structure.

**CAUTION**

- Installation work must be performed in accordance with the national wiring standards and local by authorized personnel only.
- Installations must comply with the applicable local/national or international standards.
- AWG#22, 3 core shielded is recommended when using the large hole in the center of the back plate.
- AWG#24, 3 core shielded is recommended when using the side or top knock-out of the back plate.

**5. Please use an extension cable if the distance between the wired remote controller and the indoor unit is longer than 32ft(10m).**

**CAUTION**

- When installing the wired remote controller, do not bury it in the wall.  
 (It can cause damage in the temperature sensor.)  
 Do not install the cable to be 164ft(50m) or longer. (It can cause communication error.)

## Remote controller installation

Since the room temperature sensor is in the remote controller, the remote controller box should be installed in a place away from direct sunlight, high humidity and direct supply of cold air to maintain proper space temperature. Install the remote controller about 5ft(1.5m) above the floor in an area with good air circulation at an average temperature.

### Do not install the remote controller where it can be affected by:

- Drafts, or dead spots behind doors and in corners.
- Hot or cold air from ducts.
- Radiant heat from sun or appliances.
- Concealed pipes and chimneys.
- Uncontrolled areas such as an outside wall behind the remote controller.
- This remote controller is equipped with LCD display. For proper display of the remote controller LCD's, the remote controller should be installed properly as shown in Fig.1.  
(The standard height is 4~5 ft (1.2~1.5 m) from floor level.)

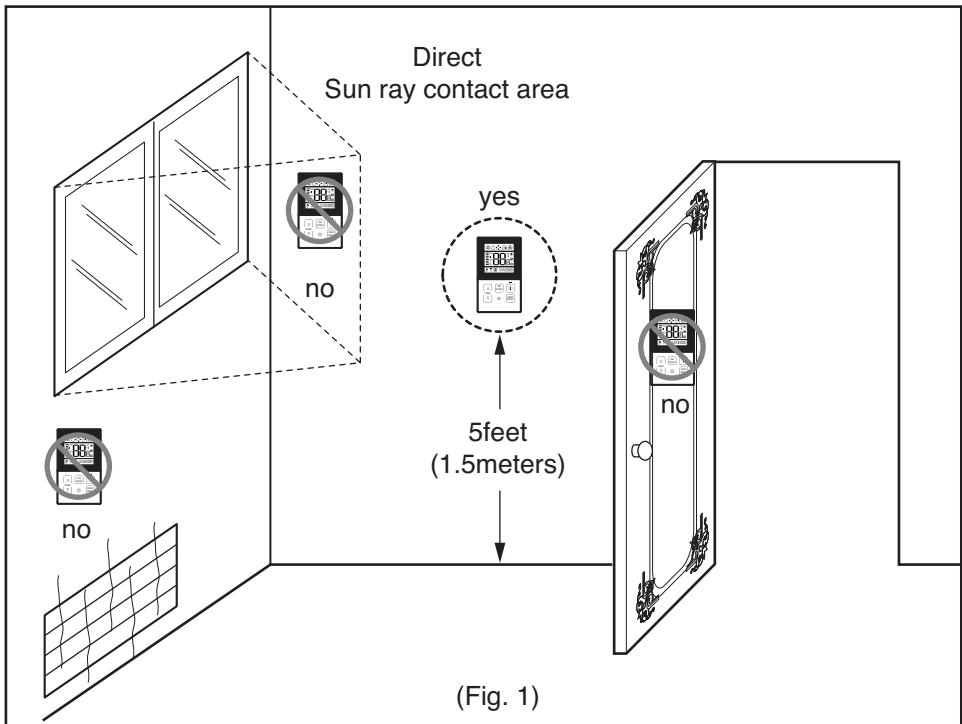

# Group control

## 1. When installing more than 2 units of air conditioner to one wired remote controller, please connect as the right figure.

- If it is not event communication indoor unit, set the unit as slave.
- Check for event communication through the product manual.

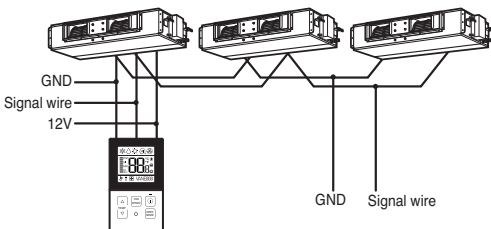

When controlling multiple indoor units with event communication function with one remote controller, you must change the master/slave setting from the indoor unit.

Indoor units, the master/slave configuration of the product after completion of indoor unit power 'OFF' and then 'ON' the power after 1 minutes elapsed sign up.

- For ceiling type cassette and duct product group, change the switch setting of the indoor PCB.



#3 switch OFF: Master  
(Factory default setting)



#3 switch ON: Slave

- For wall-mount type and stand type product, change the master/slave setting with the wireless remote controller. (Refer to wireless remote controller manual for detail)

※ When installing 2 remote controllers to one indoor unit with event communication function, set the master/slave of the remote controller. (Refer to remote controller master/slave selection)

When controlling the group, some functions excluding basic operation setting, fan level Min/Mid/Max, remote controller lock setting and time setting may be limited.

## 2. When installing more than 2 wired remote controllers to one air conditioner, please connect as the right picture.

- When installing more than 2 units of wired remote controller to one air conditioner, set one wired remote controller as master and the others all as slaves, as shown in the right picture.
- You cannot control the group as shown in the right for some products.
- Refer to the product manual for more detail.

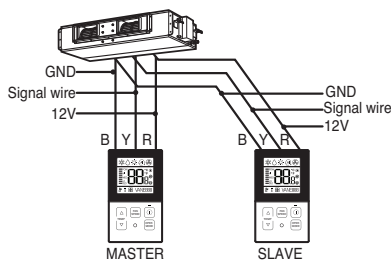

<When simultaneously connecting 2 sets of wired remote controller>

- When controlling in groups, set the master/slave of the remote controller. Refer to Installer setting section on how to set master/slave for more detail.

# Installer Setting - How to enter installer setting mode

## CAUTION

Installer setting mode is to set the detail function of the remote controller. If the installer setting mode is not set correctly, it can cause problems to the product, user injury or property damage. This must be set by a certificated installer, and any installation or change that is carried out by a non-certificated person should be responsible for the results. In this case, free service cannot be provided.

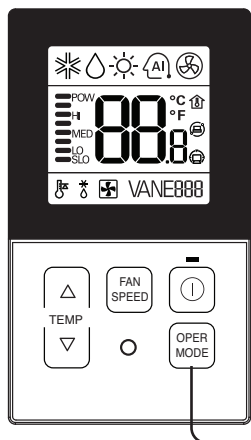

- 1 If you want to set installer setting mode, press the temperature up button and the oper mode button same time for five seconds.
- 2 When you enter the setting mode initially. Function code is displayed on the LCD screen.

### <Installer Setting Code Table>

#### 1) General air-conditioner product

No.	Function	Code	Value																		
1	Test Run	01	01:Set																		
2	Address Setting	02	00~FF : Address																		
3	E.S.P. Value	03	<table border="0"> <tr> <td>&lt;ESP Step&gt;</td> <td>&lt;ESP Value&gt;</td> <td>&lt;Example&gt;</td> </tr> <tr> <td>01:VeryLow</td> <td>0 ~ 255</td> <td>0301 000</td> </tr> <tr> <td>02:Low</td> <td></td> <td>Function Code ESP step ESP value</td> </tr> <tr> <td>03:Med</td> <td></td> <td></td> </tr> <tr> <td>04:High</td> <td></td> <td></td> </tr> <tr> <td>05:Very High</td> <td></td> <td></td> </tr> </table>	<ESP Step>	<ESP Value>	<Example>	01:VeryLow	0 ~ 255	0301 000	02:Low		Function Code ESP step ESP value	03:Med			04:High			05:Very High		
<ESP Step>	<ESP Value>	<Example>																			
01:VeryLow	0 ~ 255	0301 000																			
02:Low		Function Code ESP step ESP value																			
03:Med																					
04:High																					
05:Very High																					
4	Thermistor	04	01:Remo 02:Indoor 03:2TH																		
5	Ceiling Height	05	01:Med 02:Low 03:High 04:Very High																		
6	Static Pressure	06	01:V-H 02:F-H 03:V-L 04:F-L																		
7	Master Setting	07	00:Slave 01:Master																		
8	Celsius Fahrenheit Switching	12	00:Celsius 01:Fahrenheit (Optimized only for U.S.A)																		
9	Static Pressure Step	32	00: use static pressure (code 06) set value 01~ 11: static pressure step (code 32) set value																		

\* Some contents may not be displayed depending on the product function

## Installer Setting - Test Run Mode

After installing the product, you must run a Test Run mode.

For details related to this operation, refer to the product manual.

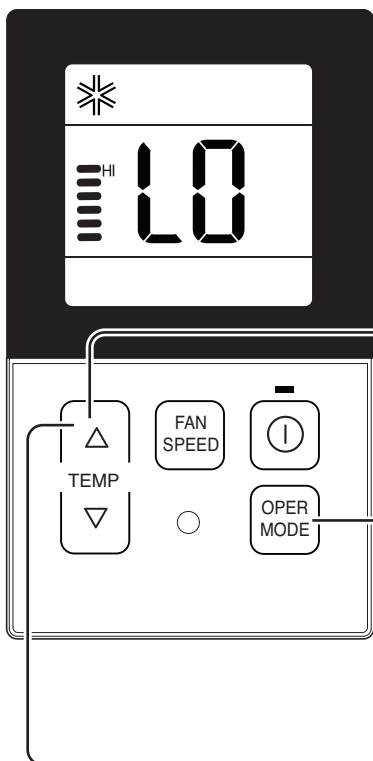

- 1** When pressing the button and button simultaneously for more than 3 seconds, the system will be entered into the installer setting mode.  
- After entering into the installer setting mode, select the test run mode code value by pressing the button.  
\* Test run mode code value : 01
- 2** When pressing the button, the test operation mode will be performed, and it is displayed as shown in the left figure.
- 3** When pressing the button and button simultaneously for more than 3 seconds after the setting has been completed, the setting mode will be released.  
- If there isn't any button input for more than 25 seconds, the installer setting mode will also be released.
- 4** When approx. 18 minutes are elapsed after starting of the test oper-mode, the system will be stopped automatically and converted to the standby state.  
- If any button is inputted during the test run mode, the test run mode will be forced to be released.

- What is the test run mode??

- This means the operation of the product under the cooling, strong wind, and Comp on state without performing room temperature control in order to confirm the installed state during the product installation.







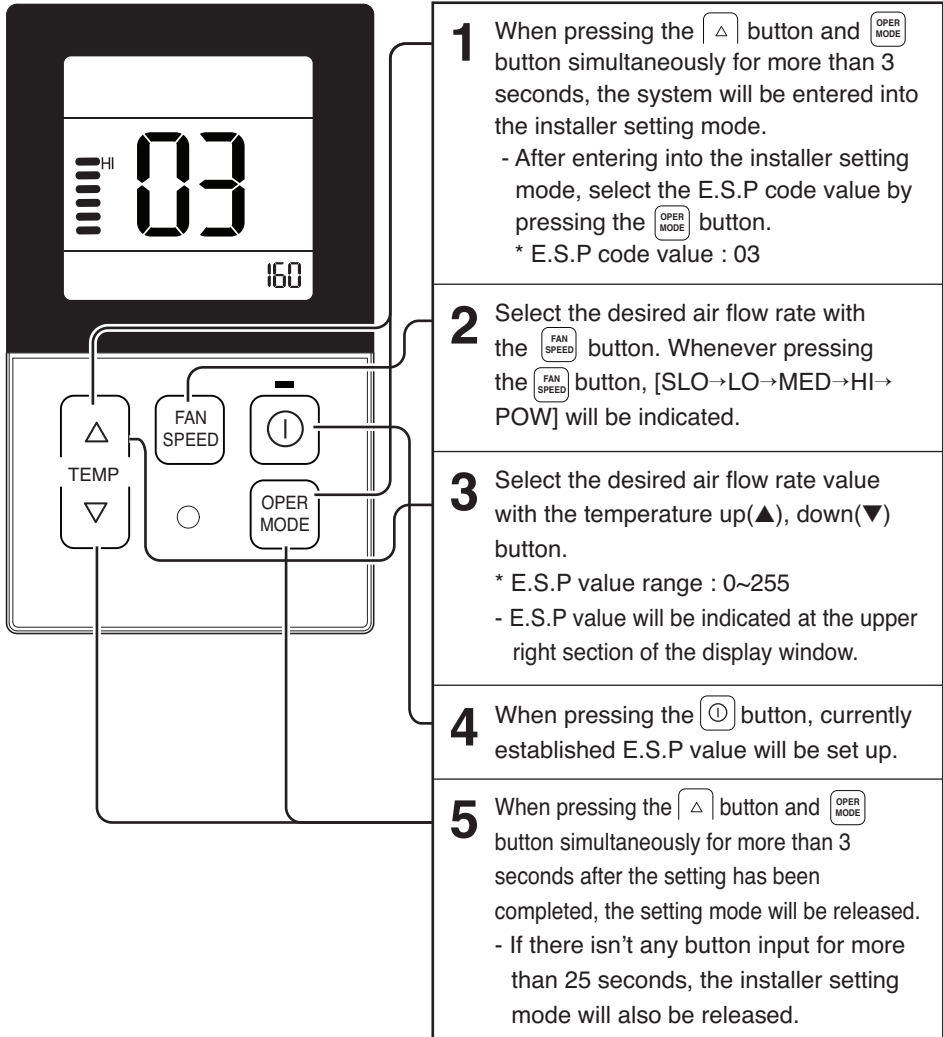



## Installer Setting - E.S.P.

This is the function that decides the strength of the wind for each wind level and because this function is to make the installation easier.

- If you set ESP incorrectly, the air conditioner may malfunction.
- This setting must be carried out by a certificated-technician.



The diagram shows a remote control with a digital display showing '03' and '160'. Below the display are several buttons: 'TEMP' (up/down arrows), 'FAN SPEED' (a fan icon), 'OPER MODE' (a power icon), and a 'HI' indicator. Lines connect the buttons to the numbered steps in the adjacent text box.

- 1 When pressing the  button and  button simultaneously for more than 3 seconds, the system will be entered into the installer setting mode.
  - After entering into the installer setting mode, select the E.S.P. code value by pressing the  button.
  - \* E.S.P. code value : 03
- 2 Select the desired air flow rate with the  button. Whenever pressing the  button, [SLO→LO→MED→HI→POW] will be indicated.
- 3 Select the desired air flow rate value with the temperature up() , down() button.
  - \* E.S.P. value range : 0~255
  - E.S.P. value will be indicated at the upper right section of the display window.
- 4 When pressing the  button, currently established E.S.P. value will be set up.
- 5 When pressing the  button and  button simultaneously for more than 3 seconds after the setting has been completed, the setting mode will be released.
  - If there isn't any button input for more than 25 seconds, the installer setting mode will also be released.

- Precaution shall be taken not to alter the E.S.P. value corresponded to each air flow section.
- E.S.P. value can be varied according to the products.
- In the case of going to the next air flow rate stage by pressing the fan-speed button during the setup of the E.S.P. value, the E.S.P. value of previous air flow rate will be maintained by remembering the E.S.P. value prior to the shift.

## Installer Setting - Thermistor

This is the function to select the temperature sensor to judge the room temperature.

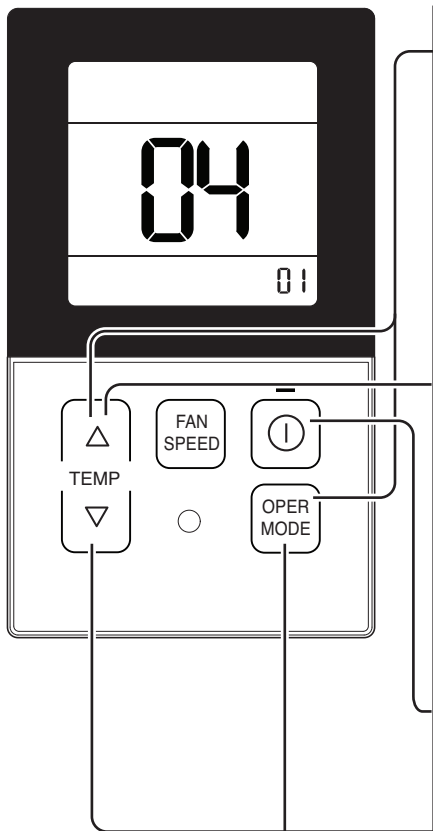

**1** When pressing the button and button simultaneously for more than 3 seconds, the system will be entered into the installer setting mode.

- After entering into the installer setting mode, select the thermistor sensor setting code value by pressing the button.

\* Thermistor sensor selection code value : 04

**2** Select the desired setting value with the temperature up() , down() button.

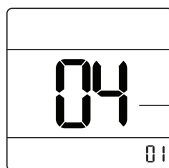

Code value

Value

\*Setting value  
01: Remote controller  
02: Indoor unit  
03: 2TH

**3** When pressing the button, currently established thermistor sensor location will be set up.

**4** When pressing the button and button simultaneously for more than 3 seconds after the setting has been completed, the setting mode will be released.

- If there isn't any button input for more than 25 seconds, the installer setting mode will also be released.

• As the characteristic of the '2TH' function can be different in accordance with the products, refer to the product instruction manual for its detail.

## Installer Setting - Static Pressure Setting

This function is applied to only duct type. Setting this in other cases will cause malfunction.

**1** When pressing the button and button simultaneously for more than 3 seconds, the system will be entered into the installer setting mode.

- After entering into the installer setting mode, select the static pressure setting code value by pressing the button.
- \* Static pressure setting code value : 06

**2** Select the desired setting value with the temperature up() , down() button.

\*Setting value  
01:V-H  
02:F-H  
03:V-L  
04:F-L

Code value  
Value

**3** When pressing button, currently established static pressure value will be set up.

**4** When pressing the button and button simultaneously for more than 3 seconds after the setting has been completed, the setting mode will be released.

- If there isn't any button input for more than 25 seconds, the installer setting mode will also be released.

### <Static Pressure Setting Table>

Pressure selection		Function	
		Zone state	ESP standard value
01	V-H	Variable	High
02	F-H	Fixed	High
03	V-L	Variable	Low
04	F-L	Fixed	Low

## Installer Setting - Remote Controller Master/Slave Setup

It is a function for settings in group control, or 2-remote controller control.

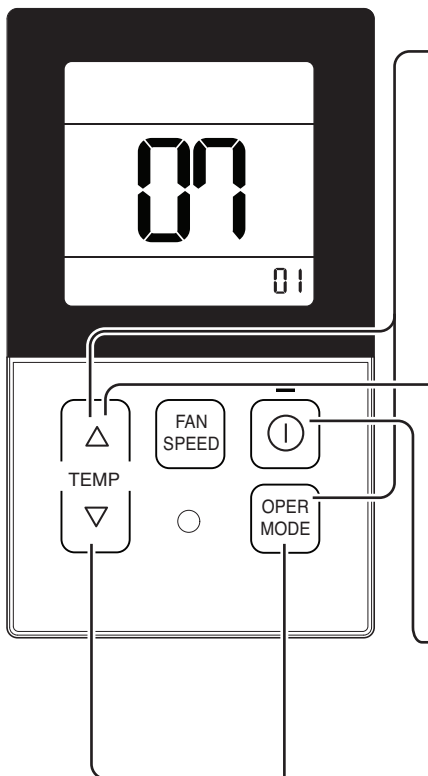

**1** When pressing the button and button simultaneously for more than 3 seconds, the system will be entered into the installer setting mode.  
 - After entering into the installer setting mode, select the remote controller master / slave setting code value by pressing the button.  
 \* Remote controller master/slave setting code value : 07

**2** Select the desired setting value with the temperature up(), down() button.

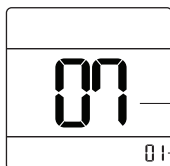

\*Setting value  
 00:Slave  
 01:Master

Code value

Value

**3** When pressing the button, currently established static pressure value will be set up.

**4** When pressing the button and button simultaneously for more than 3 seconds after the setting has been completed, the setting mode will be released.  
 - If there isn't any button input for more than 25 seconds, the installer setting mode will also be released.

Remote controller	Function
Master	Indoor unit operates based on master remote controller at group control. (Master is set when delivering from the warehouse.)
Slave	Setup all remote controllers except one master remote controller to slave at group control

\* Refer to the 'group control' part for details

- When controlling in groups, basic operation settings, airflow strength weak/medium/strong, lock setting of the remote controller, time settings, and other functions may be restricted.

## Installer Setting - Celsius / Fahrenheit Switching

This function is used for switching the display between Celsius and Fahrenheit.  
(Optimized only for U.S.A)

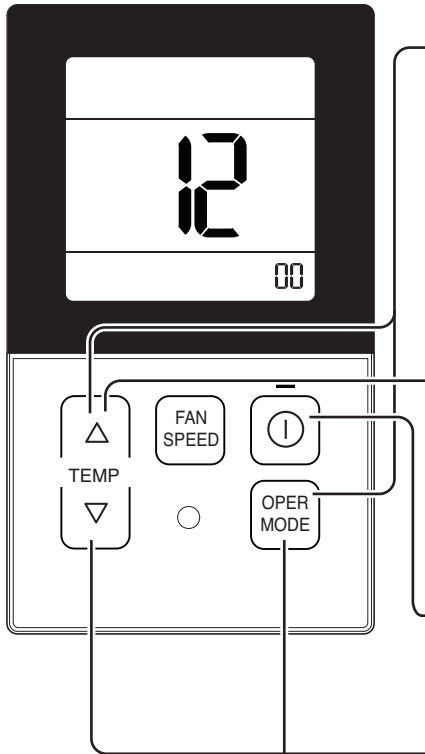

**1** When pressing the button and button simultaneously for more than 3 seconds, the system will be entered into the installer setting mode.  
- After entering into the installer setting mode, select the Celsius / Fahrenheit setting code value by pressing the button.  
\* Celsius/Fahrenheit setting code value : 12

**2** Select the desired setting value with the temperature up() , down() button.

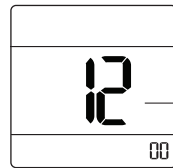

\*Setting value  
00:Celsius  
01:Fahrenheit

**3** When pressing button, currently established celsius/Fahrenheit setting value will be set up.

**4** When pressing the button and button simultaneously for more than 3 seconds after the setting has been completed, the setting mode will be released.  
- If there isn't any button input for more than 25 seconds, the installer setting mode will also be released.

• Whenever press temp up() , down() button in Fahrenheit mode, the temperature will increase/drop 2 degrees.

*Installation instruction*

Capacity	Step	C.M.M	Static Pressure(mmAq)					
			2.5	4	5	6	8	10
			Setting Value					
18k	HIGH	13.5	102	112	119	125	-	-
	MID	12	96	106	114	119	-	-
	LOW	10.5	90	102	108	114	-	-
24k	HIGH	18	121	131	137	142	-	-
	MID	16.5	115	125	130	135	-	-
	LOW	14	106	116	121	125	-	-

# Self-diagnosis Function

## Indoor Unit Error

Ex) Error 03 (Remote controller error)

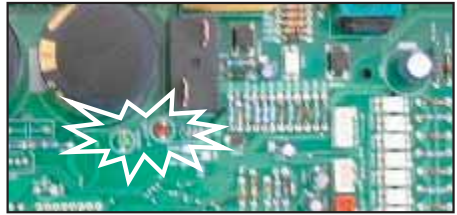
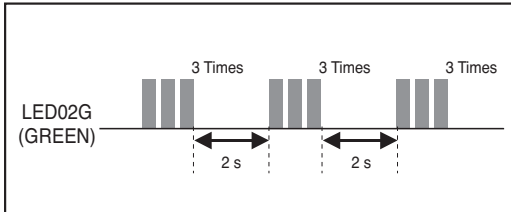

Error Code	Description	LED 1 (Red)	LED 2 (Green)	Indoor status
01	Indoor Room sensor error	0	1time ●	OFF
02	Indoor in-pipe sensor error	0	2times ●	OFF
03	Remote controller error	0	3times ●	OFF
04	Drain pump error	0	4times ●	OFF
05	Communication error indoor and outdoor	0	5times ●	OFF
06	Indoor out-pipe sensor error	0	6times ●	OFF
09	EEPROM error (indoor)	0	9times ●	OFF
10	BLDC motor fan lock (indoor)	1time ●	0	OFF

\* Because remote controller turn off when occur ERROR in simultaneous operation system, it should check LED blinks of outdoor in order to confirm error code.

\* Repeatedly after LED1 is turned on and off as the Error code number of tens digit, LED2 is turned on and off as the Error code number of single-digit.

## Dip Switch Setting

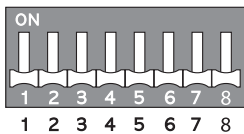

Function	Description	Setting Off	Setting On	Default	
SW3	Group Control	Selection of Master or Slave	Master	Slave	Off
SW4	Dry Contact Mode	Selection of Dry Contact Mode	Wired/Wireless remote controller Selection of Manual or Auto operation Mode	Auto	Off
SW5	Installation	Fan continuous operation	Continuous operation Removal	Working	Off

---

