

OWNER'S MANUAL

Safety and Reference

Wall Mount Bracket

Please read this manual carefully before operating your set and retain it for future reference.

WB21LGB



https://youtu.be/5D0kRyc_BSQ



Accessories

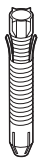

Wall mount fixing
anchors
8 pcs.



TV fixing screws
4 pcs.

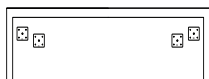

Guide paper

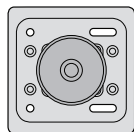

Wall Mount Support
2 pcs.

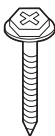

Wall mount fixing
screws
8 pcs.



TV protection cushion
2 pcs.

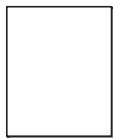

Installation Manual

Precautions for Safety

- Professional installers should read this manual carefully to ensure proper installation.
- Professional installers should forward this manual to customers after installation and encourage them to read and store it in a convenient place for future reference.

After reading the installation manual, keep it in a convenient place for future reference.

Warning

Ask a professional installer appointed by the store for installation of the product.

Installation by someone other than a professional installer is extremely dangerous and may result in personal injury.

Contact a professional installer appointed by the store prior to moving or replacing the product after installation.

Installation is a technical task and safety issues may arise if an individual attempts to install or move the product personally.

When installing the product on a wall, do not hang the power line or signal cables from the back of the TV.

This can damage the cords, resulting in a fire, electrical shock or malfunction of the product.

Do not install the product in an unstable site that cannot withstand its weight.

If the installation site lacks sufficient rigidity, the product may fall and cause personal injury.

Do not hang on the product or subject it to severe impact after installation.

Doing so may cause the product to fall and cause personal injury.

Caution

Install the product according to the instructions in the installation manual.

Failure to install the product according to the instructions in the installation manual can result in serious personal injury or product damage.

Be sure to have at least four people when installing the product or adjusting the product's height.

Attempting to perform installation or adjustments personally may result in personal injury or damage to the product.

Make sure a wall is available prior to proceeding with installation. Make use of the anchors and screws provided with the product.

Use of any unauthorized anchors or screws may not support the product's weight, which poses safety risks.

When drilling in the wall for installation, be sure to use drill bits and drills of the specified diameter. Follow the instructions for the hole depth.

Drilling and installing the product in ways other than specified in the installation manual may result in an unstable installation and potential safety issues.

Do not wipe the product with a wet towel or use any heating equipment or humidifier under the place where the product is installed.

Liquid water or vapor may enter the product and excessive heat may cause fire, electric shock, or malfunction.

Do not install the product near a fire sprinkler or detector, a place where vibration or shock may occur or near a high-voltage wire or power source.

Unplug the product's power cord from the wall outlet before installing.

Installing the product while the power cord is plugged in may result in electric shock or fire.

Do not install the product with bare hands. Be sure to wear work gloves.

Attempting installation without work gloves may cause personal injury.

Connect the product with the supplied cable. Use of an unauthorized cable may result in damage by friction with the wall. Make sure to use the supplied cable gender. (This may vary by model.)

Before Installation

- Do not use the product for any purpose other than installing the TV on a wall.
- Avoid product damage and safety accidents caused by careless installing or use of improper or unauthorized wall mount.
- Follow the instructions in the installation manual for a convenient installation of the wall mount.
- Immediately discontinue installation and contact the service center if you cannot fully understand the installation process.
Use a professional installer if any installation issues remain after the inquiry.
- Installation of this product on a concrete wall or wood stud is recommended. Installation on walls made of other types of plasterboard, plywood, brick, etc., is not recommended since there is a greater chance the product will fall.

- When installing the Full Contact Wall Mount, the TV may not be contacted firmly against the wall due to some wall conditions.
- Install the product only on a vertical wall.
Do not install on a tilted wall that exceeds building standards or on the heavily tilted wall or ceiling.
LG is not responsible for problems caused by improper installation of the product, e.g., heavily tilted walls and ceilings.
- Check the enclosed accessories before installation.
We are not responsible for any lost or damaged accessories after the inner packaging is opened.
- When an infant or small child swallows the enclosed accessories, various safety accidents such as choking may occur. Keep the enclosed accessories out of the reach of infants and children.
- When tightening screws, tighten until fully snug.
Avoid using excessive force when tightening the screws. Doing so may damage the wall and product or reduce the rigidity or performance of the product.
- Avoid installing a TV that exceeds the specified tensile load, and do not allow any external force to be applied to the product.
- Avoid accidents by using work tools with care during installation.
- After installing the product, ensure its use in close contact with a wall.
If the product is not positioned against a wall, the product may be unstable or damaged.

Tools for Installation

- "+" shaped screwdriver (manual or electric)
- level
- drill
- Ø 8 mm drill bit for concrete or Ø 4 mm drill bit for steel

How to install

- The appearance of tools may differ from the enclosed images.
- Always consult a professional when installing a wall mount.

1. Wearing gloves

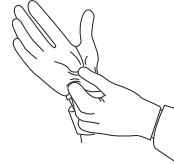

2. Attaching the guide paper to the wall

Attach the guide paper to the wall when determining the TV's installation site.

- Ensure the guide paper is level when attaching it to the wall.
- Attach it by referring to the outer line of the TV and the location of the TV center.

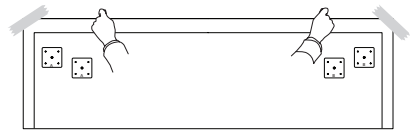

3. Fastening Anchors and Screws

- Check that the material and thickness of the wall and finishing material comply with the installation manual. Before beginning the mounting process, you must be sure the wall is able to support the weight of the TV.
- Should use the enclosed anchors and screws on crack free concrete walls.
- If the wall is not made of concrete, the wall mount must be installed on a rigid support. Never install the product on a plasterboard or wall made of paper or medium-density fiberboard (MDF). In this case, make sure that the wall material can withstand the weight of the TV, and fix the anchor screws to the retaining wall (concrete) or wooden support behind the finishing material. Since the anchors provided with this product may not be suitable for your wall material, be sure to check with a professional before attempting installation.
- Other unspecified walls must be capable of supporting pullout loads of over 70 kgf (686 N) and shear loads of over 100 kgf (980 N) per fastener.
- Use an \varnothing 8 mm drill bit for concrete and a hammer (impact) drill or \varnothing 4 mm drill bit for wood stud to drill holes.

For installation on concrete wall

1. Drill holes in anchor locations with a drill bit of \varnothing 8 mm to a depth of 80 mm to 100 mm.

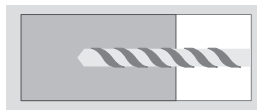

2. Clean the drilled holes.

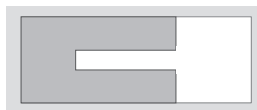

3. Insert the enclosed anchors for fixing the wall mount into the holes. (Use a hammer when inserting anchors.)

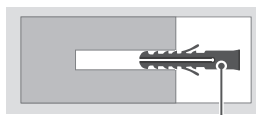

Anchors for fixing the wall mount

4. Push the wall mount support closely toward the wall to match the hole locations.

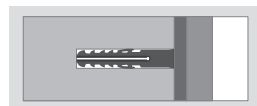

5. Tighten screws for fixing the wall mount to the holes. At this time, tighten the screws with the torque more than 45 kgf/cm to 60 kgf/cm.

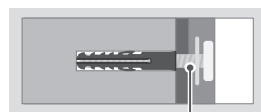

Screws for fixing the wall mount

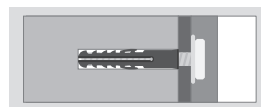

For installation on wood stud

Use the Ø 4 mm drill bit for wood to drill holes with the depth of 76 mm. (Clean the drilled hole.)

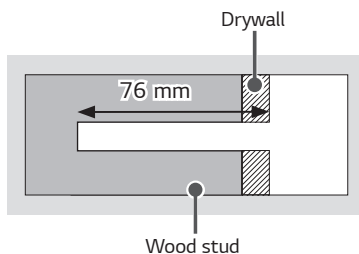

Without using the wall mounting anchor, fasten the wall mounting screw directly to the wood stud.

4. Installing the Wall Mount Support

- Refer to the following picture to fix the wall mount support.
- Use a level to verify that the wall mount is positioned horizontally.
- Fix the two screws for fixing the wall mount in this order: upper left and right sides followed by the lower left and right sides.
- Use a Phillips screwdriver (manual or powered) to tighten the screws so that the wall mount support is firmly fixed to the wall surface.

1. Install the wall mount support at the location marked on the guide paper.

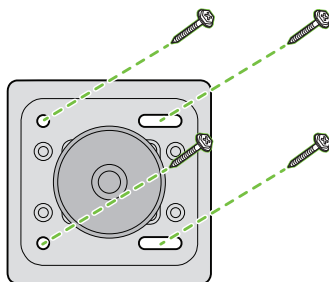
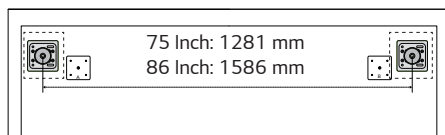

2. Make sure that the fixing screws for the wall mount support are firmly pressed against the support.
 - Caution: Any protruding screw can cause the installation to fail.

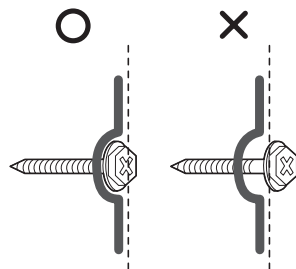

3. Remove the guide paper.

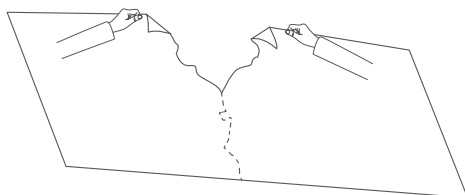

5. Attaching the TV to the Wall Support

- Remove the cover where the wall mount will be fastened.
 - Use the enclosed TV fixing screws to fasten the TV and the wall mount support.
 - Be sure to install the TV so that the holes on the TV where the wall mounting will be installed and the holes on the wall mounting are aligned.
1. Lay the TV down and remove the cover of the part where the wall mount will be fastened (it may differ by model).

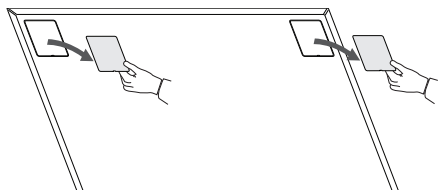

2. Behind the TV, place the wall mount support marked "B" on the left, and "A" on the right.

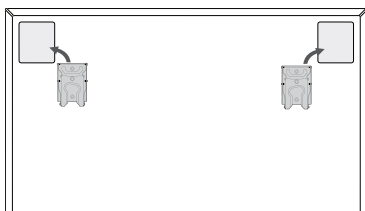

3. Fasten the TV to the support using the TV fixing screws.
 - Warning: When mounting the product, do not use screws alone without the wall mount. (It may cause screen damage.)
 - Warning: Only use the screws provided with the product. (It may cause screen damage.)

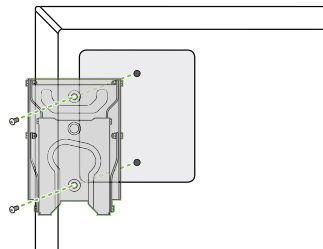

4. On the back, attach the protective cushions on the bottom left and right side.

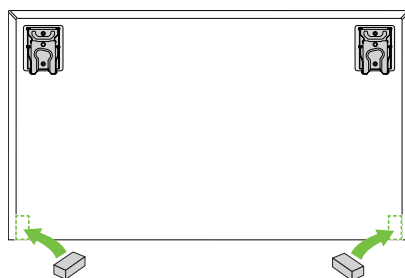

5. Once the wall mount and cushions are attached to the TV, install it on the wall with wall support attached.
- Caution: Ensure two or more people work together when mounting the TV. (If the product is lifted by one person, it may fall and result in injury or damage.)

Be careful not to trap the power cord between the wall mount bracket and the TV when mounting the TV. (If the power cord becomes trapped, it may result in product damage.)

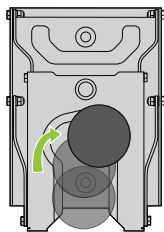
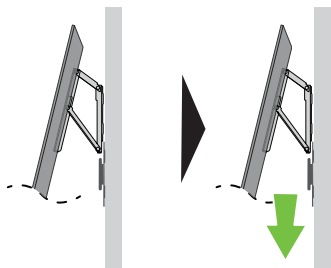
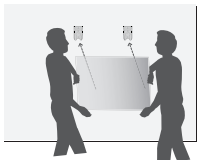

6. Push the TV close to the wall.

- Be sure to gently push the upper and lower parts of the TV so that the pushing doesn't affect the TV.
- Gently push the upper center of the TV once again until it's completely pressed against the wall.
- Caution: Do not apply excessive force to the screen. (Doing so can damage the screen.)

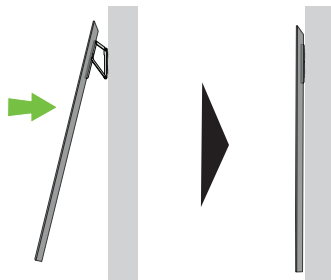

7. Adjust the product's position by hand so it's horizontal.

- Adjust it in the desired direction by pushing the sides of the TV.

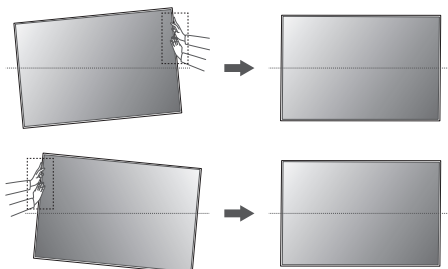

6. Plugging Additional Cables in While Using the TV

1. Pull the TV forward.
 - Gently pull the lower part of the TV so that it does not affect the product and then check the location where the cable will be connected.

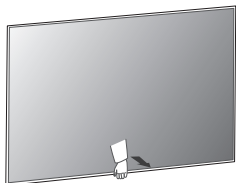

2. While pulling the TV, connect and organize the cables.
 - Position your body as close to the wall as possible behind the TV and organize the cables using the holder that came with the product.

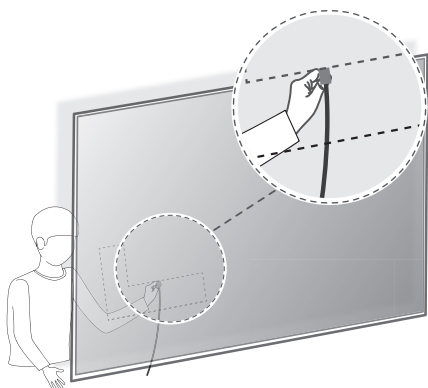

3. Push the TV until it makes close contact with the wall.
 - Push the left side of the TV to balance it, and then gently push the top and bottom parts of the TV so that it does not affect the product.
 - Gently push the upper center of the TV once again until it's completely pressed against the wall.
 - Caution: Do not apply excessive force to the screen. (Doing so can damage the screen.)

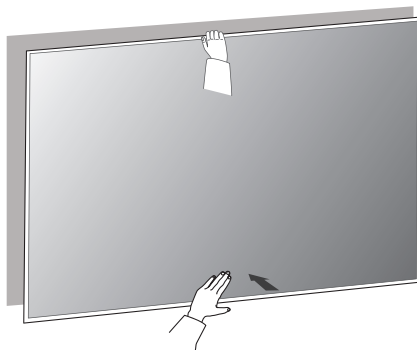

4. After re-installing the product, if the left and right sides are not level, you can adjust it with hand.
 - Adjust it in the desired direction by pushing the sides of the TV.

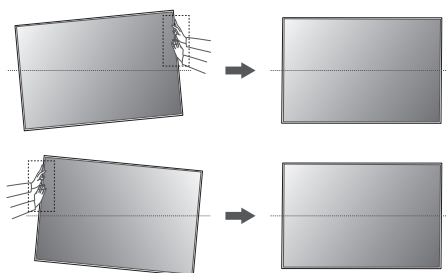

Specifications

[Unit : mm]

ENGLISH

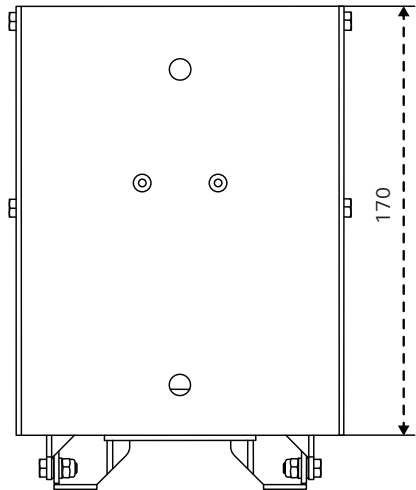
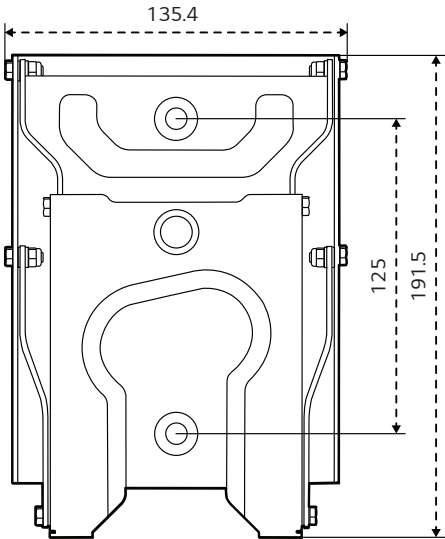

11.2

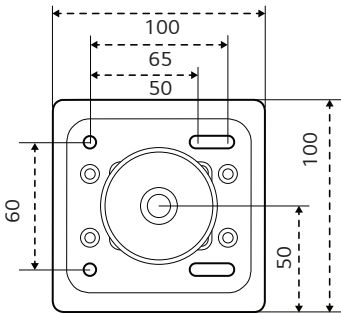
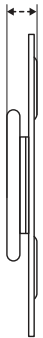

17.2

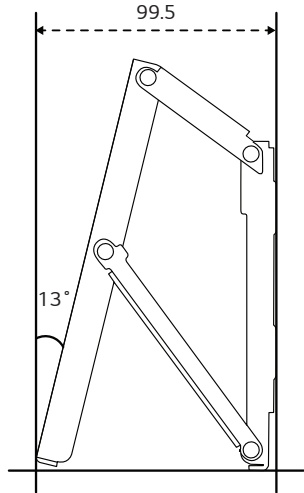
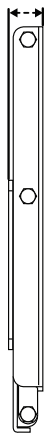

Model Name	WB21LGB	
Width (mm)	135.4	
Height (mm)	191.5	
Depth (mm)	17.2	
Product Weight (kg)	1.2 x 2	
Screws Distance (mm)	75 Inch	1281 x 125
	86 Inch	1586 x 125
Max. Tensile Load (kg)	70	
Wall Mount Support (mm)	100 x 100	

