



INSTALLATION MANUAL

AIR CONDITIONER

Please read this installation manual completely before installing the product. Installation work must be performed in accordance with the national wiring standards by authorized personnel only. Please retain this installation manual for future reference after reading it thoroughly.

AC Ez Touch
PACEZA000, CACEZA000
Original instructions



MFL69306902
Rev.09_102925



www.lg.com

Copyright © 2015 - 2025 LG Electronics Inc. All Rights Reserved.

SLOVENČINA	SLOVENŠČINA	LATVIŠĻI VALODA	LIEUVIŅU KALBA	GAEILGE	МАКЕДОНСКИ	SHQIP	BOSANSKI	ESTI KEEL	MALTI
ENGLISH	ITALIANO	ESPAÑOL	FRANÇAIS	DEUTSCH	EMHNIKA	ČEŠTINA	NEDERLANDS	POLSKI	LIMBA ROMÂNĂ
PORTUGUÊS	MAGYAR	БЪЛГАРСКИ	SRPSKI	HRVATSKI	SVENSKA	NORSK	DANSK		

SAFETY INSTRUCTIONS

The following safety guidelines are intended to prevent unforeseen risks or damage from unsafe or incorrect operation of the appliance.

The guidelines are separated into 'WARNING' and 'CAUTION' as described below.

 This symbol is displayed to indicate matters and operations that can cause risk.
Read the part with this symbol carefully and follow the instructions in order to avoid risk.

WARNING

This indicates that the failure to follow the instructions can cause serious injury or death.

CAUTION

This indicates that the failure to follow the instructions can cause the minor injury or damage to the product.

WARNING

Installation

- When you re-install this product, please contact your Supplier or Installation Company to carry out the work.
 - If someone inexperienced installs the product, it may result in fire, electric shock, explosion, injury, or failure of the product.
- Ensure there is no damage the power cable.
 - It may cause fire or electric shock.
- When you perform any electrical work, please contact the Supplier or Installation Company.
 - If an inexperienced person performs the disassembly or repair, it may cause fire or electric shock.
- Install the product that can avoid rain water.
 - If water enters into the product, it may cause product failure.
- Do not install the product at a place with a lot of moisture.
 - If moisture enters the product, it may cause product failure.

- Make sure to contact the Supplier or Installation Company for the product installation.
 - If someone inexperienced installs the product, it may result in fire, electric shock, explosion, injury, or failure of the product.
- Please ensure an electrical engineer perform the electric work based on the installation manual and the designated circuit diagram.
 - If incorrect wiring is used, or inexperienced engineer performs the electric work, it may cause fire or electric shock.
- Do not place the product near an electric fire.
 - It may cause fire.
- Avoid installing this controller in an area with sensitive electronic equipment.
 - It may cause electrical interference with sensitive electronics.
- Install the product fixed firmly.
 - If the product is not securely fixed, it may fall and become damaged.
- Correctly install the product after fully studying the provided manual.
 - It may cause fire or electric shock.
- During the wiring, do not use non-standard cable and do not force or extend the cable.
 - It may cause fire or electric shock.
- During the wiring of the power cable and communication cable, firmly fix the cable.
 - If the cable is loose, it may cause fire or electric shock.
- Do not connect the power cable to a communication terminal.
 - It may cause fire or electric shock or it may cause the product failure.
- Do not install the product in a place where combustible gas may leak.
 - It may cause fire, electric shock, explosion, injury of the user, or product failure.
- Install the product without tension on the cable.
 - If the tension is applied on the cable, the cable may be broken, or it may cause fire by the heat generation.

- Do not use damaged plugs or connectors.
 - It may cause electric shock or product failure.
 - ✳ If it is a model using a plug

Use

- Do not place a heavy object on the power cable.
 - It may cause fire or electric shock.
- Do not change or extend the power cable without authorization.
 - It may cause fire or electric shock.
- Use the cable exclusive for the product.
 - If an unauthorized or non-standard cable is used, it may cause fire or electric shock.
- Do not use a heating equipment near the power cable.
 - It may cause fire or electric shock.
- Do not let water enter inside the product.
 - It may cause electric shock or product failure.
- Do not place a container with liquid on the product.
 - It may cause product malfunction.
- Do not touch the product with wet hand.
 - It may cause fire or electric shock.
- Use standard parts.
 - If unauthorized parts are used, it may cause fire, electric shock, explosion, user injury, or product failure.
- When the product is flooded, do not use, power off and contact the Service Company.
 - It may cause fire or electric shock.
- Do not impose shock to the product.
 - It may cause product failure.
- Do not store or use combustible gas or ignition material near the product.
 - It may cause fire or product failure.
- Do not disassemble, repair, or modify the product without authorization.
 - It may cause fire or electric shock.

- Provide adequate supervision for use of the product by children or elderly.
 - The negligence may cause safety accident or product failure.
- Safeguard the product from Children.
 - It may cause product damage to the product or injury of the child.
- Check the operation temperature boundary stated in the manual before using the product. If there is no usage boundary stated in the manual, use it in the boundary of 0 °C ~ 40 °C (32 °F ~ 104 °F).
 - If it is used in an environment exceeding the operation temperature boundary, it will seriously damage the product.
- Do not press the switch or button of the product with a sharp object.
 - It may cause electric shock of product failure.
- During the wiring, do not work while the power is applied to the product.
 - It may cause fire or electric shock.
- If there is an abnormal sound, smell, or smoke from the product, stop using the product.
 - It may cause fire or electric shock.
- Do not place a heavy object on the product.
 - It may cause product failure.
- Do not directly spray water on the product or wipe the product with wet towel, etc.
 - It may cause fire or electric shock.
- Do not use the product for special usage such as animal or plant, precision equipment, or preservation of art pieces, and do not use the product at a place unsuitable for the installation.
 - It may cause property damage.
- Safely dispose of the packaging material.
 - If it is not disposed, the remaining packaging material may cause injury to the user.
- When you pull out the power plug, hold the head of the plug, and do not touch the power plug with wet hand.
 - It may cause fire or injury.

- Make sure to cut off the power of the product during the cleaning or repair.
 - It may cause fire or product deformation.

CAUTION

Installation

- Install the product firmly on a place that can support the weight of the product.
 - The product may fall and be damaged.
- Do not use the product at a place with grease, steam, or sulphuric acid gas.
 - It may cause product performance degradation or product damage.
- Check the rated power.
 - It may cause fire or product failure.
- Please use the adaptor provided where necessary.
 - If non-standard adaptor is used, it may cause product failure.
- During the transportation of the product, be careful not to drop or damage the product.
 - It may cause product failure or injury of the transporting person.
- During the wiring, do not let dew, water, insect, etc. enter the connection part where the cable is extended.
 - If an foreign object enters, it may cause electric shock or product failure.
- The appliance is only to be used with the power supply unit provided with the appliance.
- The appliance must only be supplied at safety extra low voltage corresponding to the marking on the appliance.
- Do not install the unit in potentially explosive atmospheres.

Use

- When cleaning the product, do not use strong detergent such as solvents, wipe with a soft cloth instead.
 - If strong detergent such as solvents are used, it may cause a fire or the product may be deformed.
- Do not press the touch panel with a pointed or sharp object.
 - It may cause electric shock or product failure.

- Do not let a metal material touch the product.
 - It may cause product failure.
- Before cleaning, power off the product.
 - It may cause malfunction of the product.
- Do not touch anything inside the product.
 - It may cause product failure.
- After a long period of product use, check it for any wear and tear or damage.
 - When the product is used for a long period of time, the product status may become worn or damaged, and it may cause user injury during the usage.
- Do not store the product near liquid such as a vase or water jar.
 - It may cause fire or electric shock.
- When the product is not used for a long period of time, turn off at the main power switch.
 - It may cause fire or product failure.

According to IEC 60335-1

This appliance is not intended for use by person (including children) with reduced physical, or mental capabilities, or lack of experience and knowledge, unless they have been given supervision or instruction concerning use of the appliance by a person responsible for their safety. Children should be supervised to ensure that they do not play with the appliance.

According to EN 60335-1

This appliance can be used by children aged from 8 years and above and person with reduced physical, sensory or mental capabilities or lack of experience and knowledge if they have been given supervision or instruction concerning use of the appliance in a safe way and understand the hazards involved. Children shall not play with the appliance. Cleaning and user maintenance shall not be made by children without supervision.



CAUTION

Changes or modifications not expressly approved by the manufacturer responsible for compliance could void the user's authority to operate the equipment.

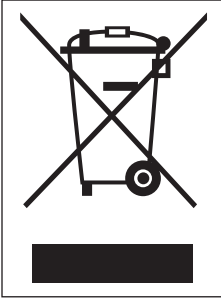

Disposal of your old appliance

1. This crossed-out wheeled bin symbol indicates that waste electrical and electronic products (WEEE) should be disposed of separately from the municipal waste stream.
2. Old electrical products can contain hazardous substances so correct disposal of your old appliance will help prevent potential negative consequences for the environment and human health. Your old appliance may contain reusable parts that could be used to repair other products, and other valuable materials that can be recycled to conserve limited resources.
3. You can take your appliance either to the shop where you purchased the product, or contact your local government waste office for details of your nearest authorised WEEE collection point. For the most up to date information for your country please see www.lg.com/global/recycling



Disposal of waste batteries/accumulators

1. This symbol may be combined with chemical symbols for mercury (Hg), cadmium (Cd) or lead (Pb) if the battery contains more than 0.0005% of mercury, 0.002% of cadmium or 0.004% of lead.
2. All batteries/accumulators should be disposed separately from the municipal waste stream via designated collection facilities appointed by the government or the local authorities.
3. The correct disposal of your old batteries/accumulators will help to prevent potential negative consequences for the environment, animal and human health.
4. For more detailed information about disposal of your old batteries/accumulators, please contact your city office, waste disposal service or the shop where you purchased the product.
(<http://www.lg.com/global/sustainability/environment/take-back-recycling/global-network-europe>)

Disposal of Waste Batteries

- All batteries should be disposed separately from the municipal waste stream via designated collection facilities appointed by the government or the local authorities.
- The correct disposal of your old batteries will help to prevent potential negative consequences for the environment, animal and human health.
- For more detail information about disposal of your old batteries, please contact your city office, waste disposal service or the shop where you purchased the product. Also You can contact our LG Support Representative Call center from below Link
https://www.lg.com/sa_en/support/contact/telephon

※ The above information applies only to Saudi Arabia.

التخلص من مخلفات البطاريات

- يجب التخلص من جميع البطاريات بشكل منفصل عن مجاري النفايات البلدية عن طريق مرافق الجمع المعينة التي تعينها الحكومة أو السلطات المحلية.
- يساعد التخلص الصحيح من البطاريات القديمة في منع الآثار السلبية المحتملة على البيئة وصحة الحيوان والبشر.
- لمزيد من المعلومات التفصيلية حول التخلص من البطاريات القديمة ، يرجى الاتصال بمكتب خدمة التخلص من النفايات في مدينتك أو المتجر الذي اشتريته منه المنتج.
- كما يمكنك الاتصال بمركز اتصال ممثل دعم LG عن طريق الدخول على الرابط التالي
https://www.lg.com/sa_en/support/contact/telephone

تتطبق المعلومات الواردة أعلاه فقط على المملكة العربية السعودية.

Safely dispose all materials in accordance with federal/state/local laws or ordinances.

التخلص الأيمن من كافة المواد بما يتوافق مع القوانين والأوامر المحلية

COMPONENTS

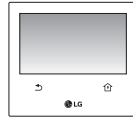
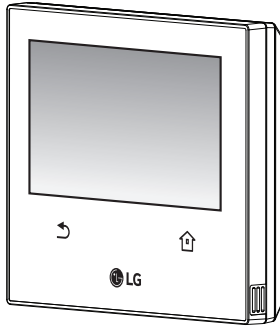

AC Ez Touch Controller

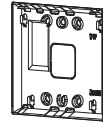

Wall installation plate



Wall installation screw



Power adapter



Power cord



Manual

! NOTE

The image of components or separately sold products may be different from the actual products.

PRODUCT SPECIFICATIONS

AC Ez Touch product specification is as follows.

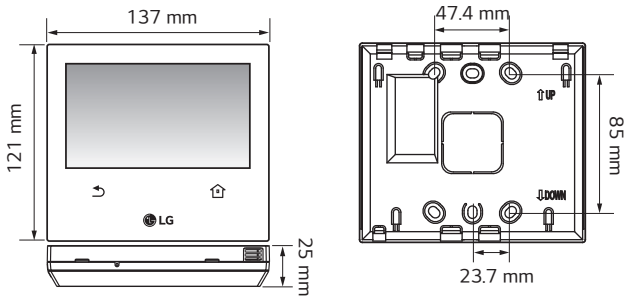

Item	Specifications
Power supply	DC 12 V (Adapter)
Adapter	Input : 100-240 V~ 50/60 Hz, 1.2 A Output : DC 12 V, 3.33 A
LCD	5 inch color LCD (800 * 480)
Touch	C-Type Touch Panel
485 communication	Max 1 000 m
DI	Max 100 m
Ethernet	100 Mbps
Keyboard	Korean / English / Number
Using Temperature	0 °C ~ 40 °C (32 °F ~ 104 °F)
Storage temperature	-20 °C ~ 60 °C (-4 °F ~ 140 °F)
Protection class	IP20

Name

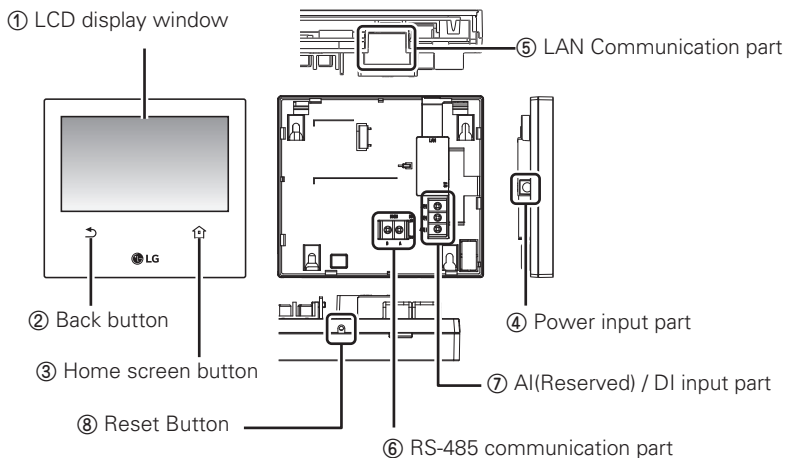

Number	Item	Specifications
①	LCD display window	Operation and setting status display
②	Back button	Move to the previous screen
③	Home screen button	Move to the default screen
④	Power input part	DC 12 V Adaptor connection part
⑤	LAN communication part	LAN communication connection port for ethernet connection (100 Mbps Support)
⑥	RS-485 communication part	1 port
⑦	AI/DI Input part	AI+ : Reserved DI+ : Contact point input (dry contact input) COM : Common GND
⑧	Reset Button	For system restart

INSTALLATION AND SETTING

In this chapter, it describes the installation and setting method to set AC Ez Touch.

To use AC Ez Touch, you need to establish the environment for the controller and the equipment (Air-conditioner/Ventilation/Heating) to communicate with each other, and you need to register the corresponding equipment through AC Ez Touch.

You need to install in the following order.

Step 1 : Installation environment check and setting up the equipment address

Before installing AC Ez Touch, check the network composition with the interfaced equipment, and assign address that does not overlap on the connected equipment.

Step 2 : Product installation and RS485 communication connection

Install AC Ez Touch and connect RS-485 communication cable.

Step 3 : Connecting cables and power adapter

Connect network and other cables, and then connect the power adapter.

Step 4 : Air-conditioner/Ventilation equipment/Heating equipment registration and group set-up

Register the connected air-conditioner, ventilation and heating equipment, and set the group.

Step 5 : Operation

Check if basic control and the set up contents work normally.

⚠ CAUTION

- Installation work requires specialized technology. Therefore, the installation contents mentioned in this chapter must be carried out by a qualified installation technician.
- If you have questions or requests related to the installation, please contact the service center or specialist installation company acknowledged by LG Electronics.

Installation environment check and setting up the equipment address

! NOTE

- The maximum communication distance guaranteed by LG Electronics is 1 000 m. That is, the equipment installed at the farthest location from AC Ez Touch shall be within 1 000 m.
- It is recommended to use the communication cable of 0.75 mm² or more.
- Set a unique address, that does not overlap with other equipment on the same bus.
- Each device which can be used with PDI must be set to a unique address when connected with PDI. For further information about the devices can be used with PDI, please refer to the PDI manual.

Central control address of the indoor unit set-up

First, you need to assign address that does not overlap with other equipment (Air-conditioner/Ventilation/Heating equipment) considering the entire installation composition connected to one AC Ez Touch.

The equipment address can be set in hexadecimal from 00 to FF.

! NOTE

Outdoor unit and indoor unit number assignment

- If the outdoor unit product is Multi V, it is recommended to set the first digit of the address as the outdoor unit number, and set the second digit as the indoor unit number, so that the system composition and division can be easily identified during the address setting.

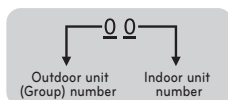

! NOTE

- The central control address setting method may be different according to the indoor unit product or remote controller type, so set the address by referring to the indoor unit product or wired remote controller manual.

RS 485 Communication cable connection

- 1 Maximum of 64 indoor units can be connected to one AC Ez Touch. If multiple number of the outdoor units need to be connected, the connection should be in BUS type. Otherwise, AC Ez Touch may malfunction.

<Correct example: RS485 BUS type connection>

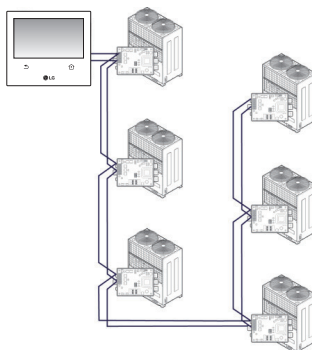

< Incorrect example: RS485 STAR type connection >

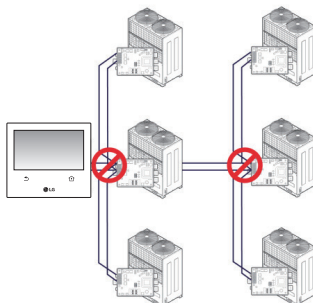

Product installation

The installation and cable connection methods of AC Ez Touch are as follows.

- 1 Decide the space to install the controller.
 - Before fixing the controller to the wall, check if it is a suitable location to connect the controller, RS485 cable, power cable, and Ethernet cable.
 - Determine the wiring direction of the product, and remove the knockout structure of the corresponding direction.

* Method of removing the knockout structure

- ① Cut the rim of the groove part on the both sides of the knockout structure using a nipper.

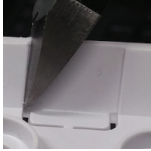

- ② After cutting, bend the knockout structure to the inward direction & outward direction for 2 times, respectively.



- ③ Tear the knockout structure.

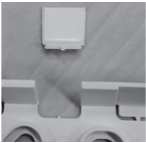

! NOTE

Make sure to use a nipper as tool. When using other tools such as pliers, a sharp cutting trail remains on the cut surface, and scratch or notches by the electric-wire may occur.



<when using a nipper>



<when using a pliers>

- 2 Fix the controller's wall installation plate to the wall above RS485 cable.

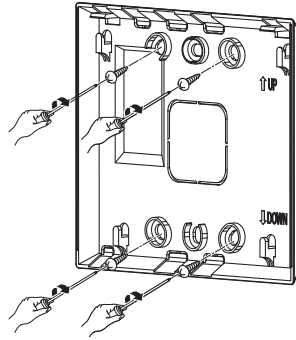

- 3 Connect RS485 cable located at the backside of the controller main unit to RS485 connector.

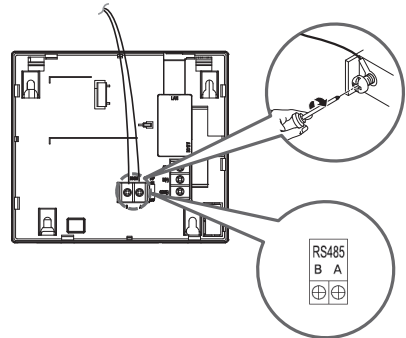

! CAUTION

- Be careful not to cross wire connections. RS485 communications are dependant on correct polarity.
- When the cable is connected in reclamation structure, be careful of the bending of RS485 communication cable.

When connecting T/B, after removing the sheath referring to the guide as shown on the picture, make sure to connect by inserting a short-protecting sleeve into the O-ring or U-terminal.

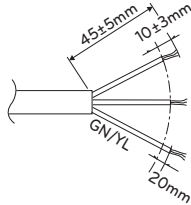

<Sheath-removal guide>

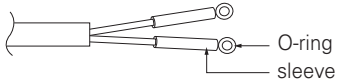

<Shape of applying to O-ring and sleeve>

- 4 If network connection is required from the controller, connect the Ethernet cable to LAN port at the backside of the controller main unit.

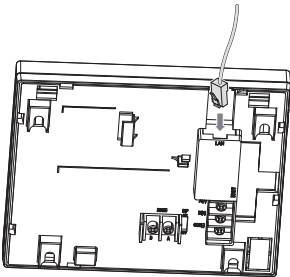

- 5 Connect power adaptor to the power connector located at the backside of the controller main unit.

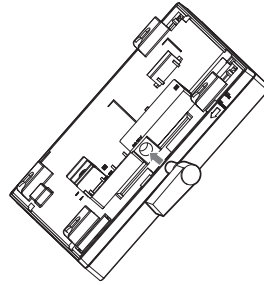

- 6 After matching the hook of the wall mounting plate installed on the wall and the groove of the product, push the product to match the groove.

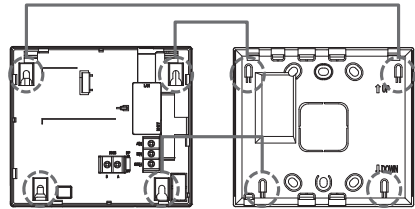

<Groove of the product>

<Wall-mounting plate hook>

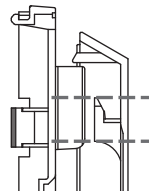

- 7 Push down the product to lock the top hook.

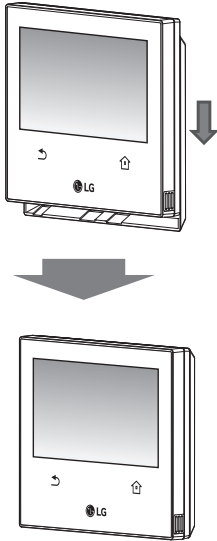

! NOTE

Separation sequence is in reverse of installation sequence.

Emergency stop function set-up

AC Ez Touch has an emergency stop function to stop all connected equipment (Air-conditioner/Ventilation/Heating equipment) when there is an emergency in the building.

When DI port detects a short circuit signal, AC Ez Touch stops the operations of all connected equipment.

Regarding emergency stop function, it can be used by connecting to the DI port of external powerless contact type on the rear of AC Ez Touch as shown below.

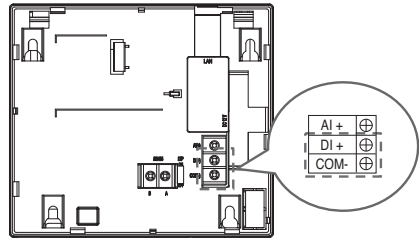

! NOTE

DI port should be open status always, except for emergency situation.

- 8 Connect the power cord of the power adapter of the power plug.

COMPOSITION OF MENU

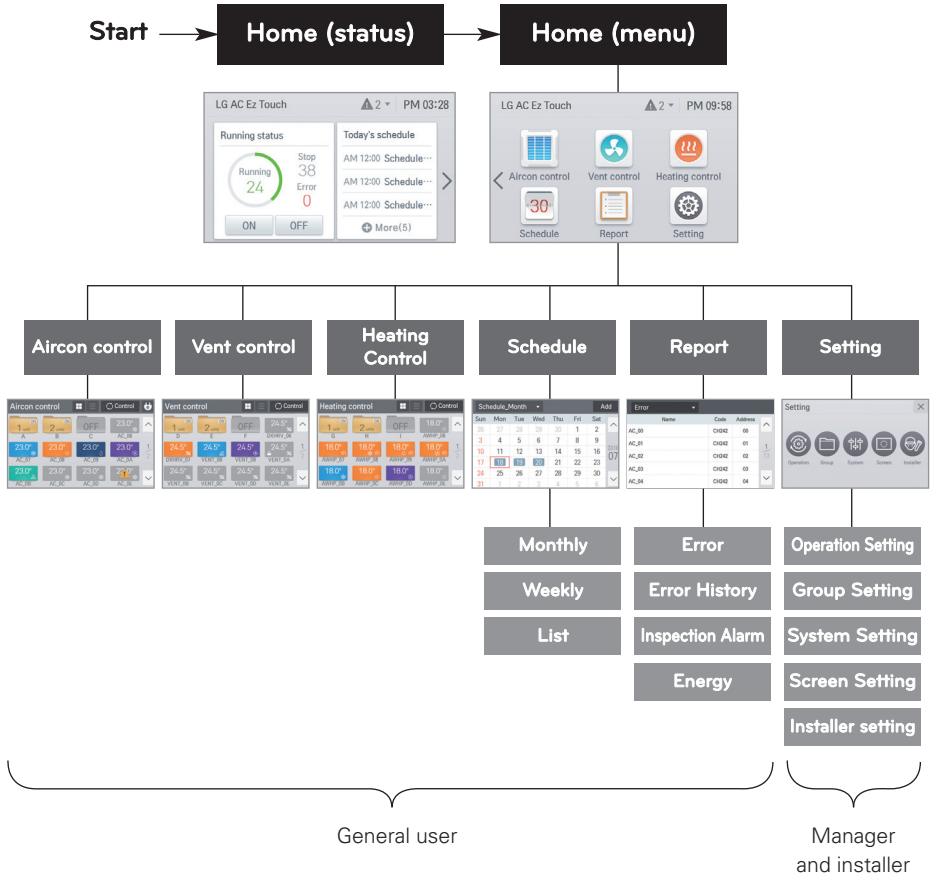

Access rights for each menu

Detail access rights

- General user: can access all menu displayed in the screen
- Manager and installer: When it enters the setting, the manger and installer are verified by password

HINT

Check list before calling for service

When any malfunction occurs to the product, check the following list before contacting the service center.

Symptoms	Check	Action
All products keep turning off. The alarm is displayed.	Check the source of the DI port.	
Product is reset in the middle of a night.	It is automatically reset at AM 2:05 every Monday.	
Equipment is not controlled.	Is the equipment in 'locked' status?	Check if lock function is set, and clear the lock function.
Error display appears on the equipment icon.	Is the equipments with the error message connected properly?	If the equipment are not properly connected, error is displayed. Check the equipment connection status.
Lock cannot be set. Cannot use temperature limit setting. Cannot user auto Registration function	Is the product set up as 'Slave' status?	In slave state, you cannot use each equipment's lock setting, set temp range, 2set point, IDU 2set, auto search device function, energy report and energy save mode.
Web program is stop.	-	After exiting the running program, try again.
Time is changed without setting manually.	Is daylight saving time set?	Please turn off daylight saving time.

[For Equipment under battery regulation]



English

The battery is in compliance with the Regulation (EU) 2023/1542

Italiano

La batteria è conforme al Regolamento (UE) 2023/1542

Español

La pila cumple con el Reglamento (UE) 2023/1542

Français

La pile est conforme à la réglementation (UE) 2023/1542

Deutsch

Die Batterie entspricht der Verordnung (EU) 2023/1542

Ελληνικά

Η μπαταρία συμμορφώνεται με τον κανονισμό (ΕΕ) 2023/1542

Česky

Baterie odpovídá Nařízení (EU) 2023/1542

Nederlands

Deze accu voldoet aan de verordening (EU) 2023/1542

Polski

Bateria spełnia wymogi rozporządzenia (UE) 2023/1542

Română

Bateria este în conformitate cu Regulamentul (UE) 2023/1542

Português

A bateria está em conformidade com o Regulamento (EU) 2023/1542

Magyar

Az akkumulátor megfelel az (EU) 2023/1542 rendeletnek

Български

Батерията е в съответствие с Регламент (ЕС) 2023/1542

Srpski

Baterija je u skladu sa Uredbom (EU) 2023/1542.

Hrvatski

Baterija je u skladu s Uredbom (EU) 2023/1542.

Svenska

Batteriet överensstämmer med förordning (EU) 2023/1542

Norsk

Batteriet overholder forordningen (EU) 2023/1542

Dansk

Batteriet er i overensstemmelse med forordning (EU) 2023/1542

Eesti

Aku vastab määrussele (EL) 2023/1542

Malti

Il-batterija hija konformi mar-Regolament (UE) 2023/1542

Slovenčina

Batéria je v súlade s nariadením (EÚ) 2023/1542

Slovenščina

Baterija je v skladu z Uredbo (EU) 2023/1542.

Latviešu

Akkumulators ir atbilstīgs Regulai (ES) 2023/1542.

Lietuvių K.

Baterija atitinka Reglamentą (ES) 2023/1542

Gaeilge

Tá an cadhnra i gcomhréir le Rialachán (AE) 2023/1542

Македонски

Батеријата е во согласност со Регулативата (ЕУ) 2023/1542.

Shqip

Bateria është në përputhje me Rregulloren (BE) 2023/1542

Bosanski

Baterija zadovoljava zahtjeve navedene u Propisu (EU) 2023/1542

LG Electronics EU Importer names and addresses / Имена и адреси на вносителите на LG Electronics в EC / Nazivi i adrese uvoznika LG Electronics u EU / Nazivi i adrese uvoznika LG Electronics u EU / Názvy a adresy dovozců LG Electronics v EU / Navne og adresser på importører af LG Electronics i EU / Namen und Adressen der LG Electronics EU-Importeure / Ονόματα και διευθύνσεις εισαγωγέων της LG Electronics EU / Nombres y direcciones de importadores para la UE de LG Electronics / LG Electronics EL maaletuojate nimed ja aadressid / LG Electronics – EU:n maahantuojien nimet ja osoitteet / Noms et adresses des importateurs pour LG Electronics EU / Ainmneacha agus seolaí lompórtálai AE LG Electronics / Nazivi i adrese uvoznika proizvoda tvrtke LG Electronics u Europskoj uniji / Az LG Electronics európai uniós importőreinek neve és címe / Nöfn og heimilisföng LG Electronics innflytjenda innan ESB / Nomi e indirizzi degli importatori UE di LG Electronics / LG Electronics ES importuotojů pavadinimai ir adresai / LG Electronics ES importētāju nosaukumi un adreses / Имиња и адреси на увозници на LG Electronics за ЕУ / LG Electronics: ismijiet u indirizzi tal-importaturi tal-UE / Namen en adressen van importeurs voor LG Electronics EU / Navn og adresser for EU-importører for LG Electronics / Nazwy i adresy importerów produktów LG Electronics w Europie / Nomes e endereços dos importadores para LG Electronics EU / Numele și adresele Importatorului UE al LG Electronics / Názvy a adresy dovozcův LG Electronics do EÚ / Imena in naslovi uvoznikov za LG Electronics EU / Emrat dhe adresat e importuesve të LG Electronics në BE / Nazivi i adrese EU uvoznika kompanije LG Electronics / Namn och adresser för LG Electronics EU-importörer

LG Electronics Benelux B.V.	Krijgsman 1, 1186 DM Amstelveen, The Netherlands
LG Electronics Deutschland GmbH	Alfred-Herrhausen-Allee 3-5, 65760, Eschborn, Germany
LG Electronics France, SAS	Immeuble Workstation, 25 quai du Président Paul Doumer, 92 400 Courbevoie, France
LG Electronics España S.A.U.	Calle Chile 1, 28290, Las Rozas, Madrid, Spain
LG Electronics Portugal S.A.	Taguspark, Av. Jacques Delors 3, Edifício Inovacao I, Corpo 1, 2740-122, Porto Salvo, Portugal
LG Electronics Hellas S.A.	Ethnarhou Makariou str. 1, 17501, Delta Paleo Faliro, Greece
LG Electronics Italia S.p.A.	Via Aldo Rossi 4, 20149, Milan, Italy
LG Electronics Latvia SIA	Gustava Zemgala gatve 74A, Rīga, LV-1039, Latvia
LG Electronics Magyar Kft.	Konyves K. krt.3/a, 1097, Budapest, Hungary
LG Electronics Polska Sp. z o.o.,	Wołoska 22, 02-675, Warszawa, Poland
LG Electronics Magyar Kereskedelmi Kft. Budapesta Sucursala București,	11-15, Tipografilor Street, S-Park Business Centre, Building B3, 5th Floor, District 1, 013714 Bucharest, Romania
LG Electronics Nordic AB	Esbogatan 18, 164 94, Kista, Sweden
LG Electronics Shared Services Center B.V.	Krijgsman 1, 1186 DM Amstelveen, The Netherlands

Depending on products or models, actual importers may be limited to some subsidiaries. For EU-produced units, there is no applicable EU importer. / В зависимости от продуктите или моделите действителните вносители може да са ограничени до някои дъщерни дружества. За апарати, произведени в ЕС, няма приложим вносител в ЕС. / U zavisnosti od proizvoda ili modela, uvoznici mogu biti ograničeni na neka povezana društva. Za jedinice proizvedene u EU ne postoji važeći uvoznik iz EU. / U zavisnosti od proizvoda ili modela, uvoznici mogu biti ograničeni na određene podružnice. Za jedinice proizvedene u EU ne postoji EU uvoznik. / V závislosti na výrobcích nebo modelech mohou být aktuální dovozci omezeni na některé dceřiné společnosti. U výrobků vyráběných v EU není žádný relevantní dovozce do EU. / Afhængigt af produkter eller modeller kan de faktiske importører være begrænset til enkelte datterselskaber. For EU-fremstillede enheder er der ingen relevant EU-importør. / Je nach Produkt oder Modell können die tatsächlichen Importeure auf einige Tochtergesellschaften beschränkt sein. Für in der EU produzierte Geräte gibt es keinen anwendbaren EU-Importeur. / Ανάλογα με τα προϊόντα ή τα μοντέλα, οι πραγματικοί εισαγωγείς ενδέχεται να περιορίζονται σε ορισμένες θυγατρικές. Για μονάδες που παράγονται στην ΕΕ δεν υπάρχει ισχύων εισαγωγέας της ΕΕ. / Dependiendo de los productos o modelos, los importadores efectivos podrían quedar limitados a algunos subsidiarios. Para las unidades producidas en la UE, no hay ningún importador para la UE aplicable. / Sõltuvalt toodetest või mudelitest võivad tegelikud maaletoojad olla piiratud mõnede tütarettevõtetega. EL-is toodetud seadmete puhul ei ole kohaldatavat EL maaletoojat. / Tuoteista tai malleista riippuen todelliset maahantuojat voivat rajoittua muutamiiin tytäryhtiöihin. EU:ssa valmistetuilla laitteilla ei ole sovellettavaa EU:n maahantuojaa. / Selon les produits ou les modèles, les importateurs effectifs peuvent être limités à certaines filiales. Pour les unités produites dans l'UE, il n'y a pas d'importateur applicable pour l'UE. / Ag brath ar tháirgí nó múnlaí, d'fhéadfaí go mbeadh iompórtálaithe iarmhír srianta go roinnt fochomhlachtaí. Maidir le aonaid déanta sa AE, níl iompórtálai AE infhéidhme. / Ovisno o proizvodima ili modelima uvoznici mogu biti ograničeni na neke podružnice. Za uređaje proizvedene u Europskoj uniji nije predviđena tvrtka za uvoz iz EU. / A termékéktől vagy modellektől függően előfordulhat, hogy a tényleges importőrök egyes leányvállalatokra korlátozódnak. Az EU-ban gyártott készülékek esetében nincs vonatkozó európai uniós importőr. / Raunverulegir framleiðendur geta verið takmarkaðir við tiltekin dótturfélag, en það fer eftir vörum eða vörumódelum. Engin ESB innflytjandi er fyrir hluti sem eru framleiddir innan ESB. / A seconda dei prodotti o dei modelli, gli importatori effettivi potrebbero essere limitati ad alcune filiali. Per le unità prodotte nell'UE, non esiste un importatore UE applicabile. / Priklausomai nuo gaminių ar modelių, tikrieji importuotojai gali apsiriboti kai kuriomis dukterinėmis įmonėmis. ES pagamintiems vienetais nėra tinkama ES importuotojai. / Atkarībā no produktiem vai modeļiem, faktiskie importētāji var būt dažādi meitasuzņēmumi. ES ražotām vienībām nav piemērojama ES importētāja. / Зависно од произвоците или моделите, актуелните увозници можеби се ограничени на некои подружници. За единиците произведени за ЕУ, нема применлив увозник за ЕУ. / Skont il-prodott jew il-mudell, l-importaturi attwali jistghu jkunu limitati ghal certi sussidjarji. Għall-unitajiet prodotti fl-UE, m'hemm importatur applikabbli tal-UE. /

Afhankelijk van de producten of modellen, kunnen de eigenlijke importeurs beperkt zijn tot enkele dochterondernemingen. Voor in de EU geproduceerde eenheden is er geen toepasselijke EU-importeur. / Avhengig av produkter eller modeller, kan faktiske importører være begrenset til enkelte datterselskaper. Det er ingen gjeldende EU-importør for EU-produserte enheter. / W zależności od produktów lub modeli, rzeczywisci importeryzcy mogą polegać na swoich podmiotach zależnych. W przypadku wyrobów produkowanych w UE nie ma odpowiedzialnego importera na region Unii. / Dependendo dos produtos ou modelos, os importadores existentes podem ser limitados a algumas filiais. Para as unidades produzidas na UE, não há nenhum importador da UE aplicável. / În funcție de produse sau modele, importatorii actuali ar putea fi limitați la anumite filiale. Pentru unitățile produse în UE, nu există niciun importator UE aplicabil. / V závislosti od výrobkov alebo modelov môžu byť skutoční dovozovia obmedzení na niektoré dcérske spoločnosti. Pre zariadenia vyrobené v EU neexistuje žiadny príslušný dovozca do EÚ. / Odvisno od izdelkov ali modelov so lahko dejanski uvozniki omejeni na nekatere hčerinske družbe. Za enote, proizvedene v EU, ni ustreznega uvoznika iz EU. / Nė varėsi tē produktēve ose modelevē, importuesit aktual mund tē jenē tē kufizuar vetēm nē disa degē. Pēr njsitē ē prodhuara nē BE, nuk ka importues tē zbatueshēm tē BE-sē. / U zavisnosti od proizvoda ili modela, stvarni uvoznici mogu biti ograničeni na neke podružnice. Za jedinice proizvedene u EU ne postoji merodavni EU uvoznik. / Beroende på produkter eller modeller kan faktiska importörer vara begränsade till vissa dotterbolag. För EU-tillverkade enheter finns det ingen tillämplig EU-importör.

LG Electronics Inc. ^① Single Contact Point (EU/UK) :
 LG Electronics Deutschland GmbH
 Alfred-Herrhausen-Allee 3-5, 65760 Eschborn, ^③ Germany

	①	②	③
ENGLISH	Single Contact Point	EU	Germany
ITALIANO	Punto di contatto unico	UE	Germania
ESPAÑOL	Punto de contacto único	UE	Alemania
FRANÇAIS	Point de contact unique	UE	Allemagne
DEUTSCH	Einheitliche Anlaufstelle	EU	Deutschland
ΕΛΛΗΝΙΚΑ	Ενιαίο σημείο επαφής	EE	Γερμανία
ČEŠTINA	Jednotné kontaktní místo	EU	Německo
NEDERLANDS	Eén enkel contactpunt	EU	Duitsland
POLSKI	Punkt kontaktowy	UE	Niemcy
LIMBA ROMÂNĂ	Punct unic de contact	UE	Germania
PORTUGUÊS	Ponto de contacto único	UE	Alemanha
MAGYAR	Egyetlen kapcsolattartó pont	EU	Németország
БЪЛГАРСКИ	Единна контактна точка	EC	Германия
SRPSKI	Jedinstvena kontaktna tačka	EU	Nemačka
HRVATSKI	Jedinstvena kontaktna točka	EU	Njemačka
SVENSKA	Enskild kontaktpunkt	EU	Tyskland
NORSK	Enkelt kontaktpunkt	EU	Tyskland
DANSK	Enkelt kontaktpunkt	EU	Tyskland
SLOVENČINA	Jednotné kontaktné miesto	EÚ	Nemecko
SLOVENŠČINA	Enotna kontaktna točka	EU	Nemčija
GAEILGE	Pointe Teagmhála Aonair	AE	an Ghearmáin
SHQIP	Pikë e vetme kontakti	BE	Gjermania
BOSANSKI	Jedinstvena kontaktna tačka	EU	Njemačka
EESTI KEEL	Üks kontaktpunkt	EL	Saksamaa
LATVIEŠU VALODA	Vienotais kontaktpunkts	ES	Vācija
LIETUVIŲ KALBA	Bendras kontaktas visiems	ES	Vokietija
MALTI	Punt ta' Kuntatt Uniku	UE	il-Ġermanja
МАКЕДОНСКИ	Единствена контакт точка	EY	Германија



Manufacturer :
LG Electronics Inc.
84, Wanam-ro, Seongsan-gu, Changwon-si, Gyeongsangnam-do, KOREA

UK Importer : LG Electronics U.K. Ltd
Velocity 2, Brooklands Drive, Weybridge, KT13 0SL