

ENGLISH Installation Guide

Please read this manual carefully before operating your set and retain it for future reference.

FRANÇAIS Guide d'installation

Veuillez lire ce manuel attentivement avant d'utiliser l'appareil et conservez-le pour pouvoir vous y reporter ultérieurement.

ESPAÑOL Guía de instalación

Lea atentamente este manual antes de poner en marcha el equipo y consérvelo para futuras consultas.

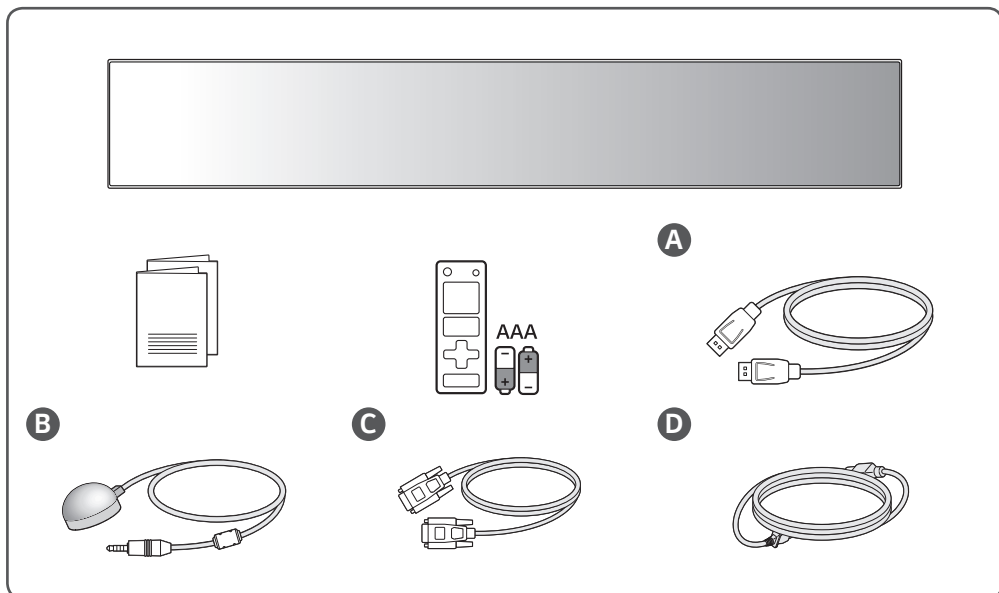



- ▶ www.lg.com/id-manual
- ▶ SuperSign : <http://partner.lge.com>

ENGLISH

You can download more detailed information on our website by searching the model number provided on the cover page.

FRANÇAIS

Vous pouvez télécharger des informations plus détaillées sur notre site Web en faisant une recherche à l'aide du numéro de modèle indiqué sur la page de couverture.

ESPAÑOL

Busque en nuestro sitio web el número de modelo que aparece en la portada y descargue información más detallada.



ENGLISH

| | | |
|--|------|---|
| Dimensions (Width x Height x Depth) / Weight | Head | 2158.3 mm x 348.5 mm x 81.7 mm / 20.5 kg (84.9 inches x 13.7 inches x 3.2 inches / 45.1 lbs) |
|--|------|---|

FRANÇAIS

| | | |
|---|-------|---|
| Dimensions (largeur x hauteur x profondeur) / Poids | Ecran | 2 158,3 mm x 348,5 mm x 81,7 mm / 20,5 kg (84,9 po x 13,7 po x 3,2 po / 45,1 lb) |
|---|-------|---|

ESPAÑOL

| | | |
|---|--------------------------------|---|
| Dimensiones (ancho x alto x profundidad) / Peso | Cabecal | 2 158,3 mm x 348,5 mm x 81,7 mm / 20,5 kg |
| Alimentación | CA 100-240 V ~ 50/60 Hz, 2,4 A | |

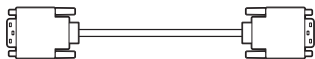
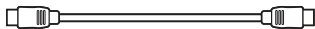



HDMI™ IN
ENTRÉE HDMI™



HDMI OUT
SORTIE HDMI

DP IN
ENTRÉE DP



DP OUT
SORTIE DP

DVI-D IN
ENTRÉE DVI-D

AUDIO IN
ENTRÉE AUDIO

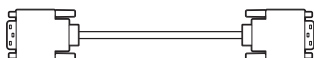

DVI-D OUT
SORTIE DVI-D



AUDIO OUT
SORTIE AUDIO



LAN IN
ENTRÉE LAN



USB 2.0 IN
ENTRÉE USB 2.0
(5 V --- 0.5 A)

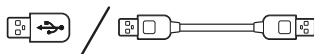

IR&LIGHT
SENSOR
CAPTEUR DE
LUMIÈRE IR

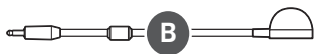

RS-232C IN
ENTRÉE RS-232C

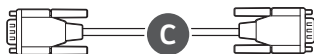

RS-232C OUT
SORTIE RS-232C



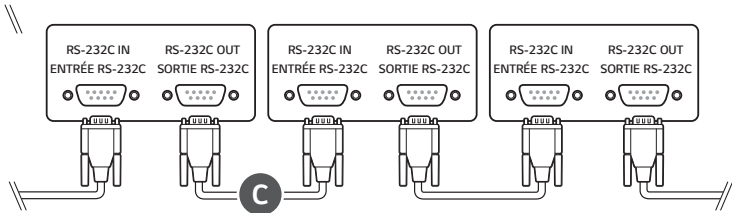
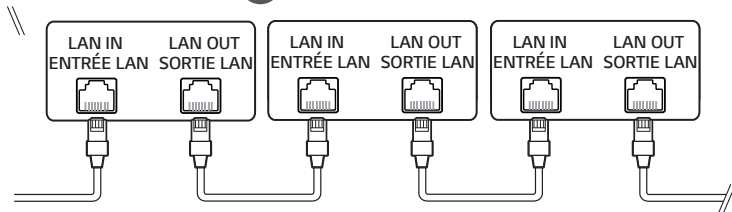
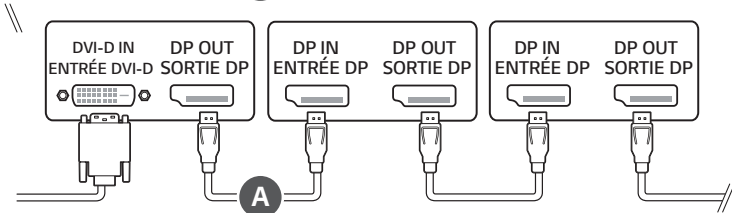
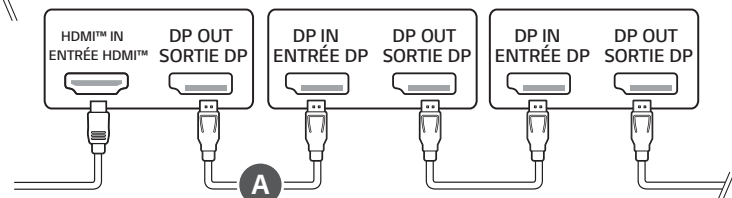
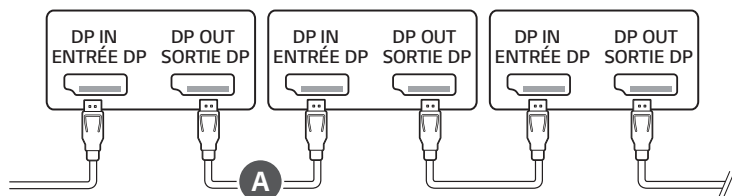

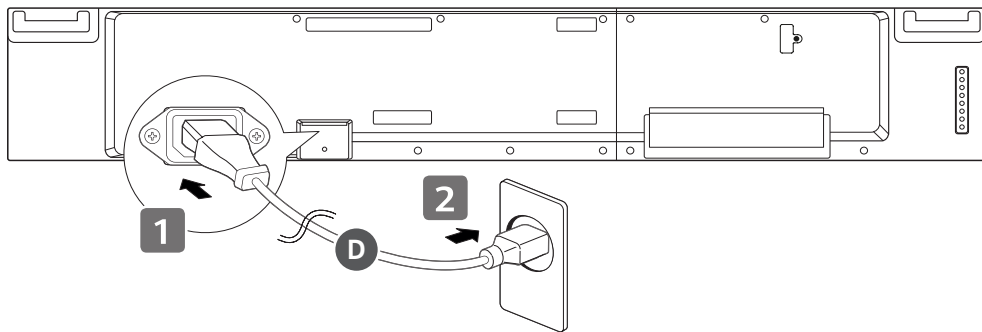

1

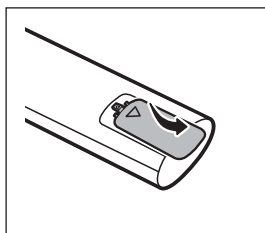

2

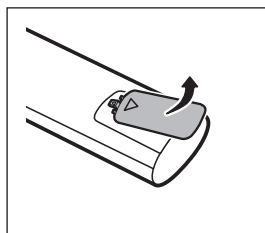

3

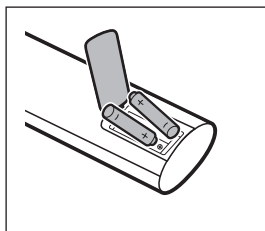

4

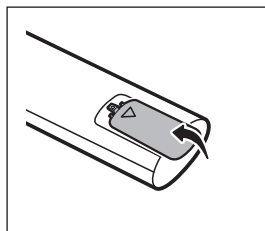

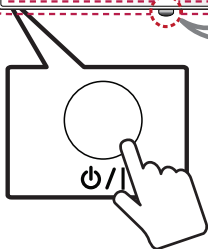
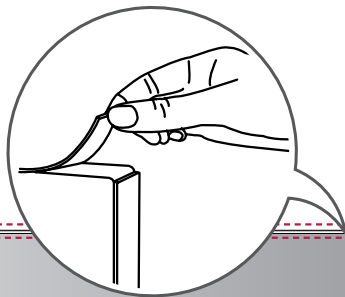



* M F L 7 1 4 5 3 3 0 2 *

(2405-REV02)

