



USER GUIDE

LM-W315

About this user guide

Thank you for choosing this LG product. Please carefully read this user guide before using the device for the first time to ensure safe and proper use.

- Always use genuine LG accessories. The supplied items are designed only for this device and may not be compatible with other devices.
- This device is not suitable for people who have a visual impairment due to the touchscreen keyboard.
- Descriptions are based on the device default settings.
- Default apps on the device are subject to updates, and support for these apps may be withdrawn without prior notice. If you have any questions about an app provided with the device, please contact a LG Service Centre. For user-installed apps, please contact the relevant service provider.
- Modifying the device's operating system or installing software from unofficial sources may damage the device and lead to data corruption or data loss. Such actions will violate your LG licence agreement and void your warranty.
- Some content and illustrations may differ from your device, depending on the area, service provider, software version, or OS version, and are subject to change without prior notice.
- Software, audio, wallpaper, images, and other media supplied with your device are licenced for limited use. If you extract and use these materials for commercial or other purposes, you may be infringing copyright laws. As a user, you are fully responsible for the illegal use of media.
- Additional charges may incur for data services, such as messaging, uploading, downloading, auto-syncing and location services. To void additional charges, select a data plan suitable to your needs. Contact your service provider to obtain additional details.

Instructional notices



WARNING: Situations that could cause injury to the user and third parties.



CAUTION: Situations that may cause minor injury or damage to the device.



NOTE: Notices or additional information.

Table of contents

01

Basic Functions

- 6 Accessories
- 7 Watch Overview
- 10 Get ready for snap-and-swap
- 12 Charging Your Watch
- 15 Using the battery efficiently
- 16 If the Screen Freezes
- 16 Turning the Watch On and Off
- 17 Waking Your Watch Up
- 17 Dimming the Screen
- 17 Using the Touch Screen

02

Connecting the Watch to Your Companion Device

- 21 Setting Up Your Companion Device
- 22 Pairing Your Watch with Your Companion Device
- 23 Connecting to Another Companion Device

03

How to Use Your Watch

- 25 Watch Face Home Screen
- 25 Changing the Watch Face
- 27 Notification Cards
- 28 Managing the Quick Settings
- 29 JustWatch
- 30 Sending a Text
- 30 Apps Screen
- 31 Master Tools
- 35 Google Fit
- 38 Opening the Apps Installed On Your Watch
- 39 Downloading Other Apps

04

Tasks Using Voice Command

- 41 Getting help from your Google Assistant on Your Watch
- 41 Setting a Reminder
- 42 Seeing Your Step Count
- 42 Sending a Text
- 43 Setting a Timer
- 44 Using the Stopwatch
- 44 Setting an Alarm
- 44 Managing Your Alarms

05

Settings

- 46 Opening the Settings Menu
- 46 Display
- 47 Apps & notifications
- 47 Gestures
- 48 Connectivity
- 50 Accessibility
- 50 Personalisation
- 51 System

06

More Information

- 53 Open Source Software Notice Information
- 53 Trademarks
- 54 DECLARATION OF CONFORMITY
- 54 Regulatory information (Regulation ID number, E-labeling, etc.)
- 54 How to Update Your Device

07

Safety Information

- 56 Safety tips
- 57 General safety & handling



01

Basic Functions

Accessories

The following accessories are provided with your device.

- Device
- Quick Start Guide
- Charging cradle
- Charger
- USB cable



- The items supplied with the device and any available accessories may vary depending on the region or service provider.
- Always use genuine LG Electronics accessories. Using accessories made by other manufacturers may affect your device's call performance or cause malfunctions. Any issues resulting from usage of accessories made by other manufacturers may not be covered by LG's repair service.
- The accessories are not water-resistant. Do not expose these items to water.



- If any of these basic items are missing, contact the dealer from which you purchased your device.
- To purchase additional basic items, contact the LG Customer Support Centre.
- To purchase optional items, contact the LG Customer Support Centre for available dealers, and then purchase online.
- Some items in the product box are subject to change without notice.
- The appearance and specifications of your device are subject to change without notice.

Watch Overview

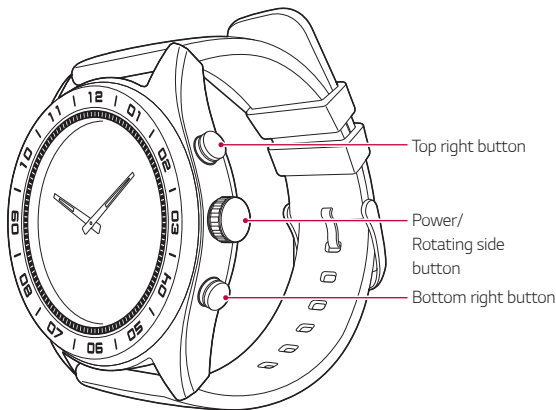

Power/Rotating side button

To turn the watch on:

- Press and hold for one second to turn the screen on. If it doesn't turn on, press and hold for a few seconds until the LG logo appears.

When the screen is dimmed:

- Press once to wake the screen.

When the screen is on:

- Press to open the Apps screen when you are on the watch face home screen.
- Press to return to the previous when you are on any other screen.
- Press and hold for one second to get help from your Google Assistant.

When the screen is off:

- Press once to wake the screen.

Power/Rotating side button	<p>Rotating the Power/Rotating side button:</p> <ul style="list-style-type: none"> • Rotate to browse the apps list on the Apps screen. • Rotate to show or hide notifications in the watch face home screen. <hr/> <p>If the screen freezes:</p> <ul style="list-style-type: none"> • Press and hold until the LG logo appears to restart the watch.
Top right button	<p>Press and hold to see the obscure area when the screen is on.</p>
Bottom right button	<p>When the screen is on:</p> <ul style="list-style-type: none"> • Press once to open the master tools • Press and hold to use JustWatch. <hr/> <p>When the screen is off:</p> <ul style="list-style-type: none"> • Press once to wake the screen.



- See *Master Tools* for details.
- See *JustWatch* for details.

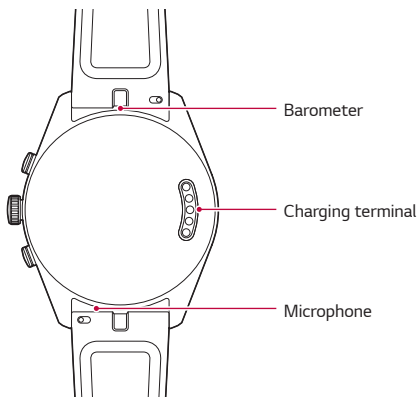

- Any damage to the barometer or microphone resulting from accidents, unreasonable use, tampering or other causes not arising from defects in material or workmanship may void the Limited Warranty.



- If water enters hole on the device, some features may not work properly. In this case, dry the device thoroughly before using it again.
- Keep the holes clear.
- If your device receives an impact or moves severely, the hour and minute hands may move slightly. Please note that this is designed behaviour.
- The hour and minute hands may move if you drop the device or subject it to severe impact. In this case, calibrate the hour and minute hands.

Get ready for snap-and-swap

Switch styles anytime with MODE™ snap-and-swap watch bands.

1

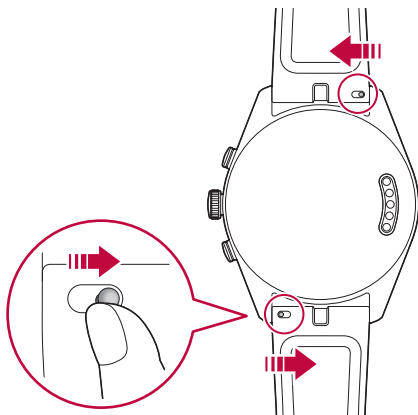

2

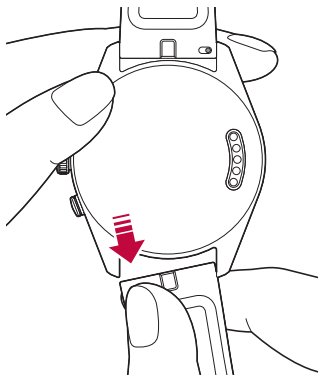



- You can change the snap-and-swap band into other band on the market. The LG limited warranty does not cover the use of third party bands.

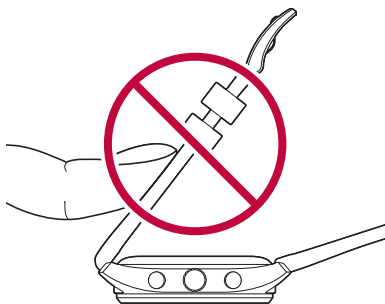

- Excess force on the watch band may lead to breakage.

Charging Your Watch

Before using your watch for the first time, you should charge the battery. Use the charging cradle provided with your watch to charge its battery.

The supplied charging cable will allow you to charge from a power outlet or from a computer.



- When the battery power is low, the battery icon may show as empty. If the battery charge is completely empty, the watch cannot be turned on immediately after connecting the charger. Leave an empty battery to charge for a few minutes before turning the device on. Some features are not available while the battery is charging.



- To charge your device, always use the power adapter and charging cradle that come with your device. Using third-party charging accessories can cause fire, electric shock, injury, or damage to your device or other property.

Do NOT attempt to remove the back cover.

- This device has a non-removable battery. Do not attempt to remove the back cover. Doing so may severely damage the battery and device, which could cause overheating, fire, and injury.

- 1 Connect the USB plug on the charging cradle to the charger adapter.
- 2 Plug the charger adapter into a power outlet.

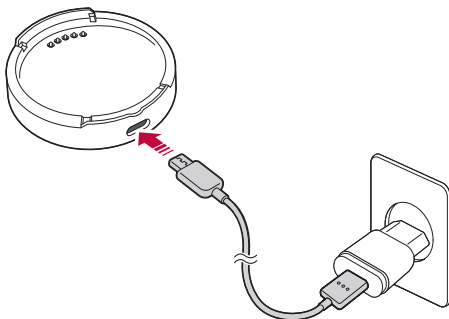

3 Place your device on the charging cradle as shown below.

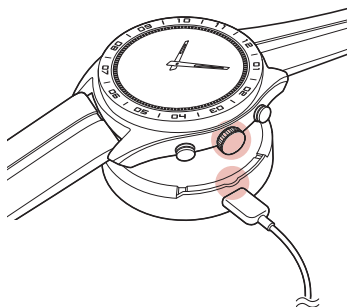

4 Press down the device on the charging cradle until you hear the "click" sound.

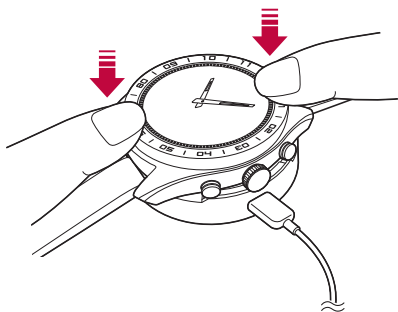



- The charging cradle is designed to only be used with the watch and is not compatible with other devices.
- To maximise battery life, make sure that the battery is fully charged before you use the device for the first time.
- Exposure to liquids or other foreign materials while using your device may affect the charging cradle, causing it to disconnect from the watch while charging.
- If the charging screen does not display after connecting to a power source, adjust your device's position on the charging cradle.
- Do not charge while the device, charging cradle or charging cable is wet or contains moisture. This can cause fire, electric shock, injury or damage to device.

5 While your watch is charging, the screen will show the time, battery percentage and charging progress (indicated by the ring around the outside).

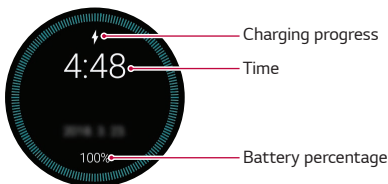

6 Once the battery is fully charged, remove it from the charging cradle.



- The watch may become warm while charging. If the device becomes hotter than usual, discontinue charging until it cools.

Using the battery efficiently

To minimise battery consumption, follow these tips.

- Turn off the Always-on screen option when not using your watch for a long time.
- Minimise the screen brightness.
- Turn off the Wi-Fi network function when not using Wi-Fi.
- Turn off the Gestures feature.
- If you get notifications on your companion device that you don't want to see on your watch, go to the Wear OS by Google™ app Settings on your companion device and add those apps to the **Block app notifications**.
- If you feel the battery life is short after installing some specific app, try to uninstall it.



- Battery Saver is automatically enabled at the 15% battery capacity on your watch. In battery saver mode, the ambient display and Wi-Fi are set to off.

If the Screen Freezes

If the device freezes up and stops working, press and hold the **Power/Rotating side button** until the device reboots and the LG logo is displayed.

Turning the Watch On and Off

Turning the Watch On

Press and hold the **Power/Rotating side button** for a few seconds.

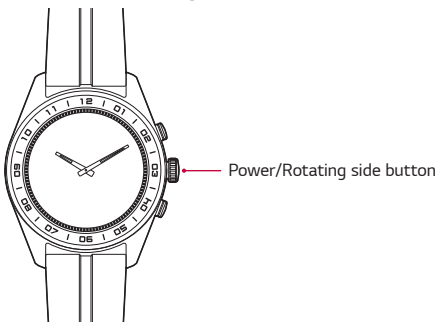

Turning the Watch Off

- 1 Press the **Power/Rotating side button** to open the Apps screen.
- 2 Tap **Settings > System > Turn off**.
- 3 When prompted with the message **Turn off: Are you sure?**, tap .

Waking Your Watch Up

If the screen is dimmed or off, you can wake up the watch by doing any of the following:

- Touch the screen.
- Raise your wrist such that the display of the watch is pointing towards your eyes.
- Press the **Power/Rotating side button** on the watch.

Dimming the Screen

Cover the screen with your palm until it vibrates.

Using the Touch Screen

You can familiarise yourself with how to control your device by using touch screen gestures.

Tapping

Lightly tap with your fingertip to select or run an app or option.

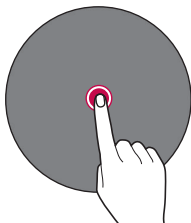

Touching and holding

Touch and hold for several seconds to display the available options.

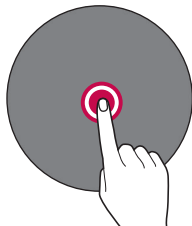

Swiping

Quickly move your finger across the surface of the screen, without pausing when you first touch it.

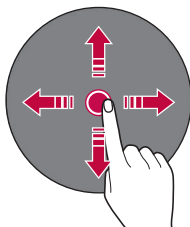

- Do not expose the touch screen to excessive physical shock. It might damage the touch sensor.



- A touch screen failure may occur if you use the device near a magnetic, metallic or conductive material.
- If you use the device under bright lights, such as direct sunlight, the screen may not be visible, depending on your position. Use the device in a shady location or a location with an ambient light that is not too bright and bright enough to read books.
- Do not press the screen with excessive force.
- Touch control may not work properly if you tap while wearing a glove on or by using the tip of your fingernail.
- The touch screen may not function properly if a screen-protective film or accessory is attached to the device.
- Do not display non-moving images for an extended period. This may cause image burn-in on the screen.
- Applications that show the same screen for more than 10 minutes are not recommended because they may cause screen damage that is not covered by the warranty.



02

Connecting the Watch to Your Companion Device

Setting Up Your Companion Device

Before pairing, follow these steps to set up your companion device that you want to pair with your watch.

- 1 Make sure the companion device is running Android™ 4.4+ or iOS 9.3+ and supports **Bluetooth®**.
 - If your companion device is not Android 4.4+ or iOS 9.3+, please check with your manufacturer for a possible software update.
- 2 Make sure your companion device supports Wear OS by Google.
 - To find out, visit <http://g.co/WearCheck> from your companion device.
- 3 Turn on Bluetooth on your companion device if it isn't already on.
- 4 Make sure your companion device is next to your watch.
- 5 On your companion device, download the Wear OS by Google app from the **Play Store** or **App Store** and install it. If Wear OS by Google is already on your companion device, make sure you have the most recent version.
- 6 Make sure your companion device is connected to mobile data or a Wi-Fi network. You need a data connection to set up your watch for the first time.



- Depending on the network connection, the setup process might take over 20 minutes.

Pairing Your Watch with Your Companion Device

Step 1. Follow these steps on your watch.

- 1 Turn on the watch and tap the screen to begin.
- 2 Tap a language.
- 3 Swipe up and follow the onscreen instructions until the watch name is displayed.

Step 2. Follow these steps on your companion device.

- 1 Open the Wear OS by Google app on your companion device.
- 2 On your companion device, you'll see a list of nearby devices. Tap your watch's name.
- 3 You'll see a passkey on your companion device and watch. Check that the codes match.
- 4 Tap **PAIR** on your companion device to start pairing.

Step 3. Follow these steps to pair your watch with your companion device.

- 1 You'll see a confirmation message on your watch once it is paired. This may take a few minutes.
- 2 Follow the onscreen instructions to complete the initial setup.
- 3 When your watch completes the connection with your companion device, you'll be asked to copy your Google accounts on your companion device to your watch.



- Copying a Google account to your watch allows you to download new apps using the Play Store.
- Once initial setup is complete, you will see a tutorial notification . Follow the tutorial notices before using your watch.

Connecting to Another Companion Device

Your watch connects to one mobile device at a time. If you want to connect your watch to a different device, you must reset your watch using the **Disconnect & reset** setting on your watch.

Unpairing and Resetting Your Watch

This setting unpairs the watch from your companion device and resets your watch's settings to their factory default values and deletes all of your data.

- 1 Press the **Power/Rotating side button** to open the Apps screen
- 2 Tap **Settings > System > Disconnect & reset**.
- 3 When prompted, tap  to confirm.
- 4 Connect your watch to another device.



- Performing a factory reset erases all data from your watch's memory and all watch data from your companion device. After resetting, your watch is ready to connect to another companion device.



03

How to Use Your Watch

Watch Face Home Screen

The watch face home screen is the starting point for the default screen. You see the current time and date. You can also show the battery level, and more.



- The displayed content depends on the watch face design you select.

Changing the Watch Face

You can add more watch faces and personalise your watch to your style.

- From the watch face home screen, swipe left or right to the last screen and then tap **Add more watch faces** .
- Tap the desired watch face to add it to your favorites and allow you to choose it.
- After adding your favorites, swipe the screen right or left to browse designs, then tap the one you want to choose.

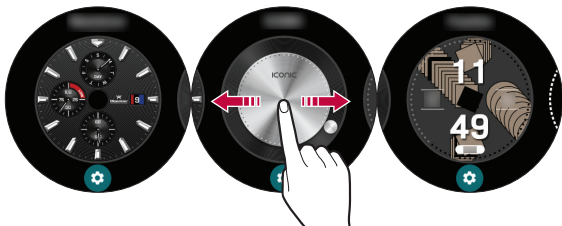



- You can also change and download watch faces through the Wear OS by Google app on your companion device.

Customise the Watch Face Home Screen Menu

- 1 Touch and hold the watch face home screen for one second.

OR

Swipe left or right from the watch face home screen and then tap

Customise .



Customise

- 2 You can customise the shortcuts and watch face layout displayed on the watch face home screen.

Notification Cards

Most notifications you see on your companion device will also show up on your watch. These include notifications for texts, event reminders, and more.

Notifications are displayed in the form of cards. Card previews appear at the bottom of the watch face home screen.

- To see a notification card, swipe the watch face upwards.
- To see more cards, keep swiping up from the bottom of the screen.
- To get more details, tap the notification card.



Notification cards

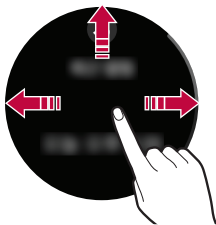

Swipe up to view more notifications.



To remove a notification, swipe left or right.

Blocking Notifications





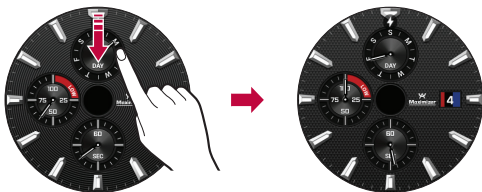

If you get notifications on your companion device that you don't want to see on your watch, you can stop specific apps from showing their notifications on your watch.

- 1 On your companion device, open the Wear OS by Google app.
- 2 Tap  > **Block app notifications** > .
- 3 Select the app you want to block.

Managing the Quick Settings

To open the Quick settings, swipe down on the watch face home screen. The Quick settings allow you to quickly and easily change commonly used settings.



-  : Set the brightness and theater mode.
-  : Tap  to open the Settings app.
-  : Tap  to disconnect all networks and turn off your device's connectivity on your watch.
-  : Your watch will not show any notifications and alerts while this setting is turned on.



- Some content may differ from your companion device depending on the OS version.

JustWatch

You can use the device as a watch only. In the device, you can turn off all features including Wear OS by Google, Watch Face Home Screen, call, messaging, and mobile network to reduce battery consumption.

Activating the JustWatch mode

- 1 Press and hold the bottom right button on the Watch Face Home Screen.

OR

On the settings screen, tap **System > JustWatch > JustWatch**.

- The duration for which you can use the device in the JustWatch mode appears on the top of the screen.
- 2 Tap  on the bottom of the screen.
 - Wear OS by Google turns off and you can use the device as a watch.

Deactivating the JustWatch mode

To turn on the all features including Wear OS by Google, press and hold the **Power/Rotating side button**.

The device turns on and automatically pairs with the mobile device.

Sending a Text

You can ask your Google Assistant to send text messages using your watch.

You can also reply to any text message cards that you receive on your watch.

Apps Screen

The Apps screen displays icons for all apps.

- From the watch face home screen, press the **Power/Rotating side button** to open to the Apps screen.
- To open an app on the Apps screen, tap an app icon.



- To set the favorite app, touch and hold a app. Then this app will be appeared at the top of the app list.

Master Tools

You can use various functions.

Compass

Use the compass function to measure the direction.

- Follow the on-screen instructions to calibrate the compass.



- Calibrate the compass in a place where the magnetic field cannot affect the device, or outdoor. If there are objects to affect the magnetic field including metals or rebar, or if you are inside the building you may not calibrate the compass properly.
- In case of the compass is not calibrated properly, check that there are no objects or materials including metals to affect the magnetic field, and then swipe the compass upwards to calibrate again.

Stopwatch

You can use the stopwatch to record a lap time.

- Press Top right button to initiate or suspend the stopwatch.
- Press Bottom right button to record a lap time or reset.



Timer

You can set the timer to trigger an alarm after a specified period of time.

- Tap the desired time to start.
- To suspend or resume the timer, press top right button. To cancel the timer, press bottom right button.



Calibration

To synchronise the time perfectly between your device and the mobile device, calibrate the hour hand and the minute hands. Align the hour and the minute hand to the red dot on the top of the screen, then tap the screen.

- To move the hour hand, tap the Top right button then align the hour hand to the red dot on the top of the screen.
- To move the minute hand, tap the Top right button then align the hour hand to the red dot on the top of the screen.



Barometer

You can check the atmospheric pressure in the current location.



- The screen displays current atmospheric pressure and temperature.
- You can set the unit of the atmospheric pressure and temperature by swiping the screen upwards.
- This feature is available only when the GPS feature is activated on your mobile device.

Altimeter

You can check altitude in the current location.



- The screen displays current altitude and temperature.
- You can set the unit of the altitude and temperature by swiping the screen upwards.
- This feature is available when the Location feature is activating on your mobile device.
- This feature is provided for your convenience only.

Google Fit

Google Fit helps to work out when you're walking, jogging or cycling. Set fitness goals and regularly record and check your progress.

To Open the Google Fit App

Open the Apps screen and then tap **Fit**.



- If you feel discomfort while using the device, stop using it and remove it from your wrist.
- If your device becomes hot to the touch, please remove it until it cools.
- This feature is provided for user convenience. Please use for reference only.

Using the Google Fit App

Setting up your goal

- 1 Open the **Fit** app to personalise your goal.
- 2 Swipe up and tap **Add goal** (➕) to set one of the following preset goals or create your own: **Take 10,000 steps a day**, **Active 30 min a day**, **Running 3 times a week**, **Steps**, **Distance**, **Active time**, **Calories**.

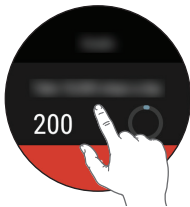

Viewing your workout report





Your workout log displays your active time, steps, distance, and active calories.

- 1 Open the **Fit** app and swipe up until the workout report appears.
- 2 Tap each goal option to show workout information and a graph depicting weekly data.



Using the Fit Workout App

Open the Fit Workout app

- 1 Open the **Fit** app and tap **Fit Workout** .
OR
Open the **Fit Workout** app.
- 2 Tap the desired workout mode.
- 3 Tap **START** to start monitoring your workout.
 - Tap  to pause or  to resume the workout.
 - Tap  to save and exit your workout and view your workout report.

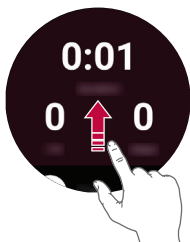

Opening the Apps Installed On Your Watch

The apps list shows you all of the applications installed on the watch. Swipe up and down to scroll through the list, and then tap one to use it. The most recently used app is displayed at first top of the circle.



- Default apps on the device are subject to updates. Support for these apps may be withdrawn without prior notice. If you have any questions about an app provided with the device, please contact an LG Service Centre. For user-installed apps, please contact the relevant service provider.
- Modifying the device's operating system or installing software from unofficial sources may damage the device and lead to data corruption or loss. Such actions will violate your LG license agreement and void your warranty.

Viewing the Apps List

- 1 If your screen is dimmed, tap the screen to wake up the watch.
- 2 Press the **Power/Rotating side button** to open the Apps screen.

Downloading Other Apps

After copying your companion device's Google accounts to your watch, you can download more apps on Google Play™ store.

To use the same apps which are already installed on your companion device, download them again on your watch. You can download them easily via the 'Apps on your phone' category on Google Play™ store.



- The apps on your device, and their functions, may vary according to country, region or hardware specifications. LG will not be responsible for any performance issues which arise from using applications developed by providers other than LG.
- LG will not be responsible for performance or incompatibility issues which arise from edited registry settings or modified operating system software.
- Any attempt to customise your operating system may lead to the device or its apps not working correctly.
- Software, audio, wallpaper, images, and other media supplied with your device are licensed for limited use. If you extract and use these materials for commercial or other purposes, you may be infringing copyright laws. As a user, you are entirely responsible for the illegal use of media.
- Additional charges may apply for data services, such as messaging, uploading, downloading, auto-syncing and location services. To avoid additional charges, select a data plan suitable to your needs. Contact your service provider for details.
- This content is not supported in iOS version.



04

Tasks Using Voice Command

Getting help from your Google Assistant on Your Watch

Your watch has the Google Assistant built in. Ask it questions. Tell it to do things. It's your own personal Google. Just say **"OK Google"** or press and hold the **Power/Rotating side button** until you see **Hi, how can I help?**



- To get help from your Google Assistant a data or Wi-Fi connection is required on your companion device, and the devices must be within Bluetooth range.
- This feature may vary or may not be supported, depending on the area, languages, or paired devices.
- IF you can use this function, activate it Tap **Settings > Personalisation > 'Ok Google' detection**.

Setting a Reminder

You can ask your Google Assistant to set a reminder. When a reminder is set, a card will appear at the reminder time.

- 1 If your screen is dimmed, tap the screen to wake up the watch.
- 2 From the watch face home screen, say **"OK Google"** or press and hold the **Power/Rotating side button** until you see **Hi, how can I help?**
- 3 Say **"Remind me"**.
- 4 Complete your reminder when prompted. Your reminder will automatically save after a few seconds (tap the **⊗** before it finishes saving to cancel it.)

Seeing Your Step Count

You can view your step count goal, the number of steps you have taken today and each day over the last week, as measured by the Fit app.

- 1 If your screen is dimmed, tap the screen to wake up the watch.
- 2 From the watch face home screen, say **“OK Google”** or press and hold the **Power/Rotating side button** until you see **Hi, how can I help?**
- 3 Say **“Show me my steps.”** You will see your daily step count information.

Sending a Text

You can ask your Google Voice to send text messages using your watch. You can also reply to any text message cards that you receive on your watch.

Sending a Message

- 1 If your screen is dimmed, tap the screen to wake up the watch.
- 2 From the watch face home screen, say **“OK Google”** or press and hold the **Power/Rotating side button** until you see **Hi, how can I help?**
- 3 Say **“Send a text.”**
- 4 **To whom?** will appear. Say the name of the contact you want to send a text message to. You can also say a mobile phone number for numbers not saved in your companion device’s Contacts list.
- 5 You will be prompted to say the message you want to send. Say your message.
- 6 Tap **▶** to send the text message (tap **⊗** to cancel it).

Replying to a Message

When you get message notifications on your companion device, cards will appear on your watch. Tap the notification and swipe up until **Reply** appears. Tap **Reply**, then say your message or insert emoticons or input message using the keyboard. To insert an emoticon, like a smiley, into the message, tap 😊.



• This content is not supported in iOS version.

Setting a Timer

You can ask your Google Assistant to set a timer. Once a timer set, a card is displayed with the countdown.

- 1 If your screen is dimmed, tap the screen to wake up the watch.
- 2 From the watch face home screen, say "**OK Google**" or press and hold the **Power/Rotating side button** until you see **Hi, how can I help?**
- 3 Say "**Set a timer**".

Using the Stopwatch

Measure how much time has passed by starting a stopwatch.

- 1 If your screen is dimmed, tap the screen to wake up the watch.
- 2 From the watch face home screen, say **“OK Google”** or press and hold the **Power/Rotating side button** until you see **Hi, how can I help?**
- 3 Say **“Start stopwatch.”**
- 4 Press Top right button to start.

Setting an Alarm

Multiple alarms can be set on your watch separately from alarms set on your companion device. Alarms set on your watch will not transfer to your companion device, but alarms activated on your companion device will display an alarm card (with vibration and sound, if set) on your watch.



- 1 If your screen is dimmed, tap the screen to wake up the watch.
- 2 From the watch face home screen, say **“OK Google”** or press and hold the **Power/Rotating side button** until you see **Hi, how can I help?**
- 3 Say **“Set an alarm.”**

Managing Your Alarms

You can view, edit, and delete the alarms that you set on your watch.

- 1 If your screen is dimmed, tap the screen to wake up the watch.
- 2 From the watch face home screen, say **“OK Google”** or press and hold the **Power/Rotating side button** until you see **Hi, how can I help?**
- 3 Say **“Show alarms.”**



- Tap  next to an alarm to edit or delete it.
- Tap  to manually set an alarm.



05

Settings

Opening the Settings Menu

If your screen is dimmed, tap the screen to wake up the watch.

- Press the **Power/Rotating side button** to open the Apps screen, then tap **Settings** .

OR

Swipe down on the watch face home screen, then tap **Settings** .



- Tap a setting to turn it on or off, open a list of choices, or view information.

Display

From the **Settings** , tap **Display**.

- **Change watch face:** You can set the watch's face. See *Changing the Watch Face* for details.
- **Adjust brightness:** You can set the level of brightness for your watch's display.
- **Font size:** You can set the size of the font displayed on your watch's screen.
- **Always-on screen:** When you're not using the watch, the screen can either turn off or on, depending on your settings.
- **Touch lock:** You can set the lock of the touch screen. To unlock the touch screen, press **Power/Rotating side button**.

Apps & notifications

From the **Settings** , tap **Apps & notifications**.

- **App info**: You can see information about installed apps.
- **App notifications**: You can set how app alerts are sent.
- **App permissions**: You can check permissions of installed apps.
- **Notification previews**: Enables or disables notification previews.
- **Override Do Not Disturb for...**: Select apps to receive notifications in Do Not Disturb mode.
- **Vibration pattern**: Select the vibration pattern.

Gestures

From the **Settings** , tap **Gestures**.

- **Tilt-to-wake**: You can set to tilt your watch to turn on the screen.
- **Touch to wake**: You can set to touch your watch to turn on the screen.
- **Wrist gestures**: You can set to flick your wrist to browse the screen.
- **Launch tutorial**: View a tutorial about using gestures on your watch.
- **More tips**: Opens a webpage on your companion device to help you with more tips for gestures.

Connectivity

From the **Settings** , tap **Connectivity**.

Bluetooth

- **Bluetooth:** Tap the switch to toggle it On or Off. On allows you to pair and connect with other Bluetooth devices.
- **Available devices:** Displays all of the Bluetooth devices that are within your companion device's range. Tap one to pair and connect.



- When using Bluetooth to connect to other mobile devices, the devices must be positioned close to each other. If not, it may cause abnormal operation or noise, depending on the use environment.
- In an open space, the Bluetooth communication range usually spans approximately 10m. This range may vary depending on the use environment.
- Do not place obstacles between your product and connected devices. Outgoing/incoming signals can weaken due to user's body, walls, corners or obstacles. Use where there is no obstacle.
- Only Bluetooth devices that support the A2DP and HFP profile are supported.

Wi-Fi

- **Wi-Fi:** Tap the switch to toggle it On or Off. On connects to a Wi-Fi network (from your list of available, detected networks).
- **Add network:** Allows you to manually add a Wi-Fi network by entering its name (SSID), security, and password.
- **Saved networks:** Displays your saved Wi-Fi networks allowing you to manage them.
- **About Wi-Fi:** Help is displayed when the product is using a Wi-Fi network.



- When using a Wi-Fi connection, your watch can get notifications from your device even if Bluetooth is unavailable.
- Your watch will search and connect to the nearest Wi-Fi network based on the Wi-Fi list registered on your device.

Aeroplane mode

Tap the switch to toggle it On or Off. When Aeroplane mode is on, you can use still many of the features on your watch when you are on an aeroplane or anywhere else where sending or receiving data is prohibited.



- Turning on Aeroplane mode on your watch does not activate it on the your companion device. If you want to activate aeroplane mode on your companion device, you'll need to turn it on separately.

Location

Tap the switch to toggle it On or Off. You can manage your location services for determining your approximate location. Some apps like Weather and Maps need your location to work.



- When paired with a companion device, the watch will use the location of the companion device. To improve location accuracy when paired with a device, turn on High accuracy in your companion device's location settings.

Accessibility

From the **Settings** , tap **Accessibility**.

- **Magnification gestures:** You can set to enable magnification to zoom in and out with triple tap.

Personalisation

From the **Settings** , tap **Personalisation**.

- **Screen lock:** You can customise screen lock settings for your device.
 - **Pattern:** Draw a pattern to unlock the screen.
 - **PIN:** Enter a numeric password to unlock the screen.
 - **Password:** Enter an alphanumeric password to unlock the screen.
 - **None:** Deactivate the screen lock function.
- **Input methods:** You can customise keyboard settings for your device.
- **Accounts:** You can add or remove a Google account to your watch.
- **Customise hardware buttons:** You can customise the **Bottom right button**.
- **Smart Reply:** You can use one of the suggestion sentences to reply to a message.
- **'Ok Google' detection:** Allows you to use Ok Google.

- **Device administration:** Allows you to view and disable your device administrators.
- **Enable alternate launcher:** Allows you to use alternate launcher.

System

From the **Settings** , tap **System**.

- **Battery Saver:** Reduce battery consumption by cutting down some device settings.
- **JustWatch:** You can only use a watch. All features can be turned off to use the watch, saving battery life.
- **Date & time:** You can set how your watch syncs and displays the date, time, and time zone.
- **Restart:** You can restart your device.
- **Turn off:** You can turn off your device
- **Disconnect & reset:** You can unpair the watch from your companion device and reset your watch's settings to their factory default values. Please note that this deletes all of your data on your watch.
- **About:** Displays the Model, Device name, Versions (for Google and Android software), Serial number, Build number, Connection, and Battery information. The following options are also available:
 - **System updates**, **Legal notices** and **Terms of USE for LG apps**
- **Regulatory information:** Displays regulatory information.



06

More Information

Open Source Software Notice Information

To obtain the source code under GPL, LGPL, MPL, and other open source licenses, that is contained in this product, please visit <http://opensource.lge.com>.

In addition to the source code, all referred license terms, warranty disclaimers and copyright notices are available for download.

LG Electronics will also provide open source code to you on CD-ROM for a charge covering the cost of performing such distribution (such as the cost of media, shipping, and handling) upon email request to opensource@lge.com.

This offer is valid for a period of three years after our last shipment of this product. This offer is valid to anyone in receipt of this information.

Trademarks

- Copyright ©2018 LG Electronics Inc. All rights reserved. LG and the LG logo are registered trademarks of LG Group and its related entities.
- Bluetooth® is a registered trademark of Bluetooth SIG, Inc. worldwide.
- Wi-Fi® and the Wi-Fi logo are registered trademarks of the Wi-Fi Alliance.
- App Store is a registered trademark of Apple Inc.
- Google and Wear OS by Google are registered trademark of Google LLC.



- All other trademarks and copyrights are the property of their respective owners.

DECLARATION OF CONFORMITY

Hereby, **LG Electronics** declares that this **LM-W315** product is in compliance with the essential requirements and other relevant provisions of Directive **2014/53/EU**.

A copy of the Declaration of Conformity can be found at <http://www.lg.com/global/declaration>.

Regulatory information (Regulation ID number, E-labeling, etc.)

For regulatory details, go to **Settings > System > Regulatory information**.

How to Update Your Device

Access to latest firmware releases, new software functions and improvements.

- Press the Power/Rotating side button and tap **Settings > System > About > System updates**.



07

Safety Information

Before turning on your product, review the basic safety information provided here.

Safety tips

To avoid damaging your product and reduce the risk of fire or electric shock, explosion, or other hazards, observe the following safety precautions:

- To charge your device, always use the included power adapter, USB cable, and charging cradle that come with your device. Using third-party charging solutions can cause fire, electric shock, injury, or damage to your device or other property.
- Available accessories may vary depending on your region, country or service provider.
- Some contents and illustrations may differ from your device depending on the region, service provider, software version, or OS version, and are subject to change without prior notice.
- Do not damage the power cord by bending, twisting, pulling, heating, or placing heavy items on it.
- This product is equipped with a charging cradle for connecting to a desktop or notebook computer or to the charger. Be sure your computer is properly grounded before connecting your product to the computer. The power supply cord of a desktop or notebook computer has an equipment-grounding conductor and a grounding plug. The plug must be plugged into an appropriate outlet that is properly installed and grounded in accordance with all local codes and ordinances.
- Do not open, disassemble, crush, bend or deform, puncture, or shred the product.
- Do not insert foreign objects into the product.
- Do not place the product in a microwave oven.
- Do not expose the product to fire, explosion, or other hazards.
- Like many electronic devices, your product generates heat during normal operation. Extremely prolonged, direct skin contact in the absence of adequate ventilation may result in discomfort or minor burns. Therefore, use care when handling your product during or immediately after operation.

- If you have a problem with using the product, please stop using it and consult with the authorised LG Electronics customer service center.

General safety & handling

While using your product, be aware of the following common-sense guidelines.

Your environment

- **Safe operating temperatures.** Use and store your product in temperatures between 0°C/32°F and 35°C/95°F. Exposing your product to extremely low or high temperatures may result in damage, malfunction, or even explosion.
- **While driving.** When driving a car, driving is your first responsibility. Using a mobile device or accessory for a call or other application while driving may cause distraction. Keep your eyes on the road.
- **Around explosives.** Do not use in areas where sparks from the product might cause a fire or explosion.
- **On airplanes.** Observe all rules and instructions for use of electronic devices. Most airlines allow electronic use only between and not during takeoffs and landings. There are three main types of airport security devices: X-ray machines (used on items placed on conveyor belts), magnetic detectors (used on people walking through security checks), and magnetic wands (hand-held devices used on people or individual items). You can pass your product through airport X-ray machines. But do not send it through airport magnetic detectors or expose it to magnetic wands.
- Always follow any special regulations in a given area. Turn your device off in areas where use is forbidden or when it may cause interference or danger.

Battery warnings

- Do not disassemble, open, crush, bend or deform, puncture or shred the device.
- Do not modify or re-manufacture the device, attempt to insert foreign objects into the battery, immerse or expose to water or other liquids, or expose to fire, explosion or other hazard.
- Make sure that no sharp-edged items such as animal's teeth or claws, come into contact with the battery. This could cause a fire.
- Only use the battery for the system for which it is specified.
- Use of an unqualified battery or charger may present a risk of fire, explosion, leakage, or other hazard.
- Do not short circuit a battery or allow metallic conductive objects to contact battery terminals.
- Battery usage by children should be supervised.
- Avoid dropping the device. If the device is dropped, especially on a hard surface, and the user suspects damage, take it to a service centre for inspection.
- Improper battery use may result in a fire, explosion or other hazard.
- Always unplug the charger from the wall socket after the product is fully charged to save unnecessary power consumption of the charger.
- Risk of explosion if battery is replaced by an incorrect type. Dispose of used batteries according to the instructions.

Embedded battery



Warning Notice for Battery replacement

- For your safety, do not remove the battery incorporated in the product. If you need to replace the battery, take it to the nearest authorised LG Electronics service point or dealer for assistance.
- Li-Ion Battery is a hazardous component which can cause injury.
- Battery replacement by non-qualified professional can cause damage to your device.

Notes on Water Resistant Properties

This product is water and dust resistant in compliance with the Ingress Protection rating IP68.

Your product has undergone testing in a controlled environment and is proven to be water and dust resistant in certain circumstances (meets the requirements of classification IP68 as described by the international standard IEC 60529 - Degrees of Protection provided by Enclosures [IP Code]; test conditions: 15-35 °C, 86-106kPa, 1.5 meter, for 30 minutes). Do not expose the device in conditions that are different from the test conditions. Results may vary in actual use.



WARNING

Despite a rating of IP68, your device is not impervious to conditions not tested in LG's controlled environment. Please note that any damages that occur due to such causes changes the colour of the LDI (Liquid Damage Indicator). If the colour of LDI located inside the product changes, the product is to be considered ineligible for any free-of-charge repair services provided under the product's limited warranty. Avoid exposing the product to environments with excessive dust or moisture. Do not use the product in the following environments.



Do not immerse the product in any liquid chemicals (soap, etc.) other than water.



Do not immerse the product in salt water, including seawater.



Do not immerse the product in a hot spring.



Do not swim with this product.



Do not place the product directly on sand (such as at a beach) or mud.



Do not immerse your product in water deeper than approximately 1.5 meters.

Do not immerse your product in water for longer than 30 minutes.

- If your product becomes wet be sure to wipe the microphone and device with a dry cloth before use.
- Should your product or your hands become wet, dry them before handling the product.
- Do not use the product in places where it may be sprayed with high pressure water (e.g. near a faucet or shower head) or submerge it in water for extended periods of time, as the product is not designed to withstand high water pressure.
- This product is not resistant to shock. Do not drop the product or subject it to shock. Doing so might damage or deform the main unit, causing water leakage.
- The product's water and dust resistant features may be damaged by dropping or receiving an impact.
- If the product gets wet, use a clean, soft cloth to dry it thoroughly.
- The touch screen and other features may not work properly if the device is used while wet.



- Failure to follow the provided instructions may invalidate your device's limited warranty.

Pacemakers and other medical devices

Persons with pacemakers should:

- Always keep the product more than six (6) inches from their pacemaker when the product is turned ON.
- Not carry the product in a breast pocket.
- Use the wrist opposite the pacemaker to minimize the potential for RF interference.
- Turn the product OFF immediately if there is any indication that interference is taking place.

If you use any other personal medical device, consult your physician or the manufacturer of your device to determine if it is adequately shielded from external RF energy.

Tips for using Bluetooth and Wi-Fi on your watch

- When connecting your product to other mobile devices, the devices must be positioned close to each other. If not, it may cause abnormal operation or noise, depending on the use environment.
- In an open space, the Bluetooth communication range usually spans approximately 10m. This range may vary depending on the use environment.
- Do not place obstacles between your product and connected devices. Outgoing/incoming signal can weaken due to user's body, walls, corners or obstacles. Use where there is no obstacle.
- When using a Wi-Fi connection, your watch can get notifications from your device even if Bluetooth is unavailable.
- Your watch will search and connect to the nearest Wi-Fi network based on the Wi-Fi list registered on your phone.

Tips for the display screen

- Do not display non-moving images for an extended period. This may cause image burn-in or stains on the screen.
- Applications that display the same screen for more than 10 minutes are not recommended because the potential screen damage is not covered by the warranty.

Exposure to radio frequency energy

Radio wave exposure and Specific Absorption Rate (SAR) information.

This product has been designed to comply with applicable safety requirements for exposure to radio waves. These requirements are based on scientific guidelines that include safety margins designed to assure the safety of all persons, regardless of age and health.

- The radio wave exposure guidelines employ a unit of measurement known as the Specific Absorption Rate, or SAR. Tests for SAR are conducted using standardised methods with the product transmitting at its highest certified power level in all used frequency bands.
- While there may be differences between the SAR levels of various LG product models, they are all designed to meet the relevant guidelines for exposure to radio waves.

- The SAR limit recommended by the International Commission on Non-ionizing Radiation Protection (ICNIRP) is 2 W/kg averaged over 10g of tissue for the Mouth SAR or 4.0 W/kg averaged over 10g of tissue for the Limb-worn SAR.
- The highest SAR value for this model product when tested for use at Next-to-Mouth(Face) is 0.101 W/kg (10g) and for Limb-worn(Wrist) is 0.208 W/kg (10g).
- This device was tested for typical Limb-worn(Wrist) operations kept 0 cm between the user's body(Wrist) and the back of the device. Additionally this device was tested for typical Next-to-Mouth(Face) operations with the front of the device kept 1 cm between the user's mouth(Face) and the front of the device. To ensure compliance with Radio Equipment SAR requirements, please ensure a minimum separation distance of 1 cm is maintained for next-to-mouth (face) operations.

Laser safety statement

Caution!

This product employs a Laser system. To ensure proper use of this product, please read this owner's manual carefully and retain for future reference. Should the unit require maintenance, contact an authorised service centre.

Use of controls, adjustments, or the performance of procedures other than those specified herein may result in hazardous radiation exposure.

To prevent direct exposure to laser beam, do not try to open the enclosure or make direct contact with the laser.

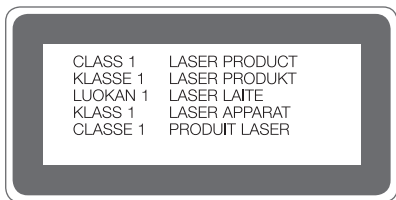



CE