

OLED77G2*
OLED83G2*

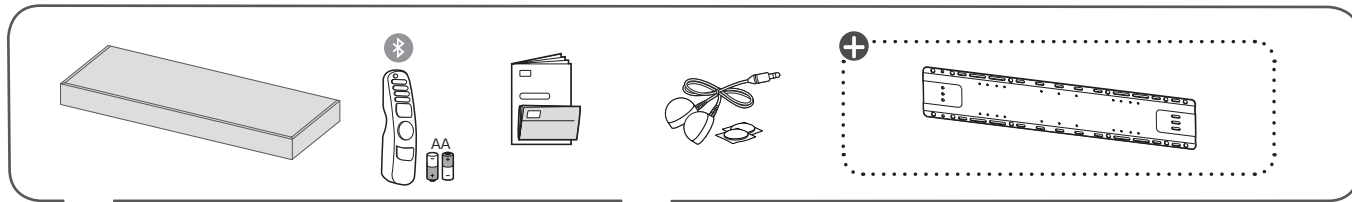

1-A
OLED77G2*

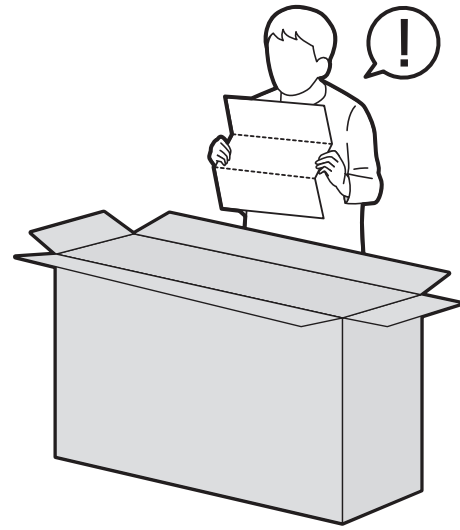
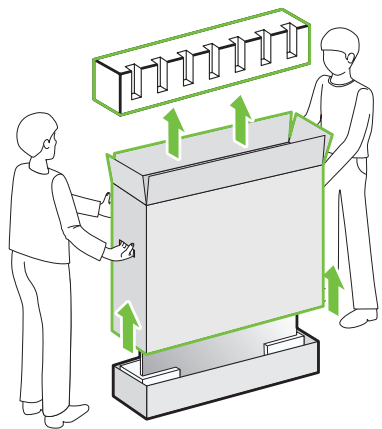

1-B
OLED83G2*

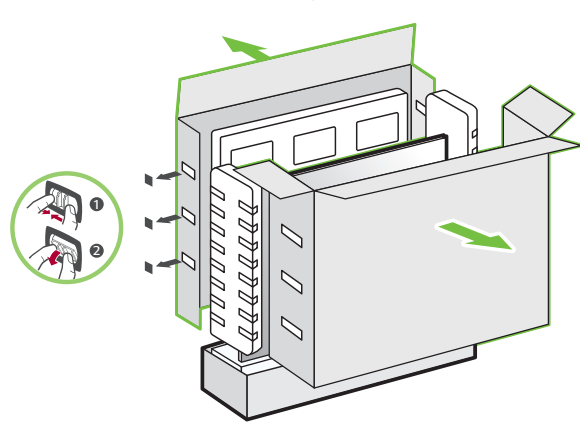

2

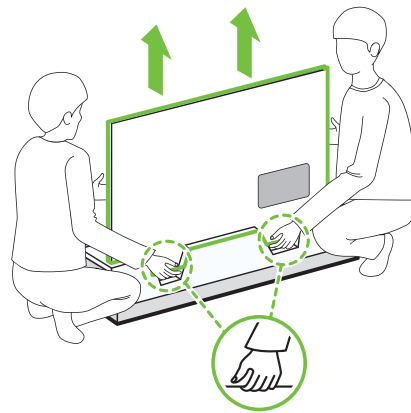

3

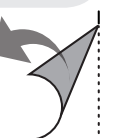
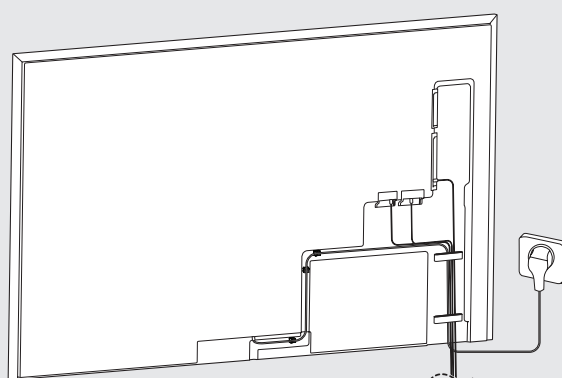
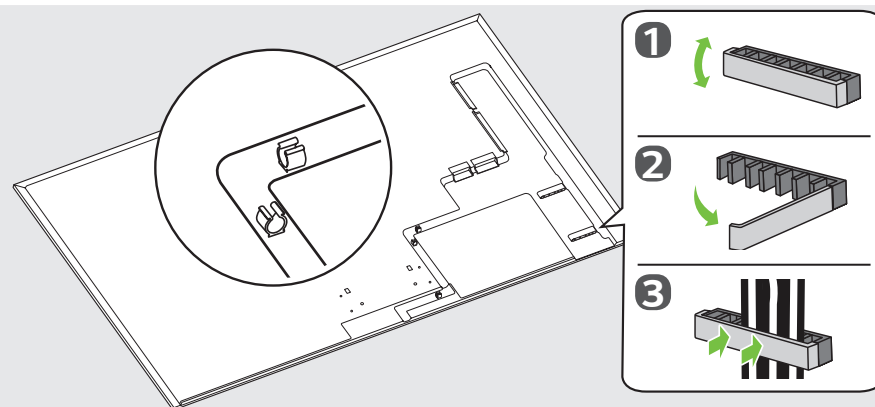
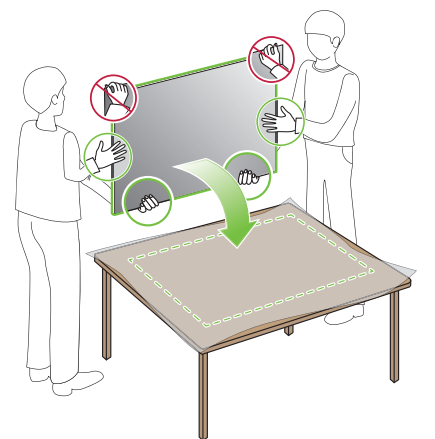

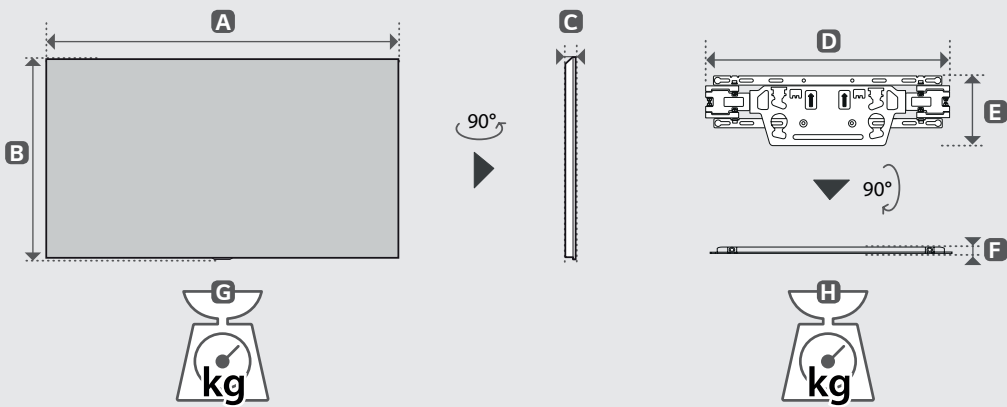
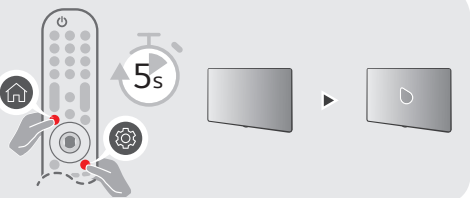
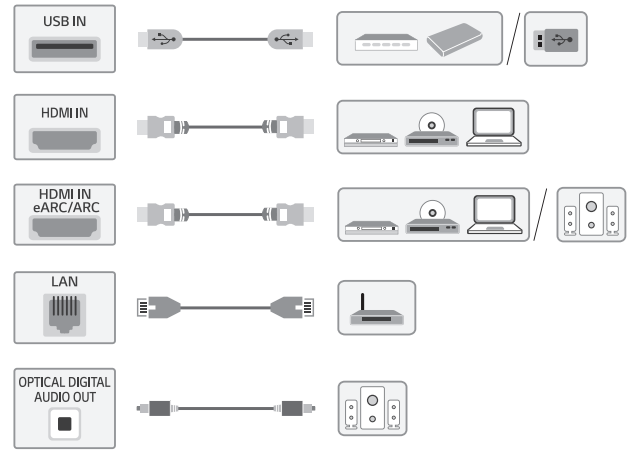
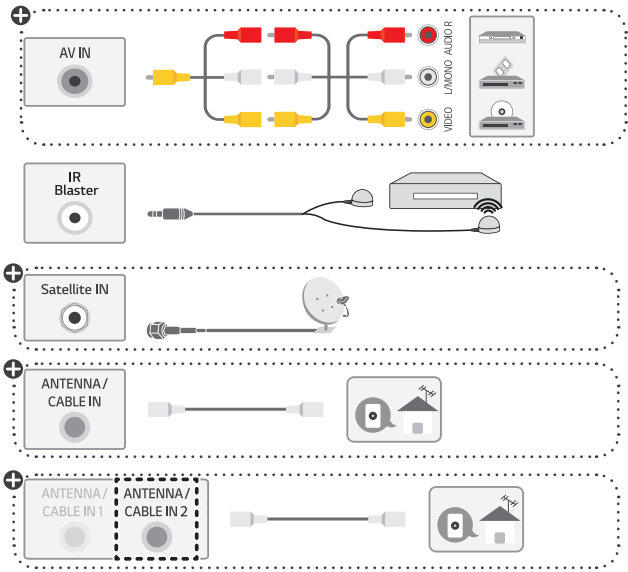

	A	B	C	D	E	F	G	H
	(mm)						(kg)	
OLED77G26LA OLED77G2PSA	1712	976	24.8	452	129	13	35.1	1.2
Power requirement / متطلبات الطاقة / Alimentation / Requisito de alimentação / แรงดันและความถี่ไฟฟ้า / Nguồn điện yêu cầu					AC 100-240 V ~ 50 / 60 Hz تيار متردد 240-100 فولت ~ 60 / 50 هرتز Only India - AC 200-240 V ~ 50 / 60 Hz			
OLED83G26LA OLED83G2PSA	1847	1052	28	452	129	13	40.9	1.2
Power requirement / متطلبات الطاقة / Alimentation / Requisito de alimentação / แรงดันและความถี่ไฟฟ้า / Nguồn điện yêu cầu					AC 100-240 V ~ 50 / 60 Hz تيار متردد 240-100 فولت ~ 60 / 50 هرتز			

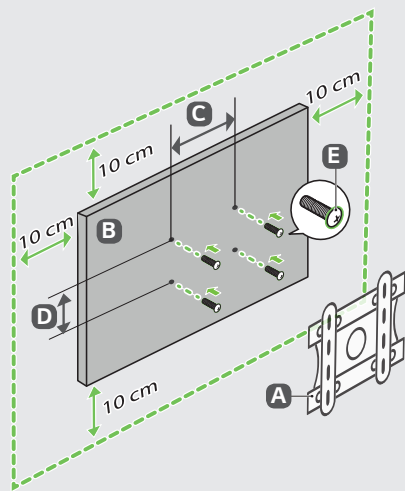

A	B	C x D (mm)	E
OLW480B	OLED77G2*	300 x 300	M6
LSW440B	OLED83G2*	400 x 400	M6



English

• Read **Safety and Reference**.

Français

• Lire le document **Sécurité et référence**.

Português

• Consulte o manual **Segurança e referência**.

ภาษาไทย

• โปรดอ่านคู่มือผู้ใช้**ความปลอดภัยและการอ้างอิง**

Tiếng Việt

• Đọc phần **An toàn và Tham khảo**.

+ : Depending on model / حسب الطراز / Selon le modèle / Dependendo do modelo / ขึ้นอยู่กับรุ่น / Tùy theo mã sản phẩm

English

• The Analog Gender adapter can be purchased separately at Customer Service.

Français

• L'adaptateur analogique peut être acheté séparément auprès du SAV.

Português

• O adaptador analógico pode ser comprado em separado no Serviço de Apoio ao Cliente da LG.

ภาษาไทย

• สายรวมสัญญาณ Component และ AV สามารถซื้อแยกต่างหากได้ที่ศูนย์บริการของบริษัท

Tiếng Việt

• Đầu chuyển tín hiệu analog có thể mua riêng tại Trung tâm chăm sóc khách hàng của LG.

العربية

• قراءة الأمان والمرجع.

العربية • يمكن شراء النوع التناظري بشكل منفصل من دعم عملاء LG.