

OLED65G1PSA OLED77G1PSA

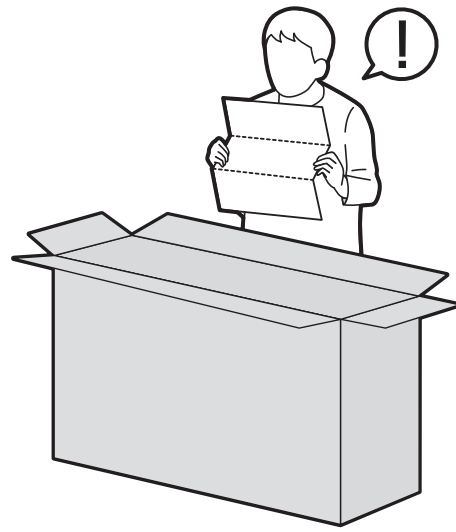

1-A OLED65G1*

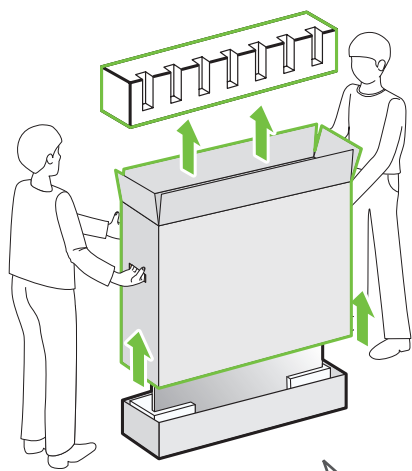

1-B OLED77G1*

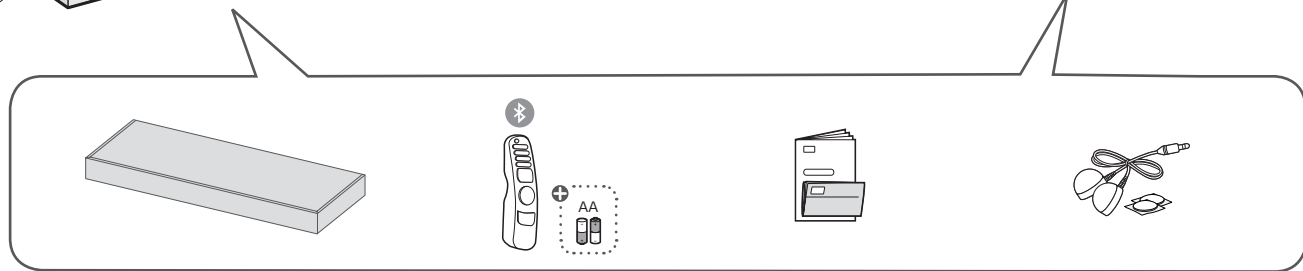
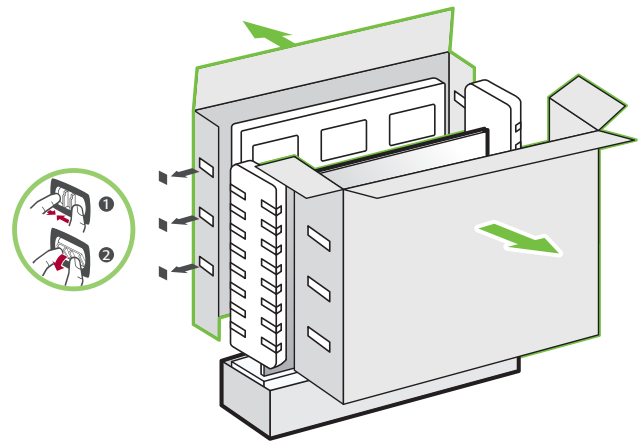

2

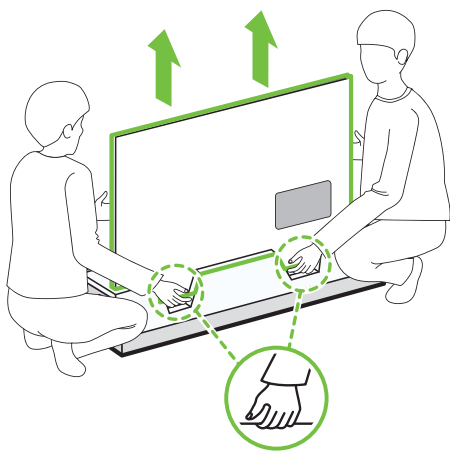

3

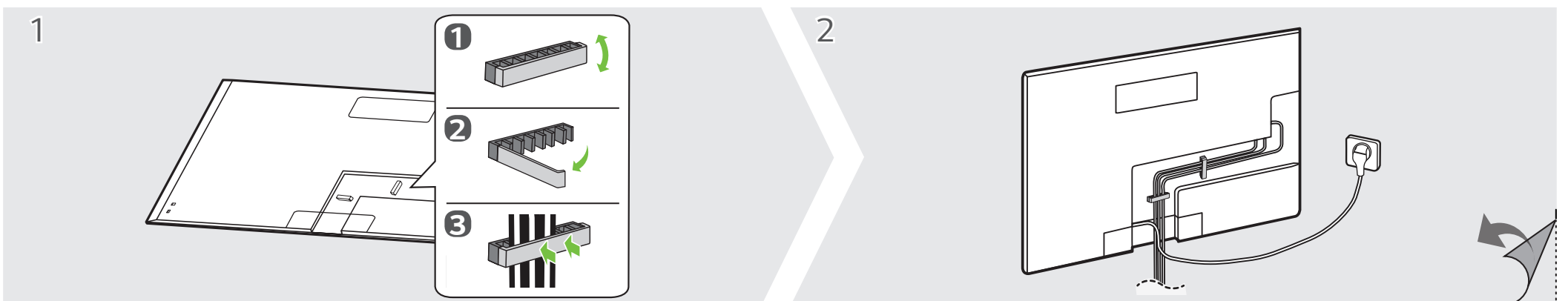
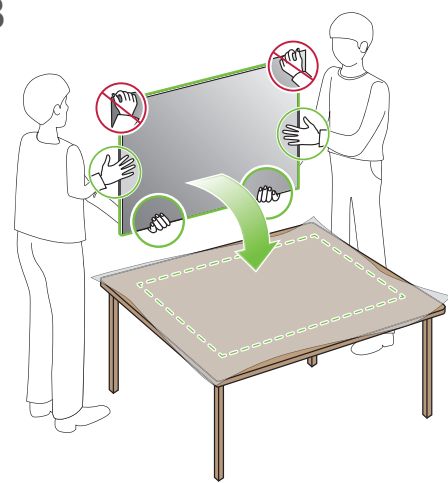

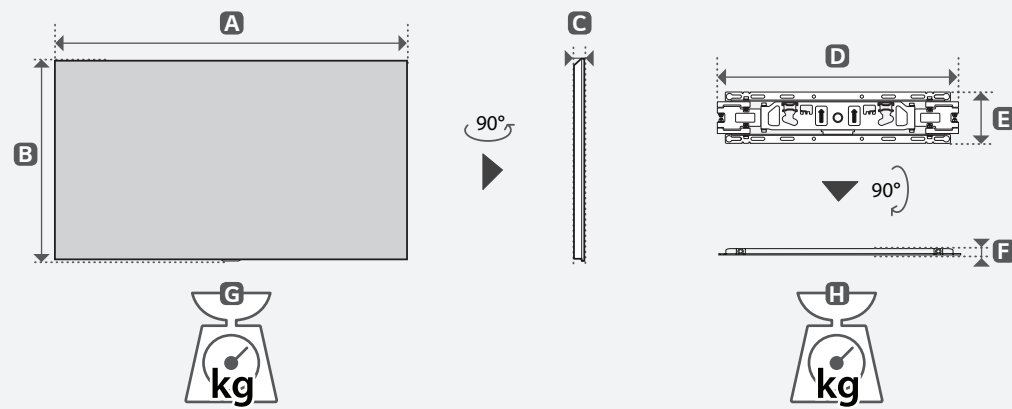
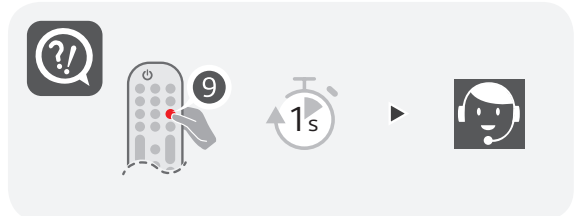
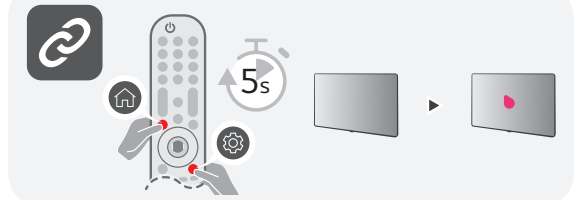
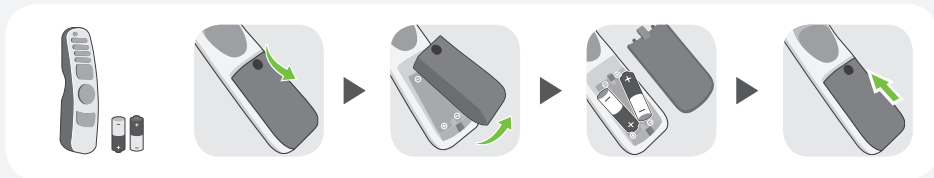
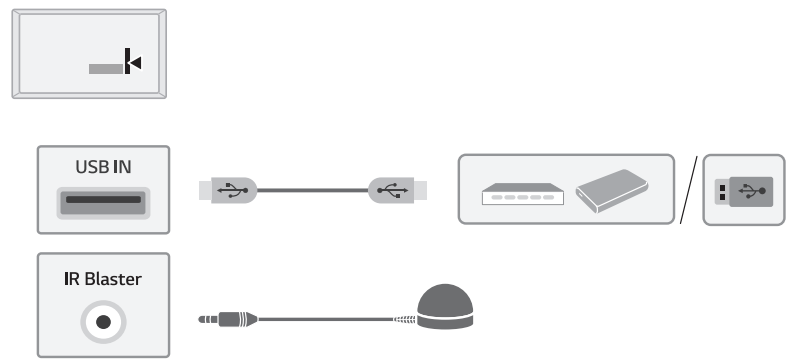
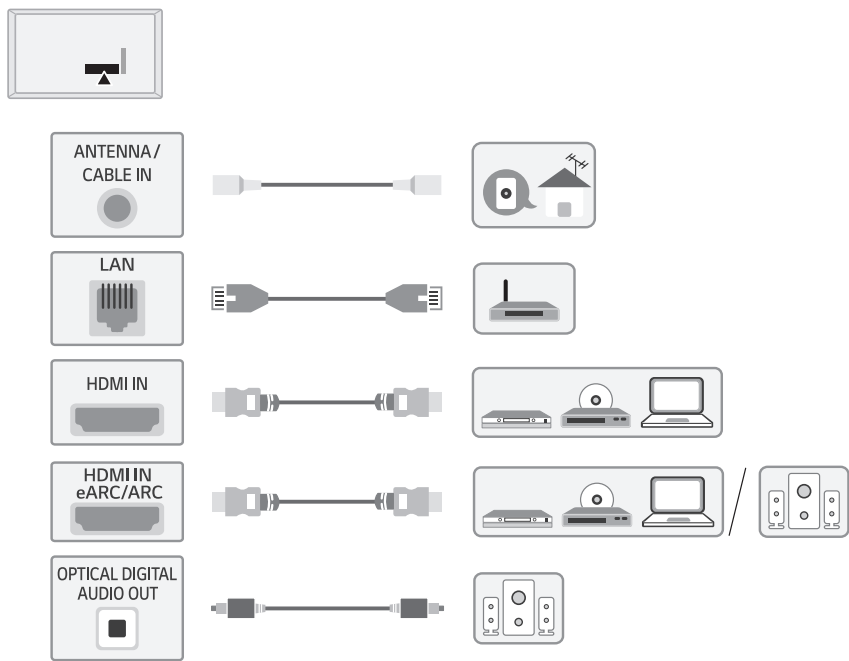

MODELS / MODELOS	A		B		C		D		E		F		G		H		Power consumption / Consumo de potencia		
	(mm)																	(kg)	
OLED65G1PSA	1,446	1 446	830	830	19,9	19,9	452	452	96	96	13	13	29,0	29,0	1,0	1,0	471 W		
OLED77G1PSA	1,721	1 721	991	991	24,1	24,1	452	452	96	96	13	13	39,4	39,4	1,0	1,0	692 W		
Power requirement / Alimentación requerida													AC 100-240 V- 50/60 Hz						



ENGLISH Read **Safety and Reference**.
Due to environmental government regulations about imports and battery destruction in Colombia, TVs will not include the batteries for the remote control.

ESPAÑOL Leer **Seguridad y Consultas**.
Por regulaciones de tipo ambiental respecto a la importación y destrucción de baterías en Colombia; los televisores no van a traer incluidas las pilas del control remoto.

ENGLISH
Easy Setup Guide
Please read this manual carefully before operating your set and retain it for future reference.

ESPAÑOL
Guía Rápida de Configuración
Lea atentamente este manual antes de poner en marcha el equipo y consérvelo para futuras consultas.

⊕ : Depending upon model / Según el modelo